

Ricoh Interactive Whiteboard D6510
(Y306)
Parts Catalog

Parts change information sample

 **Add**

 **Update**

 **Delete**

Model	Product Code	PC Style
Ricoh Interactive Whiteboard D6510	Y306	3D
Ricoh Interactive Whiteboard Camera Unit Type1	Y414	3D
Ricoh Interactive Pen Sensor Kit Type3	Y413	3D
RICOH Interactive Whiteboard Controller Type1	Y406	3D
RICOH Interactive Whitboard Stand Type3	Y408	3D

Unit All



U001
Display



U002
RICOH Interactive Whiteboard Controller Type1



U003
Ricoh Interactive Whiteboard Camera Unit Type1



U004
Ricoh Interactive Pen Sensor Kit Type3



U005
RICOH Interactive Whiteboard Stand Type3

U001 Display



10.Y3033103 SPEAKER:RIGHT:REAR
 12.Y3033105 (x2) HOLDER:SPEAKER
 8.Y3032111 (x4) SCREW:SPEAKER
 24.Y3052112 BRACKET:OPS
 18.Y3052101 FAN:SIDE

11.Y3033104 SPEAKER:LEFT:REAR

7.Y3032101 (x2) BRACKET:GUIDE:OPS

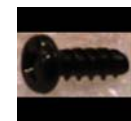

1.Y3021205 (x2) SCREW:IO_3X8_NI:8F.PA724.8R0



3.Y3026002 (NA):POWER SUPPLY CORD:NA:2G.0111.001

29.Y3052117 COVER:REAR:MIDDLE

20.Y3052103 BRACKET:COVER:OPS



4.Y3026003 (EU/AA):POWER SUPPLY CORD:2G.00921.001



5.Y3026011 CABLE:VGA:5K.06202.531

13.Y3033117 PCB:TRANSFER:PW

25.Y3052113 BUTTON:POWER SOURCE



6.Y3026012 CABLE:USB



9.Y3032112 (x8) SCREW:HANDLE

19.Y3052102 (x2) FAN:UPPER

23.Y3052111 (x7) BRACKET:SCREW

2.Y3022505 (x3) BRACKET:FAN:3K.2KS09.001

34.Y3053103 PCB:KEYPAD

32.Y3052205 TRAY:PEN

22.Y3052106 BRACKET:TRAY:PEN

28.Y3052116 COVER:REAR:LOWER

27.Y3052115 COVER:REAR:TERMINAL

21.Y3052104 COVER:USB



14.Y3033124 CABLE:HDMI:REAR



15.Y3033125 CABLE:USB:REAR

U001 Display

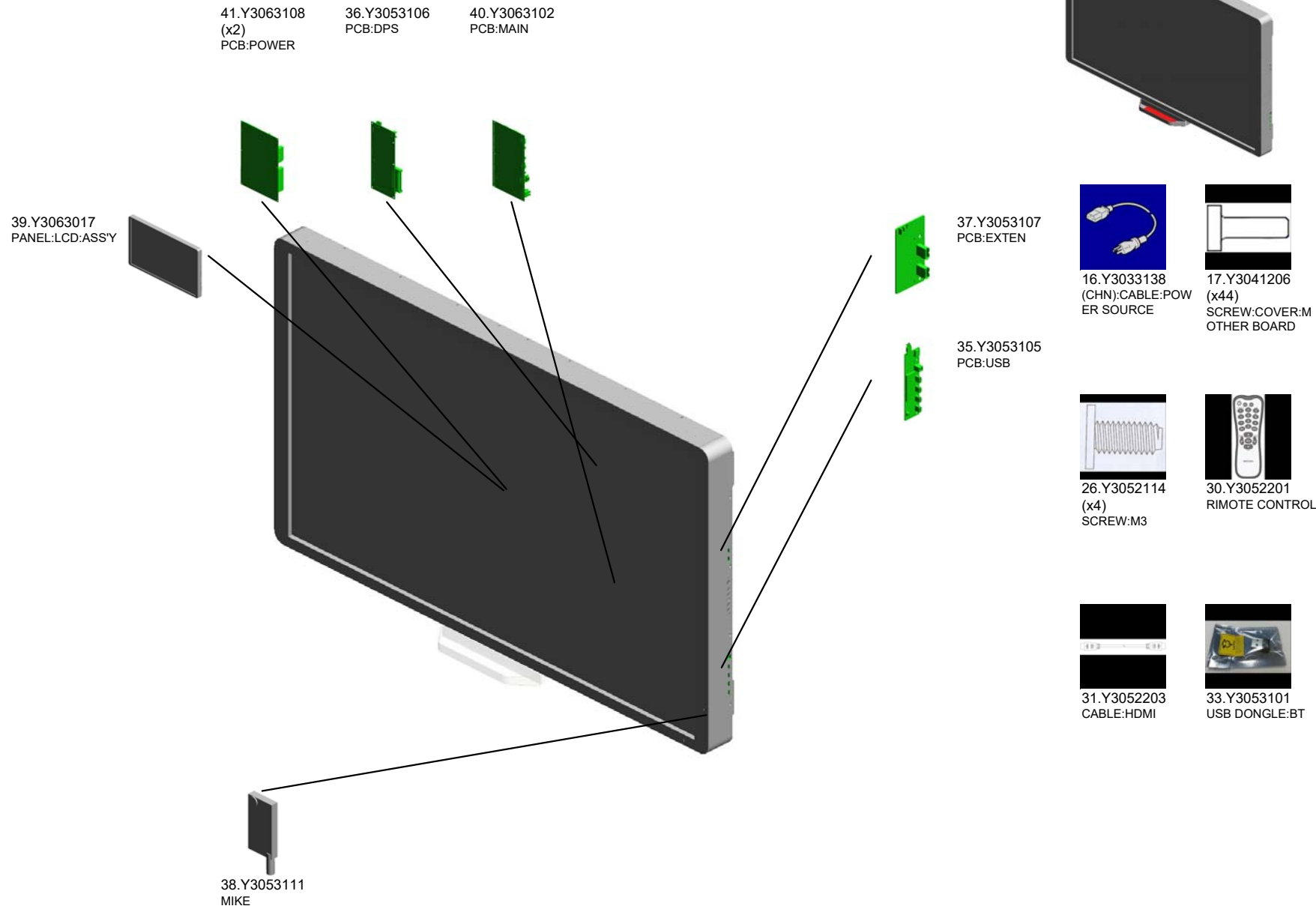

U002.RICOH Interactive Whiteboard Controller Type1

U002_S002
Y4063400
(EU/AA):MODULE:BOX:ASS'Y

U002_S003
Y4063417
(NA):MODULE:BOX:ASS'Y

U002_S004
Y4063421
(CHN):MODULE:BOX:ASS'Y

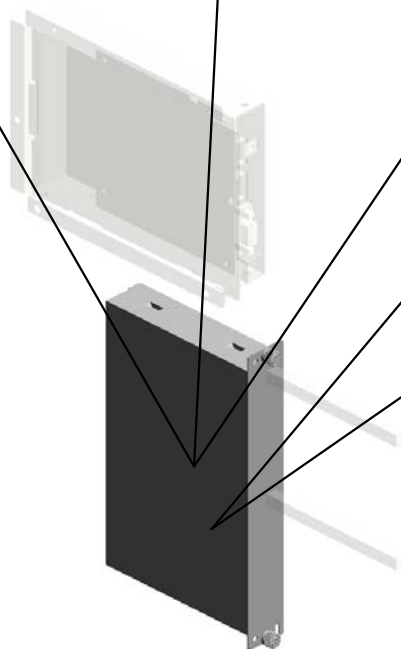

U002_S001
Y4060100
(EU:OS FREE/NA:OS FREE):
DRIVE:SSD:OPS:ASS'Y



U002_S005
Y4060100
(EU:OS FREE/NA:OS FREE):
DRIVE:SSD:OPS:ASS'Y

U002 RICOH Interactive Whiteboard Controller Type1

7.Y4062001
COVER:CAPTURE:
LOWER

4.Y3013600
PCB:CAPTURE2

6.Y4062000
COVER:CAPTURE:
UPPER

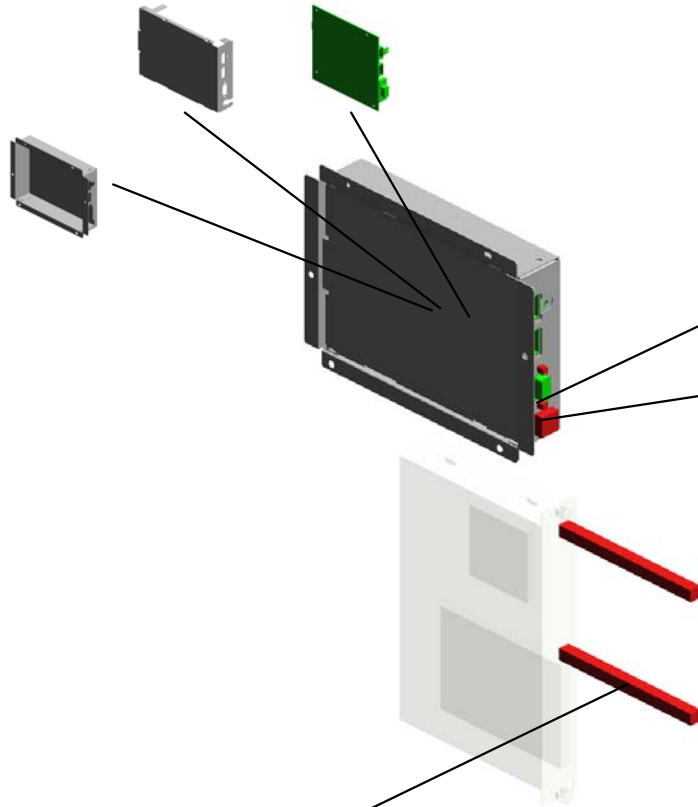

3.R0346800
(x2)
STUD:CONNECTO
R:D-SUB:ROHS

13.Y4063700
BUSHING:CABLE:H
EYCO:SR5MN-3



8.Y4063300
CABLE:USB3



9.Y4063305
CABLE:RS232C

1.03530060P (x 5)
SCREW:M3X6
2.03603006N (x 3)
SCREW - M3X6

14.Y4063950
(x2)
ANTENNA:WIFI:OP
S

U002_S001
(EU:OS FREE/NA:OS FREE):DRIVE:SSD:OPS:ASS'Y



15.Y4060100
(EU:OS FREE/NA:OS FREE):DRIVE:SSD:OPS:ASS'Y

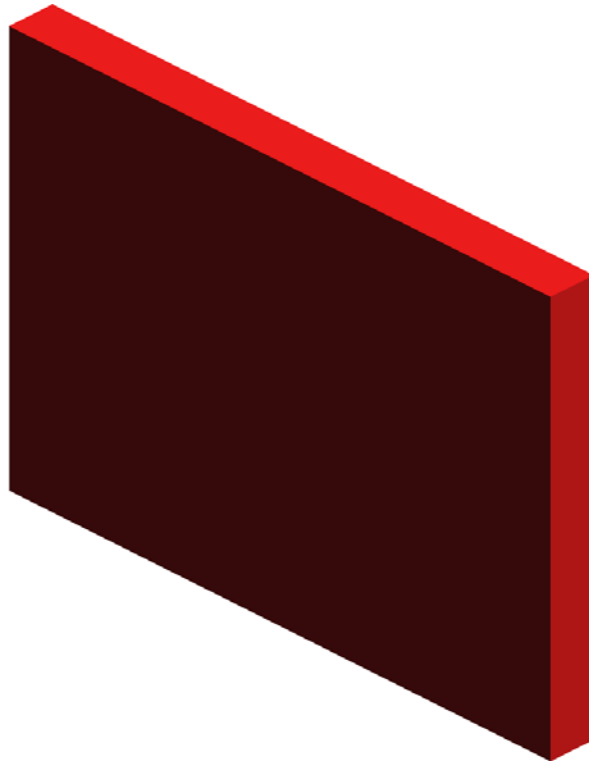

15.Y4063902
(EU:OS FREE/NA:OS FREE):DRIVE:SSD:OPS:ASS'Y

U001	U002	U003	U004	U005
------	------	------	------	------

U002_S002
(EU/AA):MODULE:BOX:ASS'Y

16.Y4063520
FAN:OPS
201801-01

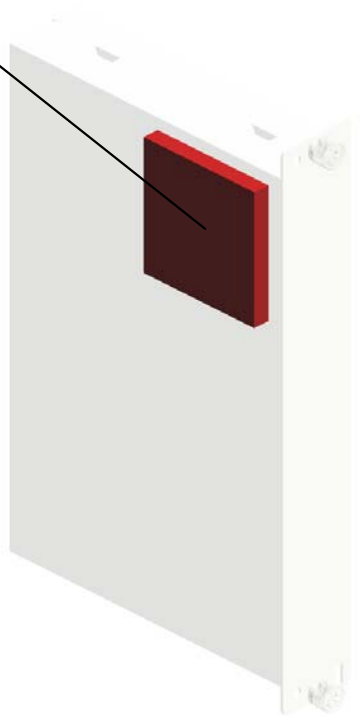

10.Y4063400
(EU/AA):MODULE:B
OX:ASSY

U002_S003
(NA):MODULE:BOX:ASS'Y

16.Y4063520
FAN:OPS
201801-01

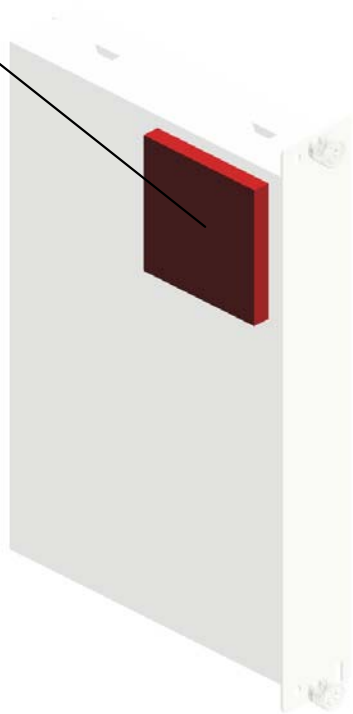

11.Y4063417
(NA):MODULE:BOX
:ASS'Y

U002_S004
(CHN):MODULE:BOX:ASS'Y

16.Y4063520
FAN:OPS
201801-01

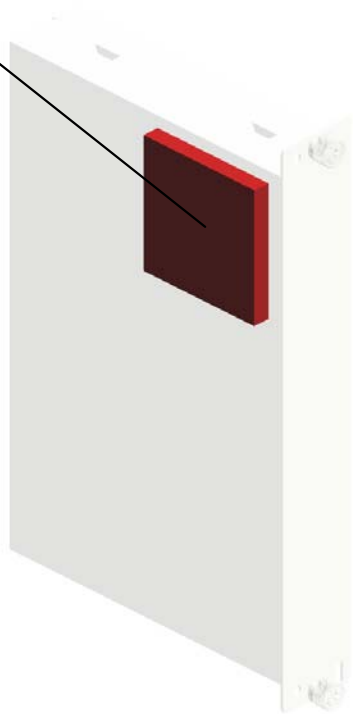

12.Y4063421
(CHN):MODULE:BO
X:ASS'Y

U001 U002 U003 U004 U005

U002_S005
(EU:OS FREE/NA:OS FREE):DRIVE:SSD:OPS:ASS'Y



15.Y4060100
(EU:OS FREE/NA:OS FREE):DRIVE:SSD:OPS:ASS'Y

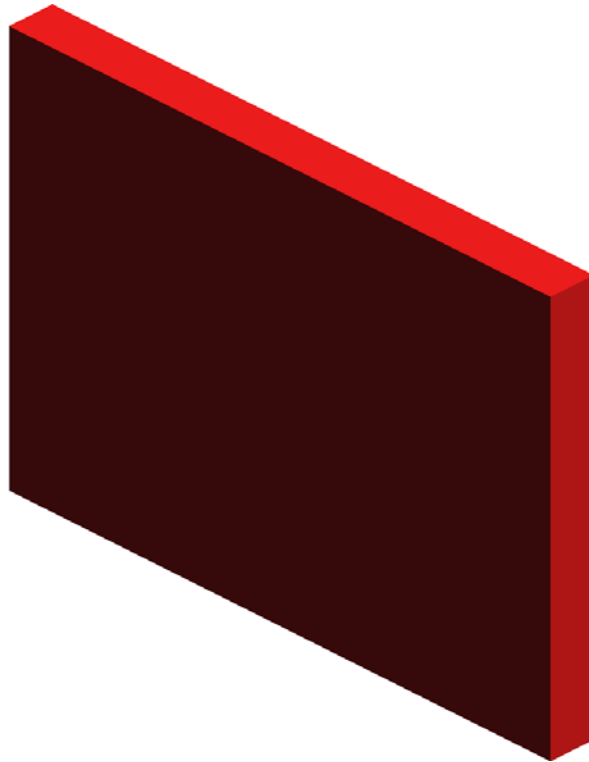

15.Y4063902
(EU:OS FREE/NA:OS FREE):DRIVE:SSD:OPS
201710-01

U001	U002	U003	U004	U005
------	------	------	------	------

U003
Ricoh Interactive Whiteboard Camera Unit Type1

1.Y4143010
CAMERA:OPTION:
ASS'Y

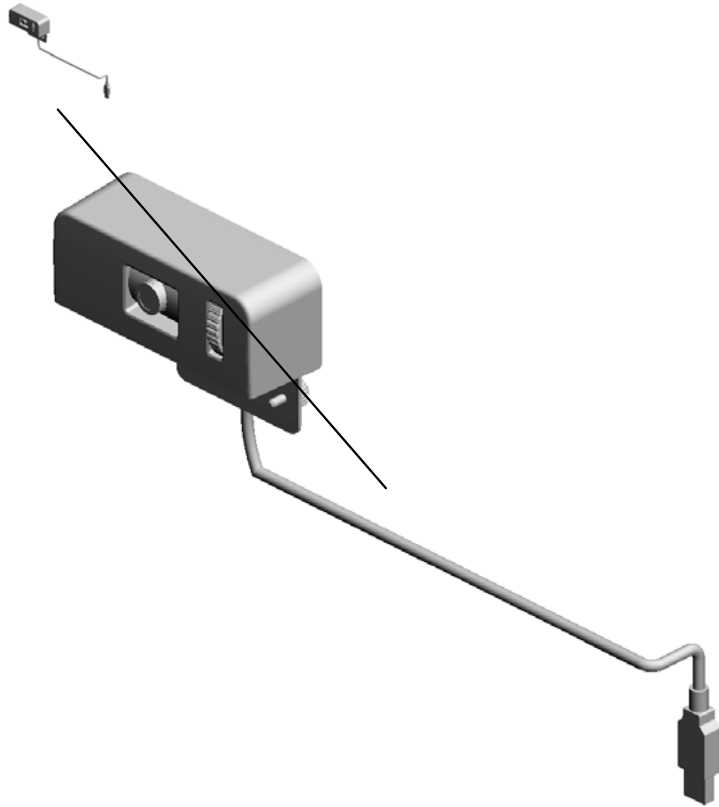

U004 Ricoh Interactive Pen Sensor Kit Type3

8.Y4131004
BRACKET:USB DO
NGLE:PEN:TYPE3
201711-01 X/O

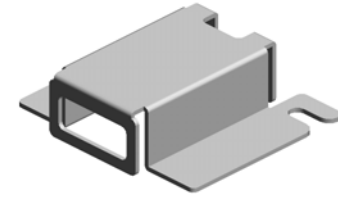
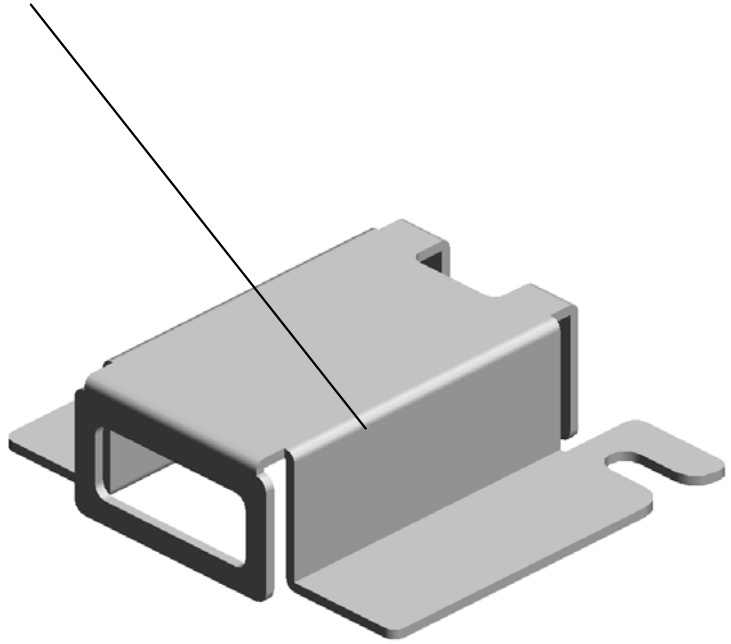
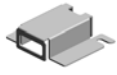

2.11050780
(x2)
CLAMP:LWST-1012

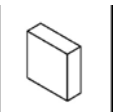

3.Y4071501
MAGNETIC:PEN



4.Y4073301
CABLE:USB



6.Y4138512
(CHN):PEN:ASS'Y



7.Y4138517
(x2)
(NA/EU/AA):PEN:ASS'Y

1.03530060P (x 2)
SCREW:M3X6

U005
RICOH Interactive Whiteboard Stand Type3



1.Y4081270
(x2)
CASTER:DIA100:S
TOPPER



2.Y4081271
(x2)
CASTER:DIA100

SPECIAL TOOLS



1.Y3009000
CUSHION:MAINTENANCE

Exclusive Parts

Number	Part Name	Group	ID
R0346800	STUD:CONNECTOR:D-SUB:ROHS	U002	3
Y3009000	CUSHION:MAINTENANCE	SPECIAL TOOLS	1
Y3013600	PCB:CAPTURE2	U002	4
Y3021205	SCREW:IO_3X8_NI:8F.PA724.8R0	U001	1
Y3022505	BRACKET:FAN:3K.2KS09.001	U001	2
Y3026002	(NA):POWER SUPPLY CORD:NA:2 G.01111.001	U001	3
Y3026003	(EU/AA):POWER SUPPLY CORD:2 G.00921.001	U001	4
Y3026011	CABLE:VGA:5K.06202.531	U001	5
Y3026012	CABLE:USB	U001	6
Y3032101	BRACKET:GUIDE:OPS	U001	7
Y3032111	SCREW:SPEAKER	U001	8
Y3032112	SCREW:HANDLE	U001	9
Y3033103	SPEAKER:RIGHT:REAR	U001	10
Y3033104	SPEAKER:LEFT:REAR	U001	11
Y3033105	HOLDER:SPEAKER	U001	12
Y3033117	PCB:TRANSFER:PWR	U001	13
Y3033124	CABLE:HDMI:REAR	U001	14
Y3033125	CABLE:USB:REAR	U001	15
Y3033138	(CHN):CABLE:POWER SOURCE	U001	16
Y3041206	SCREW:COVER:MOTHER BOARD	U001	17
Y3052101	FAN:SIDE	U001	18
Y3052102	FAN:UPPER	U001	19
Y3052103	BRACKET:COVER:OPS	U001	20
Y3052104	COVER:USB	U001	21
Y3052106	BRACKET:TRAY:PEN	U001	22
Y3052111	BRACKET:SCREW	U001	23
Y3052112	BRACKET:OPS	U001	24
Y3052113	BUTTON:POWER SOURCE	U001	25
Y3052114	SCREW:M3	U001	26
Y3052115	COVER:REAR:TERMINAL	U001	27
Y3052116	COVER:REAR:LOWER	U001	28
Y3052117	COVER:REAR:MIDDLE	U001	29
Y3052201	RIMOTE CONTROL	U001	30
Y3052203	CABLE:HDMI	U001	31
Y3052205	TRAY:PEN	U001	32
Y3053101	USB DONGLE:BT	U001	33

Number	Part Name	Group	ID
Y3053103	PCB:KEYPAD	U001	34
Y3053105	PCB:USB	U001	35
Y3053106	PCB:DPS	U001	36
Y3053107	PCB:EXTEN	U001	37
Y3053111	MIKE	U001	38
Y3063017	PANEL:LCD:ASS'Y	U001	39
Y3063102	PCB:MAIN	U001	40
Y3063108	PCB:POWER	U001	41
Y4060100	(EU:OS FREE/NA:OS FREE):DRIVE :SSD:OPS:ASS'Y	U002_S001 U002_S005	5 5
Y4062000	COVER:CAPTURE:UPPER	U002	6
Y4062001	COVER:CAPTURE:LOWER	U002	7
Y4063300	CABLE:USB3	U002	8
Y4063305	CABLE:RS232C	U002	9
Y4063400	(EU/AA):MODULE:BOX:ASS'Y	U002_S002	10
Y4063417	(NA):MODULE:BOX:ASS'Y	U002_S003	11
Y4063421	(CHN):MODULE:BOX:ASS'Y	U002_S004	12
Y4063520	FAN:OPS	U002_S002 U002_S003 U002_S004	16 16 16
Y4063700	BUSHING:CABLE:HEYCO:SR5MN- 3	U002	13
Y4063902	(EU:OS FREE/NA:OS FREE):DRIVE :SSD:OPS	U002_S001 U002_S005	15 15
Y4063950	ANTENNA:WIFI:OPS	U002	14
Y4071501	MAGNETIC:PEN	U004	3
Y4073301	CABLE:USB	U004	4
Y4081270	CASTER:DIA100:STOPPER	U005	1
Y4081271	CASTER:DIA100	U005	2
Y4131004	BRACKET:USB DONGLE:PEN:TYP E3	U004	8
Y4138512	(CHN):PEN:ASS'Y	U004	6
Y4138517	(NA/EU/AA):PEN:ASS'Y	U004	7
Y4143010	CAMERA:OPTION:ASS'Y	U003	1

Standard Parts



03530060P
SCREW:M3X6



03603006N
SCREW - M3X6



11050780
CLAMP:LWST-1012

Design Change List

Number	Title	Set	Old Part		New Part		Index No.		Q'ty	Interchg		Reason	Cut-in S/N
			P/N	Name	P/N	Name	Group	ID		Indiv.	Set		
201801-01	1801 Modification	-			Y4063520	FAN:OPS	U002_S002	16	1				
					Y4063520	FAN:OPS	U002_S003	16	1				
					Y4063520	FAN:OPS	U002_S004	16	1				
201711-01	1711 Modification	-	Y4131003	BRACKET:USB	Y4131004	BRACKET:USB D ONGLE:PEN:TYP E3	U004	8	1	X/O			
201710-01	1710 Modification	-			Y4063902	(EU:OS FREE/NA :OS FREE):DRIV E:SSD:OPS	U002_S001	15	1				
					Y4063902	(EU:OS FREE/NA :OS FREE):DRIV E:SSD:OPS	U002_S005	15	1				

