

# Advantech AE Technical Share Document

|                        |   |                     |  |
|------------------------|---|---------------------|--|
| <b>Date</b>            | 2019/5/15   | <b>Release Note</b> | <input type="checkbox"/> Internal <input checked="" type="checkbox"/> External |
| <b>Category</b>        | <input checked="" type="checkbox"/> FAQ <input type="checkbox"/> SOP                        | <b>Related OS</b>   | Windows/Linux  |
| <b>Abstract</b>        | Why the default setting of power button is different in different BIOS of AIMB-705 and 785? |                     |  |
| <b>Keyword</b>         | ACPI,Power button,BIOS, shutdown,sleep,mobile,desktop                                       |                     |  |
| <b>Related Product</b> | AIMB-705,AIMB-785   |                     |  |

■ **Problem Description:**

When we install new OS (ex:Win10) in BIOS V2.01 and V2.02 of AIMB-705, or V2.02 and V2.03 of AIMB-785, the default setting of power button is differen.

In AIMB-705(BIOS V2.01) and AIMB-785(BIOS V2.02) is sleep, but AIMB-705(BIOS V2.02) and AIMB-785(BIOS V2.03) is shutdown.

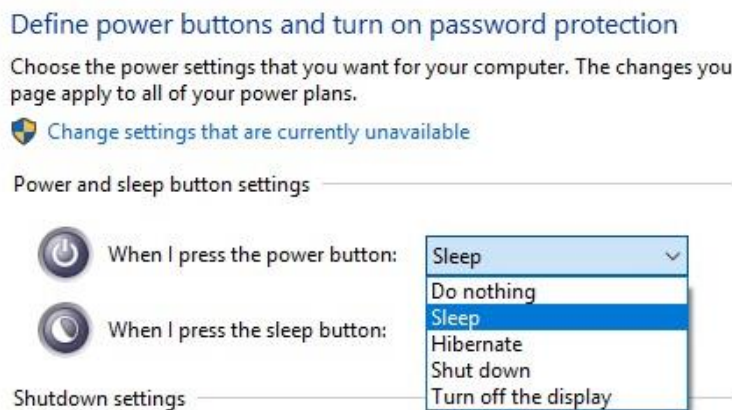

■ **Problem Analysis:**

That is because we have modified the ACPI table in the BIOS v2.01 (AIMB-705) and V2.02(AIMB-785).

*Modify PCsystemtype show "1", which means the system belongs to desktop.*

| Field                | Byte Length | Byte Offset | Description  |
|----------------------|-------------|-------------|--|
| Preferred_PM_Profile | 1           | 45          | This field is set by the OEM to convey the preferred power management profile to OSPM. OSPM can use this field to set default power management policy parameters during OS installation.<br>Field Values:<br>0 Unspecified<br>1 Desktop<br>2 Mobile<br>3 Workstation<br>4 Enterprise Server<br>5 SOHO Server<br>6 Appliance PC<br>7 Performance Server<br>8) Tablet<br>>8 Reserved |

The default of BIOS code base is set mobile type, so we modified it to desktop type in these BIOS version.

Different PC type which will cause different default power setting during OS installation.  
Which mean it doesn't effect the existing OS after BIOS updating.

■ **Brief Solution - Step by Step:**

Because it just effect the default behave of power button in OS, and those power function are still working well, so customer can manually to set the setting; in addition, it doesn't have effect in existing OS.

So we don't have the plan to modify back to mobile type in ACPI table.

■ **Contact Window and File Link:**

If you have any questions, please contact Mojo.Huang #1237

You can download this file on [Global AE SharePoint - FAQ](#)