Corn Springs

The Corn Springs study area is located north of the Corn Springs Wash diversion levees in the Chuckwalla Valley, approximately 30 miles west of the City of Blythe.

Existing Conditions

General Site Conditions

The study area is located approximately 600 feet south of Interstate 10 (I-10), adjacent to an existing communications facility. The elevation of the study area is approximately 732 feet above sea level. Soils observed within the survey area consist of silty sand with patches of gravel and cobble; no USDA soil surveys were completed for this area. Land use in the vicinity consists of I-10 to the north, overhead power lines and open space to the south, open space to the west, and an existing communication facility to the east. The study area is subject to disturbance associated with off-road vehicle use and existing facility maintenance.

Vegetation

The vegetation in the study area is part of a larger, continuous, creosote bush scrub plant community. The plant species observed include creosote bush (*Larrea tridentata*), burro-weed (*Ambrosia dumosa*), and sparse occurrences of desert ironwood (*Olneya testota*).

Wildlife

No wildlife species were observed or otherwise detected during the survey. Species expected to occur include those common in disturbed creosote bush habitats, such as zebra-tailed lizard (*Callisaurus draconoides*) and greater roadrunner (*Geococcyx californianus*).

Sensitive Biological Resources

Sensitive Species

Federally and State Listed Species

The study area contains suitable habitat for desert tortoise (*Gopherus agassizii*), a State- and federally-listed threatened species. The species was not observed within the study area. Focused surveys are necessary to determine the occupancy status of the species onsite.

CNPS Listed Species

The study area contains suitable habitat for glandular ditaxis (*Ditaxis claryana*), a CNPS List 2.2 species. The species was not observed within the study area. Regardless, plant species identified as sensitive only by CNPS are not protected by any State or federal laws or policies.

CSC

The study area contains suitable habitat for Palm Springs pocket mouse (*Perognathus longimembris bangsi*), a CSC. Neither the species nor evidence of the species was not observed within the study area. Regardless, CSC are not protected by any State or federal laws or policies.

Other Sensitive Species

No suitable habitat for sensitive species not specifically protected under any other policy occurs on the study area.

Critical Habitat

The study area is located within Critical Habitat for desert tortoise, as designated by the USFWS. Because suitable habitat occurs on the study area, focused surveys must be conducted for desert tortoise prior to consultation with the USFWS and BLM.

Nesting Birds

No nests or nesting activities were observed during the survey; however, the vegetation adjacent to the study area contains suitable nesting habitat for ground and shrub nesting avian species, such as greater roadrunner.

California Desert Native Plant Act

Desert ironwood was observed on the western most portion of the study area and this species is protected under Section 80073 of the CDNPA. According to Section 80073 of the CDNPA, no desert ironwood (including both dead and live) may be harvested except under a permit issued by the County Agricultural Commissioner or the sheriff. The commissioner may establish limits on the quantity of desert ironwood which may be taken under any permit and on the number of permits for the taking of desert ironwood which may be issued.

Jurisdictional Waters

A small, sandy, north-south erosional feature occurs along the western boundary of the study area. The feature contains a consistent bed and bank features and flows into a roadside ditch along I-10, north of the study area. This feature is potentially jurisdictional and must be avoided. No drainage features, wetlands, vernal pools, or suitable habitat for sensitive fairy shrimp species occur on the study area.

Wildlife Corridors and Movement

Given the limited size and minimal disturbance associated with the development of the study area, no impacts to any wildlife corridors or wildlife movement patterns are anticipated.

Applicable HCP or Land Use Management Plan

The study area is located on federal land managed by the BLM and is subject to the NECD amendment of the CDCA. Approval by the BLM must be obtained prior to construction.

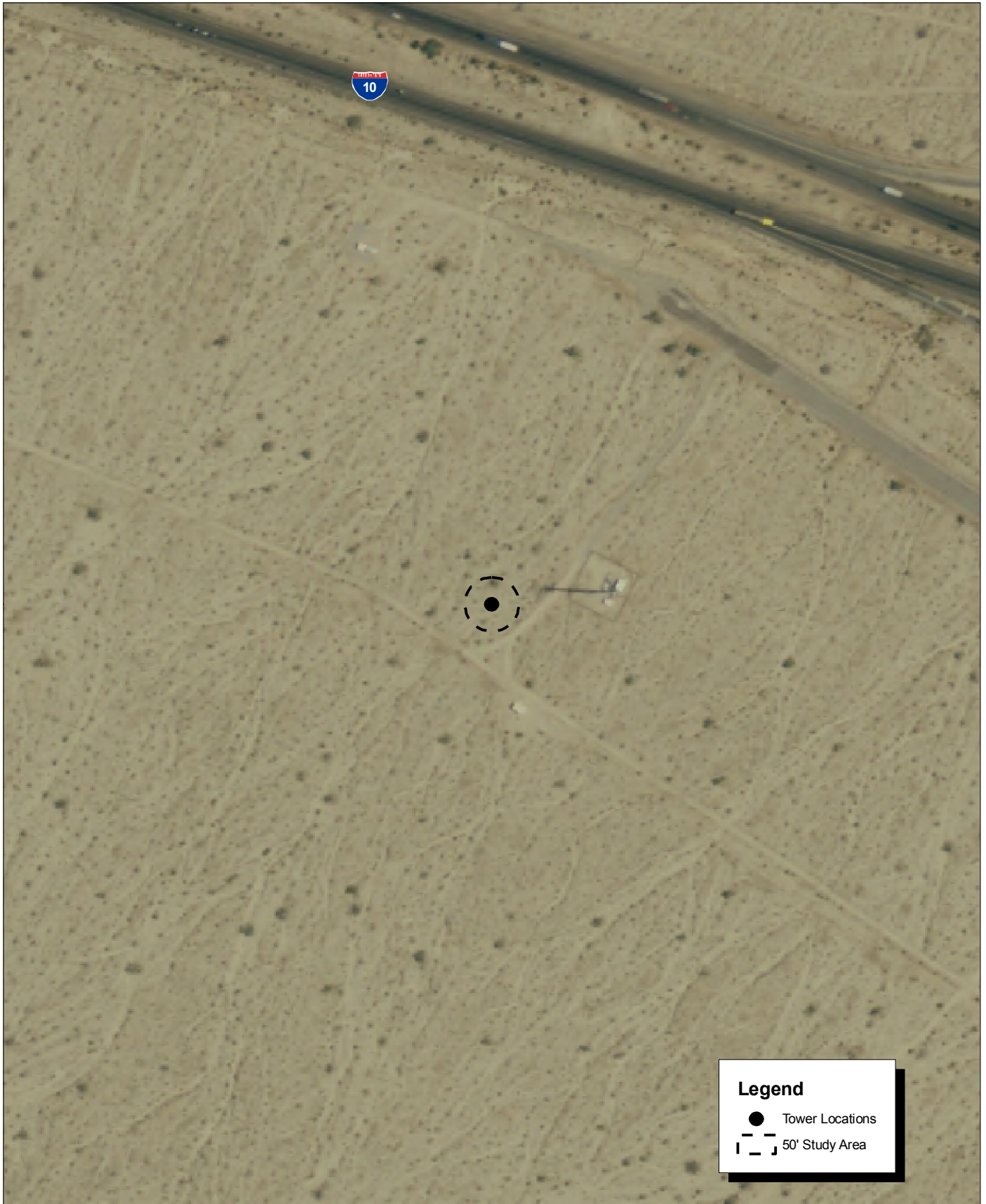

Source: Riverside County NAIP, 2005.



Michael Brandman Associates

27490003 • 04/2008 | corn_springs_aerial.mxd

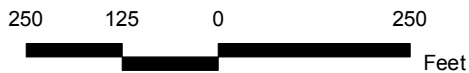

Corn Springs Communication Site Local Vicinity Aerial Map

COUNTY OF RIVERSIDE
PUBLIC SAFETY ENTERPRISE COMMUNICATION PROJECT

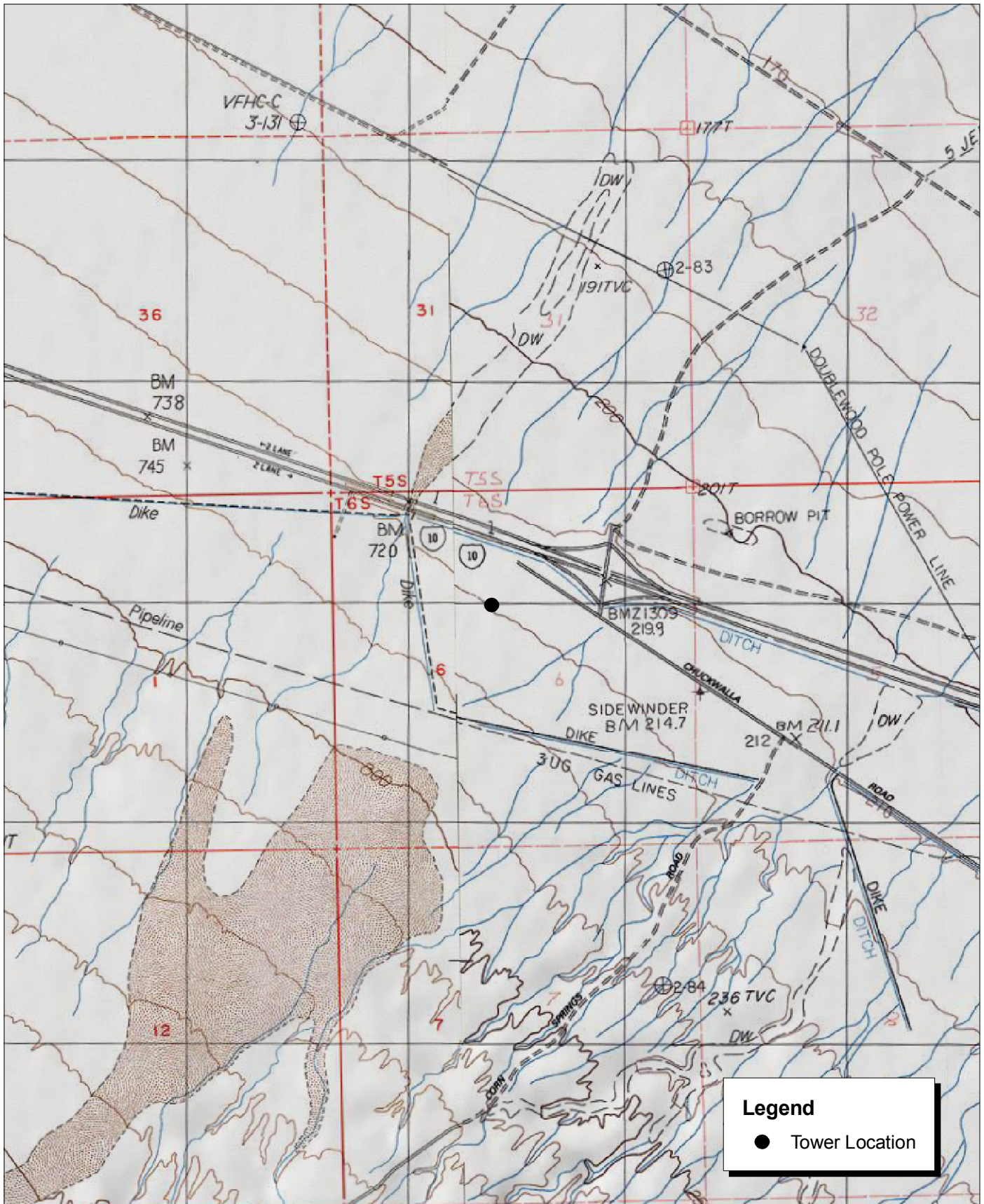

Source: USGS Sidewinder Well 7.5' Topographic Map.



Corn Springs Communication Site Local Vicinity Topographic Map



Source: USDA Soils Data (NRCS).



Michael Brandman Associates

27490003 • 04/2008 | corn_springs_soils.mxd

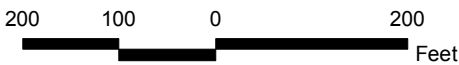

Corn Springs Communication Site USDA Soils Map

COUNTY OF RIVERSIDE
PUBLIC SAFETY ENTERPRISE COMMUNICATION PROJECT



Photograph 1: View toward Corn Springs candidate location, facing south.



Photograph 2: View toward Corn Springs candidate location, facing west.



Photograph 3: View toward Corn Springs candidate location, facing north.



Photograph 4: View toward Corn Springs candidate location, facing east.

Source: Michael Brandman Associates, 2008.



Michael Brandman Associates
27490003 • 02/2008 | Corn Springs_Photo1.doc

Corn Springs Candidate Photographs 1 to 4 PSEC Project



Photograph 5: View from Corn Springs candidate location, facing north.



Photograph 6: View from Corn Springs candidate location, facing east.



Photograph 7: View from Corn Springs candidate location, facing south.



Photograph 8: View from Corn Springs candidate location, facing west.

Source: Michael Brandman Associates, 2008.



Michael Brandman Associates

27490003 • 02/2008 | Corn Springs_Photo2.doc

Corn Springs Candidate Photographs 5 to 8
PSEC Project