



More
than just
a Display.





25 Years HYUNDAI Displays

In 1986 the production of the first HYUNDAI display – a 12" monochrome CRT monitor – started. Since that time display technology has been developed enormously. And so did HYUNDAI IT and the brand name HYUNDAI has been synonymous with the design and production of state-of-the-art display technologies. Advanced devices offering sophisticated design and supreme image quality – with "built-in" future-proofing.

More than just a Display

The innovative display solutions from HYUNDAI IT profit by 25 years experience in display development. Based on a smart and reliable product design they are offering a load of optional features that makes them suitable for any use case of today's business. That's how they bring add-on values and thus a maximum customer satisfaction. That's what they makes more than just a display.

Metal Frame Housing

DOOH Media Panel

Wide Viewing Angle

High Brightness/Contrast

Full-HD/HD-Ready

Portrait/Landscape Orientation

Integrated Video Wall Function

High Connectivity

Auto-Cooling System

Remote Control + Monitoring

VESA Wallmounting

Auto Power Control (DPMS)

Speaker-Ready

BASIC

●●● Indoor Displays



●●● Touch Screen Displays



●●● Semi-Outdoor Displays



Tempered Glass

Touch Screen

Transflective Panel

LED Backlight

Optical Bonding

Anti-Blackout Panel

Anti-Reflection Coating

Anti-Graffiti Protection

UV Protection

Auto-Brightness Sensor

Motion Sensor

Ultra Narrow Bezel

Open Frame Design

Tailored Product Design

OPTION



Adcalator™



Stereoscopic 3D Displays



Outdoor Displays





HYUNDAI IT's public displays ensure the presentation of digital signage contents in a pin sharp, high bright and brilliant picture quality. Meeting all technical requirements for professional display equipment these enhanced displays allow a reliable and failure-free operation.

Metal Frame Housing

A solid metal frame housing guarantees that the panels of HYUNAI IT's public displays are well protected especially when it comes to public area installations. In addition, the metal frame gives the product a high quality and an appealingly optical appearance.

Professional DOOH LCD Panel

Using commercial grade LCD panels for Digital Out-Of-Home applications the HYUNDAI IT public displays have a higher brightness and contrast than standard LCD TV panels. Also those panels enable permanent operation and deliver clear and bright images. They can be used in both portrait as well as landscape orientation without any losses of quality.



High Brightness & Contrast

Achieving a brightness from 450 to 1500 cd/m² and working with a smart dynamic contrast technology, the special Out-Of-Home panels ensure bright and sharp pictures with a facsimile depth, even in bright enlightened environments.

Full-HD Resolution

Having a resolution of either 1366 x 768 or 1920 x 1080, HYUNDAI IT public displays can display high-resolution and more data information on the LCD screen by an aspect ratio of 16:9. The Full-HD resolution enables brighter and sharper images if HD graphics and videos can display.

Wide Viewing Angle



The wider the panel's viewing angle is the more viewers are able to see the contents in a high quality. That matters for both meeting environments as well as public area installations. Coping with a wide viewing angle of 178° (h/v) HYUNDAI IT public displays bring the content to the entire audience.

Fast Response Time

A fast response time of 8ms ensures the displaying of a clear image quality without ghosting effects for any fast moving video or image content.

High Connectivity

Providing an array of various professional input and output connectors [HDMI, DVI, Component/Composite (BNC), VGA] HYUNDAI IT Digital Signage afford an easy, flexible and multiple connection to a broad range of external A/V devices.

Heat Control & Cooling System

In order to avoid any image corruption or downtime by overheating HYUNDAI IT Digital Signage Displays are equipped with an innovative built-in fan & heat control system, which makes the displays ready for the operation in any climatic environment.



Remote Control (RS232C)

For an easy set-up and maintenance the built-in RS-232C port allows the remote controlling and configuration of the display's functions.

Wall Mounting

Wall mounting holes according to the VESA standard (Flat Panel Mounting Interface Standard) ensure the compatibility and thus an easy installation with universal wall-mounting brackets.

Key Facts

Advantages:

- robust metal frame housing
- DOOH media panel
- high connectivity

Typical Installations:

- shops, malls
- conferencing, education
- fairs & events

Available Sizes:

- 48.3 cm / 19"
- 58.4 cm / 23"
- 81.3 cm / 32"
- 101.6 cm / 40"
- 116.8 cm / 46"
- 139.7 cm / 55"
- 177.8 cm / 70"
- 208.3 cm / 82"

●●● Indoor Displays MultiVision

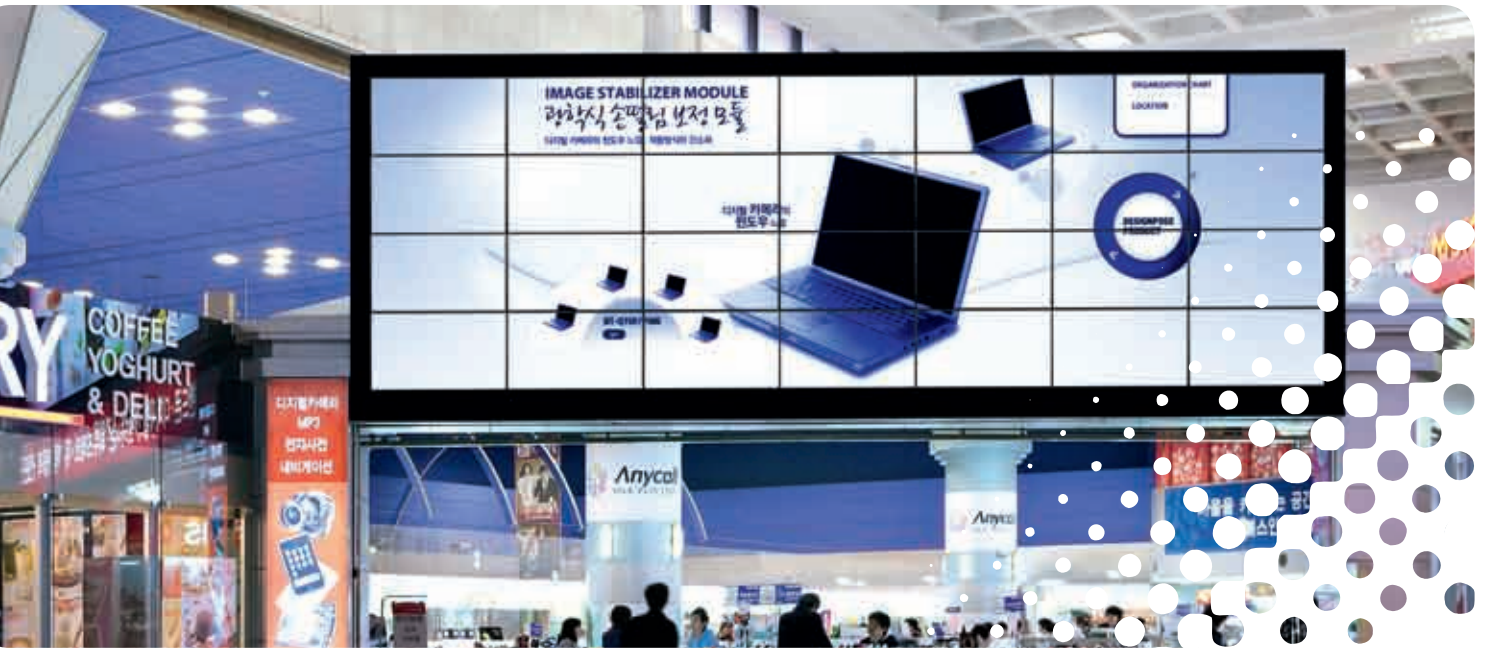

Due to the built-in video wall function HYUNDAI IT's MultiVision Displays are dedicated to installations of multi-screen walls of up to 5 by 5 single units (9x9 with amplifier). For this reason no additional expensive equipment, like video split processors, is necessary.

Daisy Chain Connection

In order to realize a multi display wall, the single units are linked by a Daisy Chain connection over HDMI, Component or the D-Sub interface. This implicates that just one display (master unit) needs a direct connection to the video source. The configuration of each display, regarding its individual ID and position in the matrix, can be easily set-up using the on-screen menu or the RS232C interface. The built-in video wall function allows flexible configuration and easy installation.

Ultra Narrow Bezel Design

Coming with an ultra narrow bezel design, HYUNDAI IT's MultiVision displays are dedicated to build video walls. Combined with the cutting edge function – which allows displaying the full picture content – the smart design of the HYUNDAI public displays ensures a maximum screen area with a minimum of viewable interruptions.

D468FL



Ultra Narrow Bezel



Key Facts

Advantages:

- ultra narrow bezel
- built-in video wall function

Available Sizes:

- 101.6 cm / 40"
- 116.8 cm / 46"
- 139.7 cm / 55"

Typical Installations:

- shopping mall
- airport, rail station
- sportsbar, museum



As an option, HYUNDAI IT public displays can be equipped with touch screen functionality. According to screen size and the kind of application, different touch screen technologies are used: infrared ray matrix, 5-wire-resistive or capacitive technique.

D465MLI

Single/Dual Touch Control

Beside single touch mode HYUNDAI IT's touch screens provide dual touch control. This enables gesture control, like "Zoom", "Rotate", "Two-Finger-Tap" etc.



HID Compatibility

The compatibility with the HID standard (Human Interface Device) makes an easy Plug&Play operation without driver installation possible.

G75TR /G95TR



Key Facts

Advantages:

- HID Compatible
- robust design

Available Sizes:

- 48.3 cm / 19"
- 58.4 cm / 23"
- 81.3 cm / 32"
- 101.6 cm / 40"
- 116.8 cm / 46"
- 132.1 cm / 52"
- 139.7 cm / 70"
- 208.3 cm / 82"

Typical Installations:

- information kiosks
- self-service terminals
- conference & education
- monitoring & control

Indoor Displays Special Solutions



WideVision

The WideVision displays of HYUNDAI IT are characterized by their special aspect ratio whose height is less than half of its width. This brings the benefit that they will fit where displays with standard height can not be installed.



C430ML

Open Frame Displays

For an easy integration of public displays to furnitures and other housings, HYUNDAI IT provides Open Frame Displays that feature reduced outline dimensions and special mounting fixtures.



Open Frame Display

Tempered Security Glass (Option)

In order to protect the displays against vandal attacks and thus avoiding additional costs during the operational period it is possible to cover the screens with a tempered security glass.

Tailored Display Solutions

Thanks to the long lasting experience in developing displays and a high flexibility, HYUNDAI IT is able to manufacture tailored display solutions, which are customized regarding to form, function and design. special mounting fixtures.

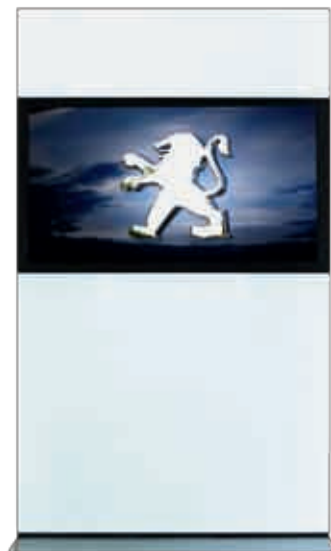

Tailored Display - Peugeot



HYUNDAI IT's Stand-Alone Displays are the best solution for single screen information signage. Combining dynamic screen contents and the static depiction of corporate identity, they bring the maximum brand communication to the point of information.

D467SL



Full Protection

In order to protect the high-tech components and ensure a long life time, the housing is fully made of steel and can be locked. The panel is protected by a special tempered glass.

Touch Screen Function (Option)

Optionally, the Stand-Alone Displays are available as touch screen models. The used infrared touch screen technology ensures maximum controlling comfort and makes them ready for a lot of interactive applications.

Key Facts

Advantages:

- easy installation
- robust housing
- easy individualization

Available Sizes:

- 116.8 cm / 46"
- 132.1 cm / 52"
- 177.8 cm / 70"

Typical Installations:

- information kiosks/terminal
- lobby, entrance area
- stores



High-Temperature Panel

HYUNDAI IT's new high-temperature panel is ready to operate in conditions of up to 105° C. This prevents so called "blackouts", caused by overheating, and makes it suitable for installation sites which are characterized by high temperature and bright ambience or direct sun light.

Transflective Panel

The transflective panel technology is a combination of both the conventional backlight transmissive mode as well as the reflective mode. By using a rear reflector behind the panel, sunlight reflections increase the display's brightness of up to 3000 cd/m² (at 80 K lux).

Optical Bonding

By using the Optical Bonding technique, the displays front glass is directly bonded to the LCD panel. This leads to the advantage that glare and reflection on the screen are reduced to a minimum while brightness and contrast ratio are increased at the same time. Furthermore glass fogging and sedimentation of dust is prevented.



High Temperature Panel

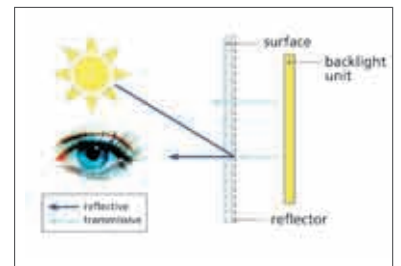

Transflective Panel



Optical Bonding



With a series of ecological features HYUNDAI IT is on target to provide environment-friendly products which reduce power consumption, especially when it comes to permanent operations of digital signage installations.

Motion Sensor (Option)

For installation sites where contents only need to be displayed on demand (e.g. information terminals), motion sensor is suitable to reduce power consumption and extend the panel's life time. Thereby the motion sensor detects human motion inside a defined periphery around the display. If there is no motion detected, the display automatically switches to stand-by mode.

Auto Brightness Sensor (Option)

An integrated light sensor that measures the ambient light takes care that panel's brightness will be adjusted to the ambient lightning conditions. As a result the power consumption will be reduced while the panel's lifetime will be increased.

Transflective Panel (Option)

With a reflector behind the panel a transflective panel uses the sunlight to increase the display's brightness.

LED Backlight (Option)

HYUNDAI IT's public displays with LED backlight bring the advantage of an up to 40% lower power consumption, compared to displays with CCFL backlight. The LED backlight also enable a super-slim design which is accented by a glossy narrow bezel.

Super-Slim Design



VESA DPMS

In order to reduce power consumption, the auto-power-control of the VESA DPMS standard ensures, that the display will be switched to stand-by mode if there is no signal input.

RoHS Compliant

With the compliance of the RoHS directive of the European Union, HYUNDAI IT guarantees that there are no hazardous substances used, which will polluting the environment after the product's life cycle.

●●● Indoor Displays Adcalator™



The ADCALATOR™ is a digital signage solution that also cares for health and safety related needs. Being installed at the entrance of escalators or moving walkways it offers digital signage operations on a highly frequented installation site. The integrated multimedia player (supporting even HD contents), a content management application and the possibility of remote control make the ADCALATOR™ a flexible digital signage solution. Due to a smart mounting system and the capability of being connected to a wireless LAN it can be easily installed to existing escalators and moving walkways.



Why Adcalator™

- Growth for advertising expenditure only expected for OOH media until 2011.
- Climate change abets widespread of vector-borne diseases.
- 50% of world population lives already in urban areas. 70% will live in cities by 2050.
- More than 85 K escalators and moving walk already installed in the EU and there are minimum 85K new installations every year.



UV Ray Sterilization

Most micro-organisms get into the human body through the air and the dust on the skin. Ultraviolet germicidal irradiation (UVGI) is one of the most efficient sterilizing solutions due to UV-C ray's capability (intensity: approx. 12K $\mu\text{W}/\text{cm}^2$) to kill more than 90% of known micro-organisms. The application of UVGI has been used primarily in medical sanitation and expands nowadays for various purposes, like water or air purification. The ADCALATOR™ is equipped with an UV sterilization system in order to keep the handrails of escalators or moving walkways clean.

Accident Precaution

Most accidents on escalators or moving walkways happen to children under 12 years or elderly persons being older than 55 years. In most cases carelessness is the main reason for accidents. In order to prevent or minimize such kind of accidents, the ADCALATOR™ offers an effective solution to draw the passenger's attention by displaying security advises on the screens.

Master/Slave Configuration

The ADCALATOR™ is always installed in pairs – there is a master and a slave. The master device contains the multimedia player. The slave is connected to the master for video (HDMI), audio and remote control (RS232). Each device contains one speaker for the stereo audio system.

Remote Administration

The ADCALATOR™ offers the possibility of remote control for administration services. Once being connected to network/internet it allows the following control functions:

- Content upload & download
- Content scheduler
- Firmware upgrade
- System power on/off
- UV sterilization system: on/off, scheduler
- Collection of system log data
- Monitoring of player



●●● Indoor Displays Stereoscopic 3D



In addition to conventional 2D operations, HYUNDAI IT's stereoscopic 3D displays make it possible to watch 3D images with a breathtaking three-dimensional effect. For example 3D models created with CAD software can be displayed more plastically and thus allow a presentation close to reality. Beside professional applications the 3D displays are also suitable for multimedia operation such as 3D games, movies or pictures.

W243S



A New Dimension in Display Technology

Based on the stereoscopic 3D technology the viewer watches the 3D contents on a polarized 3D display by wearing polarized 3D glasses. A stereoscopic image combines two images that represent the views of the left and the right eye with different perspective view points. From these two slightly different views, the eye-brain synthesizes an image of the world with stereoscopic depth.

S465D



3D Multi Vision

With the new 3D display S468FL - that combines the reliability of public displays with innovative stereoscopic 3D technology - HYUNDAI IT makes it possible to bring 3D contents to large audiences. Especially its design with almost seamless bezels (only 7.3 mm; two products side-by-side) and the integrated video wall function makes the S468FL the ideal display for multi-display installations.

S468FA

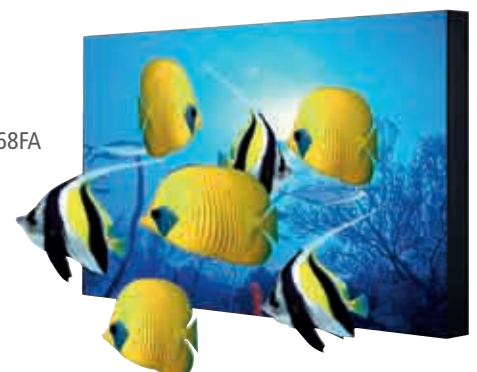

Integrated 3D Formatter

The 3D-Formatter which is already integrated (only S468FL, S320D) makes it possible to display common 3D video formats (side-by-side, top/bottom, line alternate) without any further accessories.

3D Software Package

HYUNDAI IT's 3D display comes along with a software package of the leading 3D software supplier DDD:

- 3D Media Player
- 3D Experience
- 3D Google Earth
- 3D games driver



3D Visualizer/OpenGL driver (Option)

3D Visualizer enables selected third party applications to work on HYUNDAI IT's 3D displays. Using 3D displays and 3D Visualizer, 3D models appear to have a real physical depth, just like the actual objects they are modelling.

For more information on DDD's TriDef software please visit: <http://www.tridef.com>.

Recommended Hardware Requirements

Intel® Core 2 Duo or Athlon™ 64 X2 Dual-Core CPU, 1GB RAM, NVIDIA® GeForce 6600 or ATI Radeon™ X800, 100MB free disk space, Windows® XP, Vista (32Bit), DirectX 9.0c compatible sound card, Internet connection, DVD-ROM drive, Network card.

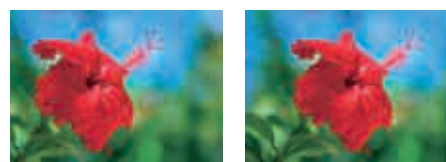

Side by Side format image.



Recognition of left eye's image.

Recognition of right eye's image.



Polarized glasses

Key Facts

Advantages:

- moire, ghosting and flicker free
- passive 3D glasses
- HDMI with HDCP support
- wide viewing angle

Available Sizes:

- 61.0 cm / 24"
- 81.3 cm / 32"
- 116.8 cm / 46"

Outdoor Displays Stand-Alone



HYUNDAI IT's outdoor displays represent state-of-the-art display technology for any outdoor environment. By meeting highest industrial standards, they provide a high degree of operational reliability and superior image quality, which are important preconditions for attracting the attention of today's audience.

IP55 Confirmity

In order to protect the display against influences the outdoor displays meet the requirements of IP55 as basic and those of optionally.

All-Weather Capable

Fitted with an intelligent cooling and heating system, the outdoor displays are well prepared for standing any weather conditions from -40°C to +50.

Air-Looping-System

In order to protect the LCD panel against so called black-outs (black areas on the screen in the wake of overheating), the outdoor displays are equipped with a smart air-looping-system.



A-Series

S-Series

Tailored Design

Sunlight-Ready

A special anti-reflection treatment reduces reflections on the display's surface.

Anti-Vandal Protection

Thanks to a special tempered security glass HYUNDAI IT's outdoor displays are well protected against any vandalism attacks.

Applicable Technologies (Options):

LED Backlight

Enables a high brightness (up to 2500 cd/m²) and reduces power consumption.

Transflective Panel

Uses the sunlight to increase the display's brightness. This enables a high brightness of up to 3000 cd/m² (at 80 lux).

Auto-Brightness Sensor

Adjusts the panels brightness automatically according to the ambient lightning conditions. This reduces power consumption and increase the panel's lifetime.

Motion Sensor

Depending on the detection of human motion in front of the screen, the display is either switched to operation or stand-by mode. This reduces power consumption and increase the panel's lifetime.

Anti-Graffiti Protection

A spevcial coating on the display allows an easy removal of colours without any damage of the display's surface.

UV Protection

A special UV filter protects the screen against ultra violette sunlight.



Key Facts

Advantages:

- all-weather capable
- IP55 to IP66
- sunlight-ready

Available Sizes:

- 116.8 cm / 46"
- 177.8 cm / 70"
- 119.4 cm / 47"

Typical Installations:

- bus Shelter
- tourist Information
- public transport

●●● Digital Signage Selection of References



Customer/Location:
G20 Summit 2010,
Seoul/South Korea
Products:
36x S468FL,
3D Video Wall (6x6)
Installation:
November 2010



Customer/Location:
Sky72 CC
Incheon, South Korea
Products:
46" Outdoor
2x2 Multi Screen
Installation:
August 2009



Customer/Location:
Stockholm,
Sweden
Products:
60x 46"
Outdoor Display
Installation:
2011



Customer/Location:
Lanarka Airport
New Terminal, Cyprus
Products:
40"/46" Multi-Screen
52" Stand-Alone
Installation:
November 2009



Customer/Location:
Airport (1F Entrance)
Kimpo, Korea
Products:
40" Multi-Screen
(3x16)
Installation:
February 2009

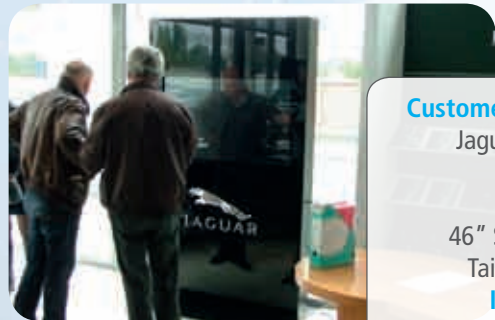

Customer/Location:
Jaguar Resellers,
France
Products:
46" Stand-Alone,
Tailored Design
Installation:
2011

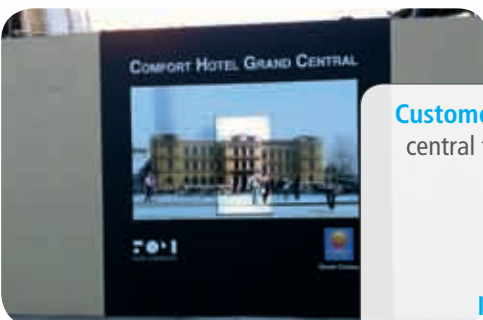

Customer/Location:
central train station,
Oslo
Products:
46"
Outdoor
Installation:
September 2010



Customer/Location:
BMW Reseller Shop,
France
Products:
46" SingleView
Installation:
2010



Customer:
TimeRoad Stores
(100 Stores), Spain
Products:
Videowall 3x3
D467ML
Installation:
2010–2011



Customer:
Shopping Mall
Seoul, Korea
Products:
46" Multi-Screen
(1x33)
Installation:
August 2008



Customer/Location:
INECO/TIFSA Madrid,
Spain
Products:
46" Outdoor
H466SL (LED Backlight)
Installation:
2010



Customer/Location:
Shopping Mall
Trondheim, Norway
Products:
9x 40" D400ML
3x3 Multi Screen
Installation:
November 2009



Customer/Location:
Shopping Mall
Tornio, Finland
Products:
9x D460ML
3x3 Video Wall
Installation:
August 2009



Customer/Location:
Barcelona Airport,
Terminal 1, Spain
Products:
22x 70" Single-Screen
& Totem
Installation:
November 2009

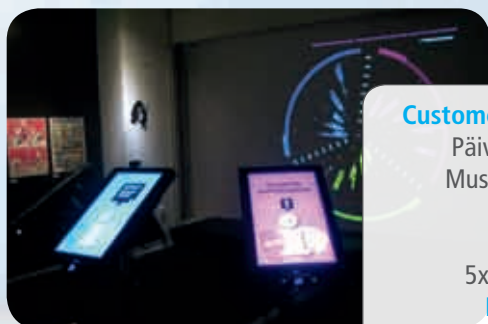

Customer/Location:
Päivälehtimuseo
Museum, Finland
Products:
D320MLI
5x Touchscreen
Installation:
Dezember 2009



Customer/Location:
Citroen dealer shops
France, Italy, UK
Products:
40" Metal Frame
19" Touch Screen
Installation:
Start: January 2010

●●● Specification Indoor Displays

SingleVision



Model		D233ML	D320ML	D405ML	D465ML	D466ML	D471ML
Product Type		Standard Metal Frame					
Panel	Screen Size (diagonal)	58,4 cm 23"	81,3 cm 32"	101,6 cm 40"	116,8 cm 46"	116,8 cm 46"	119,4 cm 47"
	Panel type	S-PVA	S-PVA	S-PVA	S-PVA	S-PVA	IPS
	Active Display Area (mm)	509.76 x 286.74	697.68 x 392.25	885.6 x 498.15	1018.08 x 572.67	1018.35 x 572.54	1039.68 x 584.82
	Resolution	1920 x 1080	1366 x 768	1920 x 1080	1920 x 1080	1366 x 768	1920 x 1080
	Aspect Ratio	16:9	16:9	16:9	16:9	16:9	16:9
	Display Colors	16.7 M	16.7 M	16.7 M	16.7 M	16.7 M	1.07 B
	Brightness (Typ)	300 cd/m ²	450 cd/m ²	450 cd/m ²	450 cd/m ²	1500 cd/m ²	700 cd/m ²
	Contrast Ratio	3000:1	3000:1	3000:1	3000:1	3000:1	1200:1
	Response Time	25 ms	8 ms	8 ms	8 ms	8 ms	9 ms
	Viewing Angle	178°/178°	178°/178°	178°/178°	178°/178°	178°/178°	178°/178°
	Lifetime (hours)	50,000	50,000	50,000	50,000	50,000	50,000
Resolution	Monitor	1920 x 1080	1360 x 768	1920 x 1080	1920 x 1080	1360 x 768	1920 x 1080
	DTV	1080p	1080i	1080p	1080p	1080i	1080p
Input	Video	D-Sub, HDMI, DVI	1x VGA (D-Sub) 1x HDMI 1x Composite (BNC) 1x Component (BNC)				
	Audio	1x PC Audio	1x PC Audio 1x Component Audio 1x Composite Audio				
Output	Video	1x D-Sub 1x HDMI	1x VGA (D-Sub) 1x DVI (HDMI connector) 1x Composite (BNC) 1x Component (BNC)				
	Audio	Speaker (ready)					
Power	Input Voltage	100~240VAC					
	Power consumption	50 W	100 W	160 W	190 W	310 W	280 W
Features	Multi-Screen Function	HDMI, D-Sub	HDMI, D-Sub, Component, Composite				
	Remote Control	yes (over RS232C)					
	Tempered Glass (option)	D233MLG	D320MLG	D405MLG	D465MLG	D466MLG	D471MLG
	Touch Screen (option)	D233MLI	D320MLI	D405MLI	D465MLI	D466MLI	D471MLI
	Transflective Panel	option					
	Optical Bonding	option					
	Anti Reflection Coating	option					
	Auto Brightness Sensor	option					
	Motion Sensor	option					
	Auto Cooling System	n/a	option	yes (1 EA)			yes (2EA)
	Others	Auto Power Control (On/Off Timer), Edge Correction					
Dimension	W x H x D (mm)	539.4 x 317 x 72.5	764 x 454 x 114.3	955.4 x 554.4 x 117.1	1086.4 x 630.4 x 115	1051.2 x 604.4 x 128.3	1071.4 x 616.6 x 99.7
	Bezel Size (U/D/L/R) (mm)	14.1/ 14.1/ 13.8/ 13.8	30/30/32/32	26.6/26.6/33.4/33.4	26.9/26.9/32/32	14.4/14.4/14.9/14.9	14.3/14.3/14.3/14.3
	Wall Mounting (WxH; mm)	100 x 100	400 x 200			600 x 200	
Weight	Set (kg)	7.0	19.0	31.0	38.5	32.5	32.0
Accessories	Power Cord, Manual, HDMI Cable, Remote Control						

Tempered Glass



Model		D320MLG	D405MLG	D465MLG	D705MLG	D825MLG
Product Type		Standard Metal Frame / Tempered Glass				
Panel	Screen Size (diagonal)	81,3 cm 32"	101,6 cm 40"	116,8 cm 46"	177,8 cm 70"	208,3 cm 82"
	Panel type	S-PVA	S-PVA	S-PVA	S-PVA	S-PVA
	Active Display Area (mm)	697.68 x 392.25	885.6 x 498.15	1018.08 x 572.67	1549.44 x 871.56	1805.76 x 1015.74
	Resolution	1366 x 768	1920 x 1080	1920 x 1080	1920 x 1080	1920 x 1080
	Aspect Ratio	16:9	16:9	16:9	16:9	16:9
	Display Colors	16.7 M	16.7 M	16.7 M	16.7 M	16.7 M
	Brightness (Typ)	450 cd/m ²	450 cd/m ²	450 cd/m ²	600 cd/m ²	600 cd/m ²
	Contrast Ratio	3000:1	3000:1	3000:1	2000:1	1200:1
	Response Time	8 ms	8 ms	8 ms	8 ms	8 ms
	Viewing Angle	178°/178°	178°/178°	178°/178°	178°/178°	178°/178°
	Lifetime (hours)	50,000	50,000	50,000	50,000	50,000
Resolution	Monitor	1360 x 768	1920 x 1080	1920 x 1080	1920 x 1080	1920 x 1080
	DTV	1080i	1080p	1080p	1080p	1080p
Input	Video	1x VGA (D-Sub) 1x HDMI 1x Composite (BNC) 1x Component (BNC)				
	Audio	1x PC Audio 1x Component Audio 1x Composite Audio				
Output	Video	1x VGA (D-Sub) 1x DVI (HDMI connector) 1x Composite (BNC) 1x Component (BNC)				
	Audio	Speaker (ready)				
Power	Input Voltage	100~240VAC				
	Power consumption	100 W	160 W	190 W	900W	1000 W
Features	Multi-Screen Function	HDMI, D-Sub, Component, Composite				
	Remote Control	yes (over RS232C)				
	Tempered Glass	yes	yes	yes	yes	yes
	Touch Screen (option)	D320MLI	D405MLI	D465MLI	D705MLI	D825MLI
	Transflective Panel	option				
	Optical Bonding	option				
	Anti Reflection Coating	option				
	Auto Brightness Sensor	option				
	Motion Sensor	option				
	Auto Cooling System	option	yes (1 EA)		yes (3 EA)	yes (8EA)
	Others	Auto Power Control (On/Off Timer), Edge Correction				
Dimension	W x H x D (mm)	764 x 454 x 114.3	955.4 x 554.4 x 117.1	1086.4 x 630.4 x 115	1671.2 x 956.4 x 164.5	1919.8 x 1088.0 x 164.5
	Bezel Size (U/D/L/R) (mm)	30/30/32/32	26.6/26.6/33.4/33.4	26.9/26.9/32/32	40.4/40.4/58.9/58.9	34.1/34.1/55/55
	Wall Mounting (WxH; mm)	400 x 200		600 x 200	400 x 600 Dual	600 x 600 Dual
Weight	Set (kg)	23.34	37.61	47.05	115.0	160.0
Accessories	Power Cord, Manual, HDMI Cable, Remote Control					

Specification Indoor Displays

MultiVision

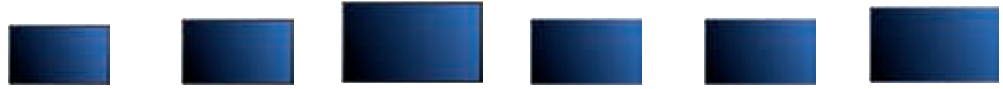

Model		D407ML	D467ML	D557ML	D462FL	D468FL	D558FL
Product Type		Narrow Bezel			Ultra Narrow Bezel		
Panel	Screen Size (diagonal)	101,6 40"	116,8 cm 46"	139,7 cm 55"	116,8 cm 46"	116,8 cm 46"	139,7 cm 55"
	Panel Type	S-PVA	S-PVA	S-PVA	S-PVA	S-PVA	S-PVA
	Active Display Area (mm)	885.6 x 498.15	1018.08 x 572.67	1209.6 x 680.4	1018.35 x 572.54	1018.35 x 572.54	1209.6 x 680.4
	Resolution	1920 x 1080	1920 x 1080	1920 x 1080	1366 x 768	1366 x 768	1920 x 1080
	Aspect Ratio	16:9	16:9	16:9	16:9	16:9	16:9
	Display Colors	16.7 M	16.7 M	16.7 M	16.7 M	16.7 M	16.7 M
	Brightness (Typ)	700 cd/m ²	700 cd/m ²	700 cd/m ²	450 cd/m ²	700 cd/m ²	700 cd/m ²
	Contrast Ratio	3000:1	3000:1	4000:1	4500:1	3000:1	3000:1
	Response Time	8 ms	8 ms	8 ms	8 ms	8 ms	10 ms
	Viewing Angle	178°/178°	178°/178°	178°/178°	178°/178°	178°/178°	178°/178°
	Lifetime (hours)	50,000	50,000	50,000	50,000h	50,000h	50,000
Resolution	Monitor	1920 x 1080	1920 x 1080	1920 x 1080	1360 x 768	1360 x 768	1920 x 1080
	DTV	1080p	1080p	1080p	1080i	1080i	1080p
Input	Video	1x VGA (D-Sub) 1x HDMI 1x Composite (BNC) 1x Component (BNC)					
	Audio	1x PC Audio 1x Component Audio 1x Composite Audio					
Output	Video	1x VGA (D-Sub) 1x DVI (HDMI connector) 1x Composite (BNC) 1x Component (BNC)					
	Audio	Speaker (ready)					
Power	Input Voltage	100~240VAC					
	Power consumption	160 W	190 W	330 W	180 W	260 W	250 W
Features	Multi-Screen Function	HDMI, D-Sub, Component, Composite					
	Remote Control	yes (over RS232C)					
	Tempered Glass (option)	D407MLG	D467MLG	D557MLG	n/a	n/a	n/a
	Touch Screen (option)	D407MLI	D467MLI	D557MLI	n/a	n/a	n/a
	Transflective Function	option			n/a	n/a	n/a
	Optical Bonding	option			n/a	n/a	n/a
	Anti Reflection Coating	option			n/a	n/a	n/a
	Auto Brightness Sensor	option					
	Motion Sensor	option					
	Auto Cooling System	yes (1 EA)	yes (1 EA)	yes (3 EA)	yes (1 EA)	Yes (1EA)	Yes (2EA)
	Others	Auto Power Control (On/Off Timer), Edge Correction					
Dimension	W x H x D (mm)	915 x 527.5 x 123.6	1051.2 x 604.4 x 128.3	1245.6 x 716.4 x 130	1025.6 x 579.8 x 108.2	1025.6 x 579.8 x 108.2	1215.3 x 686.1 x 100.7
	Bezel Size (U/D/L/R)	13.3/13.3/13.3/13.3	14.4/14.4/14.9/14.9	16.3/16.3/16.3/16.3	4.6/2.7/4.6/2.7	4.6/2.7/4.6/2.7	3.7/1.8/3.7/1.8
	Wall Mounting (WxH; mm)	600 x 200					
Weight	Set (kg)	28.0	33.5	53.2	23.0	26.0	36.0
Accessories	Power Cord, Manual, HDMI Cable, Remote Control						

Touch Screen



Model		D190MLI	D233MLI	D320MLI	D405MLI	D465MLI
Product Type		Standard Metal Frame				
Panel	Screen Size (diagonal)	48,3 cm 19"	58,4 cm 23"	81,3 cm 32"	101,6 cm 40"	116,8 cm 46"
	Panel type	TN	S-PVA	S-PVA	S-PVA	S-PVA
	Active Display Area (mm)	408 x 255	509.76 x 286.74	697.68 x 392.25	885.6 x 498.15	1018.08 x 572.67
	Resolution	1440 x 900	1920 x 1080	1366 x 768	1920 x 1080	1920 x 1080
	Aspect Ratio	16:10	16:9	16:9	16:9	16:9
	Display Colors	16.7 M	16.7 M	16.7 M	16.7 M	16.7 M
	Brightness (Typ)	300 cd/m ²	300 cd/m ²	450 cd/m ²	450 cd/m ²	450 cd/m ²
	Contrast Ratio	1000:1	3000:1	3000:1	3000:1	3000:1
	Response Time	5 ms	25 ms	8 ms	8 ms	8 ms
	Viewing Angle	160°/160°	178°/178°	178°/178°	178°/178°	178°/178°
	Lifetime (hours)	50,000	50,000	50,000	50,000	50,000
Touch Screen	Resolution	4096 x 4096	6048 X 3456	8384 x 4736	10624 x 6016	11456 x 6400
	Response Time (ms)	6	Touch: 16, Drawing: 25	Touch: 16, Drawing: 25	Touch: 21, Drawing: 33	Touch: 10, Drawing: 15.2
	Glass	Transmission : 92%(MAX), Thickness: 5mm with anti-vandal				
	Touch object size (mm)	Touch: ø14, Stylus: ø14	Touch: ø6, Stylus: ø7	Touch: ø5, Stylus: ø6	Touch: ø6, Stylus: ø7	Touch: ø6, Stylus: ø7
	Interface	USB 2.0				
	Touch Intensity	over 60,000,000				
	Detection Method	Capacitive	Infrared Rays			
	HID compatible (option)	n/a	Windows, Linux			
Resolution	Monitor	1440 x 900	1920 x 1080	1360 x 768	1920 x 1080	1920 x 1080
	DTV	1080pi	1080p	1080i	1080p	1080p
Input	Video	D-Sub, HDMI	D-Sub, HDMI	1x VGA (D-Sub) HDMI 1x Composite (BNC) 1x Component (BNC)		
	Audio	1x PC Audio	1x PC Audio	1x PC Audio 1x Component Audio 1x Composite Audio		
Output	Video	1x D-Sub 1x HDMI	1x D-Sub 1x HDMI	1x VGA (D-Sub) 1x DVI (HDMI connector) 1x Composite (BNC) 1x Component (BNC)		
	Audio	Speaker (ready)				
Power	Input Voltage	100~240VAC				
	Power consumption	25 W	50 W	100 W	160 W	190 W
Features	Multi-Screen Function	HDMI, D-Sub		HDMI, D-Sub, Component, Composite		
	Remote Control	yes (over RS232C)				
	Tempered Glass	yes	yes	yes	yes	yes
	Touch Screen	yes	yes	yes	yes	yes
	Transflective Panel	option				
	Optical Bonding	n/a	n/a	n/a		
	Anti Reflection Coating	option				
	Auto Brightness Sensor	option				
	Motion Sensor	option				
	Auto Cooling System	n/a	option	option	yes (1EA)	
	Others	Auto Power Control (On/Off Timer), Edge Correction				
Dimension	W x H x D (mm)	455.3x302.2x59.4	583 x 360 x 78.6	764 x 454 x 114.3	955.4 x 554.4 x 117.1	1086.4 x 630.4 x 115
	Bezel Size (U/D/L/R) (mm)	23/23/23/23	35.4/35.4/35.7/35.7	30/30/32/32	26.6/26.6/33.4/33.4	26.9/26.9/32/32
	Wall Mounting (WxH; mm)	100 x 100	100 x 100	400 x 200		600 x 200
Weight	Set (kg)	7	9	24.5	39.5	50.5
Accessories	Power Cord, Manual, HDMI Cable, Remote Control					

Specification Indoor Displays

Touch Screen



Model		D557MLI	D705MLI	D825MLI	G75TR	G95TR
Product Type		Metal Frame			Desktop Monitor	
Panel	Screen Size (diagonal)	139,7 cm 55"	177,8 cm 70"	208,3 cm 82"	43,2 cm 17"	48,3 cm 19"
	Panel type	S-PVA	S-PVA	S-PVA	TN	TN
	Active Display Area (mm)	1209.6 x 680.4	1549.44 x 871.56	1805.76 x 1015.74	337.9 x 270.3	376 x 301
	Resolution	1920 x 1080	1920 x 1080	1920 x 1080	1280 x 1024	1280 x 1024
	Aspect Ratio	16:9	16:9	16:9	4:3	4:3
	Display Colors	16.7 M	16.7 M	16.7 M	16.7 M	16.7 M
	Brightness (Typ)	700 cd/m ²	600 cd/m ²	600 cd/m ²	250 cd/m ²	250 cd/m ²
	Contrast Ratio	4000:1	2000:1	1200:1	1000:1	1000:1
	Response Time	8 ms	8 ms	8 ms	5 ms	5 ms
	Viewing Angle	178°/178°	178°/178°	178°/178°	160°/160°	160°/160°
	Lifetime (hours)	50,000	50,000	50,000	50,000	50,000
Touch Screen	Resolution	65535 x 65535	16384 x 9856	16384 x 13952	2048 x 2048	2048 x 2048
	Response Time (ms)	Touch: 8, Drawing: 15	Touch: 11, Drawing: 16	Touch: 12, Drawing: 21	25	
	Glass	Transmission: 93%, Thickness: 5mm with anti-vandal			harded, anti-glare (no glass)	
	Touch object size (mm)	Touch: ø 6, Stylus: ø 6	Touch: ø 7, Stylus: ø 8	Touch: ø 8, Stylus: ø 9	n/a	
	Interface	USB 1.1	USB 2.0			
	Touch Intensity	over 60,000,000			35,000,000	
	Detection Method	Infrared Rays			5-Wire Resistive	5-Wire Resistive
	HID compatible (option)	Windows, Linux			n/a	
Resolution	Monitor	1920 x 1080	1920 x 1080	1920 x 1080	1280 x 1024	1280 x 1024
	DTV	1080p	1080p	1080p	n/a	
Input	Video	1x VGA (D-Sub) 1x HDMI 1x Composite (BNC) 1x Component (BNC)			15-pin D-Sub 24-pin DVI-D	
	Audio	1x PC Audio 1x Component Audio 1x Composite Audio			1 W x 2ch	
Output	Video	1x VGA (D-Sub) 1x DVI (HDMI connector) 1x Composite (BNC) 1x Component (BNC)			n/a	
	Audio	Speaker (ready)			2 W x 2ch	2 W x 2ch
Power	Input Voltage	100~240VAC				
	Power consumption	330 W	900 W	1000 W	36 W	36 W
Features	Multi-Screen Function	HDMI, D-Sub, Component, Composite			n/a	
	Remote Control	yes (over RS232C)			n/a	
	Tempered Glass (option)	yes	yes	yes	n/a	
	Touch Screen (option)	yes	yes	yes	n/a	
	Transflective Panel	option			n/a	
	Optical Bonding	n/a			n/a	
	Anti Reflection Coating	option			n/a	
	Auto Brightness Sensor	option			n/a	
	Motion Sensor	option			n/a	
	Auto Cooling System	yes (3EA)	yes (3EA)	yes (8 EA)	n/a	
	Others	Auto Power Control (On/Off Timer), Edge Correction			n/a	
Dimension	W x H x D (mm)	1245.6 x 716.4 x 130	1683.4 x 1053 x 170.8	1962.2 x 1133.4 x 174.7	391 x 366 x 234	429 x 378 x 233
	Bezel Size (U/D/L/R) (mm)	16.3/16.3/16.3/16.3	86.5/86.5/62.7/62.7	56.9/56.9/76.2/76.2	n/a	n/a
	Wall Mounting (WxH; mm)	600 x 200, 600 x 400	400 x 600 Dual	600 x 600 Dual	75 x 75	100 x 100
Weight	Set (kg)	73.2	130	180	6.2	8.5
Accessories	Power Cord, Manual, HDMI Cable, Remote Control					

Stand-Alone



LED Backlight



WideVision



Model		D467SLG	D467SLI	D46EMA	D55EMA	C430ML
Product Type		SingleVision	Touch Screen	Slim Design		Narrow Bezel
Panel	Screen Size (diagonal)	116,8 cm 46"	116,8 cm 46"	116,8 cm 46"	139,7 cm 55"	109,22 cm 43,0"
	Panel Type	S-PVA	S-PVA	S-PVA	S-PVA	S-PVA
	Active Display Area (mm)	1018.08 x 572.67	1018.08 x 572.67	1018.35 x 572.54	1209.6 x 680.4	1059 x 264.96
	Resolution	1920 x 1080	1920 x 1080	1920 x 1080	1920 x 1080	1920 x 480
	Aspect Ratio	16:9	16:9	16:9	16:9	4:1
	Display Colors	16.7 M	16.7 M	1.07 B	1.07 B	16.7 M
	Brightness (Typ)	700 cd/m ²	700 cd/m ²	600 cd/m ²	600 cd/m ²	700 cd/m ²
	Contrast Ratio	4000:1	4000:1	3000:1	4000:1	3000:1
	Response Time	8 ms	8 ms	10 ms	10 ms	8 ms
	Viewing Angle	178°/178°	178°/178°	178°/178°	178°/178°	178°/178°
Lifetime (hours)	50,000	50,000	50,000	50,000	50,000	
Touch Screen	Resolution	n/a	11456 x 6400	n/a	n/a	n/a
	Response Time (ms)	n/a	Touch: 6; Drawing: 7	n/a	n/a	n/a
	Glass	n/a	Transmission: 93%, Thickness: 5mm	n/a	n/a	n/a
	Touch object size (mm)	n/a	Touch: ø6, Stylus: ø7	n/a	n/a	n/a
	Interface	n/a	USB 2.0	n/a	n/a	n/a
	Touch Intensity	n/a	over 60,000,000	n/a	n/a	n/a
	Detection Method	n/a	Infrared Rays	n/a	n/a	n/a
HID compatible (option)	n/a	Windows, Linux	n/a	n/a	n/a	
Resolution	Monitor	1920 x 1080	1920 x 1080	1920 x 1080	1920 x 1080	1920 x 1080
	DTV	1080p	1080p	1080p	1080p	1080p
Input	Video	1x VGA (D-Sub) 1x HDMI 1x Composite (BNC) 1x Component (BNC)				1x VGA (D-Sub), 1x HDMI, RS232
	Audio	1x PC Audio 1x Component Audio 1x Composite Audio				PC Audio
Output	Video	1x VGA (D-Sub) 1x DVI (HDMI connector) 1x Composite (BNC) 1x Component (BNC)				1x VGA (D-Sub), 1x HDMI, RS232
	Audio	Speaker (ready)				
Power	Input Voltage	100–240VAC				
	Power consumption	260 W	260 W	145 W	185W	130 W
Features	Multi-Screen Function	n/a	n/a	n/a	n/a	yes
	Remote Control	yes (over RS232C)				
	Tempered Glass (option)	yes	yes	option	option	C430MLG
	Touch Screen (option)	no	yes	n/a	n/a	n/a
	Transflective Function	option		n/a	n/a	option
	Optical Bonding	option		option		
	Anti Reflection Coating	option				
	Auto Brightness Sensor	option				
	Motion Sensor	option				
	Auto Cooling System	yes	yes	n/a	n/a	n/a
Others	Auto Power Control (On/Off Timer), Edge Correction					
Dimension	WxHxD (mm)	701.8 x 1147.4 x 150	701.8 x 1147.4 x 150	1074.1 x 628.9 x 39.5	1265.4 x 737.1 x 39.5	1087 x 292 x 112.6
	Bezel Size	n/a	n/a	26.8/26.8/26.8/26.8	26.8/26.8/26.8/26.8	n/a
	Wall Mounting (WxH; mm)	n/a	n/a	600 x 200	600 x 200	600 x 200
Weight	Set (kg)	110,5	122,5	18	23	16
Accessories	Power cord, Manual, VGA Cable, HDMI Cable, Remote Control					

●●● Specification Outdoor Displays

S-Series



A-Series



Model		H466SC	H466SL	H466ST	H466AC	H466AL	H466AT
Product Type		Stand-Alone Outdoor Display					
Panel	Screen Size	116,84 cm 46"	116,84 cm 46"	116,84 cm 46"	116,84 cm 46"	116,84 cm 46"	116,84 cm 46"
	Panel Type	S-PVA	S-PVA	S-PVA	S-PVA	S-PVA	S-PVA
	Transflective Panel	No	No	Yes	No	No	Yes
	Active Display Area (mm)	1018.35 x 572.54	1018.35 x 572.54	1018.35 x 572.54	1018.35 x 572.54	1018.35 x 572.54	1018.35 x 572.54
	Resolution	1366 x 768	1366 x 768	1366 x 768	1366 x 768	1366 x 768	1366 x 768
	Aspect Ratio	16 : 9	16 : 9	16 : 9	16 : 9	16 : 9	16 : 9
	Display Colors	16.7 M	16.7 M	16.7 M	16.7 M	16.7 M	16.7 M
	Brightness (cd/m ² ; typ.)	1500	2500	2400 (3000 at 80K lux)	1500	2500	2400 (3000 at 80K lux)
	Contrast Ratio	3000 : 1	4000 : 1	2900 : 1	3000 : 1	4000 : 1	2900 : 1
	Response Time (ms; GTG)	8	8	8	8	8	8
	Viewing Angle (H°/V°)	178°/178°	178°/178°	178°/178°	178°/178°	178°/178°	178°/178°
	Life Time (hours)	50,000	30,000	50,000	50,000	30,000	50,000
	Backlight type	CCFL	LED	CCFL	CCFL	LED	CCFL
Input	VGA (15pin D-Sub)	1	1	1	1	1	1
	HDMI	1	1	1	1	1	1
	RS232	1	1	1	1	1	1
Power	Operating Voltage	100 – 240V AC	100 – 240VAC	100 – 240VAC	100 – 240V AC	100 – 240VAC	100 – 240VAC
	Consumption	450 W	500 W	450 W	450 W	500 W	450 W
	Consumption per nits	0,3 W (max.)	0,2 W (max.)	0,187 (max.)	0,3 W (max.)	0,2 W (max.)	0,187 (max.)
	Heater Block	1.2KW/Peak 2.5KW	1.2KW/Peak 2.5KW	1.2KW/Peak 2.5KW	1.2KW/Peak 2.5KW	1.2KW/Peak 2.5KW	1.2KW/Peak 2.5KW
Features	Auto Cooling System	Yes	Yes	Yes	Yes	Yes	Yes
	Auto Heating System	Yes	Yes	Yes	Yes	Yes	Yes
	Anti-Vandal Glass	Yes	Yes	Yes	Yes	Yes	Yes
	Anti Reflection Coating	Yes	Yes	Yes	Yes	Yes	Yes
	Auto Brightness Sensor	Yes	Yes	Yes	Yes	Yes	Yes
	Anti-Graffiti Coating	option	option	option	option	option	option
	Touch Screen	option (= H466SCI)	option (= H466SLI)	option (=H466STI)	option (= H466ACI)	option (= H466ALI)	option (=H466ATI)
Dimension	Set (mm; W x H x D)	770 x 1950 x 250	770 x 1950 x 250	770 x 1950 x 250	870 x 2068 x 250	870 x 2068 x 250	870 x 2068 x 250
Weight	Set (kg)	135	135	135	205	207	206
Surface	Treatment	powder coated	powder coated	powder coated	powder coated	powder coated	powder coated
Temperature	Operational (°C)	-40/50 (min/max)	-40/50 (min/max)	-40/50 (min/max)	-40/50 (min/max)	-40/50 (min/max)	-40/50 (min/max)
	Storage (°C)	-40/60 (min/max)	-40/60 (min/max)	-40/60 (min/max)	-40/60 (min/max)	-40/60 (min/max)	-40/60 (min/max)
Humidity	Non-condensing (%)	20 – 80	20 – 80	20 – 80	20 – 80	20 – 80	20 – 80
Approvals	EMI/EMC	KCC, CE	KCC, CE	KCC, CE	KCC, CE	KCC, CE	KCC, CE
	Safety	CB, TUV, KC	CB, TUV, KC	CB, TUV, KC	CB, TUV, KC	CB, TUV, KC	CB, TUV, KC
	Ingress Protection	IP55 – IP65	IP55 – IP65	IP55 – IP65	IP66	IP66	IP66

Transflective Panel



Model		D407MLT	D466MLT	D471MLT	D557MLT
Product Type		Narrow Bezel	SingleVision	High Temperature	Narrow Bezel
Panel	Screen Size	101,6 cm 40"	116,8 cm 46"	119,4 cm 47"	116,8 cm 55"
	Active Display Area (mm)	885.6 x 498.15	1018.35 x 572.54	1039.68 x 584.82	1242.0 x 713.0
	Resolution	1920 x 1080	1366 x 768	1920 x 1080	1920 x 1080
	Aspect Ratio	16:9	16:9	16:9	16:9
	Display Colors	16.7 M	16.7 M	1.07 B	16.7 M
	Brightness (Typ)	900 cd/m ²	2400 cd/m ²	1540 cd/m ²	1150 cd/m ²
	Brightness max. (at 80K lux conditions)	1200 cd/m ²	3000 cd/m ²	2100 cd/m ²	1500 cd/m ²
	Contrast Ratio		2900:1	1200:1	2300:1
	Response Time	8 ms	8 ms	9 ms	8 ms
	Viewing Angle	178°/178°	178°/178°	178°/178°	178°/178°
	Lifetime (hour)	50,000	50,000	50,000	50,000
Resolution	Monitor	1920 x 1080	1360 x 768	1920 x 1080	1920 x 1080
	DTV	1080p	1080i	1080p	1080p
Input	Video	1x VGA (D-Sub) 1x HDMI 1x Composite (BNC) 1x Component (BNC)			
	Audio	1x PC Audio 1x Component Audio 1x Composite Audio			
Output	Video	1x VGA (D-Sub) 1x DVI (HDMI connector) 1x Composite (BNC) 1x Component (BNC)			
	Audio	Speaker (ready)			
Power	Input Voltage	100~240VAC	100~240VAC	100~240VAC	100~240VAC
	Power consumption	200 W	310 W	280 W	330 W
Features	Multi-Screen Function	HDMI, D-Sub, Component, Composite			
	Remote Control	yes (over RS232C)			
	Tempered Glass (Option)	D407MLTG	D466MLTG	D471MLTG	D557MLTG
	Touch Screen (Option)	D407MLTI	D466MLTI	n/a	D557MLTI
	Transflective Panel	yes	yes	yes	yes
	Optical Bonding	n/a			
	Anti Reflection Coating	option			
	Auto Brightness Sensor	option			
	Motion Sensor	option			
	Auto Cooling System	yes (1 EA)			yes (3EA)
Others	Auto Power Control (On/Off Timer), Edge Correction				
Dimension	Wall Mounting (WxH, mm)	400 x 200	600 x 200	600 x 200	600 x 200
	W x H x D (mm)	915 x 527.5 x 123.6	1051.2 x 604.4 x 128.3	1071.4 x 616.6 x 99.7	1245.6 x 716.4 x 130
	Bezel Size (U/D/L/R) (mm)	13.3/13.3/13.3/13.3	14.4/14.4/14.9/14.9	14.3/14.3/14.3/14.3	16.3/16.3/16.3/16.3
Weight	Set (kg)	28,0	32.5	32,0	53,2
Accessories		Power Cord, Manual, HDMI Cable, Remote Control			

●●● Specification Indoor Displays

Stereoscopic 3D



Model Name		W243S	S320D	S465D	S468FS
Product Type		Monitor			Ultra Narrow Bezel
3D Technology	Filter	Micro-Circular Polarizing Filter			
	Compatibility Conversion	2D/3D compatible Real-Time 3D Conversion (Integration Board)			
	3D Format	Horizontal interlaced			
	Viewing Angle (H/V)	160°/10°	178°/20° (typ. CR:10)	178°/20° (typ. CR:10)	178°/20° (typ. CR:10)
	Supported 3D Resolution	1920 x 1200	1366 x 768	1920 x 1080	1366 x 768
	Supported 3D Input Format	Side by Side, Top and Bottom, Line Alternate			
	Viewing Distance (Recom.)	0.6 ~1.0 m	1.0~3.0 m	1.5~5.0 m	3.0~10.0 m
Panel	Type	A-Si TFT Active Matrix	A-Si TFT Active Matrix	A-Si TFT Active Matrix	A-Si TFT Active Matrix
	Size (diagonale)	61 cm (24")	81,82 cm (32")	116.8 cm (46")	116.8 cm (46")
	Display Area (H/V)	518.4 x 324 mm	697.7 x 392.3 mm	1081.1 x 572.7 mm	1018.4 x 572.5 mm
	Viewing Angle (H/V)	160° / 160° (CR:<=10)	178° / 178° (CR:<=10)	178° / 178° (CR:<=10)	178° / 178° (CR:<=10)
	Contrast Ratio	1000:1 / 30000:1 (DCR)	3,000:1 / 6,000:1 (DCR)	4,000:1 / 6,000:1 (DCR)	3,000:1
	Response Time	5 ms (typical)	8 ms (GtG)	8 ms (GtG)	8 ms (GtG)
	Brightness	300 cd/m² (typical)	450 cd/m² (typical)	450 cd/m² (typical)	700 cd/m² (typical)
	Aspect Ratio	16:10	16:9	16:9	16:9
	Colors	16.7 M	16.7 M	16.7 M	16.7 M
Resolution	Maximum / Recommended	1920 x 1200 @ 60Hz	1366 x 768 @ 60Hz	1920 x 1080 @ 60Hz	1366 x 768 @ 60 Hz
	Video	480p, 576p, 720p, 1080i/p	480i/p, 576i/p, 720p, 1080i/p, 1080@24p	480i/p, 576i/p, 720p, 1080i/p, 1080@24p	480i/p, 576i/p, 720p, 1080i/p
Input Signal	Analog RGB / DVI-D	1/1	1/-	1/-	1/1
	HDMI (HDCP) / Component	1/1	3/1	3/1	3/1
	HSDSI	n/a	n/a		
	S-Video/Composite	-/-	1/-	1/-	1/1
	PC Audio	Yes	Yes	Yes	Yes
Plug-and-Play Power Management	VESA DDC 2B VESA DPMS	VESA DDC 1/2B VESA DPMS	VESA DDC 1/2B VESA DPMS	VESA DDC 1/2B VESA DPMS	
Power	Voltage	100-240V AC	100-240V AC	100-240V AC	100-240V AC
	Consumption	50 Watt (typical)	150 Watt (typical)	230 Watt (typical)	269 Watt (typical)
Other Features	Audio System	Internal Loudspeaker 2 x 3 Watt, PC Audio In/Out	max. 10W x 2ch	max. 10W x 2ch	ready (max. 10W x 2ch)
	Kensington Slot / Wallmount Holes	Yes Yes (VESA: 100 x 100 mm)	Yes Yes (580 x 420 mm)	Yes Yes (580 x 420 mm)	Yes Yes (600 x 200 mm)
Stand	Type	Tilt /PIVOT/height-adj.	Tilttable	Tilttable	-
Cabinet Color		Black/White high gloss design	Black	Black	Black
Dimensions	Unit (W x H x D)	579 x 455 x 240 mm	806 x 617 x 226	1143 x 831.8 x 310	1025.6x579.8x108.2
Weight	Unit (kg)	9.9	17	31	26
Accessories		Power cable, DVI Cable, D-Sub Cable, Audio Cable, Quick Installation guide, 3D glasses, HDMI-DVI Cable (S465D, S468FL only); CD-ROM: User manual, Driver, ICM profil 3D software package			

Adcalator™

Open Frame

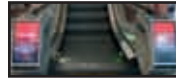

Model		A200K	H210S
Product Type		DualVision	Open Frame
Panel	Screen Size (diagonal)	50,8 cm 20"	54,86 cm 21,6"
	Panel Type	PVA	TN
	Active Display Area (mm)	442.8 x 249.075	477.4 x 268.4
	Resolution	1600 x 900	1366 x 768
	Aspect Ratio	16:9	16:9
	Display Colors	16.7 M	16.7 M
	Brightness (Typ)	500 cd/m ²	1500 cd/m ²
	Contrast Ratio	3000:1	1000:1
	Response Time	8 ms	max. 8 ms
	Viewing Angle	178°/178°	160°/160°
	Lifetime (hours)	30,000	30,000
	Backlight Type	LED	LED
Player/PC	Main Chipset	EM8621L	n/a
	Supported media format	Video: WMV9, MPEG 1,2,4 Audio: MP3, WMA Image : JPEG, BMP, PNG	n/a
	Output	D-SUB, DVI, Audio	n/a
	HDD (memory)	2GB CF Memory card	n/a
Resolution	Monitor	640 x 480	1366 x 768
	DTV	n/a	1080i
Input	Video	1x VGA (D-Sub) 1x HDMI RS232 LAN	1x VGA (D-Sub) 1x HDMI RS232 LAN
	Audio	1x PC Audio	1x PC Audio
Output	Video	1x VGA (D-Sub) 1x HDMI	1x VGA (D-Sub) 1x HDMI
	Audio	yes	yes
Power	Input Voltage	100~240VAC	100~240VAC
	Power consumption	master: 75 W slave: 55 W	85 W
Features	Multi-Screen Function	n/a	n/a
	Remote Control	yes (over RS232C)	yes (over RS232C)
	Tempered Glass (option)	yes (thickness: 5T)	yes
	Anti-Vandal Glass	n/a	yes (5+3mm)
	Touch Screen (option)	n/a	yes
	Transflective Function	n/a	option
	Optical Bonding	yes	option
	Anti Reflection Coating	yes	option
	Auto Brightness Sensor	n/a	yes
	Motion Sensor	n/a	option
	Auto Heating System	n/a	option
	Auto Cooling System	n/a	yes
Others	Auto Power Control	Auto Power Control	
Dimension	WxHxD (mm)	295.5 x 626.6 x 790	710 x 1850 x 470
	Bezel Size	n/a	12/12/14.5/14.5
	Wall Mounting (WxH; mm)	n/a	100 x 100
Weight	Set (kg)	27 (one unit)	90
Accessories	Power cord, Manual, VGA Cable, HDMI Cable, Remote Control		

●●● Accessories/Warranty Terms

Table Stand Type A – landscape (Option)

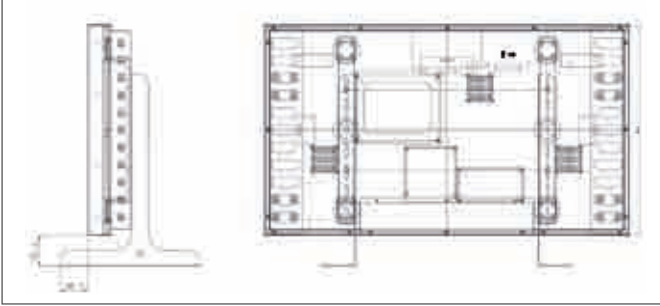
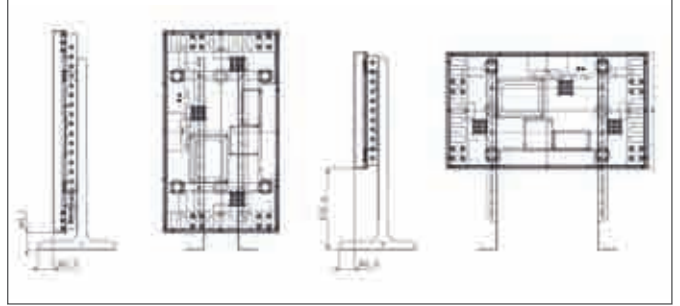
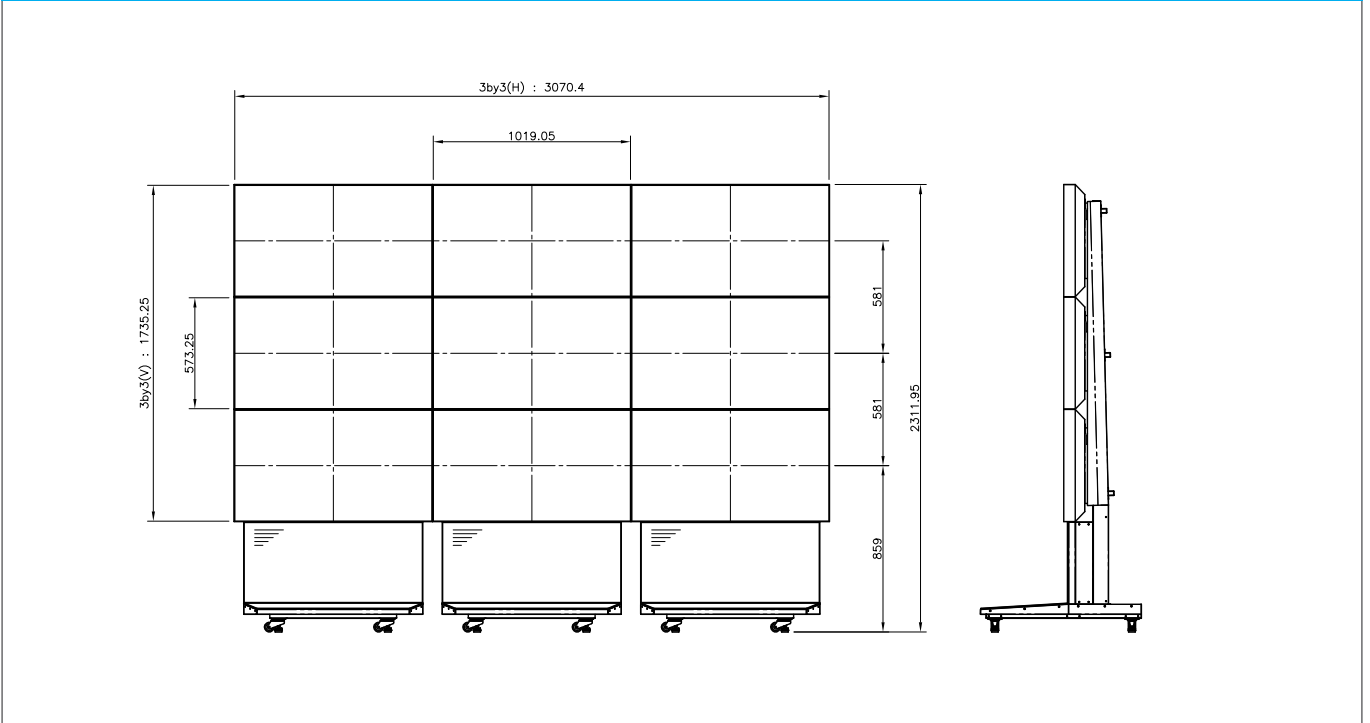

Table Stand Type B – portrait/landscape (Option)



Floorstand 3D MultiVision (Option)



Warranty Terms

Warranty Terms

HYUNDAI IT display products are high advanced technology products. By following international development and production standards, we always ensure the best product quality and thus high product reliability. Nevertheless, in case of any service event, we provide a fast and credible after-sales support. According to the customer needs we are providing different service levels.

SERVICE LEVEL	DESCRIPTION
STANDARD	2 years pick-up, repair & return
HOME-IN	On-Site analysis by engineer. If necessary a defective unit will be immediately replaced. Customer is free in un-installation and delivery time consumption.
PREMIUM	Wherever product is displayed, in next business day it is reworking. Warranty extension up to 5 years. Includes configuration, delivery, installation and maintenance.

The HYUNDAI IT Story

HYUNDAI Electronics first set up a monitor division at its electronics corporation in 1984. After launching the first monochrome monitor, HYUNDAI continuously developed its product range, rapidly succeeding in expanding production to over 1 million units per year. HYUNDAI has been a leading manufacturer of TFT displays in a variety of sizes since the mid-1990s. In 2000, the monitor division parted company with the parent corporation to become what is today Hyundai IT Corp. Ltd., Korea, and associated HYUNDAI IT Europe GmbH. The company operates in-house

research, development and production facilities to guarantee cutting-edge technology at all times and maximize customer satisfaction. "We focus on providing flawless, comprehensive service and after-sales support. We will continue to focus operations according to the needs of our customers, and combine state-of-the-art technology with the highest service standards", states President of HYUNDAI IT Europe GmbH, Mr. Y.H. Shin, in confirmation of the company's recipe for success.

Full Product Portfolio

Being an expert for digital display solutions, HYUNDAI IT is offering a full range of products for both consumer as well as professional customers:



LCD Monitor



Monitor + TV



3D Monitor



Touch Screen Monitor



3D Display



Indoor Digital Signage



Indoor Stand-Alone



Outdoor Digital Signage

GLOBAL HEADQUARTERS

HYUNDAI IT CORP.
San 136-1, Ami-ri, Bubal-eub
Ichon-si, Kyungki-do, 467-701,
The Republic of Korea
Phone: +82 31 639 8560
Fax: +82 31 636 4231
E-mail: uno@hyundaiit.com

EUROPEAN HEADQUARTERS

HYUNDAI IT EUROPE GmbH
Kreuzberger Ring 7a
65205 Wiesbaden
Germany
Phone: +49 611-20506-0
Fax. +49 611-20506-210
E-mail: info@hyundaiit.eu

FRANCE

Phone: +33 155472660
E-mail: france@hyundaiit.eu

GERMANY

Phone: +49 611-20506-0
E-mail: germany@hyundaiit.eu

POLAND

Phone: +48 605414565
E-mail: poland@hyundaiit.eu

SCANDINAVIA

Phone: +46 702377711
E-mail: scandinavia@hyundaiit.eu

SPAIN

Phone: +34 638841976
E-mail: spain@hyundaiit.eu

UNITED KINGDOM

Phone: +49 611-20506-0
E-mail: uk@hyundaiit.eu

www.hyundaiit.com