

Citizen CL-S700 series

Heavy duty industrial label printer



Who we are?

With more than half-century history, **Citizen Systems** is an expert in printing for: label, portable, point-of-sale and photo.

Having rich tradition of innovation, Citizen assures high performance, precision and perfection for its products.



Meet the Citizen CL-S700 series

- Powerful industrial label printer
- Easy access and operation of the printer
- Hi-Open™ mechanism
- Compact footprint
- Internal Rewinder factory option
- ARCP™ automatic tension system for TT model



CL-S700 series models

Printer name	Resolution	Rewinder
CL-S700	200 dpi	No
CL-S700R	200 dpi	Yes
CL-S703	300 dpi	No
CL-S703R	300 dpi	Yes

Right place in the desktop label family!



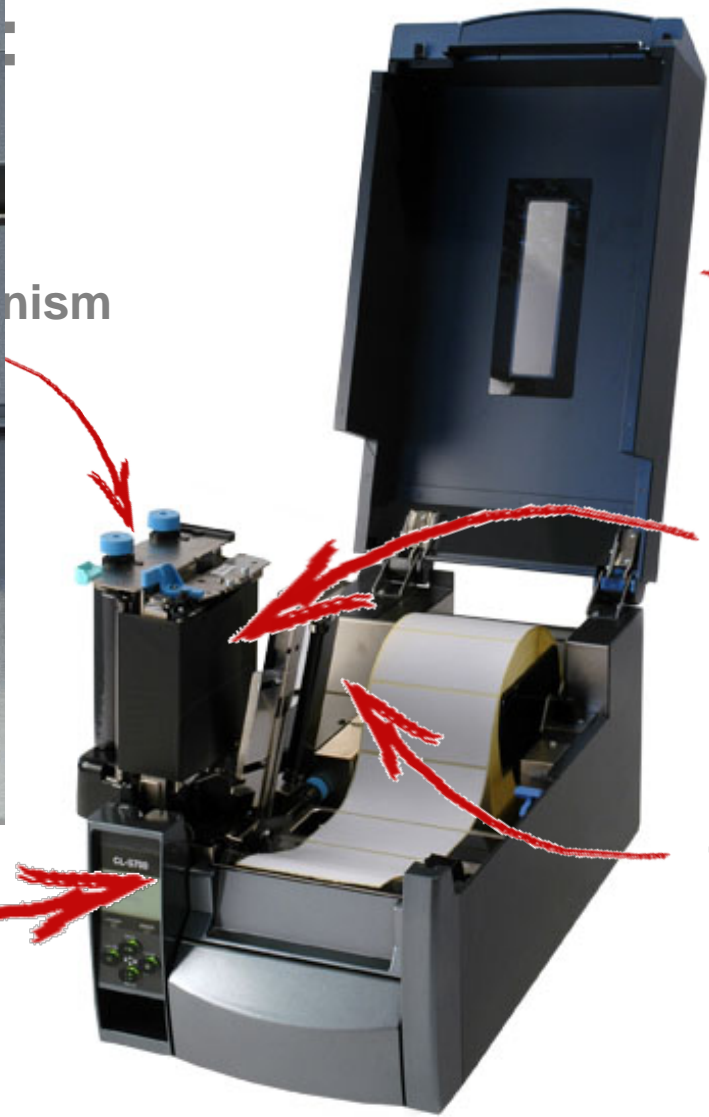

Soft close top cover

ARCP™ automatic tension system

Thermal printhead

ism

P
g

*TT model displayed

How it looks:



Rewinder Core

Internal Rewinder

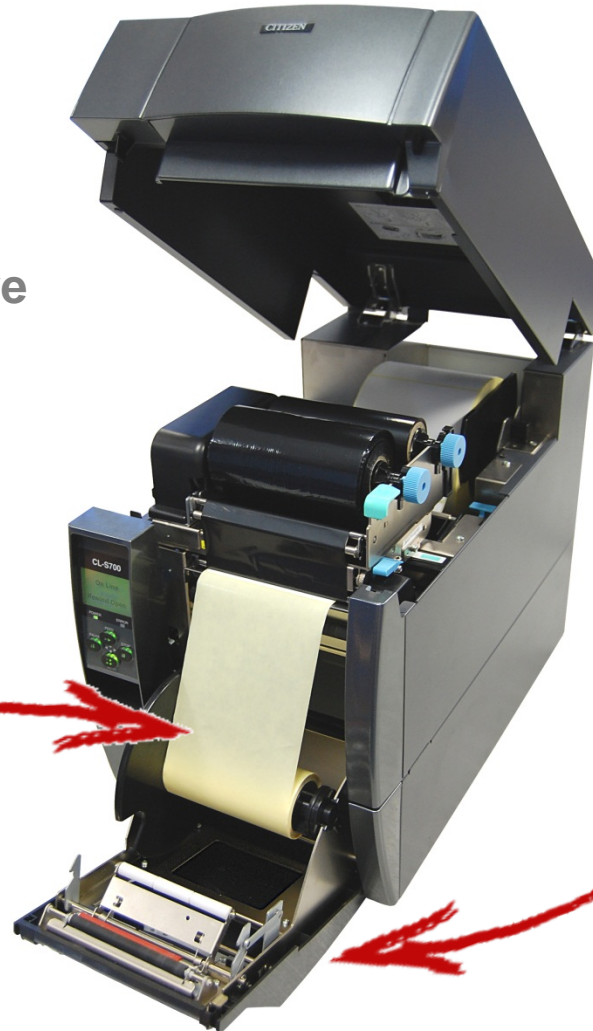

Drop-down front door

How it looks:

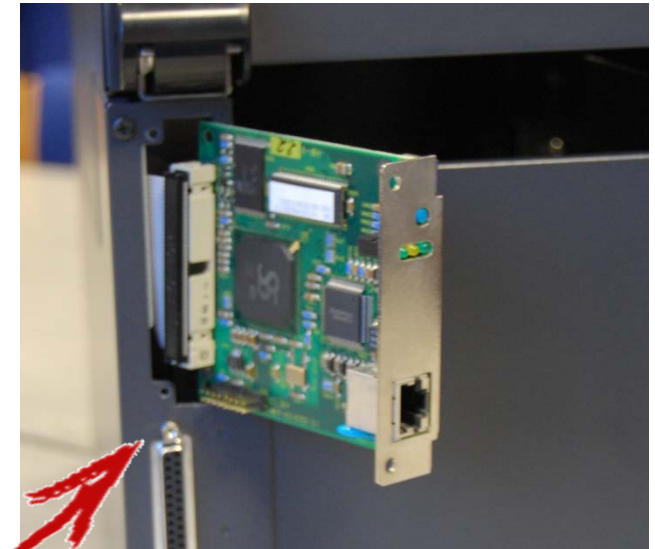
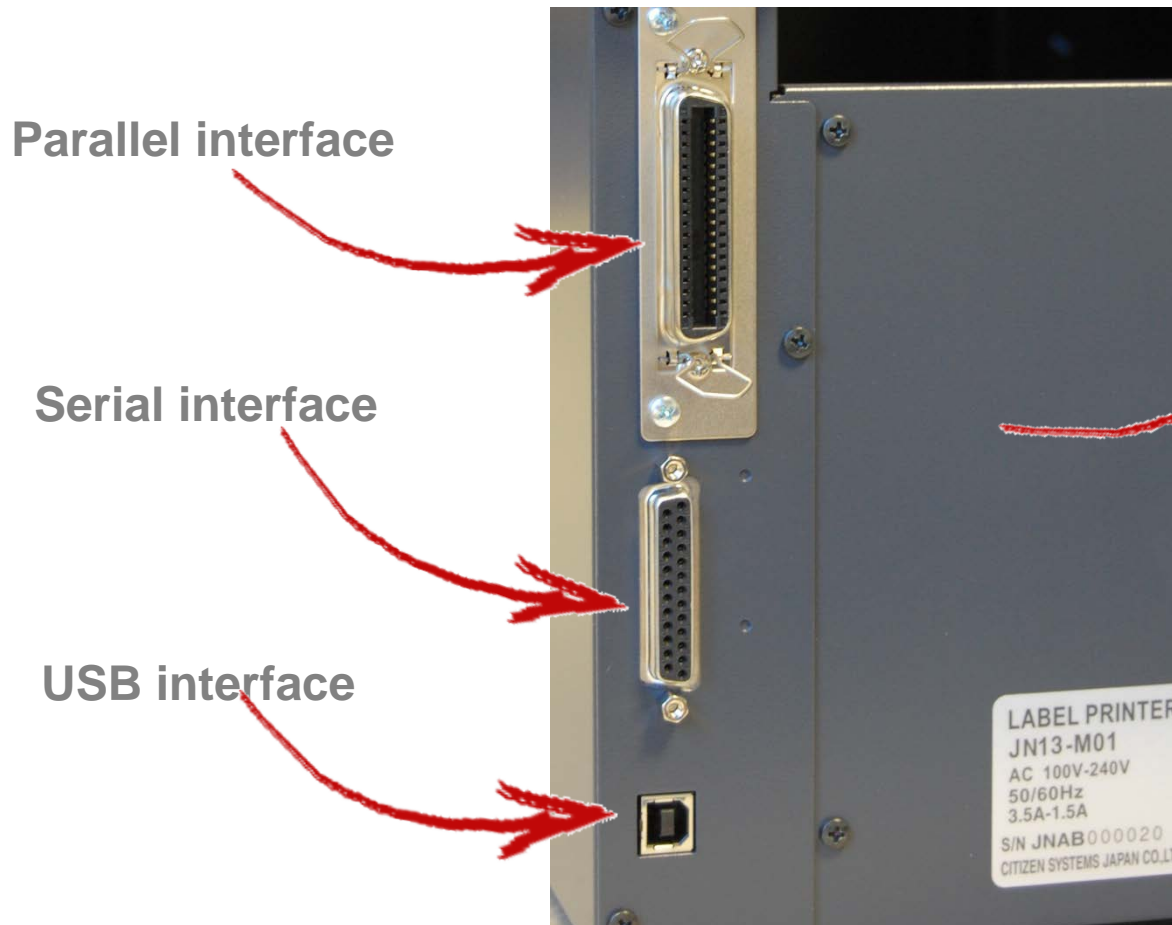

Easy access and operation

All functions accessible from the front of the printer,
without moving it:

- Ribbon loading
- Media loading
- Power switch
- Control panel
- Rewinder take-up



Compact footprint

- Ideal for tight spaces
- Smaller footprint than competition models
- Full vertical case opening
- Full operation from the front
- Drop-down front door for internal rewinder
- Two or more CL-S700 can be placed next to each other

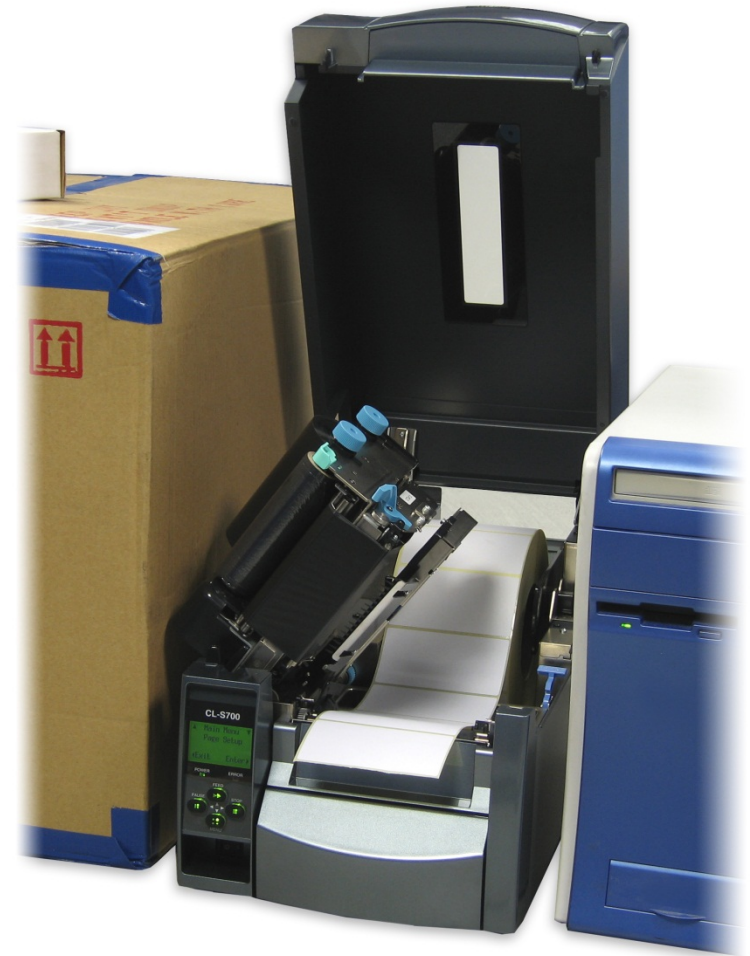

Safe operation

Soft close top cover does not slam shut and trap fingers!



Internal Rewinder

- Clever, simple and easy to use design
- Front loading
- Auto tensioning
- Used for batch printing
- Factory option only



ARCP™ system – no wrinkles!

- Keeps even tension on ribbon at all times
- Tension automatically balanced
- Better print quality
- No ribbon wrinkle

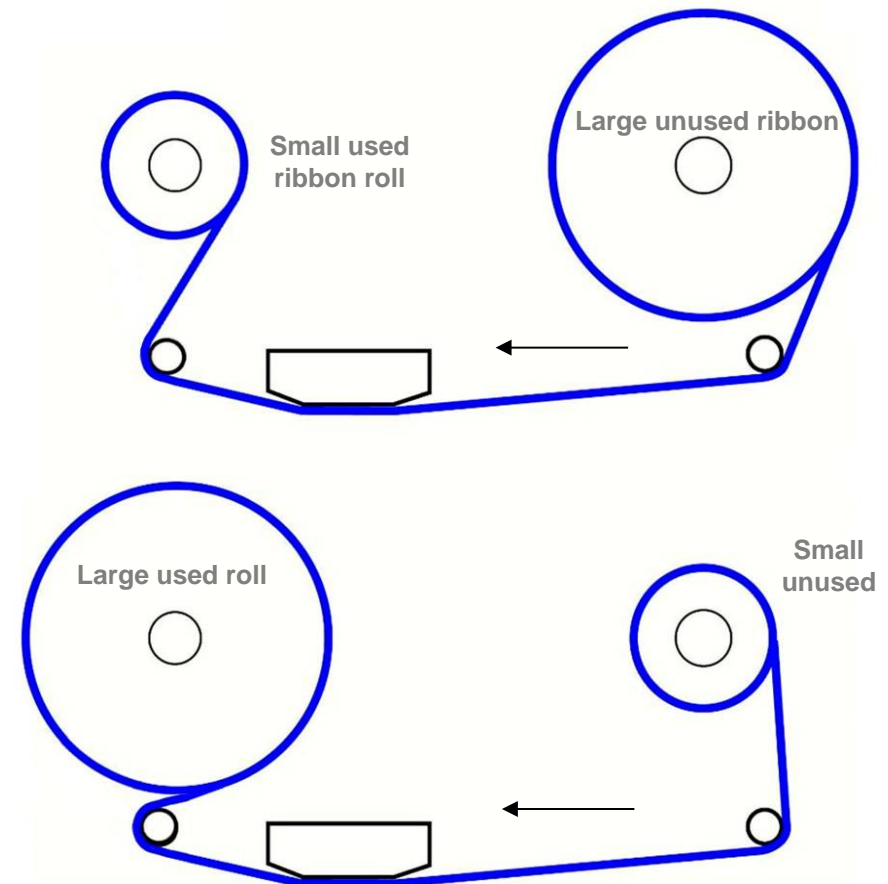

Going into details...

- **Technology** Direct Thermal & Thermal Transfer
- **Resolution** 203 dpi (8 dots/mm)
- **Print Speed** up to 10"/ sec (254 mm/sec)
- **Media Width** 1" to 4,65" (25,4 to 118,1 mm)
- **Media Thickness** 0,0025"-0,01" (0,0635 – 0,254 mm)
- **Media Sensor** Gap / Black mark

Going into details...

- **Ribbon size** 3,4” (86,5 mm) outside diameter
1476 ft (450 m) length
- **Ribbon Winding** Ink side in/out
Automatically sensing
- **Ribbon type** Wax, Wax/Resin, Resin
- **Size** 255mm x 490 mm x 265 (385) mm
- **Weight** up to 17,6 kg

Going into details...

- **Interfaces Standard** Serial & USB
- **Interfaces Optional** Parallel / Wi-LAN / Ethernet
- **Emulations** Datamax® I-Class™ & DMX400™, Zebra® ZPL-II® / Cross-Emulation™ automatic detection
- **Drivers and software** Windows®, XP®, 2003, 2008, Vista™

Where to use the CL-S700 series

- Logistics
- Courier
- Shelf-Edge
- Retail
- Warehousing
- Textile
- Card Tags



Positive experiences with CL-S700 series

- CL-S700R 2011 C-Log France
- CL-S700 2007 Dachser France
- CL-S703 2008 Fire Fighting
Headquarters Germany
- CL-S700 2007 Nature et
Découvertes France
- CL-S700 2007 ProReServ Germany
- CL-S700 2008 Smiths News UK

CL-S700 would benefit to end users...

- **Save space**
 - Hi-Open™ case vertical lift
 - Operation from the front
- **Easy handling**
 - Large LCD panel
- **High compatibility**
 - Cross emulation™ supporting Zebra® and Datamax®
- **Durability**
 - Full metal mechanism
- **Clear prints**
 - ARCP™ tension system
- **Productive**
 - Maximum operational up time
- **Lower TCO**
 - Competitive pricing

CL-S700 would benefit to you...

- Brand with solid reputation in professional printing solutions
- Competitive price positioning
- Higher margin opportunity comparing to average market level

**More business-opportunities
for you!**



Want to order or get more information?

Please contact your regional manager



Román Aresté

Sales Manager DACH

Roman.Areste@citizen-europe.com

Office +49 6071 207070

Mob. +49 172 742 7587