

800-737-7133

Raleigh Distribution Sales / Support TEAM

➤ Products – the Roseburg Framing System:

- RigidLam® LVL (2.1E), RFPI® I-joists, Rim Board, RigidLam® Columns, RigidLam® Studs

LVL: 2.1E 1 3/4" x

9 1/4", 9 1/2", 11 7/8", 14", 16", 18", 20", 24"

RFPI: 40S – 2 1/2" wide flange

9 1/2", 11 7/8", 14"

RFPI: 60S – 2 1/2" wide flange

16"

RFPI: 80S – 3 1/2" wide flange

16"

RFPI: 70 – 2 5/16" wide flange

11 7/8", 14"

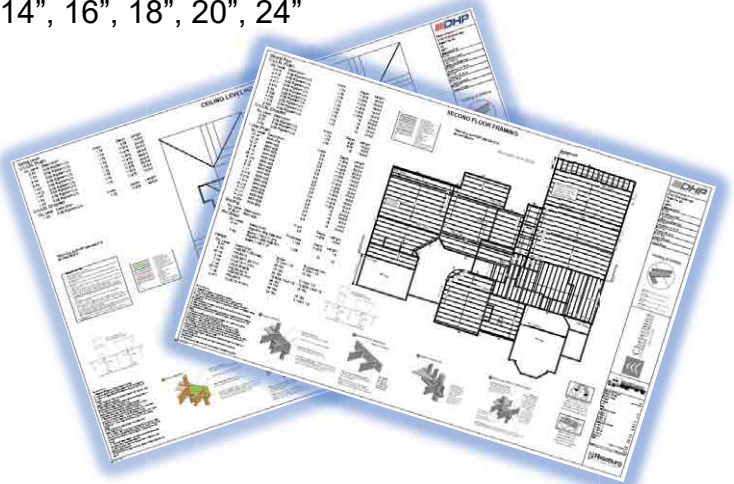

**3 acres of EWP inventory:
\$750,000 on the ground...**

➤ Design / Engineering Services:

- Full design service – beams, joists, DHP-EWP TEAM whole house systems
- 5 business days (or less) for plan turnaround on DHP-EWP TEAM whole house systems. Sealed beam calculations can be returned within 24-48 hours.
- Weather-resistant 11x17 format layouts included for all job packs

➤ DHP-EWP TEAM Support

- Nelson Pilarte / Denzel Makin / Kristen Haase – EWP Design Staff
- John Hyatt / Darrell Prevette / Marty Twiford - DHP Outside Sales
- Bill Main / Tony Cothren / Burt Steagall / Sytari Peterson – DHP Inside Sales
- Mike Toune – General Manager
- Tommy DeLoach – EWP Sales Manager
- Nick Wortel – Roseburg Territory Sales Manager (Southeast)
- Bob Dando – Roseburg Territory Sales Manager (Mid-Atlantic)

➤ Sales/Technical Training and Support

- Design and Sales Training provided as needed/requested – All technical training is presented with an emphasis on EWP sales... AIA/CES classes are available upon request.

DESIGN TEAM

EWP@diamondhillplywood.com
866-846-2715

NELSON PILARTE



EWP DESIGN MANAGER

Nelson has been employed with DHP for 5 years. He holds Bachelor of Engineering (Structural Engineering) from Pontificia Universidad Catolica Madre y Maestra, along with an Associate's Degree in Construction Engineering Technology from Greenville Technical College.

nelson.pilarte@diamondhillplywood.com



KRISTEN HAASE



EWP TECHNICAL DESIGN

Kristen has been with Diamond Hill for 1 year, and has her Associate's Degree in Architectural Engineering Technology from Greenville Technical College.

kristen.haase@diamondhillplywood.com

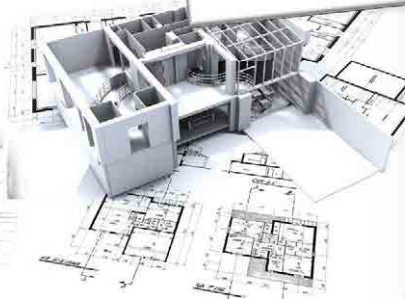

DENZEL MAKIN

EWP TECHNICAL DESIGN

Denzel is a technical design professional with an extensive background (6 years) in CAD and the building process. He has his Associates Degree in Architectural Engineering from Greenville Technical College.

denzel.makin@diamondhillplywood.com

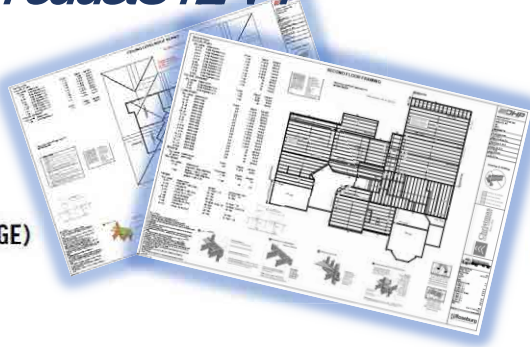

I-JOIST DIMENSIONS (SOLID SAWN FLANGE)

Lengths - Lengths up to 66 feet

Depths - RFPI 40S & 60S

- 9-1/2"
- 11-7/8"
- 14"
- 16"

Solid Sawn Flange Size

- RFPI 40S - 2-1/2" wide x 1-1/2"
- RFPI 60S - 2-1/2" wide x 1-1/2"
- RFPI 80S - 3-1/2" wide x 1-1/2"

Depths - RFPI 80S

- 11-7/8"
- 14"
- 16"

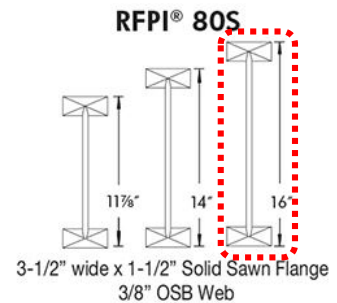
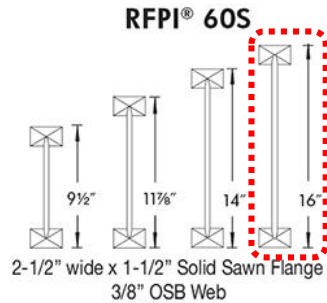
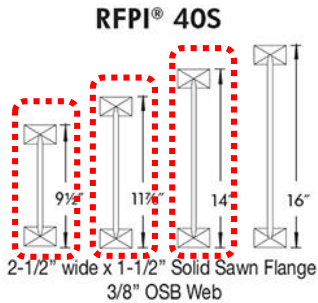

I-JOIST DIMENSIONS

Lengths - Lengths up to 66 feet

Depths

- RFPI 20 - 9-1/2", 11-7/8", 14"
- RFPI 400 - 9-1/2", 11-7/8", 14", 16"
- RFPI 40 - 9-1/2", 11-7/8", 14", 16"
- RFPI 70 - 9-1/2", 11-7/8", 14", 16"
- RFPI 90 - 11-7/8", 14", 16"
- RFPI 700 - 18", 20", 22", 24"
- RFPI 900 - 18", 20", 22", 24"

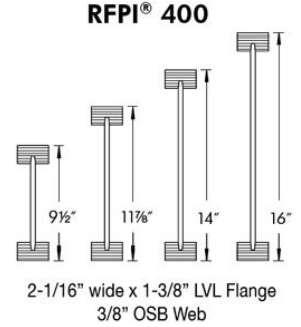
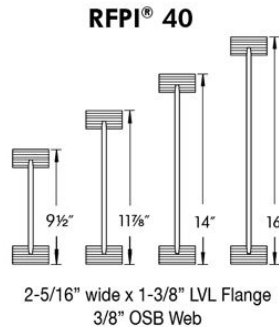
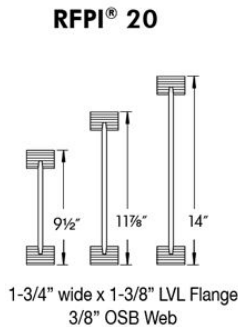

LVL Flange Size

- RFPI 20 - 1-3/4" wide x 1-3/8"
- RFPI 400 - 2-1/16" wide x 1-3/8"
- RFPI 40 - 2-5/16" wide x 1-3/8"
- RFPI 70 - 2-5/16" wide x 1-1/2"
- RFPI 90 - 3-1/2" wide x 1-1/2"
- RFPI 700 - 2-5/16" wide x 1-1/2"
- RFPI 900 - 3-1/2" wide x 1-1/2"

OSB Web Thickness

- RFPI 20 - 3/8"
- RFPI 400 - 3/8"
- RFPI 40 - 3/8"
- RFPI 70 - 3/8"
- RFPI 90 - 7/16"
- RFPI 700 - 7/16"
- RFPI 900 - 7/16"

