

SUBMITTAL SHEET

LASCO HEAVY TURF INLET MAINLINE CONNECTION



JOB NAME	
JOB LOCATION	
ENGINEER	
CONTRACTOR	
TAG	
PO NUMBER	
REPRESENTATIVE	
WHOLESALE DISTRIBUTOR	

Main Line Connection (M Inlet)

Reduces from 1½" ACME Service Fitting to Swing Joint Size

SPECIFICATIONS:

Maximum Working Pressure: 315 psi @ 73 deg F (Swing Joint)
ASTM 1970 - Standard Specification for Special Engineered Fittings, Appurtenances or Valves for use in Poly (Vinyl Chloride) (PVC) or Chlorinated Poly (Vinyl Chloride) (CPVC) Systems.
ASTM D1784 - Rigid Poly (Vinyl Chloride) (PVC) Compounds and Chlorinated Poly Vinyl Chloride (CPVC) Compounds.
ASTM F2768-09 - Standard Specification for Modified Stub ACME Thread Joint with Elastomeric Seal.

SUGGESTED SPECIFICATION:

All Swing joint rotating components are to be connected with ACME threads and O-Ring Seals in accordance with ASTM F2768-09.

MATERIALS:

PVC Type 1 Cell Classification 12454-B
 O-Rings Buna-N (Nitrile)

HOW TO ORDER:

Inlet Part No.	Inlet Size	Swing Joint Size
G001-014	1½"	1"
G001-016	1½"	1¼"
G001-004	1½"	1½"

WARRANTY:

Five Year Limited Performance Warranty
 LASCO® Fittings, Inc., an Aalberts company, extends to installing purchaser/contractors (and, through them, to the owners of irrigation systems) a Limited Five-Year Performance Warranty on all LASCO swing joints. LASCO Swing Joints and their individual component parts will be free from defects in materials, workmanship and assembly techniques that affect the performance of the units in professionally-designed irrigation systems. The Swing Joints will not leak when properly installed. The Swing Joints will not rot, rust, or corrode by electrolytic action.

WHAT IS NOT WARRANTED:

Damages or performance failures, including leakage, resulting from improper handling, storage or installation, from disassembly, modification, accident, vandalism or other events beyond control of the manufacturer; Installation in irrigation systems not in accordance with established professional standards; Consequential and associated damages to irrigation systems and to the properties in which they are installed, including, but not limited to labor and freight costs.

DURATION OF WARRANTY:

This warranty becomes effective on the date of shipment to the installing purchaser/contractor by LASCO or its authorized distributor/dealers; it remains in force for no less than Five (5) years.

SUBMITTAL SHEET

1. Place Snap Ring around Q.C.V. body and thread Q.C.V. onto the brass threaded nipple of the stabilizer elbow.
2. Place the 2 halves of Snap Lok Assembly around Q.C.V. insuring hex pattern in aligned with the base of the Q.C.V. and the horizontal cylinder facing away from the Stabilizer Elbow.
3. Slide Snap Ring down onto SnapLok assembly until it "snaps" into place.
4. Vertically stabilize with rebar placed through the side lugs.
5. Horizontally stabilize by sliding a section of 1" PVC pipe (Approx. 1 ft) through the horizontal cylinder. DO NOT CEMENT PIPE TO HORIZONTAL CYLINDER to allow for future Q.C.V. removal if necessary.

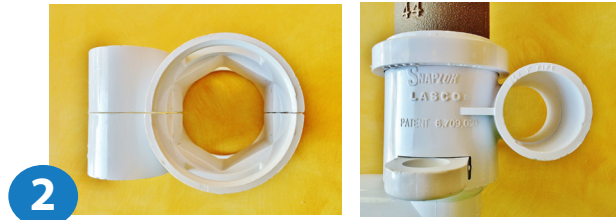

Ordering Guide

G	X	X	X	X	XX
Indicates Swing Joint	DIAMETER	INLET	OUTLET	STYLE	LENGTH
G	1 = 1" 3 = 1½"	1 = Socket 2 = Spigot (Short) 3 = Male Thread (MIPT) 4 = Male ACME 5 = Metric Spigot 6 = Male BSPT 7 = Long Spigot (4" Long) 8 = Female BSPT 9 = Reducing Female BSPT H = Spigot Saddle Connection (Increases from 1" Spigot to Swing Joint size) M = Main Line (Reduces from 1½" ACME to Swing Joint size) P = Tap'tm Saddle Connection (Reduces from 1½" ACME to Swing Joint size)	S = Available in 1" and 1½" T = Available in ¾" diameter	2 = Unitized Standard 3 = Fabricated Length	08 = 8" (Std) 12 = 12" (Std) 18 = 18" (Std) 10 = 10" (Fab) 24 = 24" (Fab) 30 = 30" (Fab)