

FORM CA17

Notice of landowner deposits under Section 31(6) of the Highways Act 1980 and section 15A (1) of the Commons Act 2006

BUCKINGHAMSHIRE COUNTY COUNCIL

An application to (deposit a map and statement) under Section 31(6) of the Highways Act 1980 and section 15A (1) of the Commons Act 2006 has been made in relation to the land (or lands) described below and shown red and green on the accompanying map.

PLEASE NOTE:

This deposit may affect rights over the land described below. Deposits made under section 31(6) of the Highways Act 1980 may prevent deemed dedication of public rights of way over such land under section 31(1) of that Act. Deposits under section 15A (1) of the Commons Act 2006 may affect the ability to register such land as a town or village green under section 15 of that Act. Please see guidance at <http://www.defra.gov.uk/rural/protected/greens/> for further information.

Description of the land(s):

Name of the Parish, Ward or District in which the lands are situated:

LAND TO EITHER SIDE OF MILL LANE AND LAND TO SOUTH OF ANSTEY BROOK, WESTON TURVILLE

Aylesbury Vale District Council

Weston Turville Parish Council

The deposit was submitted by Sir Richard and Lady Valerie Lapthorne, and was received by this authority on 16/01/2020.

The authority maintains a register of maps, statements and declarations deposited under section 31A of the Highways Act 1980 and section 15B of the Commons Act 2006.

This register can be accessed online at <https://www.buckscc.gov.uk/services/environment/public-rights-of-way/changes-to-public-rights-of-way/landowner-deposits/> or can be inspected free of charge at the address below:

Bucks County Council, Definitive Map and Local Land Charges, 7th Floor, County Hall, Walton Street, Aylesbury, Bucks HP20 1 UY. Please email row@buckscc.gov.uk to make an appointment.

Signed on behalf of Buckinghamshire County Council:

Mrs Ela Hackling, Definitive Map Officer

Date: 28/01/2020

431

Received

16/01/2020

FORM CA16

PART A: Information relating to the applicant and land to which the application relates

(all applicants must complete this Part)

1. Name of appropriate authority to which the application is addressed:

Buckinghamshire County Council

2. Applicants name and full address (including postcode)

SIR RICHARD & LADY VALERIE LAPHORNE
MILL BARN
MILL LANE
WESTON TURVILLE
BUCKS
HP 22 5RG

3. Status of applicant (tick relevant box or boxes):

LAND WE ARE

- (a) [checked] the owner of the land(s) described in paragraph 4
(b) [] making this application and the statements/declarations it contains on behalf of [insert name of owner] who is the owner of the land(s) described in paragraph 4 and in my capacity as [insert details]

4. Insert description of the land(s) to which the application relates (including full address and postcode):

LAND TO EITHER SIDE OF MILL LANE EDGED IN RED ON THE ATTACHED MAP.
LAND TO SOUTH OF ANSTEY BROOK, WESTON TURVILLE EDGED IN GREEN ON THE ATTACHED MAP.

5. Ordnance Survey six-figure grid reference(s) of a point within the area of land(s) to which the application relates (if known):

- NOT KNOWN
- BM 303710 (SP 86115W)

6. This deposit comprises the following statement(s) and/or declarations (delete Parts B, C or D where not applicable):

<table border="1"><tr><td>FORM CA16</td></tr></table>	FORM CA16
FORM CA16	

PART B: Statement under section 31(6) of the Highways Act 1980

We are **SIR RICHARD LAPT HORNE**
~~I am~~ *LADY VALERIE LAPT HORNE* **is** the owner of the land described in paragraph 4 of Part A of this form and shown *IN RED & IN GREEN* [insert colouring.....] on the map accompanying this statement. (delete wording in square brackets as appropriate and/or insert information as required).

~~[Ways shown [insert colouring.....] on the accompanying map are Byways Open to All Traffic.]~~

~~[Ways shown [insert colouring.....] on the accompanying map are Restricted Byways.]~~

~~[Ways shown [insert colouring.....] on the accompanying map are Public Bridleways.]~~

[Ways shown [insert colouring *BLUE*.....] on the accompanying map are Public Footpaths.]

INSIDE RED OR GREEN

No [other] ways over the land shown [insert colouring.....] on the accompanying map have been dedicated as highways.

(delete wording in square brackets as appropriate and/or insert information as required)

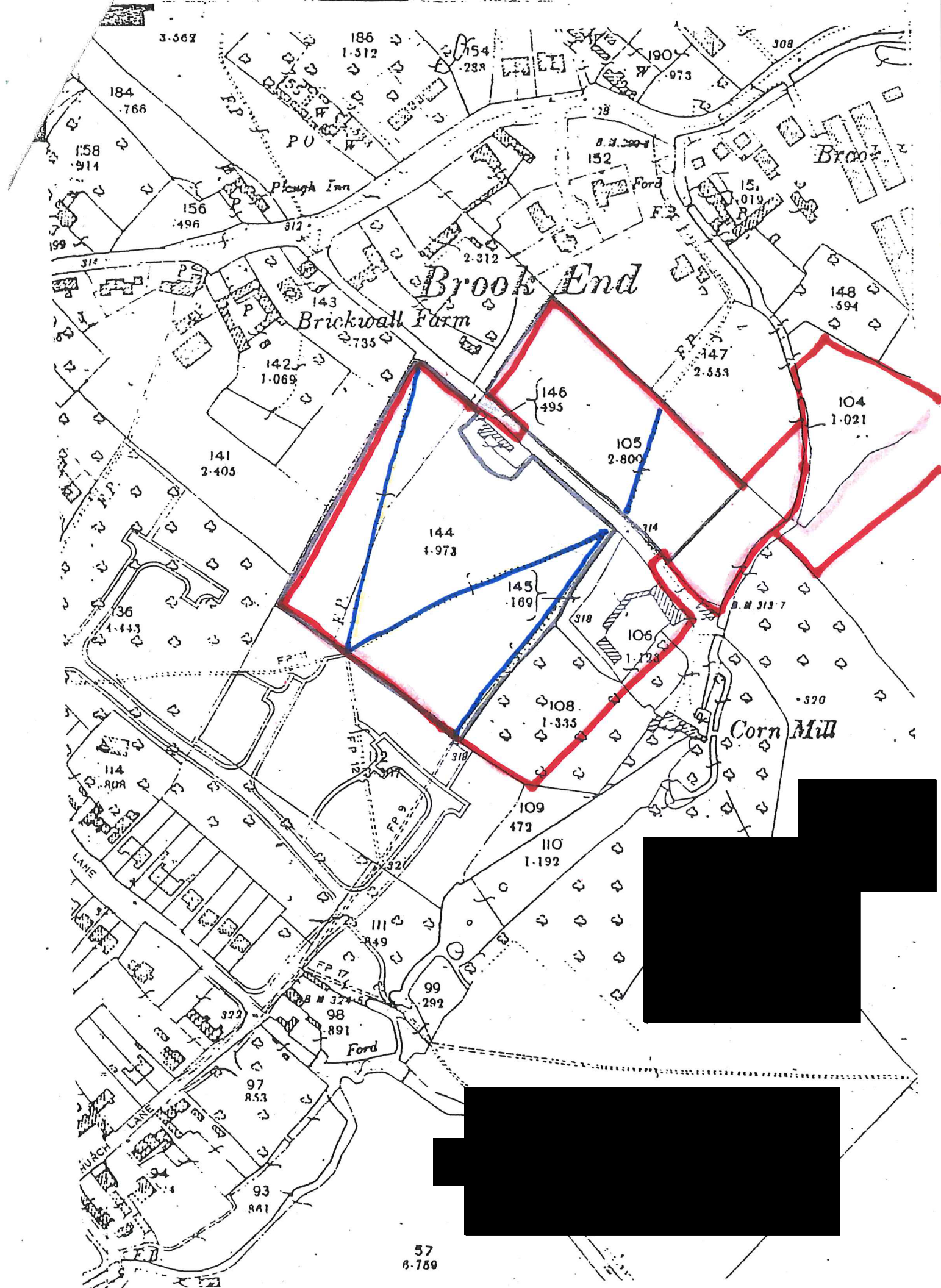

Land Registry
Official copy of
title plan

Title number BM303710
Ordnance Survey map reference SP8611SW
Scale 1:1250
Administrative area BUCKINGHAMSHIRE:
AYLESBURY VALE



©Crown Copyright. Produced by Land Registry. Reproduction in whole or in part is prohibited without the prior written permission of Ordnance Survey. Licence Number 100026316.

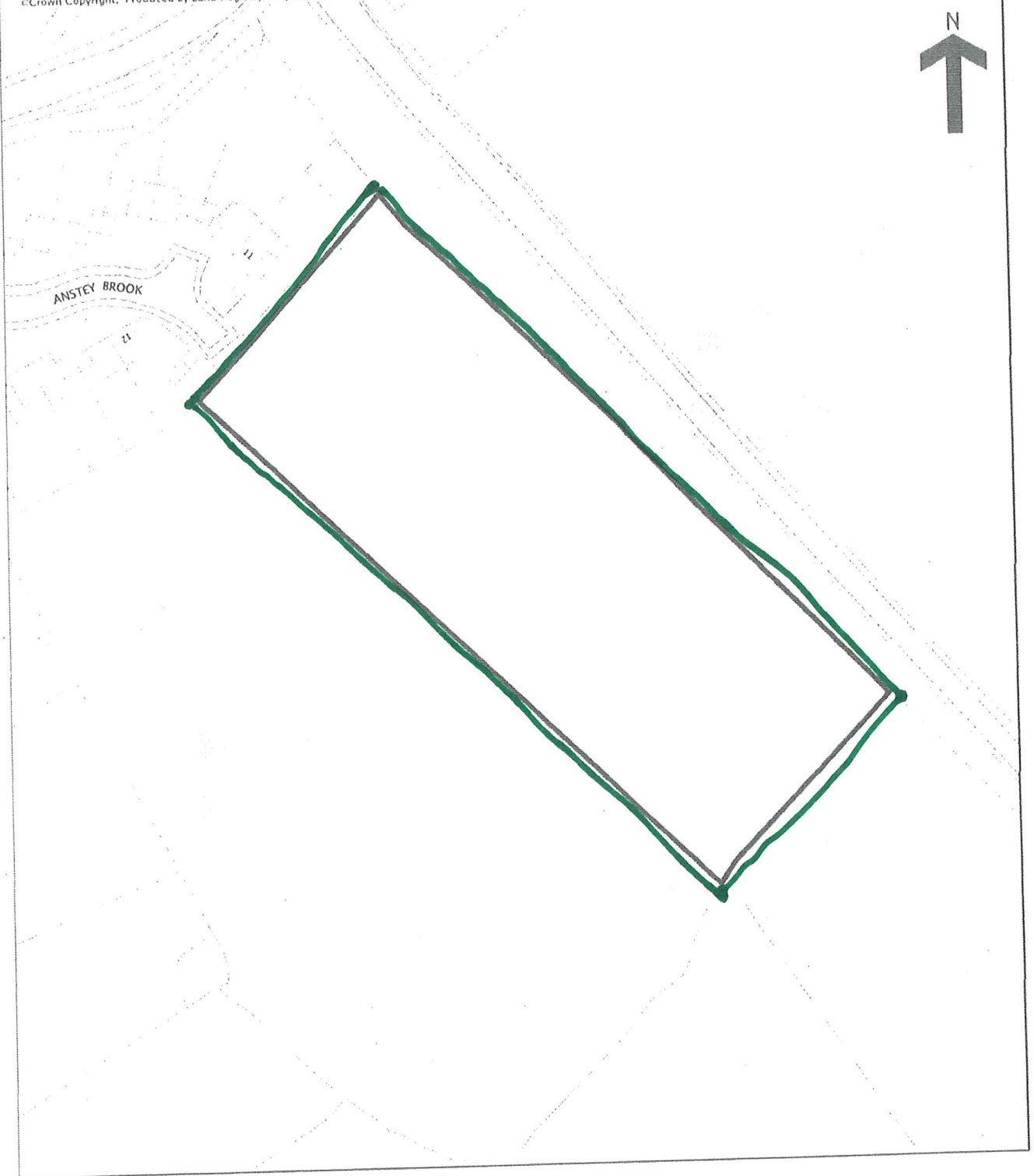

This official copy is incomplete without the preceding notes page.

FORM CA16

PART F: Statement of Truth

(all applicants must complete this Part)

WARNING: If you dishonestly enter information or make a statement that you know is, or might be, untrue or misleading, and intend by doing so to make a gain for yourself or another person, or to cause loss or the risk of loss to another person, you may commit the offence of fraud under section 1 of the Fraud Act 2006, the maximum penalty for which is 10 years' imprisonment or an unlimited fine, or both.

I BELIEVE THAT THE FACTS AND MATTERS CONTAINED IN THIS FORM ARE TRUE

Signature (of the person making the statement of truth):

[Redacted Signature]

Print Full Name:

SIR RICHARD DOUGLAS LAPT HORNE

Date:

14 / 1 / 2020

You should keep a copy of the completed form

Data Protection Act 1998 – Fair Processing Notice

The purpose of this Fair Processing Notice is to inform you of the use that will be made of your personal data, as required by the Data Protection Act 1998.

The appropriate authority (see explanation of definition in above guidance notes) in England is the data controller in respect of any personal data that you provide when you complete this form.

The information that you provide will be used by the appropriate authority in its duties to process applications to deposit statements, maps and declarations under section 31(6) the Highways Act 1980 and statements under section 15A(1) of the Commons Act 2006. The information you provide will also be used by the appropriate authority in its duty to update the registers in which details of such deposits are recorded under the Dedicated Highways (Registers under Section 31A of the Highways Act 1980) (England) Regulations 2007 and the Commons (Registration of Town or Village Greens) and Dedicated Highways (Landowner Statements and Declarations) (England) Regulations 2013.

FORM CA16

PART F: Statement of Truth

(all applicants must complete this Part)

WARNING: If you dishonestly enter information or make a statement that you know is, or might be, untrue or misleading, and intend by doing so to make a gain for yourself or another person, or to cause loss or the risk of loss to another person, you may commit the offence of fraud under section 1 of the Fraud Act 2006, the maximum penalty for which is 10 years' imprisonment or an unlimited fine, or both.

I BELIEVE THAT THE FACTS AND MATTERS CONTAINED IN THIS FORM ARE TRUE

Signature (of the person making the statement of truth):

[Redacted Signature]

Print Full Name:

LADY VALERIE LAPTHORNE

Date:

14 / 1 / 2020

You should keep a copy of the completed form

Data Protection Act 1998 – Fair Processing Notice

The purpose of this Fair Processing Notice is to inform you of the use that will be made of your personal data, as required by the Data Protection Act 1998.

The appropriate authority (see explanation of definition in above guidance notes) in England is the data controller in respect of any personal data that you provide when you complete this form.

The information that you provide will be used by the appropriate authority in its duties to process applications to deposit statements, maps and declarations under section 31(6) the Highways Act 1980 and statements under section 15A(1) of the Commons Act 2006. The information you provide will also be used by the appropriate authority in its duty to update the registers in which details of such deposits are recorded under the Dedicated Highways (Registers under Section 31A of the Highways Act 1980) (England) Regulations 2007 and the Commons (Registration of Town or Village Greens) and Dedicated Highways (Landowner Statements and Declarations) (England) Regulations 2013.