



# KX-MB2275 CATALOG

## High-Durability and High-Performance

### 500-Sheet Paper Cassette in Compact Size



Usually compact MFPs designed to be used in small offices or home offices (SOHO) are equipped with a 250-sheet paper cassette, while commercial printing paper is normally supplied in 500-sheet packs. Despite the compact design and slim profile, with a height of just 400 mm, the DP-MB310, DP-MB250, KX-MB2500 Series and KX-MB2200 Series are equipped with large-capacity cassettes capable of holding a full pack of 500 sheets. This means that you can load all 500 sheets at one time and not have to leave open reams of paper lying around your office.

## Multi-Size Paper Handling Capability



In addition to standard A4 pages, the DP-MB310, DP-MB250, KX-MB2500 Series and KX-MB2200 Series can also handle smaller documents including A5 and A6. For added convenience, the multi-purpose tray\* can hold up to 50 sheets of various sizes from A4/letter, legal and A5/A6 formats to envelopes and custom size formats for printing and copying.

\* Available on the DP-MB310, DP-MB250, KX-MB2575, KX-MB2545, KX-MB2540, KX-MB2515 and KX-MB2510. The KX-MB2275, KX-MB2270, KX-MB2235 and KX-MB2230 are equipped with the manual tray (1 sheet) for multi-size paper handling.

## A5/A6-Size Compatible Automatic Document Feeder



All DP-MB310, DP-MB250, KX-MB2500 Series and KX-MB2200 Series are equipped with a 50-sheet automatic document feeder capable of handling the smaller A5 and A6 formats as well as A4. This capability should prove especially useful in doctors' offices and pharmacies where smaller documents are commonly used. All the models can print onto the smaller A5 and A6 sizes.

- Flatbed: A4/A5/A6/Letter/B5(ISO/JIS)/B6(ISO/JIS)/16K
- ADF: A4/A5/A6/Letter/Legal/B5(ISO/JIS)/B6(ISO/JIS)/16K/216 x 330 mm/216 x 340 mm

## Automatic Double-Sided Scanning



The DP-MB310, DP-MB250 and KX-MB2500 Series are also equipped with an automatic reversing scan function that can automatically scan both sides of the document. This is done using a Reversing Automatic Document Feeder (RADF). Besides improving efficiency, this is especially convenient as double-sided printing is becoming more common.

## Saving Office Space with One Compact Design All-in-One Printer

### Layout-Free Compact Design

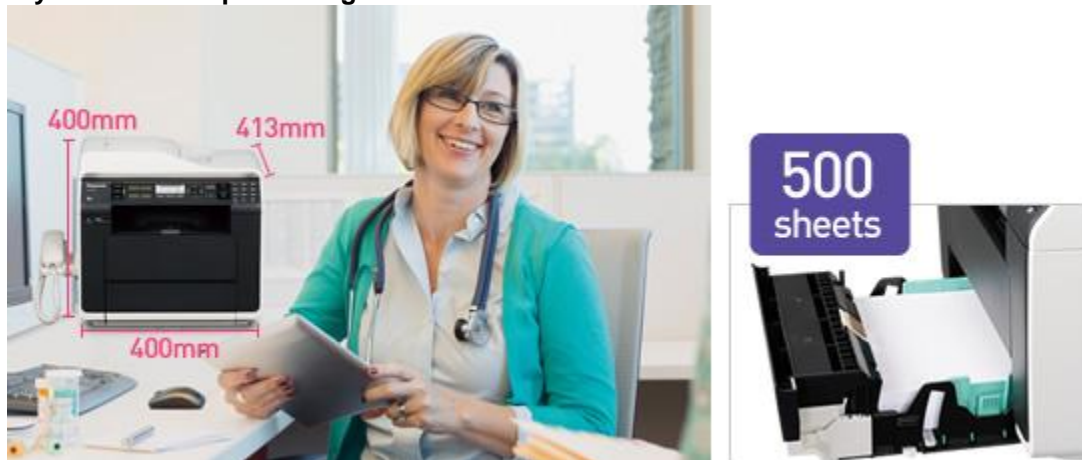

This cubic, compact body with a height of 400 mm, a depth of 413 mm, and a width of 400 mm, comes standard with a 500-page paper cassette. Now you can install a high-power and compact designed multi-function printer even on a small desk.

### Maximize Office Work Efficiency with a Single All-in-One Printer



The DP-MB310, DP-MB250, KX-MB2500 Series and KX-MB2200 Series handle printing, copying, scanning, and faxing\* all by itself, so you only have to learn how to use a single machine. Installing the DP-MB310, DP-MB250, KX-MB2500 Series and KX-MB2200 Series in an office that used to have several different machines to do these separate tasks will make everyone's work go more smoothly.

\* Not available on the KX-MB2515 and KX-MB2510.

## Easy Operation and Maintenance

### Easy-to-operate control panel



All the operation buttons are concentrated on the front control panel in a simplified layout. A slanted panel design allows the user to easily operate the printer whether standing up or sitting down.

### Easy to access to maintain machine



Basic operation such as replacing consumables and paper can be done from the front side easily.

## Printing and Copying to Match the Application

### Duplex Printing / Copying



Because documents can be output with only half the amount of paper, this feature is highly economical, and it also saves office space

### Booklet Printing / Copying

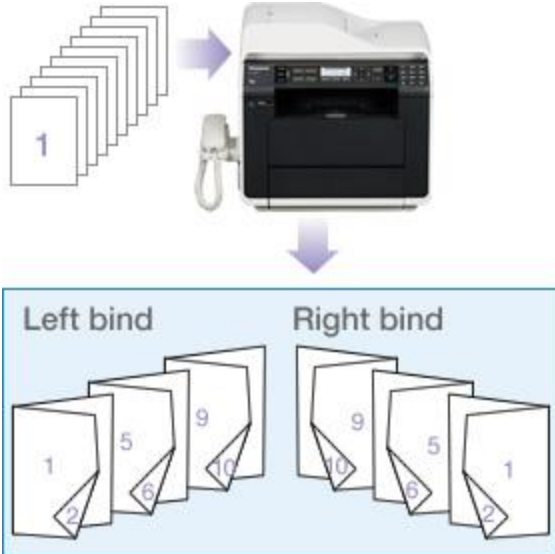

Booklets are easily created from data produced by an application and documents that you have on hand.

### **N-in-1 Printing / Copying**



Multiple sets of data can be printed onto a single page by dividing the page into 2, 4, 6, 8, 9 or 16 parts (2, 4 or 8 parts when copying). This is convenient for providing an overall view of the data, when it's not necessary to see the details of each part.

By combining this with duplex printing, the number of recording pages is also reduced, and the printing time is shortened by reducing the number of printed sheets.

### **Poster Printing / Copying**



When printing large images, you can use the Poster Printing function to divide and output the image into A4 or Letter size parts. This makes it easy to create posters by simply assembling the images after printing.

### Quick ID Copy



This function is handy for printing the information from a card, such as a two-sided ID card, onto a single sheet of paper. It will copy both sides of up to four cards onto a single sheet. Use it, for example, as evidence of ID registration.

### Image Repeat

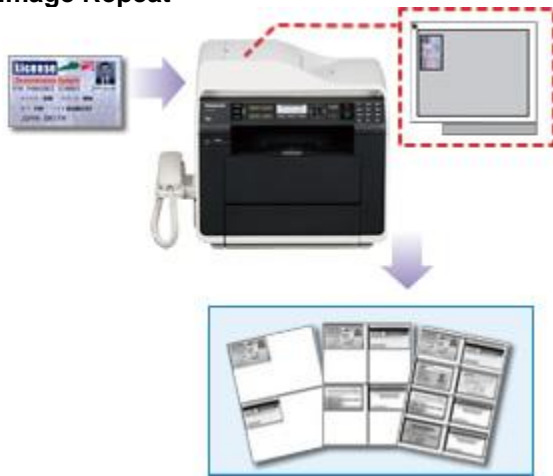

Image Repeat copies up to eight tickets or cards onto a single sheet of paper. This is an easy way to copy and distribute tickets.

### Proof Set Copy



Prior to a large copy run, you can output a small amount for use in checking. If no problems are found, you can immediately start the actual copying process. This helps to save paper costs when there are copying mistakes.

### Easy Print Utility\*1

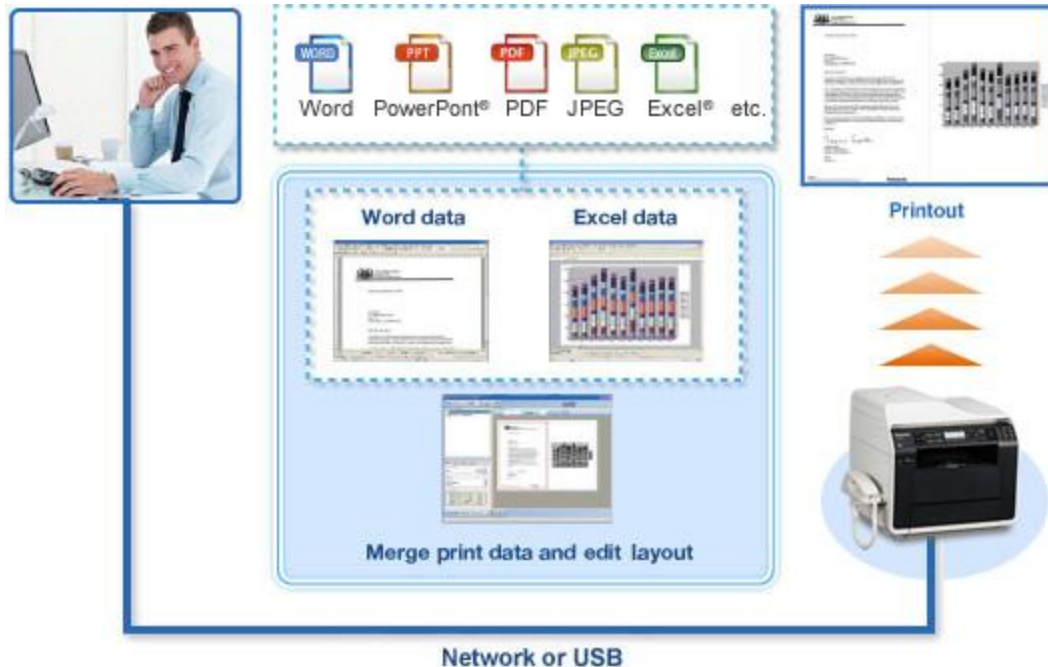

The Easy Print Utility is a multi-document print application which lets you merge multiple file types, such as Microsoft® Word and Excel® files into a single print job or PDF file. The Easy Print Utility provides a real time preview of the print output and offers the ability to modify the print layout and page order. You also have the ability to add a custom document header, footer or watermark to your document before printing.

\*1 Supported only on Windows®.

• Microsoft, Windows, Excel and PowerPoint are either registered trademarks or trademarks of Microsoft Corporation in the United States and/or other countries.

## Multifunctional Scanning Efficiency

### Scan to PC



You can send scanned data to a Personal Computer that is connected to the network or USB cable, and choose from a wide range of formats — PDF, TIFF, JPEG, or BMP — to match your application. Furthermore, it is possible also by a USB memory.

### Network Color Scanning



All models are able to scan documents in full color. Documents scanned from the main unit can automatically be sent to a Personal Computer, e-mail address, FTP server, or a shared network folder and can be saved in either the TIFF, JPEG or PDF file formats.

## Low Power Consumption Further Boosts Efficiency

### Low power consumption

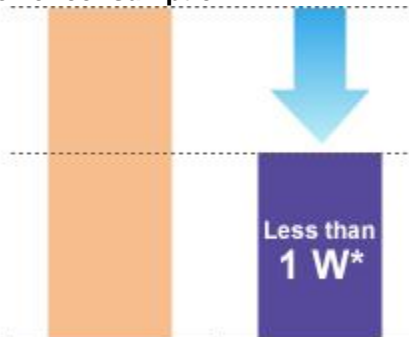

If the printer is not used for 5 minutes, it will enter Sleep mode and the power consumption will drop to less than 1 watt\*.

\* When only USB interface is connected and LAN is OFF mode. Power consumption in sleep mode depends on machine condition.

### ECO mode



A dedicated ECO button is located on the control panel. When selected, the ECO button enables two energy-saving functions. First, the duration before the printer enters Power Save mode is set to 1 minute. At the same time the 2-in-1 and Duplex Copy modes are automatically set while the backlight\* is set to OFF, effectively reducing both paper and power consumption.

\* A backlight is not available on the KX-MB2200 Series.



## Networks Make Work More Efficient

### Web Fax Preview Function\*

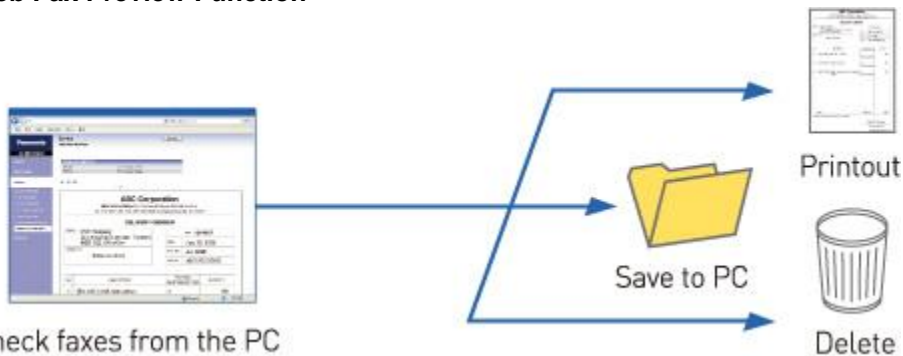

#### Check faxes from the PC

You can read the faxes you receive on a PC web browser first, and then decide to print them, save them to the PC, or delete them. This minimizes wasteful printouts.

\* Available on the DP-MB310, DP-MB250, KX-MB2575, KX-MB2545, KX-MB2540 and KX-MB2200 Series.

### Network Sharing



Up to 30 PCs can be connected to a single unit on a network. This lets a single all-in-one printer meet the needs of everyone in the office.

### Network Security

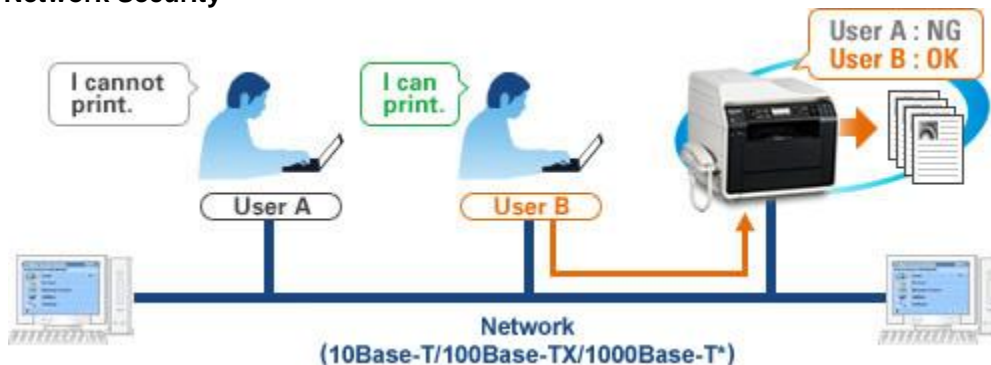

You can restrict access users with the IP address filter. This provides powerful support for today's businesses, which place strong emphasis on information security.

### Easy Network Setting

Web browser  
(LAN connection only)



You can check the status and change the settings of the unit right on your PC screen without having to walk all the way to the machine. Because you don't have to leave your PC, it saves time and lets you work more efficiently.

#### Standard 10Base-T/100Base-TX Ethernet and Wi-Fi®\*



All models come standard with 10base-T/100base-TX Ethernet network port. This means you can control the printer from any PC on the local area network. The KX-MB2575, KX-MB2275 and KX-MB2270 are also equipped with a built-in Wi-Fi® wireless network function. The WPS key\* on the control panel lets you easily easily configure a wireless network when a Wi-Fi® router is installed.

\* Available on the KX-MB2575, KX-MB2275 and KX-MB2270.

• Wi-Fi is registered trademark of the Wi-Fi Alliance.

## Specifications

<b>Specifications</b>	
<b>Model</b>	KX-MB2275CX
<b>Printing Process</b>	Laser
<b>LCD Screen</b>	16 digits / 2 lines
<b>Print</b>	<p>Print Speed: Up to 28 ppm (A4)</p> <p>Duplex Printing: Yes (A4, LTR, LGL, 216 x 330 mm, 216 x 340 mm)</p> <p>Duplex Productivity (A4): 100% (28 ppm)</p> <p>Print Resolution: Up to 2400 x 600 dpi (Interpolated)</p> <p>First Print Time: 8.5 s (from standby)</p> <p>Printer Language: PCL: Yes (KX-MB2275 only) GDI: Yes</p> <p>Supported OS: Windows® XP, Windows Vista®, Windows® 7, Windows® 8 Windows Server® 2008, Windows Server® 2012, Mac OS X 10.5 - 10.8, Linux® *4</p> <p>*4 Supported Linux distribution: Red Hat® Enterprise Linux® Desktop 5/6, Ubuntu® 10/11/12/13. Driver is provided via web download.</p> <ul style="list-style-type: none"><li>• Windows, Windows Vista and Windows Server are registered trademarks of Microsoft Corporation in the United States and/or other countries.</li><li>• Mac and OS X are trademarks of Apple Inc., registered in the U.S. and other countries.</li><li>• Linux is the registered trademark of Linus Torvalds in the U.S. and other countries.</li><li>• Red Hat and Red Hat Enterprise Linux are registered trademarks or trademarks of Red Hat, Inc. in the United States and/or other countries.</li><li>• Ubuntu is a registered trademark or a trademark of Canonical Ltd. in the U.S. and other countries.</li></ul>
<b>Copy</b>	Copy Speed *5: Up to 28 cpm (A4)

Copy Resolution: Up to 600 x 600 dpi

Multi-Copy: 99 pages

First Copy Time: 9.8 s (ADF)

Reduction / Enlargement: 25 % - 400 % (1 % step)

Copy Function: Quick ID, N-in-1, Separate N-in-1, Poster, Image Repeat, Edge/Margin, Booklet

\*5 Continuous copy of a single original.

**Scan**

Colour / Mono Scan: Yes / Yes

Scan Resolution: Up to 600 x 1200 dpi (Optical) / Up to 19200 x 19200 dpi (Interpolated)

Scan to PC: Yes

Scan to OCR: Requires OCR Software

Scan to Email Address: Yes

Scan to FTP: Yes

Scan to SMB: Yes

Scan to USB: No

Supported OS:

Windows® XP, Windows Vista®, Windows® 7, Windows® 8, Mac OS X 10.5 - 10.8, Linux® \*4

\*4 Supported Linux distribution: Red Hat® Enterprise Linux® Desktop 5/6, Ubuntu® 10/11/12/13. Driver is provided via web download.

**Fax**

Modem Speed: 33.6 kbps - 2.4 kbps with automatic fallback

Memory Size \*6: 3.1 MB

Reception: Approx. 80 pages

Transmission: Approx. 150 pages

Address book: 100

Fax / Tel Switch: Yes

	<p>Fax to Email: Yes</p> <p>Web Fax Preview: Yes</p> <p>*6 Based on the ITU-T No. 1 Test Chart in standard resolution.</p>
<b>Paper size (Simplex)</b>	<p>Cassette: A4, A5, LTR, LGL, 216 x 330 mm, 216 x 340 mm, B5(JIS/ISO), 16K</p> <p>Multi-purpose tray/Manual tray: A4, A5, A6, LTR, LGL, B6(JIS/ISO), B5(JIS/ISO), 216 x 330 mm, 216 x 340 mm, 16K, Envelope #10/DL/YOUKEI #4/CHOUKEI #3/CHOUKEI #4, Japanese Post Card, Custom (W: 90-216 mm, L: 200-356 mm)</p>
<b>Paper Capacity*1</b>	<p>Max: 501 sheets (Cassette: 500 sheets / Manual tray: 1 sheet)</p> <p>*1 Depending on the type of paper.</p>
<b>Monthly Duty</b>	<p>Average: 1500 pages</p> <p>Maximum: 1500 pages</p>
<b>ADF</b>	<p>Capacity: 50 sheets</p> <p>Document size: Single-sided: A4, A5, A6, LTR, LGL, B6(JIS/ISO), B5(JIS/ISO), 216 x 330 mm, 216 x 340 mm, 16K, Long Paper (W: 210-216 mm, L: 356-600 mm)</p>
<b>Memory Size</b>	64 MB
<b>USB Slot (Host)</b>	Yes
<b>Computer Interface</b>	<p>100Base-TX / 10Base-T: Yes</p> <p>IEEE802.11b/g/n: Yes</p> <p>USB: Yes</p>
<b>Power Consumption</b>	<p>Maximum: Approx. 1000 W, Copy: Approx. 500 W, Ready: Approx. 55 W, Sleep: Less than 1 W *2</p> <p>*2 When only USB interface is connected and LAN is OFF mode. Power consumption in sleep mode depends on machine condition.</p>
<b>Noise Level</b>	<p>Standby: Less than 26 dBA *3</p> <p>Copying: Less than 56 dBA *3</p> <p>*3 Sound Pressure Level based on ISO7779 bystander position. It depends on the measuring method.</p>

**Consumables**



Toner Cartridge



KX-FAT431  
(6,000 pages\*1)



KX-FAT430  
(3,000 pages\*1)



KX-FAT421  
(2,000 pages\*1)

Drum Cartridge



KX-FAD422  
(18,000 pages)

**Dimension** 400 x 413 x 400 mm

**Weight** Approx. 15kg

**\* Features, Package Content and Specifications are subject to change without prior notification.\***