

DICKINSON, ND

COMMUNITY PROFILE



STARK
DEVELOPMENT CORPORATION

WHERE BUSINESS GOES TO GROW

WELCOME TO DICKINSON, NORTH DAKOTA

Dickinson, North Dakota, with a population of around 25,000, is a mid-size community with a small-town feel located in Stark County in southwest North Dakota. Dickinson is the regional hub for more than 200,000 people and is home to Dickinson State University. Located approximately 100 miles west of the capital city of Bismarck, Dickinson is the midpoint between Fargo, North Dakota and Billings, Montana. Dickinson is approximately 30 miles from Theodore Roosevelt National Park in the Badlands and future home of the Theodore Roosevelt Presidential Library. 250 miles to the south is Mount Rushmore National Monument. The City's strong economy focuses on diverse resources of agriculture, energy (coal, ethanol, natural gas, and oil), manufacturing and tourism.

Dickinson is a destination community for entertainment and cultural events including: Roughrider Days, the Ukrainian Ethnic Festival, Dickinson State University Campus Activities, Summer Concert Series, Rodeos, Museum, Specialty Vehicle Shows, and Car Races, to name just a few. For those who love the outdoors, one can enjoy world class bird and big-game hunting, fishing, camping, winter and summer sporting activities, hiking, biking and equestrian trails.

However, the truest pleasure is living here! So now you know what makes Dickinson so special: the people, incredible relationship between a healthy, thriving economy, and its amazing quality of place and life. We invite you to join us in making Dickinson a world class city!





CITY OF
Dickinson
North Dakota

WHERE CAREER & FAMILY MEET

The area's economy is booming throughout many industries. From the flourishing energy development sector to leading edge technology companies, the opportunities are as varied as our geography.

You'll find careers in manufacturing, professional services, healthcare, education, government and trades for all levels. Discover current job openings and career opportunities available in the area at Job Service ND.

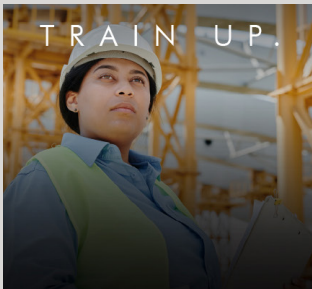

QUALITY OF LIFE

The jewel in the city that draws the community together is the West River Community Center. This amazing full-service center of 135,000 square feet is filled with venues to enjoy: indoor & outdoor aquatic areas, 4 full size gymnasiums, multi-athletic court, 3 racquetball/wallyball courts, 2 indoor tennis courts, golf simulator w/driving cage, climbing wall, community room, playground and a track. Nearby is the West River Ice Center which is used for indoor ice activities and to host special events such as trade shows, sports shows, circuses and more.

Dickinson State University, in partnership with Dickinson Public Schools and Dickinson Parks & Recreation, constructed an athletic complex located on the campus of DSU. The complex features four softball fields and showcases a championship quality, all-turf softball stadium and also includes a full grass soccer field with bleachers and scoreboard and several practice soccer fields.

The Badlands Big Sticks, in the Expedition League, is a summer collegiate wood bat baseball league that provides affordable, wholesome family entertainment and provides the tools and experience needed to optimize the collegiate players' development and potential to play professional baseball. The team plays 32 games from May through August at the Dakota Community Bank & Trust Ballpark, which serves as a great venue for group outings and other special events.



The Crooked Crane Trail outlines a portion of Patterson Lake with over 10 miles of trail with various trailheads for different access points. The Heart River flows through the community offering opportunities to kayak, canoe and take the family fishing.

The Dickinson Museum Center is a popular place to visit. The Dickinson Museum Center consists of the Badlands Dinosaur Museum, where you will find a complete Triceratops skull, discovered just west of Dickinson, the Joachim Regional Museum, Prairie Outpost Park, and Pioneer Machinery Hall.

Heart River Golf Course, an 18-hole, par 72 layout is nestled along the scenic Heart River with views of Patterson Lake. Patterson Lake Recreational Area is used for boating, fishing, swimming, water skiing, camping, picnic areas, playgrounds, disc golf, horseshoe pits, mountain biking, nature areas and sand volleyball courts.

Located just south of Dickinson, the Stark County Fairgrounds & Events Park is a premier facility for rodeos, concerts and more. The Southwest Speedway offers races from May through September.



DOWNTOWN DICKINSON

“In economic development, tourism, and community development, there is positively nothing that’s more important than your downtown”. – Roger Brooks, Destination Development Association

Downtown Dickinson has embraced this philosophy and is growing into a vibrant hub in our community. You will find unique shopping and dining experiences as well as opportunities to attend weekly events like the free downtown concert series. You can listen to fantastic live music while enjoying your favorite foods from local food trucks. The winter months bring fun shopping events, a tree lighting ceremony, a holiday parade, and celebrations that the whole family will enjoy.

In the spring of 2023 you will be able to join us downtown at the new Dickinson Legacy Square! This venue will host a variety of programming such as live concerts, children’s activities, vendor shows, weddings, parties and much more. This square will be home to a children’s play area with a splash pad and an outdoor movie screen. It also holds the potential for hosting winter sports and recreation during our colder months. Whether you’re a business owner, a resident, or a traveler, Downtown Dickinson is where you want to be!



HEALTHCARE



CHI St. Alexis Health Dickinson Medical Center is the regional medical center for Southwest North Dakota. They offer a Critical Access Hospital with a Level IV Trauma Center and a medical clinic offering several services under one roof.



Sanford Health Dickinson Clinic is a comprehensive clinic, offering care in a variety of different specialties including Family Practice, Internal Medicine, Outpatient Surgery, OB/GYN and Pediatrics. The walk-in clinic is open every day of the year including nights, weekends and holidays.

EDUCATION



Dickinson Public Schools features six elementary schools, a middle school, high school, alternative school and a K-5 online learning academy with almost 4,000 students. Dickinson Public Schools is focused on developing personalized learning for all students and developing the classroom to meet the demands of 21st century learning. The district is readying students for postsecondary education as well as equipping students with tangible skills to bring directly to industry.



Dickinson also offers two private schools: Trinity Catholic Schools and Hope Christian Academy offering preschool through high school with an enrollment of over 700 students.

Dickinson is home to the Southwest Area Career and Technical Education (CTE) Academy campus. This is a partnership of seven area high schools, Dickinson State University and numerous local, regional and national employers. The Southwest Area CTE Academy is committed to being a leader in offering innovative technical training to prepare tomorrow's workforce. Students have opportunities for career exploration, technical training, certification and degree attainment for in-demand careers. Programming is scheduled to launch in August 2023 and will continue to expand in the coming years. The forty-acre campus on the north side of Dickinson houses three buildings and multiple outdoor labs giving students unique opportunities not found in the region. Planned programming includes Agricultural Education, Automotive Technology, Business, CDL, Construction Tech, Culinary Arts, Diesel Technology, Drafting, Health Sciences, Heavy Equipment Operators, It/Cybersecurity, PowerSports, Technology & Engineering and Welding.

- 40 acre campus
- Three buildings and outdoor learning labs are under renovation in 2023
- 84,000 sq feet of training space
- Offering over ten programs in high skill, high wage and high demand careers

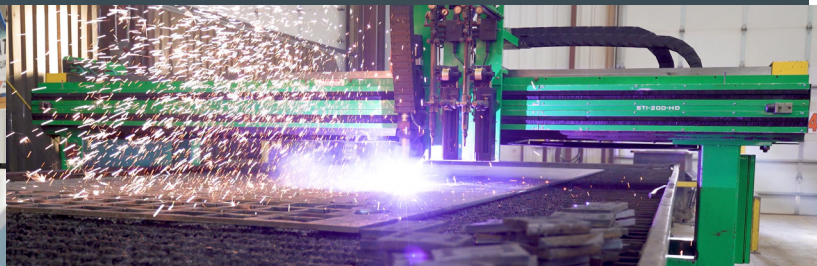

Dickinson State University (DSU) is a regional comprehensive institution within the North Dakota University System, whose primary role is to contribute to intellectual, social, economic, and cultural development, especially to Southwestern North Dakota. DSU offers more than 70 academic programs, giving students face-to-face and online learning options. Because DSU is a dual mission institution, they work directly with industries to create relevant and innovate programs. DSU offers community education, certificate programs, and associate degrees in addition to bachelor's and master's degrees.



Welcome to Dickinson, North Dakota

Hotels/Motels/Campgrounds

- | | | |
|----------------------------------|-----------------------|---------------------|
| 1. 1026 Oasis Inn | 1026 W. Villard | 225-6703 |
| 2. AmericInn & Suites | 229 15th St. W. | 225-1400 |
| 3. Astoria Hotel & Event Center | 363 15th St. W. | 456-5000 |
| 4. Badlands Inn & Suites | 71 W. Museum Dr. | 225-9510 |
| 5. Best Budget Inn | 642 12th St. W. | 690-4087 |
| 6. Candlewood Suites | 1430 Sims St. | 761-2050 |
| 7. Comfort Inn | 493 Elks Dr. | 264-7300 |
| 8. Dickinson Inn | 637 12th St. W. | 483-0637 |
| 9. Hampton Inn & Suites | 110 14th St. W. | 456-0100 |
| 10. Hawthorn Suites | 1170 Roughrider Blvd. | 483-7829 |
| 11. Heritage Suites | 475 15th St. W. | 456-8400 |
| 12. Holiday Inn Express & Suites | 103 14th St. W. | 456-8000 |
| 13. La Quinta Inn & Suites | 552 12th St. W. | 456-2500 |
| 14. Microtel Inn & Suites | 1597 6th Ave. W. | 456-2000 |
| 15. My Place Extended Stay | 2431 3rd Ave. W. | 483-0300 |
| 16. NODAK Motel | 600 E. Villard | 225-5119 |
| 17. Red Roof Inn & Suites | 165 26th St. W. | 483-1688 |
| 18. Roosevelt Grand Dakota Hotel | 532 15th St. W. | 483-5600 |
| 19. TownePlace Suites | 240 29th St. W. | 483-4724 |
| 20. WoodSpring Suites | 3233 Legend Dr. | 483-6900 |
| 21. Camp on the Heart | 387 S. State Ave. | 225-9600 |
| 22. North Park Campground | 2320 Buckskin Dr. | 227-8498 |
| 23. Patterson Lake Recreation | 3753 114th Ave. SW | 456-2056 / 456-2074 |
| 24. R & A Lot Rental | 1200 25th Ave. E. | 483-8600 |

Points of Interest

- | | |
|--|------------------------|
| 25. Badlands Dinosaur Museum | |
| 26. Biesiot Activities Center (BAC) | |
| 27. CHI St. Alexius Health (Hospital & Clinic) | |
| 28. Crooked Crane Trail | |
| 29. Dakota Community Bank & Trust Ballpark | |
| 30. Dickinson Convention & Visitors Bureau | |
| 31. Dickinson Dike/Turtle Park | |
| 32. Dickinson High School | |
| 33. Dickinson Museum Center | |
| 34. Dickinson State University | |
| 35. DSU Indoor Multipurpose Arena | |
| 36. DSU Native American Collection/Stoxen Library | |
| 37. DSU Theodore Roosevelt Ctr./Stoxen Library | |
| 38. Forest Service/Bureau of Land Management | |
| 39. Gress Softball Complex | |
| 40. Heart River Golf Course | |
| 41. ND Game & Fish Department-Dickinson | |
| 42. NDSU Dickinson Extension Research Center | |
| 43. Patterson Lake | |
| 44. Pioneer Machinery Hall | |
| 45. Prairie Hills Mall | |
| 46. Prairie Outpost Park | |
| 47. Southwest Speedway | 10 miles S. on Hwy. 22 |
| 48. Stark County Fairgrounds & Event Park | 2 miles S. on Hwy. 22 |
| 49. Stark County Veterans Memorial | |
| 50. Super Walmart | |
| 51. T-Rex Plaza | |
| 52. Theodore Roosevelt Regional Airport | 4 miles S. on Hwy. 22 |
| 53. Trinity High School | |
| 54. Ukrainian Cultural Institute | |
| 55. West River Community Center/Mustang Baseball Complex | |
| 56. West River Ice Center | |

VisitDickinson.com

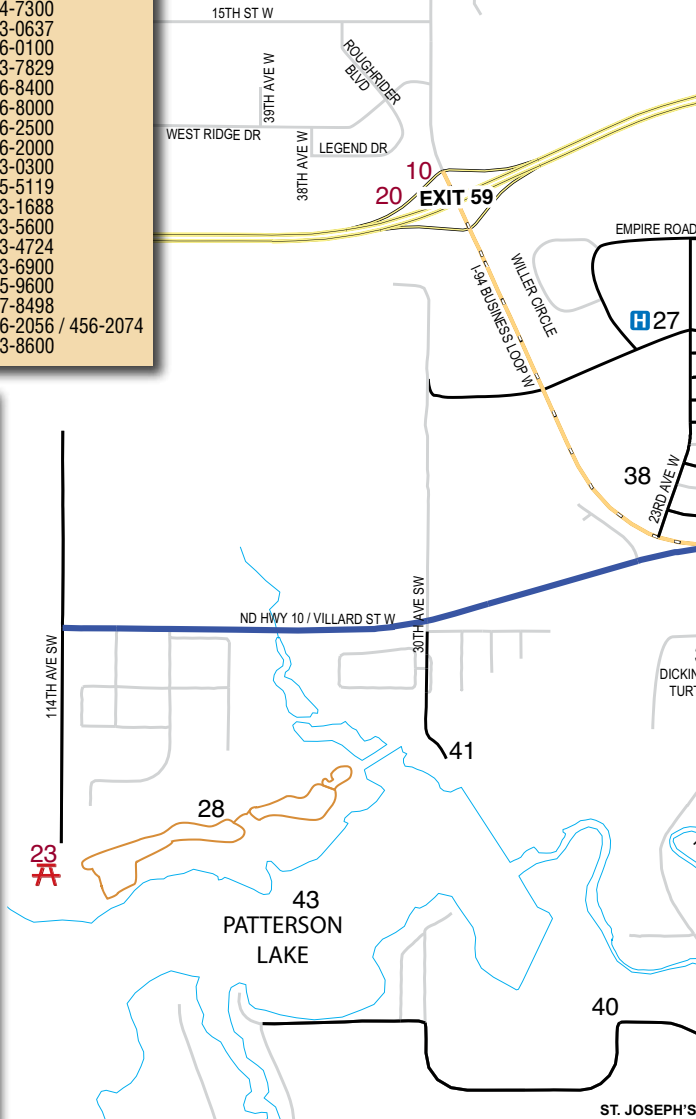

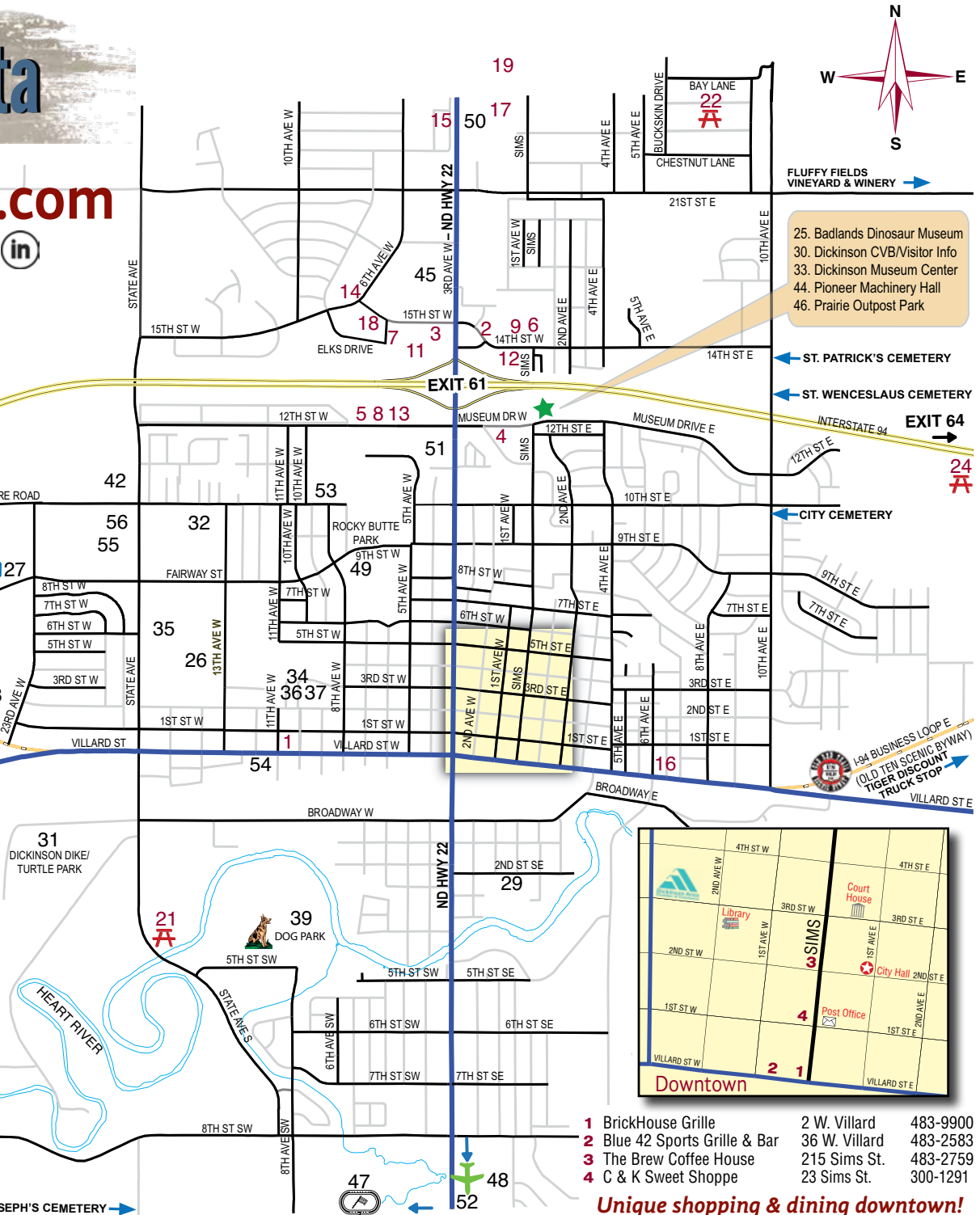
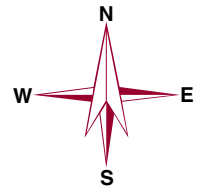

- 25. Badlands Dinosaur Museum
- 30. Dickinson CVB/Visitor Info
- 33. Dickinson Museum Center
- 44. Pioneer Machinery Hall
- 46. Prairie Outpost Park

- ← ST. PATRICK'S CEMETERY
- ← ST. WENCESLAUS CEMETERY
- ← CITY CEMETERY

194 BUSINESS LOOP E
OLD TEN SCENIC BYWAY
TIGER DISCOUNT
TRUCK STOP

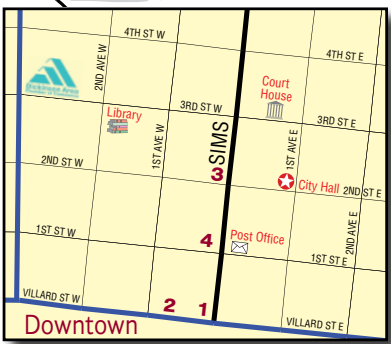

- | | | |
|-------------------------------|---------------|----------|
| 1 BrickHouse Grille | 2 W. Villard | 483-9900 |
| 2 Blue 42 Sports Grille & Bar | 36 W. Villard | 483-2583 |
| 3 The Brew Coffee House | 215 Sims St. | 483-2759 |
| 4 C & K Sweet Shoppe | 23 Sims St. | 300-1291 |

Unique shopping & dining downtown!

Attractions/Recreation

Badlands Dinosaur Museum	188 E. Museum Dr.	456-6225
Biesiot Activities Center (BAC)	398 State Ave. N.	483-1918
Dakota Community Bank & Trust Ballpark	240 2nd St. SE	456-2074
Dickinson Museum Center	188 E. Museum Dr.	456-6225
DSU Art Gallery	291 Campus Dr., Klinefelter Hall-DSU	483-2330
DSU Native American Collection	291 Campus Dr., Stoxen Library-DSU	483-2814
DSU Theodore Roosevelt Center	291 Campus Dr., Stoxen Library-DSU	483-2814
Gress Softball Complex	455 8th Ave. SW	456-2074
Griffon Theatres, LLC	1681 3rd Ave. W.	483-2688
Heart River Golf Course	2510 8th St. SW	456-2050
K5 Kayaks		290-0813
Mustang Baseball Complex	871 State Ave. N.	456-2074
NDSU Dickinson Research Extension Center	1041 State Ave.	456-1100
Paragon Bowl	1125 W. Villard	225-2345
Patterson Lake Recreation Area	3753 114th Ave. SW	456-2074
Pioneer Machinery Hall	188 E. Museum Dr.	456-6225
Prairie Outpost Park	188 E. Museum Dr.	456-6225
Southwest Speedway	47th St. SW	483-8722
Stark County Fairgrounds & Event Park	South 4024 Hwy. 22	290-0293
Ukrainian Cultural Institute	1221 W. Villard St.	483-1486
We Move Fun	30 7th St. W.	690-1654
West River Community Center	2004 Fairway St.	456-2070
West River Ice Center	1865 Empire Rd.	456-2074

Dickinson City Information

Convention & Visitors Bureau	72 E. Museum Dr.	483-4988
Dickinson Area Chamber of Commerce	314 3rd Ave. W.	225-5115
Dickinson Area Public Library	139 3rd St. W.	456-7700
Dickinson City Hall	38 1st St. W.	456-7744
Dickinson High School	979 13th Ave. W.	456-0030
Dickinson Parks & Recreation	2004 Fairway St.	456-2074
Dickinson Post Office	15 1st St. E.	225-6702
Dickinson State University	291 Campus Dr.	483-2507
Forest Service/Bureau of Land Management	99 23rd Ave. W.	227-7800 / 227-7700
Job Service ND	66 Osborn Dr.	227-3100
ND Game & Fish Department/Dickinson	225 30th Ave. SW	227-7431
NDSU Dickinson Research Extension Center	1041 State Ave.	456-1100
Stark County Courthouse	51 3rd St. E.	456-7630
Stark Development Corporation	103 1st Ave. W. Suite 101	225-5997
Theodore Roosevelt Regional Airport	11120 42nd St. SW	483-1062
	4 Miles South on Hwy. 22	
Trinity High School	810 Empire Rd.	483-6081

Emergency Information (911)

CHI St. Alexis Health (Hospital & Clinic)	2500 Fairway St.	456-4000
ND Road Report		511
Public Safety Center - Dickinson Fire Department	2475 State Ave. N.	456-7625
Public Safety Center - Dickinson Police Department	2475 State Ave. N.	456-7759
Sanford Health Dickinson Clinic	2615 Fairway St.	456-6000
Sanford Health East Dickinson Clinic	33 9th St. W.	483-6017

Specialty Coff

Backyard Play Café
 C & K Sweet Shoppe and Coffee (drive-thru only)
 C & K Sweet Shoppe (Downtown)
 Caribou Coffee
 City Brew
 Core Nutrition
 Daily Perks (drive-thru only)
 Daily Perks
 De Porres Lounge
 Dunn Brothers Coffee
 Java Junction (drive-thru only)
 Market Press Coffee Co.
 Max Nutrition
 Serendipity Coffee Bistro and Drive-thru
 Starbucks
 The Brew Coffee House
 The Hub Café (North)
 Wild Smoothie Bar

Laundro

Paradise Dry Cleaners
 Prairie Maid Coin Laundry
 Wash 'n Go Coin Laundry

Car Rental/Tra

Autorama Auto Sales & Service
 Dan Porter Motors
 Dollar Car Rental
 Enterprise Rental
 Hertz Car Rental
 U-Save Auto Rental
 Theodore Roosevelt Regional Airport

Western Edge Aviation

Jefferson Bus Lines
 Public Transit

 Google for local taxis

RV Dumping

Cenex General Store (24 hours) - no water
 Cenex Museum General (24 hours) - no water
 Patterson Lake Recreation (seasonal)
 The Hub (24 hours)

RV Serv

Goodyear Auto Service Center
 Kuntz RV
 Roughrider RV's



Coffee & Drinks

193 24th St. E Ste. 105	483-3662
2169 2nd Ave. W.	300-1988
23 Sims St.	300-1291
1761 3rd Ave. W.	225-9454
1701 3rd Ave. W.	483-4323
352 1st St. E. Ste. A	690-0106
16 State Ave. S.	
705 E. Villard	
17 2nd Ave. W.	225-2497
269 16th St. W.	483-1650
211 14th St. W.	227-0616
1740 Market Dr.	483-2877
383 15th St. W.	483-1817
789 State Ave.	483-1946
1283 Roughrider Blvd.	483-8046
215 Sims St.	483-2759
191 40th St. W.	483-3835
30 7th St. W. Door A	

Dromats

1867 6th Ave. W.	483-6655
385 15th St. W.	483-7230
1173 3rd Ave. W.	483-9510

Transportation

1765 Business Loop E.	483-3700
2391 Business Loop E.	227-1272
11120 42nd St. SW	456-8436
531 W. Villard St. Ste. 3	483-7850
11120 42nd St. SW	800-654-3131
2151 Business Loop E.	483-7550
11120 42nd St. SW	483-1062
4 Miles South on Hwy. 22	
11160 42nd St. SW	483-4221
4 Miles South on Hwy. 22	
2955 I-94 Business Loop E.	800-451-5333
361 26th St. E.	483-6564

ing Services

N of I-94, Exit 61	483-3633
S of I-94, Exit 61	483-7017
SW of City	456-2074
N on Hwy. 22	483-3835

ervices

251 21st St. W.	483-8791
1154 1st Ave. SE	483-5451
975 38th Ave. E.	483-9844

CONVENTION & VISITORS BUREAU

72 East Museum Drive • Dickinson, ND 58601

701-483-4988 • 800-279-7391

NORTH DAKOTA AREA CODE IS (701)

Dickinson is on Mountain Time

VisitDickinson.com

Restaurants

Applebee's Neighborhood Grill	289 15th St. W.	227-8573
Arby's	251 14th St. W.	227-8854
Astoria Pizzeria Bar & Lounge	363 15th St. W.	456-5000
A & W/KFC	235 Osborn Dr.	225-3838
Backyard Play Café	193 24th St. E. Ste. 105	483-3662
Blue 42 Sports Grille & Bar	36 W. Villard	483-2583
BrickHouse Grille / B2 Lounge	2 W. Villard	483-9900
Buffalo Wild Wings	3545 W. Ridge Dr.	761-2382
Burger King	321 15th St. W.	225-1766
C & K Sweet Shoppe (Downtown)	23 Sims St.	300-1291
Champs Sports Club Bar & Grill	1125 W. Villard	225-2345
City Brew	1701 3rd Ave. W.	483-4323
Country Kitchen	528 12th St. W.	483-9376
Country Rose Cafe & Catering	837 E. Villard	483-2211
Dainty Wok	1785 1st St. W.	483-8888
Dakota Diner	2857 I-94 Business Loop E.	483-9696
Domino's	401 W. Villard	225-7100
Domino's (carry-out)	237 14th St W.	483-7712
Donut Hole	837 W. Villard	483-1717
DQ Grill & Chill	372 15th St. W.	483-8100
Dunn Brothers Coffee	269 16th St. W.	483-1650
Eagles Club	31 1st Ave. E.	483-3561
El Parcutin	455 15th St. W.	483-6800
El Sombrero Restaurant	505 15th St. W.	483-5380
Elks Lodge	501 Elks Dr.	483-1137
Fluffy Fields Vineyard and Winery	2708 21st St. E.	483-2242
Food Riot	40 7th St. W.	260-3221
Godfather's Pizza	191 40th St. W.	483-3835
Grand Dakota Grille (Roosevelt)	532 15th St. W.	483-5600
Green 19 (seasonal) Heart River Golf Course	2510 8th St. SW	456-2048
Hardee's	233 W. Villard	227-0663
J & J Chinese (delivery)	1484 South Main Ave.	483-0015
JD's BBQ	789 State Ave.	483-2277
Jimmy John's	1701 3rd Ave. W. Ste. 262	483-9717
King Buffet	T-Rex Plaza, 1173 3rd Ave. W. #23	227-8888
Little Caesars Pizza	1785 1st St. W. Ste. A	483-6066
Los Cabos Family Mexican Restaurant	583 12th St. W.	483-1841
Market Press Coffee Co.	1740 Market Dr.	483-2877
McDonald's	212 Museum Dr. W.	483-0345
Papa John's	1625 W. Villard	483-7200
Papa Murphy's (carry-out)	1681 3rd Ave. S. Ste. 60	483-7272
Phat Fish Brewing Co.	1031 W. Villard	701-761-0170
Pizza Hut (carry-out)	22 S. State Ave.	225-8000
Pizza Ranch	2184 2nd Ave. W.	483-0008
Players Sports Bar and Grill	2050 1st Ave. E.	483-1733
Portillos Bakery	925 W. Villard	
PretzelMaker	Prairie Hills Mall, 1681 3rd Ave. W.	483-3455
Qdoba	1701 3rd Ave. W. Ste. 254	483-8500
Sakura Japanese Steak House & Sushi Bar	203 14th St. W.	483-3888
Sanford's Grub & Pub	167 14th St. W.	483-9770
Serendipity Coffee Bistro and Drive-thru	789 State Ave.	483-1946
Subway	401 W. Villard Ste. 254	483-6434
Subway	T-Rex Plaza, 455 12th St. W.	225-2552
Subway	Super Walmart, 2456 3rd Ave. W.	483-7144
Taco Bell	1560 3rd Ave. W.	227-1201
Taco John's	180 14th St. W.	483-0975
The Brew Coffee House	215 Sims St.	483-2759
The Hub Café (North)	191 40th St. W.	483-3835
The Perch	291 Campus Dr.	483-2014
Upin Thai (carry-out)	27 S. Main Ave.	483-0799
Wendy's	325 19th St. W.	483-9511
Yum "FroYo & More"	1674 15th St. W.	483-3671

STARK COUNTY ECONOMY AT A GLANCE

POPULATION

(Job Service North Dakota)	2021	2020
Stark County	33,046	23,646
Dickinson	25,167	25,679
North Dakota	777,934	779,094

TRANSPORTATION

Airport Boardings (Dickinson Theodore Roosevelt Airport)	2022	2021
Airport Passenger Enplanements	21,606	17,411
Airport Passenger Deplanements	22,394	17,945

WORKFORCE

(Job Service North Dakota)	Dec 2022	Dec 2021
Stark County Labor Force	17,814	17,356
Stark County Unemployment	1.9%	3.2%
Dickinson Unemployment	1.9%	3.2%
ND Unemployment	2.2%	3.0%
US Unemployment	3.3%	3.7%

TAXABLE SALES & PURCHASES

(Office of State Tax Commissioner)	3rd Qtr 2022	3rd Qtr 2021
Dickinson	\$243,269,036	\$202,271,478
Stark County	\$255,809,067	\$214,157,308

BIRTH RATES

(CHI St. Alexius Health Dickinson)	2022	2021
Live Births	656	642

EDUCATION

K-12 Fall Enrollment (Dept. of Public Instruction)	2022-2023	2021-2022
Belfield	267	250
Dickinson Public Schools	3,951	3,878
Dickinson Trinity Catholic Schools	587	554
Hope Christian Academy	148	127
Richardton-Taylor	314	335
South Heart	406	411
Higher Education Fall Enrollment (DSU)	2022-2023	2021-2022
Dickinson State University	1,473	1,415

TOP 10 LARGEST EMPLOYERS

(Job Service North Dakota)	
1	Dickinson Public School District
2	Walmart
3	CHI St Alexius Health - Dickinson
4	Killdeer Mountain Manufacturing
5	Steffes Solutions
6	Nondisclosable
7	Baker Boy inc
8	TMI Corporation
9	City of Dickinson
10	Dickinson State University

OIL PRICES

(NDIC Dept. of Mineral Resources)	Dec 2022	Dec 2021
West Texas Intermediate Oil (Price/Barrel)	\$73.14	\$67.96
North Dakota Light Sweet (Price/Barrel)	\$73.89	\$65.46



Median Household Income: \$70,364
Average Commute Time to Work: 16.6 minutes

Median Age: 34.2
Largest City: Dickinson

STARK COUNTY ECONOMY AT A GLANCE

TAX COLLECTIONS

City Sales Tax (Office of ND State Treasurer)	2022	2021
Belfield	\$488,209.34	\$416,494.20
Dickinson	\$10,124,789.54	\$8,901,057.82
Richardton	\$306,389.32	\$229,055.81
South Heart	\$71,631.95	\$74,255.58
Stark County Total	\$10,991,020.15	\$9,620,863.41
City Occupancy Tax (Office of ND State Treasurer)	2022	2021
Belfield	\$14,139.18	\$11,159.62
Dickinson	\$368,115.78	\$324,052.95
Stark County Total	\$382,254.96	\$335,212.57
City Restaurant/Lodging (Office of ND State Treasurer)	2022	2021
Dickinson	\$991,629.72	\$924,646.24

REAL ESTATE

(Badlands Board of Realtors, Inc.)	2022	2021
Dickinson # of MLS Units Sold (Does not include "for sale by owner" transactions)	416	499
Dickinson MLS Average Sale Price - Single Family	\$266,793	\$279,624
Stark County # of MLS Units Sold (Does not include "for sale by owner" transactions)	462	551
Stark County MLS Average Sale Price - Single Family	\$258,434	\$269,685

BUILDING PERMITS

Dickinson (City of Dickinson)	2022		2021	
	Permits	Total Value	Permits	Total Value
Commercial	13	\$13,019,478	12	\$2,789,831
Public	4	\$15,050,000	1	\$3,700,000
Single Family	58	\$28,954,192	68	\$28,049,079
Multi-Family	1	\$1,014,510	0	\$0
Alteration/Additions	93	\$14,442,491	95	\$9,309,905
Misc. Permits/Fees	509	\$677,118	653	\$541,766
Stark County (City of Dickinson)	2022		2021	
	Permits	Total Value	Permits	Total Value
Commercial	3	\$7,370,000	4	\$2,789,831
Public	1	\$50,000,000	0	\$0
Single Family/ Mobile Home	32	\$16,018,568	21	\$11,605,215

HOUSING RENTAL RATES

(ACS U.S. Census Bureau, American Community Survey)	
Stark County Rental Vacancy Rate (ACS 2017-21)	9.6%
Stark County Median Rent (ACS 2017-21)	\$913

LODGING

(Dickinson Convention & Visitors Bureau)	2022	2021
Occupancy Rate	48.5%	43.0%
Average Daily Rate (ADR)	\$86.50	\$83.92

INFRASTRUCTURE

Water: Southwest Water Authority provides potable water to the City of Dickinson and Southwest North Dakota. Raw water is transported from Lake Sakakawea to the Dickinson Water Treatment Plant where it is treated and sold to the City of Dickinson. The water purchased from Southwest Water Authority is distributed to the residents by a new Finished Water Pump Station, booster stations and multiple storage capabilities for fire flow.

Wastewater: Wastewater is collected and treated at the City's new Water Reclamation Facility which produces highly treated reuse water. Reuse water is sold to the Renewable Diesel Plant 11 miles to the west of Dickinson and has also been sold for fracking operations in the area. The city has reuse water available in the West Dickinson area for industrial and commercial use. The City of Dickinson has built for the future and has capacity in the wastewater collection system.

Rail Service: Burlington Northern Santa Fe's main line runs east/west through Stark County. BOE Rail is located in Dickinson, south of the Missouri River with direct access to the BNSF rail line. With 5 loops (over 40,000 ft of rail line) and over 800,000 barrels of tank storage, BOE Main is uniquely designed to provide operators significant train movement, excess rail car storage and loading capabilities. BOE is the only terminal in the Bakken that can simultaneously load 2 unit trains while also staging additional trains for pre-load arrival and post-load departure, providing for greater ratability and capacity than competing terminals.



Airport Services: The Dickinson Theodore Roosevelt Regional Airport is located 4 miles south of Dickinson, ND on Hwy 22. The airport's newly reconstructed main runway, (RWY 14-32), is 7301' x 150' and its crosswind runway, (RWY 7-25) is 4700' x75'. The Dickinson Theodore Roosevelt Regional Airport has commercial daily air service provided by United Airlines with non-stop jet service to the Denver International Airport, (DIA), in Denver, CO. Commercial terminal hours are 5:30 a.m. to 10:00 p.m. The Dickinson Airport also supports a full-service Fixed Base Operation (FBO), Western Edge Aviation, with 24 hr. aviation fuel, 100LL and JET A. The FBO also has onsite aircraft maintenance and repair, flight instruction, and air charter. The FBO's general aviation (GA) terminal is accessible 24 hrs. The airport general Information phone number is 701-483-1062 and the FBO can be reached at 701-483-4221.

Electricity & Natural Gas: Montana Dakota Utilities Co. and Roughrider Electric Cooperative supply the City and surrounding area with electricity. Montanan Dakota Utilities Co. is also the supplier of natural gas in the area.

Broadband Service:

CenturyLink

Consolidated

Midco Supply

There are several Internet options available to Dickinson area residents including fiber optic, cable and DSL. These options cover not only the city of Dickinson, they also cover the rural 58601 area with speeds up to 1 GIG to meet the demands of work from home, distance learning, streaming, gaming, and everything in between. Dickinson's providers offer fast, reliable services to meet today's broadband needs and those needs yet to come.



SDC BUSINESS INCENTIVE PROGRAMS

		INTEREST BUYDOWN PROGRAMS																																																													
		PACE PROGRAM			FLEX PACE PROGRAM																																																										
PROGRAM PURPOSE	Expands communities economic base by creating new jobs. The business must create new wealth, defined as revenues generated through the sale of products or services to customers outside of ND or customers in ND if the products or services were previously unavailable or difficult to obtain from a business in the state.			Supports community-based economic growth with the community determining it needs. Flex PACE provides assistance to businesses that do not meet the primary sector requirements of PACE.																																																											
ELIGIBILITY	Must be a good standing member of SDC. Must be a primary sector business as defined by NDCC 1-01-49 and certified by the ND Dept. of Commerce Division of Economic Development.			Must be a good standing member of SDC. Project supporting community needs, licensed child care operations and affordable housing projects.																																																											
PARTICIPATION REQUIREMENTS	SDC, Local Lender & BND participation required.			SDC, Local Lender & BND participation required.																																																											
USE OF PROCEEDS	A ND primary sector business may use this to purchase real property, equipment or term working capital.			A ND business that meets a community need may use this to purchase real property or equipment, permanent financing of costs associated with establishing or expanding a child care or affordable housing project.																																																											
PROGRAM AMOUNT/TERMS	<p>Interest rate of loan may be reduced by up to 5% below yield rate and not less than 5% below prime with a floor of 1% (yield rate is set by local lender)</p> <p>Length of term, amortization, personal guarantees, and loan-to-value percentages will be negotiated between the lead lender and BND on a case-by-case basis.</p> <table border="1"> <thead> <tr> <th colspan="6">Maximum Interest Buydown</th> </tr> <tr> <th></th> <th>Jobs Created</th> <th></th> <th>Minimum Investment</th> <th>SDC Buydown</th> <th>BND Buydown</th> </tr> </thead> <tbody> <tr> <td>Tier One</td> <td>2-5</td> <td>or</td> <td>\$750,000 - \$1,200,000</td> <td>\$53,846</td> <td>\$100,000</td> </tr> <tr> <td>Tier Two</td> <td>6-10</td> <td>or</td> <td>\$1,200,001 - \$2,200,000</td> <td>\$107,692</td> <td>\$200,000</td> </tr> <tr> <td>Tier Three</td> <td>11-15</td> <td>or</td> <td>\$2,200,001 - \$3,500,000</td> <td>\$161,538</td> <td>\$300,000</td> </tr> <tr> <td>Tier Four</td> <td>16-20</td> <td>or</td> <td>\$3,500,001 - \$4,500,000</td> <td>\$215,384</td> <td>\$400,000</td> </tr> <tr> <td>Tier Five</td> <td>20 +</td> <td>or</td> <td>\$4,500,000 +</td> <td>\$269,230</td> <td>\$500,000</td> </tr> </tbody> </table> <p>SDC share of interest buydown funds are required to be paid back commencing the close out of the loan.</p>			Maximum Interest Buydown							Jobs Created		Minimum Investment	SDC Buydown	BND Buydown	Tier One	2-5	or	\$750,000 - \$1,200,000	\$53,846	\$100,000	Tier Two	6-10	or	\$1,200,001 - \$2,200,000	\$107,692	\$200,000	Tier Three	11-15	or	\$2,200,001 - \$3,500,000	\$161,538	\$300,000	Tier Four	16-20	or	\$3,500,001 - \$4,500,000	\$215,384	\$400,000	Tier Five	20 +	or	\$4,500,000 +	\$269,230	\$500,000	<p>Interest rate of loan may be reduced by up to 5% below yield rate and not less than 5% below prime with a floor of 1% (yield rate is set by local lender)</p> <p>Length of term, amortization, personal guarantees, and loan-to-value percentages will be negotiated between the lead lender and BND on a case-by-case basis.</p> <table border="1"> <thead> <tr> <th colspan="3">Maximum Interest Buydown</th> </tr> <tr> <th></th> <th>SDC Buydown</th> <th>BND Buydown</th> </tr> </thead> <tbody> <tr> <td>Business</td> <td>\$107,692</td> <td>\$200,000</td> </tr> <tr> <td>Child Care</td> <td>\$161,538</td> <td>\$300,000</td> </tr> <tr> <td>Affordable Housing</td> <td>\$269,230</td> <td>\$500,000</td> </tr> </tbody> </table> <p>SDC share of interest buydown funds are required to be paid back commencing the close out of the loan.</p>			Maximum Interest Buydown				SDC Buydown	BND Buydown	Business	\$107,692	\$200,000	Child Care	\$161,538	\$300,000	Affordable Housing	\$269,230	\$500,000
Maximum Interest Buydown																																																															
	Jobs Created		Minimum Investment	SDC Buydown	BND Buydown																																																										
Tier One	2-5	or	\$750,000 - \$1,200,000	\$53,846	\$100,000																																																										
Tier Two	6-10	or	\$1,200,001 - \$2,200,000	\$107,692	\$200,000																																																										
Tier Three	11-15	or	\$2,200,001 - \$3,500,000	\$161,538	\$300,000																																																										
Tier Four	16-20	or	\$3,500,001 - \$4,500,000	\$215,384	\$400,000																																																										
Tier Five	20 +	or	\$4,500,000 +	\$269,230	\$500,000																																																										
Maximum Interest Buydown																																																															
	SDC Buydown	BND Buydown																																																													
Business	\$107,692	\$200,000																																																													
Child Care	\$161,538	\$300,000																																																													
Affordable Housing	\$269,230	\$500,000																																																													
HOW TO APPLY	Contact SDC & Local Lender			Contact SDC & Local Lender																																																											

Program applications will be reviewed at Stark Development Corporation's Board of Directors Meetings. Meetings are the

GRANTS & FORGIVABLE LOANS

BUILDING REVITALIZATION PROGRAM	CHILD CARE PROGRAM	FACADE IMPROVEMENT PROGRAM
Assists property owners bringing commercial buildings into compliance with local and national building codes to provide new commercial, retail and restaurant opportunities throughout communities in Stark County.	Supports development of child care facilities by providing matching funds to new or expanding center or group facilities throughout communities in Stark County.	Encourages business owners to improve the exterior of their buildings and storefronts to attract new customers and promote expansion of commercial and retail sectors throughout communities in Stark County.
Must be a good standing member of SDC. Property must be in Stark County and zoned adequately. Property must be in good standing and free of outstanding code violations with current taxes and assessments paid. Must be a for-profit business.	Must be a good standing member of SDC. Property must be in Stark County and zoned adequately. Property must be in good standing and free of outstanding code violations with current taxes and assessments paid.	Must be a good standing member of SDC. Property must be in Stark County, zoned adequately, property must be in good standing and free of outstanding code violations with current taxes and assessments paid. Building owner or store tenant with owner authorization may apply.
The applicant must leverage a minimum of \$1.00 of private funds for every \$1.00 of program funds requested. Applicants must be opening a new business or significantly expanding their business ultimately increasing the tax base in Stark County.	The applicant must leverage a minimum of \$1.00 of private funds for every \$1.00 of program funds requested. Applicants shall obtain a letter of support from the Stark County Child Care Licenser indicating the level of childcare license obtained.	The applicant must leverage a minimum of \$1.00 of private funds for every \$1.00 of program funds requested.
Capital improvements increasing the life expectancy of the property. Improvements could include, but are not limited to, accessibility and ADA improvements, fire suppression, hazardous materials abatement, structural issues, plumbing and HVAC updates as required by building code.	Facility purchase, facility expansion, equipment purchase including safety and security.	Street facing improvements could include; signage, awnings, exterior lighting, exterior painting, siding, masonry and/or structural or design changes of storefront. Other improvements to facilities providing significant economic benefit may be considered. Standard maintenance items not eligible.
Up to \$50,000 in matching funds at the discretion of the review committee. Applications are reviewed and scored quarterly and awarded based on funds available. Funds will be paid in a lump sum at the end of the project as a reimbursement of costs incurred.	Up to \$1,000 per child in matching funds not to exceed \$30,000 for group and \$100,000 for center. The interest-free loan will be pro-rated and forgiven over the course of 5 years contingent upon project completion. Applicant must also maintain a valid license for the number of children or greater specified at the time of application approval. Funds will be paid in a lump sum at the end of the project as a reimbursement of costs incurred.	Up to \$25,000 in matching funds per street facing view (max of \$50,000) or up to \$10,000 in matching funds per multi-tenant store front. The interest-free loan will be pro-rated and forgiven over the course of 5 years contingent upon project completion and approved improvements in the application remaining intact during this period. Funds will be paid in a lump sum at the end of the project as a reimbursement of costs incurred.
Contact SDC	Contact SDC	Contact SDC

on the third Tuesday of every month; applications must be submitted 10 days prior. Annual funds allocated for these programs are subject to change.



STARK

DEVELOPMENT CORPORATION

Your Economic Development Office for Stark County, Dickinson and the Surrounding Area



LOOKING TO GROW YOUR BUSINESS?

- Business Start-up/Expansion Assistance & Incentives
- Community Development Programs
- Local Infrastructure Information
- Monthly Area Economy at a Glance Updates



www.starkdev.com • team@starkdev.com • (701) 225-5997 • 103 1st Ave West, Suite 101 • Dickinson, ND 58601

WHERE BUSINESS GOES TO GROW

HAVE A BUSINESS IDEA AND NOT SURE WHAT THE NEXT STEP IS?



NORTH DAKOTA SMALL BUSINESS DEVELOPMENT CENTERS

Your Ideas - Our Expertise - Your Success

WE CAN HELP!

- Start-up Logistics
- Business Plan Development
- Financial Projections
- Market Research & Advice

We empower North Dakota Small Businesses

REGISTER ONLINE TO GET STARTED TODAY!

(701) 456-9044
matt@ndsbdc.org

NDSBDC.ORG

103 1st Ave West, Suite 102
Dickinson, ND 58601