

Installation instructions
Continuous Ink Supply System (CISS).
CISS for inkjet printers and MFU Epson models:
S22/SX125/SX130/SX230/SX235/SX420/SX425/SX430/SX435/SX440/SX445/BX305
Item code of CISS: SX130CC-X.XB (v1.1En)

Thank you for purchasing CISS TM ColorWay. We appreciate your support and we do our best for convenient usage of our products.

Continuous Ink supply system

Continuous ink supply system (CISS) is a device that is used for massive printing volumes, such as color copying, instant printing and other promotional materials printing. Systems are ideal for home and work operation.

CISS represents a device, which consists of ink tanks with inks, linked with multichannel silicon tube with cartridges, identical to the original ones. CISS ColorWay uses high quality inks TM ColorWay.

CISS advantages: volume of donor ink tanks is in 10 - 20 times bigger than the regular cartridges; there is no necessity to eject cartridges from printer during refilling, the air does not enter to the printhead, prolonging it's life. And as we know, it's the most expensive part of device; huge savings, more than in 20 - 40 times!

Box content:

1. Ink tanks with plugs (4 colors) – 1 set.
2. 4 channel silicone tube – 1 pc.
3. The holder of the tube (U shaped) – 1 pc.
4. Binders – 2 pcs.
5. T-shaped clincher – 1 pcs.
6. Cartridges set (4 pcs) with Combo chips – 1 pcs.
7. Air filter – 4 pcs.
8. Syringe – 4 pcs.
9. Batteries – 2 pcs.
10. Gloves – 1 pair.
11. Ink tanks clincher – 2 pcs.
12. Installation instructions – 1 pc.

The exterior product view and bundling may differ. Drawings and photos are presented in the manual to understand the general installation and operation process of the CISS. The manufacturer reserves the right to change product specifications, designs and bundling without prior notice.

*Inks optionally: SX130CC-0.0B (without inks); SX130CC-4.5B (4 * 50 ml. inks); SX130CC-4.1B (4 * 100 ml. inks).*

Recommended ink:

CW-EW400BK; CW-EW400C; CW-EW400M; CW-EW400Y.



1. Installation preparation

Installation of CISS requires technical information how to install it so we advise you to read instruction before installation.

Before installation please check the whole system and box content.

During the period of CISS usage please do not touch chips, do not let dust and liquids to make them broken.

1.1. Before installations of CISS please make sure the printer is in working condition: make sure the printer works well with original cartridges and paper supply mechanism is fine. If the printer is new and it is been never used before so please go to p.1.3.

Reminder! The fact that in a printer is used non original consumables can be used as a reason of warranty cancellation. Make sure that your printer is compatible with this system (list of compatible printer models is on a side label of box).

1.2. Please print test page to evaluate printer ability to work (Pic. 1).

Start/Control panel/ Printers and Fax/Choose printer/Printer adjustment/Maintenance/Nozzle Check
 If test is positive so please start CISS installation. If result is negative so please follow the recommendations on cleaning printing head via software of printer. Maintenance, Head Cleaning, if this does not bring positive effect so please service your printer in specialized center.

1.3. Please check compatibility which tank belongs to which cartridge and match of cartridge colors sequence in printer and CISS. If there is a need please change colors stickers on ink tanks in right order. Generally a sequence of colors for Epson models **S22/SX125/SX130/SX230/SX235/BX305** is **C/Y/M/BK** and for **Epson SX420/SX425/SX430/SX435/SX440/SX445** is **BK/Y/M/C**. No need to change sequence of cartridges.

1.4. Get straight a silicone tube, it should be in fine working condition. Let CISS to lie for a while for getting room temperature.

1.5. All procedures are recommended to be organized in a way to avoid getting inks on furniture, floor and clothes.

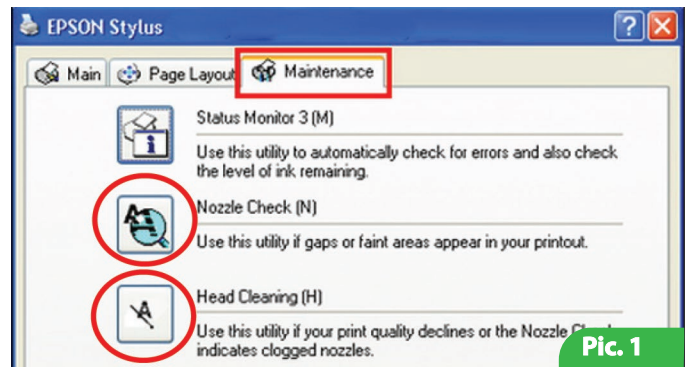

Pic. 1

Attention! If previously you have been using low quality inks or you change now pigment inks into dye inks or dye inks into pigment inks. In this case please clean a printing head before printing with a special cleaning liquid. If you have been using original inks or inks of TM ColorWay in this case no need to clean printing head. TM ColorWay inks is completely compatible with original inks and during installation of TM ColorWay CISS no need to clean printing head.

2. Ink tank refilling

PLEASE NOTE: INK VERY BADLY WASHED OFF, PLEASE ORGANIZE ALL THE PROCEDURES VERY CAREFULLY!

INK CAN RUIN YOUR FURNITURE AND CLOTHES; MAKE SURE THAT YOUR WORKING SPACE AND CLOTH ARE NOT CHERISHED.

Fill in the ink tanks as it shown on Pic. 2:

- 2.1. Plug small aperture with the rubber;
- 2.2. Inject ink though the big aperture;
- 2.3. Plug the big aperture;
- 2.4. Unplug the small aperture, insert the air filter;

2.5. In case big apertures weren't plugged, ink level in both chambers will become equal. In this case you have to unplug both chambers, insert the syringe with pulled back plunger into the small aperture. Carefully push the syringe plunger down, injecting the air into the small chamber and transferring ink into the big chamber. Than plug the big aperture (Pic. 2 – images 5).

In-service ink tanks should be correctly filled-in: please pay attention to operating level of ink in small chamber – it should be minimal.

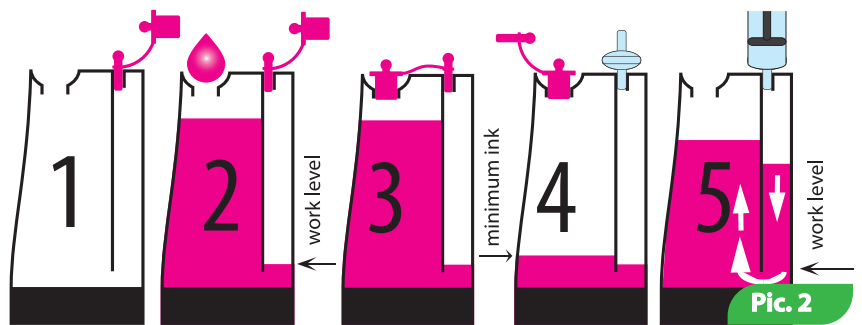

Pic. 2

Note: Do not place ink tanks higher than level of cartridges (printing head) it may cause leakage. Due to excess pressure ink flows into the printer and may spoil printing head and electronic contacts. Keep the ink tanks on the same level with the printer. The air filters (membrane) should be clean and dry. If the air filter is moisten with ink or any other liquid – it stops passing the air and CISS stops working properly (the missing colors are observed on printouts). In this case it'll be better to take filter away and use the CISS without it.

3. System pumping

During first system installation, it is necessary to pump system it means to fill silicone tube and cartridges with inks.

3.1. Turn cartridges with nozzles over, with a help of pen tear a cover (Pic. 3). To remove completely a cover from nozzles is forbidden.

3.2. Cut with a knife syringes in a way it is shown on the picture (Pic. 4).

3.3. With circular movement please put syringe in cartridge (Pic. 5, 6).

3.4. Slowly pull plunger of the syringe until inks come into a syringe (Pic. 7).

3.5. With circular movement carefully remove syringe from cartridge.

3.6. Take a clean syringe and repeat the same operation p.3.3-3.5. for other colors.



Pic. 3



Pic. 4



Pic. 5

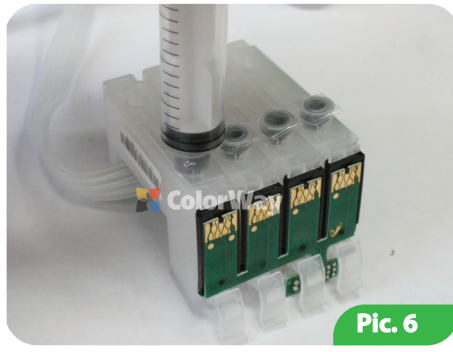

Pic. 6



Pic. 7

3.7. Put a battery in holder (Pic. 8).

If during a pulling of syringe plunger it is hard to pull or plunger comes back so in this case check a silicone tube for any kinks or bends.

4. System installation

4.1. Switch on printer (MFU), when printing head comes out from position Parking (extreme right position), pull out electricity tube. With this you make printing head free and you can move it with your hand.

4.2. If printer (MFU) has been used before, move a carriage with your hand in position Cartridge replacement and put out original cartridges from printer.

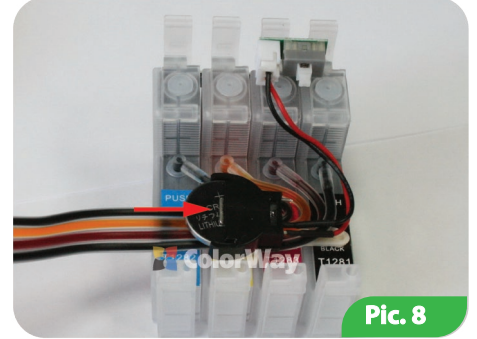

Pic. 8

! Before you start to fix the tube, you need to clearly understand the principle of its movement during the printer operation, as well as to understand the basic fixing principles:
Rule № 1: The length of the tube should be enough for free movement of the printhead from the extreme right – to the extreme left position;
Rule № 2: The tube can bend and touch the printer itself during the moving of print head, but the tube should not get stuck between moving and stationary printer parts!

4.3. Below are examples how to install CISS on various printer models and MFU, please choose a necessary printer (MFU) model for you.

5. CISS installation on Epson SX125/SX130

5.1. Move a carriage to the left with your hand (Pic 9). Get cartridges of CISS inside printer (Pic. 10; 11; 12).

5.2. Move a carriage to the right with your hand and install cartridges of CISS in carriage, please pay attention you need more efforts to install these cartridges than original ones. The main efforts should be focused on cartridges caps. Cartridges should be installed until click. Each cartridge should be clicked properly otherwise chips of cartridges cannot contact with carriage chips and printer



Pic. 9

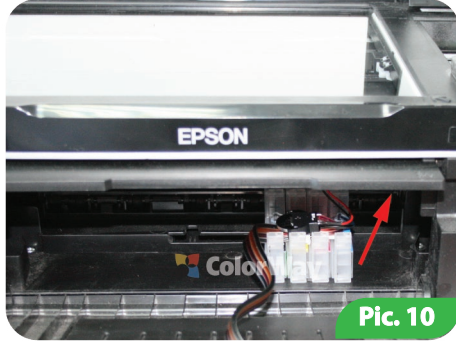

Pic. 10

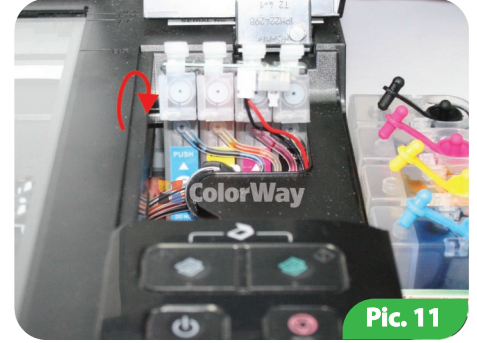

Pic. 11

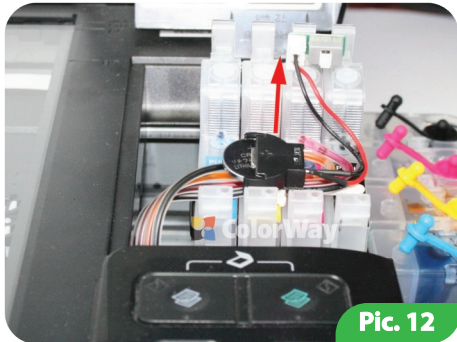

Pic. 12



Pic. 13

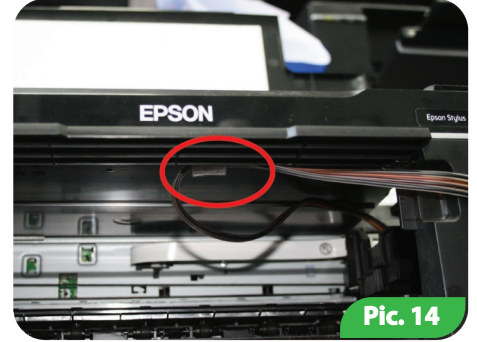

Pic. 14

cannot recognize cartridges. Please perform this procedure carefully. (Pic. 13)

5.3. With a help of two side adhesive tape please glue holder inside printer. Fix in holder a silicone tube of CISS, make sure a tube is not overturn (Pic. 14, 15). Fix a tube on printer body. (Pic. 16).

5.4. Move with your hand a carriage from extreme left to extreme right positions, a tube should not be overturn and block carriage movement, if it is necessary please adjust a silicone tube.

Further exploitation of printer with CISS depends on correct silicone tube fixation.

6. CISS installation on Epson S22

6.1. Move a carriage to position Cartridge replacement with your hand.

6.2. Install cartridges of CISS in carriage, pay attention that you need more efforts to install than with original cartridges. The main efforts should be focused on cartridges caps. Cartridges should be installed until click. Each cartridge should be clicked properly otherwise chips of cartridges cannot contact with carriage chips and printer cannot recognize cartridges. Please perform this procedure carefully.

6.3. With a help of double sided adhesive tape please glue holder of binder on the inside side of printer. Fix in holder a silicone tube, make sure a silicone tube is not overturn (Pic. 17). Fix a silicone tube on a printer body (Pic. 18).

6.4. Move gently with a hand a carriage from extreme right to extreme left position, a silicone tube should not overturn or block carriage movement. If it is necessary please adjust necessary length of silicone tube.

Further exploitation of printer with CISS depends on correct fixation of silicone tube.

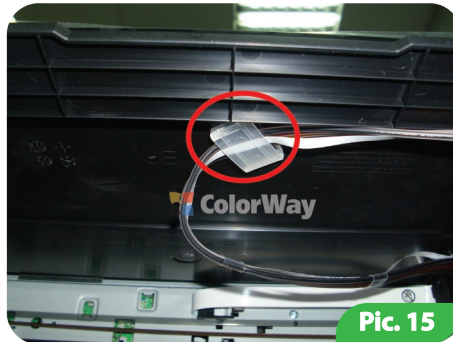

Pic. 15



Pic. 16



Pic. 17

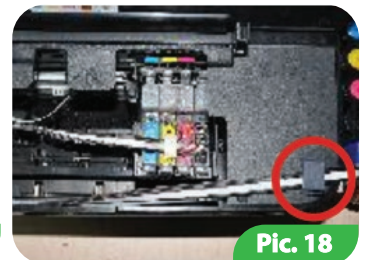

Pic. 18

7. CISS installation on Epson SX420/SX425/BX305

- 7.1. Move a carriage to the position Cartridge replacement with your hand.
- 7.2. With screwdriver remove up cap from cartridge carriage (Pic.19, 20, 21). Move a carriage with your hand to the left. Get cartridges under printer partition and then with your hand move a carriage to the position Replacement of cartridges (Pic. 22, 23, 24).
- 7.3. Install cartridges in printer carriage, please pay attention you need more efforts to install than with original cartridges. The main efforts should be focused on cartridges caps. Cartridges should be installed until click. Each cartridge should be clicked properly otherwise chips of cartridges cannot contact with carriage chips and printer cannot recognize cartridges. Please perform this procedure carefully (Pic. 25).
- 7.4. With a help of double sided adhesive tape please glue holder on side of carriage (Pic. 26). Fix in holder a silicone tube.
- 7.5. **For MFU Epson sx420/sx425.** With a help of double sided adhesive tape glue T shaped clincher and bind holder and fix a silicone tube (Pic. 27, 28).
- 7.6. **For MFU Epson BS305.** Heat with lighter and bind it (Pic. 29, 30). With a help of adhesive tape glue T shaped clincher and holder binder and then fix a silicone tube (Pic. 31, 32, 33).
- 7.7. Move gently a carriage from extreme right to extreme left to fix.

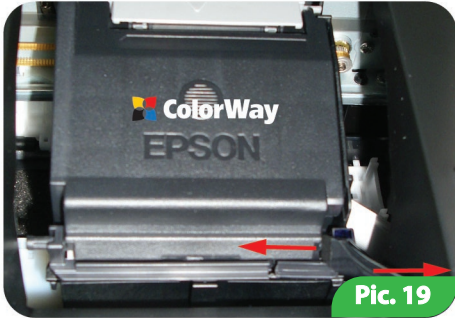

Pic. 19



Pic. 20

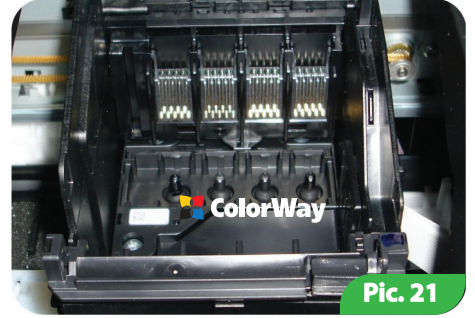

Pic. 21

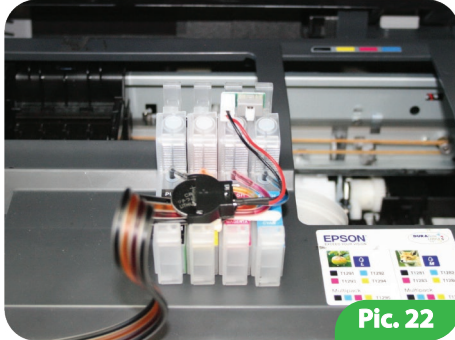

Pic. 22

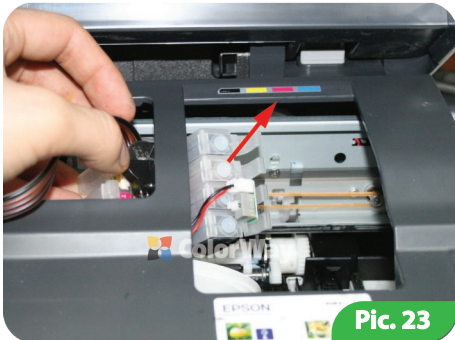

Pic. 23

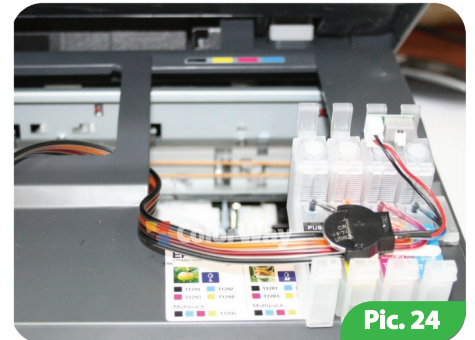

Pic. 24

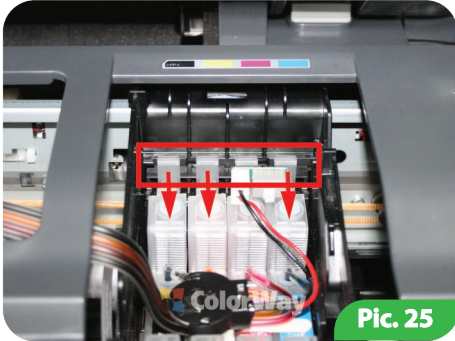

Pic. 25

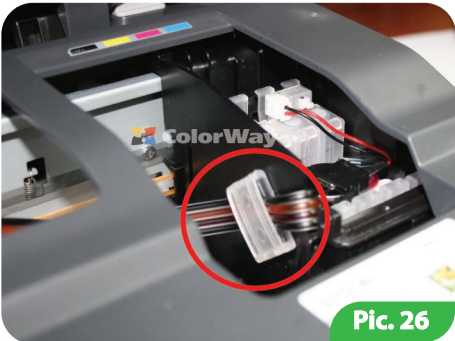

Pic. 26

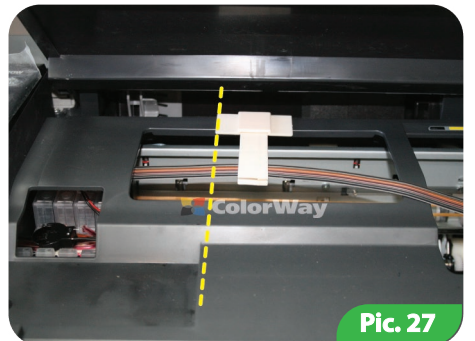

Pic. 27

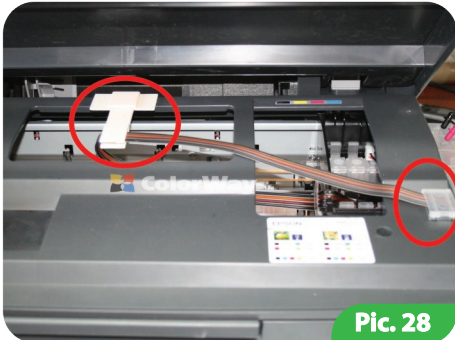

Pic. 28

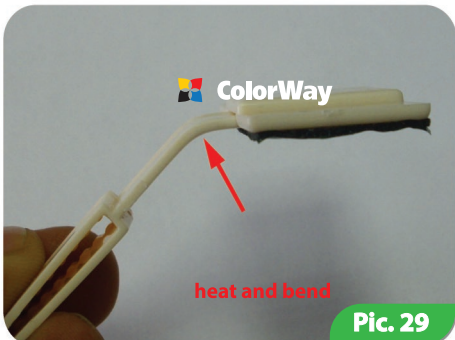

Pic. 29

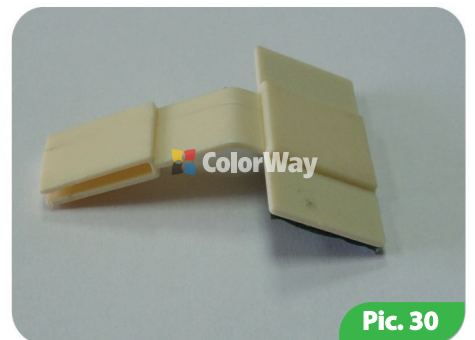

Pic. 30

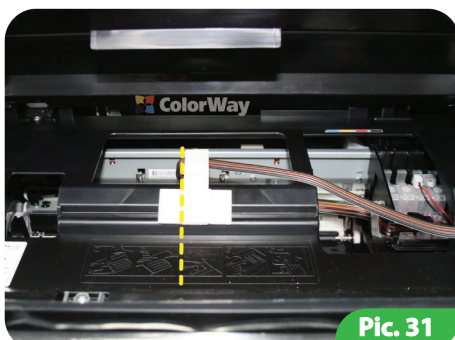

Pic. 31



Pic. 32

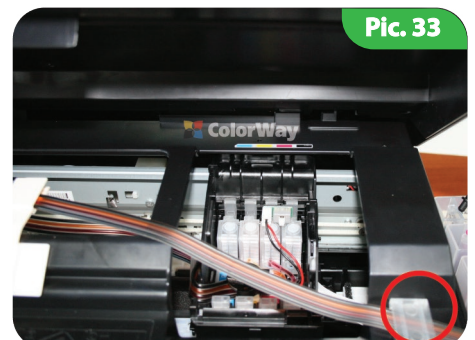

Pic. 33

8. CISS installation on Epson SX230/SX235/SX430/SX435/SX440/SX445

- 8.1. Move a carriage to the position Cartridge replacement with your hand.
- 8.2. Install cartridges of CISS in printer carriage, please pay your attention that you need more efforts to do that than with original cartridges. The main efforts should be focused on cartridges caps. Cartridges should be installed until click. Each cartridge should be clicked properly otherwise chips of cartridges cannot contact with carriage chips and printer cannot recognize cartridges. Please perform this procedure carefully (Pic. 25).
- 8.3. With a help of double sided adhesive tape please glue T shaped clincher in the middle of MFU body (Pic. 34).
- 8.4. Move a carriage from extreme left to extreme right positions and a silicone tube should not block a carriage. If it is necessary adjust a silicone tube length.

9. System start-up

! Before system start, please monitor whether you strictly followed to all instructions in section 2 "Refilling of ink tanks". Make sure that ink tanks are on the same level with the printer, and air holes are open.

9.1. Switch on printer (MFU). Wait until printer is ready. If printer does not recognize all cartridges, please do p.9. Cartridges reset.

9.2. With a help of printer driver do 2-3 cleaning procedures and after this print out a test page and then make sure all nozzles print properly. (p.1.2.). If some nozzles do not print, please leave printer for 5-10 hours, over this time an air that could get in printing head during installation can go out and also a system pressure stabilizes.

10. Cartridges reset

10.1. If printer says that one of cartridges is empty or it is impossible to recognize it, so it is necessary to make reset of ink level. For this on the printer press a button Cartridge replacement (blob), a cartridge carriage moves and stops in replacement position for cartridge that must be replaced and then press one more time button Cartridge replacement and after this carriage moves to the position of cartridges replacement. In MFU and display printer carriage moves to the cartridges replacement after first click on button. This operation can be done with a help of printer instructions.

10.2. When carriage with cartridges is in position of Cartridge replacement, please press chips button and hold it pressed for 5 sec (Pic. 35). Please do it gently in order not to harm a button. This procedure imitates a natural replacement procedure.

10.3. Press one more time button Cartridge replacement (blob) in MFU button OK, confirmation of cartridges replacement. Printer does pumping of printing head and reset empty cartridge.

10.4. If there is a problem with cartridge reset, switch off and after 2 minutes switch on printer. Pull out all cartridges from carriage when it is in Change position for 2-3 sec and put them back in, make sure all cartridges clicked.

10.5. A printer or MFU says of empty cartridges when it is consumed of inks equal to original cartridge volume.

11. Ink tanks binding

11.1. CISS box includes clinchers for ink tanks and if it is necessary you may stick tanks to the printer. Please follow instructions on shown picture 36, 37, 38).



Pic. 36



Pic. 37

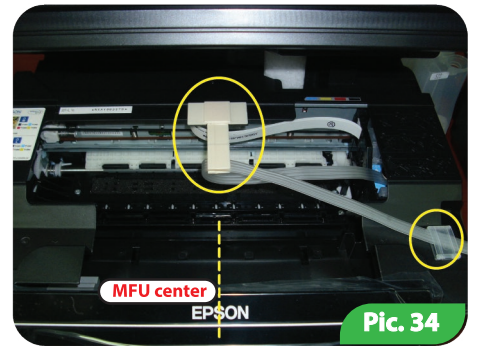

Pic. 34

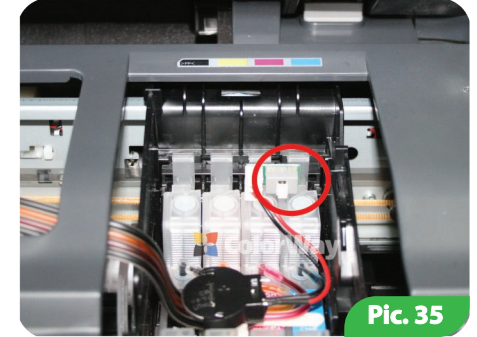

Pic. 35



Pic. 38

12. Service regulations of CISS

12.1. External ink tanks should be filled correctly. A minimum level of inks should be in small ink tanks (p.4. Filling of ink tanks). In case when in small tank too much of inks (Pic. 39), close all caps of tanks (Pic. 39). Tilt tanks on big caps and wait until inks will go from big tanks to small tanks (Pic. 40). Get tanks in standard position and open small caps (Pic. 41). Put in air filters.

12.2. Big holes in tanks should be closed and small holes open with air filters.

12.3. External ink tanks should be standing on the same level with printer, do not lift them higher than level of cartridges because it may cause leakage. If air filters do not work properly due to various reasons please remove them and use system without them.

12.4. A Silicone tube should be installed properly and do not obstruct a movement of printing head.

12.5. Print no less than 1 time a week to avoid printing head drying.

12.6. Use only high quality inks, do not mix inks of various brands and types. It may harm cartridges or printing head.

12.7. During printing do not get upside down ink tanks.

12.8. Use CISS in clean room at temperature of 15-35 C.

12.9. Do not get separate CISS parts. For getting the best printing quality please use inks and paper TM ColorWay.

12.10. Do not keep it under direct sun light.

12.11. Keep out of the reach of children, do not let inks to harm eyes.



Pic. 39



Pic. 40



Pic. 41

13. Transportation of CISS with printer.

13.1. Put out air filters and close with caps small halls in order to avoid leakage.

13.2. Bind with binder a silicone tube that comes from CISS to printer.

13.3. Transport a printer with CISS in horizontal position, do not get printer upside down. For more convenience you can stick air tanks to printer.

14. Questions and answers

14.1. Not printed well some places (pictures/text). In case when you have done a couple of times cleaning of printing heads and still printing head prints with white stripes.

Solution: cleaning of printing head several times, after each cleaning procedure make a test page. Between cleaning procedure make a pause for 5-10 min. If it does not help so please switch off printer and leave it for 12 hours in this condition. After this print a test page. If problem remains, please install original cartridges, if the same problem remains so problem with printer, please make a service for your printer.

14.2. Air bubbles in a silicone tube. In case if cleaning do not lead to positive result and problems remains. Solution is to do again p.3. System pumping, Probably in cartridges of CISS is not enough of inks.

14.3. A silicone tube is bended. In case when one or two colors do not work. Solution: please print a test page and check the whole length of silicone tube. After removing of bends please make cleaning of printing head.

14.4. Unnatural colors of printing. In case when all colors are unnatural. Solution: all cartridges should meet the respective color that is stated on a carriage of printing head. If colors mixed please wash system and refill it again in accordance with right order.

14.5. Poor printing quality. In case if a test page is printed well but printing quality is low. Solution: problem is printing settings, software installed incorrectly. Please change printer settings. Other reason might be not calibrated printing head. To fix it you need to calibrate (see instructions to the printer). During printing appears problems with colors or mix of color it might be the end of printing head life.

14.6. Printer does not recognize cartridges. Bad contact of cartridge chip and contact of carriage, make sure you installed cartridges correctly till click.

14.7. Problem with CISS installation. In case: when printer says General Error or your printer needs service

Solution: during the printing a carriage cannot move. A silicone tube might be too short of long, please adjust a necessary length of silicone tube. If an external part gets in a printer, please check printer body on any external parts.