

## PRODUCT SPECIFICATIONS

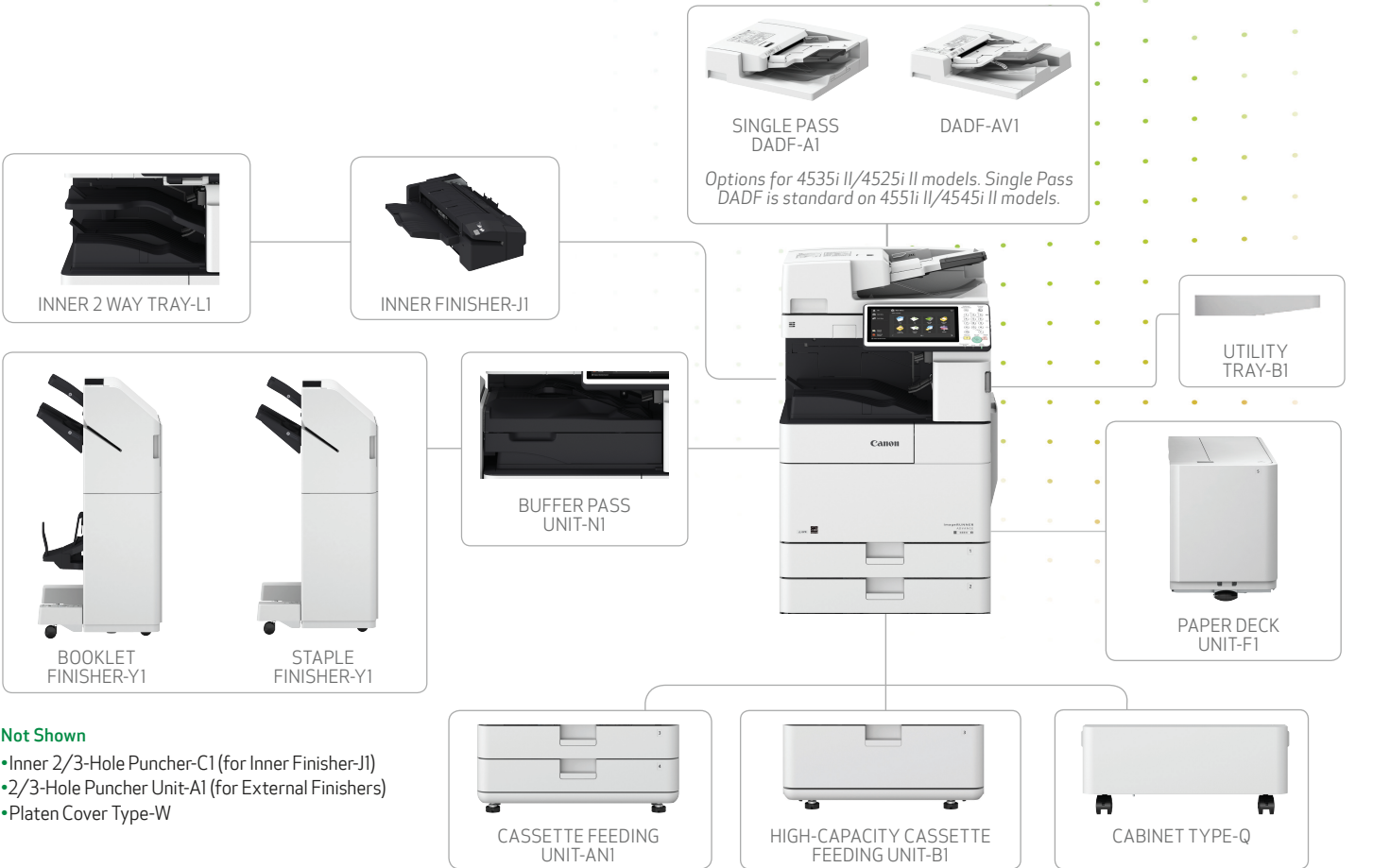

- Not Shown**
- Inner 2/3-Hole Puncher-C1 (for Inner Finisher-J1)
  - 2/3-Hole Puncher Unit-A1 (for External Finishers)
  - Platen Cover Type-W

### Main Unit

**Type**  
Monochrome Laser Multifunctional

**Core Functions**  
Standard: Print, Copy, Scan, Send, Store  
Optional: Fax

**Processor**  
Canon Dual Custom Processor (Shared)

**Control Panel**  
10.1" TFT LCD WSVGA Color Touch-panel

**Memory**  
3.0 GB RAM

**Hard Disk Drive**  
Standard: 250 GB  
Maximum: 1 TB

**Mirroring Hard Disk Drive**  
Optional (250 GB, 1 TB)  
Method: Raid1

**Print Resolution**  
1200 dpi x 1200 dpi

### Interface Connection

**Network**  
Standard: 1000Base-T/100Base-TX/10Base-T, Wireless LAN (IEEE 802.11b/g/n)  
Optional: NFC, Bluetooth

**Others**  
Standard: USB 2.0 x2 (Host), USB 3.0 x1 (Host), USB 2.0 x1 (Device)  
Optional: Serial Interface, Copy Control Interface

### Paper Capacity (LTR, 20 lb. Bond)

Standard: 1,185 Sheets  
Maximum: 6,335 Sheets

### Paper Sources (LTR, 20 lb. Bond)

Standard: Two 550-sheet Paper Cassettes, 85-sheet Stack Bypass

Optional: Two 550-sheet Paper Cassettes (Cassette Feeding Unit-AN1), 2,450-sheet Paper Deck (High Capacity Cassette Feeding Unit-B1), 2,700-sheet Paper Deck (Paper Deck Unit-F1)

### Paper Output Capacity (LTR, 20 lb. Bond)

Standard: 250 Sheets  
Maximum: 3,350 Sheets (with External Finishers)

### Finishing Capabilities

Standard: Collate, Group  
With Inner Finisher: Collate, Group, Offset, Staple, Hole Punch,<sup>1</sup> Staple-Free Staple, Staple On Demand  
With External Finisher: Collate, Group, Offset, Staple, Booklet,<sup>2</sup> Staple-Free Staple, Staple On Demand, Hole Punch<sup>3</sup>

### Supported Media Types

Paper: Thin, Plain, Recycled, Color, Heavy  
Cassettes: Pre-punched  
Stack Bypass: Thin, Plain, Recycled, Color, Heavy, Pre-punched, Bond, Transparency, Label, Envelope

### Supported Media Sizes

Paper Cassette (1): Legal, Letter, Letter-R, Executive, Statement-R, Custom Size (5-1/2" x 7-1/8" to 11-3/4" x 15-3/8")  
Paper Cassette (2): 11" x 17", Legal, Letter, Letter-R, Executive, Statement-R, Custom Size (5-1/2" x 7-1/8" to 11-3/4" x 17")  
Stack Bypass: 11" x 17", Legal, Letter, Letter-R, Executive, Statement-R, Envelope [No.10 (COM10), Monarch, DL, ISO-C5], Custom Size (3-7/8" x 5-7/8" to 11-3/4" x 17")

## Supported Media Weights

Paper Cassettes: 16 lb. Bond to 34 lb. Bond (60 to 128 g/m<sup>2</sup>)  
Stack Bypass: 14 lb. Bond to 80 lb. Cover (52 to 220 g/m<sup>2</sup>)  
Duplexing: 16 lb. Bond to 28 lb. Bond (60 to 105 g/m<sup>2</sup>)

## Warm-up Time

From Power On: 24 Seconds or Less  
From Deep Sleep Mode: 10 Seconds or Less  
Quick Startup Mode: 4 Seconds<sup>4</sup>

## Dimensions (W x D x H)

23-1/8" x 29-1/8" x 47" (587 mm x 740 mm x 1,193 mm)<sup>5</sup>

## Installation Space (W x D)

Basic [With ADF (Stack Bypass and Cassette Drawers Open)]: 35" x 46-1/2" (889 mm x 1,182 mm)  
Fully Configured [With ADF+Paper Deck Unit-F1+Booklet Finisher-Y1 (Cassette Drawers Open)]: 71-3/8" x 50-3/8" (1,811 mm x 1,280 mm)

## Weight

Approx. 240.7 lb. (109.2 kg)<sup>6</sup>

## Print Specifications

### Print Speed

455i II:	Up to 51 ppm (Letter); Up to 37 ppm (Letter-R); Up to 25 ppm (Legal); Up to 25 ppm (11" x 17")
4545i II:	Up to 45 ppm (Letter); Up to 32 ppm (Letter-R); Up to 25 ppm (Legal); Up to 22 ppm (11" x 17")
4535i II:	Up to 35 ppm (Letter); Up to 32 ppm (Letter-R); Up to 25 ppm (Legal); Up to 22 ppm (11" x 17")
4525i II:	Up to 25 ppm (Letter); Up to 17 ppm (Letter-R); Up to 13 ppm (Legal); Up to 15 ppm (11" x 17")

## Standard Page Description Languages

UFR II, PCL<sup>®</sup> 6, Adobe<sup>®</sup> PS<sup>®</sup> 3

## Direct Print

Available from USB, Advanced Box, Remote UI, and Web Access (Opt.)<sup>7</sup>

## Supported File Types for Direct Print

PDF, TIFF, JPEG, EPS, XPS

## Printing from Mobile Devices and Cloud-based Services

A range of software and MEAP-based solutions are available to provide printing from mobile devices or Internet-connected devices and cloud-based services depending on your requirements.

## Fonts

PCL fonts: 93 Roman, 10 Bitmap fonts, 2 OCR fonts, Andalé Mono WT J/K/S/T (Japanese, Korean, Simplified and Traditional Chinese),<sup>8</sup> Barcode Fonts<sup>9</sup>

PS fonts: 136 Roman

## Operating System<sup>10</sup>

UFR II: Windows Vista<sup>®</sup>/Server 2008/Windows<sup>®</sup> 7/Server 2008 R2/Server 2012/Windows 8.1/Server 2012 R2/Windows 10/Server 2016, MAC OS X (10.7 or later)  
PCL: Windows Vista/Server 2008/Windows 7/Server 2008 R2/Server 2012/Server 2012 R2/Windows 10/Server 2016  
PS: Windows Vista/Server 2008/Windows 7/Server 2008 R2/Server 2012/Windows 8.1/Server 2012 R2/Windows 10/Server 2016, MAC OS X (10.7 or later)  
PPD: MAC OS X (10.3.9 or later), Windows Vista/Windows 7/Windows 8/Windows 8.1/Windows 10

## Print Features

Suspend Job Timeout, Subset Finishing (PS only), Profile Settings, Secured Print, Forced Hold Printing, Watermark, Page Border, Header/Footer, Page Layout, Two-sided Printing, Collating, Booklet Printing, Grouping, Mixed Paper Sizes/Orientations, Offsetting, Printing on Transparencies, Front/Back Covers, Toner Reduction, Poster Printing

## Copy Specifications

### Copy Speed

455i II:	Up to 51 ppm (Letter); Up to 37 ppm (Letter-R); Up to 25 ppm (Legal); Up to 25 ppm (11" x 17")
4545i II:	Up to 45 ppm (Letter); Up to 32 ppm (Letter-R); Up to 25 ppm (Legal); Up to 22 ppm (11" x 17")
4535i II:	Up to 35 ppm (Letter); Up to 32 ppm (Letter-R); Up to 25 ppm (Legal); Up to 22 ppm (11" x 17")
4525i II:	Up to 25 ppm (Letter); Up to 17 ppm (Letter-R); Up to 13 ppm (Legal); Up to 15 ppm (11" x 17")

### First-Copy-Out Time (Letter)

455i II:	As fast as 3.7 seconds
4545i II:	As fast as 3.8 seconds
4535i II:	As fast as 3.8 seconds
4525i II:	As fast as 5.2 seconds

### Copy Resolution (dpi)

Reading: Up to 600 x 600  
Printing: 1200 x 1200

### Multiple Copies

Up to 999 Copies

### Copy Exposure

Automatic or Manual (9 Levels)

### Magnification

25%-400% (1% Increments)

### Preset Reductions

25%, 50%, 64%, 73%, 78%

### Preset Enlargements

121%, 129%, 200%, 400%

### Basic Copy Features

Preset Reduction/Enlargement Ratios by Area, Paper Setting, Previous Settings, Favorite Settings, Finishing, Two-Sided, Density Adjustment, Original Type Selection, Interrupt Mode, Setting Confirmation/Cancel

### Special Copy Features

Book to Two Pages, Two-sided Original, Finishing, Booklet, Job Build, N on 1, Add Cover, Insert Sheets, Different-size Originals, Density Adjustment, Original Type Selection, Transparency Cover Sheets, Page Numbering, Copy Set Numbering, Sharpness, Erase Frame, Secure Watermark, Print Date, Shift, Gutter, Print & Check, Negative/Positive, Repeat Images, Merge Job Blocks, Job Done Notice, Mirror Image, Store in Mail Box, Superimpose Image, Copy ID Card, Detect Feeder Multi Sheet Feed, Free Size Original

## Scan Specifications

### Type

455i II/4545i II:	Standard Single Pass Duplexing Automatic Document Feeder
4535i II/4525i II:	Optional Single Pass Duplexing Automatic Document Feeder or Duplexing Automatic Document Feeder

### Document Feeder Paper Capacity

Single Pass DADF-A1: 150 Sheets (20 lb. Bond)  
DADF-AV1: 100 Sheets (20 lb. Bond)

### Document Feeder Supported Media Sizes

11" x 17", Legal, Letter, Letter-R, Statement, Statement-R

### Document Feeder Supported Media Weights

Single Pass DADF-A1	
BW Original:	13 lb. Bond to 58 lb. Cover (50 to 157 g/m <sup>2</sup> )
CL Original:	17 lb. Bond to 58 lb. Cover (64 to 157 g/m <sup>2</sup> )
DADF-AV1	
BW Original:	13 lb. Bond to 34 lb. Bond (50 to 128 g/m <sup>2</sup> )
CL Original:	17 lb. Bond to 34 lb. Bond (64 to 128 g/m <sup>2</sup> )

### Platen Acceptable Originals

Sheet, Book, 3-Dimensional Objects [Up to 4.4 lb. (2 kg)]

## Pull Scan

Color Network ScanGear2 for both Twain and WIA  
Supported OS: Windows Vista/7/8.1/10  
Windows Server 2008/Server 2008 R2/Server 2012/Server 2012 R2/Server 2016

## Scan Resolution (dpi)

600 x 600, 400 x 400, 300 x 300, 200 x 400, 200 x 200, 200 x 100, 150 x 150, 100 x 100

## Scan to Mobile Devices and Cloud-based Services

A range of solutions is available to provide scanning to mobile devices and cloud-based services depending on your requirements.

## Scan Speed (Letter)

Single Pass DADF-A1  
Single-sided Scanning  
BW: 80 ipm (300 dpi)/80 ipm (600 dpi)  
Color: 80 ipm (300 dpi)/60 ipm (600 dpi)  
Double-sided Scanning  
BW: 160 ipm (300 dpi)/150 ipm (600 dpi)  
Color: 160 ipm (300 dpi)/80 ipm (600 dpi)  
DADF-AV1  
Single-sided Scanning  
BW: 70 ipm (300 dpi)/51 ipm (600 dpi)  
Color: 70 ipm (300 dpi)/51 ipm (600 dpi)  
Double-sided Scanning  
BW: 35 ipm (300 dpi)/25.5 ipm (600 dpi)  
Color: 35 ipm (300 dpi)/25.5 ipm (600 dpi)

## Send Specifications

### Destination

E-mail/Internet Fax (SMTP), SMB, FTP, WebDAV, Mail Box, Super G3 Fax (Optional), IP Fax (Optional)

### Color Mode

Automatic-Color Select (Full Color/Grayscale), Automatic-Color Select (Full Color/Black-and-White), Full color, Grayscale, and Black-and-White

### Address Book

LDAP (2,000)/Local (1,600)/Speed dial (200)

### Send Resolution (dpi)

600 x 600, 400 x 400, 300 x 300, 200 x 400, 200 x 200, 200 x 100, 150 x 150, 100 x 100

### Communication Protocol

File: FTP, SMB v3.0, WebDAV  
E-mail/I-Fax: SMTP, POP3, I-Fax (Simple, Full)

### File Format

Standard: TIFF, JPEG, PDF (Encrypted, Compact, Searchable, Apply Policy, Optimize for Web, PDF A/1-b), XPS (Compact, Searchable), Office Open XML (PowerPoint<sup>®</sup>, Word), Digital Signature (PDF/XPS)  
Optional: PDF (Trace & Smooth)

### Universal Send Features

Original Type Selection, Two-sided Original, Book to Two Pages, Different-size Originals, Density Adjustment, Sharpness, Copy Ratio, Erase Frame, Job Build, Delayed Send, Preview, Finished Stamp, Job Done Notice, File Name, Subject/Message, Reply-to, E-mail Priority, TX Report, Original Content Orientation, Skip Blank Originals, Detect Feeder Multi Sheet Feed

## Fax Specifications

### Maximum Number of Connection Lines

4

### Modem Speed

Super G3: 33.6 Kbps  
G3: 14.4 Kbps

### Compression Method

MH, MR, MMR, JBIG

### Resolution (dpi)

400 x 400, 200 x 400, 200 x 200, 200 x 100

### Sending/Recording Size

Statement-R to 11" x 17"

### Fax Memory

Up to 30,000 Pages

### Speed Dials

Max. 200

### Group Dials/Destinations

Max. 199 Dials

### Sequential Broadcast

Max. 256 Addresses

### Memory Backup

Yes

### Fax Features

Original Type Selection, Two-sided Original, Book to Two Pages, Different-size Originals, Density for Scanning, Sharpness, Copy Ratio, Erase Frame, Job Build, Specifying the Sender's Name (when sending fax), Sender's Name (TTI), Select Line, Selecting the Telephone Line (when sending fax), Direct Send, Delayed Send, Preview, Finished Stamp, Job Done Notice, TX Report, Detect Feeder Multi Sheet Feed

## Store Specifications

### Mail Box (Number Supported)

100 User In-boxes, 1 Memory RX In-box, 50 Confidential Fax In-boxes, 30,000 Maximum Pages Stored

### Advanced Box

Communication Protocol: SMB or WebDAV

Supported

Client PC: Windows (Windows Vista/7/8/8.1/10)

Concurrent Connections (Max.)

SMB: 64

WebDAV: 3 (Active Sessions)

### Advanced Box Available Disk Space

Approx. 16 GB (Standard HDD)

Approx. 480 GB (1 TB HDD)

### Advanced Box Features

Disabling Advanced Box, Storage Filtering, Authentication for Advanced Box Log-in, Search Function, Sort Function, Printing a PDF File with a Password, imageWARE Secure Audit Manager Support

### Memory Media

Standard: USB

## Security Specifications

### Authentication

Standard: Universal Login Manager, uniFLOW Online Express,<sup>11,12</sup> User Authentication, Department ID Authentication, Access Management System, Device and Function Level Log-in

Optional: uniFLOW

### Data

Standard: Trusted Platform Module (TPM), Hard Disk Password Lock, Hard Disk Drive Erase, Mail Box Password Protection, Hard Disk Drive Encryption (FIPS140-2 Validated)

Optional: Hard Disk Drive Mirroring, Hard Disk Drive removal, IEEE 2600.2 Common Criteria Certification, Data Loss Prevention (Requires uniFLOW)

### Network

Standard: Encrypted Secure Print, IP/Mac Address Filtering, IPsec, TLS Encrypted Communication, SNMP V3.0, IEEE 802.1X, IPv6, SMTP Authentication, POP Authentication before SMTP

### Document

Standard: Secure Watermark, Secure Print, Forced Hold Printing, Adobe LiveCycle® Rights Management ES2.5 Integration, Encrypted PDF, Encrypted Secure Print, Device Signatures

Optional: User Signatures, Document Scan Locking

## Environmental Specifications

### Operating Environment

Temperature: 50 to 86°F  
Humidity: 20 to 80% RH (no condensation)

### Power Requirements

455li II: 120-127 V AC, 60 Hz, 10.4A  
4545i II/4535i II: 120-127 V AC, 60 Hz, 9.3A  
4525i II: 120-127 V AC, 60 Hz, 7A

### Plug (Main Unit)

NEMA 5-15P

### Power Consumption

Maximum: Approx. 1.5 kWh  
Standby: Approx. 38 W  
Sleep Mode: Approx. 0.9 W<sup>13</sup>  
Typical Electricity Consumption (TEC) Rating:  
455li II: 2.5 kWh  
4545i II: 2.2 kWh  
4535i II: 1.8 kWh  
4525i II: 1.0 kWh

### Standards

ENERGY STAR® Certified  
Rated EPEAT® Gold<sup>4</sup>  
RoHS Compliant

## Consumables

### Toner

GPR-57 Toner BK

### Toner Yield (Estimated @ 6% Coverage)

Black: 42,100 Images

## Paper Supply Options

### CASSETTE FEEDING UNIT-ANI

Paper: 550 sheets x 2 Cassettes  
Capacity: [20 lb. Bond (80 g/m<sup>2</sup>)]  
Paper Type: Thin, Plain, Recycled, Color, Heavy, Pre-punched

Paper Size: 11" x 17", Legal, Letter, Letter-R, Executive, Statement-R, and Custom Size [5-1/2" x 7-1/8" to 11-3/4" x 17" (139.7 x 182.0 to 297.0 x 431.8 mm)]

Paper Weight: 16 lb. Bond to 34 lb. Bond (60 to 128 g/m<sup>2</sup>)  
Power Source: From the Main Unit  
Dimensions: 22-1/4" x 25-5/8" x 9-3/4"  
(W x D x H): (565 mm x 650 mm x 248 mm)  
Weight: 51.8 lb. (23.5 kg)

### HIGH CAPACITY CASSETTE FEEDING UNIT-BI

Paper: 2,450 sheets [20 lb. Bond (80 g/m<sup>2</sup>)]  
Capacity:  
Paper Type: Thin, Plain, Recycled, Color, Heavy, Pre-punched

Paper Size: Letter  
Paper Weight: 16 lb. Bond to 34 lb. Bond (60 to 128 g/m<sup>2</sup>)  
Power Source: From the Main Unit  
Dimensions: 22-1/4" x 25-5/8" x 9-3/4"  
(W x D x H): (565 mm x 650 mm x 248 mm)  
Weight: 61.7 lb. (28 kg)

### PAPER DECK UNIT-FI

Paper: 2,700 Sheets [20 lb. Bond (80 g/m<sup>2</sup>)]  
Capacity:  
Paper Type: Thin, Plain, Recycled, Color, Heavy, Pre-punched

Paper Size: Letter  
Paper Weight: 16 lb. Bond to 34 lb. Bond (60 to 128 g/m<sup>2</sup>)  
Power Source: From the Main Unit  
Dimensions: 15-3/4" x 24-7/8" x 17-3/8"  
(W x D x H): (400 mm x 630 mm x 440 mm)  
Weight: 68.3 lb. (31 kg)

## Output Options

### INNER 2-WAY TRAY-LI

Number of Trays: 2  
Total Output Capacity  
Upper Tray: 100 Sheets  
Lower Tray: 250 Sheets  
Paper Weight: 14 lb. Bond to 80 lb. Cover (52 to 220 g/m<sup>2</sup>)  
Paper Size (Standard): 11" x 17", Legal, Letter, Letter-R, Executive, Statement-R, Envelope [No.10 (COM10), Monarch, DL, ISO-C5], Custom Size (3-7/8" x 5-7/8" to 11-3/4" x 17")  
Dimensions (W x D x H): 16-3/4" x 16-1/4" x 4-1/4" (426 mm x 413 mm x 109 mm)  
Weight: 1.7 lb (0.77 kg)

### INNER FINISHER-JI

Number of Trays: 2  
Top Tray: Letter/Statement-R/Executive (45 Sheets), 11" x 17"/Legal/Letter-R (45 Sheets)  
Lower Tray: Letter/Statement-R/Executive (500 Sheets), 11" x 17"/Legal/Letter-R (250 Sheets)  
Paper Weight: 14 lb. Bond to 80 lb. Cover (52 to 220 g/m<sup>2</sup>)  
Staple Position: Corner, Double  
Staple Capacity  
Corner Staple and Double Staple  
Letter/  
Executive: 50 Sheets (14 to 24 lb. Bond) 11" x 17"/Legal/  
Letter-R: 30 Sheets (14 to 24 lb. Bond)  
Staple-Free Staple:  
11"x17"/Letter: 5 Sheets [14 to 17 lb. Bond ((52 to 64 g/m<sup>2</sup>)]  
4 Sheets [17.3 to 21.7 lb. Bond (65 to 81.4 g/m<sup>2</sup>)]  
3 Sheets [21.7 to 28 lb. Bond (81.5 to 105 g/m<sup>2</sup>)]

Staple On Demand: 40 Sheets [20 lb. Bond (80 g/m<sup>2</sup>)]  
Power Source: From the Main Unit  
Dimensions: 25" x 21-1/8" x 8-1/8"  
(W x D x H): (636 mm x 535 mm x 205 mm)  
Weight: Approx. 15.9 lb (7.2 kg)

### STAPLE FINISHER-YI (External)

Number of Trays: 2  
Top Tray: Letter/Executive/Statement-R (250 Sheets), 11" x 17"/Legal/Letter-R (125 Sheets)  
Lower Tray: Letter/Executive/Statement-R (3,000 Sheets), 11" x 17"/Legal/Letter-R (1,500 Sheets)  
Paper Weight  
Top Tray: 14 lb. Bond to 80 lb. Cover (52 to 220 g/m<sup>2</sup>)  
Lower Tray: 14 lb. Bond to 80 lb. Cover (52 to 220 g/m<sup>2</sup>)

Staple Position: Corner, Double  
Staple Capacity  
Corner Staple and Double Staple  
Letter/  
Executive: 50 Sheets [24 lb. Bond (90 g/m<sup>2</sup>)] 11" x 17"/Legal/  
Letter-R: 30 Sheets [24 lb. Bond (90 g/m<sup>2</sup>)]  
Staple-Free Staple  
11"x17"/Letter: 5 Sheets [14 to 17 lb. Bond ((52 to 64 g/m<sup>2</sup>)]  
4 Sheets [17.3 to 21.7 lb. Bond (65 to 81.4 g/m<sup>2</sup>)]  
3 Sheets [21.7 to 28 lb. Bond (81.5 to 105 g/m<sup>2</sup>)]

Staple On Demand: 50 Sheets [24 lb. Bond (90 g/m<sup>2</sup>)]  
Power Source: From the Main Unit  
Dimensions: 25-1/8" x 24-1/2" x 45"  
(W x D x H): (637 mm x 623 mm x 1,142 mm)<sup>13</sup>  
Weight: Approx. 68.3 lb (31 kg)

## BOOKLET FINISHER-Y1 (External)

Number of Trays:	2
Top Tray Capacity:	Letter/Executive/Statement-R (250 Sheets), 11" x 17"/Legal/Letter-R (125 Sheets)
Lower Tray Capacity:	Letter/Executive/Statement-R (3,000 Sheets), 11" x 17"/Legal/Letter-R (1,500 Sheets)
Paper Weight Top Tray:	14 lb. Bond to 80 lb. Cover (52 to 220 g/m <sup>2</sup> )
Lower Tray:	14 lb. Bond to 80 lb. Cover (52 to 220 g/m <sup>2</sup> )
Staple Position:	Corner, Double
Staple Capacity:	Corner Staple and Double Staple
Letter/Executive:	50 Sheets [24 lb. Bond (90 g/m <sup>2</sup> ) 11" x 17"/Legal/
Letter-R:	30 Sheets [24 lb. Bond (90 g/m <sup>2</sup> )
Staple-Free Staple 11"x17"/Letter:	5 Sheets [14 to 17 lb. Bond ((52 to 64 g/m <sup>2</sup> )] 4 Sheets [17.3 to 21.7 lb. Bond (65 to 81.4 g/m <sup>2</sup> )] 3 Sheets [21.7 to 28 lb. Bond (81.5 to 105 g/m <sup>2</sup> )]
Staple On Demand:	50 Sheets [24 lb. Bond (90 g/m <sup>2</sup> )
Booklet-Stitch Paper Size:	11" x 17", Legal, Letter-R, Custom Size (7-3/4" x 10-5/8" to 11-3/4" x 17")
Booklet-Stitch Staple Capacity:	20 Sheets x 10 Sets [22 lb. Bond (81 g/m <sup>2</sup> )] [including one cover sheet up to 80 lb. Cover (220 g/m <sup>2</sup> )]
Power Source:	From the Main Unit
Dimensions (W x D x H):	25-1/8" x 24-1/2" x 45" (637 mm x 623 mm x 1,142 mm) <sup>13</sup>
Weight:	Approx. 125.7 lb (57 kg)

## INNER 2/3-HOLE PUNCHER-C1

(Requires the Inner Finisher-J1)

Acceptable Punch Paper Weight:	14 lb. Bond to 80 lb. Cover (52 to 220 g/m <sup>2</sup> )
Acceptable Punch Paper Size:	Two holes: 11" x 17", Legal, Letter, Letter-R, Executive Three holes: 11" x 17", Letter, Executive
Power Source:	From the Main Unit

## 2/3-HOLE PUNCHER UNIT-A1

(Requires either the Staple Finisher-Y1 or Booklet Finisher-Y1)

Acceptable Punch Paper Weight:	14 lb. Bond to 80 lb. Cover (52 to 220 g/m <sup>2</sup> )
Acceptable Punch Paper Size:	Two holes: 11" x 17", Legal, Letter, Letter-R, Executive Three holes: 11" x 17", Letter, Executive
Power Source:	From the Main Unit

## Additional Hardware Options

### Card Readers

MICARD PLUS PROXIMITY CARD READER  
COPY CARD READER-F1  
COPY CARD READER ATTACHMENT-B5

### Others

PLATEN COVER TYPE W  
ENVELOPE FEEDER ATTACHMENT KIT-D1  
UTILITY TRAY-B1  
USB KEYBOARD

## Security Options

### Document Security

DOCUMENT SCAN LOCK KIT-B1  
iR-ADV SECURITY KIT-S1 FOR IEEE 2600 COMMON CRITERIA CERTIFICATION<sup>16</sup>

### Data Security

HDD MIRRORING KIT-J1  
2.5"/250 GB HDD-N1  
2.5"/1 TB HDD-P1  
REMOVABLE HDD KIT-AL1

## System and Controller Options

### Print Accessories

PCL INTERNATIONAL FONT SET-A1

### Barcode Printing

BARCODE PRINTING KIT-D1

### System Accessories

WEB ACCESS SOFTWARE-K1  
SERIAL INTERFACE KIT-K3  
COPY CONTROL INTERFACE KIT-A1  
CONNECTION KIT-A1 FOR BLUETOOTH LE  
NFC KIT-C1  
MEAP WEB CONNECTION KIT-G3<sup>17</sup>

## Fax Accessories

SUPER G3 FAX BOARD-AS2  
SUPER G3 2ND LINE FAX BOARD-AS2  
SUPER G3 3RD/4TH LINE FAX BOARD-AS2  
REMOTE FAX KIT-A1  
IP FAX EXPANSION KIT-B1

## Other Options

### Accessibility Accessories

ADF ACCESS HANDLE-A1  
VOICE GUIDANCE KIT-G1  
VOICE OPERATION KIT-D1  
BRAILLE LABEL KIT-F1

### Consumables

STAMP INK CARTRIDGE-C1  
STAPLE-P1  
STAPLE CARTRIDGE-Y1

- <sup>1</sup> Requires the optional Inner 2/3 Hole Puncher-C1.
- <sup>2</sup> Booklet Finisher-Y1 only.
- <sup>3</sup> Requires the optional 2/3 Hole Puncher Unit-A1.
- <sup>4</sup> Time from device power-on to when copy jobs can be programmed.
- <sup>5</sup> Includes Main Unit, Single Pass DADF-A1, and Cassette Feeding Unit-AN1.
- <sup>6</sup> Includes Main Unit, Single Pass DADF-A1, Cassette Feeding Unit-AN1, and consumables.
- <sup>7</sup> PDF print from Web sites is supported.
- <sup>8</sup> Requires the optional PCL International Font Set-A1.
- <sup>9</sup> Requires the optional Barcode Printer Kit-D1.
- <sup>10</sup> Other operating systems and environments including AS/400, UNIX, Linux and Citrix may be supported. Some of these solutions are chargeable. SAP Device Types are available via the SAP Market Place. For more information, contact your sales representative.
- <sup>11</sup> No charge for this solution; however activation is required.
- <sup>12</sup> Check for availability.
- <sup>13</sup> 0.9 W Sleep mode is not available in all circumstances due to certain settings.
- <sup>14</sup> For current EPEAT rating (Gold/Silver/Bronze), please visit [www.epeat.net](http://www.epeat.net).
- <sup>15</sup> When the extension tray is extended.
- <sup>16</sup> Will launch at a later date.
- <sup>17</sup> No charge for this option; however it does need to be ordered.

For more information, call or visit  
1.800.815.4000 CSA.CANON.COM



**Canon**

CANON SOLUTIONS AMERICA

As an ENERGY STAR® Partner, Canon U.S.A., Inc. has certified these models as meeting the ENERGY STAR energy efficiency criteria through an EPA recognized certification body. ENERGY STAR and the ENERGY STAR mark are registered U.S. marks. AirPrint and the AirPrint logo are trademarks of Apple Inc. Canon, imageRUNNER, imageWARE, imagePASS, and the GENUINE logo are registered trademarks or trademarks of Canon Inc. in the United States and may also be registered trademarks or trademarks in other countries. II indicates that this model has been upgraded to new system software and includes additional security features as standard. All other referenced product names and marks are trademarks of their respective owners. All printer output images are simulated. All features presented in this brochure may not apply to all Series and/or products and may be optional; please check with your Canon Authorized Dealer for details. Products shown with optional accessories. Canon U.S.A. does not provide legal counsel or regulatory compliance consultancy, including without limitation, Sarbanes-Oxley, HIPAA, GLBA, Check 21 or the USA Patriot Act. Each customer must have its own qualified counsel determine the advisability of a particular solution as it relates to regulatory and statutory compliance. Specifications and availability subject to change without notice. Not responsible for typographical errors.  
©2018 Canon U.S.A., Inc. All rights reserved.

CSA/18-048  
0218-CSAIRA45xxIISS-PDF-SP

**UFP** UNIFIED FIRMWARE PLATFORM



**CANON GENUINE** TONER, CARTRIDGE & PARTS

