



Transporter Springs 2013



OE-Standard

We produce springs according to OE-standard.

According to the specification we use the following materials:

- 60SiCr7
- 50CrV4
- 51CrMoV4

All our springs are stress peened to give them a higher durability.

Special paint guarantees the best surface protection.



IMPORTANT:

Make sure that the U-bolts are properly fastened, otherwise the centre-area will break!

**TRUST IN
LS GERMANY LEAF SPRINGS!**



Inhalt / Content

Bedford	1
Chevrolet	1
Chrysler	1
Citroen	1
Daihatsu	1
Fiat	1
Ford	2
Freight Rover	3
Hyundai	3
Isuzu	3
Iveco	4
Jeep	4
Mazda	4
Mercedes	4
Mitsubishi	5
Nissan	6
Opel	6
Peugeot	6
Renault	6
Suzuki	7
Tata	7
Toyota	7
Vauxhall	7
Volkswagen	8
Cross Reference List.....	9

Type List

Type	from	to	F/R	No. of Leaves	Width	LSG	- Part No.	Notes	Length front	Length rear
Bedford										
Rascal Van	02.86	07.93	R	3+1	50	LSG	290110		500	500
Midi Van	01.85	08.97	R	3+1	60	LSG	290130		650	550
Astramax Van	09.84	02.94	R	1P	70	LSG	290150		685	630
Chevrolet										
Astro	85	95	R	3+1	76	LSG	330210	Pick up	650	740
Astro	96		R	3+1	63	LSG	330230	Pick up	710	660
Blazer 4WD K20	73	91	R	4+1	63	LSG	330250		660	660
Pickup CK1500-2500	88	94	R	4+1	63	LSG	330270		810	810
Pickup CK1500-2500	88	94	R	3+1	63	LSG	330290		810	810
Suburban CK10-20	73	87	R	7+1	63	LSG	330310		660	762
Suburban CK20-30	73	87	R	8+1	63	LSG	330330		660	762
Suburban CK10	88	91	R	5+1	63	LSG	330350		660	762
Van G10-20	71	91	R	4+1	57	LSG	330370		610	710
Van G10-20	71	91	R(HD)	5+1	57	LSG	330390		610	710
Van G20	92	95	R	4+1	57	LSG	330410		660	710
Van G30	71	91	R	7+1+1	57	LSG	330430	length 1320mm	610	710
Van G30	82	91	R	7+1	57	LSG	330450	length 1370mm	660	710
Van S10	83	94	R	3+1	63	LSG	330470		660	710
Chrysler										
Voyager	88	95	R	3	63	LSG	330150		750	680
Citroen										
C25/C25D 1800 (280)	09.81	01.94	R	2+2	65	LSG	671390	all models	650	650
C25/C25D 1800 (290)	07.90	03.94	R	2+2	65	LSG	671390	all models	650	650
Relay/Jumper 1000 Van (230)	03.94	04.02	R	1P	80	LSG	673130		715	715
Relay/Jumper 1400 Van (230)	03.94	04.02	R	1P	80	LSG	673150		715	715
Relay/Jumper 1800 Van (230)	03.94	04.02	R	1P	80	LSG	673170		715	715
Relay/Jumper all (230)	03.94	04.02	R(HD)	2P	80	LSG	673250		715	715
reinforcement kit for R/J (244)	03.94	04.02	R	1	80	LSG	673177			
Relay/Jumper 1000 Van (244)	04.02	03.06	R	1P	80	LSG	673130		715	715
Relay/Jumper 1400 Van (244)	04.02	03.06	R	1P	80	LSG	673150		715	715
Relay/Jumper 1800 Van (244)	04.02	03.06	R	1P	80	LSG	673170		715	715
Relay/Jumper all (244)	04.02	03.06	R(HD)	2P	80	LSG	673250		715	715
reinforcement kit for R/J (244)	04.02	03.06	R	1	80	LSG	673177			
Relay/Jumper	04.06		R	1	70	LSG	673190		715	715
Relay/Jumper	04.06		R	2	70	LSG	673270		715	715
Daihatsu										
Feroza 1,6 F300	10.88		R	3+1	60	LSG	810270		550	620
Feroza 1,6 F300	10.88		R	1+1	60	LSG	810290		535	600
Fourtrak/Rocky F70-F95	01.84	07.93	F	2	60	LSG	810100	all models	650	520
Fourtrak/Rocky F70,F80 SWB	01.84	07.93	R	3+1	60	LSG	810150	all models	620	550
Fourtrak/Rocky F75,F85,F95 LWB	01.84	08.93	R	4+1	60	LSG	810130		620	550
Sportrak F300 Series	10.88	04.98	R	3+1	60	LSG	810170		600	535
Sportrak F300 Series	08.93	05.97	R	1P+1	60	LSG	810190		600	535
Hi-Jet S85 Van	92		R	2+2	60	LSG	810210		500	500
Fiat										
New Fiorino	01.90	98	R	1P	70	LSG	679250		670	650
Doblo	01		R	1P	70	LSG	680010		595	665
Ducato (280)	09.81	01.90	R	2+2	65	LSG	671390	up to 1890 kg	650	650
Ducato (290)	07.90	03.94	R	2+2	65	LSG	671390	up to 1890 kg	650	650
Ducato 10Q (233)	03.94	04.02	R	1P	80	LSG	673130		715	715

Type	from	to	F/R	No. of Leaves	Width	LSG	- Part No.	Notes	Length front	Length rear
Ducato 14Q (233)	03.94	04.02	R	1P	80	LSG	673150		715	715
Ducato 18Q (233)	03.94	04.02	R	1P	80	LSG	673170		715	715
reinforcement (233)	03.94	04.02	R	1	80	LSG	673177			
Ducato 10-18Q (244)	04.02	06	R(HD)	2P	80	LSG	673250		715	715
Ducato 10Q (244)	04.02	06	R	1P	80	LSG	673130		715	715
Ducato 14Q (244)	04.02	06	R	1P	80	LSG	673150		715	715
Ducato 18Q (244)	04.02	06	R	1P	80	LSG	673170		715	715
reinforcement kit (244)	04.02	06	R	1	80	LSG	673177			
Ducato 10-18Q (244)	04.02	06	R(HD)	2P	80	LSG	673250		715	715
Ducato Multijet	07.06		R	1	70	LSG	673190		715	715
Ducato Multijet	07.06		R	2	70	LSG	673270		715	715
Ducato Multijet	07.06		R	1P+1	70	LSG	675170		715	715

Ford

Escort Van 35	09.80	07.90	R	1P	60	LSG	200310	350 kg	597	597
Escort Van 55	09.80	07.90	R	1P	60	LSG	200330	550 kg	597	597
Escort Van 40	08.90	01.95	R	1P+1	60	LSG	200350	500 kg	670	620
Escort Van 55	01.94		R	1P+1	60	LSG	200350	500 kg	670	620
Escort Van 60	08.90	01.94	R	1P+1	60	LSG	200370	700 kg	670	620

Transit

Transit All	11.85	2000	F	1P	60	LSG	200020		516	684
Transit 80 Van&Minibus	11.85	08.91	R(HD)	2+1	60	LSG	200010	Minibus 9 Seats	685	685
Transit 100 Van	11.85	08.91	R(HD)	2+1	60	LSG	200010		685	685
Transit 120 Van	11.85	08.91	R	2+1	60	LSG	200010		685	685
Transit 120 Chassis-Cab	11.85	08.91	R	1P	60	LSG	200130		685	685
Transit 190 Van Minibus	11.85	08.91	R	2+1	60	LSG	200110		755	635
Transit 190 Chassis-Cab	11.85	08.91	R	2+1	60	LSG	200110		755	635
Transit 100L Van	11.85	08.91	R	2+1	60	LSG	200070		755	635
Transit 80 Van&Minibus	09.91	2000	R(HD)	2+1	60	LSG	200050	Minibus 9 Seats	685	675
Transit 100 Van	09.91	2000	R(HD)	2+1	60	LSG	200050		685	675
Transit 120 Van&Minibus	09.91	2000	R	2+1	60	LSG	200050	Minibus 9 Seats	685	675
Transit 120 Chassis-Cab	09.91	2000	R	1P	60	LSG	200150		695	675
Transit 190 Van Minibus	09.91	2000	R	2+1	60	LSG	200030	Single Rear Wheel	695	675
Transit 190 Chassis-Cab	09.91	2000	R	2+1	60	LSG	200030	Single Rear Wheel	695	675
Transit 190 H/D	09.91	2000	R(HD)	2+1	60	LSG	200790		695	675
Transit 190-190 EF	08.92	2000	R	2+1	60	LSG	200170	Twin Rear Wheel	695	675
Transit 190-190 EF	08.92	2000	R(HD)	2+1	60	LSG	200810		695	675
Transit 100L Van Minibus	09.91	2000	R	2+1	60	LSG	200210		695	675
Transit 100L Van highroof	09.91	2000	R	2+1	60	LSG	200210		695	675
Transit 100L Chassis Cab	09.91	2000	R	2+1	60	LSG	200210		695	675
Transit 150L Van highroof	06.91	08.94	R	2+1	60	LSG	200210		695	675
Transit 100A 2.5D	08.92	2000	R	2+1	60	LSG	200230		695	677
Transit 80AA 2.5D	08.92	2000	R	2+1	60	LSG	200250		695	680
Transit 150S Van&Minibus	09.91	2000	R	2+1	60	LSG	200270	Minibus 9 Seats	695	680
Transit 80 Van&Minibus	09.91	2000	R	1P	60	LSG	200290		695	675
Transit 100 Van&Minibus	09.91	2000	R	1P	60	LSG	200290		695	675
Transit 100S, 100 Bus	92	2000	R	2+1	60	LSG	200390		695	675

Ford Transit 2000

FWD/RWD=front/rear wheel driven

SWB/MWB/LWB=short/medium/long base

260 SWB FWD	99	06	R	1P	60	LSG	200410		698	672
280 SWB FWD	99	06	R	1P	60	LSG	200410		698	672
280 LWB RWD	99	06	R	2P	60	LSG	200470		694	674
300 SWB FWD	99	06	R	1P	60	LSG	200410		698	672
300 SWB RWD	99	06	R	2P	60	LSG	200470		694	674
300 SWB FWD Chassis Cab.	99	06	R	1P	60	LSG	200430		698	672
300 SWB RWD Chassis Cab.	99	06	R	2P+1	60	LSG	200610		697	683
300 MWB RWD	99	06	R	2P	60	LSG	200470		694	674

Type	from	to	F/R	No. of Leaves	Width	LSG	- Part No.	Notes	Length front	Length rear
300 MWB FWD Chassis Cab.	99	06	R	1P	60	LSG	200430		698	672
300 MWB RWD Chassis Cab.	99	06	R	2P+1	60	LSG	200610		697	683
300 LWB RWD	99	06	R	2P	60	LSG	200470		694	674
300 LWB RWD Chassis Cab.	99	06	R	2P+1	60	LSG	200610		697	683
330 SWB RWD	99	06	R	2P	60	LSG	200470		694	674
330 SWB RWD Chassis Cab.	99	06	R	2P+1	60	LSG	200610		697	683
330 MWB RWD	99	06	R	2P	60	LSG	200470		694	674
330 MWB RWD	99	06	R	2P+1	60	LSG	200610		697	683
330 MWB RWD Chassis Cab.	99	06	R	2P+1	60	LSG	200610		697	683
330 LWB RWD	99	06	R	2P	60	LSG	200470		694	674
330 LWB RWD				2P+1	60	LSG	200610		697	683
350 MWB RWD	99	06	R	2P	60	LSG	200470		694	674
350 MWB RWD Chassis Cab.				2P+1	60	LSG	200670		697	683
350 LWB RWD	99	06	R	2P	60	LSG	200470		694	674
350 LWB RWD Chassis Cab.				2P+1	60	LSG	200670		697	683
300 - 350 RWD HD	99	06	R	2P+1	60	LSG	200690		697	683
430 LWB RWD	99	06	R	2P+1	60	LSG	200870		697	683

Ford Transit 2006 TT9

2,2-3,2L	07.06		R	1P	75	LSG	200910		695	675
2,2-3,2L	07.06		R	1P+1	75	LSG	200950		694	674
2,2-3,2L	07.06		R	2P+1	75	LSG	200930		695	675

Ford Transit Connect

SWB 65	02	03.05	R	1+1	60	LSG	565080		662	593
SWB 65	03.05		R	1	60	LSG	565085		662	593
SWB 80	02.04		R	1+1	60	LSG	565082		662	593
LWB 80	02		R	1+1	60	LSG	565083		662	593
LWB 900	02		R	1+1	60	LSG	565083		662	593

Ford Ranger

Ranger 2WD ER	98	11.02	R	3+2	60	LSG	200830		670	530
Ranger 4WD ER	99	11.02	R	3+2	60	LSG	200850		670	530
Ranger 2WD EQ	06.02	06	R	3+2	60	LSG	200830		670	530
Ranger 4WD EQ	06.02	06	R	3+2	60	LSG	200850		670	530
Ranger 2WD ET	06		R	3+2	60	LSG	200890		580	745
Ranger 4WD ET	06		R	3+2	60	LSG	200891		580	745

Freight Rover

Sherpa 310,350	9.93		R	1		LSG	530110		682	661
285, 310	83		R	1		LSG	530130		682	661
350A	83		R	1		LSG	530150		682	661
210(2.8, 3.1)	83		R	1		LSG	530190		682	661
Ambulance	83		R	1		LSG	530210		682	661
LDV200/Pilot	04.89		R	2P	60	LSG	530230	2.6-2.8 Pick up chassis cab	640	610
LDV200/Pilot	04.89		R	1P	60	LSG	530250	2.0-2,4 to	597	553
LDV200/Pilot	04.89		F	1P	60	LSG	530100	2,0-2,6 to	596	553
LDV400/Convoy	04.89		F	1P	60	LSG	530120	2,8-3,5 to	640	610
LDV400/Convoy	04.89		R	1P	75	LSG	530270	Twin Rear Wheel	662	662

Hyundai

H100 VL3/VL6	03.95		R	3+1	70	LSG	390010		525	675
H1	10.98	01.05	R	3+1	70	LSG	390030		525	675
H1	05.04		R	3+1	70	LSG	390050		525	675

Isuzu

Campo 2WD	88	02	R	3+1	60	LSG	840190		555	650
Campo 4WD	88	02	R	3+1	60	LSG	840210		550	650
Trooper UBS 16/17	87	12.92	R	3+1	60	LSG	840110		550	650
Trooper UBS 52/55	87	12.92	R	3+1	60	LSG	840130		550	650

Type	from	to	F/R	No. of Leaves	Width	LSG	- Part No.	Notes	Length front	Length rear
Euro Midi Van	88	96	R	3+1	60	LSG	840150		550	650
Van WFR Series	80		R	3+1	60	LSG	840170		550	650
D-Max 4WD	10.07		R	4+1	60	LSG	840230		600	600
D-Max 4WD	10.07		R(HD)	5+1	60	LSG	840250		600	600

Iveco

Daily/Turbo Daily 35	90		R	1	80	LSG	679270		750	750
Daily 40	90		R	4+2	60	LSG	672810		715	700
Daily 35	99		F	1	80	LSG	673120	Composite Spring	660	660

Jeep

Cherokee Jeep XJ	84	01	R	4	60	LSG	330110		584	727
Cherokee Jeep XJ (H/D)	84	01	R	5	60	LSG	330130		584	727

Mazda

B-series Pick-up

B2000 UF	01.85	99	R	5+2	60	LSG	545150		530	670
B2200 UF	01.85	99	R	5+2	60	LSG	545150		530	670
B2200 2WD UN	06.99	06	R	3+2	60	LSG	545230		530	670
B2200 4WD UN	06.99	06	R	3+2	60	LSG	545250		530	670
B2500 UF	87	06.99	R	5+2	60	LSG	545210		530	670
B2500 2WD UN	06.99	06	R	3+2	60	LSG	545230		530	670
B2500 4WD UN	06.99	06	R	3+2	60	LSG	545250		530	670
B2600 UF	87	06.99	R	5+2	60	LSG	545210		530	670
B2600 2WD UN	06.99	06	R	3+2	60	LSG	545230		530	670
B2600 4WD UN	06.99	06	R	3+2	60	LSG	545250		530	670

BT50 Pick-up

2WD UN	06		R	3+2	60	LSG	545270		580	745
4WD UN	06		R	3+2	60	LSG	545290		580	743

E2000 SR Van	01.85	08.99	R	3+2	60	LSG	545110		550	650
E2000 SR Van	9.99		R	3+2	60	LSG	545130		555	650
E2200 SR Van	01.85	03.97	R	3+2	60	LSG	545110		550	650
E2200 SR Van	03.97	08.99	R	3+2	60	LSG	545310		550	650
E2200 SR Van	9.99		R	3+2	60	LSG	545130		555	650

Mercedes

207D, 208D, 209D	10.77		F	2	60	LSG	305200	1,5 to	610	690
207D, 208D, 209D	10.77		F	3	60	LSG	315100	1,65to	610	690
207D, 208D, 209D	91		F	2	60	LSG	315180	1,5 to similar 305200	611	687
207D, 208D, 209D	91		F	3	60	LSG	315100	1,65to	610	690
207D, 208D, 209D	10.77		R	2+1	60	LSG	315290	1,65to repl. for all old nos.	740	810
207D, 208D, 209D	10.77		R	3+1	60	LSG	315870	2,2 to repl. for all old nos.	740	803
307D, 309D	10.77		F	2	60	LSG	305200	1,5 to	610	690
308, 310	10.77		F	2	60	LSG	305200	1,5 to	610	690
307D, 308, 309D, 310	10.77		F	3	60	LSG	315100	1,65 to	610	690
410,410D	10.77		F	3	60	LSG	315100	1,65 to	610	690
307D, 308D, 309D	10.77		R	3+1	60	LSG	315870	2,2 to	740	803
L407D, L409D, L410		09.93	F	2	60	LSG	315260	1,65 to	610	690
407D, 409D, 410D		05.95	R	4+1	70	LSG	315470	3,2 to	870	790

Sprinter 208D -214D	01.95	03.00	F	1P	110	LSG	337020	2,8 to	650	650
Sprinter 308D -314D	01.95	03.00	F	2P	110	LSG	337040	3,5 to	650	650
Sprinter 308D -314D	01.95	03.00	F(H/D)	2P	100	LSG	337060	4,6 to	650	650
Sprinter 408D -414D	01.95	03.00	F	2P	100	LSG	337060	4,6 to	650	650
Sprinter 208D-214D	01.95	03.00	R	1P	70	LSG	337070	2,8 to	740	753
Sprinter 308D -314D	01.95	03.00	R	1P	70	LSG	337130	3,5 to	740	753
reinforcement kit for 337130	01.95	03.00	R	1P	70	LSG	337137			
Sprinter 308D -314D	01.95	03.00	R	1+1	70	LSG	337150	3,5 to	740	753

Type	from	to	F/R	No. of Leaves	Width	LSG	- Part No.	Notes	Length front	Length rear
reinforcement kit for 337150	01.95	03.00	R	1P	70	LSG	337157			
Sprinter 408D -414D	01.95	03.00	R	2+1	70	LSG	337210	4,6 to	740	753
Sprinter 408D -414D	01.95	03.00	R	2+1	70	LSG	337250	4,6 to	740	753
Sprinter 308D -314D	01.95	03.00	R	1P	70	LSG	337170	3,5 to special Chassis	740	753
Sprinter 308D -314D	01.95	03.00	R	1P	70	LSG	337190	3,2 to special Chassis	740	753
Sprinter 408D -414D	01.95	03.00	R	1P	70	LSG	337230	4,6 to special Chassis	740	753
Sprinter 208CDi -216CDi	04.00	05.06	F	1P	110	LSG	337020	2,8 to	650	650
Sprinter 308CDi -316CDi	04.00	05.06	F	2P	110	LSG	337040	3,5 to	650	650
Sprinter 408CDi -416CDi	04.00	05.06	F	2P	100	LSG	337060	4,6 to	650	650
Sprinter 413CDi, 416CDi	04.00	05.06	F	2P	100	LSG	337200	4,6 to	650	650
Sprinter 616CDi, 616TDi	04.00	05.06	F	1	100	LSG	337400	6,0 to Composite Spring	650	650
Sprinter 208CDi -216CDi	04.00	05.06	R	1P	70	LSG	337090	2,8 to	740	753
Sprinter 308CDi -316CDi	04.00	05.06	R	1P	70	LSG	337310	3,5 to	740	753
Sprinter 308CDi -316CDi	04.00	05.06	R	1P	70	LSG	337430	3,5 to	740	753
Sprinter 308CDi -316CDi	04.00	05.06	R	1P	70	LSG	337510	3,5 to	740	753
Sprinter 308CDi -316CDi	04.00	05.06	R	2+1	70	LSG	337550	3,5 to	740	753
Sprinter 308CDi -316CDi	04.00	05.06	R	1+1	70	LSG	337610	3,5 to	740	753
Sprinter 308CDi -316CDi	04.00	05.06	R	2P	70	LSG	337450	3,5 to	740	753
Sprinter 308CDi -316CDi	04.00	05.06	R	1+1	70	LSG	337470	3,5 to	740	753
Sprinter 308CDi -316CDi	04.00	05.06	R	2P	70	LSG	337350	3,5 to	740	753
Sprinter 408CDi -416CDi	04.00	05.06	R	1+1	70	LSG	337330	4,6 to	740	753
Sprinter 408CDi -416CDi	04.00	05.06	R	2+1	70	LSG	337490	4,6 to	740	753
Sprinter 408CDi -416CDi	04.00	05.06	R	2+1	70	LSG	337370	4,6 to	740	753
Sprinter 408CDi -416CDi	04.00	05.06	R	2+1	70	LSG	337390	4,6 to	740	753
Sprinter 408CDi -416CDi	04.00	05.06	R	2+1	70	LSG	337670	4,6 to	740	753
Sprinter 616CDi, 616TDi	04.00	05.06	R	2+1	70	LSG	337410	6,0 to	740	753
Sprinter 224-318CDI	06.06		F	1	100	LSG	337440	3,5 to Composite Spring	650	650
Sprinter 524,509CDI-518CDI	06.06		F	1	100	LSG	337460	5,0 to Composite Spring	650	650
Sprinter 224, 209CDI -218CDI	06.06		R	1P	70	LSG	337710	3,0 to	740	753
Sprinter 224, 209CDI -218CDI	06.06		R	1P	70	LSG	337830	3,0 to	740	753
Sprinter 224, 209CDI -318CDI	06.06		R	1P+1	70	LSG	337850	3,0 to	740	753
Sprinter 224, 309CDI -318CDI	06.06		R	1P	70	LSG	337710	3,5 to	740	753
Sprinter 324, 309CDI -318CDI	06.06		R	1P	70	LSG	337830	3,5 to	740	753
Sprinter 324, 309CDI -318CDI	06.06		R	1P+1	70	LSG	337850	3,5 to	740	753
Sprinter 324, 309CDI -318CDI	06.06		R	2P	70	LSG	337750	3,5 to	740	753
Sprinter 524,509CDI-518CDI	06.06		R	2P+1	70	LSG	339550	5,0 to	740	753
Sprinter 524,509CDI-518CDI	06.06		R	2P+1	70	LSG	337810	5,0 to	740	753
Sprinter 524,509CDI-518CDI	06.06		R	2P	70	LSG	339530	5,0 to	740	753
Mitsubishi										
Shogun SWB	01.83	05.95	R	3+1	70	LSG	360230		685	515
Shogun SWB	01.83	05.95	R(HD)	4+1	70	LSG	360130		685	515
Shogun LWB	01.83	05.95	R	5+1	70	LSG	360150		685	515
Pajero SWB	01.83	05.95	R	3+1	70	LSG	360230		685	515
Pajero SWB	01.83	05.95	R(HD)	4+1	70	LSG	360130		685	515
Pajero LWB	01.83	05.95	R	5+1	70	LSG	360150		685	515
L200 series Van/Pick Up	87	96	R	4+2	70	LSG	360170		510	695
L200 series Van/Pick Up 4X4	01.96	06	R	3+2	70	LSG	360250		685	515
L200 series Van/Pick Up 4X4	01.96	06	R	4+2	70	LSG	360270		685	515
L200 series Van/Pick Up 2X4	01.96	06	R	4+1	70	LSG	360310		520	690
L200 KA4T	01.07		R	4+2	70	LSG	360270		685	515
L200 KB4T	11.05		R	4+1	70	LSG	360350		520	690
L 200 KB4T	11.05		R(HD)	5+1	70	LSG	360370		520	690
L200 KB4T	11.05		R	4+2	70	LSG	360410		520	690
L300 Series 2x4	1987	1996	R	2+1	70	LSG	360190		685	520
L300 Series 4x4	1987	1996	R	3+1	70	LSG	360290		685	520
L400	03.95		R	3+1	60	LSG	360330		525	675

Type	from	to	F/R	No. of Leaves	Width	LSG	- Part No.	Notes	Length front	Length rear
Nissan										
Cabstar			R	3+2	60	LSG	370110		640	640
Hardbody D22	01.06		R	2+2	60	LSG	370530		565	635
Interstar	02		R	1	70	LSG	370550		715	715
Patrol (160)	11.79	08.88	F	4	60	LSG	370100		550	550
Patrol (160)	11.79	08.88	R	4	60	LSG	370150		825	610
Patrol (160)	11.79	08.88	R	3+2	60	LSG	370130		550	550
Patrol SWB (260)	05.86	11.95	F	2	60	LSG	370400		640	600
Patrol LWB (260)	05.86	11.95	F	3	60	LSG	370420		645	590
Patrol SWB/LWB (260)	05.86	11.95	R	5+2	60	LSG	370310		800	620
Urvan (E24)	02.87	05.97	R	2+2	60	LSG	370170		685	565
Vanette C22 1,5,2,0D	09.86	12.95	R	4	60	LSG	370210		625	525
Vanette C23 Cargo SWB	93		R	3+1	60	LSG	370290		615	505
Vanette C23 Cargo LWB	93		R	4+1	60	LSG	370510		610	500
King Cab D 21 4x2	09.85		R	2+2	60	LSG	370230		605	605
King Cab D21 4x4	09.85	06.98	R	2+2	60	LSG	370250		565	625
King Cab D22	02.98		R	2+2	60	LSG	370530		565	635
King Cab D40	05		R	3+1	60	LSG	370370		670	740
Pick up D 21 4x2	09.85		R	2+2	60	LSG	370230		605	605
Pick up D21 4x4	09.85	06.98	R	2+2	60	LSG	370250		565	625
Pick up D22	02.98		R	2+2	60	LSG	370530		565	635
Navara D22	02.98		R	2+2	60	LSG	370530		565	635
Pick up D40	05		R	3+1	60	LSG	370370		670	740
Navara D40	05		R	3+1	60	LSG	370370		670	740
Serena SWB	07.92		R	3+1	60	LSG	370290		615	505
Serena LWB	07.92		R	4+1	60	LSG	370510		610	500
NP300 Pick up D22	01.08		R	2+2	60	LSG	370530		565	635

Opel

Arena	97	01	R	1	70	LSG	461375		635	635
Combo	07.94	10.01	R	1	70	LSG	461376		635	685
Campo 2WD			R	3+1	60	LSG	461374		555	650
Campo 4WD			R	3+1	60	LSG	461373		555	650
Frontera SWB 3 doors			R	3+1	60	LSG	461372		550	660
Frontera LWB 5 doors			R	3+1	60	LSG	461371		550	660
Movano	98		R	1P	70	LSG	380210		715	715
Movano, reinforcement kit	98		R	1P	70	LSG	380157			

Peugeot

J5 1800 kg	09.81	03.94	R	2+2	65	LSG	671390	Van/Chassis Cab	650	650
Boxer 1000 (233)	03.94	04.02	R	1P	80	LSG	673130	Van/Chassis Cab	715	715
Boxer 1400 (233)	03.94	04.02	R	1P	80	LSG	673150	Van/Chassis Cab	715	715
Boxer 1400 (233)	03.94	04.02	R	1P	80	LSG	673150	Minibus	715	715
Boxer 1800 (233)	03.94	04.02	R	1P	80	LSG	673170	Van/Chassis Cab	715	715
Boxer 1000-1800 (233)	03.94	04.02	R(H/D)	2P	80	LSG	673250		715	715
reinforcement kit for Boxer (233)	03.94	04.02	R	1	80	LSG	673177			
Boxer 1000 (244 + ZCT)	04.02	03.06	R	1P	80	LSG	673130	Van/Chassis Cab	715	715
Boxer 1400 (244 + ZCT)	04.02	03.06	R	1P	80	LSG	673150	Van/Chassis Cab	715	715
Boxer 1400 (244 + ZCT)	04.02	03.06	R	1P	80	LSG	673150	Minibus	715	715
Boxer 1800 (244 + ZCT)	04.02	03.06	R	1P	80	LSG	673170	Van/Chassis Cab	715	715
Boxer 1000-1800 (244+ ZCT)	04.02	03.06	R(H/D)	2P	80	LSG	673250		715	715
reinforcement kit (244+ZCT)	04.02	03.06	R	1	80	LSG	673177			
Boxer	04.06		R	1	70	LSG	673190		715	715
Boxer	04.06		R	2	70	LSG	673270		715	715

Renault

Master T35	05.80	02.89	R	1P	70	LSG	380110		683	683
------------	-------	-------	---	----	----	-----	--------	--	-----	-----

Type	from	to	F/R	No. of Leaves	Width	LSG	- Part No.	Notes	Length front	Length rear
Master P35	05.80	89	R	1+1P	70	LSG	380130		688	688
Master II	98	10	R	1P	70	LSG	380150		715	715
Master III	11		R	1P	70	LSG	380150		715	715
reinforcement kit for Master	98		R	1P	70	LSG	380157			
Traffic T series	81	03.01	R	1P	70	LSG	380170		632	632
Traffic TE series	03.89		R	2P	70	LSG	380190		632	632

Suzuki

Carry Van	04.86	99	R	3+1	50	LSG	980110	SK410	500	495
SJ4104x4	06.82	90	R	3+1	50	LSG	980130	incl. Santana	500	500
SJ413 4x4	05.85	12.95	R	3+1	50	LSG	980150	incl Samurai	500	500
SJ410,SJ413 4x4	06.82	12.95	F	3	50	LSG	980100		470	465

Tata

Laodbeta Pick Up	94		R	4+2+1		LSG	890110			
------------------	----	--	---	-------	--	-----	--------	--	--	--

Toyota

Landcruiser

BJ42	81	04.86	F	6	70		250300		600	555
BJ42	81	04.86	R	6	70		250310		610	505
BJ45	81	04.86	F	7	70		250320		600	500
BJ45	81	04.86	R	6	70		250330		600	500
HJ45	84	04.86	F	7	70		250340		605	500
HJ45	84	04.86	R	6+3	70		250350		675	660
BJ60/HJ60/FJ62	08.80	12.90	F	6	70	LSG	250100		555	555
BJ60/HJ60/FJ62	08.80	12.90	R	5+1	70	LSG	250110		650	575
BJ60/HJ60/FJ62	08.80	12.90	R	8	70		250370		640	560
HJ61	80	90	R	7	70		250390		640	560
BJ73/BJ75	84	90	F	6	70		250360		590	560
BJ73/BJ75	84	90	R	6+2	70		250410		600	600

Hi-Lux

RN36,46	79	07.83	F	4	60	LSG	250120		580	580
RN50,55/LN50-56	08.83	07.94	R	3+2	60	LSG	250250		670	535
LN60-67/YN60-67	08.83	07.98	F	4	60	LSG	250120		580	580
LN60-67/YN60-67	08.83	07.98	R	4+2	60	LSG	250190		685	525
LN85/YN85/LN108/RN106	08.88	08.97	R	3+2	60	LSG	250250		670	535
LN85/YN85/VZN85	08.88	08.92	R	5	60		250430		740	560
LN105/YN106	08.88	12.97	F	5	60	LSG	250180	Also VW Taro	580	580
LN105/ YN106	08.88	12.97	R	4+3	60	LSG	250210	Also VW Taro	690	520
LN110/RN106,110/YN110	08.88	08.97	R	3+1	60	LSG	250450		740	560
LN165/RNZ168	08.97	12.99	R	4+2	60	LSG	250270		755	540
LN170/RZN173/KDN170	11.97	01.05	R	3+2	60	LSG	250470		740	560
KDN165	01	01.05	R	4+2	60	LSG	250590		565	743
KUN25/26	07.05	10.08	R	3+2	60	LSG	250610		610	695
KUN25/26	07.05	10.08	R(HD)	4+2	60	LSG	250630		610	695
KUN25/26	10.08		R	3+2	60	LSG	250610		610	695
KUN25/26	10.08		R(HD)	4+2	60	LSG	250630		610	695
Hi-Ace Van	12.82	08.87	R	3+1	60	LSG	250130	YH6-Series	670	535
Hi-Ace Van	08.89	08.93	R	3+1+1	60	LSG	250150	LH&RZH Series	670	530
Lite-Ace Van	10.85	01.94	R	2+1	60	LSG	250170		670	530

Vauxhall

Brava Pick Up 1t	12.88		R	3+1	60	LSG	461372	4x2	550	660
Frontera 3 Door SWB	03.92	01.95	R	3+1	60	LSG	461372	Sport	550	660
Frontera 5 Door LWB	03.92	01.95	R	3+1	60	LSG	461371	Estate	550	660

Type	from	to	F/R	No. of Leaves	Width	LSG	- Part No.	Notes	Length front	Length rear
Movano Van	98		R	1P	70	LSG	260170		715	715
Corsa Combo Van	10.93		R	1P	70	LSG	260190	Also Astramax	685	630

Volkswagen

Caddy	08.86	07.92	R	1P+1+1	60	LSG	951110		668	640
Taro Pick Up All Modells	02.89	03.97	F/RH	5	60	LSG	952100	Type 7A	575	575
Taro Pick Up All Modells	02.89	03.97	F/LH	5	60	LSG	952120	Type 7A	575	575
Taro Pick Up 4x2	02.89	03.97	R	4+3	60	LSG	952110	Type 7A	518	612
LT 28	98		F	1P	110	LSG	337020		650	650
LT 28	75		R	1+1	60	LSG	950830	46 mm bush	654	558
LT 28	75		R	4+2	60	LSG	950890	46 mm bush	654	558
LT 28	75		R	2+1	60	LSG	950910	46 mm bush	654	558
LT 28	75		R	2+1+1	60	LSG	950990	46 mm bush	638	722
LT 28	98		R	1P	70	LSG	337070	30 mm bush	740	750
LT 35	98		F	2P	110	LSG	337040		650	650
LT 35	75		R	1+1	60	LSG	950850	46 mm bush	638	722
LT 35	75		R	3+1	60	LSG	950870	46 mm bush	638	722
LT 35	98		R	1P	70	LSG	337130		740	750
LT 35	98		R	1P	70	LSG	337190		740	750
LT 35	98		R	1+1	70	LSG	337150		740	750
LT 40			R	2+1	60	LSG	950930	46 mm bush	775	775
LT 40			R	2+1	60	LSG	950930	46 mm bush	775	775
LT 40	98		R	2+1	70	LSG	337210		740	750
LT 45	75		R	3+1	60	LSG	950870	46 mm bush	638	722
LT 45			F	2	60	LSG	950800	46 mm bush	750	750
LT 45	98		F	2P	100	LSG	337060		650	650
LT 45	75	98	F	2+1	60	LSG	950820		750	750
LT 50			R	2+1	60	LSG	951070		775	775
LT 55			F	2+1	60	LSG	950900		750	750
LT 55			R	1+1+1	60	LSG	951050		775	775
Crafter 30-50 3,5 to	06.06		F	1	100	LSG	337440	3,5 to Composite Spring	650	650
Crafter 30-50 5,0 to	06.06		F	1	100	LSG	337460	5,0 to Composite Spring	650	650
Crafter 30-50 3,5 to	06.06		R	1P	70	LSG	337710	3,0 to	740	753
Crafter 30-50 3,5 to	06.06		R	1P	70	LSG	337830	3,0 to	740	753
Crafter 30-50 3,5 to	06.06		R	1P+1	70	LSG	337850	3,0 to	740	753
Crafter 30-50 3,5 to	06.06		R	1P	70	LSG	337710	3,5 to	740	753
Crafter 30-50 3,5 to	06.06		R	1P	70	LSG	337830			
Crafter 30-50 3,5 to	06.06		R	1P+1	70	LSG	337850	3,5 to	740	753
Crafter 30-50 3,5 to	06.06		R	2P	70	LSG	337750	3,5 to	740	753
Crafter 30-50 5,0 to	06.06		R	2P+1	70	LSG	339550			
Crafter 30-50 5,0 to	06.06		R	2P+1	70	LSG	337810	5,0 to	740	753
Crafter 30-50 5,0 to	06.06		R	2P	70	LSG	339530	5,0 to	740	753

Cross Reference List

Manufacturer	Part No.	OE-Part-No.	OE-Part-No.	Part No.
Bedford	290110	91125012	90222241	290150
Bedford	290130	91122032	91122032	290130
Bedford	290150	90222241	91125012	290110
Chrysler	330110	5602-213-4MA	5200-005-44MA	330130
Chrysler	330130	5200-005-44MA	5602-213-4MA	330110
Citroen	671390	7567244	1306357080	673130
Citroen	673130	1306357080	1311824080	673150
Citroen	673150	1311824080	1311825080	673170
Citroen	673170	1311825080	7567244	671390
Daihatsu	810100	48110-87630	48110-87630	810100
Daihatsu	810130	48210-87632	48200-87556	810210
Daihatsu	810150	48210-87628	48210-87628	810150
Daihatsu	810170	48210-87658	48210-87632	810130
Daihatsu	810190	48210-87659	48210-87658	810170
Daihatsu	810210	48200-87556	48210-87658	810270
Daihatsu	810270	48210-87658	48210-87659	810190
Daihatsu	810290	48210-87659	48210-87659	810290
Fiat	671390	7567244	46774754	680010
Fiat	673130	1306357080	7567244	671390
Fiat	673150	1311824080	7739125	679250
Fiat	673190	7700314662	1306357080	673130
Fiat	673250	1326233080	1311824080	673150
Fiat	673270	HD for 673190	1326233080	673250
Fiat	675170	1357567080/1350011080	7700314662	673190
Fiat	679250	7739125	1357567080/1350011080	675170
Fiat	680010	46774754	HD for 673190	673270
Ford	200010	86VB5560BD	1C15 5560 PE	200430
Ford	200020	86VB5310CB	6C11 5560 EC	200950
Ford	200030	95VB5560MA	6C11 5560 GB	200910
Ford	200050	95VB5560GA	6C11 5560 HB	200930
Ford	200070	86VB5560NB	81AB5560LB	200330
Ford	200110	86VB5560FE	81AB5560MA	200310
Ford	200130	86VB5560KB	86VB5310CB	200020
Ford	200150	95VB5560CA	86VB5560BD	200010
Ford	200170	95VB5560RA	86VB5560FE	200110
Ford	200210	95VB5560HA	86VB5560KB	200130
Ford	200230	95VB5560SA	86VB5560NB	200070
Ford	200250	95VB5560TA	91AB5560LE	200350
Ford	200270	95VB5560DA	95AB5560SA	200370
Ford	200290	95VB5560AB	95VB5560AB	200290
Ford	200310	81AB5560MA	95VB5560CA	200150
Ford	200330	81AB5560LB	95VB5560DA	200270
Ford	200350	91AB5560LE	95VB5560EB	200390
Ford	200370	95AB5560SA	95VB5560GA	200050
Ford	200390	95VB5560EB	95VB5560HA	200210
Ford	200410	YC15 5560CC	95VB5560MA	200030
Ford	200430	1C15 5560 PE	95VB5560RA	200170
Ford	200470	YC15 5560HD	95VB5560SA	200230
Ford	200490	YC15 5560 KJ/KG	95VB5560TA	200250
Ford	200610	YC15 5560BF/SF	UH7128L10A	200850
Ford	200670	YC15 5560 VH	UH7128L10B	200830
Ford	200690	YC15 5560 ZG	VIC15 550 HA	200870

Manufacturer	Part No.	OE-Part-No.	OE-Part-No.	Part No.
Ford	200830	UH7128L10B	YC15 5560 KJ/KG	200490
Ford	200850	UH7128L10A	YC15 5560 VH	200670
Ford	200870	VIC15 550 HA	YC15 5560 ZG	200690
Ford	200910	6C11 5560 GB	YC15 5560BF/SF	200610
Ford	200930	6C11 5560 HB	YC15 5560CC	200410
Ford	200950	6C11 5560 EC	YC15 5560HD	200470
Freight Rover	530100	DAR3918	AAR6597	530110
Freight Rover	530110	AAR6597	AAR6926	530130
Freight Rover	530120	DAR4330	DAR3702	530270
Freight Rover	530130	AAR6926	DAR3918	530100
Freight Rover	530230	DAR3923	DAR3920	530250
Freight Rover	530250	DAR3920	DAR3923	530230
Freight Rover	530270	DAR3702	DAR4330	530120
Isuzu	840110	94233-3800	94124-5440	840170
Isuzu	840130	94438-6450	94233-3800	840110
Isuzu	840150	94450-1810	94438-6450	840130
Isuzu	840170	94124-5440	94450-1810	840150
Iveco	672810	93805008	93805008	672810
Iveco	673120	Composite 500316837	500358299	679270
Iveco	679270	500358299	Composite 500316837	673120
Mazda	545110	SH0528L10A	SB7228010C	545130
Mazda	545130	SB7228010C	SH0528L10A	545110
Mazda	545150	UB7128010A	UB7128010A	545150
Mercedes	305200	602 320 0202/0302	601 320 2106/2206	315290
Mercedes	315100	611 320 0302/0502	602 320 0202/0302	305200
Mercedes	315180	602 320 2502/2602/3502	602 320 2502/2602/3502	315180
Mercedes	315260	611 320 1002	602 320 3006/4306	315870
Mercedes	315290	601 320 2106/2206	611 320 0302/0502	315100
Mercedes	315470	611 320 2106/2206/3706	611 320 1002	315260
Mercedes	315870	602 320 3006/4306	611 320 2106/2206/3706	315470
Mercedes	337000	901 320 0601	901 320 0601	337000
Mercedes	337010	901 320 1606/1706	901 320 1606/1706	337010
Mercedes	337020	902 320 0401	902 320 0401	337020
Mercedes	337040	903 320 0001	902 320 1006/1106	337070
Mercedes	337060	904 320 0301/0401	902 320 1506	337090
Mercedes	337070	902 320 1006/1106	903 320 0001	337040
Mercedes	337090	902 320 1506	903 320 0406/0506	337130
Mercedes	337130	903 320 0406/0506	903 320 0606/0706	337150
Mercedes	337150	903 320 0606/0706	903 320 0806	337190
Mercedes	337170	903 320 1006	903 320 1006	337170
Mercedes	337190	903 320 0806	903 320 1606	337310
Mercedes	337200	904 320 0501	903 320 1706	337430
Mercedes	337210	904 320 0506/0606	903 320 1806	337470
Mercedes	337230	904 320 0806	903 320 1906	337350
Mercedes	337250	904 320 0706	903 320 2006	337550
Mercedes	337310	903 320 1606	903 320 2106	337450
Mercedes	337350	903 320 1906	903 320 2606	337510
Mercedes	337370	904 320 1606	903 320 2906	337610
Mercedes	337390	904 320 1906	904 320 0301/0401	337060
Mercedes	337400	904 320 0601	904 320 0501	337200
Mercedes	337410	905 320 0006	904 320 0506/0606	337210
Mercedes	337430	903 320 1706	904 320 0601	337400
Mercedes	337440	906 320 0903/1003	904 320 0706	337250
Mercedes	337450	903 320 2106	904 320 0806	337230
Mercedes	337460	906 320 1103/1203	904 320 1406	337490
Mercedes	337470	903 320 1806	904 320 1606	337370

Manufacturer	Part No.	OE-Part-No.	OE-Part-No.	Part No.
Mercedes	337490	904 320 1406	904 320 1906	337390
Mercedes	337510	903 320 2606	904 320 2006	337670
Mercedes	337550	903 320 2006	905 320 0006	337410
Mercedes	337610	903 320 2906	906 320 0206	337810
Mercedes	337670	904 320 2006	906 320 0406	337850
Mercedes	337710	906 320 1806	906 320 0903/1003	337440
Mercedes	337750	906 320 2006	906 320 1103/1203	337460
Mercedes	337810	906 320 0206	906 320 1806	337710
Mercedes	337830	906 320 3206	906 320 2006	337750
Mercedes	337850	906 320 0406	906 320 3006	339550
Mercedes	339530	906 320 4306	906 320 3206	337830
Mercedes	339550	906 320 3006	906 320 4306	339530
Mitsubishi	360110	MB339051	DMX411903	360150
Mitsubishi	360130	MB339052	MB339051	360110
Mitsubishi	360150	DMX411903	MB339051	360230
Mitsubishi	360170	MB515307	MB339052	360130
Mitsubishi	360190	MB584026	MB515307	360170
Mitsubishi	360210	MB584028	MB584026	360190
Mitsubishi	360230	MB339051	MB584028	360210
Mitsubishi	360270	MR353079	MR353079	360270
Nissan	370100	54010-G9604	54010-G9604	370100
Nissan	370110	55020-S1438	54010-G9805	370420
Nissan	370130	55020-C8500	55020-0C016	370270
Nissan	370150	55020-G9802	55020-15N20	370170
Nissan	370170	55020-15N20	55020-7C000	370510
Nissan	370190	55020-9C510	55020-9C510	370190
Nissan	370210	55020-G6105	55020-9C510	370290
Nissan	370230	55020-QW001B	55020-C8500	370130
Nissan	370250	55020-QW002B	55020EB300	370370
Nissan	370270	55020-0C016	55020-G6105	370210
Nissan	370290	55020-9C510	55020-G9802	370150
Nissan	370370	55020EB300	55020-QW001B	370230
Nissan	370420	54010-G9805	55020-QW002B	370250
Nissan	370510	55020-7C000	55020-S1438	370110
Nissan	370530	55020VK313	55020VK313	370530
Opel	380210	7703-14-662	7703-14-662	380210
Opel	461371	91142083	91140061	461372
Opel	461372	91140061	91142083	461371
Opel	461373	424 382	424 381	461374
Opel	461374	424 381	424 382	461373
Peugeot	671390	4478130	4478130	671390
Renault	380110	7702-257081	41110-83001	980100
Renault	380170	7702-25-7089	41310-80010	980130
Renault	380190	7702-25-7016	41310-80020	980150
Suzuki	980100	41110-83001	41310-85120	980110
Suzuki	980110	41310-85120	7702-25-7016	380190
Suzuki	980130	41310-80010	7702-257081	380110
Suzuki	980150	41310-80020	7702-25-7089	380170
Tata	890110	2654.3240.0124	2654.3240.0124	890110
Toyota	250100	48110-60161	48110-35170	250120
Toyota	250110	48210-60240	48110-35230	250180
Toyota	250120	48110-35170	48110-60161	250100
Toyota	250130	48210-26260	48120-35100	250140

Manufacturer	Part No.	OE-Part-No.	OE-Part-No.	Part No.
Toyota	250140	48120-35100	48120-35120	250160
Toyota	250150	48210-26620	48210-26260	250130
Toyota	250160	48120-35120	48210-26620	250150
Toyota	250170	48210-27310	48210-27310	250170
Toyota	250180	48110-35230	48210-35450	250190
Toyota	250190	48210-35450	48210-35640	250430
Toyota	250210	48210-35670	48210-35670	250210
Toyota	250250	48210-35830	48210-35681	250450
Toyota	250270	48210-35881	48210-35830	250250
Toyota	250430	48210-35640	48210-35881	250270
Toyota	250450	48210-35681	48210-3D240	250590
Toyota	250590	48210-3D240	48210-60240	250110
Vauxhall	260170	7703.14.662	7703.14.662	260170
Vauxhall	260190	90222241	90222241	260190
Volkswagen	950820	291.411.101H	291.511.151	950850
Volkswagen	950830	281.511.151A	2654.3240.0124	952100
Volkswagen	950850	291.511.151	2654.3240.0124	952120
Volkswagen	950870	291.511.151D	147.511.151B	951110
Volkswagen	950890	281.511.151B	281.511.151A	950830
Volkswagen	950900	293.411.101C	281.511.151B	950890
Volkswagen	950910	281.511.151D	281.511.151D	950910
Volkswagen	950930	293.511.151B	281.511.151L	950990
Volkswagen	950990	281.511.151L	291.411.101H	950820
Volkswagen	951050	293.511.151S	291.511.151D	950870
Volkswagen	951070	293.511.151D	293.411.101C	950900
Volkswagen	951110	147.511.151B	293.511.151B	950930
Volkswagen	952100	2654.3240.0124	293.511.151D	951070
Volkswagen	952110	J4821035670	293.511.151S	951050
Volkswagen	952120	2654.3240.0124	J4821035670	952110

How to measure springs?

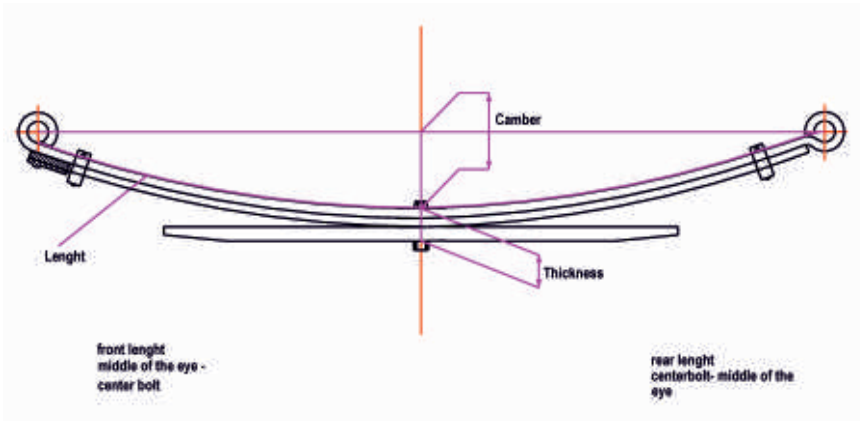

- Always measure:
- camber (free arch)
 - length
 - thickness

Always measure over the surface.

How to measure U-Bolts?

Types of U-Bolts

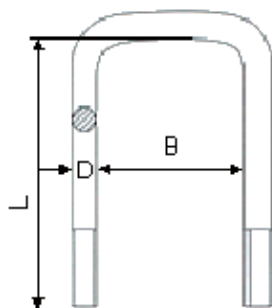

L = Length
 D = Thread diameter
 B = Width

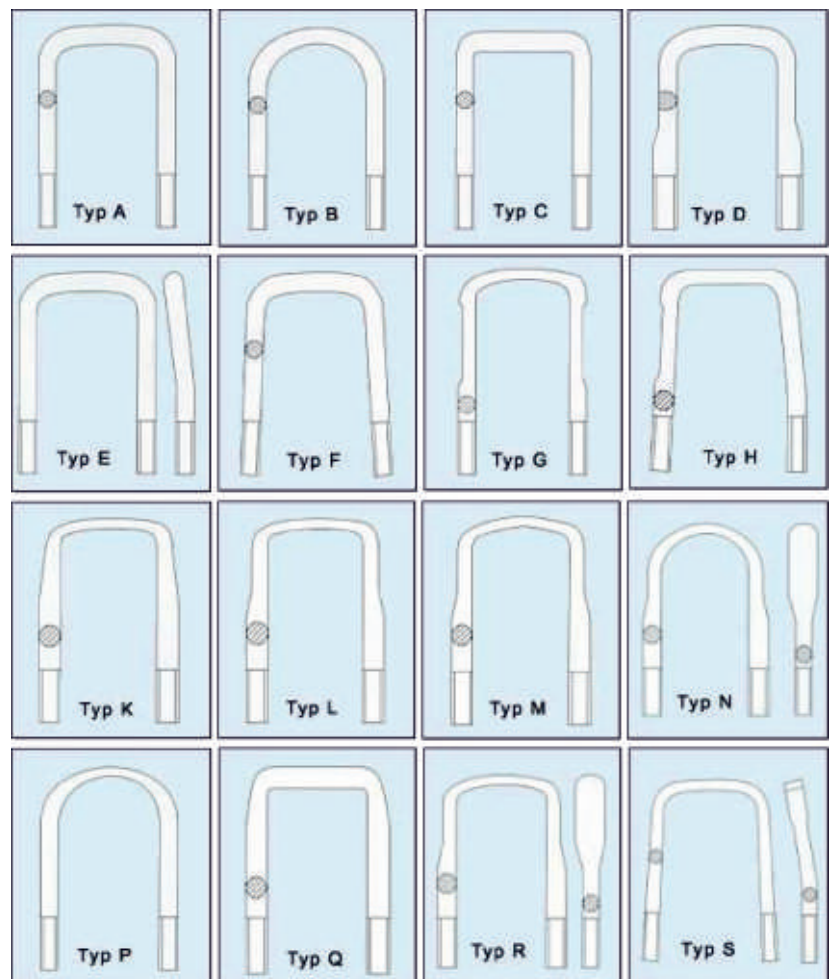

CERTIFICATE **TUV NORD**

Management system as per
DIN EN ISO 9001 : 2008

In accordance with TUV NORD CERT procedures, it is hereby certified that

**LS Germany
Blattfedern GmbH
Selbecker Straße 161a - 163
58091 Hagen
Deutschland**



applies a management system in line with the above standard for the following scope

Distribution of leaf springs for passenger and commercial vehicles

Certificate Registration No. 04 100 200347-001
Audit Report No. 2008 0347

Valid until 2015-01-30
Initial certificate 2008

C. Brütigam
Certification Body
in TUV NORD CERT GmbH

Essen, 2012-01-28

This certification was conducted in accordance with the TUV NORD CERT auditing and certification procedures and is subject to regular surveillance audits. This certificate is valid in conjunction with the main certificate.

TUV NORD CERT GmbH Laugenschulstrasse 20 45141 Essen www.tuv-nord-cert.com



СЕРТИФИКАТ **TUV NORD**

СИСТЕМА УПРАВЛЕНИЯ В СООТВЕТСТВИИ С
DIN EN ISO 9001 : 2008

В соответствии с процедурами TUV NORD CERT исполняется подтверждение, что

**LS Germany
Blattfedern GmbH
Selbecker Straße 161a - 163
58091 Hagen
Deutschland**



применяет систему менеджмента в соответствии с указанным стандартом для следующей области действия

Сбыт и продажа листовых рессор для легковых и грузовых автомобилей

Регистрационный номер сертификата: 04 100 200347-001
Отчет об аудите №: 2008 0347

Действителен до: 2015-01-30
Дата первоначальной сертификации: 2008

C. Brütigam
Сертификационный орган
в TUV NORD CERT GmbH

в Эссен, 2012-01-28

Принцип сертификации проводится в соответствии с процедурами аудирования и сертификации TUV NORD CERT и подлежит регулярным надзорным аудитам. Данный сертификат действителен только вместе с основным сертификатом.

TUV NORD CERT GmbH Laugenschulstrasse 20 45141 Essen www.tuv-nord-cert.com



СИСТЕМА СЕРТИФИКАЦИИ ГОСТ Р ГОСТСТАНДАРТ РОССИИ



СЕРТИФИКАТ СООТВЕТСТВИЯ

№ РОСС ВЕ.МТ14.В24896 от 31.10.2010
Срок действия с 02.11.2009 **8369553**

ОРГАН ПО СЕРТИФИКАЦИИ АВТОМОБИЛЬНЫХ РЕССОР - НАМН-00013
ИП № РОСС RE.0001.11MT14 от 17.09.2009 г.
125436, с. Москва, 4-я Звениковский пер., 17А
Телефон: 454-95-91, Факс: 456-54-80

ПРОДУКЦИЯ Рессоры листовые "LSG" ("LS Germany") по заказу
"LS Germany - Transfert Springs, 01/2008" с дополнительным применением
для технического обслуживания и ремонта легковых грузовых и грузовых
автомобилей
Сериальный выпуск

код ОК 010 000 000 000
45 9031

СООТВЕТСТВИЕ ТРЕБОВАНИИМ НОРМАТИВНЫХ ДОКУМЕНТОВ
ГОСТ Р 91585-2008 (и экв. 4.11-4.13, 4.16, 4.18, 4.20, 4.21, 4.23, 4.24)

код ТИ 001 000 000 000
7320 10 110 0

ПОДГОТОВИТЕЛЬ "LS Germany - Leaf Springs Germany Blattfedern GmbH", Германия
Selbecker Straße 161a-163, D-58091 Hagen

СЕРТИФИКАТ ВЫДАН "LS Germany - Leaf Springs Germany Blattfedern GmbH", Германия
Selbecker Straße 161a-163, D-58091 Hagen
тел. +49(0) 23 31 3482 734, факс +49(0) 23 31 3494 576

НА ОСНОВАНИИ Протокола № 6707/25/062, № 8732/25/066
ФГУП "НАМН" (Исполнительный орган производства автомобильной продукции)
РОСС RE.0001.11MT14 от 29.09.2009 г.
Сертификата LRQA № 850155 соответствии системы менеджмента качества требованиям
ИСО 9001:2008

ДОПОЛНИТЕЛЬНАЯ ИНФОРМАЦИЯ
Многостраничный сертификат прилагается: полный соответствует по ГОСТ Р 90466-02
Зона ответственности указана по запросу или уведомлению



Руководитель органа

О.В. Гурский
В.Е. Матвиенко

Эксперт

Сертификат имеет юридическую силу на всей территории Российской Федерации



LS Germany Blattfedern GmbH
Selbecker Straße 161a-163
D-58091 Hagen/Germany
Tel. +49 2331 36757-20
Fax +49 2331 36757-25
Web: www.leaf-springs.de
Mail: pk@leaf-springs.de