

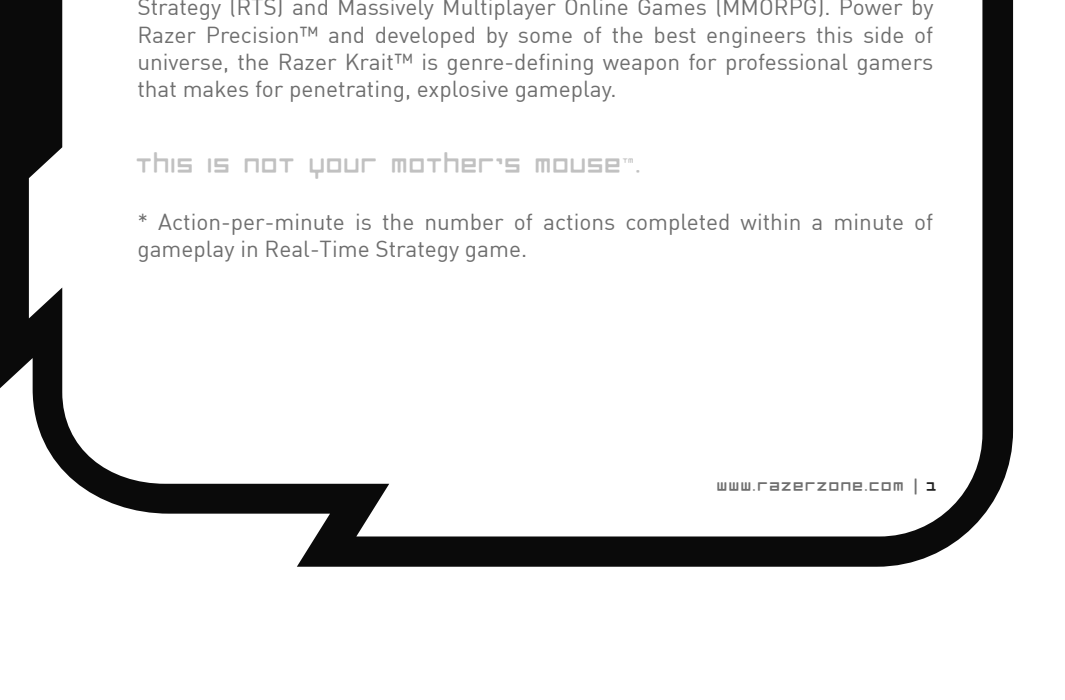

MASTER GUIDE



This is not your mother's mouse.

\* Action-per-minute is the number of actions completed within a minute of gameplay in Real-Time Strategy game.

www.razerzone.com | 3



There's no turning back. You're one of us now.

Imagine adding 35% to 50% more actions-per-minute (APM) to your game? The Razer Krait™ is a premier gaming mouse offering a punishing engine to allow 6400 frames per second and up to 1200 APM, a superb optical tracking precision of up to 1600 dpi and drop dead accuracy on fly to match. Featuring Razer's award winning drivers including On-The-Fly Sensitivity™ to suit your gaming style, it's also equipped with 3 programmable ultra-large non-slip HyperResponse™ buttons. With a dedicated 16 bit-data channel to keep up with dataloom demands, this is one lethal weapon for precision gaming in RTS and MMOG games.

It features Always-On™ capabilities pioneered by Razer™ where the optical sensor never powers down, providing instantaneous response at all times during gameplay -- unlike other mice that power down when stationary and experience latency when powered on.

We are a company of avid gamers who work closely with the gaming community and we know exactly what you need. The Razer Krait™ is designed to provide you with the much needed competitive edge in gameplay, made for Gamers. By Gamers™. Undoubtedly, the Razer Krait™ will be at the forefront in competitive gaming and you're at the helm of this technological revolution.

We know you're bustin' at your chops to put this baby through the rigors of game play. But before you do so, take some time to go through this Master Guide in order to unleash the maximum potential of your Razer Krait's capabilities.

We live by the mantra of gamers. by gamers.™ and it is imperative that we bring you into the fold.

Sign up at www.razerzone.com for the latest news, product and driver announcements to stay ahead of the game. It'd assure you that all information provided will be kept private.

There's no turning back. You're one of us now. Peace and great gaming.

Razerguy  
RazerGuy@razerzone.com

www.razerzone.com | 4

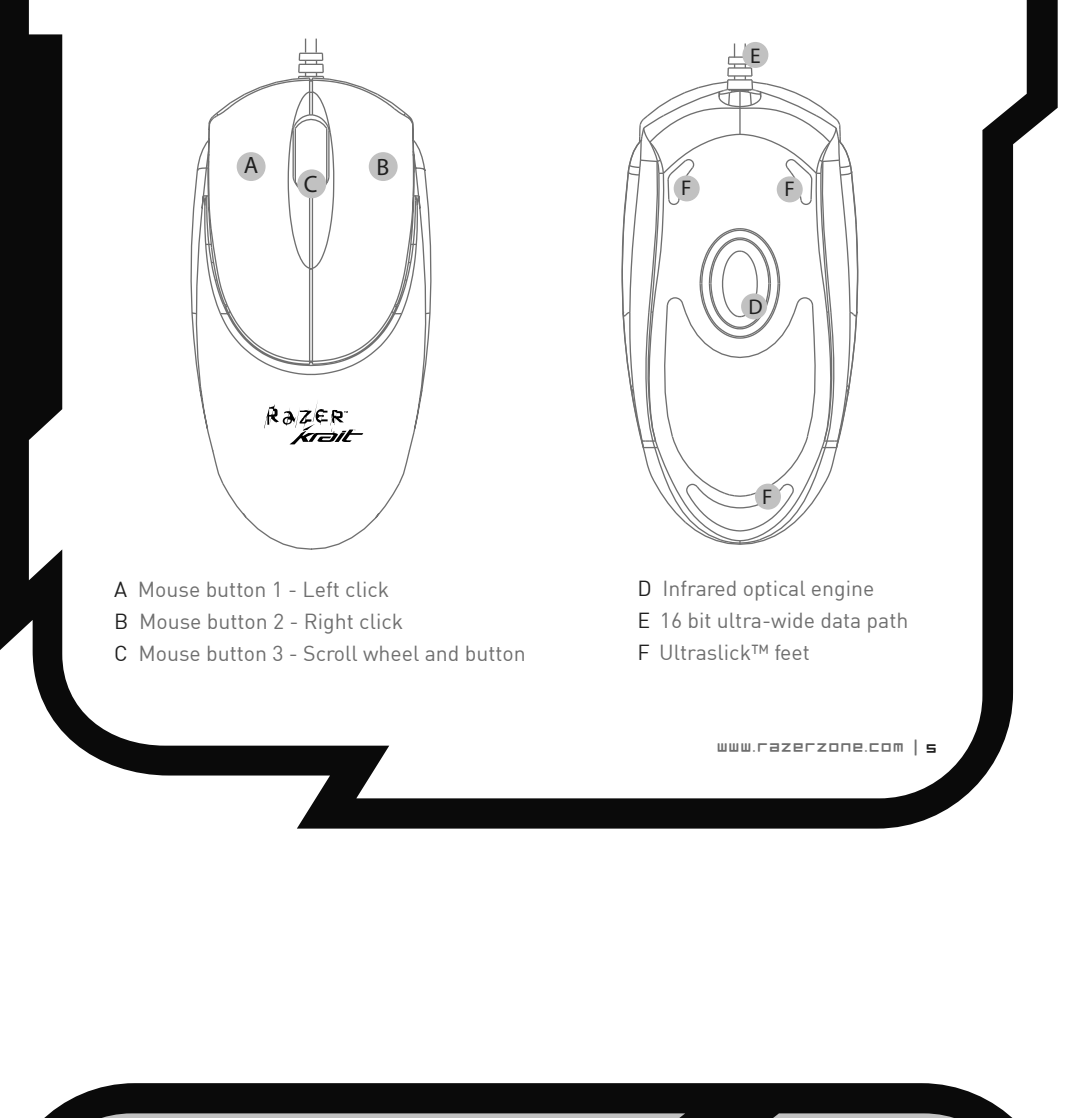
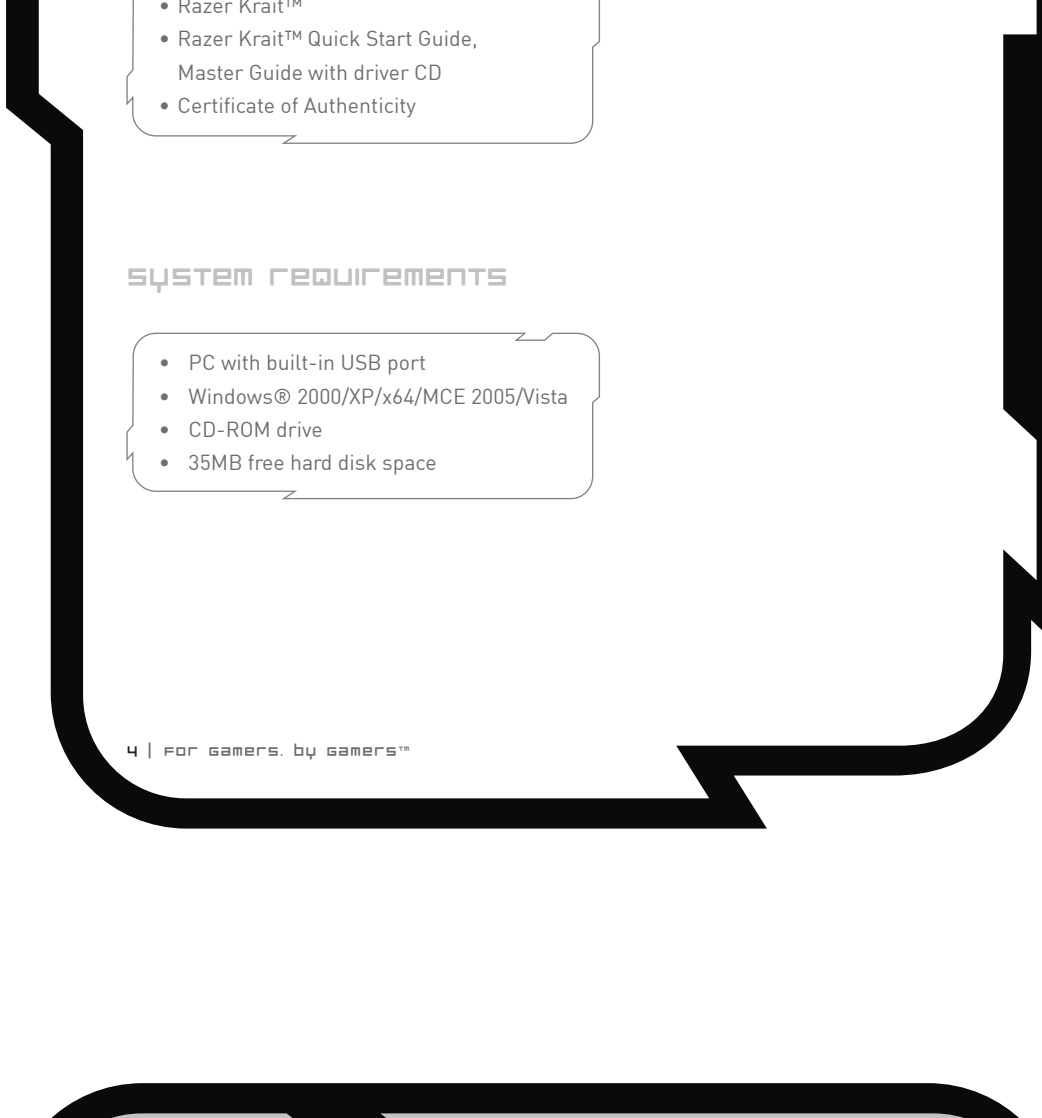

PACKAGE CONTENTS

- Razer Krait™
- Razer Krait™ Quick Start Guide, Master Guide with driver CD
- Certificate of Authenticity

SYSTEM REQUIREMENTS

- PC with built-in USB port
- Windows® 2000/XP/x64/MCE 2005/Vista
- CD-ROM drive
- 25MB free hard disk space

For gamers. by gamers.™

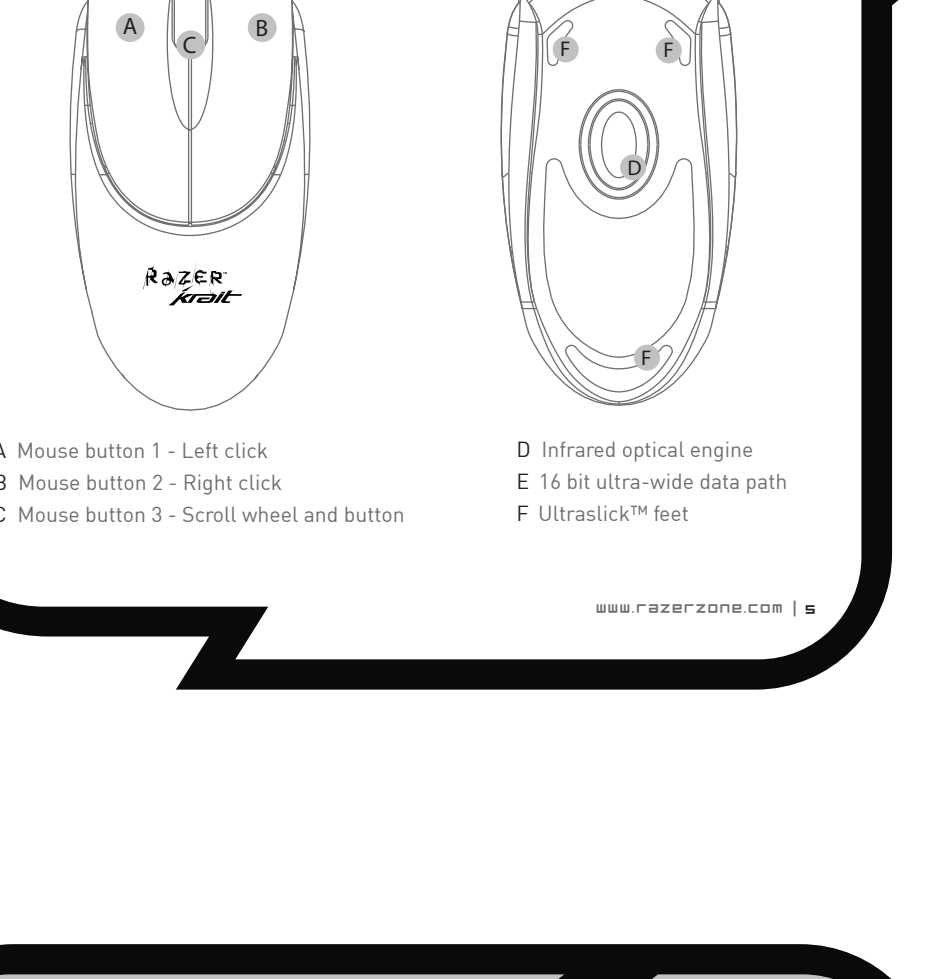

KEY FEATURES

Default button assignments

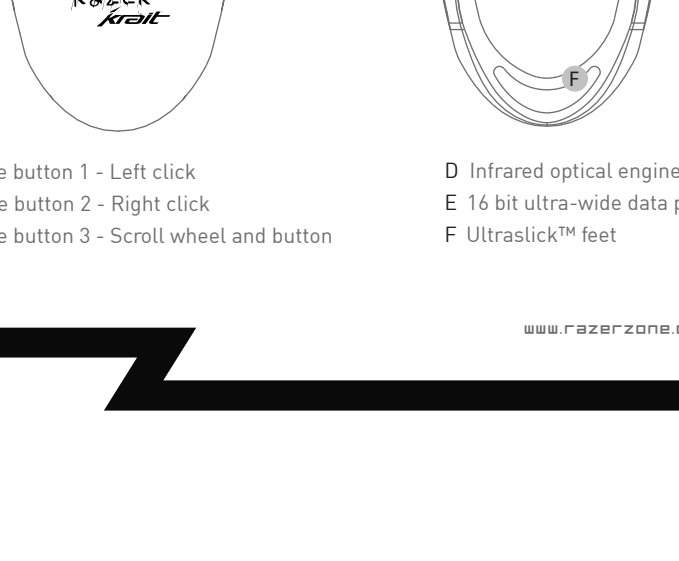

- A Mouse button 1 - Left click
- B Mouse button 2 - Right click
- C Mouse button 3 - Scroll wheel and button
- D Infrared optical engine
- E 16 bit ultra-wide data path
- F Ultra-trip feet

www.razerzone.com | 5

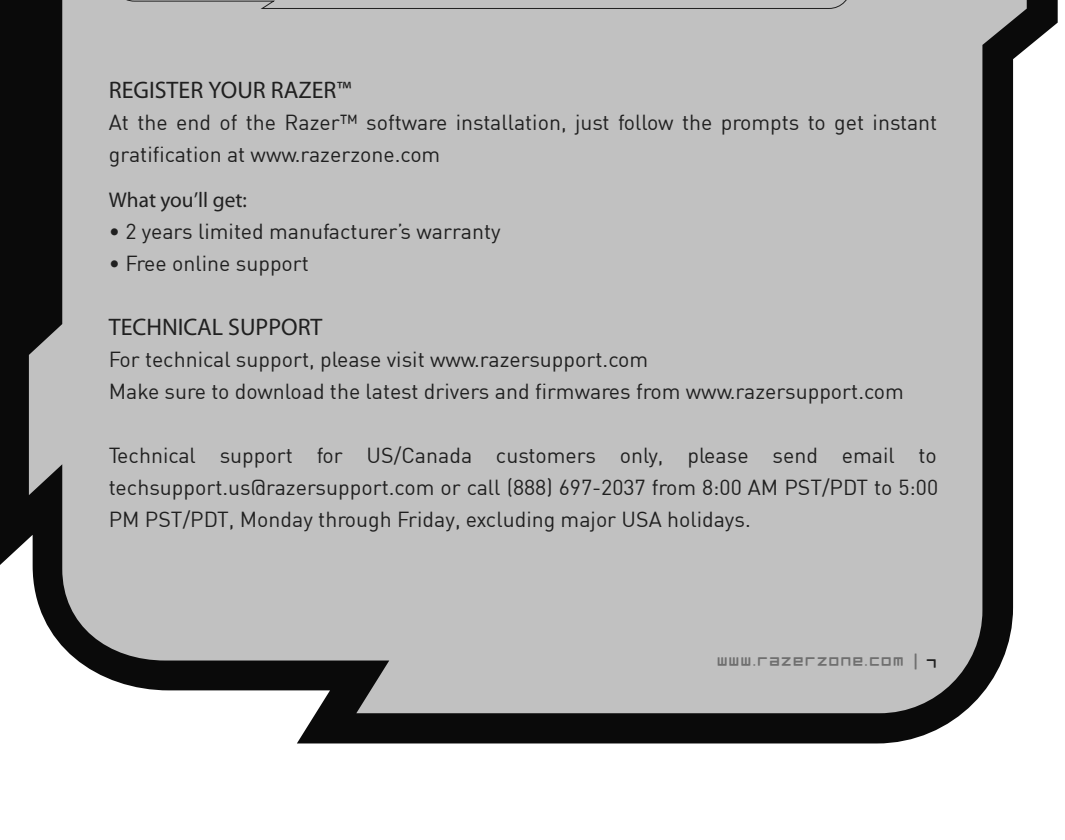
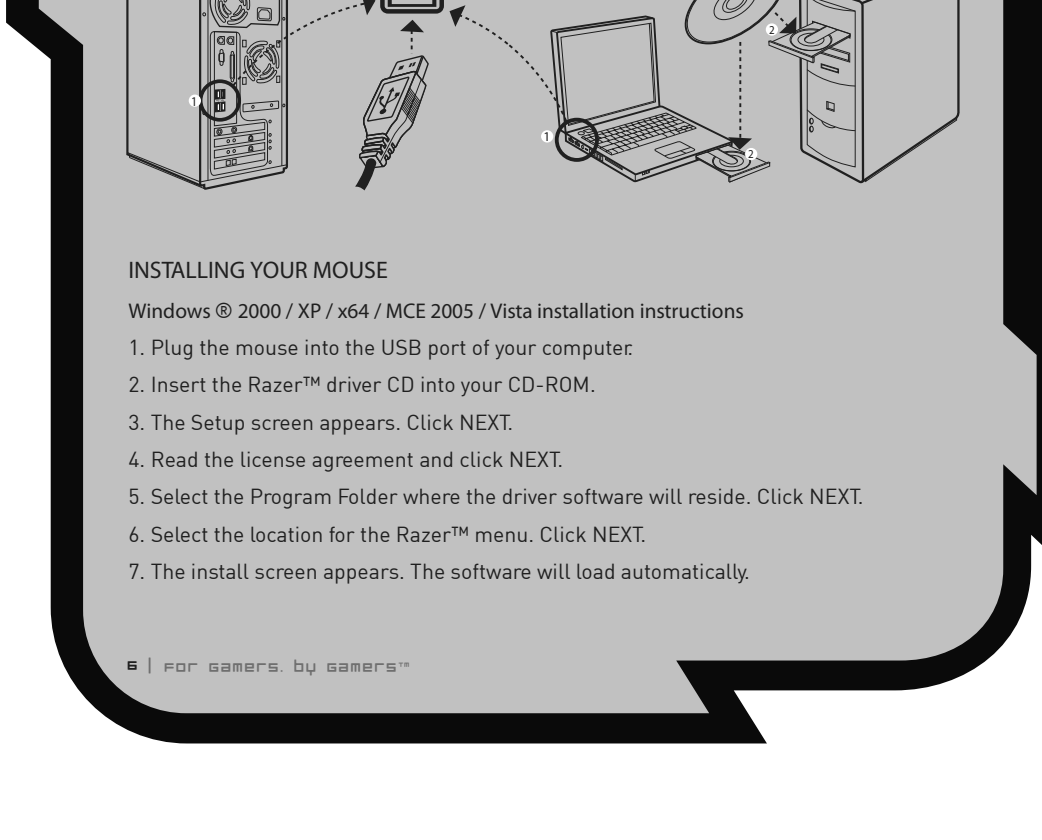

INSTALLATION / REGISTRATION / TECHNICAL SUPPORT

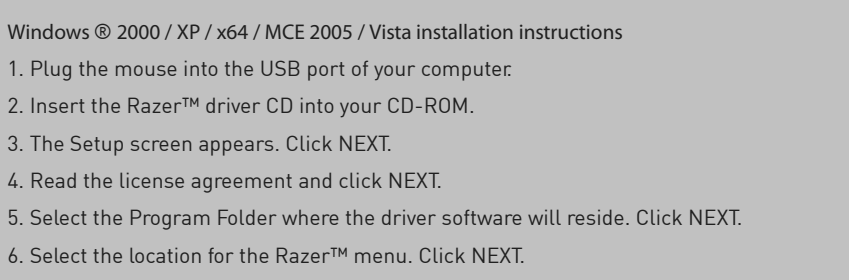

INSTALLING YOUR MOUSE

- Windows® 2000 / XP / x64 / MCE 2005 / Vista installation instructions
- Plug the mouse into the USB port of your computer.
- Insert the Razer™ driver CD into your CD-ROM.
- The Setup screen appears. Click NEXT.
- Read the license agreement and click NEXT.
- Select the Program Folder where the driver software will reside. Click NEXT.
- Select the location for the Razer™ menu. Click NEXT.
- The install screen appears. The software will load automatically.

For gamers. by gamers.™



8. Restart your system.

Note: When you install the XP driver while using a particular USB port, it will not recognize the mouse until you change to a different USB port later. We recommend you assign a permanent port for the Razer Krait™.

REGISTER YOUR RAZER™

At the end of the Razer™ software installation, just follow the prompts to get instant gratification at www.razerzone.com

- What you'll get:
- 2 years limited manufacturer's warranty
- Free online support

For technical support, please visit www.razerzone.com  
Make sure to download the latest drivers and firmwares from www.razerzone.com

Technical support for US/Canada customers only, please send email to techsupport@razerzone.com or call (888) 847-2037 from 8:00 AM PST/PDT to 5:00 PM PST/PDT, Monday through Friday, excluding major US holidays.

www.razerzone.com | 7



CONFIGURING YOUR MOUSE

The features listed here require the Razer Krait™ software driver to be installed and the Razer Krait™ Tray Icon to be active. On-The-Fly Sensitivity™ requires the Razer Krait™ driver to be installed.

SENSITIVITY WINDOW



For gamers. by gamers.™



- Sensitivity: Adjust the Razer Krait's pointer sensitivity to suit your needs.
- On-The-Fly Sensitivity: Activate On-The-Fly Sensitivity™ and show it on screen when active.
- Double-click speed: Adjust the double-click speed.
- ADVANCED SENSITIVITY OPTIONS: This can be accessed by clicking the Advanced tab from the Sensitivity Window.
- Master Sensitivity Control: This must be enabled in order for individual adjustments to X-Y sensitivity to be effective. Adjust X-Y sensitivity separately.
- Master Acceleration Control: Turn on/off pointer acceleration and set acceleration level. Acceleration is not recommended for gaming.



www.razerzone.com | 8



SCROLL WHEEL WINDOW

- Scroll Wheel Speed: Adjust the scroll wheel speed.
- Universal Scrolling: Once activated, clicking the middle mouse button and dragging the mouse will scroll in the direction of the mouse movement.
- Test Area: Use this area to test the scrolling wheel speed.



For gamers. by gamers.™



BUTTONS WINDOW

- Orientation: Select whether you are right-handed or left-handed.
- Button Assignment and Mousewheel Options: If the button function is not listed, or if you would like to assign a macro, select an option from the drop down menu. Macros can be up to 5 characters in length, and Special Keys may be selected from the appropriate sub-menu.



www.razerzone.com | 9

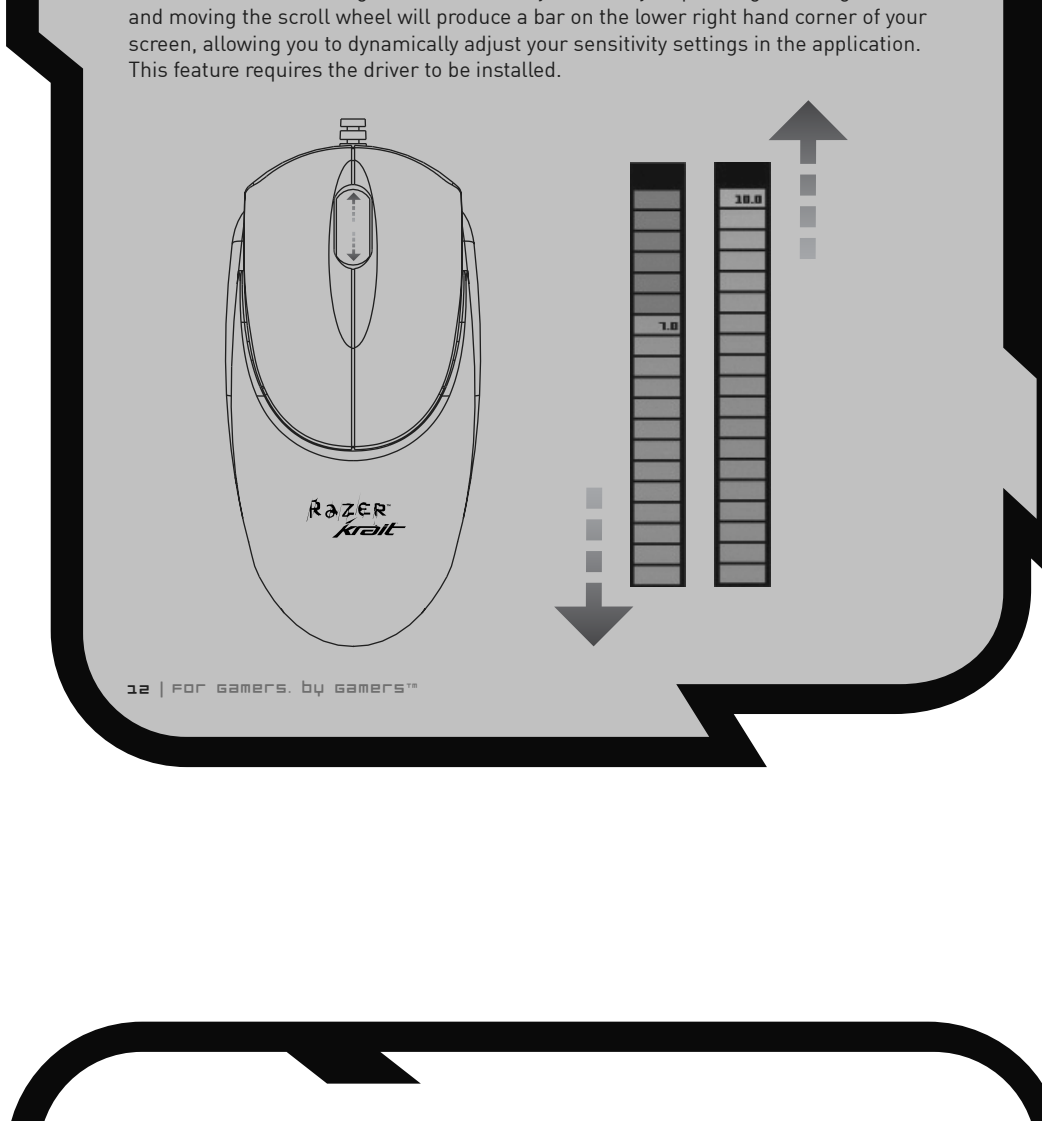

USING YOUR RAZER KRAIT™

ON-THE-FLY SENSITIVITY™

If a button has been assigned to "On-The-Fly Sensitivity™", pressing the assigned button and moving the scroll wheel will produce a bar on the lower right hand corner of your screen, allowing you to dynamically adjust your sensitivity settings in real time. This feature requires the driver to be installed.



For gamers. by gamers.™



ADVANCED SETTINGS GUIDE

- Sensitivity: Mouse sensitivity is an internal filter of the driver. The maximum sensitivity setting of 10 is sufficient. Each increment of 10 is a 10% increase in sensitivity. Acceleration: Acceleration is an internal filter of the driver, and is primarily a response option for the mouse. With acceleration enabled, the faster you move the mouse, the more acceleration is added. Windows XP has acceleration turned on by default in order to prevent users from losing accuracy. The acceleration off option (default) turns off internal acceleration and does not affect the Control Panel, Mouse Properties, and mouseing Enhance Mouse Precision. Windows Pointer Speed: Pointer speed is the Windows implementation of sensitivity in Windows XP. A setting of 5, which is 400% means a movement of one inch will result in 400 units of movement. Without any of the above filters operating, this will result in 400 units of movement on the screen. Independent X and Y axis Settings: This is used to adjust sensitivity movements side to side and up and down. It allows you to modify the X or Y axis sensitivity to suit your needs. It is not recommended to use this feature for further sensitivity adjustments. SAFETY AND PERFORMANCE: SAFETY GUIDELINES: In order to ensure maximum safety while using your mouse, adjust the following guidelines: 1. Avoid looking directly into the infrared optical beam of your mouse or pointing the beam in anyone's eye. Note that the infrared optical beam is NOT visible to the naked human eye and is not a laser. 2. Should you have trouble operating the mouse properly and troubleshooting does not work, unplug the device and contact the Razer™ Customer Support team for support. Do not attempt to service or fix the device yourself at any time. 3. Do not take apart the mouse casing as you will void your warranty and do not attempt to service a mouse or separate its internal components. 4. Keep your mouse away from liquid, humidity or moisture. Operate your mouse within the specified humidity or moisture range of 0% to 100% RH (32°F to 122°F). Should you operate at a temperature that is beyond this range, unplug and store the device in order to see the temperature of the room with the optimal humidity level. 5. Do not use your mouse for long periods of repetitive motion, improper positioning of your computer peripherals, incorrect body position, and poor habits may be associated with physical discomfort and injury to the neck, wrist, hand, and fingers. Please follow the guidelines to ensure comfortable use of your mouse and avoid injury. 6. Master Windows Control: Adjust Windows pointer speed (as per Windows Mouse Control Panel). Takes effect only after reboot. 7. DPI Switch: Set the DPI of the Razer Krait™. Select from either the 400 or 1600 dpi setting. 8. Customizable Buttons: You can customize buttons on your mouse to suit your style of play and to support your workflow. 9. Customizable Buttons: You can customize buttons on your mouse to suit your style of play and to support your workflow. 10. Customizable Buttons: You can customize buttons on your mouse to suit your style of play and to support your workflow.

www.razerzone.com | 10



RESTRICTIONS

Razer™ retains full ownership of the Software. You shall not modify, reverse engineer, or modify the Software in any way without the express written consent of Razer™.

You may not transfer the Software or a network license to any third party without the express written consent of Razer™.

Software may be used for personal or non-commercial use only. Software may not be used for commercial or other purposes without the express written consent of Razer™.

Software may not be used for any purpose that is illegal, fraudulent, or otherwise prohibited by applicable law.

Software may not be used for any purpose that is harmful to the health, safety, or well-being of any person or the general public.

Software may not be used for any purpose that is in violation of applicable law or the terms and conditions of any license or agreement.

For gamers. by gamers.™



U.S. GOVERNMENT RESTRICTIONS

This Software is provided to the U.S. Government only with the limited rights described herein, pursuant to part 115 of the FCC Rules. These limits are designed to provide a reasonable protection against harmful interference to a residential installation. This equipment generates, uses and can radiate radio frequency energy and it may interfere with radio communications if not installed and used in accordance with the instructions, may cause harmful interference to radio communications. Therefore, these limits apply to radio emissions and do not apply to radio reception. If this equipment does cause harmful interference to radio communications, you may be required to take one or more of the following measures: Reorient or relocate the receiving antenna. Increase the separation between the equipment and the receiver. Connect the equipment into an outlet on a circuit different from that to which the receiver is connected. Consult the dealer or an experienced radio TV technician for help.

For more information, refer to the online help system on your Razer Krait™ CD-ROM or www.razerzone.com

www.razerzone.com | 11

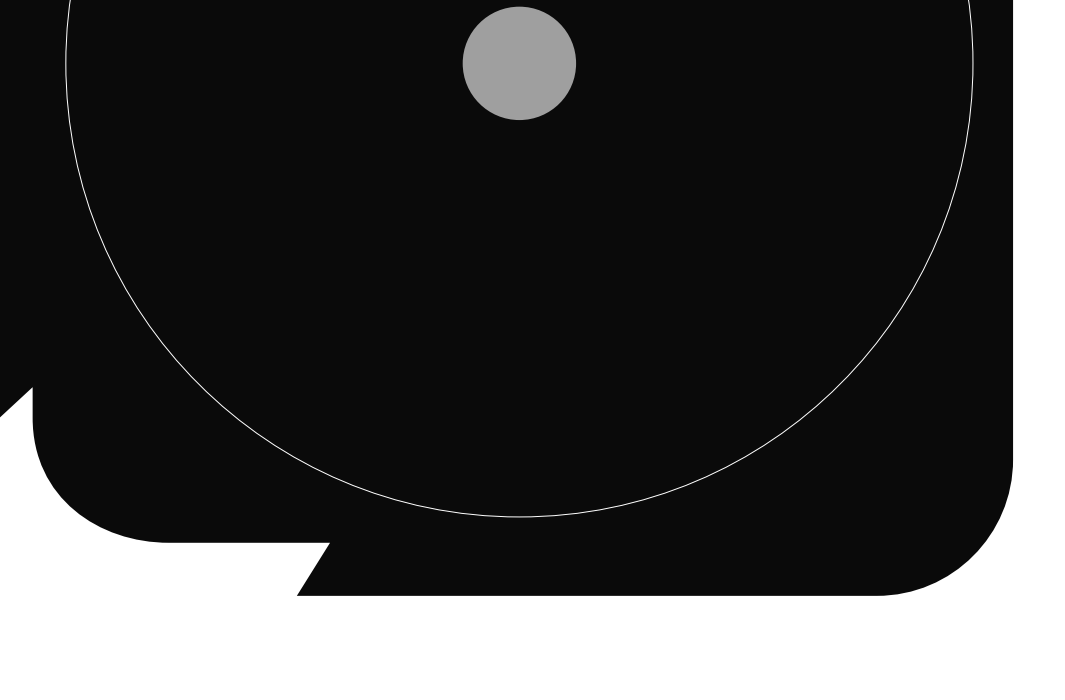

WEEE INFORMATION

WEEE INFORMATION: This symbol indicates that this product contains hazardous substances and should be disposed of separately from other waste.

WEEE INFORMATION: This symbol indicates that this product contains hazardous substances and should be disposed of separately from other waste.

WEEE INFORMATION: This symbol indicates that this product contains hazardous substances and should be disposed of separately from other waste.

For gamers. by gamers.™

