

EPSON Stylus® Pro 4000

Start Here

Unpack

- 1 Make sure you have all the parts shown below for your EPSON Stylus Pro 4000:

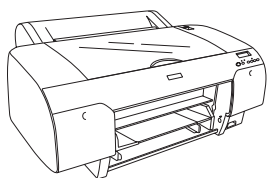

Printer

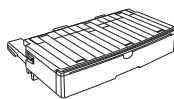

Paper tray

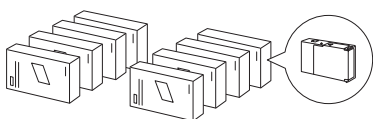

Ink cartridges



Power cord

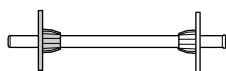

Roll paper spindle



Exhaust port cover



Spindle adapters
(attached to spindle)

Warning: The printer weighs about 85 pounds, and should be lifted by two people.

- 2 Remove all the packing materials and tape. Save the box and packaging in case you need to ship the printer.

- 3 Loosen the two screws and remove the carriage retainer bracket.

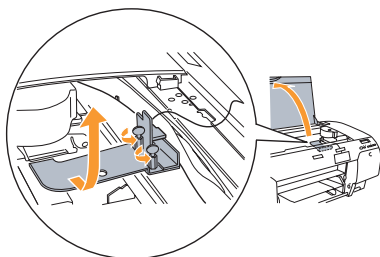

- 4 Unlock the print head carriage by pulling the green tab to the left. Do not remove the tab.

Note: To lock the print head carriage for transportation, push the green tab to the right.

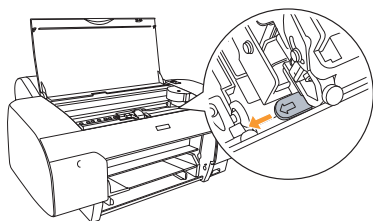

Set Up and Plug In

- 1 Connect the power cord to the AC inlet on the back of the printer.
- 2 Plug the other end of the power cord into a properly grounded electrical outlet.
- 3 Attach the exhaust port cover by sliding it along the slots on the back of the printer.
- 4 Insert the paper tray into the slots at the front of the printer.

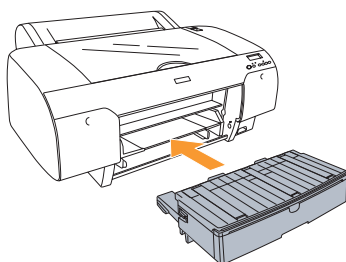
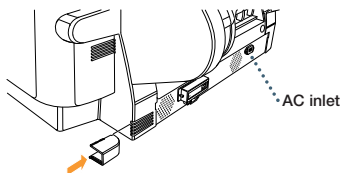

Install Ink

Use the ink cartridges that came with your printer for initial ink charging. During the initial installation process, it is normal for up to one-third of the ink in each cartridge to be used.

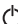
- 1** Press the  Power button to turn on the printer.

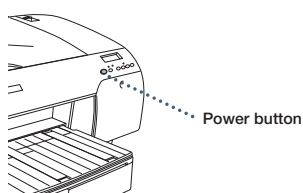

- 2** Press both ink compartment covers to open them.

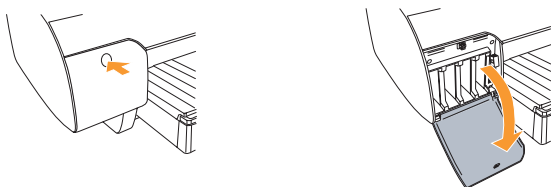

- 3** Raise both ink levers.

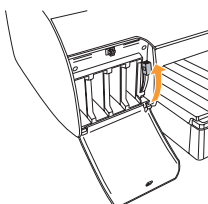

- 4** Remove each ink cartridge from its package and gently shake the cartridge.

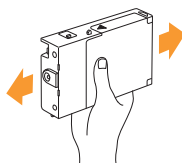

- 5** Install the ink cartridges in the printer. Hold each cartridge with the arrow pointing toward the printer, then insert it into its slot. Make sure you insert each cartridge in the correct slot.

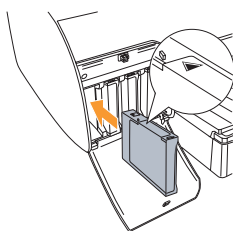

- 6** After installing all 8 cartridges, lower the ink levers. The printer begins charging the ink delivery system and the  Pause light flashes.

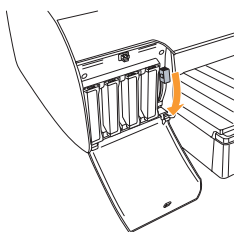

- 7** After approximately 2 minutes, ink lever messages appear on the LCD. follow the instruction to raise or lower the ink levers.

Caution: Charging takes about 8 minutes. Never turn off the printer, release the paper lever, or open the cover while the  Pause light is flashing, or you may damage the printer.

- 8** When **READY** appears on the LCD display, charging is complete. Close the ink compartment covers.

Caution: Always turn off the printer using the  Power button. Then wait until the LCD display turns off. This ensures that the print head is safely capped.

Load Roll Paper

- 1 Slide the black paper stop off the end of the spindle.
- 2 If the paper has a 2-inch core, remove the adapters by pressing the four tabs.

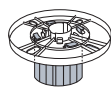
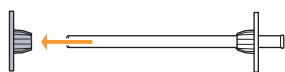

Note: Make sure your hands are clean, and avoid touching the printable surface of the paper. Try to handle paper by the edges. Make sure you don't rub or scratch the coating or dent the edges of the paper.

- 3 Position the roll so the paper unwinds as shown, then slide it onto the spindle.
- 4 Slide the black paper stop back onto the spindle. Insert it firmly into the end of the roll.

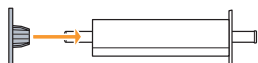

- 5 Open the roll paper cover.

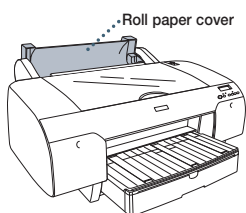

- 6 Place the paper and spindle in the printer as shown, with the gray end on the right.

- 7 Make sure the printer is powered on and ready. Press the < Paper Source button until the or roll paper icon appears.

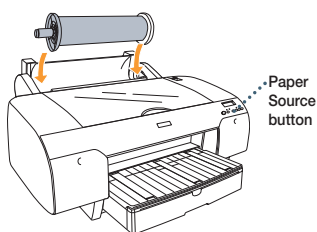

- 8 Release the paper lever.

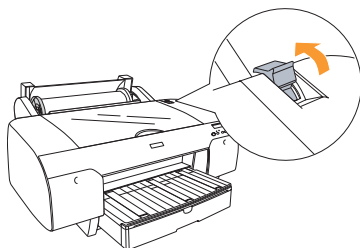

- 9 Hold both sides of the paper and feed it into the slot until the paper is aligned with the **OTHER** mark and the vertical line on the paper tray cover. Then move the paper lever to the secured position.

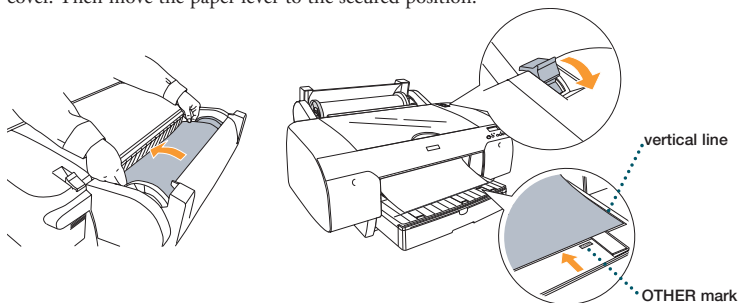

- 10 Raise the roll paper support on top of the paper tray. Then close the roll paper cover.

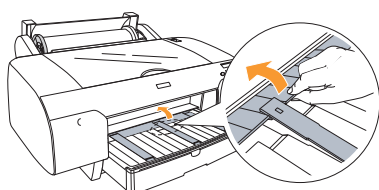

Load Cut Sheet Paper

When you are ready to print on cut sheet paper, make sure you release the paper lever and wind up the roll paper. Then return the paper lever to the secured position and close the roll paper cover.

Note: Some papers cannot be used with the paper tray. You need to load them through the front or top manual feed slots. See the *Printer Guide* for details.

1 Make sure the printer is on and ready to print.

2 Pull out the paper tray and cover, then remove the cover. Flip up the paper guide roller.

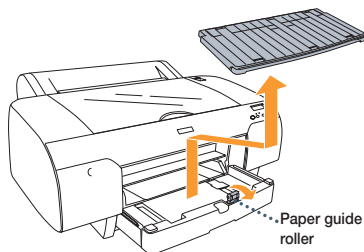

3 Slide the edge guide all the way to the left.

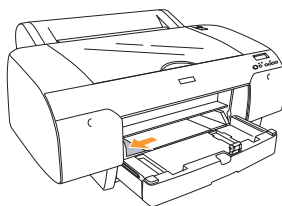

4 Thumb through a stack of paper, then gently tap it on a flat surface to even the edges.



5 Load the sheets in the portrait orientation, with the whiter or glossier printable side face down. Place the paper all the way back, against the right side of the tray.

Don't load paper above the arrow mark inside the edge guide.

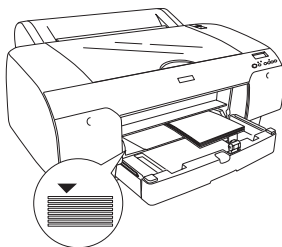

6 Adjust the paper tray and edge guide according to the paper size. For small sheets, raise the paper guide and move it to the edge of the stack.

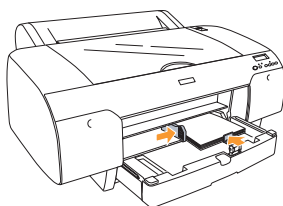

7 Flip down the paper guide roller, then replace the paper tray cover and adjust its length.

Note: Make sure the roll paper support is not raised.

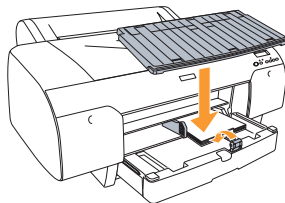

8 Press the < Paper Source button until you see the □ cut sheet icon.

Connect to Your System

You can use either of the following connections. Make sure your system has the appropriate port, and you have a standard, shielded cable 10 feet long or less:

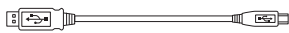

USB cable

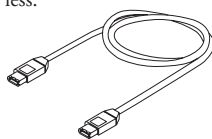

IEEE FireWire® cable

If you have the optional EpsonNet Ethernet card, you can connect the printer directly to your network. You'll need a standard RJ-45 network cable.

- 1 Make sure that both the printer and the computer are off.
- 2 Plug the interface cable into the appropriate port on the printer.
- 3 Plug the other end of the cable into the appropriate connector on your computer or network hub.

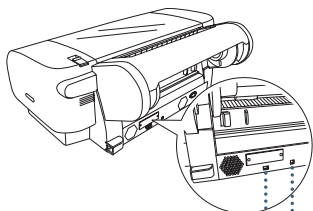

IEEE FireWire connector

USB connector

Install the Software

Follow the steps below for Macintosh® or Windows®.

Macintosh

- 1 Turn on your Macintosh and your printer.
- 2 Insert the printer software CD-ROM. If necessary, double-click the EPSON CD-ROM to open its window.
- 3 Double-click the **EPSON OS X Installer**.

If you are using Mac® OS 9, double-click the **EPSON OS 9 Installer**.

- 4 Double-click **Install Reference Guide** and wait while the guide is installed.
- 5 Double-click **Install Printer Driver and Utilities**. Enter your password if necessary.
- 6 Follow the on-screen instructions to install your software. When you see a message informing you that installation was successful, click **Restart** to restart your Macintosh.

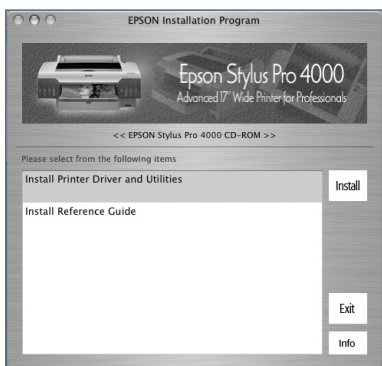

- 7 If you're using OS X, continue with step 8.

If you're using OS 9, open the Chooser from the Apple® menu. Select **SPro 4000**, then select your port and turn on background printing. Your installation is complete.

- 8 Open the Applications folder, then open the Utilities folder and open the Print Center or Printer Setup utility.

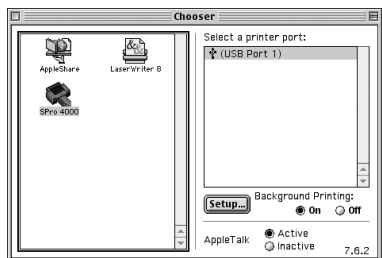

- 9 Click the **Add** icon at the top of the Printer List window.

Continue ►

10 Pull down the menu and select the connection you are using—either **EPSON USB**, **EPSON FireWire**, or **EPSON TCP/IP**. The Stylus Pro 4000 appears on the Printer List screen.

11 Click **Stylus Pro 4000**, then open the Page Setup pull-down menu.

12 Select **All**, then click **Add**.

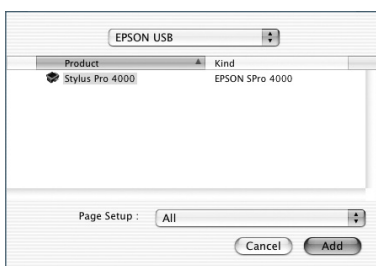

Windows

1 Make sure your printer is turned off.

2 Turn on your computer.

3 Insert the printer software CD-ROM in your computer. The installer starts automatically. If it doesn't start, double-click **My Computer** or click **Start > My Computer**. Then double-click your CD-ROM icon.

4 Double-click **Install Printer Driver and Utilities**.

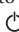
5 When you see a window asking you to turn on your printer, press the  Power button.

6 When you see a message that setup is complete, click **OK**.

7 Double-click **Install Reference Guide** and wait while the guide is installed.

8 If you need the ZEHPlot or EPSON HDI driver, double-click the icon and follow the instructions on the screen.

9 Click  to close the installer, then remove the CD-ROM.

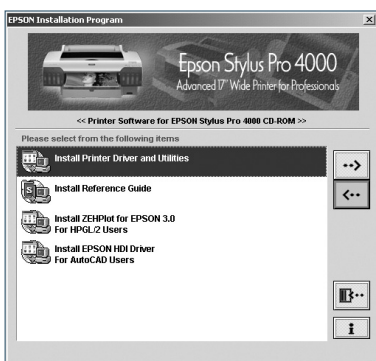

Any Questions?

Here's where to look for answers:

Mastering Your Printer Video Workshop

Insert the *Mastering Your Printer* CD-ROM and select the video you want to watch. You'll get expert advice on optimizing print quality, printing from Photoshop®, and basic printer operations.

Printer Guide

Refer to this book for complete instructions on using and maintaining your printer, as well as problem-solving tips and specifications.

Quick Reference Guide

Keep this booklet handy for instructions on loading paper, replacing ink cartridges and other components, changing and aligning the print head, and what to do when you see a printer error message.

Electronic Reference Guide

Double-click the **SP4000 Reference Guide** icon on your desktop. If you didn't install the guide, insert the printer software CD-ROM in your CD-ROM or DVD drive. Then double-click **Install Reference Guide**.

EPSON Technical Support

- World Wide Web
<http://support.epson.com>
- Call (888) 377-6611. Make sure you have your EPSON PreferredSM Unit ID number. If you have any difficulty with this service, call (562) 276-1305.

EPSON and EPSON Stylus are registered trademarks of SEIKO EPSON CORPORATION. EPSON Preferred is a service mark of Epson America, Inc.

General Notice: Other product names used herein are for identification purposes only and may be trademarks of their respective owners. EPSON disclaims any and all rights in those marks.

Printed on recycled paper
© 2004 by Epson America, Inc. 9/04
Printed in USA

CPD-17011R1