

OVERLAND TANDBERG

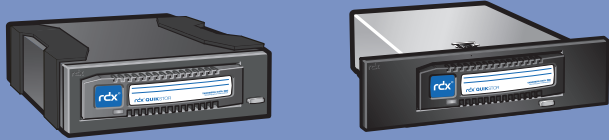

RDX® QuikStor®
External / Internal USB and SATA

QUICK START

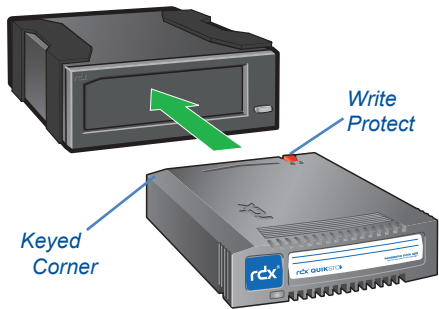

For More Information

Visit the support section of the Tandberg Data web site (www.tandbergdata.com) for more information, including product warranty and registration, knowledge base articles, user documentation and technical support.

WHAT'S IN THE BOX?

Quick Start Guide



Mounting Screws (Internal Only)



USB Type-C Adapter (External Only)



USB or SATA Cables



USB Cable (Internal)



SATA Cable (Internal)



USB Y-cable (External)

Power Adapter Cable (Internal Only)

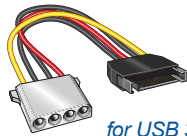

for USB 3.0

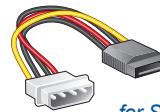

for SATA

RDX Media (with Selected Products)



RDX Emergency Media Eject Pin



Power Ratings

The following power ratings represent typical-use performance.

RDX Type	Power Source	DC Input Voltage & Rated Input Current
Int SATA III	Int Power Cable	5V/1.6A and 12V/0.003A
Int USB 3.0	Int Power Cable	5V/1.6A and 12V/0.003A
Ext USB3+	USB Cable	5V/1.6A peak (<0.9A typical)
	Ext Power Supply	5-14VDC/2.4-0.9A ⏻ 5.5mm

For RDX Warranty Registration and Technical Support Activation visit:
<http://registration.tandbergdata.com/>

FCC Compliance Notice



NOTE: This equipment has been tested and found to comply with the limits for a Class B digital device, pursuant to part 15 of the FCC Rules. These limits are designed to provide reasonable protection against harmful interference in a residential installation. This equipment generates, uses and can radiate radio frequency energy and, if not installed and used in accordance with the instructions, may cause harmful interference to radio communications. However, there is no guarantee that interference will not occur in a particular installation. If this equipment does cause harmful interference to radio or television reception, which can be determined by turning the equipment off and on, the user is encouraged to try to correct the interference by one or more of the following measures:

- Reorient or relocate the receiving antenna.
- Increase the separation between the equipment and receiver.
- Connect the equipment into an outlet on a circuit different from that to which the receiver is connected.
- Consult the dealer or an experienced radio/TV technician for help.

产品中有害物质的名称及含量

部件名称	有害物质					
	铅 (Pb)	汞 (Hg)	镉 (Cd)	六价铬 (Cr(VI))	多溴联苯 (PBB)	多溴二苯醚 (PBDE)
机箱/风扇	X	0	0	0	0	0
印刷电路板组件	X	0	0	0	0	0

本表格依据SJ/T 11364 的规定编制。

0: 表示该有害物质在该部件所有均质材料中的含量均在 GB/T 26572 规定的限量要求以下。
X: 表示该有害物质至少在该部件的某一均质材料中的含量超出 GB/T 26572 规定的限量要求。

Taiwan RoHS
本产品符合臺灣 RoHS 標準 CNS15663

單元	限制物質及其化學符號					
	鉛 (Pb)	汞 (Hg)	鎘 (Cd)	六價鉻 (Cr ^{VI})	多溴聯苯 (PBB)	多溴二苯醚 (PBDE)
外觀	0	0	0	0	0	0
電路板組件	-	0	0	0	0	0
電線/連接器	0	0	0	0	0	0
配件	0	0	0	0	0	0

備註 1: "0" 係指該項限制物質之百分比含量未超出百分比含量標準值。
備註 2: "-" 係指該項限制物質為排除項目。



START HERE

P/N 1021426 Rev. J

1 Install RDX Manager

The RDX Manager is available for both Windows and Mac.

1. Go to <ftp://ftp1.overlandtandberg.com/rdx>.
2. At the FTP site, click **RDX Manager**.
3. Depending on your OS, click either **Mac** or **Windows**.
4. To automatically download the files, click the **release notes PDF link** and then the **installer ZIP link**.
5. Make a note of the **location** where you saved the files.
6. Unpack the zip file, launch **RDXManagerInstaller.exe**, and follow the instructions.

2 Install and Connect Cables

Internal Drive

1. Power **OFF** the server.
2. Open the server **cover**.
3. Slide the **RDX drive** into an empty drive bay.
4. Using the four supplied mounting **screws**, secure the RDX in the bay.
5. Connect the **data cable** to motherboard or controller card.
6. Connect both **data and power** cables to the back of the RDX drive. (The RDX connections are keyed to ensure a correct fit.)

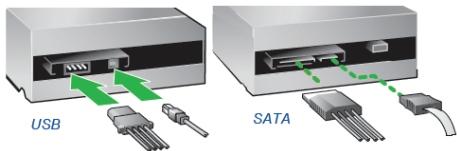
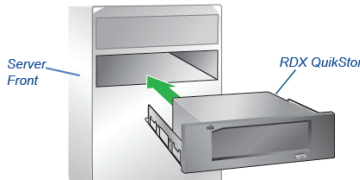

7. When done, reinstall the server **cover** and turn the computer **ON**.

Internal Interface Notes:

- **SATA interface** – SATA controller driver and BIOS support for AHCI is required, please verify and enable AHCI before you install the operating system on your computer device.
- **USB interface** – If you encounter connectivity problems, please order the appropriate accessory cable. Visit the Tandberg website for the currently available cables.

External Drive

The primary plug of the Y-cable should be connected to a USB 3.0 port for maximum transfer rate.

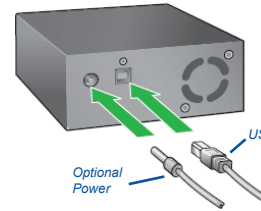

IMPORTANT: The RDX USB3+ drive is powered by the USB cable.

RDX External Power Options

In the event a single USB data port cannot fully power an RDX, connect the second plug of the RDX Y-cable to a neighboring USB port on the same system.

Cautions:

- The second plug of the Y-cable (for power) must be connected to a neighboring USB 3.0 or USB 2.0 port on the same host board.
- Do not plug the Y-cable into an AC/Wall USB power adapter of a different system.

Note that the external RDX also includes a power input jack which may be used as an alternative power input where there is no second USB port for power. Typical adapter specs: 5 VDC/2.4 A 5.5mm jack, or 12 VDC/1.0 A 5.5mm jack.

3 Update RDX Drive Firmware

1. Go to <ftp://ftp1.overlandtandberg.com/rdx>.
2. At the FTP site, click **Firmware**.
3. Check your current firmware **version** and, if a newer version is available, download and install it.

4 Features and LED Statuses (see table)

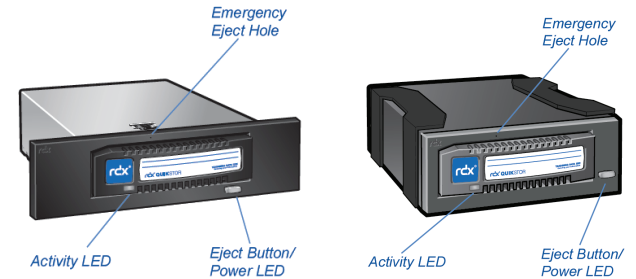

LED State		Media LED		Drive LED		Host
Color	Activity	Status	Description	Status	Description	Activity
	OFF	NOT READY	Media is not inserted properly or is powered down due to low power mode and host inactivity.	POWER DOWN	Drive does not have power through USB connection ¹ or does not have power through external adapter. ²	ON
	STEADY GREEN	READY	Media is ready.	READY	RDX is ready and working properly.	ON
	BLINKING GREEN	ACTIVITY	Reading, writing, or seeking.	EJECTING	Drive is ejecting Media.	ON
	STEADY AMBER	FAULT	RDX has detected a Media fault condition. For more information, run a diagnostic application.	FAULT	RDX has detected a Drive fault condition. For more information, run a diagnostic application.	ON
	STEADY GREEN Blinking Amber once eject button pressed	N/A		PREVENT	Host computer is accessing the media and the user has pressed Eject. The drive will eject the media after the Host access completes.	ON
	STEADY GREEN for 30 seconds, then OFF	N/A		POWER ³ SAVING	Press and hold Eject Button to eject RDX Media	OFF
	STEADY GREEN Blinking Amber once eject button pressed	N/A		POWER ³ SAVING	Press Eject Button to eject RDX Media	OFF

1. Only applicable for USB3+ RDX drives.

2. Even if power adapter is plugged in, drive is in a power saving state and LED is OFF until USB cable is connected.

3. Only applicable for USB3+ RDX drives with external power adapter.