

INDEX OF SHEETS

SHEET NO.	TITLE PAGE
2, 3	SUMMARY
4-8	PLAN SHEETS
CS-1, CS-2, CS-3, CS-4	STANDARD SHEETS
13	PLANTING DETAIL

STATE OF NEW HAMPSHIRE
DEPARTMENT OF PUBLIC WORKS AND HIGHWAYS

STATE	PROJ. NO.	SHEET NO.	TOTAL SHEETS
N.H.			

PLANS OF PROPOSED

I-93-1(131)21

LENGTH OF PROJECT - 1.1 MILES

N.H. PROJECT NO. P-2781 CONTRACT #2

LANDSCAPE PLANTING

THIS PROJECT TO BE CONSTRUCTED IN ACCORDANCE WITH
STANDARD SPECIFICATIONS DATED 1974

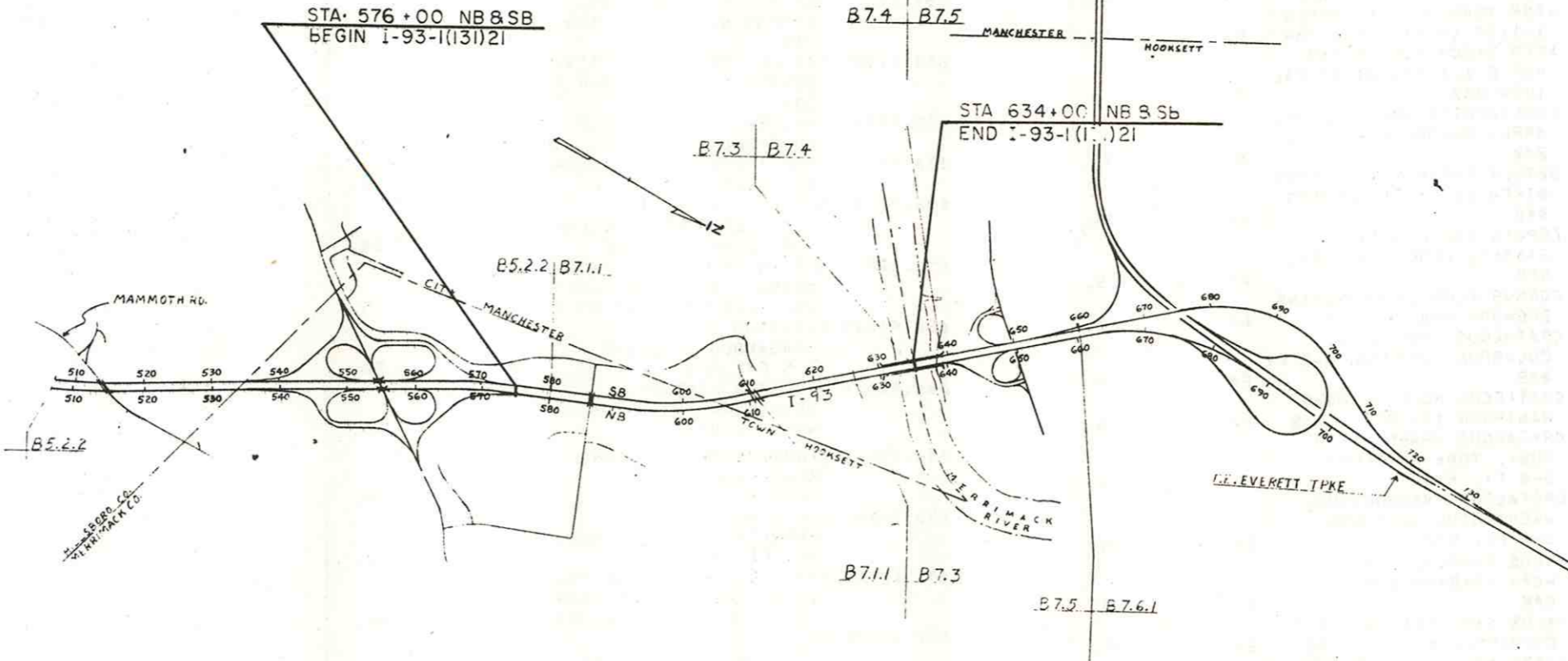
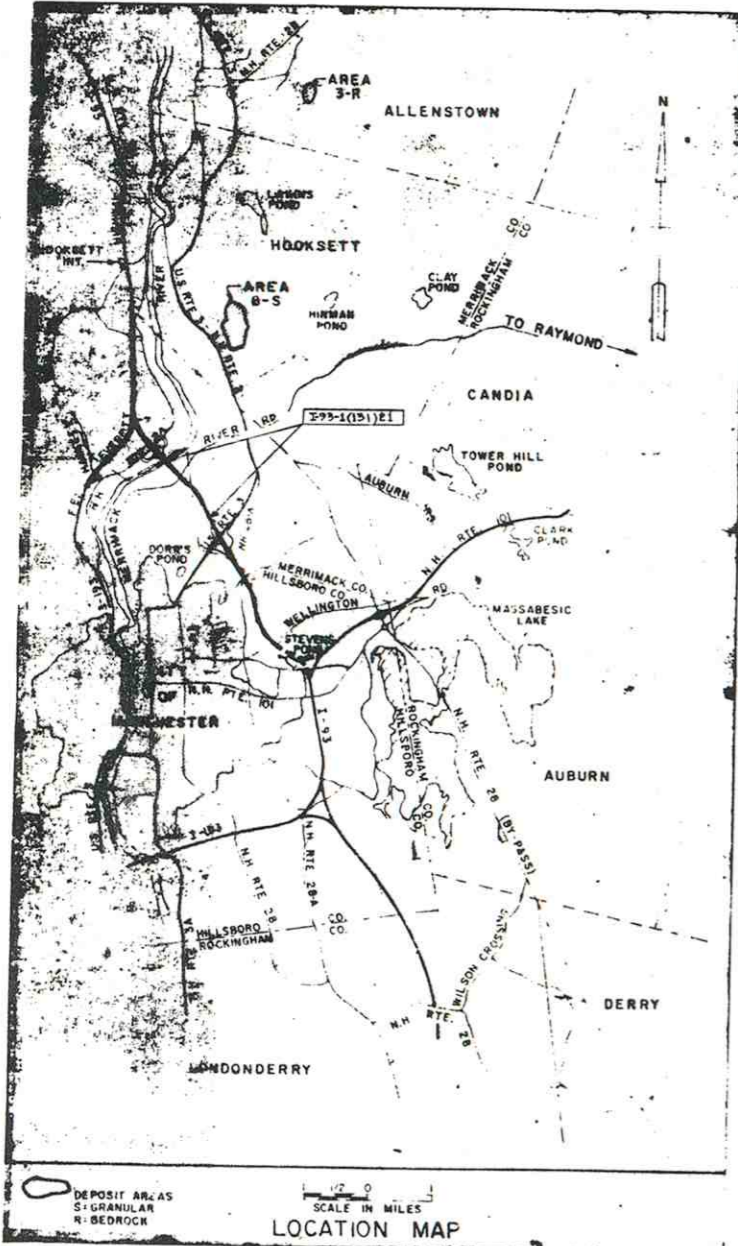

RECOMMENDED FOR APPROVAL DATE Aug. 24, 1977

John L. Oudens
SPECIAL SERVICES ENGINEER

RECOMMENDED FOR APPROVAL DATE Aug. 25, 1977

[Signature]
MAINTENANCE ENGINEER

RECOMMENDED FOR APPROVAL DATE 8-25-77

Russell W. Webb
DEPUTY COMMISSIONER AND CHIEF ENGINEER

APPROVED: John L. Oudens
COMMISSIONER

DEPARTMENT OF TRANSPORTATION
FEDERAL HIGHWAY ADMINISTRATION

APPROVED: _____
DIVISION ENGINEER

DATE _____

CONVENTIONAL SIGNS

STATE LINE	-----	R.O.W. LINE	-----
TOWN LINE	-----	SURVEY LINE	-----
FENCE	-----	CULVERT	-----
STONE WALL	-----	POWER POLE	-----
UNFENCED PROPERTY	-----	TELEPHONE POLE	-----
TRAVELED WAY	-----	TELEGRAPH POLE	-----
RAILROAD	-----	JOINT POWER & TEL. POLE	-----
RETAINING WALL	-----	GROUND ELEVATION (LEFT)	-----
SEWER MANHOLE	-----	GRADE ELEVATION (RIGHT)	-----
HYDRANT	-----	SLOPE LINE	-----
LEDGE	-----	CATCH BASIN	-----
BRUSH LINE	-----	DROP INLET	-----
SWAMP	-----	BOUND	-----
PROPERTY PARCEL NO.	-----	CLEARING & GRUBBING AREA	-----

1977 - 104(b)5 Study Section... B5.2.2 Etc.

THESE PLANS HAVE BEEN REDUCED PHOTOGRAPHICALLY
TO APPROXIMATELY 1/2 SCALE

DRAWN BY JAMES LAY
CHECKED BY
DATE 11-3-76

PROJ. NO.	SHEET NO.	TOTAL SHEETS
193-1(131)21	1	13

11/77 - 11/79

JAMES A. LAW (PROJ. ENGR.)

NOTE BOOKS
BOOK NO. _____ PAGE NO. _____

SUMMARY OF QUANTITIES (ESTIMATED)
THIS INFORMATION IS FOR BIDDING PURPOSES ONLY

* NOT AN ITEM TOTAL

ITEM NUMBER	ITEM DESCRIPTION	UNIT	QUANTITY
651.40071	PINUS N. AUSTRIACA, AUSTRIAN PINE 7-8 FT. B&B	EA	35.
651.52051	PINUS STROBUS, WHITE PINE 5-6 FT. B&B	EA	64.
651.52071	PINUS STROBUS, WHITE PINE 7-8 FT. B&B	EA	100.
651.52081	PINUS STROBUS, WHITE PINE 8-10 FT. B&B	EA	90.
651.52011	PINUS STROBUS, WHITE PINE 10-12 FT. B&B	EA	48.
652.01061	ACER GINNALA, AMUR MAPLE 6-8 FT. B&B	EA	19.
652.04401	ACER PLATANOIDES SUMMER-SHADE, NOR. MAPLE S'SHADE 1-3/4"-2" CALIPER B&B	EA	12.
652.11301	ACER RUBRUM, RED MAPLE 1-1/2"-1-3/4" CAL. B&B	EA	63.
652.13201	ACER SACCHARUM, SUGAR MAPLE 1-1/4"-1-1/2" CALIPER B&B	EA	12.
652.21041	AMELANCHIER GRANDIFLORA, APPLE SHADDBLOW 4-5 FT. B&B	EA	27.
652.30014	BETULA POPYRIFERA, PAPER BIRCH 10-12 FT. CLUMPS B&B	EA	36.
652.45061	CERCIS CANADENSIS, EASTERN REDBUD 6-8 FT. B&B	EA	5.
652.53061	CORNUS FLORIDA, FLOWERING DOGWOOD 6-8 FT. B&B	EA	21.
652.58041	CRATAEGUS CRUGALLI, COCKSPUR HAWTHORN 4-5 FT B&B	EA	9.
652.61011	CRATAEGUS MOLLIS, DOWNY HAWTHORN 10-12 FT. B&B	EA	15.
652.66051	CRATAEGUS PHAENOPYRUM TOBA, TOBA HAWTHORN 5-6 FT. B&B	EA	17.
652.67061	CRATAEGUS PHAENOPYRUM, WASHINGTON HAWTHORN 6-8 FT. B&B	EA	46.
653.27061	MALUS PURPUREA HOPA, HOPA CRABAPPLE 6-8 FT. B&B	EA	3.
653.35041	MALUS SARGENTI, SARGENT CRABAPPLE 4-5 FT. B&B	EA	21.
653.41061	NYSSA SYLVATICA, BLACK TUPELO 6-8 FT. B&B	EA	11.
653.66401	QUERCUS BOREALIS, NORTH-ERN RED OAK 1-3/4"-2" CALIPER B&B	EA	62.
653.66601	QUERCUS BOREALIS, NORTH ERN RED OAK 2-1/2"-3" CAL. B&B	EA	26.
653.76061	ROBINIA PSEUDOACACIA, BLACK LOCUST 6-8 FT. B&B	EA	10.
653.98401	TILIA CORDATA GREENSPIRE, GREENSPIRE LINDEN 1-3/4"-2" CAL. B&B	EA	2.
654.45011	KALMIA LATIFOLIA, MOUNTAINLAUREL 2-2-1/2 FT. B&B	EA	100.
655.20041	CARAGANA ARBORESCENS, SIBERIAN PEASHRUB 4-5 FT B&B	EA	26.
655.23031	CORNUS RACEMOSA, GRAY DOGWOOD 3-4 FT. B&B	EA	20.
655.41041	ELAEAGNUS UMBELLATA, AUTUMN ELAEAGNUS 4-5 FT. B&B	EA	79.
655.57041	HAMAMELIS VIRGINIANA, COMMON WITCHHAZEL 4-5 FT B&B	EA	16.
655.71031	LINDERA RENZOIN AESTIVALE COMMON SPICEBUSH 3-4 FT. B&B	EA	7.
655.74041	LONICERA MAACKI, AMUR HONEYSUCKLE 4-5 FT. B&B	EA	50.
656.0318	RHUS AROMATICA, FRAGRANT SUMAC 18"-24"	EA	55.
656.57041	SYRINGA ISABELLA, ISABELLA PRESTON LILAC HYBRID 4-5 FT. B&B	EA	18.
656.62041	SYRINGA KATHARINE HAVEMEYER, KATHARINE HAVEMEYER LILAC HYB, 4-5 FT B&B	EA	5.
656.91041	VIBURNUM DENTATUM, ARROWWOOD VIBURNUM 4-5 FT. B&B	EA	28.
656.94041	VIBURNUM LENTAGO, NANNYBERRY VIBURNUM 4-5 FT. B&B	EA	23.
656.95041	VIBURNUM PRUNIFOLIUM, BLACKHAW VIBURNUM 4-5 FT. B&B	EA	80.
656.98041	VIBURNUM TRILOBUM, AMERICAN CRANBERRYBUSH 4-5 FT. B&B	EA	7.
657.12022	CAMPISIS TAGLIARUANA MME. GALEN, MMF. GALEN TRUMPETCRPEPER 2 YR. #1 PC	EA	80.
657.14022	CELASTRUS SCANDENS, AMERICAN BITTERSWEET 2 YR. #1 PC	EA	50.
657.45022	PARTHENOISSUS QUINQUE-FOLIA, VIRGINIA CREEPER 2 YR. #1 PC	EA	50.

CONSTRUCTION SIGNING PROJECT REQUIREMENTS

ITEM 619.2

OPERATIONAL CONTROLS	CODE	NO. REQUIRED
SIGN	W20-1d	5
	W20-8	3
BARRICADE	TYPE II	2
EASEL	-	9
TRAFFIC CONE	36" BLAZE ORANGE	36

MISCELLANEOUS ITEM

ITEM 618.109 UNIFORMED OFFICERS AND FLAGMEN ESTIMATED \$2800.00

KEY

██████ BARK MULCH BED

REVISIONS

DATE	BY	DESCRIPTION

DATE _____ DATE _____ DATE _____

COMPILED BY _____ CHECKED BY _____

SUMMARY OF QUANTITIES (ESTIMATED)
THIS INFORMATION IS FOR BIDDING PURPOSES ONLY

* NOT AN ITEM TOTAL

NOTE BOOKS
BOOK NO. PAGE NO.

ITEM NO. ITEM	651.40071 AUSTRIAN PINE 7-8'	651.52051 WHITE PINE 5'-6'	651.52071 WHITE PINE 7-8'	651.52081 WHITE PINE 4'-10'	651.52011 WHITE PINE 10-12'	652.01061 AMUR MAPLE 6'-8'	652.04401 NORWAY MAPLE SUMMERSHADE 1 3/4" - 2" CAL.	652.11301 RED MAPLE 1 1/2" - 1 3/4" CAL.	652.13201 SUGAR MAPLE 1 1/4" - 1 1/2" CAL.	652.21041 APPLE SHADBLow 4'-5'	652.30014 PAPER BIRCH 10'-12' CLUMPS	652.45061 EASTERN RED BUD 6'-8'	652.53061 FLOWERING DOGWOOD 6'-8'	652.58041 COCKSPOUR HANTHORN 4'-5'
SHEET NUMBER														
4	-	45'	47 11	-	-	-	-	10' 7	-	9'	13' 11	-	-	9'
5	-	19'	47 44	29' 25	11' 7	19'	-	15' 10	-	5'	-	5'	21'	- 42
6	32' 12	-	20' 31	52' 54	30' 16	-	1'	30' 26	12'	-	18' 10	-	-	-
7	3'	-	17' 14	9' 7	7' 6	-	-	-	-	13'	7'	-	-	-
8	-	-	-	-	-	-	11' 12	-	-	-	-	-	-	-
TOTAL	35' 15	64' 65	100'	96' 86	48' 29	19' 20	12' 13	65' 43	12'	27'	36' 28	5'	21'	7' 51

ITEM NO. ITEM	652.61011 DOWNY HANTHORN 10'-12'	652.66051 TOBA HANTHORN 5'-6'	652.67061 WASHINGTON HANTHORN 6'-8'	653.27061 HORA CRABAPPLE 6'-8'	653.35041 SARGENT CRABAPPLE 4'-5'	653.41061 BLACK TUPEDO 6'-8'	653.66401 NORTHERN RED OAK 1 3/4" - 2" CAL.	653.66601 NORTHERN RED OAK 2 1/2" - 3" CAL.	653.76061 BLACK LOCUST 6'-8'	653.98401 LITTLELEAF LINDEN-GRENSPEE 1 3/4" - 2" CAL.	654.45011 MOUNTAIN LAUREL 2'-2 1/2'	655.20041 SIBERIAN PEASHURB 4'-5'
SHEET NUMBER												
4	-	10'	18'	-	-	5'	24' 9	-	-	-	-	-
5	15'	7'	-	-	-	3'	11'	-	-	-	35' 100	-
6	-	-	18'	3'	13'	2'	15'	11'	10' 5	-	25'	26'
7	-	-	-	-	5'	-	12'	4'	7' 4	-	-	-
8	-	-	10'	-	3'	-	-	7' 4	-	2'	-	-
TOTAL	15' 0	17'	46'	3'	21'	11' 0	62' 28	26' 21	10' 5	2'	106' 125	26'

ITEM NO. ITEM	656.23031 GRAY DOGWOOD 3'-4'	656.41041 AUTUMN FLAEGHUS 4'-5'	656.57041 COMMON WITCHHAZEL 4'-5'	656.71031 COMMON SPICEBUSH 3'-4'	656.74041 AMUR HONEYBUCKLE 4'-5'	656.0318 FRAGRANT SUMAC 18"-24"	656.57041 LAVENDER PRESHY LILAC 4'-5'	656.62041 KATHERINE HAN LILAC 4'-5'	656.91041 ACORNWOOD VIBURNUM 4'-5'	656.94041 HANNIBERRY VIBURNUM 4'-5'	656.95041 BLACKHAW VIBURNUM 4'-5'	656.98041 AMERICAN CRANBERRY BUSH 4'-5'	657.12022 MME. GALEN TAMPE-CREPER 2 YR. #1
SHEET NUMBER													
4	-	-	7'	-	-	55'	11'	-	6' 3	-	22'	7' 4	80' 44
5	20'	53'	9'	-	50' 45	-	-	-	15'	23' 16	22'	-	-
6	-	26'	-	7' 1	-	-	-	-	7'	-	16'	-	-
7	-	-	-	-	-	-	-	-	-	-	-	-	-
8	-	-	-	-	-	-	-	-	-	-	-	-	-
TOTAL	20'	79'	16' 0	7' 1	50' 45	55'	18' 0	5' 0	28' 3	23' 16	80' 0	7' 4	80' 44

ITEM NO. ITEM	657.14022 AMERICAN BITTERSWEET 2 YR. #1	657.45022 VIRGINIA CREEPER 2 YR. #1	S.A. 651.40051 AUSTRIAN PINE 5'-6'	S.A. 651.40061 AUSTRIAN PINE 6'-7'	S.A. 651.52061 WHITE PINE 6'-7'	S.A. 652.08601 SUMMERSHADE NOR MAPLE 2 1/4" - 3" CAL.	S.A. 652.11 RED MAPLE 1" - 1 1/4" CAL.	S.A. 652.11201 RED MAPLE 1 1/4" - 1 1/2" CAL.	S.A. 652.11401 RED MAPLE 1 1/4" - 2" CAL.	S.A. 652.53051 FLOWERING DOGWOOD 5'-6'	S.A. 652.75401 GREEN ASH 1 1/4" - 2" CAL.	S.A. 653.20 CARMINE CRABAPPLE 10-12'	S.A. 653.91051 BLACK TUPEDO 5'-6'	S.A. 655.45 WINGED RUONIMUS 3'-4'	S.A. 655.55 EARLY FORSYTHIA 3'-4'
SHEET NUMBER															
4	50' 86	-	-	-	3	-	-	3	2	1	15'	-	4	22	-
5	-	-	-	-	13	-	-	9	6	6	8	15	4	-	-
6	-	50'	12	8	3	-	-	9	6	6	7	-	-	-	-
7	-	-	-	-	1	-	-	-	-	-	4	-	-	-	16
8	-	-	-	-	-	2	-	-	-	-	-	-	-	-	-
TOTAL	50' 86	50'	12	8	22	5	5	20	8	7	34	15	4	22	16

ITEM NO. ITEM	S.A. 655.27041 COMMON WITCHHAZEL 3'-4'	S.A. 655.71451 RED THREARROW HONEYBUCKLE 4'-5'	S.A. 656.573 ELLEN WILLMUT LILAC 4'-5'	S.A. 656.713 WILLOW LILAC 4'-5'	S.A. 656.91341 ACORNWOOD VIBURNUM 3'-4'	S.A. 656.91451 ACORNWOOD VIBURNUM 4'-5'	S.A. 656.95231 BLACKHAW VIBURNUM 2'-3'
SHEET NUMBER							
4	7	-	16	-	6	-	-
5	9	5	-	-	15	-	7
6	-	-	-	-	7	-	-
7	-	-	7	3	-	-	-
8	-	-	-	-	-	-	-
TOTAL	16	5	23	3	28	6	7

DATE DATE DATE
DATE DATE DATE

Log Cabin

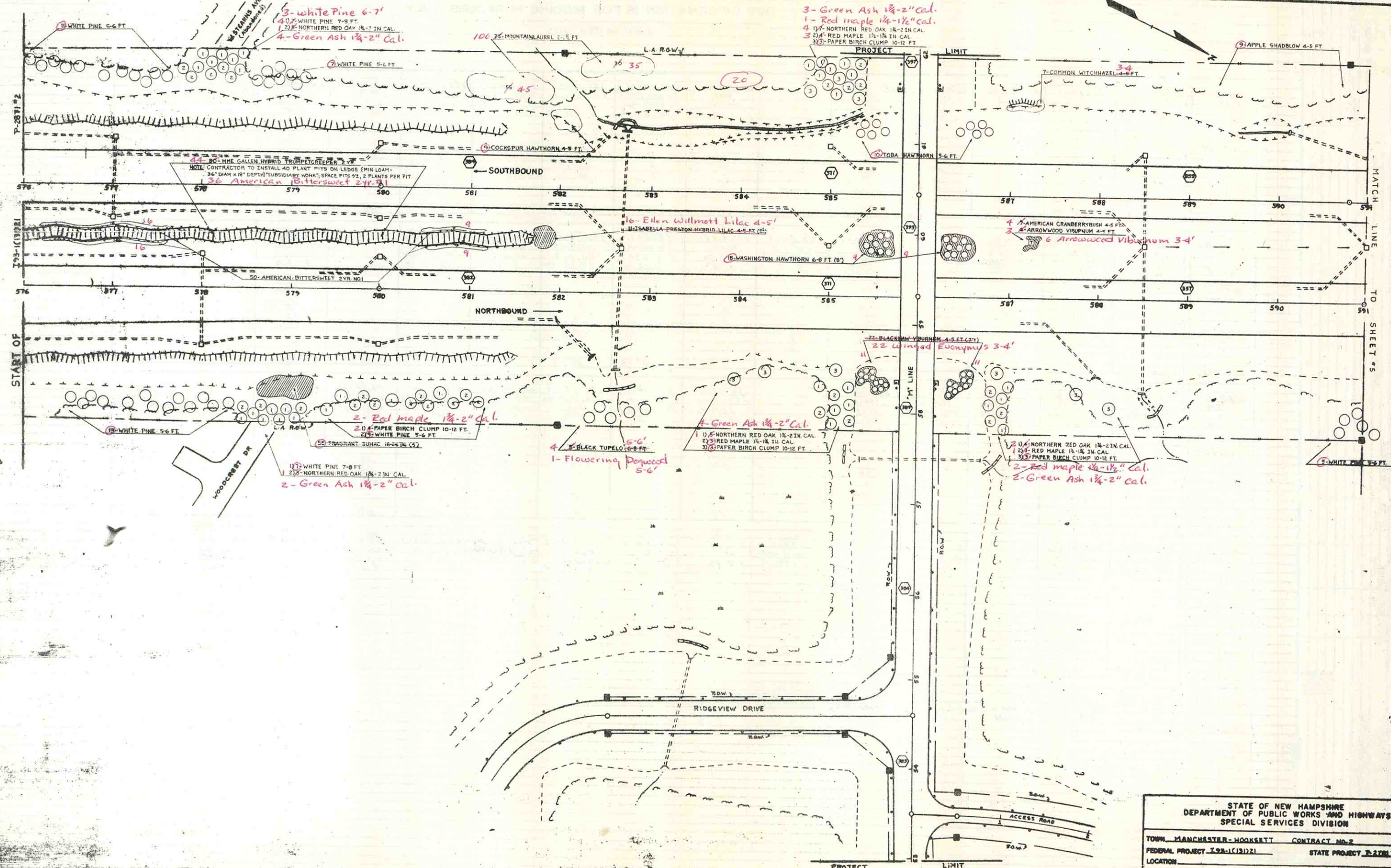

STATE OF NEW HAMPSHIRE
DEPARTMENT OF PUBLIC WORKS AND HIGHWAYS
SPECIAL SERVICES DIVISION

TOWN MANCHESTER-HOOKSETT CONTRACT NO. 2
FEDERAL PROJECT 128-1(13)21 STATE PROJECT 2-2781-2
LOCATION _____

DESIGNED	BY	DATE	CHECKED	BY	DATE	SPECIAL SERVICES
DRAWN	J. LAY	8/77	CHECKED			SHEET NO.
TRACED			CHECKED			OF
QUANTITIES			CHECKED			FILE NUMBER

APPROVED BY _____

REVISIONS

PROJECT NO. I 93-1(13)21 SHEET NO. 4 OF 13

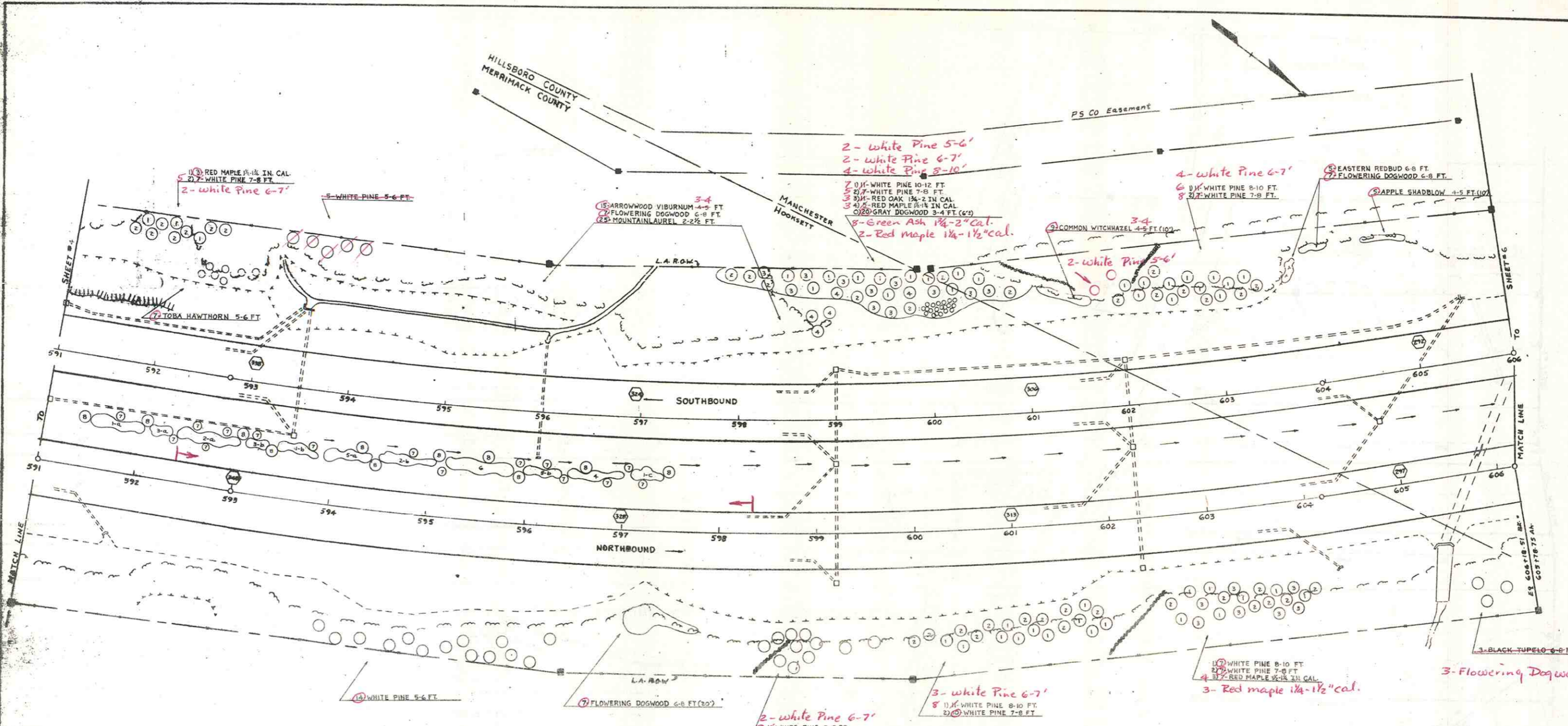

592+50-596+50
 MEDIAN PLANTING (STA 591+50-597+50)

1-a) 1) AUTUMN ELAEAGNUS 4-5 FT (8")	
1-b) 2) " " " " " " " "	
1-c) 3) " " " " " " " "	
2-a) 2) AMUR HONEYSUCKLE 4-5 FT (8")	5-Red Tartarian Honeysuckle 4-5'
2-b) 3) " " " " " " " "	
3-a) 1) SIBERIAN PEASHRUB 4-5 FT (8")	
3-b) 2) " " " " " " " "	
4) 2) NANNYBERRY VIBURNUM 4-5 FT (8")	7-Blackhaw Viburnum 2-3'
5) 1) 2) BLACKHAW VIBURNUM 4-5 FT (8")	21-Cockspur Hawthorn 4-5'
6) 1) 2) AMUR MAPLE 6-8 FT (10")	15-Carmine Crabapple 10-12'
7) 1) 2) DOWNY HAWTHORN 10-12 FT	
8) 1) 2) NORTHERN RED OAK 2 1/2-3 IN CAL	

STATE OF NEW HAMPSHIRE
 DEPARTMENT OF PUBLIC WORKS AND HIGHWAYS
 SPECIAL SERVICES DIVISION

TOWN MANCHESTER-HOOKSET CONTRACT NO 2
 FEDERAL PROJECT 193-1(131)21 STATE PROJECT T-2721-28
 LOCATION

DESCRIPTION	BY	DATE	CHECKED	BY	DATE	SPECIAL SERVICES SHEET NO. OF FILE NUMBER
DESIGNED						
DRAWN	J.A.LAW	8/77	CHECKED			
TRACED			CHECKED			
QUANTITIES			CHECKED			
APPROVED BY			REVIEWED BY			
			PROJ. NO.		SHEET NO.	TOTAL SHEETS
			193-1(131)21		5	13

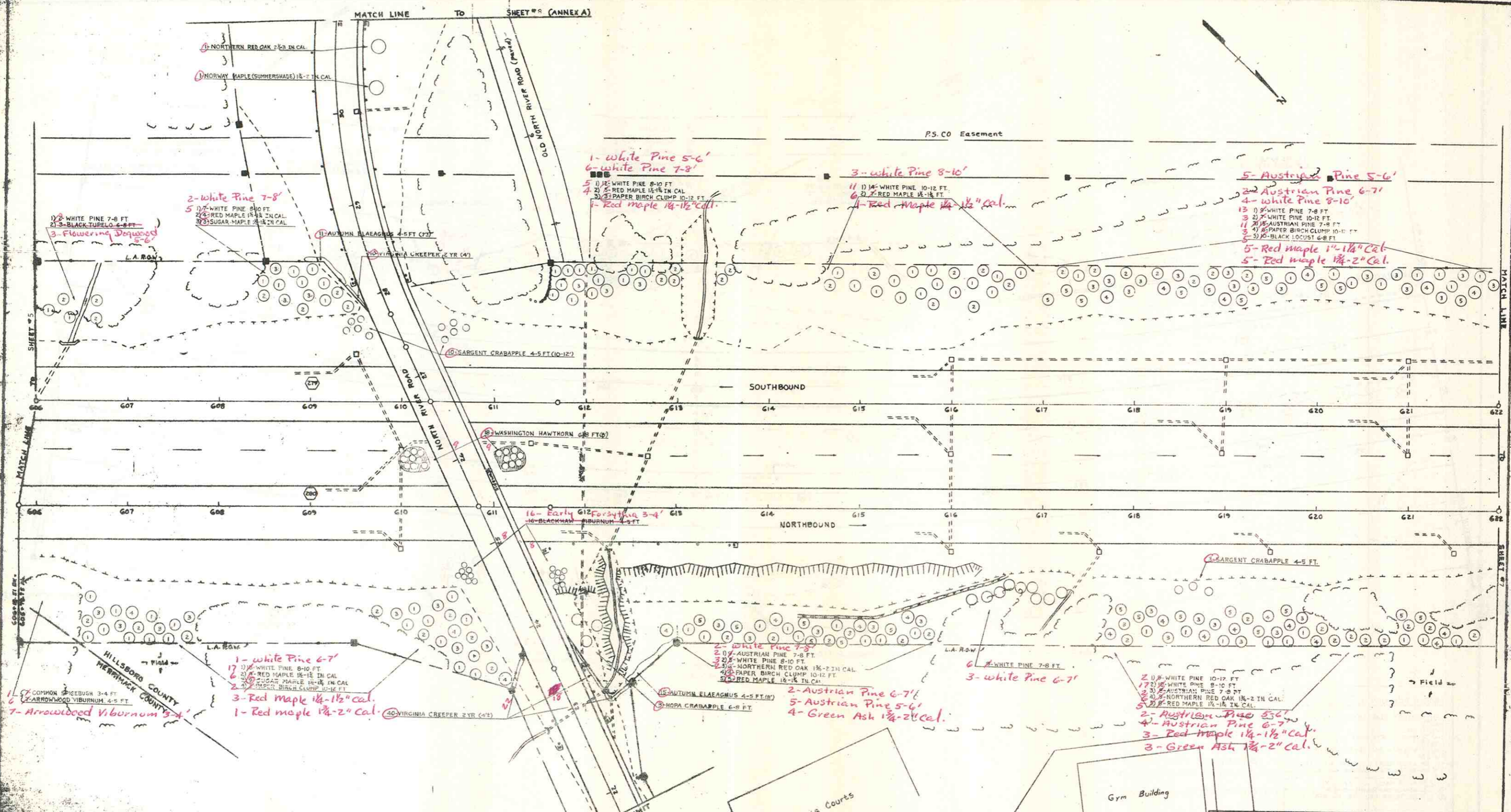

1- white Pine 5-6'
 6- white Pine 7-8'
 5- 1) 1/2 WHITE PINE 8-10 FT
 2) 5- RED MAPLE 1 1/2 IN CAL
 3) 3- PAPER BIRCH CLUMP 10-12 FT
 4- Red maple 1 1/2-1 1/2" cal.

3- white Pine 8-10'
 1) 1/2 WHITE PINE 10-12 FT
 2) 7- RED MAPLE 1 1/2-1 1/2" cal.

5- Austrian Pine 5-6'
 2- Austrian Pine 6-7'
 4- white Pine 8-10'
 13) 1) 1/2 WHITE PINE 7-8 FT
 2) 7- WHITE PINE 10-12 FT
 3) 15- AUSTRIAN PINE 7-8 FT
 4) 6- PAPER BIRCH CLUMP 10-12 FT
 5) 10- BLACK LOCUST 6-8 FT
 5- Red maple 1 1/2-1 1/2" Cal.
 5- Red maple 1 1/2-2" Cal.

2- white Pine 7-8'
 5) 7- WHITE PINE 8-10 FT
 2) 4- RED MAPLE 1 1/2 IN CAL
 3) 3- SUGAR MAPLE 1 1/2 IN CAL

1) 2- WHITE PINE 7-8 FT
 2) 3- BLACK TUPELO 6-8 FT
 3- Flowering Dogwood

1) 1- AUTUMN ELAEAGNUS 4-5 FT (7-2)
 2) VIRGINIA CREEPER 2 YR (4-5)

1) 1- SARGENT CRABAPPLE 4-5 FT (10-12)

1) 1- WASHINGTON HAWTHORN 6-8 FT (9)

1) 1- Early Forsythia 3-4'
 2) 1- BLACK HAW VIBURNUM 4-5 FT

1) 1- COMMON SPREBUSH 3-4 FT
 2) 1- ARROWWOOD VIBURNUM 4-5 FT
 3) 1- Arrowwood Viburnum 5-4'

1- white Pine 6-7'
 12) 1) 1/2 WHITE PINE 8-10 FT
 2) 4- RED MAPLE 1 1/2 IN CAL
 3) 3- SUGAR MAPLE 1 1/2 IN CAL
 4) 3- PAPER BIRCH CLUMP 10-12 FT
 3- Red maple 1 1/2-1 1/2" cal.
 1- Red maple 1 1/2-2" cal.

1) 1- AUTUMN ELAEAGNUS 4-5 FT (8)
 2) 1- HOPE CRABAPPLE 6-8 FT

2- white Pine 7-8'
 2) 1/2- AUSTRIAN PINE 7-8 FT
 3) 5- WHITE PINE 8-10 FT
 4) 2- NORTHERN RED OAK 1 1/2-2 IN CAL
 5) 2- PAPER BIRCH CLUMP 10-12 FT
 6) 5- RED MAPLE 1 1/2-1 1/2 IN CAL
 2- Austrian Pine 6-7'
 5- Austrian Pine 5-6'
 4- Green Ash 1 1/2-2" cal.

6- white Pine 7-8 FT
 3- white Pine 6-7'

2) 1/2- WHITE PINE 10-12 FT
 12) 1) 1/2 WHITE PINE 8-10 FT
 3) 5- AUSTRIAN PINE 7-8 FT
 4) 2- NORTHERN RED OAK 1 1/2-2 IN CAL
 5) 2- RED MAPLE 1 1/2-1 1/2 IN CAL
 2- Austrian Pine 5-6'
 4- Austrian Pine 6-7'
 3- Red maple 1 1/2-1 1/2" cal.
 3- Green Ash 1 1/2-2" cal.

STATE OF NEW HAMPSHIRE
 DEPARTMENT OF PUBLIC WORKS AND HIGHWAYS
 SPECIAL SERVICES DIVISION

TOWN MANCHESTER-HOOKSETT CONTRACT No. 2
 FEDERAL PROJECT 193-1(181)2 STATE PROJECT T-5781-E
 LOCATION _____

DESIGNED	BY	DATE	CHECKED	BY	DATE	SPECIAL SERVICES SHEET NO.
DRWN	J.A. LAW	8/77	CHECKED			67
TRACED			CHECKED			FILE NUMBER
QUANTITIES			CHECKED			

APPROVED BY _____ REVIEWED BY _____

PROJ. NO. 193-1(181)2 SHEET NO. 6 TOTAL SHEETS

(Consolidated)

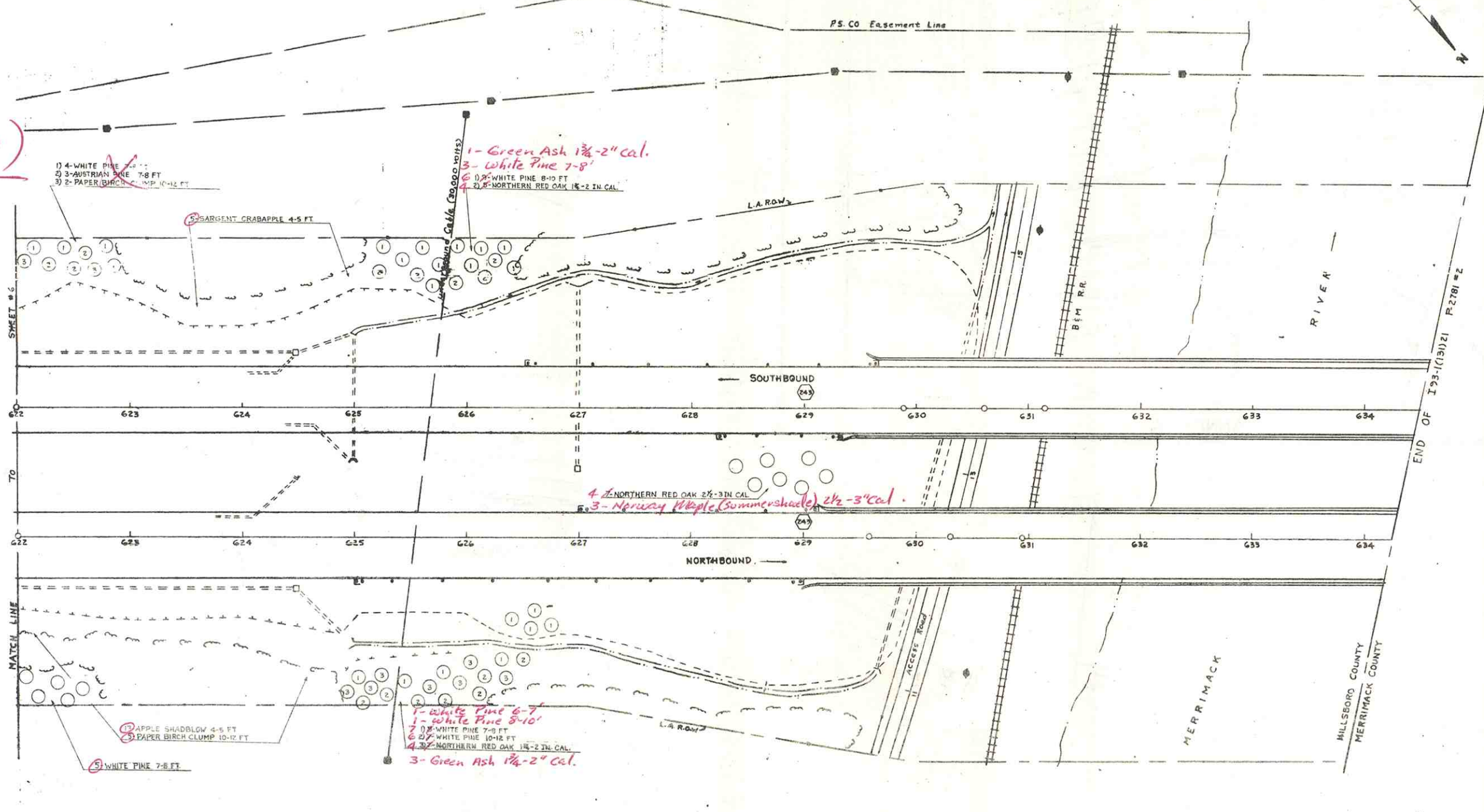

STATE OF NEW HAMPSHIRE
 DEPARTMENT OF PUBLIC WORKS AND HIGHWAYS
 SPECIAL SERVICES DIVISION

TOWN MANCHESTER - HOOKSETT CONTRACT NO. 2
 FEDERAL PROJECT I93-1(13)21 STATE PROJECT P-2781-2
 LOCATION _____

DESCRIPTION	BY	DATE	QUANTITIES	REVISIONS

DESIGNED	BY	DATE	CHECKED	BY	DATE	SPECIAL SERVICES SHEET NO. OF

APPROVED BY	REVIEWED BY	PROJ. NO.	SHEET NO.	TOTAL SHEETS

I93-1(13)21 7 13

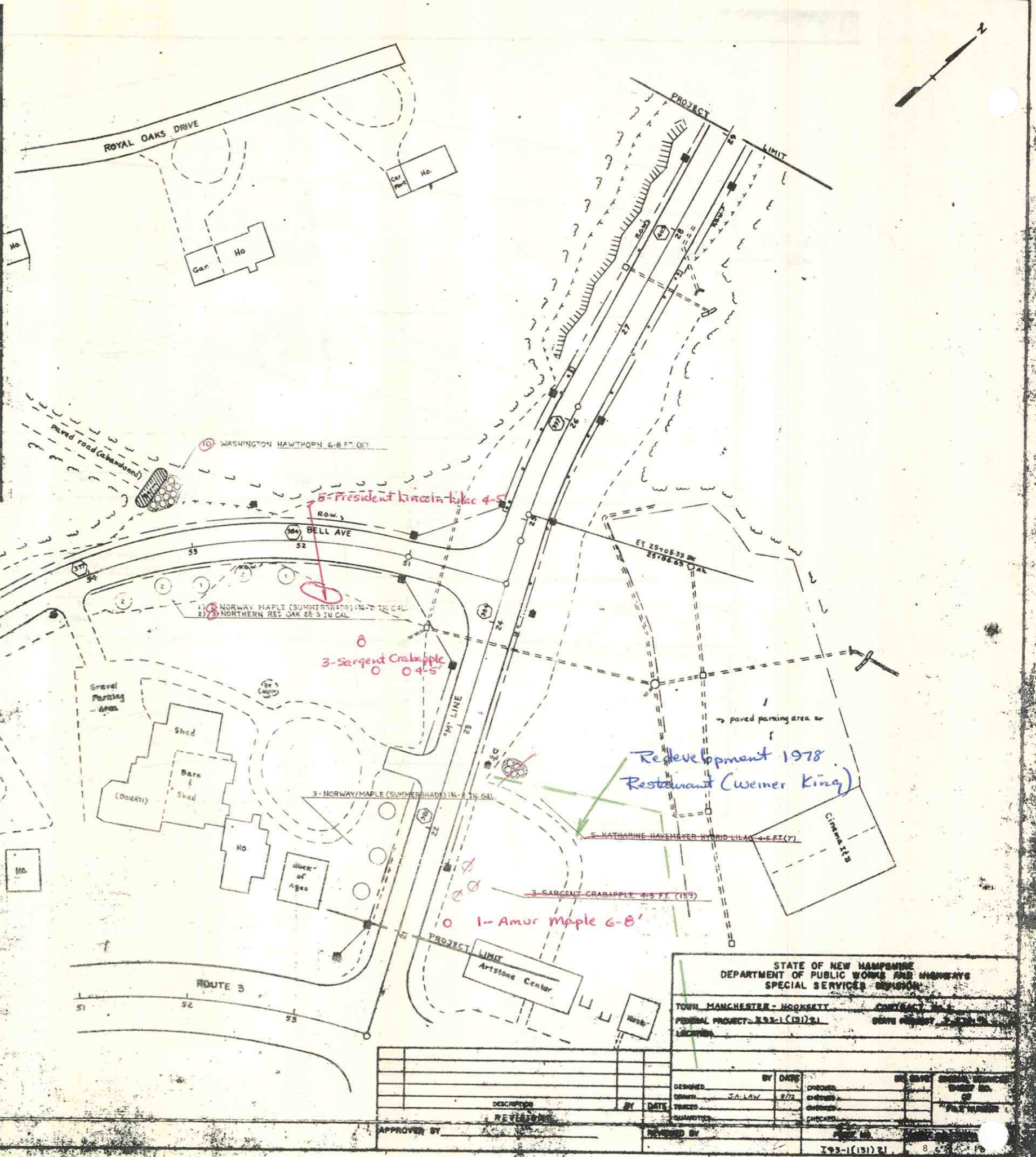
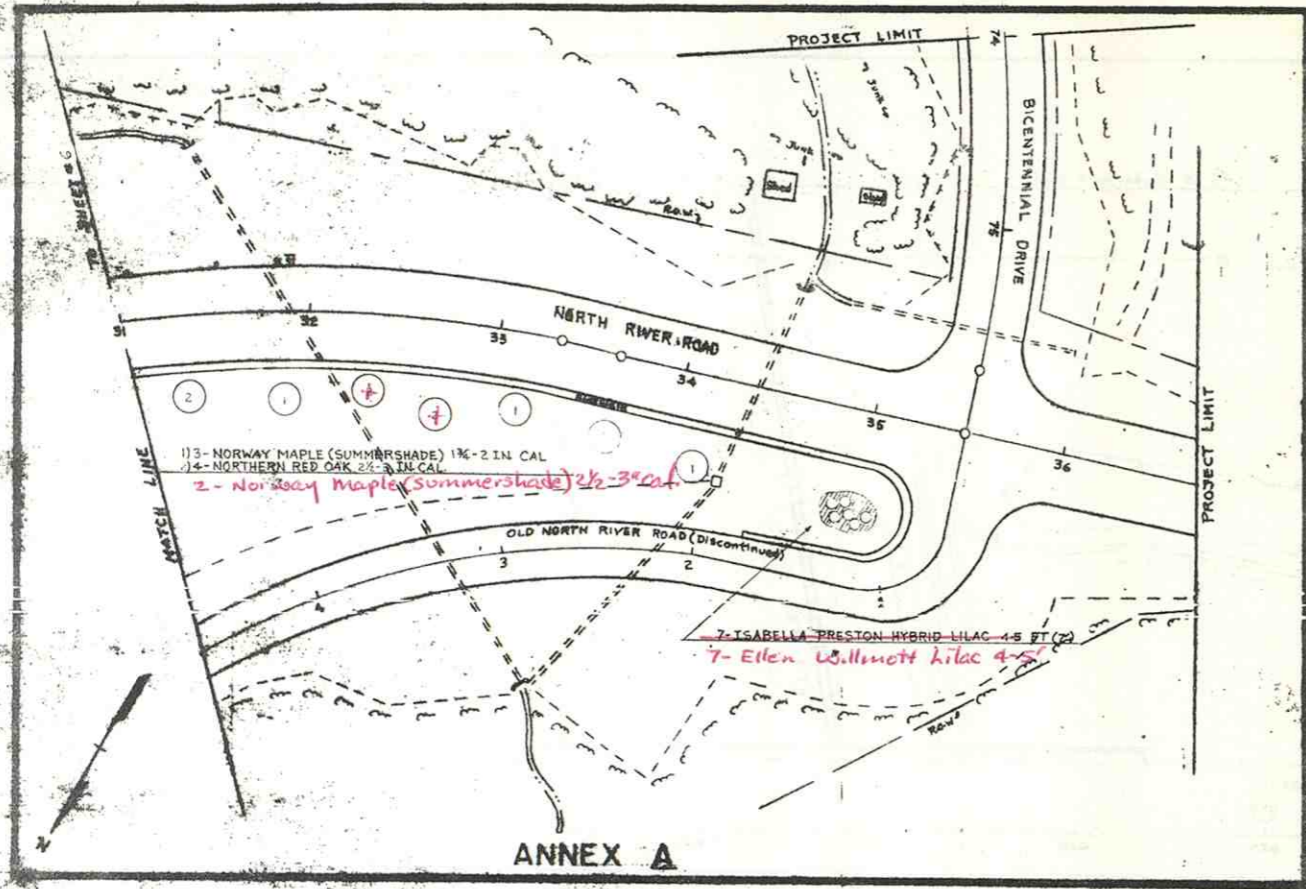

ANNEX A

Redevelopment 1978
Restaurant (Weiner King)

STATE OF NEW HAMPSHIRE
DEPARTMENT OF PUBLIC WORKS AND HIGHWAYS
SPECIAL SERVICES DIVISION
TOWN MANCHESTER - HOOKSETT
FEDERAL PROJECT - R32-1(13)21

DESCRIPTION	BY	DATE	APPROVED	BY	DATE
DESIGNED	J.A. LAW	8/77	CHECKED		
DRAWN			CHECKED		
REVISIONS			CHECKED		
APPROVED BY			REVIEWED BY		

APPROVED *John A. Moran*
COMMISSIONER
APPROVED *Walter J. ...*
DEPUTY COMMISSIONER &
CHIEF ENGINEER

STATE OF NEW HAMPSHIRE
DEPARTMENT OF PUBLIC WORKS AND HIGHWAYS
STANDARD CONST. SIGNING
CONCORD, N.H. JUNE 1, 1962

REVISIONS	DATE
1	10/26/60
2	4/2/63
3	1/17/67
4	1/17/67
5	1/17/67
6	1/17/67
7	1/17/67

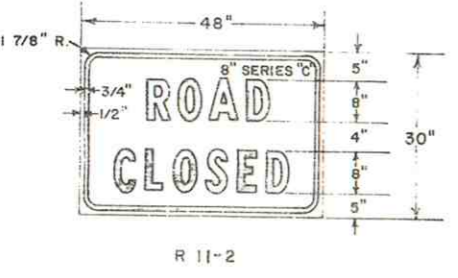
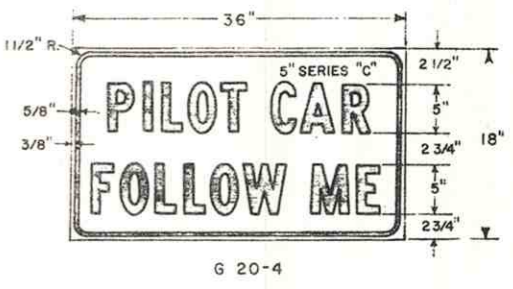
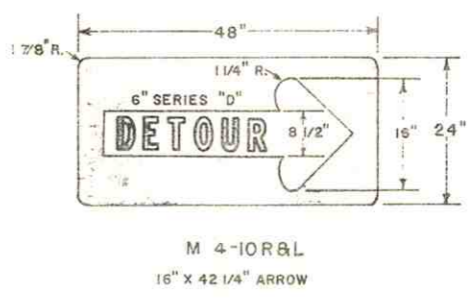
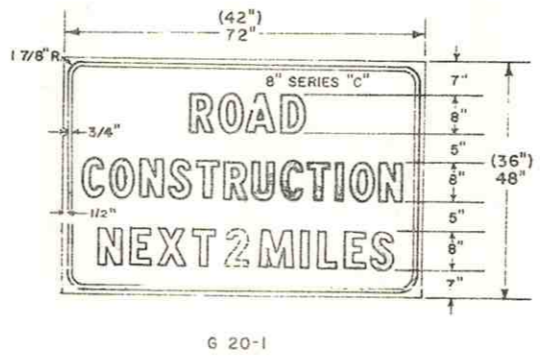
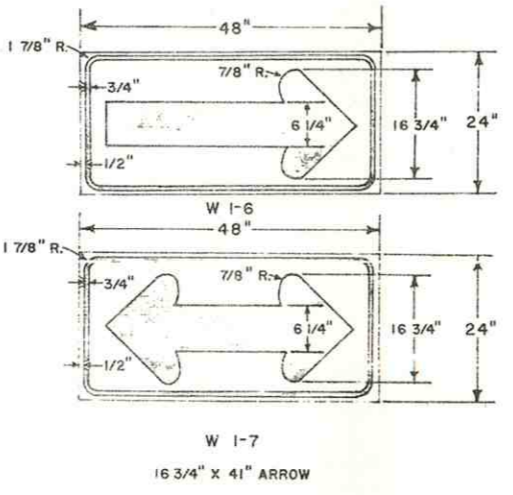
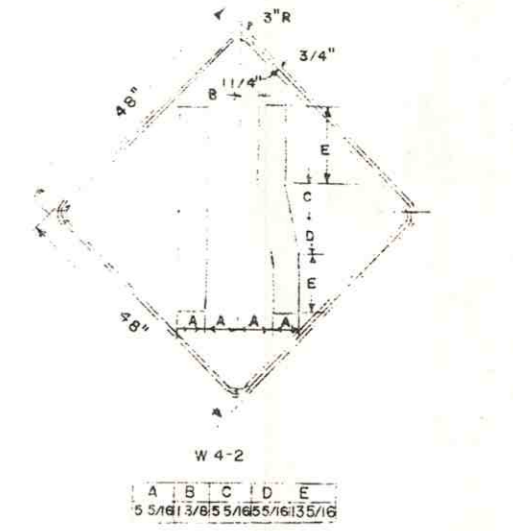
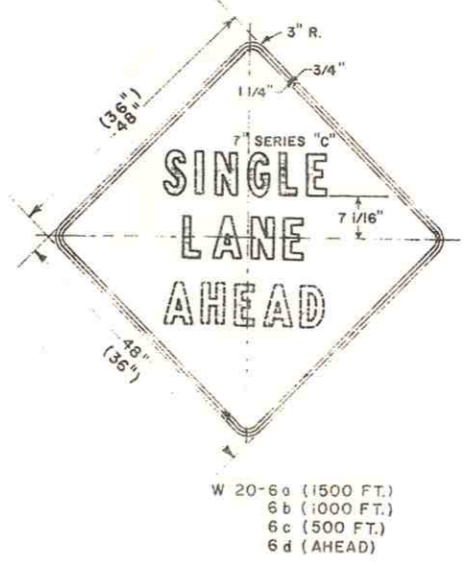
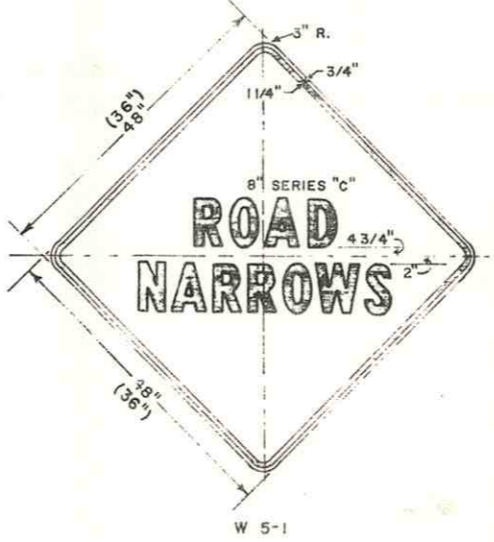
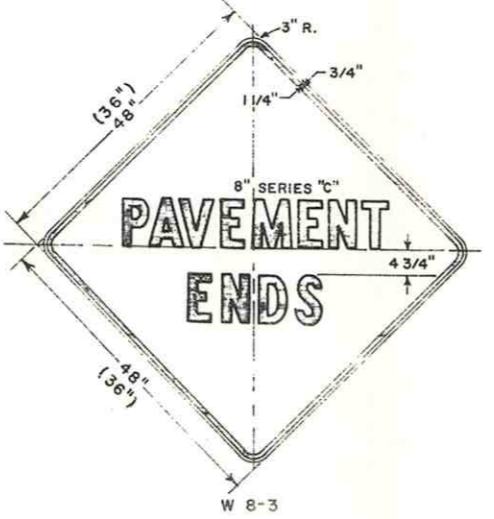
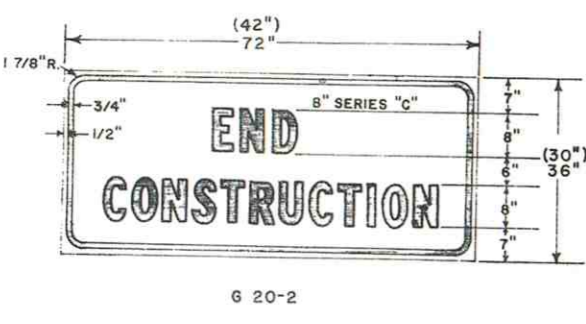
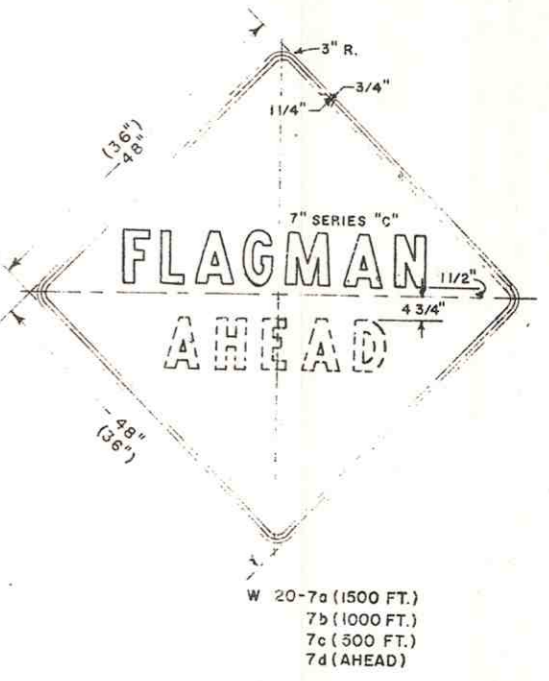
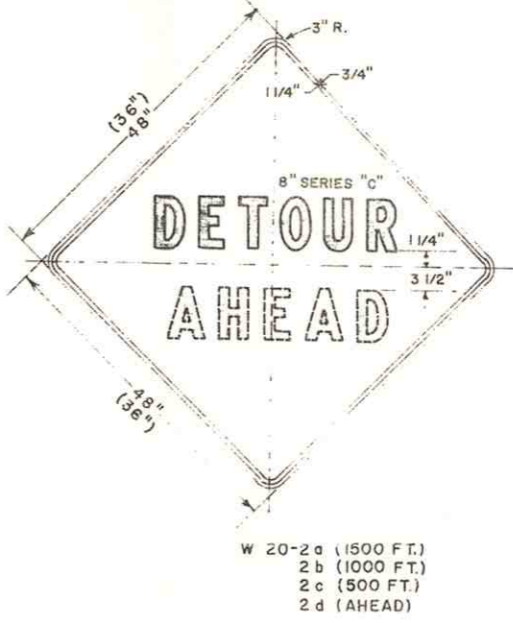
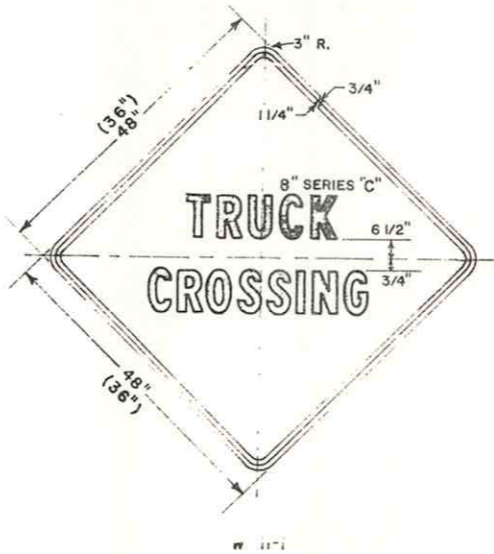
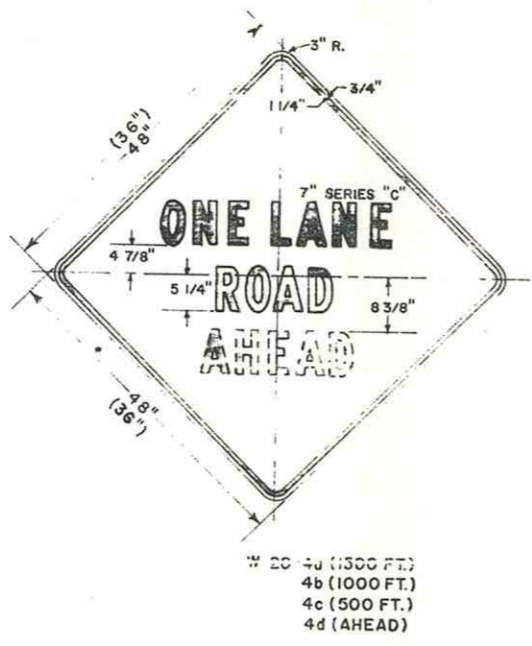
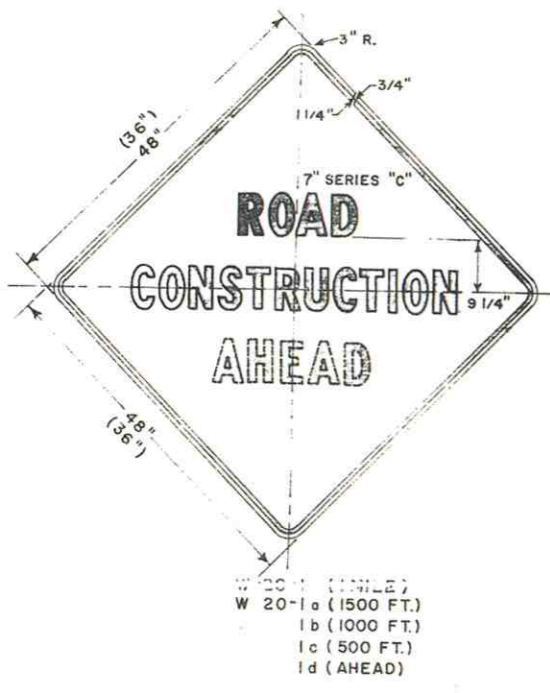

NOTES:
All signs indicated on this sheet shall have black text on reflective sheeting background. See Standard Sheet CS-2 for background color designation.
All signs shall be mounted on two (2) posts; vertical clearance, rural 5', urban 7'. See Standard Sheet CS-4 sign installation detail. Exception: sign designations R4-1 & R4-7A shall be single post mounted.
(36") indicates alternate sizes for use in urban areas where prevailing speeds are lower and it is necessary to minimize sidewalk obstruction. Sign copy shall be reduced accordingly.

