

IPAEXPORT

The Caribbean's Primary Source for Hotel, Restaurant & Laundry Equipment/Supplies
3770 S.W. 30th Avenue Tel: (954) 581-6620 info@ipaexport.com
Fort Lauderdale, FL 33312 Fax: (954) 581-6665 www.ipaexport.com

bodum®

from the soul of slow coffee

collection 2017



IPAEXPORT

The Caribbean's Primary Source for Hotel, Restaurant & Laundry Equipment/Supplies

3770 S.W. 30th Avenue | Tel: (954) 581-6620 | info@ipaexport.com
Fort Lauderdale, FL 33312 | Fax: (954) 581-6665 | www.ipaexport.com

2017 will go slow

“The appreciation of Slow Coffee has never been greater than it is today. In fact, it is the heart and soul of everything we’ve been doing since the 1950s, where my father – Peter Bodum – introduced our first vacuum coffee maker. And here on the brink of 2017, we’re excited to introduce e-PEBO: a fully automatic vacuum/siphon coffee maker that brings out the best in your preferred coffee beans.

Brewing coffee with an e-PEBO:

1. Use cold water fresh from the tap.
2. Grind those flavorsome coffee beans right before brewing.
3. Turn on your e-PEBO and watch the miracle unfold. It looks like a science experiment, and that is no coincidence. Because this brewing method was invented in 1756 by a French chemist who needed a strong cup of steaming hot coffee while he was working.

BODUM’s passion for good coffee is shared by coffee lovers across the world under the slogan: *Make Taste, Not Waste*. No paper filters. No capsules. Nothing disposable.

In 2017 we will also launch a wide range of other new products, such as our new bar-line, mugs and electrical kitchen tools. Take your time and relax with a nice cup of coffee while you browse through this catalog.”





| | |
|-----|---|
| 5 | BODUM®'s Portuguesa |
| 11 | Coffee |
| 12 | Coffee Maker Comparison Chart |
| 13 | Coffee Brewing Methods |
| 18 | Coffee-House Style Drinks |
| 34 | Parts of The French Press Coffee Maker |
| 35 | Guide to Spare Beakers and Filter Parts |
| 53 | Tea |
| 54 | Tea Brewing Methods |
| 56 | Tea Presses and Teapots Comparison Chart |
| 57 | Parts of The Tea Press |
| 58 | Varieties of Tea |
| 75 | Cork Line |
| 89 | Drinkware |
| 105 | Kitchen |
| 119 | Grill |
| 127 | e-BODUM® |
| 147 | BODUM® Stores and Shop-In-Shops |
| 150 | BODUM® Offices |



BODUM® Portuguesa

BODUM AG is responsible for the manufacturing and distribution of BODUM products worldwide. BODUM AG ensures that all BODUM products meet the highest standards and that only state-of-the-art products find its way into the market. More and more BODUM products are produced for and on behalf of BODUM AG by BODUM Portuguesa.

Since the beginning of BODUM® Portuguesa, environment has been a driving force and a major concern in our activity. During almost 30 years of production, BODUM® Portuguesa assumed a responsible position towards the surrounding environment but also to the internal working conditions and safety and well-being of the workers.



By having production processes that are majorly focused in transforming metal and applying surface treatments to metals, a lot of “environment unfriendly” unitary processes are used and required such as stamping or welding, but the most concerning are those connected to the plating line and degreasing processes.

These production processes consume natural resources, BODUM® works to minimize the impacts in:

- Emission of greenhouse gases
- Emission of other pollutant air streams
- Emission of pollutants in water
- Emission of pollutants in soils
- Risk of industrial accidents
- Workers safety, health and well-being



This was done by adopting the best available techniques (BAT) as preventive at the source of the pollution emission:

- Training to workers in operating, control and contain processes.
- Reducing the number or quantity of hazardous and dangerous materials.
- Equipment and process good-keeping by internal maintenance procedures.
- Optimization of operational conditions and control of processes.
- Reduction of re-processing needs.
- Project and built processes and facilities prevent and contain pollution in its source.
- Good storage of materials to prevent accidents with environmental impact.
- Good storage of materials and production parts to prevent its deterioration.
- Installing containment tanks and isolated floors in risk areas.
- Saving energy in power sources and make the processes energy efficient.
- Introduction of thermal isolation in the whole building and process tank walls to avoid heat loss.
- Isolation of equipments to avoid the noise propagation.

Saving water

- Recycling water – only 20% of the total consume is fresh water.
- Consume control by introducing automatic valves and volume controllers.
- Reducing drag-outs and introduce cascade rinsing between processes.
- Extend the liquid baths life and processes to prevent the treatment need by using filtration, evaporation, ionic exchange techniques.

In 2008, BODUM® Portuguesa had its recognition for all the efforts made and processes developed and implemented along the last decades, by having the Environmental Permit¹ issued by the Portuguese Environment Ministry.

Because it is impossible to contain all pollutant in its sources, BODUM® Portuguesa has installed end processes to treat, reduce or eliminate the pollution charge in its effluents and wastes. On these, we can highlight:

Waste Water Treatment Plant

- All liquid effluents are separated according to their characteristics and treated as in batches
- All pre-treatments and final treatments are permanently monitored until the admissible values of discharge are achieved.
- The discharge of BODUM® lines are connected to a municipal waste water treatment plant that complements the final treatment.
- The sludge generated in the water treatment are de-watered by using recycled air of the pressed air equipments.

Waste Classification and Separation

- All wastes generated in the plant are submitted to a proper separation, classification, handling and storage until there are sent to the destination.
- All waste management is outsourced to licensed entities, meaning the proper destination has as priority the recyclability of the wastes. Only two of the wastes generated at BODUM® must be eliminated because the recycling limitations in the market.

Air Aspiration System

- The air aspiration system is connected to all the pollution sources avoiding the pollutants spread inside the plant.
- These systems filter the air before its release to the atmosphere.
- In the plating line, besides the filtration, all the air is washed with water in scrubbers.

1. The permit is mandatory and directly comes from the EC Directive 2008/1/EC of January 15 (IPPC). According to this permit, BODUM® must have a permanent monitoring of the environmental indicators and values so; it is the guarantee of the legislation fulfilling, good practices and procedures.

2017 Color Edition



BISTRO Thermo Jug
Designed in 2009



CAFFETTIERA Coffee Maker
Designed in 1995



TRAVEL MUG
Designed in 2009



BISTRO Salt & Pepper Grinder
Designed in 2010



BISTRO Bread Box
Designed in 2003



BEAN Ice Cold Brew Coffee Maker
Designed in 2014



ASSAM Tea Press
Designed in 1991



PAVINA Double Wall Outdoor
Designed in 2014



GINGKO Salad server
Designed in 1994



Ceylon Infuser Jug
Designed in 1991 Smal Size - 2006 Big Size



NEW YORK Plate
Designed in 1998

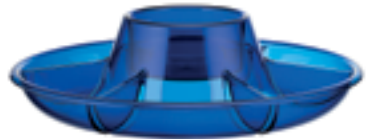

BISTRO Chip 'N' Dip
Designed in 2014



KIRA Wine Cooler
Designed in 1989



NEW YORK Plate & Bowl
Designed in 1998





Coffee

BODUM® was founded in 1944 by Peter Bodum. Launching a new business during the war wasn't easy, and jobs were scarce, but my father sensed it was time to venture out on his own. He was incredibly fortunate to be granted an import license, and by the late 1940s he had achieved great success. As he looked to grow the business, he found new interest in coffee makers. The company's first vacuum coffee maker, MOCCA, was introduced in the early fifties, but it wasn't until 1958 with the production of the SANTOS Vacuum Coffee maker that BODUM® became a household name for quality coffee products, and coffee has been the major product group for BODUM® ever since.











In the 1970s we introduced the now iconic French press, which continues to be BODUM®'s most popular item. Today, the majority of BODUM® coffee makers are produced at our factory in Portugal, where producing the highest quality products as well as environmental responsibility and safe working conditions are of the utmost importance.

In the years to come we are focused on expanding BODUM®'s factory in Portugal and moving more and more BODUM® products there, this move will make the entire process from design to manufacturing a family operation. Another important part of the BODUM® line is our collection of electric products that have been introduced over the past few years. Centered around coffee, from boiling water to grinding beans to the perfect automatic brew produced by our BISTRO Automatic Pour Over Coffee Machine, the collection encompasses everything the modern kitchen might need.

But no matter how much we grow, we will always reflect on our core value that form should follow function.

Coffee Makers Comparison Chart

Coffee Maker Comparison

| | | | Double wall | Patented locking-lid system | Stainless steel body or frame | Plastic frame | Stainless steel plunger | Plastic plunger | Borosilicate glass | BPA-Free | Available in different sizes | Made in Europe |
|----------------|--|---|-------------|-----------------------------|-------------------------------|---------------|-------------------------|-----------------|--------------------|----------|------------------------------|----------------|
| French Presses | BODUM® COLUMBIA Coffee Maker p. 23 |  | • | • | | | • | | • | • | | |
| | CHAMBORD® Coffee Maker p. 25 |  | | • | • | | • | | • | • | • | • |
| | EILEEN Coffee Maker p. 27 |  | | | • | | • | | • | • | • | • |
| | CHAMBORD® Coffee Maker p. 29 |  | | | • | | • | | • | • | • | • |
| | CAFFETTIERA Coffee Maker p. 31 |  | | | • | | • | | • | • | • | • |
| | BEAN ICE Cold Brew Ice Coffee Maker p. 33 |  | | • | | • | | • | | • | | • |
| | BRAZIL Coffee Maker p. 31 |  | | | | | • | • | • | • | • | • |
| Vacuum | PEBO® Vacuum Coffee Maker p. 38 |  | | | | | | | • | • | | • |
| Drip | POUR OVER Coffee Maker p. 41 |  | | | | | | | • | • | • | • |
| | POUR OVER Coffee Maker p. 41 |  | • | | | | | | • | • | | • |

Coffee Brewing Methods

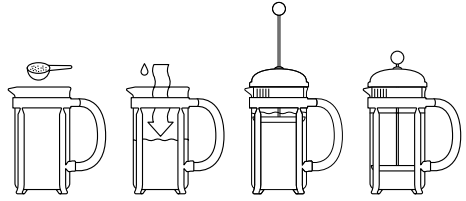

French Press

The French press coffee maker is the simplest of all brewing systems, where coarsely ground beans meet hot water right off the boil. The right temperature (92–96 °C, 195–205 °F) brings the optimal extraction power for the essential oils in the beans to develop their full flavor profile in just four minutes. An easy press on the plunger locks the grinds at the bottom of the glass carafe and stops the brewing process.

Note: For the French press brewing method, BODUM® recommends a coarse grind.

CHAMBORD®, p. 29



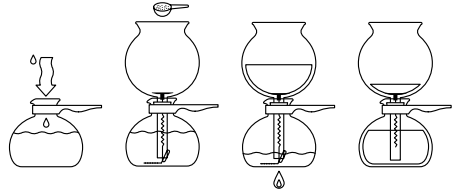

Vacuum

The vacuum brew method has fascinated generations of coffee drinkers with its theatrical technique. Water heats in the lower chamber, creating water vapor pressure that forces the boiling water up to mix with coffee grounds. The coffee maker is then removed from the heat and vacuum pressure draws the brewed coffee downward through a strainer, and into the bottom chamber for serving.

Note: For the PEBO® vacuum brewing method, BODUM® recommends a grind between coarse and medium.

PEBO®, p. 38



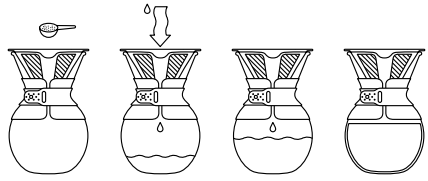

Pour Over

The pour over brew method features a fine mesh stainless steel filter that eliminates need for paper filters. Paper filters actually absorb the coffee's essential oils hence robbing coffee of true flavor, plus no paper filter means no waste!

Note: For the pour over brewing method, BODUM® recommends a medium grind.

[POUR OVER, p. 41](#)



**How to prepare cold brew coffee!
Brewing with cold water will give
70% less bitter taste.**



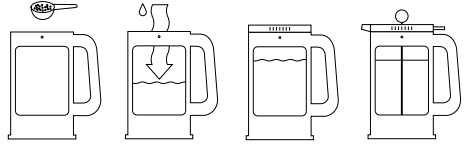

Cold Brew

Quality cold brewed coffee can be made using essentially the same steps. Instead of hot water, add filtered water at room temperature and stir. Place the lid on the carafe and let brew for 12 – 24 hours at room temperature or in your refrigerator. Press and enjoy!

Note: For the French press brewing method, BODUM® recommends a coarse grind.

[BEAN ICE](#), p. 33



STEP 1

Add fresh ground coffee



STEP 2

Pour fresh cold water



STEP 3

Brew for 12 – 24 hours



STEP 4

Change lid



STEP 5

Press



STEP 6

Enjoy

Coffee-House Style Drinks

Double wall glasses are the perfect vessel for showcasing the beauty of your coffeehouse style drinks at home. Plus the double wall glass construction will keep your drinks hot longer!

Espresso



An espresso is about 1 to 1.5 oz of espresso coffee. It fills about $\frac{1}{4}$ to $\frac{3}{8}$ of a demitasse. Espresso is made in an espresso machine by quickly forcing steam and boiling water through finely ground coffee.

PAVINA, p. 90

Americano

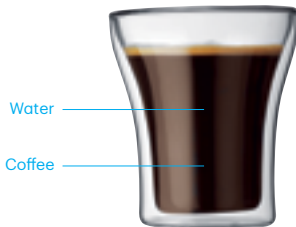

Americano is a style of coffee that is prepared by adding hot water to black coffee which result in a similar strength to traditional drip.

ASSAM, p. 91

Cappuccino

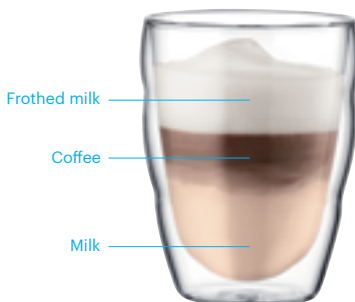

In Italy cappuccino is served in a 6 oz cup. The coffee is topped by a dense froth (half foam, half steamed milk) in a ratio of 3:1. Usually the drink is dusted with unsweetened cocoa.

PILATUS, p. 93

Latte Macchiato



The coffee is slowly poured into an 8 oz glass filled with hot, frothed milk. The coffee “stains” the milk and creates a darker layer over the milk. Then it all gets topped off with pure white foam – making a perfect latte macchiato, a three-layer drink.

PAVINA, p. 90

Caffe Mocha



Caffe mocha has been served in Italian-American cafes since the 1950s. It's a combination of equal amounts of coffee, hot chocolate and hot frothed milk. Today the hot chocolate is often-times substituted with chocolate syrup. For the ultimate sinners it is topped off with whipped cream.

PAVINA, P.90

Caffe Latte

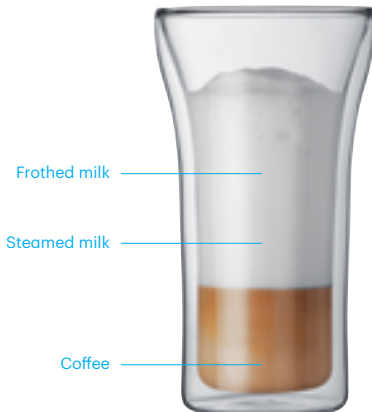

Latte is made with coffee and steamed milk in a ratio of 5:1. The coffee is topped with steamed milk then finished with steamed milk foam.

ASSAM, p. 91



No paper filter!



No capsule!



STEP 1

Coffee



STEP 2

Water



STEP 3

Press





STEP 4

Enjoy!

Coffee Makers



The **BODUM® COLUMBIA** Coffee Makers are made of double wall stainless steel which means that your coffee stays hot much longer. The air in between the two walls provides a highly effective layer of insulation. The **COLUMBIA** is not just any nice looking coffee pot: It is a coffee press. After all, you would not want to compromise taste for beauty. And it works just like any of our coffee presses.

 No paper filter!  No capsule!

Stainless steel body

Plastic plunger

BPA-Free

Dishwasher safe



BODUM® COLUMBIA

Double Wall Coffee Maker

Stainless steel

- | | |
|-------------|-----------------------------|
| 1. 1303-16 | 3 cup , 0.35l, 12 oz |
| 2. 11055-16 | 4 cup , 0.5l, 17 oz |
| 3. 1308-16 | 8 cup , 1.0l, 34 oz |
| 4. 1312-16 | 12 cup , 1.5l, 51 oz |



BODUM® COLUMBIA

Milk Jug

Stainless steel

10913-16 **0.7l**, 24 oz



BODUM® COLUMBIA

Sugar and Creamer Set

Stainless steel

K1305-16



BODUM® COLUMBIA

Tea Press

Stainless steel

11496-16 **1.5l**, 51 oz

Coffee Makers



This coffee maker is a beautiful extension of our classic CHAMBORD® line of products with their signature handles and knobs. The borosilicate glass of the CHAMBORD® coffee maker is encased in stainless steel, protecting the glass beautifully. The simple push of a lever lets the coffee flow into the cup – all easily manageable with one hand.

☒ No paper filter! ☒ No capsule!

Stainless steel frame and plunger

Borosilicate glass beaker

BPA-Free

Made in Europe

Dishwasher safe*



CHAMBORD®

Coffee Maker

With patented locking-lid system,
Stainless steel

- | | | |
|----|----------|-----------------------------|
| 1. | 11170-16 | 3 cup , 0.35l, 12 oz |
| 2. | 11171-16 | 4 cup , 0.5l, 17 oz |
| 3. | 11172-16 | 8 cup , 1.0l, 34 oz |
| 4. | 11173-16 | 12 cup , 1.5l, 51 oz |



CHAMBORD®

Coffee Maker

With patented locking-lid system,
Gold-plated stainless steel

- | | | |
|----|----------|-----------------------------|
| 1. | 11170-17 | 3 cup , 0.35l, 12 oz |
| 2. | 11171-17 | 4 cup , 0.5l, 17 oz |
| 3. | 11172-17 | 8 cup , 1.0l, 34 oz |
| 4. | 11173-17 | 12 cup , 1.5l, 51 oz |



CHAMBORD®

Coffee Maker

With patented locking-lid system,
Copper-plated stainless steel,
*Only beaker is dishwasher safe

- | | | |
|----|----------|-----------------------------|
| 1. | 11170-18 | 3 cup , 0.35l, 12 oz |
| 2. | 11172-18 | 4 cup , 0.5l, 17 oz |
| 3. | 11172-18 | 8 cup , 1.0l, 34 oz |
| 4. | 11173-18 | 12 cup , 1.5l, 51 oz |

Coffee Makers



Designed in honor of the great Irish designer Eileen Gray, as well as all coffee lovers who frequent the bistros and cafés of Paris – Gray’s adopted city. BODUM®’s classic EILEEN Coffee Maker makes a stylish addition to any tabletop decor. Perfect for gifting and entertaining. The solid stainless steel frame protects borosilicate glass beaker and round handle designed for comfortable, secure grip.

☒ No paper filter! ☒ No capsule!

Stainless steel frame and plunger

Borosilicate glass beaker

BPA-Free

Made in Europe

Dishwasher safe*



EILEEN

Coffee Maker

- | | |
|-------------|-----------------------------|
| 1. 11198-16 | 3 cup , 0.35l, 12 oz |
| 2. 11196-16 | 4 cup , 0.5l, 17 oz |
| 3. 11195-16 | 8 cup , 1.0l, 34 oz |



EILEEN

Coffee Maker

Copper-plated stainless steel,
*Only beaker is dishwasher safe

- | | |
|-------------|-----------------------------|
| 1. 11198-17 | 3 cup , 0.35l, 12 oz |
| 2. 11196-17 | 4 cup , 0.5l, 17 oz |
| 3. 11195-17 | 8 cup , 1.0l, 34 oz |



EILEEN

Coffee Maker

Copper-plated stainless steel,
*Only beaker is dishwasher safe

- | | |
|-------------|-----------------------------|
| 1. 11198-18 | 3 cup , 0.35l, 12 oz |
| 2. 11196-18 | 4 cup , 0.5l, 17 oz |
| 3. 11195-18 | 8 cup , 1.0l, 34 oz |

Coffee Makers



CHAMBORD® is a true original. The iconic design, now synonymous with the **BODUM®** name, dates back to the 1950s. To this day we continue to produce the **CHAMBORD®** with the same artisan craftsmanship of yesteryear, but with a focus on environmentally responsible manufacturing in our **BODUM®** owned factory in Portugal. The French press system continues to be a greener way to brew coffee with the truest flavor possible.

☒ No paper filter! ☒ No capsule!

Stainless steel frame and plunger

Borosilicate glass beaker

BPA-Free

Made in Europe

Dishwasher safe*



CHAMBORD®

Coffee Maker

- | | |
|------------|-----------------------------|
| 1. 1923-16 | 3 cup , 0.35l, 12 oz |
| 2. 1924-16 | 4 cup , 0.5l, 17 oz |
| 3. 1928-16 | 8 cup , 1.0l, 34 oz |
| 4. 1932-16 | 12 cup , 1.5l, 51 oz |



CHAMBORD®

Coffee Maker

- | | |
|------------|-----------------------------|
| 1. 1923-17 | 3 cup , 0.35l, 12 oz |
| 2. 1924-17 | 4 cup , 0.5l, 17 oz |
| 3. 1928-17 | 8 cup , 1.0l, 34 oz |
| 4. 1932-17 | 12 cup , 1.5l, 51 oz |



MELIOR

Coffee Maker

Stainless steel, with Soft Grip handle and knob

- | | |
|-------------|-----------------------------|
| 1. 11732-16 | 3 cup , 0.35l, 12 oz |
| 2. 11733-16 | 4 cup , 0.5l, 17 oz |
| 3. 11734-16 | 8 cup , 1.0l, 34 oz |
| 4. 11735-16 | 12 cup , 1.5l, 51 oz |



CHAMBORD®

Coffee Maker

Copper-plated stainless steel,

*Only beaker is dishwasher safe

- | | |
|----------|----------------------------|
| 11652-18 | 8 cup , 1.0l, 34 oz |
|----------|----------------------------|



CHAMBORD®

Espresso Maker

Stainless steel body

- | | |
|----------|-----------------------------|
| 10617-16 | 6 cup , 0.35l, 12 oz |
|----------|-----------------------------|

Coffee Makers



☒ No paper filter! ☒ No capsule!

Stainless steel / Plastic frame

Borosilicate glass beaker

Stainless steel plunger

BPA-Free

Made in Europe

Dishwasher safe



CAFFETTIERA
Coffee Maker

1. 1913-945B-Y17
2. 1918-945B-Y17

3 cup, 0.35l, 12 oz
8 cup, 1.0l, 34 oz



BRAZIL
Coffee Maker

1. 10948-01
2. 10938-01

3 cup, 0.35l, 12 oz
8 cup, 1.0l, 34 oz



Cold Brew Coffee Maker

The BEAN comes with two lids: one for the fridge overnight, and one with a plunger to press down the coffee grounds in the morning. The 1.5 l BEAN Cold Brew Ice Coffee Maker is made from plastic, silicone and stainless steel and comes in 6 beautiful colors.



☒ No paper filter! ☒ No capsule!

Plastic frame

Plastic beaker

Plastic plunger

BPA-Free

Made in Europe

Dishwasher safe

BEAN

Cold Brew Ice Coffee Maker

With locking-lid and extra lid

The COLD BEAN ICE comes with two lids: one for the fridge overnight, and one with a plunger to press down the coffee grounds in the morning.

K11683-945S-Y17

12 cup, 1.5l, 51oz



Coffee

THERMIA

Coffee and tea press

1608-10

8 cup, 10l, 34oz



Parts of The French Press Coffee Maker

Plunger - The bar of the plunger is made of stainless steel. After the 4 minutes recommended brewing time, you simply depress the plunger with the tip of your finger. The knob is made of heat-resistant plastic.

Safety Lid - BODUM®'s safety lid prevents the splashing of liquids. Line the safety lid so that it is in the closed position in line with the pour spout. After the brewing has stopped, turn the safety lid back and enjoy your coffee!



Spiral plate - The spiral plate keeps the filter mesh in place and makes sure that water goes through but no ground coffee. The flexible spiral provides a universal fit taking into account the manufacturing tolerances of glass jugs.



Mesh - The filter mesh is a key component to the BODUM® Coffee Makers. It separates the ground coffee beans from the water after the brewing has stopped.



Cross plate - The cross plate holds the mesh in place together with the spiral plate.

Glass beaker - French press coffee makers feature a durable borosilicate beaker. Borosilicate glass is an outstanding material: It is ultra-light and strong, has great heat resistant properties, and will not get cloudy in the dishwasher.

Metal frame - The original CHAMBORD® Coffee Maker features a frame made of chrome-plated, durable stainless steel that protects the glass beaker from cracks and scratches, as well as protecting surfaces from heat damage.

Handle - The plastic handle provides heat-resistance and durability. In other words, it keeps your fingers from getting burnt.

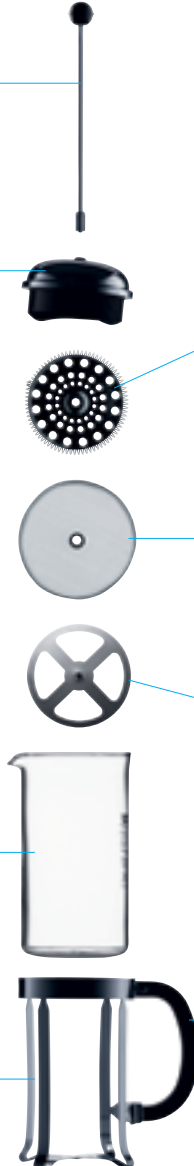

Guide to Spare Beakers and Filter Parts

Glass Beakers

Plastic Beakers

Spout

Without Spout

Metal Filter Parts

Plastic Filter Parts

3 cup
0.35l, 12oz



Item number:
1503-10



Item number:
01-11080-10



Item number:
01-1503-16-611
(5.7cm, 2¼in)



Item number:
01-1503-16-612
(7cm, 2¾in)



Item number:
01-1503-16-613
(6.5cm, 2½in)



Item number:
01-1503-10-230



Item number:
V1503
(6.5cm, 2½in)

4 cup
0.5l, 17oz



Item number:
1504-10



Item number:
01-11142-10



Item number:
01-1508-16-611
(8.6cm, 3¾in)



Item number:
01-1508-16-612
(10cm, 4in)



Item number:
01-1508-16-613
(9.5cm, 3¾in)



Item number:
01-1504-10-230



Item number:
V1508-ISR
(9.5cm, 3¾in)

6 cup
0.8l, 27oz



Item number:
1926-10



Item number:
01-1508-16-611
(8.6cm, 3¾in)



Item number:
01-1508-16-612
(10cm, 4in)



Item number:
01-1508-16-613
(9.5cm, 3¾in)

8 cup
1.0l, 34oz



Item number:
1508-10



Item number:
01-10945-10



Item number:
01-1508-16-611
(8.6cm, 3¾in)



Item number:
01-1508-16-612
(10cm, 4in)



Item number:
01-1508-16-613
(9.5cm, 3¾in)



Item number:
01-1508-10-230



Item number:
V1508-ISR
(9.5cm, 3¾in)

12 cup
1.5l, 51oz



Item number:
1512-10



Item number:
01-11081-10



Item number:
01-1512-16-611
(10cm, 4in)



Item number:
01-1512-16-612
(12cm, 4¾in)



Item number:
01-1512-16-613
(11.5cm, 4½in)



Item number:
01-1512-10-230



Item number:
V2012-ISR
(11.5cm, 4½in)



No paper filter!



No capsule!



STEP 1

Water



STEP 2

Boil



STEP 3
Coffee



STEP 4
Enjoy!

Vacuum Coffee Maker

- ☒ No paper filter! ☒ No capsule!

- Borosilicate glass chambers

- Plastic handle

- BPA-Free

- Made in Europe

- Dishwasher safe



PEBO®
Vacuum Coffee Maker
 1208-01 **8 cup, 1.0l, 34 oz**



PEBO®
Gas Burner with Stand
 K11423-16



PEBO®
Vacuum coffee maker with burner and accessories
 K1218-01 **8 cup, 1.0l, 34 oz**



Spoon Holder Lid Lid

The vacuum brewing system extracts all of the flavorful oils and aromas from your coffee without using paper filters. Made of borosilicate glass, users can view the theatrical brewing process from start to finish. Its exceptionally effective vacuum brewing method extracts all precious oils of your favorite coffee. The vacuum brewing process is entirely sealed off so no aroma can escape. In addition, the brewing time and temperature are perfectly calibrated, ensuring a perfect cup of coffee with each brew.

ORIGINAL
SANTOS

• of
BODUM
produkt

Pour Over Coffee Makers



The POUR OVER promises excellent, rich taste and robust aroma while maintaining the natural oils of the ground coffee. For the perfect cup of coffee, simply fill the cone-shaped filter with freshly ground coffee and pour a small amount of heated water over them until soaked. Slowly pour the remaining hot water into the filter. Coffee will drip into the mouth-blown, borosilicate glass carafe and, in 3–4 minutes, will be ready to serve. Remove the filter from the carafe before serving and enjoy!

☒ No paper filter! ☒ No capsule!

Borosilicate glass carafe

Stainless steel mesh filter

BPA-Free

Made in Europe

Dishwasher safe



POUR OVER

Coffee Maker

1. 11592-01S **4 cup**, 0.5l, 17oz
2. 11571-01S **8 cup**, 1.0l, 34oz
3. 11593-01S **12 cup**, 1.5l, 51oz



POUR OVER

Coffee Maker

With tritan body

- 11736-01S **8 cup**, 1.0l, 34oz

Coffee Drippers

☒ No paper filter! ☒ No capsule!

Borosilicate glass carafe

Stainless steel mesh filter

BPA-Free

Made in Europe

Dishwasher safe



1



2

MELIOR

Coffee Dripper

With filter holder and filter

- | | |
|-------------|-------------------|
| 1. 11762-10 | 1.0l, 34oz |
| 2. 11767-10 | 0.6l, 20oz |



CIN CIN

Coffee Dripper

With filter holder and filter

- | | |
|----------|-------------------|
| 11783-10 | 1.0l, 34oz |
|----------|-------------------|



Thermo Jugs



| TESTSIEGER | |
|---|--------------|
| ETM Testmagazin - Urteil | |
| BODUM® BISTRO Thermo Jug 1.1l | |
| SEHR GUT | 92.0% |
| 5 Isollerkannen mit Edelstahlinsatz im Vergleichstest | Heft 02/2014 |

Keeps hot drinks
hot for hours!



95° C **START!**
200° F

90° C 1h45
195° F

80° C 5h30
175° F

70° C 10h30
160° F

60° C 16h45
140° F

50° C 25h30
120° F



BISTRO
Thermo Jug

This BISTRO Thermo Jug opens with an easy one-handed press on the lid to let the fluids flow. The lid closes automatically after each use. Ideal for serving or outdoor picnic.

11189-01B

1.1l, 37oz



CHAMBORD®
Thermo Jug

This thermo jug fits nicely into our CHAMBORD line. It is extremely stable and effective. It opens with an easy turn of the lid for pouring.

10886-01TL

1.0l, 34oz



Travel Presses



Enjoy a single-serving of French press coffee or loose leaf tea on the go with the TRAVEL PRESS Coffee Maker. Brew and drink or use in the place of a traditional 3 cup French Press. Add 3–4 tablespoons coarse ground coffee, preferred milk and sweetener, and hot water to the mug. Stir contents, replace lid with plunger up, and go. After 4 minutes press down the plunger and enjoy! The stainless steel double wall design with a vacuum seal maintains heat for hours while remaining cool to the touch.

☒ No paper filter! ☒ No capsule!

Plastic body/Stainless steel body

BPA-Free

Top-rack dishwasher safe

TRAVEL PRESS Coffee Maker

Double wall, Plastic body with extra lid

1. K11102-01 **0.35l**, 12 oz
2. K11100-01 **0.45l**, 15 oz



TRAVEL PRESS Coffee Maker

Vacuum, Stainless steel body with extra lid

1. K11067-01 **0.35l**, 12 oz
2. K11057-01 **0.45l**, 15 oz



BISTRO 4 Min Timer

The key to brewing great coffee is allowing adequate time. After pouring in the hot water, stir the coffee grounds and flip over this classic sand timer. The sand will run out at exactly the 4 minute mark.

11573-01B



Travel Mugs



Today's on-the-go lifestyle makes us miss out on our comforting daily routines far too often. Well, enjoying our favorite drink wherever we go is no longer on the list. The TRAVEL MUG Collection goes where you go - in just the right size and just the right color and material for all your endeavors. The mugs are absolutely spill-proof once the opening is closed all the way. The flow of fluids can be adjusted with an easy turn of the screw within the lid.

Plastic body

BPA-Free

Top-rack dishwasher safe



TRAVEL MUG

Mug

Double wall, Plastic body

- 1. 11685-01 **0.45l**, 15 oz
- 2. 11684-01 **0.35l**, 12 oz



TRAVEL MUG

Mug

Double wall, Plastic body

- 11103-01 **0.35l**, 12oz



- 01 913 945 946 947 948



TRAVEL MUG

Mug

Double wall, Stainless steel body

- 11093-01 **0.35l**, 12oz



- 01 913



TRAVEL MUG

Mug

Double wall, Stainless steel body

- 11068-01 **0.45l**, 15oz



- 01 913 945 946 947 948



JOY CUP

Travel Mug

Double wall, Plastic Body

- 11674-01-1 **0.3l**, 10oz

Electric Milk Frothers



SCHIUMA
Milk Frother

Stainless steel, Battery operated
(batteries not included)

3043-16



SCHIUMA
Milk Frother

Battery operated (batteries not included)

3040-01



Milk frothers turn your daily cup of joe into a coffeehouse specialty with the push of a button. Become the ultimate barista at home by creating airy foam and froth in seconds. Not to mention you can use these handy tools on any light mixing job including salad dressings, protein drinks and cocktails. For best results use ice cold, non-fat or low-fat milk.

Manual Frothers



LATTEO

Milk Frother

1446-01

0.251, 8 oz



AERIUS

Milk Frother

1466-01

0.251, 8 oz



1

2

CHAMBORD®

Milk Frother

1. 1963-01

0.081, 2.5 oz

2. 1966-16

0.251, 8 oz



CHAMBORD®

Milk Frother

Copper-plated stainless steel,

*Only beaker is dishwasher safe

11653-18

0.151, 5 oz



CHOCOLATIERE

Chocolate Jug

10676-16

1.01, 34 oz



Tea

No wonder tea has been the most popular drink after water for centuries. Black teas, white teas, green teas, herbal teas, fruit teas, rooibos teas – the options for pleasure and delight are simply limitless. We have the right tea maker for all of your tea preferences, including iced tea.

Tea brewing doesn't get any purer than with the BODUM® tea presses. With this unique system your tea is brewed precisely to your desired strength and aroma. We developed the tea press in collaboration with the English Tea Council over 30 years ago and we've been perfecting it ever since.

BODUM® tea presses are made of the highest quality borosilicate glass – a material that doesn't stain and is absolutely neutral in taste. The glass allows you to observe the brewing process and stop it when it's exactly right. It's just fascinating to see all the beautiful tea colors come to life. The BODUM® tea presses are as much a pleasure for your eyes as they are for your taste buds.

Our collection of various infusers are the perfect match when brewing green teas, rooibos teas and herbal teas which have become more and more popular. Here, the brewing process does not necessarily need interruption and the leaves can be left to swirl freely in the infuser to develop their full flavor. The filter with the tea leaves inside can be removed to stop the brewing process and used again to re-infuse quality loose leaf tea a second time. Green tea for example can be reused for up to four times, taken that it is a high quality loose leaf tea.

Tea Brewing Methods

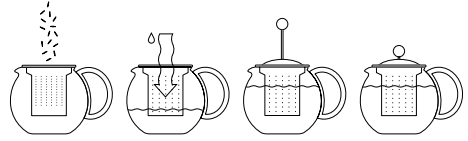

Tea Press

The tea press utilizes the same brewing system as the French press to allow for full control of the tea steeping process. Once your preferred coloring and strength is reached, you simply press down the plunger and seal the tea leaves into the bottom part of the filter that has no holes. This makes the brewing process stop with one easy push and you can discard or re-use the tea leaves after you have enjoyed your beverage. Silicone rim secures filter firmly into the teapot and stays cool to the touch for safe removal.

Note: All loose leaf teas are suitable for the BODUM® tea press. The tea press works best with fruit teas and black tea because it interrupts the brewing process – avoiding bitterness.

[Tea Press, p. 65](#)



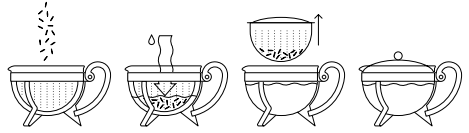









Teapot And Tea Infuser

Tea leaves can be left to swirl freely in the infuser to develop their full flavor, and can be left to brew without interruption. The filter, along with the tea leaves, can be removed at any time to stop the brewing process and can even be used a second time to re-infuse quality loose leaf tea. The highest quality green tea, for example, can be reused up to four times.

Teapot, p. 67



Tea Presses and Teapots Comparison Chart

| | | Tea Presses and Teapots Comparison | | | | | | |
|--------------|---|------------------------------------|------------------------|----------------|----------|------------------------------|----------------|--|
| | | Borosilicate glass pot | Stainless steel filter | Plastic filter | BPA-Free | Available in different sizes | Made in Europe | |
| Tea Presses |  <p>BODUM® COLUMBIA Tea Press p. 62</p> | | • | | • | | | |
| |  <p>ASSAM Tea Press Stainless steel filter p. 65</p> | • | • | | • | • | • | |
| |  <p>ASSAM Tea Press p. 65</p> | • | | • | • | • | • | |
| Tea Infusers |  <p>CHAMBORD® Teapot Stainless steel filter p. 67</p> | • | • | | • | | • | |
| |  <p>CHAMBORD® Teapot p. 67</p> | • | | • | • | • | • | |
| |  <p>NEW YO-YO Tea Strainer p. 69</p> | | | • | • | | • | |
| |  <p>CEYLON Infusion Jug p. 71</p> | | | • | • | • | • | |
| |  <p>BIASCA Infusion Jug p. 71</p> | • | | • | • | | • | |

Parts of The Tea Press

Lid – During the brewing process, place the lid with the plunger on top of the tea filter to retain heat during and after the tea brewing process. The lid is attached to the plunger and made of high-polished stainless steel.



Plunger – To stop the brewing process, simply press down the plunger made of stainless steel with the tip of your finger. The knob is made of a heat-resistant plastic and will keep your fingers from getting burnt.

Silicone rim – The coronated, elastic silicone rim improves the combined benefits of a glass pot with a stainless steel filter. It provides a universal fit between teapot and tea filter and it keeps your fingers from getting burnt and the tea filter from falling out when pouring hot beverages.



Plunger – Depressing the plunger keeps the hot water away from the tea in order to stop the brewing process entirely. It is made of heat-resistant plastic and silicone. The silicone gasket ensures a clean performance.



Perforated strainer – The perforated strainer ensures that leaves and kernels remain within the strainer while brewing. The filter basket is made of stainless steel.



Glass Pot – Most of BODUM® tea presses feature a durable borosilicate pot. Borosilicate glass is an outstanding material: It is ultra-light and strong, has great heat resistant properties, and will not get cloudy in the dishwasher.

Varieties of Tea

Black Tea

90–96°C
195–205°F

2–3 min



One of the most known varieties of tea is black tea. It is made from the tea-plant *Camellia sinensis/assamica* and amongst the most popular in Europe and North America. After harvest, the tea leaves are allowed to oxidize to the fullest, so that the freshly plucked leaves slowly turn brownish and darker. The flavour is usually stronger, than other types of tea, but can also vary from light and floral Himalayan first flush to strong and malty Assam teas.

[PAVINA, p. 90](#)

Rooibos Tea

90–96°C
195–205°F

5–6 min



Only a very limited area in the Cedar mountains, in the heart of South Africa is capable of providing the right soil and climate to grow rooibos. Being used for centuries by the local people, the rooibos cultivation and processing started only a few hundred years ago. Now the bush is treated nearly the same way, as it has been for decades. The bush is allowed to ferment after harvest, giving the tea its distinctive sweet and red cup.

[PAVINA, p. 90](#)

Green Tea

70–80 °C
158–175 °F

1–2 min



The freshly plucked leaves of the tea plant *camellia sinensis* must be heated directly after harvest, to prevent the leaves from oxidization and becoming black tea. Traditionally heating in iron pans in China, the Japanese have developed a hot water steam heating to prevent the tea from burning. Both methods create a distinct flavour for each region, that can vary from light, floral, sweet to full bodied and slightly toasted.

BISTRO, p. 94

White Tea

70–80 °C
158–175 °F

4–6 min



Coming from the same plant as green or black tea, white tea is the one with the least human effect during production. Only the youngest and most fragile buds are harvested by hand and left to dry under the sun. No oxidization or heating is done to preserve the full natural character of the white tea. The name derives from the fuzzy white appearance of the young tea leaves.

BODUM® CANTEEN, p. 92

Fruit Tea

90–96 °C
195–205 °F

5–6 min



Commonly used in Europe, dried fruit pieces and other parts of suitable plants have been brewed with hot water into fruit tea – or tisane – for thousands of years. The basic fruit tea consists of apple, orange, hibiscus and rosehip and is given a special twist with whatever exotic fruits and ingredients is added to it. Fruit teas are naturally caffeine free and make the perfect iced teas for children!

TITLIS, p. 95



No paper filter!



No capsule!



STEP 1

Tea



STEP 2

Water



STEP 3
Press



STEP 4
Enjoy!

Tea Presses

☒ No paper filter! ☒ No capsule!

Stainless steel pot

BPA-Free

Dishwasher safe



BODUM® COLUMBIA

Tea Press

Stainless steel

11496-16

1.5l, 51oz

BODUM® COLUMBIA pairs utility with timeless elegance. Highly polished stainless steel and classic design make this the perfect choice for entertaining and gifting. The French press brewing system allows for full control over the tea steeping process. The silicone plunger locks the tea leaves into bottom of the filter once brewing is complete, cutting off access of water to the tea leaves. This allows tea to be used multiple times.



Tea Presses



The ASSAM Tea Press is the icon among the wide variety of BODUM® Tea Presses. Its classic round shape and borosilicate glass let all teas shine in their best light. Contrary to non-transparent pots, the glass pot allows the distinct color palates to be viewed as they are a big part of any tea lover's delight. There is also a very practical reason for making glass the preferred staging ground for your teas: You have precise control over the extraction and strength of the tea as the color's intensity indicates how far along in the brewing process.

☒ No paper filter! ☒ No capsule!

Borosilicate glass pot

BPA-Free

Made in Europe

Dishwasher safe

ASSAM

Tea Press

With glass handle, Stainless steel filter and lid



- | | |
|------------|---------------------|
| 1. 1807-16 | 0.5l , 17 oz |
| 2. 1801-16 | 1.0l , 34 oz |
| 3. 1802-16 | 1.5l , 51 oz |

ASSAM

Tea Press

With glass handle, Plastic filter and lid



- | | |
|-----------------|---------------------|
| 1. 1823-945-Y17 | 0.5l , 17 oz |
| 2. 1830-945-Y17 | 1.0l , 34 oz |



ASSAM

Tea Press

With stainless steel filter, Plastic handle and lid



- | | |
|---------|---------------------|
| 1805-01 | 1.0l , 34 oz |
|---------|---------------------|

ASSAM

Tea Press

With plastic filter, Handle and lid



- | | |
|------------|---------------------|
| 1. 1842-01 | 0.5l , 17 oz |
| 2. 1844-01 | 1.0l , 34 oz |



BISTRO

Warmer

10447-16

ø13.5cm, ø5.3in



Teapots



The CHAMBORD® Teapot comes with a wide filter basket in the borosilicate glass bowl which lets the tea leaves swirl freely and gives them the space they need to live up to their full aroma potential. Whether you prefer black or green teas – the CHAMBORD® serves them all perfectly; giving them the stage they deserve and displaying their unique coloring beautifully.

☒ No paper filter! ☒ No capsule!

Borosilicate glass pot

BPA-Free

Made in Europe

Dishwasher safe*



CHAMBORD®

Teapot

With stainless steel filter and lid

1921-16-6

1.31, 44 oz



CHAMBORD®

Teapot

Copper-plated stainless steel lid and frame, Stainless steel filter,

*Only the filter is dishwasher safe

1. 11656-17

1.31, 44 oz

2. 11656-18

1.31, 44 oz



CHAMBORD®

Teapot

With clear plastic filter and coloured lid

1. 1975-01

1.01, 34 oz

2. 1970-01

1.31, 44 oz

01

913



CHAMBORD®

Teapot

With coloured plastic filter and lid

1. 1975-01-2

1.01, 34 oz

2. 1970-01-2

1.31, 44 oz

01

913



CHAMBORD®

Warmer

1902-16

Tea Strainers



☒ No paper filter! ☒ No capsule!

BPA-Free

Dishwasher safe



BISTRO
Tea Egg

11569-913



1



2

NEW YO-YO
Tea Strainer

Stainless steel

1. 10547-16B **Tea Strainer**
2. K11239-16 **Set, 0.35l, 12 oz**

TEA FOR ONE
Double Wall Glass and Tea Strainer

K11153-01

0.35l, 12 oz



YO-YO
Mug and Tea Strainer

K11239-01

0.35l, 12 oz



Tea

Infusion Jugs & Carafes



☒ No paper filter! ☒ No capsule!

BPA-Free

Made in Europe

Dishwasher safe



CEYLON

Infusion Jug

With filter

The pitcher features a removable filter that infuses water to your preferred flavor. The lid includes a screening filter to help prevent particulates from flowing into your cup.

1. 1470-10 1.5l, 51oz
2. 10619-10 3.0l, 101oz



CLOSED position



OPEN position



BISTRO

Water Carafe

Its plastic spout makes for precise pouring and a little rubber ball in the lid closes the Carafe when it's standing upright. When it's tilted the little ball moves up and opens the carafe for easy pouring. The opening is blocked by a grid to keep ice cubes or herbs from falling into the glass.

11187-10-2 1.0l, 34oz



BIASCA

Infusion Jug

With mesh filter

Named after a small town in southern Switzerland, the BIASCA easily brews your favorite teas or other infused drinks.

11575-10 1.2l, 40oz



Drinkware

BODUM® premiered its line of double wall glasses in 2002. The inventive design coupled with timeliness style made these glasses an instant classic. Over the past ten years, the collection has earned numerous awards and expanded to include a variety of styles and sizes. Made of heat-resistant borosilicate glass, and individually mouth-blown by expert artisans, the double wall construction creates a highly effective layer of insulation. Hot drinks stay hot longer, while the glass remains cool to the touch, and cold drinks stay cold without producing messy condensation. The result is endless serving possibilities.

The patent pending hydrophobic silicone vent at the bottom of each glass equalizes pressure within the walls of the glass with the outside air pressure. The glass will self-adjust to any temperature liquid, and the vent is only permeable to air, not water, so whether your beverage is hot or cold it will never allow fluids into the interior of the glass layers.

Our new collection of unbreakable Outdoor Tumblers, allows you to entertain with BODUM® classic design silhouettes at your next BBQ or poolside gathering!

These Outdoor Tumblers have the same thermal properties as our glass versions, so your hot drinks will stay hot and cold drinks will stay cold for a longer period of time and with no messy condensation rings to worry about! Crystal clear design for the outdoors. We'll toast to that.

The BODUM® Double Wall Glasses have won the following awards:



reddot design award
winner 2006



reddot design award
winner 2005



#FORM
2005

Double Wall Outdoor Tumblers



BPA-Free

Dishwasher safe



BODUM® CANTEEN

Double Wall Outdoor Tumbler

BPA-Free material

1. 11614-10 **0.251**, 8 oz
2. 11615-10 **0.451**, 15 oz



PAVINA

Double Wall Outdoor Tumbler

BPA-Free material

1. 11686-10 **0.091**, 3 oz
2. 11616-10 **0.251**, 8 oz
3. 11617-10 **0.351**, 12 oz
4. 11618-10 **0.451**, 15 oz



PAVINA

Double Wall Outdoor Tumbler

Tritan

1. 11686-10-1 **0.091**, 3 oz



Double Wall Glasses that Breathe!



A silicone vent at the base of each of BODUM®'s Double Wall Glasses equalizes the air pressure between the two layers of glass when either hot or cold liquids are added. Permeable only to air, never water, the vent enhances durability and will never allow liquids to enter between the two layers.

Drinkware

USE & CARE

Every double wall glass is mouth-blown by expert artisans, and therefore each may have slight differences in height, thickness, and weight. To preserve the longevity of the glass, please adhere to the following precautions:



Microwave Safe
Up to 350°F/180°C.



Oven Safe
Up to 350°F/180°C.



Dishwasher safe
Do not place glasses into a crowded dishwasher.



Double Wall Glasses



PAVINA
Double Wall Glass

2 Pcs set

- | | | |
|----|---------|-----------------------|
| 1. | 4557-10 | 0.08l , 2,5 oz |
| 2. | 4558-10 | 0.25l , 8 oz |
| 3. | 4559-10 | 0.35l , 12 oz |
| 4. | 4560-10 | 0.45l , 15 oz |



Double Wall Glasses



ASSAM

Double Wall Glass

2 Pcs set

- | | |
|------------|----------------------|
| 1. 4554-10 | 0.1l , 3oz |
| 2. 4555-10 | 0.2l , 6oz |
| 3. 4556-10 | 0.25l , 8oz |
| 4. 4547-10 | 0.4l , 13.5oz |



Double Wall Glasses



1

2

3

BODUM® CANTEEN Double Wall Glass

2 Pcs set

- 1. 10108-10 **0.11**, 3 oz
- 2. 10109-10 **0.21**, 6 oz
- 3. 10110-10 **0.41**, 13.5 oz



1

2

BODUM® CANTEEN Double Wall Mug

2 Pcs set

- 1. 10325-10 **0.21**, 6 oz
- 2. 10326-10 **0.41**, 13.5 oz



Double Wall Glasses

PILATUS

Double Wall Glass

2 Pcs set

- 1. 11477-10 **0.081**, 2.5 oz
- 2. 10484-10 **0.251**, 8 oz
- 3. 10485-10 **0.351**, 12 oz



1



2



3



Double Wall Mugs & Glasses

BISTRO

Double Wall Mug

2 Pcs set

- | | | |
|----|----------|---------------------|
| 1. | 10602-10 | 0.151 , 5oz |
| 2. | 10604-10 | 0.31 , 10oz |
| 3. | 10606-10 | 0.451 , 15oz |
| 4. | 10608-10 | 0.451 , 15oz |



BISTRO

Double Wall Glass

2 Pcs set

- | | | |
|----|----------|---------------------|
| 1. | 10607-10 | 0.451 , 15oz |
| 2. | 10605-10 | 0.451 , 15oz |





Double Wall Glasses



TITLIS
Double Wall Glass

2 Pcs set

- 1. 10481-10 **0.251**, 8 oz
- 2. 10482-10 **0.351**, 12 oz
- 3. 10483-10 **0.451**, 15 oz

Porcelain Cups

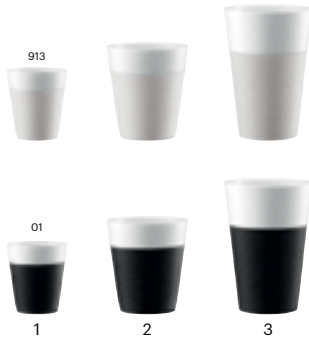

BISTRO Mug

Porcelain cup with silicone sleeve,
2 Pcs set

- | | | |
|----|----------|----------------------|
| 1. | 11581-01 | 0.171 , 5.7oz |
| 2. | 11582-01 | 0.31 , 10oz |
| 3. | 11583-01 | 0.61 , 20oz |

Coffee & Tea Glasses



BISTRO
Mug Tree

Plastic, Set with glass mugs

Space saving design to keep your mugs on display and easily accessible.

K2110-946-Y17

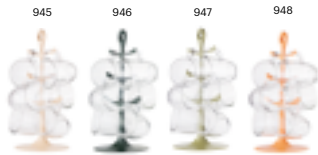

ASSAM
Glass

With steel handle, 2 pcs set

- 1. 4552-16 **Coffee, 0.3l**, 10 oz
- 2. 4553-16 **Tea, 0.35l**, 12 oz



BISTRO
Coffee Mug

Glass

11239-10B

0.35l, 12 oz



Kitchen

Our kitchens have become the central hub of our living quarters – almost like the farm kitchens in Denmark used to be, the country where BODUM® was founded. The kitchen of today is a living room, it's where everybody ends up anyway. It's where discussions are held and beans are spilled.

Bar Line





NERO
Wine cooler
11137-01



TOP OFF
Bottle Opener
7064-10



MELIOR
Cork Screw
11724-01



MELIOR
Foil Cutter
11725-01



MELIOR
Stopper, Wine Pourer & Aerator
1. 11737-01 **Stopper**
2. 11738-01 **Wine Pourer & Aerator**



1



2

MELIOR
Drink Dispenser
1. 11742-01 **Single Wall** **10l, 338oz**
2. 11726-01 **Double Wall** **10l, 338oz**



COOL
Double Wall Ice Bucket
BPA-Free material

The double wall construction provides optimum insulation and eliminates messy condensation. Matching tongs are neatly stored within the lid design for easy access.

11584-913B **Bucket & Pincers, 1.5l, 51oz**



Storage Jars



PRESSO

Storage Jar

With silicone sleeve

The PRESSO collection invites the consumer to have full flexibility of storing any kind of products – all from very hot liquids to liquids with a high acidity level – without discoloration.

- | | | |
|----|----------|--------------------|
| 1. | 11128-01 | 0.25l , 8oz |
| 2. | 11129-01 | 0.6l , 20oz |
| 3. | 11099-01 | 1.0l , 34oz |
| 4. | 11130-01 | 2.0l , 68oz |
| 5. | 11131-01 | 2.5l , 85oz |
| 6. | 11132-01 | 1.9l , 64oz |



CLASSIC

Storage Jar

Copper-plated stainless steel,
*Only beaker is dishwasher safe

- | | | |
|----|----------|--------------------|
| 1. | 11713-18 | 0.6l , 20oz |
| 2. | 11654-18 | 1.0l , 34oz |
| 3. | 11714-18 | 2.0l , 68oz |
| 4. | 11784-18 | 1.8l , 60oz |



Gold-plated stainless steel,

*Only beaker is dishwasher safe

- | | | |
|----|----------|--------------------|
| 1. | 11713-17 | 0.6l , 20oz |
| 2. | 11654-17 | 1.0l , 34oz |
| 3. | 11714-17 | 2.0l , 68oz |
| 4. | 11784-17 | 1.8l , 60oz |

Chrome-plated stainless steel,

*Only beaker is dishwasher safe

- | | | |
|----|----------|--------------------|
| 1. | 11713-16 | 0.6l , 20oz |
| 2. | 11654-16 | 1.0l , 34oz |
| 3. | 11714-16 | 2.0l , 68oz |
| 4. | 11784-16 | 1.8l , 60oz |



Napkin Rings

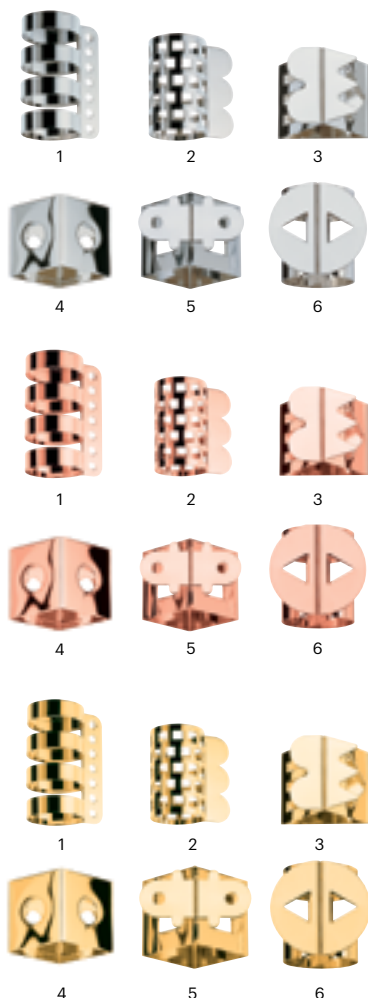

Napkin Rings

Our napkin rings are made of nickle-plated brass and from a production point of view are a very complicated product to produce even though it looks so easy and simple. You can buy them in sets of 3 or 4 or you them buy them individually.

Stainless Steel

- | | | |
|----|---------|------------------------------------|
| 1. | 4831-16 | 8 x 6 cm , 3.17 x 2.34 in |
| 2. | 4832-16 | 6.5 x 6.5 cm , 2.5 x 2.5 in |
| 3. | 4833-16 | 4.5 x 5 cm , 1.75 x 2 in |
| 4. | 4834-16 | 4 x 5.5 cm , 1.6 x 2.17 in |
| 5. | 4835-16 | 4 x 6.5 cm , 1.6 x 2.5 in |
| 6. | 4836-16 | 5 x 5.5 cm , 2 x 2.17 in |

Copper-plated

- | | | |
|----|---------|------------------------------------|
| 1. | 4831-18 | 8 x 6 cm , 3.17 x 2.34 in |
| 2. | 4832-18 | 6.5 x 6.5 cm , 2.5 x 2.5 in |
| 3. | 4833-18 | 4.5 x 5 cm , 1.75 x 2 in |
| 4. | 4834-18 | 4 x 5.5 cm , 1.6 x 2.17 in |
| 5. | 4835-18 | 4 x 6.5 cm , 1.6 x 2.5 in |
| 6. | 4836-18 | 5 x 5.5 cm , 2 x 2.17 in |

Gold-plated

- | | | |
|----|---------|------------------------------------|
| 1. | 4831-17 | 8 x 6 cm , 3.17 x 2.34 in |
| 2. | 4832-17 | 6.5 x 6.5 cm , 2.5 x 2.5 in |
| 3. | 4833-17 | 4.5 x 5 cm , 1.75 x 2 in |
| 4. | 4834-17 | 4 x 5.5 cm , 1.6 x 2.17 in |
| 5. | 4835-17 | 4 x 6.5 cm , 1.6 x 2.5 in |
| 6. | 4836-17 | 5 x 5.5 cm , 2 x 2.17 in |

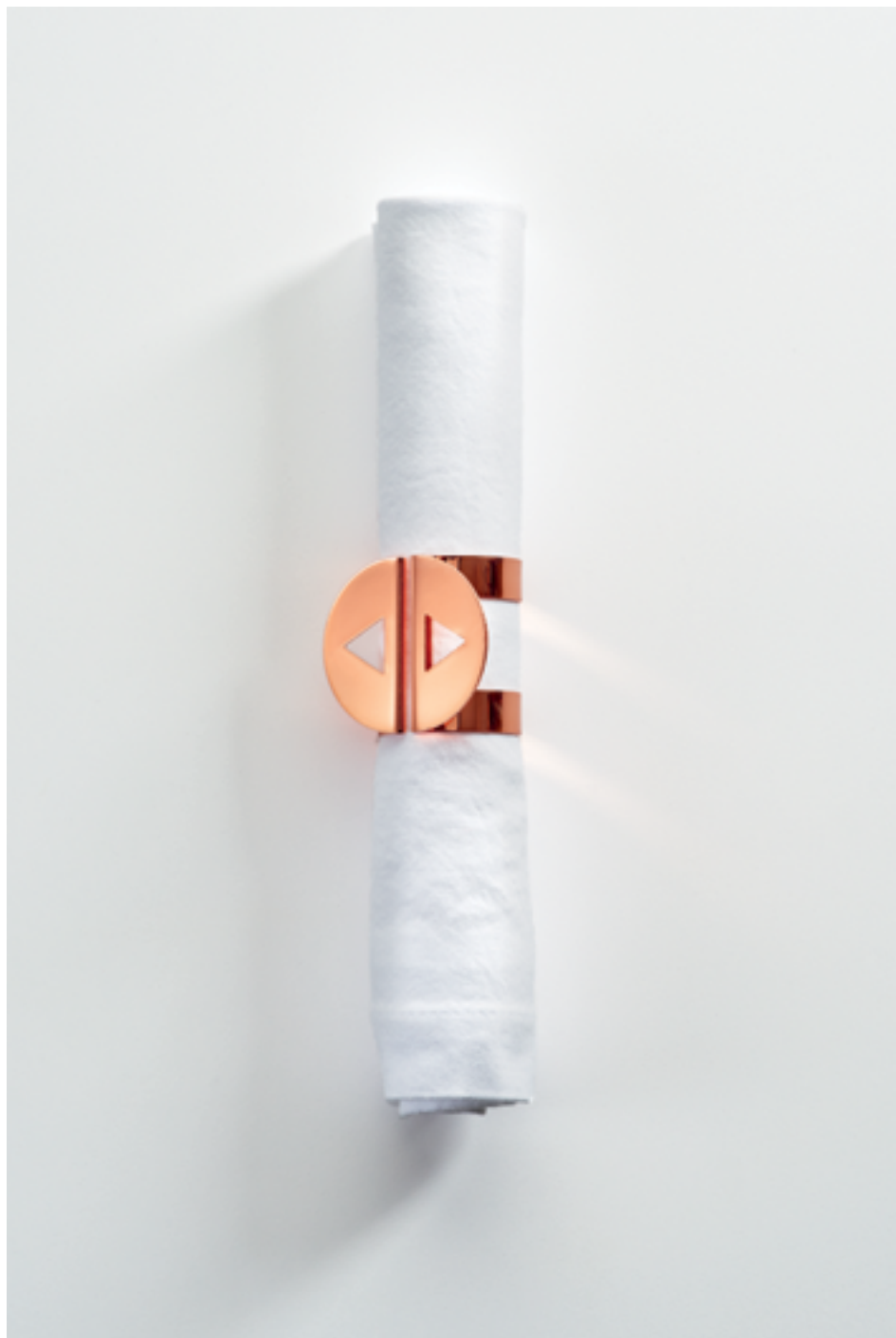

Salt & Pepper Grinders and Kitchen Accessories



BISTRO
Knife Block

The inside of the Knife Block is made of a myriad of very fine plastic sticks allowing any knife to sit anywhere in the block – tight and secure.

11089-01



BISTRO
Salt and Pepper Grinder

The powerful ceramic grinder is gradually adjustable, allowing you to grind salt and pepper to your desired coarseness. The BISTRO salt and pepper grinder is easily refillable.

11368-01-3

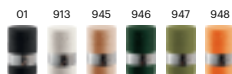

TWIN
Salt and Pepper Grinder

With one easy turn of the silicone band that serves as a non-slip handle, the TWIN switches between salt and pepper. Its excellent ceramic gears make this manual grinder extremely easy to use. The TWIN's shape is round on top and elliptical at the bottom, combining the ergonomically correct shape for hands.

11002-01





Bread Storage

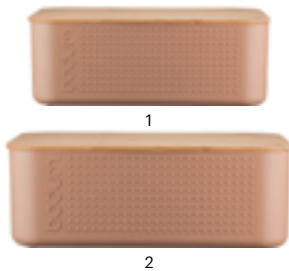

BISTRO Bread Box

Large capacity bread box featuring a crumb-catching lid that doubles as a serving tray and cutting board. Made of sustainable, eco-friendly bamboo and BPA free plastic. Handsome countertop storage unit for your kitchen or pantry. Large enough to accommodate oversized loaves of bread.

* Only the plastic box is dishwasher safe.

- 1. 11740-945-Y17 **Small Bread Box**
- 2. 11555-945-Y17 **Bread Box**

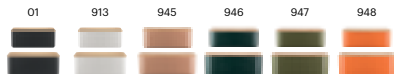

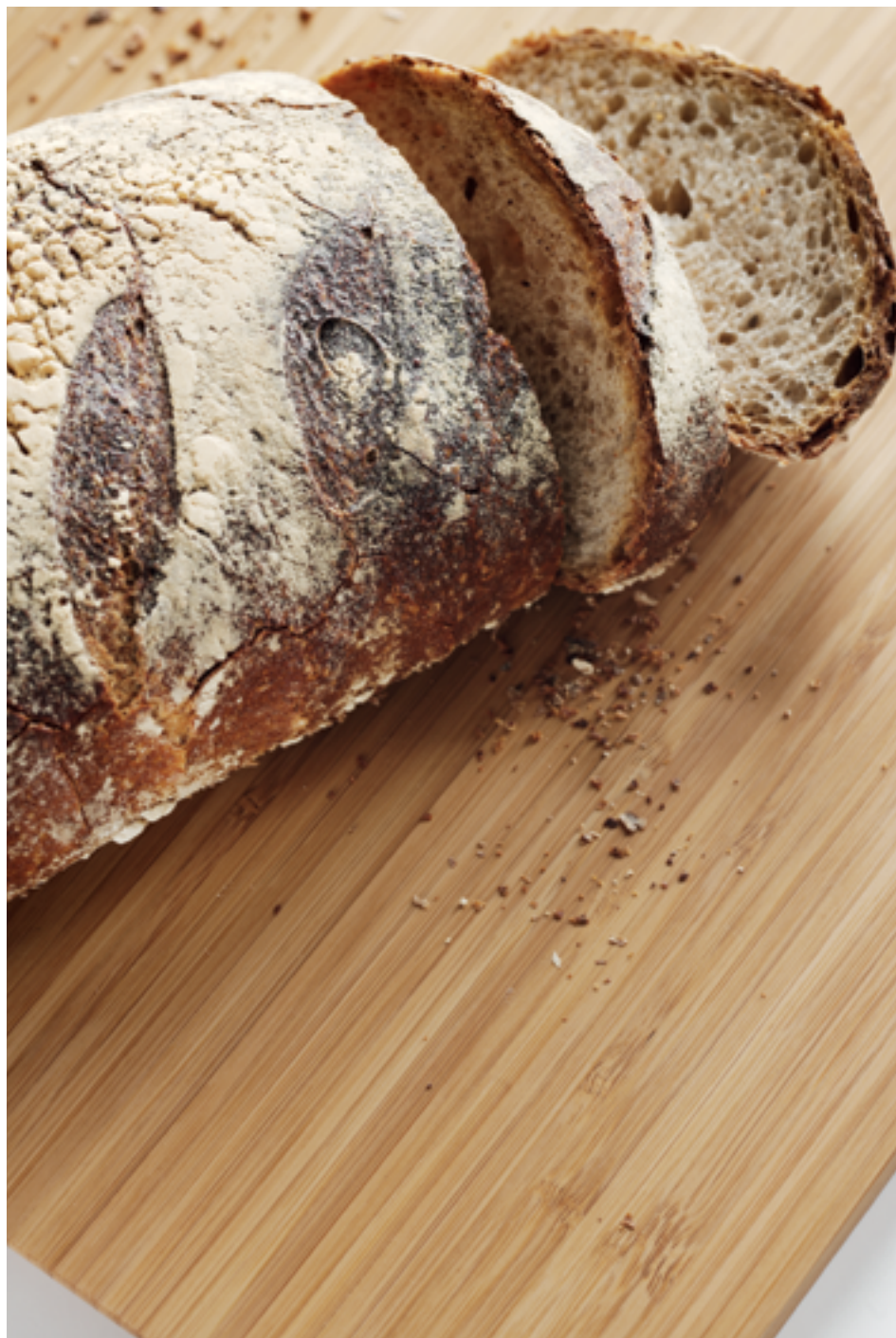

Cooking Accessories





HOT POT

Bowl

Borosilicate glass with Copper frame and silicone lid

*Only glass is dishwasher safe

Cooking, serving and storage in one. The HOT POTS are made from heat-resistant borosilicate glass – perfect for the oven. Their lines are of classic simplicity – perfect for the table. Put the silicone lid on top – and they're perfect for the fridge or the freezer. And as if that weren't enough – turn the lid upside down and it doubles as a coaster.

- | | |
|--------------|--------------------|
| 1. K11710-18 | 0.25l , 8oz |
| 2. K11711-18 | 1.0l , 34oz |
| 3. K11712-18 | 2.5l , 84oz |

HOT POT

Bowl

Borosilicate glass with silicone lid

Cooking, serving and storage in one. The HOT POTS are made from heat-resistant borosilicate glass – perfect for the oven. Their lines are of classic simplicity – perfect for the table. Put the silicone lid on top – and they're perfect for the fridge or the freezer. And as if that weren't enough – turn the lid upside down and it doubles as a coaster.

- | | |
|--------------|--|
| 1. 10125-913 | 0.25l , 8oz, 2 pcs set |
| 2. 10126-913 | 1.0l , 34oz |
| 3. K10127-01 | 1.0l , 34oz + 2.5l , 85oz, 2 pcs set |
| 4. 10127-01 | 2.5l , 85oz |

CHAMBORD SET

Bowl

Borosilicate glass with silicone lid and PP/wood handle

*Only glass is dishwasher safe

- | | |
|--------------|--------------------|
| 1. K4915-143 | 0.25l , 8oz |
| 2. K4904-143 | 1.0l , 34oz |
| 3. K4906-143 | 2.5l , 85oz |



Salad Set



BPA-Free

Dishwasher safe



GINKGO
Salad Server

BPA-Free material

2525-10 **Salad Server Set**



1



2



3



4

BISTRO
Salad Bowl

BPA-Free material

Ideal size for side salads or first course servings, these bowls are light-weight and stackable. Great for use indoor or out.

1. 11634-10 **Salad Bowl, ø14 cm**, 5.5 in, BPA-Free material
2. 11635-10 **Salad Bowl, ø16 cm**, 6.3 in, BPA-Free material
3. 11636-10 **Salad Bowl, ø23 cm**, 9 in, BPA-Free material
4. 11637-10 **Salad Bowl, ø33 cm**, 13 in, BPA-Free material
5. K11637 **Salad Bowl Set**, 4 pcs set,

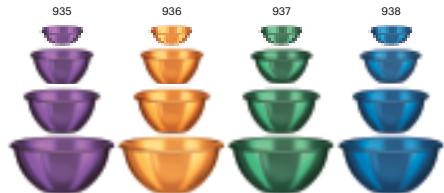



Grill

BODUM®'s first FYRKAT Grill was introduced in 1961 with the launch of the FYRKAT Cone Grill. Since then, we have refined our offering to focus on compact grilling. We saw a real need to bring good design to the aesthetics of BBQ and created our Charcoal Picnic Grill. The Picnic Grill is perfect for urban grilling and easily transportable for spontaneous beach parties.

Grill Tools



FYRKAT Grill Tools

The FYRKAT grill tools are made mainly from stainless steel and heat-resistant silicone so you stay safe while grilling.

- 1. 11487-01 **Nipper**
- 2. 11488-01 **Oil Brush**
- 3. 11489-01 **Tool Brush**
- 4. 11490-01 **Shovel**
- 5. 11491-01 **Fork**
- 6. 11492-01 **Tweezers**
- 7. K11487-01 **BBQ Tools set**, includes Nipper, Tool Brush and Shovel



FYRKAT Skewers

These skewers are made of 100% stainless steel. They come in a set of 5, each with their own letter to keep track of which is who's.

11351-16 5 pcs set

BISTRO Oil or Vinegar Dispenser

11190-143 **0.5l, 17oz**



BISTRO Sauce Pot

Make marinade directly in the pot, and the sealed lid allows you to store any leftover marinade in the fridge. The lid, with its long handle, doubles as a brush.

11203-01 **0.25l, 8oz**



Mini Picnic Charcoal Grill



FYRKAT

Picnic Charcoal Grill

Grill on the go with the sleek, portable FYRKAT Charcoal Grill. Ideal for picnics in the park or small space living but large enough to fit 4 burgers or small filets. The sleek chrome-plated finish adds strength and durability to the steel body and legs. The silicone handle stays cool to the touch and adjusts air flow into the grill while in use. The clips lock lid into place for easy and safe transport. Removable cooking rack easily transports to the sink or dishwasher for cleaning. Metal bowl captures grease while controlling heat for safe use on most outdoor surfaces.

11421-01

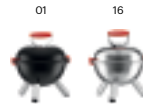

Picnic Set



1



2

NEW YORK Picnic Plate

- 1. 1617-10S **Large Plate**
- 2. 1619-10S **Small Plate**

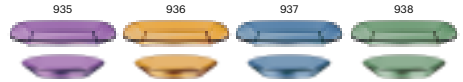

NEW YORK Picnic Bowl

2116-10S **0.35l, 27 oz**

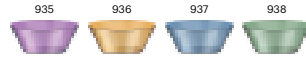

NEW YORK Cutlery Set

K6400-10

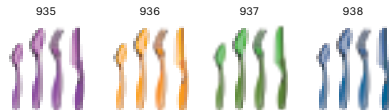

Outdoor Serveware



BISTRO
Chip 'N' Dip

BPA-Free material

The Chip 'N' Dip is ideal to serve and organize dips. Made of durable plastic, the piece is dishwasher safe. There are 6 compartments around the plate with a center dip holder.

11631-10B



BISTRO
Salad Bowl

BPA-Free material

Ideal size for side salads or first course servings, these bowls are lightweight and stackable. Great for use indoor or out.

1. 11634-10B **Salad Bowl, ø14 cm, 5.5 in,**
2. 11635-10B **Salad Bowl, ø16 cm, 6.3 in**
3. 11636-10B **Salad Bowl, ø23 cm, 9 in**
4. 11637-10B **Salad Bowl, ø33 cm, 13 in**
5. K11637 **Salad Bowl Set, 4 pcs set,**

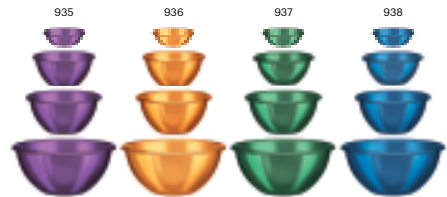

Double Wall Outdoor Barware



COOL

Double Wall Ice Bucket

BPA-Free material

The double wall construction provides optimum insulation and eliminates messy condensation. Matching tongs are neatly stored within the lid design for easy access.

11584-913 **Bucket & Pincers, 1.5l, 51oz**



KIRA

Wine Cooler

BPA-Free material

The KIRA keeps bottles cooler for longer. The double walls have an insulated effect and will withhold the temperature for a much longer period of time than a single wall.

1620-10



Double Wall Outdoor Drinkware



BODUM® CANTEEN
Double Wall Outdoor Tumbler

BPA-Free material

- 1. 11614-10 **0.251**, 8 oz
- 2. 11615-10 **0.451**, 15 oz



PAVINA
Double Wall Outdoor Tumbler

BPA-Free material

- 1. 11686-10 **0.091**, 3 oz
- 2. 11616-10 **0.251**, 8 oz
- 3. 11617-10 **0.351**, 12 oz
- 4. 11618-10 **0.451**, 15 oz



PAVINA
Double Wall Outdoor Tumbler

Tritan

- 1. 11686-10-1 **0.091**, 3 oz



Cork Line

BODUM has a new design line with cork. One of nature's most beautiful and functional materials. Cork comes from the bark of cork oak that is a bit of a miracle in itself. Each 9 years you can harvest all the tree's bark so that it is completely naked. Without damaged. The tree generates new bark and can grow up to 200-300 years old.

Kork-oak grows in the Mediterranean region, not least in Portugal, which supplies about half of all the cork that is used in the world. We know the cork from winebootles plugs, but because cork has so many good qualities, it also moved into the home. Cork is thermal insulation, water and air-tight, elastic, light and soundproofing. And it is beautiful to look at and smooth to touch.

Cork is a 100% natural materials and sustainable. And we have almost the cork-trees standing just outside the windows. All BODUM products are produced namely in our own factory in Portugal, where environmental responsibility already has the highest priority.

Yohki Storage Jars





Yohki
Storage Jar

Borosilicate glass with cork lid
 *only glass is dishwasher safe

- 1. 8525-109-2 **0.25l**, 8oz
- 2. 8560-109-2 **0.6l**, 20oz
- 3. 8600-109-2 **1.0l**, 34oz
- 4. 8650-109-2 **2.0l**, 68oz
- 5. 8700-109-2 **2.5l**, 85oz
- 6. 8687-109-2 **1.8l**, 64oz



Wine Decanter & Water Infuser



MELIOR

Wine Decanter & Water Infuser

Borosilicate glass

*only glass is dishwasher safe

1. 11765-109 **8 cup**, 1.0l, 34oz
2. 11790-109 **16 cup**, 2.0l, 68oz



Cork Line

Glogg Decanters



2

2

MELIOR

Glogg Decanter & Glogg Set

Borosilicate glass

*only glass is dishwasher safe

1. 11766-109 **8 cup**, 1.0l, 34 oz
2. 11785-109 **8 cup**, 1.0l, 34 oz

Pour Over Coffee Makers



☒ No paper filter! ☒ No capsule!

Borosilicate glass carafe

Stainless steel mesh filter

BPA-Free

Made in Europe

Dishwasher safe



POUR OVER

Coffee Maker

with leather band

*cork and leather parts are not dishwasher safe

1. 11592-109S **4 cup**, 0.5l, 17 oz
2. 11571-109S **8 cup**, 1.0l, 34 oz
3. 11593-109S **12 cup**, 1.5l, 51 oz



POUR OVER

Coffee Maker

with silicone band

*cork and leather parts are not dishwasher safe

1. 11592-109A **4 cup**, 0.5l, 17 oz
2. 11571-109A **8 cup**, 1.0l, 34 oz
3. 11593-109A **12 cup**, 1.5l, 51 oz



POUR OVER

Double Wall Coffee Maker

with tritan body

*cork and leather parts are not dishwasher safe

- 11736-109 **8 cup**, 1.0l, 34 oz



STEP 1
Coffee



STEP 2
Water



Cork Line

STEP 3
Enjoy!

Hot Pots & Porcelain Mugs



HOT POT

Bowl

Borosilicate glass with cork base & silicone lid
*only glass is dishwasher safe

- 1. 4401-10-143 **0,25**, 8oz
- 2. 4402-10-143 **1,01**, 34oz
- 3. 4403-10-143 **2,51**, 84oz



BISTRO

Mugs

Porcelain cup with cork sleeve

- 1. 11793-109 **0,17**, 8oz
- 2. 11794-109 **0,31**, 34oz
- 3. 11795-109 **0,61**, 84oz

Grill Tools



FYRKAT

Grill Tools

The FYRKAT grill tools are made mainly from stainless steel. Now you can have it with soft cork handles.

1. 11487-109 **Nipper**
2. 11488-109 **Oil Brush**
3. 11489-109 **Tool Brush**
4. 11490-109 **Shovel**
5. 11491-109 **Fork**
6. 11492-109 **Tweezers**
7. K11487-109 **BBQ Tools set**, includes Nipper, Tool Brush and Shovel



e-BODUM®

e-BODUM® inspires you to build a collection of power tools that reflect our core principle: Good design has to be functional and affordable. Once you see past the good looks of e-BODUM®, each product's attributes and performance will make you a loyal fan! Not only will you appreciate the award-winning design of these products, e-BODUM® will bring the power and innovation necessary to make kitchen duty a breeze!

Stand Mixer

The Stand Mixer effortlessly takes care of blending, mixing, and kneading your dough as well as whipping cream and beating egg whites.



Capacity 4.7l, 5Qt, 160oz

Measurements 234 × 397 × 343mm

Material Plastic, silicone, rubber, stainless steel, non-stick coated cast aluminum, chrome-plated steel

Rating Europe 700W, 220–240V, 50–60Hz

The Stand Mixer comes with the following attachments:

- 1 Stainless steel mixing bowl
- 1 Dough hook
- 1 Beater
- 1 Whisk

- Powerful 700W, 7 speed motor delivers up to twice the power of traditional stand mixers.
- Rotating attachment head provides orbital movement, maximizing capture surface for thorough mixing.
- Includes 3 attachments: Dough hook, ideal for bread and pizza doughs, rolls and sweet bread dough; Beater for cake batters; Stainless steel whisk for beating egg whites, cream and cocktail sauces. Attachments and mixing bowl are dishwasher safe.
- Lift-assist mixer head locks into place during use with lever for easy release.

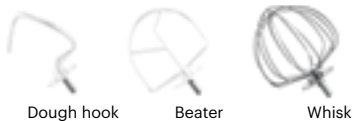

e-BODUM®

BISTRO
Stand Mixer
 11381-01-3



Meat Mincer

Measurements 161×100×190 mm

Material Plastic, stainless steel, silicone, metal, non-stick coated aluminum

The Meat Mincer comes with the following attachments:

1 Fine grinding plate

1 Coarse grinding plate

The Meat Mincer is an attachment to the BISTRO Stand Mixer for mincing raw and cooked meats.

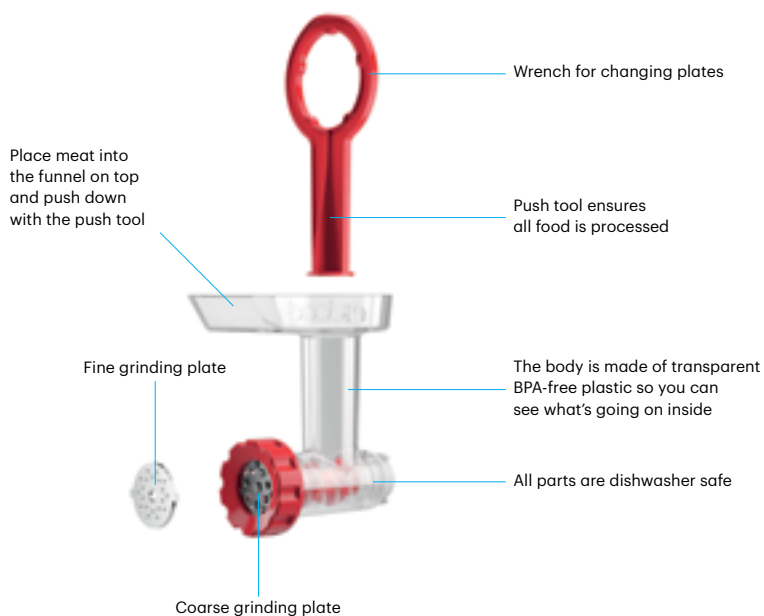

BISTRO
Meat Mincer
11514-10



Slicer Shredder

Measurements 141 × 96 × 207 mm

Material Plastic, stainless steel, non-stick coated aluminum, silicone, metal

The Slicer Shredder comes with the following attachments:

- 1 Coarse shredding drum
- 1 Fine shredding drum
- 1 Slicing drum
- 1 Parmesan grating drum

The Slicer Shredder is an attachment to the BISTRO Stand Mixer to grate, slice and shred a wide variety of foods.

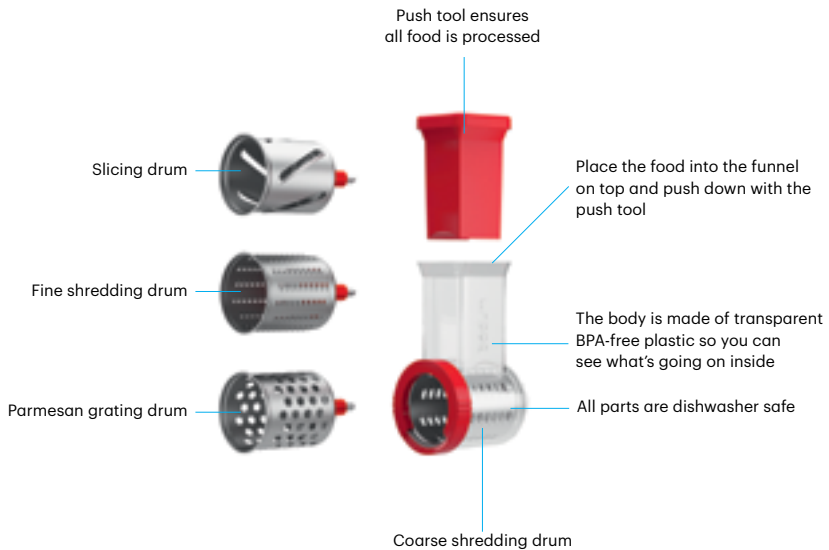

BISTRO
Slicer Shredder
11515-10



Blender

The Blender is a powerhouse tool that easily mixes, chops, grinds, crushes and liquefies everything from nutritious smoothies to satisfying soups.



Capacity 1.25l, 42 oz

Measurements 220 × 215 × 345 mm

Material Plastic, stainless steel, rubber, silicone

Rating Europe 500W, 220-240V, 50-60Hz

- Easily adjustable continuous speed dial with convenient pulse function.
- The pitcher is made of BPA-free plastic which is enormously sturdy and durable and is dishwasher safe.
- The lid has two openings: one with a filter to hold back any unwanted pieces, the other to pour thicker liquids.
- The pitcher holds 1.25l and comes with an easy to read scale line.
- The container's handle is rubber coated for a safe and firm grip.
- Suction cups at base offer secure countertop stability.

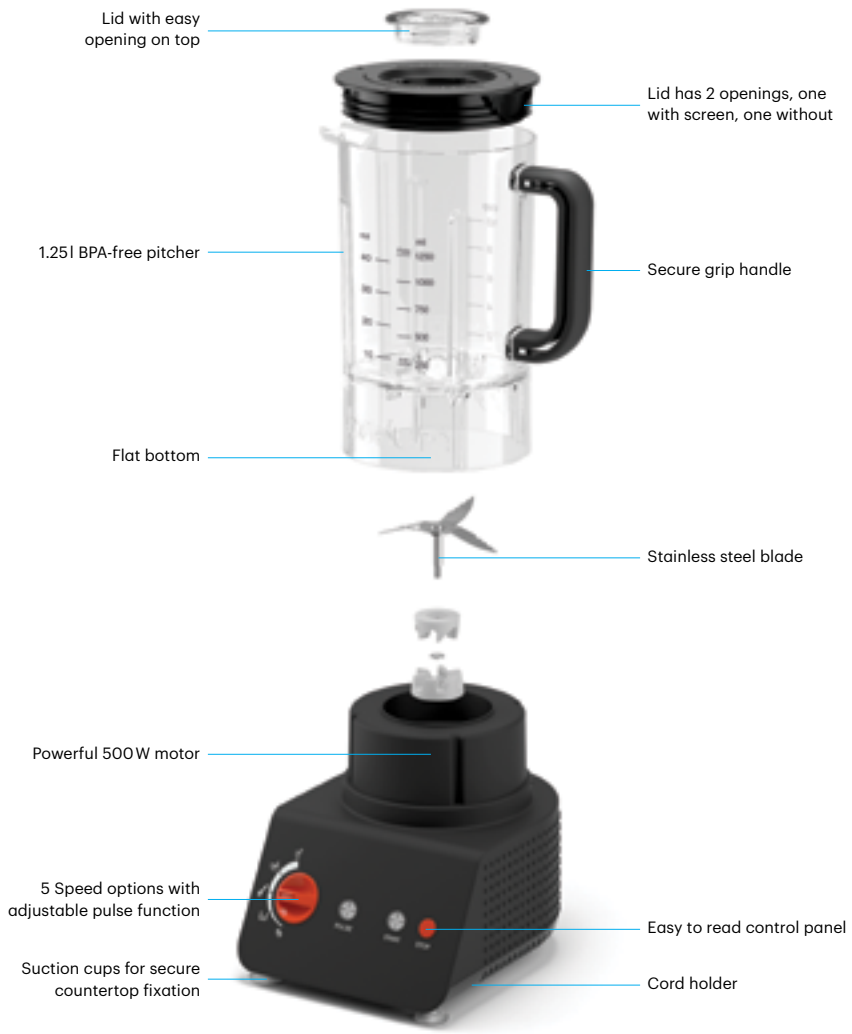

e-BODUM®

BISTRO
Blender
 11303-01



Blender Stick

This Blender Stick is very convenient and includes 3 stainless steel accessories. Ideal for pureeing, whipping cream and beating egg whites as well as for smoothies and soups.



Measurements 67 × 67 × 358 mm

Material Plastic, stainless steel, silicone

Rating Europe 200 W, 220–240 V, 50–60 Hz

Rounds per minute EU (r/min)

Low speed: approx. 15'000

High speed: approx. 20'000

The Blender stick comes with the following attachments:

| | |
|-------------------|-------------------|
| 1 Whisk | 1 Knife |
| 1 Beater | 1 Tool for blades |
| 1 Beaker with lid | |

- The slim and sleek design is perfect for reaching deep into bowls, pots, and pitchers.
- Includes three stainless steel blades: Beater to whip up cream and egg whites; Whisk to blend mayos and sauces and knife for soups and smoothies.
- Includes a beaker with silicone lid ideal for pureeing and food storage.
- Two push-activated buttons control speed settings for convenient, one-handed use. 12'000 rotations per minute in low speed, 17'000 in high speed make for a powerful kitchen tool.
- No-slip, rubber-coated grip features BODUM®'s signature ergonomic dots for a secure, comfortable grip.

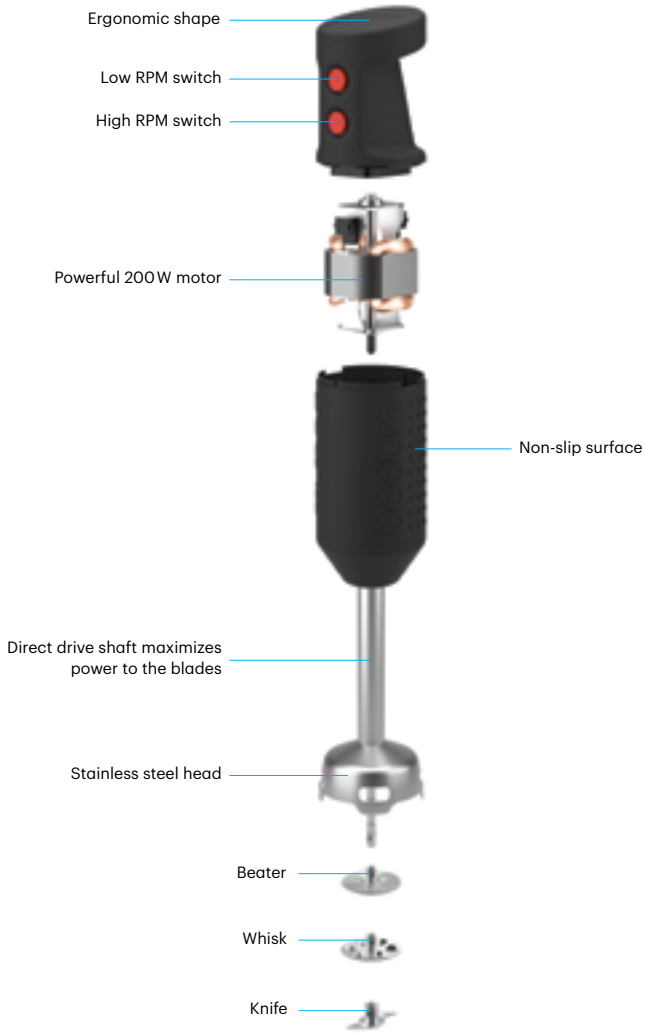

e-BODUM®

BISTRO
Blender Stick
K11179-01



Hand Mixer

This handy Hand Mixer can handle blending, mixing and whipping tasks and its power cord rolls up inside the mixer for easy storage.



Measurements 315×90×208mm

Material Plastic, rubber, silicone, stainless steel

Rating Europe 200 W, 220–240 V, 50–60 Hz

The hand mixer comes with the following attachments:

- 2 pcs Beaters set
- 2 pcs Dough hooks set
- 1 pc Whisk

- Its five powerful speeds can handle anything from blending a simple sauce to kneading a bread dough.
- For easy and space efficient storage, the power cord can be rolled up in the mixer's body.
- Includes three stainless steel attachments: Beaters to blend; Dough hooks to knead batters or doughs and whisk to whip cream or beating egg whites.
- Slip-proof silicone feet allows the mixer to stand upright on its own.
- Speed control button that slides for one-handed mixing.
- The stainless steel attachments are dishwasher safe.
- Handy in use and space efficient in your kitchen cabinet.

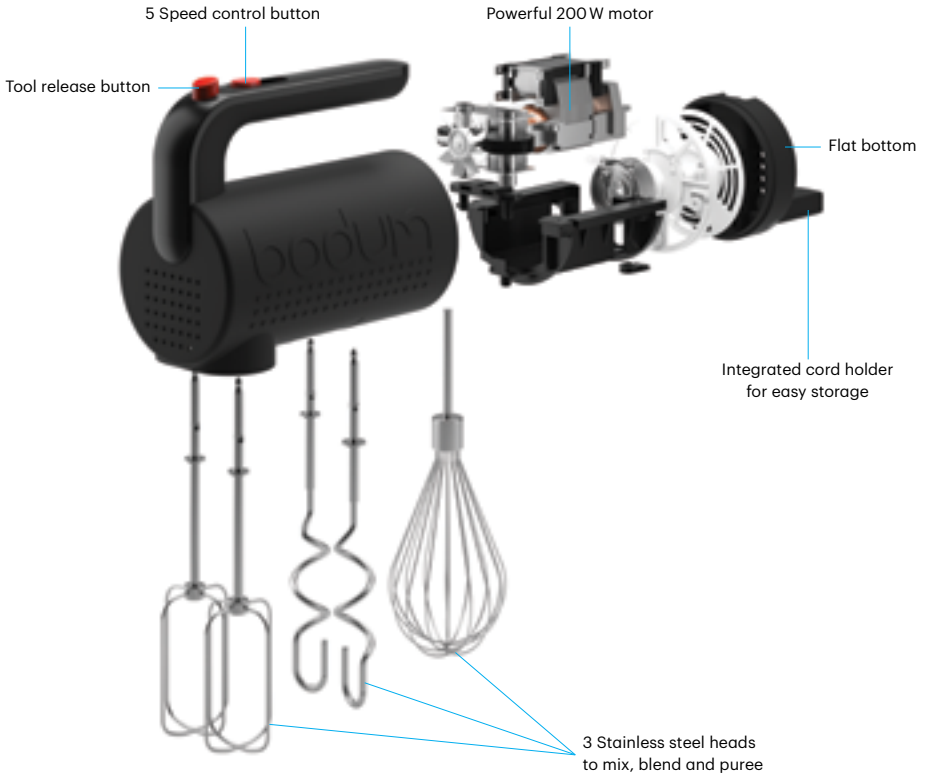

BISTRO
Hand Mixer
With integrated cord holder
11520-01



Hand Mixer

This handy Hand Mixer can handle anything from whipped cream to mashed potatoes, kneading bread dough or mixing cake batters.



Measurements 170 × 95 × 172mm

Material Plastic, stainless steel, silicone

Rating Europe 185 W, 220–240 V, 50–60 Hz

The hand mixer comes with the following attachments:

2 pcs Beaters set
2 pcs Dough hooks set

- Its five powerful speeds can handle anything from blending a simple sauce to kneading a bread dough.
- Includes two stainless steel attachments: Beaters to blend, mix and puree (whipping cream, beating egg whites and blending cocktail sauces); Dough hooks to knead cake batters, bread or pizza doughs.
- Slip-proof silicone feet allows the mixer to stand upright on its own.
- Speed control button that slides for one-handed mixing.
- The stainless steel attachments are dishwasher safe.
- Handy in use and space efficient in your kitchen cabinet.



BISTRO
Hand Mixer
11532-01



Toaster

Toaster with 2-slice opening has variable temperature control designed to toast to perfection.



Measurements 155×265×215 mm

Material Metal, stainless steel, plastic, rubber, silicone

Rating Europe 940 W, 220–240 V, 50–60 Hz

- Adjustable-width toasting slots create a secure grip around food while toaster is in use.
- Variable browning temperature control and defrost function and stop button for perfect defrosting and crisping of bread.
- Pop-up warming rack for rolls, croissants, bread and more.
- Integrated slide-out crumb tray for easy cleaning.
- Footed base with cord retainer to adjust cord length and store neatly.
- Cool touch exterior is easy to clean.

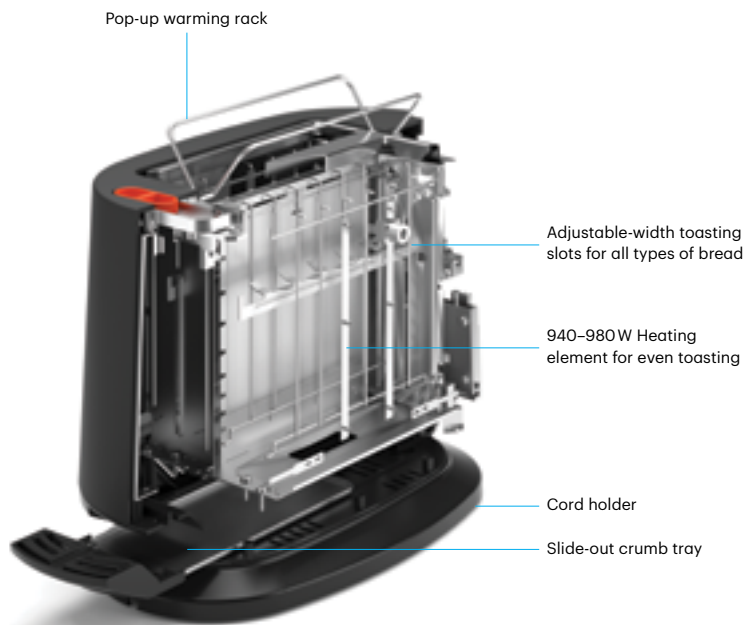

BISTRO
Toaster
 10709-01-3

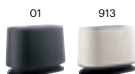

Juicer

High speed, efficient Juicer designed to accommodate taller glasses. Ideal for quickly and efficiently juicing fruits.



Measurements 195 × 180 × 285 mm

Material Plastic, silicone, stainless steel, Rubber

Rating Europe 90 W, 220–240 V, 50 Hz

Rounds per minute (r/min)

Low speed: 90+/- 10"%

High speed: 570+/- 10"%

- One head works for smaller and bigger fruits.
- Robust stainless steel tray.
- High-speed cyclone function separates every drop of juice from the pulp.
- A drip stop prevents your kitchen counter from turning into a sticky mess.
- Features a higher pour spout to accommodate taller glasses.
- Easy to clean: All detachable parts of the juice tray are dishwasher safe.

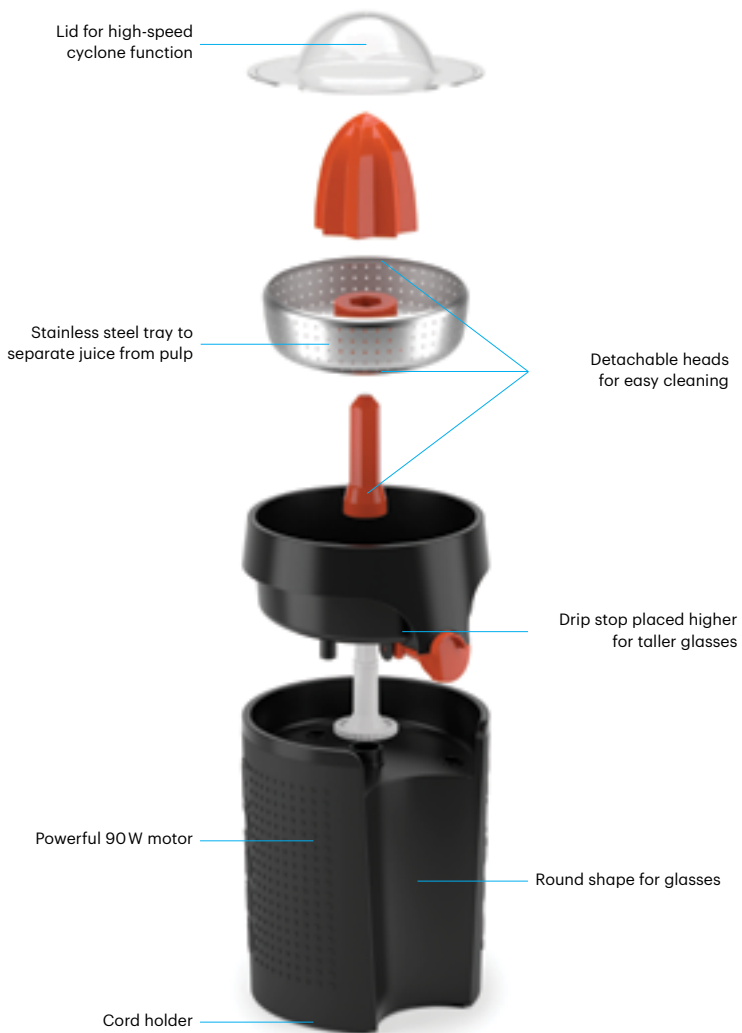

e-BODUM®

BISTRO
Juicer
 11149-01



Double Wall Water Kettle

This Water Kettle can be set and held at desired temperature for up to 30 min! Ideal for maintaining optimal brew temperatures for your teas!



Capacity 1.1l, 37 oz

Measurements 145 × 230 × 260 mm

Material Plastic, silicone, borosilicate glass, metal, stainless steel, rubber

Rating Europe 1500 W, 220–240 V, 50–60 Hz

- Five temperature settings perfect for different kinds of teas: 60°C/140°F, 70°C/158°F, 80°C/176°F, 90°C/194°F and boiling.
- The inner glass wall is made of borosilicate glass, the outer one of transparent plastic. It protects the glass, insulates, and keeps you from burning your fingers.
- The water only comes in contact with glass – the process is therefore BPA-free.
- Mesh-screened spout captures chalk while pouring.
- The transparent container makes it easier to control the water level. The scale line indicates liters, ounces and cups.
- Manual On/Off switch plus temperature sensor for automatic shut off and added safety.
- Keep warm for up to 30 min



e-BODUM®

BISTRO
Double Wall Water Kettle

With adjustable temperature control

11659-01 **1.1l**, 37oz



Water Kettles

The electric BISTRO Water Kettle was developed to boil water quickly and energy efficiently – ideal for coffee, tea and instant soups.



Capacity 0.5l, 17oz – 1.0l, 34oz – 1.5l, 51oz

Measurements

0.5l: 172 × 100 × 195 mm
1.0l: 125 × 200 × 224 mm
1.5l: 148 × 232 × 235 mm

Material Plastic, stainless steel, silicone

Rating Europe

0.5l: 700W, 220–240V, 50–60Hz
1.0l: 1300W, 220–240V, 50–60Hz
1.5l: 1850W–2200W, 220–240V, 50–60Hz

- The heating element is safely tucked away at the bottom of the kettle and doesn't get in contact with the water.
- The cordless container can be positioned on its 360 degree base and easily remove for cordless pouring.
- The lid opens at the push of a button.
- The heating element is safely tucked away at the bottom of the kettle and doesn't get in contact with the water.
- Mesh-screened spout captures chalk while pouring.
- Easily readable water level scale to avoid wasting water and energy.

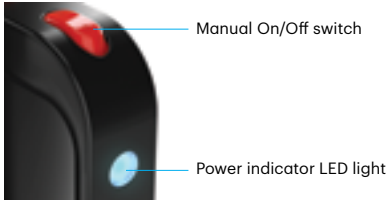

e-BODUM®

BISTRO
Water Kettle

| | | |
|----|----------|--------------------|
| 1. | 11451-01 | 0.5l , 17oz |
| 2. | 11452-01 | 1.0l , 34oz |
| 3. | 11138-01 | 1.5l , 51oz |

| | |
|----|-----|
| 01 | 913 |
| | |

1 2 3

Programmable Coffee Maker

The Programmable Coffee Maker sets new standards in coffee making: Excellent, full-bodied taste without capsules or paper filters!



☒ No paper filter! ☒ No capsule!

Capacity 1.5 liter - 51 fl. oz

Measurements 281×180×367 mm

Material Plastic, Silicone, Glass, Stainless Steel, Galvanized steel, Nickel plated steel

Rating Europe

900W, 220-240V, 50-60 Hz
*keep warm for 30 minutes

Rating USA 900W, 120V, 60 Hz
*keep warm for 30 minutes

- Glass Carafe with an easy to grip, non-slip handle
- Includes a permanent stainless steel coffee filter
- Stain resistant heating plate keeps coffee warm for up to 30 minutes.
- Easy to read back-lit LED display
- Programmable up to 24 hours in advance for convenience



e-BODUM®

BISTRO
**Programmable
Coffee Maker**

11754-01 1.5l, 51oz



ePEBO Vacuum Coffee Maker

The ePEBO vacuum coffee maker is the modern version of Santos, and has been part of the Bodum range long ago.



☒ No paper filter! ☒ No capsule!

Capacity 1.0l/34 oz

Measurements 200 × 232 × 342 mm

Material Plastic, stainless steel, borosilicate glass, rubber, silicone

Rating Europe
1000W, 220-240V, 50-60Hz

Rating USA 1000W, 120V, 60 Hz

- Funnel made of borosilicate glass, users can view the brewing process from start to finish.
- Includes a permanent plastic coffee filter
- Stain resistant heating plate keeps coffee warm for up to 30 minutes.
- Easy to read back-lit LED display



Step 1
Water



Step 2
Coffee



Step 3
Brew



Step 4
Enjoy !

Funnel Made of borosilicate glass, users can view the theatrical brewing process from start to finish.

Filter The coffee maker is removed from the heat and vacuum pressure draws the brewed coffee downward through a strainer, and into the bottom chamber for serving.

Jug Water heats in the lower chamber, creating vapor pressure that forces the boiling water up to mix with coffee grounds.

Base The brewing time and temperature are perfectly calibrated, ensuring a perfect cup of coffee with each brew.



e-BODUM®

ePEBO
**Vacuum Coffee
Maker**

11744-01

1.0l, 51oz



Burr Coffee Grinder

The Burr coffee grinder uses conical burr grinders, the best you can get. The result is oily and flavoured coffees.



Measurements 170 × 163 × 296 mm

Material Ceramic, Plastic, Silicone

Rating Europe

160 W, 220–240 V, 50–60 Hz

Rating USA

160 W, 120 V, 60 Hz

Rounds per minute (r/min)

720 +/- 15%

- This space-saving grinder holds an amazing 220gr of coffee and therefore allows for larger quantities in one go.
- Settings allow you to grind from a coarse French press to a fine espresso with the ability to micro-adjust between settings.
- Programmable time function for even easier handling.
- You can use a conical burr grinder for oily or flavoured coffees and it is not likely to clog, like the other kinds of grinders.
- Tightly fitting plastic lid keeps the grounds from spilling.
- The burr spins slower than the wheel model, which makes them quieter and less messy



Conic ceramic
burr blades



e-BODUM®

BISTRO
Burr Coffee Grinder
11750-01



Burr Coffee Grinder

Grinder crushes beans between stainless steel conical burrs rather than slicing them which preserves bean's intrinsic flavor and aroma.



Measurements 120x156x275 mm

Material Plastic, rubber, silicone, borosilicate glass, stainless steel, die-cast aluminium (for 70/73 version)

Rating Europe

160 W, 220-240 V, 50-60Hz

Rounds per minute (r/min)

720+/-15%

- This space-saving grinder holds an amazing 220 gr of coffee and therefore allows for larger quantities in one go.
- 12 settings allow you to grind from a coarse French press to a fine espresso with the ability to micro-adjust between settings.
- Programmable time function for even easier handling.
- The wide open funnel prevents spilling of the beans.
- Tightly fitting plastic lid keeps the grounds from spilling.
- Equipped with a friction clutch, preventing damage to the grinding gear by the presence of small stones.



e-BODUM®

BISTRO
Burr Coffee Grinder
 10903-73-1



Blade Coffee Grinder

Grinds coffee beans from coarse to fine quickly and efficiently with its strong, durable, stainless steel cutting blade.



Measurements 90 × 95 × 166 mm

Material Plastic, stainless steel, rubber, die-cast aluminium (for 70/73 version)

Rating Europe 150 W, 220–240 V, 50–60 Hz

Rounds per minute (r/min)
26'000 +/- 20%

- Compact and small – this space efficient coffee grinder can easily be left on the kitchen counter.
- The transparent lid allows you to control the grinding progress – the longer the grind, the finer the grounds.
- The power cord can be tucked away within the grinder.
- Easy, push-button control allows for pulse action or continuous grind.
- Strong, durable stainless steel cutting blade that spins at a precise RPM.
- Convenient cord storage in base.

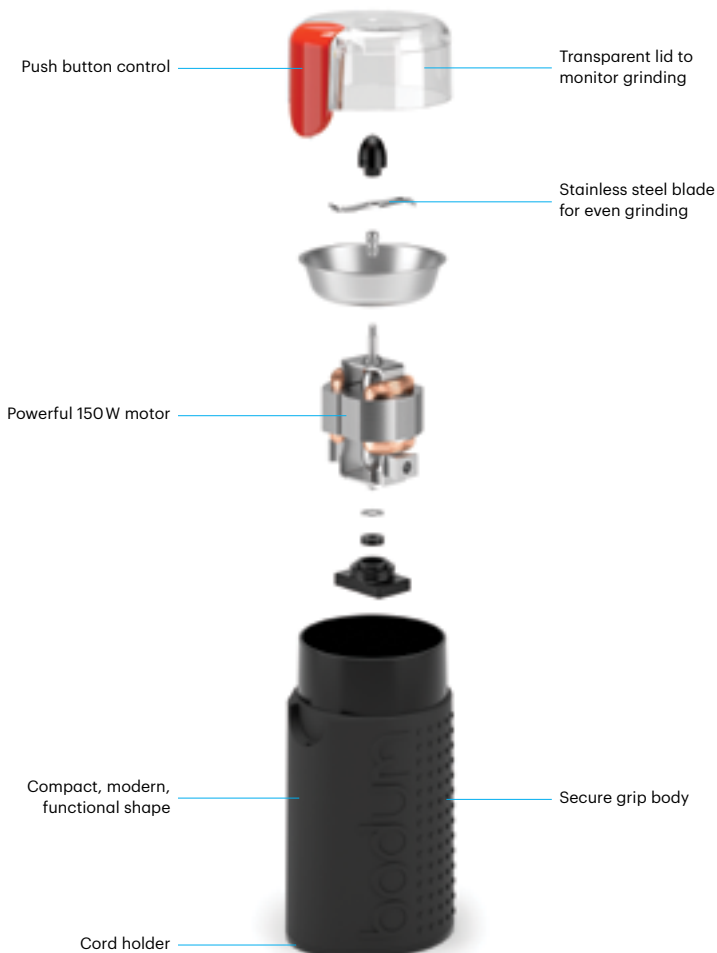

e-BODUM®

BISTRO
Blade Coffee Grinder
 11160-70-1









Step 1
WATER



Step 2
COFFEE



Step 3
BREW



Step 4
ENJOY!

