

CentreStage

CentreStage Theatre
Technical Specification.
June 2022

Contents

Contact Information	3
Stage Specifications	4
Flying and Rigging Specifications	5
Dressing Rooms	5
Electrical Specifications	6
Sound Specifications	8
Get In and Parking	9
Health & Safety	10
PPE Policy	11
Covid 19	12
Lighting Plan	13
Dimmer Plan	14
Pit Layout	15
Blank Hanging Plot	16
CentreStage Site Map	17

Contact Information

Ayrshire Arts Academy and CentreStage
15 Elmbank Road
Kilmarnock
East Ayrshire
KA1 3AE
01563 551505 (Reception)

Service Yard/Get in door accessed off Braeside Street

If you have any questions please contact:

Chris Buffham, Technical & Building Ops Manager:

01563 551505
chris.buffham@centrestagemt.org.uk

Stage:

The stage surface is flat and painted matte black. Lightweight fixing into the surface with screws is permitted. Wing space is height restricted D/S/R. The space is accessed via upstage left and right leading from the dressing room corridor. Auditorium and Orchestra pit can be accessed from pass doors downstage left and right.

Stage Dimensions:

Stage depth to front incl. apron:	9.3m
Stage depth to back of proscenium:	8.15m
Proscenium width:	8.6m
Proscenium height:	4.2m
Height above stage:	9.5m
Underside of both fly floors	5.96m
Stage height from auditorium	1m
SL wing:	2.6m x 8.1m
SR wing:	4.3m Upstage 2.8m Downstage x 8.1m

Auditorium Dimensions:

Seating retracted, Pit wall to back wall:	9.5m
Seating retracted, width:	17.3m

Orchestra Pit Dimensions:

Depth from stage floor: 2.5m, please see pit layout plan in this document.

Opening covered over with removable modular safety mesh

12 x Lit music stands

Drapes:

Red House Tabs in line with pros. Manually controlled SR.

3 x pairs of 5000 x 2000mm black legs

1 x pair of 5000 x 1800mm black legs

3 black borders 10000 x 550mm

Cyclorama on fixed bar US

8m x 4.5m DMX LED star cloth available

Flying System:

At CentreStage we have an 11 bar automated stage flying system with the capacity to have 50 pre-programmed fly cues per act operated from stage right wing. We also have 6 overhead drill driven winch bars for the purpose of lighting operated on stage left fly floor.

6 x Drill driven winch. SWL 250kg

1 x Internally Wired Bar (10 x 16A + 2 x DMX) on fixed bar DS

2 x Internally wired Bar (4 x 15A + 2 x DMX) fixed in vertical position either side of circle

11 x Motorized flying bars SWL 150kg

1 x Motorized advance fly bar (FOH Lighting position) SWL 350k

[Please see attached blank hanging plot for fly bar distances](#)

Backstage Accommodation:

The backstage area is accessed via a secure fob operated stage door

There are two fully accessible large dressing rooms that can comfortably accommodate 20 in each room, with LED lighting, mirrors, sockets, and adjacent toilets. There are also 2 extra dressing rooms without mirrors if needed accommodating 20 in each room.

Fully accessible multipurpose green room that can accommodate 60, that can be used to relax, rehearse pre, during and post theatre productions.

At present there are no showers available in the backstage area. If needed we do have a shower room below the stage in our admin area should you need to use it.

Lighting

As a multi-functional venue we have our standard lighting permanently rigged to ensure we can be as versatile as possible. This can be de-rigged with 4 weeks prior notice to guarantee we can schedule this prior to your arrival.

[Please see our attached standard rig plan.](#)

Control:

Zero88 OrbXF console

2 x Touch screen Monitors

4 DMX universe outputs + a further 8 DMX universes through ARTnet

4 x DMX tie ins in booth position and 4 x DMX tie ins in SR of auditorium.

Multiple data points throughout the booth and stage area which can be patched through ArtNET DMX node in dimmer room. Patchable DMX outputs USL, USR, DSL, DSR, SR+SL perch position in auditorium

Houselights are available for DMX or manual control from the prompt desk

Dimmers:

4 x Flown Movable IWB'S (10 x 16A + 2 x DMX)

72 ways of Zero88 Chilli Pro dimming/ switchable 16A circuits

Please note, LX 1 is a static bar.

[Please see our attached Dimmer plan.](#)

Temporary Power:

Onstage:

1 x 63amp 3ph upstage right

Auditorium.

1 x 32amp 3ph auditorium left and auditorium right

Control position:

Fully accessible sound and lighting, position, located in the back centre of the circle.

Lighting Fixtures:

18 x Showtec Spectral M1000

21 x Showtec Spectral M800

14 x Showtec Infinity iS-200

2 x Showtec Infinity iW-1915

5 x Showtec Phantom Spot 130

2 x Showtec Shooter 180

8 x Showtec Spectral Cyc2000

8 x Showtec Sunstrip

2 x Showtec Spectral M3000 Zoom

2 x Source 4 CE 15/30

2 x Source 4 Fresnel

4 x Strand Prelude 16/30

4 x Strand Coda 500/1

Followspots:

1 x Strand Solo 2K

1 x Eurolite LED SL350

Both rigged overhead in control booth

Effects

Pea Souper Co2 Phantom Hazer with DMX control.

SOUND and AV

DESK:

Allen & Heath GLD 112 (48mic inputs, 20 mix outputs)

System:

dB Line array DVA MINI system. 4 flown boxes per side

Subs: DVA MS12 one pair flown per side

Centre Fill: one DVA MINI M2M+M2S pair

Mic Stock:

We stock a large range of condenser and dynamic microphones from Shure, Rode, Sennheiser, AKG, Behringer etc. This includes a drum pack, vocal, instrument and overhead mics.

Assorted mic stands, DI's, cables and stage monitors available.

Radio Mics: (Available at an extra cost)

24 x Trantec Radio receivers.

8 x Trantec S5.5 handheld mics serviced by above receivers

24 x Trantec S5.5 overear microphones

8 x Audio Technica handheld mics

AV: (Available at an extra cost)

SANYO XF45 10K projector

Epson H431B projector with pop up screen

2 x JVC 65" 4K HDR Smart TVs on stands

Roland V4 4 channel Video Mixer

Show operation:

Show Relay feed to backstage areas.

Mic for BOH and FOH Calls

Prompt desk located D/S/R

CCTV Tie in at prompt desk includes FOH view, Fly Floor motors, MD and IR camera for blackout.

Comms: Canford / Altair Wired comms points – D/S/R, D/S/L, Sound, LX, Follow-spot, Orchestra Pit, Motor/Fly floor.

4 x Altair Wireless comms units

Get In:

Access for all vehicles via service yard in rear of building accessed off Braeside Street. (See Attached Map)

Auditorium accessed via set of double doors directly into auditorium left via a ramp.

Get-in doors are 1.98m wide x 3.04m high and are located mid-stage right directly off the service yard via a ramp.

Parking:

CentreStage has 2 free car parks onsite. Please see attached map for details.

Venue Plans:

All venue DWG or PDF plans are available on request

Health and Safety

Prior to arrival at CentreStage the following documentation must be received by our technical staff:

- Production rider (4 weeks in advance of performance)
- All risk Assessments
- Method statements
- Hanging plot detailing bar weights
- Details of all certification with regards to the production
- CDM information

Please also be aware that any rigging that arrives without a stamped SWL will not be able to be used. CentreStage has the right to refuse to hang or fit up any equipment brought into the building that does not have the correct certification.

All touring electrical equipment must be PAT tested; under no circumstance should any portable electrical appliance be used in the building without being so. Our electrical department can arrange PAT testing for you however a charge will apply.

The correct PPE must be worn at all times. All visiting staff must adhere to in-house health and safety guidelines; the CentreStage Technical Department has the right to remove any member of visiting company staff from a working area who is not complying. More details on these requirements can be obtained from CentreStage Technical Department.

Access to the building/Stage must be pre-arranged with CentreStage Technical Department. Rehearsal/maintenance calls should be called prior to your arrival at the venue. Any change in calls must have 24 hours' notice

The Duty Manager/Technician has the right to stop any performance by whatever means necessary in the event of an emergency situation arising.

PPE Policy – Visiting Companies

Safety boots must be worn:

- At all times while working in technical areas. (The only exception to this is when there is absolutely no risk to staff – e.g. when working a performance where there are no trucks moving or the need to manually handle heavy objects)

Safety helmets must be worn under the following circumstances:

The decision has been taken that hard hats must be worn by all local and visiting staff during fit up/get in and de-rig/get out when the flying system is in use and or while working below a colleague on access equipment.

High Visibility Jackets

- Any staff required to work on the public highways (pavements/roads) must wear a high visibility jacket. These are available for all resident staff

All staff should visually check PPE for signs of damage before and after each use, any signs of wear and tear/damage must be reported to a full-time member of staff.

It is a breach of health and safety to tamper with or hide any piece of PPE. Anyone found doing so will be subject to disciplinary action.

PPE Equipment Policy

Harnesses

- Must be worn where there is a risk of falling while working at height.

Safety boots must be worn unless you are told otherwise by the CentreStage Technical Department, failure to arrive for work without them will result in you being denied access to work areas.

[Covid 19 guidance for staff & visitors arriving at CentreStage.](#)

Internal visitors (employees):

On arriving at the reception please adhere to the following:

- Wearing a face mask/covering
- Temperature check with digital thermometer - any reading above 38 degrees you will be required to go home, self-isolate & book a COVID-19 test
- Wash hands at hand wash station/use sanitiser provided
- Sign in and record temperature on staff sign in sheet
- Use hand sanitiser and wash hands throughout your shift

External visitors:

On arriving at the reception please adhere to the following:

- Wearing a face mask/ covering
- Temperature check with digital thermometer - any reading above 38 degrees you will be required to go home, self-isolate & book a COVID-19 test
- Wash hands at hand wash station or use sanitiser provided
- Complete a COVID-19 checklist (red folder) – anyone feeling unwell or having met someone testing positive for COVID-19 will be asked to leave the building
- Complete visitor's book with full contact details – for track & trace purposes
- Be encouraged to use hand sanitiser throughout their visit

[Any questions please ask.](#)

[Thanks](#)

Full Plan can be found [HERE](#)

CentreStage

Theatre Lighting Plot
May 2021

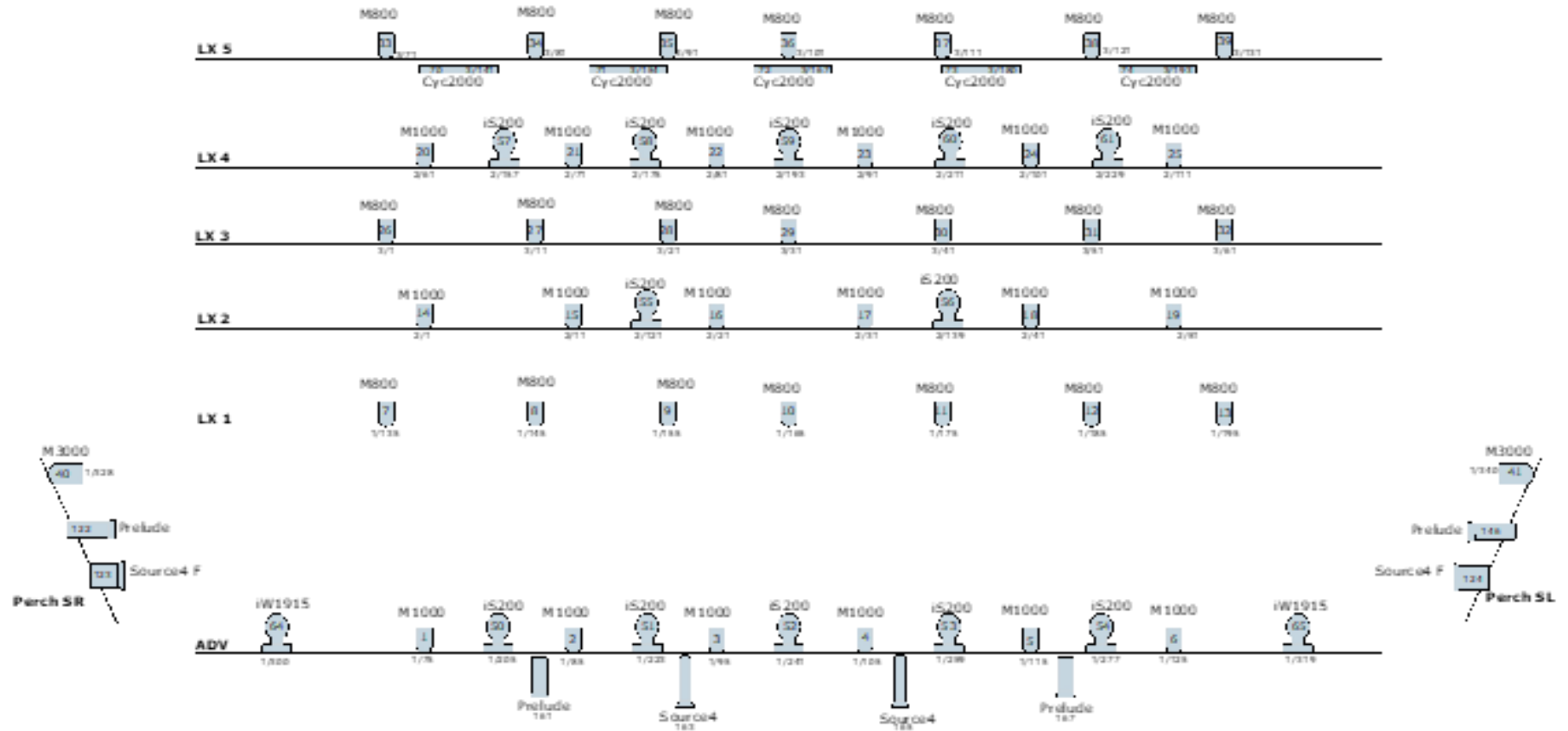

CentreStage

Full Plan Can Be found [HERE](#)

CentreStage
Dimmer/Power Channels
May 2021

71
Stage level

72
Stage level

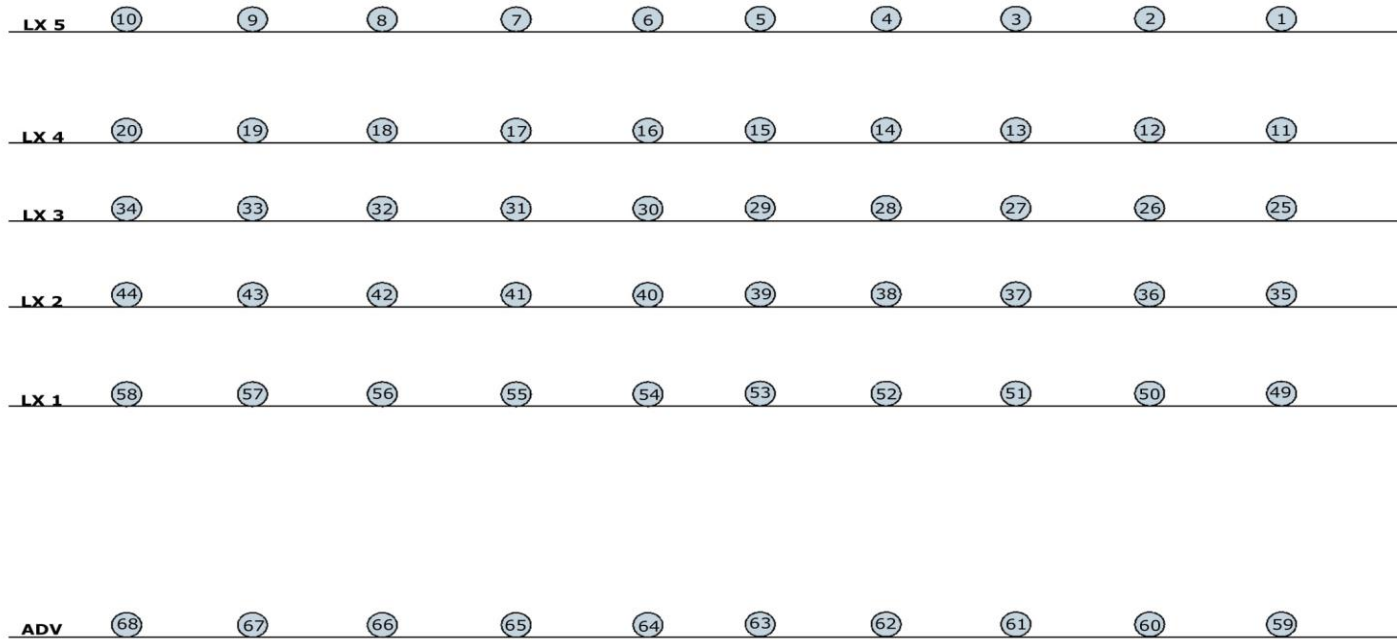

69
Stage level

70
Stage level

47 48
Followspot Positions in
Booth

Orchestra pit Layout

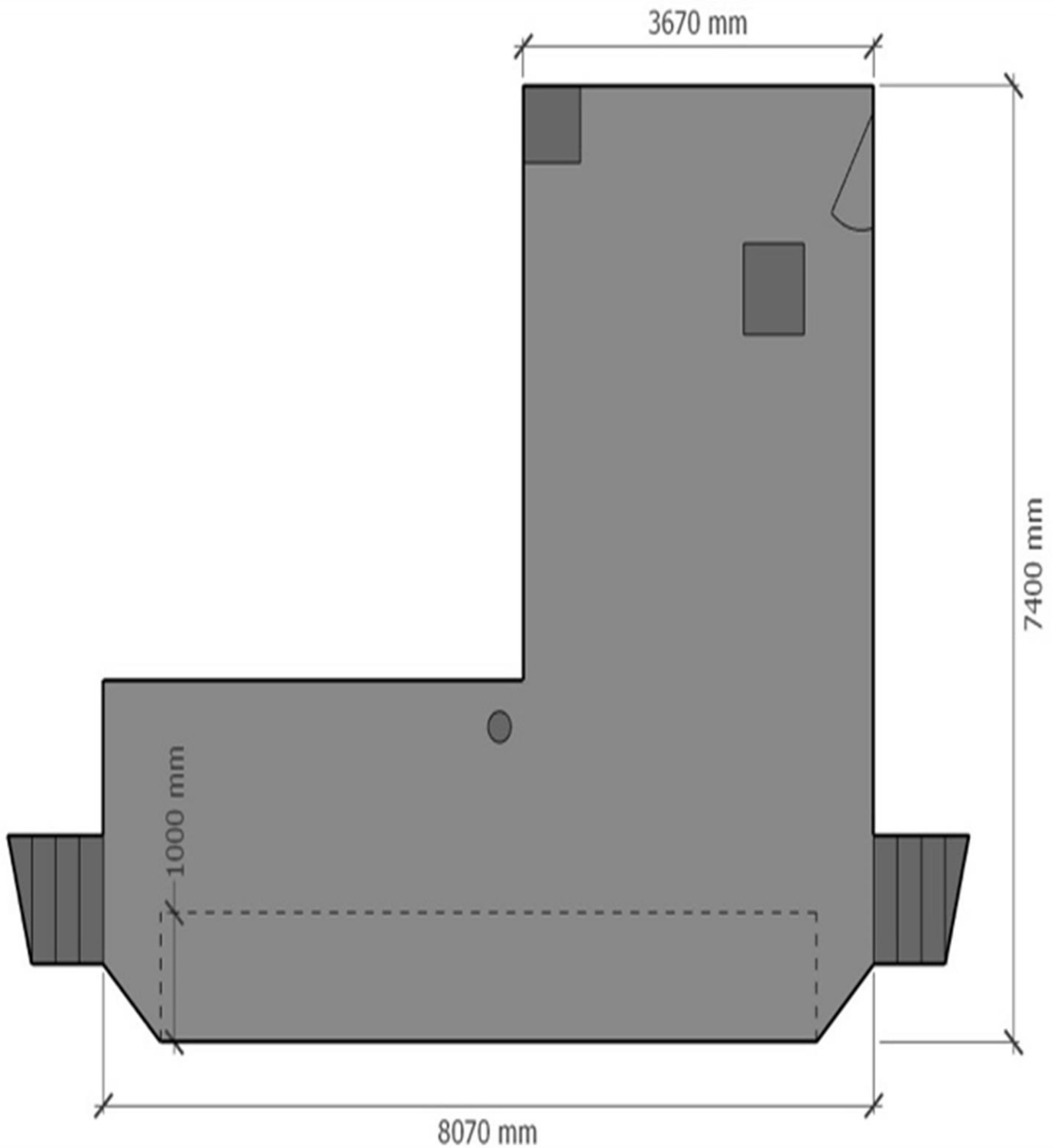

Dotted line indicates 'uncovered' section. The rest is fully under the stage at a height of 2400mm

(Blank) Hanging Plot.



Bar	Flying Piece	Distance From Back of Proc	Weight (KG)	SWL	Notes
All measurements are in mm from the back of the proc					
	Red House Tabs	0.2m			Permanently rigged on Tab Track
M1		1.2m		150	
W1/IWB		1.5m		250	
M2		1.9m		150	
M3		2.2m		150	
W2/IWB		2.43m		250	
W3/IWB		2.91m		250	
M4		3.21m		150	
M5		3.51m		150	
W4/IWB		3.81m		250	
W5/IWB		4.14m		250	
M6		4.51m		150	
M7		5.01m		150	
M8		5.51m		150	
W6/IWB		6.29m		250	
M9		6.49m		150	
M10		6.99m		150	
M11		7.49m		150	

M = Motor/Automated Bar W = Drill driven winched IWB

EXCEL Document can be found [HERE](#)

CentreStage.

Carparks and Load In

-  CentreStage Carpark A
-  CentreStage Service Yard
-  CentreStage Carpark B

