

The Garden Path

Grand Opening Special Edition

April 2017



3 Letter from the CEO
Steve Bloom

4 April - May Event Calendar

5 Member Events
Special

6 The Perfect Project
Letter from Sadafumi Uchiyama

8 A Curator's Wish for the Future
Letter from Diane Durston

10 The Next Chapter, A New Design
Letter from Lisa Christy

12 Introducing the New Garden
Map

14 Experience Umami Café
Menu and Hours

15 Grand Opening Partners & Sponsor Profile
Moonstruck Chocolate

16-19 Cultural Crossing Donors

20-21 Golden Crane Society

22-23 Golden Crane Legacy Society
Global Ambassadors
Tribute Gifts & Annual Fund Donations

Back Cover

Tips for Visiting
Transportation, parking, and more

HAIKU

Moss covered stone
Its image unaltered
in the quiet pool
–Peter Kendall

SENIOR STAFF

CHIEF EXECUTIVE OFFICER Steve Bloom
DEPUTY DIRECTOR Cynthia Johnson Haruyama
THE ARLENE SCHNITZER CURATOR OF CULTURE, ART, AND EDUCATION Diane Durston
GARDEN CURATOR Sadafumi Uchiyama
CHIEF OPERATIONS OFFICER Cheryl Ching
DIRECTOR OF FINANCE Diane Brauer
DIRECTOR OF MARKETING Lisa Christy
CHIEF DEVELOPMENT OFFICER Tom Cirillo
DIRECTOR OF RETAIL Ashley McQuade
EXECUTIVE ASSISTANT Sarah MacDonald

BOARD OF TRUSTEES

PRESIDENT Cathy Rudd
PRESIDENT-ELECT Dorie Vollum
VICE PRESIDENTS Ann Carter, Michael Ellena, Jerry Hudson, Carol L. Otis M.D.
TREASURER Douglas Lovett, CPA
SECRETARY Dede DeJager

MEMBERS

Suzanne Storms Berselli, Jimmy Crumacker, Dean M. Dordevic, Katherine Frandsen, Bruce Guenther, William H. Hughes, Janelle Jimerson, Gail Jubitz, John Kodachi, Michiko Kornhauser, Lindley Morton, Darren Nakata, Travers Hill Polak, Paul Schommer, Drake Snodgrass, Frances von Schlegell, Dr. Calvin "Cal" Tanabe, Susan Winkler, Robert Zagunis

FOUNDATION BOARD

CHAIR Greg Fitz-Gerald
PRESIDENT Steve Bloom
VICE PRESIDENT Carmen Wong
SECRETARY/TREASURER Diane Brauer

MEMBERS

Trish Adams, Dede DeJager, Jerry Hudson, Joshua Husbands, Douglas Lovett, CPA, James D. Lynch, Dee Ross

THE GARDEN PATH

FOR QUESTIONS OR COMMENTS
Email marketing@japanesegarden.org



To our Members and all those who helped make Cultural Crossing a reality:
Welcome and Thank You!

Fifty years ago, who would have thought that the empty cement landscape of the former Zoo would be transformed into a place dedicated to beauty, nature, and learning more about each other? The visionaries who saw the potential are repeated in you, the people who are now helping us take the next step forward.

I travel frequently on behalf of the Garden and it is remarkable to me how the Garden's reputation and work speaks to those around the globe. From Tokyo to London, Montreal to Buenos Aires. From humble ceramic artists to Japan's First Lady. Every time we tell our story, people are inspired by what this organization aims to do.

Looking to the future, we started asking: how can we evolve that story, share it with more people, and tell it better? This was the moment to ask ourselves that question! A strong organization starts with a clear and concise mission, and there is no better time to reinvent ours than now, as we sit at the edge of tomorrow. For these last fifty years, the Garden's mission has essentially been the Garden's purpose. While it has been incredibly effective, it is also long and perhaps ineloquent:

The purpose of the Portland Japanese Garden is to create, maintain, improve, and administer an authentic, world-class Japanese garden in the city of Portland and to offer compatible educational, cultural, artistic, horticultural, environmental, and charitable activities.

The Garden's Board of Trustees and Staff wanted a new mission statement to honor that purpose while reflecting our history, our community, and the role this organization plays in the world. We also wanted it to look forward and reflect our potential in a new, evolving world. I want to share with you something our good friend, Chris Riley, wrote of the Garden:

Born out of a hope that the experience of peace can contribute to a long lasting peace. Born out of a belief in the power of cultural exchange. Born out of a belief in the excellence of craft, evidenced in the garden itself, and the activities that come from it. Born out of a realization that all of these things are made more real and possible if we honor our connection to nature. These ideals and the possibilities of Cultural Crossing are more relevant to us all today than ever before... The Portland Japanese Garden brings people together in one place, demonstrating our fundamental interconnectedness, and sharing the ideals worldwide.

All of these things joined together became the basis of our new mission which I am proud to share with you to here today:

Our mission is to bring the ideals of the Portland Japanese Garden to the world: art of craft, connection of nature, experience of peace.

At this historic moment in Garden history, it is inspiring to have a mission that reaffirms what we do here and why we exist. So again I say welcome to our future members! We are honored to serve you, our community, and we are honored as together we write the next chapter of the Garden's story.

With gratitude,

Steve

April

- 1** Gateway Member Grand Opening
Member-only

- 2** Public Grand Opening

- 2-5/21** Art in the Garden: Hosokawa Morihiro:
The Art of Life, A Rebirth in Clay



Photo: Yoshihiro Saito

- 5** Fifteen Years of Pottery Making:
Hosokawa Morihiro Today
by Dr. Hiroko Nishida
Tickets Required

- 8-9** Exhibition: Saga Goryu Ikebana

- 11** Special Hours: Photography Members
Photography Members Only

- 14** Cultural Demonstration: Koto Harp

- 22-23** Exhibition: Portland Bonsai

- 22** Member Tea and Tour:
Hosokawa Exhibition
Member-only

- 28** Cultural Demonstration: Koto Harp

- 29-30** Exhibition: Ohara Ikebana

*All events were accurate at press time;
please check japanesegarden.org/events
for up-to-date information.*

May

- 6** Cultural Demonstration: Koto Harp

- 7** Cultural Festival: Children's Day

- 8** Annual Meeting of the Membership
Member-only

- 11** Special Hours: Photography Members
Photography Members Only

- 18** Member Tea and Tour:
Hosokawa Exhibition
Member-only

- 19** Special Hours: Member Evening Hours
Member-only

- 27** Cultural Demonstration: Koto Harp

- 27** Cultural Demonstration:
Calligraphy, by Yoshiyasu Fuji



- 27-28** Exhibition: Meito-kai / Fujii Calligraphy

Recurring Cultural Demonstrations

Tea Ceremony Presentation
Every Wednesday from 5:00-6:00pm

Tea Ceremony Presentation
Every Saturday from 1:00-2:00pm

Ikebana (flower arranging)
Every Sunday from 1:00-2:00pm



Photo: Nina Johnson



Photo: Jonathan Ley



Photo: Jonathan Ley

Photographer Member Special Hours

April 11, 2017

6:30 - 8:00 am

Portland Japanese Garden

Photo Members and their Guests Only

Photographer Members and their guests are given special early-morning access to the Garden. Capture familiar landscapes at their most serene: illuminated in quiet solitude by dawn's first light.

2017 Photographer Member Special Hours:

May 11, 6:30 - 8:00 am

June 11, 7:00 - 9:00 pm

July 11, 7:00 - 9:00 pm

August 11, 7:00 - 9:00 pm

September 11, 6:30 - 8:00 am

October 11, 6:30 - 8:00 am

Evening Hours for Members

April 21, 2017

7:00 - 9:00 pm

Portland Japanese Garden

Members and their Guests Only

On special evenings, we offer extended hours for our Members and their guests.

Upcoming Evening Hours for Members:

May 19, 7:00 - 9:00 pm

June 12, 7:00 - 9:00 pm

June 16, 7:00 - 9:00 pm

Member Tea & Exhibition Tour

April 22, 2017

8:00 - 10:00 am

May 18, 2017

7:00 - 9:00 pm

Garden Grounds, Pavillion, and Village
Members and their Guests Only

No reservations required.

During this special Member-Only Hours, join us for complimentary tea, Garden tours, and scheduled tours of the current *Art in the Garden* exhibition, *Hosokawa Morihiro: The Art of Life, A Rebirth in Clay* (April 2- May 21, 2017).

In honor of the Grand Opening of our new Cultural Village, the first exhibition of 2017 is a celebration of tea culture in the art and life of Hosokawa Morihiro, a former Prime Minister of Japan. After a formal apprenticeship as a potter, this accomplished artist, calligrapher, and poet, expresses a love of simplicity and originality in his work and in his life. The Portland Japanese Garden is honored to host former Prime Minister Hosokawa's solo exhibition in the US.

Supporting and Sponsor Members

Look for exciting changes to our upper levels of membership with your renewal. Our new upper membership levels, Patron and Steward, will be customizable, have monthly payment options, and new benefits.

Questions?

membership@japanesegarden.org

The Perfect Project

SADAFUMI UCHIYAMA

Dear Members,

As we celebrate this grand opening, we are commemorating the biggest gift we have received. That gift is intangible yet priceless: throughout the entirety of this project, there has been someone there to support us. When I think about the scope of the project, it really has been about the people who have put their heart and souls into it. Throughout this process, I have drawn on relationships that I have forged for more than 20 years. Every friend, every contractor has told me they felt like this is the project. The one we have all been waiting to do together. It really is the perfect project.

When I came to the Garden nearly ten years ago, Steve Bloom and Diane Durston were already discussing expansion plans. I quickly realized the magnitude and how a design like this happens once every one hundred years if not longer. To start talking about this ten years ago and then to get this far is incredible. I don't think we will ever do something like this again.

Probably the hardest part of this project has been practicing moderation, to recognize the emotional and physical investment and how quickly we move. It has been an exciting project and I have struggled to keep myself calm and not get too excited. Moderation is the toughest thing to do. This is common among most designers: the single most difficult thing is to moderate your actions and thinking. I liken it to being a painter. You just keep painting and then before you know it, you are painting without purpose and you are past the threshold of where it looks good. Knowing when to stop is key.

We want the Garden to remain a tranquil, gentle, natural gathering place. My hope is that when you enter the Garden and see the expansion, you will find it to be the same. It is now a little bigger, yes, and updated, but in essence, I hope you will have the same experience as before. It is important that we remain who we are. That is why we were able to do this expansion. It is not meant to change anything, but to help us all grow.

With gratitude,



Sadafumi Uchiyama,
Garden Curator

These are actual notes and reminders Uchiyama wrote every morning for the last three years throughout the project.

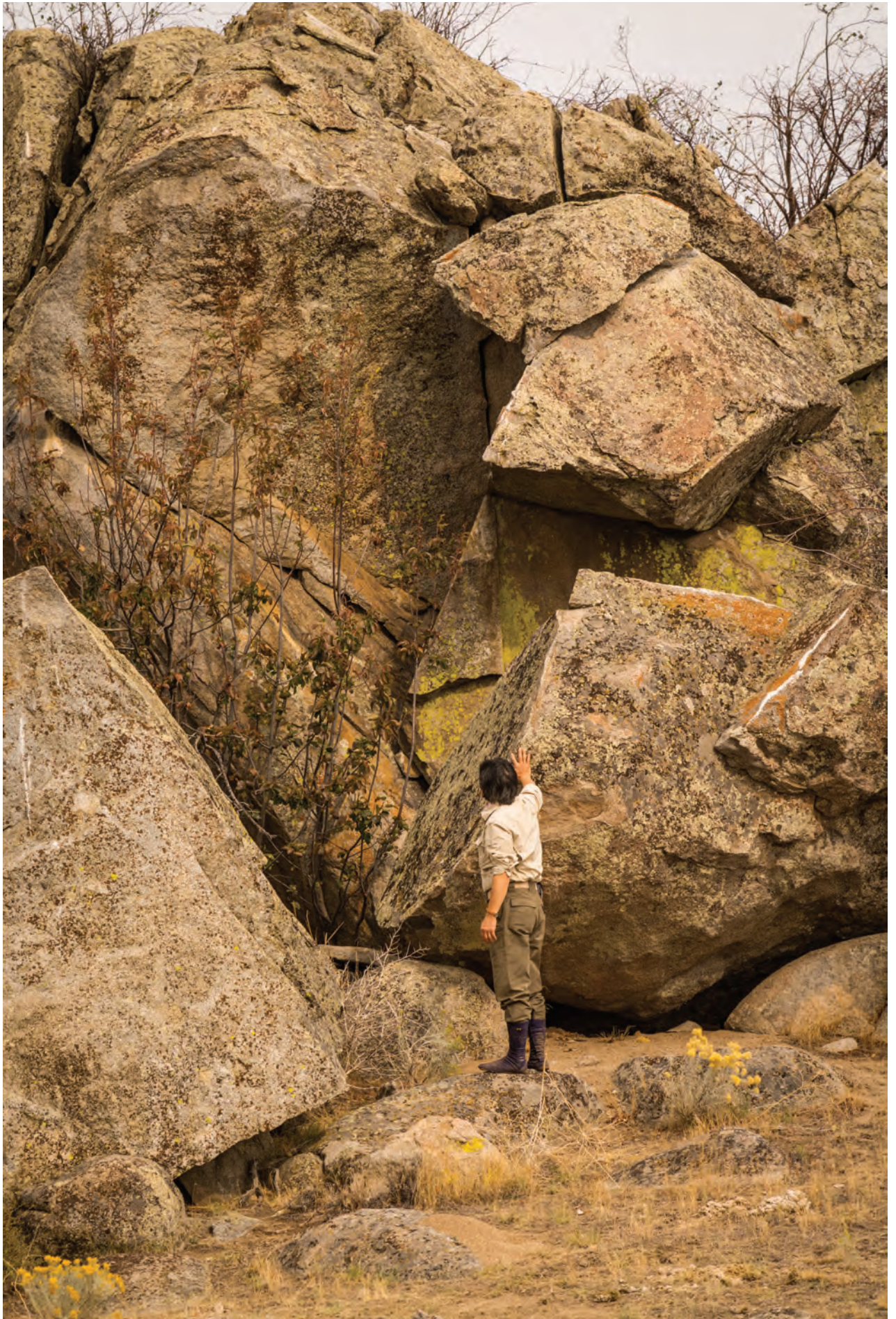

Photo: Bruce Forster

A Curator's Wish for the Future

D I A N E D U R S T O N

Dear Members,

For many, a stroll through the Portland Japanese Garden is the closest they will come to experiencing Japan. The Garden is a living “classroom,” the lessons of which are many—not only about how trees grow and moss forms on stone, but about the elegant beauty of the curved line of a branch and the lives and culture of those who designed and nurtured this art form.

The Garden grows and dies and is re-born, telling us life is short and must be appreciated in the moment – a message eloquently expressed in Japanese poetry throughout history. This work of art was planned by Tokyo Professor Takuma Tono to be a bridge between cultures. Its multiple styles represent not just a survey of the history of Japanese garden design but also a window to the aesthetics, culture, history, and spirit of Japan itself.

With the Cultural Village, our Garden includes traditional and contemporary design elements, incorporating the trees and topography of its Pacific Northwest location while pointing to the future with new design elements based on traditional Japanese concepts. Our educational programs reflect this diversity, providing grounds for fostering international understanding, bridging East and West, connecting tradition and modernity and expanding our awareness of the world.

From the moment I entered its gates, the Garden took me back to Kyoto, my home for 18 years, whose gardens I knew and loved. The Learning Center brings my life full circle. With the new classroom, gallery, and cultural corner come opportunities to work with partners in the community and in Japan who practice its living arts—tea, ikebana, calligraphy, music, and bonsai. The efforts of those dedicated people have kept our Garden vibrant for more than 50 years. At this defining moment in the Garden's history, I see daily the eyes of visitors from all over the world opening to new ideas — just as my eyes opened more than 30 years ago. My gratitude to those whose vision and support brought this dream to life.

With Gratitude,

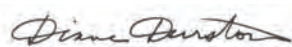

Diane Durston,
Arlene Schnitzer Curator of Culture, Art, and Education



Photo: Jonathan Ley

The Next Chapter, A New Design

L I S A C H R I S T Y

Dear Members,

Welcome to the next chapter of the Portland Japanese Garden! To complement these beautiful new buildings, gardens, and exciting new programming, it is only fitting that at this historic moment, we update the Garden's branding.

Like the Garden itself, this new look was crafted with purpose and intention. Working with a talented group of marketing and branding professionals, we went through a rigorous process of discovery and reflection to articulate the essence of this organization. We want to honor Japanese culture and aesthetics, while evoking feelings of being in and involved with the Garden itself.

We're incorporating more white space in all our materials with pops of color inspired by the hues of Japan: indigo, matcha green, and bright vermillion. You'll see updated fonts that blend the modernity of current Japanese design with the classic elegance of the Garden. Above all, our goal is to keep things simple and highlight the real star: the Portland Japanese Garden.

WHAT'S CHANGING?

We're excited to call your attention to two of the biggest updates:

The new japanesegarden.org

Shifting our website from japanesegarden.com to japanesegarden.org reflects what we have always been: a nonprofit organization. Don't worry: If you type in the old address, it will redirect you to the right place.

Next, we want this new site to have easier paths to find information and more photographs to showcase the beauty of the Garden. We also added a "Membership" button at the top of all pages. There, you can quickly find all the information that is relevant just for you.

Last, we'll be publishing all the content from *The Garden Path* plus much more at japanesegarden.org/TheGardenPath. Here we'll share the stories and events of the Garden every week. Many of you have commented that you would like to know about events earlier. So

this "e-magazine" will be complemented with email reminders and updates. In this way we can reduce how often the newsletter is printed, saving resources while giving you timelier, more substantive stories with more photos and even videos! Contact membership@japanesegarden.org to make sure we have your email address.

***The Garden Path* Grows**

With content published more frequently online, *The Garden Path* will be printed and mailed every other month. This change in timing allows us to create a newsletter that looks and reads more like a magazine. Over the last two years, *The Garden Path* has nearly doubled in size. The next natural step was to update its look. With a larger format, *The Garden Path* can now give each story more room using an easier to read layout and bigger photographs.

We want these redesigns to honor this important moment for the Garden. The new look should communicate that there's something new happening while staying true to the essence of what this organization is. That's what we've tried to do and we truly hope members like the new look!

On behalf of the Marketing Department, we would like to thank Dede DeJager, Trish Adams, Ann Carter, Katherine Frandsen, James Lynch, Katherine Melchior-Ray, Chris Riley, and Steve Bloom for your input, advice, help, and time in assisting with this task.



Lisa Christy,
Director of Marketing and Communications



EXPERIENCE THE GARDEN

VISIT

EVENTS

NEWS & PHOTOS

EDUCATION & COMMUNITY

ABOUT



BUY TICKETS MEMBERSHIP DONATE 日本語 中文



TUESDAY'S WINTER HOURS

10am - 4pm

MEMBER HOURS: 8AM - 10AM

Last admission one hour before Garden closure

[VIEW ALL HOURS & TICKET PRICES](#)

EVENT

Grand Opening for Gateway Members

April 1, 2017 / Garden Hours



EVENT

Photographer Member Special Hours

March 11, 2017 / 9:30am - 8:00pm



EVENT

Evening Hours for Members

April 21, 2017 / 7:00pm - 9:00pm



NEWS

The Cultural Crossing: April 2 is Your Day



Get unlimited access to the Garden with an annual membership.

Become a Member.

THE PORTLAND JAPANESE GARDEN ON INSTAGRAM



Artist rendering of new website

An aerial illustration of a Japanese garden design. The garden is set on a hillside overlooking a body of water. It features a network of white paths, lush green trees, and several traditional Japanese buildings with blue roofs. A large, curved path winds through the garden, leading to a building with a grey roof and a blue pool. The overall style is artistic and detailed, showing the layout of the garden and its integration with the natural environment.

Introducing

THE NEW PORTLAND JAPANESE GARDEN

ILLUSTRATION BY: JÉRÔME MIREAULT, COLAGENE.COM



Experience the Umami Café

Come engage all five senses while finding the spirit of Japanese culture.

The Umami Café provides a place for you to relax and refresh while at the Garden. Here, you will experience the pairing of world class Japanese tea with traditional gracious, attentive service, and delicious edible delights.

Café Hours

Open during regular Garden hours and Member hours

Please note

Last seating is 30 minutes before the Garden closes

With a design reminiscent of Kyoto's Kiyomizu-dera Temple, the Umami Café floats over the hillside and provides views of the area's natural beauty.

Tea is provided by the Tokyo-based Jugetsudo tea company, while light snacks come from our partnership with Japanese food company, Ajinomoto as well as several local Japanese confectionaries.

Our Teas



Matcha
Powdered green tea

Matcha has been the highlight of Japanese tea ceremonies for centuries. Shade grown leaves are harvested, dried, and ground into a fine powder, giving it a bright jade color and a savory, grassy flavor.



Organic Sencha
Classic green tea

Sencha has a light, mildly sweet flavor and a fragrance of young spring leaves. It is by far the most popular tea in Japan.



Organic Genmaicha
Green tea with roasted brown rice

Our Genmaicha is made with Sencha, roasted rice, and a hint of Matcha, giving it a nutty, earthy flavor and aroma. This is a great choice for those new to tea drinking.



Organic Hojicha
Roasted green tea

Roasting at high temperatures provides Hojicha with an aromatic sweetness. It is lower in caffeine and tannins than other green teas, making it gentle on the stomach.

Moonstruck Chocolates

Julian Rose,
Master Chocolatier



Moonstruck Chocolate is no stranger to the Portland Japanese Garden. In fact, CEO Steve Bloom says, “it’s my number one *omiyage* when I travel to Japan,” referring to the much-beloved Japanese tradition of giving gifts connected to one’s home. And the Garden is no stranger to Moonstruck. As Moonstruck’s Master Chocolatier Julian Rose puts it, “the Portland Japanese Garden has personally been a constant source of inspiration for many years.”

Julian also happens to be an old friend of the Garden’s Chief Development Officer, Tom Cirillo, who suggested a partnership. Julian recalls, “when the opportunity of creating a special collection of Japanese inspired truffles came along, I was ecstatic.” Moonstruck has a long history of supporting the non-profit community, and the entire company was quickly on board, offering not only Julian’s talents and donated chocolates, but a generous cash sponsorship of our Grand Opening Year.

Anyone familiar with Moonstruck’s Oregon Craft Brewers and Oregon Distillers collections knows that Julian can make the seemingly impossible happen in chocolate ganache. For this project, Tom introduced Julian to longtime Garden supporter Chef Naoko for creative consultation. After sampling over a dozen unique Japanese flavors from Naoko’s pantry of organic ingredients, Julian set to work in his laboratory kitchen. “From the shape and flavor, to every stroke of decoration, these truffles were conceived with intention and balance.” Julian goes on to say, “these chocolates are probably my favorite creations in years!”

Moonstruck’s Portland Japanese Garden Collection will be on sale at the Garden Gift Shop for a limited time and features three sophisticated bonbons: Sakura Cherry Blossom, Roasted Black Sesame, and Matcha Green Tea. The Garden is deeply grateful to Julian for the passion he put into this collaboration and to Moonstruck Chocolate Co. for their partnership and donation of all the *omiyage* we will give to the Garden’s special guests from Japan and around the world during our Grand Opening year.

The Portland Japanese Garden Thanks its Grand Opening Year Partners

PLATINUM



GOLD



SILVER



BRONZE



The Campaign for a Cultural Crossing

Contributions received
through February 16, 2017

The Cultural Crossing project will enable the Garden to extend its legacy and purpose—providing a heightened sense of beauty and tranquility and more educational opportunities while preserving significant cultural traditions and art forms. Construction of the Cultural Crossing project has nearly completed. To finish funding these beautiful and much-needed new facilities, we are asking for your help in making this dream project a reality. As our most loyal and generous members, your participation is vital. We hope you will join us. Every gift makes a difference!

\$5,000,000 AND ABOVE

Arlene Schnitzer in honor of Jordan D. Schnitzer's 20-year service to the Portland Japanese Garden

\$2,000,000 TO \$4,999,999

Drs. Calvin & Mayho Tanabe Travers Hill Polak and Family in memory of Ellie Murrah & Walter Clay Hill

\$1,000,000 TO \$1,999,999

Anonymous
Ajinomoto Group
Yoko Fukuta
Prudence Miller in memory of Jane Stimson Miller
State of Oregon Lottery Bonds
The Harold & Arlene Schnitzer CARE Foundation
Tadashi and Teruyo Yanai
Robert & Deborah Zagunas

\$750,000 TO \$999,999

The Collins Foundation
Frederick D. & Gail Y. Jubitz Foundation
Ross M. Lienhart, Edward Lienhart Family Foundation in memory of Sheila Edwards Lienhart
M.J. Murdock Charitable Trust

\$500,000 TO \$749,999

Atsuhiko & Ina Goodwin Tateuchi Foundation
Robert W. Franz
Dorothy Lemelson
National Endowment for the Humanities
Dorothy Piacentini in memory of Dr. Franklin Piacentini
Cathy & Jim Rudd
Dorie & Larry Vollum

\$100,000 TO \$499,999

Ray & Jean Auel
Melissa & Stephen Babson
Anne & James F. Crumpacker Family
Wayne & Julie Drinkward
Fred W. Fields Fund of The Oregon Community Foundation
Hacker Architects
Hoffman Construction Co.
Kengo Kuma & Associates
Yoshio & Nikki Kurosaki, Kurosaki Family Fund of the Oregon Jewish Community Foundation
Lani McGregor & Daniel Schwoerer
Marilyn Mclver
Janet & Tom Montag
Wayne M. Quimby & Michael Roberts Quimby
Frances & John von Schlegell
Storms Family Foundation
Walker Macy
Nani Warren
Capt. David G. & Carolyn Berry Wilson

\$75,000 TO \$99,999

Maybelle Clark
Macdonald Fund
Mildred & Morris Schnitzer Charitable Fund of The Oregon Community Foundation
PGE Foundation
Spirit Mountain Community Fund

\$50,000 TO \$74,999

Anonymous
Suzanne Storms Berselli
Gwyneth Gamble Booth
City of Portland, Portland Parks & Recreation
Alan S. Davis
Margueritte H. Drake
Marilyn Easley in memory of David Easley
William Emery
William G. Gilmore Foundation
Geoffrey Hoefer
Jerry & Ann Hudson
Hoichi Kurisu
Ritz Family Foundation
Kelly Saito
Catherine & Taisuke Sasanuma



Rendering: Kengo Kuma & Associates

\$20,000 TO \$49,999

Anonymous (2)
 Dean & Susan Alterman
 Thomas P. Anderson &
 Jack B. Blumberg
 Mary Bishop
 City of Portland,
 Office of International Affairs
 Daiwa Lease
 Dede & Joe DeJager
 de Weese Family Fund of The Oregon
 Community Fund Foundation
 Mary & Blaine Dickson
 Drake's 7 Dees Landscaping
 Katherine & Mark Frandsen
 Ronna & Eric Hoffman Fund of The
 Oregon Community Foundation
 The Japan Foundation,
 Center for Global Partnership
 Komatsu Seiren Co., Ltd.
 J. Douglas Macy
 Oregon Cultural Trust
 PAE Engineers
 Dori Schnitzer in memory of
 Mildred & Morris Schnitzer
 Jeanne Schnitzer Marks in memory
 of Mildred & Morris Schnitzer
 Susan Dee Schnitzer in memory of
 Mildred & Morris Schnitzer
 Urban Resources, Inc.
 Vanguard Charitable - Wayne & Sandra
 Ericksen Charitable Fund
 Don & Marian Vollum
 Susan & Jim Winkler & Family

\$10,000 TO \$19,999

Anonymous
 Peter & Missy Bechen
 Chita Becker
 Stephen Bloom & Michael Blankenship
 Mora Chartrand & Linda Grant
 Worth & Barbara Caldwell
 Sandra Chandler & Chris Schaefer
 Delta Airlines
 The Dunagan Foundation, Inc.
 Caroline Fenn & Marc Bohn
 Bill Findlay

Doyle Forister & Gary Sheldon
 Sean C. Gay
 Green Building Services
 Bruce Guenther &
 Eduardo A. Vides, M.D.
 Beth & Jerry Hulsman
 Judy & Hank Hummelt
 Salena Johnson
 KPFF Consulting Engineers
 Amy S. Katoh
 Peter J. Kendall
 Elizabeth M. King
 Komatsu Seiren Co., Ltd.
 Mimasu Shoji -
 Toshiaki Kuno & Lisa Nakamichi
 Doug & Theresa Lovett
 Luma: Lighting Design
 Dinah & Bob McCall
 Ed McVicker & Gertrude Bernstein
 Glenn & Widney Moore
 NPO Greenwave
 Tom & Chris Neilsen
 Shirley & David Pollock
 Rod & Cheryl "Charlie" Rogers in
 memory of Lorna Markwart
 Forrest & B.J. Simmons
 Don & Jan Stastny
 Stoel Rives
 Mary & James G. Wallach Foundation
 Carmen Wong

\$5,000 TO \$9,999

Anonymous
 Ajinomoto North America, Inc.
 Anderson Krygier, Inc.
 The Bookin Group, LLC
 Bruce & Cindy Brenn
 James & Diane Burke
 Dr. John R. & Susan Campbell
 Ann C. Carter & Thomas P. Palmer
 Columbia Bank & West Coast Trust
 Alexander de Weese
 Douglas H. de Weese
 Michael & Janet Ellena
 Geotechnical Resources, Inc.
 Jeanne Giordano & Bob Frasca
 Greenline Fine Woodworking
 John Hall & Margaret Chula

Dr. Tsutomu Hattori
 Margaret & Roger Hinshaw
 Joshua & Kerstin Husbands
 Listen Acoustics, Inc.
 Bruce & Jeanette Morrison
 Verne & Aki Naito
 Carol L. Otis MD & Roger Goldingay
 David Pollock in honor of
 Martha & Anthony Belluschi &
 Gwyneth Gamble Booth
 PosterGarden
 Al Solheim & Mary Hanlon
 Bonnie Pomeroy Stern
 Rena & Cheryl Tonkin
 Torii Mor Winery & Vineyard
 Mr. & Mrs. Richard Ward
 Suwako Watanabe

\$2,500 TO \$4,999

Anonymous
 Acorn Fund of The Oregon
 Community Foundation
 Carole Alexander
 Terry Dalsemer & Gail Owen
 Carol Edelman
 Andrew & Cynthia Haruyama
 Joan & Fred Horstkotte
 William A. Hughes &
 Nancy L. Richmond
 Joto Sake LLC
 Rev. Zuigaku & Keiko Kodachi
 Joseph Krakora
 Masa & Associates, Inc.
 Mako Hayashi-Mayfield &
 Stan F. Mayfield
 Sandy & Greg Mico
 Yoshiaki Nakamura
 Miller Nash
 Omomuki Foundation
 Marilyn Ross Podemski
 Laurie & William Rawson
 John & Susan Turner

\$1,000 TO \$2,499

Anonymous (4)
 Architecture Foundation of Oregon
 in honor of Arlene Schnitzer &
 Jordan Schnitzer
 Anthony & Martha Belluschi
 Randy & Kim Boehm
 Nell & Robert Bonaparte
 Nancy & Paul Bragdon
 Kay Bristow
 Susan C. Brown
 Citi Lites Builders Inc.
 Patsy Crayton Berner
 Cathy Cheney
 Thomas Cirillo
 William Cook & Gwil Evans
 Diane Durston & Stephen Futscher
 Greg & Susan Fitz-Gerald
 Gemma Furno
 Dale & Iris Garell
 Geffen Mesher
 Tom & Susan Hamman
 Katherine A. & William J. Hawkins
 Kihachiro Nishiura & Tomoe Horibuchi
 ICTSI Oregon, Inc.
 The Jackson Foundation
 Lois B. Jackson
 William David & Mary Jones
 Allan Karsk & Keith Berglund
 Tracy Keys & Chris Keys
 Catherine & John Knox
 John A Kodachi, PC
 Mr. & Mrs. Joe Labadie
 Tina Lamb
 Gilbert & Miriam Lissy
 Joyce & Stanley Loeb
 Julia Mark
 Judy & Mike McCuddy
 Sarah & Andrew Meigs
 Mrs. Jane Moriyasu
 Corrine Oishi & Lindley Morton
 William & Janet Perry
 Helen E. Ramatowski
 P. Redman
 Robert Ridgley
 Marilyn L. Rudin, MD &
 Richard Testut Jr.
 Luwayne Sammons
 Larry & Barbara Sanders

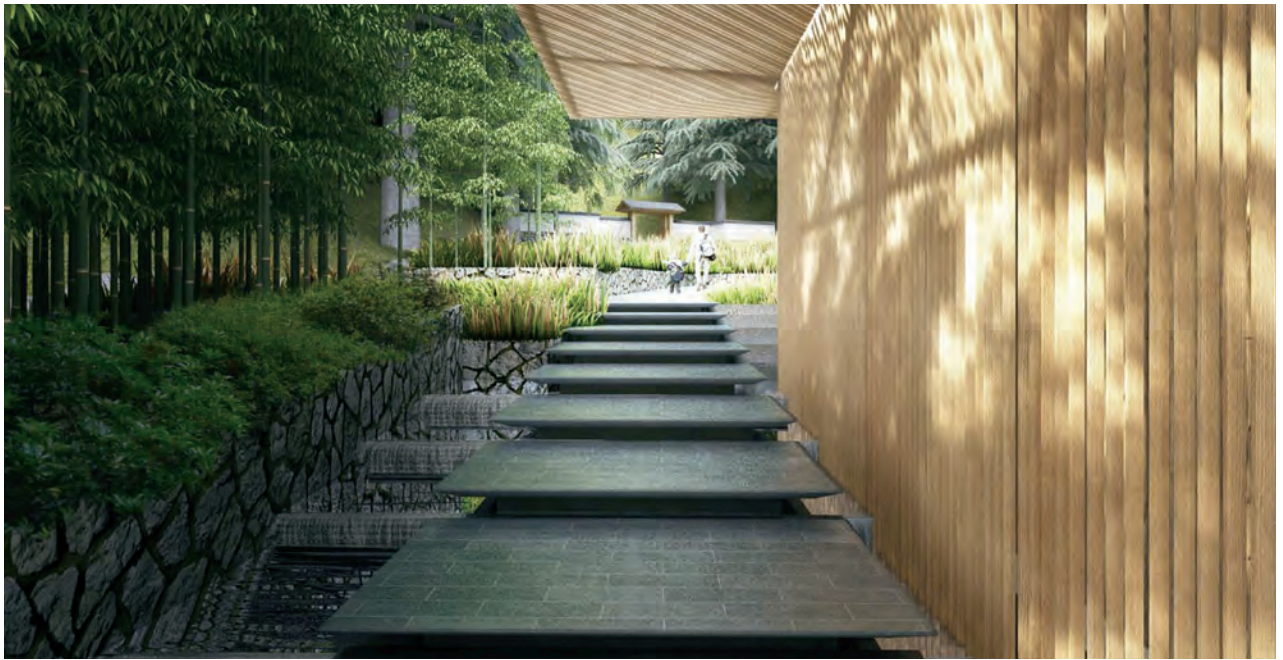

Rendering: Kengo Kuma & Associates

Patricia O. Schleuning
 Peter Shinbach
 Beth Skoll
 Steven H. Smith & Dennis C. Johnson
 Thomas & Frances Stein
 Charles J. & Caroline Swindells
 Charitable Fund of the Oregon
 Community Foundation
 David & Christine Vernier
 Maureen & Frederick Wearn
 Richard Williams & Diane Field
 Ben & Elaine Whiteley
 Randy Zmrhal

UNDER \$1,000

Anonymous (30)
 Stephen Achimore
 Charles L. Adams
 Ad-Mail, Inc.
 Bruce & Carolyn Alter
 Paula Amato
 Anchor QEA, LLC
 Charles C. Anderson
 Susan & Bill Anderson
 Garnet Ascher
 Sally Ashley
 Jonathan A. Ater
 David & Jennifer Austin
 Sandy Axel
 Kathleen Azevedo
 Irene Bachhuber
 Martha Bailey
 Joseph Bain
 Bain Insurance Agency
 Elizabeth & Michael Bamberger
 Alan & Julieann Barker
 Elizabeth Barker
 Ann Barkley
 Carol & Donald Barnes
 Linda H. Barnwell
 Anne Batey
 Alan Baucom
 Nancy J. Bean
 Judy Beaston
 Karen Bettin
 Elizabeth Berard
 Pamela Berg
 Bruce Berkoff & Irene Calder
 Rene & Michael Berndt
 Chris Bidleman
 Melanie Billings-Yun

Jim & Sue Bisio
 David Bjorge
 Mayno Blanding
 Barbara Bloomfield
 Marilou Bohmann
 Matthew & Wendy Bonfield
 Dr. Aimee Bonneval
 Craig Boretz & Rachelle Jacover
 Lois Bosland
 Diana Boss
 Judy Bradley & Dave Mitchell
 Art Brandenburg
 Daniel C. Brandt & Fatima Ono
 Michael Brent
 Evona Brim
 Mr. Brad Bringgold & Roxy Suzuki
 Winslow & Joyce Brooks
 Dennis Brophy & Cathy Gwinn
 Frederick & Leila S. Brown
 Darrell & Marilyn Brownawell
 Michele Browne
 Richard Browning
 Leilanie Bruce
 Steven Bruckner
 Marianne Buchwalter
 Sharon Buck & James Buck
 Mary Jo Buckingham, Ph.D &
 Paul D. Fitzpatrick
 Patricia Buckley
 Nancy J. Burch
 Barbara Burkart
 Robert Byrne
 Carla Caesar & Nora King
 Caron C. Campbell
 Sue Cannard
 Lillian & Philip Carbone
 Cecile L. Carpenter
 Eloise Carson
 Anne & Terry Carter, MD
 Evelyn Carter
 George Caspar & Mary Hanigan
 Frank Castle
 Carolyn Chaliff & David Mallison
 Christine Chapman
 Cynthia Chilton
 Stephen Chipps & Laura Sherrill
 Anne Churchill
 Heather & Bill Clydesdale
 John & Kathryn Cochran
 Susan Colburn
 Community Foundation
 for Southwest Washington
 Bryan Concannon & Debi Derriko

Judy & David Conley
 Krista Connerly & Jonathan Gordon
 Susan & Mark Cook
 Thomas & Sherry D. Cook
 C A Cooke
 Judy Cooke
 Toni E. Cooper
 Joseph Cortright & Laurel Dukehart
 Claudia Coughlin
 James Cox & Brenda Nuckton
 Mr. & Mrs. Jed Cronin
 Mary Felice Crowe
 Sheila C. Cullen
 George Cummings
 Stephen F. Dale & Lillian M. Li
 Herbert Danielsen &
 Anita Freyman-Danielsen
 Melanie & Will Dann
 Arthur & Winnifred Danner
 Laura Davidson
 Joni & Bob Davis
 Robert & Nancy Dawson
 Dennis Deming & Corky Cortright
 John D. Dennis
 Dr. Ted & Marilyn Depew
 Joann M. Derie
 Alan & Marcia Director
 Lauren M. Dixon
 Leslie & Leigh Dolin
 Jeff & Lynn Dorr
 Vicki Dotson
 Steve Dotterer & Kevin Kraus
 Nathan C. Douthit
 Sharon Dowsett
 Kristen A. Dozono
 Cornelia Jane Drevescraft
 David & Corinne Dumas
 Gail Durham & E Benno Philippson
 Bart Eberwein
 Virginia Ehelebe & David Missert
 Electronic Arts Outreach
 Linda & Stephen Emerson
 Arthur & Charlene Emlen
 Patricia A. Engelbretson
 Kathie E. England
 Kathryn & Mark Everts
 Marc Eyraud & Shelley Smith
 Andrew L. Fall
 Timothy Fang
 Linda Farris & Paul Wilson
 Rebecca Farris
 James & Diana Faville
 Jeffrey Feiffer & John Briggs

Bob & Debbie Fellman
 Linda Fenton
 Wendy W. Fish
 Kenneth K. Fisher & Elizabeth Gilliam
 David Fiske & Valerie Lau
 Jane Fouts
 Roy & Kimberly Fox
 Carol Frankel
 Olga Fredrikson
 Peter Freedman & Lynda Ater
 Jon E. Frew
 Ruth Friedel
 Deborah Friedman
 Takashi Fuji
 Hui Ning Fung & Fabrice Paillet
 Froelick Gallery
 Mr. Steve Gallon & Linda Gallon
 Steve & Peggy Garber
 Bruce W. Garnsey Jr.
 Joyce Gee
 Ed & Lynn Geis
 Margaret & Susan Genné
 Kathy & James Gentry
 Terry & Florence Gerlach
 Kate & Carl Giavanti
 Susan Giese
 Rusti & Bill Gilmore
 Sha Gleason
 James Glogowski
 Marielle Gomez-Kaifer
 Robert & Melissa E. Good
 Don & MJ Gordon
 Eric & Susan Graf
 Peter & Mim Gray
 Yoko & Jonathan Greeney
 William Greer
 Lorraine Guthrie & Erik Kiaer
 Al Haas
 Leah Haas
 Dr. Paul W. Hagen
 Chris Hagerman & Molly Rogers
 Nancy D. Haigwood
 Peter & V. Haldeman
 Mrs. Stephen Halsey
 Jon & Suzanne Hanifin
 Lynne & Gary Hartshorn
 Mr. & Mrs. John Hartup
 Jette K. Haslett
 Judith L. Hatton
 Jared Hayes, Sarah Mace,
 & Supattra Namnon
 Marcelle Heath & Mark Berrettini
 Susan M. Hedges

Andrea & Ted Heid
 Janet Heineck
 Sandra L. Helton
 Calvin Hennig
 Kae Hensey
 Kenneth Herrick
 Marsh Hieronimus
 Shinji & Yuki Hioki
 Cathy & Steve Hoff
 William Hogsett
 Claire & Peter Holland
 David & Maryanne Holman
 Robert & Karen Holman
 Jo Won & Joseph Homann
 Albert Horn & Nancy Goodwin
 Susan & Ken Hornung
 Elizabeth P. Hudson
 William J. Huebner & Janice E. Quivey
 Gail Huggett
 Mary Hurst
 Hilary Hutchinson
 Georgene Inaba
 Kathleen Jaffe
 Michael H. James & Brian Ruder
 Debra Jackson
 Allan & Pam Jacobson
 Sherrie James
 Ronald & Roberta Janssen
 Gloria Jane Jarrett & David C
 McCarthy
 Charles E. Jenkins & James Dixon
 Donald Jenkins
 Winsor & Dee Dee Jenkins
 Linda Jensen
 Jesse W. Jimerson
 Phillip & Steve Jetter
 Nancy Johns
 Mr. Bradford Johnston
 Liz Johnston
 Steven Joiner
 Alice Jones
 Isaac Jones
 Jeffrey C Jones & Donna Wax
 Soren Jorgensen
 Kathleen Kahle
 Steven C. Kallio & Katherine A. Kallio
 Marianne Kandel
 Leatrice Kaplan
 Kristine & George Karnezis
 Aphra & Richard Katzev
 Stephanie Kaza & Davis Te Selle
 Steven Kazmierczak
 Erin C. Kelley-Scott
 Douglas J. Kelso
 Nancy G. Kennaway
 Al & Judy Kenning
 Tracy Keys & Chris Keys
 Claudia Kimball
 Ichiro I. Kimijima
 James R. King
 Laura King
 Rosemary King
 Marilyn Kingery
 Kay Kitagawa & Andy Johnson-Laird
 The Klapper-Hickey Family Fund of
 T. Rowe Price
 The Klebleev Family
 Jeffrey Knapp & Mark Clift
 Kristina D. Knight
 Betty Lou Koffel & Philip Moyer
 Christopher Konczyk
 Michiko Kornhauser
 David & Nicholas Krichevsky
 Karen S. Krumrey-Fulks
 Arnold G. Kumagai
 Allison Kutz
 Robert Kyr
 Ed Labinowicz
 Kurt Laidlaw & Craig Cowden
 Barbara LaMack & Jim Kalvelage
 Sabin Lamson
 Alyse Lansing & Joe Gass
 Mr. Kerby Lauderdale
 Libbi Layton-Tamiyasu
 Joann D. Le

Thomas Lee
 Patricia T. Leiser
 JonQuil LeMaster
 David Lennert
 Ellen Levine
 C. Keith & Mark Lewis Brown
 James & Diane Liefeld
 Roger & Katherine Lintault
 Lori & David Lochelt
 Alan Locklear & Marie Valleroy
 Patty Locktov
 Joyce & Stanley Loeb
 Carole Lower
 Georgianna Lukens
 Catherine K. Lum & Joseph Pinter
 Judith Lundeen & Douglas Briedwell
 John Lunsford
 Lee Lustberg & Michael Musto
 Anne & Charles Macquarie
 Patricia Madden
 Patricia de Magalhaes
 Nona K. Mann
 Lois Manookian
 William Mansfield
 Linda & Ken Mantel
 John R. Martin
 Stan & Kathy Martin
 Christopher Mason
 Barbara Maurer
 Oscar H. & Mary S. Mayer
 Katherine McCabe
 Stephen McConnell
 Virginia McCormick
 Isabel McDonald
 Judy McElhaney
 Bob & Betty Ann McKay
 Jill McLean
 Richard E. Meade
 Eric & Carol Means
 Anne Meixner
 Lisa D. Meyer & Darren Ferris
 Katie Miller
 Michael & Anne Miller
 Suzanne Millies & Dale Allen
 Barbara Mills
 Paul & Laura Milne
 Christine Mitchell
 Michael Thomas Mock
 Earl Molander
 Mark Mooney
 Phyllis L. Morical
 Frank & Zanice Muckler
 Alfred & Susan Mukatis
 Martin C. Muller
 John & Nancy Murakami
 Ana Murmann
 Carolyn & Terry Murphy
 Martha Murray & Kent Duffy
 Yoko Nakamura
 Patrick & Anna Neal
 Linda Nelson
 Nichiren Buddhist Temple
 Nichiren-Shu Minori-kai
 Members of Niwa-No-Bikai
 Tetsuro Nomura
 Mr. Eugene Norcross-Renner
 Adrienne Nowers
 Marie U. Nysten
 Ohara School of Ikebana
 Linda E. Olds
 Mr. & Mrs. Allan Olson
 Carlton Olson
 Kathleen O'Reilly
 Phyllis & Warren Oster
 Mona M. Ozaki
 Tricia Pace & David Heal
 Glenna Palmer
 Jeff A. Parnaby & Samia Haddad
 Sheila Pastore
 Elaine Paul
 Irene & Shiva Patil
 John & Rose Mary Payne
 Daniel Peabody & Kajanne Pepper
 Perry & Bradley Pearce
 Ellen Penswick

The Perez & Shea Family in memory of
 Grace T. Brophy
 Richard & Sharon Perkins
 Carlton Perry
 Constance Person
 Lucille H. Pierce
 Claude Pierrelouis
 Dr. Gerald Pires
 Charles & Ruth Poindexter
 Dolores Poth
 Debby Potts
 Bob Powers & Donald Clement
 Curt & Mary Pradelt
 Barbara Prigohzy
 Lee & Ronald Ragen
 Eugenia Raptis
 Katherine Melchior Ray
 Margaret Rea & Mark Riley
 Mary Reece
 Dawn Regier
 Betty Reynolds
 Elaine Rhodes
 Judith L. Rice
 Frances L. Richey
 Barbara & Scott Richmond
 Grace Y. Richter
 Bob & Claire Riddle
 Michael & Carol Riley
 Larry Robidoux & Thelma Soderquist
 Fern Rollin
 Dee Ross
 Katherine & Jonathan Rozes
 Gaye Rumsey
 Karen Runkel
 William D. Rutherford
 Bonnie C. Ryan
 Patricia E. Sacks M.D.
 Amy & Katie Sakurai
 Julie Sara & Gary Martin
 Valerie Sasaki
 Barbara A. Schaper
 Nancy Schaumberg
 Sandra Schlesinger
 Carol Schnitzer Lewis
 W. Curtis Schade &
 Jacquie Siewert-Schade
 Laura Schlafly
 Susan Schwartz & Michael Marciniak
 Poni Scofield
 Michiko Senaga
 Priscilla R. Senior
 Thomas & Stephanie Serleth
 Nancy B. Seton
 Charles R. Sheldon
 Susan K. Sherwood
 Ted & Arlette Sieckman
 Joan Silverman & Max Asbock
 Yoneko Shimizu-Dalton
 Alan & Gwen Shusterman
 Elaine Sibley
 Virginia Siemsen
 Kathy Simpson
 Eric Sitiko
 Sylvia Skarstad
 Jaymi & Francis Sladen
 Andrew Smith & Barbara Resnick
 Jane A. Smith
 Sarah Alexander Smith
 Carol Smith-Larson
 Betsy Smyser
 Barbara & Jim Snow
 J Andrew Snyder
 Sogetsu Portland Branch
 Joseph A. Soldati
 Thomas Soule
 Kyle Spencer
 John Sprietsma & Dana Plautz
 Karen Springer
 Amy R. Stahl
 Valerie Stallings
 Susan A. Steinhurst
 Melinda Stephens-Bukey
 Bruce & Janice Stevenson
 Jay Stewart
 Jackie Sticha & Chris Hautman

Pamela A. Still
 Portia & Matt Stinson
 Milan & Jean Stoyanov
 Sharon E. Streeter in honor of Ann
 Goetcheus
 Robert Steinberg & Nancy Alexander
 Kathleen Suckow
 Makoto Suzuki
 Carmelita Sweeney
 Harry Tachiki & Barbara Bonnice
 Takumi Company
 Tarbell Family Foundation
 Roberta Taussig
 Gale A. Taylor
 Robert & Carolyn Tecklenburg
 Thacker-Taylor Family Trust
 Nancy & Robert Thompson
 Tracy Thorne
 M. Thraikill. Architect LLC
 Cathy & Greg Tibbles
 Barbara Tillman
 Tomodachi Committee JASO
 Andrea Topete
 Gina Toynbee
 Cheryl & David M. Trine
 Dagne & Elliott Trommald
 Brian Trostel & Carol Shaw
 Hiroki Tsurumi
 Steve & Linda Tubbs
 Robert Tufts
 Marleen Tulas
 Taketoshi Uchiyama
 Mary Ellen Ulmer &
 John Charles Cowles
 Stephen J. Urion
 Bill Valenti
 Valqua America, Inc.
 Tyrell & Kathleen Vance
 Barbara G. Van Raalte Family Fund
 of Fidelity Charitable
 David A. VanTassel
 Nancy D. Vartanian
 Al & Dawn Vermeulen
 Anton Vetterlein & Pamela Birkel
 Dieta Von Matthiessen & Caitlin Moore
 Sherrie Wade
 Teri Wadsworth & John Paul
 Jan Waldmann
 Perry & Kristie Walker
 Sandy & Dale Walker
 Laura Walsh
 Keith Walters & Jonathan Tamez
 Helen Warberg
 Harriet & Peter Watson
 James K. & Jenny L. Watson
 Scott Weaver & Curvin C. Carbaugh
 Sarah Weston
 Bart & Karin Whalen
 Ron Widmar
 Thomas M. Williams & Naomi Miller
 Janet Williamson
 Baxter Wilson
 Buzz & Diane Wilson
 Christina & Reed Wilson
 Dan Wilson
 Pat Wilson
 Steve Wilson & Barbara Stafford-
 Wilson
 Jared Winn
 Scott Winters
 Bruce & Susan Winthrop
 Robert Wise
 Joe & Phyllis Whittington
 Lynda Wonacott-Decker
 Judy Yamauchi
 Takeshi Yoro
 Ronald Zaraza



The Golden Crane Society

Cumulative giving to the Annual Fund from 2/21/2016 through 2/16/2017

PLATINUM CIRCLE \$100,000+

Arlene Schnitzer & Jordan Schnitzer
of the Harold & Arlene Schnitzer
CARE Foundation

GOLD CIRCLE \$50,000 - \$99,999

Delta Air Lines

SILVER CIRCLE \$25,000 - \$49,999

Bamboo Sushi
George Nakashima Woodworking, S.A.
Torii Mor Winery & Vineyard

BRONZE CIRCLE \$10,000 - \$24,999

Bank of America
Brown Printing, Inc.
Devil's Food Catering
Dean & Kathi Dordevic
Susan & Greg Fitz-Gerald
Yoko Fukuta
William G. Gilmore Foundation
Jeanne Giordano & Bob Frasca
Google
Hoffman Construction
Joto Sake LLC
Gail & Fred Jubitz
Gary Langford
Kazuo & Setsuko Mitsuhashi
Moonstruck Chocolate Company
Samuel T. & Mary K. Naito Foundation
Oregon Community Foundation
Community Grants
Dorothy Piacentini
Kathy Pike
Travers & Vasek Polak
Jim & Cathy Rudd
Arlene Schnitzer & Jordan Schnitzer
of the Harold & Arlene Schnitzer
CARE Foundation
Travel Oregon
Tsurugaoka Hachimangu Shrine
Juan Young Trust
Robert & Debb Zagunis
And those who wish to remain
anonymous (2)

FOUNDER'S CIRCLE \$5,000 - \$9,999

The Autzen Foundation
Anthony & Martha Belluschi
Gwyneth Gamble Booth
George Cummings
Dede & Joe DeJager
Mrs. Marguerite H. Drake
Marguerite Hirschbuhl Drake Fund of
the Oregon Community Foundation
Wayne R. & Sandra F. Ericksen
ESCO Foundation
Fred W. Fields Fund of The Oregon
Community Foundation
Katherine & Mark Frandsen
Ron & Jenny Herman
Robert Hogfoss
W.A. Hughes Construction Inc.
Roman Johnston Photography
J. Douglas Macy
Dinah & Robert McCall
Marilyn McIver
Kelly & Steve McLeod
Glenn & Widney Moore
Northwest Bank
NW Natural Gas Co.
Omomuki Foundation
PosterGarden
Mr. & Mrs. Charles Putney
Regional Arts & Culture Council
Marge Riley Fund of the Oregon
Community Foundation
Trudy & Pat Ritz, Ritz Family
Foundation
Smith Rock, Inc.
Drs. Calvin & Mayho Tanabe
John & Susan Turner
Larry & Dorie Vollum

PRESIDENT'S CIRCLE \$2,500 - \$4,999

Trish & Joe Adams
Thomas P. Anderson &
Jack B. Blumberg
Jean & Ray Auel
Bill & Joan Bailey
Suzanne Storms Berselli
Stephen Bloom & Michael Blankenship
Bruce & Cindy Brenn
Dr. & Mrs. John R. Campbell
Candy Cassarno
Mora Chartrand & Linda Grant
John & Kathryn Cochran
Dr. Mark Edge
Rich Farrington & Deborah Lycan
Mary E. Fellows & John W. Russell
Geffen Mesher
Barbara Giesy
Jeffrey & Sandra Grubb
Hacker Architects
Halton Foundation
Tom & Susan Hamman
Hasegawa Kogyo in honor of
Yasumasa Hasegawa
Irene Hirano-Inouye
Hank & Judy Hummelt
Hyster-Yale Group
Tatsuo Ito
The Japan Foundation
Janelle & Lee Jimerson
Jerry Jones Fund of the
So-Hum Foundation
William David & Mary Jones
Peter J. Kendall
Kay Kitagawa & Andy Johnson-Laird
John A Kodachi, PC
Dorothy Lemelson
Doug & Theresa Lovett
Curtis W. Marble
Mary's Woods at Marylhurst
Multnomah Whiskey Library
Friends of the Library Program
The Paramount Hotel
Park Lane Suites & Inn
PGE Foundation
Shirley & David Pollock
Wayne M. Quimby &
Michael Roberts Quimby
Paul J. Schommer
Treecology, Inc.
Rose E. Tucker Charitable Trust
Dan & Priscilla Bernard Wieden
Mr. & Mrs. James H. Winkler



Photo: Jonathan Ley

GARDENER'S CIRCLE
\$1,500 - \$2,499

A-dec, Inc.
Sally Ashley
Alan & Julieann Barker
Jerome & Irene Barr
David E. & Mary C. Becker Fund of the Oregon Community Foundation
Allison & Robert Belcher
in Memory of David Bruce Belcher
Broughton & Mary Bishop Foundation
Mary Lee Boklund
Ibby Brooke
Richard Louis Brown & Thomas Mark
James & Diane Burke
Worth & Barbara Caldwell
Linda Campbell
Ann C. Carter & Thomas P. Palmer
Sandra Chandler & Chris Schaeffer
Jeremy J. Cochran
Columbia Grain, Inc.
William Cook & Gwil Evans
Anne & James Crumpacker
Bill Dickey
Mary Dickson
Drake's 7 Dees
Gail Durham & E Benno Philippon
Judith M. Dyer & Richard Dyer

Marilyn Easley in memory of David Easley
Ferguson Wellman Capital Management
Flowerree Foundation
Ford Foundation
Doyle Forister & Gary Sheldon
Ann Goetcheus
Bruce Guenther & Eduardo A. Vides, M.D.
John Hall & Margaret Chula
Thom & Margaret Hacker
Andrew & Cynthia Haruyama
Jay A. Henry
Michel & Vicki Hersen
Lynne M. Hoffman
Mary & Gordon Hoffman
Jerry & Ann Hudson
William A. Hughes & Nancy L. Richmond
Beth & Jerry Hulsman
Joshua & Kerstin Husbands
The Jasmine Pearl Tea Company
John & Janet Jay
Salena Johnson
Allan Karsk & Keith Berglund

Jayn K. Kellar
Susan Koe
Caroline Kerl & Bill Lunch
Selby & Douglas Key
Elizabeth M. King
The Kresge Foundation
Yoshio & Nikki Kurosaki
Ross M. Lienhart,
Edward Lienhart Family Foundation
Joyce & Stanley Loeb
James D. Lynch & Robby Cunningham
saRah Mahler
Laura S. Meier
Masa Mizuno
Morel Ink
Darren & Casey Nakata
Chef Naoko
Mrs. Hester H. Nau
Carol L. Otis MD & Roger Goldingay
Pacific Power Foundation
Piper Park, The Park Foundation
Marilyn R. Podemski
Portland Roasting Coffee
Pat Reser
Sapporo Brewing USA
Forrest & B.J. Simmons

Susan Dee Schnitzer Family Fund of the Oregon Community Foundation
Susan Schnitzer & Greg Goodman
Steven H. Smith & Dennis C. Johnson
Drake & Lynn Snodgrass
Donald & Susan Spencer
The Standard
Bonnie Pomeroy Stern
Andrée Stevens
Mr. Ernie Stoddard
Peter W. Stott Foundation
Hitomi Tamura & James Peters
Rebecca & Russell Teasdale
Rena & Cheryl Tonkin
Anthony Van Ho, MD & Forrest Davidson III, PhD
Walker Macy
Stuart Weitz & John Gustavsson
Stacie D. White
Work for Art
And those who wish to remain anonymous (3)



Photo: Roman Johnston





Global Ambassadors

Including our Global Ambassador Members, Sponsors of our 2014 New York Launch Event, and Donors contributing \$500 in the past 12 months and residing more than 120 Miles from Portland, Oregon.

Ajinomoto
 Capt. David G. & Carolyn Berry Wilson
 Susan C. Brown
 Darrell & Marilyn Brownawell
 Dr. Mary Jo Buckingham & Paul D. Fitzpatrick
 Kathryn Campbell
 Candy Cassarno
 David H. Corry
 Susan Cummins
 Lynn A. Cyert & Russell Westbrook Jr.
 Daiwa Lease Co., Ltd.
 Peggy & Dick Danziger
 Delta Air Lines
 Dr. Mark Edge
 Lawrence & Sarah Eppenbach
 Fast Retailing Co., Ltd.
 Steve & Peggy Garber
 William G. Gilmore Foundation
 Lisa Gimmy Landscape Architecture
 Jeanne Giordano & Bob Frasca
 Google
 Justine Halliday
 Tom & Susan Hamman

Hasegawa Kogyo Co., Ltd.
 Ron & Jenny Herman
 Irene Hirano-Inouye
 Geoffrey Hoefer
 Itogumi Co., Ltd.
 The Japan Foundation, Center for Global Partnership
 William David & Mary Jones
 Joto Sake LLC
 Amy S. Katoh
 Scot Kellar
 Tracy Keys & Chris Keys
 Komatsu Seiren Co., Ltd.
 Patricia T. Leiser & Gary Leiser
 Kathleen & Curtis Marble
 Mary & James G. Wallach Foundation
 Maybelle Clark Macdonald Fund
 Kelly & Steve McLeod
 Richard Milgrim
 Yoshiaki Mizumoto
 Janet & Tom Montag
 Nakamura Sotoji Komuten
 George Nakashima Woodworking, S.A.
 Scott & Connie Neish

Alan, Gwen, Avery & Ashton Niemann
 NPO Greenwave
 Omomuki Foundation
 Kathy Pike
 David & Jane Pollock
 PricewaterhouseCoopers LLP
 Diane Pyles
 Patricia E. Sacks M.D.
 Catherine & Taisuke Sasanuma
 Jeanne Schnitzer Marks
 Mr. Henry Sidel
 David & Abigail Snoddy
 So Hum Foundation
 Sony Electronics
 Erik & Cornelia Thomsen
 L. D. Tisdale & Patricia A. Tisdale
 Torii Mor Winery & Vineyard
 Tsurugaoka Hachimangu Shrine
 Mary Wallach
 Uniqlo
 And those who wish to remain anonymous (2)



Tribute Gifts

Contributions received
 1/1/2017 - 2/16/2017

IN HONOR OF JANE CHAMBERS

Anonymous

IN MEMORY OF MRS. ROSE KILLINGSTAD

Lori and David Lochelt

IN HONOR OF MRS. MARGUERITTE H. DRAKE

Laurie and Peter Turney

IN MEMORY OF JON LEXAU

Lezah and Jens Petersen

IN HONOR OF DAVID HOPKINS AND RICK YOUNGE

Robert Cramer & Allen Simmons

IN MEMORY OF DR. TSUNEO SUZUKI

Charles and Janet Warden
 Stephanie Warden

IN HONOR OF MARY AND OSCAR MAYER

Oscar H. & Catharine Mayer



Photo: Jonathan Ley



Golden Crane Legacy Society

Golden Crane Legacy Members have named the Garden as the ultimate beneficiary of a planned gift. We are grateful to the following people for letting us know of their plans to support the Garden in this thoughtful way.

Carole Beauclerk
Barbara Bell
Diane Benjamin
Melanie Billings-Yun
Stephen Bloom & Michael Blankenship
Judith L. Bradley & David L. Mitchell
Susan Coe Brown
Carla Caesar & Nora King
Mora Chartrand & Linda Grant
Mary Dickson

Mrs. Marguerite H. Drake
Elaine West Durst
Yoko Fukuta
Ms. Susan Halton
Ron & Jenny Herman
Albert Horn
Jerry & Ann Hudson
Mary Kay Johnson
Elizabeth M. King
Ron and Polly Wall Lauser

John & Lisa Lehman
Linda and Don McNeill
Wayne M. Quimby & Michael Roberts Quimby
W. Curtis Schade & Jacquie Siewert-Schade
Mr. Ernie Stoddard
Ann & John Symons
Ms. Carmen Wong
And those who wish to remain anonymous (2)

If you would like to include the Garden in your estate plans, or if you have already done so and would allow us to list you as a Legacy Member, please contact Chief Development Officer Tom Cirillo at (503) 595-5225 or tcirillo@japanesegarden.org

We are grateful to the following individuals and families for their generous estate/bequest gifts received by the Garden:

Nancy Beamer
Clarence Bobbe
Stanley L. Davis Trust
Bill Findlay
Robert W. Franz
Estate of Stanley W. Greenhalgh

Elizabeth Ann Hinds
Jerry G. Jones Trust
Noel Jordan
Estate of James Kesler
Duke Mankertz
Ms. Beverly Merrill

Jack O. Rickli
Jeaneatta Sautter
The James W. Skog Trust
Toya Family Trust: George, Sonoya, Georgene, and Evelyn
David E. Wedge Trust

Annual Fund Donations

Contributions received
1/1/2017 - 2/16/2017



Photo: Julia Taylor

Amazon Smile
Barbara Bell
Biwa
Mayno Blanding
Frederick & Leila S. Brown
Marianne Buchwalter
Mitchell Burghart & Yvonne Alderman
Naomi Carrier
Susan Cole
C A Cooke
David H. Corry
Margaret A. Doolen
Kay Endo
Mr. Joseph Ferguson
Gemma Furno
Christina Gullion
Sally R. Hamaji & Alan Flum

Marilyn S. Hartzell & Kerrie G. Standlee
Janet Heineck
Helen Herman
Colonel Jim Heupel
Laura L. Hudson & Rob Sims
Craig & Joyce Jacobsen
JCPenney Change for the Better Campaign
Steven T. Karker
Kashintei Kai
Aphra & Richard Katzev
Craig & Vanessa Lang
Georgia M. Lee
Isabel McDonald
Lani McGregor & Daniel Schwoerer
Leslie C. & Wallace L. Rainey

Fred Meyer Community Rewards Program
Michael Rego
Ken Robertson & Tony Smith
Rod & Cheryl "Charlie" Rogers
Richard & Mary Rosenberg
Marjorie Russell
Laura Schlafly
Ms. Maxine Selling
Don & Joan Strand Foundation
TRUiST
Barbara G. Van Raalte
Al & Dawn Vermeulen
Suwako Watanabe
Robert Wright
And those who wish to remain anonymous (7)

DID YOU KNOW?

Summer hours are here!

Mondays: Noon - 7pm
Tuesdays–Sundays: 10am - 7pm

The Washington Park Reservoir Project continues until 2018.
We encourage you to take TriMet and the Washington Park Free Shuttle, which begins service on the weekends starting in April.

Learn more at explorewashingtonpark.org

NON-PROFIT ORG.
U.S. POSTAGE
PAID.
PERMIT NO. 11
PORTLAND, OR



Official winery of the Portland Japanese Garden



Official Airline of the Portland Japanese Garden

