



## PHW 400 M Full-Motion TV Wall Mount

Article number (SKU) 6302400  
Colour Black

### Key Benefits

- Strong and Simple: solid, secure solutions to mount your TV; Smoothly turn your TV up to 180°

Enjoy your TV mounted very flat to the wall, and turn and tilt it towards you for the perfect viewing angle. The TURN & TILT MEDIUM wall mount from Physix is suitable for TV's from 32" to 55" weighing up to 30 kg.

This universal support is suitable for almost all TV brands (use our MOUNT MATCHER to find exactly the right mount size for your TV). It comes with easy mounting instructions, as well as all the screws and wall plugs you might need. The Turn functionality let's you turn the screen left or right up to 90 degrees (depending on TV size) or tilt it 15 degrees, to ensure the perfect viewing angle from anywhere you want to watch.

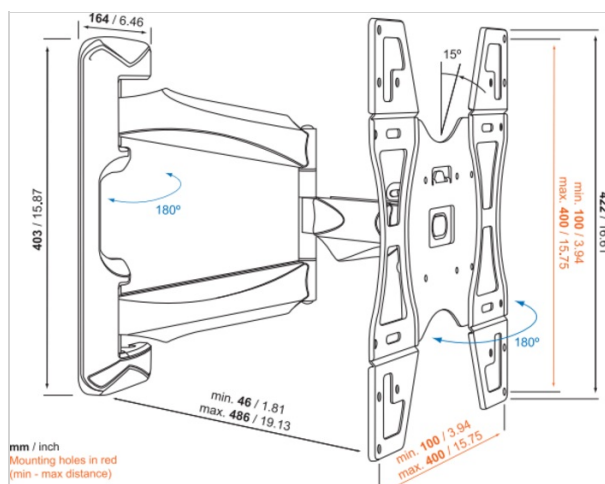

# PHW 400 M Full-Motion TV Wall Mount

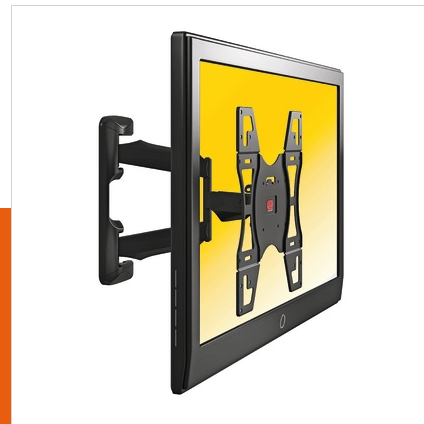

VOGEL'S HOLDING BV 2018 (c) All rights reserved  
Subject to printing errors, technical and price  
amendments  
Date: 30-03-2018

[www.vogels.com](http://www.vogels.com)

## Specifications

### Product specifications

Product type number	PHW 400 M
Article number (SKU)	6302400
Colour	Black
EAN single box	8712285320804
Product size	M
TÜV certified	Yes
Tilt	Tilt up to 15°
Turn	Full motion (up to 180°)
Guarantee	Lifetime
Min. screen size (inch)	32
Max. screen size (inch)	55
Max. weight load (kg)	30
Standard fixed VESA patterns	100 mm x 100 mm 200 mm x 100 mm 200 mm x 200 mm 300 mm x 300 mm 400 mm x 200 mm 400 mm x 300 mm 400 mm x 400 mm
Max. bolt size	M8
Max. height of interface (mm)	422

Max. width of interface (mm) 427

### Features

Functionality Turn

Min. distance to the wall (mm) 46

Max. distance to the wall (mm) 486

