



HP Jetdirect 3100w BLE/NFC/Wireless Accessory

Secure, reliable mobile printing made simple

Enhance the mobile productivity of your business with seamless wireless printing. New Dual Band Wi-Fi connectivity enables increased Wi-Fi performance and reliability in Enterprise and SMB environments. Activate HP Roam on your printer with this accessory to enable mobile printing.¹



Seamless mobile printing

Make network, cloud, and peer-to-peer Wi-Fi Direct® printing easy for everyone on select HP LaserJet Enterprise MFPs and printers.^{2,3} With the HP Jetdirect 3100w BLE/NFC/Wireless Accessory, users can:

- Deploy wireless printing and other HP mobile printing solutions on HP printers or MFPs in a few simple steps.^{2,3} This accessory easily plugs into the Hardware Integration Pocket or USB accessory port located on the back of your HP device.^{2,4}
- Manage peer-to-peer printing at the device level, using the control panel or the HP Embedded Web Server. Or apply changes fleetwide, using HP Web Jetadmin remote management software.⁵
- Save employees time and effort by making it easy to send print jobs from smartphones, tablets, or laptop PCs that use 802.11b/g/n Wi-Fi from anywhere in the office. Add the option to print from NFC-enabled mobile devices—no network needed.^{3,4}

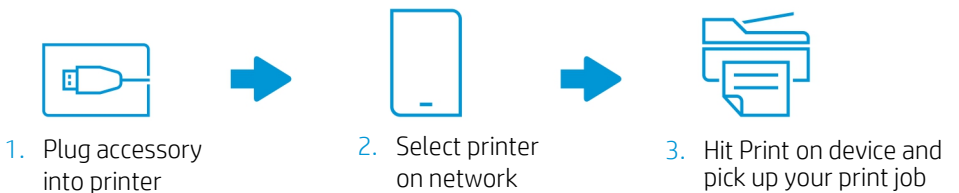

Reliable wireless performance and security

Dual Band Wi-Fi (802.11n on 2.4 GHz and 5 GHz) helps ensure that the wireless connectivity of your printer and mobile devices performs better and more reliably in commercial environments.

Device access control and wireless security protocols help ensure that information is safe from the start to finish while printing:

- Documents are encrypted both in-transit and on the printer or MFP.
- Protect your business information while giving users touch-to-print convenience. Print directly from mobile devices without accessing the corporate network.^{3,4}

Multiple options, print wherever business happens

Give employees the option to print directly from an array of mobile devices without hassle:

- Easily print documents, emails, PDFs, and more from an iPhone® and iPad®, as well as smart devices and laptops running iOS, Android™, Windows® 8 and 10, and Google Chrome™ operating systems—generally no setup or apps required.³
- HP Roam enables mobile workers to print effortlessly from any device to any HP printer, securely through the cloud.¹



Product specifications

Part number	3JN69A
Connectivity	802.11b/g/n with Dual Band wireless Ethernet (2.4 GHz and 5 GHz); Wi-Fi Direct; BLE; NFC (near-field communication)
Supported printers and MFPs	HP LaserJet and PageWide Enterprise printers running FutureSmart version 4 firmware including M506, M507, MFP M527, MFP M528, M604, M605, M606, M607, M608, M609, MFP M631, MFP M632, MFP M633; HP Color LaserJet Enterprise M552, M553, MFP M577, M652, M653, MFP M681, MFP M682, M751, MFP M776, M856; PageWide 556, 755, 765; PageWide MFP 586, 774, 779, 780, 785. For a complete list of supported devices, visit hp.com/go/jetdirect .
Network types	Dual Band wireless Ethernet 802.11b/g/n (2.4 GHz and 5 GHz)
Browsers supported	Microsoft® Internet Explorer® 6.0 and higher, Mozilla® Firefox® 2.x and higher, Safari®, Chrome
Memory	None (uses memory and storage in printer)
Network operating systems ⁶	Uses printer/MFP firmware. See the printer/MFP datasheet for compatible network operating systems.
Network protocols	IPv4/IPv6: Apple® Bonjour® compatible, SNMPv1/v2c/v3, HTTP, HTTPS, FTP, Port 9100, LPD, IPP, Secure-IPP, WS Discovery, WS Print; IPv6: MLDv1, ICMPv6; IPv4: SLP, Telnet, IGMPv2, DHCP Server, AirPrint®, Google Cloud Print™ 2.0, BTLE 4.0 compliant, Wi-Fi Direct®
Security	Management security: SNMPv3, SSL/TLS (HTTPS); Wireless network security: WPA2-Personal (WPA2-AES); Administrator password. Plus, same security protocols as attached printer/MFP.
Dimensions	3.2 x 2.2 x 0.8 in (81 x 56 x 20 mm)
Weight	0.13 lb (0.061 kg)
Packaged dimensions	7.0 x 5.4 x 2.4 in (178 x 138 x 60 mm)
Packaged weight	0.59 lb (0.266 kg)
What's in the box	HP Jetdirect 3100w BLE/NFC/Wireless Accessory, 2 mini USB cables, stand-alone plastic cover, Velcro kit, installation guide, warranty cards
Warranty	One-year replacement warranty
Power specifications	Host USB-powered accessory, input voltage: 5V, 500mA Power consumption: ⁷ 2.9 watts maximum
Environmental ranges	Recommended temperature: 32 to 104° F (0 to 40° C); Storage temperature: -40 to 158° F (-40 to 70° C); Humidity (operating and nonoperating): 15 to 95% RH
Standards and certifications	Safety: EU (Low Voltage Directive 2006/95/EC) EN60950-1:2006/A11:2009+A1:2010/A12/A2:2013 EMC: EMC Directive 2004/108/EC EN 301 489-1 V2.2.0, EN489-17 V3.2.0, USA FCC CFR 47 Part 15, Canada RSS-210

¹ Subscription or accessory may be required. For more information, visit hp.com/go/roam. To enable HP Roam for Business, some devices may require firmware to be upgraded and an optional accessory to add Bluetooth Low Energy (BLE) beaconing capabilities. Customer can purchase the HP Jetdirect 3100w BLE/NFC/Wireless accessory or the RadBeacon USB.

² HP 3100w BLE/NFC/Wireless Accessory is compatible with select HP LaserJet Enterprise and PageWide Enterprise printers and MFPs with HP FutureSmart Firmware Version 4, introduced spring 2015 and later. For a complete list of supported devices, visit hp.com/go/jetdirect.

³ Wireless operations are compatible on both 2.4 GHz and 5 GHz frequency bands. Mobile device needs to be network connected or connected directly to the Wi-Fi Direct® network of a wireless direct-capable MFP or printer prior to printing. Depending on mobile device, an app or driver may also be required. Some mobile solutions may require registration of service to enable solution. Learn more at hp.com/go/businessmobileprinting.

⁴ Requires a compatible NFC-printing-enabled mobile device. For a list of compatible NFC printing-enabled mobile devices, see hp.com/go/nfcprinting.

⁵ HP Web Jetadmin is available for download at no additional cost at hp.com/go/webjetadmin. Universal device plug-in is offered with HP Web Jetadmin 10.3 SR4 and higher.

⁶ Not all protocol and operating system combinations are supported. For more information, refer to the support page at hp.com/support/id3100w. Select the HP Jetdirect 3100w and then select HP Support and Drivers.

⁷ Values subject to change. Power numbers are the highest values measured using all standard voltages. See hp.com/support for current information.

Sign up for updates
hp.com/go/getupdated



© Copyright 2018-2019 HP Development Company, L.P. The information contained herein is subject to change without notice. The only warranties for HP products and services are set forth in the express warranty statements accompanying such products and services. Nothing herein should be construed as constituting an additional warranty. HP shall not be liable for technical or editorial errors or omissions contained herein.

Apple, AirPrint, iPad, iPhone, Bonjour, Safari are trademarks of Apple Inc. Android, Google Chrome, and Google Cloud Print are trademarks of Google Inc. Microsoft and Windows are U.S. registered trademarks of the Microsoft group of companies.

4AA7-3409ENW, October 2019, Rev. 2

