

# 18th International Symposium on Plasma Chemistry Final Program

August 26 - 31, 2007

Kyoto University, Japan

<http://plasma.kuee.kyoto-u.ac.jp/ispc18/>



## Patronages and Sponsorships



International Union of Pure and Applied Chemistry (IUPAC)



International Plasma Chemistry Society (IPCS)



The 153rd Committee on Plasma Materials Science, Japan Society for the Promotion of Science (JSPS153)



Japan Society of Applied Physics (JSAP)



Graduate School of Engineering, Kyoto University



Kyoto Nanotechnology Cluster (Kyo-NANO)



Research Institute for Applied Sciences (RIAS)

## Scientific Supports



Science Council of Japan

## Financial Supports



Gentech Japan



Iwatani Naoji Foundation



Japan Society for the Promotion of Science (JSPS)

The Murata Science Foundation

Nippon Sheet Glass Foundation for Materials Science and Engineering (NSG Foundation)



SAMCO, Inc.



ULVAC, Inc. and ULVAC TECHNO, Ltd.



U.S. Air Force Office of Scientific Research (AFOSR) and



Asian Office of Aerospace Research and Development (AOARD)

## Committees

### International Organizing Committee

Kunihide TACHIBANA (Chair)	(Kyoto Univ., JAPAN)
Javad MOSTAGHIMI (Past-Chair)	(Univ. Toronto, CANADA)
Peter AWAKOWICZ	(Ruhr Univ., Bochum, GERMANY)
Pietro FAVIA	(Univ. Bari, ITALY)
Ellen FISHER	(Colorado State Univ., USA)
Khaled HASSOUNI	(Univ. Paris Nord, FRANCE)
Jae-Koo LEE	(Postech, KOREA)
Stanislav PEKAREK	(Czech Tech. Univ., CZECH REPUBLIC)
Takayuki WATANABE	(Tokyo Inst. Technol., JAPAN)
Michael WERTHEIMER	(Ecole Polytech. Montreal, CANADA)

### International Plasma Chemistry Society (IPCS) Board of Directors

Jean-Michel POUVESLE, President (FRANCE)	Achim von KEUDELL (GERMANY)
Uwe KORTSHAGEN, Vice President (USA)	Anthony MURPHY (AUSTRALIA)
Farzaneh AREFI-KHONSARI (FRANCE)	Christian OEHR (GERMANY)
Hynek BIEDERMAN (CZECH REPUBLIC)	Ken OKAZAKI (JAPAN)
Rod BOSWELL (AUSTRALIA)	Pedro PATINO (VENEZUELA)
Gheorghe DINESCU (ROMANIA)	Boris POTAPKIN (RUSSIA)
Pietro FAVIA (ITALY)	Yi-Kang PU (CHINA)
Ellen FISHER (USA)	Kunihide TACHIBANA (JAPAN)
Alexander FRIDMAN (USA)	Richard van de SANDEN (NETHERLANDS)
Francois GITZHOFFER (CANADA)	Michael WERTHEIMER (CANADA)

### Local Organizing Committee

Kunihide TACHIBANA (Chair) (Kyoto Univ.)	Toshiaki MAKABE (Keio Univ.)
Osamu TAKAI (Co-Chair) (Nagoya Univ.)	Akihisa MATSUDA (Osaka Univ.)
Hiroshi FUJIYAMA (Nagasaki Univ.)	Ken OKAZAKI (Tokyo Inst. Technol.)
Rikizo HATAKEYAMA (Tohoku Univ.)	Takayuki WATANABE (Tokyo Inst. Technol.)
Akihiro KONO (Nagoya Univ.)	Toyonobu YOSHIDA (The Univ. of Tokyo)
Masayuki KUZUYA (Matsuyama Univ.)	

### Local Executive Committee

Kunihide TACHIBANA (Chair) (Kyoto Univ.)	Masahiro KAWASAKI (Kyoto Univ.)
Atsushi FUKUYAMA (Kyoto Univ.)	Zenpachi OGUMI (Kyoto Univ.)
Satoshi HAMAGUCHI (Osaka Univ.)	Koichi ONO (Kyoto Univ.)
Yasuaki HAYASHI (Kyoto Inst. Technol.)	Yuichi SETSUHARA (Osaka Univ.)
Masaru HORI (Nagoya Univ.)	Tatsuru SHIRAFUJI (Kyoto Univ.)

### ISPC-18 OFFICE

c/o Prof. Tachibana  
 Department of Electronic Science and Engineering  
 Graduate School of Engineering, Kyoto University  
 Kyoto-Daigaku-Katsura, Nishikyo-ku,  
 Kyoto 615-8510 Japan  
 TEL: +81-75-383-2289 FAX: +81-75-383-2290  
 E-mail: ispc18@plasma.kuee.kyoto-u.ac.jp

ISBN978-4-9903773-1-1

## General Information

### Welcome

The International and the Local Organizing Committees welcome you to Kyoto for the 18th International Symposium on Plasma Chemistry (ISPC-18). We wish you a pleasant week in this beautiful historical city of Japan and an exciting and fruitful participation to the Symposium.

### Symposium Venues

All sessions are held at Yoshida Campus of Kyoto University in the city except Wednesday's sessions which are held at Katsura Campus in the suburbs. For the transportation to Katsura Campus, please refer to the description below.

August 26 (Sun), 27 (Mon), 28 (Tue)	Yoshida Campus (Yoshida-Honmachi, Sakyo-ku, Kyoto)
29 (Wed)	Katsura Campus (Kyoto-Daigaku-Katsura, Nishikyo-ku, Kyoto)
30 (Thu), 31 (Fri)	Yoshida Campus

### Registration and Information Desks

The locations and office hours of the registration and information desks are as follows.

August 26(Sun)	13:00–20:00	at Clock Tower 2F, Yoshida Campus
27(Mon), 28(Tue)	9:00–19:00	as above
29(Wed)	9:00–13:00	at Rohm Plaza 3F, Katsura Campus
30(Thu)	9:00–19:00	at Clock Tower 2F, Yoshida Campus
31(Fri)	9:00–18:00	as above

At the registration desk, you will receive a name plate with your name and affiliation. This is your personal *passport* to all official activities and events. The name plate indicates that you are a registered participant or accompanying person. Please wear it throughout the symposium and social events.

### IPCS General Assembly (Friday, 31 August)

All registered participants at the biennial ISPC are automatically members of the International Plasma Chemistry Society (IPCS) for the two years following the participated Symposium. Membership fee is included in the registration fee of the ISPC. IPCS General Assembly is going to be held at 13:00 on Friday, 31 August, in the **Room A** at the Clock Tower. All members are requested to attend the General Assembly for the purpose of approvals of the election of Board of Directors, operating principles and future plans of the ISPC, etc.

### Vote for IPCS Board of Directors (Deadline: 12:00, Thursday, 30 August)

You, IPCS members, have the right to elect new members of the IPCS Board of Directors according to the bylaws of IPCS. Please do not forget to vote for the board of directors with the official ballot, which is included in your registration items as a color sheet. A ballot box is placed at the registration desk from 9:00 on Monday, 27 August, to 12:00 on Thursday, 30 August. Delayed ballots are invalid.

### Internet

Wireless LAN environment is available at the Clock Tower area in Yoshida Campus, and at Rohm Plaza in Katsura Campus. If you want to use wireless LAN, please visit the registration desk and fill out a registration form with your personal information including passport number for security reasons to get your authentication ID. Some internet-capable PCs are available in the **Room M1** at the Clock Tower in Yoshida Campus.

## Presentations

### Plenary Lectures

Plenary lectures are scheduled at the beginning of the morning sessions except Wednesday, 29 August. In addition to the main lecture hall (**Room A**) at the Clock Tower, another conference room (**Room B**) is connected by internet AV systems, where you can audit the lecture and make Q/As.

### Oral Session Speakers

Each speaker at oral sessions is asked to deposit an electronic version of your slides at the presenter's desk of which location is shown below. Please provide us with your presentation file at least a half-day before your actual presentation schedule for the smooth operation of the oral sessions.

- **Slide deposition room: Room M1** at Clock Tower 2F. Slide deposition room is open from 9:00 to 19:00 every day except Wednesday, 29 August (closed) and Friday, 31 August (until 12:00). There is an extra LCD projector in the room for your own test prior to the deposition if necessary.
- **Deadline for the deposition: A half-day prior to the presentation.** If your presentation is scheduled in the morning session, please deposit your file in the afternoon of the day before or earlier. If it is in the afternoon session, please do so in the morning of the same day.

*\*Note that on Wednesday, 29 August, there is **no place for the deposition at Katsura campus**. Therefore, speakers in the morning sessions of Thursday, 30 August, are asked to deposit electronic files in the afternoon of Tuesday, 28 August or earlier.*

- **Lengths of oral presentations:**

Plenary Lectures	35 min + 5 min for discussion
Invited Talks	25 min + 5 min for discussion
Contributed Talks	15 min + 5 min for discussion

## Poster Session Presenters

Poster sessions are held at the International Conference Hall (**Poster Room**) on the 2nd floor of the Clock Tower at 14:10-15:50 on 27 (Mon), 28 (Tue), and 30 (Thu) August.

- **Poster board size: 900 mm width × 2,100 mm height.** Poster pins are available at each poster board and additionally at the registration desk.
- **Times to hang up and take off posters:** A poster board with each assigned poster number is available during the full day of each poster session. It is recommended for each presenter to hang up posters as early as possible before the start of the session and take off before the end of all sessions of the day.
- **Length of the poster session:** 100 min. (You may visit the poster room at any time during the office hour.)

## Best Paper Award and Plasma Chemistry Award

The International Organizing Committee will choose excellent contributions of young scientists, on the basis of innovation and quality of presentation. The Best Paper Awards of ISPC-18 will be presented to the winners at the Closing Ceremony of the Symposium.

The Plasma Chemistry Award will be presented to an outstanding scientist in recognition of lifetime achievements in Plasma Chemistry and Processing. The winner is selected by the IPCS Board of Directors, and the Award will be presented at the Social Dinner.

## Exhibitions

Exhibitions of scientific equipments and books are held during the symposium in the **Poster Room**.

- **Exhibitors:** ISI Inc., SAMCO Inc., Surfx Technologies LLC, Toray Engineering Co., Ltd. and Wiley Japan.

## Industrial Workshop on Plasma Chemistry (Friday, 31 August, Afternoon)

Industrial Workshop is attached to the main body of the Symposium in the afternoon of the last day: Friday, 31 August. All registered participants of the Symposium are welcome to join the Workshop for fee.

## Social Events

### Welcome Reception (Sunday, 26 August)

The Welcome Reception will take place in the University Restaurant *Renais*. The Reception is scheduled to open from 18:00 to 20:00 on Sunday, 26 August. All participants of the Symposium and accompanying persons are welcome to the reception. Light meals and drinks are served for free.

### Lecture on Kyoto and Japanese Culture (Wednesday, 29 August, Morning)

Professors Bonnie Jennifer Shikiko Kawakami and Junko Kawai present lectures “*Kyoto—Past and Present (An Introduction to Japan’s Ancient Capital)*” during the morning session in Katsura Campus on Wednesday, 29 August. The lectures start from 9:30 at the **Room L** of the administration bldg. in B-Cluster of Katsura Campus (See pages 10 and

11). Accompanying persons are invited to this program for free. Please join us for learning more about the city, its people and its cultural heritage. The first half of the talk will explore the many faces of Kyoto and Japanese culture — from food and entertainment to literature and the arts. The second half will include **Hands-On** activities such as **Origami** and Japanese calligraphy. **Japanese Tea Ceremony** is planned after the Hands-On activities. Symposium participants are also welcome to join these programs.

### Excursions (Wednesday, 29 August, Afternoon)

The ISPC-18 Local Organizing Committee has organized three courses of excursions in Kyoto in the afternoon of Wednesday, 29 August. Buses is going to pick up attendees at the Rohm Plaza in Katsura Campus at 13:10 after the morning session, and will return to the major hotels after the excursions. Box lunches are served on the buses. On-site registration for the excursions may be possible depending on the capacity of each course at a cost of JPY 4,000 per person. Please ask its availability at the registration desk by 17:00 on Tuesday, 28 August.

*\*For persons who are not attending the excursions, buses returning directly to major hotels in downtown are also available (See below and also page 8).*

### Symposium Social Dinner (Thursday, 30 August)

The symposium dinner will be held at 19:00 in the evening of Thursday, 30 August, at the Banquet Room **MIZUHO** on the 4th floor in The Westin Miyako Hotel. Shuttle buses to the hotel depart at 18:20–18:40 successively from the spot shown on the map below.

## Transportations

- **From Major Hotels to Yoshida Campus**

For the reference of your daily attendance to the Symposium, except Wednesday, see the map on page 5.

A one-day pass (Kyoto Convention Pass) valid for subway and bus lines of Kyoto City is available at the information desk. The price of a pass is JPY 700, which is cheaper than the cost of a round trip connecting city subway and bus.

- **From Major Hotels to Katsura Campus**

In the morning of Wednesday, 29 August, shuttle buses are available from the major hotels for the Katsura Campus. Meeting places for the shuttle buses and the departure time are shown on the map on page 8.

*\*Accompanying persons who plan to join the excursions in the afternoon are recommended to take the buses together and join the cultural lectures in the morning.*

- **From Katsura Campus to Major Hotels**

Shuttle buses for returning directly to the major hotels from Katsura Campus are available only at 13:20–13:40 on Wednesday, 29 August, which depart from the Rohm Plaza and stops at the spots on the map of page 8.

- **From Yoshida Campus to the Social Dinner Site (Westin Miyako Hotel)**

Shuttle buses are arranged for the transportation to the Social Dinner Site. Please take the buses departing successively from 18:20 to 18:40 from the spot shown on the map below.

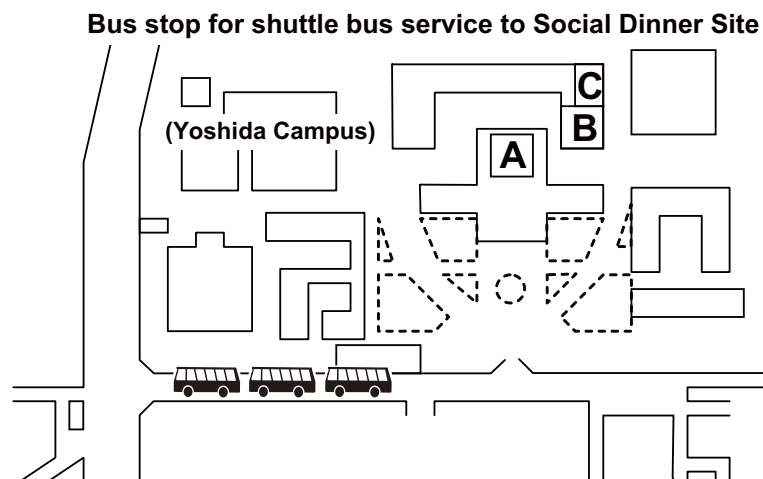



## Yoshida Campus: Route Map

except Aug. 29 (Wed)

Hotels in the area near Kyoto Station: ①, ②, ③ and ④

i) **Kyoto Station** → City Subway (North bound) (10 min) → **Imadegawa**

**Imadegawa** → City bus #201 (East bound) (15 min) → **Kyodai Seimon-mae**

or City bus #203 or #102 (East bound) (15 min) → **Hyakuman-ben**

ii) **Kyoto Station** Bus Terminal → City bus #206 (East bound) (40 min) → **Kyodai Seimon-mae**

Hotels around Shijo-Karasuma: ⑤ and ⑥

iii) **Shijyo-Karasuma** → City Bus #201 (East bound) (30 min) → **Kyodai Seimon-mae**

iv) Take City Subway from **Shijo-Karasuma** and follow the Route i)

Hotels around Karasuma-Oike: ⑦ and ⑧

v) **Karasuma-Oike** → City Subway (North bound) (5 min) → **Imadegawa**

Then, follow the Route i)

Hotels around City Hall or along Kawaramachi-dori Av.: ⑨ and ⑩

vi) Take City bus #3 or #17 from a bus stop nearby (North bound) (20 min) → **Hyakuman-ben**

vii) **Keihan-Sanjo** or **Keihan-Shijo** → Keihan-line (5~7 min) → **Demachi-yanagi** → walk (15 min)

Hotels along Subway Tozai-line ⑪

viii) Walk to **Higashiyama-Sanjo** (7 min) and take City bus #201 or #206 (North bound) (10 min)

→ **Kyodai Seimon-mae**

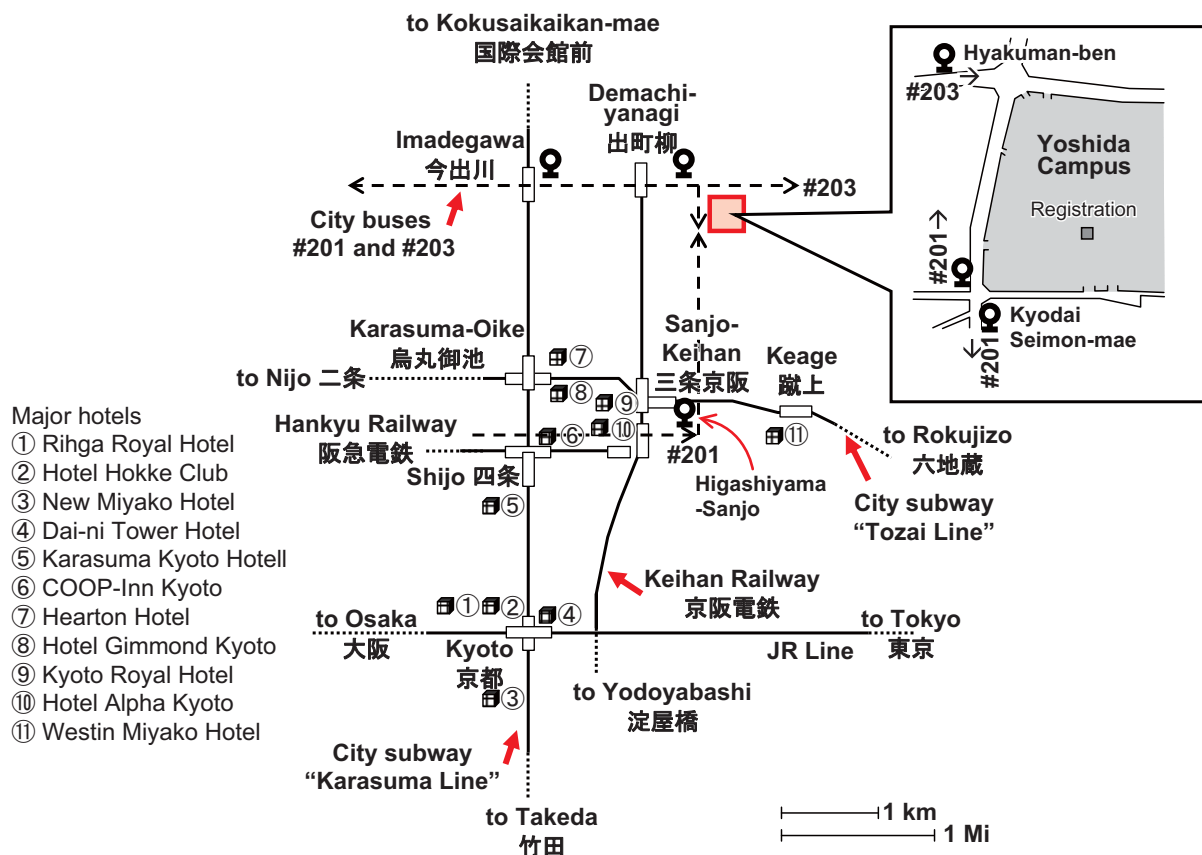

\*See page 4 for one-day pass (Kyoto Convention Pass).

**Yoshida Campus: Symposium Venue**

**except Aug. 29 (Wed)**



Clock Tower Centennial Hall		
2F	<b>Registration</b>	Registration and Information
	<b>Poster Room</b>	Posters and Exhibitions
	<b>Room M1</b>	Slide-Deposition / Wired-LAN
	<b>Room M2</b>	Multi-Purpose
	<b>Room M3</b>	Local Organizing Committee
	<b>Room M4</b>	Multi-purpose
Wireless LAN Area		
1F	<b>Room A</b>	Plenary and Oral
B1F	<b>COOP Shop</b>	Foods, stationeries, medicines, etc.
	<b>ATM</b>	

Faculty of Law and Economics Bldg. East Wing		
1F	<b>Room B</b>	Oral, Plenary (Remote AV)
	<b>Room C</b>	Oral

Kyoto Univ. COOP West Bldg 2F Restaurant <i>Renais</i>		
2F	<b>Welcome Party</b>	Only on Aug. 26(Sun)
1F	<b>COOP Shop</b>	Books, CDs, PCs



# Yoshida Campus: Session Rooms

except Aug. 29 (Wed)

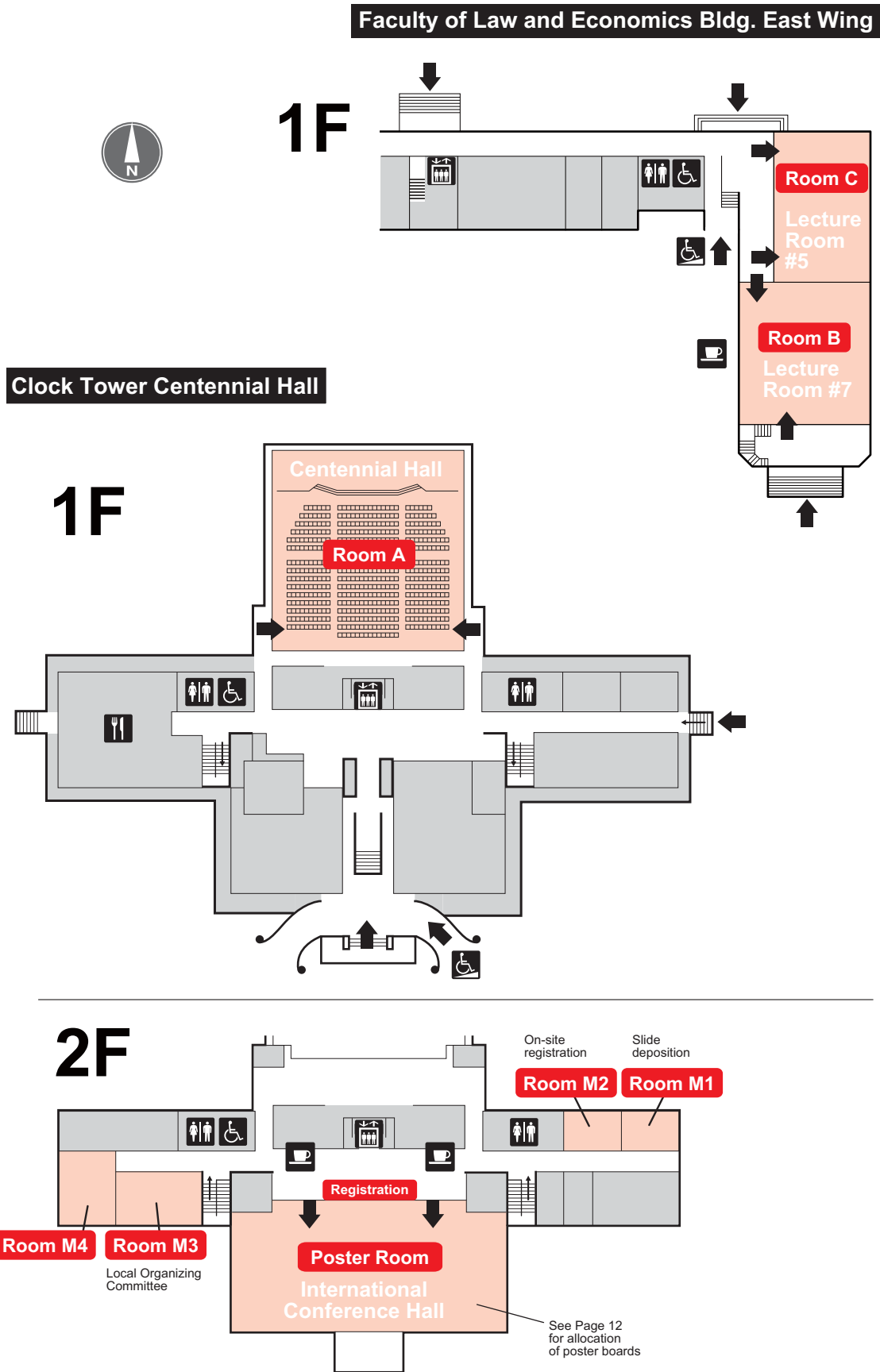

\*Conference rooms will open at 8:50 in the morning.

# Katsura Campus: Shuttle Bus

Aug. 29 (Wed)

- Bus stops and departure/arrival times

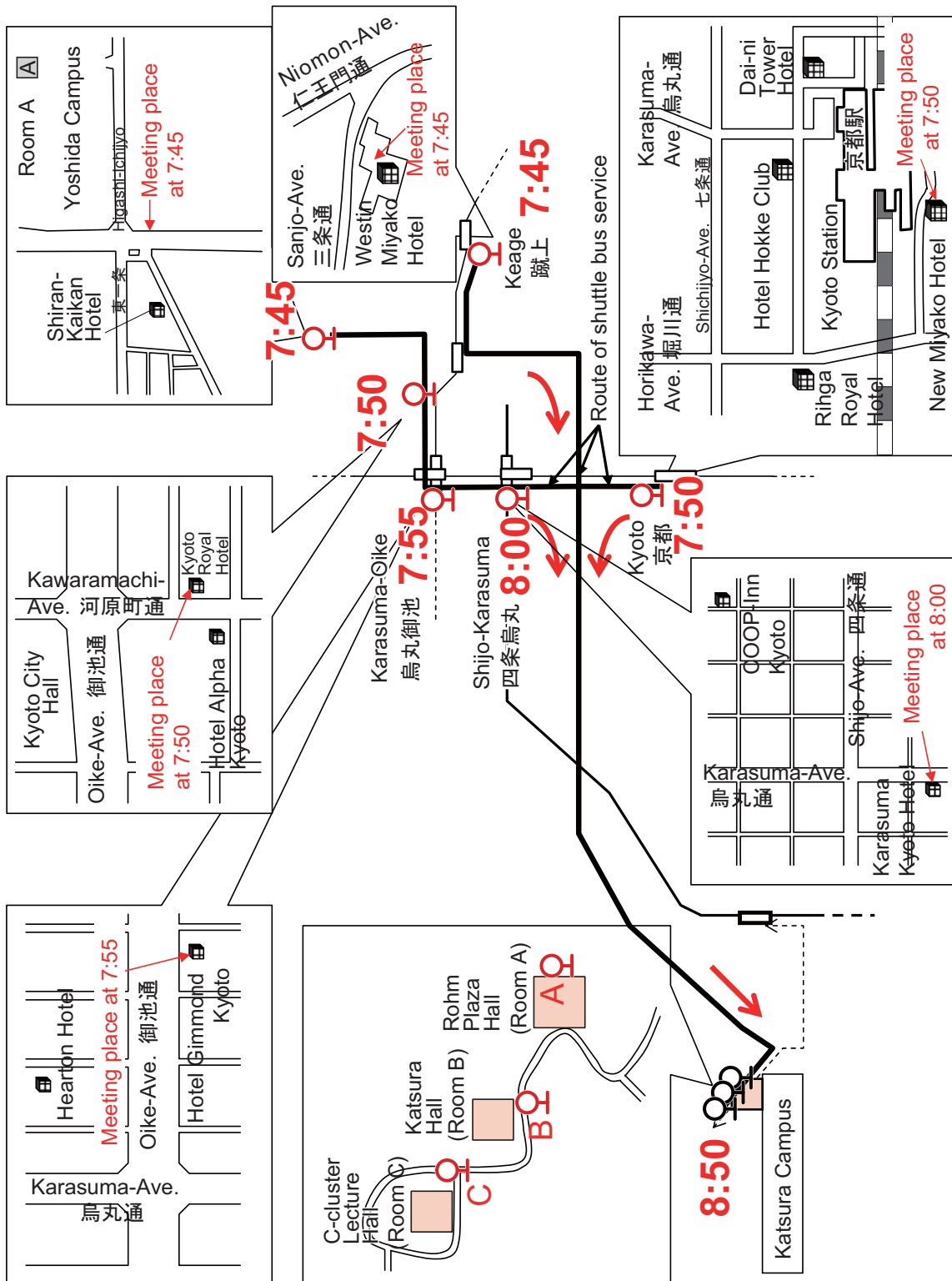

- In the afternoon, all buses for excursions and downtown hotels are departing from Rohm Plaza.
- Participants attending sessions in **Room C** will be transported from stop **C** to Rohm Plaza right after the sessions.

# Katsura Campus: Route Map

Aug. 29 (Wed)

- Reference route for persons coming to the Katsura Campus by themselves from hotels in downtown.
  - Take Hankyu-Railway trains for **Umeda** at Shijo-Karasuma (**Karasuma** station) or Shijo-Kawaramachi (**Kawaramachi** station).
  - Get off at **Katsura** station and go to the bus terminal at west side (**Nishi-guchi**).
  - Take City bus **#West 6 (西 6)** or Keihan-Kyoto-Kotsu bus for **Katsurazaka-chuo (桂坂中央)** at the bus stop-1 shown below.

City bus	<b>West #6 (西 6)</b>	8:04, 8:27, 8:50
Keihan-Kyoto-Kotsu bus	for <b>Katsurazaka-chuo (桂坂中央)</b>	8:06, 8:22, 8:36

- Get off at **Kyodai Katsura-Campus-mae** if you are attending sessions at **Room A, Room B** or Cultural Lecture Course (15 min).
- Get off at **Katsura Goryo-zaka** if you are attending sessions at **Room C** (17 min).

\* If you take a taxi from the bus terminal to Katsura Campus, it will take about 10 min and cost approx. JPY 1,000.

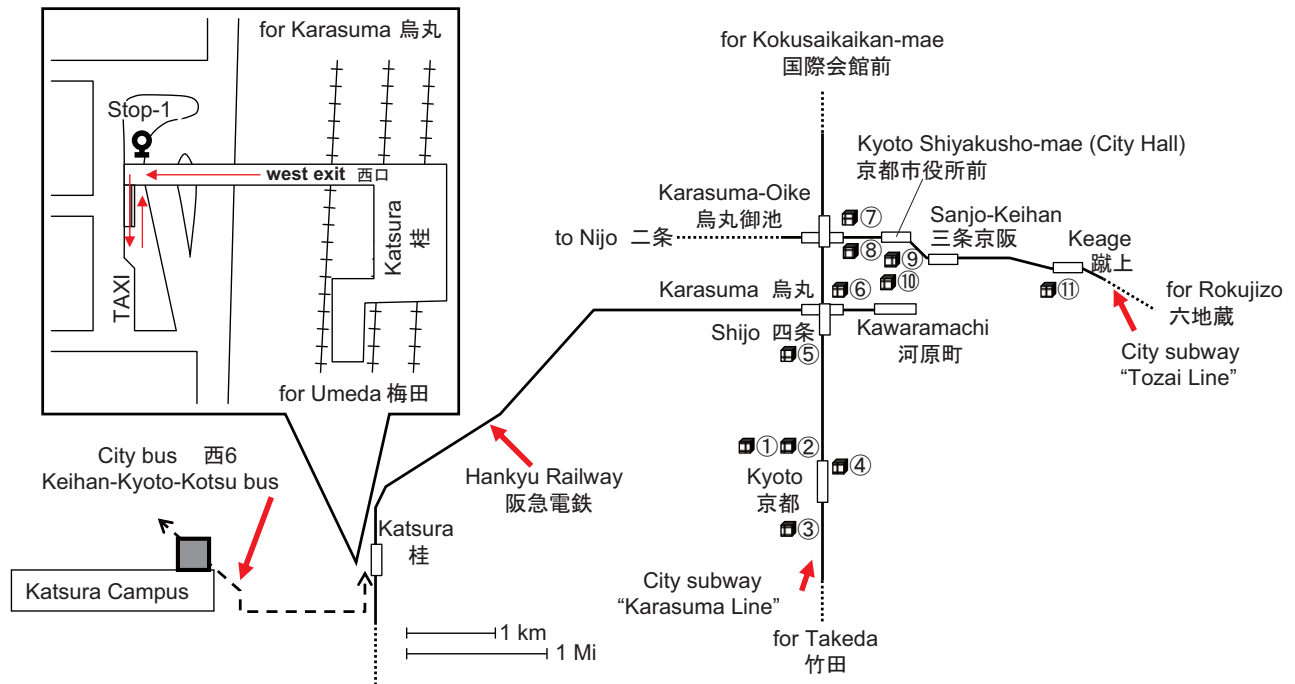

Routes from major hotels to Hankyu-line

① Rihga Royal Hotel ② Hotel Hokke Club ③ New Miyako Hotel ④ Dai-ni Tower Hotel	<b>Kyoto Station</b>	→ City subway → <b>Shijo-Karasuma</b> (Karasuma line)
⑤ Karasuma Kyoto Hotell ⑥ COOP-Inn Kyoto	Hankyu Railway <b>Karasuma</b> Station (walking distance)	
⑦ Hearton Hotel ⑧ Hotel Gimmond Kyoto	<b>Karasuma-Oike</b>	→ City subway → <b>Shijo-Karasuma</b> (Karasuma line)
⑨ Kyoto Royal Hotel ⑩ Hotel Alpha Kyoto	<b>Kyoto Shiyakusho-mae (City Hall)</b>	→ City subway → <b>Karasuma-Oike</b> → City subway → <b>Shijo-Karasuma</b> (Tozai line) (Karasuma line)
⑪ Westin Miyako Hotel	<b>Keage</b>	→ City subway → <b>Karasuma-Oike</b> → City subway → <b>Shijo-Karasuma</b> (Tozai line) (Karasuma line)

**Katsura Campus: Symposium Venue**

**Aug. 29 (Wed)**

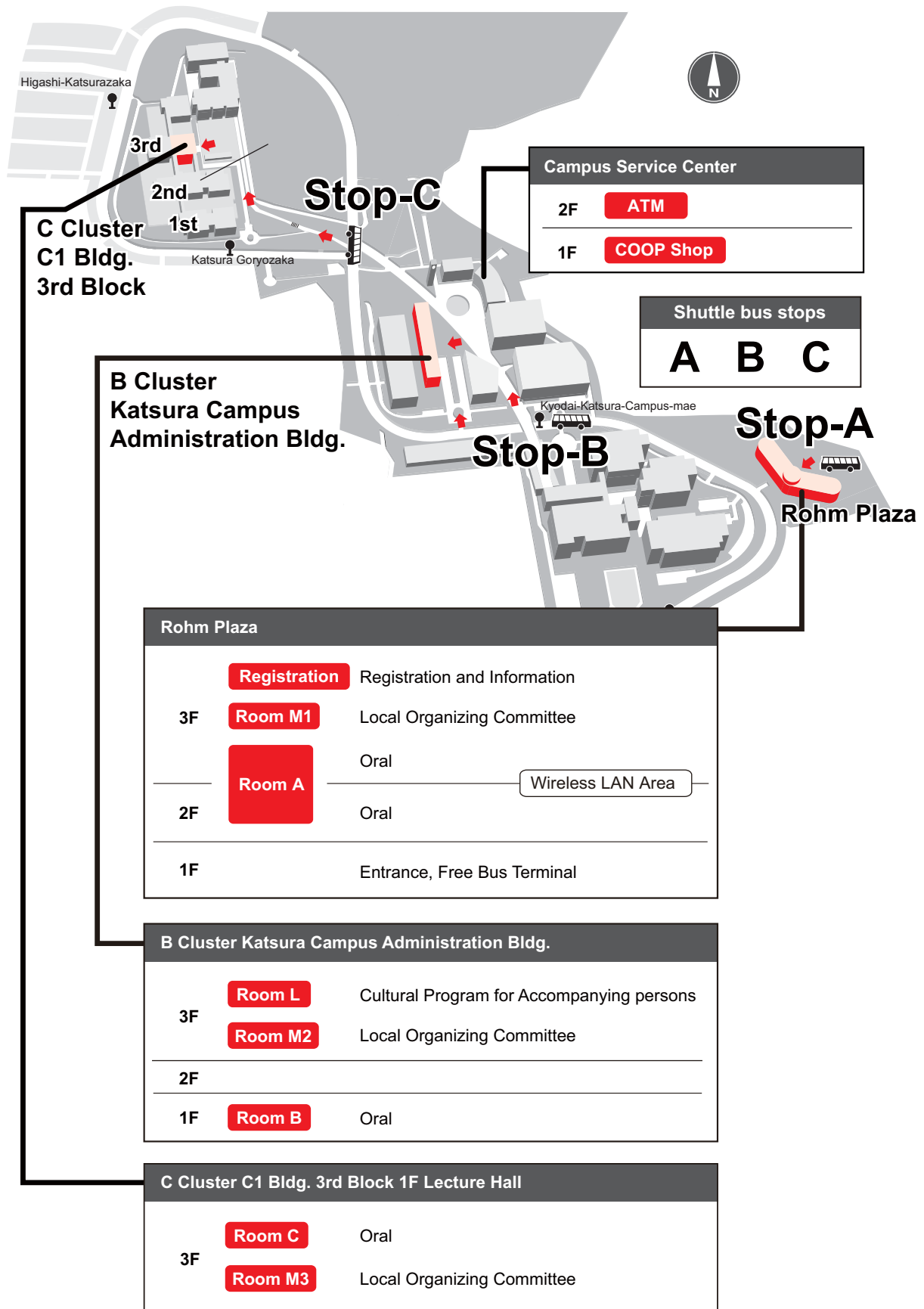

# Katsura Campus: Session Rooms

Aug. 29 (Wed)

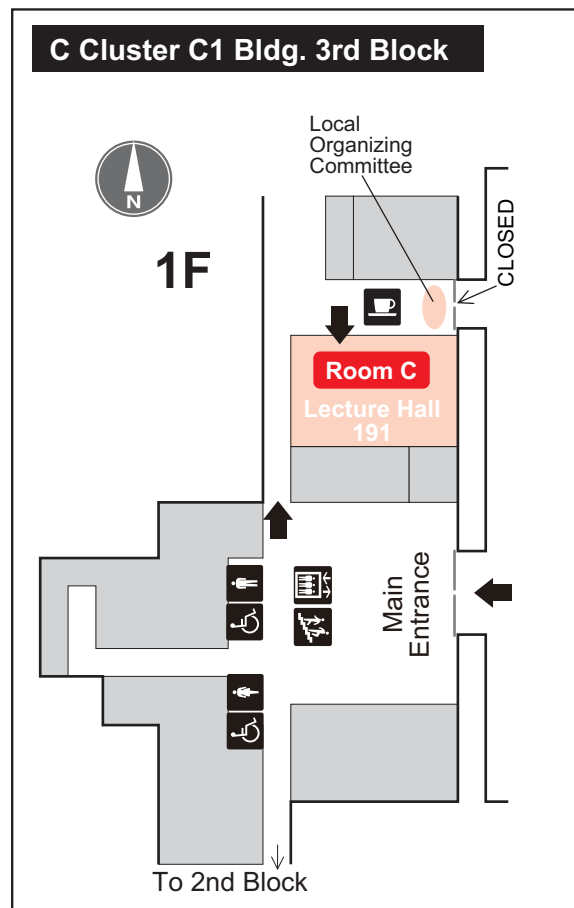
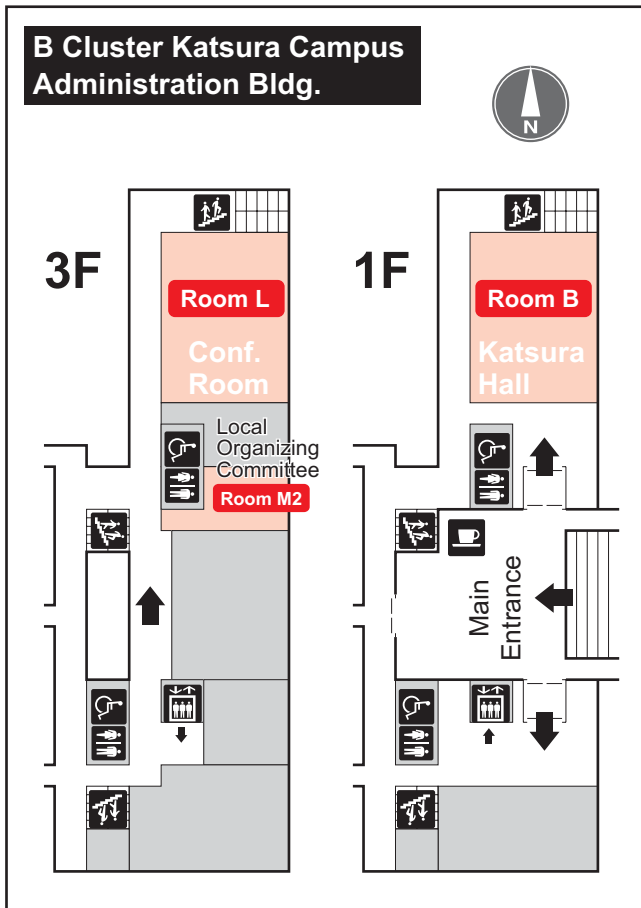
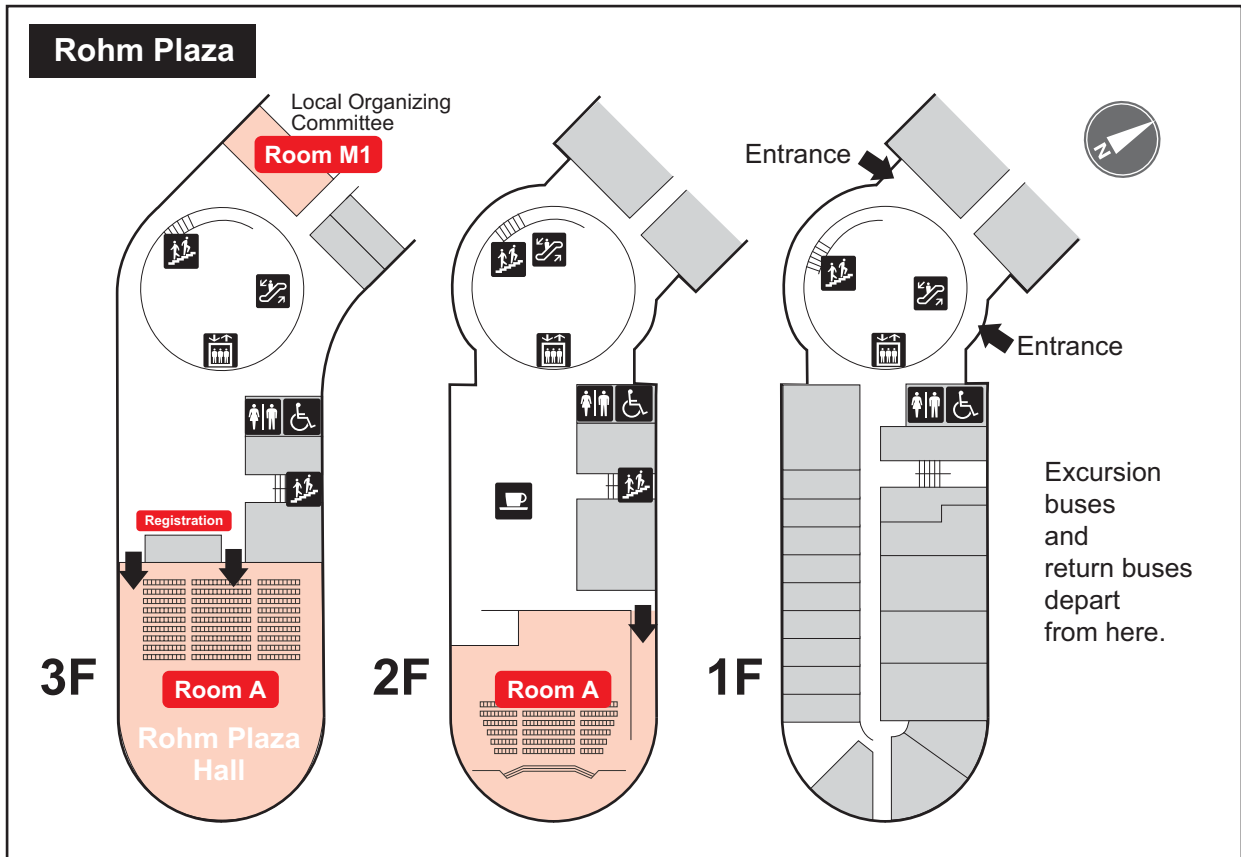

# Yoshida Campus: Poster Room

## Aug. 27 (Mon), 28 (Tue), 30 (Thu)

### • Clock Tower 2F International Conference Hall

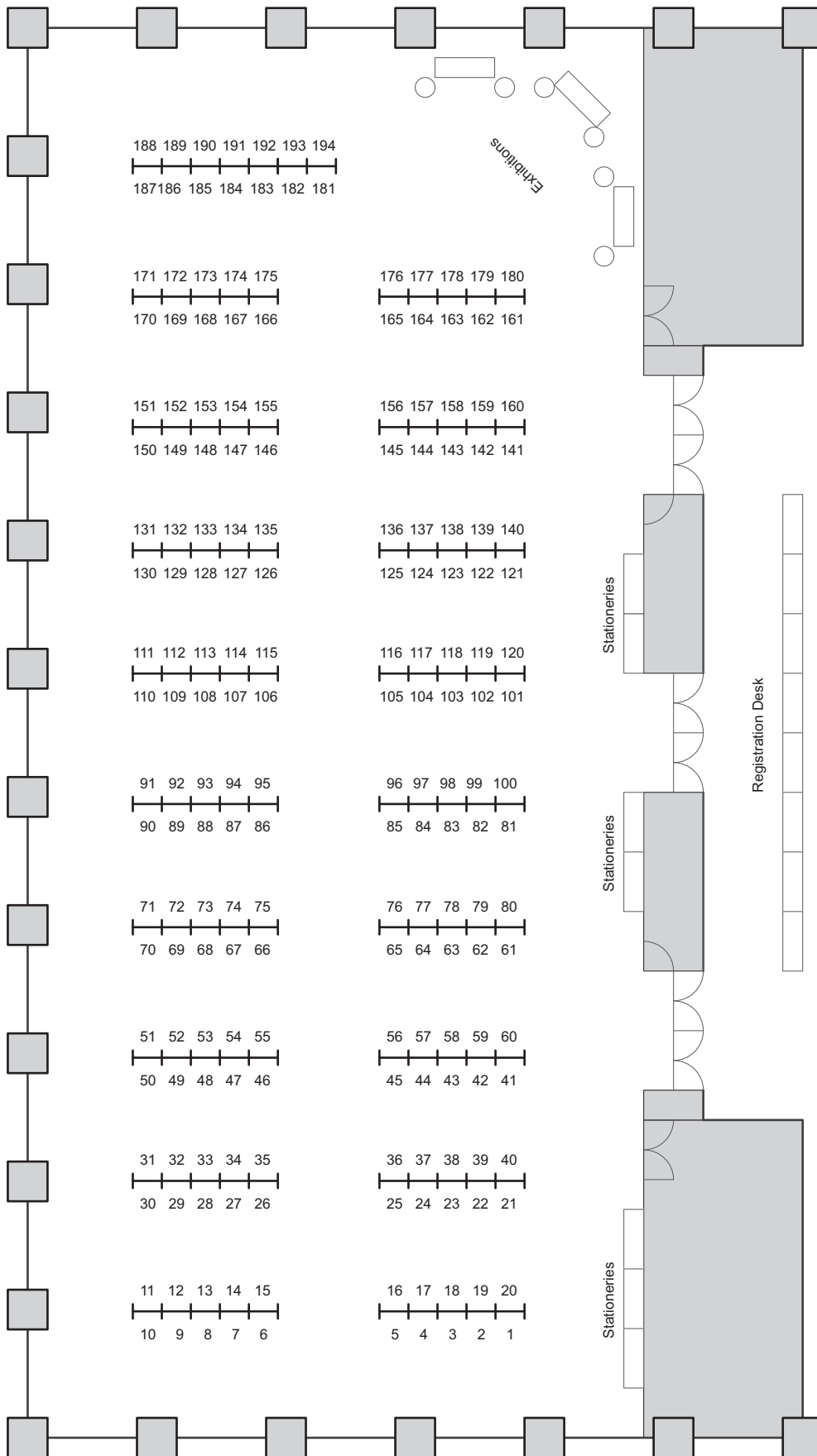

## Yoshida Campus: Room A

## 27 (Mon) Morning

Clock Tower 1F

9:10–13:10

## Opening Celemony (9:10–9:30)

Opening remarks by the chair of ISPC-18

**Kunihide Tachibana**

Greetings from the president of IPCS

**Jean-Michel Pouvesle**

Greetings from the president of IUPAC

**Bryan R. Henry**

Welcome messages from the dean of Graduate School of Engineering, Kyoto University

**Seiichi Nishimoto**Plenary (9:30–10:10) Chair: **K. Tachibana**

Abst. Page

27A-a0 The role of modeling of non-equilibrium plasmas: Scientific curiosity or industrial tool? 1

**Invited****Mark J. Kushner**

Short break (10:10–10:20)

Microdischarges and microplasmas (10:20–11:20) Chair: **B. N. Ganguly & S. Ishii**

Abst. Page

27A-a1 Light emission characteristics of micro plasmas arrays operated under different operational conditions 207  
J. Waskönig, V. Schulz von der Gathen, **J. Winter**, S.-J. Park and J. G. Eden27A-a2 Atmospheric-pressure discharge ignited on flexible electrodes of fabric structure 208  
**O. Sakai**, T. Shirafuji and K. Tachibana27A-a3 Direct current parallel microdischarges in helium 209  
**R. Dussart**, T. Dufour, P. Lefauchaux, P. Ranson, L. Overzet, J.-B. Lee, M. Mandra and N. Sadeghi

Coffee break (11:20–11:40)

Microdischarges and microplasmas (11:40–13:10) Chair: **S. Ishii & B. N. Ganguly**

Abst. Page

27A-a4 Low-voltage APP-generation by piezo ceramics: a new (r)evolutionary enabling technology 210  
**Invited** Markus Teschke and **Jürgen Engemann**27A-a5 Low-temperature non-thermal micro plasma jets for chemical reactions in liquids 211  
**K. Kitano** and S. Hamaguchi27A-a6 Microplasma used as micro reactor for depollution 212  
X. Aubert, A. Pipa, J. Ropcke and **A. Rousseau**27A-a7 Discharge modes of microplasma with miniature gas flow 213  
**K. Nanno**, T. Yamauchi, S. Ibuka, K. Yasuoka and S. Ishii

Lunch (13:10–14:10)



## Yoshida Campus: Room B

27 (Mon) Morning

Law &amp; Economics 1F South-East

9:10–13:10

## Opening Celemony (9:10–9:30) Remote AV

Opening remarks by the chair of ISPC-18

**Kunihide Tachibana**

Greetings from the president of IPCS

**Jean-Michel Pouvesle**

Greetings from the president of IUPAC

**Bryan R. Henry**

Welcome messages from the dean of Graduate School of Engineering, Kyoto University

**Seiichi Nishimoto**

## Plenary (9:30–10:10) Remote AV

Abst. Page

27A-a0	The role of modeling of non-equilibrium plasmas: Scientific curiosity or industrial tool?	1
<b>Invited</b>	<b>Mark J. Kushner</b>	
	Short break (10:10–10:20)	

## Plasma sources: designs and characterizations (10:20–11:20) Chair: Y. Setsuhara &amp; G. Dinescu

Abst. Page

27B-a1	Molecular discharge lamps <b>W. Stoffels</b> and H. Mulders	265
27B-a2	Laser-induced fluorescence measurements in an inductively coupled plasma reactor <b>B. Jacobs</b> , W. Gekelman, M. Barnes and P. Pribyl	266
27B-a3	Ionization processes in a Grimm type source used in pulsed r.f.-glow-discharge time-of-flight mass spectrometry A. Tempez, N. Bordel, M. Hohl, L. Lobo, J. Orphal, C. Diplasu, A. Surmeian, <b>M. Ganciu Petcu</b> and T. Nakamura	267
	Coffee break (11:20–11:40)	

## Plasma sources: designs and characterizations (11:40–13:10) Chair: G. Dinescu &amp; Y. Setsuhara

Abst. Page

27B-a4	Non-thermal atmospheric pressure discharges, and their applications in energy systems, biology and medicine <b>Invited Alexander Fridman</b>	268
27B-a5	Development and characteristics of fast atom source <b>Y. Hara</b> , S. Takashima, K. Yamakawa, S. Den, H. Kano, H. Toyoda, H. Sugai and M. Hori	269
27B-a6	Low temperature deposition of mixed phase Si:H thin films by multi-hole-cathode VHF-PECVD <b>C. Jariwala</b> , A. Chainani, R. Eguchi, M. Matsunami, S. Shin, P. Kikani, S. Bhatt, K. L. Narasimhan, V. Dalal and P. I. John	270
27B-a7	Hybrid plasma process for the synthesis of metal nanoparticle-ethylene glycol nanofluids <b>J. Tavares</b> and S. Coulombe	271
	Lunch (13:10–14:10)	

## Yoshida Campus: Room C

27 (Mon) Morning

Law & Economics 1F North-East		10:20–13:10
<b>Plasma deposition of inorganic films and hard coatings (10:20–11:20) Chair: F. Arefi-Kohsari &amp; A. Hatta</b>		
		Abst. Page
27C-a1	In-situ X-ray scattering studies during Si film deposition by mesoplasma CVD <b>J. M. A. Diaz</b> , M. Kambara and T. Yoshida	355
27C-a2	Organosilicon plasma deposition on microstructured substrate by microwave low pressure discharge and atmospheric pressure Townsend-like discharge <b>I. Savin de Larclause</b> , N. Gherardi, I. Enache, H. Caquineau, Y. Segui, F. Massines and P. Raynaud	356
27C-a3	Full surface wafer coating and direct patterning through localized SiO <sub>2</sub> CVD enhanced by atmospheric plasma at low temperature <b>E. Debourg</b> , <b>F. Benhalima</b> and T. Sindzingre	357
Coffee break (11:20–11:40)		
<b>Plasma deposition of inorganic films and hard coatings (11:40–13:10) Chair: A. Hatta &amp; F. Arefi-Kohsari</b>		
		Abst. Page
27C-a4	Synthesis of functional TiO <sub>2</sub> -based nanoparticles in RF induction thermal plasma <b>Takamasa Ishigaki</b> and Ji-Guang Li	358
27C-a5	Supported Ag@TiO <sub>2</sub> core-shell nanofibers synthesized by low temperature plasma enhanced CVD <b>A. Borrás</b> , A. Barranco, J. Cotrino, J. P. Espinos, F. Yubero and A. R. Gonzalez-Elipe	359
27C-a6	Ion energy and ion flux control during deposition of thin oxide films <b>M. C. M. van de Sanden</b> , A. Milella, I. Volintiru, B. Kniknie, M. Blauw and M. Creatore	360
27C-a7	Carbon nanotube and WO <sub>3</sub> hybrid NO <sub>x</sub> gas sensor for environmental monitoring <b>M. M. H. Bhuiyan</b> , H. Norimatsu, F. Mitsugi and T. Ikegami	361
Lunch (13:10–14:10)		

## Yoshida Campus: Poster

## 27 (Mon) Afternoon

Clock Tower 2F (180 posters)

14:10–15:50

## Plasma deposition of inorganic films and hard coatings

Abst. Page

27P-1	Properties of SiCN films prepared by cathode coupled PE-CVD using liquid source material Y. Kusuda, D. Katayama, A. Ogishi, T. Minaguchi, S. Motoyama and O. Tsuji	369
27P-2	X-Ray diffraction study of cubic- and hexagonal-boron-nitride thin films grown by inductively-coupled-plasma-Enhanced chemical vapor deposition K. Nakamura, S. Hirano, K. Inaba, K. Nose and T. Yoshida	370
27P-3	Fabrication of carbon nanotube based gas sensor with TiO <sub>2</sub> photocatalytic nanoparticle composites using plasma processes T. Ueda, H. Norimatsu, S. Katsuki, M. Bhuiyan, K. Ebihara and T. Ikegami	371
27P-4	Using plasma sources of jet types for deposition of thin TiO <sub>x</sub> layers M. Chichina, V. Stranak, P. Virostko, J. Olejnicek, P. Adamek, O. Churpita, S. Kment, Z. Hubicka, M. Tichy and P. Āāpatenka	372
27P-5	Microstructural control of amorphous and crystalline TiO <sub>2</sub> thin films deposited by remote microwave PECVD A. Borrás, A. Barranco, J. Cotrino, J. P. Espinos and A. R. Gonzalez-Elipe	373
27P-6	Real time study of the interaction of silicon (001) with atomic hydrogen G. V. Bianco, M. M. Giangregorio, M. Losurdo, P. Capezzuto and G. Bruno	374
27P-7	Growth of $\mu\text{c-Si:H}$ stimulated by LiF thin film at the boundary conditions of PECVD J. Stuchlík, T. H. Stuchlíková, S. Honda, K. Hruška, T. Mates, A. Fejfar and J. Kočka	375
27P-8	The effect of bias voltage on depositing Si-based thin films with nano structure by atmospheric plasma-enhanced chemical vapor deposition L. Xia, Q. Zhou and J. Zhang	376
27P-9	Microwave plasma CVD of Si:H:Cl films from chlorinated materials for large area electronics K. Saha, N. Ohse, K. Hamada and H. Shirai	377
27P-10	Low temperature synthesis of high functional carbon and related materials using non-equilibrium CO plasma S. Mori, H. Hattori and M. Suzuki	378
27P-11	Effects of NH <sub>3</sub> and NH <sub>3</sub> .H <sub>2</sub> O on the growth of carbon nanotubes by high pressure DBD plasma Y. Fu, Q. Chen, Y. Zhang and C. Zhang	379
27P-12	Deposition of diamond-like carbon and amorphous boron nitride films using nanopulse magnetron chemical vapor deposition method M. Saito, T. Saito, Y. Kondo, H. Murakami and N. Ohtake	380
27P-13	High density plasma production with effects of hollow-cathode and high secondary-electron-emission for a-C: H thin film preparation Y. Ohtsu, C. Nakamura, H. Fujita, M. Akiyama and T. Tabaru	381
27P-14	Si- and W-containing carbon based nanocomposite thin films: chemical and nanomechanical properties I. Bertóti, M. Mohai, A. Tóth, T. Ujvári, J. Szépvölgyi, M. Veres and G. Radnóczy	382
27P-15	Structure and properties of DLC:SiO <sub>x</sub> films deposited in CW and pulsed HMDSO/CH <sub>4</sub> plasmas A. Granier, B. Angleraud, T. Begou, C. Duquenne, M. A. Djouadi, X. Feng, V. Bursickova and L. Zajickova	383
27P-16	Phase control and electrical properties of undoped and nitrogen-doped nanodiamond films deposited from Ar-rich microwave plasmas T. Ikeda, K. Takeguchi and K. Teii	384
27P-17	Preparation of super-hydrophobic films using pulsed hexafluorobenzene plasma S.-H. Yang, H. Chen, C.-H. Liu, C.-H. Su and S. Lin	385
27P-18	Structural and bonding characteristics of hydrogenated amorphous carbon films prepared by plasma-enhanced chemical vapor deposition J. Huran, I. Hotovy, J. Petzold, P. Bohacek, N. I. Balalykin and A. P. Kobzev	386
27P-19	Permanent surface hydrophilization of polycarbonate sheets by atmospheric pressure plasma (APP) G. Rombolà, C. Pavan, F. Parisi, D. Daprà, S. Gross and R. Buscaino	387
27P-20	Structure and properties of carbon thin films deposited using thermionic vacuum arc (TVA) method R. Vladioiu, G. Musa, V. Ciupina and V. Bursikova	388
27P-21	Deposition of aluminum oxide film on polycarbonate substrate by inductively coupled plasma assisted reactive sputtering H. Kim, H. Y. Lee, D. S. Jang and J. J. Lee	389
27P-22	NiO nanostructured films with Au coating prepared by modified magnetron sputtering I. Hotovy, J. Huran, L. Spiess, H. Romanus, V. Rehacek and D. Buc	390
27P-23	Properties of Ag-Al <sub>2</sub> O <sub>3</sub> thin films deposited by thermionic vacuum arc (TVA) technology G. Musa, N. Ekem, S. Pat, M. Balbag and R. Vladioiu	391

27P-24	Effects of electrolyte on plasma electrolytic oxide coatings on aluminum alloy <b>Y. Zhang</b> , L. Yang, Q. Chen, Z. Wang and Y. Fu	392
27P-25	Ag doped WO <sub>3</sub> thin film gas sensors prepared by pulsed laser deposition <b>M. M. H. Bhuiyan</b> , S. Kastuki, T. Ueda, T. Ikegami and K. Ebihara	393
27P-26	Plasma-assisted MOCVD growth of Er <sub>2</sub> O <sub>3</sub> thin films <b>M. M. Giangregorio</b> , M. Losurdo, A. Sacchetti, P. Capezzuto and G. Bruno	394
27P-27	Growth of high- <i>k</i> oxides thin films in low pressure plasma E. Angelini, <b>S. Grassini</b> , A. Carullo, A. Palma, F. Fracassi, F. Palumbo and R. d'Agostino	395
27P-28	Sputter-deposition of aluminum-doped zinc oxide thin films assisted by inductively coupled plasma S. Iwai, <b>Y. Matsuda</b> , M. Shinohara and H. Fujiyama	396
27P-29	Deposition of ZnO in energy-controlled O <sub>2</sub> /Ar hollow-type magnetron RF discharge plasma <b>H. Ono</b> and S. Iizuka	397
27P-30	Structural and surface study of SnO <sub>2</sub> thin films prepared by RF magnetron sputtering <b>J. Pavlik</b> , Z. Stryhal, J. Matousek, T. Vagner and P. Hedbavny	398
27P-31	Sputter deposition of transparent conducting films exhibiting high-temperature ferromagnetism <b>K. Tanabe</b> , T. Nakamura and K. Tachibana	399
27P-32	O-atom kinetics in pulsed O <sub>2</sub> /HMDSO ICP plasmas A. Bousquet, <b>A. Granier</b> , G. Cartry, A. Gouillet and T. Begou	400
27P-33	Radical transport in a PECVD process at atmospheric pressure <b>I. Enache</b> , H. Caquineau, N. Gherardi, T. Paulmier, L. Maechler and F. Massines	401
27P-34	The growth principle of the microcrystal of the silica coated layer by PDPs Y. Sun, Y. Fu, <b>Q. Chen</b> , C. Zhang and Y. Zhang	402
27P-35	The properties of the silicon oxide barrier film deposited by PDPs Y. Sun, Y. Fu, <b>Q. Chen</b> , C. Zhang and Y. Zhang	403
27P-36	The SiO <sub>x</sub> film deposited in magnetized plasmas <b>Q. Chen</b> , Y. Sun, Y. Fu, Y. Zhang and Y. Liu	404
27P-37	Simplified 2D transient modeling of splat formation: application to zirconia K. Fataoui, B. Pateyron, M. El Ganaoui and <b>P. Fauchais</b>	405
27P-38	Deposit of high purity multi-compounds thin layers in a low pressure plasma process for SOFC or thermal barrier application <b>S. Awamat</b> , F. Rousseau, D. Morvan and J. Amouroux	406
27P-39	Discharge power dependence of H atom density in rf discharges for anisotropic CVD of Cu <b>J. Umetsu</b> , K. Koga and M. Shiratani	407
27P-40	Plasma deposited nanocomposite C-S-Au thin film and their unique properties <b>S. Morita</b> , M. Suzuki, A. Amassian, O. Zabeida and L. Martinu	408
27P-41	Investigation of the mechanical properties of the thin tungsten films deposited by thermoionic vacuum arc (TVA) method <b>R. Vladoiu</b> , G. Musa, V. Ciupina, V. Bursikova, J. Bursik and O. Bláhová	409

#### Plasma deposition and treatment of polymers

Abst. Page

27P-42	Etching properties of carbon nanowalls fabricated using radical injection plasma enhanced CVD <b>S. Kondo</b> , K. Yamakawa, M. Hiramatsu and M. Hori	435
27P-43	The structure and electric conduction of carbon nanowalls using radical injection plasma enhanced CVD <b>W. Takeuchi</b> , M. Ura, Y. Tokuda, M. Hiramatsu, H. Kano and M. Hori	436
27P-44	Transcription of carbon nanowall pattern into SiO <sub>2</sub> film <b>A. Noda</b> , M. Hiramatsu and M. Hori	437
27P-45	The improvement of field emission from carbon nanowalls by hydrogen plasma treatment <b>T. Obayashi</b> , K. Yamakawa, H. Kano, M. Hiramatsu and M. Hori	438
27P-46	Effect of kinds of substrates on the growth of carbon nanowalls <b>S. Maruyama</b> , K. Yamakawa, H. Kano, H. Mineo and M. Hori	439
27P-47	Radical density measurements in VHF fluorocarbon/hydrogen plasma with radical injection used for carbon nanowall fabrication <b>S. Kato</b> , H. Sasaki, S. Takashima, K. Yamakawa, M. Hiramatsu and M. Hori	440
27P-48	Carbon nanowalls with dispersed nanometal particles and evaluation of the field emission properties <b>T. Machino</b> , M. Nakamura, K. Yamakawa, M. Hiramatsu and M. Hori	441
27P-49	Growth of carbon nanowalls using electron beam excited plasma-enhanced chemical vapor deposition <b>T. Mori</b> , M. Hiramatsu, K. Yamakawa, K. Takeda and M. Hori	442
27P-50	Growth and characterisation of thin organic coatings deposited by vacuum-ultraviolet (VUV) photo-polymerisation F. Truica-Marasescu, S. Pham and <b>M. R. Wertheimer</b>	443

27P-51	Observing large negative ions in pulsed polymerising acrylic acid plasmas <b>J. Bradley</b> , I. Swindells, S. Voronin and M. Alexander	444
27P-52	Micro-patterned surface potential of allylamine plasma polymers tuned by nanoprobe chemistry <b>A. Choukourov</b> , A. Grinevich, M. Drabik, D. Slavinska, H. Biederman, N. Saito and O. Takai	445
27P-53	Optical constants of plasma-polymerized tetravinylsilane films <b>B. Cechalova</b> , J. Studynka and V. Cech	446
27P-54	Effect of discharge power to optical properties of atmospheric pressure plasma polymerized pyrrole nanoparticles <b>P. Yang, J. Zhang</b> , Y. Guo and X. Fang	447
27P-55	Composite Sn or SnO <sub>2</sub> /hydrocarbon plasma polymer thin films and their basic properties <b>J. Matousek</b> , J. Pavlik, H. Biederman, Z. Stryhal, T. Vagner and A. Zoulova	448
27P-56	Deposition of Teflon-like coatings using pulsed dc and rf discharges and their comparison S. Akkireddy, N. Tanwani, P. Kikani and <b>S. Nema</b>	449
27P-57	Physical versus chemical properties of plasma-polymerized a-SiOC:H films <b>V. Cech</b> , J. Studynka, B. Cechalova, D. Bussey, F. Jones, V. Perina and J. Zemek	450
27P-58	Nanoindentation measurements of plasma polymer films <b>V. Cech</b> , D. Bussey, J. Studynka and F. Jones	451
27P-59	Morphological characterization of plasma deposited polystyrene coatings <b>M. Haidopoulos</b> , F. Mirabella, M. Horgnies, C. Volcke, P. Thiry, P. Rouxhet and J.-J. Pireaux	452
27P-60	Study of poly(methylmethacrylate) sheets treated by Ar, O <sub>2</sub> /Ar and N <sub>2</sub> /Ar atmospheric-pressure plasmas <b>C.-H. Liu</b> , C.-H. Su, C.-W. Chen, W.-T. Hsu, S.-H. Yang, H. Chen and S. Lin	453
27P-61	Atmospheric plasma enhanced functional coatings for roll-to-roll products <b>J. Nikkola</b> , K. Näntinen, J. Mannila, M. Kallio, J. Vartiainen, E. Hurme, J. Kuusipalo, M. Tuominen, K. Lahtinen and J. Lahti	454
27P-62	Surface modification of polystyrene by plasma polymers of isopropanol or hexamethyldisilazane <b>L. Hong-ru</b> , C. Ko-shao, M.-Y. Wu, T.-C. Hung and S.-C. Chen	455
27P-63	Deposition of a-C:H polymer films with variable roughness and wettability in pulsed low-pressure RF discharge <b>N. Bibinov</b> and K. Wieseemann	456
27P-64	Dimethylamminosilanes plasmas for SiCN films deposition:FT-IR study of plasma and solid phase <b>R. Di Mundo</b> , R. d'Agostino, F. Fracassi and F. Palumbo	457
27P-65	Plasma deposition of acrylic acid on PS beads in a fluidized bed reactor R. Jafari, <b>M. Tatoulian</b> and F. Arefi-Khonsari	458
27P-66	Plasma enhanced CVD of thin films using hexamethyldisiloxane and octamethyltetrasiloxane monomers <b>L. Zajickova</b> , Z. Kucerova, D. Franta, V. Bursikova, P. Stahel, J. Bursik and P. Klapetek	459
27P-67	Deposition of amorphous fluorocarbon films by C <sub>8</sub> F <sub>18</sub> /Ar plasma-enhanced chemical vapor deposition and their chemical properties <b>H. Koike</b> , T. Yamauchi, Y. Sakai, H. Sugawara and Y. Suda	460
27P-68	Nanocomposite Ti/hydrocarbon plasma polymer films from reactive magnetron sputtering <b>A. Grinevich</b> , A. Choukourov, Y. Pihosh, D. Slavinska and H. Biederman	461
27P-69	Improved silica particle adhesion on plasma modified polyethylene films for composite applications <b>D. Pappas</b> , A. Bujanda, J. D. Demaree, J. Hirvonen, J. Orlicki, R. Jensen and S. Mcknight	462
27P-70	The effect of frequency on the electrical and energetic properties of a DBD for SiO <sub>x</sub> film deposition <b>R. Maurau</b> , D. Duday, H. N. Migeon, J. Amouroux and F. Arefi-Khonsari	463
27P-71	Influence of pretreatment on the deposition of SiO <sub>x</sub> diffusion barrier coatings on polypropylene substrate <b>L. Körner</b> , A. Sonnenfeld and P. Rudolf von Rohr	464
27P-72	Applications of plasma processes in the fabrication of metal microstructures on polymer substrates by selective electroless deposition F. Bessueille, S. Gout, Y. Goepfert, <b>M. Romand, M. Charbonnier</b> , N. Jaffrezic-Renault and D. Leonard	465
27P-73	The interaction of CO <sub>2</sub> laser pulses with polymer films <b>D. Dorrnian</b> , F. Torkaman, A. H. Sari and M. Ghoranneviss	466
27P-74	Influence of thermal annealing on morphology and structural properties of Al-Cu-N thin films deposited by DC magnetron plasma <b>M. Ghoranneviss</b> , A. H. Sari, D. Dorrnian, S. Valyniya and A. Hojabri	467
27P-75	Effect of electron beam irradiation on low density polyethylene (LDPE) films <b>M. Ghoranneviss</b> , A. H. Sari, D. Dorrnian, N. Bolouki, S. Davoudi and A. Hojabri	468
27P-76	Analysis of surface Hardness improvement by using ion and electron irradiation <b>T. Masaki</b> , T. Iwao and M. Yumoto	469

27P-77	Treatment of fluoropolymers by hydrogen LF-plasma: plasma and surface analysis W. Michaeli, <b>D. Binkowski</b> , F. von Fragstein and A. Hegebart	470
27P-78	Selective surfaces modification of polyethersulfone by microwave CF <sub>4</sub> plasma <b>M.-J. Chuang</b> , H.-F. Huang and C.-H. Wen	471
27P-79	Decontamination treatment using radio frequency (RF) HF plasma of the cultural heritage objects <b>E. G. Ioanid</b> , S. Dunca, A. Ioanid, D. Rusu and A. Muresan	472
27P-80	Aerosol and underwater plasma for polymer surface functionalization <b>R. Mix</b> , R.-D. Schulze, R. Joshi, A. Meyer-Plath and J. F. Friedrich	473
27P-81	Influence of the spatial distribution of reactive species on the surface modification of polymers by DBD R. Cazan, A. Chiper, <b>G. Borcia</b> and G. Popa	474
27P-82	Rapid improvement of polymer film hydrophilicity by high density microwave plasma Y. Takagi, Y. Gunjo, <b>H. Toyoda</b> and H. Sugai	475
27P-83	Approach to the Stabilization of plasma Aminofunctionalized polystyrene surfaces <b>M. Brueser</b> , B. Finke, K. Schröder and A. Ohl	476
27P-84	Surface analysis of corona discharge treated polypropylene films Z. Ziari, S. Sahli, A. Bellel, <b>I. Savin de Larclause</b> , Y. Segui and P. Raynaud	477
27P-85	Selective functionalization of UHMW-PE using atmospheric DBD plasma J. Yim, G. Palmese, <b>A. Fridman</b> , V. Vasilets, J. Hirvonen, J. D. Demaree and D. Pappas	478
27P-86	Plasma pre-treatment for silver electroless metallization of polymers S. Gout, F. Bessueille, Y. Goepfert, <b>M. Romand</b> , <b>M. Charbonnier</b> , N. Jaffrezic-Renault and D. Leonard	479
27P-87	Strategies for the evaluation of x-ray photoelectron spectroscopy data after chemical derivatization of surface functional groups <b>A. Meyer-Plath</b> and J. F. Friedrich	480
27P-88	Plasma activation and deactivation mechanisms of polymers <b>U. Cvelbar</b> , M. Mozetič and I. Junkar	481
27P-89	Surface modification of polymer films in a triode glow discharge <b>M. Kusabiraki</b> , A. Tamura and T. Kawai	482
27P-90	Reduction of hydrophobic recovery of PET surface modified by plasma treatment using electron-beam-excited plasma source <b>K. Taniguchi</b> , M. Saegusa, K. Gotoh, M. Shindo and T. Hara	483
27P-91	Modification of PET foils by high energy ion irradiation and plasma treatments I. Luciu, V. Satulu, M. Ionita, G. Suliman, D. Ghita, L. Nistor, B. Mitu, L. I. Kravets and <b>G. Dinescu</b>	484
27P-92	Dielectric-barrier discharges and its application in polymer surface etching <b>Q. Zhou</b> , L. Xia, J. Xu and J. Zhang	485
27P-93	Atmospheric-pressure plasma treatment characteristics of indium tin oxide thin films C.-H. Su, <b>C.-H. Liu</b> , C.-W. Chen, S. Lin, T.-H. Chen and J.-T. Teng	486
27P-94	Plasma surface modification of low density polyethylene for functionalization in medical devices (IUDS) S. Das, <b>S. Neogi</b> , S. Ray and S. Guha	487
27P-95	Organic coatings using atmospheric pressure dielectric barrier discharge: en route for a straightforward manufacture of bioactive films <b>P. Heyse</b> , S. Paulussen and B. Sels	488
27P-96	Evaluation of surface energetic characteristics of fibres treated by DBD C. Borcia and <b>N. Dumitrascu</b>	489
27P-97	Control of the blood-polymer materials interface by plasma treatments N. Dumitrascu, <b>G. Borcia</b> and C. Borcia	490
27P-98	Bioactivity control of material surface used by surface-wave plasma (SWP) <b>S. Fujita</b> , T. Ishizaki, N. Saito and O. Takai	491
27P-99	Improvement of blood clotting property of chitosan modified by low-temperature ammonia plasma treatment <b>A. Ogino</b> , M. Kral, Y. Sakata, M. Yamashita and M. Nagatsu	492
27P-100	Influence of the composition of carbon film on its anti-bacteria performance <b>H. Zhou</b> , L. Xu, A. Ogino and M. Nagatsu	493
27P-101	Treatment by cold plasma HF for cleaning and protecting textile fabrics from cultural heritage objects <b>A. Muresan</b> , C. Mihailescu, E. Muresan, A. Ioanid and E. G. Ioanid	494
27P-102	Superhydrophobic cotton textile prepared by atmospheric pressure plasma chemical vapor deposition <b>C.-W. Chen</b> , W.-T. Hsieh, C.-H. Liu, C.-H. Lin and K.-Y. Yen	495
27P-103	Wool surface modification by plasma polymerisation of selected organic compounds E. Aimo Boot, G. Benveniste, F. Cartasegna, D. D'Angelo, P. Fileppo, <b>M. Perucca</b> , G. Piacenza and G. Viscardi	496

27P-104	Surface modification of paper in a continuous atmospheric pressure plasma system <b>L. E. Cruz-Barba</b> , A. J. Martinez-Gomez, M. A. Sanchez-Castillo, R. Young and F. Denes	497
27P-105	Surface modification of cellulose-based filter paper by atmospheric plasma for industrial applications E. Aimo Boot, G. Benveniste, F. Cartasegna, O. Chiantore, D. D'Angelo, S. Musciacchio, <b>M. Perucca</b> and G. Piacenza	498
27P-106	Synthesis of hydrophobic layers on wood surface by dielectric barrier discharge treatments at atmospheric pressure M. G. Gutierrez-Cordova, G. Toriz-Gonzalez, V. Gonzalez-Alvarez, P. Gatenholm, A. Wendel and <b>A. J. Martinez-Gomez</b>	499

Biomedical applications		Abst. Page
27P-107	Air sterilization using non thermal plasma <b>N. Vaze</b> , M. Gallagher Jr., V. Vasilets, S. Anandan, A. Gutsol and A. Fridman	675
27P-108	Water sterilization using a pulsed spark plasma discharge <b>K. P. Arjunan</b> , V. Vasilets, A. Gutsol, S. Anandan, Y. Cho and A. Fridman	676
27P-109	Sterilization of penicillium digitatum using nonequilibrium atmospheric pressure plasma <b>S. Iseki</b> , A. Aomatsu, T. Ohta, M. Ito, H. Kano, Y. Higashijima and M. Hori	677
27P-110	Application of microplasma for the treatment of melanoma cells <b>H. J. Lee</b> , H. J. Yoon, C. H. Shon and G.-C. Kim	678
27P-111	Sterilization effect of oxygen radicals produced by inductively coupled plasma using oxygen and water <b>N. Hayashi</b> , S. Tsutsui, T. Tomari and W. Guan	679
27P-112	Inactivation characteristics of bacillus subtilis in low pressure pulsed plasma <b>D. Vicoveanu</b> , Y. Ohtsu and H. Fujita	680
27P-113	Nanosecond pulsed uniform dielectric barrier discharge for medical applications <b>H. Ayan</b> , G. Fridman, A. Gutsol, V. Vasilets, A. Fridman and G. Friedman	681
27P-114	Comparison of direct and indirect effects of non-thermal atmospheric pressure plasma on bacteria and mechanisms of such interaction <b>G. Fridman</b> , A. Gutsol, V. Vasilets, A. Fridman and G. Friedman	682
27P-115	Monitoring plasma sterilization D. Vujošević, <b>U. Cvelbar</b> , M. Mozetič, N. Krstulović, S. Milošević and U. Repnik	683
27P-116	Cold atmospheric plasma sterilization against both microorganisms and protein X. T. Deng, J. J. Shi and <b>M. Kong</b>	684
27P-117	Low temperature internal sterilization of plastic tube using line-shaped dielectric barrier discharge <b>H. Eto</b> , Y. Ono, A. Ogino and M. Nagatsu	685
27P-118	Non-equilibrium dielectric barrier discharge plasma promoting apoptotic behavior in melanoma skin cancer cells <b>G. Fridman</b> , R. Sensenig, S. Kalghatgi, A. Shereshevsky, M. Balasubramanian, A. Gutsol, V. Vasilets, A. Brooks, A. Fridman and G. Friedman	686
27P-119	Decontamination of heat sensitive products by means of plasmas at atmospheric pressure J. Ehlbeck, R. Brandenburg, T. Von Woedtke, U. Krohmann, M. Stieber, K. Rackow, K.-D. Weltmann and <b>A. Ohl</b>	687
27P-120	Bio-decontamination by DC discharges in atmospheric air: Identification of Mechanisms by emission spectroscopy <b>Z. Machala</b> , I. Jedlovsky, M. Janda and K. Hensel	688
27P-121	Plasma based removal of microbial contamination of paper <b>J. Vrajova</b> , I. Prudikova, Z. Raskova and F. Krema	689
27P-122	Experimental comparison of antibacterial effect in cold plasmas at normal atmospheric pressure <b>T. Akitsu</b> , H. Ohkawa, W. Ohhashi, M. Tsuji, H. Murayama and K. Katayama-Hirayama	690
27P-123	Studies on surface sterilization of medical polytetrafluoroethylene by remote oxygen plasma H. Liu, <b>J. Chen</b> , L. Yang and Y. Zhou	691
27P-124	Amino functionalized titanium-a surface for improved osteoblast's function <b>B. Finke</b> , F. Luethen, K. Schröder, B. Nebe, J. Rychly and A. Ohl	692
27P-125	Surface modification of plasma-treated polyethylene with fluorinated alcohols using chlorinated phosphazenes as coupling agents <b>R. Milani</b> , M. Gleria, R. Bertani, R. De Jaeger, A. Mazzah, L. Gengembre and C. Jama	693
27P-126	Surface characterization study of biomer film grafted with sulfobetaine as biomaterial via plasma induced graft polymerization <b>A. Mazzah</b> , D. Hadadj, R. Dejaeger and L. Gengembre	694
27P-127	Culture of hepatocytes on plasma polymerized pyrrole surfaces E. Pérez-Tejada, L. E. Gómez-Quiróz, J. Morales, M. C. Gutiérrez-Ruiz, G. Olayo, G. Cruz and <b>R. Olayo</b>	695
27P-128	Plasma induced creation and analysis of chemical microstructures for cell-based diagnostics <b>H. Steffen</b> , B. Busse, K. Schröder, A. Ohl and K.-D. Weltmann	696



27P-129	Hydrophilic transformation of carbon films prepared by thermionic vacuum arc method <b>A. M. Lungu</b> , P. Chiru, O. Pompilian, E. Dutu, C. P. Lungu, F. Craciunoiu, M. Simion, I. Kleps, G. Prodan, R. Vladoiu, V. Ciupina and G. Musa	697
27P-130	Surface engineering of LDPE sheet by plasma techniques and atom transfer radical polymerization for fabrication of blood-compatible materials <b>Y. Sasai</b> , M. Oikawa, S. Kondo and M. Kuzuya	698
27P-131	Tribological characteristics of DLC coatings on medical steel substrates in body fluid environment M. Paquette, <b>J. Klemberg-Sapieha</b> , L. Martinu, M. Azzi, J. Szpunar, E. Park, K. Taylor and K. Casey	699
27P-132	ICP plasma formation of silica nano powder to be used as a biomedical absorber <b>M. Kogoma</b> , A. Takeda, M. Mio, H. Fukuki, K. Maeyama and K. Tanaka	700
27P-133	PTFE treated by O <sub>2</sub> plasma for biological applications. a contact angle, AFM, OES and XPS study <b>N. Vandecasteele</b> , B. Broze, B. Nisol, P. Viville, R. Lazzaroni, L. G. Gamble, D. Castner and F. Reniers	701
27P-134	Plasma treatment for giving surface biocompatibility of silicone elastomers P. Guo, <b>Q. Chen</b> , S. Xiao, F. Xie and Y. Ge	702
27P-135	Biomolecule immobilization a unique step by plasma polymerization technique <b>E. Akdogan</b> , E. Ozmen, N. Sir and M. Mutlu	703
27P-136	Encapsulation of biomolecules into single-walled carbon nanotubes using electrolyte plasmas <b>T. Kaneko</b> , T. Okada, Y. Hirotsu and R. Hatakeyama	704
27P-137	Eye protective Al doped TiO <sub>2</sub> particle preparation by ICP plasma <b>A. Takeda</b> and M. Makino	705
27P-138	Mechanism of blood coagulation by non-equilibrium atmospheric pressure dielectric barrier discharge plasma <b>S. Kalghatgi</b> , G. Fridman, M. Balasubramanian, M. Peddinghaus, A. Brooks, A. Gutsol, V. Vasilets, A. Fridman and G. Friedman	706
<b>Environmental applications</b>		<b>Abst. Page</b>
27P-139	Synergetic effect in plasma catalytic systems devoted to NO, CH <sub>4</sub> and soot particulates remediation <b>J. L. Hueso</b> , J. Cotrino, A. Caballero, J. P. Espinos and A. R. Gonzalez-Elipe	721
27P-140	Influence of streamer-to-glow transition in NO <sub>x</sub> removal using pulsed power generator with SOS diodes <b>K. Takaki</b> , K. Kanesawa, S. Mukaigawa, T. Fujiwara and T. Go	722
27P-141	Influence of NO initial concentration on removal efficiency in dielectric barrier discharge reactor <b>T. Sato</b> , S. Mukaigawa, K. Takaki and T. Fujiwara	723
27P-142	Influence of packing materials on the electric fields of packed-bed dielectric barrier discharge reactors <b>H.-M. Lee</b>	724
27P-143	Optical emission spectroscopy of microwave flowing discharges of Ar-NO and N <sub>2</sub> -NO gas mixtures <b>J. L. Hueso</b> , J. Cotrino, A. Yanguas-Gil, A. Caballero and A. R. Gonzalez-Elipe	725
27P-144	OES characterization of low pressure surface-wave plasmas of complex mixtures containing N <sub>2</sub> as carrier gas <b>J. L. Hueso</b> , J. Cotrino, A. Caballero and A. R. Gonzalez-Elipe	726
27P-145	Optimization of process parameters for nitric oxide synthesis using pulsed arc discharge <b>K. Ohara</b> , S. Nishimura, K. Ogata, T. Ikegami and K. Ebihara	727
27P-146	Influence of temperature on the oxidation of NO to NO <sub>2</sub> with hydrocarbons addition in nonthermal plasma <b>H.-L. Chen</b> , H.-M. Lee, S.-H. Chen and M.-B. Chang	728
27P-147	Effect of plasma jet and liquid layer interaction conditions for organic compounds oxidation in aqueous solutions <b>A. Samokhin</b> , N. Alexeev and Y. Tsvetkov	729
27P-148	On the decomposition of organic pollutants in water induced by corona discharge above the liquid in a DBD reactor <b>E. Marotta</b> , X. Ren, M. Schiorlin, P. Venturini, M. Rea and C. Paradisi	730
27P-149	Multi-bubble plasma production in liquid for chemistry control <b>T. Ishijima</b> , H. Hotta, M. Sato and H. Sugai	731
27P-150	Generation and application of plasma in supercritical fluids. <b>M. Sasaki</b> , T. Fang, T. Kiyon, T. Saito, T. Morishima, A. Uemura, M. Takade, B. C. Roy, T. Namihira, M. Goto, H. Akiyama and M. Hara	732
27P-151	Sterilization treatment of bacteria by discharge in an aqueous solution and elucidation of the mechanism <b>T. Takeda</b> , P. Baroch, T. Ishizaki, N. Saito, M. Ohta and O. Takai	733
27P-152	Decomposition of persistent substances by pulsed plasmas inside bubbles <b>K. Sato</b> , A. Yamatake, K. Yasuoka and S. Ishii	734
27P-153	Comparison of organic dyes decomposition by DC diaphragm discharge, electrolysis and UV radiation effects <b>Z. Stara</b> , F. Krcma and B. Olexova	735
27P-154	Gliding arc discharge assisted catalytic degradation of bisphenol a in solution with ferrous ions <b>F. Abdelmalek</b> , R. A. Torres, E. Combet, C. Petrier, C. Pulgarin and A. Addou	736
27P-155	Removal of benzene in the Presence of a catalyst in a multistage corona discharge reactor <b>P. Rangsunvigit</b> , W. Kiatubolpaiboon, T. Sreethawong and S. Chavadej	737

27P-156	Degradation of wastewaters by plasmacatalytic process <b>A. Addou</b> , F. Abdelmalek, R. M. Ghezzer and M. Belhadj	738
27P-157	Decomposition of methylene blue by RF plasma in water <b>K. Kurokawa</b> , T. Maehara, I. Miyamoto, Y. Hashimoto, H. Toyota, S. Nomura, M. Kuramoto and A. Kawashima	739
27P-158	Observation of plasma on ePTFE-covered metal rod in ethanol <b>T. Shirafuji</b> , M. Kimura, O. Sakai and K. Tachibana	740
27P-159	Plasma thermal synthesis and plasma technologies at XXI century V. Blokhin, V. Gnedenko and <b>A. Pereslvtsev</b>	741
27P-160	Computer control plasma torch equipment for plasma treatment of waste V. Agafonkin, O. Alpatov, V. Gnedenko, S. Mironchuk, K. Motuzniy, <b>A. Pereslvtsev</b> and S. Tresviatsky	742
27P-161	Using a non-transferred arc air plasma torch for the gasification of waste <b>P. Carabin</b> , P. Chevalier and G. Holcroft	743
27P-162	Mobile type of twin torch plasma arc furnace for medical waste <b>T. Inaba</b> , T. Iwao, M. Yumoto, H.-P. Li and H. Nishiwaki	744
27P-163	Interaction of humic acids thin layers with plasma at atmospheric pressure E. Cechova, M. Klucakova, F. Krcma, P. Majzlík and <b>J. Vrajova</b>	745
27P-164	RF thermal plasma treatment of waste glass: design of the experiment with 3-D modelling and glass reutilization in composite materials <b>V. Colombo</b> , E. Ghedini, F. Andreola, L. Barbieri, E. Fabbri, I. Lancellotti and P. Pozzi	746
27P-165	Solid surface cleaning by R.F. discharge plasma <b>Y. Yoshida</b> , K. Sato and S. Ono	747
27P-166	Plasma treatment of solid waste V. Gnedenko, S. Dmitriev, <b>A. Pereslvtsev</b> and S. Tresviatsky	748
27P-167	RF plasma system for medical waste treatment <b>G. Paskalov</b>	749
27P-168	Ozone production using dielectric barrier discharge reactor driven by pulse generator <b>K. Takaki</b> , T. Sato, K. Arima, S. Mukaigawa, T. Fujiwara and T. Miura	750
27P-169	VOC total oxidation using cycled system. adsorption and oxygen plasma decomposition <b>H.-H. Kim</b> , A. Ogata and S. Futamura	751
27P-170	VOC destruction in atmospheric pressure discharges analysis of the low molecular products H. Grossmannova, <b>J. Vrajova</b> and F. Krcma	752
27P-171	Abatement of perfluorinated greenhouse gases using microwave-generated plasma torch <b>T.-C. Wei</b> and W.-Y. Cheng	753
27P-172	Comparative study between air and nitrogen thermal plasma processes for CF <sub>4</sub> decomposition <b>S. Choi</b> , H. S. Lee, C. M. Lee, J. S. Nam and S. H. Hong	754
27P-173	PFCs abatement system with high efficiency using plasma and CaO under a decompression atmosphere <b>K. Suzuki</b> , Y. Ishihara, K. Sakoda, T. Ohmi and M. Hirayama	755
27P-174	Comparison of the efficiencies and kinetic analysis of the carbon tetrachloride decomposition in RF thermal plasma in inert and oxidative environments <b>T. Kovács</b> , T. Turányi, K. A. Föglein and J. Szépvölgyi	756
27P-175	Atmospheric pressure microwave plasma sources for production of hydrogen <b>M. Jasinski</b> , M. Dors and J. Mizeraczyk	757
27P-176	Plasma modification of catalysts for cathodic reduction of hydrogen peroxide in fuel cells <b>V. Brüser</b> , A. Schmuhl, H. Junge, M.-K. Tse and S. Karsten	758
27P-177	Modification of nanostructures of biological materials using low pressure RF plasma I. Abdullin, <b>L. Abutalipova</b> and V. Zheltukhin	759
27P-178	Low pressure RF plasmas for processes of surface nanolayers formation I. Abdullin, <b>L. Abutalipova</b> , V. Zheltukhin and I. Sagbiev	760
27P-179	Laser measurement of photocatalytic anti-fog effect of TiN/TiO <sub>2</sub> film deposited on glass by plasma processes <b>S. Parajulee</b> , S. Ikezawa, T. Hara and Y. Taga	761
27P-180	Crystalline TiO <sub>2</sub> thin films sputter-deposited on unheated flat and nanostructured substrates <b>Y. Pihosh</b> , I. Turkevych, M. Goto, A. Kasahara and M. Tosa	762

## Yoshida Campus: Room A

## 27 (Mon) Afternoon

Clock Tower 1F

15:50–18:40

**Plasma deposition and treatment of polymers (15:50–17:00) Chair: M. R. Wertheimer**

Abst. Page

27A-p1	Control of plasma polymerization processes	411
<b>Invited</b>	<b>Dirk Hegemann</b>	
27A-p2	The role of ions in thin film deposition in a pulsed acrylic acid RF discharge <b>S. Voronin</b> , M. Zelzer, C. Fotea, M. Alexander and <b>J. Bradley</b>	412
27A-p3	On the film microstructure control by means of plasma enhanced chemical vapor deposition and plasma assisted atomic layer deposition. <b>M. Creatore</b> , N. M. Terlinden, E. Langereis, J. L. Van Hemmen, W. M. M. Kessels and M. C. M. van de Sanden	413
	Coffee break (17:00–17:20)	

**Fundamentals of plasma-surface interactions (17:20–18:40) Chair: S. Neogi**

Abst. Page

27A-p4	Kinetics and transport of Cu and CuCl in Cu film deposition by metal chloride reduction plasma CVD N. Oyama, K. Furuta, Y. Tomita, N. Yahata, H. Sakamoto and <b>K. Sasaki</b>	5
27A-p5	A new concept of adhesion promotion in metal-polymer composites by introduction of covalently bonded hydrophobic spacers at interface <b>J. F. Friedrich</b> , R. Mix, S. Wettmarshausen and H. Sturm	6
27A-p6	Investigation of the alignment layers on fluorinated amorphous carbon films by plasma beam <b>T.-H. Chen</b> , J. Teng, C.-H. Liu, C.-Y. Lee, H. C. Tang, C.-H. Su and S. Lin	7
27A-p7	Application of radio frequency inductively coupled plasma (rf-ICP) in the measurement of physical properties of melts <b>A. Moradian</b> and J. Mostaghimi	8

## Yoshida Campus: Room B

## 27 (Mon) Afternoon

Law & Economics 1F South-East		15:50–18:40
<b>Plasma chemical syntheses (15:50–17:00) Chair: U. Kortshagen &amp; R. Hatakeyama</b>		Abst. Page
27B-p1	Self-assembled nanostructures on plasma-exposed surfaces	543
<b>Invited</b>	<b>Kostya (Ken) Ostrikov</b>	
27B-p2	Effects of hydrogen supply on growth of carbon nanotubes in CH <sub>4</sub> /H <sub>2</sub> plasmas <b>A. Okita</b> , Y. Suda, A. Oda, J. Nakamura, H. Sugawara and Y. Sakai	544
27B-p3	Effects of plasma ion irradiation on synthesis of nitrogen atom encapsulated fullerenes <b>S. Nishigaki</b> , S. Abe, T. Kaneko and R. Hatakeyama	545
Coffee break (17:00–17:20)		
<b>Plasma chemical syntheses (17:20–18:40) Chair: R. Hatakeyama &amp; U. Kortshagen</b>		Abst. Page
27B-p4	Nanostructuring metal bulk materials with reactive plasma <b>U. Cvelbar</b> , K. Ostrikov and M. Mozetič	546
27B-p5	RF thermal plasma synthesis of LaB <sub>6</sub> nanopowders <b>J. Szépvölgyi</b> , I. Mohai, K. A. Föglein, Z. Károly, L. Gál and M. Tóth	547
27B-p6	Synthesis of gold nanoplates and nanorods in aqueous solutions using gas-liquid interface discharge at atmospheric pressure <b>K. Furuya</b> , Y. Hirowatari, T. Ishioka and A. Harata	548
27B-p7	New in-situ sampling and analysis of the production of CeO <sub>2</sub> powders from liquid precursors using a novel wet collection system in a rf inductively coupled thermal plasma reactor <b>I. Castillo</b> and R. Munz	549

## Yoshida Campus: Room C

## 27 (Mon) Afternoon

Law & Economics 1F North-East		15:50–18:40
<b>Plasma processing for micro electronics and mechanics</b> (15:50–17:00) Chair: <b>S. Samukawa</b>		Abst. Page
27C-p1	Electron impact reactions in processing plasma for LSI device fabrications <b>K. Kinoshita</b>	321
27C-p2	Formation of SiN films on Si substrates and OLEDs at low temperature using VHF-CCP and improvement of the properties <b>M. Li</b> , T. Matsubara, K. Takeda, Y. Masumoto, T. Mori, S. Tada, H. Harukawa and M. Hori	322
27C-p3	Spectroscopic characterisation of a preionized high power pulsed magnetron discharge for reactive sputter deposition of conductive RuO <sub>2</sub> thin films <b>D. Benzeggouta</b> , M. Ganciu Petcu, M.-C. Hugon, R. Sireilles and B. Agius	323
Coffee break (17:00–17:20)		
<b>Environmental applications</b> (17:20–18:40) Chair: <b>A. B. Murphy</b>		Abst. Page
27C-p4	Monitoring of the metal accumulation in vegetal tissues by laser induced plasma spectroscopy <b>J. Kaiser</b> , M. Galiova, K. Novotny, M. Liska, L. Reale, R. Malina and K. Palenikova	707
27C-p5	Production of biosyngas by gasification in steam plasma <b>M. Hrabovsky</b> , M. Konrad, V. Kopecky, M. Hlina, T. Kavka, O. Chumak and G. van Oost	708
27C-p6	Syngas production via partial oxidation of methane with plasma-assisted catalysis <b>Y. Chao</b> , M.-B. Chang, H.-M. Lee and C.-T. Huang	709
27C-p7	Diesel fuel reformation with a plasmatron V. Plaksin, <b>S. B. Joa</b> , M. K. Ko and H. J. Lee	710

## Yoshida Campus: Room A

## 28 (Tue) Morning

Clock Tower 1F		9:10–13:10
<b>Plenary (9:10–9:50) Chair: D. B. Graves</b>		Abst. Page
28A-a0	Hollow cathode and hybrid atmospheric plasma sources	2
<b>Invited</b>	<b>Hana Baránková</b> and Ladislav Bardos	
Short break (9:50–10:00)		
<b>Plasma deposition and treatment of polymers (10:00–11:20) Chair: T. Wydeven &amp; O. Takai</b>		Abst. Page
28A-a1	Plasma deposition of functionalized coatings with acid/base properties for biomedical applications <b>E. Sardella</b> , R. Gristina, M. Nardulli, P. Favia and R. d'Agostino	414
28A-a2	Nitrogen-rich plasma polymer films deposited in atmospheric- and low-pressure plasmas for biomedical applications F. Truica-Marasescu, P.-L. Girard-Lauriault, S. Lerouge, F. Mwale, A. Lippitz, W. Unger, P. Desjardins and <b>M. R. Wertheimer</b>	415
28A-a3	An electron paramagnetic resonance study of the creation and recombination of free radicals in plasma polymers <b>C. Oehr</b> , M. Haupt and B. Elkin	416
28A-a4	Stimuli-responsive polymer coating deposited by rf plasma <b>M. Haidopoulos</b> , F. Mirabella, M. Horgnies, P. Rouxhet, J.-F. Gohy and J.-J. Pireaux	417
Coffee break (11:20–11:40)		
<b>Plasma deposition and treatment of polymers (11:40–13:10) Chair: O. Takai &amp; T. Wydeven</b>		Abst. Page
28A-a5	Electron dynamics of low- pressure deposition plasma	418
<b>Invited</b>	<b>Hirotsugu Yasuda</b> , Loic Ledernez, Fethi Olcaytug and Gerald Urban	
28A-a6	Plasma deposition of organosilicon coatings as low-k dielectrics <b>A. Milella</b> , G. Aresta, R. d'Agostino, F. Fracassi and F. Palumbo	419
28A-a7	High rate MW-PCVD process for transparent hard coatings on large PC parts <b>K.-D. Nauenburg</b> , L. Alberts, R. Dreher, M. Kaiser and O. Stahlschmidt	420
28A-a8	Plasma polymers from RF sputtering of nylon <b>J. Hanus</b> , O. Polonskyi, J. Kousal, A. Choukourov, A. Grinevich, D. Slavinska and H. Biederman	421
Lunch (13:10–14:10)		

## Yoshida Campus: Room B

28 (Tue) Morning

Law & Economics 1F South-East		9:10–13:10
<b>Plenary</b> (9:10–9:50) Remote AV		Abst. Page
28A-a0	Hollow cathode and hybrid atmospheric plasma sources	2
<b>Invited</b>	<b>Hana Baránková</b> and Ladislav Bardos	
Short break (9:50–10:00)		
<b>Diagnostics and modeling in plasma chemistry</b> (10:00–11:20) Chair: <b>A. Kono &amp; A. von Keudell</b>		Abst. Page
28B-a1	Modeling nanodusty plasmas L. Ravi, S. Warthesen and <b>S. Girshick</b>	63
28B-a2	Chemical kinetic modeling of the remote plasma source and transport of atomic fluorine for chamber cleaning applications S. Gangoli, A. Johnson, <b>A. Fridman</b> , R. Pearce, A. Gutsol and A. Dolgopolsky	64
28B-a3	Real-time monitoring of anomalous-discharge in a high-density plasma chamber <b>M. Sato</b> , H. Ohtake and S. Samukawa	65
28B-a4	Improvement of accuracy for measurements of electron density and electron temperature with dual surface wave probes <b>K. Nakamura</b> , O. Hirano, H. Sugai and K. Kinoshita	66
Coffee break (11:20–11:40)		
<b>Diagnostics and modeling in plasma chemistry</b> (11:40–13:10) Chair: <b>A. von Keudell &amp; A. Kono</b>		Abst. Page
28B-a5	Modelling of a high power ICP source for negative ion production <b>Invited</b> <b>Gerjan J. M. Hagelaar</b> , Jean-Pierre Boeuf and A. Simonin	67
28B-a6	Plasma diagnostics on high power and high pressure VHF discharges <b>S. Nunomura</b> and M. Kondo	68
28B-a7	Exploration of the gas phase chemistry in microwave activated diamond depositing plasmas by laser spectroscopy and modelling <b>J. Ma</b> , J. Henney, A. Cheesman, M. Ashfold, S. Wright, G. Duxbury and Y. Mankelevich	69
28B-a8	Plasma generation of excited oxygen and combustion enhancement <b>A. Bourig</b> , J.-P. Martin, V. Lago, D. Thévenin, K. Zähringer, F. Pliavaka and S. Gorbato	70
Lunch (13:10–14:10)		



## Yoshida Campus: Room C

28 (Tue) Morning

Law & Economics 1F North-East		10:00–13:10
<b>Plasma spray and thermal plasma material processing (10:00–11:20) Chair: T. Ishigaki &amp; F. Gitzhofer</b>		Abst. Page
28C-a1	Diagnostics and control of instabilities in a plasma spray torch <b>D. Outcalt</b> , M. Hallberg, G. Yang, J. Heberlein, P. Strykowski and E. Pfender	589
28C-a2	Experimental investigation of fully turbulent plasma jet and its interaction with ambient air <b>T. Kavka</b> , A. Maslani, V. Sember, V. Kopecky, O. Chumak and M. Hrabovsky	590
28C-a3	High-speed thermal imaging of yttria-stabilized zirconia droplets impinging on a substrate in plasma spraying <b>K. Shinoda</b> , H. Murakami, S. Kuroda, S. Oki, K. Takehara and T. G. Etoh	591
28C-a4	Peculiarities of plasma processing and spraying of mechanically activated metal and metal alloy powders modified with ultra-fine refractory particles <b>O. Solonenko</b> , A. Cherepanov, V. Poluboyarov, I. Gulyaev and A. Lapin	592
Coffee break (11:20–11:40)		
<b>Plasma spray and thermal plasma material processing (11:40–13:10) Chair: F. Gitzhofer &amp; T. Ishigaki</b>		Abst. Page
28C-a5	Modeling time-dependent phenomena in plasma spraying of powders and liquid precursors <b>Invited Armelle Vardelle</b> , C. Marchand, C. Chazelas and G. Mariaux	593
28C-a6	Modelling of the influence of welding gas composition on arc properties and weld depth in TIG welding <b>A. B. Murphy</b> , M. Tanaka, S. Tashiro, T. Satoh and J. Lowke	594
28C-a7	Investigation on magnetically driven transferred arc : experiments and numerical analyses <b>S. Takeuchi</b> , K. Yamamoto, T. Toh, H. Hamatani, J. Tanaka and K. Takeda	595
28C-a8	New development of 10 kW-class arbitrary-waveform modulated induction thermal plasmas 'AMITP' <b>Y. Tanaka</b> , Y. Morishita, K. Okunaga, S. Fushie and Y. Uesugi	596
Lunch (13:10–14:10)		

## Yoshida Campus: Poster

## 28 (Tue) Afternoon

Clock Tower 2F (191 posters)

14:10–15:50

## Fundamentals of plasma-surface interactions

Abst. Page

28P-1	Heat transfer of solid particles in thermal plasmas <b>J. Amouroux</b> , S. Dresvin and S. Zverev	17
28P-2	Thin film formation on metals and dielectrics. <b>A. Bondareva</b> , G. Zmievskaya and A. V. Ivanov	18
28P-3	Measurement of magnesium oxide (MgO) sputtering yields by Ne ions with a low-energy ion beam system <b>K. Hine</b> , S. Yoshimura, K. Ikuse, M. Kiuchi, J. Hashimoto, M. Terauchi, M. Nishitani and S. Hamaguchi	19
28P-4	Application of high power ICP to fusion oriented experiments of erosion and dust formation using graphite and refractory metal materials <b>Y. Uesugi</b> , S. Fushie, Y. Tanaka, N. Ohno and S. Masuzaki	20
28P-5	Global evaluation and direct measurement of the energy transfer between an ICP argon plasma and a surface <b>R. Dussart</b> , A.-L. Thomann, N. Semmar, L. E. Pichon, J.-F. Lagrange, J. Mathias and S. Mazouffre	21
28P-6	Effect of ion-induced sub-plantation on the interface properties of plasma deposited thin films A. Amassian, P. Desjardins, J. Klemberg-Sapieha and <b>L. Martinu</b>	22
28P-7	Edge and core mechanism for anomalous diffusion in a magnetized cold plasma <b>M. Pinheiro</b>	23
28P-8	Interaction of surface discharge plasma with Insulator in vacuum <b>G.-J. Zhang</b> , K.-K. Yu, N. Zheng, W.-B. Zhao and Z. Yan	24
28P-9	Numerical investigation of air trapping during splat formation <b>I. Choquet</b>	25
28P-10	Diffusion of nitrogen in Fe-Cr alloys treated in abnormal glow discharge <b>A. Sarmiento Santos</b> and J. L. R. Muzart	26
28P-11	Investigation of interaction of hydrogen plasma with amorphous carbon film <b>M. Shinohara</b> , H. Shibata, K. Cho, T. Shibasaki, Y. Matsuda, H. Fujiyama and T. Nakatani	27
28P-12	Dependence of adsorption of hydrocarbon species during PECVD on substrate temperatures <b>M. Shinohara</b> , K. Cho, Y. Matsuda, H. Fujiyama and T. Nakatani	28
28P-13	ToF-SIMS analysis of surface layer of polysilicon etched film with an ECR CFC plasma <b>J. Ghormley</b> and M. Douglas	29
28P-14	Time of flight measurements of desorbed products by $CF_3^+$ beam irradiation on $SiO_2$ <b>K. Karahashi</b> and S. Hamaguchi	30
28P-15	Oxidative coupling methane with carbon dioxide under pulse corona plasma over various catalysts <b>X.-L. Zhang</b> , X.-H. Li, J. Wang and X.-D. Yuan	31
28P-16	Surface chemistry in the Si:H:Cl film growth by RF PE-CVD on c-Si for hetero-junction solar cells <b>H. Matsui</b> , T. Saito and H. Shirai	32
28P-17	O atoms lost adsorption/desorption processes on a porous photocatalytic material under plasma exposure <b>K. Allegraud</b> , O. Guaitella, L. Gatilova and A. Rousseau	33
28P-18	Study of plasma-solid interaction in electronegative gas mixtures: influence of substrate geometry <b>S. Novak</b> , R. Hrach, P. Bruna, P. Cerny and V. Hrachova	34
28P-19	Ion-assisted functional monolayer coating of arrays of nanorods in hydrogen plasmas <b>K. K. Ostrikov</b> , I. Levchenko, E. Tam, M. Keidar and S. Xu	35
28P-20	Reactive magnetron sputtering from tungsten, copper and indium targets in $Ar/H_2S$ : measurement of ion-energy distributions at the substrate <b>K. Ellmer</b> , K. Harbauer and S. Seeger	36
28P-21	Hydrophobic thin films performed by CDA and $N_2$ atmospheric pressure plasma CVD C.-W. Chen, W.-T. Hsieh, C.-Y. Lee, C.-H. Lin and K.-Y. Yen	37
28P-22	Investigation on carbon synthesis from high voltage pulsed discharge of methane N. Ekem, <b>G. Musa</b> , S. Pat, Z. Balbag, R. Vladioiu and V. Ciupina	38
28P-23	Titanium oxidation by pulsed oxygen discharge at elevated temperatures <b>G. Musa</b> , N. Ekem, Z. Balbag, I. Cenik and R. Vladioiu	39
28P-24	Understanding of the plasma/photocatalyst synergy for VOC abatment <b>O. Guaitella</b> , F. Thevenet, C. Guillard and A. Rousseau	40
28P-25	Model analysis of ion reflection on feature surfaces and profile evolution during Si etching in chlorine- and bromine-containing plasmas <b>S. Irie</b> , Y. Osano, M. Mori, K. Eriguchi and K. Ono	41

28P-26	Etching of high- $k$ dielectric HfO <sub>2</sub> films in BCl <sub>3</sub> -containing plasmas without rf biasing <b>D. Hamada</b> , K. Nakamura, K. Eriguchi and K. Ono	42
28P-27	Point defects induced by dry-etching in wurtzite-type GaN crystal <b>K. Harafuji</b> and K. Kawamura	43
28P-28	Generation and reduction of UV photon-induced defects during plasma etching processes <b>Y. Ishikawa</b> , A. Uedono, S. Yamasaki and S. Samukawa	44
28P-29	Atmospheric pressure plasma enhanced chemical etching for crystalline silicon solar wafer processing <b>V. Hopfe</b> , I. Dani, E. Lopez and M. Heintze	45
28P-30	Photo-resist stripping using multi-functional microwave plasma system <b>H.-H. Chen</b> , J. D. Liao, C. C. Weng, S. C. Tsai, K. M. Chen, B. W. Hsu and B. J. B. Wen	46
28P-31	Repetitive arcing characteristics on spacecraft surface insulator in ambient plasma environment and numerical calculation of their physical phenomena <b>H. Tahara</b> and T. Onishi	47
28P-32	Spatiotemporal evolution of discharge oscillation in Hall thrusters <b>N. Mizuno</b> , K. Sekine and Y. Nejoh	48
28P-33	Investigation on thermal characteristics and erosion of the channel wall in Hall thrusters <b>K. Kikuchi</b> , H. Nakamoto, Y. Yamamura, Y. Nejoh and N. Mizuno	49
28P-34	Catalycity and ageing study of space shuttle material: regeneration of their original catalytic properties L. Benabdelmoumène, G. Da Rold, C. Guyon, <b>S. Cavadias</b> and J. Amouroux	50
28P-35	An study of the effect of the cathode work function on plasma parameters <b>N. Mungkung</b> and O. Morimiya	51
28P-36	An analysis of the effect of cathode thermal conductivity on the stability arc <b>N. Mungkung</b> and O. Morimiya	52
28P-37	Angular distribution of ion current in a hot refractory anode vacuum arc <b>I. I. Beilis</b> , A. Shashurin and R. L. Boxman	53
28P-38	Effect of microstructure of cathodes on arc erosion and arc velocity of cold cathodes <b>L. Rao</b> and R. Munz	54
28P-39	Towards a new family of arc electrodes: electric field enhancement from vertically aligned carbon nanotubes <b>M. Dionne</b> , S. Coulombe and J.-L. Meunier	55
28P-40	Polymer surface treatment by atmospheric-pressure and low-pressure plasmas C. Lopez, <b>J. Cotrino</b> , A. Barranco and A. R. Gonzalez-Elipse	56
28P-41	Properties of amine-containing functional films by plasma polymerization F. Xie, J. Weng, <b>Q. Chen</b> and Y. Ge	57
28P-42	Surface characteristics and printing properties of PET fabric treated by atmospheric dielectric barrier discharge plasma U. M. Rashed, <b>A. A. Garamoon</b> and A. Al-halwagy	58
28P-43	Discharge characteristics of the plasma on liquid media <b>M. Kimura</b> , T. Shirafuji, O. Sakai and K. Tachibana	59
28P-44	Plasma-electrolyte solution chemistry <b>Q. Chen</b> , K. Saito, K. Haruta and H. Shirai	60
28P-45	Real time diagnostics of plasma-electrolyte solution interface by spectroscopic ellipsometry <b>K. Saito</b> , Q. Chen, K. Haruta and H. Shirai	61
28P-46	Characteristics of films deposited from pulsed and continuous wave aniline plasmas T. Merian, D. Debarnot and <b>F. Poncin-Epaillard</b>	62
<b>Non-equilibrium effects and atmospheric pressure plasma processes</b>		Abst. Page
28P-47	Effect of packed particle bed including titan oxide on ozone generation using dielectric barrier discharge plasma <b>K. Ishimaru</b> and D. Shimizu	155
28P-48	Effect of micro hydrodynamical flow in microgap discharge at atmospheric pressure <b>K. Nawa</b> , H. Ito, H. Kirihara, J. Yamamoto, T. Aizawa, Y. Shida, S. Mukaigawa, K. Takaki and T. Fujiwara	156
28P-49	Influence of the dielectric materials and gas type to the behavior of double discharges in a pulsed-DBD at atmospheric pressure A. S. Chiper, <b>R. Cazan</b> and <b>G. Popa</b>	157
28P-50	About the role of wire mesh electrodes to get a homogeneous dielectric barrier discharge in air at atmospheric pressure N. Naudé, S. Okazaki, N. Gherardi and <b>F. Massines</b>	158
28P-51	Ultra-short pulsed excitation: an efficient route to highly reactive, tens kilowatts, and near room-temperature atmospheric glow discharges <b>J. L. Walsh</b> and M. Kong	159

28P-52	Estimation of thermo-chemical properties of Ar plasmas with $C_xH_yO_z$ molecular gas for two-temperature chemically non-equilibrium modeling <b>S. A. Al-mamun</b> , Y. Tanaka and Y. Uesugi	160
28P-53	Numerical simulation of non-equilibrium plasma property of gas tungsten arcs <b>S. Tashiro</b> , T. Iwao, T. Inaba and M. Tanaka	161
28P-54	Numerical simulations on DC glow discharges with varied gas pressure Y. Zhao, Y. Deng, Shafiq-ur-Rehman, <b>Y. Liu</b> and Y. Bai	162
28P-55	Degree of non-equilibrium in gliding arc plasma L. Lin, B. Wu and <b>C. Wu</b>	163
28P-56	Production of N and O atoms in flowing Ar-N <sub>2</sub> and Ar-O <sub>2</sub> microwave post-discharges at high pressures. <b>F. Gaboriau</b> and A. Ricard	164
28P-57	Measurement of absolute carbon atom density in reactive plasma using vacuum ultraviolet Absorption spectroscopy <b>H. Sasaki</b> , S. Takashima and M. Hori	165
28P-58	Measurement of rotational and vibrational temperature of gas molecules in the CVM plasma by using spatial resolved optical emission spectra <b>K. Ueno</b> , Y. Oshikane, Y. Sano and K. Yamamura	166
28P-59	Experimental study on atmospheric pressure RF capacitive He/CF <sub>4</sub> , He/C <sub>2</sub> F <sub>6</sub> and He/SF <sub>6</sub> discharges <b>T. Kimura</b> , H. Tanahashi and T. Mori	167
28P-60	Characterisation of a throughflow atmospheric pressure dielectric barrier discharge and its afterglow by optical emission spectroscopy <b>A. Ionascut Nedelcescu</b> , C. Carlone, U. Kogelschatz, C. Nessim, D. Gravelle and M. I. Boulos	168
28P-61	Time-resolved optical pumping of nitric oxide by a CO laser <b>A. White</b> , I. Adamovich and J. W. Rich	169
28P-62	Application of the probe method to the atmospheric pressure discharge plasma <b>H. Matsuura</b> and Y. Matsumura	170
28P-63	Measurement of dynamic property of pulse modulated induction thermal plasmas using Langmuir probe <b>Y. Takeguchi</b> , Y. Kawashita, Y. Uesugi and Y. Tanaka	171
28P-64	Production of high density plasmas using the focused atmospheric pressure plasma jets <b>K. Yambe</b> , H. Sakakita, N. Ikeda and Y. Hirano	172
28P-65	Study of plasma jet using coaxial dielectric barrier discharges at atmospheric pressure <b>Y. Ito</b> , K. Urabe, M. Kubo and K. Tachibana	173
28P-66	A cold atmospheric pressure plasma jet operated with helium-argon-nitrogen mixtures <b>J. Laimer</b> , S. Haslinger and H. Störi	174
28P-67	Experimental investigations of a plasma bullet generated by nanoseconds voltage pulses <b>T. Akan</b> , X. Lu and M. Laroussi	175
28P-68	Chemical reactions induced by glow plasmas generated in bubbles in water <b>H. Aoki</b> , K. Kitano and S. Hamaguchi	176
28P-69	SiO <sub>x</sub> thin films coated using atmospheric pressure plasma chemical vapor deposition W.-T. Hsieh, C.-W. Chen, C.-H. Liu, C.-H. Lin and K.-Y. Yen	177
28P-70	High yield synthesis of vertically-aligned single-walled carbon nanotubes in atmospheric pressure radio-frequency discharge <b>K. Ohnishi</b> , T. Nozaki and K. Okazaki	178
28P-71	Highly fluorinated layers deposited on cellulose surfaces from non-equilibrium SF <sub>6</sub> -plasma environments at low and atmospheric pressure <b>L. E. Cruz-Barba</b> , H. Zulaica-Villagomez, A. J. Martinez-Gomez, S. Manolache and F. Denes	179
28P-72	Atmospheric dielectric barrier discharge for synthesizing nanocrystalline anatase TiO <sub>2</sub> <b>A.-M. Zhu</b> , L.-H. Nie, C. Shi, X.-L. Zhang and Y. Xu	180
28P-73	Plasma treatments of gelatin nanofiber membranes for bioabsorbable polymer substrates <b>V. Tura</b> , N. Dumitrascu, T. Balau Mandru, I. Balau Mandru and S. Maier	181
28P-74	Evaluation of electrode grooves formed using surface discharge plasma <b>T. Hamada</b> , T. Sakoda, M. Otsubo, K. Matsui and K. Nagasawa	182
28P-75	Non-equilibrium effects inside an oxygen cutting-torch <b>S. Ghorui</b> , J. Heberlein and E. Pfender	183
28P-76	Spacecraft sterilization using non-equilibrium atmospheric pressure plasma <b>M. Cooper</b> , S. Anderson, G. Fridman, V. Vasilets, A. Gutsol, A. Tsapin and A. Fridman	184
28P-77	Characteristic of an atmospheric pressure plasma for PR Ashing in the blower type dielectric barrier discharge <b>H.-C. Kwon</b> , S.-Y. Jeong, S.-H. Lee and G.-H. Kim	185
28P-78	Atmospheric pressure-glow plasma induced surface functionalization of flexible substrate <b>H. Itoh</b> , N. Zettsu, M. Shibahara and K. Yamamura	186

28P-79	Characteristics of CF <sub>4</sub> treatment process with various operating conditions of rotating arc <b>K.-T. Kim</b> , Y.-H. Song, D. H. Lee, M. S. Cha and J. K. Lee	187
28P-80	Surface modification of BOPP films by N <sub>2</sub> glow dielectric-barrier discharges <b>H.-F. Huang</b> , C.-H. Wen and M.-J. Chuang	188
28P-81	Organic materials surface hydrophilic control using an atmospheric pressure plasma jet <b>H. Ito</b> , K. Nawa, H. Kiriara, S. Mukaigawa, K. Takaki and T. Fujiwara	189
28P-82	Wetting process dynamics on wood samples treated by DBD <b>I. Topala</b> , N. Dumitrascu and V. Pohoata	190
28P-83	Effects of atmospheric pressure plasma activation on paper and printability <b>M. Pykönen</b> , M. Toivakka, P. Fardim, H. Sundqvist, O.-V. Kaukonen, L. Hakola, K. Eiro, M. Tuominen, J. Lahti and J. Järnström	191
28P-84	<sup>13</sup> C-benzene synthesis process from <sup>13</sup> C-methane using non-equilibrium pulsed discharge Y. Sekine, <b>S. Kanemasu</b> , S. Nishikata, E. Kikuchi, M. Matsukata, T. Nakajima and I. Shimizu	192
28P-85	Syngas production from the biomass gasification by plasma torch <b>M. Brothier</b> , P. Gramond, C. Poletto, H. Lorcet, D. Guenadou, E. Meillot, U. Michon, A. Hacala, G. Mariaux and F. Onofri	193
28P-86	Plasma methane oxidation for methanol synthesis with Cu-Zn-Al catalyst <b>A. Indarto</b> , J.-W. Choi, H. Lee and H. K. Song	194
28P-87	Behavior of ammonia production in high-frequency discharges at atmospheric pressure <b>J. Nakajima</b> and H. Sekiguchi	195
28P-88	Conversion of toluene by dielectric barrier discharge: O-atoms reactivity <b>N. Blin Simiand</b> , L. Magne, <b>S. Pasquiers</b> , F. Jorand and C. Postel	196
28P-89	Acetylene decomposition in packed bed corona discharge reactors using different packing material at ambient temperature <b>M. Redolfi</b> , X. Duten, N. Aggadi, S. Touchard and K. Hassouni	197
28P-90	Comparison between trichloroethylene and carbon tetrachloride destruction in a microwave air plasma S. Rubio-García, <b>A. Rodero-Serrano</b> and M. C. Quintero-Ortega	198
28P-91	Distribution of temperatures and species in the axial injection torch during the trichloroethylene destruction S. Rubio-García, <b>M. C. Quintero-Ortega</b> and A. Rodero-Serrano	199
28P-92	A non-thermal plasma study in VOCs' treatment: propane conversion in a pulsed DBD reactor <b>O. Aubry</b> , J. M. Cormier and A. Khacef	200
28P-93	High efficiency DBD pilot for environmental purposes L. Martin, <b>S. Cavadias</b> , S. Ognier, S. Dresvin and J. Amouroux	201
28P-94	FTIR-study on plasma-catalytic removal of tars from syngas <b>A. J. M. Pemen</b> , E. J. M. van Heesch, G. J. J. Winands, F. D. P. de Leeuw, J. J. Schmeits and K. J. Ptasinski	202
28P-95	Pathways of methane decomposition in plasma process by arc jet <b>N. K. Hwang</b> , D. H. Lee, M. S. Cha and Y.-H. Song	203
28P-96	Plasma-assisted catalytic reaction for ethanol decomposition Y. Sekine, <b>M. Tomioka</b> , H. Iwasaki, E. Kikuchi, M. Matsukata and H. Akama	204
28P-97	Decomposition of 1,2-dichlorobenzene using non-thermal plasma with catalyst <b>G.-S. Cho</b> , I. Moon, J.-W. Choi, H. Lee, D.-J. Suh and H. K. Song	205
28P-98	Production of ozone in a DBD in N <sub>2</sub> /O <sub>2</sub> mixture containing porous photocatalyst: influence of UV and VOC <b>P. Ceccato</b> , O. Guaitella and A. Rousseau	206
<b>Microdischarges and microplasmas</b>		<b>Abst. Page</b>
28P-99	Properties of dielectric barrier discharges at elevated pressure in compressible transonic flows P. Reichen, <b>A. Sonnenfeld</b> and P. Rudolf von Rohr	221
28P-100	Characteristics of atmospheric pressure micro-plasma jet excited by dielectric barrier discharge <b>H. Matsuba</b> , M. Kawata, H. Motomura and M. Jinno	222
28P-101	Characteristics of micro-hollow cathode discharges with pre-ionization for atmospheric pressure sterilization <b>M. Nagatsu</b> , J. Watanabe, L. Xu and A. Ogino	223
28P-102	Fabrication of micro hollow cathode structures for material processing <b>R. Masamori</b> , H. Nishiyama, T. Iba, M. Mizoshiri and Y. Hirata	224
28P-103	Generation of high-power atmospheric transient micro glow discharge with miniature gas flow <b>S. Ibuka</b> , F. Furuya, K. Ogura, K. Yasuoka and S. Ishii	225
28P-104	Electrode Phenomena in a microplasma by electrolyte cathode atmospheric glow discharge <b>M. Nakazawa</b> , M. Shikama, S. Ibuka, K. Yasuoka and S. Ishii	226
28P-105	Microplasma production by field electron emission <b>Q. Zou</b> and A. Hotta	227

28P-106	Collimated proton beam generation by a tailored thin foil target illuminated by an intense short pulse laser <b>S. Kawata</b> , M. Nakamura, R. Sonobe and T. Kikuchi	228
28P-107	Plasma characteristics of atmospheric microplasma produced by high secondary electron-emission-materials <b>Y. Ohtsu</b> , N. Yamasaki and H. Fujita	229
28P-108	Energy control of microplasma by quenching capacitor <b>K. Takaki</b> , T. Sasaki, S. Mukaigawa, T. Fujiwara, H. Mase and N. Sato	230
28P-109	Discharge properties of MgO thin films deposited by sputtering <b>T. Misu</b> , M. Sugimoto, M. Goto and T. Arai	231
28P-110	Temperature dependant characteristics of cryo microplasma <b>Y. Noma</b> , S. Stauss, T. Tomai and K. Terashima	232
28P-111	Atmospheric pressure RF microplasma characterization <b>D. Staack</b> , B. Farouk, A. Gutsol and A. Fridman	233
28P-112	Low voltage APP-generation by piezo ceramics: Basic structures, electro-mechanical simulations and poling techniques <b>M. Teschke</b> and J. Engemann	234
28P-113	Plasma diagnostics on multi-micro hollow light source <b>T. Ohta</b> , Y. Tachibana, M. Ito, S. Takashima, Y. Higashijima, H. Kano, S. Den and M. Hori	235
28P-114	Characterization of spatial homogeneity of atmospheric air plasma in plane-parallel microgap barrier discharges <b>T. Sakurai</b> , S. Yamazaki, K. Yamamoto and T. Akitsu	236
28P-115	Statistical approach investigating atmospheric plasma intensities generated by fast voltage rise up pulse power <b>S. Khadijah</b> , T. Akitsu, T. Otagawa, S. Yamazaki and T. Sakurai	237
28P-116	Thomson scattering diagnostics of plasmas for EUV light sources <b>K. Tomita</b> , S. Araki, T. Yamada, T. Kagawa, K. Uchino, H. Imamura, S. Katsuki and H. Akiyama	238
28P-117	Thomson scattering diagnostics of a plasma produced in a miniature microwave discharge ion engine <b>K. Tomita</b> , A. Majima, T. Yamada, K. Uchino, S. Kondo, N. Yamamoto and H. Nakashima	239
28P-118	Diagnostics of supercritical CO <sub>2</sub> dielectric barrier discharge plasma by Raman spectroscopy <b>T. Tomai</b> , H. Yui and K. Terashima	240
28P-119	Behavior of metastable Ar atoms in atmospheric-pressure Ar microgap discharge excited by microwave T. Shibata, M. Kobayashi, M. Aramaki and <b>A. Kono</b>	241
28P-120	Electron density and collisional frequency in plasma with terahertz time-domain spectroscopy <b>H. Nakanishi</b> , D.-S. Lee, O. Sakai and K. Tachibana	242
28P-121	Numerical simulation for microplasma streamer discharges in high pressure region <b>T. Kikuchi</b> and S. Kawata	243
28P-122	Particle modeling of low pressure dc microdischarges in a narrow channel L. Tong, <b>S. Yonemura</b> , H. Takana and H. Nishiyama	244
28P-123	Numerical analysis and optical diagnostics of a microwave-excited plasma source for microthrusters <b>T. Takahashi</b> , Y. Takao, K. Eriguchi and K. Ono	245
28P-124	Particle-in-cell simulations of micro hollow cathode discharges:comparison of secondary electron emission models <b>Y. J. Hong</b> , G. J. Kim, F. Iza and J. K. Lee	246
28P-125	Numerical simulation of capacitively coupled high-frequency driven microplasma with gas dynamics - influence of gas flow - <b>F. Tochikubo</b> , S. Otsuka and S. Uchida	247
28P-126	Influence of voltage polarity and electrode configuration on discharge formation for microplasma array <b>T. Kubota</b> , S. Uchida and F. Tochikubo	248
28P-127	Study of ozone generation and polluted air control by using micro plasma <b>K. Shimizu</b> , T. Sugiyama, M. Nishamani and M. Kanamori	249
28P-128	Chemical reactivity of water/SO <sub>2</sub> gas mixture activated by porous medium micro plasma I. G. Koo, M. S. Lee, J. H. Kim and <b>W. M. Lee</b>	250
28P-129	Microplasma using liquid materials as a plasma reactor <b>N. Shirai</b> , K. Matsui, S. Ibuka, K. Yasuoka and S. Ishii	251
28P-130	Creation of carbon materials using microplasma with miniature methane gas flow <b>K. Harada</b> , S. Ibuka, K. Yasuoka and S. Ishii	252
28P-131	Carbon nanotube growth on microelectrode tips by femtosecond laser lithography <b>Y. Akanishi</b> , H. Nishiyama, M. Mizoshiri and Y. Hirata	253
28P-132	Nanoparticle production by microdischarge using copper wire <b>M. Kanemaru</b> , I. Yousuke, T. Hashimoto, I. Shinji, K. Yasuoka and S. Ishii	254
28P-133	Microplasma synthesis of tunable photoluminescent silicon nanocrystals <b>T. Nozaki</b> , K. Sasaki, T. Ogino and K. Okazaki	255

28P-134	Silicon dicing process using an atmospheric-pressure microplasma <b>T. Ideno</b> , H. Inui, H. Fujiwara, A. Masuda, M. Kondo, M. Hiramatsu and M. Hori	256
28P-135	Modification of inner surface of a small-diameter PTFE tube by RF impulse discharge with coaxial micro-electrodes <b>T. Muraoka</b> and S. Iizuka	257
28P-136	Preparation of 5-fold symmetrical starfish-shape molybdenum grains in ambient air using atmospheric microplasma jet <b>Y. Shimizu</b> , D. Mariotti, T. Sasaki, K. Koga, K. Terashima and N. Koshizaki	258
28P-137	Microplasma catalysis: selective conversion of propane into olefins in micro-DBD plasma reactor <b>A. Agiral</b> , C. Trionfetti, K. Seshan, L. Lefferts and H. Gardeniers	259
28P-138	Thin film deposition by means of atmospheric pressure microplasma jet <b>J. Benedikt</b> , A. Yanguas-Gil, K. Focke and A. von Keudell	260
28P-139	Gas treatment by atmospheric microdischarges in porous materials <b>K. Hensel</b> , M. Janda, M. Lestinsky, Z. Machala and A. Mizuno	261
28P-140	Hydrogenation of unsaturated hydrocarbons using atmospheric pressure non-thermal plasma <b>H. Sekiguchi</b> , H. Ito, T. Shono and C. Zhou	262
28P-141	Synthesis and characterization of microplasma-polymerized acrylic acid and allylamine films H. Aizawa, Y. Gokita, Y. Yoshimi, <b>S. Kurosawa</b> , K. Terashima and T. Hatta	263
28P-142	Chemical reactivity of water/SO <sub>2</sub> gas mixture activated by porous medium micro plasma I. G. Koo, M. S. Lee, J. H. Kim and <b>W. M. Lee</b>	264

### Plasma chemical syntheses

Abst. Page

28P-143	Reforming of CO <sub>2</sub> -containing natural gas using an AC gliding arc system: effects of feed component <b>N. Rueangjitt</b> , C. Akarawitoo, T. Sreethawong and S. Chavadej	555
28P-144	Reforming of CO <sub>2</sub> -containing natural gas using an AC gliding arc system: effects of applied voltage and frequency <b>T. Sreethawong</b> , N. Rueangjitt and S. Chavadej	556
28P-145	Effects of temperature and water content on the steam reforming of hydrocarbons with nonthermal plasma <b>M. Sugawara</b> , T. Terasawa and S. Futamura	557
28P-146	Steam reforming of hydrocarbons fuels stimulated by DBD <b>D. Medvedev</b> , G. Kononov, V. Jivotov, M. Krotov, A. Galkin, S. Korobtsev and B. Potapkin	558
28P-147	Production of hydrogen-rich gas via partial oxidation of diesel fuel <b>A. Samokhin</b> , N. Alexeev, A. Rabinovich and A. Peschkoff	559
28P-148	Plasma treated Ni catalyst for partial oxidation of methane to syngas <b>Z. Li</b> , J. Lv, Y. Zhu and M. Chen	560
28P-149	Effects of Ir, Pd, Re/r-Al <sub>2</sub> O <sub>3</sub> catalyst on the production of synthesis gas using low temperature plasma <b>C. J. Hong</b> , I. Moon, J.-W. Choi, H. Lee and H. K. Song	561
28P-150	Effects of scale-up on methane conversion via atmospheric pressure non-thermal plasma W. Cheng, <b>J. Lv</b> , D. Xu, X. Ma and Z. Li	562
28P-151	Effect of cooling methods on methane conversion via dielectric-barrier discharges K. H. Yang, <b>B. W. Wang</b> , J. Lv, Z. Li and G. Xu	563
28P-152	Plasma pilot gasifier E. I. Karpenko, <b>E. I. Lavrishcheva</b> , V. E. Messerle and A. B. Ustimenko	564
28P-153	Plasma aided coal gasification V. E. Messerle and <b>A. B. Ustimenko</b>	565
28P-154	Effect of thickness of aluminum oxide underlayer on single-walled carbon nanotube growth using plasma-enhanced chemical vapor deposition <b>Y. Suda</b> , A. Ozeki, A. Okita, T. Saito, Y. Sakai and H. Sugawara	566
28P-155	Large-scale continuous synthesis of high purity carbon nanotubes in a dc thermal plasma torch reactor G.-P. Dai and <b>J.-L. Meunier</b>	567
28P-156	Time evolution of single-walled carbon nanotube growth with diffusion plasma CVD <b>T. Kato</b> and R. Hatakeyama	568
28P-157	Synthesis of double-walled carbon nanotubes by arc plasma reactor with twelve-phase alternating current discharge <b>T. Matsuura</b> , Y. Aoyagi, Y. Kondo, N. Maki and K. Matsumoto	569
28P-158	Carbon arc discharge: synthesis of SWCNTs and plasma diagnostics <b>H. Lange</b> , M. Bystrzejewski and A. Huczko	570
28P-159	The evolution of carbon precursors for carbon nanotube synthesis in a DC plasma torch reactor <b>L. Guo</b> , J.-L. Meunier and I. D. Hinkov	571
28P-160	Development of surface morphology in Ni catalyst deposition for growing dense nanotube forests: numerical simulation I. Levchenko, <b>K. K. Ostrikov</b> and K. Chan	572



28P-161	Effects of atomic oxygen on multiwall carbon nanotubes growth <b>C. Zhang</b> , Y. Fu, <b>Q. Chen</b> and Y. Zhang	573
28P-162	Synthesis of carbon nanotubes by thermal decomposition of methane using an inductively coupled thermal plasma <b>J. S. Nam</b> , C. M. Lee, S. Choi, H. S. Lee and S. H. Hong	574
28P-163	Growing multi-wall carbon nanotube on ambient substrate by atmospheric pressure remote spark discharge <b>Y. Yang</b> , W. W. Sun and T. Whidden	575
28P-164	Synthesis of carbon nanostructures by D.C. thermal plasma jet R. Stankiewicz, W. Plotczyk, M. Bystrzejewski, A. Huczko and <b>H. Lange</b>	576
28P-165	Syntheses of metal-carbon hybridized Nanostructures using arc in liquid <b>N. Sano</b> , T. Charinpanitkul, P. Muthakarn, T. Kikuchi, O. Kawanami and W. Tahthapanichakoon	577
28P-166	Low-temperature growth of graphene-encapsulated nanomaterials using surface-wave plasma CVD <b>D. Lu</b> , T. Tanaka, M. Mesko, A. Ogino and M. Nagatsu	578
28P-167	Plasmachemical preparation of nanometric powders <b>V. Brozek</b> , J. Janca and Z. Srank	579
28P-168	Simulation of binary core/shell quantum dots formation on Si substrates I. Levchenko, <b>K. K. Ostrikov</b> , A. Rider and U. Cvelbar	580
28P-169	Fabrication of ultra water-repellent surface by using capacitively-coupled plasma CVD with organosilicon reactant <b>N. Shimazu</b> , Y. Yun, N. Nanba, Y. Inoue, N. Saito and O. Takai	581
28P-170	Ethylene Epoxidation in low-temperature corona discharge <b>A. Tansuwan</b> , S. Chavadej and T. Sreethawong	582
28P-171	Zinc oxide film deposition by atmospheric thermal plasma CVD using Ar /air Working gas <b>Y. Ando</b> , S. Tobe and H. Tahara	583
28P-172	Induction plasma synthesis of titania nanopowders <b>C. Nessim</b> , J. Jurewicz and M. I. Boulos	584
28P-173	Alternative routes of thermal plasma synthesis of composite oxides nanopowders. Precursor's Choice J. Nakic and <b>J. Jurewicz</b>	585
28P-174	On the electrodeposition of zinc on plasma - treated copper foils in acid and alkaline baths <b>N. Ghali</b> , N. Benderdouche, B. Bestani, M. Belhakem, A. Addou and J. L. Brisset	586
28P-175	Film formation of Ag/PEO-like polymer deposited by ionic-beam magnetron sputtered <b>L. Yue</b> , M. Zhou, Q. Chen and Y. Ge	587
28P-176	Experimental study and kinetic modeling of hydrogen production by non-equilibrium plasma discharge decomposition of methane <b>Y. Yang</b> , T. Boutot, Z. Liu and T. Whidden	588
<b>Plasma aided combustion and aerodynamics</b>		<b>Abst. Page</b>
28P-177	Modelling of the production of excited oxygen molecules in a crossed discharge (barrier discharge and CW discharge) <b>A. Bourig</b> , J.-P. Martin, V. Lago, D. Thévenin and K. Zähringer	647
28P-178	On the effect of water vapor on CH <sub>4</sub> oxidation in atmospheric pressure rotating discharge plasma reactor A. Khacef, <b>J. M. Cormier</b> and E. El Ahmar	648
28P-179	Kinetic mechanisms of plasma-aided combustion <b>E. I. Mintoussov</b> , S. E. Yankina, A. A. Nikipelov, S. M. Starikovskaya and A. Starikovskii	649
28P-180	Kinetics of plasma-aided ignition of hydrocarbons <b>I. Kosarev</b> , S. Kindusheva, N. Aleksandrov, S. M. Starikovskaya and A. Starikovskii	650
28P-181	Plasma aided coal combustion E. I. Karpenko, <b>V. E. Messerle</b> and A. B. Ustimenko	651
28P-182	A new plasma-chemical reactor for liquid and gaseous fuel conversion using gliding discharge in tornado flow M. Gallagher Jr., R. Geiger, <b>A. Gutsol</b> and A. Fridman	652
28P-183	Analysis of air radical flow generated by pulsed discharge for combustion assist H. Nishiyama, <b>H. Takana</b> , S. Niikura, H. Shimizu, K. Katagiri and Y. Nakano	653
28P-184	Plasma-fuel systems influence on aerodynamics and NO <sub>x</sub> formation at pulverised coal combustion A. S. Askarova, E. I. Lavrishcheva, V. E. Messerle and <b>A. B. Ustimenko</b>	654
28P-185	Experimental study of induced airflow of a DBD EHD actuator <b>B. Dong</b> , J.-M. Bauchire, J.-M. Pouvesle, P. Magnier and D. Hong	655
28P-186	Effect of AC electric fields on the flame liftoff in coflow jets S. H. Won, <b>M. S. Cha</b> , S. K. Ryu and S. H. Chung	656
28P-187	Detonation initiation by pulse corona discharge D. Medvedev, G. Konovalov, S. Zaitsev, V. Jivotov, M. Krotov, A. Borisov, S. Korobtsev, <b>B. Potapkin</b> and A. Dean	657



28P-188	Deflagration to detonation transition under initiation by high-voltage pulsed discharges <b>A. Rakitin</b> , V. Zhukov and A. Starikovskii	658
28P-189	Investigation of Impulse nanosecond discharge <b>M. Nudnova</b> , D. Roupasov and A. Starikovskii	659
28P-190	Low temperature plasma for combustion support at thermal power plants fired by pulverized coal P. Stefanovic, Z. Pavlovic, <b>D. Cvetinovic</b> and N. Zivkovic	660
28P-191	Modelling study of a utility boiler pulverized coal ignition by means of plasma torches <b>S. Belosevic</b> , M. Sijercic, P. Stefanovic and D. Cvetinovic	661

## Yoshida Campus: Room A

## 28 (Tue) Afternoon

Clock Tower 1F	15:50–18:40
----------------	-------------

<b>Microdischarges and microplasmas (15:50–17:00) Chair: J. Engemann &amp; H. Shirai</b>	Abst. Page
--	------------

28A-p1	Nanoseconds pulsed nonequilibrium plasma discharges and applications	214
<b>Invited</b>	<b>Mounir Laroussi</b>	
28A-p2	Experimental and numerical study of an argon microhollow cathode plasma <b>N. Sadeghi</b> , X. Aubert, J.-P. Boeuf, J.-F. Lagrange, L. Pitchford and A. Rousseau	215
28A-p3	Study of surface charges behavior in PDP-like coplanar barrier discharges using an electro-optic crystal <b>T. Sakurai</b> , H. Yoda, K. Ishii and Y. Murakami	216
Coffee break (17:00–17:20)		

<b>Microdischarges and microplasmas (17:20–18:40) Chair: H. Shirai &amp; J. Engemann</b>	Abst. Page
--	------------

28A-p4	(Strongly coupled) micro-plasma formation during opening of a low current electrical contact <b>J.-L. Dorier</b> and C. Hollenstein	217
28A-p5	Electron kinetics in atmospheric-pressure RF microdischarges <b>F. Iza</b> and J. K. Lee	218
28A-p6	Finite element analysis of atmospheric pressure RF-excited plasma needle <b>Y. Sakiyama</b> and D. B. Graves	219
28A-p7	Numerical modeling of an atmospheric pressure methane-hydrogen micro-discharge <b>T. Farouk</b> , B. Farouk, A. Gutsol and A. Fridman	220

## Yoshida Campus: Room B

## 28 (Tue) Afternoon

Law & Economics East 1F		15:50–18:40
<b>Plasma deposition of inorganic films and hard coatings (15:50–17:00) Chair: H. Toyoda &amp; K. Hassouni</b>		
		Abst. Page
28B-p1	Novel quaternary Si-B-C-N films prepared by reactive magnetron sputtering	362
<b>Invited</b>	<b>Jaroslav Vlcek</b> , Jiri Houska, Stepan Potocky, Jiri Kalas, Stanislav Hreben, Jiri Capek, Petr Zeman and Vratislav Perina	
28B-p2	Preparation routes based on reactive magnetron sputtering for tungsten disulfide films ( $WS_{2-x}$ ) for thin film solar Cells	363
	<b>K. Ellmer</b> , S. Seeger, S. Brunken, M. Kunst and R. Mientus	
28B-p3	Electrochemical investigation of inorganic thin layers deposited by RF magnetron sputtering	364
	E. Angelini, <b>S. Grassini</b> , A. Palma, F. Rosalbino, F. Fracassi, F. Palumbo and R. d'Agostino	
	Coffee break (17:00–17:20)	
<b>Plasma deposition of inorganic films and hard coatings (17:20–18:40) Chair: K. Hassouni &amp; H. Toyoda</b>		
		Abst. Page
28B-p4	Temperature evolution and pore distribution in zirconia footprint deposits using atmospheric plasma spraying	365
	H. Salimijazi, L. Pershin, T. Coyle, <b>J. Mostaghimi</b> , S. Chandra, L. Rosenzweig and E. Moran	
28B-p5	Preparation of DLC films at atmospheric pressure by nanopulse plasma CVD	366
	<b>N. Ohtake</b> , Y. Kondo, T. Saito, M. Saito and T. Terazawa	
28B-p6	Dies service performance enhancement for aluminum alloy die casting by nano-composite PVD ceramic coatings	367
	E. Aimo Boot, F. Cartasegna, G. Krawczyk, <b>M. Perucca</b> , G. Piacenza, M. Rosso, E. Torres and D. Ugues	
28B-p7	Bulk-like beryllium film formation by thermionic vacuum arc method	368
	<b>C. P. Lungu</b> , I. Mustata, V. Zaruschi, A. M. Lungu, A. Anghel, G. Burcea, V. Bailescu, G. Dinuta, G. Serban, F. Miculescu, I. Vata and E. Ivanov and D. Dudu	

## Yoshida Campus: Room C

## 28 (Tue) Afternoon

Law &amp; Economics East 2F

15:50–18:40

**Plasma sources: designs and characterizations (15:50–17:00)** Chair: **W. Stoffels & K. Terashima** Abst. Page

28C-p1	Radiofrequency expanding plasmas at low, intermediate and atmospheric pressure and their applications	272
<b>Invited</b>	<b>Gheorghe Dinescu</b> and E. R. Ionita	
28C-p2	Experimental study on the arc root behavior of a DC non-transferred plasma jet	273
	<b>H. Huang</b> , W. Pan, X. Meng and C. Wu	
28C-p3	Modelling and comparison of different design solutions for DC transferred arc plasma cutting torches	274
	<b>V. Colombo</b> , E. Ghedini, S. Dallavalle and M. Vancini	
	Coffee break (17:00–17:20)	

**Plasma sources: designs and characterizations (17:20–18:40)** Chair: **K. Terashima & W. Stoffels** Abst. Page

28C-p4	Capacitive discharges driven by combined DC/RF sources	275
	<b>M. A. Lieberman</b> , E. Kawamura, A. J. Lichtenberg and E. A. Hudson	
28C-p5	Global model of a dual-frequency capacitive discharge	276
	<b>P. Chabert</b> , P. Levif and M. M. Turner	
28C-p6	Pulsed neon xenon discharge kinetics associated to pulse duration	277
	S. Point, E. Robert, S. Dozias, C. Cachoncinlle, R. Viladrosa and <b>J.-M. Povesle</b>	
28C-p7	Spatially inhomogeneous electron kinetics in oxygen plasmas	278
	G. K. Grubert and <b>D. Loffhagen</b>	

**Katsura Campus: Room A****29 (Wed) Morning****Rohm Plaza** **9:10–13:00****Biomedical applications (9:10–11:00) Chair: P. Favia** Abst. Page

29A-a1	Atmospheric pressure non-thermal plasma sterilization of microorganisms in liquids and on the surfaces	663
<b>Invited</b>	<b>Yuri Akishev</b> , M. Grushin, V. Karalnik, N. Trushkin, V. Kholodenko, V. Chugunov, E. Kobzev, N. Zhirkova and I. Irkhina	
29A-a2	Inactivation of Aquatic microorganisms by low frequency pulsed discharges	664
	<b>C. W. Chen</b> , H.-M. Lee and M.-B. Chang	
29A-a3	Internal sterilization of wrapped medical implements using large-volume microwave plasmas	665
	<b>L. Xu</b> , Y. Ohno, A. Ogino, Y. Koide and M. Nagatsu	
29A-a4	Sterilization of living human and animal tissue by non-thermal atmospheric pressure dielectric barrier discharge plasma	666
	<b>G. Fridman</b> , A. Shereshevsky, M. Balasubramanian, M. Peddinghaus, A. Brooks, A. Gutsol, V. Vasilets, A. Fridman and G. Friedman	
29A-a5	Pulsed RF plasma sterilization of medical packaging	667
	<b>Y. L. M. Creighton</b> , T. Huijser and M. Broekhuijsen	

Coffee break (11:00–11:20)

**Plasma deposition and treatment of polymers (11:20–13:00) Chair: D. Hegemann** Abst. Page

29A-a6	Tailoring of functional nano-patterned surfaces for biosensing applications by combination of plasma processes and electron-beam lithography	422
	F. Bretagnol, L. Ceriotti, A. Valsesia, T. Sasaki, D. Gilliland, <b>G. Ceccone</b> , P. Colpo and F. Rossi	
29A-a7	Selective amino functionalization of polymer surfaces: UV-laser irradiation compared to plasma processing	423
	M. Jäger, <b>A. Meyer-Plath</b> , F. Sonntag, J. F. Friedrich and R. Poll	
29A-a8	New plasmas for polymer surface functionalization	424
	<b>R. Mix</b> , R.-D. Schulze, R. Joshi, A. Meyer-Plath and J. F. Friedrich	
29A-a9	Functionalized surfaces by plasma polymerization : a new strategy to reach reversible adhesion between two substrates	425
	<b>V. Roucoules</b> , F. Siffer, A. Ponche and M.-F. Vallat	
29A-a10	Effect of time-modulated surface-wave plasma treatment on chemical modification of polyurethane	426
	<b>M. Kral</b> , A. Ogino, K. Narushima, M. Yamashita and M. Nagatsu	

**Cultural Program: Room L****29 (Wed) Morning****B-Cluster Admin Bldg 3F Conference Hall** **9:30-12:30**

Lectures on Kyoto and Japanese Culture in parallel with the scientific sessions. See page 3 for details.

Kyoto—*Past and Present*: An introduction to Japan's Ancient Capital**Bonnie Jennifer Shikiko Kawakami** and Junko Kawai**Excursion:****29 (Wed) Afternoon****Departing from Rohm Plaza** **13:10-18:00**

Lunch is served on the tour bus.

**Katsura Campus: Room B****29 (Wed) Morning****B-Cluster Admin Bldg 1F Katsura Hall 9:10–13:00****Environmental applications (9:10–11:00) Chair: K. Okazaki & U. Kogelschatz Abst. Page**

29B-a1	Thermal plasma treatment of detention pond sludges - Toward solution to non-point source pollutants	711
<b>Invited</b>	<b>Jen-Shih Chang</b> , O. L. Li and Y. Guo	
29B-a2	Analyses of fine particle formations by pulsed arc electrohydraulic discharges in water with Fe and Ti electrodes	712
	<b>T. Ikeda</b> , H. Li, K. Teii and J.-S. Chang	
29B-a3	Submerged thermal plasma technology for process liquor treatment	713
	<b>G. Soucy</b> , L. Fortin, G. Poirier, P. Quintal and L. Armstrong	
29B-a4	Organic liquid waste gasification by underwater thermal plasma	714
	<b>N. Boudesocque</b> , F. Lemort, C. Girold, C. Lafon, C. Vandesteendam and J.-M. Baronnet	
29B-a5	Bactericidal effects of positively and negatively charged cluster ions generated by atmospheric plasma discharge	715
	<b>K. Nishikawa</b> and H. Yagi	
	Coffee break (11:00–11:20)	

**Environmental applications (11:20–13:00) Chair: U. Kogelschatz & K. Okazaki Abst. Page**

29B-a6	Study on plasma incineration and vitrification for simulative waste from NPPs	716
	C. Cheng, D. Tang and <b>H. Tong</b>	
29B-a7	Reduction of iron ore by a mixture of Ar-H <sub>2</sub> with CO and CO <sub>2</sub> under plasma application	717
	<b>K. Badr</b> , E. Bäck and W. Krieger	
29B-a8	The plasma-catalytic processing of Aromatic, Saturated and Unsaturated hydrocarbons for environmental clean-up	718
	<b>A. M. Harling</b> , V. Demidiouk, S. Futamura, S. L. Hill, H.-H. Kim and J. C. Whitehead	
29B-a9	Additive effect of water on the reaction behavior of VOCs in nonthermal plasma	719
	<b>S. Futamura</b> , T. Terasawa and M. Sugasawa	
29B-a10	Recent experiments with diesel particulate and NO <sub>x</sub> reduction systems based on nonthermal plasma combined processes	720
	<b>M. Okubo</b> , T. Kuroki, K. Yoshida, H. Fujishima, K. Otsuka and T. Yamamoto	

**Cultural Program: Room L****29 (Wed) Morning****B-Cluster Admin Bldg 3F Conference Hall 9:30-12:30**

Lectures on Kyoto and Japanese Culture in parallel with the scientific sessions. See page 3 for details.

Kyoto—*Past and Present*: An introduction to Japan's Ancient Capital  
**Bonnie Jennifer Shikiko Kawakami** and Junko Kawai**Excursion:****29 (Wed) Afternoon****Departing from Rohm Plaza 13:10-18:00**

Lunch is served on the tour bus.

**Katsura Campus: Room C****29 (Wed) Morning****C-Cluster C1 Bldg 3rd Blk 1F Lecture Hall 9:10–13:00****Plasma aided combustion and aerodynamics (9:10–11:00) Chair: J. -M. Povesle Abst. Page**

29C-a1	Micro plasma thruster for ultra small satellites: plasma chemical and aerodynamical aspects	641
<b>Invited</b>	<b>Koichi Ono</b>	
29C-a2	Low-temperature ignition of hydrocarbons by repetitively pulsed, nanosecond pulse duration plasma A. Bao, Y. G. Utkin, S. Keshav and <b>I. V. Adamovich</b>	642
29C-a3	Spark ignited methane/air mixtures: experimental and modelling studies <b>J.-M. Bauchire</b> , C. Zaepffel and D. Hong	643
29C-a4	Forcing Mechanisms in a direct-Current surface plasma Actuator in a supersonic flow <b>J. Shin</b> , S. Mahadevan, V. Narayanaswamy, N. Clemens and L. Raja	644
29C-a5	Measurement of instantaneous gas flow induced by plasma actuator with laser Doppler velocimeter <b>N. Takeuchi</b> , K. Yasuoka and S. Ishii	645
	Coffee break (11:00–11:20)	

**Plasma chemical syntheses (11:20–13:00) Chair: Y. Pu Abst. Page**

29C-a6	Synthesis of amorphous silicon oxynitride nanowires from silicon wafers by ammonia plasma <b>J. Zheng</b> , X. Song, X.-G. Li and Y.-K. Pu	550
29C-a7	In-liquid plasma chemical deposition <b>Y. Takahashi</b> , H. Toyota, S. Nomura and S. Mukasa	551
29C-a8	Reforming of CO <sub>2</sub> -containing natural gas with partial oxidation using an AC gliding arc discharge system <b>S. Chavadej</b> , N. Rueangjitt and T. Sreethawong	552
29C-a9	Plasma conversion of hydrocarbons and fuels into hydrogen-containing gas A. Babaritskiy, M. Bibikov, F. Chebankov, M. Deminsky, S. Dyomkin, V. Jivotov, A. Moskovskiy, V. Rusanov, R. Smirnov and <b>B. Potapkin</b>	553
29C-a10	Synthesis gas production from methane and air mixture with a vortex gliding arc reactor <b>J. Heo</b> , J.-W. Choi, H. Lee, H. Sekiguchi and H. K. Song	554

**Cultural Program: Room L****29 (Wed) Morning****B-Cluster Admin Bldg 3F Conference Hall 9:30-12:30**

Lectures on Kyoto and Japanese Culture in parallel with the scientific sessions. See page 3 for details.

Kyoto—*Past and Present*: An introduction to Japan's Ancient Capital  
**Bonnie Jennifer Shikiko Kawakami** and Junko Kawai

**Excursion:****29 (Wed) Afternoon****Departing from Rohm Plaza 13:10-18:00**

Lunch is served on the tour bus.

## Yoshida Campus: Room A

30 (Thu) Morning

Clock Tower 1F		9:10–13:10
<b>Plenary (9:10–9:50) Chair: A. Fridman</b>		Abst. Page
30A-a0	Use of low pressure plasma discharge for the decontamination and sterilization of medical devices	3
<b>Invited</b>	<b>François Rossi</b>	
Short break (9:50–10:00)		
<b>Plasma deposition and treatment of polymers (10:00–11:20) Chair: H. K. Yasuda &amp; H. Biederman</b>		Abst. Page
30A-a1	Wood surface functionalisation by means of atmospheric plasma pressure polymerization E. Aimo Boot, G. Benveniste, F. Cartasegna, D. D'Angelo, <b>M. Perucca</b> , G. Piacenza and R. Zanuttini	427
30A-a2	Influence of hydrogen content in polymer chemical structure on surface modification in N <sub>2</sub> /H <sub>2</sub> atmospheric pressure plasmas <b>C. Sarra-Bournet</b> , G. Ayotte, S. Turgeon, F. Massines and G. Laroche	428
30A-a3	In-line atmospheric pressure plasma (APP) treatment of synthetic fibres and fabrics. <b>C. Pavan</b> , F. Parisi, G. Rombolà, S. Gross, P. Quagliotto and G. Viscardi	429
30A-a4	The role of chemical structures in amorphous plasma enhanced chemical vapour deposited titanium oxide-like films for their absorption in the uv range <b>A. Sonnenfeld</b> , R. Hauert, U. Mueller and P. Rudolf von Rohr	430
Coffee break (11:20–11:40)		
<b>Plasma deposition and treatment of polymers (11:40–13:10) Chair: H. Biederman &amp; H. K. Yasuda</b>		Abst. Page
30A-a5	Solution plasma processing (SPP)	431
<b>Invited</b>	<b>Osamu Takai</b>	
30A-a6	Deposition of poly(acrylic acid) coatings by electro-spray on DBD pretreated PE films <b>L. Tatoulian</b> , F. Arefi-Khonsari, M. Tatoulian and J. P. Borra	432
30A-a7	Pretreatment of polyolefins and deposition of thin organic films from HMDSO/O <sub>2</sub> mixtures with an atmospheric pressure plasma jet <b>U. Lommatzsch</b> , J. Ihde, D. Pasedag and H.-E. Wagner	433
30A-a8	Characterization of plasma deposited allylamine polymer and its effects on separation property of composite membranes <b>D. T. Tran</b> , S. Mori and M. Suzuki	434
Lunch (13:10–14:10)		



## Yoshida Campus: Room B

30 (Thu) Morning

Law & Economics 1F South-East		9:10–13:10
<b>Plenary</b> (9:10–9:50) Remote AV		Abst. Page
30A-a0	Use of low pressure plasma discharge for the decontamination and sterilization of medical devices	3
<b>Invited</b>	<b>François Rossi</b>	
Short break (9:50–10:00)		
<b>Non-equilibrium effects and atmospheric pressure plasma processes</b> (10:00–11:20) Chair: <b>L. Bardos &amp; T. Watanabe</b>		Abst. Page
30B-a1	Fluorination of polymers by means of atmospheric pressure glow dielectric barrier discharges <b>F. Fanelli</b> , R. d'Agostino, F. Fracassi and E. Magrino	139
30B-a2	Atmospheric O <sub>2</sub> and H <sub>2</sub> DBD plasmas for decontamination and reduction of steel surfaces E. Michel, E. Silberberg and <b>F. Reniers</b>	140
30B-a3	Atmospheric pressure PECVD for crystalline silicon solar wafer processing <b>V. Hopfe</b> , I. Dani, E. Lopez and M. Heintze	141
30B-a4	Gas phase diagnostics in nonequilibrium atmospheric-pressure pulsed remote plasma for glass cleaning <b>M. Iwasaki</b> , M. Ito, T. Yara, T. Uehara and M. Hori	142
Coffee break (11:20–11:40)		
<b>Non-equilibrium effects and atmospheric pressure plasma processes</b> (11:40–13:10) Chair: <b>T. Watanabe &amp; L. Bardos</b>		Abst. Page
30B-a5	Enhancing the production of reactive plasma species without compromising plasma stability in cold atmospheric discharges	143
<b>Invited</b>	<b>Michael Kong</b> , Jian J. Shi, James L. Walsh, S. Perni and Xutao T. Deng	
30B-a6	Comparison of N <sub>2</sub> -O <sub>2</sub> and N <sub>2</sub> -N <sub>2</sub> O Townsend dielectric barrier discharge E.-T. Es-Sebbar, N. Gherardi and <b>F. Massines</b>	144
30B-a7	Influences of different Factors on dielectric barrier discharge in air <b>G.-J. Zhang</b> , Y. Yang, G.-Q. Yang, Y.-B. Zhang and W.-Y. Zhang	145
30B-a8	Comparison of industrial atmospheric pressure plasma (APP) treatments and vacuum plasma treatments <b>F. Parisi</b> , G. Rombolà, C. Pavan and D. Daprà	146
Lunch (13:10–14:10)		

## Yoshida Campus: Room C

30 (Thu) Morning

Law & Economics 1F North-East		10:00–13:10
<b>Fundamentals of plasma-surface interactions</b> (10:00–11:20) Chair: <b>J. Vlcek &amp; M. Hori</b>		Abst. Page
30C-a1	Energetic neutral particle production in the cathode sheath of direct-current discharges <b>T. Ito</b> and M. Cappelli	9
30C-a2	Surface catalytic contributions to molecule conversion in plasmas <b>R. Zijlmans</b> , S. Welzel, O. Gabriel, G. Yagci, J. Röpcke, F. Hempel, D. Schram and R. Engeln	10
30C-a3	Impact of reactor walls chemical composition on radicals densities in the chlorine based silicon etching ICP plasmas <b>N. Sadeghi</b> , G. Cunge and R. Ramos	11
30C-a4	Molecular dynamics simulations of low energy ion bombardment on gallium arsenide surfaces <b>E. Despiau-Pujo</b> , P. Chabert and D. B. Graves	12
Coffee break (11:20–11:40)		
<b>Fundamentals of plasma-surface interactions</b> (11:40–13:10) Chair: <b>M. Hori &amp; J. Vlcek</b>		Abst. Page
30C-a5	Insights into plasma-surface interactions from molecular dynamics simulations and beam experiments <b>Invited</b> <b>David B. Graves</b> , J. J. Végh and D. G. Nest	13
30C-a6	Molecular dynamics simulation of plasma surface interactions for reactive ion etching and thin film formation <b>S. Hamaguchi</b> , H. Hashimoto, M. Matsukuma, T. Takizawa, M. Taguchi and M. Yamashiro	14
30C-a7	Effects of ultraviolet (UV) light irradiation on sputtering yields by CF <sub>3</sub> ion beam injections <b>K. Ikuse</b> , S. Yoshimura, M. Kiuchi, T. Takizawa, T. Toyoshima, K. Karahashi and S. Hamaguchi	15
30C-a8	Plasma surface interactions: the key to EUVL viability <b>D. Ruzic</b> , M. Neumann, H. Shin, H. Qui, J. Spencer, K. Thompson, S. Srivastava and W. Lytle	16
Lunch (13:10–14:10)		

## Yoshida Campus: Poster

## 30 (Thu) Afternoon

Clock Tower 2F (193 posters)

14:10–15:50

## Diagnostics and modeling in plasma chemistry

Abst. Page

30P-1	Two-dimensional simulation of surface preparation species in a low-pressure Ar+H <sub>2</sub> plasma <b>K. K. Ostrikov</b> , H. J. Yoon, A. Rider, V. Ligatchev and E. Tsakadze	79
30P-2	Modelling of Ar-C-O-H-Sn discharge for SnO <sub>x</sub> deposition <b>W. Morscheidt</b> , N. Ning, A.-M. Coclite, J. Pulpytel, K. Hassouni and F. Arefi-Khonsari	80
30P-3	Modelling of carbon dust formation by cluster growth in plasmas X. Bonnin, G. Lombardia, <b>K. Hassouni</b> , A. Michau, F. Bénédica and C. Arnas	81
30P-4	On Fe(CO) <sub>4</sub> quantum dots formation in plasma synthesis of Fe <sup>0</sup> nanocomposite <b>E. Apostolova</b> and A. Tikhonov	82
30P-5	Electron impact dissociation behavior of organosilicon molecules Y. Yun, <b>N. Nanba</b> , T. Yoshida, N. Shimazu, Y. Inoue, N. Saito and O. Takai	83
30P-6	Calculation of combined diffusion coefficients for Ar/He, Ar/Cu and Ar/Fe mixtures <b>Y. Cressault</b> , P. Teulet and A. Gleizes	84
30P-7	Chemical reactions in heat and mass transfer Between Small particles and plasma <b>J. Amouroux</b> , S. Dresvin and D. Ivanov	85
30P-8	Plasma-damage prediction system with on-wafer sensors and neural network <b>H. Ohtake</b> , Y. Ishikawa, Y. Ichihashi and S. Samukawa	86
30P-9	High-rate SiC etching with high-density plasma <b>K. Fujii</b> , I. Nakatani and <b>A. Doi</b>	87
30P-10	Effect of the wall material on the species density distributions in a large volume N <sub>2</sub> -O <sub>2</sub> post-discharge reactor <b>K. Kutasi</b> , J. Loureiro and C. Pintassilgo	88
30P-11	Determining the electron density in low-pressure nitrogen and argon plasmas by optical emission spectroscopy <b>X.-M. Zhu</b> and Y.-K. Pu	89
30P-12	Radical monitoring probe for measurements of H, N, O and C atomic radical densities in reactive process plasmas <b>S. Takahashi</b> , S. Takashima, K. Yamakawa, S. Den, H. Kano, M. Ito and M. Hori	90
30P-13	Effect of behaviors of activated species on Si oxidation in Ar diluted O <sub>2</sub> surface wave plasma on production level <b>K. Takeda</b> , S. Takashima and M. Hori	91
30P-14	Influence of mercury traces on pure nitrogen post-discharge at decreased wall temperature F. Krcma, <b>Z. Stara</b> , A. Hrdlicka, V. Kanicky, V. Otruba and P. Krasensky	92
30P-15	Reactivity of low pressure glow discharges in He-O <sub>2</sub> and Ar-O <sub>2</sub> gas mixtures with coked catalysts <b>M. Khan</b> and A. Aljalal	93
30P-16	Concentration measurement of H density in H <sub>2</sub> /Ar and CH <sub>4</sub> /Ar ICPs by optical actinometry <b>Y. Matsuda</b> , T. Shibasaki, M. Shinohara and H. Fujiyama	94
30P-17	Mechanism of dissociative excitation of BrCN in electron cyclotron resonance plasma of He and Ar <b>H. Ito</b>	95
30P-18	Spectroscopic study on dissociation degree of nitrogen and oxygen in N <sub>2</sub> -O <sub>2</sub> microwave discharge plasma Y. Ichikawa, T. Sakamoto, H. Matsuura and <b>H. Akatsuka</b>	96
30P-19	Plasma monitoring using a quartz sensor <b>A. Suzuki</b> , A. Kurokawa and H. Nonaka	97
30P-20	Spatio-temporal diagnostics of the plasma in xenon fluorescent lamp with auxiliary external electrode <b>Y. Toda</b> , S. Iwaki, Y. Imai, H. Kurokawa, H. Motomura and M. Jinno	98
30P-21	VUV emission from microwave CO-Xe gas discharge: direct energy transfer from excited Xe atoms to CO molecules <b>J.-S. Oh</b> , K. Yanai, K. Kawamura and A. Hatta	99
30P-22	Multiscale multiphysics non-empirical approach to calculation of light emission properties of chemically active non-equilibrium plasmas S. Adamson, V. Astapenko, I. Chernysheva, V. Chhorkov, M. Deminskii, A. Demura, G. Demchenko, N. Dyatko, A. Eletsii, A. Knizhnik, I. Kochetov and A. Napartovich and <b>B. Potapkin</b>	100
30P-23	Observation of H <sup>-</sup> /D <sup>-</sup> negative ion in sheet plasma <b>H. Ishioka</b> , A. Tonegawa, M. Ono and K. Kawamura	101
30P-24	Observation and modelling in high density hydrogen plasma <b>T. Nishijima</b> , A. Nakanowatari, A. Tonegawa, M. Ono and K. Kawamura	102
30P-25	Characteristics of fluorine negative ions diffused radially around a CF <sub>4</sub> magnetized plasma column M. A. Imtiaz and <b>T. Mieno</b>	103
30P-26	Comparison of the ionization efficiency of Ti in magnetron sputtering plasmas with various discharge gases <b>N. Nafarizal</b> , N. Takada, K. Nakamura, Y. Sago and K. Sasaki	104

30P-27	Electron dynamics in capacitively coupled RF discharges J. Schulze, B. G. Heil, D. Luggenhölscher, T. Kampschulte and U. Czarnetzki	105
30P-28	Calculation of two-temperature composition for argon and air plasmas H. Hingana, P. Teulet, Y. Cressault and A. Gleizes	106
30P-29	Study of electron energy distribution function in helium afterglow R. Plasil, I. Korolov, T. Kotrik, O. Novotny, J. Varju, Z. Donko, G. Bano and J. Glosik	107
30P-30	IEDF measurement of multiple frequency capacitive discharges Y.-K. Pu, Z.-G. Guo, S. Zhang, J.-Y. Chen, X.-Y. Qian and T. Ni	108
30P-31	Inelastic processes in a low pressure inductively coupled CH <sub>4</sub> /H <sub>2</sub> plasma K. Okada, S. Komatsu and S. Matsumoto	109
30P-32	Experimental study on inductively coupled RF CF <sub>4</sub> /O <sub>2</sub> /Ar discharges T. Kimura, K. Hanaki and S. Shimagami	110
30P-33	Modeling of electron containment and cooling in magnetic trap T. Kotrik, R. Plasil, M. Jilek, M. Komm, I. Korolov and J. Glosik	111
30P-34	Theoretical and experimental aspects of carbon formation in thermal plasmas K. A. Föglein, J. Gubicza, I. Z. Babiewskaya and J. Szépvölgyi	112
30P-35	Time-dependent 3-D modelling of DC transferred arc twin torch V. Colombo and E. Ghedini	113
30P-36	Advanced modelling of RF and DC thermal plasma torches for industrial applications V. Colombo and E. Ghedini	114
30P-37	Time dependent 3D large Eddy simulation of a DC non-transferred arc plasma spraying torch with particle injection E. Ghedini and V. Colombo	115
30P-38	Comparison of plasma-sprayed zirconia particle melting states obtained by experiment and 3D time-dependent plasma torch modelling C. Bourgeois, V. Debout and E. Meillot	116
30P-39	Mathematical modeling of argon plasma in ICP torch by non-equilibrium model S. Dresvin, J. Amouroux and D. Ivanov	117
30P-40	Modeling of thermal and chemical non equilibrium Ar/(He,H <sub>2</sub> ,O <sub>2</sub> ,N <sub>2</sub> ) supersonic induction plasmas M. El Morsli, A. Bannari, I. Bolduc, N. Trigoulet and P. Proulx	118
30P-41	Calculation of net emission coefficients of radiation in argon thermal plasmas V. Aubrecht and M. Bartlova	119
30P-42	Controlled arc rotation using a 2-phase AC field A. Westermoen and J. A. Bakken	120
30P-43	Diagnostic of thermionic vacuum arc plasma produced in pure chromium vapors C. P. Lungu, A. M. Lungu, C. Surdu-bob and M. Osiac	121
30P-44	Non-equilibrium hydrogen radical concentration in pulse-modulated Ar-H <sub>2</sub> induction thermal plasmas for hydrogen doping into zinc oxide R. Ye and T. Ishigaki	122
30P-45	Temperature measurement in a DC laminar plasma jet X. Meng, T. Li, W. Pan, X. Chen and C. Wu	123
30P-46	Emission spectroscopy diagnostic of liquid injection in induction RF thermal plasma Y. Lakaf, F. Gitzhofer and D. Gravelle	124
30P-47	Photocatalysers activated by water stabilized plasma radiation V. Brozek, V. Sember, M. Hrabovsky, J. Janca and J. Domlatil	125
30P-48	Influence of alkaline salts on radiative properties of laser induced water plasma R. Hannachi, Y. Cressault, P. Teulet, A. Gleizes and Z. Ben Lakhdar	126
30P-49	Spectroscopic study on water vapor microwave plasma K. Kawamura, K. Yanai, K. P. Bimal, J.-S. Oh and A. Hatta	127
30P-50	Breakdown of DC diaphragm discharge in liquids J. Prochazkova, Z. Stara and F. Krema	128
30P-51	One-dimensional modelling of high-pressure xenon barrier discharge S. Avtaeva, V. Lelevkin, E. Kulumbaev and A. Skorniyakov	129
30P-52	One-dimensional fluid simulations of high-pressure Xe barrier discharges: effect of frequency S. Avtaeva and E. Kulumbaev	130
30P-53	Proton conducting polymer surface treated by atmospheric pressure helium/hydrogen plasma I. G. Koo, J. H. Cho, M. Y. Choi and W. M. Lee	131
30P-54	The deposition mechanism of atmospheric pressure glow plasma polymerized polyethylene K. Tanaka and M. Kogoma	132
30P-55	Influence of gas humidity in atmospheric pressure helium plasma J. H. Cho, I. G. Koo, Y. D. Park and W. M. Lee	133

30P-56	Monitoring plasma density using V-I phase difference in the atmospheric pressure dielectric barrier discharge <b>S.-H. Lee</b> , H.-C. Kwon, S.-Y. Jeong and G.-H. Kim	134
30P-57	Comparison of two different DBD reactors for ethylene removal <b>Y.-C. Chen</b> , S.-H. Chen, H.-M. Lee and M.-H. Huang	135
30P-58	Investigation of discharge dynamic and chemical kinetics in the microdischarges generated in a multipin-to-plane pulsed N <sub>2</sub> /O <sub>2</sub> corona system working in the nanosecond regime N. Aggadi, M. Redolfi, X. Duten, A. Michau and <b>K. Hassouni</b>	136
30P-59	Dielectric barrier discharge driven by a flyback circuit: analysis using energy resolved molecular beam mass spectrometry <b>Y. Aranda-Gonzalvo</b> , D. L. Seymour, C. L. Greenwood, J. A. Rees, T. D. Whitmore, V. J. Law and S. Daniels	137

**Plasma sources: designs and characterizations**

Abst. Page

30P-60	Magnetron design for AF plasma polymerization of dielectric films <b>L. Ledernez</b> , F. Olcaytug, G. Urban and H. Yasuda	279
30P-61	Effects of discharge conditions on kHz dielectric barrier discharge <b>G.-Q. Yang</b> , Y. Yang, G.-J. Zhang and W.-Y. Zhang	280
30P-62	Experimental and numerical analysis of microwave plasma using multi-hole dielectric plate <b>S. Nakao</b> , I. P. Ganachev and H. Sugai	281
30P-63	Discharge gap effect on VHF H <sub>2</sub> plasma characteristics Y. Yamauchi, Y. Takeuchi, H. Takatsuka, H. Muta and <b>Y. Kawai</b>	282
30P-64	On the E-H transition mechanisms in inductively coupled plasmas M. H. Lee and <b>C. W. Chung</b>	283
30P-65	Ion cyclotron resonance heating in a magnetized sheet plasma <b>Y. Ohara</b> , H. Matsumoto, A. Tonegawa, M. Ono and K. Kawamura	284
30P-66	Magnetic field effect on obstructed discharge used for cold cathode electron source <b>A. H. Sari</b> , M. Ghoranneviss, N. Bolouki, S. H. Mortazavi, M. Khoramabadi and H. R. Ghomi	285
30P-67	A novel plasma setup for depositing plasma polymers <b>J. Jiang</b> , M. Benter, K. West and K. Bechgaard	286
30P-68	Diamond etching with capacitively coupled plasma using MgO electrodes <b>M. Murakami</b> , T. Misu, M. Goto and T. Arai	287
30P-69	Influences of oxygen on the features of radio-frequency, atmospheric-pressure, bare-metallic-electrode glow discharges W.-T. Sun, G. Li, S. Wang, <b>H.-P. Li</b> and C.-Y. Bao	288
30P-70	Effects of ionic liquid electrode on the generation of radio frequency plasmas <b>K. Baba</b> , T. Kaneko and R. Hatakeyama	289
30P-71	Study of high frequency plasma generation in supercritical carbon dioxide <b>A. Kawashima</b> , T. Takemori, H. Toyota, S. Nomura, S. Mukasa, H. Yamashita and T. Machara	290
30P-72	Design of new ICP system and improvement of etching uniformity <b>S. Nakagami</b> , H. Nakano, T. Tatuta, M. Sawai and O. Tsuji	291
30P-73	Large-scaled line plasma generation by microwave in a narrowed rectangular waveguide <b>H. Shindo</b> , E. Abdel Fattah, Y. Sudo, M. Suzuki and Y. Kitamura	292
30P-74	Novel ferromagnetic enhanced inductively coupled plasma for large area plasma processing <b>K. H. Lee</b> , Y. K. Lee, S. Jo and C. W. Chung	293
30P-75	Development of large-volume plasma source for medical sterilization <b>S. Mrityunjai K.</b> , K. Ninomiya, L. Xu, A. Ogino, Y. Koide, S. Nanko, I. Kurawaki and M. Nagatsu	294
30P-76	Characterization of argon/oxygen mixture plasmas driven by Multiple internal-Antenna Units <b>K. Takenaka</b> , Y. Setsuhara, A. Ebe, Y.-M. Kim and J. G. Han	295
30P-77	Meters-Scale ultra-large-Area plasma source designs employing Multiple low-inductance-Antenna modules <b>Y. Setsuhara</b> , D. Tsukiyama, K. Takenaka and A. Ebe	296
30P-78	Measurement of negative hydrogen ion densities in high density recombining hydrogen plasmas <b>K. Shibagaki</b> , T. Hirasawa and K. Sasaki	297
30P-79	Surface-wave negative ion plasma production in a very high permittivity discharge tube <b>K. Kusaba</b> , M. Suzuki, T. Morishita, T. Mori, S. Tanaka and H. Shindo	298
30P-80	Plasma parameters in the cylindrical tube low-pressure xenon ICP lamps <b>A. N. Dagang</b> , A. Kondo, T. Takeda, H. Motomura and M. Jinno	299
30P-81	Reduction of harmonic currents and evaluation of luminous efficiency in a lag type operating circuit of a metal halide lamp <b>M. Kurozumi</b> , T. Sakota and M. Otsubo	300

30P-82	A nitrogen plasma light source stimulated by RF electrodeless field discharge for CTCP technology in printing <b>C. Li, Q. Chen and G. Zhang</b>	301
30P-83	Metal halide lamps from 1 to 10 g <b>W. Stoffels, A. Flikweert, T. Nimalasuriya, M. Beks, J. van der Mullen, M. Haverlag and G. Kroesen</b>	302
30P-84	Emission spectroscopy of DBD plasma in mixtures of cadmium halide vapor with gases <b>M. Guivan, A. Malinin, H. Motomura and M. Jinno</b>	303
30P-85	Influences of magnetic field and acceleration channel configurations on performance of Hall-effect thrusters <b>H. Tahara and S. Yuge</b>	304
30P-86	Research and development of pulsed plasma thrusters <b>H. Tahara and T. Edamitsu</b>	305
30P-87	Experimental test of atmospheric gliding arc plasma source containing metal and non-metal electrode-material ions for plasma processing <b>K. Noro, H. Himura, S. Masamune, A. Sanpei, Y. Hasebe and T. Isshiki</b>	306
30P-88	Gliding arc plasma reactor supplied from AC/DC/AC inverter <b>H. D. Stryczewska, A. Sikorski, A. Ruszczyk and G. Komarzyniec1</b>	307
30P-89	Characterisation of the plasma needle by using derivative probes and fast ICCD camera <b>N. Puac, S. Lazovic, G. Malovic, A. Djordjevic and Z. L. Petrovic</b>	308
30P-90	Biomolecular effects using radio-frequency, atmospheric-pressure, bare-metallic-electrode glow discharge plasmas W.-T. Sun, G. Li, <b>H.-P. Li</b> , C.-Y. Bao, L.-Y. Wang, Z.-X. Gou, H.-X. Zhao and X.-H. Xing	309
30P-91	Development of the extended plasma source suitable for the etching of silicon wafers <b>V. Plaksin, V. A. Ryabyy, H. J. Lee, M. K. Ko, G. C. Sin, S. B. Joa and J. H. Kim</b>	310
30P-92	Electrospray-ionization plasma for deposition of ultra-thin polymer layers R.-D. Schulze, S. Weidner, U. Just and <b>J. F. Friedrich</b>	311
30P-93	Long life plasmatron with carbon nanostructured electrodes V. I. Golish, E. I. Karpenko, <b>V. E. Messerle</b> , V. Z. Ushanov and A. B. Ustimenko	312
30P-94	Impulse source of thermal plasma sprays <b>N. Mungkung, T. Thepluen, K. Korytchenko, A. Dovbnaya, A. Pleshkov, Y. Volkolupov and Y. Tur</b>	313
30P-95	Rotational instabilities in a thermal plasma jet J. Hlina and <b>J. Sonsky</b>	314
30P-96	Characterization of a dc plasma torch by pressure measurements: analytical model and experiments <b>V. Rat</b> and J.-F. Coudert	315
30P-97	Novel plasma source for thermal spray <b>K. Hadidi, E. Jordan, B. Cetegen and P. Woskov</b>	316
30P-98	Effect of dc arc anode attachment on flow structure of plasma jet <b>O. Chumak, K. Tetyana and M. Hrabovsky</b>	317
30P-99	Electrical characteristics of a multiple pulsed plasma torch <b>A. J. M. Pemen, F. J. C. M. Beckers, L. J. H. van Raay, Z. Liu, E. J. M. van Heesch and P. P. M. Blom</b>	318
30P-100	A comparison between Fluent and OpenFAOM for TIG plasma arc modeling A. Javidi Shirvan, M. Sass-Tisovskaya, <b>I. Choquet</b> and S. Zahrai	319
30P-101	Effect of pressure on evolution of plasma jet fluctuations <b>V. Kopecky</b> and M. Hrabovsky	320
<b>Plasma processing for micro electronics and mechanics</b>		<b>Abst. Page</b>
30P-102	Stable amine based plasma polymerized films on quartz crystals for immunosensor applications <b>D. Çökeliler, A. Choukourov, J. Kousal, J. Zemek, H. Biederman and M. Mutlu</b>	331
30P-103	Optimization of a Re TVA plasma parameters used for thin film deposition <b>M. Osiac, C. Surdu, C. Iacob and C. P. Lungu</b>	332
30P-104	Low dielectric constant SiCH: deposition and aging study <b>V. Jousseume, L. Favennec, C. Charles-Alfred and J. Gaillard</b>	333
30P-105	SiO <sub>x</sub> F <sub>y</sub> film growth in SiF <sub>4</sub> /O <sub>2</sub> plasma at cryogenic temperature L. E. Pichon, C. Duluard, T. Tillocher, <b>R. Dussart</b> , P. Lefauchaux, P. Ranson and M. Boufnichel	334
30P-106	Hydrogen effect on high rate and low temperature mesoplasma epitaxy <b>M. Kambara, J. M. A. Diaz, T. Ichikura and T. Yoshida</b>	335
30P-107	Characterization of reactive magnetron sputtered RuO <sub>2</sub> films implanted with nitrogen <b>D. Buc, I. Bello, M. Caplovicova, M. Mikula, D. T. K. Kwok, I. Hotovy and G. G. Siu</b>	336
30P-108	Tantalum nitride diffusion barriers made by inductively coupled plasma assisted reactive magnetron sputtering <b>S. M. Kim, G. R. Lee and J. J. Lee</b>	337

30P-109	Semiconducting cubic boron nitride thin films prepared by in-situ sputter-doping <b>K. Nose</b> and T. Yoshida	338
30P-110	Field emission characteristics of vertically aligned carbon nanotubes grown on submicron-sized catalyst array using plasma CVD <b>T. Matsuda</b> , M. Mesko, A. Ogino and M. Nagatsu	339
30P-111	High speed growth process of carbon nanowalls using radical injection plasma CVD <b>K. Yamakawa</b> , S. Den, T. Katagiri, H. Kano, M. Hiramatsu and M. Hori	340
30P-112	Low-damage fabrication of high aspect nanocolumns by using neutral beams and ferritin-iron-core mask <b>T. Kubota</b> , S. Saito and S. Samukawa	341
30P-113	Charging in aspect ratio dependent etching: an in-situ microcharging diagnostic for plasma etching E. Ritz, <b>D. Ruzic</b> and S. Srivastava	342
30P-114	Porous low- <i>k</i> film etching process and its diagnostics employing an alternative fluorocarbon gas <b>E. Shibata</b> , H. Sasaki, H. Okamoto and M. Hori	343
30P-115	Etching silica glass in inductively coupled fluorine-based plasmas L. Lallement, J.-M. Lorcy, C. Gosse and <b>C. Cardinaud</b>	344
30P-116	Plasma-chemical processing of silicon substrates using a plasmatron. V. Plaksin, <b>C. J. Yim</b> , M. K. Ko and H. J. Lee	345
30P-117	Analysis of plasma-surface interactions during etching of Si and high- <i>k</i> HfO <sub>2</sub> films by in situ diagnostics of reactants and reaction products <b>Y. Ueda</b> , M. Yoshida, K. Eriguchi and K. Ono	346
30P-118	Decreasing of residual oxygen by using Si solid source in Cl <sub>2</sub> -ICP etching of Al <b>A. Matsutani</b> , H. Ohtsuki and F. Koyama	347
30P-119	Optical wiring circuit formed in two dimensional photonic crystal by plasma processes K. Suzuki, <b>M. Suzuki</b> and S. Morita	348
30P-120	Patterning of thin GaAs suspended membranes for gas microsensors using a dry etching technique S. Hascik, I. Hotovy, T. Lalinsky and <b>V. Rehacek</b>	349
30P-121	Considerations for the use of plasma in wafer level microelectronics packaging <b>J. Getty</b> and <b>J. Zhao</b>	350
30P-122	Tunneling magnetoresistive structures prepared by thermionic vacuum arc <b>C. P. Lungu</b> , A. Anghel, I. Mustata, A. M. Lungu, C. Iacob and M. Badulescu	351
30P-123	Diagonstics of rapid crystallization of amorphous silicon utilizing teh tehrmal plasma annealing <b>Y. Mie</b> , K. Haruta, T. Kobayashi and H. Shirai	352
30P-124	Effect of plasma fluorination of epoxy resin used as passive optical waveguide A. Airoudj, D. Debarnot, B. Beche and <b>F. Poncin-Epaillard</b>	353

**Clusters, particles and powders**

Abst. Page

30P-125	Influence of particle surface energy on the flow behavior of lactose powder treated by PECVD <b>A. Spillmann</b> , A. Sonnenfeld and P. Rudolf von Rohr	513
30P-126	Oxidation of activated carbon using a hybrid fluidized bed-dielectric barrier discharge system <b>A. J. Martinez-Gomez</b> , V. Gonzalez-Alvarez, A. Gonzalez-Alvarez, M. A. Sanchez-Castillo and L. E. Cruz-Barba	514
30P-127	Chemical and structural modifications induced by low pressure plasma on multi-wall carbon nanotubes <b>A. Felten</b> , C. Bittencourt, J.-F. Colomer, D. Ling, G. Van Tendeloo, J. Mayer and J.-J. Pireaux	515
30P-128	Carbon black processing by pyrolysis of methane in a supersonic ICP M. El Morsli and <b>P. Proulx</b>	516
30P-129	Study of the basic surface properties of granular filtering materials coated with plasma deposited films by allylamine vapours <b>N. De Vietro</b> , F. Fracassi and R. d'Agostino	517
30P-130	In-situ measurement of synthesis process of carbon clusters under gravity-free arc discharge by the Mie scattering method <b>T. Mieno</b> , S. Usuba and M. Shiratani	518
30P-131	Analysis of neutral species in the downstream region of CF <sub>4</sub> , C <sub>2</sub> F <sub>6</sub> , and C <sub>3</sub> F <sub>8</sub> plasmas by Li <sup>+</sup> ion attachment mass spectrometry <b>H. Okumura</b> , K. Furuya and A. Harata	519
30P-132	Mass spectrometric analysis of chemical species in the downstream region of Ar/CH <sub>4</sub> plasmas <b>A. Ide</b> , H. Okumura, K. Furuya and A. Harata	520
30P-133	Effect of additives on fullerene formation in RF thermal plasma conditions <b>I. Mohai</b> , J. Szépvölgyi, M. Hardi, E. Kováts, B. Todorovic-Markovic and Z. Markovic	521
30P-134	Synthesis of spherical carbon particles of micron size from a DC methane/Ar plasma <b>Z. Feng</b> , A. Kono, T. Nagai and F. Shoji	522



30P-135	Novel carbon nanostructures synthesized by liquid arc in magnetic field <b>G. Xing</b> , S. Jia, J. Xing and Z. Shi	523
30P-136	Vertically aligned carbon nanotubes growth from carbon-encapsulated metal nanoparticles <b>M. Mesko</b> , Q. Ou, T. Matsuda, T. Tanaka, A. Ogino and M. Nagatsu	524
30P-137	Gas phase synthesis of single-walled carbon nanotubes by plasma chemical vapor deposition and their properties of hydrogen storage <b>Y. Hayashi</b> , N. Imazato and M. Imano	525
30P-138	Characteristics of nanostructured ZnO Phosphors fabricated using laser ablation method <b>Q. Ou</b> , A. Ogino and M. Nagatsu	526
30P-139	Size control of TiO <sub>2</sub> nanoparticles through quench gas injections into RF induction thermal plasma <b>M. Ikeda</b> , J.-G. Li, R. Ye, N. Kobayashi, Y. Moriyoshi and T. Ishigaki	527
30P-140	Photocatalytic TiO <sub>2</sub> nanocrystals prepared by confined laser plasma in water and introduced into hydrogenated silicon based junctions <b>J. Stuchlík</b> , V. Švrček, T. H. Stuchlíková, T. Q. Trung, A. Fojtík and J. Kočka	528
30P-141	RF thermal plasma processing and room temperature ferromagnetic properties of cobalt doped TiO <sub>2</sub> nanopowders <b>J.-G. Li</b> , T. Ishigaki, R. Buechel and S. Pratsnis	529
30P-142	Transport of nano-particles in amplitude modulated RF discharges <b>S. Iwashita</b> , K. Koga and M. Shiratani	530
30P-143	Thermal plasma synthesis and annealing of SiCN composite nanopowders <b>R. Mach</b> , U. Letzig, H.-E. Maneck, F. Oleszak, M.-M. Pohl, J. F. Friedrich and K. Richter	531
30P-144	Simulation of a-Si:H deposition for multi-hollow discharge plasma CVD method <b>W. M. Nakamura</b> , D. Shimokawa, K. Koga and M. Shiratani	532
30P-145	Thermal plasma synthesis of silica nanoparticles with controlled particle size <b>Z. Károly</b> and J. Szépvölgyi	533
30P-146	Nanoparticle generation in high pressure SiH <sub>4</sub> /H <sub>2</sub> discharges <b>S. Nunomura</b> and M. Kondo	534
30P-147	Non-thermal plasma synthesis and in-flight passivation of luminescent silicon nanocrystals <b>L. Mangolini</b> and U. Kortshagen	535
30P-148	Room temperature and high rate deposition of silicon nanoparticles using pulse-modulated UHF plasma <b>E. Takahashi</b> , Y. Ito, T. Chikyow and M. Hori	536
30P-149	Diagnostics of a plasma process to synthesize cube shaped silicon nanocrystals A. Bapat, Y.-P. Ding, S. Campbell and <b>U. Kortshagen</b>	537
30P-150	Synthesis of spinel ferrites in radiofrequency thermal plasma reactor <b>J. Szépvölgyi</b> , L. Gál, I. Mohai, I. Mészáros and J. Gubicza	538
30P-151	Synthesis of Ga-N powders in RF induction thermal plasma <b>N. Kobayashi</b> , J. G. Li, T. Watanabe and T. Ishigaki	539
30P-152	Preparation of iron-nickel alloy ultrafine particles using spraying of liquid materials into thermal plasma <b>K. Saitou</b>	540
30P-153	Induction plasma spheroidization of molybdenum powder <b>S. Uesaka</b> , G. Han, H. Takashima, S. Xue, J. Jurewicz and M. I. Boulos	541
30P-154	Nanocomposite hybrid membranes for proton exchange membrane fuel cell application K. Fatyeyeva and <b>F. Poncin-Epaillard</b>	542

#### Plasma spray and thermal plasma material processing

Abst. Page

30P-155	LPPS-thin film: a hybrid thermal spray process for PVD-like coatings and large area applications <b>M. Gindrat</b> , K. Von Niessen and A. Refke	601
30P-156	Reactive plasma spraying of aluminum nitride based coatings and evaluation of its property <b>M. Yamada</b> , C. C. Lee, T. Yasui, M. Fukumoto and K. Takahashi	602
30P-157	Preparation of high-value nano $\alpha$ -tricalcium phosphate powders by suspension induction plasma spraying (SIPS) <b>H. Park</b> , G. Baroud and F. Gitzhofer	603
30P-158	Investigation of supersonic thermal plasma Jet <b>V. Sember</b> and A. Maslani	604
30P-159	Research and development of supersonic plasma spraying in low pressure environment <b>H. Tahara</b> and Y. Ando	605
30P-160	Atmospheric pressure plasma spraying using microwave discharge <b>T. Yasui</b> , D. Yamaguchi, Y. Kimura and M. Fukumoto	606
30P-161	Research and development of MPD plasma spraying <b>H. Tahara</b> and Y. Ando	607
30P-162	Evaluation of in-flight particle process using a small power DC-RF hybrid plasma flow system H. Nishiyama, M. Onodera, J. Igawa and <b>T. Nakajima</b>	608



30P-163	In-flight melting mechanism of granulated powders for glass production by ar-gon-oxygen induction thermal plasmas <b>M. M. Hossain</b> , Y. Yao, Y. Oyamatsu, T. Watanabe, F. Funabiki and T. Yano	609
30P-164	Innovative in-flight glass melting technology using thermal plasmas T. Watanabe, <b>Y. Yao</b> , T. Yano, T. Iseda, O. Sakamoto, M. Iwamoto and S. Inoue	610
30P-165	In-flight melting of granulated powders in multi-phase arc for glass production <b>Y. Yao</b> , Y. Oyamatsu, T. Watanabe, F. Funabiki and T. Yano	611
30P-166	Modeling of radiative-convective heating of a single semitransparent ceramic particle in a plasma jet N. Rubtsov, <b>E. Kartae</b> v and O. Solonenko	612
30P-167	Modeling of the spreading dynamics and crystallization kinetics of a metal droplet modified with refractory nanoparticles after its impingement onto a substrate <b>A. Cherepanov</b> , V. Popov and O. Solonenko	613
30P-168	Finite-element modeling of the high energy flux treatment of Ni-Al heterogeneous coating deposited by cold spraying A. Golovin, <b>O. Solonenko</b> and V. Neronov	614
30P-169	Physicochemical properties of forming coating in conditions of plasma spraying technology <b>V. Frolov</b> and O. Egorova	615
30P-170	3D simulation of Ceramic particle heating in plasma Jet <b>L. Chen</b> , J. Mostaghimi and L. Pershin	616
30P-171	Study of powder dispersion at the injector exit and its influence on particles thermal and dynamic history <b>F. Ben Ettouil</b> , B. Pateyron, H. Ageorges, M. El Ganaoui and P. Fauchais	617
30P-172	Modeling of the flow and heat transfer in a thermal plasma reactor with the counter injection of carrier gas G.-Q. Wu, <b>H.-P. Li</b> , C.-Y. Bao and X. Chen	618
30P-173	Experimental study on the entrainment of turbulent plasma jets <b>H.-X. Wang</b> , X. Meng, X.-L. Hu, F.-Z. Wei, W. Pan, X. Chen and H.-B. Tang	619
30P-174	Influence of 'on-time' on increase in the excited nitrogen atom density in Ar-N <sub>2</sub> pulse-modulated induction thermal plasmas Y. Tanaka, <b>K. Hayashi</b> , T. Nakamura and Y. Uesugi	620
30P-175	Influence of the self absorption of oxygen lines on the temperature determination of a CaCl <sub>2</sub> -water LIBS plasma R. Hannachi, P. Teulet, <b>Y. Cressault</b> , A. Gleizes, Z. Ben Lakhdar and G. Taieb	621
30P-176	A nodal model for co-condensation synthesis of silicide nanoparticles using inductively coupled thermal plasmas <b>M. Shigeta</b> and T. Watanabe	622
30P-177	Thermally and chemically non-equilibrium modelling of high-power Ar-N <sub>2</sub> -H <sub>2</sub> inductively coupled plasmas <b>Y. Tanaka</b>	623
30P-178	Experimental study of the effect of arc root fluctuations on the injection in suspension plasma spraying R. Etchart-salas, <b>V. Rat</b> , J.-F. Coudert, P. Fauchais, N. Branland and S. Alexandre	624
30P-179	Minimization of negative influence of electrode wear on generated plasma in DC arc torches <b>T. Kavka</b> , T. Kupke and J. Arnold	625
30P-180	Measurement of arc mode in transverse magnetic field <b>T. Iwao</b> , K. Oinuma and M. Yumoto	626
30P-181	Characteristics of pulse low vacuum arc using metal cathode Covered with oxide Layer <b>Y. Arai</b> , M. Sugimoto, S. Sugiyama and K. Takeda	627
30P-182	Theoretical consideration on the interactive forces among magnetically driven arcs and their reduction <b>T. Yamamoto</b> , I. Kuno, K. Takeda, T. Toh, J. Tanaka, K. Yamamoto and S. Takeuchi	628
30P-183	Novel structured yttria-stabilized zirconia coatings fabricated by twin hybrid thermal plasma spraying <b>T. Ma</b> , K. Eguchi, M. Kambara and T. Yoshida	629
30P-184	Control of the adhesion of alumina or zirconia coatings onto iron based substrates through their surface structuration <b>A. Denoirjean</b> , S. Valette, J. Cedelle, M. Vardelle, P. Lefort and P. Fauchais	630
30P-185	Low friction graphite-metal coatings prepared by plasma spray <b>D. Trusca</b> , I. Trusca, A. M. Lungu, C. P. Lungu, V. Manoliu, C. Serghie, D. Buzescu and C. Puscasu	631
30P-186	Simple modeling of the thermal history of d.c plasma sprayed agglomerated nanosized zirconia particles <b>F. Ben Ettouil</b> , O. Mazhorova, B. Pateyron, H. Ageorges, M. El Ganaoui and P. Fauchais	632
30P-187	Productions of carbon nanotubes in high temperature thermal plasma <b>E. Ringdalen</b> , B. Monsen, R. Jensen and O. Raaness	633
30P-188	Influence of graphite doping on the wear and friction coefficient of air plasma sprayed stainless steel coatings <b>H. Ageorges</b> and P. Fauchais	634
30P-189	The effectiveness of prevailing plasma conditions in the synthesis of high temperature resistance mineral fibre <b>V. Valincius</b> , R. Kezelis, V. Valinciute and P. Valatkevicius	635
30P-190	Mechanical testing of extremely thick plasma-sprayed alumina layers <b>P. Cibor</b> and K. Neufuss	636

30P-191	Plasma processing of spray-dried YSZ powder and formation of splats from hollow molten particles impinging onto substrate <b>O. Solonenko</b> , I. Gulyaev, E. Kartaev and A. Smirnov	637
30P-192	Thermal plasma treatment of graphite powders - modification of the surface <b>R. Mach, H.-E. Maneck</b> , F. Oleszak, A. Meyer-Plath, B. Peplinski, S. Benemann and J. F. Friedrich	638
30P-193	Purification of metallurgical grade silicon by Ar-O <sub>2</sub> RF thermal plasma treatment with molten bath biasing S. Rousseau, A. Soric, M. Benmansour, <b>D. Morvan</b> and J. Amouroux	639

**Yoshida Campus: Room A****30 (Thu) Afternoon****Clock Tower 1F** **15:50–18:20****Biomedical applications (15:50–18:20) Chair: M. Laroussi & T. Akitsu** Abst. Page

30A-p1	Plasma tuning of surface chemistry for driving cell behavior	668
<b>Invited</b>	<b>Riccardo d'Agostino</b> , Pietro Favia, Eloisa Sardella, M. Nardulli, Linda Lopez, B. R. Pistillo and Roberto Gristina	
30A-p2	Industrial operation of magnetron plasma polymerization for biocompatible nanofilm encapsulation of contact lens	669
	<b>Y. Matsuzawa</b> and H. Yasuda	
30A-p3	Improved biocompatibility of titanium by plasmachemical amino functionalization	670
	<b>A. Ohl</b> , B. Finke, F. Luethen, K. Schröder, B. Nebe and J. Rychly	
30A-p4	Plasma assisted production of chemical nano-patterns based on colloidal lithography: application to bio-interfaces	671
	<b>A. Valsesia</b> , P. Colpo, F. Bretagnol, G. Ceccone and F. Rossi	
30A-p5	Adhesion and stability of fluorocarbon thin films on 316L stainless steel for stent coatings	672
	<b>F. Lewis</b> , P. Horny, P. Hale, M. Touzin, S. Turgeon, M. Tatoulian and D. Mantovani	
30A-p6	Galactosamine immobilization on plasma modified polystyrene to enhance hepatocytes functions	673
	<b>P. Favia</b> , L. Lopez, R. Gristina, M. Nardulli, M. Belviso and R. d'Agostino	
30A-p7	Thiol based plasma polymerized films on piezoelectric quartz crystal surfaces for a biosensor	674
	B. Ozansoy, D. Çökeliler, H. Göktaş and <b>S. Mutlu</b>	

**Westin Miyako Hotel: Social Dinner****30 (Thu) Evening****West Bldg. 4F Mizuho Room** **19:00–21:00**

Shuttle buses depart successively from the spot in front of Clock Tower between 18:20 and 18:40 (See page 4).

The awarding ceremony for **Plasma Chemistry Award 2007** is included.

**Yoshida Campus: Room B****30 (Thu) Afternoon**

Law &amp; Economics 1F South-East

15:50–18:20

Clusters, particles and powders (15:50–18:20) Chair: <b>K. Ostorikov &amp; M. Shiratani</b>		Abst. Page
30B-p1 <b>Invited</b>	Plasma synthesis of group IV quantum dots for luminescence and photovoltaic applications <b>Uwe Kortshagen</b> , Ryan Gresback, Zachary Holman, Xiaodong Pi and Lorenzo Mangolini	501
30B-p2	Nonthermal plasma synthesis of conductive germanium nanocrystal films for photovoltaic applications <b>Z. Holman</b> , R. Gresback and U. Kortshagen	502
30B-p3	Revealing deposition of clusters into a-Si:H by using multi-hollow discharge plasma CVD method <b>K. Koga</b> , W. M. Nakamura, D. Shimokawa and M. Shiratani	503
30B-p4	Gas-atom encapsulated silicon fullerenes formed by reactions of rare-gas ions with silicon plasmas <b>T. Kaneko</b> , K. Ejiri, M. Yabuno and R. Hatakeyama	504
30B-p5	Kinetics of 2D-3D transformations of carbon nanostructures I. Lebedeva, <b>A. Knizhnik</b> and B. Potapkin	505
30B-p6	Investigations of the growth process and the morphology of “smart nanoparticles” R. Weiß, S. Hong, J. Ransch and <b>J. Winter</b>	506
30B-p7	Fast plasma assisted treatment of solid-state micro-sized particulate material A. Sonnenfeld, A. Spillmann, C. Arpagaus and <b>P. Rudolf von Rohr</b>	507

**Westin Miyako Hotel: Social Dinner****30 (Thu) Evening**West Bldg. 4F *Mizuho* Room

19:00–21:00

Shuttle buses depart successively from the spot in front of Clock Tower between 18:20 and 18:40 (See page 4).

The awarding ceremony for **Plasma Chemistry Award 2007** is included.

## Yoshida Campus: Room C

30 (Thu) Afternoon

Law &amp; Economics 1F North-East

15:50–18:20

Plasma processing for micro electronics and mechanics (15:50–18:20) Chair: K. Ono &amp; J. Winter

Abst. Page

30C-p1	Porous low- <i>k</i> SiOCH etching technology by high-precision radical control	324
<b>Invited</b>	<b>Masaru Hori</b>	
30C-p2	Plasma etching damages on low- <i>k</i> films due to VUV light, UV light, radicals and ions <b>S. Takashima</b> , S. Uchida, M. Fukasawa, K. Ohshima, K. Nagahata, T. Tatsumi and M. Hori	325
30C-p3	Effects of CF <sub>3</sub> I plasma for reducing UV irradiation damage in dielectric film etching processes <b>Y. Ichihashi</b> , Y. Ishikawa, R. Shimizu, H. Mizuhara, M. Okigawa and S. Samukawa	326
30C-p4	Porous SiOCH, SiCH, and SiO <sub>2</sub> etching in inductively coupled fluorocarbon plasma with a pulsed bias: surface analyses and etch rate modeling V. Raballand, G. Cartry and <b>C. Cardinaud</b>	327
30C-p5	Low- <i>k</i> dielectric etching using Groovy ICP plasma source <b>G. Vinogradov</b>	328
30C-p6	Effects of geometrically different microstructures on etching profiles <b>H. Fukumoto</b> , K. Eriguchi and K. Ono	329
30C-p7	Hydrogen plasma as assisted thermal curing for ultra low <i>k</i> material <b>A. Zenasni</b> , V. Jousseume, L. Favennec, P. Maury and M. Payet	330

## Westin Miyako Hotel: Social Dinner

30 (Thu) Evening

West Bldg. 4F Mizuho Room

19:00–21:00

Shuttle buses depart successively from the spot in front of Clock Tower between 18:20 and 18:40 (See page 4).

The awarding ceremony for **Plasma Chemistry Award 2007** is included.

## Yoshida Campus: Room A

## 31 (Fri) Morning

Clock Tower 1F		9:10–13:00
<b>Plenary (9:10–9:50) Chair: T. Yoshida</b>		Abst. Page
31A-a0	Understanding plasma spray coating process: a modeling approach <b>Invited</b> Javad Mostaghimi	4
Short break (9:50–10:00)		
<b>Diagnostics and modeling in plasma chemistry (10:00–11:20) Chair: C. Oehr &amp; K. Sasaki</b>		Abst. Page
31A-a1	Non-equilibrium plasma effect on the combustion limits and the normal premixed flame velocity in the methane-air mixtures V. Chorkov, M. Deminsky, M. Strelkova, B. Potapkin and A. Zizin	71
31A-a2	Diagnostics and kinetics of fluorocarbon radicals in pulsed CF <sub>4</sub> /H <sub>2</sub> RF plasmas J. Meichsner, O. Gabriel, S. Stepanov and M. Geigl	72
31A-a3	Emission of Ba atoms from the electrode of a low-pressure fluorescent lamp operated by glow and arc discharge modes T. Ueda, Y. Egashira, A. H. Ahmed Samir, G. Yamashita, Y. Manabe, Y. Yamagata and K. Uchino	73
31A-a4	Diagnostic of water plasma by time resolved optical spectroscopy C. Miron, M. A. Bratescu, N. Saito and O. Takai	74
Coffee break (11:20–11:40)		
<b>Diagnostics and modeling in plasma chemistry (11:40–13:00) Chair: K. Sasaki &amp; C. Oehr</b>		Abst. Page
31A-a5	H <sub>2</sub> O-Ar plasma property functions for modeling of hybrid water-gas plasma torch P. Krenek and M. Hrabovsky	75
31A-a6	Determination of particle fluxes in an atmospheric pressure DC plasma jet N. Bibinov, D. Dudek, P. Awakowicz and J. Engemann	76
31A-a7	Investigation on the energy distribution in argon transferred arcs R. Bini and M. I. Boulos	77
31A-a8	Modelling of stable and unstable rotation modes for a DC arc A. Westermoen and J. A. Bakken	78

## Closing Celemony: Room A

Clock Tower 1F		13:00–13:20
Best paper awards of ISPC-18 Kunihide Tachibana		
IPCS general assembly Jean-Michel Pouvesle		
Announcements on GRC 2008 and ISPC-19 Jean-Michel Pouvesle and Jörg Winter		
Closing remarks Kunihide Tachibana		
Clock Tower 2F		13:20–13:50
<b>Closing reception / Lunch break before Industrial Workshop</b>		
Light meal is served.		

## Yoshida Campus: Room B

## 31 (Fri) Morning

Law & Economics 1F South-East	9:10–13:00
-------------------------------	------------

Plenary (9:10–9:50) Remote AV	Abst. Page
-------------------------------	------------

31A-a0	Understanding plasma spray coating process: a modeling approach	4
<b>Invited</b>	<b>Javad Mostaghimi</b>	
	Short break (9:50–10:00)	

<b>Non-equilibrium effects and atmospheric pressure plasma processes (10:00–11:20)</b> Chair: <b>S. Hamaguchi &amp; F. Massines</b>	Abst. Page
---	------------

31B-a1	Effects of conduction and displacement currents on Ar metastable production efficiency in a short pulse excited DBD R. J. Leiweke and <b>B. N. Ganguly</b>	147
31B-a2	Unipolar discharge phenomena in an atmospheric pressure helium plasma generated in dielectric tube <b>R. Ye</b> and W. Zheng	148
31B-a3	Experimental studies and modeling of an atmospheric pressure plasma working in the nanosecond regime coupled with a catalytic bed <b>X. Duten</b> , M. Redolfi, N. Aggadi, A. Michau and K. Hassouni	149
31B-a4	Time resolved investigation on a nanosecond pulsed discharge for combustion triggering <b>P. Tardiveau</b> , N. Moreau, C. Postel, F. Jorand, S. Pasquiers and P. Vervisch	150
	Coffee break (11:20–11:40)	

<b>Non-equilibrium effects and atmospheric pressure plasma processes (11:40–13:00)</b> Chair: <b>F. Massines &amp; S. Hamaguchi</b>	Abst. Page
---	------------

31B-a5	Direct reforming of biogas using non-equilibrium plasma Y. Sekine, <b>J. Yamadera</b> , E. Kikuchi, M. Matsukata and S. Nakamura	151
31B-a6	Mechanisms of conversion of heavy hydrocarbons in biogas initiated by pulsed corona discharges V. A. Bityurin, <b>E. A. Filimonova</b> and G. V. Naidis	152
31B-a7	Characteristic of methane processing by rotating arc reactor <b>D. H. Lee</b> , K.-T. Kim, Y.-H. Song and M. S. Cha	153
31B-a8	Simulation of transient non-equilibrium plasma in a gliding arc B. Wu, L. Lin and <b>C. Wu</b>	154

## Closing Celemony: Room B (Remote AV)

Law & Economics 1F South-East	13:00–13:20
-------------------------------	-------------

Best paper awards of ISPC-18 <b>Kunihide Tachibana</b>
IPCS general assembly <b>Jean-Michel Povesle</b>
Announcements on GRC 2008 and ISPC-19 <b>Jean-Michel Povesle</b> and <b>Jörg Winter</b>
Closing remarks <b>Kunihide Tachibana</b>

Clock Tower 2F	13:20–13:50
----------------	-------------

Closing reception / Lunch break before Industrial Workshop
--

Light meal is served.

## Yoshida Campus: Room C

31 (Fri) Morning

Law & Economics 1F North-East		10:00–13:00
<b>Plasma spray and thermal plasma material processing (10:00–11:20) Chair: J. Heberlein</b>		Abst. Page
31C-a1	Deposition of YSZ coating using molecular gases for DC plasma generation <b>L. Pershin</b> , L. Chen, J. Mostaghimi and T. Coyle	597
31C-a2	Suspension plasma spraying of alumina coatings: process and coating structure O. Tingaud, R. Etchart-salas, V. Rat, J.-F. Coudert, H. Ageorges, A. Grimaud, A. Denoirjean, <b>P. Fauchais</b> , G. Montavon, N. Caron and S. Alexandre	598
31C-a3	Comparative study on nano-structured SOFC electrolyte deposition using solution plasma spraying and suspension plasma spraying <b>L. Jia</b> and F. Gitzhofer	599
31C-a4	Thermal plasma directed vapor deposition of Ceramics coatings T. Lavaud, S. Cartel, M. I. Vardelle, G. Mariaux and <b>A. Vardelle</b>	600
Coffee break (11:20–11:40)		
<b>Clusters, particles and powders (11:40–13:00) Chair: Y. Hayashi</b>		Abst. Page
31C-a5	Formation of nanoparticles and nanostructure of tin oxide thin films deposited by PECVD <b>J. Pulpytel</b> , M. Jubault, F. Kaddouri, L. Boufendi and F. Arefi-Khonsari	508
31C-a6	Deposition of nanostructured films by a hybrid of chemical vapor deposition and hypersonic plasma particle deposition A. Beaber, A. Boies, L. Qi, J. Hafiz, P. Mcmurry, W. Gerberich, J. Heberlein and <b>S. Girshick</b>	509
31C-a7	Reaction kinetics for synthesis of gold nanoparticles in solution plasma field <b>J. Hieda</b> , M. Oda, K. H. Lee, N. Saito and O. Takai	510
31C-a8	Thermal plasma synthesis of different SiO nanostructures by the injection of micrometric particles: moving from nanoparticles to nanorods <b>B. Mostajeran Goortani</b> , P. Proulx and F. Gitzhofer	511



**Yoshida Campus: Workshop at Room A****31 (Fri) Afternoon**

Clock Tower 1F		14:00–17:45
<b>Industrial Workshop: Plasma recycling I</b> (14:00–15:30) Chair: <b>Chair: T. Watanabe</b>		Abst. Page
WS-1	Waste destruction and the possibility of recycling in the PLASCON process <b>A. B. Murphy</b>	763
WS-2	Synthesis gas production with the plasma enhanced melter (PEM™) <b>J. Batdorf</b>	764
WS-3	Thermal plasma droplet refining technology and its applications <b>G. Han</b>	765
Break (15:30–15:45)		
<b>Industrial Workshop: Plasma recycling II</b> (15:45–17:15) Chair: <b>Chair: A. Mizuno</b>		Abst. Page
WS-4	Greenhouse gas plasma chemistry - an option for CO <sub>2</sub> control? <b>U. Kogelschatz</b>	766
WS-5	CO <sub>2</sub> reforming of methane via the low temperature plasmas H. Lee, J.-W. Choi, A. Indarto and <b>H. K. Song</b>	767
WS-6	Application of nonthermal plasma to chemical conversion of CO <sub>2</sub> <b>S. Futamura</b>	768
<b>Industrial Workshop: Panel discussion</b> (17:15–17:45) Chair: <b>Chair: T. Watanabe &amp; A. Mizuno</b>		
WS-7	How can we make plasma environmental technologies industrial? <b>All panelists</b>	

## ISPC-18: Cooperative Societies (Alphabetical order)

IEEE Japan Council NPS Plasma

International Innovation Center, Kyoto University

Japan Ozone Association

Materials Science Society of Japan

Society of Geomagnetism and Earth, Planetary and Space Sciences

Spectroscopical Society of Japan

The Ceramic Society of Japan

The Chemical Society of Japan

The Electrochemical Society of Japan

The Institute of Electrical Engineers of Japan

The Institute of Electronics, Information and Communication Engineers

The Institute of Electrostatics Japan

The Iron and Steel Institute of Japan

The Japan Institute of Metals

The Japan Society for Aeronautical and Space Sciences

The Japan Society of Plasma Science and Nuclear Fusion Research

The Physical Society of Japan

The Society of Polymer Science, Japan

The Surface Finishing Society of Japan

The Vacuum Society of Japan

# ISPC-18 Time Schedule

MONDAY, 27 August				TUESDAY, 28 August				WEDNESDAY, 29 August				THURSDAY, 30 August				FRIDAY, 31 August			
Yoshida Campus				Yoshida Campus				Katsuracampus				Yoshida Campus				Yoshida Campus			
9:10	Room A	Room B	Room C	9:10	Room A	Room B	Room C	9:10	Room A	Room B	Room C	9:10	Room A	Room B	Room C	9:10	Room A	Room B	Room C
9:30	Plenary Mark J. Kustner			9:10	Plenary Hana Barankova			9:10	Biomedical	Environment.	Comb. & Aero.	9:10	Plenary François Rossi			9:10	Plenary Javad Mostaghimi		
10:10	Short break			9:50	Short break			9:40	C. W. Chen	T. Ikeda	I. V. Adamovich	9:50	Short break			9:50	Short break		
10:20	Microplasma	Plasma Sources	Dep. Inorganic	10:00	Polymers	Diag. & Model	Spray & Thermal	10:00	L. Xu	G. Soucy	J.-M. Bauchire	10:00	Polymers	Non-eq. Atm.	Surface	10:00	Diag. & Model	Non-eq. Atm.	Spray & Thermal
10:40	J. Winter	W. Stoffels	J. M. A. Diaz	10:20	E. Sardella	S. Girschick	D. Outcalt	10:20	G. Fridman	N. Boudescocque	J. Shin	10:20	M. Perucca	F. Farnelli	T. Ito	10:20	M. Deminsky	B. Ganguly	L. Pershin
11:00	O. Sakai	B. Jacobs	I. Savin de Larcluse	10:40	M. R. Wertheimer	A. Fridman	T. Kavka	10:40	Y. L. M. Creighton	K. Nishikawa	N. Takeuchi	10:40	C. Sarra-Bourret	F. Remiers	R. Zijlmans	10:20	J. Melchner	R. Ye	P. Fauthais
11:20	R. Dussart	M. Ganciu Petcu	E. Debourg	11:00	C. Oehr	M. Sato	K. Shinoda	11:00	Coffee break			10:40	C. Pavan	V. Hopfe	N. Sadeghi	10:40	T. Ueda	X. Duten	L. Jia
	Coffee break			11:20	M. Haidopoulos	K. Nakamura	O. Solonenko	11:20	Polymers	Environment.	Syntheses	11:00	A. Sonnenfeld	M. Iwasaki	E. Desplau-Pujo	11:00	C. Ueda	X. Duten	L. Jia
11:40	Microplasma	Plasma Sources	Dep. Inorganic	11:40	Polymers	Diag. & Model	Spray & Thermal	11:20	G. Ceccone	H. Tong	J. Zheng	11:20	Coffee break			11:20	Coffee break		
12:10	J. Engemann	A. Fridman	T. Ishigaki	11:40	H. Yasuda	G. J. M. Hagelaar	A. Vardelle	11:40	A. Meyer-Plath	K. Badr	Y. Takahashi	11:40	Polymers	Non-eq. Atm.	Surface	11:40	Diag. & Model	Non-eq. Atm.	Cluster
12:30	K. Kitano	Y. Hara	A. Borrás	12:10	A. Milala	S. Nunomura	A. B. Murphy	12:00	R. Mix	A. M. Harling	S. Chavadei	11:40	O. Takai	M. Kong	D. B. Graves	11:40	P. Krenek	J. Yamadera	J. Pulpytel
12:50	A. Rousseau	C. Jarwala	M.C.M. van de Sanden	12:30	K.-D. Neuenburg	J. Ma	S. Takeuchi	12:40	V. Roucoules	S. Futamura	B. Potapkin	12:10	M. Tatoulian	F. Massines	Hamaguchi	12:00	N. Bibnov	E. Filimonova	S. Girschick
13:10	K. Nanno	J. Tavares	M. M. H. Bhuiyan	12:50	J. Hanus	A. Bourig	Y. Tanaka	13:00	M. Kral	M. Okubo	J. Heo	12:30	U. Lommatazsch	G.-J. Zhang	K. Ikuse	12:20	R. Bini	D. H. Lee	J. Hieda
14:10	Lunch			13:10	Lunch			13:10	Lunch			13:10	D. T. Tran	F. Parisi	D. Ruzic	12:40	A. Westermen	C. Wu	B. Mostajeran Goortani
15:30	Poster (Clock Tower 2E Int. Conf. Hall) Dep. Inorganic / Polymers / Biomedical / Environment			14:10	Poster (Clock Tower 2E Int. Conf. Hall) Surface / Non-eq. Atm. / Microplasma / Syntheses / Comb. Aero			14:10	Poster (Clock Tower 2E Int. Conf. Hall) Diag. & Model / Plasma Sources / Electron. & Mech. / Clusters / Spray & Thermal			13:10	Lunch			13:00	Best Paper Awards IPCS General Assembly Announcements of GRC 2008 and ISPC-19 Closing		
16:20	D. Hegemann	K. Ostrikov	K. Kinoshita	15:50	M. Laroussi	J. Vleck	G. Dinescu	15:50	Biomedical	Cluster	Electron. & Mech.	13:20	Closing Reception / Lunch Break before Industrial Workshop			13:20	Closing Reception / Lunch Break before Industrial Workshop		
16:40	S. Voronin	A. Okita	M. Li	16:20	N. Sadeghi	K. Ellmer	H. Huang	16:40	A. Ohi	K. Koga	Y. Ichihashi	14:00	Workshop	A. B. Murphy	14:00	Workshop	A. B. Murphy	14:00	A. B. Murphy
17:00	M. Creatore	S. Nishigaki	D. Benzegouta	16:40	T. Sakurai	S. Grassini	V. Colombo	17:00	Excursion Buses depart from Rohm Plaza at 13:10 (including lunch time)			14:30	J. Batdorf	14:30	J. Batdorf	14:30	J. Batdorf	14:30	J. Batdorf
	Coffee break			17:00	Coffee break			17:00	A. Valsesia	T. Kameko	C. Caridraud	15:00	G. Han	15:00	G. Han	15:00	G. Han	15:00	G. Han
17:20	Surface	Syntheses	Environment.	17:20	Microplasma	Dep. Inorganic	Plasma Sources	17:20	F. Lewis	A. Knitzhnik	G. Vinogradov	15:15	Break	15:15	Break	15:15	Break	15:15	Break
17:40	K. Sasaki	U. Cveibar	J. Kaiser	17:20	J.-L. Dorier	M. Mostaghimi	M. A. Lieberman	17:40	P. Favla	J. Winter	H. Fukumoto	15:45	U. Kogelschatz	15:45	U. Kogelschatz	15:45	U. Kogelschatz	15:45	U. Kogelschatz
18:00	J. F. Friedrich	J. Szépvölgyi	M. Hrabovsky	17:40	F. Iza	N. Ohatake	P. Charbert	18:00	S. Mutlu	P. Rudolf von Rohr	A. Zensari	16:15	H. K. Song	16:15	H. K. Song	16:15	H. K. Song	16:15	H. K. Song
18:20	T. H. Chen	K. Furuya	Y. Chao	18:00	Y. Sakiyama	M. Perucca	J.-M. Pouvesle	18:20	Shuttle buses for Social Dinner depart successively from Clock Tower			16:45	S. Fumamura	16:45	S. Fumamura	16:45	S. Fumamura	16:45	S. Fumamura
18:40	A. Moradian	I. Castillo	S. B. Joa	18:20	B. Farouk	C. P. Lungu	D. Lofthagen	19:00	Social Dinner at Westin Miyako Hotel			17:15	Panel Discussion	17:15	Panel Discussion	17:15	Panel Discussion	17:15	Panel Discussion
	Coffee break			18:40	Coffee break			18:40	Social Dinner at Westin Miyako Hotel			17:45	Panel Discussion						