

PRC Environmental Management, Inc.
650 Minnesota Avenue
Kansas City, KS 66101
913-281-2277
Fax 913-281-5383

RECEIVED
MAY 27 REC'D
REME SECTION

PRC

May 27, 1992

Mr. James Colbert
CERCLA Work Assignment Manager
U.S. EPA, Region 7
726 Minnesota Avenue
Kansas City, Kansas 66101

Re: EPA Contract No. 68-W9-0006
Work Assignment No. C07071
Trip Memorandum for the Oversight of Soil/Concrete Activities at the Interchem Site
Alton, Iowa

Site: <u>Interchem</u>
JA0067495328
d. d
B+V
5-27-92

Dear Mr. Colbert:

PRC Environmental Management, Inc. (PRC), is submitting the trip memorandum summarizing oversight observations made during the removal conducted at the Interchem site. This oversight was conducted by our Technical Enforcement Support 9 team firm B&V Waste Science and Technology Corporation (BVWST).

If you have any questions or comments on this submittal, please call me at (913) 281-2277.

Sincerely,

Paula Hirtz

Paula Hirtz
Acting Regional Manager

PH/ksd

Enclosure

cc: (letter only)

Maureen Hunt, U.S. EPA-RPO
Curt Enos, PRC EMI
Gary Felkner, BVWST

30307889

Superfund



U.S. Environmental Protection Agency
Office of Environmental Programs Enforcement
Contract No. 68-W9-0006

TRIP MEMORANDUM
OVERSIGHT OF SOIL/CONCRETE REMOVAL

INTERCHEM SITE
ALTON, IOWA

TES IX

TES 9

Technical Field Support
at Hazardous Waste Sites
Zone II
Regions 6, and 7

PRC

PRC Environmental Management, Inc.

RECEIVED

MAY 27 REC'D

REME SECTION

TRIP MEMORANDUM
OVERSIGHT OF SOIL/CONCRETE REMOVAL

INTERCHEM SITE
ALTON, IOWA

TES IX

Prepared for

U.S. ENVIRONMENTAL PROTECTION AGENCY
Region 7, Superfund
Kansas City, Kansas 66101

Work Assignment No.	:	C07071
EPA Region	:	7
Date Prepared	:	May 27, 1992
Contract No.	:	68-W9-0006
Prepared by	:	B & V Waste Science Technology Corp.
Project Manager	:	Gary L. Felkner
Technical Monitor	:	Curt Enos
Telephone No.	:	(913) 338-6583
EPA Work Assignment Manager	:	Jim Colbert
Telephone No.	:	(913) 551-7489

B&V WASTE SCIENCE AND TECHNOLOGY CORP.

MEMORANDUM

PRC/USEPA
TES IX Oversight
Interchem Site, Alton IA

BVWST Project 45566.100
BVWST File D.3
May 22, 1992

To: Gary L. Felkner
From: Douglas E. Lade
Re: Oversight of soil/concrete removal at the Interchem site in Alton, IA.

The following summarizes observations made by TES IX field team representative Douglas E. Lade during oversight efforts of the soil/concrete removal activities at the Interchem site in Alton, IA by the PRP's consultants Woodward-Clyde Consultants and Heritage Environmental Services. Mr. Lade was onsite from April 13, 1992 through May 6, 1992. General observations, site maps, calculation drawings for cubic yards of soil/concrete removed, and photocopies of the field notes are attached as a reference to the following comments. Site photographs have been submitted under separate cover.

<u>Date</u>	<u>Comments</u>
04-13-92	<ul style="list-style-type: none">There was no removal of soil or concrete because permits to the hazardous waste landfill were not yet signed.Sampled the four monitoring wells onsite. Collected split samples of wells MW-1, MW-2, MW-3, and MW-4.

<u>USEPA Sample No.</u>	<u>Well Location</u>
IS4DT-001	MW-2
IS4DT-002	MW-1
IS4DT-003	MW-4
IS4DT-004	MW-3
IS4DT-005	Acid Blank
IS4DT-006	Trip Blank

- Dave Boxum from KTIV Channel 4 in Sioux City, Iowa came onsite to see how the clean up was going. I filled him in on what in general is going to be done and then referred him to Jim Colbert, U.S. Environmental Protection Agency (EPA).

MEMORANDUM

Page 2

PRC/USEPA
TES IX Oversight

BVWST Project 45566.100
May 12, 1992

- 04-14-92
- No work performed.
 - I packaged and delivered split samples to Federal Express for shipment to USEPA lab in Kansas City, Kansas.
- 04-15-92
- Heritage Environmental Services (HES) arrived onsite to perform the removal of the hazardous materials onsite.
 - HES moved the drums and one large storage tank from out of the north and south sheds. They placed them on the concrete pad which was covered with plastic on the east side of the main building.
 - HES excavated soil from Area 10c on the north end of the main building and stock piled the soil near northeast corner of the main building where 11th and 1st Avenue meet. Woodward-Clyde Consultants (WCC) monitored the excavation with a dust mini-ram to make sure the level of dust is in the safe limits.
 - WCC personnel put out air sampling pumps with puff tubes for long term air monitoring.
 - HES supervisor had the electric department of the City of Alton, Iowa, disconnect the power lines to the sheds that are going to be demolished.
 - WCC personnel collected four individual aliquots from Area 10c for soil verification analysis.
 - HES backhoe operator began excavating Area 14, but stopped because rain-water was building up in the Area.
 - HES backhoe operator began excavating Area 2d north but stopped because it began to rain harder.
 - WCC personnel had the HES trackhoe operator bring down the walls and roof of the north shed onto the floor of the north shed.

MEMORANDUM

Page 3

PRC/USEPA
TES IX Oversight

BVWST Project 45566.100
May 12, 1992

04-16-92

- Jim Colbert, USEPA, visited the site.
- Jim Colbert and I walked around the site. I filled him in on what has been happening onsite. Jim decided that there should be no more stock piling of soil.
- Jim Colbert and I observed HES personnel breaking up the toxaphene concrete pad using there HOE ram. The southeast quarter of the pad will be incinerated.
- Jim Colbert, the HES supervisor, and myself walked through the south shed. Jim Colbert decided that the lower three boards of the walls and the floor should go as hazardous material.
- HES personnel tore the lower three boards of the walls off the south shed and stockpiled them on plastic.
- Jim Colbert did an interview with Dave Boxum KTIV Channel 4 of Sioux City, Iowa.
- WCC personnel monitored HES personnel with dust mini-ram while HES personnel tore boards off the south shed.
- WCC personnel had the HES trackhoe operator bring down the walls and roof of the south shed onto the floor of the south shed.
- HES personnel put broke up concrete, which was to be incinerated, into 55-gallon drums in level C.
- WCC personnel put out their puff tube samplers for long-term air monitoring.

04-17-92

- Jim Colbert from the USEPA visited site again.
- HES personnel loaded non-hazardous shed debris into trucks to be taken to a near by sanitary landfill.

MEMORANDUM

Page 4

PRC/USEPA
TES IX Oversight

BWST Project 45566.100
May 12, 1992

- HES personnel began tearing up the south and north sheds floor and wrapping the wood in plastic for areas where soil was to be excavated.
 - WCC personnel put out their puff tube samplers for long-term air monitoring.
 - HES personnel loaded eleven trucks with non-hazardous debris. The loads averaged around 1.3 tons each. The debris was transported to a near by sanitary landfill in Hospers, Iowa.
- 04-18-92
- HES personnel finished taking up the floor from the north and south sheds.
 - Work stopped early in the day because of rain.
- 04-20-92
- WCC personnel put out their puff tube samplers for long-term air monitoring.
 - Another person from HES arrived onsite to take lab pack drums offsite to an HES disposal area.
 - HES trackhoe operator broke up and stock piled concrete footings from the north and south sheds between 1st Street and the main building.
 - HES trackhoe operator began hoe-ramming the shed's concrete footings into small pieces.
- 04-21-92
- HES backhoe operator hoe-rammed the shed's concrete footings into small pieces.
 - WCC personnel put out their puff tube samples for long-term air monitoring.
 - HES backhoe operator hoe rammed the rest of the toxaphene concrete pad area.
 - Five trucks arrived onsite to carry off the hazardous soil and hazardous shed flooring and particle walls. The first two trucks were filled with stock-piled soil from Areas 10c and 2d. The last three trucks were loaded with the hazardous

MEMORANDUM

Page 5

PRC/USEPA
TES IX Oversight

BVST Project 45566.100
May 12, 1992

wood. When done loading the five trucks there was still some hazardous wood left over. It will be loaded on the trucks coming on Wednesday, April 22, 1992. (Soil samples were collected from grade level to verify that stock piled soils had not impacted the stock pile location. Results of the samples were within acceptable limits).

04-22-92

- WCC personnel put out air sampling pumps with puff tubes for long-term air monitoring.
- Thirteen trucks arrived onsite to be loaded with hazardous shed material, soil, and concrete. The first two trucks were loaded with the wood from the shed. The last eleven trucks were loaded with soil from Area 2d. The trucks loaded with soil averaged between 15 and 17 yards of soil each.
- WCC personnel collected four individual aliquots from the northern half of Area 2d and four from the southern half of Area 2d for soil verification analysis.
- Area 2d north and south has been excavated except for about two feet at each end.
- WCC and HES personnel measured Area 2d to estimate how many yards of soil have been excavated so far.
- Three box trailers were delivered onsite to store the incineration drums.

04-23-92

- WCC personnel put out air sampling pumps with puff tubes for long-term air monitoring.
- HES trackhoe operator broke a phone line while loading soil from Area 2d north into the first truck of the day. Two trucks were loaded in this area before moving.
- HES supervisor let the phone company in to fix the broken line after he received permission from EPA and his office in Chicago, Illinois.

MEMORANDUM

Page 6

PRC/USEPA
TES IX Oversight

BWST Project 45566.100
May 12, 1992

04-24-92

- HES trackhoe operator was finished with Area 2d except for a small area in the southeast corner of the excavation. HES supervisor instructed trackhoe operator to move to Area 1d where the sheds had set and began excavating there.
- HES trackhoe operator loaded the next seven and one-half trucks with soil from Area 1d.
- HES trackhoe operator moved to Area 14 and loaded two and one-half trucks with soil from Area 14.
- HES trackhoe operator then moved to Area 2d south and loaded what was left in that area into the last truck of the day.
- WCC personnel collected four individual aliquots from Areas 1d north, 1d south, and 14 for soil verification analysis.
- WCC personnel put out air sampling pumps with puff tubes for long-term air monitoring.
- HES trackhoe operator moved to Area 2d the east side of the former quonset hut. He finished loading the last truck from April 23, 1992 which had spent the night onsite and the first truck for today's shipment.
- HES had brought a vacuum truck onsite to clean the above ground storage tanks.
- WCC personnel collected four individual aliquots from Area 2d east for soil verification analysis.
- HES personnel moved the concrete from the toxaphene pad area (which will be transported for incineration) 50 feet west of the eastern edge of the toxaphene pad. The concrete was triple layered with plastic and placed on a concrete surface. This was done in Level C.

MEMORANDUM

Page 7

PRC/USEPA
TES IX Oversight

BVWST Project 45566.100
May 12, 1992

- HES supervisor and project manager would not excavate the toxaphene concrete pad area because the levels of contamination were so high in the concrete they felt it may be in the soil. They also felt they would be liable if the landfill rejected the load because they knew it might be higher than expected.
- WCC personnel collected offsite soil samples from two different areas that might be used as fill material in the excavated areas. I observed them collect one of the samples.
- I observed HES personnel cold cutting the large storage tank taken from the sheds. The pieces were placed with the hazardous soil that is going to the landfill. Earlier I observed HES personnel cleaning out the tank using the drum vacuum.
- HES's supervisor and project manager decided they could not wait any longer for the soil verification sample results. They decided to go ahead and load soil and concrete from the toxaphene concrete pad area.
- Earlier I talked to Jim Colbert about the toxaphene concrete pad area. He informed me that there were samples collected from the concrete drive to the east of the toxaphene concrete pad area. He told WCC and myself the need to remove soil a ten foot distance to the east from the eastern edge of the toxaphene concrete pad. Jim Colbert said to remove the concrete as far south as the concrete extends and to the north to where the concrete begins to slope up. He also told WCC and myself that the soil to the south of the southern edge of the concrete needs to be excavated to the southeast corner of the toxaphene pad.
- I observed HES trackhoe operator load three trucks with soil and concrete from the toxaphene concrete pad area.

MEMORANDUM

Page 8

PRC/USEPA
TES IX Oversight

BWST Project 45566.100
May 12, 1992

- HES trackhoe operator moved back to Area 1d. WCC personnel had marked off two more small areas that had a strong odor. They had HES excavate more soil in these two areas which filled truck No. 5. HES also loaded the cut up pieces of the large storage tank into the truck.
- 04-25-92
- I observed HES personnel cleaning the above ground storage tanks (AGSTs) using the purged water from the drilling this last fall. They first pumped out the product that was in the bottom of the tanks, then they washed the inside of the tanks with the purged water and last pumped it out using a vacuum truck. WCC took combustible gas indicator (CGI) readings after the tanks were cleaned. Instrument readings for Tanks 4, 5, and 6 were 0%-LEL and 20%-O₂. Tank 7 readings were 5%-LEL and 20%-O₂. Tank 8 readings were 10%-LEL, 20%-O₂.
 - HES personnel moved the drums that were sitting on the concrete next to the main building into the box trailers that were delivered on Wednesday, April 22, 1992. HES personnel could not finish loading drums because they ran out of hazardous waste stickers. They will finish the job next week.
- 04-26-92
- WCC personnel put out air sampling pumps with puff tubes for long-term air monitoring.
 - I observed HES personnel breaking up toxaphene concrete for incineration into 3 inch x 3 inch pieces just west of the toxaphene pad area.
 - HES operator was using the hoe ram to break up the drive pad to the east of the toxaphene area. He also stock piled soil in that area so it can be loaded into trucks which are to arrive Monday, April 27, 1992.
 - HES vacuum truck left site for Chicago, Illinois.

MEMORANDUM

Page 9

PRC/USEPA
TES IX Oversight

BVWST Project 45566.100
May 12, 1992

04-27-92

- I informed WCC personnel of the phone conversation I had with Jim Colbert on Sunday, April 26, 1992. WCC will need to take another round of readings from the AGST's because there was not enough time between the cleaning and when the CGI readings were measured. I also informed WCC personnel that if there are drums accumulated from the cleaning of the shed's concrete footings the water will need to be sampled.
- WCC personnel put out air sampling pumps with puff tubes for long-term air monitoring.
- I observed HES trackhoe operator load five trucks with soil and concrete from the toxaphene concrete pad area and from the drive area to the east of the pad.
- HES personnel loaded PPE, plastic, and soil from the site into the sixth truck.
- WCC personnel, with the help of HES personnel, took another round CGI readings from the AGST's. Tank 4 reads 1%-LEL, 21%-O₂, Tank 5 reads 0%-LEL, 23%-O₂, Tank 6 reads 2%-LEL, 22%-O₂, Tank 7 reads 2%-LEL, 20%-O₂, and Tank 8 reads 3%-LEL, 22%-O₂.
- WCC personnel collected two composite concrete samples and two composite soil samples from the toxaphene pad and drive areas. The first soil sample was taken in the toxaphene pad area. Four individual aliquots were collected to form sample No. TPS-1. Soil sample TPS-2 was taken from the drive pad area east of the toxaphene pad. The first concrete sample (No. TPC-1) was taken at the western edge of the toxaphene pad. The second concrete sample (No. TPC-2) was collected from the north and east side of the drive pad's excavation.
- HES personnel loaded truck seven with the following: a few more pieces of concrete that didn't get picked up in the drive pad area, more PPE, and the solid waste drums contents that was generated this last fall.

MEMORANDUM

Page 10

PRC/USEPA
TES IX Oversight

BVWST Project 45566.100
May 12, 1992

- HES personnel were still breaking concrete for incineration into 3 inch x 3 inch pieces.
- 04-28-92
- HES personnel finished breaking concrete into 3 inch x 3 inch pieces and placed the concrete and the plastic it was sitting on into twenty-three 55-gallon drums.
 - WCC and HES personnel dumped out the soil cuttings from the previous drilling effort into the front end loader then stock piled the soil near Area 2d.
 - HES personnel were preparing to wash the shed's concrete footings. The HES supervisor is concerned that washing the concrete off with water won't work very well. He asked me to talk to Jim Colbert to see if they could just brush the dirt off of the concrete since it is dry. I talked to Jim Colbert about the cleaning of the concrete footings. I explained the concern with using water and asked if HES can just brush the dirt off with a stiff brush that it will come clean. He said alright as long as it is clean. He also said if the brushing doesn't work they will have to wash it.
- 04-29-92
- I informed HES's supervisor and WCC that Jim Colbert approved them to brush the soil off as long as the concrete is clean.
 - I observed HES personnel brushing clean the concrete. HES's operator had to break the concrete into small pieces, so that they can be handled by hand. HES personnel would brush the dirt off the smaller concrete pieces into their front end loader and stockpile it to the north of the shed excavation.
 - HES personnel also finished dumping out the rest of soil cuttings from last falls work.
- 04-30-92
- I observed HES personnel finish cleaning and moving concrete footings to the clean stock pile area.

MEMORANDUM

Page 11

PRC/USEPA
TES IX Oversight

BVWST Project 45566.100
May 12, 1992

05-01-92

- Two trucks arrived onsite to be loaded with the clean concrete and taken to the local sanitary landfill. After the first two loads there was only one truck being used.
- I observed HES trackhoe operator loading trucks with concrete. There were only seven loads of concrete shipped out. There is about a half a load left for the next day. The loads roughly averaged 10 to 12 yards per load.
- HES trackhoe operator loaded the last of the concrete to go to the sanitary landfill.
- HES finished labeling incineration drums and loading them into the box trailers.
- WCC project manager informed HES personnel and myself of the pre-analytical results from the samples that were shipped out last Saturday, April 25, 1992. All the areas came back below 10 ppm total TCL pesticides, but Area 2d south was 9.27 ppm, so the PRP's and WCC decided to remove two more feet in depth in this area. Sample analysis from the toxaphene pad drive pad area won't be received until Saturday, May 2, 1992 or Monday, May 4, 1992.
- WCC gave permission to HES to backfill all areas except 2d south and the toxaphene pad/drive pad area.
- HES personnel could not do anymore work onsite because the fill material is too wet and results are not back on toxaphene pad/drive pad area.
- HES project manager ordered five trucks for Monday, May 4, 1992 and five for Tuesday, May 5, 1992 because of the deeper excavation in Area 2d south and because there may be more excavation in the toxaphene pad/drive pad area.

MEMORANDUM

Page 12

PRC/USEPA
TES IX Oversight

BVWST Project 45566.100
May 12, 1992

- 05-04-92
- WCC site manager informed HES personnel and myself about the results of the toxaphene pad/drive pad area. He said they will need to go a foot deeper in the drive pad area and remove some more concrete. The soil had a level of 20 ppm total TCL pesticides and the composite of the north and east concrete edges was 120 ppm. WCC site manager also informed me that their VOA samples collected from the four wells onsite exceeded the 4° C preservation requirement during shipment and will need to be collected again.
 - Trucks with fill soil arrived onsite. The fill was still too wet, so they were bringing the black topsoil fill onsite. A total of 16 trucks with backfill were unloaded.
 - HES personnel began backfilling Area 1d with the first fourteen and one-half trucks. The other one and one-half truck load of soil was spread in Area 14. The backfill was brought by trucks with belly dumps. HES personnel would have the trucks drop their loads then the HES personnel would spread it in the excavated area and compact it. The final process after the soil has been filled to grade-level is to spread grass seed.
 - I observed HES's trackhoe operator load two and two-thirds trucks from Area 2d south. The final part of the load for truck No. 3 came from the bits of concrete, dirt, and plastic left over from the cleaning of the concrete footings. The last two trucks that are going to the hazardous waste landfill were loaded with soil and concrete from the toxaphene pad/drive pad area which had to have more excavating done.
- 05-05-92
- HES personnel had missed a few lab packs for the truck brought in on Monday, April 20, 1992, so another truck was onsite to pick up the remaining lab packs.

MEMORANDUM

Page 13

PRC/USEPA
TES IX Oversight

BVWST Project 45566.100
May 12, 1992

- I observed loads of fill soil being delivered onsite. Area 14 took two loads for it to be filled.
- All five trucks scheduled to haul off hazardous material were sent back empty.
- WCC site manager collected four individual aliquots from Area 2d south for soil verification analysis of newly excavated area.
- I observed 16 loads of fill that went into Area 2d for it to be filled.
- I observed 2 loads of fill that went into Area 2d east and Area 10 for them to be filled.
- I observed 7 loads of fill go into the toxaphene pad/drive area, but it was not completely backfilled.
- WCC site manager collected four individual aliquots from the drive pad area for soil verification analysis. He also collected a concrete composite from the north and east edge of the drive pad area.
- HES lab pack left site late this afternoon.
- All areas were compacted to grade and seeded with grass seed.
- WCC site manager purged and sampled MW-2 for VOA analysis.
- WCC site manager sent soil and concrete samples to the lab by Federal Express.
- HES personnel received the 2 loads of fill for the toxaphene pad/drive pad area. It was compacted to grade with a slope running east to west. Then seeded with grass seed.

05-06-92

MEMORANDUM

Page 14

PRC/USEPA
TES IX Oversight

BVWST Project 45566.100
May 12, 1992



- WCC site manager purged and sampled wells MW-1, MW-3, and MW-4. The City of Alton gave him permission to put the purge water into the city's POTW.
- HES, WCC, and myself left the site.

v1b

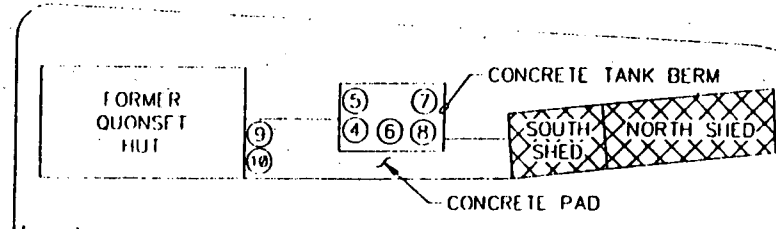
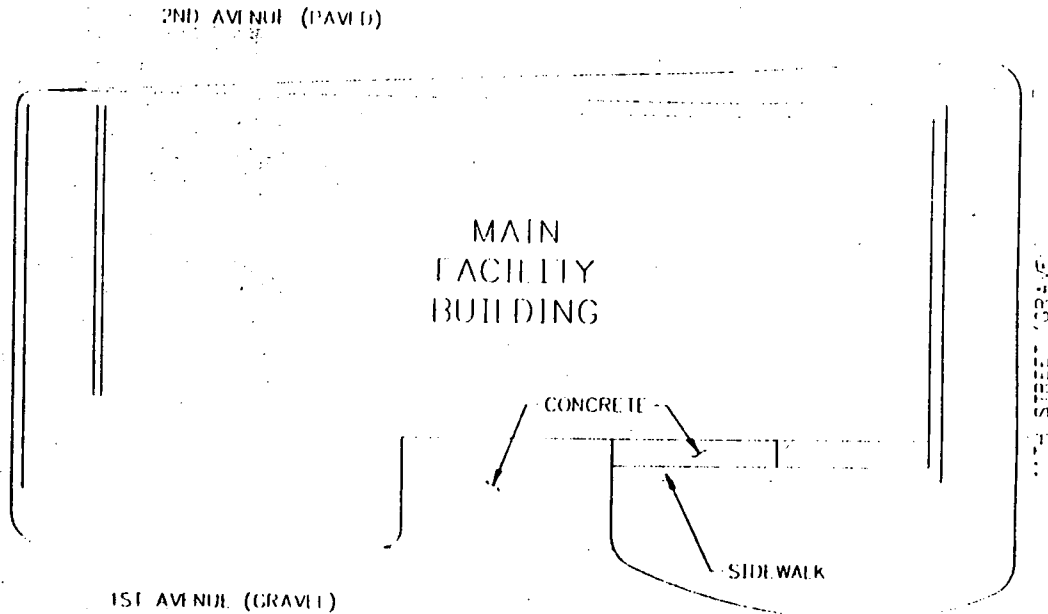
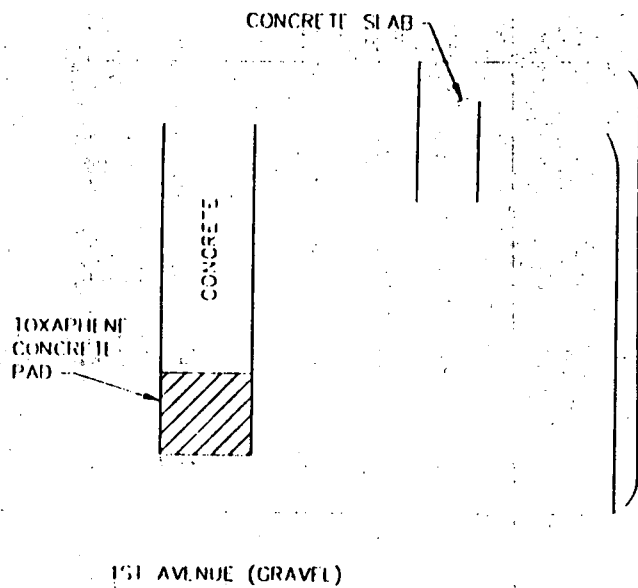
Enclosures

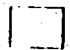
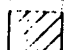

LEGEND:

- (4) ABOVE GROUND STORAGE TANK (AGST) WITH TANK NUMBER (AGST'S 4-8 CONTAIN WASTE LIQUID)
-  PROPOSED SOIL REMOVAL AREAS
-  PROPOSED CONCRETE REMOVAL AREAS
-  PROPOSED SHED DEMOLITION

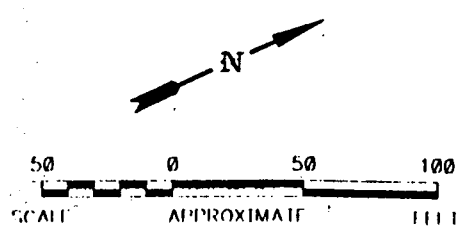

INTERCHEM SITE - ALTON, IOWA			
Woodward-Clyde Consultants Engineers, Geologists, And Environmental Scientists			
SOIL, CONCRETE, WASTE LIQUID, AND SHED REMOVAL AREAS			
DRAWN: M A I.	DATE: 01/30/82	PROJECT NUMBER	FIG. NO.
BY: [unclear]	DATE:	91073115	3

ACAD FILE: INTRO082



Calculation of in-place cubic yards
 concrete footings beneath sheds

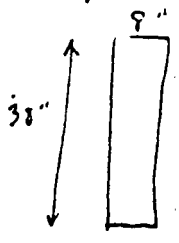

6 footings
 100-foot long footings

~~Volume = 6 footings × 5" wide × 38' deep × 100' long = 144 in³/ft~~

Volume = 5" wide × 38' deep ÷ 144 in³/ft = 100 feet long ÷ 27 ft³/yd³ × 6 footings
 = 6.9 yd³ in-place volume of concrete footings.

Contractor: [Signature]
 Inspector: [Signature]

Date: 4/23/92
 Date: 4/23/92



Excavation area 2d - south & east

~~southern~~ ^{eastern} ~~portion~~ ^{portion} - shallow soil above ~~concrete~~ ^{BAH} ~~asphalt~~

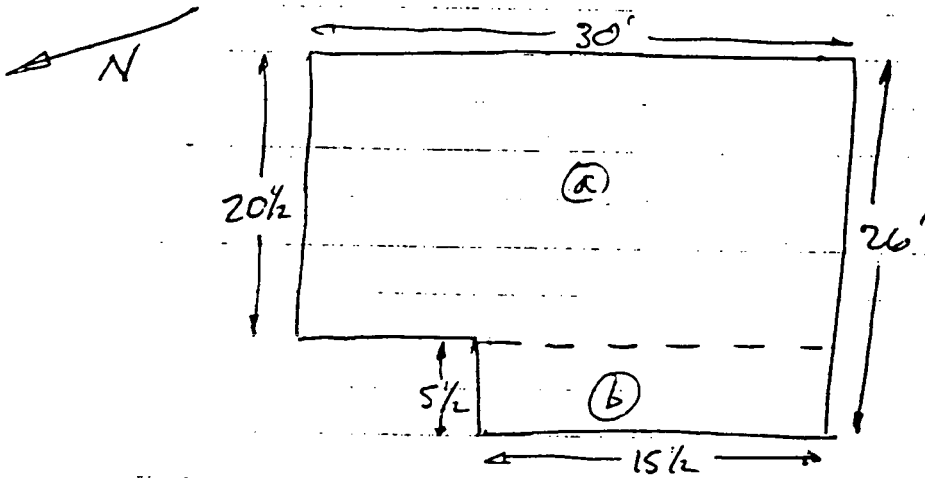

$$Vol_a = 20\frac{1}{2}' \times 30' \times 1' \div 27 \text{ ft}^3/\text{yd}^3$$

$$= 22.8 \text{ yds}^3$$

$$Vol_b = 5\frac{1}{2}' \times 15\frac{1}{2}' \times 1' \div 27 \text{ ft}^3/\text{yd}^3$$

$$= 3.2 \text{ yds}^3$$

$$\text{Total} = Vol_a + Vol_b = 22.8 \text{ yds}^3 + 3.2 \text{ yds}^3$$

$$= 26 \text{ yds}^3$$

~~southern~~ ^{southern} ~~portion~~ ^{portion} - shallow soil scraped above concrete asphalt.

Stockpiled soil from the southern side estimated to be 5 yds³

Contractor: [Signature]

Inspector: But A Helderby
 Woodward-Clyde Consultants



Excavation of Area below Sped

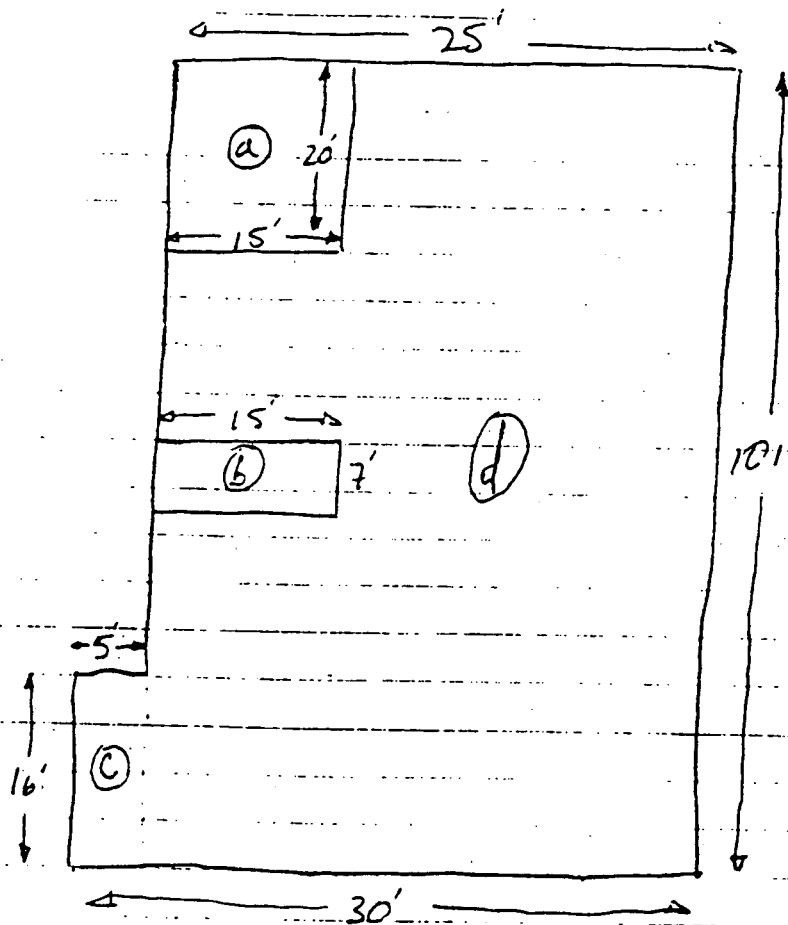

Note:

areas a & b have been done
 an additional 1 1/2 ft below
 area d. Area d will be
 calculated 1st and the
 additional areas for a & b
 will be calculated

Vol_d =

$$[(25' \times 2') + (0.5' \times 25' \times 0.5')] \div 27 \text{ ft}^3/\text{yd}^3 = 210.4$$

Vol_a =

$$(20' \times 15' \times 1.5') \div 27 \text{ ft}^3/\text{yd}^3 = 16.7 \text{ yds}^3$$

Vol_b =

$$(15' \times 7' \times 1.5') \div 27 \text{ ft}^3/\text{yd}^3 = 5.8 \text{ yds}^3$$

$$\text{Vol}_c = (16' \times 5' \times 2 \frac{1}{2}') \div 27 \text{ ft}^3/\text{yd}^3 = 7.4 \text{ yds}^3$$

Total Volume = $V_a + V_b + V_c + V_d$

$$= (210.4 + 16.7 + 5.8 + 7.4) \text{ yds}^3$$

$$= 240.3 \text{ yds}^3$$

Contractor: [Signature]

Inspector: Brit A Hedger 4/25/92



DATE 4/23/92
PROJECT NO. 91C7315
PAGE NO. 1 OF 1 BY BAH

Excavation of Area 14 April 23, 1992

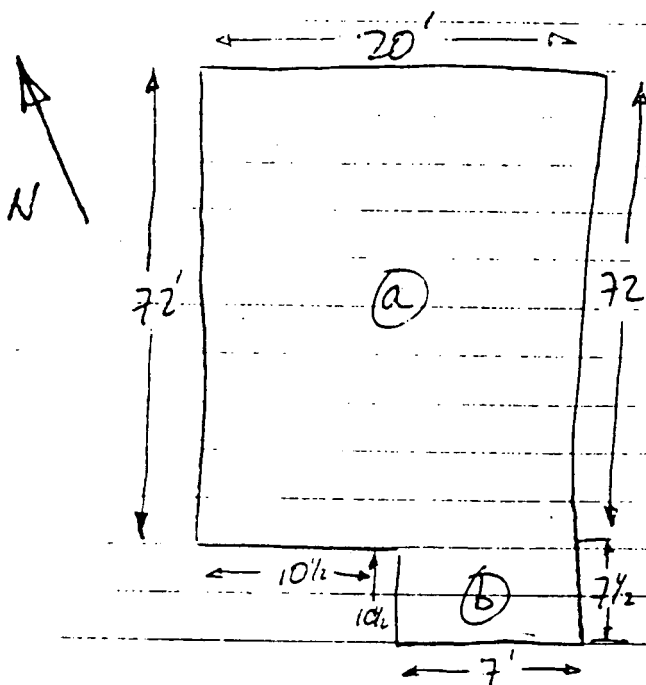

$$\text{Volume}_a = [(72' \times 17.5') + (2.5' \times 72' \times 0.5)] \times 1.5' \div 27 \text{ ft}^3/\text{yd}^3$$
$$= 75 \text{ yds}^3$$

$$\text{Volume}_b = [(7 1/2' \times 7') + (7' \times 3' \times 0.5)] \times 1.5' \div 27 \text{ ft}^3/\text{yd}^3$$
$$= 3.5 \text{ yds}^3$$

$$\text{Volume}_{\text{total}} = \text{Vol}_a + \text{Vol}_b$$
$$= 75 \text{ yds}^3 + 3.5 \text{ yds}^3$$
$$= 78.5 \text{ yds}^3$$

Contractor: [Signature]

Inspector: Bert A Healy 4/



Excavated Area 10c

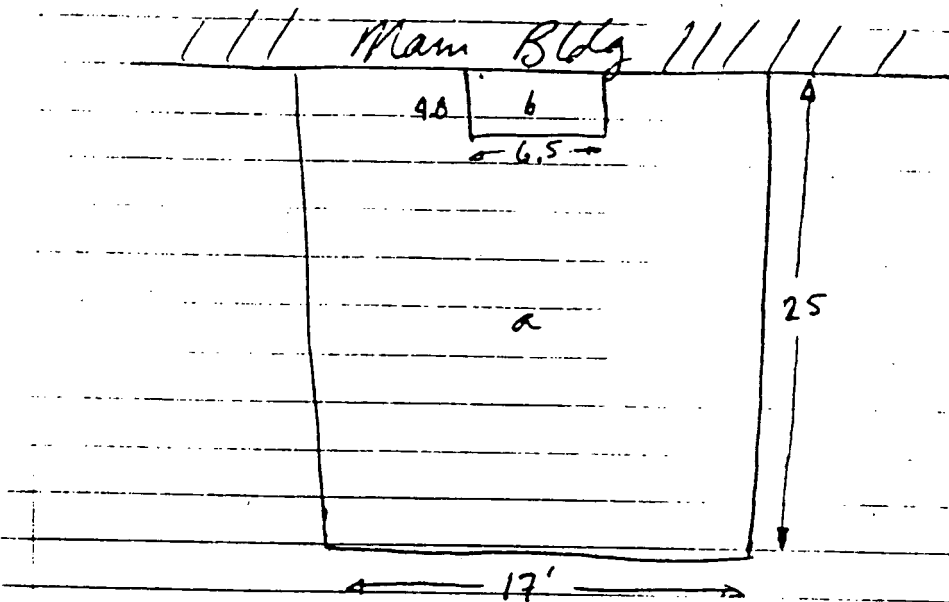

$$\begin{aligned} Vol_a &= 25' \times 17' \times 1.5' \div 27 \text{ ft}^3/\text{yds}^3 \\ &= 23.6 \text{ yds}^3 \end{aligned}$$

$$\begin{aligned} Vol_b &= 4.8' \times 6.5' \times 1.5' \div 27 \text{ ft}^3/\text{yds}^3 \\ &= 1.7 \text{ yds}^3 \end{aligned}$$

$$\begin{aligned} \text{Total Volume} &= Vol_a - Vol_b \\ &= 23.6 \text{ yds}^3 - 1.7 \text{ yds}^3 \\ &= 21.9 \text{ yds}^3 \end{aligned}$$

Contractor: [Signature]

Inspector: Bret A Healy 4/25/92

Removal Estimate - Additional Street Level Area
 Adv to Tax pad 4/27/92

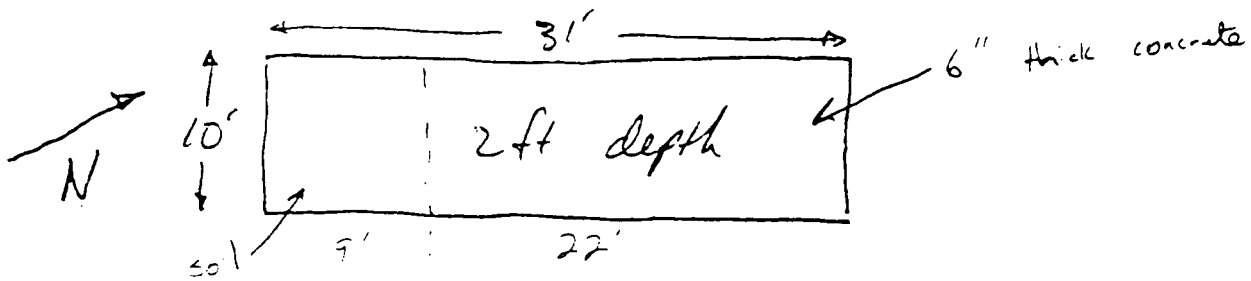

$$\text{Volume} = 31' \times 10' \times 2' \div 27 \text{ ft}^3/\text{yd}^3$$

$$= \text{23 yds}^3 - 4.1 \text{ yd}^3 =$$

18.9 yd ³ soil
4.1 yd ³ concrete

Contractor: L. D. [Signature]

Inspector: Bret A. Hedley 4/30/92

EVW/ST
 5-22-92

Concrete

$$0.5' \times 22' \times 10' = 110 \text{ ft}^3$$

$$= 4.1 \text{ yd}^3$$



DATE _____

PROJECT NO. _____

PAGE NO. _____ OF _____ BY _____

AGST Fluid removal

AGST #	CGI Readings		Comments
	Post rinse ⁴	Post, post rinse ⁵	
4 ^{1,3}	0%	1%	_____
5 ^{1,2}	0%	0%	2-55 gal drums of product 1-55 gal drum of rinsate
6 ^{1,4}	0%	2%	_____
7 ^{1,3}	5%	2%	_____
8 ^{1,2}	10%	3%	_____

Notes

- 1) One 55-gal drum of purge/decon water used to rinse each of the 5 tanks.
- 2) Fluids from tank #5 are containerized - product & rinsate.
- 3) A total of approximately 2000 gals of product & rinsate removed from AGST's #4, 6, 7 & 8.
- 4) CGI reading taken immediately after rinsing. AGST #8 was taken after access hatch had been put back on temporarily for ~15 min.
- 5) readings taken approx 36 hours after the hatches have been sealed up.

Contractor: CDHDate: 4/28/92Inspector: Burt A. KellyDate: 4/28/92

Additional Removal Areas - 2d west (4/23/92)

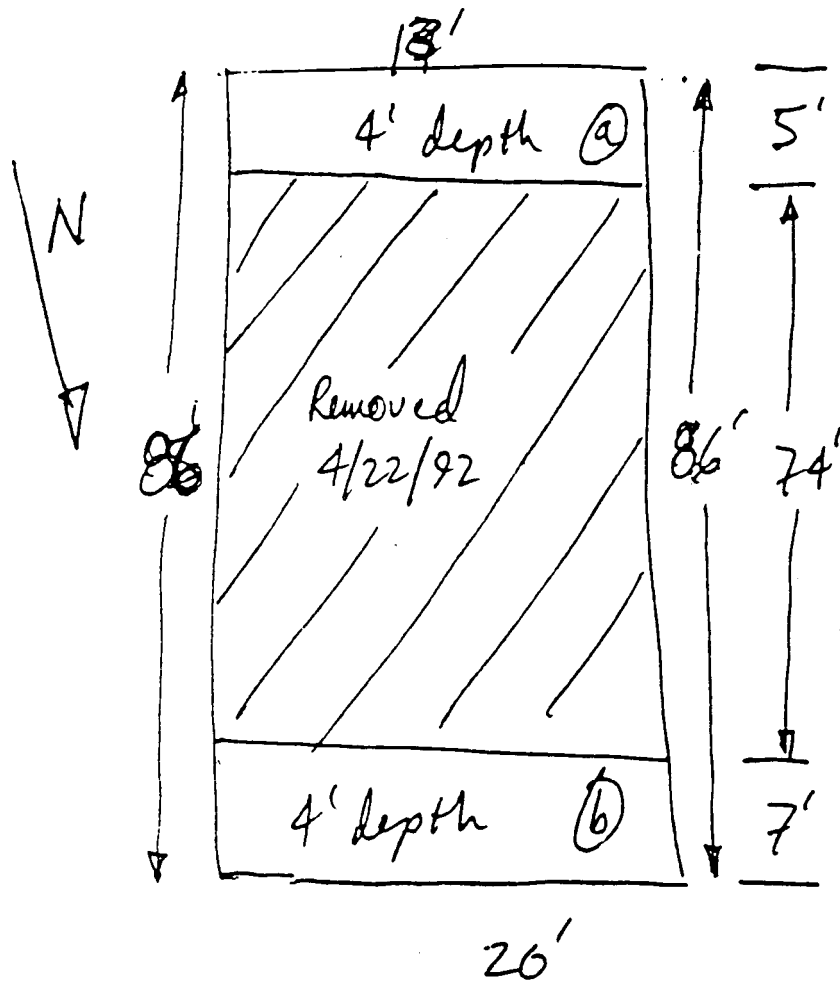

$$\text{Volume}_a = 13' \times 5' \times 4' \div 27 \text{ ft}^3/\text{yd}^3 = 9.63 \text{ yds}^3$$

$$\text{Volume}_b = 20' \times 7' \times 4' \div 27 \text{ ft}^3/\text{yd}^3 = 20.74 \text{ yds}^3$$

$$\text{total} \quad \underline{\underline{30.4 \text{ yds}^3}}$$

Contractor: POJ 4-30-92

Inspector: Bret A Hedgp 4/29/92



BY BAH DATE 4/22/92 PROJECT NAME Interchem PROJECT NUMBER 94C7315
 CHKD. BY MLK DATE 4/23/92 SUBJECT Removal est area 2d SHEET NO. 1 OF 1

Excavation of portion of soil area 2d. on 4/22/92

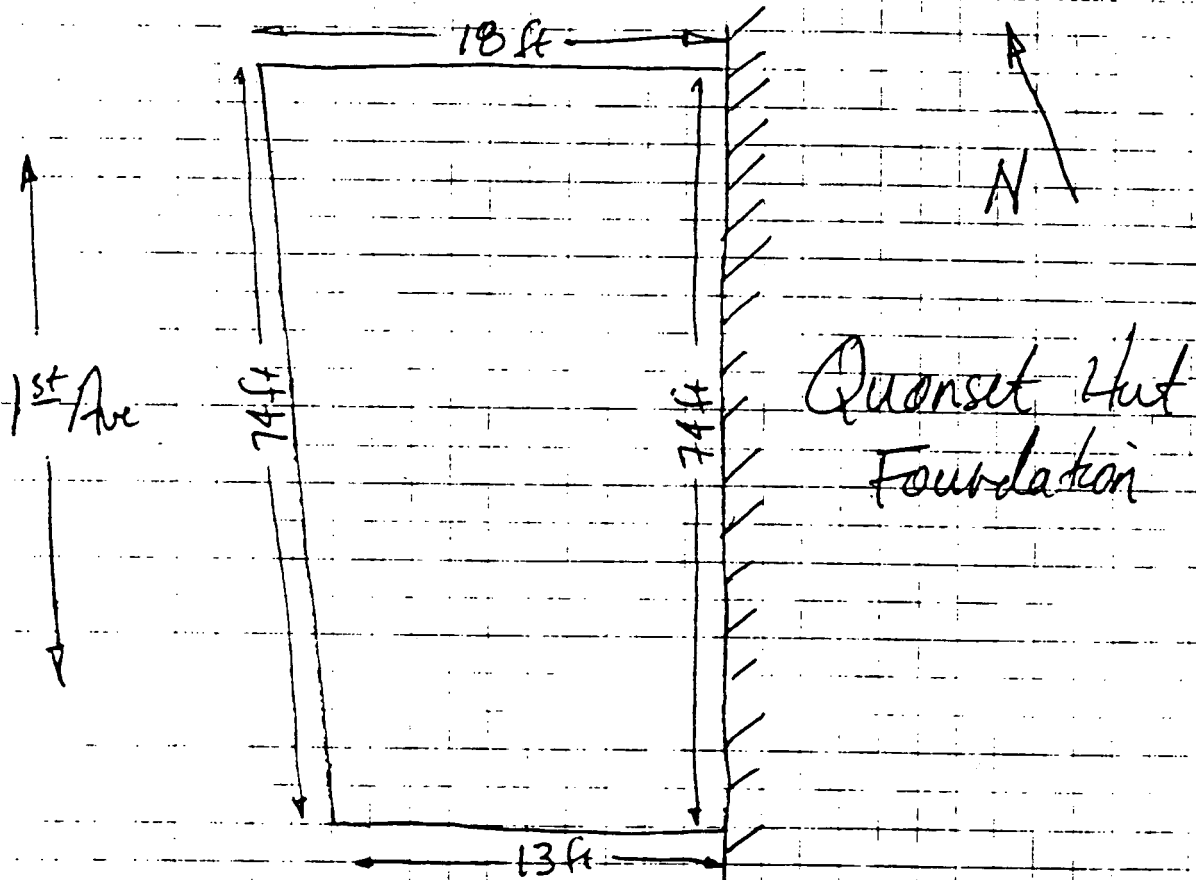

Consistent excavation depth of 42 in

i. In-place removal volume:

$$V = [(13' \times 74') + \frac{1}{2}(5' \times 74')] \times 3\frac{1}{2}' \div 27 \text{ ft}^3/\text{yd}^3$$

$$= 148.7 \text{ yds}^3$$

Contractor: [Signature]

Date: 4-23-92

Inspector: Bret A Kelly

Date: _____

Removal Estimate - Tax Pad 4/24 - 4/27/92

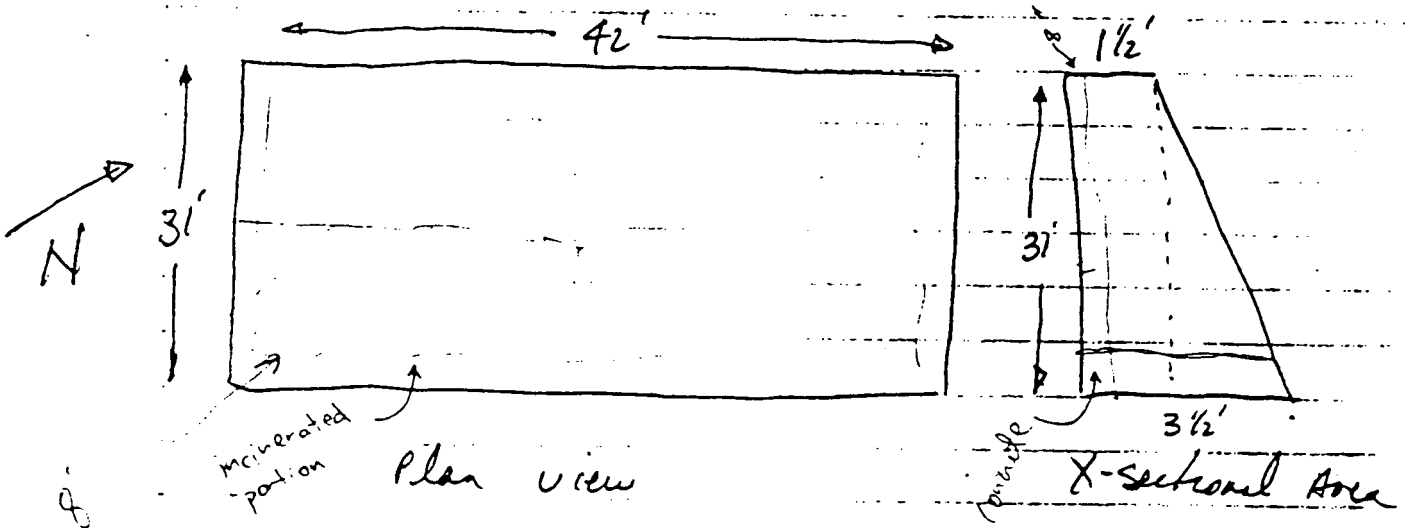

$$\begin{aligned} \text{X-sectional area} &= (2' \times \frac{1}{2} \times 31') + (1\frac{1}{2}' \times 31') \\ &= 77\frac{1}{2} \text{ ft}^2 \end{aligned}$$

$$\text{Volume} = 77\frac{1}{2} \text{ ft}^2 \times 42 \text{ ft} \div 27 \text{ ft}^3/\text{yd}^3$$

$$= 120.6 \text{ yd}^3 - 33.8 \text{ yd}^3 = \begin{array}{l} 86.8 \text{ yd}^3 \text{ soil} \\ 33.8 \text{ yd}^3 \text{ concrete} \end{array}$$

Contractor: L. D. [Signature]

Inspector: Bill A Hedup 4/30/92

BV45T

T-22-92

Concrete

$$\begin{aligned} 0.7' \times 31' \times 42' &= 911.4 \text{ ft}^3 \\ &= 33.8 \text{ yd}^3 \end{aligned}$$



Street Level Additional Soil/Concrete Removal

5/4/92

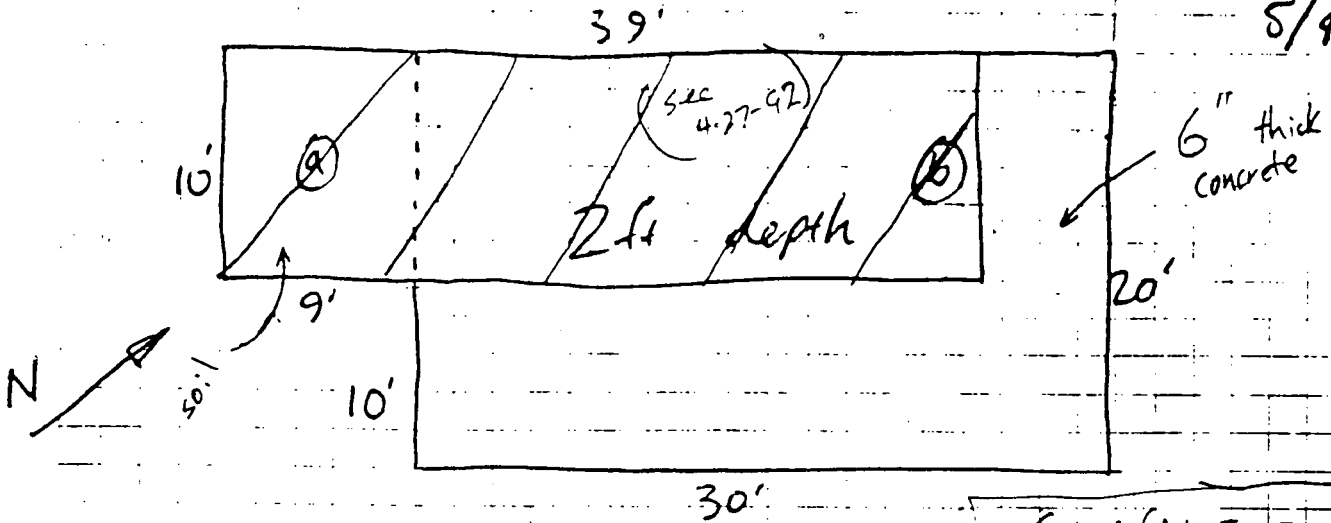

$$\begin{aligned} \text{Volume a} &= 10' \times 9' \times 2' \div 27 \text{ ft}^3/\text{yd}^3 \\ &= 6.7 \text{ yds}^3 \end{aligned}$$

$$\begin{aligned} \text{Volume b} &= 30' \times 20' \times 2' \div 27 \text{ ft}^3/\text{yd}^3 \\ &= 44.5 \text{ yds}^3 \end{aligned}$$

Concrete (B/W/S/T 5-22-92)

$$\begin{aligned} 30' \times 20' \times 0.5' &= 300 \text{ ft}^3 \\ &= 11.1 \text{ yds}^3 \text{ (Total)} \\ - 4.1 \text{ yds}^3 \text{ (4-27-92)} \\ \hline &= 7.0 \text{ yds}^3 \text{ (5-4-92)} \end{aligned}$$

Soil (B/W/S/T 5-22-92)

$$\begin{aligned} 28.2 \text{ yds}^3 - 7.0 \text{ yds}^3 &= 21.2 \text{ yds}^3 \text{ (5-4-92)} \\ + 18.9 \text{ yds}^3 \text{ (4-27-92)} \\ \hline &= 40.1 \text{ yds}^3 \end{aligned}$$

$$\text{Volume total} = 6.7 \text{ yds}^3 + 44.5 \text{ yds}^3 - \text{Volume removed on 4/27/92}$$

$$\begin{aligned} &= 51.2 \text{ yds}^3 - 23 \text{ yds}^3 \\ &= 28.2 \text{ yds}^3 \end{aligned}$$

Contractor: CPD

Inspector: Bret A. Healy 5/5/92

	B/W/S/T 5-22-92	4-27-92	5-4-92	Total
Concrete				
Removed	4.1 yd ³		7.0 yd ³	= 11.1
Soil		18.9 yd ³	21.2 yd ³	= 40.1
Removed				
			Grand Total	51.2



Additional soil Removal
 Area - 2d south

5/5/92

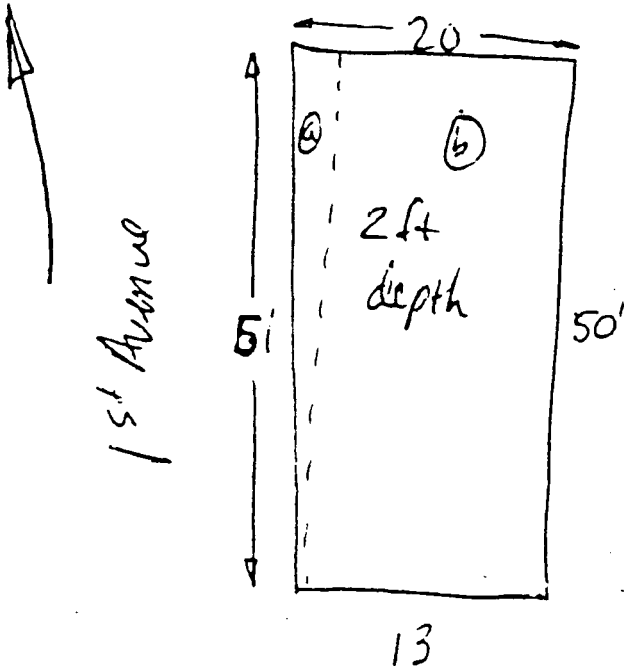

$$\begin{aligned} \text{Volume}_{a+b} &= (7' \times 51' \times \frac{1}{2} \times 2') + (13' \times 50' \times 2') \div 27 \text{ ft}^3/\text{yds}^3 \\ &= 61.4 \text{ yds}^3 \end{aligned}$$

Contractor : L. O. J.

Inspector : Bret A Hedley 5/5/92

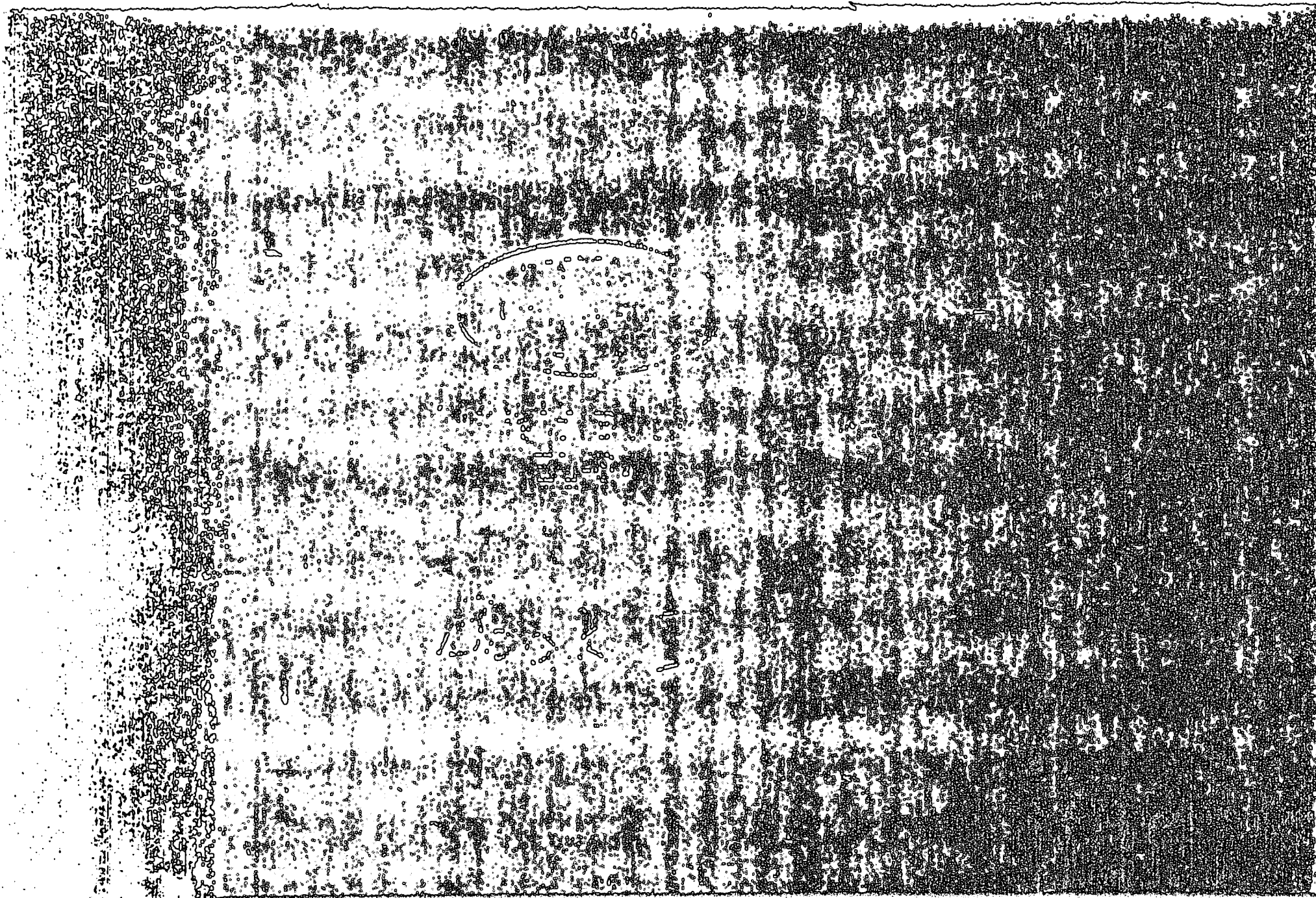

9/6 10/4/91

10/13/91 Jay FIM

site. All of the containers in the north sled have been double covered with visqueen. The site is all cleaned up and the workers are heading to the house.

1050 Left the site and returned to K.L.

~~FIM~~

10/13/91 Jay FIM

FM UC 9
11/11/91

Douglas E. Lade 4/13/92
0802 I ARRIVED ON SITE IN ALTON, IA. WOODWARD-CLYDE WAS ON SITE SETTING UP THE AIR MONITORING PUMPS.

0930 I WENT TO CASEY'S GENERAL STORE TO GET SOME SUPPLIES. WCC WAS THERE ON THE PHONE. THEY TOLD ME THAT THEY HAVEN'T GOTTEN A WRITTEN OK FROM THE HAZARDOUS WASTE LANDFILL. SO THEY WON'T BE STARTING UNTIL WEDNESDAY ON THE REMOVAL.

1015 I CALLED GARY FELKNER TO TELL HIM WHAT IS GOING ON. I TOLD HIM THAT WCC IS GOING TO COLLECT SOIL FROM SOURCE MATERIAL & GROUND WATER SAMPLES FROM THE FOUR WELLS

Douglas E. Lade

100 AA-DEL
98

Douglas E. Lade 4/13/92
ON SITE. THEY ARE
ALSO GOING TO RUN
THEIR AIR MONITORING
PUMPS.

1110 I CALLED GARY KEMNER
IN THE KC, MO. OFFICE
TO TELL HIM WHAT IS
GOING ON NOW AND
ASK HIM ABOUT THE
SAMPLING PAPERWORK.

1140 I TALKED TO WCC ABOUT
TODAYS ACTIVITIES. THEY
SAID THEY ARE GOING TO
DO A ROUND OF AIR MONITORING.
TAKE LUNCH THEN
SAMPLE THE WELLS.

1225 I TOOK LUNCH.

1248 I FINISHED TAKING LUNCH.

1250 I STOPPED BY THE SITE
BRETT WAS GETTING
READY TO TAKE WATER
LEVEL READINGS. HE IS
THEN GOING TO BEGIN
PURGING THE WELLS.
THAN SAMPLE THEM.

Douglas E. Lade

100 AA-DEL
98

Douglas E. Lade 4/13/92
1251 I LEFT SITE TO GET
COPIES OF PAPERWORK.

1307 I RETURNED TO SITE.

1315 MET DEL FROM THE
SHERIFFS DEPT.

1330 BRETT HEADENKAMP
GOT SET UP TO PURGE
WELLS.

1350 I MET TERRY ANDRAWS,
MARK KEMNER.

1352 I BEGAN PURGING MW-2
WATER LEVEL READING.

1422 WCC FINISHED PURGING
AND TAKING PH, COND, TEMP
READINGS FROM MW-2

1426 MARK KEMNER TOLD ME
THEY ARE GOING TO PURGE
AND SAMPLE WELLS

EVEN IF THEY DON'T MEET
THEIR FEDEX PICK UP.
HE SAID THEY WILL SHIP
IT TOMMOROW. BRETT &

TERRY ARE DOING ANOTHER
ROUND OF AIR MONITORING

1500 DAVE BOXUM FROM

Douglas E. Lade

102
100

RELAY
REC

Douglas E. Ladd 4/13/92
CHANNEL 4 ACTIV
STOPPED BY TO
SEE HOW THE CLEAN
UP IS GOING. MARK
KEMNER REFERRED
HIM TO ME. I THEN
REFERRED HIM TO
JIM COLBERT IN THE
KANSAS CITY, KS OFFICE.
HE ASKED WHAT THEY
WILL BE DOING AND
WHAT IS THE EXTENT
OF THE CONTAMINATION.
I TOLD HIM THERE WILL
BE SOIL EXCAVATING,
CONCRETE AND SHEET
DEMOLITION. I TOLD
HIM I DID NOT KNOW
THE EXTENT OF THE
CONTAMINATION AT THIS
TIME.

1540 BEGAN SAMPLING MW-2
I COLLECTED METALS,
CYANIDE, SEMI-VOAS,
+ IS4DT-001-MW-2

Douglas E. Ladd

Douglas E. Ladd 4/13/92 (10)
~~DEL BEGAN SAMPLING MW-1~~
~~DEL COLLECTED SAME ANALYSIS~~
~~DEL IS4DT-002-MW-1~~
1616 WCC BEGAN PURGING
MW-1. BRETT TOOK 3
ROUNDS OF pH, COND & TEMP.
1625 FINISHED PURGING MW-1
1630 WCC BEGAN SAMPLING
MW-1. I COLLECTED
SAME ANALYSIS AS BEFORE
IS4DT-002-MW-1
1650 FINISHED SAMPLING @ MW-1
1700 WCC BEGAN PURGING
MW-3
1726 WCC FINISHED PURGING
MW-3
1730 WCC BEGAN SAMPLING
MW-3. SAME ANALYSIS +
VOA'S AND PESTICIDES. IS4DT-004
1755 FINISHED SAMPLING
MW-3. WCC TOOK A DUP.
1820 WCC BEGAN PURGING
MW-4. THEY TOOK
THEIR LAST AIR MONITOR
READINGS BEFORE STARTING

Douglas E. Ladd

(104)

Douglas E. Lade 4/13/92
TO PURGE MW-4

1845 BEGAN SAMPLING MW-4
SAME ANALYSIS AS MW-14
2. SAMPLE NUMBER
IS 40T-003

1900 FINISHED SAMPLING
MW-4. AT 1800 I TOOK
AN ACID BLANK AND AT
1815 A TRIP BLANK.

1922 I LEFT SITE FOR THE
DAY.

Douglas E. Lade

TUESDAY

(105)

Douglas E. Lade 4/14/92
1000 I BEGAN PACKAGING SAMPLES
FOR SHIPMENT.

1325 LEFT FOR FED EX TO DROP
OFF GROUNDWATER SAMPLES
DEL FOR SHIPMENT.

1415 DELIVERED SAMPLES TO
FED EX.

1530 I RETURNED TO THE MOTEL.

Douglas E. Lade

WEDNESDAY

(106)

Douglas E. Lade 4/15/92

0700 I ARRIVED ON SITE. HERITAGE & WCC HAD ARRIVED ON SITE. BRETT HEADENKAMP SAID THEY WILL BE ~~SETUP~~ SETTING UP AND BUILDING A DECON AREA.

0725 HERITAGE BEGAN UNROLLING DOORS ON THE SHEDS TO BE DEMOLISHED. BRETT SAID THEY ARE GOING TO START ^{BE} REMOVING THE DRUMS FROM THE SHEDS AND PLACING THEM ON THE CONCRETE BESIDE THE MAIN BLDG ON THE EAST SIDE. THEY WILL THEN BEGIN TAKING APART THE SHEDS AT THE SAME TIME THEY WILL BE EXCAVATING THE SOIL FROM THE NORTHEAST OF THE MAIN BLDG AREA "10C"

0800 HERITAGE BEGAN MOVING DRUMS FROM THE SHEDS OVER TO THE CONCRETE, IN LEVEL "C"

0817 HERITAGE BEGAN EXCAVATING AREA 10C.

Douglas E. Lade

(107)

Douglas E. Lade 4/15/92

0820 BRETT WAS TAKING READINGS WITH DUST MINI-RAM. HE IS GETTING .44 DOWN WIND. ACTION LEVEL IS 175 $\mu\text{g}/\text{m}^3$. THEY ARE REMOVING UP TO 12" OF SOIL.

0908 BACKHOE OPERATOR BEGAN MOVING SOME OF THE EXCAVATED SOIL FROM 10C TO THE NEAST CORNER OF 1ST AVE & 11TH ST.

1000 TRACK HOE FOR HERITAGE ARRIVED ON SITE TO HELP IN TAKING APART THE SHEDS AND DIGGING OTHER AREAS.

1058 CITY OF FALTON ELECTRIC DEPT ARRIVED TO SHUT OFF POWER TO ELECTRICAL POLE ON THE SOUTH END OF THE SHEDS. AND DISCONNECT IT.

1117 LEFT SITE TO CALL JIM COLBERT EPA - WAM OVER THIS JOB TO TELL HIM HOW THINGS ARE GOING. HE ASKED ME TO CHECK ON WHEN THE TRUCKS MITE ARRIVE TO PICK UP SOIL AND TAKE IT TO THE HAZDOUS WASTE LANDFILL.

1135 I RETURNED TO INTERCHEM SITE. ACTIVITIES ARE STILL GOING.

Douglas E. Lade

(108) Douglas E. Lake 4/15/92

1220 STOPPED TO TAKE LUNCH

1300 RETURNED TO SITE.

1308 BRETT & TERRY GOT SET
UP TAKE SOIL VERIFICATION
SAMPLES.

1310 WCC BEGAN COLLECTING
COMPOSITE SOIL SAMPLE
FROM 10c REMOVAL AREA.
HERITAGE FINISHED EXCAVATION
AREA 10c. THEY ARE GOING TO
COVER THE EXCAVATING AREA
WITH PLASTIC.

1408 HERITAGE BEGAN MOVING
THE LARGE TANK FROM ^{THE} SHED
NO 13. IT IS STARTING TO RAIN.

1440 WCC WANTED HERITAGE TO
EXCAVATE AREA 2^d BUT THERE
RUN OFF COMING DOWN
DOWN OFF OF THE MAIN BLDG
THEY GOING TO EXCAVATE
2^d HADEL. OTHER HERITAGE
WORKERS ARE COVERING
DRUMS WITH PLASTIC.

1500 I TALKED TO ^{WCC} ABOUT
STOPPING THE DIGGING

Douglas E. Lake 4/15/92 (109)

BECAUSE OF THE RAIN
THAT IT WILL SEND THE
PESTICIDES DEEPER.

BRETT AND MARK FROM
WCC DID NOT FEEL TO
CONCERNED ABOUT IT.

1525 I TALKED WITH DOB

FROM HERITAGE AND
MARK FROM WCC THAT IT
IS STARTING TO RAIN HARDER
AND THAT WE SHOULD STOP
DIGGING UNTIL IT STOPS
AND DRIES UP. MARK ASK
ME IF IT WAS OK IF THEY
COULD PILE THE WALLS &
ROOF OF THE SHED ON
TOP OF THE FLOOR IF IT
IS COVERED WITH PLASTIC
I SAID ~~NO~~ ^{NO} SINCE THEY
WERE TESTED AND
FOUND TO BE CLEAN.
THEY ARE NOT GOING TO DO
ANYMORE EXCAVATING UNTIL
IT STOPS RAINING AND
DRIES UP SOME.

(110) Douglas E. Lade 4/15/92
 1545 HERITAGE FINISHED
 DEMONSTRATING THE BUCKET
 ON THE BACKHOE, AND
 1546 THEY BEGAN TEARING
 DOWN THE SHEDS.
 1550 MARK ASKED IF IT WAS OK
 THAT THEY DID NOT HAVE
 PLASTIC DOWN AROUND THE
 BUILDING WHILE THEY ARE
 DEMOLISHING THE NORTH
 SHED I SAID IT IS OK BUT
 THERE SHOULD BE PLASTIC
 DOWN WHEN THEY REMOVE
 THE FLOOR.
 1650 HERITAGE FINISHED DEMO
 ON THE NORTH SHED.
 1715 LEFT SITE FOR THE DAY.

Douglas E. Lade

THURSDAY
 Douglas E. Lade 4/16/92 (111)
 0655 I ARRIVED ON SITE.
 HERITAGE & WCC WAS ON
 SITE.
 0703 HERITAGE BEGAN TAPING
 OFF THE EXCLUSION ZONE
 WITH CAUTION TAPE.
 0720 MET WITH JIM COLBERT FROM
 EPA REGION III. WE TALKED
 ABOUT WHAT IS GOING ON ON SITE.
 WE TALKED BRETT & MARK
 FROM WCC ABOUT THE STOCK
 PILING OF THE CONTAMINATED
 SOIL. WE SAID IF THEY ARE
 GOING TO STOCK PILE THE
 ON PLASTIC THAT THEY WILL
 HAVE TO TAKE A LAYER OF
 CLEAN SOIL UNDER THE PLASTIC
 JUST TO MAKE SURE IT HAS
 NOT BEEN CONTAMINATED.
 BRETT THEN TALKED TO JIM
 ABOUT THAT THEY ARE GOING
 TO REMOVE ^{TO REMOVE} ~~FOR WCC~~ ^{MARK'S DEP} THE FIRST INCH OR SO FROM
 THE CONCRETE AREA WHERE
 THE TOXAPHENE TANK HAD SAT
 THAT IT HAS HIGH LEVELS.

(112)

Douglas E. Lapp 4/16/92
 AND WILL NEED TO BE
 INCINERATED. WE THEN
 WENT OVER THE ISSUE OF
 THE SOUTH SHED AS TO
 WHAT IS STAINED AND WHAT
 IS NOT. AFTER INSPECTION
 OF THE SHED BOARDS FROM
 HERITAGE THAT THEY
 COULD TAKE THE FIRST
 THREE BOARDS FROM THE
 BOTTOM UP AND THE FLOOR
 AS HAZDOURS MATERIAL.
 JIM COLBERT AGREED.
 WE THEN BRIEFLY DISCUSSED
 THE TANK CLEANING PROCESS
 IT WILL BE DECIDED LATER.
 JIM AND I OBSERVED HERITAGE
 CHIP AWAY THE 1" LAYER
 OF CONCRETE. THE MINI-
 RAM WAS IN PLACE AND WAS
 READING 0.12. WELL BELOW
 LIMITS. JIM AND I ALSO
 NOTICED THE AIR SAMPLER
 NEARBY HE FELT THERE
 SHOULD BE TWO SAMPLES

0845

Douglas E. Lapp

Douglas E. Lapp 4/16/92 (113)

DOWN WIND AND THE WIND
 IS BLOWING RIGHT ACROSS
 THE PAD OUT OF THE
 NORTHWEST.

JIM LEFT SITE TO TALK TO
 SOME PEOPLE. HE IS STILL
 NOT SURE IF STOCK PILING
 THE SOIL IS THE RIGHT
 THING TO DO. HE IS GOING
 CALL THE EPA OFFICE
 TO SEE HOW THEY FEEL
 HE WILL BE BACK AT 1000
 WHEN THE REPORTER FROM
 SIOUX CITY, IOWA ARRIVES.

0915

I OBSERVED HERITAGE
 WORKERS TEARING OFF
 THE FIRST THREE BOARDS
 FROM THE SOUTH SHED.

1008

JIM COLBERT ARRIVED BACK AT SITE.

1010

THE REPORTER FROM SIOUX
 CITY, IA. TO TAKE PHOTO
 OF THE SITE. WORKERS WERE
 STOCK PILING CONTAMINATED
 WOOD FROM SOUTH SHED
 ON TO PLASTIC IN LEVEL C.

Douglas E. Lapp 4/16/92

(114) Douglas E. Lade 4/16/92
TERRY ANDREWS IS TAKING
AIR MONITORING READINGS
WITH A DUST MINI-RAM
0.20 IS AN AVERAGE.
1026 OBSERVED CONCRETE PAD
DEMOLITION, DUST READINGS
AVERAGED ~~0.40~~ 0.40
1100 HERITAGE BEGAN DEMO
ON SOUTH SHED,
1130 STOPPED TO TAKE LUNCH.
1200 RETURNED TO SITE
1215 HERITAGE BEGAN LOADING
CHIPPED CONCRETE INTO
55 gal DRUMS. DUST READINGS
20 FT AWAY AVERAGE (0.3)
1245 BRETT UPGRADED WORKERS TO
LEVEL "C". READINGS ARE ONLY
2.9 BUT WCC IS JUST BEING
CAUSIOUS.
1440 HERITAGE STOPPED BRAKING
UP CONCRETE.
1445 HERITAGE BEGAN DECONNING
JACK HAMMER.
1450 FINISHED DECONNING.
1555 LEFT SITE FOR THE DAY

FRIDAY
Douglas E. Lade 4/17/92 (115)
0722 I ARRIVED ON SITE. BRETT & TERRY
FROM WCC WERE ON SITE.
WEATHER: 40'S FOG HIGH IN
THE 50'S.
0737 JIM COLBERT EPA ARRIVED
ON SITE.
0757 HERITAGE BEGAN LOADING
TRUCKS WITH CLEAN WASTE.
0830 JIM COLBERT LEFT SITE FOR
KANSAS CITY, KS OFFICE.
THE FIRST LOAD OF SHED
DEBREE ALSO LEFT SITE FOR
THE LANDFILL.
0925 THE FIRST TRUCK ARRIVED BACK
ON SITE FOR ITS SECOND
LOAD.
0941 HERITAGE WORKERS LINED
THEIR FLAT BED SO THEY CAN
LOAD CONTAMINATED BOARDS ONTO
IT MOVE IT TO A CONTAMINATED SOIL
AREA WHERE IT WILL BE WRAPPED
IN PLASTIC.
0946 HARRY VAN ^{OF} THE MAN SUPPLIES
TRUCKS TO TAKE CLEAN DEBRIS
TO THE LANDFILL.

(116) Douglas E. Lade 4/17/92

1002 SECOND TRUCK ARRIVED ON SITE TO BE LOADED

1018 MR VANDER POL LEFT SITE AND SECOND TRUCK LEFT SITE

1025 THIRD TRUCK ARRIVED FOR FOURTH LOAD.

1034 THIRD TRUCK LEFT ^{OPEN END} SITE.

1049 2ND TRUCK ARRIVED FOR THE FIFTH LOAD.

1050 BRETT HEADENKAMP ASKED ME TO CALL JIM COLBERT TO SEE IF THEY CAN USE SOIL CUTTINGS FROM THE BORINGS AND WELLS AS BACK FILL FOR EXCAVATED AREAS. THEY ARE ALSO WANTING TO KNOW IF THEY CAN DRUMP THE WATER DRUMS.

1100 DEL WALINGLATHÉ ONE INCHARGE OF NIGHT SECURITY ARRIVED ON SITE. THE FIFTH LOAD LEFT.

1126 THIRD TRUCK ARRIVED FOR 6TH LOAD OF DEBREE

1134 7TH LOAD ARRIVED TO BE LOADED

8 7 10 10

Douglas E. Lade 4/17/92

(117)

1136 6TH LOAD LEFT SITE.

1150 7TH LOAD LEFT SITE.

1158 8TH LOAD ARRIVED TO BE LOADED.

1205 8TH LOAD LEFT SITE.

1220 THE FORTH TRUCK (OPEN END) ARRIVED ON SITE FOR THE NINTH LOAD.

1229 9TH LOAD LEFT SITE.

1239 10TH LOAD ARRIVED TO BE LOADED.

1250 10TH LOAD LEFT SITE

1253 11TH LOAD ARRIVED TO BE LOADED.

1310 11TH LOAD AND ^{THE} LAST LOAD LEFT SITE.

1330 LEFT SITE TO TAKE LUNCH.

1400 RETURNED TO SITE FROM LUNCH.

HERITAGE WORKERS ARE LOADING FLOOR DECKING FROM NORTH SHED AND MOVING IT TO AREA 14 FOR STOCK PILING. WOOD WILL BE WRAPPED IN PLASTIC. HERITAGE IS WORKING UNTIL 1500 HOURS. SATURDAY THEY ARE GOING TO REMOVE THE REST OF THE DECKING, INSPECT THE

8 7 10 10

(118)

Douglas E. Lado 4/17/92
CONCRETE, TRY AND WASH
IT IF STAINED, IF IT IS
ABLE TO BE CLEANED
IT WILL BE TAKEN OFF
SITE AS CLEAN WASTE.
THERE WILL BE NO WORK
SUNDAY.

1450 HERITAGE FINISHED MOVING
AND COVERING FLOOR DECK
WITH PLASTIC AND THE
FOUNDATION OF THE SHEDS
WITH PLASTIC.

1500 LEFT SITE FOR THE DAY.

1525 I CALLED JIM COLBERT
ABOUT TODAY'S ACTIVITIES
AND THE QUESTION
ABOUT THE DRUMS
BRETT ASKED ME ABOUT.
HE WAS NOT IN I LEFT
A MESSAGE.

1535 HE CALLED BACK, I
FILLED HIM IN AND
THE QUESTION ABOUT
THE DRUMS. HE SAID
HE WOULD HAVE TO

Douglas E. Lado

Douglas E. Lado 4/17/92 (119)

CHECK ON IT AND GET
BACK TO ME

1435 JIM COLBERT CALLED BACK.
HE SAID HE STILL DID NOT
HAVE ENOUGH INFO OR THE
OK TO USE THE SOIL FROM
THE DRUMS THAT WAS COLLECTED
DURING THE DRILLING ON
SITE. HE SAID TWO FOR RIGHT
NOW AND THAT THEY CAN
NOT DUMP THE WATER
DRUMS EITHER. ALSO THERE
WILL BE NO STOCK
PILING OF SOIL OR
CONTAMINATED CONCRETE.

Douglas E. Lado

(120)

SATURDAY

Douglas E. Lade 4/18/92

0655

I ARRIVED ON SITE.
HERITAGE WAS AND BRETT
FROM WCC WAS ON SITE.

0710

HERITAGE WORKERS
BEGAN PULLING PLASTIC
OFF OF THE TOP OF THE
DECKING SO THAT THEY
CAN PULL THE DECKING UP
AND BREAK UP THE CONCRETE.

0715

BEGAN PULLING DECKING.

0757

DUST READING SO. 24-0.16
HIGH OF 0.66

0824

FINISHED PULLING UP
NORTH SIDE'S DECKING.

0828

HERITAGE BROKE UP DECKING
CROSS MEMBERS WITH THE
TRACKHOE.

~~0844~~

~~IT BEGAN RAIN - 4/18/92~~

0900

STOPPED BECAUSE OF RAIN.

0930

RAIN LET UP WENT BACK
TO WORK.

1122

HERITAGE MADE ANOTHER
PILE OF COMINATED DECKING
ON SOIL AREA 2nd of 14.

1140

STOPPED FOR LUNCH.

2.10

(121)

Douglas E. Lade

1210 RETURNED TO SITE FROM
LUNCH.

1258 HERITAGE WORKERS WENT
TO WORK AFTER A RAIN
DELAY.

1350 STOPPED WORK BECAUSE
OF RAIN.

1350 I LEFT SITE.

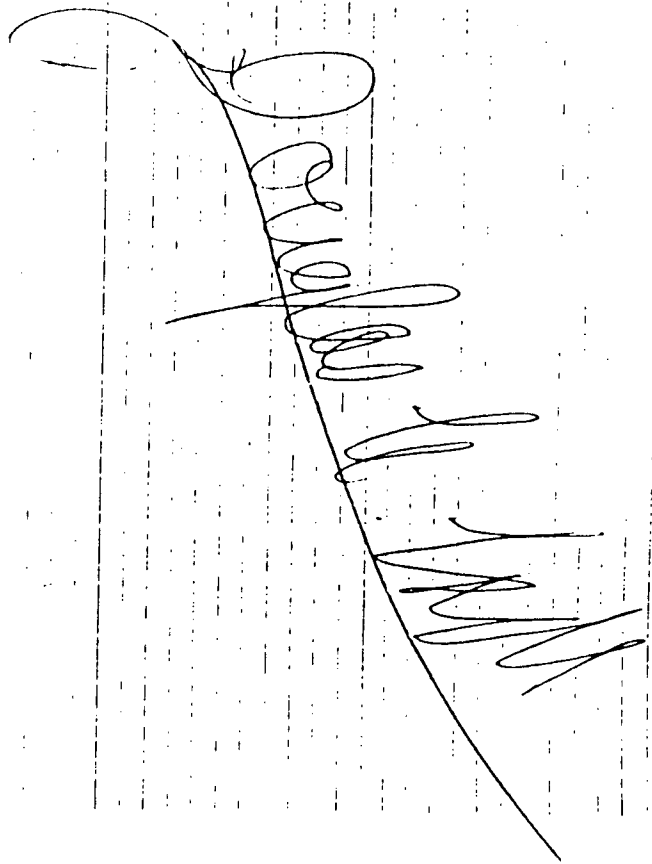

(122) Douglas E. Lade 4/20/92 MONDAY

0657 I^{ARRIVED} ON SITE AT INTERCHER/ HERITAGE AND WCC WAS ON SITE. WEATHER 30'S HIGH 43, CHANCE OF RAIN CHANGING TO SNOW. TRUCKS HAVE NOT ARRIVED YET.

0715 I TALKED TO BRETT HEADEN KAMP ABOUT WHAT IS GOING TO HAPPEN TODAY. HE SAID THEY MITE FINISH REMOVING SHED FLOOR DECKING, BREAK UP THE CONCRETE PILLARS AND THE CONCRETE FOUNDATION SOUTH END OF THE SITE. BRETT DOESN'T KNOW ACT^{UALLY} WHEN WHAT TIME THE TRUCKS WILL ARRIVE^{DEL}.

0725 TERRY ANDREWS WCC SET OUT^{TAKE} AIR SAMPLING PUMPS.

0730 AL^{LEN} KALMER FROM HERITAGE ARRIVED ON SITE TO DELIVER POLY^{ETHYLENE} PICK UP LAB PAK DRUMS.

0805 I MADE A PHONE CALL TO MY

Douglas E. Lade 4/20/92 (123)

OFFICE TO TURN MY HOURS IN FOR FRIDAY'S TIME.

0819 I RETURNED TO SITE.

0850 HERITAGE TRACKHOE BEGAN BREAKING AND MOVING CONCRETE. 0915 KELLY FROM HERITAGE BEGAN BREAKING UP CONCRETE PAD WHERE THE TOXAPHENE TANK WAS. THE TRACKHOE OPERATOR WAS MOVING THE CONCRETE FROM THE SHED AREA TO^{DEL} OVER NEAR THE MAIN BUILDING PLACING IT ON PLASTIC.

1200 STOPPED TO TAKE LUNCH.

1230 RETURNED TO SITE FROM LUNCH

1305 LEFT SITE TO CALL JIM COLBERT EPA-WAM IN KANSAS CITY, KS. I BASICLY TOLD WHAT IS GOING ON AND THAT THERE HAS NOT BEEN ANY TRUCKS ARRIVE TO BE LOADED. I TOLD HIM THEY WERE MOVING THE CONCRETE SHED FOUNDATION OVER BESIDE BY THE EAST SIDE OF THE MAIN BUILDING SOUTH OF THE STOCK

(124) Douglas E. Lade 4/20/92
PILED SOIL, I TOLD HIM
THAT THEY WERE BASICALLY
JUST SCRAPING THE SOIL OFF
THE CONCRETE NOT WASHING
IT. HE FELT THAT MITE
NOT BE SUFFICIENT AND
MORE MITE HAVE TO BE DONE
BY WHAT THE WORK PLAN
SAYS. I ALSO INFORMED
HIM THAT THE WOOD CAN BE
TAKEN IN LOADS OF DEL
BY THEMSELVES.

1325 I RETURNED TO SITE.
1350 WORKERS COVERED SECOND
STOCK PILE OF CONTAMINATED
WOOD WITH PLASTIC.
1500 HERITAGE FINISHED MOVING
CONCRETE OUT OF SHED AREA.
1550 CHUCK HERITAGE'S OPERATOR
BEGAN BREAKING UP CONCRETE
FROM THE SHED'S FOUNDATION
WITH HOERAM.
1645 STOPPED WORK & LEFT
SITE FOR DAY.

Donald J. A.

TUESDAY
Douglas E. Lade 4/21/92 (125)
0716 I ARRIVED ON SITE. WE HAVE
I ESTIMATE 3+4" OF SNOW & ICE
ON THE GROUND. SNOW IS STILL
COMING DOWN. THERE IS ONLY
5 TRUCKS COMING TO BE LOADED.
0734 I CALLED JIM COLBERT EIA-WA
TO TELL HIM THAT THERE WILL
BE ONLY 5 TRUCKS LOADED AND
WHAT THE WEATHER CONDITIONS
ARE.
0750 BRETT HEADENKAMP AND MARK KEMNER
FROM WCC ARRIVED ON SITE.
HERITAGE WAS HAVING A FLAT FIXED
ON THE SEMI-TRACTOR.
0827 HERITAGE BEGAN BREAKING UP
CONCRETE FROM SHED FOUNDATION.
0835 I CALLED JIM COLBERT AGAS
HE WAS STILL NOT IN YET.
0840 I RETURNED TO SITE NO CHANGE
IN ACTIVITY.
0855 HERITAGE STOPPED BREAKING UP THE
SHED'S FOUNDATION AND WENT
OVER TO THE TOXAPHENE PAD
TO BREAK IT UP.
0858 HERITAGE BEGAN BREAKING UP THE

(126) Douglas E. Lade 4/21/92

TOXAPHENE PAD.

- 0910 FINISHED BRAKING UP CONCRETE AT TOXAPHENE PAD. HERITAGE MOVED BACK TO SHED FOUNDATION TO BRAKE IT UP.
- 0915 I LEFT SITE TO SEE IF I COULD GET SOME MORE MONEY.
- 0940 I RETURNED TO SITE. STILL NO CHANGE.
- 1005 I LEFT SITE TO PICK UP A NEW LOG BOOK.
- 1028 I RETURNED TO SITE. NOTHING HAS CHANGED. I HAD NO LUCK IN FINDING A LOG BOOK.
- 1030 MARK KEMNER TOLD ME THAT HERITAGE'S PROJECT MANAGER IS SNOWED IN IN OMAHA, NE.
- 1100 LEFT SITE TO TAKE LUNCH AND STOP BY THE BANK.
- 1140 I RETURNED TO SITE. NO CHANGE.

TOXAPHENE PAD.

Douglas E. Lade 4/21/92

(127)

1143 I CALLED JIM COLBERT AT THE EPA REGION III OFFICE. WE TALKED ABOUT THAT THEY DID NOT COVER THE CONCRETE FROM THE SHEDS WITH PLASTIC OUR WASH OFF THE SOIL FROM THE FOOTINGS. THEY ARE NOT TO STOCK PILE SOIL ANYMORE AND THE AREAS WHERE SOIL IS STOCK PILED AND THE CONCRETE IS SOIL WILL BE SAMPLED AFTER AMPLE SOIL HAS BEEN REMOVED. HE IS ALSO GOING TO TALK TO THEM ABOUT THE DRUMS INSIDE THEY WANT TO USE AS BACKFILL. I ALSO TOLD HIM THERE HAS NOT BEEN ANY TRUCKS COME THRU YET. JIM IS ALSO CONCERNED ABOUT WHEN THEY BEGIN REMOVING CONCRETE FROM THE TOXAPHENE PAD THEY WILL GET THE LOWER CONCRETE AREA CONTAMINATED. HE SAID MAKE SURE THEY CLEAN THE AREA

(128) Douglas E. Lade 4/21/92
UP WHEN THEY ARE DONE.
I TOLD HIM I ASKED IF
THEY MIGHT BE GOING TO
COVER THE THE CONCRETE
FROM THE SHED'S, THEY SAID
NO. THAT IT IS NOT CONTAMINATED
AND DOES NOT NEED TO BE
DONE. I DID NOT PRESS THE
ISSUE.

1220 I RETURNED TO SITE AND
TOLD WCC THAT WHAT JIM
AND I TALKED ABOUT WILL
BE COVERED IN THE CONFERENCE
CALL AT 1400.

1240 5 TRUCKS ARRIVED ON SITE
FROM KEWANNA, ILL; RATLIFF
BROS. & CO. TRUCKING COMPANY.

1305 I CALLED JIM COLBERT EPA-
WAM TO LET HIM NO THAT
THE FIRST ROUND OF TRUCKS
HAD ARRIVED ON SITE. HE
WAS NOT IN I LEFT A
MESSAGE ON HIS VOICEMAIL

1315 I RETURNED TO SITE
HERITAGE WAS ON SITE.

Douglas E. Lade

Douglas E. Lade 4/21/92 (129)
1330 THINGS ARE NOT CLEAR AS
TO WHAT IS GOING TO BE
LOADED FIRST AND WHEN.
1400 BEGAN LOADING SOIL THAT
HAS BEEN STOCK PILED.
MET WITH TIM LUTZ
FROM HERITAGE HE IS
A PROJECT MANAGER.

1427 BOBCAT WAS BEING USED TO
HELP DIG. HE WAS GETTING
INTO THE CONTAMINATED SOIL
I FELT WHEN HE LEAVES
THE AREA HE MITE CROSS
CONTAMINATE THE CLEAN
GROUND I DIRECTED MY
QUESTION TO BRETT HEAREN.
1430 SET UP TO LOAD TRUCK #2.

1437 TRUCK NO. 1 IS 4 TONS LITE.

1443 TRUCK NO. 1 LEFT TO VEIGHAGAN.

1444 BEGAN LOADING TRUCK NO. 2

1455 FINISHED LOADING STOCK PILE
FROM AREA A - 4 1/2 10d

1458 BEGAN LOADING SOIL - ~~10d~~ FROM 2d
1511 FINISHED LOADING AREA ~~10d~~ 2d
1515 BEGAN LOADING STOCK PILED WOOD.
Douglas E. Lade

(130) Douglas E. Lade 4/21/92
1552 LEFT TO GO THE BANK
AND ^{CALL} JIM COLBERT. HE
WAS NOT IN.
1615 I RETURNED TO SITE.
1624 MARK KEMNER TOLD ME
TO CALL JIM COLBERT.
1630 I CALLED JIM COLBERT.
HE TOLD THAT WCC WILL
TAKE SAMPLES FROM THE
STOCK PILE ~~D~~ AREAS AND
THAT THEY ~~WILL~~ MITE REUSE
THOSE SAME AREAS FOR MORE
STOCK PILING AT THE END
OF THE DAY IF TRUCKS ARE
COMING IN THE NEXT MORNING.
HE ALSO TOLD ME THAT WCC
AGREED TO WASH THE
CONCRETE FROM THE SHEDS THAT
HAS DIRT ON IT. THEY MITE TRY
AND WASH STAINED AREAS TO.
THE WATER DRUMS INSIDE
THE MAIN BUILDING FROM DRILLING
CAN BE USED IN CLEANING THE
ABOVE GROUND TANKS. EPA
HAS STILL NOT GIVEN AHEAD DEL

Douglas E. Lade

Douglas E. Lade 4/21/92 (131)
WCC THE OK TO USE THE
SOIL CUTTINGS FOR BACK FILL.
JIM ALSO SAID WHEN THE
TOXAPHENE PADS IS REMOVED
WCC WILL HAVE HERITAGE
TAKE AN EXTRA FOOT
BEYOND THE PAD BEFORE
SAMPLING.

1705 I RETURNED TO SITE.
HERITAGE WAS LOADING THEIR
5TH TRUCK WITH WOOD.
THERE WILL STILL BE WOOD
LEFT ON SITE. IT WILL
TAKE 2 TO 3 TRUCKS TO
GET RID OF THE WOOD.
1720 HERITAGE FINISHED LOADING
LAST TRUCK.
1745 I LEFT SITE FOR THE
DAY.

Douglas E. Lade

(132) Douglas E. Lade 4/22/92 WEDNESDAY

- 0659 I ARRIVED ON SITE WOOD HERITAGE WAS ON SITE. THERE WAS A TRUCK ON SITE WAITING TO BE LOADED. WEATHER: CURRENTLY 29° SUNNY SKIES. HIGH OF 46° CLEAR SKIES
- 0720 HERITAGE BEGAN LOADING WOOD INTO THE 6TH TRUCK - 1ST FOR TODAY.
- 0739 HERITAGE FINISHED LOADING SECOND PILE OF DEGREE AND THIAN BEGAN WORKING ON THE THIRD.
- 0750 BRETT HEADENKAMP AND MARK KEMNER SHOWED TIM LUTZ AROUND THE SITE.
- 0805 FINISHED LOADING THE 6TH TRUCK LOAD OF HAZ. MATERIAL TRIAD TRUCKING. ALL LOAD ARE GOING TO ADAMS CENTER IN INDIANA.
- 0855 4 MORE TRUCKS FROM TRIAD ARRIVED TO BE LOADED. HERITAGE IS GOING TO FINISH LOADING THE WOOD THEN

Douglas E. Lade 4/22/92 (133)

- BEGIN DIGGING THE CONTAMINATED AREA.
- 0700 2 MORE TRUCKS ARRIVED TO BE LOADED.
- 0720⁰⁷²⁰ BEGAN LOADING 7TH TRUCK #2 WITH WOOD.
- 0745 FINISHED LOADING WOOD.
- 0750 FUEL ARRIVED FOR TRACKHDE.
- 0751⁰⁸⁰⁰ TRAILER ARRIVED FOR DRUMS THAT ARE STORED OUTSIDE.
- 1025 HERITAGE BEGAN DIGGING AREA 10d WITH TRACKHDE. RUN OFF FROM THE BUILDING IS GOING INTO EXCAVATED AREA.
- 1049 STOPPED DIGGING IN AREA 10d BECAUSE OF RUN OFF HERITAGE IS MOVING OVER TO AREA 2 TO DIG. WATER HAD TO BE DRAINED OUT THE HOLE WHERE THE PLASTIC WAS IN AREA 2.
- 1105 BEGAN DIGGING AREA 2 WITH F. HOLE
- 1115 I LEFT SITE TO CALL MY OFFICE AND JIM COLBERT EPA - WANN. I FIRST CALLED GARY FELKNER IN MY

(134) Douglas E. Lade 4/22/92
OFFICE. I FILLED HIM
ON WHAT IS GOING AND
TO SEND ME ANOTHER
LOG BOOK.

1135

I TALKED TO JIM COLEBENT
I FILLED HIM IN ON WHAT
HAS BEEN HAPPENING.
I ASKED ABOUT THE TRUCK
ROUTE'S AND THE NEW
CONCRETE AREA WCC IS
GOING TO BREAK UP. BELOW
THE TOXAPHENE PAD. HE SAID
HE RAN ACCROSS SOME INFO
THAT THE AREA MITE BE
CONTAMINATED HE IS STILL
RUNNING DOWN LEADS ON IT.
WCC HAS DECIDED TO GO
AHEAD AND TAKE THE
CONCRETE OUT INSTEAD OF
SAMPLING AND WAITING FOR
RESULTS. IT WOULD BE SENT
TO A HAZDOUS WASTE
LANDFILL. HE NOTHING ELSE.
I TOLD HIM WE WILL BE
WORKING THROUGH THE

DR. M. S. L. 11

Douglas E. Lade 4/22/92 (135)
WEEKEND.

1205 I RETURNED TO SITE
THEY HAD JUST FINISHED
LOADING THEIR #11 TRUCK
AND WERE WORKING
ON THEIR 5 TH.

1300 HERITAGE FINISHED LOADING
NO. 5 AND WENT TO TAKE
LUNCH. I STAYED ON SITE.

1320 LYLE VANDER POL CAME TO
SEE BOB PATTON ABOUT
WHEN HE WANTS TO REMOVE
THE NON-HAZDOUS CONCRETE
I TOLD HIM HE SHOULD
BE BACK WITH IN 10 TO
20 MINUTES FROM LUNCH.

1340 HERITAGE RETURNED TO
SITE TO BEGIN LOADING
TRUCKS AGAIN. THEY ARE
STILL DIGGING IN AREA.

1355 HERITAGE BEGAN LOAD TRUCK
NO. 6 TRIAD TRUCK. TRIAD

1420 TRUCK 6 PULLED OFF TO WEIGH.

1421 TRUCK 7 PULLED IN TO BE LOADED.

1428 TRUCK 6 IS FULL.

(136) Douglas E. Lode 4/22/72

- 1429 TRUCK 7 BEGAN BEING LOADED
1448 TERRY MEASURED THE CONCRETE FOOTINGS FROM THE SHEDS. THEY WERE 38" IN HEIGHT WITH 12" INTO THE SOIL.
1450 TRUCK 7 PULLED OFF TO WEIGH AND TRUCK 8 PULLED IN TO BE LOADED.
1452 TRUCK 8 (FORT) BEGAN BEING LOADED.
1500 TRUCK 7 WAS FULL.
1508 TRUCK 8 PULLED OFF TO WEIGH
1510 TRUCK 9 PULLED ON TO BE LOADED. (LIBERTY)
1515 BEGAN LOADING TRUCK 9
1516 DUST READING AVE, 0.09
1518 TRUCK 8 ONLY HAD 63,000 HE WILL NEED A LITTLE MORE DIRT.
1532 TRUCK 9 PULLED OFF TO WEIGH.
1533 TRUCK 8 PULLED ON FOR MORE SOIL
1546 TRUCK 8 PULLED OFF TO WEIGH.
1547 TRUCK 9 PULLED ON TO GET MORE SOIL
1549 TRUCK 9 PULLED OFF TO WEIGH.

Douglas P. Zell

Douglas E. Lode 4/22/72 (137)

- 1550 TRUCK 10 PULLED ON TO BE LOADED.
1552 DUST READING AVE. 0.11
1555 TRUCK 8 WAS FULL,
1610 TRUCK 10 PULLED OFF TO WEIGH
1613 TRUCK 11 PULLED ON TO BE LOADED. (TRIAD)
1638 TRUCK 11 PULLED OFF TO WEIGH
1639 TRUCK 10 PULLED BACK ON TO HAVE SOIL TAKEN OUT.
1649 TRUCK 10 PULLED OFF TO WEIGH.
1650 TRUCK 11 PULLED BACK ON TO GET MORE SOIL.
1659 TRUCK 11 PULLED OFF TO WEIGH
1700 TRUCK 10 TO HAVE MORE SOIL TAKEN OUT.
1706 TRUCK 11 WAS FULL TRUCK 10 PULLED OFF TO WEIGH.
1709 TRUCK 11 WAS 1300 LBS OVER.
1712 TRUCK 11 PULLED OFF TO WEIGH.
1719 TRUCK 12 PULLED ON TO BE LOADED. TRUCK 10 & 11 WERE FULL. (TRIAD)
1735 TRUCK 12 PULLED OFF TO WEIGH.
1736 TRUCK 13 PULLED ON TO LOAD (TRIAD)

(138) Douglas E. Lade 4/22/92
1756 TRUCK 13 PULLED OFF TO BE WEIGHED.
1758 TRUCK 12 PULLED ON TO GET MORE SOIL.
1802 TRUCK 12 PULLED OFF TO WEIGH AGAIN.
1804 TERRY ANDREWS WCC BEGAN COLLECTING SOIL FROM AREA 2d. NORTHERN HALF.
1810 TRUCK 12 CAME BACK FOR MORE SOIL.
1812 LEFT TO WEIGH.
1816 TRUCK 13 PULLED ON FOR MORE SOIL.
1818 TRUCK 13 PULLED OFF TO WEIGH. TRUCK 12 IS FULL.
1820 TERRY FINISHED SAMPLING 2d NORTHERN AREA. 2d IN
1824 TRUCK 13 IS FULL.
1828 TERRY BEGAN COLLECTING SOIL FROM 2d S SOUTHERN.
1840 TERRY FINISHED SAMPLING 2d S
1842 WCC & HER. ARE TAKING MEASUREMENTS.
1854 HER. COVERED AREA 2d WITH PLASTIC
1915 LEFT SITE FOR THE DAY.

THURSDAY
Douglas E. Lade 4/23/92 (139)
0657 I ARRIVED ON SITE. WCC AND TWO TRUCKS WAITING TO BE LOADED WERE ON SITE. WEATHER: PARTLY CLOUDY 50% CHANCE OF RAIN TODAY.
0700 HERITAGE ARRIVED ON SITE.
0711 TRUCK 1 PULLED ON TO A LOAD. 0720 BEGAN LOADING TRUCK 1 LIBERTY
0733 T-HOE CUT A PHONE LINE.
0755 TRUCK 1 PULLED OFF TO WEIGH. TRUCK 2 PULLED IN TO BE LOADED
0820 PHONE COMPANY ARRIVED TO CHECK ON BREAK. BOB PATTON TOLD THEM THEY COULD NOT FIX IT UNTIL BOB TALKED TO THE STATE.
0822 ORANGE CITY NEWSPAPER PHOTOGRAPHER ARRIVED TO TAKE PHOTOS HER MOVED TO AREA 1
0825 I LEFT SITE TO CALL JIM COLBERT. HE TOLD ME HE HAS NO PROBLEM GOING IN THE ZONE SINCE THE WORKER WILL BE STANDING ON CLEAN SOIL AS LONG AS THERE IS PLASTIC
Final Report 1.11

(140) Douglas E. Lade 4/23/92
DOWN AND WORKER HAS
PPE ON.

0840 JIM CALLED BOB PATTON
ON WCC MOBILE PHONE
TO TELL HIM THE SAME.
JIM SAID THAT EPA IS
NOT GOING TO BELIEVE.

0845 BOB CALLED HIS OFFICE

0905 I TALKED TO BOB PATTON.
HE TOLD ME THEY ARE
GOING TO LET THEM IN
WEREING PPE AND SUPERVISED
HER. IS WORKING ON TRUCK 3

0935 TELEPHONE COMPANY ARRIVED TO
FIX BROKEN LINE

0940 TIM LUTZ ASKED ME IF
THEY COULD STOCK PILE
THE CONCRETE FOR INCINER-
ATION SO THAT THEY CAN
EXCAVATE IN THE TOXAPHENE
PAD AREA.

0955 TRUCK 4 IS BEING LOADED (FORT)

1003 TRUCK 4 WAS LOADED.

1009 TRUCK 4 PULLED IN TO BE LOADED
WITH MORE DIRT.

Douglas E. Lade

Douglas E. Lade 4/23/92

(141)

1012 TRUCK 5 PULLED IN TO LOAD ^{FORT}

1020 TRUCK 4 WAS FULL.

1030 TRUCK 5 PULLED OFF TO WEIGH.

1053 I LEFT SITE TO CALL JIM COLBERT

EPA - WAM. I TOLD HIM THAT
WCC 9 HER. ASKED IF THEY
COULD STOCK PILE THE INSINERATION
CONCRETE AND WHERE. HE SAID

YES ITS THE SAME AS THE SOIL
IT CAN BE STOCK PILED WHERE
SOIL IS TO BE EXCAVATED, PLACE
IT ON PLASTIC AND TAKE VERIFICATION
SAMPLES AFTER IT IS REMOVED

OR EMPTY THE SOIL DRUMS OUT
THAT OUR INSIDE THE BUILDING
AND USE THEM. THEY USE

THE AREAS WHERE SOIL WAS
STOCK PILED BECAUSE SAMPLES
ARE GOING TO BE TAKEN.

I ALSO ASKED ABOUT THE
LOWER CONCRETE AREA OF
THE TOXIPHENE PAD. HE SAID

HE STILL HASN'T HEARD ANYTHING
I WILL CALL LATER. WE ALSO
TALKED ABOUT THE LARGE

142

Douglas E. Lude 4/23/92
BLUE STORAGE TANK. HE
WANTS TO MAKE SURE
IT CLEANED WELL AND
THE SCRAP ITN'T SOLD TO
JEST ANYONE. I TOLD JIM
THAT THEY MITE START
CLEANING THE ABOVE
GROUND STORAGE TANKS
FRIDAY.

1130 I RETURNED TO SITE
AND FILLED IN WCC &
HER. ON EPA'S DECISION
AND THAT THERE IS NO
NEW ON THE LOWER TOXIPHENE
PAD.

1135 MARK KEMNER ASKED ME
TO CHECK TO SEE WHAT
THEY CAN DO WITH THE
DRUMED PURGE WATER. I
WROTE ON 4/21/92 THAT
THEY COULD USE IT FOR
RINSE WASHING THE TANKS
BUT I WANT TO ASK JIM
AGAIN TO MAKE SURE.

1220 I CALLED JIM COLBERT FROM
Dialer A-1.

143

Douglas E. Lude 4/23/92
WCC MOBILE PHONE. WCC AND
HER. BOTH ASKED IF THEY
COULD RAPT THE CONCRETE
FOR INSINATION IN TRIPLE
LAYLES OF PLASTIC AND
PLACE ON THE CONCRETE
TO THE WEST OF THE
TOXIPHENE PAD. JIM SAID
YES AND THEY HAVE TO SWEEP
THAT AREA AFTER THE
CONCRETE IS MOVED. HER
WANT TO KNOW CUT UP
THE LARGE BLUE TANK WITH
A TOUREH AFTER IT HAS BEEN
CLEAN AND MEETS THE
RIGHT O₂ LEL READINGS.
JIM WANTS WCC CLEAN
OFF THE AREA ~~IN FRONT~~ ^{DEL}
OF TOEL EAST OF THE
TOXIPHENE PAD BETTER
TO SEE IF THERE IS ANY
PATTERN OF 25 3/8" x 2" DEEP
HOLES.

1240 I LEFT SITE TO TAKE LUNCH
1311 I RETURNED TO SITE.

(144) Douglas E. Lade 4/23/92

- 1327 TRUCK 8 NEEDS MORE SOIL
1330 TRUCK 8 PULLED OFF TO WEIGH
1331 TRUCK 9 PULLED IN TO BE LOADED
1346 TRUCK 8 IS FULL
1354 TRUCK 9 WENT WEIGH TRUCK
10 PULLED IN TO BE LOADED
1404 TRUCK 10 PULLED IN FOR MORE SOIL
TRUCK 10 PULLED BACK IN.
1424 HER. FINISHED DIGGING SHED
AREA 1d.
1432 WAS SMELLING THE SOIL
FROM DOWN INSIDE THE
HAVE DEL EXCAVATED SHED
AREA. HE NOTICED A SMELL
OF PESTICIDES IN NORTHERN
AREA OF THE SHED EXCAVATION.
HE IS GOING TO CALL BOB
SKA ABOUT IT.
1437 HER. BEGAN DIGGING AREA
14d AND LOADED TRUCK 10
1515 TRUCK 10 PULLED OFF TO WEIGH
1518 TRUCK 11 PULLED IN TO BE LOADED
1525 TRUCK 10 WAS 13000 OVER.
1540 TRUCK 10 WENT TO WEIGH
1542 TRUCK 11 LOADED MORE SOIL IN.

Douglas E. Lade 4/23/92 (145)

- 1550 TRUCK 10 WAS STILL OVER.
1602 TRUCK 11 PULLED OFF TO WEIGH;
1607 TRUCK 12 PULLED IN TO BE LOADED
1630 TRUCK 12 PULLED OFF TO WEIGH.
I NOTICED A 2" WHITE PVC
PIPE GOING ACROSS
EXCAVATION AREA 14d.
1640 TRUCK 13 PULLED IN TO BE LOADED
1718 HER. FINISHED DIGGING AREA 14d.
1720 HER. MOVED TO DIG IN THE
SOUTH END OF 2d.
1735 MARK KEMNER AND I HAD
HER. USE THEIR BOBLAT
TO SCRAPE THE LOWER
AREA OF THE TOXIPHENE
PAD AND WE SWEEP & SCAPED
THE ARE TO TRY AND
FIND THE SAMPLE HOLES.
WE CLEANED OFF AN AREA
OF 11' X 20' ROUGHLY.
1800 STOPPED LOOKING FOR
SAMPLING HOLES.
1805 TRUCK 13 WAS FULL.
1806 TRUCK 14 PULLED IN TO LOAD.
1850 LEFT SITE FOR THE DAY.

(146)

0700

FRIDAY
Douglas Lade 4/24/92
I ARRIVED ON SITE. WCC
WAS ON SITE

0703

HERITAGE ARRIVED ON SITE
WEATHER OVERCAST
40'S CHANCE OF RAIN.

0722

THURSDAY AT 730 TERRY
ANDREWS COLLECTED SOIL
SAMPLES FROM 14c AND 14d
HER. VAC. TRUCK ARRIVED
ON SITE.

0725

I OBSERVED HER. DIGGING
IN AREA 2 & EAST SIDE.

0735

TRUCK 14 FROM THURSDAY
WENT TO WEIGH,

0750

I CALLED JIM COLBERT
EPA-WAM TO TALK ABOUT
SOME NEW ISSUES AND IF
HE HAS FOUND OUT ABOUT THE
CONCRETE AREA BELOW
THE TOXIPHENE PAD.
HE SAID YES THAT THE SAMPLE
WAS TAKEN FROM THAT AREA
BUT EXACTLY WHERE HE
DOESN'T KNOW. HE SAID
THAT IS UP TO WCC HOW

Douglas Lade 4/24/92

(147)

Douglas E Lade 4/24/92
THEY WANT TO HANDLE IT.
WCC IS GOING TO GET EPA'S
OK WHEN THEY DECIDED.
JIM FEELS THEY SHOULD
AT LEAST TAKE OUT WHAT
WOULD HAVE BEEN THE
LOADING AREA; I TOLD JIM
ABOUT THE OPER THAT IS
COMING FROM CERTAIN AREAS
WHERE THE SHEDS WERE.
ALSO THAT THE CONCRETE
FOUNDATION FROM THAT AREA
SMELLS TO. IT IS TO BE
WASHED THEN SENT TO A
SANITARY LANDFILL. I ALSO
FILLED IN JIM ABOUT HOW
WCC IS GOING TO HAVE HER.
TAKE THE WALL OUT FAR DEL
FOUNDATION OUT OF THE
TOXIPHENE PAD AREA. MARK
SAID IF THE WALL ON THE
EAST COMES DOWN ON IT
OWN THEY WILL TAKE OUT
ABOUT 1-2 FEET OF CONCRETE
BELOW THE PAD. IF THE

Douglas E Lade 4/24/92

148

Douglas E. Lake 4/29/92
WALL DOESNT COME DOWN
ON IT OWN THEY WILL TAKE
THE TOP TO DEC 1 FOOT OR SO,
SO THAT THE SOIL WONT
WASH OUT. THATS ALL FOR
NOW.

0820 I RETURNED TO SITE
WORKERS WERE PREPARING
TO TO MOVE THE INSULATION
CONCRETE FROM THE
TOXIPHENE PAD AREA AND
TRIPLE RAPIT JUST WEST
OF THE PAD.

0910 TRUCK WAS LOADED
0926 HER. WORKER CLEANED
TRACKHOE OF LOOSE AIRT.
OTHER HER. WORKERS OR
MOVING TOXIPHENE CONCRETE
ON TO TRIPLE LAYER PLASTIC.

1010 HERITAGE GOT READY TO
EXCAVATE TOXIPHENE PAD
AREA. BOB PATTON INFORMED
ME AND ~~BOB~~ WEL WEL
AND I ABOUT THAT THEY
WILL BE IN LEVEL C

Douglas E. Lake

149

Douglas E. Lake 4/24/92
WHEN WORKING IN THE
TOXIPHENE PAD AREA.
UNLESS WE ARE
UP WIND. WIND IS OUT
OF THE WEST.

1027 MARK KEMNER CALLED
JIM COLBERT EPA - WAM
ABOUT WHAT TO DO ABOUT
THE LOWER CONCRETE OF
THE TOX. PAD. JIM SAID
TO TAKE 10' OUT OF THE
CONCRETE LOADING AREA.

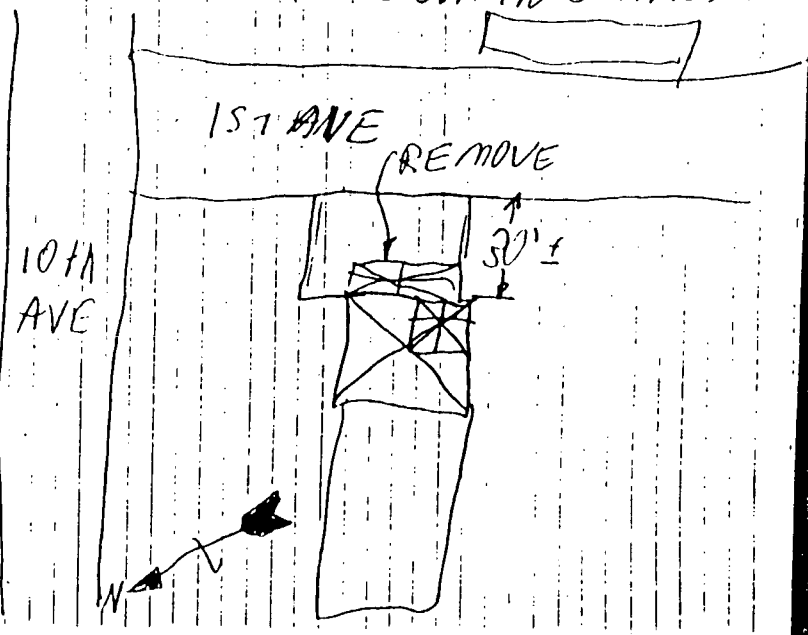

Douglas E. Lake

150

Douglas E. Lade 4/24/92
BOB PATTON ASKED ME
IF THE SOIL FROM UNDERNEATH
THE THE TOXIPHENE INSULATION
CONCRETE IS HIGH LEVEL
AND SHOULD BE ELIT 50 FOR
INSINATION OR MIXED WITH
THE OTHER SOIL. I DERECTED
HIM TO ASK WCC.

1100

HERITAGE HAS STOPPED WORK
ON THE TOXIPHENE PAD
BECAUSE THEY FEEL SINCE
THE LEVELS FROM THE
CONCRETE MITE BE THE
SAME OR THEN DEL HIGHER
THAN WHAT THE HAZDOUS
LAND FILL WILL EXCEPT.
THEY WONT START UNTIL
A SIGNED LIABILITY IS SIGNED
SAYING TO GO AHEAD AND
DIG.

1120

I OBSERVED TERRY
ANDREWS COLLECTING
SOIL SAMPLES FROM EAST
AREA 2d.

1135

I OBSERVED HER GETTING READY

Douglas E. Lade 4/24/92 (151)

TO CLEAN THE BLUE TANK.

1145

LEFT TO COLLECT FILL SAMPLES
IN ORANGE CITY AND HAYWARD.

1200

TERRY BROUGHT ME
BACK TO ALTON, IA I
DID NOT WANT TO BE GONE
FROM THE SITE TOO LONG.

1233

I CALLED JIM COLBERT
EPA-WAM ABOUT IS
GOING ON ON SITE AND IF
HE HAS ANY NEW NEWS.
I TOLD HIM ABOUT AND WHY
HER. STOPPED WORKING
ON THE TOXIPHENE PAD
AREA. JIM CONFIRMED WHAT
MARK KEMNER SAID ABOUT
TAKING THE TEN FEET
OF CONCRETE EAST OF
THE TOXIPHENE PAD AND
ALONG THE LENGTH OF THE
FOUNDATION WALL OUT.
JIM SAID HE WANTS A ^{SOIL} SAMPLE
FROM THE PAD AREA AND THE
10' LOADING AREA. A NEW
IS THAT HE WANT A

(152) Douglas E. Lade 4/24/92
CONCRETE SAMPLE OF
BOTH EAST & WEST
EDGES OF CONCRETE
AFTER HAZDOUS CONCRETE
IS REMOVED. JIM ALSO
TOLD ME THAT WCC IS
GOING TO MORE DIRT
TAKING OUT OF THE
SHED AREA WHERE THE
ODER CAME FROM AND
SAMPLE ALIQUATS WILL
BE TAKEN THERE
1250 I RETURNED TO SITE
HER. WORKERS WERE
COLD CUTTING THE
LARGE BLUE TANK.
1315 HERITAGE GOT SETUP TO
REMOVE DEBREE AND AND
SOIL FROM TOXIPHENE PAD
AREA NOT IN QUESTION.
1335 BEGAN LOADING TRUCK #2
1406 TERRY ANDREWS IS BACK FROM
SAMPLING FILL DIRT.
1412 TRUCK 2 PULLED OF TO WEIGH.
1424 TRUCK 2 PULLED BACK IN. HE IS

DIAGRAM TO 7. 10

Douglas E. Lade 4/24/92 (153)
HEAVY IN FRONT.
1436 TRUCK 2 LEFT TO WEIGH.
1445 I CALLED INTO THE
OFFICE TO TURN MY
TIME IN AND ORDER MORE
BOOT COVERS.
1516 I RETURNED TO SITE
TRUCK 3 WAS BEING WEIGHED.
1519 TRUCK 3 PULLED BACK FOR
1525 TRUCK 3 IS LOADED.
1550 TRUCK 4 PULLED INTO BELOADED
1100 HER STOPPED DIGGING
IN THE TOXIPHENE AREA AND
MOVED TO THE DEL THE SHED
AREA TO DIG UP THE
AREA'S THAT WERE MARKED
OUT FOR DEEPER EXCAVATION.
1712 HER BEGAN LOADING TRUCK 5
WITH SOIL FROM DEEPER EXCAVATION
IN THE NW CORNER OF THE
NORTH SHED AREA AND SW
END OF WHERE THE NORTH
SHED ~~WAS~~ WAS AND THE LARGE STORAGE
LIGHT POLE WAS PUSHED TANK
DOWN SO SOIL CAN BE

(154)

Douglas E. Lade 4/24/92
DUG UNDER IT. TERRY
ANDREWS WAS COLLECTING
SOIL FROM AREA 1.

1900

HER. TRAPPED THE 5TH
TRUCK.

1910

MCC, HER. & I LOOKED
OVER THE TOXIC HAZARD AREA.
THEY WANT ME TO ASK
JIM COLBERT EPA-WAM
SOME QUESTIONS ABOUT
THE AREA. THEY WANT TO
KNOW HOW HE WANTS IT
SLOPED, HOW MUCH OF THE
DRIVE PAD CONCRETE
REMOVED, AND THAT THEY
CAN'T TAKE ANY SOIL PAST
THE PAD ON THE SOUTH SIDE
BECAUSE OF UTILITIES AND ON
THE NORTH BECAUSE OF THE
WELL AND CONCRETE PADS
AROUND IT.

1935

I LEFT SITE FOR THE
DAY.

2210

I CALLED JIM COLBERT
EPA-WAM ABOUT THE JOB.

Douglas E. Lade 4/24/92 (155)

I FIRST ASKED HIM HOW MUCH
OF THE CONCRETE ON THE
DRIVE PAD DOES HE WANT
TO TAKE OUT. I EXPLAINED
THAT THE NORTHERN PART
IS SLOPED. HE TOLD ME TO
TAKE OUT TO THE DE 4 10' EAST
AND TO THE NORTH WHERE
IT BEGINS TO SLOPE. I
ALSO EXPLAINED THAT THE
DRIVE PAD DOESN'T GO ALL THE
WAY TO THE SOUTHEAST CORNER
OF THE FOUNDATION WALL THAT
THE GROUND SLOPES DOWN TO
THE CONCRETE FROM THE SOUTH.
HE SAID THAT HE WANTS
ONE OF THE SAMPLE ALIQUOTS
FROM THAT SOIL AREA CLOSE
TO THE WALL. HE ALSO SAID
HE WANTS CONCRETE SAMPLES
ON BOTH THE NORTH & EAST
EDGE OF THE CONCRETE
DRIVE AFTER IT IS REMOVED.
I NEXT ASKED ABOUT
HOW HE WANTS THE SOIL

156

Douglas E. Laid 4/24/92
 IN THE TOXIPHENE PAD
 AREA. HE SAID HAVE A
 FLAT AREA THEN GRADUAL
 SLOPE OR A LARGE FLAT
 AREA THEN A EXTREME
 SLOPE. I THEN ADDRESSED
 THAT HER. CANT TAKE
 SOIL BEYOND THE SOUTH
 WALL BECAUSE OF UTILITIES
 AND THE NORTH SIDE HAS
 A LOT OF CONCRETE AROUND
 IT AND THE MONITORING
 WELL CLOSE BY. HE SAID
 OK ABOUT NOT TAKING SOIL
 FROM THE SOUTH SIDE
 BECAUSE OF UTILITIES AND
 ABOUT THE NORTH SIDE
 TO GET WHAT SOIL THERE
 IS "X1". THERE WILL ALSO
 BE A CONCRETE SAMPLE
 TAKE FROM WEST EDGE OF
 OF TOXIPHENE PAD AREA.
 GOT OFF THE PHONE WITH
 JIM COLBERT.

2310

Douglas E. Laid

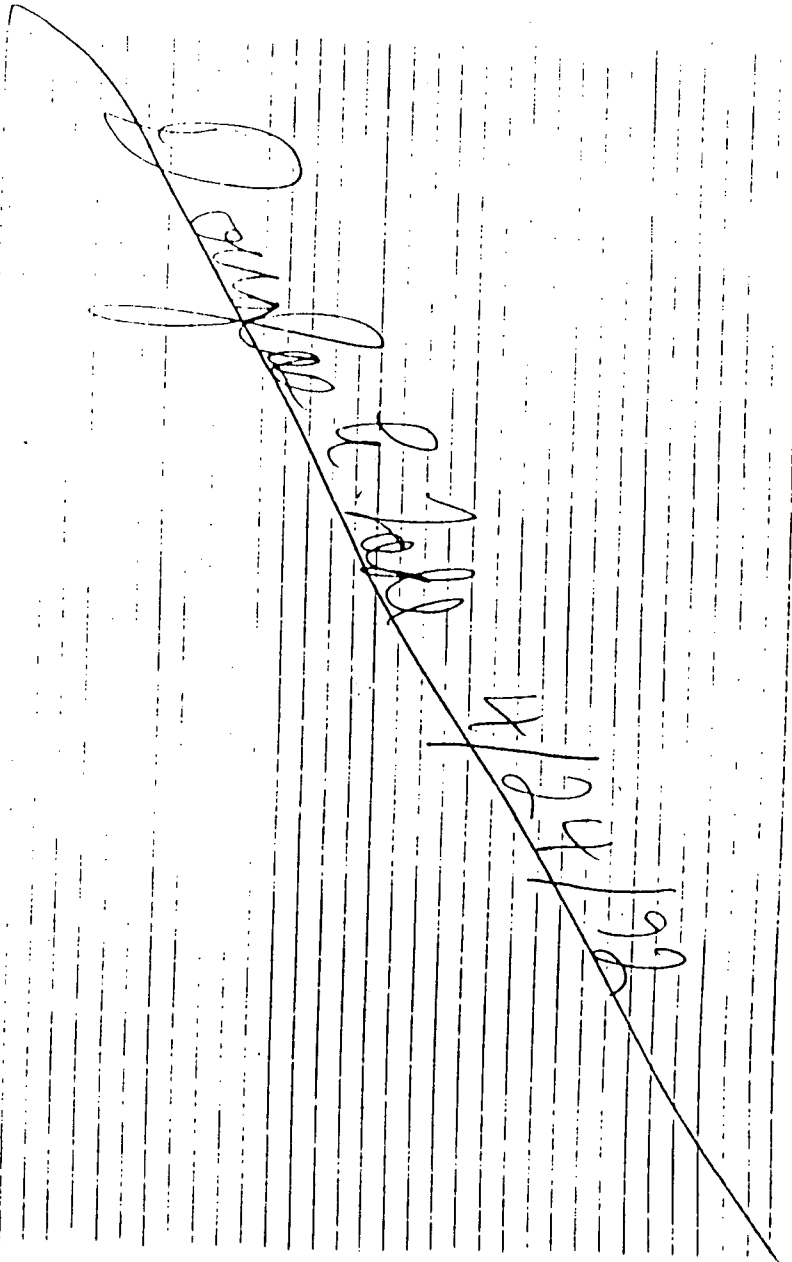

Interchem Site
Alton, IA



FIELD BOOK

FB 802

Book II

CONTENTS

PAGE NO.	REFERENCE	DATE
	INTERCHEM SITE	
	ALTON, IOWA	
	BYWST PN: 45566.100	
	PRC TES. WORK ASSIG. CO 70.71	
	EPA CONTRACT 68-W9-0006	
	(BYWST SUBCONTRACTOR TO PRC)	
	EPA-WAM: JAMES COLBERT	
	BYWST-PM: GARY FELKNER	
	PRP CONSULTANTS: WOODWARD-CLYDE	
	CONSULTANTS.	
	JIM COLBERT (913) 521-7489	
	HOME (816) 333-1034	

SATURDAY

Douglas E. Lade 4/25/92 (1)

0658 I ARRIVED ON SITE WCC AND HERITAGE IS ON SITE. WEATHER 35° HIGH'S IN THE 40'S CLOUDY SKIES.

0730 HER. BEGAN OPENING ABOVE GROUND STORAGE TANKS. SO THAT THEY CAN CLEAN THE TANKS.

0840 HER GOT SET UP TO PUMP OUT THE AGST.

0855 HER. BEGAN PUMPING OUT TANK #4.

0915 I CALLED JIM COLBERT EPA-WAM. HER. ASKED IF THEY COULD STOCK PILE ON THE LOWER DRIVE AREA EAST OF THE TOX. PAD SINCE IT IS GOING TO COME OUT ANYWAY, IT WILL BE ONLY OVERNIGHT, THERE WILL BE 6 TRUCKS IN AT 0700 MONDAY. I ALSO GAVE HIM THE DIMENSIONS OF THE AREA'S TO COME OUT. I TOLD HIM THERE IS 11 FEET FROM THE EDGE OF THE TOX. PAD TO

② Douglas E. Lade 4/25/92

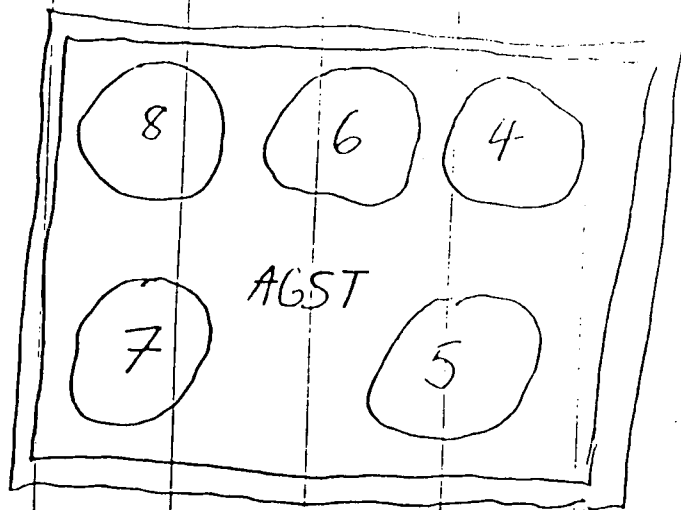

THE EDGE OF THE CONCRETE DRIVE THAT IS SLOPED SOIL. HE SAID JIM SAID NOW THAT HE WANTS TO TAKE OUT THAT AREA OUT FROM THE TOX. PAD CORNER OUT 10' EAST AND A 1' DEEP. HE ALSO WANTS SADEL 2 ALIQUANTS FROM THAT AREA FOR SOIL SAMPLES. I TOLD HIM THAT HER. IS CLEANING TANKS AND PERPARING TO LOAD DRUMS INTO TRAILLORS. HE

Douglas E. Lade 4/25/92 ③

SAID IT IS OK TO STOCK PILE SINCE IT IS ONLY OVER NIGHT.
0935 I RETURNED TO SITE AND FILLED BRETT HEADENKOP ON WHAT JIM WANTS. BRETT SAID OK BUT I NEED TO TALK TO HER
1000 I TOLD BOB PATTON & TIM LUTZ ABOUT WHAT JIM WANTS. THERE CONCERN IS THEY MITE NEED ANOTHER TRUCK.
1030 WORKERS BEGAN MOVING DRUMS INTO TRAILLERS,
1125 HER. FINISHED PUMPING PRODUCT OUT OF AGST.
1135 HER. SADEL BEGAN MOVING PURGE & DEVELOPMENT WATER DRUMS OUT TO TANK AREA.
5 - PURGE PW 1 - DEVELOPMENT DW, 15 - AUGER CUTTINGS AC, 7 - SOLID WASTE SW
1145 BRETT SAID THAT THE HER. WORKERS SAID THE

④ Douglas E. Lade 4/25/92
STILL IN THE BOTTOM
OF THE TANKS.

1154 HER. FINISHED LOADING
THEIR FIRST TRAILOR
WITH DRUMS FOR INSINER-
ATION.

1200 WENT TO LUNCH.

1235 I RETURNED TO SITE
FROM LUNCH. HER. WORKERS
PREPARED TO CLEAN AGST'S
USING PURGE + DEVELOPEMENT
WATER.

1250 OTHER HER. WORKERS
ARE CHANGING TRAILORS
SO THET CAN LOAD
MORE DRUMS IN EMPTY ONES.

1300 BEGAN LOADING DRUMS
INTO TRAILOR.

1400 TANK # 8 IS CLEANED OUT.
HER. IS WORKING ON
CLEANING TANK 7

1405 TANK # 7 HAS BEEN CHECKED
AND IS CLEAN.

1410 HER. BEGAN CLEANING
TANK # 6

Douglas E. Lade 4/25/92 ⑤
1420 HER. FINISHED CLEANING TANK # 6

1425 I OBSERVED BRET HEADENKAMP
WITH HER. WORKER TAKING
READINGS OF TANK # 6 FROM
2-MAN LIFT. HE IS AGAIN NOT
DRESSED IN PPE AND NO
SAFETY HARNES

1429 TANK # 6 PASSED IT IS CLEAN.
HER. GOT ALL THE DRUMS THEY
COULD GET LOADED ON THE SECOND
TRUCK THEY RAN OUT OF LABELS
FOR THE REST OF DRUMS. THEY
ARE GOING TO GET MORE LABELS
TO FINISH NEXT WEEK.

1455 HER. WAS CLEANING TANK # 4
1520 TANK # 4 HAS PASSED METERING
AND IS CLEAN. HER. IS TO
USE A WELDON PUMP TO
PUMP OUT THE TOXIPHENE
TANK # 5 THEN DRUM
THE WATER.

1525 HER. BEGAN PUMPING PRODUCT
OUT OF TANK # 5.

1540 BEGAN CLEANING TANK # 5.

⑥ Douglas E. Lade 4/25/92

TANK	LELO	JOEL	LOEL
4	0%	20%	
5	0%	20%	
6	0%	20%	
7	5%	20%	
8	10%	20%	

TWO 55 GAL DRUMS OF PRODUCT WERE PUMPED OUT OF TANK #5. 55 GALS OF PURGE WATER WAS PUMPED THROUGH EACH TANK. ALL TANKS ARE CLEAN. 1 DRUM OF WASH WATER. I LEFT SITE FOR THE DAY.

16 30

Douglas E. Lade

Douglas E. Lade ^{SUNDAY} 4/26/92 ⑦

0700 I ARRIVED ON SITE. HERITAGE WAS ON SITE BUT NOT WCL. WEATHER: 50'S SUNNY 10-20 MPH WINDS.

0715 WCC BRETT HEADENKAMP ARRIVED ON SITE. HER. GOT SET UP TO BREAK UP INSINERATION CONCRETE AND STOCK PILING OF TOX. PAD CONCRETE & SOIL ON DRIVE PAD FOR MONDAYS TRUCK.

0730 HER. BEGAN BREAKING UP INSINERATION CONCRETE INTO 3" X 3" PEACES.

0800 HER. BEGAN HOE RAVING TOX. DRIVE PAD AREA TO BE REMOVED.

0830 HER. GOT READY TO MOVE AND STOCK PILE REMAINING TOX. PAD DOWN TO DRIVE PAD AREA.

0855 HER. BEGAN MOVING DEBRIS^{DEC} CONCRETE & SOIL IN TOX. PAD AREA. THE VACCUUM TRUCK FOR HER. LEFT SITE FOR CHICAGO ILL.

1025 HER. ROBE...
1030 HER. ROBE...

⑧ Douglas E. Lade 4/26/92
WALL.

1140 I TALKED TO WCC AND HERITAGE ABOUT WASHING THE NON-HAZDOUS CONCRETE. THE WATER FROM WASHING THE CONCRETE WILL BE DRUMED UP. HERITAGE WANTS TO KNOW IF THE HAS TO BE SAMPLED AND IS GOING TO BE DONE WITH THE DRUMS IF ~~FOR~~ THE WATER ISN'T SAMPLED. I WILL NEED TO TALK TO JIM COLBERT ABOUT THE DRUM SAMPLING. IF WATER COMES BACK HAZDOUS CONCRETE WILL HAVE TO BE SHIPPED TO A HAZDOUS WASTE LANDFILL. IF SAMPLED CONCRETE CAN NOT LEAVE SITE UNTIL RESULTS ARE BACK.

1405 I LEFT SITE FOR THE DAY

1715 I

1435 I CALLED JIM COLBERT

Douglas E. Lade 4/26/92 ⑨

TO ASK HIM SOME QUESTIONS HERITAGE AND WCC HAVE RAISED. HE WAS NOT AT HOME AT THIS TIME, I LEFT A MESSAGE FOR HIM TO CALL ME BACK.

1715 JIM COLBERT RETURNED MY CALL. HERITAGE AND WCC ASKED ME IF THERE WILL BE A NEED FOR A SAMPLE OF THE WATER GENERATED FROM CLEANING THE NONE HAZDOUS CONCRETE. JIM SAID YES THAT THEY NEED TO RUN A WASTE CHARACTERIZATION PROFILE RUN ON THE WATER BEFORE IT IS TAKEN OFF SITE. HE SAYS IT CAN NOT BE DUMPED ON SITE AND HE DOUBTS ANYONE WILL TAKE IT WITH OUT THE ANALYTICAL RESULTS. JIM ASKED IF THE TANKS WERE CLEANED. I SAID YES AND THAT THE VAC TRUCK LEFT SITE TODAY. HE ALSO ASKED IF THE WCC TOOK CG READINGS

(10)

Douglas E. Lade 4/26/92
 ON THE TANKS BEFORE
 AND AFTER THE CLEANING
 OF THE TANKS. I SAID
 THEY TOOK READINGS
 AFTER THE CLEANING
 ABOUT 10 TO 15 MINUTES
 AFTER CLEANING. JIM
 SAYS IF THEY TOOK READINGS
 BEFORE CLEANING AND
 THEY ~~OK~~ ^{OK} ~~DEL~~ ^{DEL} THEY WERE
 OK ^{OTHER} NO READINGS ARE
 NEEDED BUT IF WCC
 DID NOT TAKE READINGS
 BEFORE THAT ~~DEL~~ THE
 CLEANING THEN THERE
 SHOULD BE ANOTHER
 ROUND OF READINGS TO
 CONFIRM THAT THE TANKS
 ARE SAFE FROM CHANCE
 OF EXPULSION. I ALSO
 TOLD JIM THAT THERE
 WILL BE 7 TRUCKS ON
 SITE MONDAY TO TAKE
 AWAY THE REST OF THE
 HAZDOUS SOIL AND CONCRETE.

10 2114 20 to 1. 2. 2.

(11)

Douglas E. Lade 4/26/92
 1755 I GOT OFF THE PHONE
 WITH JIM.
 1850 I INFORMED WCC OF WHAT
 JIM COLBERT HAD TOLD ME.

Handwritten signature and date:
 Doug E. Lade
 4/26/92

(12) Douglas E. Lade 4/27/92 MONDAY

- 0700 I ARRIVED ON SITE. WCC AND HERITAGE WAS ON SITE. WEATHER: 33°F HIGH OF 63 SUNNY WIND 10-20 MPH.
- 0715 HER. GET READY TO LOAD SOIL AND CONCRETE FROM THE TOX. PAD AND DRIVE PAD AREAS.
- 0733 BRET HEADENKAMP BEGAN SETTING OUT AIR PUMPS FOR 8 HOURS OF SAMPLING.
- 0822 HER. BEGAN LOADING TRUCK #1 FROM FORT ^{PT} LIBERTY.
- 0830 I TOLD HER. & WCC THAT PLASTIC NEEDS TO BE PUT DOWN BETWEEN THE TRUCK AND THE EXCAVATION AREA.
- 0844 HER. PUT PLASTIC DOWN ^{TRUCK} ~~TRUCK~~ BETWEEN THE TRUCK AND EXCAVATION AREA.
- 0851 TRUCK #1 WENT TO WEIGH.
- 0900 TRUCK #1 IS FULL.
- 0901 TRUCK #2 PULLED IN TO LOAD.
- 0920 TRUCK #3 PULLED IN TO LOAD

Douglas E. Lade

Douglas E. Lade 4/27/92 (13)

- AND #2 PULLED OUT TO WEIGH.
- 0922 BRET H. TOLD ME HE WAS GOING TO TAKE ANOTHER ROUND OF CG READINGS FROM THE AGST'S.
- 0942 TRUCK #2 NEEDED MORE SOIL AND CC HE WAS 15,000 LITE.
- 0943 TRUCK #3 PULLED BACK IN FOR MORE SOIL & CC.
- 0953 BRET H. FINISHED TAKING CG READINGS OF AGST'S HE SAID READINGS WERE ALL WITH IN THE LIMITS. HE HAS TO AIR SAMPLING PUMP READING (CALIBRATION) THEN HE WILL GIVE ME ALL THE AGST'S READINGS.
- 1000 TRUCK #3 WENT TO WEIGH.
- 1008 TRUCK #4 PULLED IN TO LOAD. TRUCK #3 WAS ^{DEL} FULL.
- 1032 TRUCK #4 PULLED OFF TO WEIGH.
- 1040 TRUCK #5 PULLED IN TO BE LOADED.
- 1124 TRUCK #5 PULLED OFF TO WEIGH.
- 1126 TRUCK #6 PULLED IN TO LOAD.
- 1153 LEFT SITE TO CALL JIM COLBERT

(14) Douglas E. Lode 4/27/92
ABOUT WHAT HAS BEEN
GOING ON ARDEL ON SITE.
1218 I RETURNED TO SITE
HER. STOPPED FOR LUNCH.
JIM COLBERT TOLD ME
THAT WCC CALLED HIM
THIS MORNING ABOUT
THE SAMPLING OF DRUMMED
WATER FROM THE CONCRETE
WASHING. JIM TOLD
WCC THAT THE WATER
NEEDS TO BE DEPOSED
OF PROPERLY, MEANING
THAT IT DOESNT GET
DUMPED ON THE GROUND
OR SENT TO A LANDFILL
WITH RUNNING ANALYTICALS
ON THE WATER. I TOLD
JIM THEY ARE ALMOST
DONE EXCAVATING IN
THE TOX. PAD & DRIVE
PAD AREA.

1225 I TALKED TO BRETT
OF WCC. HE TOLD ME
THAT I WILL BE THE

Douglas E. Lode 4/27/92 (15)
ONE TO GIVE THE LAST
OK ON WHETHER THE
CONCRETE IS CLEAN OR NOT.
THAT DIRECTION CAME
FROM HIS OFFICE KANSAS
CITY. HE ALSO FEELS
THERE WONT BE VERY
MUCH WATER CREATED
FROM THE CLEANING OF
THE CONCRETE. BUT THAT
THE WATER AND SOLIDS
WILL GO IN INSINARATION DRUMS
AND BE SENT WITH HER.
FOPEL TO BE INSINARATED
IF THEY WILL DO THAT.
1300 I TRIED TO CALL JIM COLBERT
HE WAS NOT IN.
1315 HER. BEGAN LOADING TRASH
PLASTIC AND SOIL INTO TRUCK
#6.
1322 I LOOKED AT THE TOX. PAD
AREA TO SEE IF ANYMORE
NEEDS TO BE DONE WITH
IT. THERE IS STILL SOME
PEACES OF CONCRETE

(16) Douglas E. Lade 4/27/92

- NEEDS TO BE LOADED.
- 1335 JIM COLBERT CALLED ME BACK. I EXPLAINED TO JIM WHAT STADEL WCC WANTS ME TO GIVE THE OK FOR DEL AS TO WHAT IS CLEAN AND WHAT ISNT. JIM SAID OK BUT THAT I SHOULD DIRECT BRET HEADENKAMP NOT HER. HE ALSO SAID MAKE SURE WATER AND PLASTIC IS DISPOSED OF PROPERLY.
- 1354 HER. PICKED UP THE LAST OF THE PEACES OF CONCRETE OUT OF THE TOX. PAD AREA.
- 1405 TRUCK #6 IS LOADED.
- 1410 BRET BEGAN COLLECTING SOIL FROM TOX. PAD AREA. TFS-1 SAMPLE NO.
- 1420 BRET FINISHED SAMPLING TFS-1
- 1428 BRET BEGAN COLLECTING TFS-2
- EDWARD P. P. -

Douglas E. Lade 4/27/92 (17)

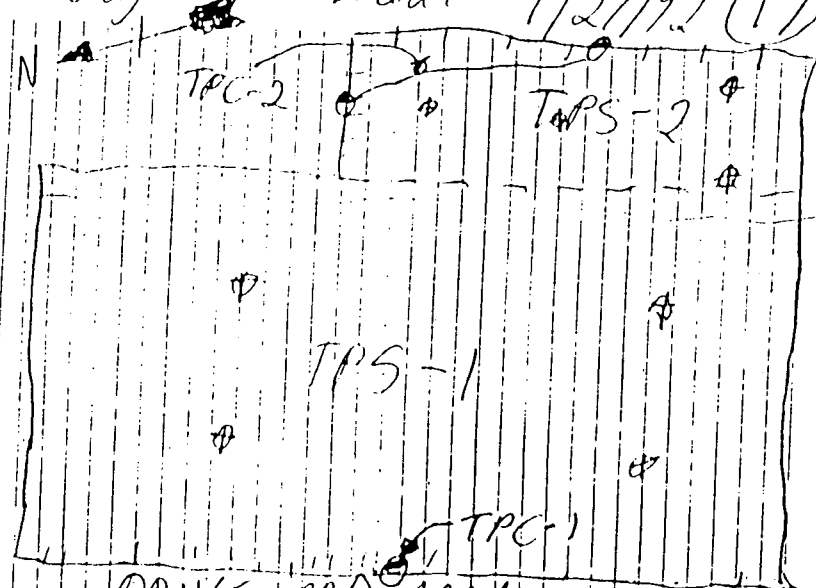

- DRIVE PAD AREA.
- 1438 ASKED ME TO SEE WHAT HER. IS DOING ON THE NORTH END OF THE SITE. WE DEL THERE NEEDS TO BE SOME MORE CONCRETE REMOVED.
- 1440 I ASKED BOB PATTON TO COME AND LOOK AT TOX. AREA HE AGREED AND SENT HIS OPERATOR DOWN TO DIG CONCRETE AND LOAD IT.
- 1449 BRET BEGAN SAMPLING TPC-2 COMPOSITE CC AND OPERATOR WAS 1 RADIM

(18) Douglas E. Lade 4/27/92
CONCRETE INTO TRUCK
#7

1455 OPERATOR FINISHED LOADING
CONCRETE INTO TRUCK #7.

1507 BRET FINISHED SAMPLING
TPC-2

1513 BRET H. BEGAN COLLECTING
TPC-1 COMPOSITE.

BRET COLLECTED CONCRETE
INTO A S.S. BOWL CHIPPED
FROM ALONG THE EDGES
THEN COMPOSITED AND
PUT INTO A SAMPLE
MASON JAR BY HAND.

A PPE ATIRER WAS WORN.

1520 I OBSERVED HER. LOADING
SOLID WASTE DRUMS
INTO BRONTEND LOADER
THEN INTO TRUCK #7.

1535 FEDEX ARRIVED TO PICK
UP SOIL AND CONCRETE
SAMPLES.

1543 TRUCK #7 WAS LOADED
AND HEADED TO WEIGH

1550 TRUCK #7 LEFT SITE

Douglas E. Lade 4/27/92 (19)

AND IS THE LAST TRUCK.

1620 HER. BEGAN CLEANING UP
AND COVERING UP TOX. PAP AREA.

1630 BRET PULLED HIS AIR SAMPLING
PUMPS.

1645 HER. LEFT SITE FOR
THE DAY.

1715 BRET H. I WENT OVER
WHAT WENT ON TODAY

TANK	O ₂	LEL
4	21%	1%
5	23%	0
6	22%	2%
7	20%	2%
8	22%	3%

1755 ABOVE IS READINGS FOR EG
OF THE AGST'S.

1800 LEFT SITE FOR THE DAY.

~~Douglas E. Lade~~

TUESDAY
②① Douglas E. Lade 4/28/92

0700 I ARRIVED AT THE
INTERCHEM SITE.
WCC WAS ON SITE
WEATHER: 40° HIGH NEAR
70, CHANCE OF RAIN
THIS AFTERNOON.

0705 HERITAGE ARRIVED ON
SITE.

0715 I CALLED FEDERAL EXPRESS
FOR A PICK UP.

0725 I RETURNED TO SITE, HER.
WAS BREAKING UP INSULATION
CONCRETE.

0740 BOB PATTON LEFT SITE
WITH AIR COMPRESSOR
IN TOW.

0800 BOB RETURNED WITH
COMPRESSOR.

0815 BRET HEADENKAMP ^{MET} LEFT ²⁵
WITH A BANK OFFICER FROM
THE ALTON BANK TO
LOOK AT SOME DRUMS THAT
MITE HAVE BEEN DUMPED
SOUTH OF TOWN.

0838 THE BANK OFFICER LEFT.

Douglas E. Lade

Douglas E. Lade 4/28/92 ②①

1012 I LEFT SITE TO CALL JIM
COLBERT. WCC ASKED ME
TO ASK JIM IF EPA WOULD
GIVE ME THE CONSENT TO
SAY THAT THE CONCRETE
CAN BE SHIPPED OFF SITE.
JIM SAID NO THAT I CAN
ONLY SAY WHAT IS CLEAN
OF DUST AND DIRT AND
WHAT NEEDS TO BE
CLEANED. IT IS IN WCC
CONTRACT WITH HERITAGE
WCC THAT STATES WHEN
IT IS CLEANED IT CAN
BE SENT OFF SITE TO A
SANITARY LANDFILL. IF
HERITAGE HAS A PROBLEM
WITH THAT THAT WCC HAS
TO RESOLVE IT ON THEIR OWN.
EPA CAN NOT GET INVOLVED.
I ALSO FILLED IN JIM ABOUT
WHAT HAS BEEN GOING ON
ON SITE AND THAT BRET H.
(WCC) COLLECTED THE
LAST SOIL & CONCRETE

Douglas E. Lade

(22) Douglas E. Lade 4/28/92
SAMPLES YESTERDAY

1105 BRET H. (WCC) TOOK
DUST READINGS AROUND
CONCRETE BREAKING AREA
0.37 WAS THE HIGHEST
READING.

1125 STOPPED FOR LUNCH.

1205 I RETURNED TO SITE.
HERITAGE WAS PICK UP
THE LAST BIT OF INSULATION
CONCRETE AND PLASTIC. THE
IS BEING SWEEPED OF CONCRETE
PEACES.

1230 WCC & HER WENT TO DUMP
SOIL FROM AC DRUMS
SO THEY CAN PUT
CONCRETE IN THEM.

1248 THEY RETURNED TO
TOX. PAD AREA.

1310 HERITAGE FINISHED BREAKING
AND PICKING UP CONCRETE.

1340 WATER WAS TURNED ON
IN THE MAIN BLDG.

1355 LEFT TO CALL JIM COLBERT

1410 I RETURN TO SITE &
D. M. M. P. 7.10

Douglas E. Lade 4/28/92 (23)

COULD NOT GET HOLD OF
JIM COLBERT I LEFT WORD
FOR HIM TO GIVE ME A
CALL ON WCC MOBILE
PHONE. HERITAGE'S OPERATOR
IS BREAKING UP THE NON
HAZARDOUS CONCRETE.

1450 HER. BEGAN DEL. ASKED ME
TO TELL THEM WHAT
IS CLEAN AND WHAT ISN'T
THEY WERE HANDLING IT BY HAND.

1500 I CALLED JIM COLBERT
ABOUT HOW SHOULD I
REALLY HAVE HERITAGE
DO THIS. HE SAID TO
SCOOP A LOAD INTO THE
FRONT END LOADER SPRAY
THE CONCRETE OFF
WITH A STEAM CLEANER
THEN PUMP UP THE WATER
WITH A DRUM VAC THEN
MOVE THE LOAD OVER TO
ANOTHER AREA. GARY FELKNER

1520 I CALLED RAY HERZOG
IN MY OFFICE BUT HE

(24)

Douglas E. Lude 4/28/92
WAS NOT IN^{SO} I ASKED
TO TALK TO RAY HERZOG
I FILLED HIM ON WHAT
IS GOING ON AND^{DEL} ABOUT
CONCRETE FOOTINGS TO
TO BE WASHED CLEAN
OF DIRT DIRECTED TO
WCC BY EPA. HE ASKED
IF THE CONCRETE AND
SOIL HAD BEEN SAMPLED.
I TOLD ONLY ONE AREA
OF SOIL UNDER THE SHEETS
WAS SAMPLED BUT NOT
THE CONCRETE. RAY
FELT THAT THE CONCRETE
SHOULD BE SAMPLED TO
~~CONFIRMED THAT~~ IF
THE CONCRETE IS CLEAN
OR NOT. I TOLD HIM THAT
IS NOT THE MAIN CONCERN.
THE MAIN CONCERN IS EPA
TO MAKE SURE ALL DUST &
DIRT IS REMOVED FROM
THE CONCRETE THAT WCC
HAS GIVEN EPA A NOUGH

Douglas E. Lude

Douglas E. Lude 4/28/92 (25)

REASON TO BELIEVE THAT
THE CONCRETE IS NOT
HAZARDOUS. HE SAID YOU DON'T
KNOW WITHOUT SAMPLING
THE CONCRETE. I SAID I
KNOW BUT WHAT ABOUT
THE CLEANING THE SOIL
WITH WATER. HE SAID IT
CAN BE DONE IT IS JUST
GOING TO TAKE SOME TIME,
BUT THE CONCRETE
SHOULD REALLY BE SAMPLED.
1535 I TALKED TO BOB PATTON
ABOUT THE METHOD
J.C. TOLD ME ABOUT. HE
INSTRUCTED HIS OPERATOR
TO PICK UP A LOAD IN HIS
FRONT BUCKET TO SEE
WHAT IT WOULD LOOK LIKE.
IT LOOKED AS THOUGH ALL
THE PEICES WOULD NOT
GET CLEANED BY THE WATER.
~~AT ALL~~ THAT IT WOULD BE
HARD TO GET THE SUCTION
HOSE DOWN INTO THE

(26) Douglas E. Lade 4/28/92
BUCKET TO GET ALL
THE WATER. AND THAT
WHEN YOU DUMP THE
BUCKET LOADS ON TOP
OF EACH OTHER THAT
MUD WOULD FALL BACK
ONTO THE CLEAN CONCRETE
1550 BP MADE A PHONE TO
HIS OFFICE IN CHICAGO
1600 BP, WCC, AND I DECIDED
TO STOP FOR THE DAY
AND THERE NEEDS TO
BE MORE THOUGHT TO
THIS. BRETT AND I
CONTINUED TALKING
ABOUT THE ISSUE.
1630 MARK KEMNER WCC
CALLED BRET H.
BRET FILLED MARK
ON WHAT HAS BEEN
GOING ON. MARK ASKED
TO TALK TO ME. HE
ASKED ME TO TALK TO
J.C. ABOUT SEEING IF
IT IS OK TO USE
Douglas E. Lade

Douglas E. Lade 4/28/92 (27)
BRUSHES TO CLEAN
THE CONCRETE OR COME
UP WITH A BETTER
WAY WITH USING WATER.
I SAID I WOULD TRY.
1705 I LEFT SITE FOR
THE DAY
1800 I CALLED JIM COLBERT
TO TALK ABOUT ANOTHER
WAY TO CLEAN THE
CONCRETE. HE WAS NOT
HOME I ASKED HIS WIFE
TO GIVE ME A CALL.
2015 JIM COLBERT CALLED ME
BACK. I TOLD HIM ABOUT
THE PROBLEM THEIR MITE
BE WITH USING WATER TO
WASH THE CONCRETE. I
MENTIONED TRYING TO
USE BRUSHES TO CLEAN
THE CONCRETE. I TOLD
HIM WE HAVEN'T TRIED
THE WATER YET. HE
SAID IF THE BRUSHES
WILL GET IT CLEAN
Douglas E. Lade

(28)

Douglas E. Lade 4/28/92
THAT'S FINE IF WATER
WORKS THAT'S FINE.
HE ALSO SAID IF IT CANT
BE CLEAN MAYBE IT
SHOULD GO AS HAZDOUS.
HE SAID TO USE MY BEST
JUDGEMENT ON HOW CLEAN
THE CONCRETE IS.

Douglas E. Lade

WEDNESDAY

Douglas E. Lade 4/28/92 (29)

0652 I ARRIVED ON SITE AT INTER-
CHEM. WCC & HERITAGE IS NOT
ON SITE YET WEATHER: ~~FOG~~
CURRENTLY IN THE 50'S HIGH
IN THE 70'S SUNNY SKIES
0700 HERITAGE ARRIVED ON SITE
0707 BRET HEADENKAMP (WCC)
ARRIVED ON SITE.
0710 BRET H. BOB P. AND MYSELF
HAD A CONVERSATION ABOUT
THE CLEANING OF THE
CONCRETE. I SAID THAT JIM
COLBERT SAID IF YOU CAN
GET IT CLEAN BY BRUSHING
IT THEN DO IT. IF IT TAKES
WATER USE WATER. HE
LAST SAID IF IT CANT BE
CLEANED OF DUST & ~~DIRT~~
DIRT IT WILL PROBABLY
GO AS HAZDOUS.
0718 HERITAGE WORKERS BEGAN
DUMPING AUGER CUTTING
DRUMS INTO THE FRONT
END LOADER THEN WILL BE
STOCK PILED NEAR AREA 2d

(30) Douglas E. Lade 4/29/92
FOLL BACKFILL WHEN
ANALITICAL COMES
BACK CLEAN FROM
THE LAB.

0749 HER. FINISHED DUMPING
A.C. DRUMS IN TO F.E.L.
0752 BEGAN BREAKING, CLEANING,
AND MOVING CONCRETE.
WITH HOE RAM HER.
WORKERS & F.E.L.
MYSELF & WCC IS
SUSPOSED TO INSPEC
THE CONCRETE FOR
CLEANNESS.

0830 BRET H. MADE A
PHONE CALL TO HIS
OFFICE.

0900 BRET RETURNED TO
HELP INSPEC.

1000 BRET CALLED HIS
OFFICE AGAN.

1120 LEFT SITE TO TAKE
LUNCH.

1200 RETURNED TO SITE

1202 LEFT SITE TO CALL JIM

DANA L. P. 1110

Douglas E. Lade 4/29/92 (31)
COLBERT TO FILL HIM IN
ON WHAT HAS BEEN GOING ON.
I TOLD JIM THAT BRUCE DEL
BRUSHING THE DIRT OFF
IS WORKING AND THAT
HER. HAS MOVED ABOUT
HALF THE PILE ALREADY.
THERE IS NO NEWS ABOUT
THE VERIFICATION SAMPLES
YET.

1218 I RETURNED TO SITE
HERITAGE'S OPERATER
WAS HOE RAMMING CONCRETE
SO CONCRETE CAN BE LOADED
INTO THE F.E.L.

1635 STOPPED WORK FOR THE
DAY.

1640 I CALLED ~~MY~~ GARY
FELKNER IN MY OFFICE TO
TELL HIM WHAT THE SCHEDULE
IS.

1650 I LEFT SITE FOR
THE DAY.

Douglas E. Lade

(32) THURSDAY
Douglas E. Lode 4/30/92

0700 I ARRIVED ON SITE. WCC AND HERITAGE WERE ON SITE.
WEATHER: 50° HIGH 92°,
5-10 MPH WIND, 30% CHANCE
OF RAIN.

0715 HERITAGE BEGAN BREAKING
ROCK WITH THE HOE RAN
AND MOVING IT WITH THE
F.E.L.

0725 TWO DUMP TRUCKS FROM
RUSSELLS READY MIX ARRIVED
TO BE LOADED WITH CLEAN
CONCRETE.

0745 HER. OPERATOR BEGAN LOADING
DUMP TRUCKS. OTHER HER
WORKER CLEANED AND
LOAD CONCRETE TO BE
LOADED.

0750 I WAS ~~TOLD~~ ^{DEL} TALKING
TO HERITAGE AND WCC ABOUT
THE CONCRETE CLEANING
AND REMOVAL. TIM LUTZ
SUGGESTED USING ONE
OF THE HAZDOUS WASTE
TRUCKS FOR FILLING WITH

Douglas E. Lode

Douglas E. Lode 4/30/92 (33)

THE REMAINING PLASTIC,
TRASH, AND CONCRETE
PEICES THAT IS LEFT BY DEL
AFTER ALL LARGE CONCRETE
FOOTING PEICES ARE CLEANED
AND REMOVED. HE ALSO SAID
A LAYER OF DIRT WILL
PROBELY COME UP WITH
THE CONCRETE CHIPS, BRUSHES
OFF DIRT, AND PLASTIC FROM
THAT STOCK PILE AREA. I
WILL CALL JIM COLBERT
TO SEE HOW HE FEELS
ABOUT IT.

0752 TRUCK #1 LEFT WITH
CONCRETE LOAD FOR THE
HOSPERS SANITARY LANDFILL.

0800 TRUCK #2 LEFT WITH
CONCRETE LOAD FOR THE
HOSPERS SANITARY LANDFILL.
TRUCK ONE WILL NOT
BE RUNNING ANYMORE. THERE
WILL BE JUST ONE TRUCK
LOAD NUMBER 3 LEFT FOR
THE LANDFILL.

Douglas E. Lode

(34) Douglas E. Lade 4/30/92

1110 I CALLED JIM COLBERT
TO FILL HIM IN ON ~~THE~~ ^{THE} ~~DEL~~ ^{DEL}
WHAT HAS BEEN
GOING ON. I SAID RESULTS
WILL BE IN FOR TODAY
FOR ALL AREAS ~~DEL~~
EXCEPT THE TOX. PAD
AREA. TOX. PAD AREA
RESULTS WILL BE BACK
ON SATURDAY FOR SOIL
AND MONDAY FOR CONCRETE.
I ALSO TOLD THE SHED
FOOTINGS ARE ALMOST
ALL CLEANED BY
BRUSHING AND IS BEING
TAKEN OFF SITE TO
THE LANDFILL.

1120 I FINISHED TALKING
TO JIM COLBERT.

1125 ~~WE~~ ^{WE} ~~DEL~~ ^{DEL} LEFT SITE FOR
LUNCH.

1205 RETURNED TO SITE ~~FOR~~ ^{DEL}
FROM LUNCH. LOAD 5 IS
BEING LOADED.

1215 LOAD 5 LEFT FOR LANDFILL.

Douglas E. Lade

Douglas E. Lade 4/30/92

(35)

1250 HER. FINISHED CLEANING AND
MOVING SHED FOOTING
CONCRETE TO A NEW PILE
TO BE REMOVED.

1310 HER. BEGAN PILING SHED
FOOTING CHIPS INTO A
PILE.

1320 TRUCK ARRIVED TO BE LOADED
FOR THE 6TH TIME.

1334 LOAD 6 LEFT FOR LANDFILL.

1425 TRUCK ARRIVED BACK FOR 7TH
LOAD.

1430 HER. FINISHED LOADING
THE 7TH LOAD OF CONCRETE
TO GO TO THE LANDFILL.

1440 HER. STOPPED WORK FOR THE
DAY AND LEFT SITE. THERE IS
ONE MORE 1/2 HALF LOAD OF CC.

1445 I WENT TO MAKE COPIES
OF FIGURES OF THE EXCAVATION
AREAS AT THE LIBRARY.

1500 I RETURNED TO SITE.

MIDCON EQUIPMENT CO. CAME
TO PICK UP THEIR COMPRESSOR.

1530 MAN PICKING UP COMPRESSOR

(36) Douglas E. Lade 4/30/92
AXIDENTLY SMASHED THE
TOP OF THE COMPRESSOR
WHILE LOADING IT WITH
THE TRACK MOE.
1605 I LEFT SITE FOR
THE DAY.

Douglas E. Lade

FRIDAY
Douglas E. Lade 5/1/92

(37)

- 0658 I ARRIVED ON SITE. MARK
KEMNER (WCC) IS ON SITE
IN PLACE OF BRET HEADENKAMP.
0700 HERITAGE ARRIVED ON SITE.
WEATHER: 60'S CURRENTLY,
HIGH IN THE 90'S SUNBATHINE.
MARK K. TOLD THAT ALL
AREAS NORTH OF TENTH ST.
AREA 2d SOUTH IS VERY
CLOSE TO 10 IT IS 9.37
MARK IS GOING TO TALK THE
PRP'S TO SEE WHAT THEY
WANT TO DO AROUND 0830
0725 TRUCK ARRIVED TO PICK UP
LAST LOAD OF NON-HAZDOUS.
0730 HER WORKERS BEGAN LOADING
DRUMS INTO TRAILERS WITH
F.E. LI FOR INCINERATION
0738 TRUCK LEFT WITH 1/2 LOAD
OF CONCRETE FOR THE SANITARY
LANDFILL.
0810 I CALLED JIM COLBERT TO
INFORM HIM OF THE VERBAL
PRELIMINARY ANALITICAL
RESULTS AND THAT WCC

(38)

Douglas E. Lade 5/1/92
WOULD LIKE TO PUNCH
HOLES IN THE PLASTIC
THAT IS COVERING THE
EXCAVATIONS AND BACK
FILL OVER THE PLASTIC
SO IF NEEDED THEY CAN
FIND THAT DEPTH
AGAIN. HE SAID HE WILL
HAVE TO GET BACK WITH
ME ON THE PLASTIC.

0835 HER. WORKERS BEGAN
LOADING CONCRETE INCINERATION
DRUMS.

0840 JIM COLBERT CALLED
BACK. MARK KEMNER TALKED
TO HIM FIRST. JIM TOLD
ME THAT EPA DID NOT
WANT TO LEAVE THE
PLASTIC IN THE EXCAVATED
HOLES THAT IT SHOULD
GO BE SENT OFF SITE.
HE SAID THEY CAN USE
SOMETHING ^{SOME} BIODEGRADABLE TO MARK
THE BOTTOM THATS.
I TOLD HIM THEY
Douglas E. Lade

(39)

Douglas E. Lade 5/1/92
WERE FINISHING LOADING
THE INCINERATION CONCRETE
DRUMS. JIM WANTS ME
TO FIND OUT WHEN THE
DRUMS WILL BE GOING
OFF SITE FOR INCINERATION.
I TOLD HIM THEY HAVE
THE PERMITS BUT NO
SLOTS TO THE LANDFILL.

0900 MARK CALLED BOB SKATCK
TO SEE WETHER HER. CAN
BACK FILL. MARK TOLD
HER. AREA'S 10c, 14d, 12 SOUTH,
AND 2d EAST CAN BE BACK FILL.
0920 HER. IS MAKING A PHONE
CALL TO THEIR OFFICE.

1000 I TALKED WITH HERITAGE
ABOUT BACK FILLING
THEY SAID THEY WOULD
PROBIBLY JEST STOCK
PILE SOIL AND NO COMPACTING
THEY WOULD JEST SEND
THEIR MEN HOME FOR
THE WEEKEND.

1010 I CALLED JIM & GARY
Douglas E. Lade

(40)

Douglas E. Lade 5/1/92
FELKNER TO TELL
HIM ABOUT WHAT HAS
COME UP AND IS IT OK
FOR ME TO GO HOME,
HE SAID YES IF JIM COLBERT
SAYS YES.

1015 I CALLED JIM COLBERT
TO ASK HIM IF I COULD
LEAVE. HE SAID YES IF
ALL THEY ARE DOING IS
STOCK PILING.

1025 BOB PATTON TOLD ME
HE CAN'T EVEN STOCK PILE
THE BACKFILL IS TO WET.

1043 LEFT SITE FOR THE
WEEKEND. NO WORK
WILL BE GOING ON
UNTILL MONDAY.

Douglas E. Lade

MONDAY

Douglas E. Lade 5/4/92 (41)

0658 I ARRIVED ON SITE AT
INTERCHEM. HERITAGE IS
ON SITE ALSO WEATHER:
60° HIGH'S IN THE 70'S SUNNY
SKIES

0710 BRET HEADENKAMP (WCC)
ARRIVED ON SITE AND RELEASED
THE GRAD. HER. WAS
PULLING BACK THE PLASTIC
ON THE AREAS WHERE
THEY ARE GOING TO
BACKFILL

0735 I TALKED TO WCC & HER
ABOUT WHAT AREAS WILL
HAVE MORE EXCAVATING
DONE. AREA 2 & THEY
AREA REMOVING 2' IN DEPTH
50' IN LENGTH AND 15' IN
WIDTH. THE DRIVE PAD
AREA BESIDE THE TOX. PAD
WAS A LITTLE HOT.
THE CONCRETE COMPOSITE
WAS 1200 ppm AND THE SOIL
WAS 200 ppm. HER IS GOING
TO REMOVE 3' OF C.C.

Douglas E. Lade

(42) Douglas E. Lade 5/4/92
EAST EDGE AND SOME
SOIL UNDER THE C.C.
0750 BRET H. TOLD ME THAT
WCC VOA SAMPLES GOT
HOT AND WILL HAVE TO
BE RESAMPLED. I WILL
HAVE TO CHECK WITH
JIM COLBERT TO SEE
WHAT HE WANTS DO WHETHER
RESAMPLE MW-3 FOR
OUR SPLIT OR NOT.
0758 THE FIRST FILL MATERIAL
TRUCK ARRIVED ON SITE.
TOP SOIL MATERIAL.
0856 TWO MORE TRUCKS
ARRIVED WITH TOP SOIL
FILL MATERIAL.
0925 HER. BEGAN COMPACTING
FILL IN 1d SHED AREA,
0944 4th TRUCK LOAD OF FILL.
1020 THE FIRST HAZARDOUS WASTE
TRUCK ARRIVE ABOUT 3 HOURS
EARLY.
1031 5th TRUCK LOAD OF FILL.
1036 I CALLED JIM COLBERT
Douglas E Lade

(43) Douglas E. Lade 5/4/92
EPA-WAN TO TELL HIM ABOUT
WHAT TRANSPOSED SINCE
FRIDAY WHEN I LEFT
SITE FOR THE WEEKEND,
I COVERED THE HOT EXCAV.
AREA'S, BACK FILLING, AND
RESAMPLING OF GROUNDWATER
VOA SAMPLES FROM
ALL 4 WELLS.
1054 TRUCK NO 6 PULL IN WITH
FILL I ALSO RETURNED
TO SITE.
1123 LOAD NO 7 CAME IN WITH FILL.
1135 I LEFT TO GET LUNCH.
1154 I RETURNED TO SITE WITH LUNCH.
1216 LOADED ^{DEL} NO 8 CAME IN WITH FILL.
1234 LOAD NO 9 CAME IN WITH FILL.
1255 MARK SEHURER FROM RUSSELLS
CONCRETE OUT OF ORANGE
CITY, IA. CAME OUT TO
CHECK THE PROGRESS OF
BACK FILLING.
LOAD # 10 CAME IN WITH FILL.
BEGAN EXCAVATING MORE
SOIL FROM AREA 2d SOUTH.
Douglas E Lade

44 Douglas E. Lade 5/4/92

HERITAGE HAS BEEN INSTRUCTED TO DIG ANOTHER 2' DEEP ON TOP OF THE 3' FEET ALREADY DUG OUT FOR A TOTAL OF 5'.

1320 TRUCK #1 PULLED IN TO LOAD. I ALSO OBSERVED HER WORKERS SMASHING EMPTY DRUMS WITH THE HOE RAN SO THEY CAN BE PLACED IN WITH THE HAZDOUS WASTE DIRT IN THE HAZ. TRUCKS.

1400 TRUCK #1 CAME BACK FOR MORE SOIL.

1405 TRUCK #2 PULLED IN TO BE LOADED.

1416 LOAD # 11 CAME IN WITH FILL.

1430 LOAD # 12 " " " "

1431 TRUCK #2 LEFT TO WEIGH

1445 TRUCK #2 PULLED OFF WEIGHT.

1454 TRUCK #3 PULLED IN TO BE LOADED.

LOAD #13 CAME IN WITH FILL.
Douglas E. Lade

Douglas E. Lade 5/4/92 45

1508 FINISHED EXCAVATING AREA
1510^{DEL} 2d SOUTH.

1510 BEGAN LOADING WHAT IS LEFT OF CONCRETE SHED FOOTING INTO TRUCK #3

1533 HER FINISHED LOADING SHED CONCRETE DEBRIS

1548 HER. BEGAN BREAKING UP CONCRETE IN THE DRIVE PAD AREA. BRETH. OF WCC DECIDED TO TAKE OUT MORE CONCRETE AND SOIL THAN ANTICIPATED.

1558 TRUCK #3 WAS TOO HEAVY.

1559 LOAD #14 CAME IN WITH FILL.

1612 LOAD #15 CAME IN WITH FILL.

TRUCK #4 PULLED IN TO LOAD.

1633 LOAD #16 CAME IN WITH FILL.

1644 TRUCK #5 PULLED IN TO LOAD.

HER. WORKER WAS MOVING

STOCK PILED FILL INTO AREA HOE DEL 14

1738 TRUCK #4 & 5 OUR FULL.

1800 LEFT SITE FOR THE DAY

Douglas E. Lade

THURSDAY

(46) Douglas E. Lade 5/5/92

0657 I ARRIVED ON SITE. SOME OF HERITAGE WORKERS WERE ON SITE.

0700 BRET HEADENKAMP ARRIVED ON SITE. WEATHER: HIGH IN THE 60'S SUNNY.

0703 THE REST OF HERITAGE ARRIVED ON SITE. TOM MALKAYHEE FROM HER. BOUGHT A TRUCK UP TO LOAD 3 LAB PAKS AND ABOUT 10 EMPTY OVERPAKS. HE ALSO BROUGHT RICK SMITH CAMP WITH HIM TO DRIVE TRUCK TO CHICAGO.

0730 BRET H. AND TOOK SAMPLE MEASUREMENTS FROM THE NEWLY EXCAVATED AREAS.

0735 LOAD #1 ARRIVED WITH FILL.

0740 HER. WORKER BEGAN MOVING LOAD #1 INTO AREA 10E DEL 14

0745 LEFT SITE TO GET DONALD P. ZAD

Douglas E. Lade 5/5/92 (47)

DISTILLED WATER FOR DECONMINING.

0746 TRACK HOE OPERATOR BEGAN EVENING DIRT OUT IN AREA 10E DEL 14

0754 BRET RETURNED TO SITE.

0756 LOAD #2 ARRIVED WITH FILL

0800 ALL 5 TRUCKS ORDERED FOR TODAY HAVE ARRIVED ON SITE.

0807 BRET H. BEGAN COLLECTING SOIL FROM 2d SOUTH

0810 LOAD #3 WAS FILLED WITH CLAY FILL. 6 WHEELER. PROPEL 10 20 E

0815 BRET FINISHED SAMPLING AREA 2d SOUTH.

0824 LOAD #4 WAS FILLED CLAY FILL. 6 WHEELER DROPE IN 2d SOUTH.

0830 HER. FINISHED COMPACTING AREA 10E DEL 14

0840 LOADS 5 & 6 CAME IN WITH BLACK FILL, TOP SOIL. BELLIE LOADERS.

0845 AREA 2d EAST IS BEING COMPACTED

Donal P. Zad

(48) Douglas E. Lade 5/5/92

0858 LOAD #7 WAS FILLED WITH CLAY FILL. DUMPED IN AREA ~~1014~~ ¹⁰¹⁴ NORTH SIDE OF BUILDING.

0911 LOAD #8 WAS FILLED WITH BLACK TOPSOIL FOR AREA 2d.

0915 BRET H. WCC BEGAN COLLECTING SOIL FROM TOX. DRIVE PAD AREA. TPC-3

0922 LOAD #9 WAS FILLED WITH CLAY FILL FOR AREA TOX DRIVE PAD.

0925 BRET FINISHED SAMPLING SOIL IN TOX. DRIVE PAD AREA.

0934 LOAD #10 WAS FILLED WITH CLAY FILL FOR TOX PAD AREA.

0940 LOAD #11 WAS FILLED WITH BLACK TOPSOIL FOR AREA 2d.

0950 BRET H. WCC BEGAN COLLECTING SOIL ^{DEL} CONCRETE SAMPLE FROM TOX. PAD AREA.

~~TPC-3~~ TPC-3

Douglas E. Lade 5/5/92

(49)

1000 LOAD #12 WITH CLAY FILL FOR AREA TOX PAD DRIVE.

1018 BRET H. FINISHED SAMPLING TPC-3 TOX DRIVE PAD.

1020 HERITAGE SEEDED AREAS ~~1014~~ ^{DEL} 19/14

1022 LOAD #13 WITH BLACK TOPSOIL FILL FOR AREA 2d.

1033 LOAD #14 WITH BLACK TOPSOIL FILL FOR AREA 2d.

1040 LOAD #15 WITH BLACK TOPSOIL FILL FOR AREA 2d

1118 LEFT SITE FOR LUNCH.

1155 RETURNED TO SITE FROM LUNCH. BRET SAID LOAD

#16 CAME IN AT 1130 BELLIE LOADER TOPSOIL, LOAD #17 CAME IN AT 1145 DUMP TRUCK TOPSOIL.

1158 I CALLED JIM COLBERT EPA-WAM TO TELL HIM THAT THE BACKFILLING WILL MORE THAN LIKELY BE DONE TODAY. I TOLD HIM THAT WCC GOT

(50)

Douglas E. Lade 5/5/92
RID OF THE LAST
OF THE SOIL & CONCRETE
AND PLASTIC TO BE
REMOVED FROM THE
SITE YESTERDAY. BRET
TOOK HIS CONFIRMATORY
SAMPLES TODAY AND
HE WILL BE TAKING VOA
SAMPLES WEDNESDAY FROM
THE WELLS. HE HAD NOTHING
TO ADD.

- 1218 LOAD #18 WITH BLACK FILL FOR AREA 2d. BELLY LOAD
- 1227 LOAD #19 WITH BLACK FILL FOR AREA 2d. BELLY LOAD.
- 1232 LOAD #20 WITH BLACK FILL FOR AREA 2d. BELLY LOAD
- 1315 HERITAGE T-HOE OPERATOR WENT TO SPREAD CLAY IN THE TOX DRIVE PAD AREA.
- 1324 LOAD #21 WITH BLACK FILL FOR AREA 2d. BELLY LOAD.
- 1330 BRET H. BEGAN PURGING
H₂O READINGS MW-2 WATER LEVEL 14'-10³/₄"
- 1338 MW-1 WATER LEVEL 15'-4¹/₂"

(51)

Douglas E. Lade 5/5/92

- TOTAL DEPTH 23'-11¹/₂"
- MW-1, TOTAL DEPTH OF MW-2 - 20'-6"
- 1345 MW-4 WATER LEVEL 21'-9" TOTAL DEPTH T.O.R. 26'-10¹/₂"
- 1350 MW-3 WATER LEVEL 14'-9" TOTAL DEPTH T.O.R. 25'-3¹/₄"
- 1352 LOAD 22 WITH BLACK FILL FOR AREA 2d. BELLY LOAD.
- 1417 LOAD #23 WITH BLACK FILL DUMPED SOIL AT AREA 10c. NORTH END OF BUILDING.
- 1421 HERITAGE T-HOE SPREAD BLACK FILL AT AREA 10c.
- 1425 ARLIN POTTSBAUM STOPPED BY TO SIGN LAB PAK MANIFEST.
- 1433 LOAD #24 WITH BLACK FILL FOR AREA 2d. BELLY LOAD.
- 1434 HERITAGE T-HOE FINISHED COMPACTING AREA 10c.
- 1448 BRET BEGAN PURGING MW-2
- 1450 HERITAGE WORKER SEEDS AREA 10c.
- 1459 LAB PAK 1 FET SITE

(52) Douglas E. Lede 5/5/92

- 1510 BRETT BEGAN SAMPLING
MW-2 FOR VOA'S
- 1513 FINISHED SAMPLING MW-2.
- 1519 LOAD #25 WITH BLACK
FILL FOR AREA 2d
- 1523 LOAD #26 WITH BLACK
FILL FOR FOX PAD
DRIVE AREA.
- 1535 FED EX ARRIVED TO PICK
UP WCC VERIFICATION
SAMPLES.
- 1553 HERITAGE FINISHED COMPACTING
AREA 2d.
- 1555 HERITAGE T-HOE OPERATOR
BEGAN SPREADING SOIL
IN TOX DRIVE PAD AREA.
- 1605 LOAD #27 WITH BLACK
FILL FOR TOX DRIVE PAD
AREA.
- 1615 I CALLED JIM LOEBERT
EPA-WAM TO ASK FOR WCC
TO SEE IF WCC CAN GET
RID OF THE PURGE WATER
TO ALTON POTW BY USING
ANALYTICAL FROM LAST

Douglas E. Lede 5/5/92 (53)

- FALL. HE ^{SAID} "OK IF THE CITY
WILL DO THAT."
- 1630 LOAD #28 DUMPED BLACK
FILL IN TOX DRIVE
PAD AREA.
- 1646 LOAD #29 WITH BLACK FILL
FOR TOX DRIVE PAD AREA.
- 1705 STOPPED WORK FOR THE
DAY.
- 1715 I HELPED BRETT H. PICK UP
AND LOAD RENTAL BARAKADES.
- 1746 WE LEFT SITE WITH 26
BARAKADES.
- 1802 ARRIVED AT MOTEL AND
UNLOADED VANS OF BARAKADES.
- 1808 ~~FINISHED~~ FINISHED WORK
FOR THE DAY.

Douglas E. Lede

(54) Douglas E. Lade 5/6/92 ^{WEDNESDAY}

0654 I ARRIVED ON SITE.
WEATHER: CURRENTLY
50°F HIGH IN THE 70'S,
SUNSHINE.

0656 HERITAGE ARRIVED ON SITE.

0701 WCC ARRIVED ON SITE.

0725 HERITAGE T-HOE OPERATOR
BEGAN SLOPING SOIL
WAITING ON THE LAST
TOLoads OF FILL TO
ARRIVE ON SITE.

0800 BRET H. BEGAN PURGING
MW-3 FOR VOA SAMPLES

0802 LOAD #1 WITH BLACK FILL
FOR TOX. DRIVE PAD
AREA.

0803 LOAD #2 WITH BLACK
FILL FOR TOX. DRIVE
PAD AREA.

0815 HERITAGE T-HOE OPERATOR
BEGAN TO SPREAD SOIL
IN TOX. DRIVE PAD AREA.

0825 BRET FINISHED SAMPLING
AND PURGING MW-3.

0828 BRET WENT TO DELON

Douglas E. Lade

Douglas E. Lade 5/6/92 (55)

0915 BAILER FOR NEXT WELL.
HERITAGE FINISHED
FILLING IN AND
COMPACTING TOX DRIVE
PAD AREA. THEY ALSO
FILLED IN RUTS AND
SEEDED THE TOX DRIVE
PAD AREA & RUTS.

0923 BRET H. BEGAN PURGING
MW-4. FOR VOA SAMPLES.

0938 BRET H. FINISHED PURGING
AND SAMPLING MW-4.

0945 HERITAGE WAS CLEANING
EQUIPMENT AND TRYING
TO START THEIR BOBCAT
LOADER.

0950 BRET BEGAN DECAVING
HIS BAILER.

1015 BRET BEGAN PURGING MW-1
FOR VOA SAMPLES.
HERITAGE PARKED 3RD
TRAILER UP AGAINST THE
MAIN BLDG.

1105 HERITAGE LEFT SITE FOR
GOOD.

Douglas E. Lade

(56) Douglas E. Ladd 5/6/92

1115 I LEFT SITE FOR THE
KANSAS CITY OFFICE

1145 I CALLED JIM COLBERT
TO TELL HIM WE
ARE DONE AND I AM
COMING HOME. I ASKED
WHAT HE WANTED
IN THE TRIP REPORT.
HE SAID QUANTITIES,
PHOTO'S, SAMPLES
TAKEN AND WHERE,
WHAT WENT WHERE,
AND MORE.

1200 I LEFT SUPER 8 MOTEL
IN LEMARS, IA AND

1700 HELDED TO KANSAS CITY, MO
~~1500~~ I ARRIVED AT MY OFFICE
IN KANSAS CITY, MO.

Douglas E. Ladd

site is all cleaned up and
the workers are heading to the
house.

1050 Left the site and returned
to K.L.

~~FM~~

10/13/91

Jay FM

OUT THE AIR MONITORING ^{WELLS}
PUMPS.

0930

I WENT TO CASEY'S GENERAL
STORE TO GET SOME
SUPPLIES. WCC WAS THERE
ON THE PHONE. THEY
TOLD ME THAT THEY
HAVEN'T GOTTEN A
WRITTEN OK FROM
THE HAZARDOUS WASTE
LANDFILL. SO THEY
WON'T BE STARTING
UNTIL WEDNESDAY
ON THE REMOVAL

1015

I CALLED GARY FELKNER
TO TELL HIM WHAT IS
GOING ON. I TOLD HIM
THAT WCC IS GOING
TO COLLECT SOIL FROM
SOURCE MATERIAL & GROUND
WATER SAMPLES FROM
THE FOUR WELLS

Douglas E. Lade