

# STRUCTURAL WALL INSULATION

RESIDENTIAL | MULTI-FAMILY | LIGHT COMMERCIAL

Installation instructions and fastening details must be followed to provide water resistive barrier and structural insulated sheathing performance. Prior to installing, refer to DrJ TER 1905-02 and UL ER16529-01 for additional detailed installation instructions.

**SAFETY:** Follow all OSHA regulations, safety guidelines, and practices when installing ThermalStar SWI. The product should be kept away from flame sources and intense heat.

**PRODUCT DESCRIPTION & OVERVIEW:** ThermalStar SWI has been designed specifically for residential, light commercial construction, and multi-family applications, up to 3 stories. The combination of structural sheathing, continuous insulation, water resistive barrier, and air barrier components creates a 4-in-1 product, saving significantly on time and labor.

Depending on your design criteria, ThermalStar SWI can be installed with the rigid insulation layer facing outward (“foam-out”), or with the rigid insulation layer facing inwards towards the wall cavity (“foam-in”). A foam-out installation will be illustrated in the following pages.

**PRODUCT COMPOSITION:** ThermalStar SWI is available in two configurations, either R3 (3/4” total thickness), or R5 (1-1/8” total thickness). ThermalStar SWI is manufactured as 4’x8’, 4’x9’, or 4’x10’ sheets.

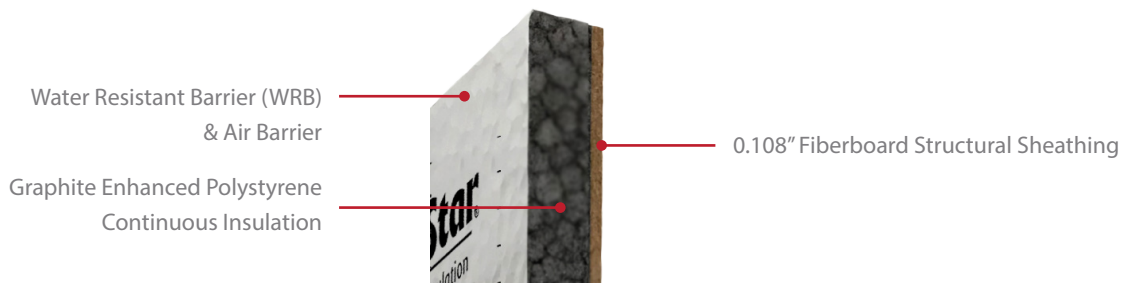

**STORAGE & HANDLING:** ThermalStar SWI is packaged in bundles. The bundle is stretched wrapped and can be stored temporarily outside as long as the packaging is intact and weather resistant. All bundles should be elevated from the ground. *ThermalStar SWI must be protected from direct sunlight during storage.*

**LIMITATIONS:** For specific design load limitations, please refer to DrJ TER 1905-02.

# INSTALLATION INSTRUCTIONS

Prior to installing, refer to DrJ TER Report 1905-02 and UL ER16529-01 for additional detailed installation instructions.

Using approved staples or nails, ThermalStar SWI must be fastened around the perimeter every 3" on center. All perimeter edges of ThermalStar SWI must be installed over framing members and fastened for structural use.

Follow the fastening pattern details in the following steps. For foam-out installations, the fasteners will penetrate through the rigid insulation and will sit tight against the structural sheathing. All fasteners must penetrate the wood framing at least 1". For foam-in installations, the fastener shall sit tight against the structural sheathing, and penetrate at least 1" into the wood framing.

**FOAM-OUT FASTENING**

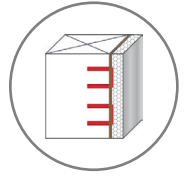

**FOAM-IN FASTENING**

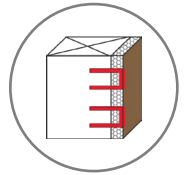

**WARNING:** DO NOT FASTEN THE FOUR CORNERS FIRST.

## STEP 1

Starting in the top corner, fasten the ThermalStar SWI down the full length of the framing member, following the 3" nailing pattern.

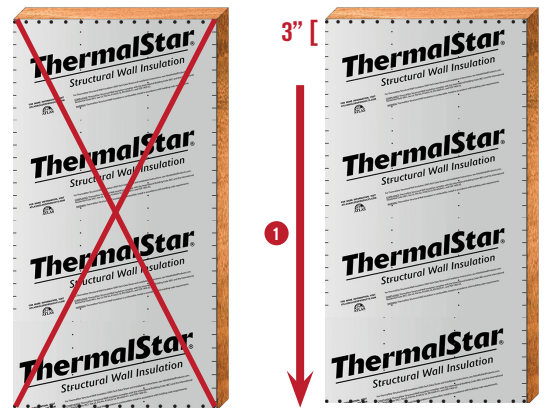

## STEP 2

Starting in the top corner, fasten horizontally to next framing member (2A). Then start in bottom corner and fasten to next framing member (2B).

## STEP 3

Starting at top, fasten down framing member.



## STEP 4

Repeat the horizontal fastening pattern for top (4A) and bottom (4B).

## STEP 5

Repeat the vertical fastening pattern down the framing member.

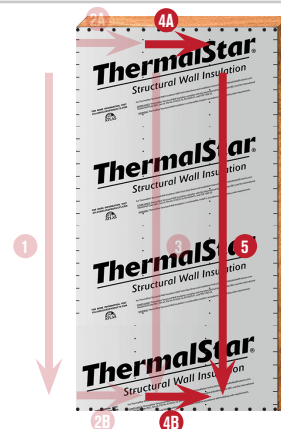

**STEP 6** Repeat the horizontal fastening pattern for top (6A) and bottom (6B).

**STEP 7** Repeat the vertical fastening pattern down the framing member.

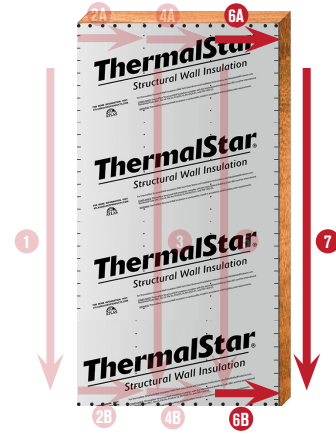

**STEP 8** All seams must be taped to achieve a water resistive barrier. Seams must be dry and clean of debris. Utilize a J roller to firmly mate tape to surface.



**STEP 9** For accessory products, refer to specific manufacturer's installation instructions. Cladding should be installed within 30 days of installation of ThermalStar SWI.



FOR ADDITIONAL RESOURCES, VISIT THE WALL INSULATION SECTION OF OUR WEBSITE [ATLASMOLDEDPRODUCTS.COM](https://www.atlasmoldedproducts.com)

**GREATER COVERAGE  
GREATER AVAILABILITY**



Atlas Molded Products, a Division of Atlas Roofing Corporation

