



# AURUM

*The Standard in Home Technology*





## WHO WE ARE

We are a full-service residential and commercial custom electronics design, installation, service and integration company. Our smart home technology solutions from companies like Savant and Crestron make your Colorado home safe, elegant, fun and easy to use. Businesses experience increased productivity, enhanced environments for employees and customers, and simple control. Our team is comprised of world-class experts in every field whose number one priority is to provide the best products and services to our clients.



303.558.9050 • 730 S Jason St Unit 18 Denver CO 80223 • [aurumhometech.com](http://aurumhometech.com)



## CONSULTATION

With our extensive experience providing smart technology and integrated systems, we are able to provide thoughtful discussion and valuable insight about what products and solutions work best to achieve a desired result for you. We advise on what brands and technologies are reliable and which play well with others. Get up to speed on the latest innovations and trends and have your questions answered.

## PROJECT SPECIFICATION

We can apply our knowledge and expertise to documenting requirements for AV and integrated technology products, materials and services for a proposed project. We can work together with architects and engineers to assist in preparing contract documents and construction requirements. Our specifications describe the type and quality of every product required for the project including functionality, installation and finishing.

## DESIGN AND ENGINEERING

Comprehensive and thoughtful system design and engineering up front leads to the best balance of functionality, reliability and aesthetics in the end result. Avoid costly mistakes or change orders, having to do something twice, or tearing up walls once they've been closed. Careful attention is given to the numerous details involved with smart technology and integrated systems to ensure they are easy to use and deliver consistent performance and allow for future expansion or upgrades.

## LIGHTING CONTROL

Our in-house design team will create an efficient and elegant lighting control system that illuminates your space for function and aesthetics. We consult and collaborate with lighting designers, architects, engineers, interior designers and general contractors. Your team will receive detailed electrical prints and enclosure schedules to ensure all is controlled as specified. Combining our technical acumen and design the light will beautifully elevate the experience of your space. Human Centric lighting makes you look and feel better with the press of a button.

## SYSTEM DOCUMENTATION

A smoother construction process is achieved when the technology system design is documented in advance of actual construction. All parties involved in building your space benefit with clearly defined drawings for device location, pre-wire, technical power, schematics, rack elevation, lighting control, motorized window treatments, equipment space planning, video sightlines, requirements for video niches, and more.

SERVICES





## AS-BUILT DOCUMENTATION

At the completion of the project we will produce and provide a clear and concise final set of as-built drawings of the integrated technology system. This is critical because a constructed building almost never corresponds exactly to the original design drawings, and becomes a valuable asset for any property. The documentation includes all changes that have been made to the original construction drawings, including notes, modifications, and any other pertinent information.

## PROJECT MANAGEMENT

A smart technology project takes effective planning, organizing, and allocating resources to make sure it's completed on time and with the desired result at fit and finish. Additionally, procedures and protocols need to be met and unforeseen problems should be resolved quickly. Our dedicated project managers oversee all details and consistently communicate with the contractor, subcontractors and owner.

## COMMISSIONING

A quality assurance process for installed building systems prior to occupancy is best achieved with commissioning services. It's our goal to make sure the final installed system meets owner requirements and the design intent as planned after the many variables within the construction process. Owners will experience reduced energy and operating costs and enhanced satisfaction and acceptance from users.

## SYSTEM MONITORING

Peace of mind, scheduling maintenance, and optimizing system performance for functionality and energy savings is accomplished with system monitoring services. From a dashboard on a touch screen or a secure software application on a computer or smart device, real-time information is accessible to provide status of lighting, temperature, security, and more 24/7, whether you're there or on the other side of the globe.

## MAINTENANCE & SUPPORT

Just as a vehicle needs regular maintenance and over time require service or replacement of parts, the same is true with smart technology and integrated systems. We provide continued tuning and system adjustments at set time intervals based on your unique solution to maximize performance levels. When something goes wrong, which is an inevitable truth about electronics, we will be there to fix it quickly. Plus the fact that constant innovation continues to advance electronic equipment means there may be new features and enhanced performance that you will want whether it's for the video, music, security or control in your space.



SERVICES





## LIGHTING CONTROL

**Create the perfect ambiance and save energy with intelligent and effortless control of your lights.**

Custom-tailored lighting control allows you to change the mood of any area of your home to suit the occasion. Whether watching TV, dining or entertaining, one press of a button can create the ideal atmosphere you desire. For example, press "Goodnight" to turn all your lights off or "Pathway" to light the way downstairs. Smart lighting control also contributes to a safe environment by linking with the security system to turn all lights on if uninvited activity is detected.



## MOTORIZED WINDOW TREATMENTS

**Maximize efficiency with automated window coverings for shades, drapery, and more.**

With motorized window treatments, you can easily adjust the amount of daylight in your home to save energy while increasing comfort and protecting interiors. Motorized shading and drapery reduces solar heat gain by blocking out the sun entirely or using a transparent shade to allow just the right amount of light needed in your family room, bathroom, or other area of your home.



## SMART HOME TECHNOLOGY

**Enhance your lifestyle with simple yet sophisticated control of music, video, lights, climate and more.**

Systems for music, video, lights, climate and security have become more intelligent, enabling you to easily operate them from a smart phone, tablet, keypad, or touch panel. Effortlessly listen to your favorite music from any area of the home with a single button press or set the lights and shades to create ambiance for your open concept kitchen. From your mobile device, you can view surveillance cameras, unlock the door or set the temperature.

**HOME SOLUTIONS** SMART HOME AUTOMATION





## CLIMATE CONTROL

**Smart climate control makes it easy for you to set the perfect temperature of your home regardless of the season or other conditions.**

Create a comfortable environment by making adjustments from the same touch screen you use to control your lights, shades, and home entertainment system. Monitor and control your thermostats from a mobile device if you left your AC blasting when you left home or to turn up the heat before you return on a cold day.



## NETWORKING

**Reliable, robust and secure network for communications and home control**

A network is a home's central nervous system for all communications and control. We'll help lay a solid and reliable foundation that's robust for the technology of today and tomorrow. We will work with you to find a complete networking solution that satisfies all of your system needs including your TV, telephone, music, security, control system and mobile devices that are connected on the network in a smart home. A high-speed and secure network provides the functionality and protection you desire.



## VIDEO SURVEILLANCE

**Monitor activities real-time whether you're in the house or on the other side of the world.**

With high-definition surveillance cameras in and around your home, you can monitor activities real-time whether you're in the house or halfway around the globe. Receive live video streams of entrances to see who's at the door, interior areas, the perimeter, or even check on the kids playing in the pool all from the same touch screen that controls your home entertainment system or from your smart mobile device.

**HOME SOLUTIONS** SMART HOME AUTOMATION





## HOME MEDIA

**Simplify your digital lifestyle with easy to control high quality audio/video in one room or your whole home**

Home media systems today include High Definition flat panels, architectural loudspeakers and streamlined AV components to give you the best possible sound and video. Even if the room doesn't allow for a complete home theater setup, we bring together the highest quality audio/video equipment to suit your entertainment needs.



## HOME THEATER

**Pull the curtains back, home theater design made to impress.**

A dedicated private home theater is a room in which the environment has been precisely designed and engineered to provide maximum movie and music enjoyment. Special acoustic treatments isolate the room from outside noise, and measured speaker placement optimizes the audio. Plush theatre seating is carefully positioned to allow for unobstructed viewing of your video content on the big screen.



## OUTDOOR ENTERTAINMENT

**Create the perfect oasis to enjoy music and TV outside with family and friends.**

Outdoor living spaces have become an extension to our homes and there's now a wide range of technology solutions built to withstand the elements without compromising performance. Add music, video, and lighting control to make the perfect entertaining space for family and friends or create a great spot for a much needed personal respite from the everyday.

**HOME SOLUTIONS** SMART HOME AUTOMATION





## HIGH PERFORMANCE AUDIO

**Simplify your digital lifestyle with easy to control high quality audio/video in one room or your whole home**

The passion you have for the listening experience demands a high performance audio system that delivers unrivaled sound reproduction and superior aesthetics. When you pair high performance audio with acoustic works of art the results are stunning. We can help you design and engineer an easy to use system that rivals the experience of seeing your favorite musicians live in concert.



## HIDDEN AUDIO/ VIDEO

**Blend technology with architecture and décor so you only experience home entertainment when you want to.**

Stay true to the aesthetic vision of your space by blending your home technology with the architecture and décor. Home entertainment can be seen and heard only when you want it to with hidden speakers, concealed video displays, mirror TVs, and flush-mount controls. Keep counters, walls, and bookshelves clear so that your home design stays clean and simple.



## MULTI-ROOM MUSIC

**Share your music across multiple rooms in your home.**

Audio distribution systems send music to any room in your home via a central processor or matrix switcher. The days of a volume knob on the wall are long gone. Control of your music is simple and intuitive by means of a touch panel, keypad, handheld RF remote, iPad® or similar Wi-Fi smart device. Whether the speakers are placed in the walls, ceilings, bookshelves, shower or pool, they can be designed to aesthetically blend in to minimize

**HOME SOLUTIONS** SMART HOME AUTOMATION





# REMOVE THESE DEVICES FROM YOUR WALLS

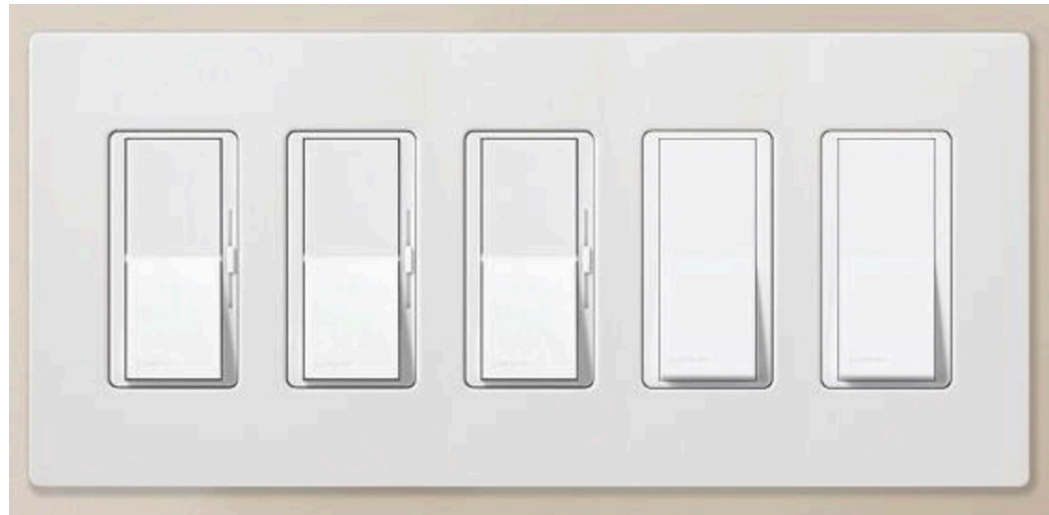

# CONTROL YOUR HOME WITH ELEGANCE

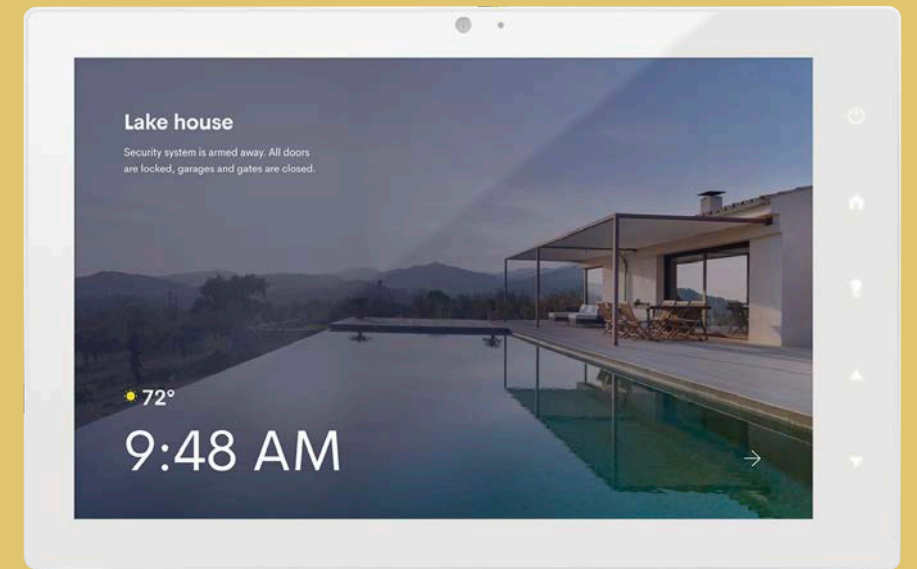
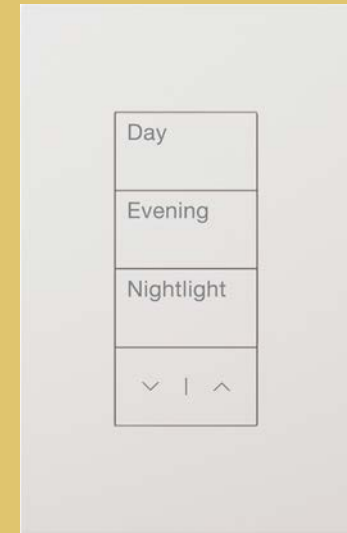

# HOME SOLUTIONS WALL CLUTTER

# SAVANT



## USER EXPERIENCE

From a single, intuitive app Savant provides unparalleled convenience to control the lights, climate, entertainment and security. A solution for even the most distinctive spaces, like pools and home theaters, is only a touch away. Unwind as day turns to night with pre-determined scenes that set the mood with the right lighting and a relaxing playlist. No matter where life takes you, easily check-in on your home using a smartphone to ensure everything is just right. A Savant System is designed to match the way you live, create experiences that reflect your personality and help you live more comfortably.

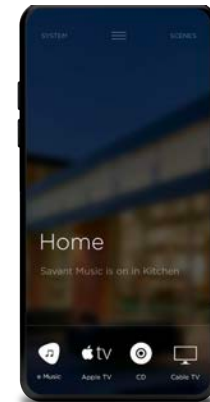

## VIDEO

Enjoy media content from any location with the simple press of one button.



## LIGHTING

Conveniently create the perfect ambiance and increase safety with one-touch control of your lights.

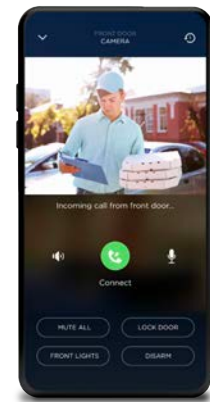

## SECURITY

Secure what matters most, your family and home, and receive email alerts when away.



Smart media control gives you simple access to shows and movies in any room.



Lighting control allows you to change the mood of any area to suit the occasion.



Monitor activities real-time whether you're in the house or on the other side of the world

**HOME SOLUTIONS** SAVANT CONTROLS



# SAVANT POWER

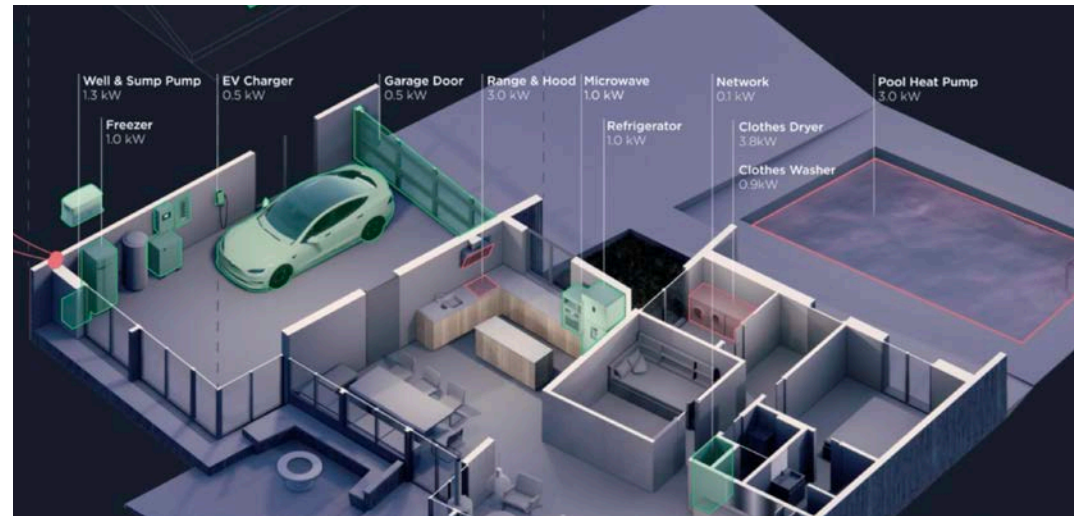

## THE FUTURE OF ENERGY

Scalable Savant Power Systems paired with the Savant app, delivers you full control over time-of-use pricing, off-grid energy independence, and backup power sources including automatic generators. Savant Power Systems make it all easier

Whether you want the ability to check the status of your home's current energy consumption or are looking to dive deep into historical data trends, the Savant app's energy service delivers you full insight and control.

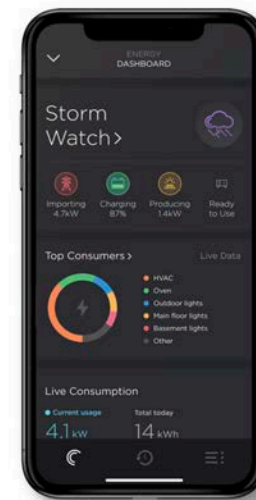

**STORM WATCH**  
Quickly store energy and protect the home for possible outages.



**POWER OUTAGE**  
Automatically power critical loads when the grid goes down.



**OFF GRID**  
Energize the home without drawing power from the utility.

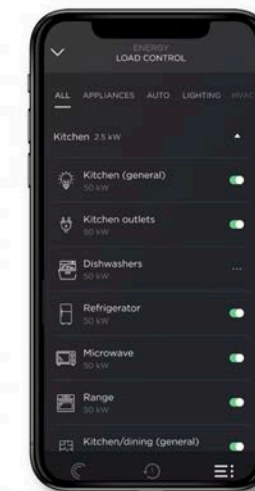

**LOAD CONTROL**  
Directly turn on or off any circuit in the home as needed.



**HOME SOLUTIONS** SMART ENERGY

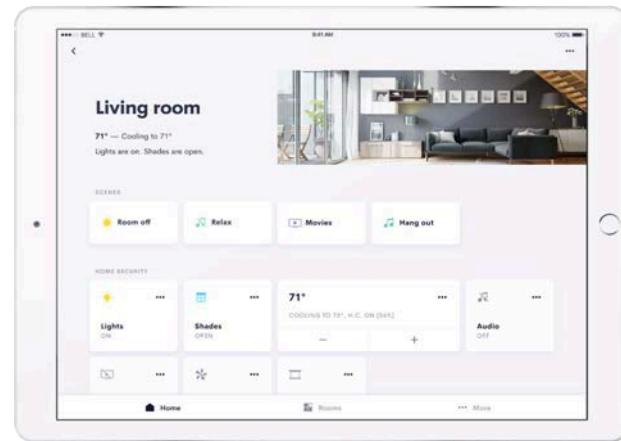

## USER EXPERIENCE

Simplify your life with a complete Crestron solution that controls lights and shades, audio and video, heating and air conditioning, security and surveillance, and many other functions. From elegant keypads with discreet control to touch screens that combine flexibility and reliability, you're always in control, no matter the environment. Monitor multiple locations, such as a primary residence, vacation home and office, from a smart phone or tablet and receive real-time status of room temperature, shade position and lighting levels.

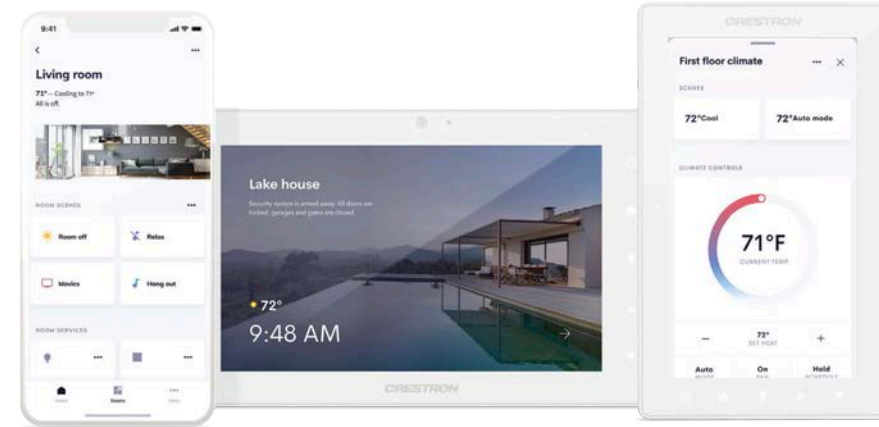

## VIDEO

Enjoy media content from any location with the simple press of one button.

## LIGHTING

Conveniently create the perfect ambiance and increase safety with one-touch control of your lights.

## SECURITY

Secure what matters most, your family and home, and receive email alerts when away.

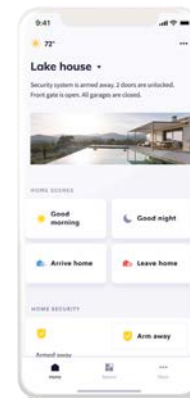

Smart media control gives you simple access to shows and movies in any room.



Lighting control allows you to change the mood of any area to suit the occasion.

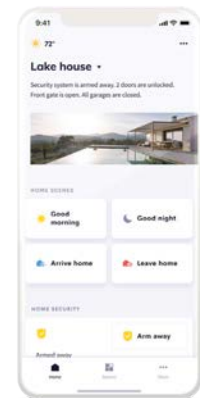

Monitor activities real-time whether you're in the house or on the other side of the world

# HOME SOLUTIONS CRESTRON CONTROLS



CUSTOM PROPOSAL:

SMITH RESIDENCE



DATE 05/29/20  
CLIENT Aurum  
PROJECT AURUM-1443

Proposal Summary  
OVERVIEW

AREA TOTALS	
NETWORK	\$12,350.00
WHOLE HOUSE EQUIPMENT	\$37,339.00
NVX VIDEO DISTRIBUTION	\$23,399.00
SYSTEM SOURCES	\$4,893.00
LIGHTING CONTROL	\$0.00
WINDOW TREATMENTS	\$100,383.10
CLIMATE CONTROL	\$20,375.00
SURVEILLANCE	\$13,120.00
SECURITY	\$5,629.68
INFRASTRUCTURE	\$14,387.51
SITTING [102]	\$6,669.00
STUDY [103]	\$8,913.00
GARAGE [107]	\$470.00
LIVING [111]	\$850.00
KITCHEN [112]	\$6,474.00
DINING [113]	\$2,420.00
MASTER BED [201]	\$2,420.00
MASTER BED VIDEO [201]	\$19,669.00
MASTER BATH [202]	\$2,420.00
MASTER DECK	\$1,880.00
LOFT [213]	\$2,420.00

Rev. 0 5/29/2020 Page 6 of 23

DATE 05/29/20  
CLIENT Aurum  
PROJECT AURUM-1443

Network

PROPOSED PRODUCTS

QTY	UNIT	MANUFACTURER	MODEL	DESCRIPTION	PRICE
1	EA	Luxul	ABR-5000	Epic 4 Gigabit Dual-WAN Router with Domains and Router Limits management software. Includes 12 months monitoring.	\$790.00
2	EA	Luxul	XMS-2624P	XV Series 26-Port 24 PoE+ Gigabit Managed Switch	\$2,220.00
7	EA	Access Networks	A610	Dual-band 802.11abgn/ac wireless access point. 3x3.3 streams	\$7,350.00
1	EA	Access Networks	ZoneDirector C120	ZoneDirector 1200 - Includes 8 AP licenses - Includes 4 years of support	\$1,990.00
Network TOTAL					\$12,350.00

Whole House Equipment

PROPOSED PRODUCTS

QTY	UNIT	MANUFACTURER	MODEL	DESCRIPTION	PRICE
1	EA	Crestron	CP3	3-Series control system	\$1,800.00
1	EA	Crestron	C2N-AMP-6X100	4 Room audio system	\$1,900.00
4	EA	Crestron	C2N-AMP-6X100	6 Room plus 2 audio distribution system	\$10,000.00
1	EA	Autonomic Controls	MMS-2A	Mirage media server. 2 audio streams, 24bit/96kHz, 1 RCA analog output, 1 coaxial digital output and other	\$1,995.00
1	EA	Aurum	RCK-CBL-MGT	Rack Assembly and Associated Parts and Materials	\$2,800.00
2	EA	Middle Atlantic	CBS-WRK-27	Caster base for WRK 27" deep	\$330.00
3	EA	Middle Atlantic	PDU-Equipment Rack Power	24 outlet, (12) 20 amp circuits with (6) 15 amp circuits that accept 1" power	\$2,235.00
1	EA	Exact Power	EP-CORE-10-240	PowerCore - 10kva / Rack Room & House Wide Power Panel	\$10,400.00
1	EA	Panamax	M4315-PRO	Programmable Power Conditioner	\$647.00
1	EA	Panamax	MB1500	Battery Backup	\$1,225.00
1	EA	Middle Atlantic	SPN-44-267	44 space side panel	\$680.00
2	EA	Middle Atlantic	WRK-44-27	44 Space, 27" depth WRK rack	\$3,680.00
1	EA	Panamax	CV2	BlueBOLT TCP/IP Ethernet Interface Card	\$247.00
Whole House Equipment TOTAL					\$37,339.00

\* Price Includes Accessories  
Rev. 0 5/29/2020 Page 8 of 23

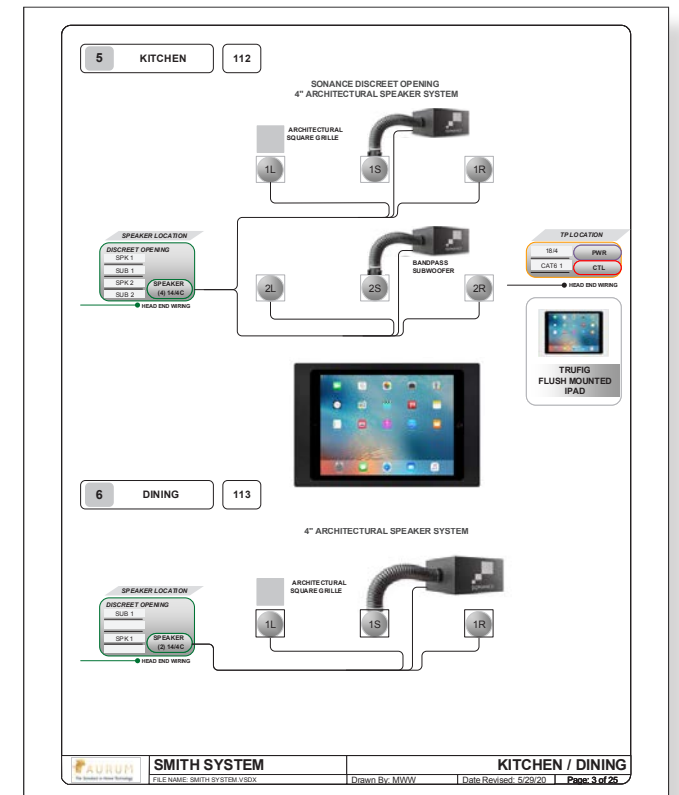
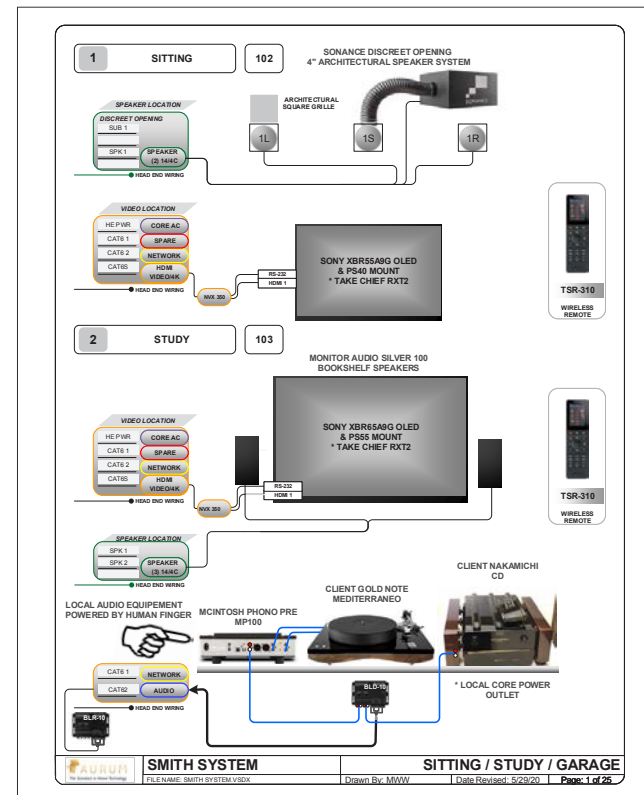

RESIDENTIAL PROPOSALS



THE INFORMATION AND DESIGN INTENT OF THESE DRAWINGS ARE THE PROPERTY OF AURUM HOME TECHNOLOGIES AND AS SUCH SHALL NOT BE USED IN ANY MANNER WITHOUT PRIOR WRITTEN PERMISSION. THESE DRAWINGS ARE NOT TO BE USED FOR CONSTRUCTION. UNLESS APPROVED BY A LICENSED DESIGN PROFESSIONAL, AND AURUM HOME TECHNOLOGIES DISCLAIMS ANY LIABILITY FOR SUCH UNAUTHORIZED USE.

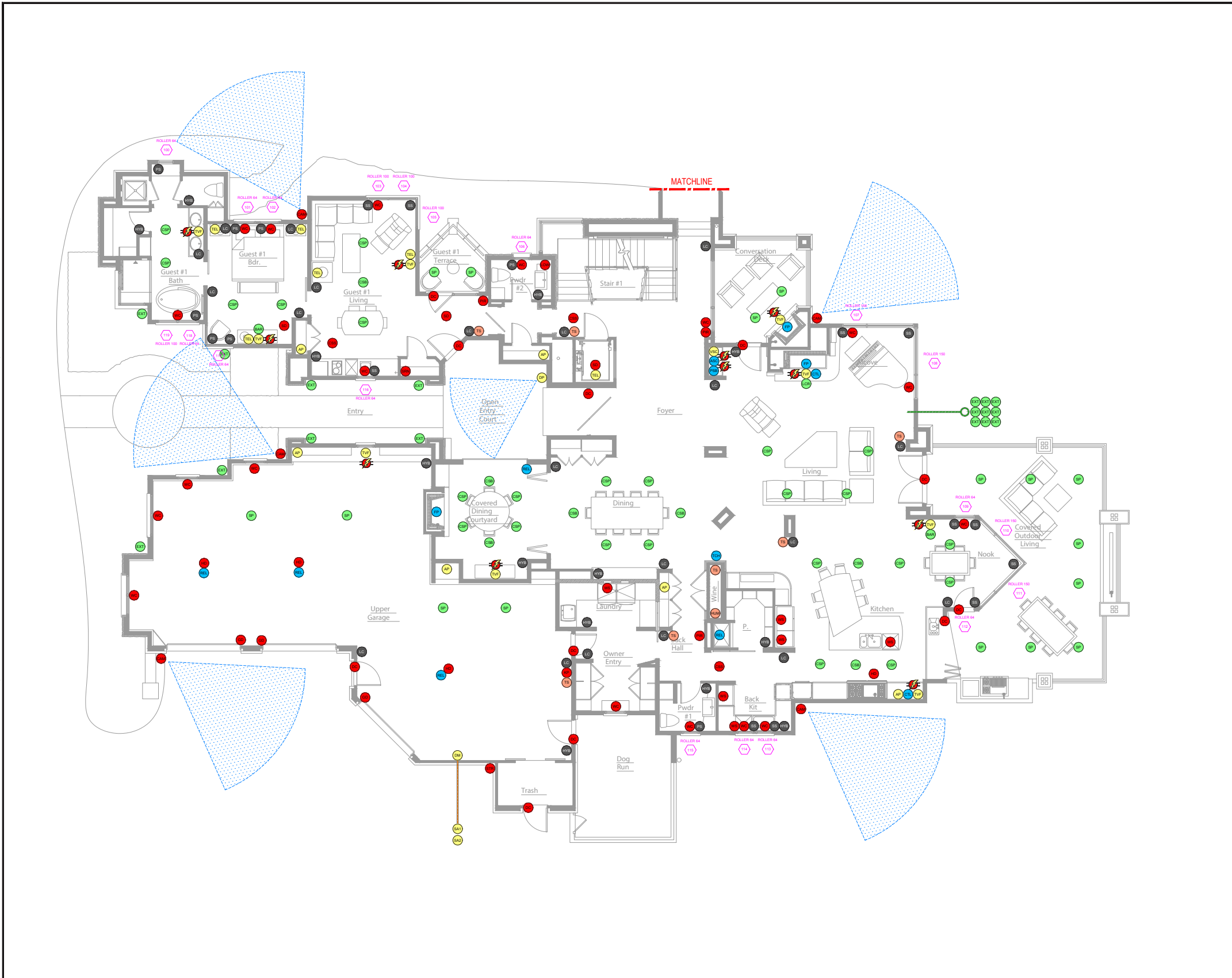

SYMBOL	DESCRIPTION	QUANTITY	NOTES
XX.XX.XX	AUDIO	WIRING	
(A1)	AUDIO HEADEND	1	16 GA. 24/2
(A2)	STEREO TV SOUNDBAR OR BROADCAST SPEAKER	1	16 GA. 24/2
(A3)	DISCREET CENTRAL CEILING SUBWOOFER	1	16 GA. 24/2
(A4)	DISCREET CENTRAL CEILING SPEAKER	1	16 GA. 24/2
(A5)	DISCREET CENTRAL CEILING SUBWOOFER	1	16 GA. 24/2
(A6)	LANDSCAPE SPEAKER	1	16 GA. 24/2
(A7)	MULTICHANNEL TV SPEAKER	1	16 GA. 24/2
(A8)	WALL OR CEILING SPEAKER	1	16 GA. 24/2
(A9)	IN-WALL SUBWOOFER	1	16 GA. 24/2
(A10)	THEATER CEILING SPEAKER	1	16 GA. 24/2
(A11)	THEATER WALL SUBWOOFER	1	16 GA. 24/2
(A12)	THEATER WALL SPEAKER	1	16 GA. 24/2
XX.XX.XX	HVAC CONTROL	WIRING	
(H1)	HVAC CONTROL HEADEND	1	24 GA. CAT5
(H2)	HUMIDITY SENSOR	1	CAT5
(H3)	THERMOSTAT	1	CAT5
(H4)	TEMPERATURE SENSOR	1	CAT5
XX.XX.XX	LIGHTING & SHADES	WIRING	
(L1)	BLACKOUT PANELED WINDOW COVERING	1	4 CONDUCTOR LUTRON WIRE
(L2)	CREATION WINDOW COVERING	1	24 GA. CAT5
(L3)	WIRELESS DIMMER	1	WIRELESS DIMMER DEVICE
(L4)	WIRELESS DIMMER	1	WIRELESS DIMMER DEVICE
(L5)	WIRELESS DIMMER	1	WIRELESS DIMMER DEVICE
(L6)	LIGHTING CONTROL STATION	1	4 CONDUCTOR LUTRON WIRE
(L7)	LIGHTING CONTROL STATION	1	24 GA. CAT5
(L8)	LUTRON RF REPEATER	1	4 CONDUCTOR LUTRON WIRE
(L9)	MANUAL SHADE	1	NONE NEEDED
(L10)	MOTION SENSITIVE DIMMER	1	4 CONDUCTOR LUTRON WIRE
(L11)	MOTION SENSITIVE DIMMER	1	4 CONDUCTOR LUTRON WIRE
(L12)	PULLDOWN SURFACE RECEPTOR	1	4 CONDUCTOR LUTRON WIRE
(L13)	SHADE CONTROL HEADEND	1	24 GA. CAT5
XX.XX.XX	POWER & CONDUIT	WIRING	
(P1)	POWER SOURCE COMPONENT	1	16 GA. 24/2
(P2)	POWER SOURCE COMPONENT	1	16 GA. 24/2
(P3)	POWER SOURCE COMPONENT	1	16 GA. 24/2
(P4)	POWER SOURCE COMPONENT	1	16 GA. 24/2
(P5)	POWER SOURCE COMPONENT	1	16 GA. 24/2
(P6)	POWER SOURCE COMPONENT	1	16 GA. 24/2
(P7)	POWER SOURCE COMPONENT	1	16 GA. 24/2
(P8)	POWER SOURCE COMPONENT	1	16 GA. 24/2
(P9)	POWER SOURCE COMPONENT	1	16 GA. 24/2
(P10)	POWER SOURCE COMPONENT	1	16 GA. 24/2
(P11)	POWER SOURCE COMPONENT	1	16 GA. 24/2
(P12)	POWER SOURCE COMPONENT	1	16 GA. 24/2
(P13)	POWER SOURCE COMPONENT	1	16 GA. 24/2
(P14)	POWER SOURCE COMPONENT	1	16 GA. 24/2
(P15)	POWER SOURCE COMPONENT	1	16 GA. 24/2
(P16)	POWER SOURCE COMPONENT	1	16 GA. 24/2
(P17)	POWER SOURCE COMPONENT	1	16 GA. 24/2
(P18)	POWER SOURCE COMPONENT	1	16 GA. 24/2
(P19)	POWER SOURCE COMPONENT	1	16 GA. 24/2
(P20)	POWER SOURCE COMPONENT	1	16 GA. 24/2
(P21)	POWER SOURCE COMPONENT	1	16 GA. 24/2
(P22)	POWER SOURCE COMPONENT	1	16 GA. 24/2
(P23)	POWER SOURCE COMPONENT	1	16 GA. 24/2
(P24)	POWER SOURCE COMPONENT	1	16 GA. 24/2
(P25)	POWER SOURCE COMPONENT	1	16 GA. 24/2
(P26)	POWER SOURCE COMPONENT	1	16 GA. 24/2
(P27)	POWER SOURCE COMPONENT	1	16 GA. 24/2
(P28)	POWER SOURCE COMPONENT	1	16 GA. 24/2
(P29)	POWER SOURCE COMPONENT	1	16 GA. 24/2
(P30)	POWER SOURCE COMPONENT	1	16 GA. 24/2
(P31)	POWER SOURCE COMPONENT	1	16 GA. 24/2
(P32)	POWER SOURCE COMPONENT	1	16 GA. 24/2
(P33)	POWER SOURCE COMPONENT	1	16 GA. 24/2
(P34)	POWER SOURCE COMPONENT	1	16 GA. 24/2
(P35)	POWER SOURCE COMPONENT	1	16 GA. 24/2
(P36)	POWER SOURCE COMPONENT	1	16 GA. 24/2
(P37)	POWER SOURCE COMPONENT	1	16 GA. 24/2
(P38)	POWER SOURCE COMPONENT	1	16 GA. 24/2
(P39)	POWER SOURCE COMPONENT	1	16 GA. 24/2
(P40)	POWER SOURCE COMPONENT	1	16 GA. 24/2
(P41)	POWER SOURCE COMPONENT	1	16 GA. 24/2
(P42)	POWER SOURCE COMPONENT	1	16 GA. 24/2
(P43)	POWER SOURCE COMPONENT	1	16 GA. 24/2
(P44)	POWER SOURCE COMPONENT	1	16 GA. 24/2
(P45)	POWER SOURCE COMPONENT	1	16 GA. 24/2
(P46)	POWER SOURCE COMPONENT	1	16 GA. 24/2
(P47)	POWER SOURCE COMPONENT	1	16 GA. 24/2
(P48)	POWER SOURCE COMPONENT	1	16 GA. 24/2
(P49)	POWER SOURCE COMPONENT	1	16 GA. 24/2
(P50)	POWER SOURCE COMPONENT	1	16 GA. 24/2
(P51)	POWER SOURCE COMPONENT	1	16 GA. 24/2
(P52)	POWER SOURCE COMPONENT	1	16 GA. 24/2
(P53)	POWER SOURCE COMPONENT	1	16 GA. 24/2
(P54)	POWER SOURCE COMPONENT	1	16 GA. 24/2
(P55)	POWER SOURCE COMPONENT	1	16 GA. 24/2
(P56)	POWER SOURCE COMPONENT	1	16 GA. 24/2
(P57)	POWER SOURCE COMPONENT	1	16 GA. 24/2
(P58)	POWER SOURCE COMPONENT	1	16 GA. 24/2
(P59)	POWER SOURCE COMPONENT	1	16 GA. 24/2
(P60)	POWER SOURCE COMPONENT	1	16 GA. 24/2
(P61)	POWER SOURCE COMPONENT	1	16 GA. 24/2
(P62)	POWER SOURCE COMPONENT	1	16 GA. 24/2
(P63)	POWER SOURCE COMPONENT	1	16 GA. 24/2
(P64)	POWER SOURCE COMPONENT	1	16 GA. 24/2
(P65)	POWER SOURCE COMPONENT	1	16 GA. 24/2
(P66)	POWER SOURCE COMPONENT	1	16 GA. 24/2
(P67)	POWER SOURCE COMPONENT	1	16 GA. 24/2
(P68)	POWER SOURCE COMPONENT	1	16 GA. 24/2
(P69)	POWER SOURCE COMPONENT	1	16 GA. 24/2
(P70)	POWER SOURCE COMPONENT	1	16 GA. 24/2
(P71)	POWER SOURCE COMPONENT	1	16 GA. 24/2
(P72)	POWER SOURCE COMPONENT	1	16 GA. 24/2
(P73)	POWER SOURCE COMPONENT	1	16 GA. 24/2
(P74)	POWER SOURCE COMPONENT	1	16 GA. 24/2
(P75)	POWER SOURCE COMPONENT	1	16 GA. 24/2
(P76)	POWER SOURCE COMPONENT	1	16 GA. 24/2
(P77)	POWER SOURCE COMPONENT	1	16 GA. 24/2
(P78)	POWER SOURCE COMPONENT	1	16 GA. 24/2
(P79)	POWER SOURCE COMPONENT	1	16 GA. 24/2
(P80)	POWER SOURCE COMPONENT	1	16 GA. 24/2
(P81)	POWER SOURCE COMPONENT	1	16 GA. 24/2
(P82)	POWER SOURCE COMPONENT	1	16 GA. 24/2
(P83)	POWER SOURCE COMPONENT	1	16 GA. 24/2
(P84)	POWER SOURCE COMPONENT	1	16 GA. 24/2
(P85)	POWER SOURCE COMPONENT	1	16 GA. 24/2
(P86)	POWER SOURCE COMPONENT	1	16 GA. 24/2
(P87)	POWER SOURCE COMPONENT	1	16 GA. 24/2
(P88)	POWER SOURCE COMPONENT	1	16 GA. 24/2
(P89)	POWER SOURCE COMPONENT	1	16 GA. 24/2
(P90)	POWER SOURCE COMPONENT	1	16 GA. 24/2
(P91)	POWER SOURCE COMPONENT	1	16 GA. 24/2
(P92)	POWER SOURCE COMPONENT	1	16 GA. 24/2
(P93)	POWER SOURCE COMPONENT	1	16 GA. 24/2
(P94)	POWER SOURCE COMPONENT	1	16 GA. 24/2
(P95)	POWER SOURCE COMPONENT	1	16 GA. 24/2
(P96)	POWER SOURCE COMPONENT	1	16 GA. 24/2
(P97)	POWER SOURCE COMPONENT	1	16 GA. 24/2
(P98)	POWER SOURCE COMPONENT	1	16 GA. 24/2
(P99)	POWER SOURCE COMPONENT	1	16 GA. 24/2
(P100)	POWER SOURCE COMPONENT	1	16 GA. 24/2
XX.XX.XX	SECURITY	WIRING	
(S1)	SECURITY CAMERA	1	24 GA. CAT5
(S2)	CARBON MONOXIDE	1	16 GA. 24/2
(S3)	COMBINED CARBON MONOXIDE & SMOKE DETECTOR	1	16 GA. 24/2
(S4)	DOOR CONTACT OR GARAGE DOOR CONTACT	1	24 GA. CAT5
(S5)	GLASS BREAK	1	24 GA. CAT5
(S6)	HEAT DETECTOR	1	16 GA. 24/2
(S7)	SECURITY KEYPAD	1	24 GA. CAT5
(S8)	SECURITY KEYPAD	1	24 GA. CAT5
(S9)	LOW TEMPERATURE	1	24 GA. CAT5
(S10)	MAGNETIC DOOR LOCK	1	16 GA. 24/2
(S11)	NATURAL GAS SENSOR	1	24 GA. CAT5
(S12)	PASSIVE INFRARED MOTION SENSOR	1	24 GA. CAT5
(S13)	SMOKE DETECTOR	1	16 GA. 24/2
(S14)	SPRINKLER	1	24 GA. CAT5
(S15)	EXTERIOR STROBE	1	24 GA. CAT5
(S16)	WINDOW CONTACT OR WINDOW SENSING CONTACT	1	24 GA. CAT5
(S17)	WATER SENSOR	1	24 GA. CAT5
XX.XX.XX	SPECIALTY	WIRING	
(SP1)	AUDIO SOURCE COMPONENT	1	24 GA. CAT5
(SP2)	EQUIPMENT CONTROL OR SPA AND HOT TUB CONTROL	1	24 GA. CAT5
(SP3)	FIREPLACE CONTROL	1	16 GA. 24/2
(SP4)	SPECIALTY HEADEND	1	16 GA. 24/2
(SP5)	AUDIO NET	1	24 GA. CAT5
(SP6)	POWERED SUBWOOFER	1	16 GA. 24/2
(SP7)	RELAY	1	16 GA. 24/2
(SP8)	IN-WALL TOUCHSCREEN	1	24 GA. CAT5
XX.XX.XX	VIDEO POINT COMMUNICATION	WIRING	
(V1)	VIDEO POINT COMMUNICATION	1	24 GA. CAT5
(V2)	VIDEO POINT COMMUNICATION	1	24 GA. CAT5
(V3)	VIDEO POINT COMMUNICATION	1	24 GA. CAT5
(V4)	VIDEO POINT COMMUNICATION	1	24 GA. CAT5
(V5)	VIDEO POINT COMMUNICATION	1	24 GA. CAT5
(V6)	VIDEO POINT COMMUNICATION	1	24 GA. CAT5
(V7)	VIDEO POINT COMMUNICATION	1	24 GA. CAT5
(V8)	VIDEO POINT COMMUNICATION	1	24 GA. CAT5
(V9)	VIDEO POINT COMMUNICATION	1	24 GA. CAT5
(V10)	VIDEO POINT COMMUNICATION	1	24 GA. CAT5
(V11)	VIDEO POINT COMMUNICATION	1	24 GA. CAT5
(V12)	VIDEO POINT COMMUNICATION	1	24 GA. CAT5
(V13)	VIDEO POINT COMMUNICATION	1	24 GA. CAT5
(V14)	VIDEO POINT COMMUNICATION	1	24 GA. CAT5
(V15)	VIDEO POINT COMMUNICATION	1	24 GA. CAT5
(V16)	VIDEO POINT COMMUNICATION	1	24 GA. CAT5
(V17)	VIDEO POINT COMMUNICATION	1	24 GA. CAT5
(V18)	VIDEO POINT COMMUNICATION	1	24 GA. CAT5
(V19)	VIDEO POINT COMMUNICATION	1	24 GA. CAT5
(V20)	VIDEO POINT COMMUNICATION	1	24 GA. CAT5
(V21)	VIDEO POINT COMMUNICATION	1	24 GA. CAT5
(V22)	VIDEO POINT COMMUNICATION	1	24 GA. CAT5
(V23)	VIDEO POINT COMMUNICATION	1	24 GA. CAT5
(V24)	VIDEO POINT COMMUNICATION	1	24 GA. CAT5
(V25)	VIDEO POINT COMMUNICATION	1	24 GA. CAT5
(V26)	VIDEO POINT COMMUNICATION	1	24 GA. CAT5
(V27)	VIDEO POINT COMMUNICATION	1	24 GA. CAT5
(V28)	VIDEO POINT COMMUNICATION	1	24 GA. CAT5
(V29)	VIDEO POINT COMMUNICATION	1	24 GA. CAT5
(V30)	VIDEO POINT COMMUNICATION	1	24 GA. CAT5
(V31)	VIDEO POINT COMMUNICATION	1	24 GA. CAT5
(V32)	VIDEO POINT COMMUNICATION	1	24 GA. CAT5
(V33)	VIDEO POINT COMMUNICATION	1	24 GA. CAT5
(V34)	VIDEO POINT COMMUNICATION	1	24 GA. CAT5
(V35)	VIDEO POINT COMMUNICATION	1	24 GA. CAT5
(V36)	VIDEO POINT COMMUNICATION	1	24 GA. CAT5
(V37)	VIDEO POINT COMMUNICATION	1	24 GA. CAT5
(V38)	VIDEO POINT COMMUNICATION	1	24 GA. CAT5
(V39)	VIDEO POINT COMMUNICATION	1	24 GA. CAT5
(V40)	VIDEO POINT COMMUNICATION	1	24 GA. CAT5
(V41)	VIDEO POINT COMMUNICATION	1	24 GA. CAT5
(V42)	VIDEO POINT COMMUNICATION	1	24 GA. CAT5
(V43)	VIDEO POINT COMMUNICATION	1	24 GA. CAT5
(V44)	VIDEO POINT COMMUNICATION	1	24 GA. CAT5
(V45)	VIDEO POINT COMMUNICATION	1	24 GA. CAT5
(V46)	VIDEO POINT COMMUNICATION	1	24 GA. CAT5
(V47)	VIDEO POINT COMMUNICATION	1	24 GA. CAT5
(V48)	VIDEO POINT COMMUNICATION	1	24 GA. CAT5
(V49)	VIDEO POINT COMMUNICATION	1	24 GA. CAT5
(V50)	VIDEO POINT COMMUNICATION	1	24 GA. CAT5
(V51)	VIDEO POINT COMMUNICATION	1	24 GA. CAT5
(V52)	VIDEO POINT COMMUNICATION	1	24 GA. CAT5
(V53)	VIDEO POINT COMMUNICATION	1	24 GA. CAT5
(V54)	VIDEO POINT COMMUNICATION	1	24 GA. CAT5
(V55)	VIDEO POINT COMMUNICATION	1	24 GA. CAT5
(V56)	VIDEO POINT COMMUNICATION	1	24 GA. CAT5
(V57)	VIDEO POINT COMMUNICATION	1	24 GA. CAT5
(V58)	VIDEO POINT COMMUNICATION	1	24 GA. CAT5
(V59)	VIDEO POINT COMMUNICATION	1	24 GA. CAT5
(V60)	VIDEO POINT COMMUNICATION	1	24 GA. CAT5
(V61)	VIDEO POINT COMMUNICATION	1	24 GA. CAT5
(V62)	VIDEO POINT COMMUNICATION	1	24 GA. CAT5
(V63)	VIDEO POINT COMMUNICATION	1	24 GA. CAT5
(V64)	VIDEO POINT COMMUNICATION	1	24 GA. CAT5
(V65)	VIDEO POINT COMMUNICATION	1	24 GA. CAT5
(V66)	VIDEO POINT COMMUNICATION	1	24 GA. CAT5
(V67)	VIDEO POINT COMMUNICATION	1	24 GA. CAT5
(V68)	VIDEO POINT COMMUNICATION	1	24 GA. CAT5
(V69)	VIDEO POINT COMMUNICATION	1	24 GA. CAT5
(V70)	VIDEO POINT COMMUNICATION	1	24 GA. CAT5
(V71)	VIDEO POINT COMMUNICATION	1	24 GA. CAT5
(V72)	VIDEO POINT COMMUNICATION	1	24 GA. CAT5
(V73)	VIDEO POINT COMMUNICATION	1	24 GA. CAT5
(V74)	VIDEO POINT COMMUNICATION	1	24 GA. CAT5
(V75)	VIDEO POINT COMMUNICATION	1	24 GA. CAT5
(V76)	VIDEO POINT COMMUNICATION	1	24 GA. CAT5
(V77)	VIDEO POINT COMMUNICATION	1	24 GA. CAT5
(V78)	VIDEO POINT COMMUNICATION	1	24 GA. CAT5
(V79)	VIDEO POINT COMMUNICATION	1	24 GA. CAT5
(V80)	VIDEO POINT COMMUNICATION	1	24 GA. CAT5
(V81)	VIDEO POINT COMMUNICATION	1	24 GA. CAT5
(V82)	VIDEO POINT COMMUNICATION	1	24 GA. CAT5
(V83)	VIDEO POINT COMMUNICATION	1	24 GA. CAT5
(V84)	VIDEO POINT COMMUNICATION	1	24 GA. CAT5
(V85)	VIDEO POINT COMMUNICATION	1	24 GA. CAT5
(V86)	VIDEO POINT COMMUNICATION	1	24 GA. CAT5
(V87)	VIDEO POINT COMMUNICATION	1	24 GA. CAT5
(V88)	VIDEO POINT COMMUNICATION	1	24 GA. CAT5
(V89)	VIDEO POINT COMMUNICATION	1	24 GA. CAT5
(V90)	VIDEO POINT COMMUNICATION	1	24 GA. CAT5
(V91)	VIDEO POINT COMMUNICATION	1	24 GA. CAT5
(V92)	VIDEO POINT COMMUNICATION	1	24 GA. CAT5
(V93)	VIDEO POINT COMMUNICATION	1	24 GA. CAT5
(V94)	VIDEO POINT COMMUNICATION	1	24 GA. CAT5
(V95)	VIDEO POINT COMMUNICATION	1	24 GA. CAT5
(V96)	VIDEO POINT COMMUNICATION	1	24 GA. CAT5
(V97)	VIDEO POINT COMMUNICATION	1	24 GA. CAT5
(V98)	VIDEO POINT COMMUNICATION	1	24 GA. CAT5
(V99)	VIDEO POINT COMMUNICATION	1	24 GA. CAT5
(V100)	VIDEO POINT COMMUNICATION	1	24 GA. CAT5

THE INFORMATION AND DESIGN INTENT OF THESE DRAWINGS ARE THE PROPERTY OF AURUM HOME TECHNOLOGIES AND AS SUCH SHALL NOT BE USED IN ANY MANNER WITHOUT PRIOR WRITTEN PERMISSION. THESE DRAWINGS ARE NOT TO BE USED FOR CONSTRUCTION. UNLESS APPROVED BY A LICENSED DESIGN PROFESSIONAL, AND AURUM HOME TECHNOLOGIES DISCLAIMS ANY LIABILITY FOR SUCH UNAUTHORIZED USE.

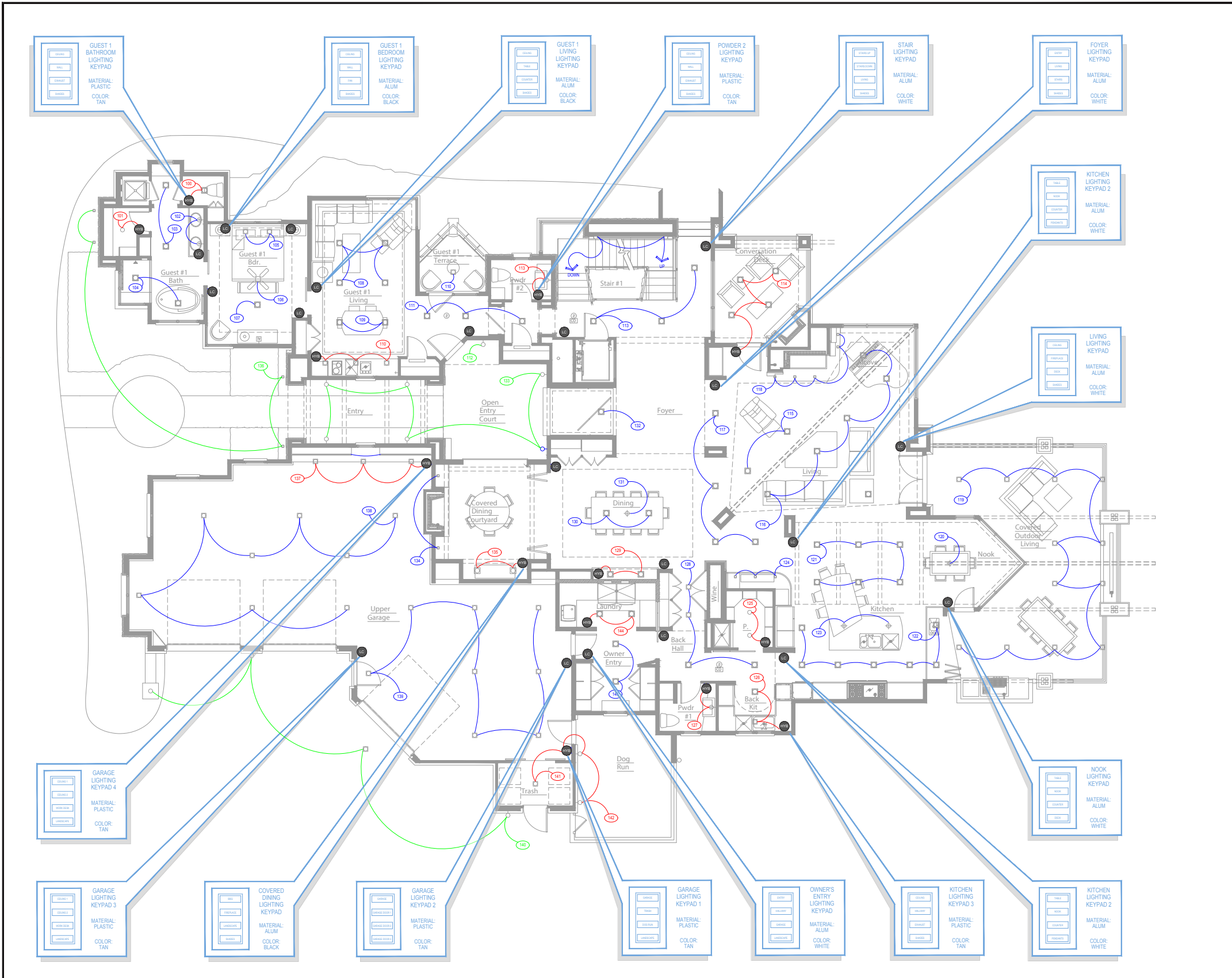

Room/Device	Wiring
XX.XX.XX AUDIO	WIRING
XX.XX.XX HVAC CONTROL	WIRING
XX.XX.XX LIGHTING & SHADES	WIRING
<ul style="list-style-type: none"> <li>CRESTON INFINIT GATEWAY 2x CAT5</li> <li>HYBRID SINGLE COLOR LIGHTING KEYPAD WIRELESS DEVICE</li> <li>HYBRID DOUBLE COLOR LIGHTING KEYPAD WIRELESS DEVICE</li> <li>HYBRID DRIVER LIGHTING KEYPAD WIRELESS DEVICE</li> <li>LIGHTING CONTROL STATION 4x CONDUCTOR LUTRON WIRE</li> <li>LUTRON W/ REPEATER 2x CAT5</li> <li>OCCUPANCY SENSOR 4x CONDUCTOR LUTRON WIRE</li> </ul>	
XX.XX.XX POWER & CONDUIT	WIRING
XX.XX.XX PREWIRE ONLY	WIRING
XX.XX.XX SECURITY	WIRING
XX.XX.XX SPECIALTY	WIRING
XX.XX.XX VIDEO AND COMMUNICATION	WIRING

**AURUM**  
730 S Jason St Unit 18  
Denver, CO 80223  
(303) 558-9050  
aurumhometech.com

**PROJECT DOCUMENTATION**  
TYPICAL DESIGN DRAWINGS

**PROJECT INFO**

NO.	DATE	BY
01	08.01.2017	DMP
02	08.29.2019	DMP
03		
04		
05		
06		
07		
08		

**REVISIONS**

LOWER LEVEL LIGHTING CONTROL AND KEYPAD PLAN

**SHEET TITLE**

LOW VOLTAGE  
**LV-6.0 LIGHTING**

**SHEET NUMBER**

# RESIDENTIAL LIGHTING CONTROL & KEYPAD PLANS

THE INFORMATION AND DESIGN INTENT OF THESE DRAWINGS ARE THE PROPERTY OF AURUM HOME TECHNOLOGIES AND AS SUCH, SHALL NOT BE USED IN ANY MANNER WITHOUT PROPER WRITTEN PERMISSION. THESE DRAWINGS ARE NOT TO BE USED FOR CONSTRUCTION, UNLESS APPROVED BY A LICENSED DESIGN PROFESSIONAL. AURUM HOME TECHNOLOGIES DISCLAIMS ANY LIABILITY FOR SUCH UNAUTHORIZED USE.

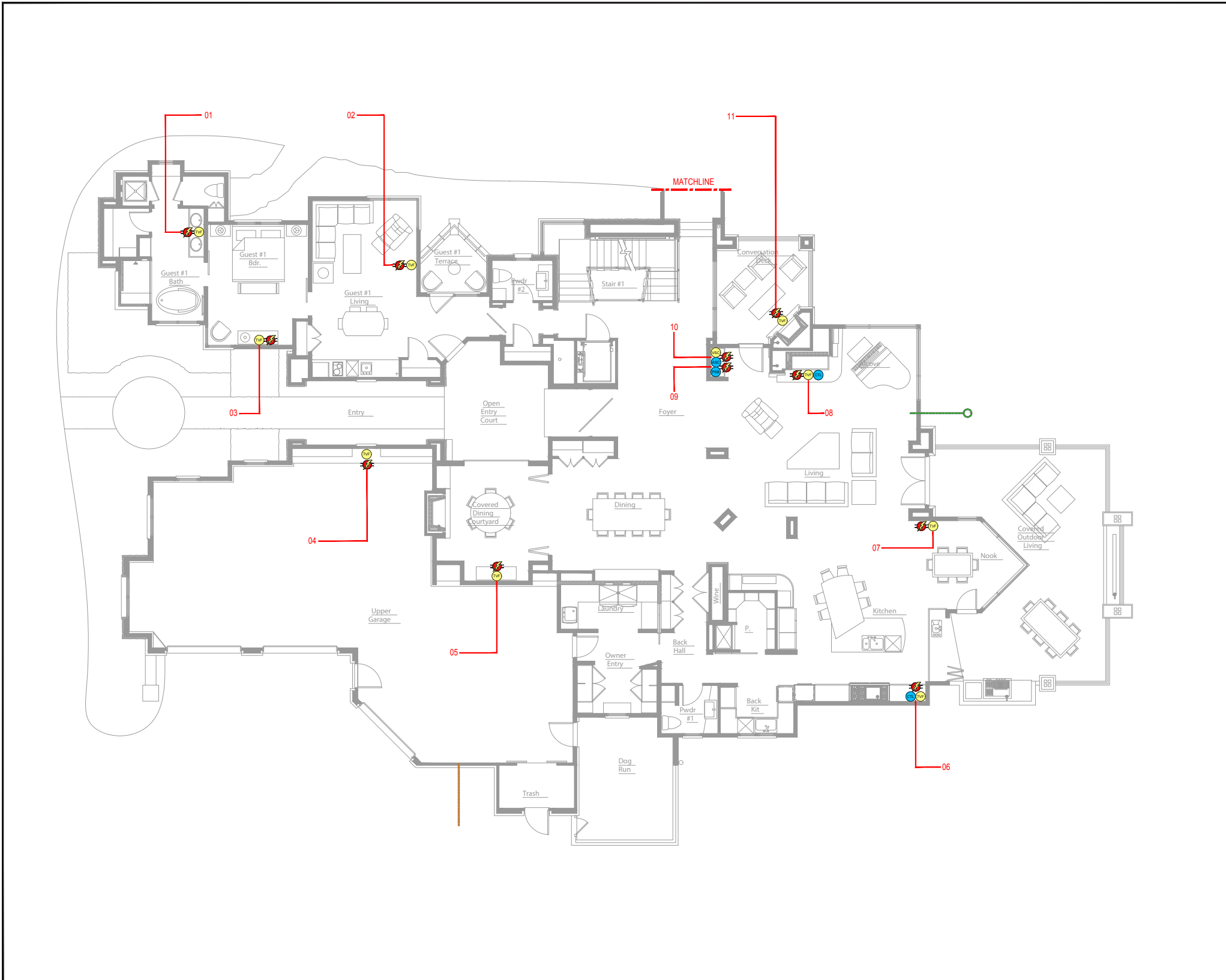

XX.XX.XX	AUDIO	WIRING
01	AUDIO HEADEND	DEDICATED POWER OUTPUT REQUIRED
XX.XX.XX	HVAC CONTROL	WIRING
01	HVAC CONTROL HEADEND	2x CAT5
XX.XX.XX	LIGHTING & SHADCS	WIRING
01	LIGHTING CONTROL HEADEND	2x CAT5
		HOME WIRE
01	SHADE CONTROL HEADEND	2x CAT5
XX.XX.XX	POWER & CONDUIT	WIRING
01	POWER CONDUIT	POWER CONDUIT SYSTEM
02	POWER CONDUIT	POWER CONDUIT SYSTEM
03	POWER CONDUIT	POWER CONDUIT SYSTEM
04	POWER CONDUIT	POWER CONDUIT SYSTEM
05	POWER CONDUIT	POWER CONDUIT SYSTEM
06	POWER CONDUIT	POWER CONDUIT SYSTEM
07	POWER CONDUIT	POWER CONDUIT SYSTEM
08	POWER CONDUIT	POWER CONDUIT SYSTEM
09	POWER CONDUIT	POWER CONDUIT SYSTEM
10	POWER CONDUIT	POWER CONDUIT SYSTEM
11	POWER CONDUIT	POWER CONDUIT SYSTEM
XX.XX.XX	PREWIRE ONLY	WIRING
01	PREWIRE PROJECTOR	2x CAT5 AND 1x RG6
02	PREWIRE SUBWOOFER LOCATION	1x 4 AND 1x RG6
03	PREWIRE TV LOCATION	2x CAT5 AND 1x RG6
XX.XX.XX	SECURITY	WIRING
01	SECURITY HEADEND	2x CAT5
XX.XX.XX	SPECIALTY	WIRING
01	AUDIO SOURCE COMPONENT	2x CAT5
02	EQUIPMENT CONTROL OR SPA	2x CAT5
03	SPECIALTY HEADEND	DEDICATED POWER OUTPUT REQUIRED
04	AUDIO NET	2x CAT5, DIGITAL, RG6 AND 1x CAT5
05	POWERED SUBWOOFER	1x CAT5 AND 1x RG6
XX.XX.XX	VIDEO AND COMMUNICATION	WIRING
01	PROJECTOR WITH IRM REMOTE	2x CAT5 AND 1x RG6
02	BASIC TELEVISION	1x CAT5
03	BASIC TELEVISION-DATA	1x CAT5 AND 1x RG6
04	STANDARD TV LOCATION	2x CAT5 AND 1x RG6
05	TYPICAL AURUM TV LOCATION	1x CAT5 AND 1x RG6
06	FIBER TV LOCATION	1x CAT5 AND 1x RG6
07	VIDEO DISPLAY	1x CAT5 AND 1x RG6
08	VIDEO AND COMM HEADEND	DEDICATED POWER OUTPUT REQUIRED
09	VIDEO SOURCE COMPONENT	1x CAT5 AND 1x CAT5 SHIELD

**AURUM**  
730 S Jason St Unit 18  
Denver, CO 80223  
(303) 558-9050  
aurumhometech.com

**PROJECT DOCUMENTATION**  
TYPICAL DESIGN DRAWINGS

**PROJECT INFO**

NO.	DATE	BY
01	08.01.2017	DMP
02	08.29.2019	DMP
03		
04		
05		
06		
07		
08		

**REVISIONS**

**LOWER LEVEL DEVICE LOCATION POWER PLAN**  
SHEET TITLE

**LOW VOLTAGE LV-4.0 POWER**  
SHEET NUMBER



THE INFORMATION AND DESIGN INTENT OF THESE DRAWINGS ARE THE PROPERTY OF AURUM HOME TECHNOLOGIES AND AS SUCH, SHALL NOT BE USED IN ANY MANNER WITHOUT PRIOR WRITTEN PERMISSION. THESE DRAWINGS ARE NOT TO BE USED FOR CONSTRUCTION. IN ESS APPROVED BY A LICENSED DESIGN PROFESSIONAL, AND AURUM HOME TECHNOLOGIES DISCLAIMS ANY LIABILITY FOR SUCH UNAUTHORIZED USE.

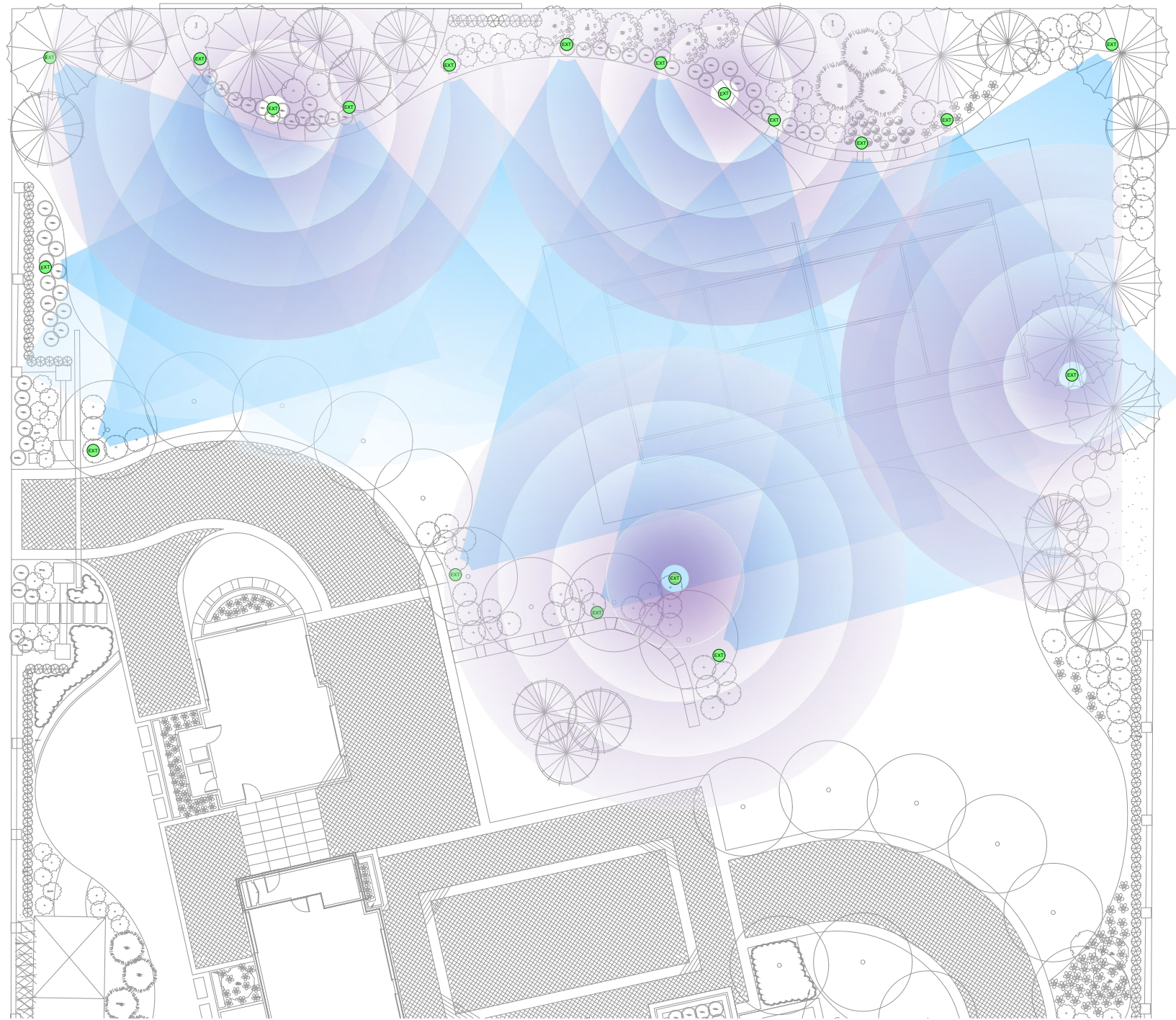

NO.	DESCRIPTION	WIRING
001	AUDIO-HEADER	02 DEDICATED POWER OUTLETS REQUIRED
002	STEREO TV SOUNDBAR OR BOOKSHELF SPEAKER	1x 14 / 4
003	DOORWAY OPENING CEILING SUBWOOFER	1x 14 / 4
004	DOORWAY OPENING CEILING SPEAKER	1x 14 / 4
005	LANDSCAPE SPEAKER	1x 14 / 4 DIRECT BURIAL
006	MULTI-CHANNEL TV SPEAKER	2x 14 / 4
007	WALL OR CEILING SPEAKER	1x 14 / 4
008	IN-WALL SUBWOOFER	1x 14 / 4
009	THEATER WALL SPEAKER	1x 12 / 2
010	THEATER WALL SUBWOOFER	1x 12 / 2
011	THEATER WALL SPEAKER	1x 12 / 2
<b>000.XX.XX HVAC CONTROL WIRING</b>		
012	HVAC CONTROL HEADEND	2x CAT6
013	HUMIDITY SENSOR	CAT6
014	THERMOSTAT	CAT6
015	TEMPERATURE SENSOR	CAT6
<b>000.XX.XX LIGHTING &amp; SHADES WIRING</b>		
016	BLACKOUT SHADE OR SOLAR SHADE	4 CONDUCTOR LUTRON WIRE
017	CRESTRON INFINET GATEWAY	2x CAT6
018	HYBRID SINGLE GANG LIGHTING FIXTURE	WIRELESS DEVICE
019	HYBRID DOUBLE GANG LIGHTING FIXTURE	WIRELESS DEVICE
020	HYBRID DIMMER LIGHTING FIXTURE	WIRELESS DEVICE
021	LIGHTING CONTROL STATION	4 CONDUCTOR LUTRON WIRE
022	LIGHTING CONTROL HEADEND	2x CAT6
023	LUTRON RF REPEATER	4 CONDUCTOR LUTRON WIRE
024	MANUAL SHADE	NONE PREC
025	MOTORIZED GARAGE OR ROOM SHADE	4 CONDUCTOR LUTRON WIRE
026	OCCUPANCY SENSOR	4 CONDUCTOR LUTRON WIRE
027	FULL-COVERAGE MOUNTED SHADE	4 CONDUCTOR LUTRON WIRE
028	SHADE CONTROL HEADEND	2x CAT6
<b>000.XX.XX POWER &amp; CONDUIT WIRING</b>		
029	POWER CORE IN-CEILING DETECT (PROVIDED BY ELECTRICIAN)	WIRE WIRELESS HEADEND 1x 14 / 4 2WIRE
030	POWER CORE HEADEND (BACK MOUNTED BY AURUM)	1x 14 / 4 2WIRE
031	POWER CORE HEADEND (BACK MOUNTED BY AURUM)	1x 14 / 4 2WIRE
032	POWER CORE HEADEND (BACK MOUNTED BY AURUM)	1x 14 / 4 2WIRE
033	POWER CORE HEADEND (BACK MOUNTED BY AURUM)	1x 14 / 4 2WIRE
034	POWER CORE HEADEND (BACK MOUNTED BY AURUM)	1x 14 / 4 2WIRE
035	POWER CORE HEADEND (BACK MOUNTED BY AURUM)	1x 14 / 4 2WIRE
036	POWER CORE HEADEND (BACK MOUNTED BY AURUM)	1x 14 / 4 2WIRE
037	POWER CORE HEADEND (BACK MOUNTED BY AURUM)	1x 14 / 4 2WIRE
038	POWER CORE HEADEND (BACK MOUNTED BY AURUM)	1x 14 / 4 2WIRE
039	POWER CORE HEADEND (BACK MOUNTED BY AURUM)	1x 14 / 4 2WIRE
040	POWER CORE HEADEND (BACK MOUNTED BY AURUM)	1x 14 / 4 2WIRE
041	POWER CORE HEADEND (BACK MOUNTED BY AURUM)	1x 14 / 4 2WIRE
042	POWER CORE HEADEND (BACK MOUNTED BY AURUM)	1x 14 / 4 2WIRE
043	POWER CORE HEADEND (BACK MOUNTED BY AURUM)	1x 14 / 4 2WIRE
044	POWER CORE HEADEND (BACK MOUNTED BY AURUM)	1x 14 / 4 2WIRE
045	POWER CORE HEADEND (BACK MOUNTED BY AURUM)	1x 14 / 4 2WIRE
046	POWER CORE HEADEND (BACK MOUNTED BY AURUM)	1x 14 / 4 2WIRE
047	POWER CORE HEADEND (BACK MOUNTED BY AURUM)	1x 14 / 4 2WIRE
048	POWER CORE HEADEND (BACK MOUNTED BY AURUM)	1x 14 / 4 2WIRE
049	POWER CORE HEADEND (BACK MOUNTED BY AURUM)	1x 14 / 4 2WIRE
050	POWER CORE HEADEND (BACK MOUNTED BY AURUM)	1x 14 / 4 2WIRE
<b>000.XX.XX PREWIRED ONLY WIRING</b>		
051	PREWIRED SECURITY CAMERA	2x CAT6
052	PREWIRED DOOR PHONE STATION	2x CAT6 AND 1x 18 / 4
053	PREWIRED TV SOUNDBAR LOCATION AT TV	1x 14 / 4
054	PREWIRED WALL MOUNT WITH HDMI INPUT	1x CAT6 SINGLE WIRE WITH HDMI CABLE (SEE NOTE)
055	PREWIRED WALL MOUNT WITH HDMI INPUT	1x CAT6 SINGLE WIRE WITH HDMI CABLE (SEE NOTE)
056	PREWIRED WALL MOUNT WITH HDMI INPUT	1x CAT6 SINGLE WIRE WITH HDMI CABLE (SEE NOTE)
057	PREWIRED WALL MOUNT WITH HDMI INPUT	1x CAT6 SINGLE WIRE WITH HDMI CABLE (SEE NOTE)
058	PREWIRED WALL MOUNT WITH HDMI INPUT	1x CAT6 SINGLE WIRE WITH HDMI CABLE (SEE NOTE)
059	PREWIRED WALL MOUNT WITH HDMI INPUT	1x CAT6 SINGLE WIRE WITH HDMI CABLE (SEE NOTE)
060	PREWIRED WALL MOUNT WITH HDMI INPUT	1x CAT6 SINGLE WIRE WITH HDMI CABLE (SEE NOTE)
061	PREWIRED WALL MOUNT WITH HDMI INPUT	1x CAT6 SINGLE WIRE WITH HDMI CABLE (SEE NOTE)
062	PREWIRED WALL MOUNT WITH HDMI INPUT	1x CAT6 SINGLE WIRE WITH HDMI CABLE (SEE NOTE)
063	PREWIRED WALL MOUNT WITH HDMI INPUT	1x CAT6 SINGLE WIRE WITH HDMI CABLE (SEE NOTE)
064	PREWIRED WALL MOUNT WITH HDMI INPUT	1x CAT6 SINGLE WIRE WITH HDMI CABLE (SEE NOTE)
065	PREWIRED WALL MOUNT WITH HDMI INPUT	1x CAT6 SINGLE WIRE WITH HDMI CABLE (SEE NOTE)
066	PREWIRED WALL MOUNT WITH HDMI INPUT	1x CAT6 SINGLE WIRE WITH HDMI CABLE (SEE NOTE)
067	PREWIRED WALL MOUNT WITH HDMI INPUT	1x CAT6 SINGLE WIRE WITH HDMI CABLE (SEE NOTE)
068	PREWIRED WALL MOUNT WITH HDMI INPUT	1x CAT6 SINGLE WIRE WITH HDMI CABLE (SEE NOTE)
069	PREWIRED WALL MOUNT WITH HDMI INPUT	1x CAT6 SINGLE WIRE WITH HDMI CABLE (SEE NOTE)
070	PREWIRED WALL MOUNT WITH HDMI INPUT	1x CAT6 SINGLE WIRE WITH HDMI CABLE (SEE NOTE)
<b>000.XX.XX SECURITY WIRING</b>		
071	SECURITY CAMERA	2x CAT6
072	CARBON MONOXIDE	1x 14
073	COMBO CARBON MONOXIDE SMOKE DETECTOR SIREN	1x 14
074	DOOR CONTACT OR GARAGE DOOR CONTACT	2x 14
075	GLASS BREAK	2x 14
076	HEAT DETECTOR	1x 14
077	SECURITY HEADEND	2x CAT6
078	SECURITY KEYING	2x 14
079	LOW TEMPERATURE	2x 14
080	MAGNETIC DOOR LOCK	1x 14
081	NATURAL GAS SENSOR	2x 14
082	PASSIVE INFRARED MOTION SENSOR	2x 14
083	SMOKE DETECTOR	1x 14
084	SIREN ALARM	2x 14
085	EXTERIOR STRIKE	2x 14
086	WINDOW CONTACT OR BROUEN SENSOR CONTACT	2x 14
087	WATER SENSOR	2x 14
<b>000.XX.XX SPECIALTY WIRING</b>		
088	AUDIO SOURCE COMPONENT	2x CAT6
089	CLIMATE CONTROL OR SPA AND HOT TUB CONTROL	2x CAT6
090	FIREPLACE CONTROL	1x 18 / 4
091	SPECIALTY HEADEND	02 DEDICATED POWER OUTLETS REQUIRED
092	ALCOHOL	2x SERIAL DIGITAL RS485 AND 1x CAT6
093	POWERED SUBWOOFER	1x CAT6 AND 1x RS485
094	RELAY	1x 18 / 4
095	IN-WALL TOUCHSCREEN	2x CAT6
<b>000.XX.XX VIDEO AND COMMUNICATION WIRING</b>		
096	AV RECEIVER WITH 5.1 CHANNELS OR FLOOR TELEPHONE	2x CAT6
097	DEMODULATION POINT	4x CAT6 AND 2x RS485
098	DOOR PHONE STATION	2x CAT6 AND 1x 18 / 4
099	TELEVISION WITH HDMI INPUT	1x CAT6 SINGLE WIRE WITH HDMI CABLE (SEE NOTE)
100	SATELLITE DISH LOCATION	1x 18A DIRECT BURIAL AND 2x RS485
101	BASIC TELEVISION	1x CAT6
102	BASIC TELEVISION DATA	1x CAT6 AND 1x RS485
103	STANDARD TV LOCATION	2x CAT6 AND 1x RS485
104	TYPICAL AURUM TV LOCATION	1x CAT6 BURIED, 2x CAT6 AND 1x RS485
105	FIBER TV LOCATION	1x CAT6 BURIED, 1x CAT6, 1x RS485
106	VIDEO DISPLAY	1x CAT6 BURIED, 1x CAT6, 1x RS485
107	VIDEO AND COMM HEADEND	02 DEDICATED POWER OUTLETS REQUIRED
108	VIDEO AND COMM HEADEND	02 DEDICATED POWER OUTLETS REQUIRED
109	VIDEO SOURCE COMPONENT	2x CAT6 AND 1x CAT6 BURIED

**AURUM**  
730 S Jason St Unit 18  
Denver, CO 80223  
(303) 558-9050  
aurumhometech.com

**PROJECT DOCUMENTATION**  
TYPICAL DESIGN DRAWINGS

**PROJECT INFO**

NO.	DATE	BY
01	08.01.2017	DMP
02	08.29.2019	DMP
03		
04		
05		
06		
07		
08		

**REVISIONS**

**EXTERIOR ENTERTAINMENT SITE PLAN**

**SHEET TITLE**

LOW VOLTAGE  
**LV-0.0**  
**SITE**

**SHEET NUMBER**

# RESIDENTIAL OUTDOOR AUDIO DESIGNS

THE INFORMATION AND DESIGN INTENT OF THESE DRAWINGS ARE THE PROPERTY OF AURUM HOME TECHNOLOGIES AND AS SUCH SHALL NOT BE USED IN ANY MANNER WITHOUT PRIOR WRITTEN PERMISSION. THESE DRAWINGS ARE NOT TO BE USED FOR CONSTRUCTION. UNLESS APPROVED BY A LICENSED DESIGN PROFESSIONAL, AND AURUM HOME TECHNOLOGIES DISCLAIMS ANY LIABILITY FOR SUCH UNAUTHORIZED USE.

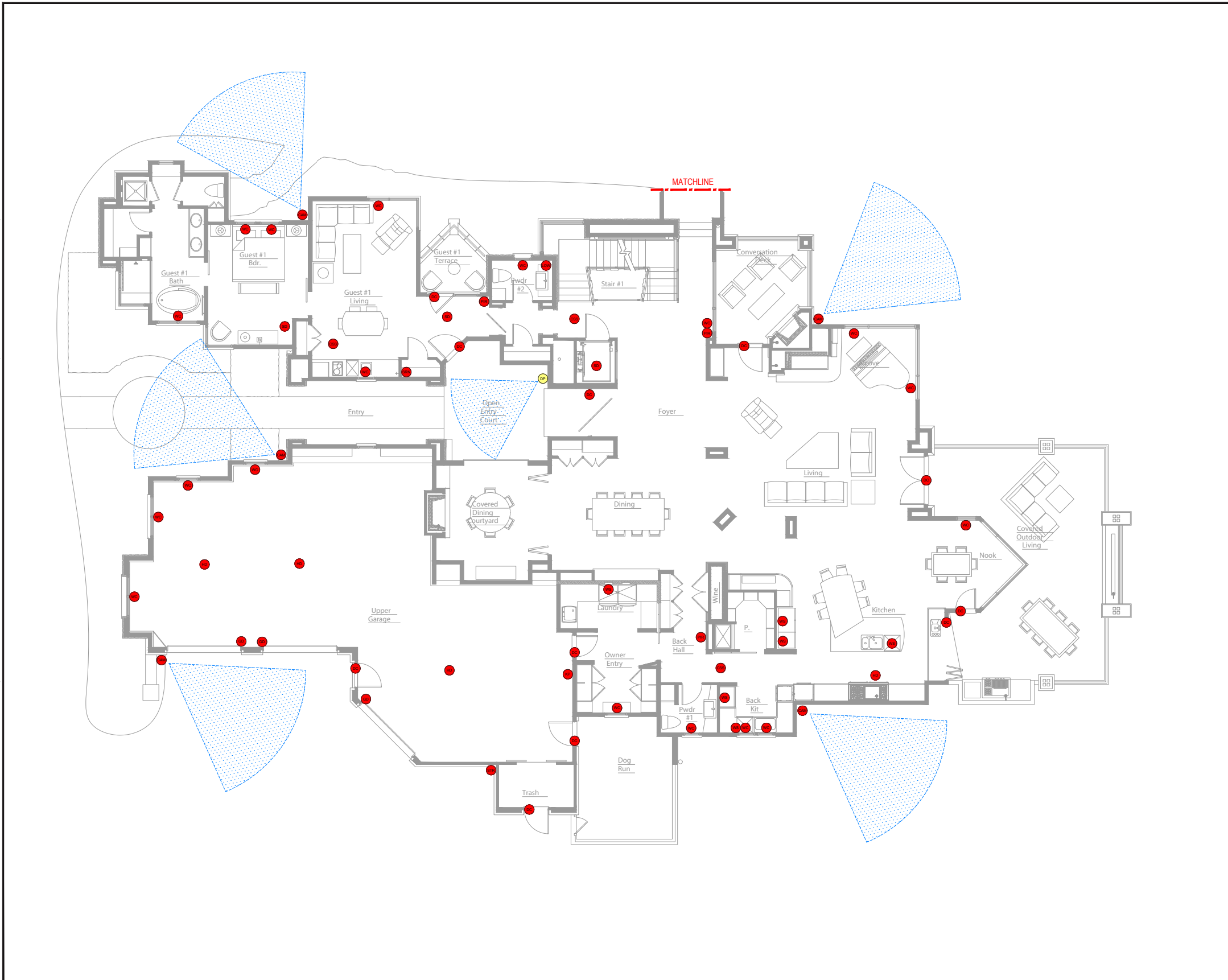

XX.XX.XX	AUDIO	WIRING
XX.XX.XX	MIAC CONTROL	WIRING
XX.XX.XX	LIGHTING & SHADES	WIRING
XX.XX.XX	POWER & CONDUIT	WIRING
XX.XX.XX	PREWIRE ONLY	WIRING
XX.XX.XX	PREWIRE SECURITY CAMERA	2x CAT6
XX.XX.XX	PREWIRE DOOR PHONE STATION	2x CAT6 AND 1x 184
XX.XX.XX	SECURITY	WIRING
●	SECURITY CAMERA	2x CAT6
●	CARBON MONOXIDE	18-4
●	COULM CARBON MONOXIDE SMOKE DETECTOR & SMOKE	18-4
●	DOOR CONTACT OR GARAGE DOOR CONTACT	22-4
●	GLASS BREAK	22-4
●	HEAT DETECTOR	18-4
●	SECURITY HEADEND	2x CAT6
●	SECURITY KEYPAD	22-4
●	LOW TEMPERATURE	22-4
●	MAGNETIC DOOR LOCK	18-4
●	NATURAL GAS SENSOR	22-4
●	PASSIVE INFRARED MOTION SENSOR	22-4
●	SMOKE DETECTOR	18-4
●	SPRINKLER ALARM	22-4
●	EXTERIOR STRIKE	22-4
●	WINDOW CONTACT OR WINDOW FORCED CONTACT	22-4
●	WATER SENSOR	22-4
XX.XX.XX	SPECIALTY	WIRING
XX.XX.XX	VIDEO AND COMMUNICATION	WIRING
●	DOOR PHONE STATION	2x CAT6 AND 1x 184

**AURUM**  
730 S Jason St Unit 18  
Denver, CO 80223  
(303) 558-9050  
aurumhometech.com

**PROJECT DOCUMENTATION**  
TYPICAL DESIGN DRAWINGS

**PROJECT INFO**

NO.	DATE	BY
01	08.01.2017	DMP
02	08.29.2019	DMP
03		
04		
05		
06		
07		
08		

**REVISIONS**

**LOWER LEVEL  
DEVICE LOCATION  
SECURITY PLAN**

**SHEET TITLE**

LOW VOLTAGE  
**LV-5.0  
SECURITY**  
SHEET NUMBER

**RESIDENTIAL SECURITY CAMERA LAYOUTS**

THE INFORMATION AND DESIGN INTENT OF THESE DRAWINGS ARE THE PROPERTY OF AURUM HOME TECHNOLOGIES AND AS SUCH, SHALL NOT BE REPRODUCED IN ANY MANNER WITHOUT PRIOR WRITTEN PERMISSION. THESE DRAWINGS ARE NOT TO BE USED FOR CONSTRUCTION, UNLESS APPROVED BY A LICENSED DESIGN PROFESSIONAL AND AURUM HOME TECHNOLOGIES DISCLAIMS ANY LIABILITY FOR SUCH UNAUTHORIZED USE.

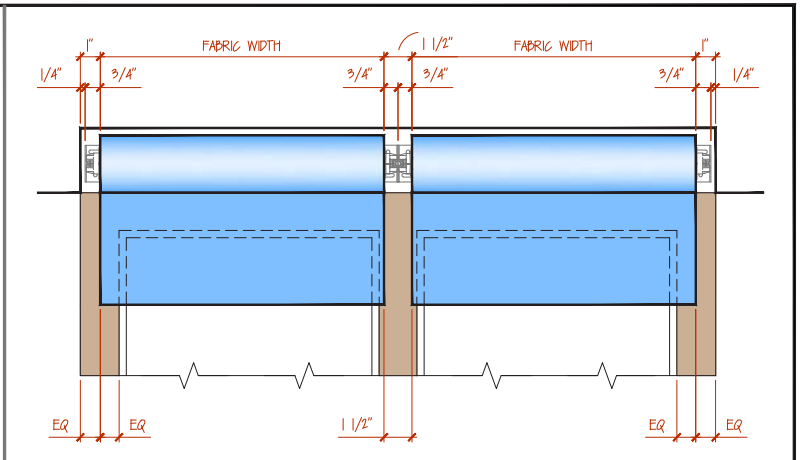
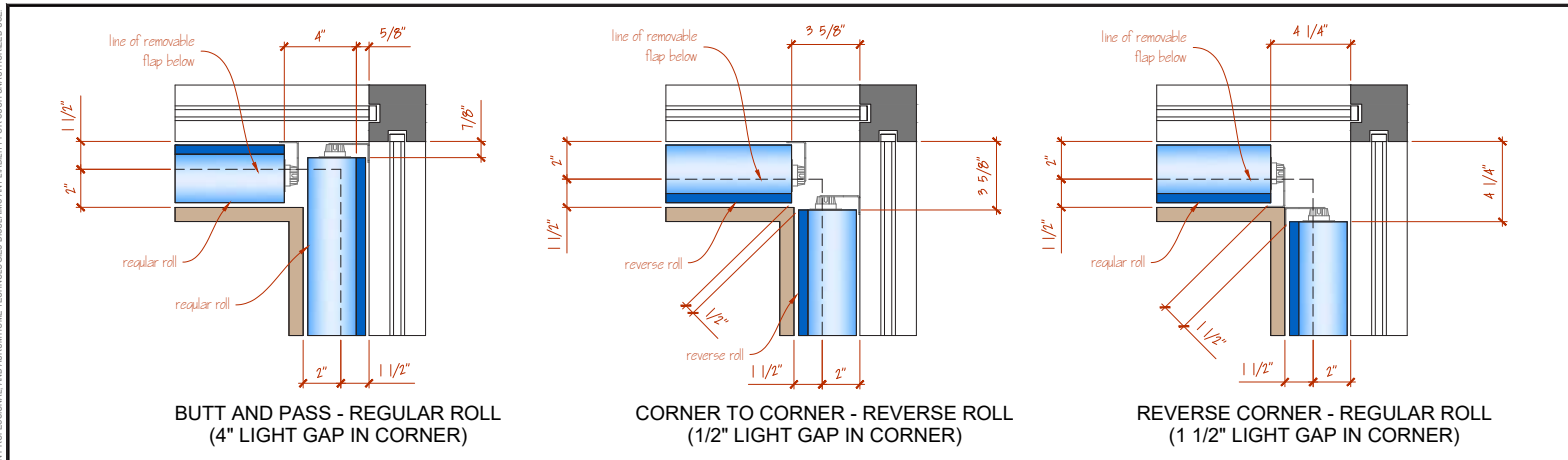

**01 REFLECTED CEILING PLAN - TYPICAL SHADE CORNER CONDITIONS**  
SCALE: 3" = 1'-0" ROLLER 64 OPTIONS

**02 TYPICAL SHADE POCKET ELEVATION WITH WINDOW TRIM OVERLAP**  
SCALE: 3" = 1'-0" TYPICAL FOR ROLLER 64, 100, 100W, 150, 150W, AND 225

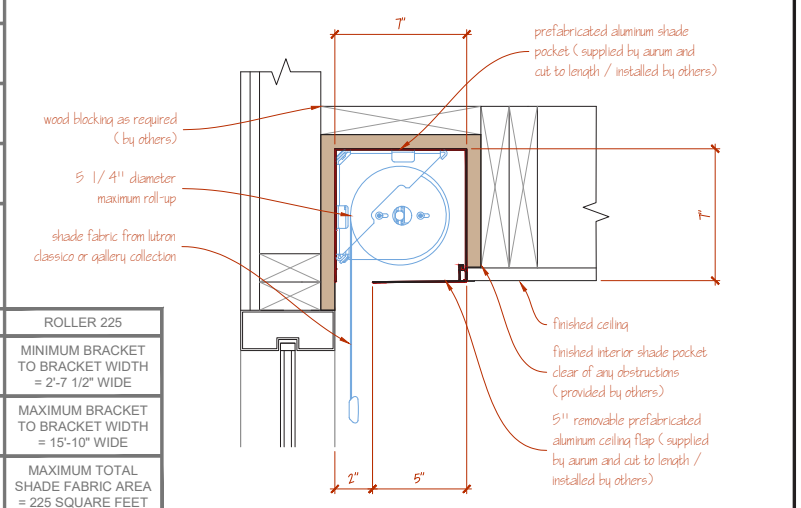
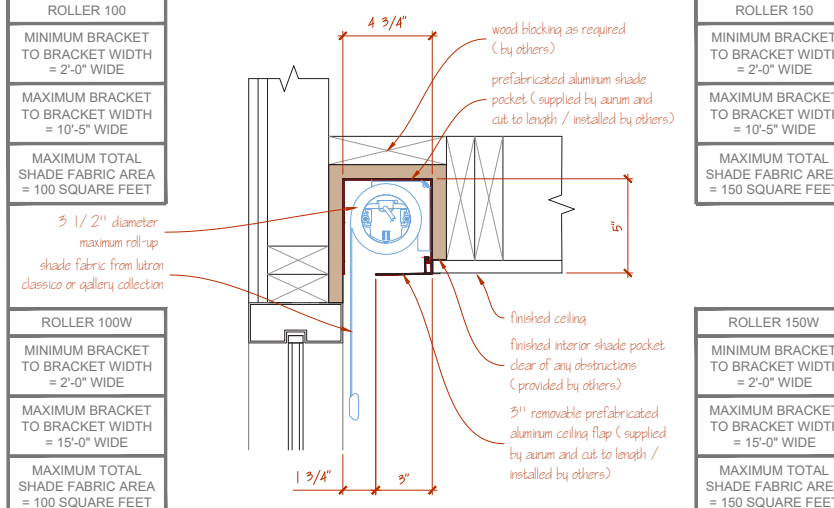
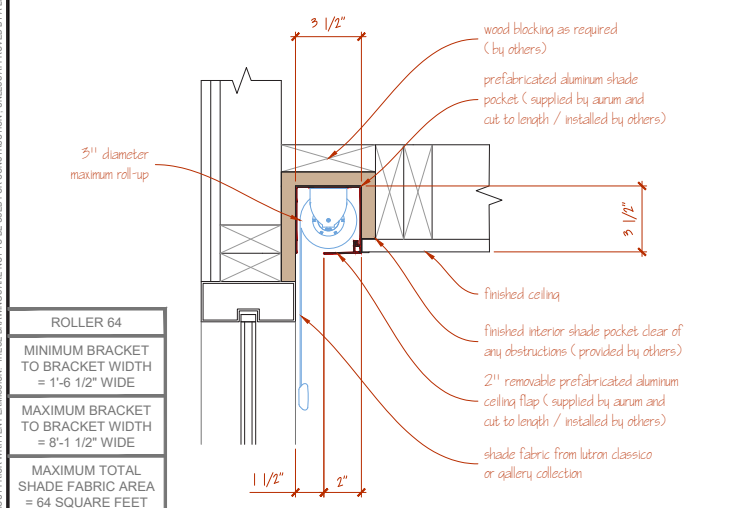

**03 ROLLER 64 - SINGLE REGULAR ROLL SHADE POCKET**  
SCALE: 3" = 1'-0" FINISHED HEAD POCKET SIZE = 3 1/2" WIDE x 3 1/2" HIGH

**04 ROLLER 100, 100W, 150, AND 150W - SINGLE REGULAR ROLL SHADE POCKET**  
SCALE: 3" = 1'-0" FINISHED HEAD POCKET SIZE = 4 3/4" WIDE x 5" HIGH

**05 ROLLER 225 - SINGLE REGULAR ROLL SHADE POCKET**  
SCALE: 3" = 1'-0" FINISHED HEAD POCKET SIZE = 7" WIDE x 7" HIGH

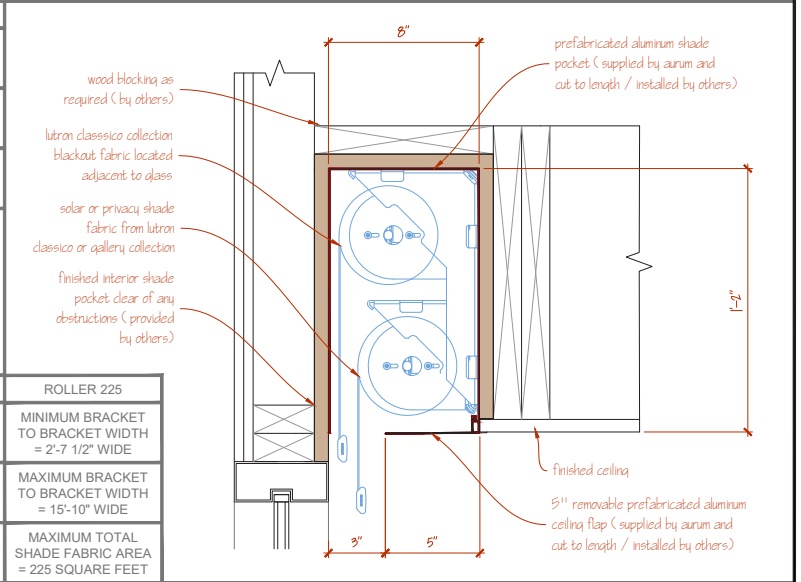
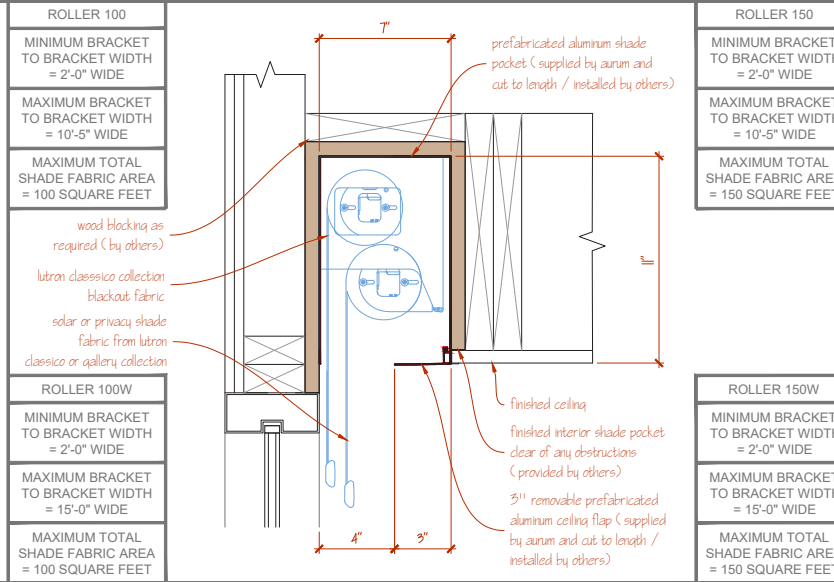
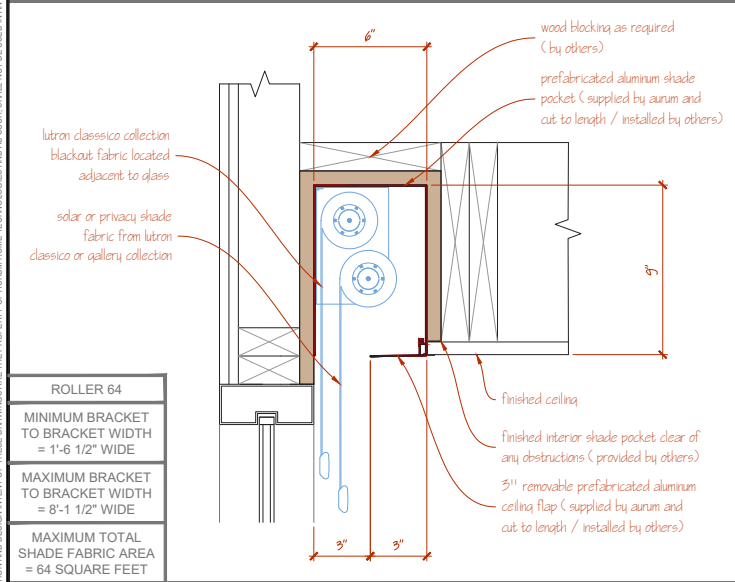

**06 ROLLER 64 - DUAL REGULAR ROLL SHADE POCKET**  
SCALE: 3" = 1'-0" FINISHED HEAD POCKET SIZE = 6" WIDE x 9" HIGH

**07 ROLLER 100, 100W, 150, AND 150W - DUAL REGULAR ROLL SHADE POCKET**  
SCALE: 3" = 1'-0" FINISHED HEAD POCKET SIZE = 7" WIDE x 11" HIGH

**08 ROLLER 225 - DUAL REGULAR ROLL SHADE POCKET**  
SCALE: 3" = 1'-0" FINISHED HEAD POCKET SIZE = 8" WIDE x 14" HIGH

**AURUM**  
730 S Jason St Unit 18  
Denver, CO 80223  
(303) 558-9050  
aurumhometech.com

**PROJECT DOCUMENTATION**  
TYPICAL DESIGN DRAWINGS

PROJECT INFO

NO.	DATE	BY
01	08.01.2017	DMP
02		
03		
04		
05		
06		
07		
08		

REVISIONS

OPERABLE SHADE  
DETAILS AND  
SPACE PLANNING

SHEET TITLE

LOW VOLTAGE  
**LV-9.1**  
SHEET NUMBER

# RESIDENTIAL MOTORIZED WINDOW TREATMENT DETAILS

THE INFORMATION AND DESIGN INTENT OF THESE DRAWINGS ARE THE PROPERTY OF AURUM HOME TECHNOLOGIES AND AS SUCH, SHALL NOT BE USED IN ANY MANNER WITHOUT PRIOR WRITTEN PERMISSION. THESE DRAWINGS ARE NOT TO BE USED FOR CONSTRUCTION, UNLESS APPROVED BY A LICENSED DESIGN PROFESSIONAL AND AURUM HOME TECHNOLOGIES ASSUMES NO LIABILITY FOR SUCH UNAUTHORIZED USE.

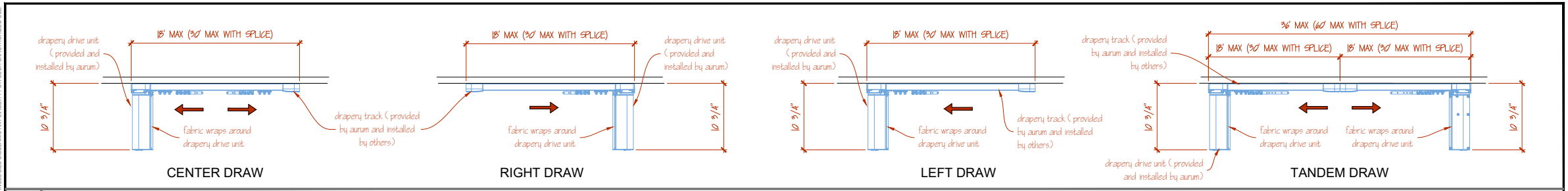

**01 MOTORIZED DRAPERY TRACK DRAW OPTIONS AND MAXIMUM TRACK LENGTHS**  
 SCALE: NONE | FABRIC PROVIDED AND INSTALLED BY OTHERS

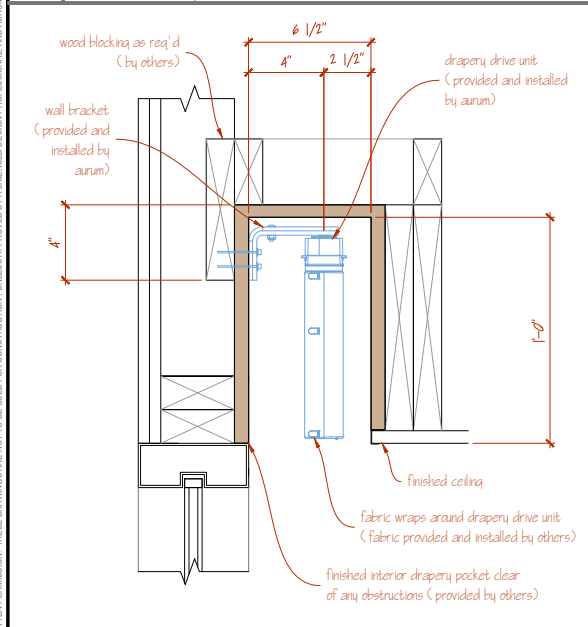

**02 MOTORIZED SINGLE DRAPERY POCKET - MINIMUM**  
 SCALE: 3\"/>

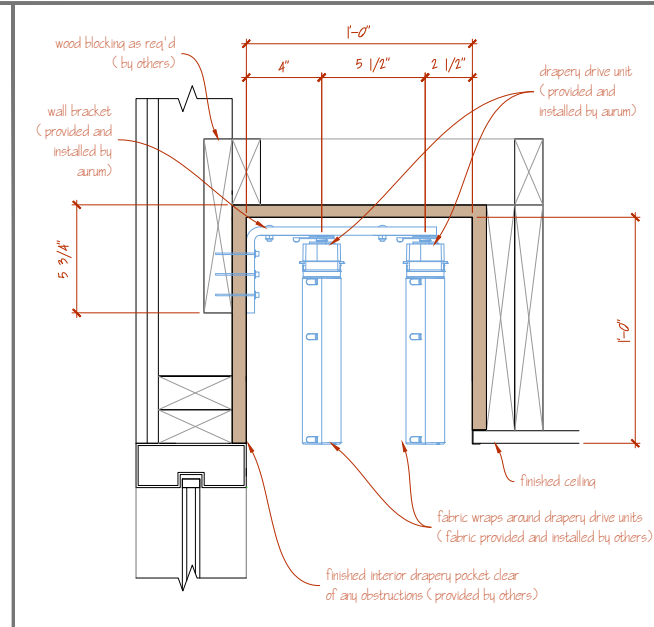

**03 MOTORIZED DUAL DRAPERY POCKET - MINIMUM**  
 SCALE: 3\"/>

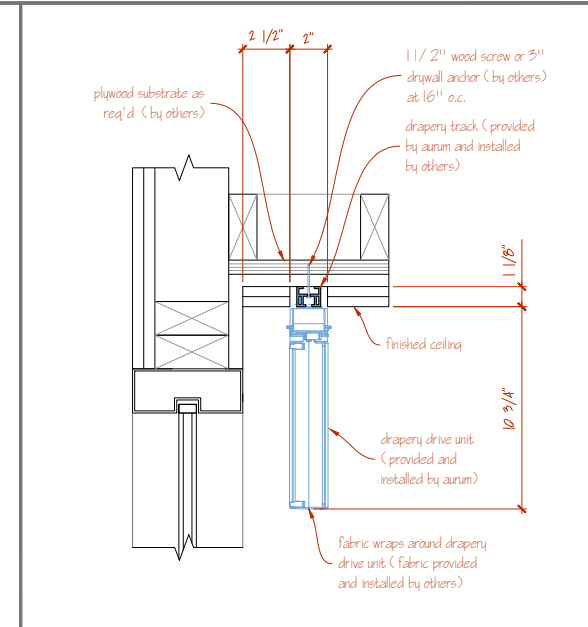

**04 MOTORIZED RECESSED DRAPERY TRACK**  
 SCALE: 3\"/>

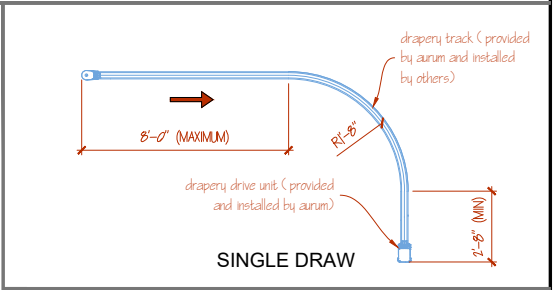

**05 MOTORIZED DRAPERY TRACK - SINGLE BEND**  
 SCALE: NONE | 90 DEGREE MAX BEND WITH 20\"/>

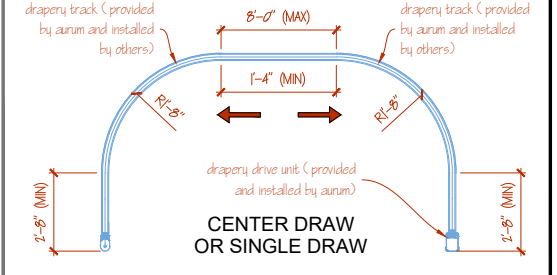

**06 MOTORIZED DRAPERY TRACK - DOUBLE BEND**  
 SCALE: NONE | 90 DEGREE MAX BEND WITH 20\"/>

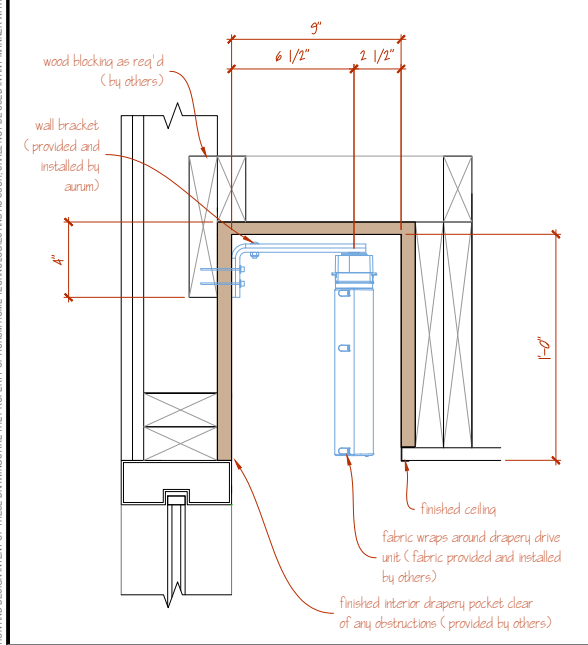

**07 MOTORIZED SINGLE DRAPERY POCKET - MAXIMUM**  
 SCALE: 3\"/>

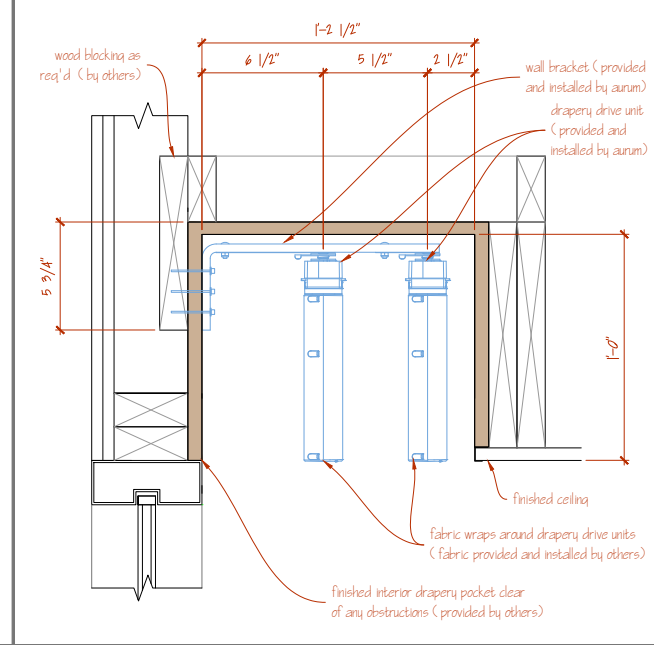

**08 MOTORIZED DUAL DRAPERY POCKET - MAXIMUM**  
 SCALE: 3\"/>

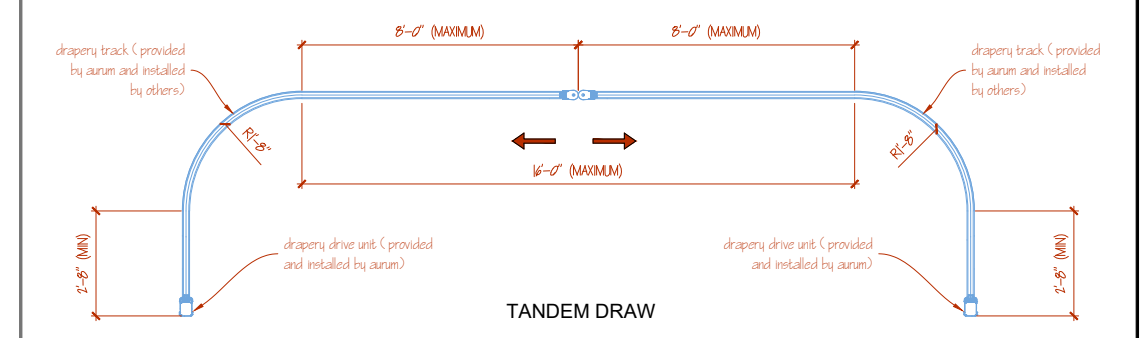

**09 MOTORIZED DRAPERY TRACKS - DOUBLE BEND TANDEM SYSTEM**  
 SCALE: NONE | 90 DEGREE MAX BEND WITH 20\"/>

LUTRON AVANT COLLECTION OR COM FABRIC PROVIDED AND INSTALLED BY OTHERS		LUTRON AVANT COLLECTION OR COM FABRIC PROVIDED AND INSTALLED BY OTHERS	
FULLNESS RATIO OF 3:1 IS ALLOWABLE FOR SHEER ONLY. MAX 2.5:1 RATIO FOR OTHERS		LUTRON RIPPLEFOLD TRACKS ARE AVAILABLE IN 3 FULLNESS FACTORS: 80%, 100%, & 120%	
USE DRAPERY HOOK SETTING OF 1/2\"/>			
TYPICAL PINCH PLEAT DRAPERY STACK DEPTH = 1/3 OF OVERALL SPAN OF DRAPERY TRACK		3 SYSTEMS AVAILABLE: D105 (105 LBS MAX), D145 (150 LBS MAX), & D175 (175 LBS MAX)	
		TYPICAL RIPPLEFOLD DRAPERY STACK DEPTH = 1/3 OF OVERALL SPAN OF DRAPERY TRACK	

**10 PINCH PLEAT DRAPERY INFO**  
 SCALE: NONE | DESIGN, FABRICATION, & INSTALLATION BY OTHERS

**11 RIPPLEFOLD DRAPERY INFO**  
 SCALE: NONE | DESIGN, FABRICATION, & INSTALLATION BY OTHERS

**AURUM**  
 730 S Jason St Unit 18  
 Denver, CO 80223  
 (303) 558-9050  
 aurumhometech.com

**PROJECT DOCUMENTATION**  
 TYPICAL DESIGN DRAWINGS

PROJECT INFO

NO.	DATE	BY
01	08.01.2017	DMP
02		
03		
04		
05		
06		
07		
08		

REVISIONS

MOTORIZED  
 DRAPERY TRACK  
 DETAILS

SHEET TITLE

LOW VOLTAGE  
**LV-9.3**

SHEET NUMBER

# RESIDENTIAL MOTORIZED WINDOW TREATMENT DETAILS

THE INFORMATION AND DESIGN INTENT OF THESE DRAWINGS ARE THE PROPERTY OF AURUM HOME TECHNOLOGIES AND AS SUCH, SHALL NOT BE USED IN ANY MANNER WITHOUT PRIOR WRITTEN PERMISSION. THESE DRAWINGS ARE NOT TO BE USED FOR CONSTRUCTION, UNLESS PROVIDED BY A LICENSED DESIGN PROFESSIONAL, AND AURUM HOME TECHNOLOGIES DISCLAIMS ANY LIABILITY FOR SUCH UNAUTHORIZED USE.

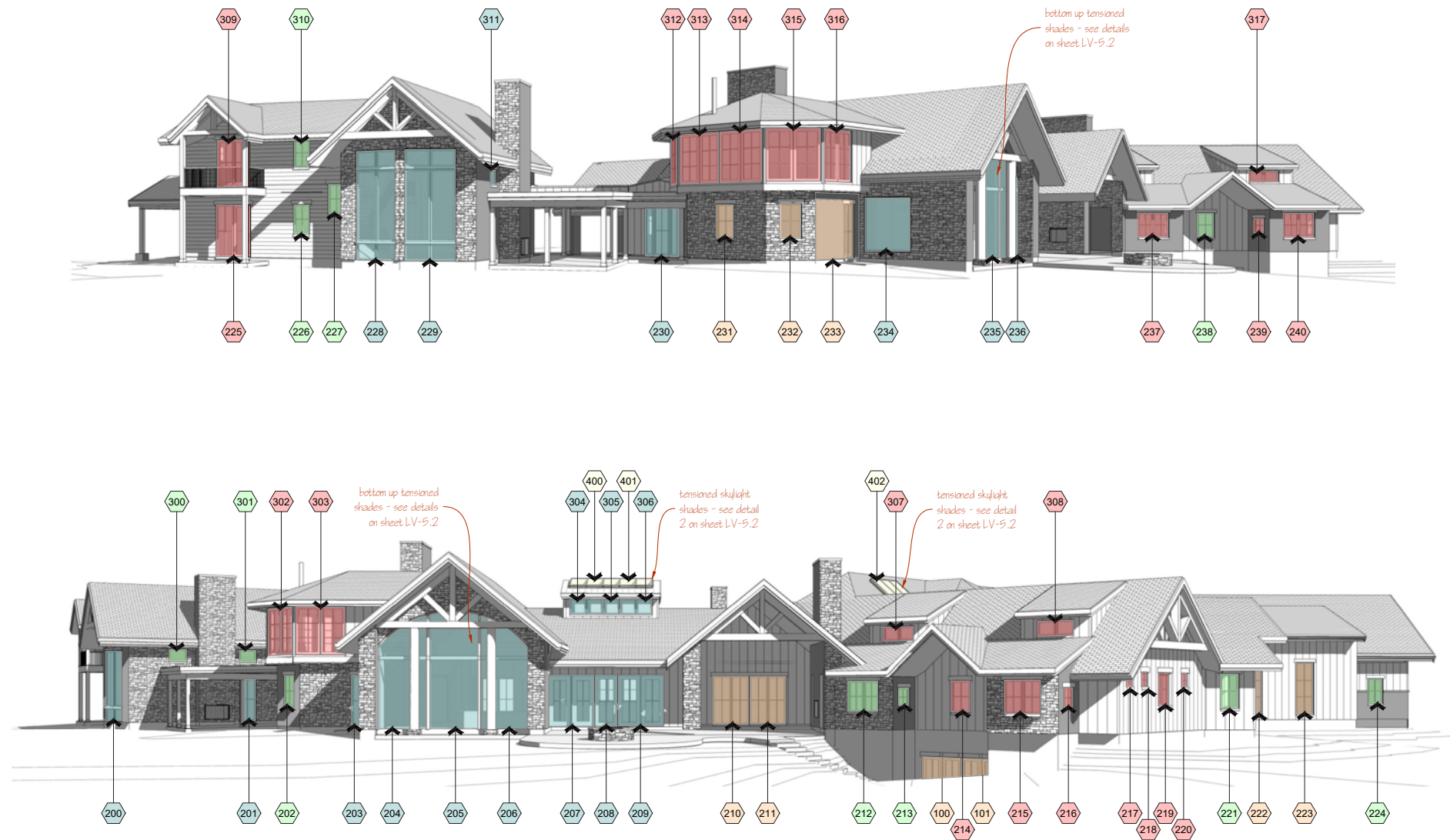

MOTORIZED SINGLE ROLLER SOLAR SHADE SEE DETAILS 3, 4, AND 5 ON SHEET LV-9.1 FOR REQ'D POCKET SIZE	MOTORIZED SINGLE ROLLER PRIVACY SHADE SEE DETAILS 3, 4, AND 5 ON SHEET LV-9.1 FOR REQ'D POCKET SIZE	MOTORIZED DUAL ROLLER SOLAR AND PRIVACY SHADE SEE DETAILS 6, 7, AND 8 ON SHEET LV-9.1 FOR REQ'D POCKET SIZE	MOTORIZED DUAL ROLLER SOLAR AND BLACKOUT SHADE SEE DETAILS 6, 7, AND 8 ON SHEET LV-9.1 FOR REQ'D POCKET SIZE
--	--	--	---

**AURUM**  
730 S Jason St Unit 18  
Denver, CO 80223  
(303) 558-9050  
aurumhometech.com

**PROJECT DOCUMENTATION**  
TYPICAL DESIGN DRAWINGS

**PROJECT INFO**

NO.	DATE	BY
01	08.01.2017	DMP
02		
03		
04		
05		
06		
07		
08		

**REVISIONS**

**WINDOW & SKYLIGHT COVERING TYPES AND LOCATIONS**

**SHEET TITLE**

LOW VOLTAGE

**LV-9.5**

**SHEET NUMBER**

**RESIDENTIAL** MOTORIZED WINDOW TREATMENT DETAILS

THE INFORMATION AND DESIGN INTENT OF THESE DRAWINGS ARE THE PROPERTY OF AURUM HOME TECHNOLOGIES AND AS SUCH, SHALL NOT BE USED IN ANY MANNER WITHOUT PRIOR WRITTEN PERMISSION. THESE DRAWINGS ARE NOT TO BE USED FOR CONSTRUCTION, UNLESS APPROVED BY A LICENSED DESIGN PROFESSIONAL, AND AURUM HOME TECHNOLOGIES DISCLAIMS ANY LIABILITY FOR SUCH UNAUTHORIZED USE.

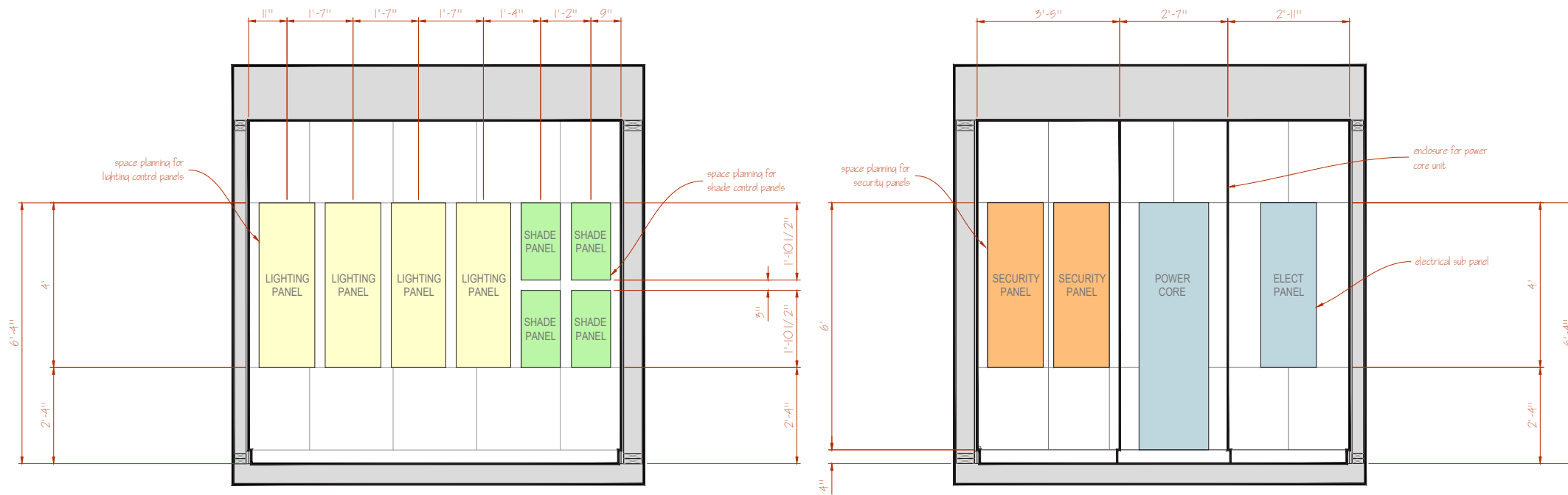

**1** LOW VOLTAGE ROOM - ELEVATION  
SCALE: 3/4" = 1'-0"

**2** LOW VOLTAGE ROOM - ELEVATION  
SCALE: 3/4" = 1'-0"

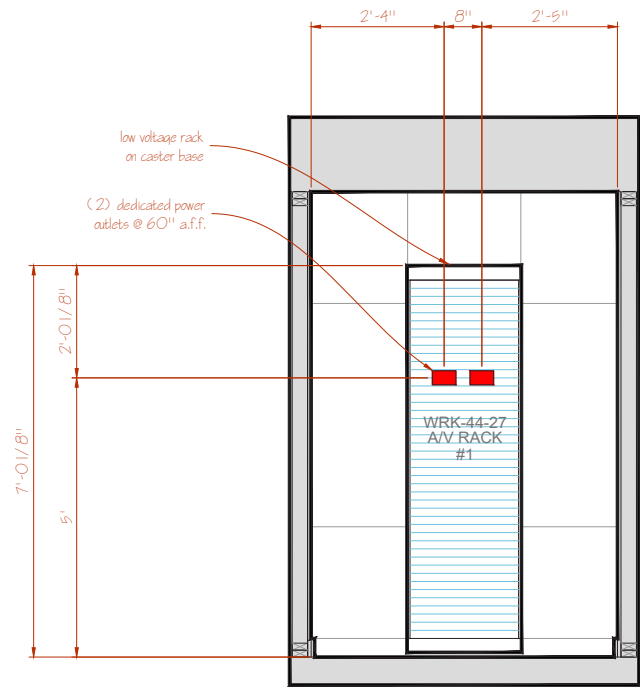

**4** LOW VOLTAGE ROOM - ELEVATION  
SCALE: 3/4" = 1'-0"

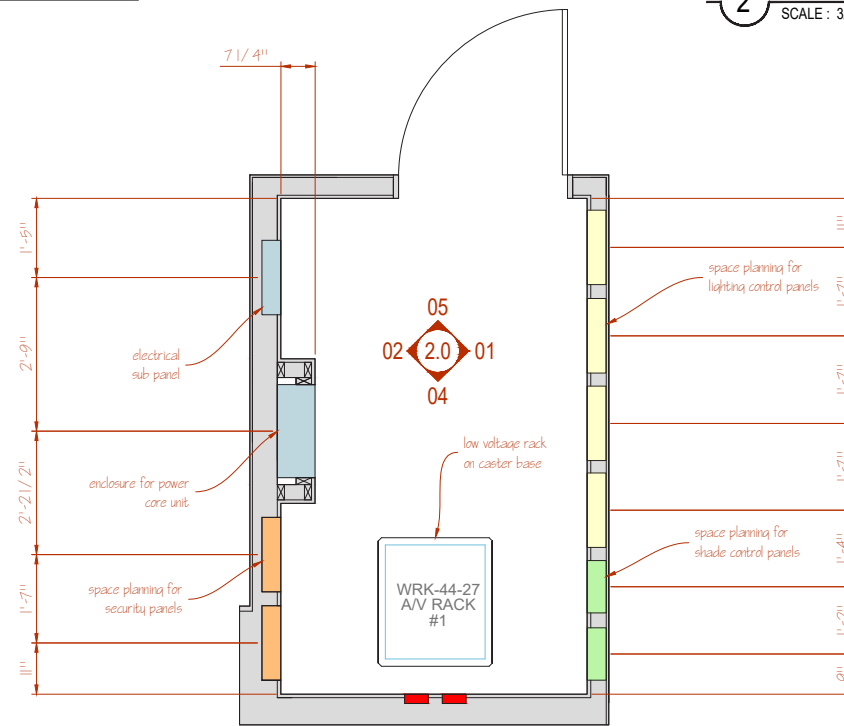

**3** LOW VOLTAGE ROOM - FLOOR PLAN  
SCALE: 3/4" = 1'-0"

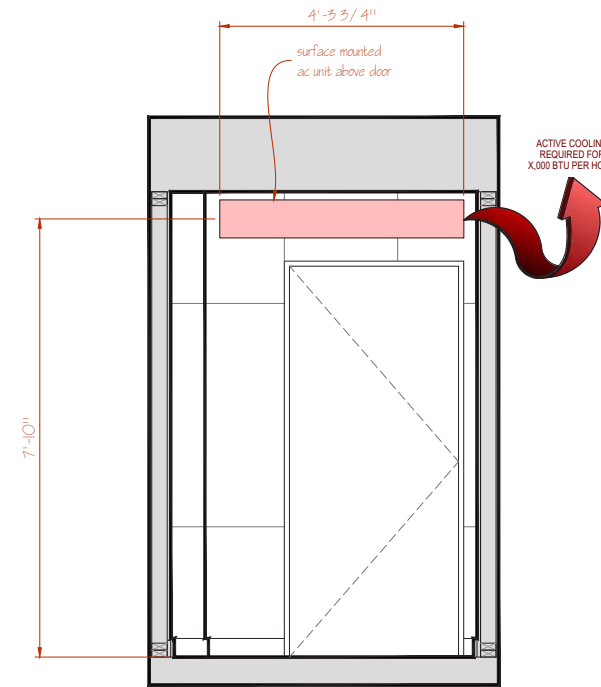

**5** LOW VOLTAGE ROOM - ELEVATION  
SCALE: 3/4" = 1'-0"

**AURUM**  
730 S Jason St Unit 18  
Denver, CO 80223  
(303) 558-9050  
aurumhometech.com

**PROJECT DOCUMENTATION**  
TYPICAL DESIGN DRAWINGS

**PROJECT INFO**

NO.	DATE	BY
01	08.01.2017	DMP
02		
03		
04		
05		
06		
07		
08		

**REVISIONS**

LOW VOLTAGE ROOM SPACE PLANNING

**SHEET TITLE**

LOW VOLTAGE

**LV-10.0**

**SHEET NUMBER**

**RESIDENTIAL MECHANICAL ROOM LAYOUT**

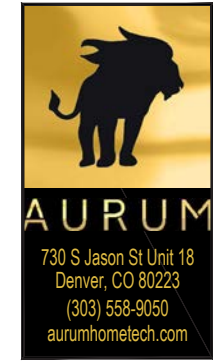

PROJECT DOCUMENTATION  
TYPICAL DESIGN DRAWINGS

PROJECT INFO

NO.	DATE	BY
01	08.01.2017	DMP
02		
03		
04		
05		
06		
07		
08		

REVISIONS

TYPICAL AV  
EQUIPMENT SPACE  
PLANNING

SHEET TITLE

LOW VOLTAGE

SHEET NUMBER

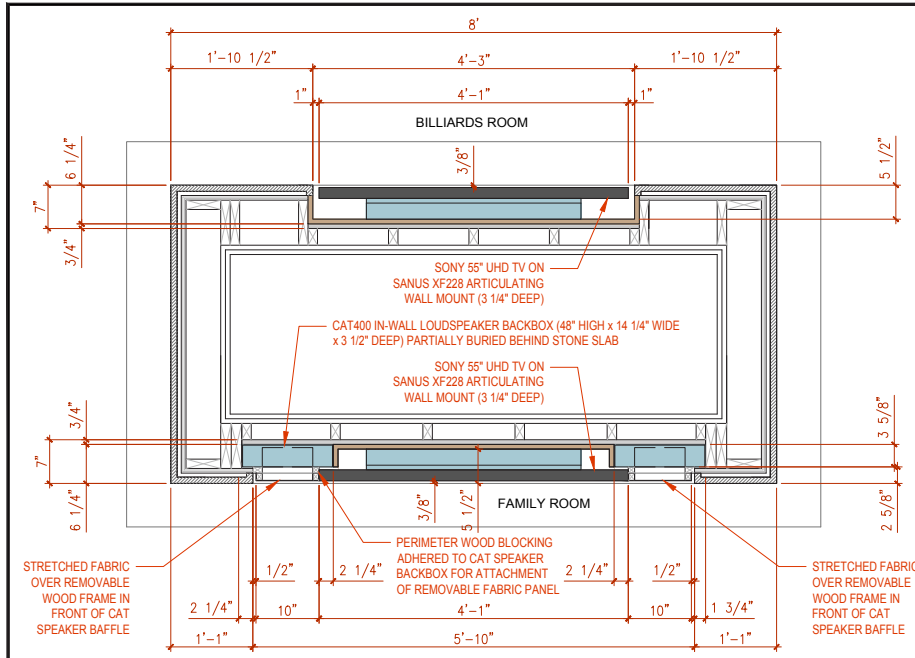

**01 LOWER LEVEL - TV'S OVER DOUBLE SIDED FIREPLACE - PLAN SECTION**  
SCALE: 1" = 1'-0"

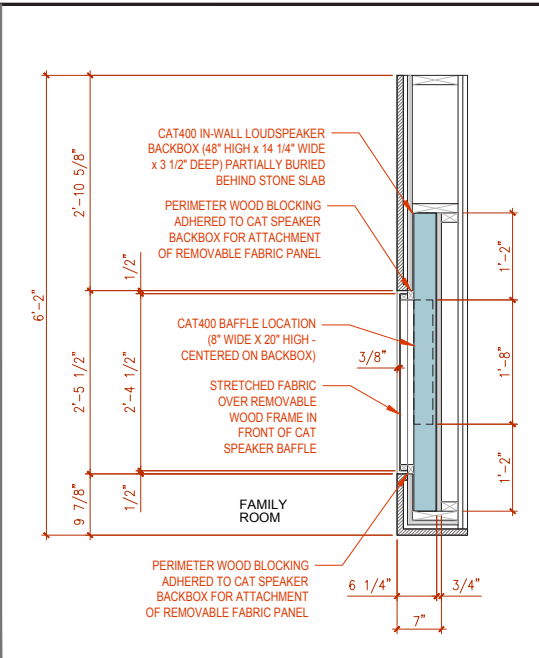

**02 FAMILY ROOM - SECTION THRU SPEAKERS**  
SCALE: 1" = 1'-0"

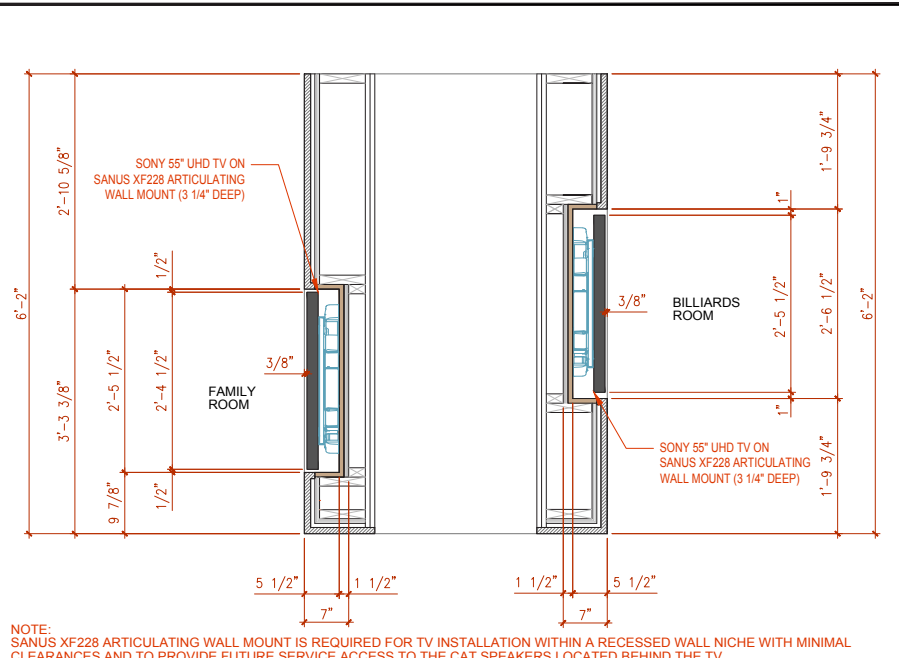

**03 LOWER LEVEL - SECTION THRU TV'S OVER DOUBLE SIDED FIREPLACE**  
SCALE: 1" = 1'-0"

NOTE: SANUS XF228 ARTICULATING WALL MOUNT IS REQUIRED FOR TV INSTALLATION WITHIN A RECESSED WALL NICHE WITH MINIMAL CLEARANCES AND TO PROVIDE FUTURE SERVICE ACCESS TO THE CAT SPEAKERS LOCATED BEHIND THE TV.

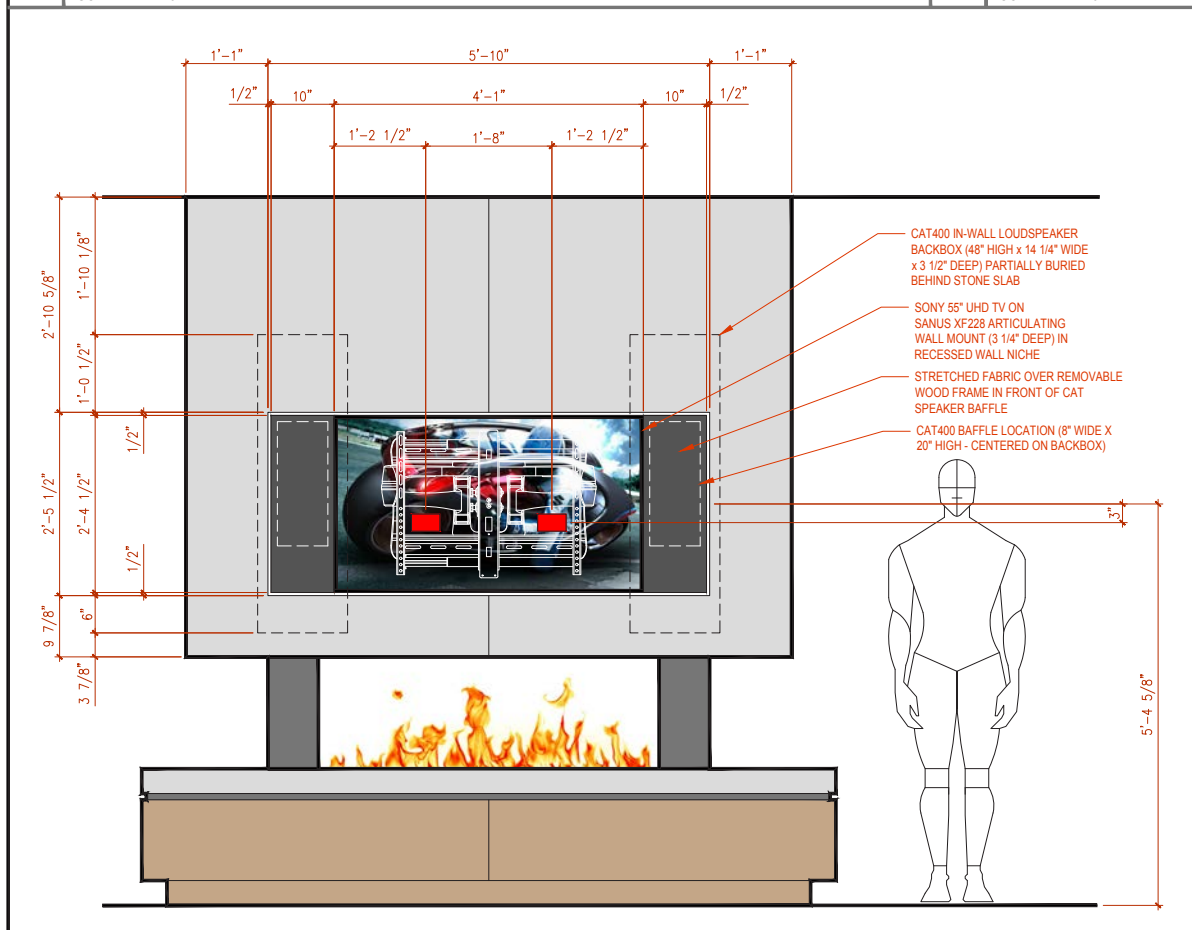

**04 LOWER LEVEL - FAMILY ROOM TV OVER FIREPLACE ELEVATION**  
SCALE: 1" = 1'-0"

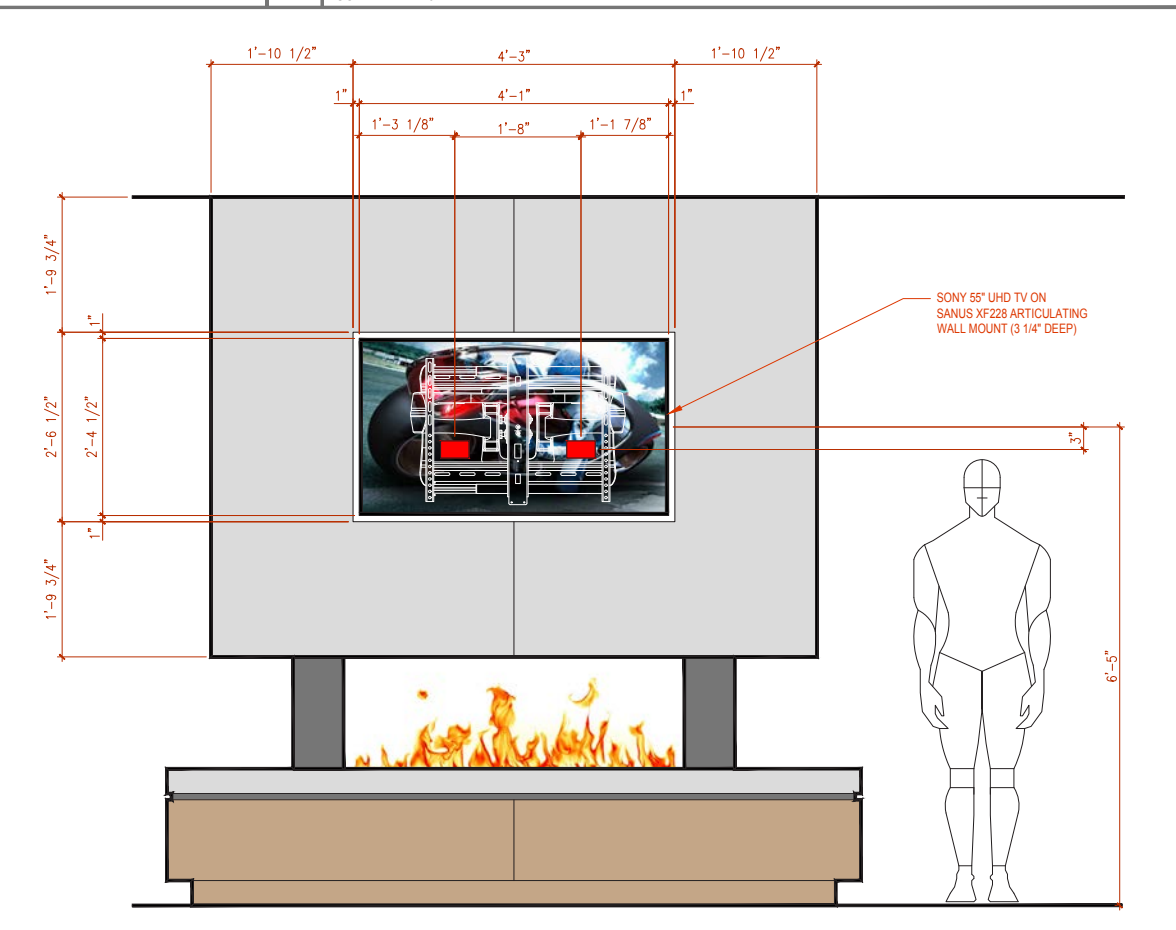

**05 LOWER LEVEL - BILLIARDS ROOM TV OVER FIREPLACE ELEVATION**  
SCALE: 1" = 1'-0"

# RESIDENTIAL MEDIA ROOM ELEVATIONS



NO.	DATE	BY
01	08.01.2017	DMP
02		
03		
04		
05		
06		
07		
08		

REVISIONS

TYPICAL AV  
 EQUIPMENT SPACE  
 PLANNING

SHEET TITLE

LOW VOLTAGE

SHEET NUMBER

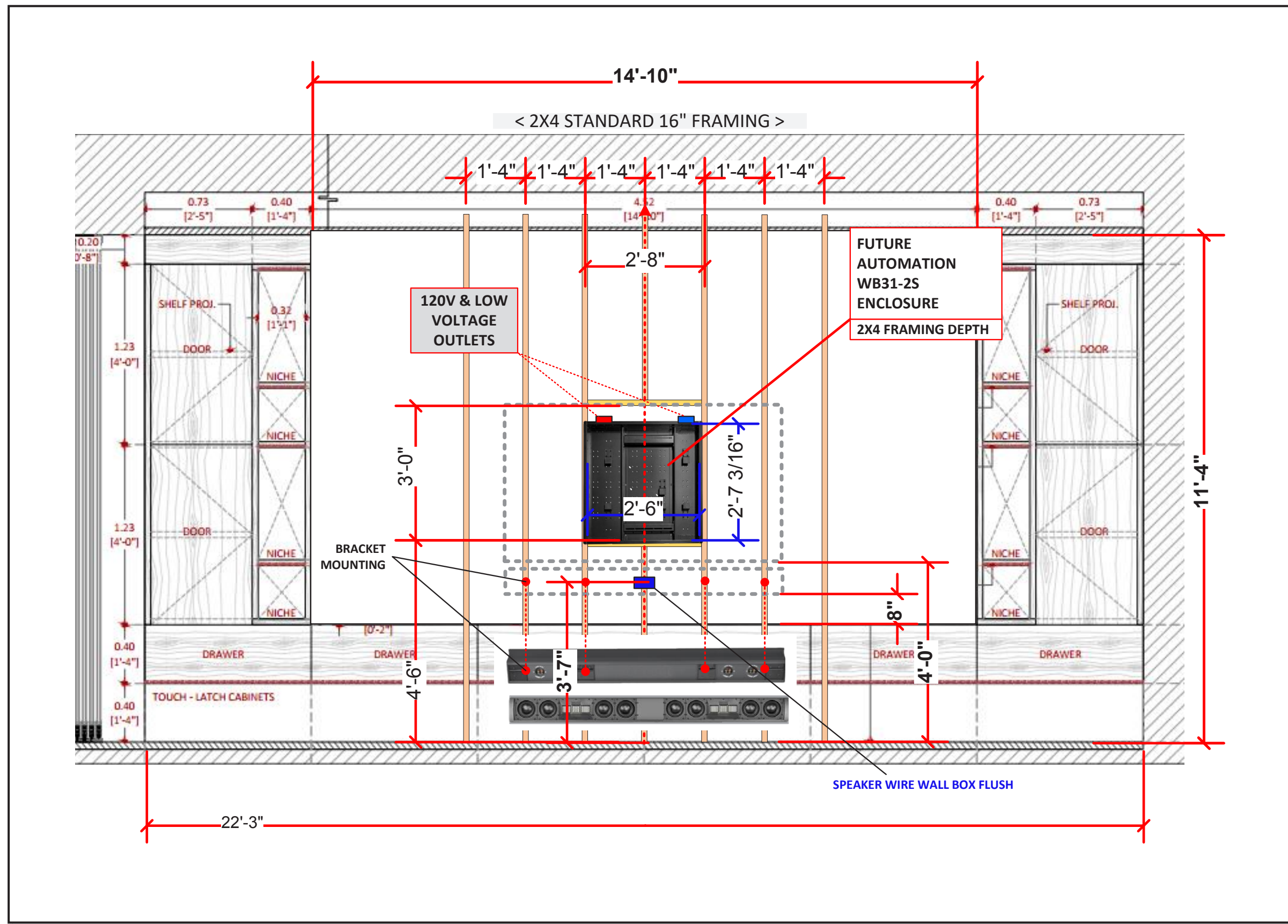



THE INFORMATION AND DESIGN INTENT OF THESE DRAWINGS ARE THE PROPERTY OF AURUM HOME TECHNOLOGIES AND AS SUCH, SHALL NOT BE USED IN ANY MANNER WITHOUT PRIOR WRITTEN PERMISSION. THESE DRAWINGS ARE NOT TO BE USED FOR CONSTRUCTION. UNLESS PROVIDED BY A LICENSED DESIGN PROFESSIONAL, AND AURUM HOME TECHNOLOGIES DISCLAIMS ANY LIABILITY FOR SUCH UNAUTHORIZED USE.

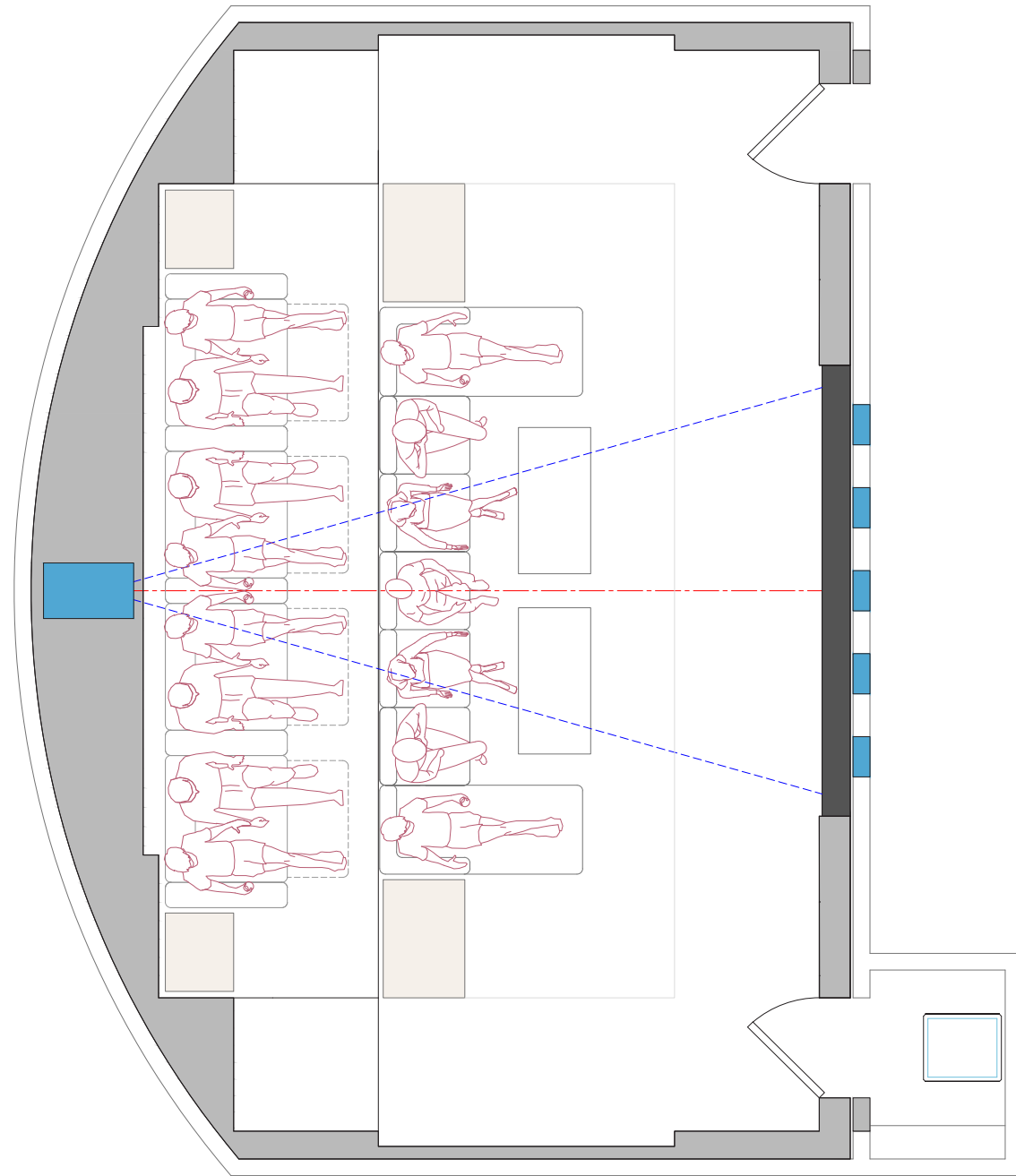

**1** THEATER FLOOR PLAN (15 PEOPLE)  
SCALE: 1/2" = 1'-0"

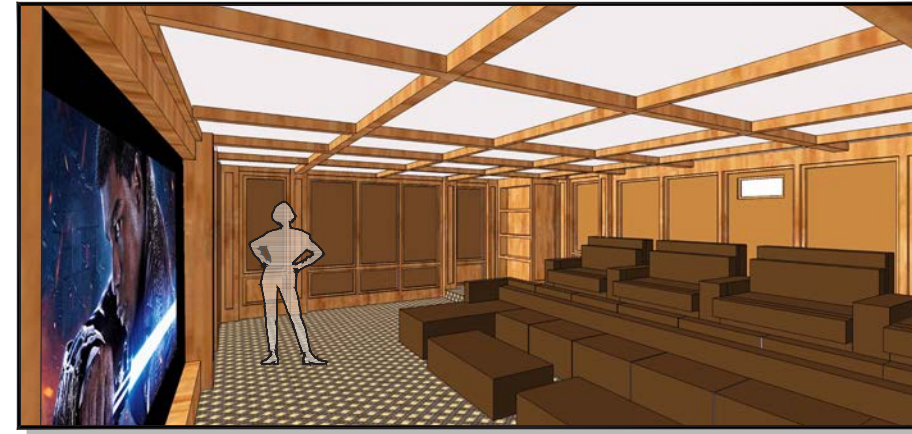

**2** THEATER - INTERIOR PERSPECTIVE  
VIEW FROM THEATER ENTRY DOOR



**3** THEATER - INTERIOR PERSPECTIVE  
VIEW FROM UPPER TIER SEATING

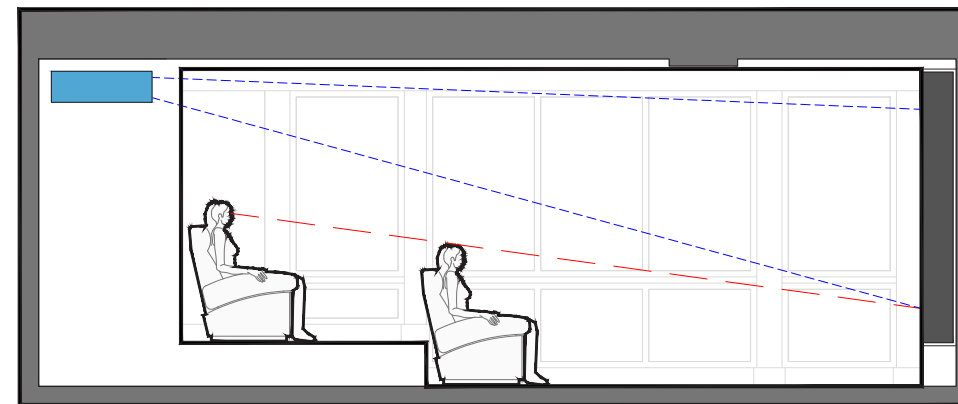

**4** THEATER ROOM SECTION / SIGHTLINES  
SCALE: 1/2" = 1'-0"

**AURUM**  
730 S Jason St Unit 18  
Denver, CO 80223  
(303) 558-9050  
aurumhometech.com

**PROJECT DOCUMENTATION**  
TYPICAL DESIGN DRAWINGS

PROJECT INFO

NO.	DATE	BY
01	08.01.2017	DMP
02		
03		
04		
05		
06		
07		
08		

REVISIONS

HOME THEATER  
DESIGN DRAWINGS

SHEET TITLE

LOW VOLTAGE  
**LV-11.0**  
SHEET NUMBER

# RESIDENTIAL HOME THEATER DESIGNS



**PROJECT DOCUMENTATION**  
TYPICAL DESIGN DRAWINGS

**PROJECT INFO**

NO.	DATE	BY
01	08.01.2017	DMP
02		
03		
04		
05		
06		
07		
08		

**REVISIONS**

**HOME THEATER CONSTRUCTION FLOOR PLAN**  
SHEET TITLE

**LOW VOLTAGE**  
**LV-12.0**  
SHEET NUMBER

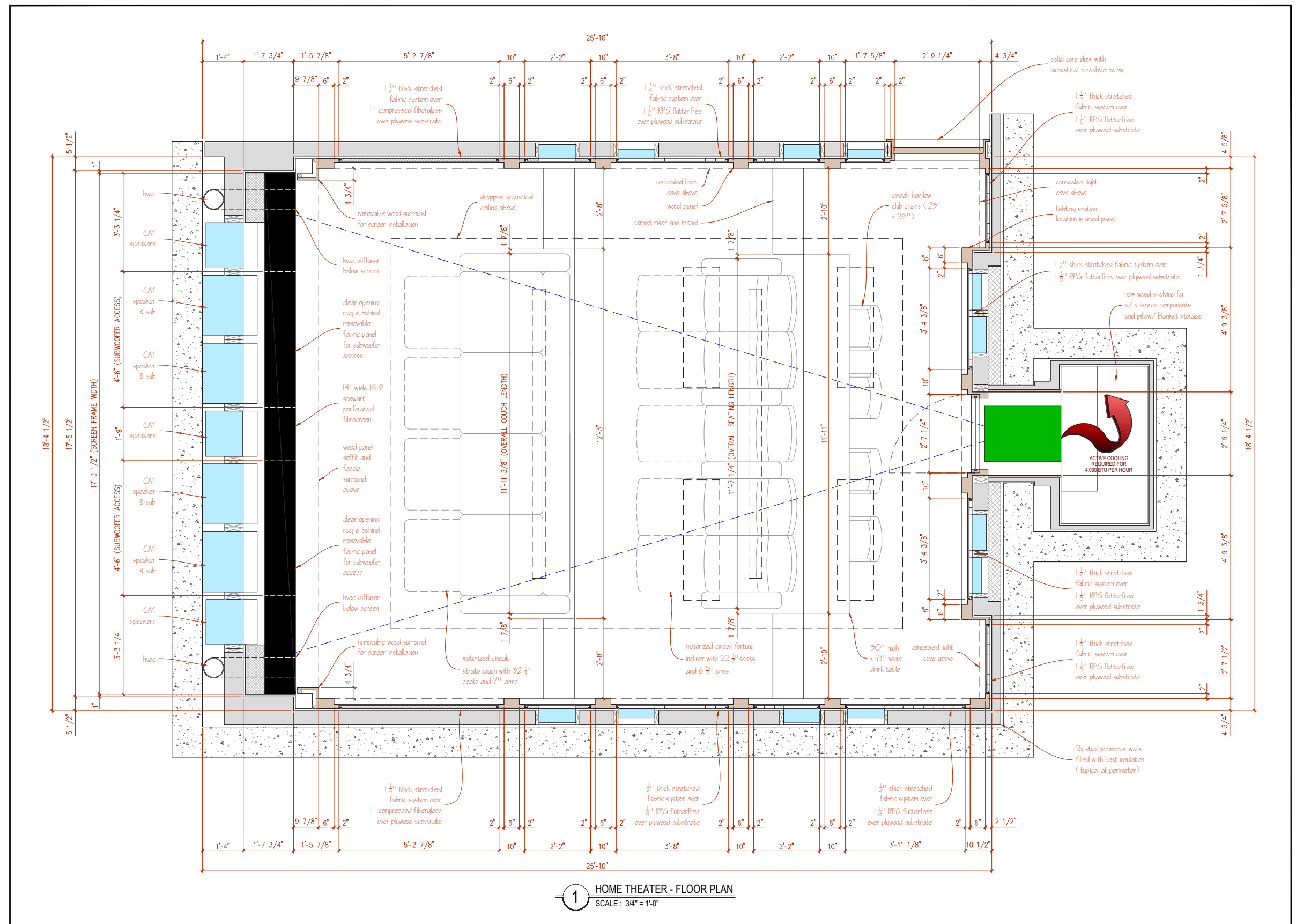

**1 HOME THEATER - FLOOR PLAN**  
SCALE: 3/4" = 1'-0"

THE INFORMATION AND DESIGN INTENT OF THESE DRAWINGS ARE THE PROPERTY OF AURUM HOME TECHNOLOGIES AND AS SUCH, SHALL NOT BE USED IN ANY MANNER WITHOUT PRIOR WRITTEN PERMISSION. THESE DRAWINGS ARE NOT TO BE USED FOR CONSTRUCTION, UNLESS APPROVED BY A LICENSED DESIGN PROFESSIONAL, AND AURUM HOME TECHNOLOGIES DISCLAIMS ANY LIABILITY FOR SUCH UNAUTHORIZED USE.

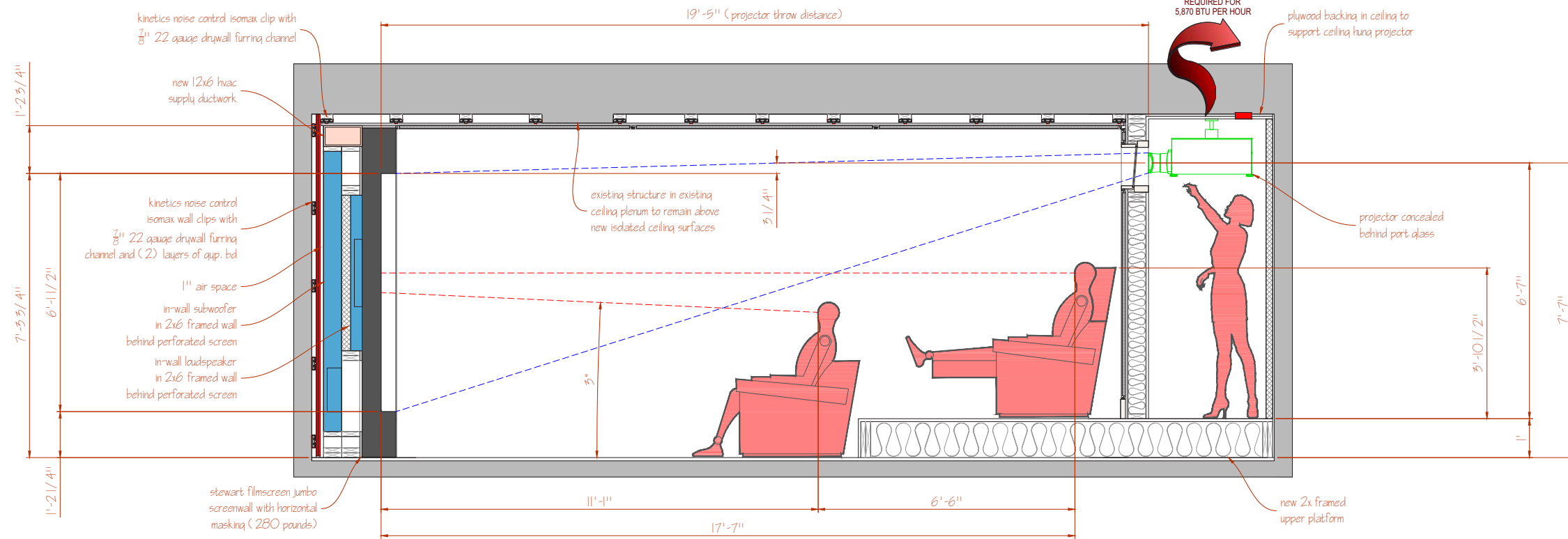

**1 THEATER - ROOM SECTION / SIGHTLINES**  
SCALE: 3/4" = 1'-0"

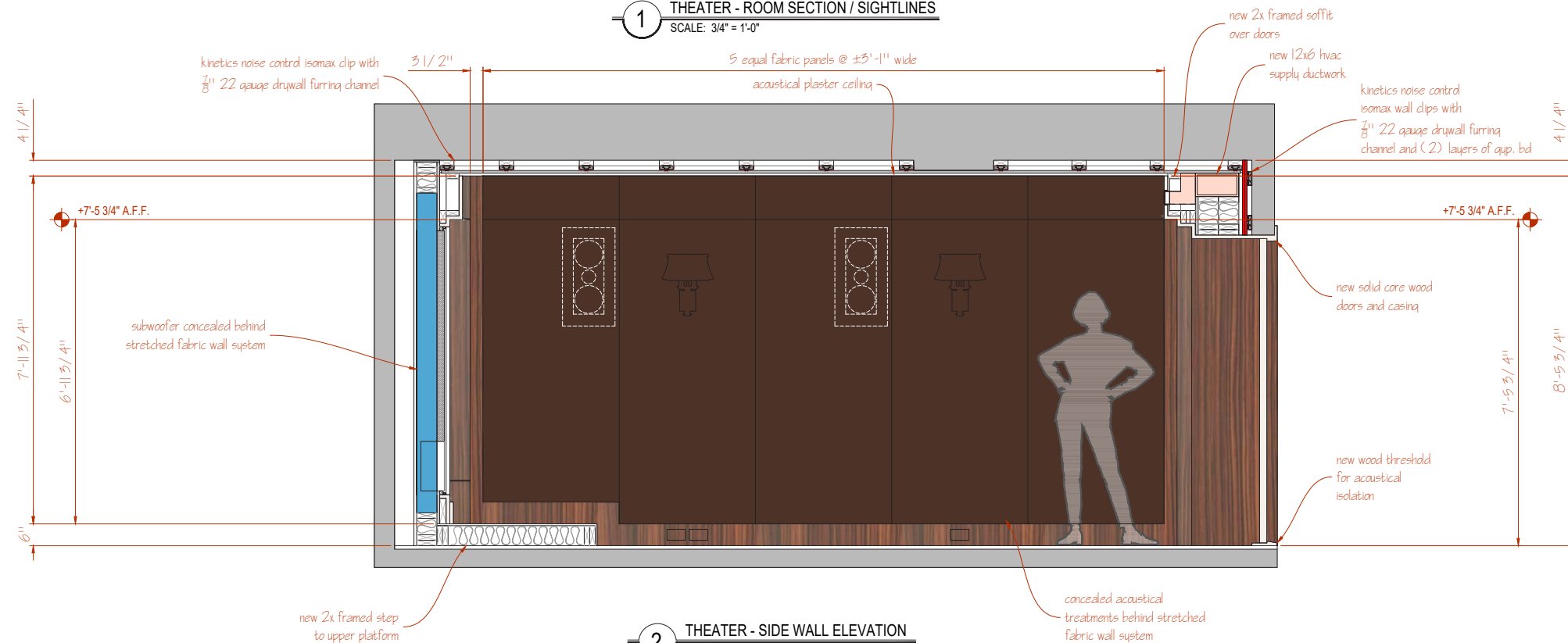

**2 THEATER - SIDE WALL ELEVATION**  
SCALE: 3/4" = 1'-0"

**AURUM**  
730 S Jason St Unit 18  
Denver, CO 80223  
(303) 558-9050  
aurumhometech.com

**PROJECT DOCUMENTATION**  
TYPICAL DESIGN DRAWINGS

**PROJECT INFO**

NO.	DATE	BY
01	08.01.2017	DMP
02		
03		
04		
05		
06		
07		
08		

REVISIONS

HOME THEATER  
CONSTRUCTION DWGS  
INTERIOR ELEVATIONS

SHEET TITLE

LOW VOLTAGE  
**LV-12.3**

SHEET NUMBER



**RESIDENTIAL** THEATER RENDERINGS





**RESIDENTIAL** THEATER RENDERINGS





**RESIDENTIAL** THEATER RENDERINGS





**VISIT OUR SHOWROOM** TO EXPERIENCE THE AURUM DIFFERENCE

