

## 5. Exploded View & Part List

### 5-1 PS50B850Y1WXXC Exploded View

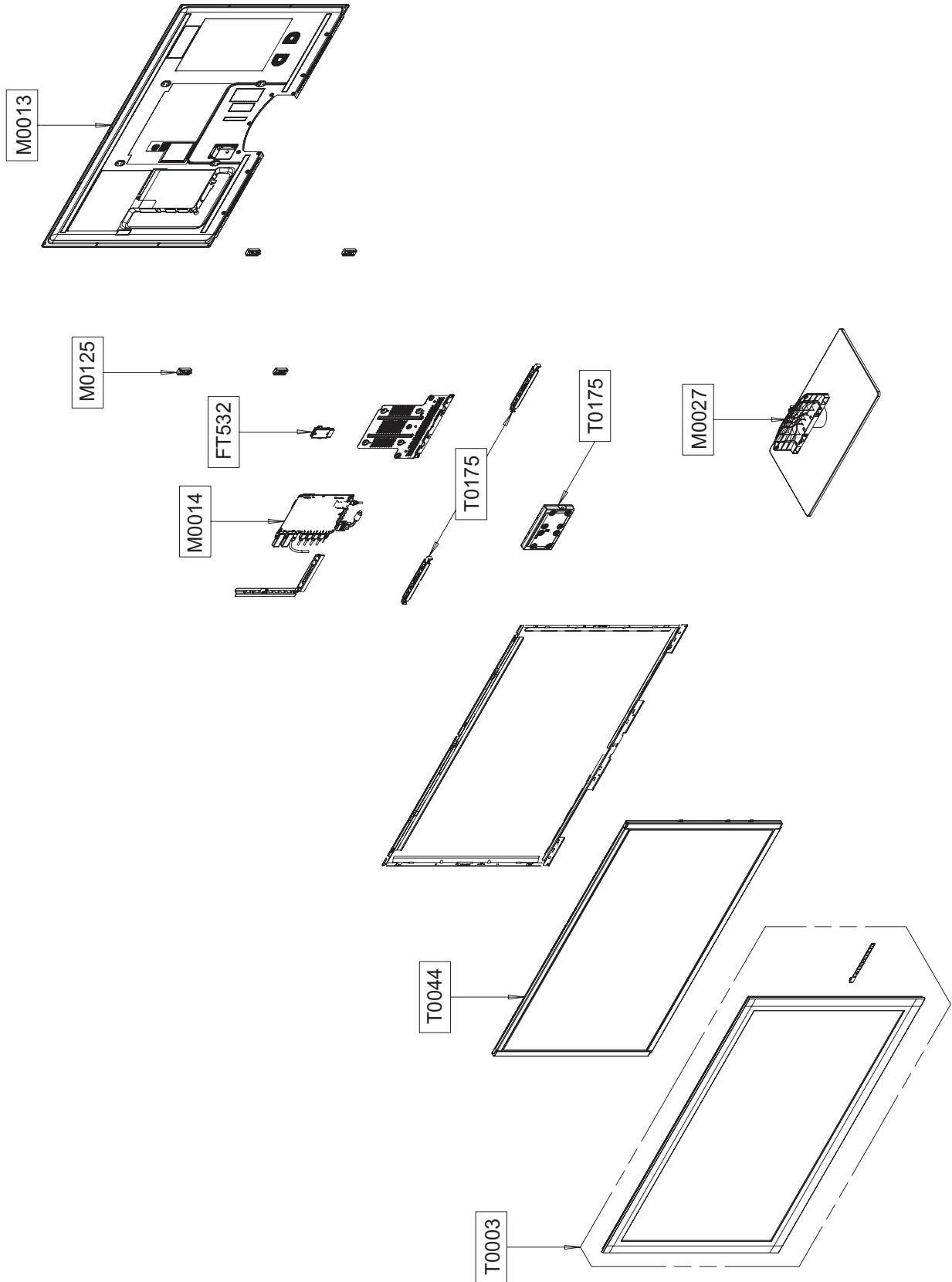

Loc. No.	Code No.	Description	Specification	Q'ty	SA/SNA	Remark
FT532	2901-001555	FILTER-EMI AC LINE	250V,6A,UL, CSA, VDE,	1	S.A	
M0013	BN96-10949B	ASSY COVER P-REAR	PB850 50,PCM,BKN-P824	1	S.A	
M0014	BN94-02826A	ASSY PCB MISC-MAIN	PS50B850Y1WXXC	1	S.A	△
M0027	BN96-10954A	ASSY STAND P-BASE	B850 50	1	S.A	
M0125	BN96-11443B	ASSY HOLDER P-WALL	50/58 B850,ABS HB,BLK	4	S.N.A	
T0003	BN96-10947D	ASSY COVER P-FRONT	PB850 50,PC(CLR)+PC(D)	1	S.A	
T0044	BN96-11174A	ASSY PDP MODULE P	S50FH-YD03,PP50FF007B,	1	S.A	△
T0175	BN96-09470D	ASSY SPEAKER P	8ohm,4pin,15W,R:800 / L:8	1	S.A	
T0175	BN96-11611A	ASSY SPEAKER P	8ohm,4pin,15W,R:800/L:800	1	S.A	

## 5-2 PS58B850Y1WXXC Exploded View

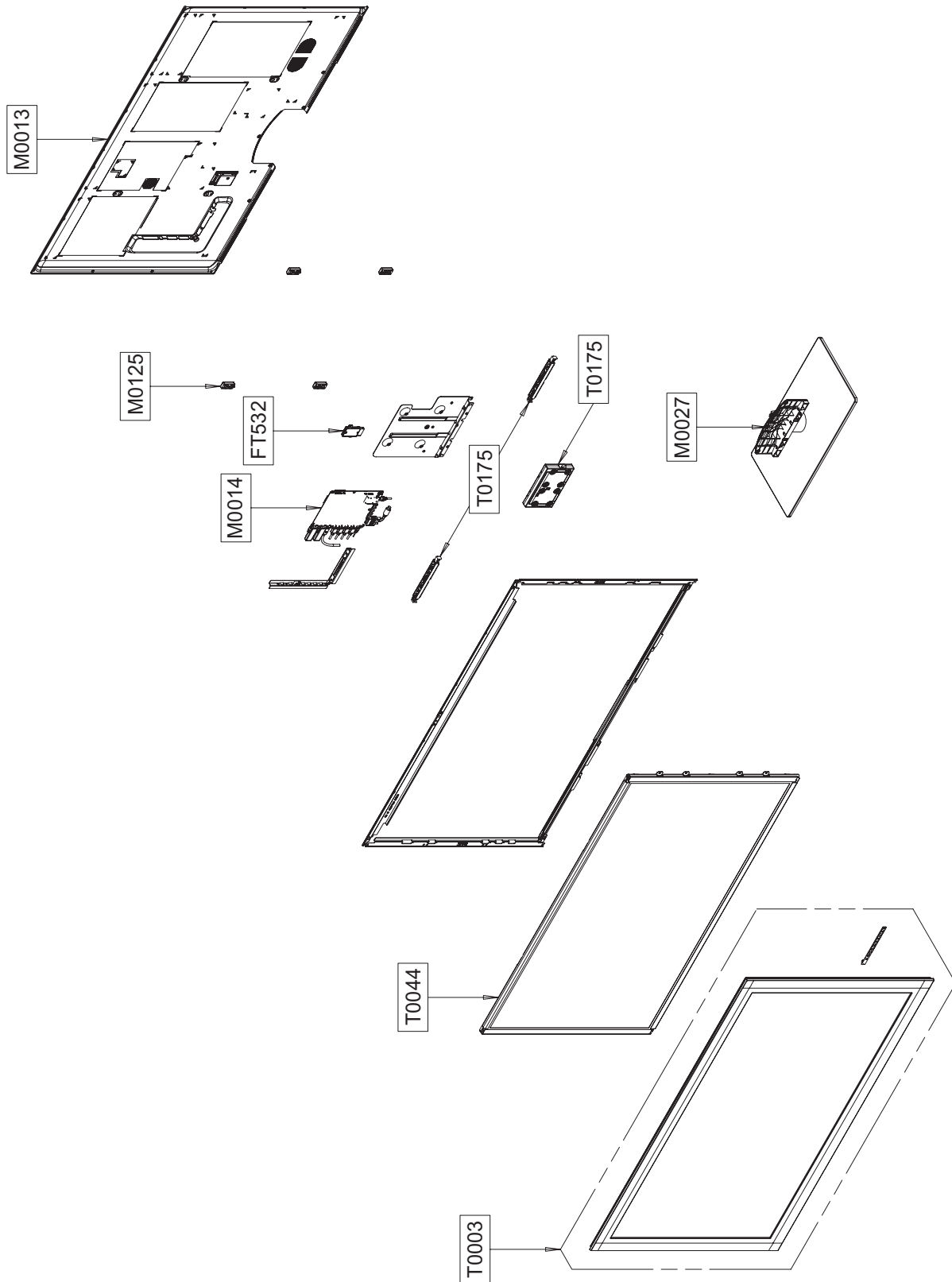

Loc. No.	Code No.	Description	Specification	Q'ty	SA/SNA	Remark
FT532	2901-001556	FILTER-EMI AC LINE	250V,8A,UL, CSA, VDE,	1	S.A	
M0013	BN96-10950B	ASSY COVER P-REAR	PB850 58,PCM,BKN-P824	1	S.A	
M0014	BN94-02827A	ASSY PCB MISC-MAIN	PS58B850Y1WXXC	1	S.A	△
M0027	BN96-10955A	ASSY STAND P-BASE	B850 58	1	S.A	
M0125	BN96-11443B	ASSY HOLDER P-WALL	50/58 B850,ABS HB,BLK	4	S.N.A	
T0003	BN96-10948D	ASSY COVER P-FRONT	PB850 58,PC(CLR)+PC(D)	1	S.A	
T0044	BN96-10295A	ASSY PDP MODULE P	S58FH-YB02,PL58FF002B,	1	S.A	△
T0175	BN96-09470E	ASSY SPEAKER P	8ohm,4pin,15W,R:800 / L:8	1	S.A	
T0175	BN96-11612A	ASSY SPEAKER P	8ohm,4pin,15W,R:1000/L:10	1	S.A	

### 5-3 PS50B850Y1WXXC Service Item

※ This is the list which is available to repair the real material at the time of service.

Loc. No.	Code No.	Description	Specification	Q'ty	Remark
M0013	BN96-10949B	ASSY COVER P-REAR	PB850 50,PCM,BKN-P824	1	
M0014	BN94-02826A	ASSY PCB MISC-MAIN	PS50B850Y1WXXC	1	△
M0027	BN96-10954A	ASSY STAND P-BASE	B850 50	1	
M0114	BN39-01154C	CBF SIGNAL	Chelsea Slim, STEREO Plug to	1	
M0114	BN39-01154E	CBF SIGNAL	Chelsea Slim, STEREO Plug to	1	
M0114	BN39-01154F	CBF SIGNAL	UE40B7000WWXXC,24P/20P,30AWG,	1	
M2893	BN39-01196A	LEAD CONNECTOR	P860,UL1007#26,24p/30p,60	1	
T0003	BN96-10947D	ASSY COVER P-FRONT	PB850 50,PC(CLR)+PC(D	1	
T0037	BN96-10517A	ASSY PDP P-LOGIC MAIN BOARD	S50FH-YB04,P	1	
T0044	BN96-11174A	ASSY PDP MODULE P	S50FH-YD03,PP50FF007B,	1	△
T0045	BN96-10514A	ASSY PDP P-LOGIC E-BUFFER BOAR	S50FH-YB0	1	
T0045	BN96-10515A	ASSY PDP P-LOGIC F-BUFFER BOAR	S50FH-YB0	1	
T0073	BN96-10510A	ASSY PDP P-X MAIN BOARD	S50FH-YB04,PL50F	1	
T0074	BN59-00860A	REMOCON	LCD850,750,TM970,EUROPE,49,146g	1	
T0095	BN96-10512A	ASSY PDP P-X MAIN BUFFER SCAN	S50FH-YB04	1	△
T0096	BN96-10511A	ASSY PDP P-Y MAIN BOARD	S50FH-YB04,PL50F	1	△
T0764	BN44-00277A	SMPS-PDP TV	50U/S_SS,AC/DC,441.88W,AC90~	1	△
T0961	BN96-11208A	ASSY PDP P-Y-M SCAN BUFFER BOA	S50FH-YB0	1	

## 5-4 PS58B850Y1WXXC Service Item

※ This is the list which is available to repair the real material at the time of service.

Loc. No.	Code No.	Description	Specification	Q'ty	Remark
M0013	BN96-10950B	ASSY COVER P-REAR	PB850 58,PCM,BKN-P824	1	
M0014	BN94-02827A	ASSY PCB MISC-MAIN	PS58B850Y1WXXC	1	△
M0027	BN96-10955A	ASSY STAND P-BASE	B850 58	1	
M0114	BN39-01154C	CBF SIGNAL	Chelsea Slim, STEREO Plug to	1	
M0114	BN39-01154E	CBF SIGNAL	Chelsea Slim, STEREO Plug to	1	
M0114	BN39-01154F	CBF SIGNAL	UE40B7000WWXXC,24P/20P,30AWG,	1	
M2893	BN39-01196A	LEAD CONNECTOR	P860,UL1007#26,24p/30p,60	1	
T0003	BN96-10948D	ASSY COVER P-FRONT	PB850 58,PC(CLR)+PC(D	1	
T0037	BN96-11190A	ASSY PDP P-LOGIC MAIN BOARD	S58FH-YB02,P	1	
T0039	BN96-09763A	ASSY PDP P-ADDRESS F-BUFFER BO	S58FH-YB0	1	
T0040	BN96-09764A	ASSY PDP P-ADDRESS G-BUFFER BO	S58FH-YB0	1	
T0044	BN96-10295A	ASSY PDP MODULE P	S58FH-YB02,PL58FF002B,	1	△
T0045	BN96-11182A	ASSY PDP P-X-MAIN BOARD	S58FH-YB02,PL58F	1	△
T0045	BN96-11183A	ASSY PDP P-X-MAIN BUFFER BOARD	S58FH-YB0	1	
T0045	BN96-11185A	ASSY PDP P-Y-MAIN SCAN UPPER B	S58FH-YB0	1	
T0045	BN96-11186A	ASSY PDP P-Y-MAIN SCAN LOWER B	S58FH-YB0	1	
T0074	BN59-00860A	REMOCON	LCD850,750,TM970,EUROPE,49,146g	1	
T0262	BN96-11184A	ASSY PDP P-Y-MAIN BOARD	S58FH-YB02,PL58F	1	△
T0764	BN44-00278A	SMPS-PDP TV	58U/S_DY1,AC/DC,635.08W,AC90	1	△
T0764	BN44-00279A	SMPS-PDP TV	58U/S_DY2,AC/DC,635.08W,AC90	1	△
T0937	BN96-09762A	ASSY PDP P-ADDRESS E-BUFFER BO	S58FH-YB0	1	

# MEMO