

# Multi Split

LG Multi Split system is an advanced air conditioning system of superior quality that has the ability to operate at different temperatures and fan speeds in individual rooms. The multi split system can be made up of large indoor units for living areas and small indoor units for bedrooms, all operated from the one common outdoor unit.



## **CALOR SRL**

Str. Progresului nr. 30-40, sector 5, Bucuresti  
tel: 021.411.44.44, fax: 021.411.36.14  
[www.calorserv.ro](http://www.calorserv.ro) - [www.calor.ro](http://www.calor.ro)

# Multi Split

## High Efficiency Multi

### 1 High COP & Energy Saving

#### Top Class Energy Efficiency

In 2010, LG Inv. Multi New Model has Top class Energy Efficiency Model using LG BLDC Compressor, BLDC motor, high efficiency heat exchanger.

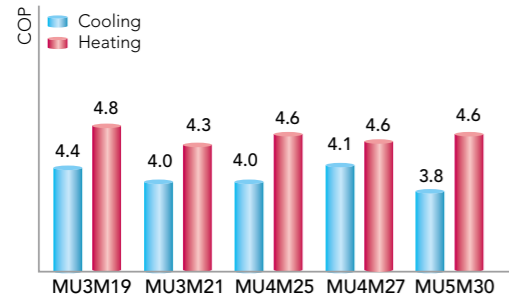

Using LG Inverter AC is same as planting 138 big cone pines.



- 1) KFRI(Korea Forest Research Institute) calculated based on annual power save. (Assumption : Using AC 4hr/day, 365days)
- 2) Energy saving 37% was compared with LG Non-inverter model

#### DC Inverter Technology

With the advancement of inverter technology comes more silent, economical and powerful air conditioning systems. The LG air conditioner is manufactured using the PFC and the sine wave technology.

Step-up Inverter by the PFC & the Sine Wave Control Technology (PFC : Power Factor Correction)compared to conventional.

##### • PFC Control in Power Input

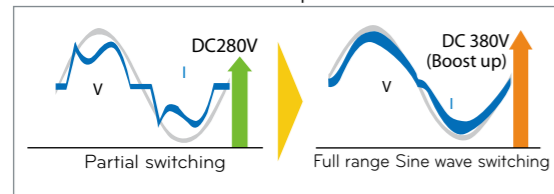

##### • Sine wave Control in BLDC Compressor

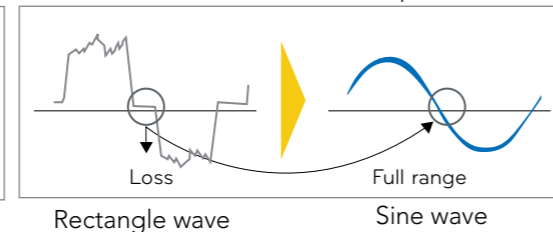

#### Powerful BLDC Compressor

The LG inverter air conditioner comes with a BLDC compressor that uses a strong neodymium magnet. Its compressor thus has improved efficiency compared with AC inverter.

- 1 Minimized Oil circulation
- 2 High Efficiency Motor
- 3 Optimize Compression Eff.
- 4 Optimize Vibration, Noise
- 5 High Reliability

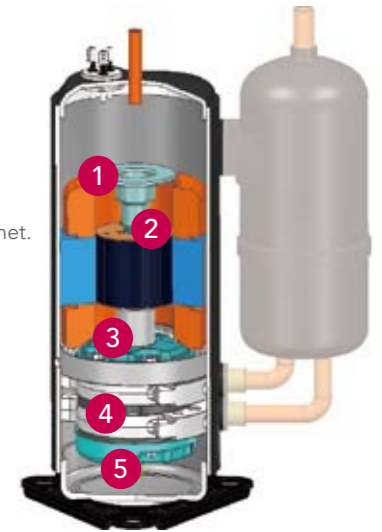

#### BLDC Fan Technology

BLDC Fan motor offers additional energy saving in operating mode. Compared with AC motors, BLDC Fan motor can cut energy by 35% at full velocity.

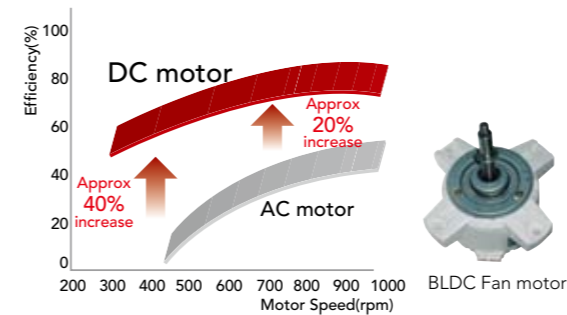

#### Prevent Oil Discharge at High Hz !

For keeping Oil level in high Hz , Improved Oil circulation system So. LG inv. Multi can have high reliability system

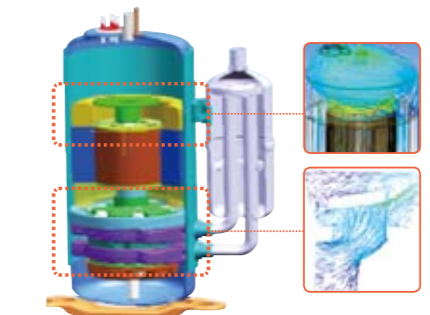

Adopt Oil Separate & Optimize Oil Path

#### Axial Fan

3 Step Axial fan shape can be available of high-efficient & low noise

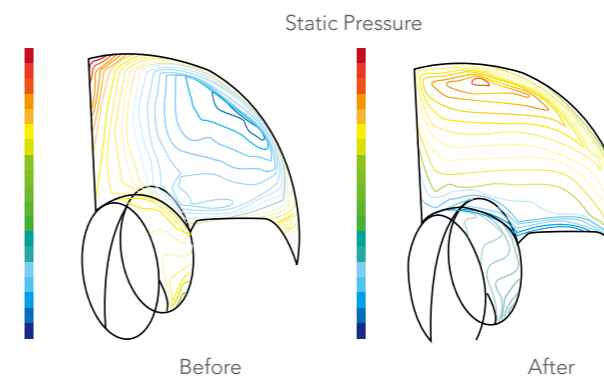
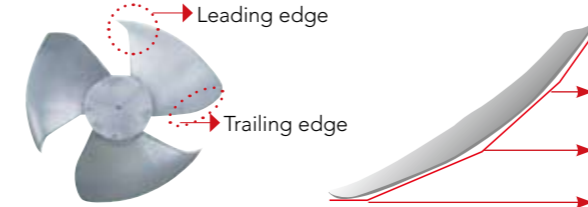

#### Wide Louver tech

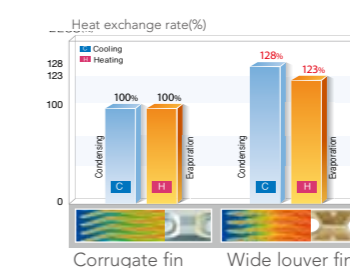

- Improved heat exchange rate by max 28%
- Anti-corrosion treatment (Gold fin)

#### More Heat exchanger

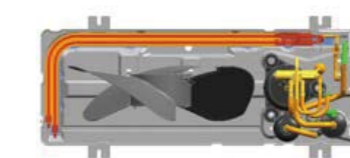

Height : 6% ↑  
Length : 8% ↑  
Energy Efficiency ↑

# Multi Split

## 2 Comfort Application

The Variety of Various Combination



### For Reference Sites

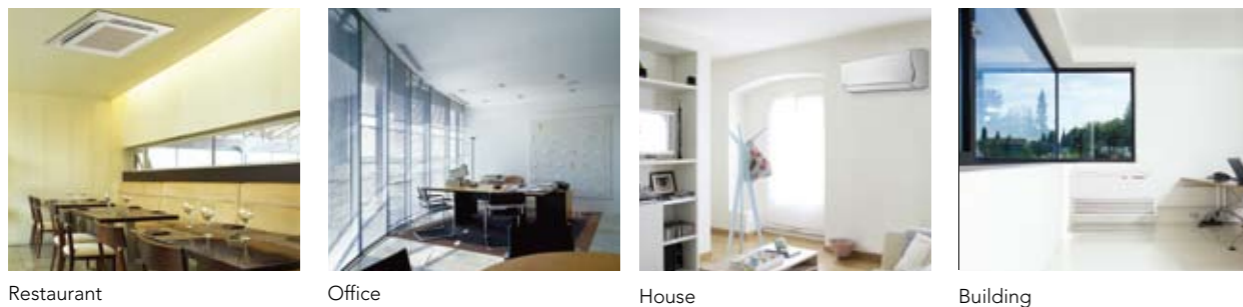

### Available from 1.5kW

According to construction regulation, house wall is becoming thicker & to strengthen insulation, LG can provide right solution to small space.



### Wide Operating Range

When cooling computer rooms and other rooms in the event of low outdoor temperature, the BLDC inverter compressor and outdoor BLDC fan motor are used to adjust the air flow and volume, with a view to ensuring efficient operation by allowing the air conditioner to keep operating at -10°C without turning it off.

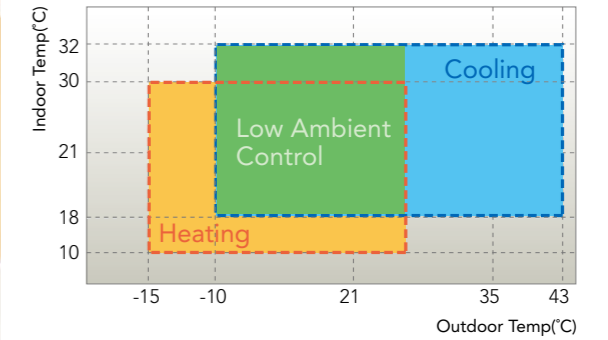

### Indoor Capacity Combination

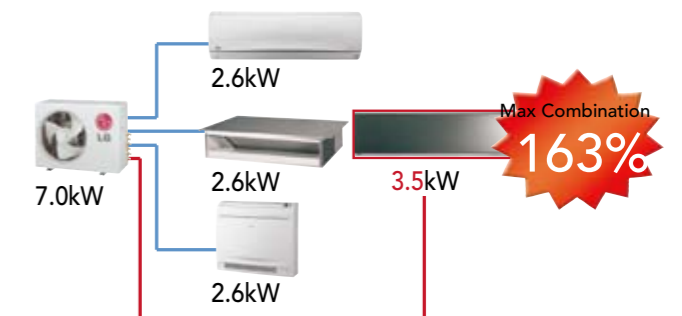
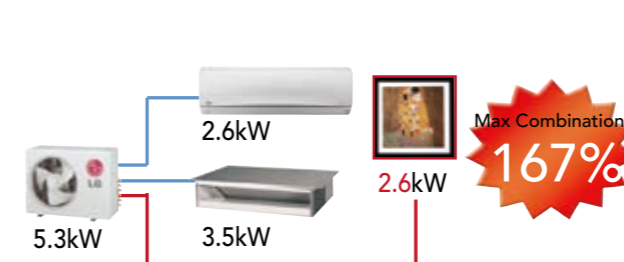
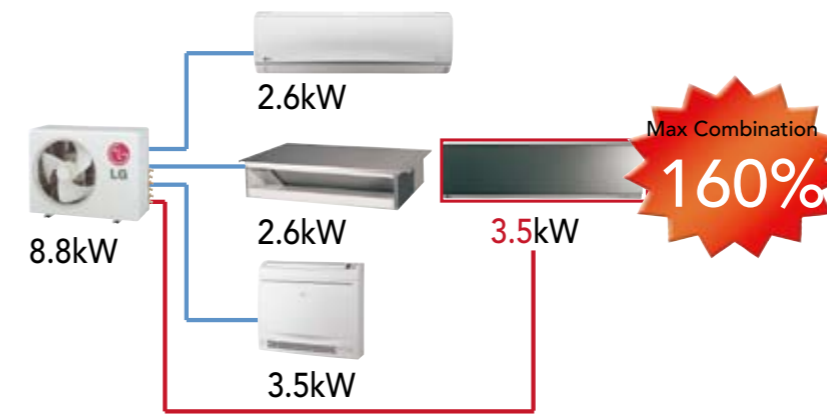

# Multi Split

## Long & High Elevation Piping

The FM56AH supports a piping length of up to 145m and high elevation of up to 30m for more flexibility in installation

### \*Multi Piping Type

Piping Length (m)	15/17k	19k/21k	25k/27k	30k	40k
Total	30	50	70	75	85
Max / Room	20	25	25	25	25
Allowable Elevation (Indoor-Outdoor)	15	15	15	15	15
(Indoor-Indoor)	7.5	7.5	7.5	7.5	7.5

### \*Distributor Box Type

Piping Length(m)	40k	48k	56k
Total Pipe (A+L1+L2+L3)	100	135	145
Main Pipe(A)	50	55	55
Total Branch Pipe (L1+L2+L3)	50	80	90
Each Branch Pipe	15	15	15
Allowable Elevation (Indoor-Outdoor (B))	30	30	30
(Indoor-Indoor (C))	15	15	15

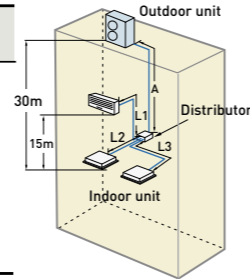

## Max 145m pipe run / 30m Elevation

Remove outdoor unit From Balcony and Move to car parking lot or Roof.

- Beauty care center
- Easy to get approval from council
- Avoid safety issue (Baby fall down from balcony)

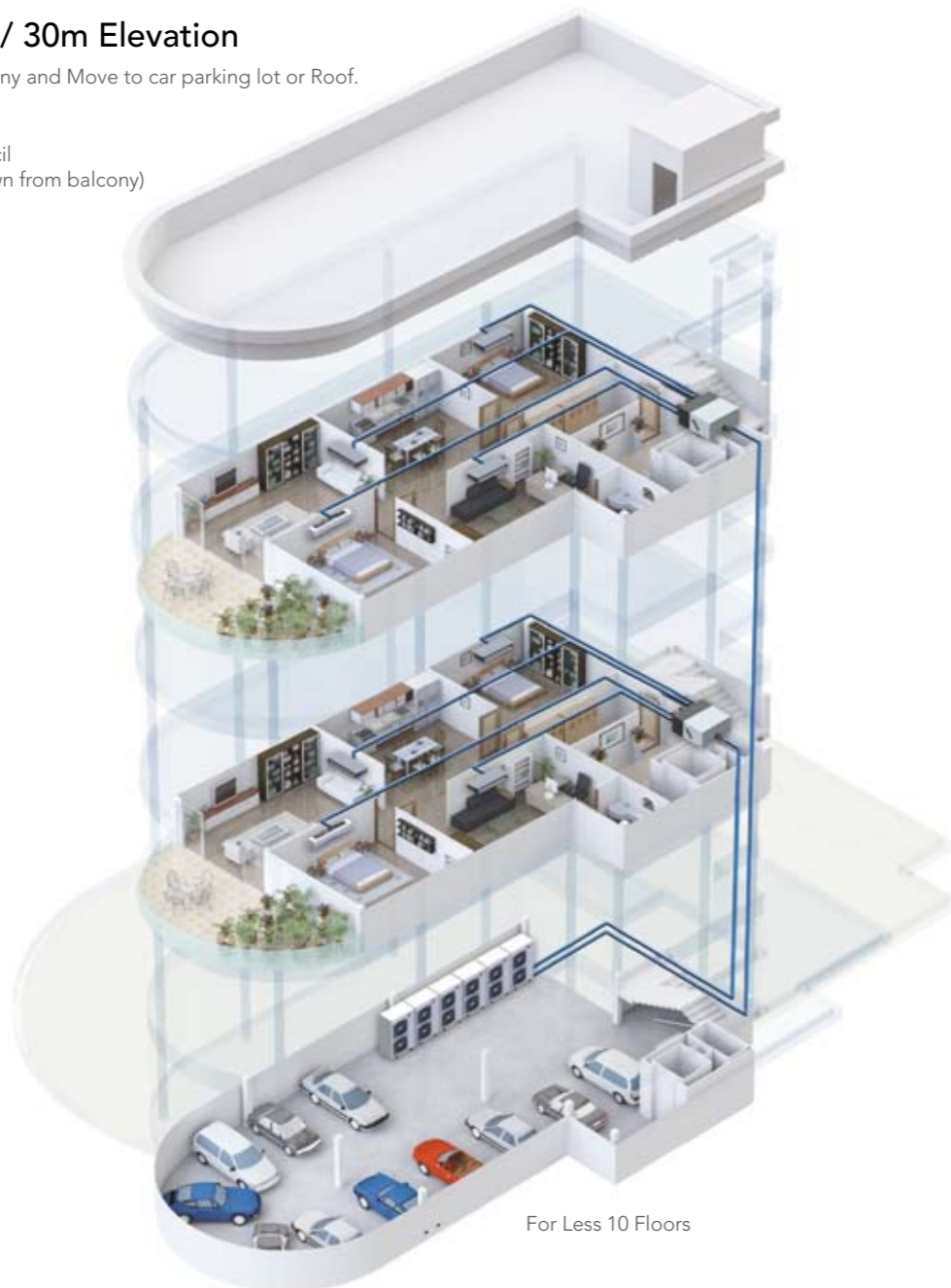

For Less 10 Floors

## 3 Comfort Operation & Ez installation

### Improved Low Noise

The Inverter technology, the BLDC Motor technology, and LG's unique new Skew Fan technology have achieved the world's lowest noise level of 19dB. Thus, the Sleep mode will allow pleasant sleeping.

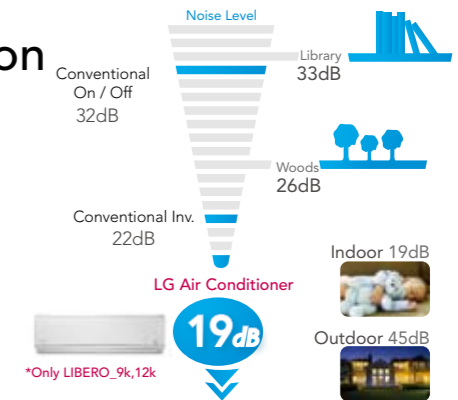

### LG MV

- Easy start-up, easy trouble shooting
- Monitoring the normality of all parts such as compressor, fan, valve, etc

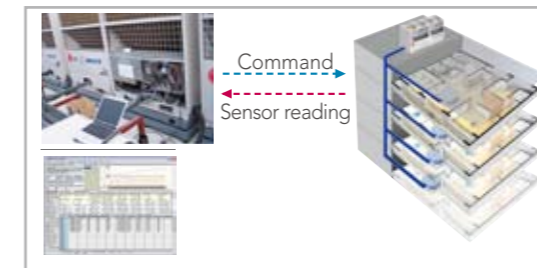

### Available to link with home network

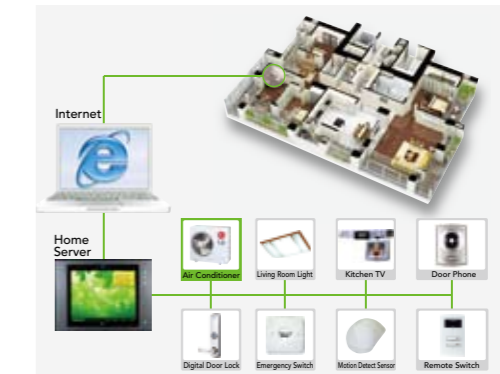

\*LG does not supply home network. Only available to link.

### Smart phone Solution for Operation monitoring & Trouble shooting

#### Smart phone connection

When faults have occurred, you can see the Error code during the check of indoor and outdoor units, select the Error code, and find solutions to each problem through Q&A. It is like the trouble shooting guide book embedded in the smart phone.

#### Operation Monitoring



- Select communication method and language
- Check the installation status
- Compressor operation status
- Check the indoor unit status
- Operational status in line with the frequency

#### Troubleshooting on Smart phone



1. Select Error Code
2. Easy Process
3. Service Action

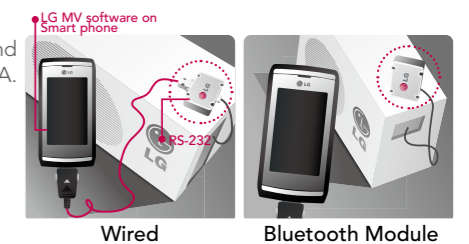

Wired

Bluetooth Module

### Easy to Service

Easy & efficient installation of outdoor unit will provide the best solution for small offices and shops.

- 1. Inner SVC valve**
  - 4 Way piping is possible (Front, Rear, Right, Down)
  - Excellent exterior
- 2. Convenient moving handle**
  - Fitted hand grips for easy transportation and installation
- 3. Compact Design & Ez SVC**
  - Remove 3 pieces of screw for SVC
  - Front panel removal system

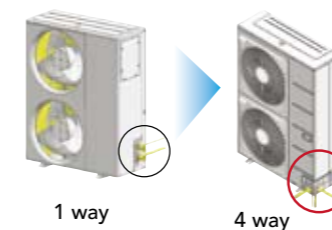

1 way

4 way

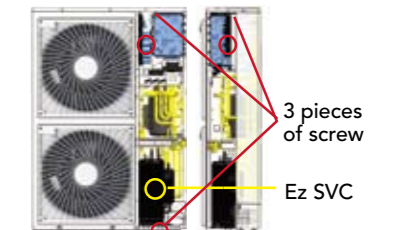
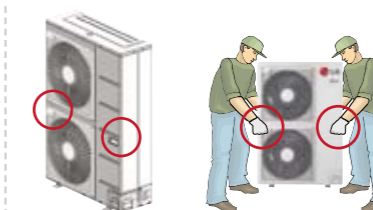

3 pieces of screw

Ez SVC

# Multi Split

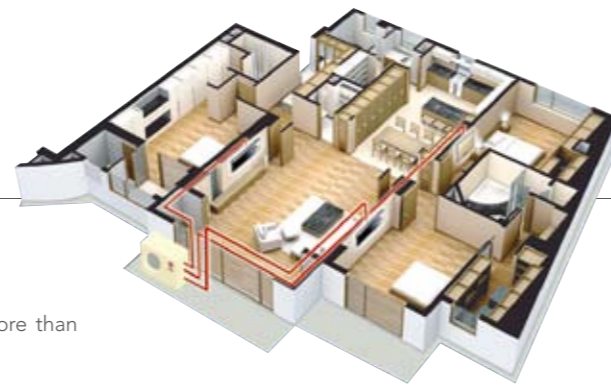

## Wide Range

LG Multi systems provide various indoor units and outdoor units up to 16.4kW. More than 2,000 types of combinations are available using 15 outdoor units and 48 indoor units

Type	Multi Piping				DB Box Type			
	Category	Category	Category	Category	Category	Category	Category	Category
Model	MU2M15 UL0 MU2M17 UL0	MU3M19 UE0 MU3M21 UE0 MU4M25 UE0	MU4M27 U40 MU5M30 U40	MU5M40 UH0	FM40AH UH5	FM48AH U33 FM56AH U33	FM37AH UE0	FM41AH U33 FM49AH U33 FM57AH U33
Capacity KW(C/H)	4.1/4.7 4.7/5.3	5.3/6.3 6.2/7.0 7.0/8.4	7.9/9.1 8.8/10.1	11.7/13.5	11.7/13.5	15.5/16.4 16.7/17.9	9.7/11.1	13.5/14.1 15.5/16.4 16.7/17.9
Max. Indoor units	2 2	3 3 4	4 5	5	7	8 9	6	7 8 9
Phase	1ø	1ø	1ø	1ø	1ø	1ø	3ø	3ø

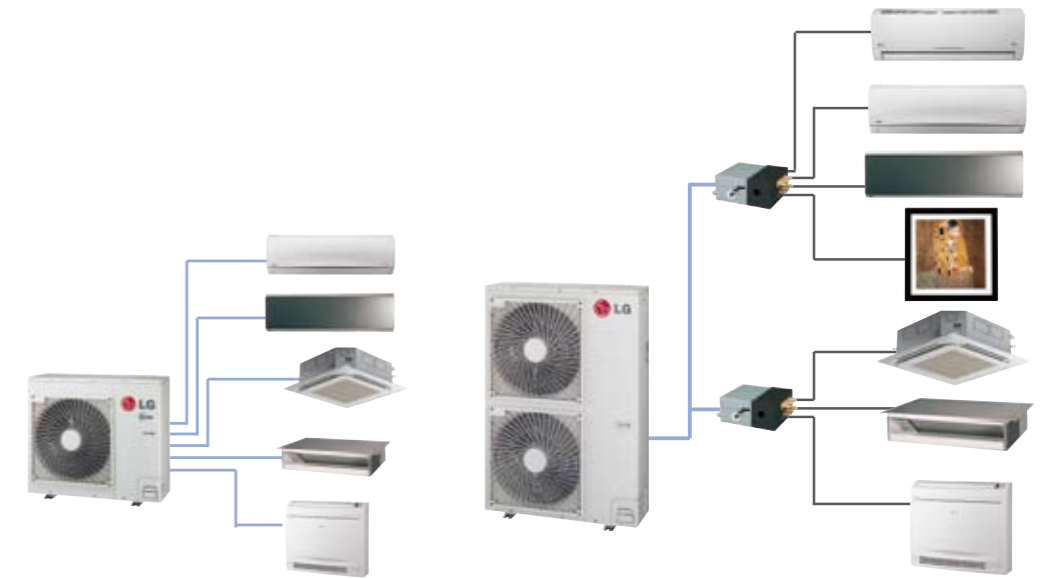

## Free Combination with Various Indoor Types

Product	Wall Mounted Type						Ceiling Cassette Type		Ceiling Concealed Duct Type		Console	Ceiling & Floor Type
	Wall Mounted	<i>LIBERO</i>	<i>HERO</i>	ART COOL Mirror	ART COOL Gallery	ART COOL Panel	1-way	4-way	Slim Duct	High		
5/1.5	MS05AH N40		CS05AF NH0					MT06AH NR0				
7/2.1	MS07AH N40	CS07AQ NB0	CS07AF NH0	CC07AW* NE3				MT08AH NR0				
9/2.6	MS09AH N40	CS09AQ NB0	CS09AF NH0	CC09AW* NE3	MA09AH1 NF1	MA09AH* NF1	MT09AH NC1	MT10AH NR0	MB09AHL N12		CQ09 NAO	MV09AH NE0
12/3.5	MS12AH N40	CS12AQ NB0	CS12AF NH0	CC12AW* NE3	MA12AH1 NF1	MA12AH* NF1	MT11AH NC1	MT12AH NR0	MB12AHL N12		CQ12 NAO	MV12AH NE0
18/5.3	MS18AH N50	CS18AQ NC0		CC18AW* N83				MT18AH NQ0	MB18AHL N22	MB18AH NH0	CQ18 NAO	MV18AH NB0
24/7.0	MS24AH N50	CS24AQ NC0		CC24AW* N83				MT24AH NP0	MB24AHL N22	MB24AH NH0		MV24AH NB0

ART COOL Note : \* indicates color of panel  
 \*Blue(B) \*Mirror(R) \*Silver(V) \*Red(E) \*Gold(G) \*White Silver(H) \*Gallery(1)

# Multi Split \_MULTI

## Specifications\_Outdoor Units



- MU2M15 UL0
- MU2M17 UL0

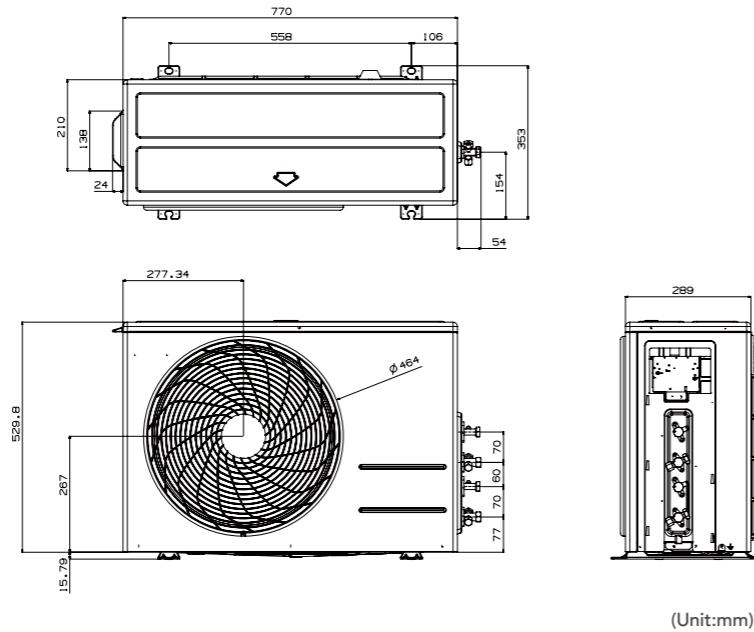

Model	MU2M15 UL0			MU2M17 UL0		
Nominal Capacity* (Min~Rated~Max)	Cooling	Btu/h	4,600~14,000~16,000	4,600~16,000~17,500		
		kW	1.35~4.10~4.69	1.35~4.69~5.13		
	Heating	Btu/h	4,800~16,000~18,000	4,800~18,000~19,500		
		kW	1.41~4.70~5.27	1.41~5.27~5.71		
Nominal Input* (Min~Rated~Max)	Cooling	kW	0.38~1.07~1.70	0.4~1.38~1.83		
	Heating	kW	0.45~1.12~1.80	0.39~1.31~1.73		
Energy label	A/A			A/A		
Testing Combination	CS07AQ NB0 x 2EA			CS09AQ NB0 x 2EA		
Running Current (Min~Rated~Max)	Cooling	A	1.6~4.9~7.6	1.6~6.13~8.04		
	Heating	A	1.7~5.1~8.2	1.7~5.88~7.51		
Power Supply	Ø / V / Hz		1 / 220~240 / 50			
Dimensions	W*H*D		770x545x288 (30.3x21.5x11.3)			
Net Weight	kg(lbs)		35(77.2)			
Max. Number of Connectable Indoor Units			2			
Refrigerant	Charge (at 7.5m)		g(oz)			
Air Flow Rate	CMM(CFM)		28.2(995)			
Sound Level	Sound Pressure at 1m		dB(A)+3			
Piping connections	Liquid(ø)	mm(inch)	6.35(1/4)x2EA			
	Gas(ø)	mm(inch)	9.52(3/8)x2EA			
Max. Interunit	Total of Each Room		m			
Piping Length	For One Room		m			
Max. Elevation	Indoor Unit~Outdoor Unit		m			
	Indoor Unit~Indoor Unit		m			

- Notes:
- Capacities are based on the following conditions:  
Cooling: - Indoor Temperature 27°C (80.6°F) DB / 19°C (66.2°F) WB  
- Outdoor Temperature 35°C (95°F) DB / 24°C (75.2°F) WB  
Heating: - Indoor Temperature 20°C (68°F) DB / 15°C (59°F) WB  
- Outdoor Temperature 7°C (44.6°F) DB / 6°C (42.8°F) WB  
Piping Length - Interconnecting Piping Length 7.5m  
- Level Difference of Zero.
  - \* : See page "Combination Table".
  - Due to our policy of innovation some specifications may be changed without notification.
  - At least two indoor units should be connected.
  - Minimum combination capacity rate should be more than 40%.

## Specifications\_Outdoor Units



- MU3M19 UE0
- MU3M21 UE0
- MU4M25 UE0

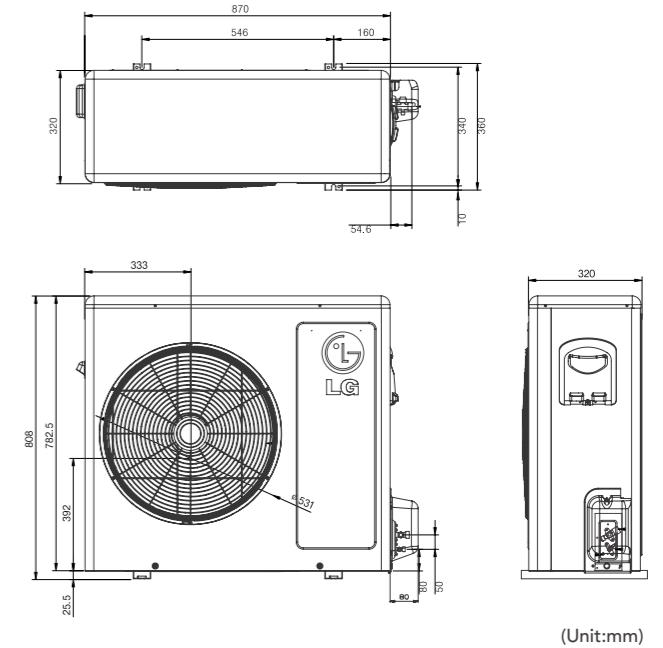

Model	MU3M19 UE0			MU3M21 UE0			MU4M25 UE0		
Nominal Capacity* (Min~Rated~Max)	Cooling	Btu/h	4,600~18,000~21,600	6,300~21,000~25,000	6,300~24,000~29,000				
		kW	1.35~5.3~6.33	1.85~6.15~7.33	1.85~7.03~8.5				
	Heating	Btu/h	4,800~21,600~24,800	7,560~24,000~26,500	7,560~28,000~32,000				
		kW	1.41~6.3~7.27	2.22~7.03~7.77	2.22~8.44~9.38				
Nominal Input* (Min~Rated~Max)	Cooling	kW	0.38~1.20~2.37	0.72~1.53~2.94	0.72~1.75~3.09				
	Heating	kW	0.45~1.31~2.48	0.88~1.63~2.95	0.88~1.83~3.10				
Energy label	A/A			A/A			A/A		
Testing Combination	CS07AQ NB0 x 3EA			CS07AQ NB0 x 3EA			CS07AQ NB0 x 4EA		
Running Current (Min~Rated~Max)	Cooling	A	1.7~5.23~10.3	3.1~6.65~12.7	3.1~7.65~13.4				
	Heating	A	2.0~5.7~10.8	3.8~7.1~12.8	3.8~8.0~13.5				
Power Supply	Ø / V / Hz		1 / 220~240 / 50						
Dimensions	W*H*D		870x808x320 (34.3x31.8x12.6)						
Net Weight	kg(lbs)		58(128)						
Max. Number of Connectable Indoor Units			3						
Refrigerant	Charge (at 7.5m)		g(oz)						
Air Flow Rate	CMM(CFM)		53(1872)						
Sound Level	Sound Pressure at 1m		dB(A)+3						
Piping connections	Liquid(ø)	mm(inch)	6.35(1/4)x3EA						
	Gas(ø)	mm(inch)	9.52(3/8)x3EA						
Max. Interunit	Total of Each Room		m						
Piping Length	For One Room		m						
Max. Elevation	Indoor Unit~Outdoor Unit		m						
	Indoor Unit~Indoor Unit		m						

- Notes:
- Capacities are based on the following conditions:  
Cooling: - Indoor Temperature 27°C (80.6°F) DB / 19°C (66.2°F) WB  
- Outdoor Temperature 35°C (95°F) DB / 24°C (75.2°F) WB  
Heating: - Indoor Temperature 20°C (68°F) DB / 15°C (59°F) WB  
- Outdoor Temperature 7°C (44.6°F) DB / 6°C (42.8°F) WB  
Piping Length - Interconnecting Piping Length 7.5m  
- Level Difference of Zero.
  - \* : See page "Combination Table".
  - Due to our policy of innovation some specifications may be changed without notification.
  - At least two indoor units should be connected.
  - Minimum combination capacity rate should be more than 40%.

# Multi Split \_MULTI

## Specifications\_Outdoor Units



- MU4M27 U40
- MU5M30 U40

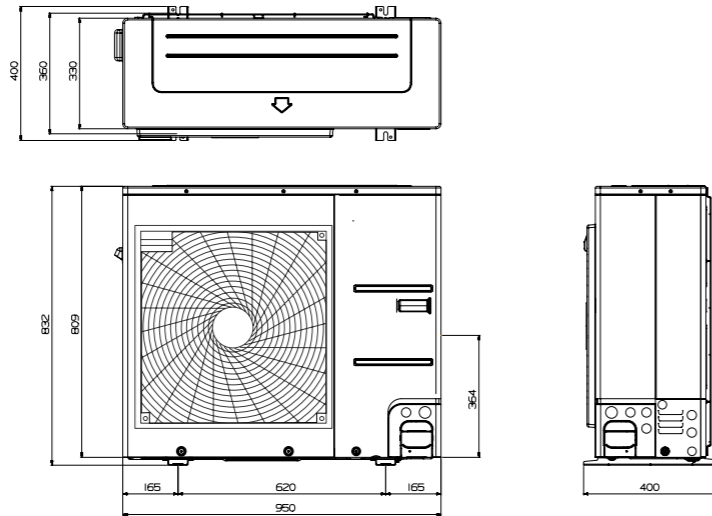

(Unit:mm)

Model	MU4M27 U40			MU5M30 U40		
Nominal Capacity* (Min~Rated~Max)	Cooling	Btu/h	6,300~27,000~32,400	6,300~30,000~36,000		
		kW	1.85~7.91~9.49	1.85~8.80~10.55		
Heating	Btu/h		7,560~31,000~36,000	7,560~34,500~41,400		
		kW	2.22~9.08~10.55	2.22~10.1~12.1		
Nominal Input* (Min~Rated~Max)	Cooling	kW	0.72~1.98~3.12	0.72~2.31~3.16		
	Heating	kW	0.88~1.97~3.68	0.88~2.19~3.87		
Energy label	A/A			A/A		
Testing Combination	CS07AQ NB0 × 4EA			CS07AQ NB0 × 5EA		
Running Current (Min~Rated~Max)	Cooling	A	3.1~8.6~13.5	3.1~10.1~13.7		
	Heating	A	3.8~9.0~16.0	3.8~9.6~16.8		
Power Supply		Ø / V / Hz	1/220~240/50			
Dimensions	W*H*D	mm(inch)	950×834×330(37.4×32.8×13.0)			
Net Weight		kg(lbs)	67(147.7)			
Max. Number of Connectable Indoor Units			4			
Refrigerant	Charge (at 7.5m)	g(oz)	3,300(116.4)			
Air Flow Rate		CMM(CFM)	60(2119)			
Sound Level	Sound Pressure at 1m	dB(A)+3	53			
Piping connections	Liquid(ø)	mm(inch)	6.35(1/4)×4EA			
	Gas(ø)	mm(inch)	9.52(3/8)×4EA			
Max. Interunit	Total of Each Room	m	70			
Piping Length	For One Room	m	25			
Max. Elevation	Indoor Unit~Outdoor Unit	m	15			
	Indoor Unit~Indoor Unit	m	7.5			

Notes:

- Capacities are based on the following conditions:  
Cooling: - Indoor Temperature 27°C (80.6°F) DB / 19°C (66.2°F) WB  
- Outdoor Temperature 35°C (95°F) DB / 24°C (75.2°F) WB  
Heating: - Indoor Temperature 20°C (68°F) DB / 15°C (59°F) WB  
- Outdoor Temperature 7°C (44.6°F) DB / 6°C (42.8°F) WB  
Piping Length - Interconnecting Piping Length 7.5m  
- Level Difference of Zero.

2. \* : See page "Combination Table".

3. Due to our policy of innovation some specifications may be changed without notification.

4. At least two indoor units should be connected.

5. Minimum combination capacity rate should be more than 40%.

## Specifications\_Outdoor Units



- MU5M40 UH0

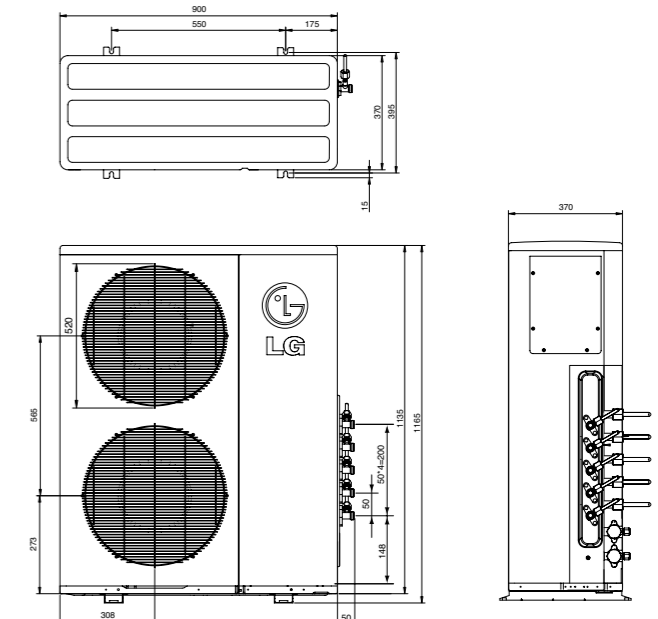

(Unit:mm)

Model	MU5M40 UH0		
Nominal Capacity* (Min~Rated~Max)	Cooling	Btu/h	9,600~40,000~46,000
		kW	2.8~11.7~13.5
Heating	Btu/h		11,040~46,000~51,000
		kW	3.2~13.5~15.0
Nominal Input* (Min~Rated~Max)	Cooling	kW	1.1~3.63~4.65
	Heating	kW	1.4~3.65~4.84
Energy label	A/A		
Testing Combination	MS09AH N40 × 5EA		
Running Current (Min~Rated~Max)	Cooling	A	6.2~16.0~20.0
	Heating	A	6.9~16.4~20.5
Power Supply		Ø / V / Hz	1/220~240/50
Dimensions	W*H*D	mm(inch)	900×1165×370(35.4×45.8×14.5)
Net Weight		kg(lbs)	95(209)
Max. Number of Connectable Indoor Units			5
Refrigerant	Charge (at 7.5m)	g(oz)	4,000(141.1)
Air Flow Rate		CMM(CFM)	53(1872)×2
Sound Level	Sound Pressure at 1m	dB(A)+3	58
Piping connections	Liquid(ø)	mm(inch)	6.35(1/4)×5EA
	Gas(ø)	mm(inch)	9.52(3/8)×5EA
Max. Interunit	Total of Each Room	m	85
Piping Length	For One Room	m	25
Max. Elevation	Indoor Unit~Outdoor Unit	m	15
	Indoor Unit~Indoor Unit	m	7.5

Notes:

- Capacities are based on the following conditions:  
Cooling: - Indoor Temperature 27°C (80.6°F) DB / 19°C (66.2°F) WB  
- Outdoor Temperature 35°C (95°F) DB / 24°C (75.2°F) WB  
Heating: - Indoor Temperature 20°C (68°F) DB / 15°C (59°F) WB  
- Outdoor Temperature 7°C (44.6°F) DB / 6°C (42.8°F) WB  
Piping Length - Interconnecting Piping Length 7.5m  
- Level Difference of Zero.

2. \* : See page "Combination Table".

3. Due to our policy of innovation some specifications may be changed without notification.

4. At least two indoor units should be connected.

5. Minimum combination capacity rate should be more than 40%.

# Multi Split \_MULTI

## Specifications\_Outdoor Units



- FM40AH UH5

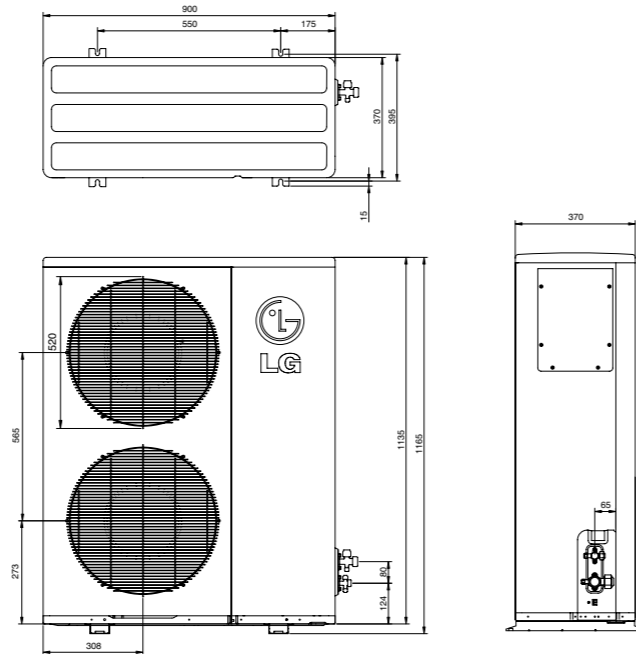

(Unit:mm)

Model	FM40AH UH5		
Nominal Capacity* (Min~Rated~Max)	Cooling	Btu/h	9,600~40,000~46,000
		kW	2.8~11.7~13.5
Heating	Btu/h		11,040~46,000~51,000
	kW		3.2~13.5~15.0
Nominal Input* (Min~Rated~Max)	Cooling	kW	1.1~3.63~4.65
	Heating	kW	1.4~3.65~4.84
Energy label	A/A		
Testing Combination	CS09AH NB0 × 7EA		
Running Current (Min~Rated~Max)	Cooling	A	6.2~16.0~20.0
	Heating	A	6.9~16.4~20.5
Power Supply	Ø / V / Hz		
Dimensions	W*H*D	mm(inch)	900×1165×370(35.4×45.8×14.5)
Net Weight	95(209)		
Max. Number of Connectable Indoor Units	7		
Refrigerant	Charge (at 7.5m)	g(oz)	4,400(155)
Air Flow Rate	53(1872) × 2		
Sound Level	Sound Pressure at 1m	dB(A)+3	58
Piping connections	Liquid(ø)	mm(inch)	9.52(3/8)
	Gas(ø)	mm(inch)	19.05(3/4)
Max. Interunit Piping Length	Total Piping (Main+Total Branch)	m	100
	Main Piping	m	50
	Total Branch Piping	m	50
	Each Branch Piping	m	15
Max. Elevation	Indoor Unit~Outdoor Unit	m	30
	Indoor Unit~Indoor Unit	m	15

### Notes:

- Capacities are based on the following conditions:  
Cooling: - Indoor Temperature 27°C(80.6°F) DB /19 °C(66.2°F) WB  
- Outdoor Temperature 35°C(95°F) DB /24°C(75.2°F) WB  
Heating: - Indoor Temperature 20°C(68°F) DB / 15°C(59°F) WB  
- Outdoor Temperature 7°C(44.6°F) DB / 6°C(42.8°F) WB  
Piping Length - Main piping 5m, Branch piping 5m  
- Level Difference of Zero.

2. \* : See page "Combination Table"

3. Due to our policy of innovation some specifications may be changed without notification.

4. At least two indoor units should be connected.

5. Minimum combination capacity rate should be more than 40%.

## Specifications\_Outdoor Units



- FM48AH U33
- FM56AH U33

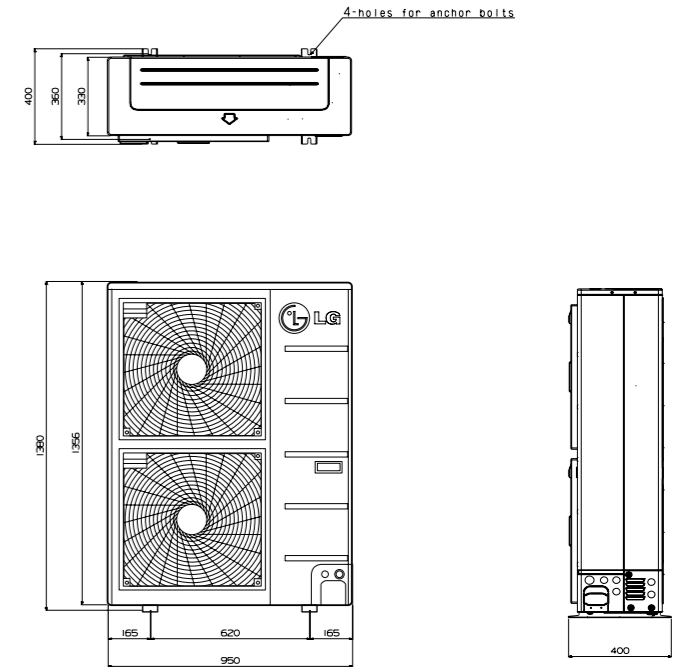

(Unit:mm)

Model	FM48AH U33		FM56AH U33	
Nominal Capacity* (Min~Rated~Max)	Cooling	Btu/h	11,400~52,800~58,000	13,800~57,000~63,200
		kW	3.3~15.5~17.0	4.0~16.7~18.52
Heating	Btu/h		12,768~56,000~59,000	15,456~61,000~64,000
	kW		3.7~16.4~17.29	4.5~17.9~18.75
Nominal Input* (Min~Rated~Max)	Cooling	kW	0.84~4.69~5.35	1.0~4.96~5.65
	Heating	kW	1.30~4.43~5.58	1.25~4.62~5.70
Energy label	A/A		A/A	
Testing Combination	MS07AH N40 × 5EA MS09AH N40 × 3EA		MS09AH N40×8EA	
Running Current (Min~Rated~Max)	Cooling	A	3.9~21.1~23.2	4.6~21.7~24.0
	Heating	A	6.9~22.6~25.0	7.4~22.4~26.0
Power Supply	Ø / V / Hz		1/220~240/50	
Dimensions	W*H*D	mm(inch)	950×1380×330 (37.4×54.3×13.0)	950×1380×330 (37.4×54.3×13.0)
Net Weight	108(238)		108(238)	
Max. Number of Connectable Indoor Units	8		9	
Refrigerant	Charge (at 7.5m)	g(oz)	4800(169.3)	4800(169.3)
Air Flow Rate	60(2,119) × 2		60(2,119) × 2	
Sound Level	Sound Pressure at 1m	dB(A)+3	58	59
Piping connections	Liquid(ø)	mm(inch)	9.52(3/8)	9.52(3/8)
	Gas(ø)	mm(inch)	19.05(3/4)	19.05(3/4)
Max. Interunit Piping Length	Total Piping (Main+Total Branch)	m	135	145
	Main Piping	m	55	55
	Total Branch Piping	m	80	90
	Each Branch Piping	m	15	15
Max. Elevation	Indoor Unit~Outdoor Unit	m	30	30
	Indoor Unit~Indoor Unit	m	15	15

### Notes:

- Capacities are based on the following conditions:  
Cooling: - Indoor Temperature 27°C(80.6°F) DB /19 °C(66.2°F) WB  
- Outdoor Temperature 35°C(95°F) DB /24°C(75.2°F) WB  
Heating: - Indoor Temperature 20°C(68°F) DB / 15°C(59°F) WB  
- Outdoor Temperature 7°C(44.6°F) DB / 6°C(42.8°F) WB  
Piping Length - Main piping 5m, Branch piping 5m  
- Level Difference of Zero.

2. \* : See page "Combination Table"

3. Due to our policy of innovation some specifications may be changed without notification.

4. At least two indoor units should be connected.

5. Minimum combination capacity rate should be more than 40%.



# Multi Split \_MULTI

## Specifications\_Outdoor Units



- FM37AH UE0

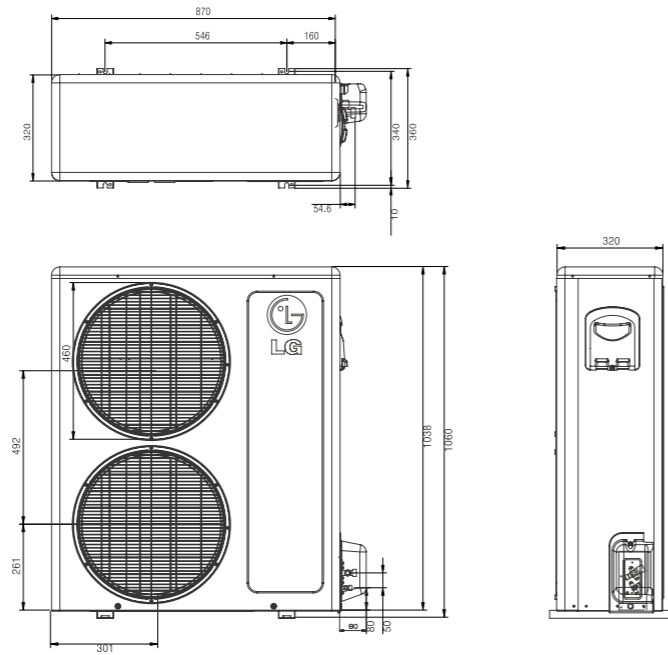

(Unit:mm)

Model	FM37AH UE0		
Nominal Capacity* (Min~Rated~Max)	Cooling	Btu/h	21,600~33,000~37,000
		kW	6.33~9.67~10.8
Heating	Btu/h	22,800~38,000~42,000	
	kW	6.68~11.1~12.3	
Nominal Input* (Min~Rated~Max)	Cooling	kW	1.80~3.00~3.45
	Heating	kW	1.83~3.05~3.51
Energy label	A/A		
Testing Combination	MS07AH N40 × 6EA		
Running Current (Min~Rated~Max)	Cooling	A	3.4~5.4~6.0
	Heating	A	3.5~5.4~6.1
Power Supply	Ø / V / Hz		
Dimensions	W*H*D	mm(inch)	870×1,038×320 (34.3×40.9×12.6)
Net Weight	80(17.6)		
Max. Number of Connectable Indoor Units	6		
Refrigerant	Charge (at 7.5m)	g(oz)	2,800(98.8)
Air Flow Rate	CMM(CFM)		
Sound Level	Sound Pressure at 1m	dB(A)+3	32(1,130) × 2
Piping connections	Liquid(ø)	mm(inch)	51/47
	Gas(ø)	mm(inch)	6.35(1/4) / 15.88(5/8)
Max. Interunit Piping Length	Total Piping (Main+Total Branch)	m	100
	Main Piping	m	40
	Total Branch Piping	m	60
	Each Branch Piping	m	20
Max. Elevation	Indoor Unit~Outdoor Unit	m	30
	Indoor Unit~Indoor Unit	m	15

### Notes:

- Capacities are based on the following conditions:  
Cooling: - Indoor Temperature 27°C(80.6°F) DB / 19 °C(66.2°F) WB  
- Outdoor Temperature 35°C(95°F) DB / 24°C(75.2°F) WB  
Heating: - Indoor Temperature 20°C(68°F) DB / 15°C(59°F) WB  
- Outdoor Temperature 7°C(44.6°F) DB / 6°C(42.8°F) WB  
Piping Length - Main piping 5m, Branch piping 5m  
- Level Difference of Zero.

2. \* : See page "Combination Table"

3. Due to our policy of innovation some specifications may be changed without notification.

4. At least two indoor units should be connected.

5. Minimum combination capacity rate should be more than 40%.

## Specifications\_Outdoor Units



- FM41AH U33
- FM49AH U33
- FM57AH U33

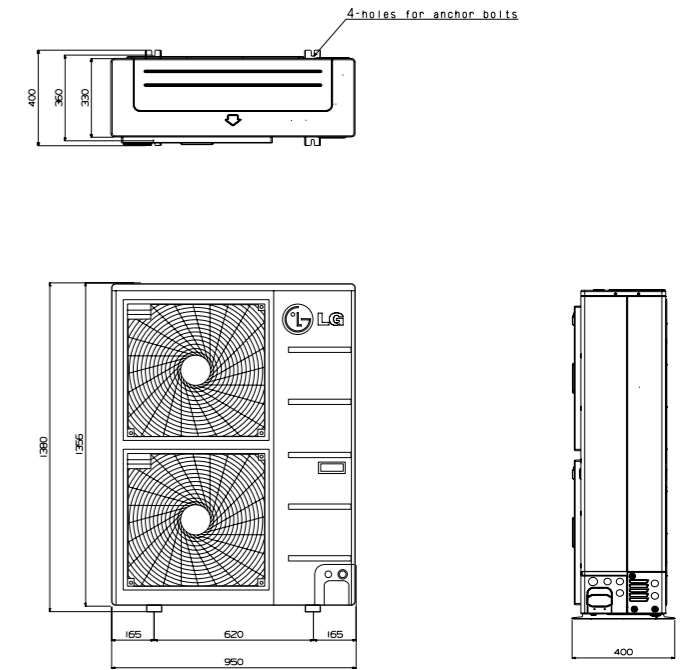

(Unit:mm)

Model	FM41AH U33		FM49AH U33		FM57AH U33	
Nominal Capacity* (Min~Rated~Max)	Cooling	Btu/h	9,600~46,000~48,000	11,400~52,800~58,000	13,800~57,000~63,200	
		kW	2.8~13.5~14.1	3.3~15.5~17.0	4.0~16.7~18.52	
Heating	Btu/h	10,752~48,000~52,000	12,768~56,000~59,000	15,456~61,000~64,000		
	kW	3.2~14.1~15.2	3.7~16.4~17.29	4.5~17.87~18.75		
Nominal Input* (Min~Rated~Max)	Cooling	kW	0.8~4.0~4.9	0.94~4.6~5.4	1.0~4.91~5.7	
	Heating	kW	0.89~3.9~5.1	1.13~4.45~5.2	1.49~4.55~5.65	
Energy label	A/A		A/A		A/A	
Testing Combination	MS07AH N40 × 7EA		MS07AH N40 × 5EA + MS09AH N40 × 3EA		MS09AH N40×8EA	
Running Current (Min~Rated~Max)	Cooling	A	1.5~7.2~8.1	1.8~8.0~8.4	2.3~8.1~9.1	
	Heating	A	1.7~7.5~8.0	2.1~7.5~8.3	2.5~8.0~8.7	
Power Supply	Ø / V / Hz		3/380~415/50		3/380~415/50	
Dimensions	W*H*D	mm(inch)	950×1380×330 (37.4×54.3×13.0)	950×1,380×330 (37.4×54.3×13.0)	950×1,380×330 (37.4×54.3×13.0)	
Net Weight	108(238.0)		108(238.0)		108(238.0)	
Max. Number of Connectable Indoor Units	7		8		9	
Refrigerant	Charge (at 7.5m)	g(oz)	4,800(169.3)	4,800(169.3)	4,800(169.3)	
Air Flow Rate	CMM(CFM)		60(2,119) × 2		60(2,119) × 2	
Sound Level	Sound Pressure at 1m	dB(A)+3	58		59	
Piping connections	Liquid(ø)	mm(inch)	9.52(3/8)		9.52(3/8)	
	Gas(ø)	mm(inch)	19.05(3/4)		19.05(3/4)	
Max. Interunit Piping Length	Total Piping (Main+Total Branch)	m	125	135	145	
	Main Piping	m	55	55	55	
	Total Branch Piping	m	70	80	90	
	Each Branch Piping	m	15	15	15	
Max. Elevation	Indoor Unit~Outdoor Unit	m	30	30	30	
	Indoor Unit~Indoor Unit	m	15	15	15	

### Notes:

- Capacities are based on the following conditions:  
Cooling: - Indoor Temperature 27°C(80.6°F) DB / 19 °C(66.2°F) WB  
- Outdoor Temperature 35°C(95°F) DB / 24°C(75.2°F) WB  
Heating: - Indoor Temperature 20°C(68°F) DB / 15°C(59°F) WB  
- Outdoor Temperature 7°C(44.6°F) DB / 6°C(42.8°F) WB  
Piping Length - Main piping 5m, Branch piping 5m  
- Level Difference of Zero.

2. \* : See page "Combination Table"

3. Due to our policy of innovation some specifications may be changed without notification.

4. At least two indoor units should be connected.

5. Minimum combination capacity rate should be more than 40%.