

THE CHICAGO
ATHENAEUM
MUSEUM OF
ARCHITECTURE
AND DESIGN

The International Architectural Awards

2006
A R C H I V E

A R C H I V E
01



01

CÂMARA MUNICIPAL DE BRAGA STADIUM

Location: Braga, Portugal

Architects: Souto Moura – Arquitectos, LDA

Engineers: Afassociados – Projectos de Engenharia, SA

Client: Braga Municipal Council

Contractor: ACE–Assoc/Soares da Costa, SA

Photographer: Christian Richters

Photographer: Paulo Carica

ARCHIVE
02

02

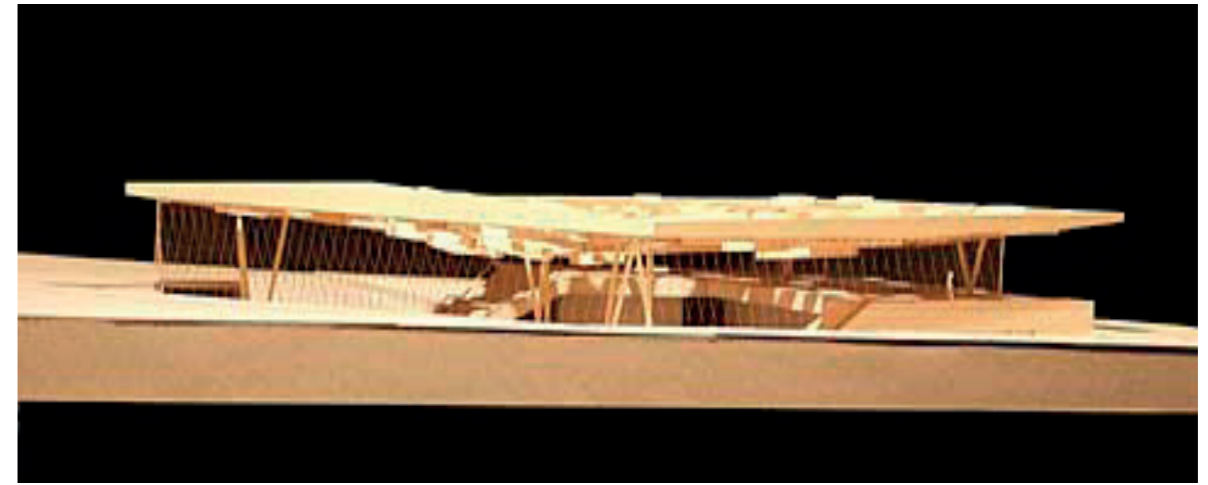

CAMPUS RESTAURANT

Location: Ditzingen, Germany
Architects: Barkow Leibinger Architects
Client: Trumpf GmbH & Co. KG
Engineers: Werner Sobek



A R C H I V E
03

03



LIAUNIG MUSEUM NEYHAUS

Location: Neuhas, Austria

Architects: Odile Decq Benoit Cornette

Client: HL Museumverwaltung GmbH

Engineers: BATISERF

A R C H I V E
04

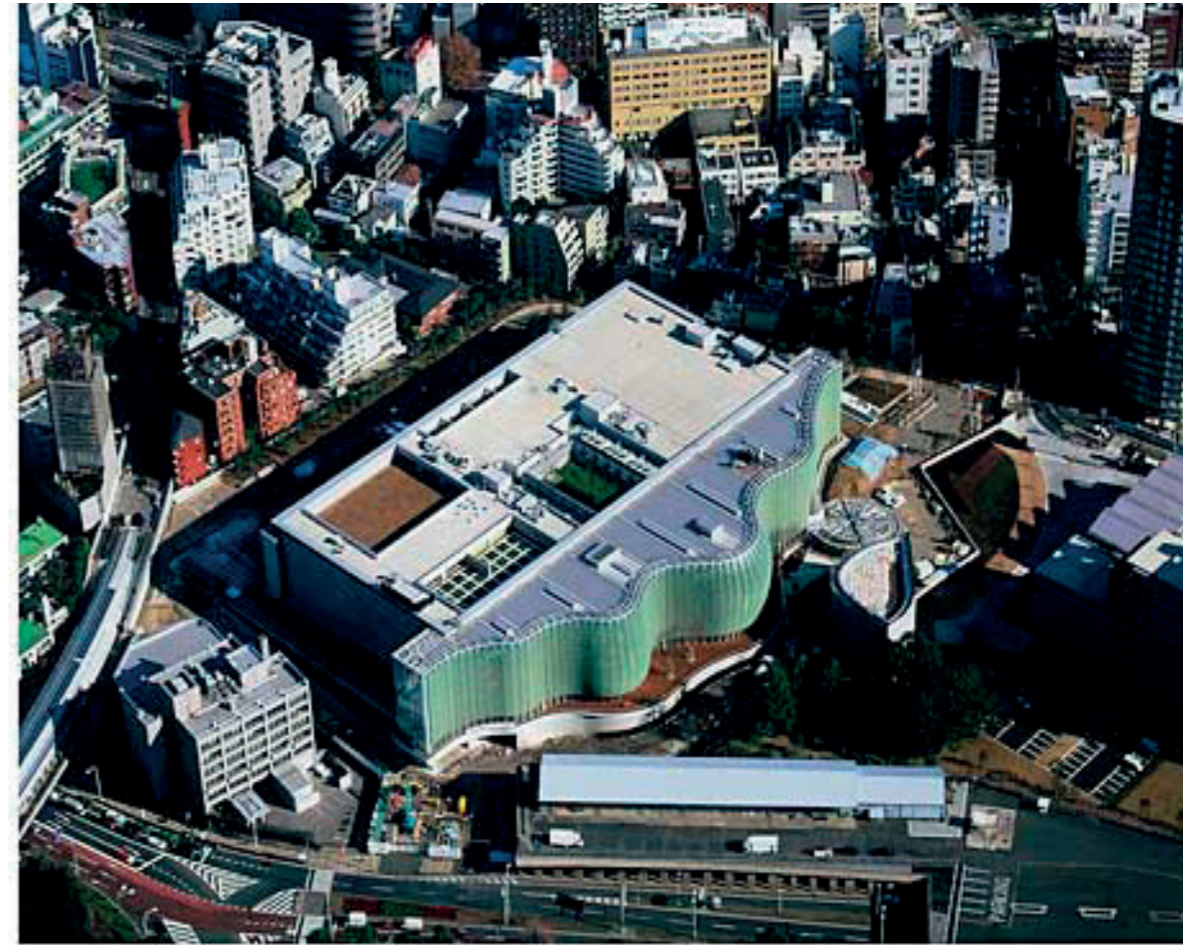

04

THE NATIONAL ART CENTER, TOKYO

Location: Tokyo, Japan

Architects: Kisho Kurokawa Architect + Associates, representative (KCAA + Nihon Sekkei)

Client: Ministry of Education, Culture, Sport, Science and Technology

Contractor: Kajima + Shimizu

Photographer: Koji Kobayashi

Photographer: (Birds Eye View, Detail) Asahi News Paper

Photographer: (Birds Eye View Entire View) SS Tokyo

A R C H I V E
05



05

T CENTER ST. MARX OFFICE BUILDING

Location: Vienna, Austria

Architects: Domenig-Eisenköck-Peyker Architektur Consult ZT GmbH

Client: mm Liegenschaftsbesitz GmbH

Contractor: Porr AG + Wieba GmbH

ARCHIVE 06

06



SHIMANAE ARTS CENTER

Location: Shimane Prefecture, Japan
Architects: Naito Architect & Associates
Client: Shimane Arts Center
Contractor: Taisei Corporation
Photographer: Kazunori Hitruta



ARCHIVE
07

07



THEATRE LA SCALA RENOVATION AND RESTRUCTURING

Location: Milan, Italy

Architects: Studio Arch. Mario Botta

Client: Municipality of Milan

Contractors: CCC-Consortio Cooperative di Costruzione

Photographer: Pino Musi

A R C H I V E
08



08

INFORMATION CENTRE AND ENTRANCE KIOSK TO BEACH AT BOULDERS, SIMON'S TOWN

Location: Cape Town, South Africa
Architects: Piet Louw Architects Urban Planners
Associate Architects: Anton Roux
Client: South African National Parks
Contractor: GVK Siya Zama

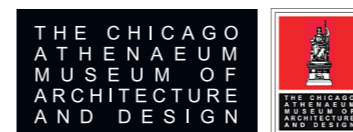

The Chicago Athenaeum | 601 South Prospect Street
Galena, Illinois 61036, USA | Tel: 815/777-4444 | Fax: 815/777-2471
E-mail: curatorial@chicagoathenaeum.org

A R C H I V E
09



09

ÍIHAVO CITY LIBRARY

Location: Ílhavo, Portugal

Architects: ARX Portugal Arquitectos Lta

Client: Câmara Municipal Ílhavo

Contractor: Ramos Catarino, SA

Engineers: Safre Estudos e Projectos de Engenharia Lta

Photographer: FG + SG - Fotografia de Arquitectura

ARCHIVE 10



10

ELM PARK MIXED USE DEVELOPMENT

Location: Dublin, Ireland

Architects: Bucholz McEvoy Architects LLC

Client: Radora Developments

Contractor: William McNamara & Co. Building Contractors

ARCHIVE



11

SAP BUILDING GALWAY

Location: Galway, Ireland
Architects: Bucholz McEvoy Architects
Client: SAP Ireland
Contractor: Heron Property Ltd.



ARCHIVE
12

12



MAGGIES HIGHLANDS CANCER CARING CENTRE

Location: Inverness, Scotland, United Kingdom

Architects: Page/Park Architects

Client: Maggie's Centres

Contractor: Morrison Construction

Photographer: Harvey Wood

Photographer: Keith Hunter

ARCHIVE
13

13



THREE HOUSES AT JERVOIS ROAD

Location: Singapore
Architects: BEDMaR & SHi Pte Ltd
Client: Erwin Luhur
Contractor: Sysma Construction
Photographer: Albert Lim KS



ARCHIVE
14



14

TREVOSE 12 LANDED HOUSING PROJECT

Location: Singapore
Architects: BEDMaR & SHi Pte Ltd
Associate Architects: Project & Design Architects
Client: Kheng Leong Pte. Ltd.
Contractor: Eng Kim Construction
Photographer: Albert Lim KS

ARCHIVE
15

15



BARCOM AVENUE APARTMENTS

Location: Sydney, Australia
Architects: Ian Moore Architects
Client: Jumbuk Pty. Ltd.
Contractor: Arenco
Photographer: Ross Honeysett

ARCHIVE
16

16



THREE HOUSES AT VICTORIA ROAD

Location: Singapore

Architects: WOHA Designs Pte. Ltd.

Client: Sin Heng Chan (1960) Pte. Ltd.

Contractors: Hoe Guan Engineering Private Limited

Engineers: KH Consultants

ARCHIVE
17

17



LEV OFFICE BUILDING

Location: Ljubljana, Slovenia
Architects: Studio Kalamar
Client: Interimg Holding d.o.o.
Contractor: SGP Pomgrad d.o.o.
Engineers: IZTR d.o.o.
Photographer: Miran Kambic



ARCHIVE
18

18



ATHLONE CIVIC CENTRE

Location: Athlone, Co. Westmeath, Ireland

Architects: Keith Williams Architects

Client: Westmeath County Council & Athlone Town Council

Contractor: John Sisk & Sons (Ltd.) Galway

ARCHIVE
19

19



CENTENNIAL HP SCIENCE AND TECHNOLOGY CENTRE

Location: Toronto, Canada

Architects: Kuwabara Payne McKenna Blumberg Architects

Associate Architects: Stone McQuire Vogt (SMV) Architecture

Client: Centennial College

Contractor: Vanbots

THE CHICAGO
ATHENAEUM
MUSEUM OF
ARCHITECTURE
AND DESIGN



The Chicago Athenaeum | 601 South Prospect Street
Galena, Illinois 61036, USA | Tel: 815/777-4444 | Fax: 815/777-2471
E-mail: curatorial@chicagoathenaeum.org

ARCHIVE
20

20



GUANGZHOU CITY LIBRARY

Location: Guangzhou, People's Republic of China
Architects: Rocco Design Ltd.
Client: Guangzhou Urban Planning Bureau



The Chicago Athenaeum | 601 South Prospect Street
Galena, Illinois 61036, USA | Tel: 815/777-4444 | Fax: 815/777-2471
E-mail: curatorial@chicagoathenaeum.org

ARCHIVE 21

21



THE RED HOUSE

Location: London, Great Britain
Architects: Tony Fretton Architects
Client: Alex Sainsbury
Contractor: Gardiner & Theobald Mana
Engineers: Price and Myers

ARCHIVE 22



22

HOUSE FOR THE FOUR SEASONS

Location: New York, New York, USA
Architects: SCDA Architects Pte. Ltd.
Client: Withheld

ARCHIVE
23



23

EUROSPAR LEIBNITZ SUPERMARKET

Location: Leibnitz, Austria

Architects: Rieger Riewe, Architects Pty. Ltd.

Client: SPAR Österreichische Warenhandels AG

Contractor: Vollmann Hoch - U. Tiefbau GmbH

Engineers: Gmeiner Haferi Civil



ARCHIVE
24

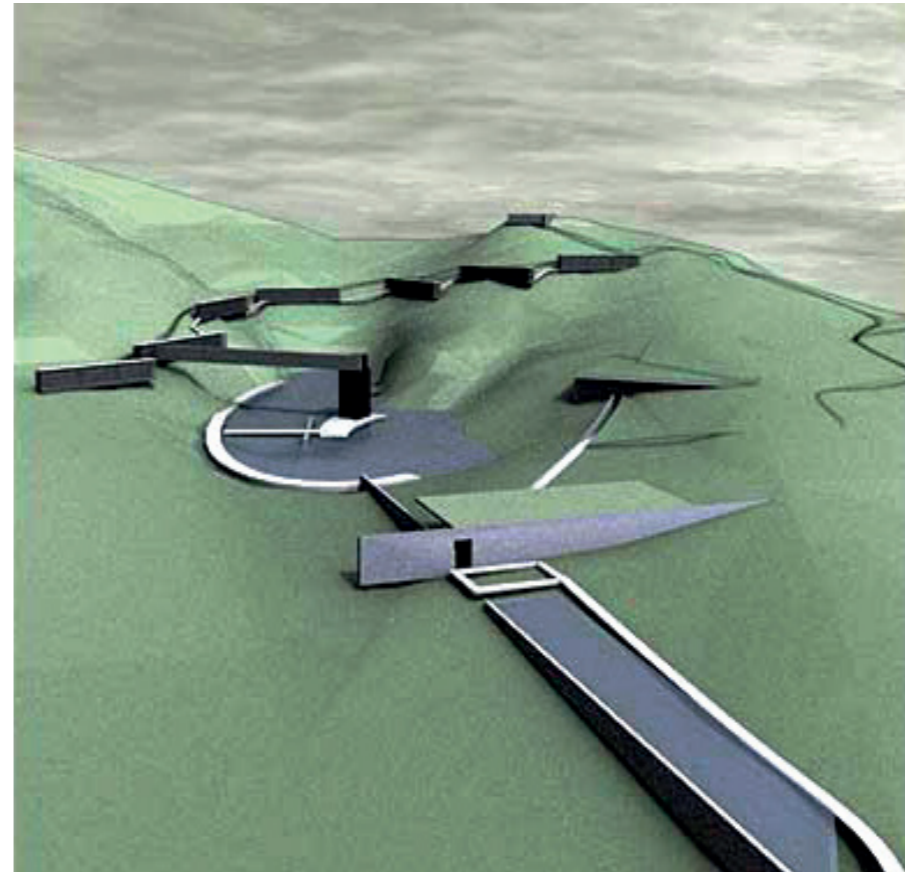

24

THE COLUMBARIUM

Location: Guangzhou, People's Republic of China

Architects: SCDA Architects Pte. Ltd.

Client: Yan Qing Yuan (HK) Ltd.

ARCHIVE
25

25



HEEREN STREET SHOPHOUSE

Location: Malacca, Malaysia

Architects: SCDA Architects Pte. Ltd.

Client: Hsieh Fu Hua

Contractor: Integrity Furnishing & General Construction

Engineers: Web Structures

ARCHIVE
2006

26



PARISH CENTER PODERSDORF

Location: Podersdorf, Austria
Architects: lichblau.wagner architekten
Client: Stift Heiligenkreuz
Contractor: Gartner-Schiener Bau GmbH
Photographer: Bruno Klomfar, Margherita Spiluttini

ARCHIVE
27

27



TRAVEL EUROPE OFFICE BUILDING

Location: Stans, Austria

Architects: Oskar Leo Kaufmann | Albert Rűf

Client: DMG

ARCHIVE
2006

28



TOMIHIRO ART MUSEUM

Location: Gunma, Japan

Architects: aat + makoto yokomizo architects Inc.

Client: Azuma Village

Contractor: aat + makoto yokomizo architects Inc.

Engineers: Arup Japan

Photographer: Christoffer Rudquist

Photographer: Shigeru Ohno

ARCHIVE
20



SHANGHAI XINTIANDI

Location: Shanghai, China
Architects: Ben Wood Studio Shanghai
Client: Shui on Land



ARCHIVE
30

30



M-CLINIC

Location: Hiroshima, Japan
Architects: Kubota Architect Atelier
Client: Miyata Eye Clinic
Contractor: Nomura Architecture
Construction

ARCHIVE
31

31



I-HOUSE

Location: Hiroshima, Japan

Architects: Kubota Architect Atelier

Client: Takashi & Hitomi Ito

Contractor: Nomura Architecture Construction

ARCHIVE
32



32

VIIKKI CHURCH

Location: Helsinki, Finland

Architects: JKMM Architects, ATL

Client: Helsinki Parishes

Contractor: Peab Seicon OY

Photographers: Arno de la Chapelle, Jussi Tiainen, Kimmo Räisänen

The International Architectural Awards

2006 ARCHIVE

THE CHICAGO
ATHENAEUM
MUSEUM OF
ARCHITECTURE
AND DESIGN



The Chicago Athenaeum | 601 South Prospect Street
Galena, Illinois 61036, USA | Tel: 815/777-4444 | Fax: 815/777-2471
E-mail: curatorial@chicagoathenaeum.org