



QUICK START GUIDE

Once you have installed the CWT Sato To Go app, tap on the icon to launch the app, and then complete these steps to register and log in.

NOTE: Following recent updates made to the app, all users will be required to re-register their CWT Sato To Go credentials.

1. Log into the app.

Click the **LOG IN** button on the Welcome screen.



2. Accept the Privacy Act Notice.

Click the **ACCEPT** button when the Warning Message displays.

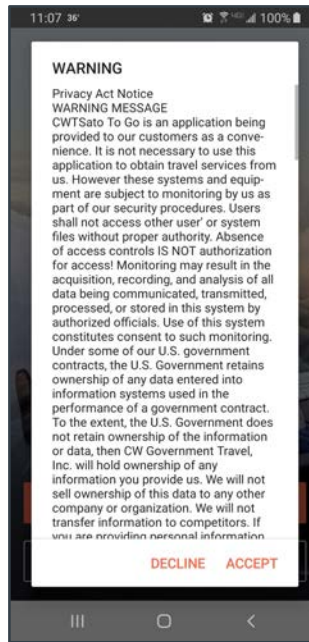

3. Re-register your CWT Sato To Go credentials.

Click the **RE-REGISTER** button to continue.

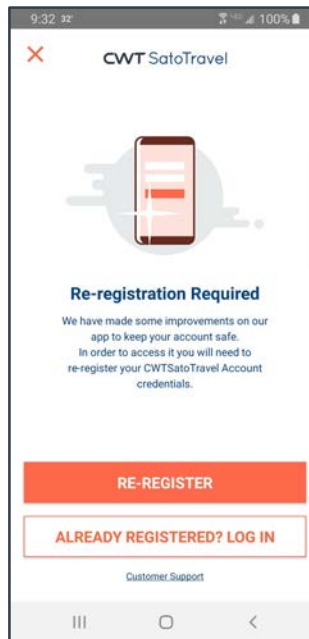

4. Create your CWT Sato To Go account.

- Enter your official email address in the **Work email address** field.
- Enter your name in the **First name** and **Last name** fields.
- Click **NEXT**. A "Welcome to CWT" email is sent to your email address.

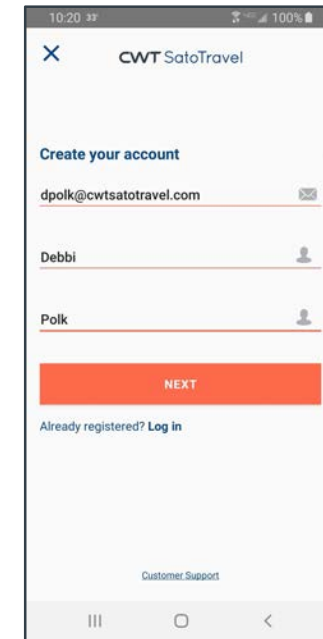

5. Activate your account.

Click the **ACTIVATE ACCOUNT** button in the email, or copy and paste the supplied link into your browser.

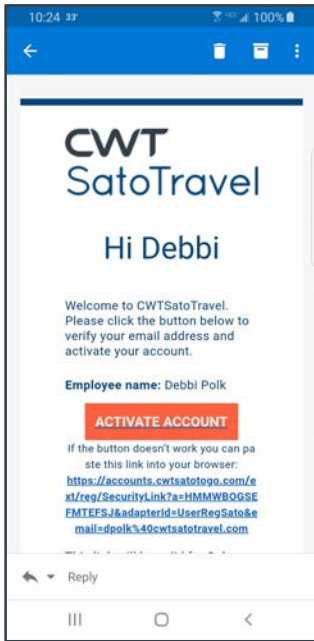

6. Create a password for the app.

Enter the password in the **Password** field, and then click the **SIGN UP** button.

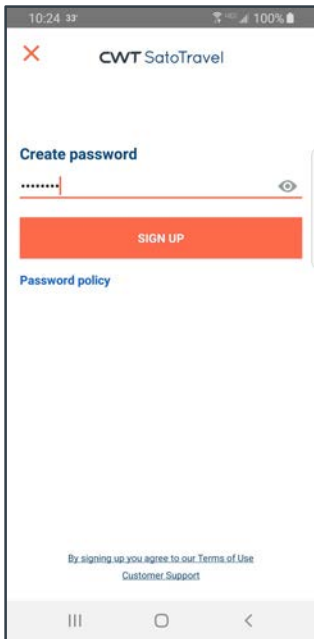

7. Set your home city.

Enter your city in the **Search city** field, and then click the **NEXT** button.

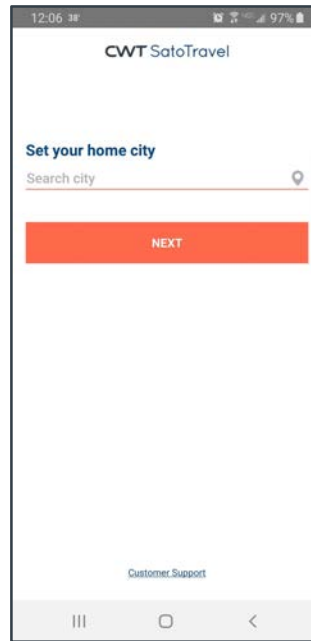

8. Remember your email?

To make it easier to log on the next time you access the app, click **Yes** when the *Remember my email on this device?* message displays. The app will remember your user name/email address, and all you will need to enter is your password.

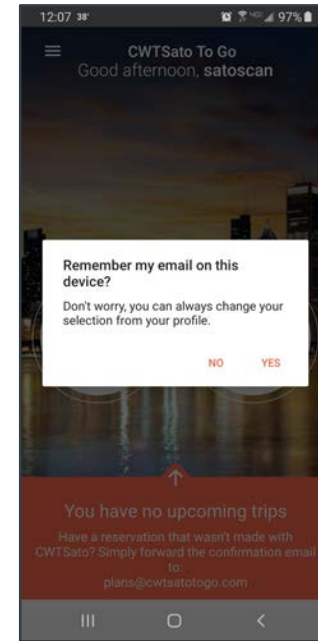

9. Start using CWTSato To Go!

Version 2.0 – April 2019

CWTSatoTravel is a trademark of CWT. All other marks are the property of their respective owners.

© 2019 CW Government Travel, Inc. All rights reserved.