



Land at Newhouse,
Rusland, Harray,
Orkney, KW17 2LE



Land extending to approx. 1.26 acres located in Harray close to the Merkister Hotel. With impressive views overlooking the famous Harray Loch and neighbouring countryside. Also has the advantage of being situated close to Skara Brae, Maeshowe, Brough of Birsay and many more tourist attractions, with a 15 minute drive from Kirkwall and Stromness.

Included in the sale is a ruinous dwelling that would be ideal to renovate or replace subject to the appropriate consents from the local authority. Electricity and water are located close by.

The land is easily accessible and the surrounding land will not be developed in the future.

To view simply call past the sites or telephone the office for further details (01856 872216).

Offers over £70,000

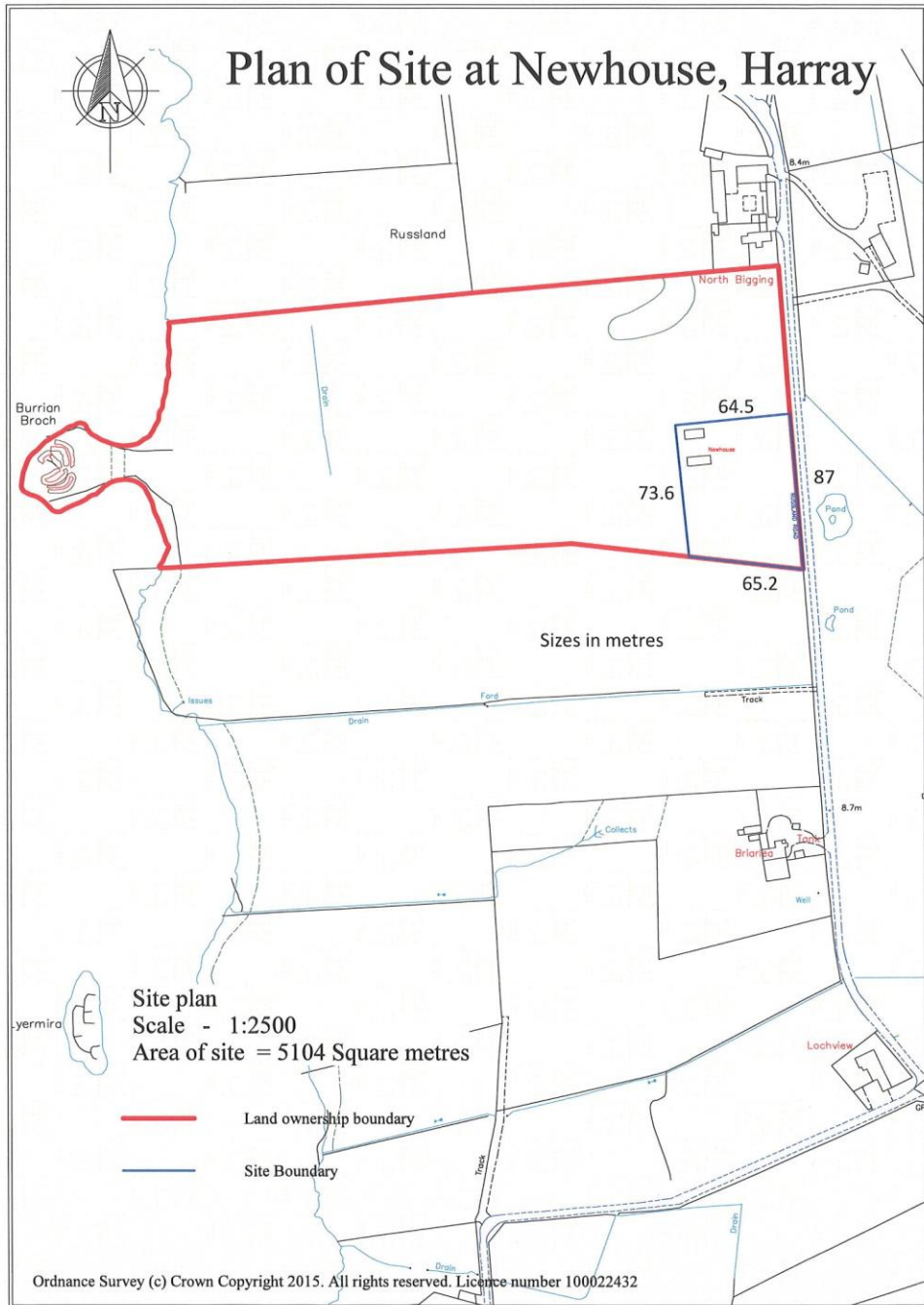

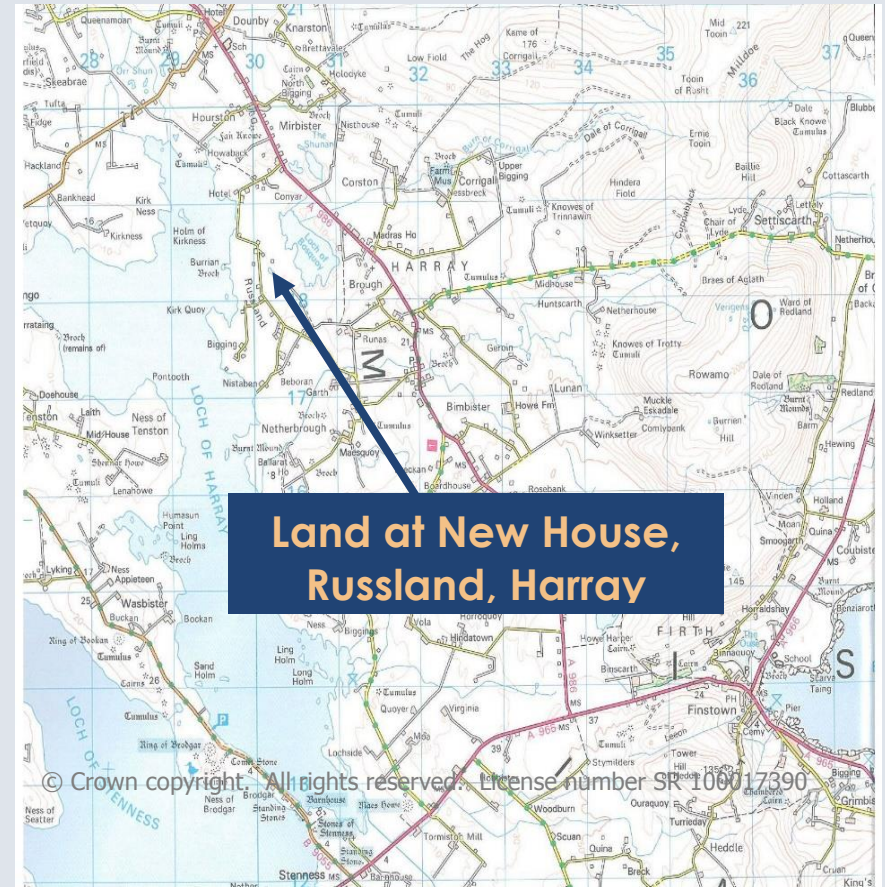

**Land at New House,
Russland, Harray**

NOTES - These particulars have been prepared following an inspection of the property on the 22 January 2019 and from information furnished by the sellers on that date. Whilst every care has been taken in the preparation of these particulars they are not guaranteed or warranted in any way, nor will they give rise to an action in law. In particular it should be noted that all measurements are approximate only. Prospective purchasers are recommended to view the subjects personally. Interested parties should note their interest with the Selling Agents. However, the Seller retains the right to accept an Offer at any time without setting a Closing Date.

d and h, 56A Albert Street, Kirkwall, Orkney KW15 1HQ tel: 01856 872216 fax: 01856 872483
email: enquiries@dandhlaw.co.uk www.dandhlaw.co.uk