



8-Channel HD PoE+ NVR with 2 TB HDD

TV-NVR208D2 (v1.0R)

- Standalone 8-channel PoE+ network video recorder
- Plug and play up to 8 TRENDnet PoE cameras*
- Concurrent 1080p HD video recording for all channels
- Preinstalled 2 TB HDD provides one week of continuous 1080p video recording***
- Two 3.5" SATA II bays support up to a 12 TB of storage (6 TB max. per bay, additional HDDs sold separately)
- Advanced video playback
- Rack mountable
- PoE power budget: 120 W
- ONVIF compliant

TRENDnet's standalone 8-channel HD PoE+ NVR, model TV-NVR208D2, offers a comprehensive rack mountable camera management solution. This NVR includes a preinstalled 2 TB hard drive and connects up to eight cameras*. Install up to 12 terabytes of storage (additional hard drives sold separately) to record four weeks of continuous video from eight HD cameras**. The TV-NVR208D2 features advanced video playback and free iOS® / Android™ apps available.

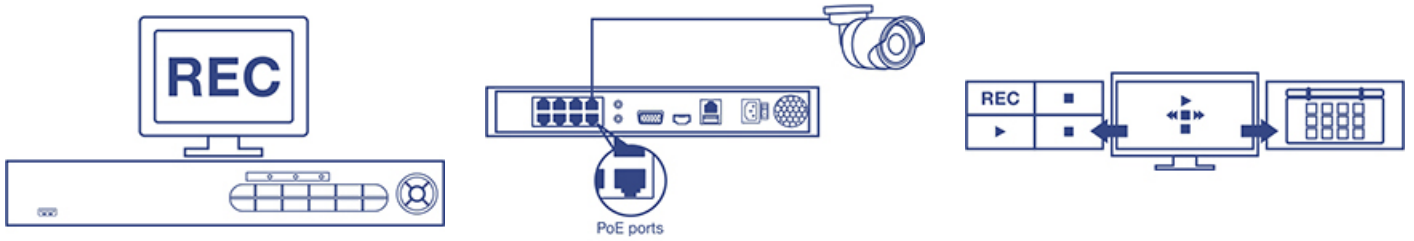

Standalone HD NVR

This standalone 1080p HD NVR includes a preinstalled 2 TB hard drive and supports a total storage capacity of up to 12 TB and powers up to eight PoE network cameras—HDDs, cameras, and display sold separately.

Plug-and-Play Installation

The NVR auto-recognizes and powers TRENDnet PoE cameras* – simply connect compatible TRENDnet PoE cameras and start recording surveillance video.

Intuitive Interface

Users will find the management interface intuitive and easy to use – quickly navigate live view preferences, recording schedules, and advanced playback options.

Networking Solution

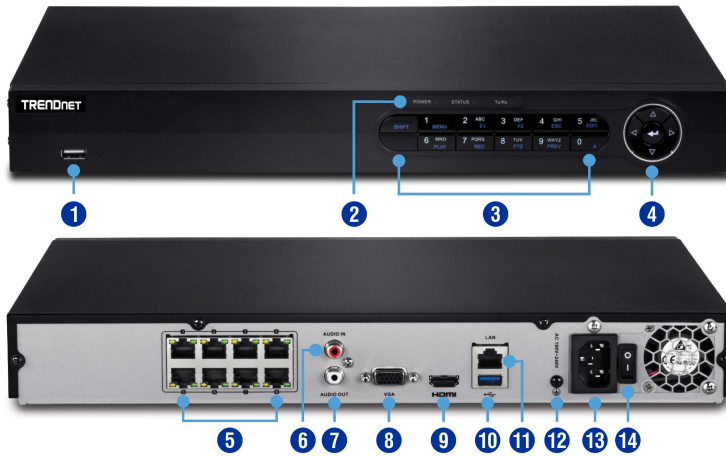

- | | | | |
|---|---------------------|----|-----------------|
| 1 | USB 3.0 | 8 | VGA port |
| 2 | LED indicators | 9 | HDMI port |
| 3 | Push button control | 10 | USB 3.0 port |
| 4 | Navigation button | 11 | LAN port |
| 5 | PoE ports | 12 | Ground |
| 6 | Audio in | 13 | Power port |
| 7 | Audio out | 14 | On / off switch |

Hardware



PoE+ Ports

Plug and play TRENDnet PoE network cameras* to the eight PoE+ ports with a total power budget of 120 W



Storage

Two 3.5" SATA II bays support up to 12 TB of total storage (2 TB HDD Included, 6 TB max. per bay)



Network Uplink Port

Gigabit Ethernet network uplink port



Display Interface

HDMI and VGA interfaces



Audio Ports

Audio in and out ports



USB Ports

One USB port for the included mouse and one for configuration backup



Mouse Included

Supports mouse and keyboard (keyboard sold separately)



Rack Mount

Rack mount hardware included

Management



Mobile App

See live video on a mobile device with the free iOS® and Android™ apps



Remote Access

Access the NVR over the internet



Camera Setup

Auto-recognizes TRENDnet cameras* and works with most PoE network cameras



Live View

Multiple camera viewing options with auto-scan function



Camera Management

For each camera, manage on-screen display (OSD), image settings, PTZ functionality, motion detection, privacy masks, tamper detection, and video loss



Video Recording

- Max. resolution for all cameras concurrently: Full HD 1080p video at 30 fps in H.264 compression
- Max. for a single camera: 6 MP resolution in H.264 compression



Recording Time

- One week of continuous recording per camera with preinstalled 2 TB HDD and 8 x 1080p cameras at 30 fps (medium VBR)
- Four weeks of continuous recording per camera with 12 TB of storage (HDDs sold separately) and 8 x 1080p cameras at 30 fps (medium VBR)



Scheduled Recording

Create weekly continuous and motion detection recording schedules for each camera with video overwrite when storage is full



Advanced Playback

Advanced archived video playback with a quick reference timeline and calendar



Video Export

Quickly export and archive recorded video



Dynamic DNS Support

Support for dyn.com and NO-IP.com



IPv6

IPv6 support



ONVIF

ONVIF compliant

Specifications

Video Output

- HDMI / VGA
- Resolution:
 - 1920 × 1080P / 60Hz
 - 1600 × 1200P / 60Hz
 - 1280 × 1024 / 60Hz
 - 1280 × 720 / 60Hz
 - 1024 × 768 / 60Hz

Audio

- Line-in with RCA connector (2.0 Vp-p, 1 kΩ)
- Line-out with RCA connector

Recording

- 8-channel simultaneous recording up to 1080p 30 fps
- 2 SATA interface for HDD or SSD up to 6 TB storage each

Playback

- Playback resolution: 5MP, 3MP, 1080p, UXGA, 720p, VGA, 4CIF, DCIF, 2CIF, CIF, QCIF

Hardware Standards

- IEEE 802.3
- IEEE 802.3u
- IEEE 802.3x
- IEEE 802.3ab
- IEEE 802.3af
- IEEE 802.3at

Device Interface

- 1 x Gigabit network port
- 8 x 10/100 PoE+ camera network ports
- 1 x 2 TB HDD
- 1 x USB 2.0, 1 x USB 3.0
- HDMI port
- VGA port
- Analog audio in / out port
- Power port
- LED indicators (Power, Storage, and Network)

PoE Ports

- PoE 802.3at (max. 30 W per port)
- Total PoE power budget: 120 W

- Plug and play with TRENDnet PoE cameras*

Network Protocol

- IPv4, IPv6, UDP, TCP, ICMP, SSL, TLS, ONVIF v2.2
- DHCP, NTP, DNS, DDNS, SMTP, FTP, SNMP v2
- HTTP, UPnP, RTSP, RTP, RTCP

Operating Temperature

- -10 ~ 55 °C (14 ~ 131 °F)

Operating Humidity

- Max. 90% non-condensing

Certifications

- CE
- FCC
- UL 60950

Dimensions

- 380 x 310 x 45 mm (15 x 11 x 1.8 in.)

Weight

- 3.3 kg (7.3 lb.)

Power

- Input: 100 – 240 V AC, 50/60 Hz
- Power consumption:
 - Main board: 10 W max.
 - Fully loaded with HDD and PoE: 150 Watts max.

Management Interface

- Live view: Simultaneous 3x3, 1+7, 1+5, 2x2 views or auto switch single view
- Scheduled recording: continuous and motion detection with optional holiday exceptions.
- Supporting camera configuration through NVR*: On Screen Display, display settings: brightness, contrast, saturation, PTZ, motion detection setting, video tamper, and video loss.
- Holiday scheduling for custom recording schedules during observed holidays
- Advanced playback: playback multiple channels simultaneously and search video recordings with special event or tag
- Video export: tag, cut, and export video clips

- HDD: Encoded disk formatting, S.M.A.R.T. disk health monitoring and testing, bad sector detection, storage quota allocation to each video channel, recycle old recordings or send disk full warning to administrator by email
- USB external storage: firmware upgrade, import / export configuration file and logs, export recorded video files, search and playback videos directly from external storage
- Local live view settings: define screen layout and channel viewing sequence
- Alert messages: storage full, storage error, network disconnected, IP conflict, illegal login, and recording exceptions, and PoE power overload.
- Supported dynamic DNS services: Dyn.com and NO-IP.com
- Management Setting: maximum 32 user accounts
- Traffic chart and statistics for network management

TRENDnet IP View App

- Free iOS® and Android™ app
- View your NVR video on your mobile device
- Take snapshots
- Zoom

Warranty

- 2 year limited

Package Contents

- TV-NVR208
- 1 x 2TB HDD
- CD-ROM (Utility & User's Guide)
- Power cord (1.8 m / 6 ft.)
- Network cable (1.8 m / 6 ft.)
- HDMI cable (1.8 m / 6 ft.)
- Optical mouse
- IR Remote Control
- SATA data cables / power cables
- Quick Installation Guide
- Rack mount hardware

*See list of compatible cameras

** Four weeks of continuous recording 8 cameras in 1080p resolution at 30 fps (medium VBR) with 12 TB of storage (HDDs not included)

*** One week of continuous recording per camera with preinstalled 2 TB HDD and 8 x 1080p cameras at 30 fps (medium VBR)

