

# **HARVEST**

by **MERIDIAN**



## **A1042 AUGER ASSEMBLY MANUAL**

**Read & understand all instructions pertaining to this auger prior to use!**



# Safety Alert

Watch for this **ALERT** Symbol. It identifies potential hazards to Personal **SAFETY** and your **HEALTH**. It points out Safety precautions.

This **SAFETY** symbol means:

**ATTENTION:**

**BE ALERT**

Why is **SAFETY** important to you?

**THREE BIG REASONS:**

\***ACCIDENTS DISABLE AND KILL**

\***ACCIDENTS COST**

\***ACCIDENTS CAN BE AVOIDED**

Failure to read this Auger manual before operation of the Auger is a misuse of the equipment and a needless risk to your **HEALTH** and **SAFETY**. Your life and limbs are worth keeping. Use this equipment with care.

## Symbol

**Signal Words:**

**DANGER, WARNING, CAUTION**

The appropriate signal word for each message has been selected using the following guidelines below the Alert Symbol.



**BE ALERT!**

**DANGER** – Indicates an imminently hazardous situation that, if not avoided, will result in death or serious injury. This signal word is to be limited to the most extreme situations, typically for machine components that, for functional purposes, cannot be guarded.

**WARNING** – Indicates a potentially hazardous situation that, if not avoided, could result in death or serious injury, and includes hazards that are exposed when guards are removed. It may also be used to alert against unsafe practices.

**CAUTION** – Indicates a potentially hazardous situation that, if not avoided, may result in minor or moderate injury. It may also be used to alert against unsafe practices.

# TABLE OF CONTENTS

<b>Tube Identification</b>	.....	<b>4</b>
Step 1		
<b>Tube &amp; Flighting Assembly</b>	.....	<b>4</b>
Steps 2-7		
<b>Winch Installation</b>	.....	<b>5</b>
Step 4		
<b>Discharge Head Assembly</b>	.....	<b>5</b>
Step 5		
<b>Infeed Housing Assembly</b>	.....	<b>6</b>
Steps 6-16		
<b>Transport Arm Assembly</b>	.....	<b>12</b>
Steps 17 & 18		
<b>Carriage Assembly (Identification)</b>	.....	<b>14</b>
Step 19-27		
<b>Lift Cable Assembly</b>	.....	<b>19</b>
Step 28		
<b>Swing Tube &amp; Hopper Assembly</b>	.....	<b>20</b>
Steps 29-35		
<b>Parts Book Drawings</b>	.....	<b>24</b>

## Step 1

### Tube Identification

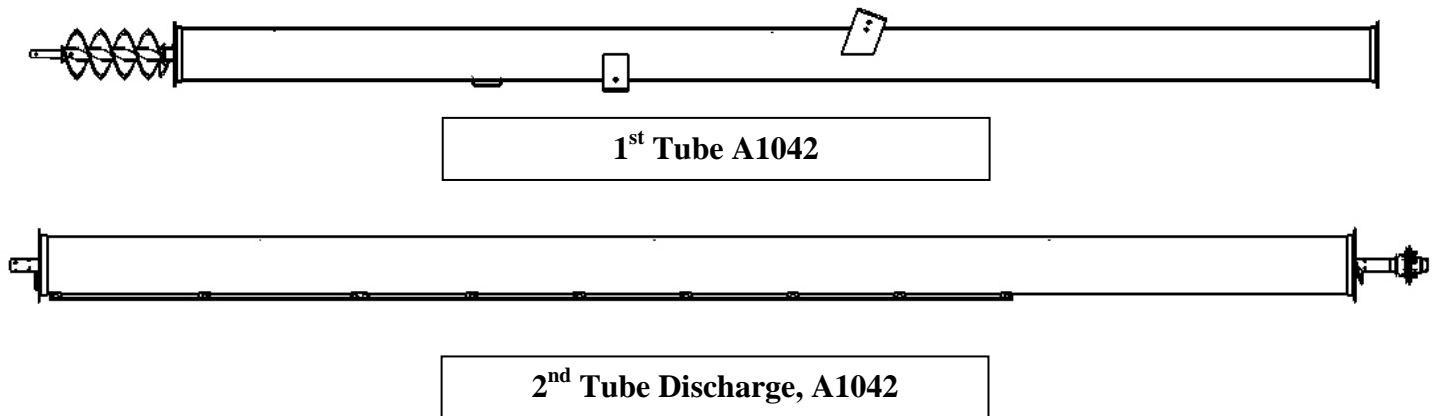

### Step 2 (Tube & Flighting Assembly)

Place tubes on assembly stands as shown. Place stands 12" or less from the end of the tube. Placing stands further than 12" from end of the tube may cause damage to the tubes.

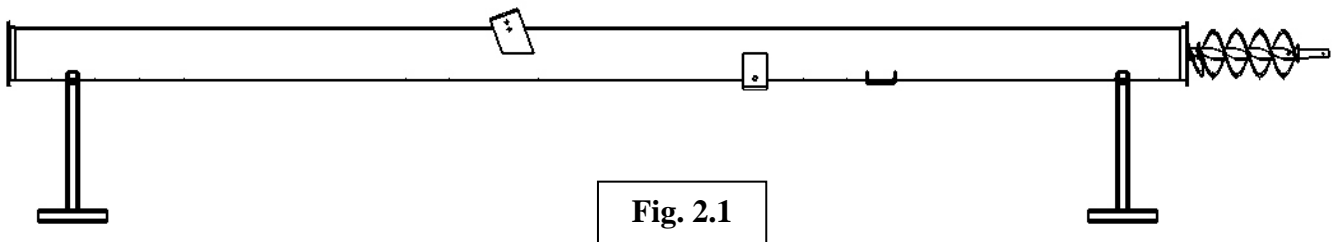

### Step 3

Slide the flighting together from the 1<sup>st</sup> & 2<sup>nd</sup> tube. Connect the flighting using (2) 1/2" x 2-1/2" hex bolts and top lock nuts. Align flighting as shown to make continuous. After connecting the flighting, slide the 1<sup>st</sup> & 2<sup>nd</sup> tube together putting in the top 2 & bottom (2) 1/2" x 1-1/2" flange bolts & nuts.

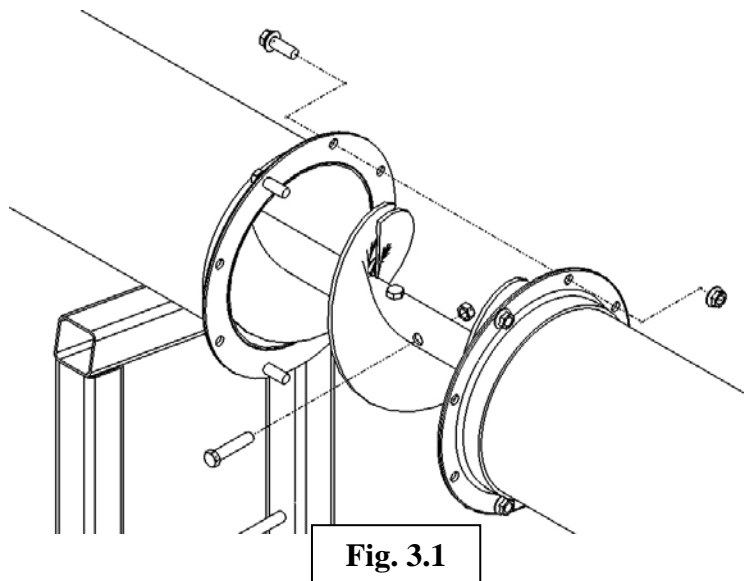

#### **Step 4 (Winch Installation)**

After the drive option is assembled on to the auger the winch will need to be installed. To install the winch, fasten it to the bracket welded on the underside of the first tube. Secure it to the bracket by using (3) 3/8" x 1" hex flange bolts & nuts as shown in fig. 4.1. (If handle is not installed on the winch refer to the operator's manual for the winch that is provided)

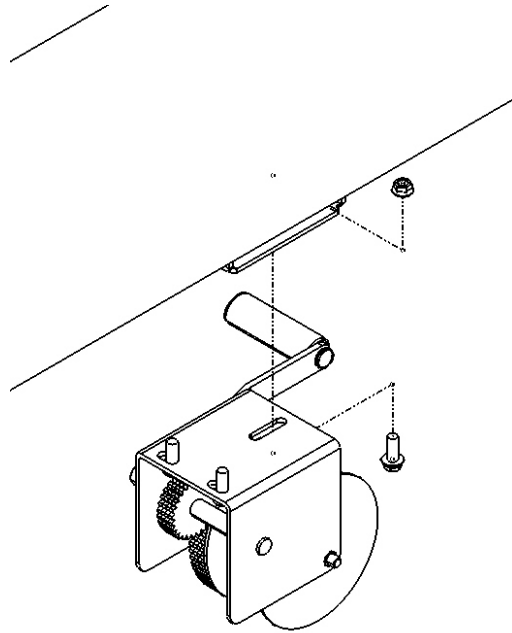

**Fig. 4.1**

#### **Step 5 (Discharge Head Assembly)**

Next, align the 5 studs on the flighting with the 5 holes in the discharge head. Fasten the discharge head to the flighting using (5) 1/2" lock washers & (5) 1/2" lug nuts. Thread lug nuts on flat side against the lock washers. Tighten the 5 lug nuts. Next, fasten the discharge head to the tube using (2) 1/2" x 1-1/2" flange bolts & nuts & (6) 1/2" x 1-1/2" hex bolts & flange nuts. The flange bolts are used on the top 2 holes of the discharge head as shown. Tighten all 8 bolts mounting the discharge head to the tube. Tie red flag supplied in the kit to the discharge head.

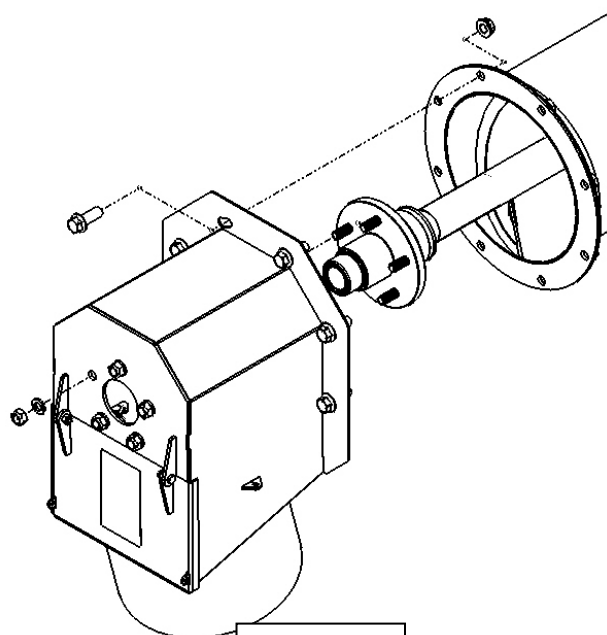

**Fig. 5.1**

### **Step 6 (Infeed Housing Assembly)**

Loosen bolts and remove both access panels. Using a lifting strap, lift and slide the infeed housing over the bottom flighting on the 1<sup>st</sup> tube. Secure the infeed housing to the first tube using (6) 1/2" x 1-1/2" flange bolts and nuts & (2) 1/2" x 1-1/2" hex bolts & flange nuts. The (2) 1/2" x 1-1/2" hex bolts should be used on the bottom holes and orientated as shown in fig. 6.4.

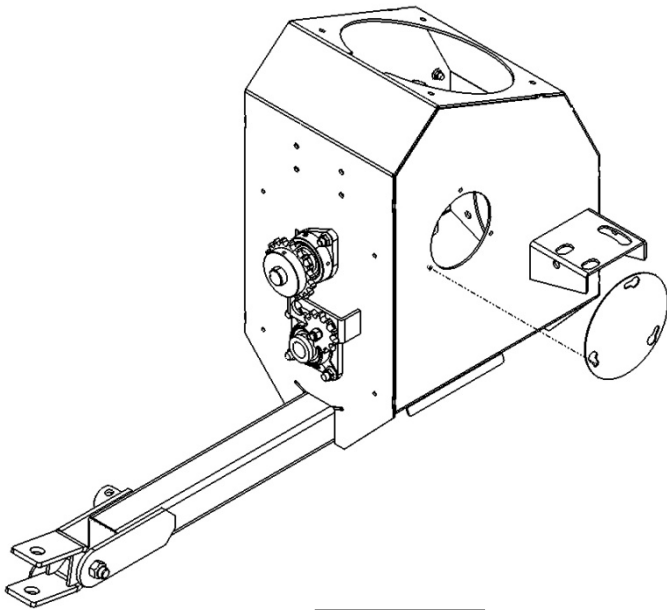

**Fig. 6.1**

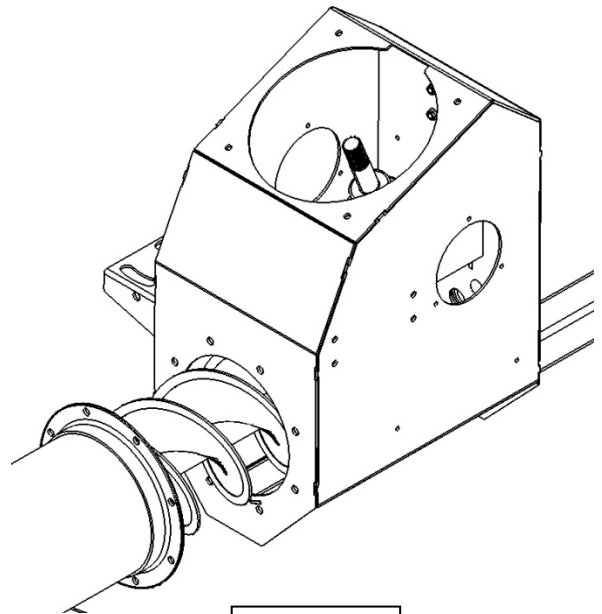

**Fig. 6.2**

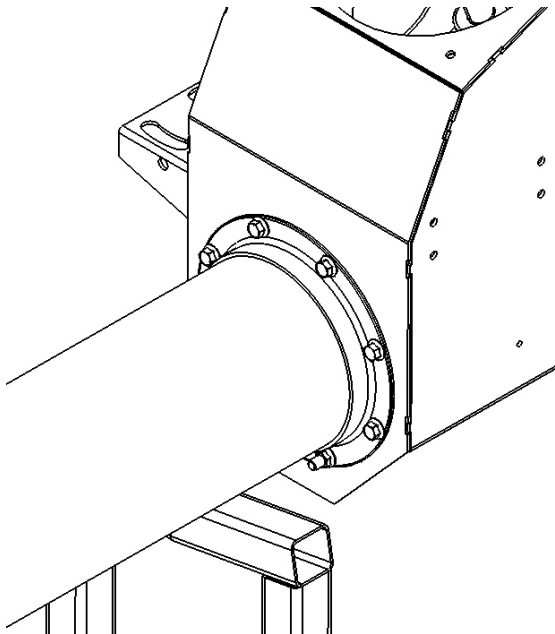

**Fig. 6.3**

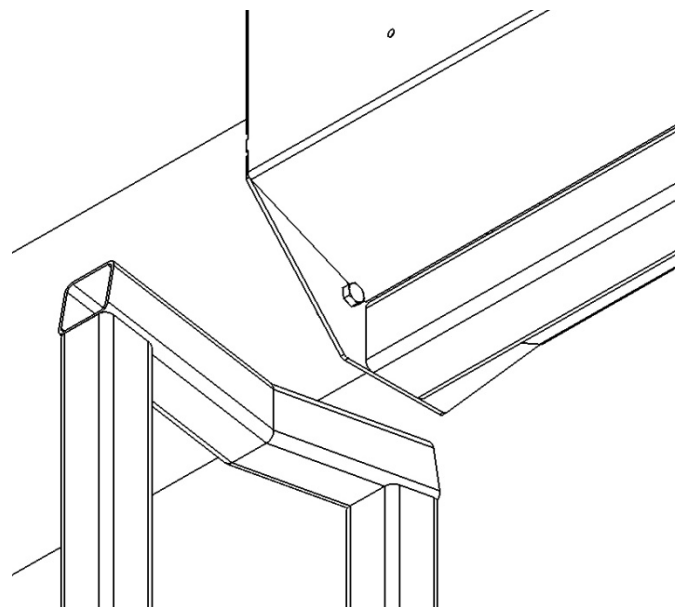

**Fig. 6.4**

### **Step 7**

Next, locate the gearbox mounted inside of the infeed housing. Remove the 2 top plugs in the gearbox & replace the top one with the grease zerk & the bottom one with the breather provided.

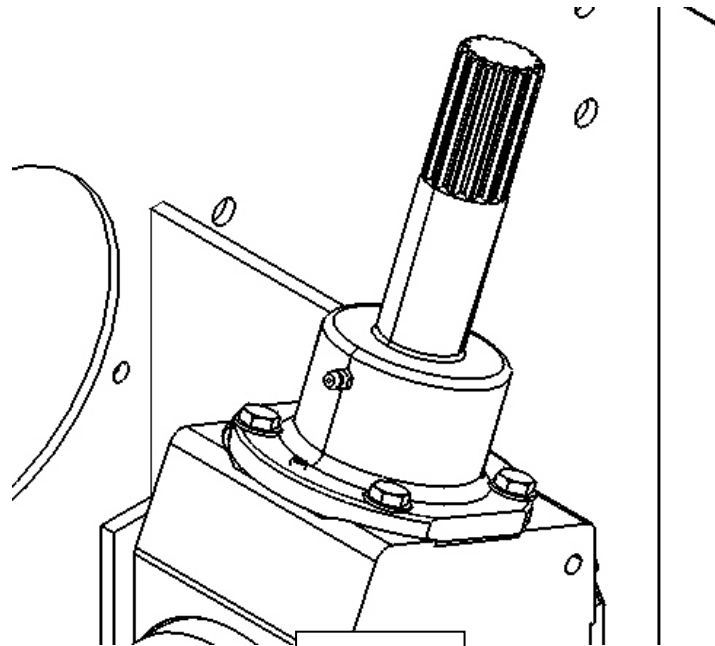

**Fig. 7.1**

### **Step 8**

Next, slide the 4 bolt 1-1/4" cast flange bearing over the shaft making sure the grease zerk is located on the same side as the idler sprocket. (If the shaft has surface rust, clean first with an emry cloth) Secure the 4 bolt bearing to the infeed housing using (4) 1/2" x 1-1/2" carriage bolts & flange nuts as shown. When completed use a punch to rotate the shaft so the keyway is in an easy to access position.

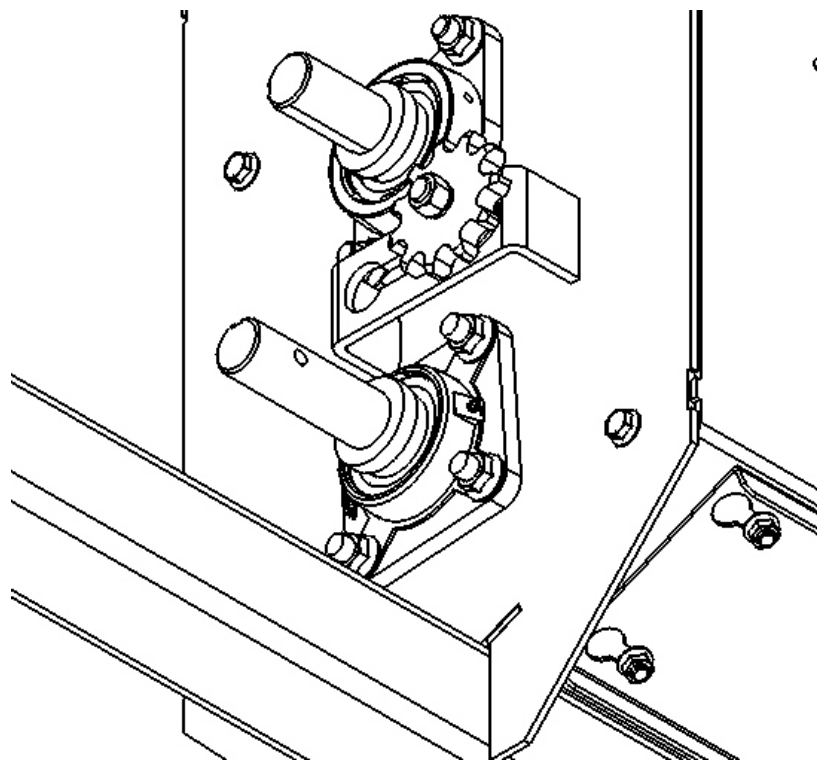

**Fig. 8.1**

### **Step 9**

Next, insert (2) 1/4" x 1" square keys into the top & bottom shaft. Slide the 18 tooth sprocket onto the top shaft & the 20 tooth sprocket onto the bottom shaft as shown in fig. 9.1. Use a measuring tape & measure the distance from the center of each sprocket to the infeed housing. Once sprockets are aligned, apply lock-tite to set screws & tighten.

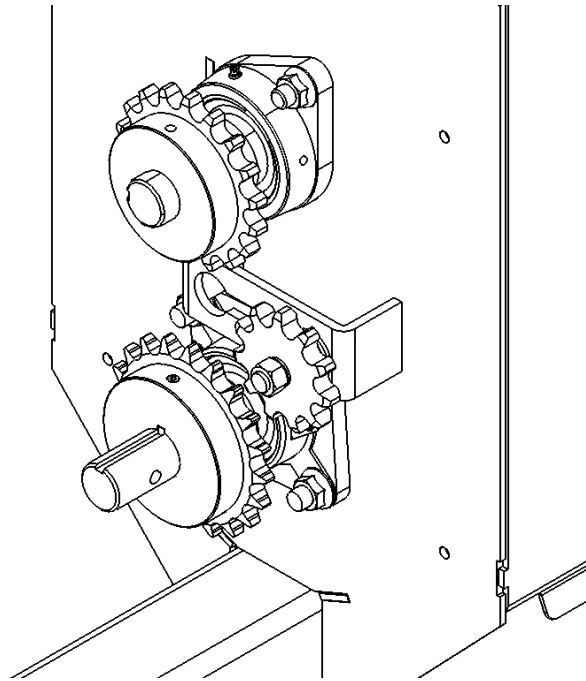

**Fig. 9.1**

### **Step 10**

Locate the #60 chain, #60 half link, & #60 connector link. Attach the half link to the chain on one end & place the chain around the sprockets as shown in fig. 10.1. Secure chain with connector link. When connector link is installed & the loop has been completed, push the idler sprocket in the chain to achieve good tension. When proper tension is achieved tighten the idler sprocket. Now grease top & bottom bearings with multi-lith grease.

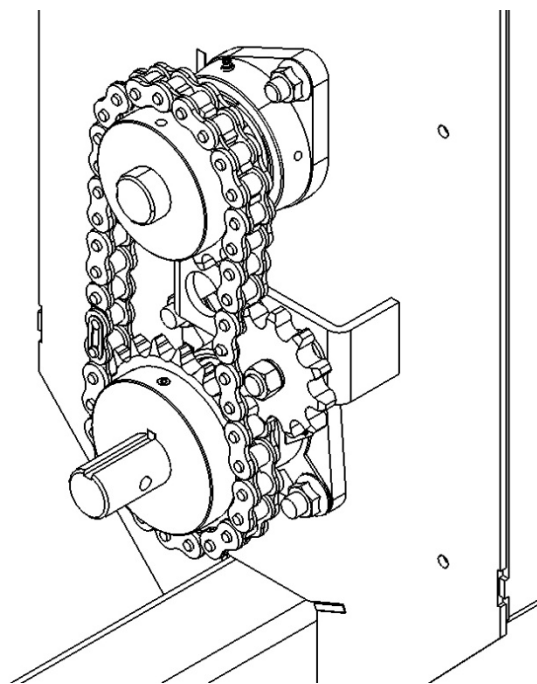
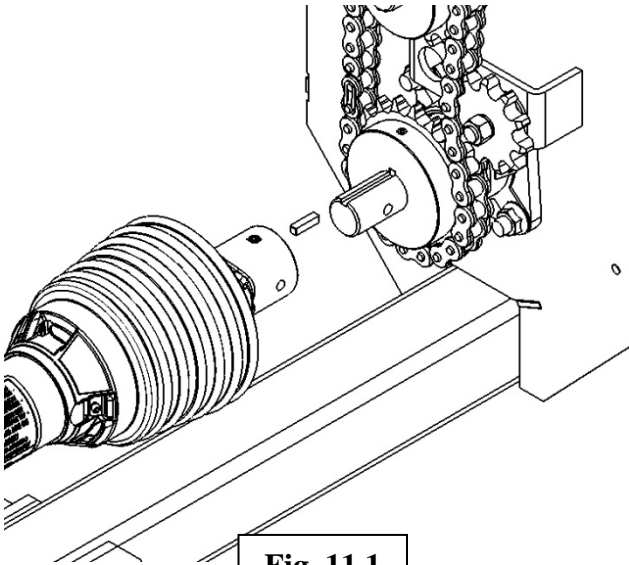

**Fig. 10.1**



### **Step 11**

Next, insert a 1/4" x 1" square key into the bottom shaft. Slide PTO shaft onto lower drive shaft. Align holes in PTO shaft with hole in drive shaft. Using a punch will help in this application. Secure using a 5/16" x 3" hex bolt & top lock nut. Tighten set screw on PTO shaft.



**Fig. 11.1**

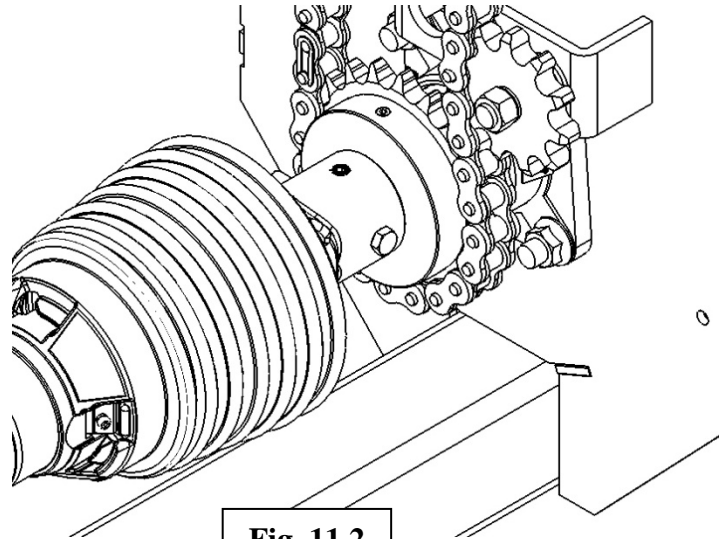

**Fig. 11.2**

### **Step 12**

Next slide the chain guard over the PTO shaft and secure to the infeed housing (4) 3/8" x 3/4" flange bolts. Then place lower "U" shaped guard place onto guard and secure with (4) 3/8" x 3/4" flange bolts.

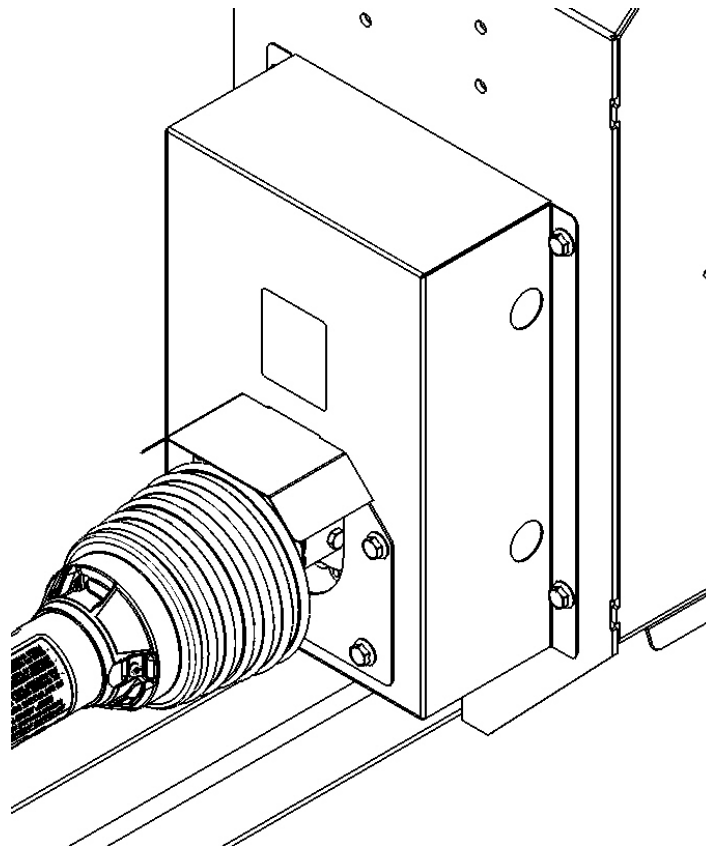

**Fig. 12.1**

**Step 13**

Locate the PTO support bracket & mount it to the infeed housing as shown in fig. 13.1 using (3) 3/8" x 3/4" flange bolts & flange nuts. Attach the PTO support chain to the bracket as shown using a 3/8" x 1" flange bolt & flange nut.

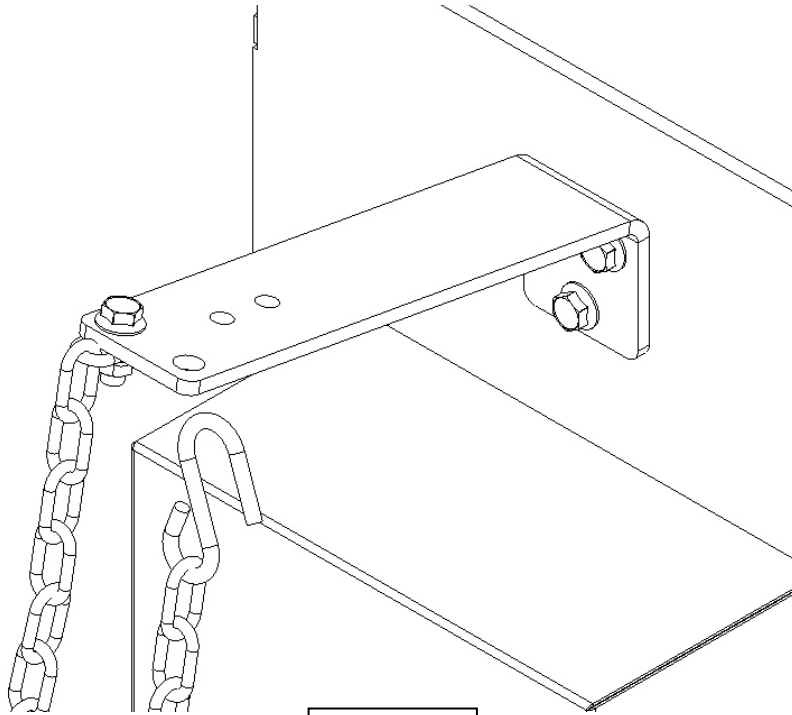

**Fig. 13.1**

**Step 14**

Locate the jack and slide it onto the jack mount tube located on the side of the tongue. Secure jack with pin.

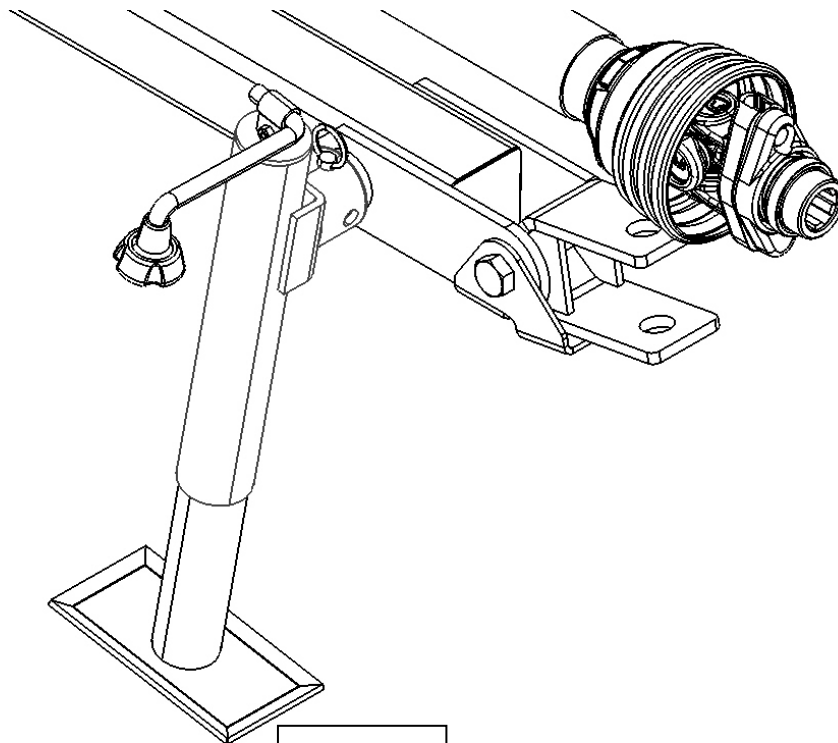

**Fig. 14.1**

## **Step 15**

Next the hopper winch will be mounted. On the right side of the infeed housing there is a bracket with a pin through it. (Fig. 15.1) Remove pin & set aside. Remove bracket & attach to winch using (3) 3/8" x 1" carriage bolts & flange nuts as shown in fig. 15.2. Tighten bolts by hand only for now. Slide the winch handle onto winch with spring & nut. Tighten nut to secure handle. Place winch on top of bracket welded to the infeed housing and secure with the pin. Angle the winch so it is centered with the top bracket (hopper arm bracket) on the 1<sup>st</sup> tube as shown in figure 15.3. Tighten the (3) 3/8" x 1" carriage bolts.

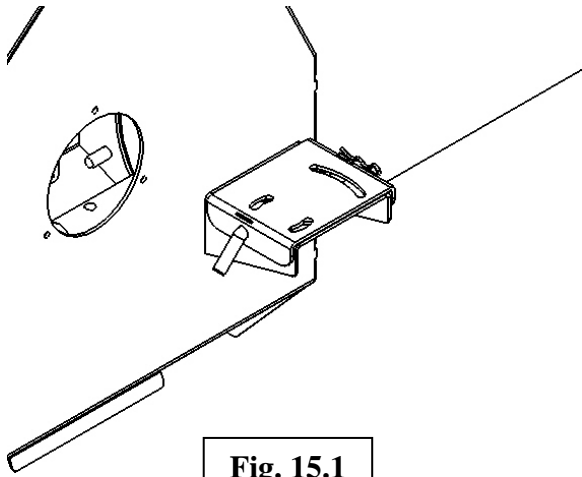

**Fig. 15.1**

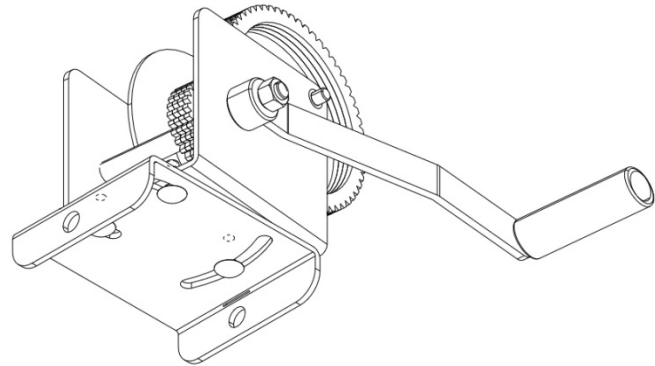

**Fig. 15.2**

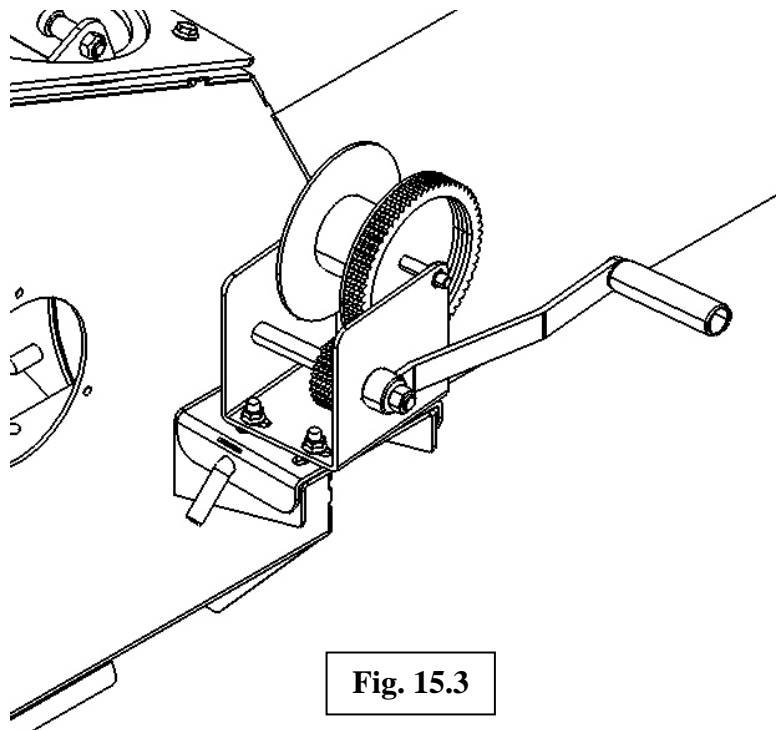

**Fig. 15.3**

**Step 16**

Next mount the left hand winch bracket (10131B) to the left side of the infeed housing. Attach the bracket using (4) 3/8" x 1" flange bolts & flange nuts.

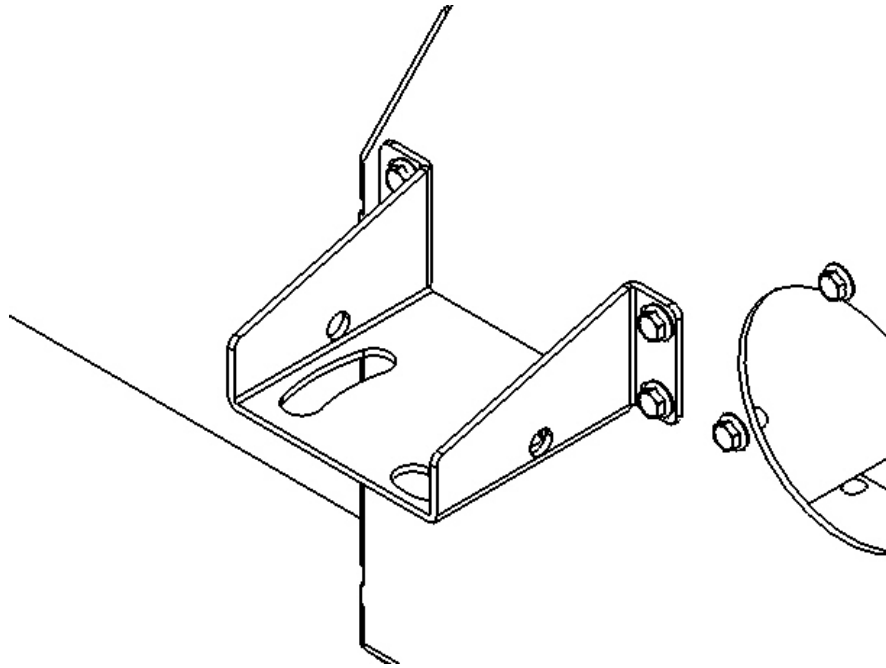

**Fig. 16.1**

**Step 17 (Transport Arm Assembly)**

After the left hand side winch mount bracket is secured assemble the hopper transport arm to the 1<sup>st</sup> tube. This will be done using (2) 1/2" x 7" bent pins as shown in figure 17.1.

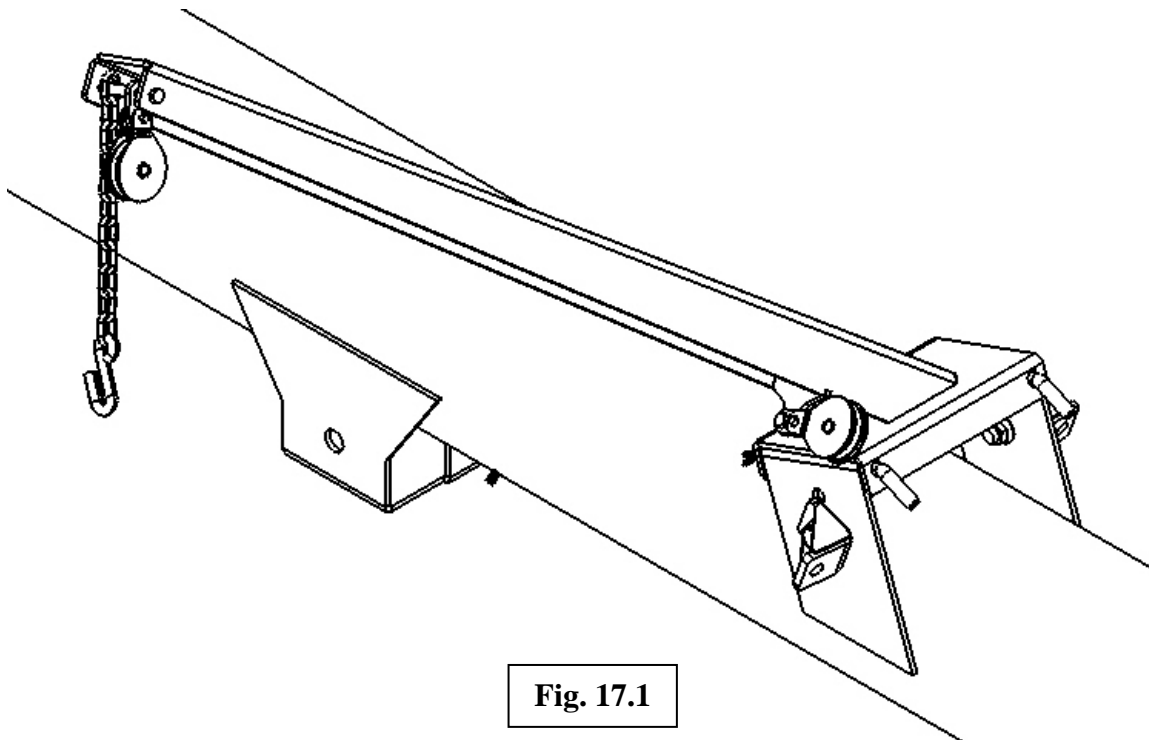

**Fig. 17.1**

**Step 18**

Next the hopper lift cable will be assembled. Insert cable through the upper then the lower pulley on the hopper transport arm. Pull cable back to the winch. Insert cable through hole on the side of the winch drum. Fasten to winch using the winch cable clamp & nut provided with winch.

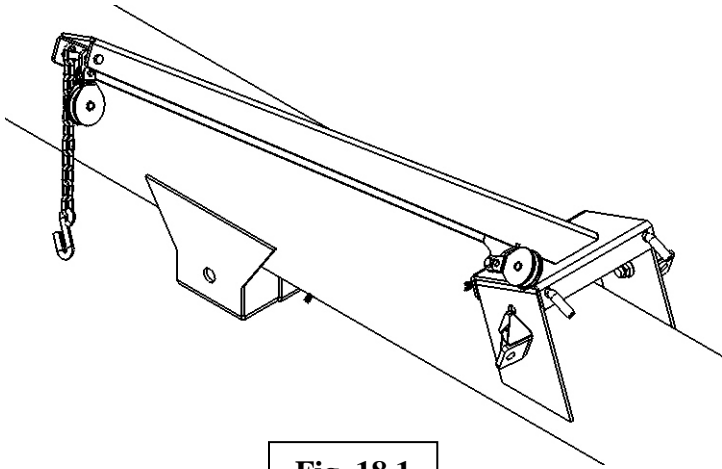

**Fig. 18.1**

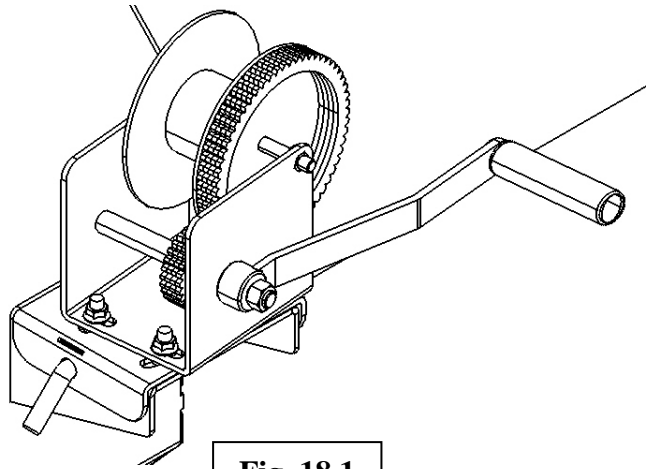

**Fig. 18.1**

**Step 19** (Carriage Assembly)

**Carriage Identification**

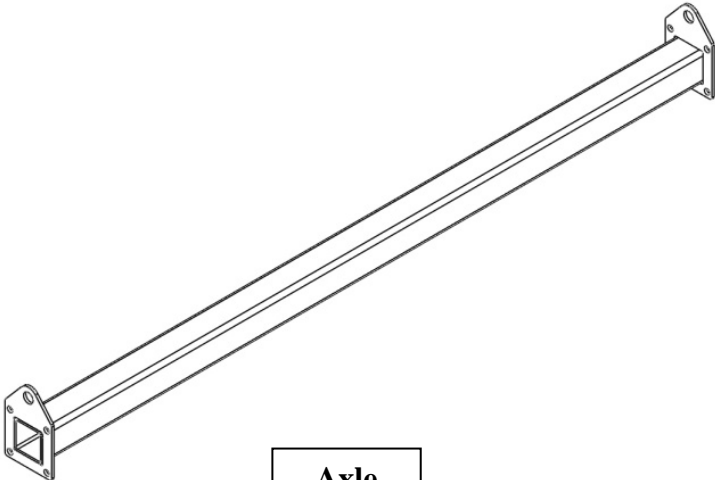

**Axle**

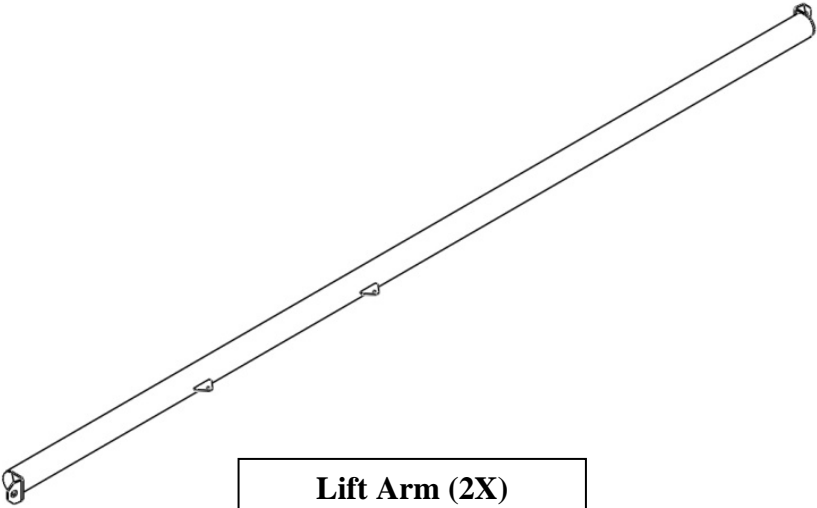

**Lift Arm (2X)**

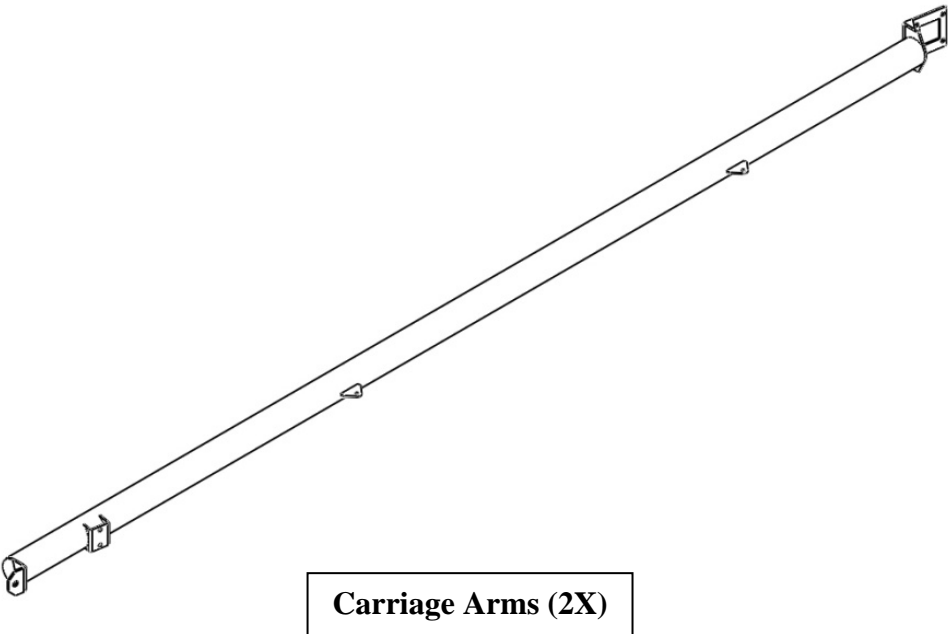

**Carriage Arms (2X)**

### **Step 20**

First, place the axle under the auger tubes in the middle of the tubes. Attach the carriage arms to the axle with the hub and spindle as shown in fig. 20.1. Fasten the carriage arms & the spindle using (4) 1/2" x 1-1/2" flange bolts and nuts.

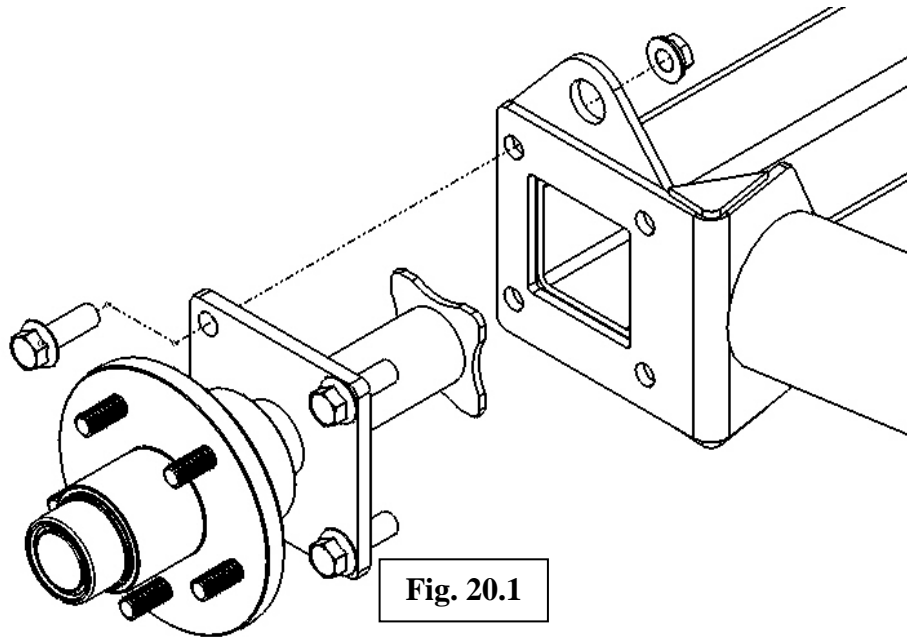

### **Step 21**

Next, attach each tire onto the hub and spindle and secure each with (5) 1/2" lug nuts. Tighten lug nuts evenly using a "star" pattern to 80-90 ft/lbs of torque.

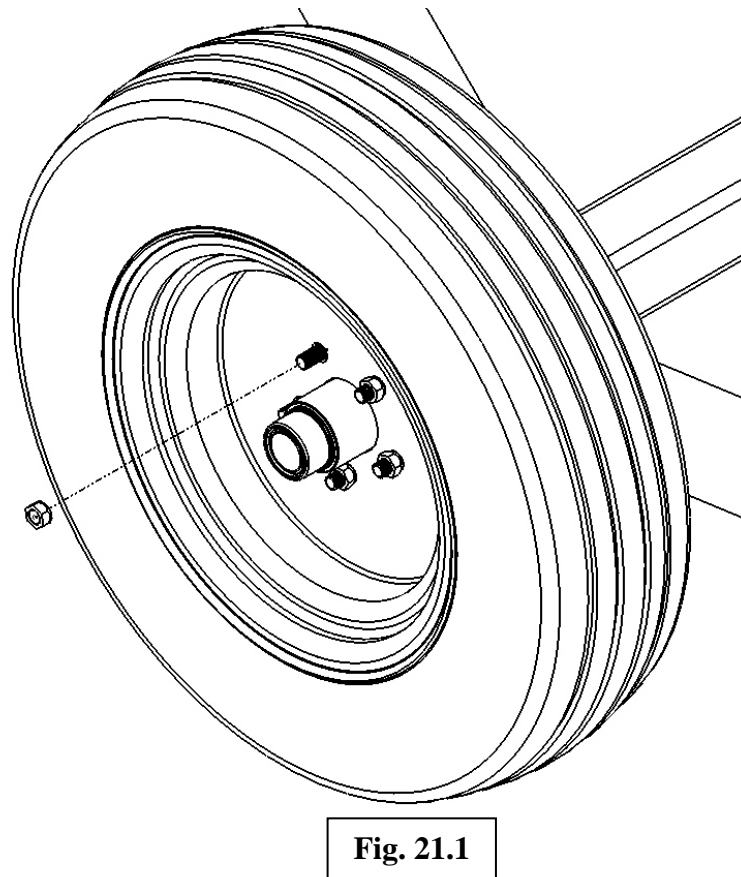

## **Step 22**

Next, locate the anti-twist brackets (11657 & 11660). Mount the 2 smaller link brackets to each carriage arm using a 1/2" x 1" hex flange bolt & flange nut. Next, attach the anti-twist arms to the link brackets as shown in Fig. 22.1. Secure all 4 brackets together in this location with a 1/2" x 1-1/2" hex flange bolt & flange nut. Align the holes in the other end of the arm brackets with the holes in the carriage arms.

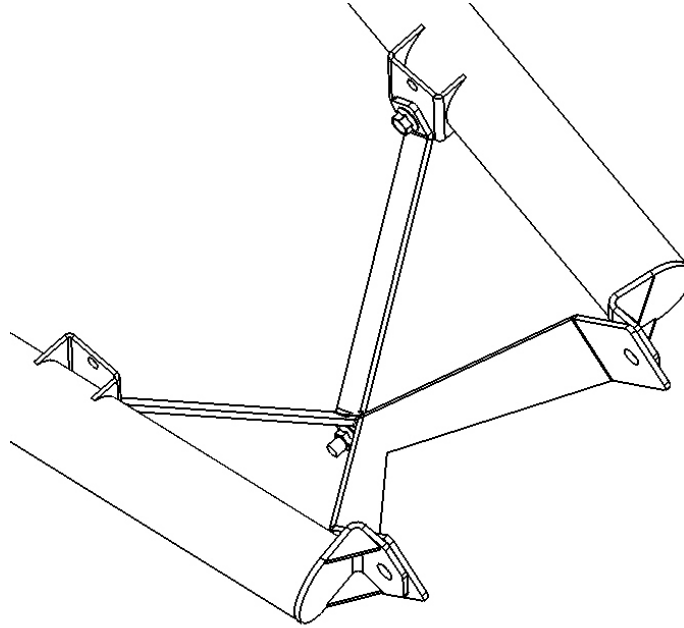

**Fig. 22.1**

## **Step 23**

Next, attach the carriage arms and anti-twist brackets to the 1<sup>st</sup> auger tube. Secure using (2) 3/4" x 1-1/2" hex bolts & top lock nuts.

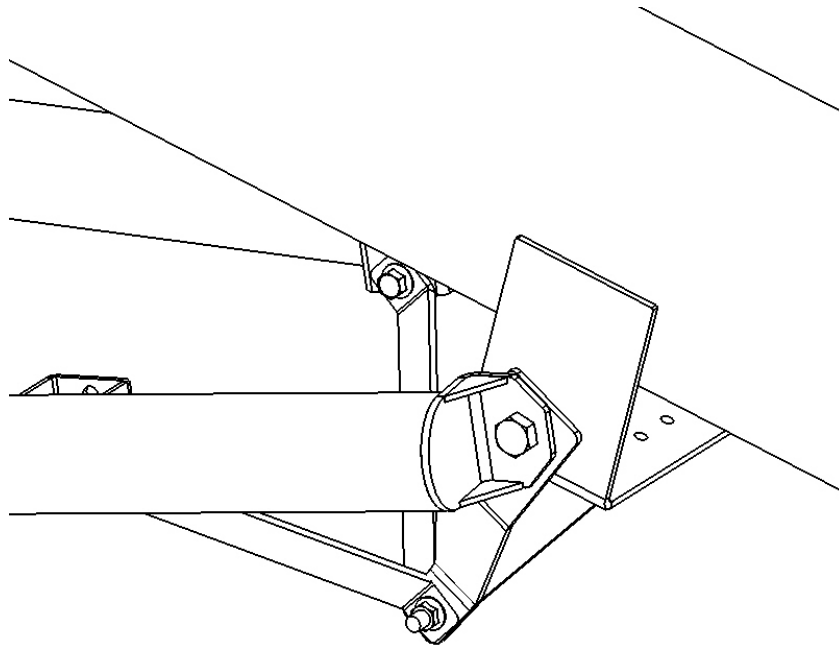
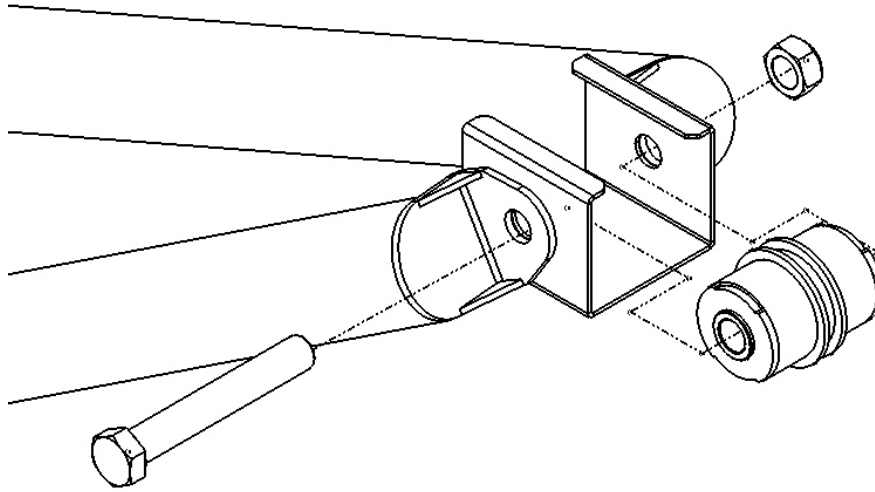

**Fig. 23.1**



### **Step 24**

Next, the lift roller will be assembled to the lift arms. Place the lift roller housing bracket (11673) up to one of the lift arms and align the holes. Take the 1" x 7" hex bolt and put it through the arm & one side of the bracket. Place the lift roller (30971) in the housing and push the bolt through the roller. Now, push bolt all the way through the housing. Attach other lift arm onto bolt & secure with a 1" top lock nut. The lift arms, housing, & roller should now be assembled together.



**Fig. 24.1**

### **Step 25**

Next, slide the roller housing assembly onto the top of the track down past the 3<sup>rd</sup> set of holes. Mount the roller stop as shown in Fig. 25.1. Secure with (2) 3/8" x 1" hex flange bolts & flange nuts.

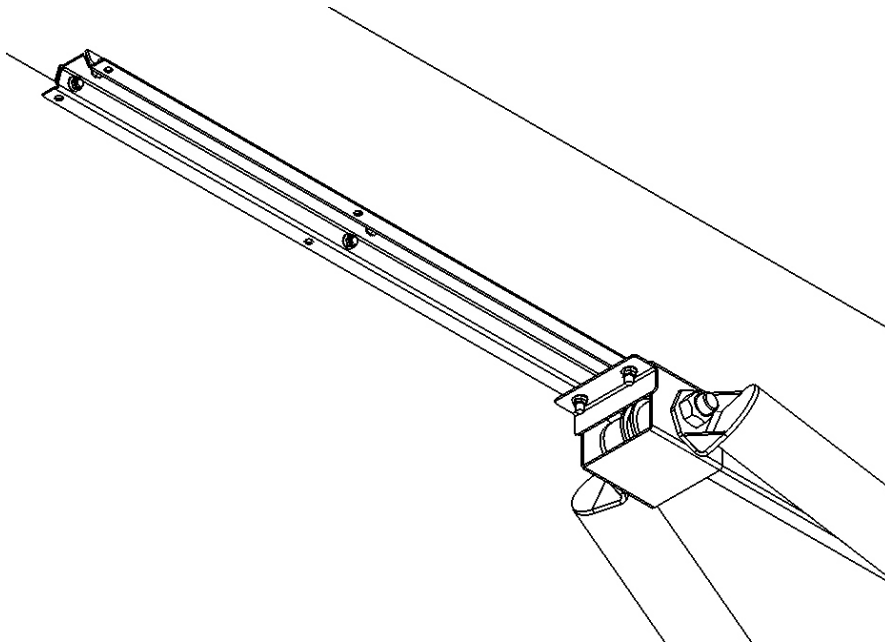

**Fig. 25.1**

### **Step 26**

Next, lift the auger tubes up using a lifting strap. Lift auger tubes up far enough to attach the lift arms to the axle. (See Fig. 26.1) Secure the lift arms with a 1" x 2" hex bolt & top lock nut.

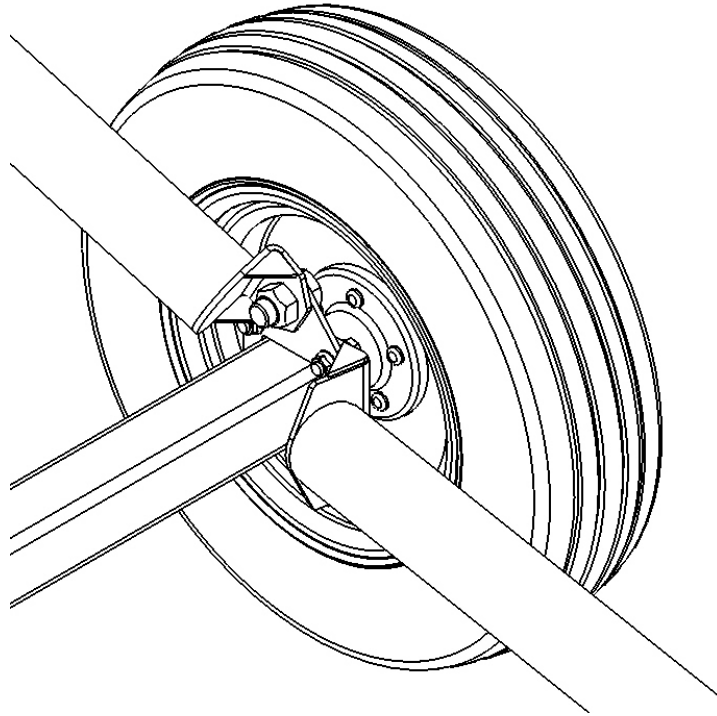

**Fig. 26.1**

### **Step 27**

Next, locate the long x-braces (10693). Mount these to the carriage arms as shown in Fig. 27.1. Secure both braces with (5) 3/8" x 1" hex flange bolts & nuts. Repeat this with the shorter braces (10988) on the lift arms.

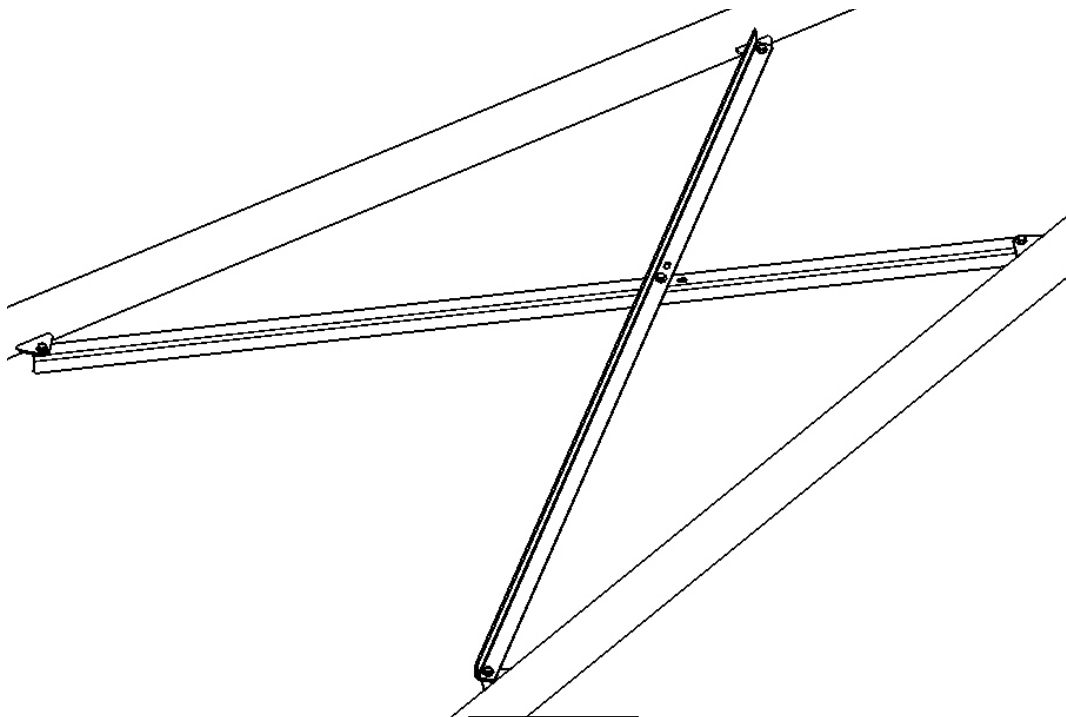

**Fig. 27.1**

### **Step 28 (Lift Cable Assembly)**

Next, attach the lift cable to the winch by sticking one end through the side of the drum and fastening the cable to the outside of the drum. For more information refer to winch manual included with auger. Route the cable up around the lift roller (Fig. 28.2) going from the bottom around the top. Next, pull the cable to the bottom of the discharge tube at wrap cable around the cable stop (30993) as shown if Fig. 28.3. Secure cable around the cable stop using (2) 1/4" cable clamps. After clamps are tightened, track the cable on the winch by slowing turning the handle and guiding the cable on to the drum so it spools properly.

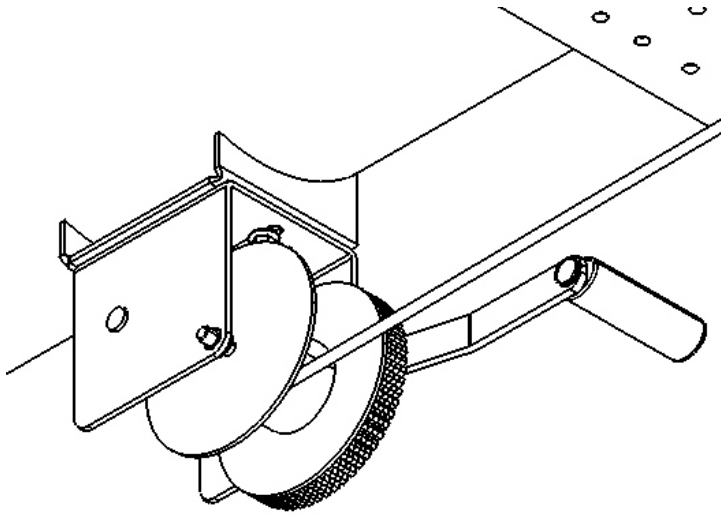

**Fig. 28.1**

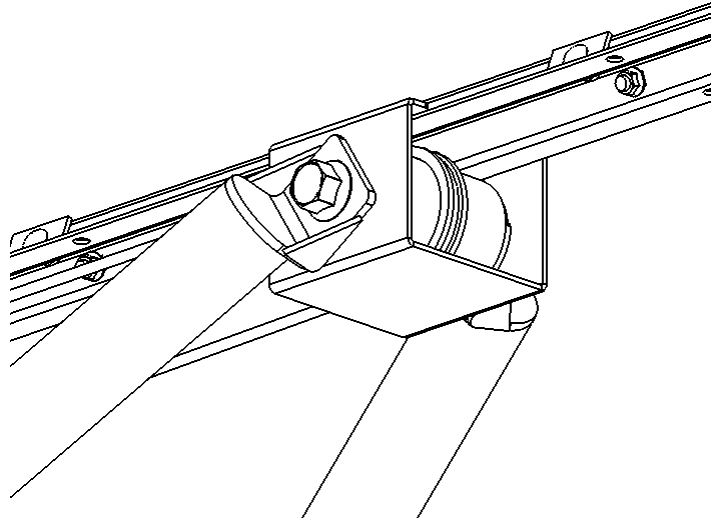

**Fig. 28.2**

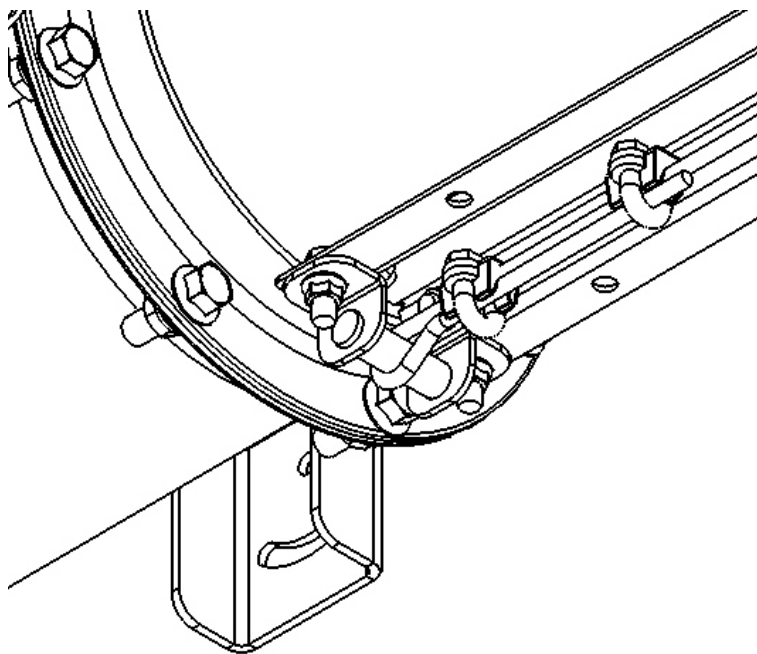

**Fig. 28.3**

**Step 29** (Swing Tube & Hopper Installation)

Locate the swing hopper swivel ring (30027A). Install the swing hopper swivel ring on the discharge head of the swing tube. Fasten the ring as shown in fig. 29.1 using (2) 1/2" x 5/8" shoulder bolt & 1/2" top lock nuts.

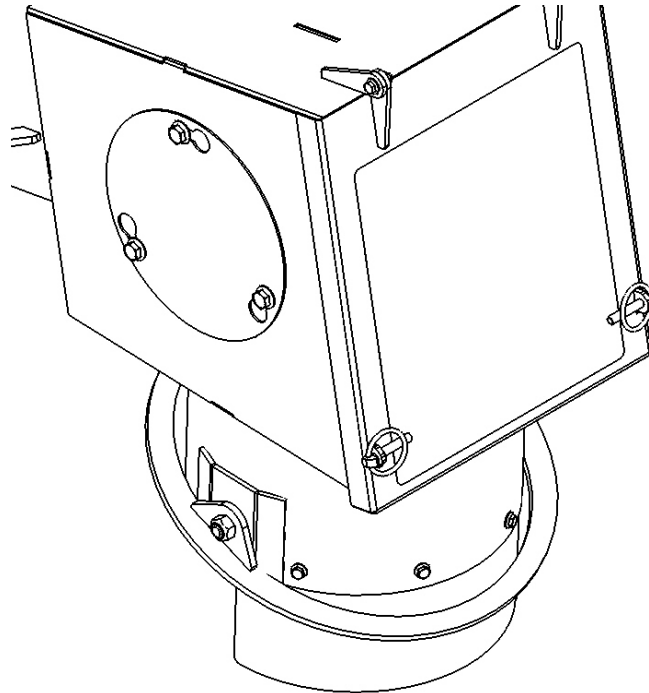

**Fig. 29.1**

**Step 30**

Lift the swing tube up and set on infeed housing as shown. Be sure to align the knuckle assembly in the swing tube with the lower gearbox in the infeed housing. Lower the other end of the swing tube onto the ground.

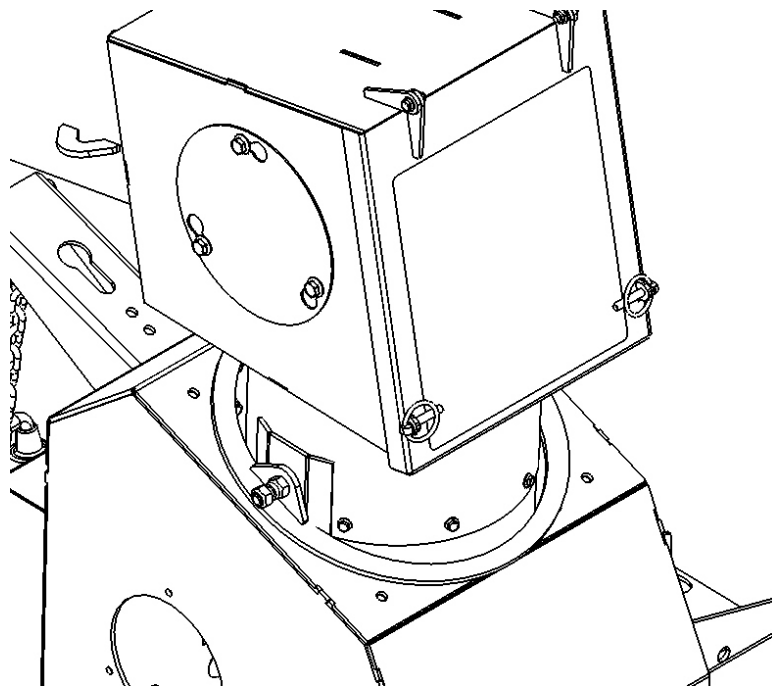

**Fig. 30.1**

### **Step 31**

Locate the swing tube hold down plate & the 4 hold down spacers. Install the hold down plates & spaces using (4) 3/8" x 1-1/2" flange bolts & flange nuts. Tighten all 4 fasteners.

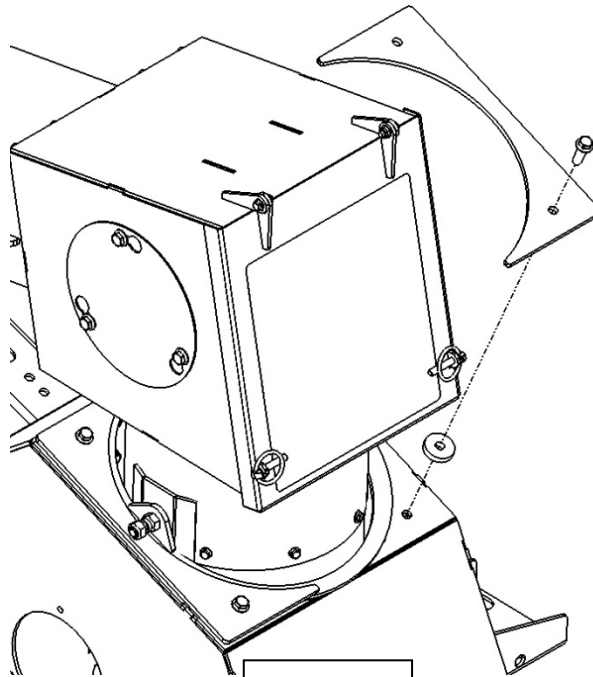

**Fig. 31.1**

### **Step 32**

Next the wheel will be installed on the swing hopper. First, locate the 4 hopper tires (30104), 4 clevis pins, 4 spacer tubes (10186) & 4 lynch pins. Place the spacer tube through the first hole in the outside of the swing hopper. Slide the clevis pin through the tire and the spacer making sure the offset part of the rim is facing in towards the swing hopper as shown in fig. 32.1. Secure the spacer, tire, & clevis pin by placing a 3/16" lynch pin through the end of the clevis pin. Repeat for all 4 hopper tires. (For more ground clearance install the tire in the bottom hole.)

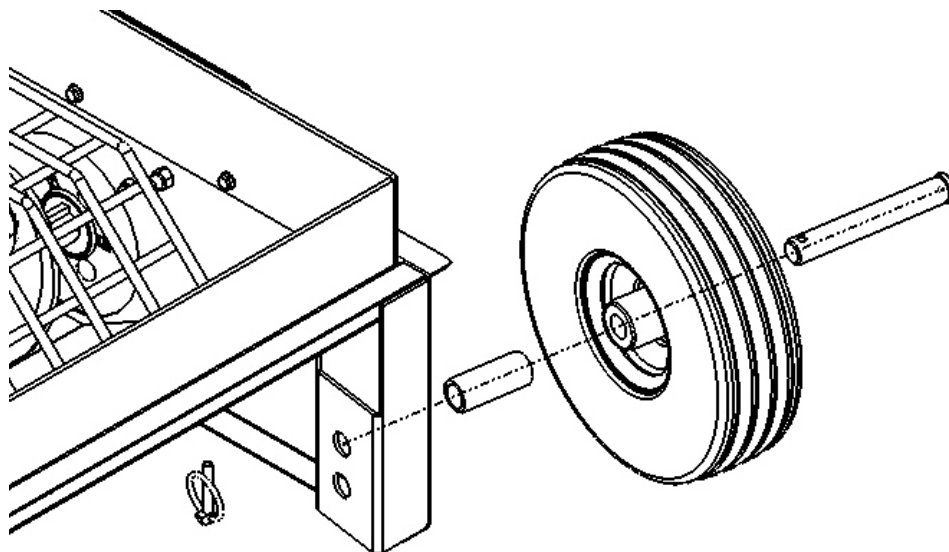

**Fig. 32.1**

### **Step 33**

Next, install the upper transition flighting (30864) on the lower drive shaft attached to the swing tube flighting. To do this, slide a  $\frac{3}{8}$ " x 1" square key into key way on swing tube flighting shaft. Slide upper transition flighting onto shaft aligning the key and keyway. To secure the transition flighting thread the set screw that is  $\frac{5}{16}$ " x 1- $\frac{1}{4}$ " into hole on knuckle (Fig. 33.1). After set screw is tightened, thread a  $\frac{5}{16}$ " flange nut onto set screw and tighten to lock set screw in place.

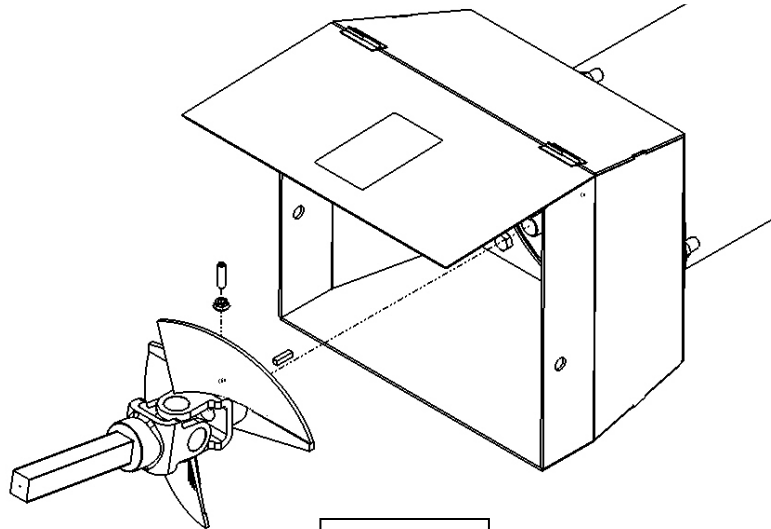

**Fig. 33.1**

### **Step 34**

Next, install the swing hopper onto the swing tube. Slide the hopper transition onto the swing tube while inserting the square shaft of the upper transition flighting into the square tube on the lower transition flighting. Align the holes in the hopper and swing tube with a punch. With the access door open secure the hopper to the swing tube using (2)  $\frac{1}{2}$ " x 1- $\frac{1}{2}$ " flange bolts, (4)  $\frac{1}{2}$ " washers, & (2)  $\frac{1}{2}$ " top lock nuts. The washer will go between the bolt and the hopper & the nut and swing tube respectively.

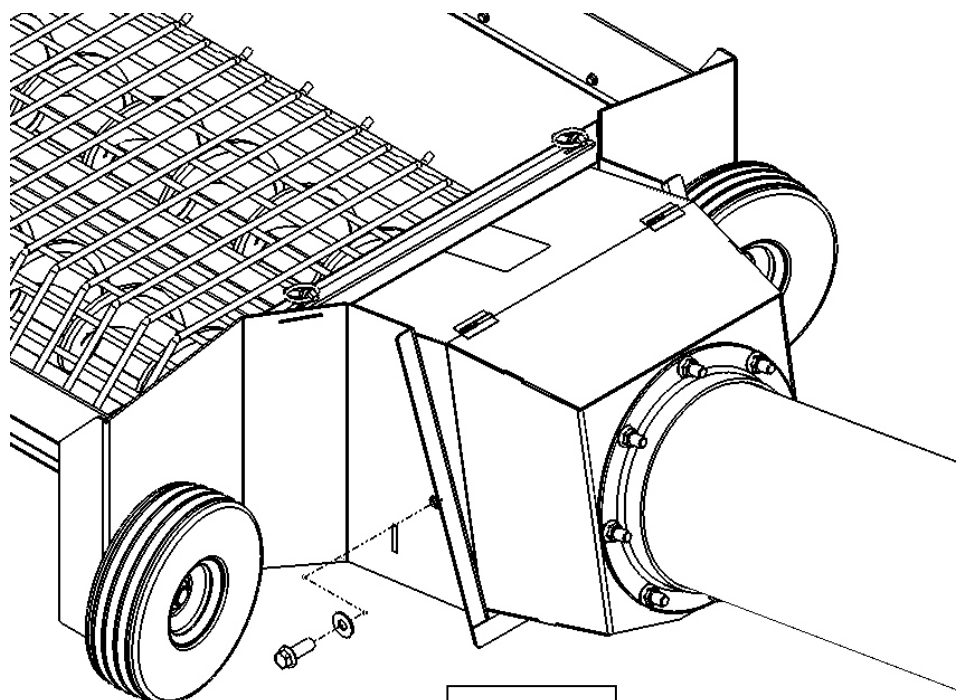

**Fig. 34.1**

### **Step 35**

Next, install the manual canister. Mount the manual canister approximately 4 feet down the carriage arms below the anti-twist brackets. Secure to the tube using (2) #12 x 3/4" self tapping screws. Note that they canister lid will have to be removed to install 1 of the screws. After installation, reattach the canister lid.

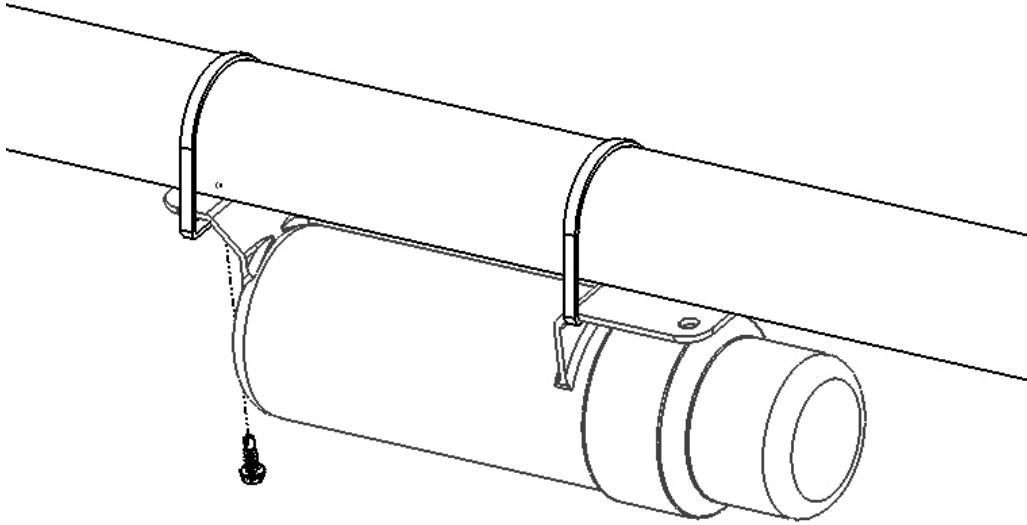

**Fig. 35.1**

**This will complete the assembly for your Harvest by Meridian A1042 grain auger.**

**For additional part numbers, information, & overall views please refer to the parts book drawings located at the end of this assembly manual or log onto [www.harvestauger.com](http://www.harvestauger.com).**

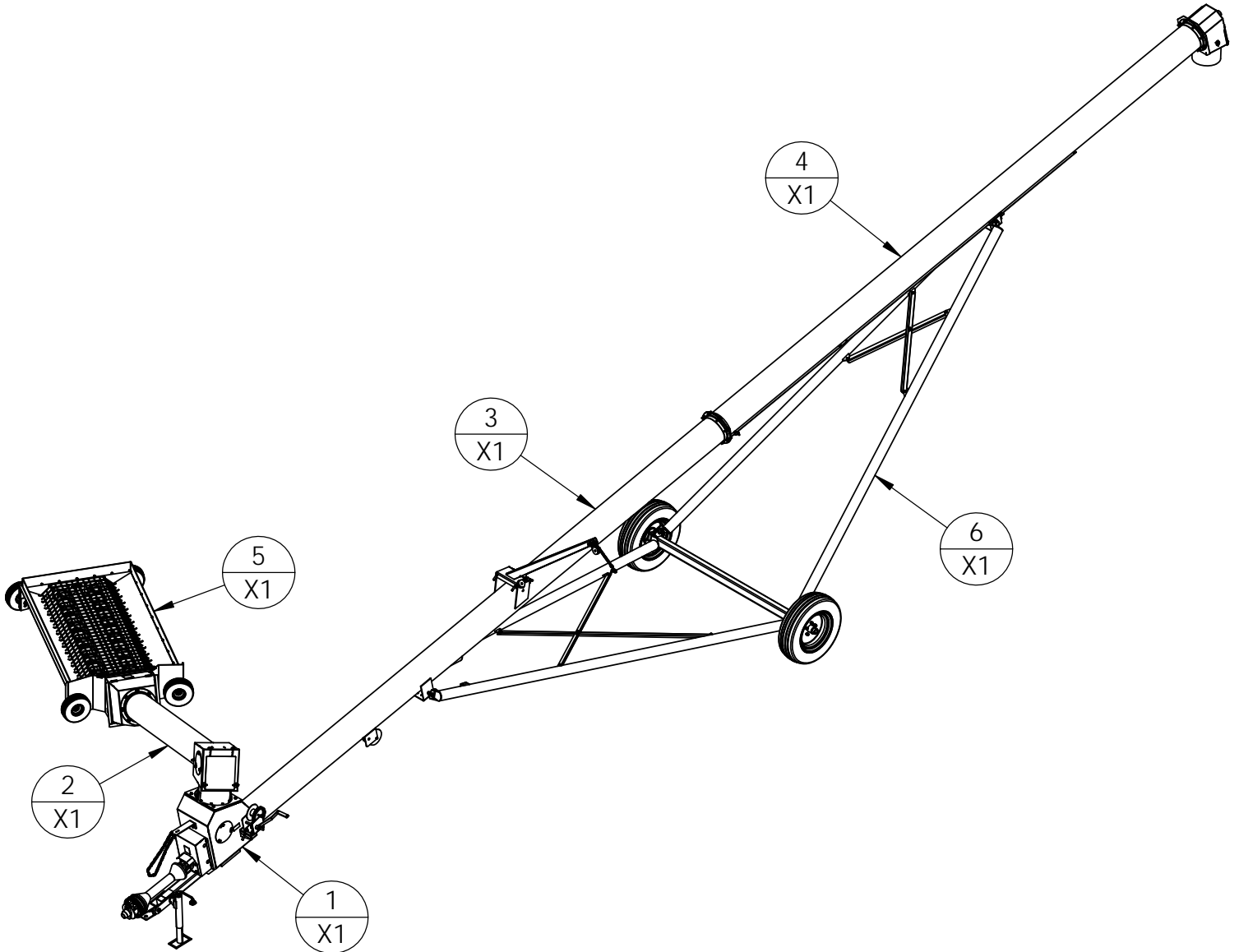

ITEM NO.	PART NO.	DESCRIPTION	QTY
1	PBA10003	INFEED HOUSING ASSEMBLY, A10XX	1
2	PBA10004	TUBE ASSY, SWING HOPPER, 10"	1
3	PBA10009	TUBE ASSEMBLY, INFEED, A1042	1
4	PBA10010	TUBE ASSEMBLY, DISCHARGE, A1042	1
5	PBH10012	HOPPER ASSEMBLY, H1062, H1072, H1082, A1072	1
6	PBT13009	CARRIAGE ASSEMBLY, T1342	1



REV	AUGER MODEL(S)	PART/ASSEMBLY DESCRIPTION
	A1072	INFEED HOUSING ASSYEMBLY

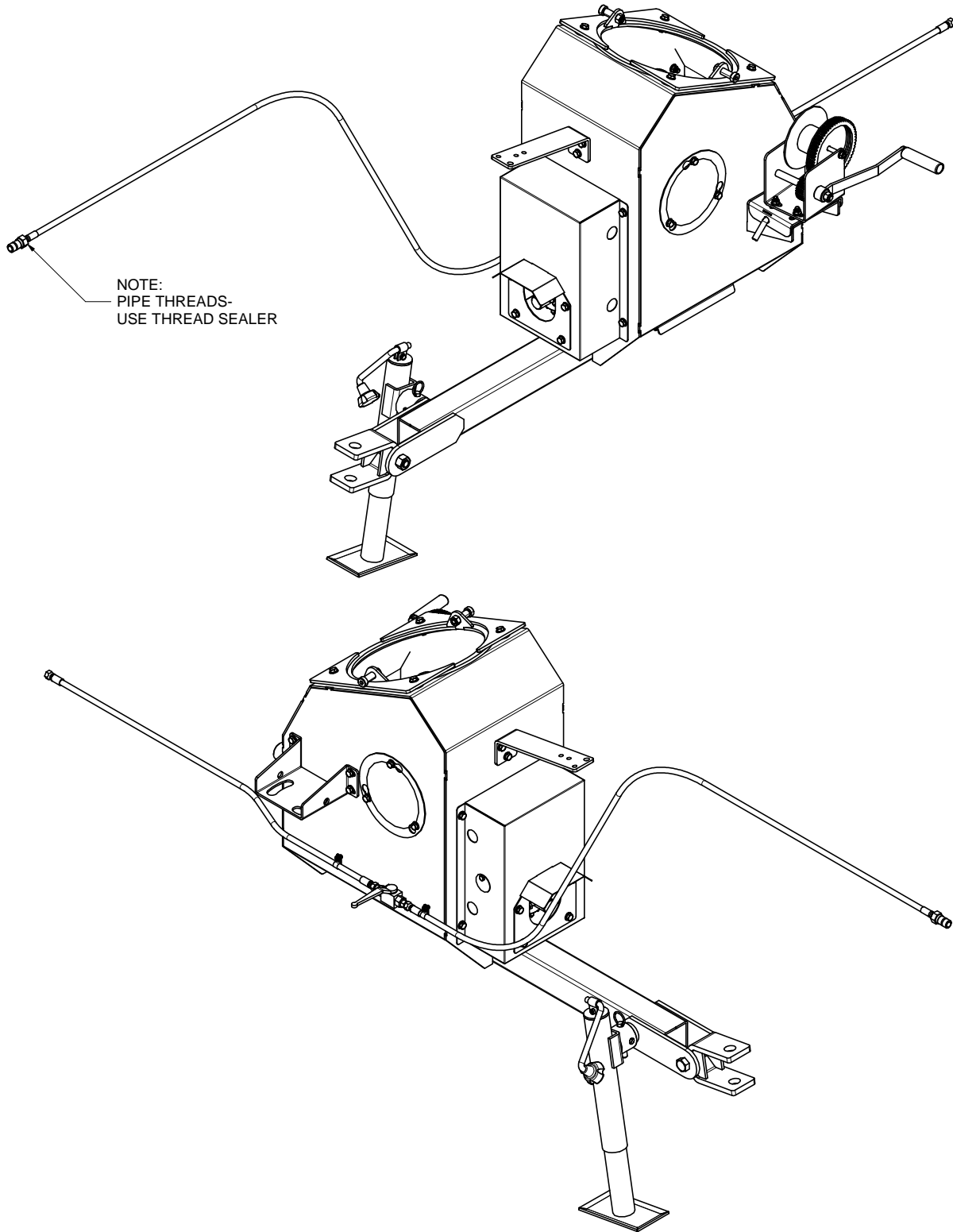



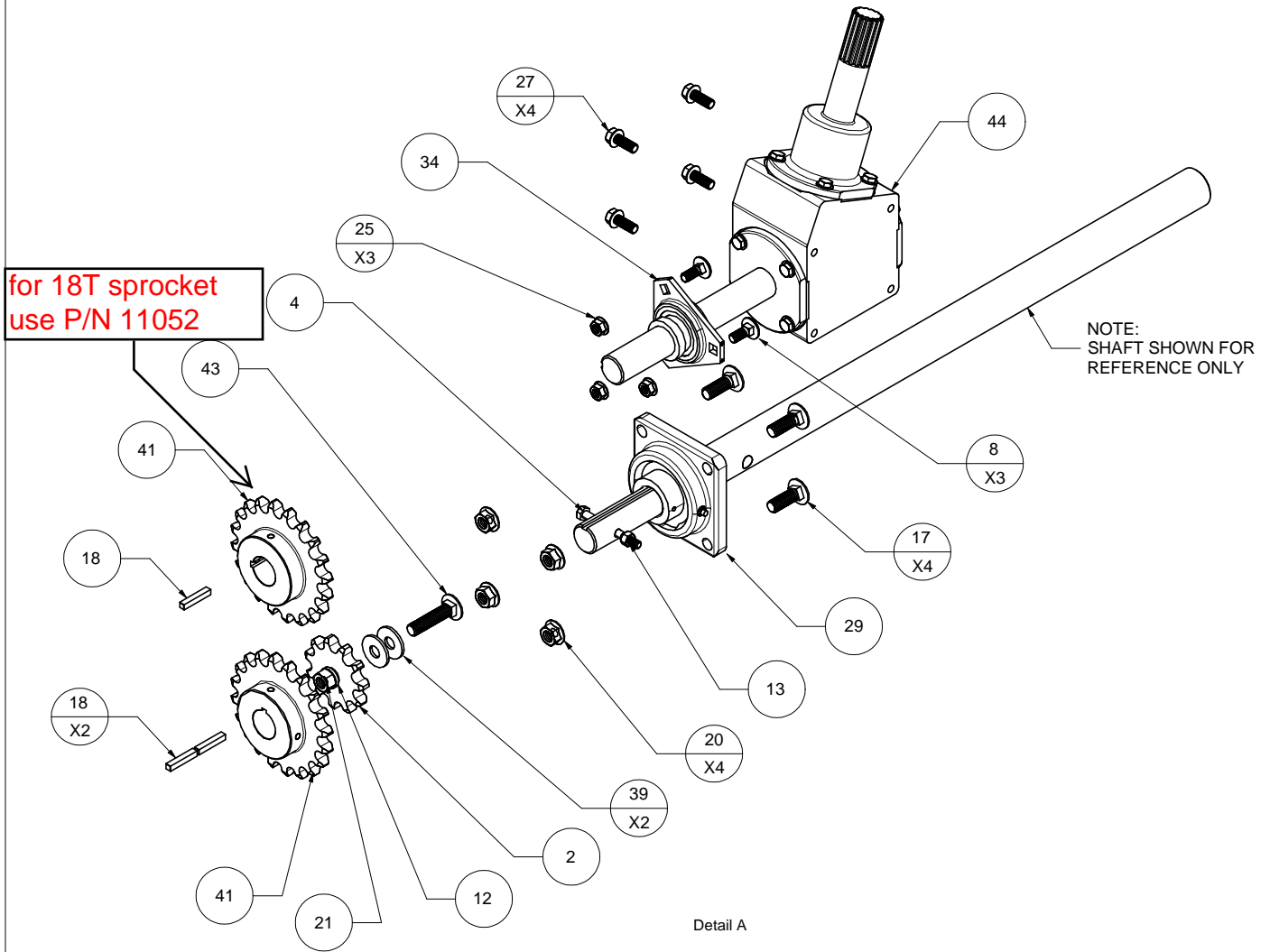

NOTE: PARTS NOT SHOWN  
PART NO.- 10320 - CHAIN, ROLLER, INFEED DRIVE  
#60 X 40 ROLLERS + CONNECTOR

when 18T sprocket is used, use 60h x 38 rollers + connector

DRAWING NO.

PBA10003



REV	AUGER MODEL(S)	PART/ASSEMBLY DESCRIPTION
	A1072	INFEED HOUSING

49	PB10002	1	CHAIN COVER ASSEMBLY, INFEED HOUSING, A10XX & H10XX
47	30098	1	HYDRAULIC HOSE ASSEMBLY, 1/4" x 72", #6 FEMALE JIC TO 1/2" FEMALE PIPE
46	30095	1	VALVE, BALL, 1/4" NPT
45	30006A	1	CLEVIS HITCH ASSEMBLY
44	30001	1	GEARBOX LOWER1071 (18851)
43	1-2 X 2 INCH CARRIAGE BOLT	1	1/2-13UNC x 2" CARRIAGE BOLT, GRD 5, ZINC
42	HEX HD FLG_~375-16 UNC ~75.SIMP	10	BOLT, 3/8-16UNC X 3/4", HEX, FLANGE, GRD 5, ZINC
41	10248	2	SPROCKET, #60 x 20 TOOTH, 1.25in BORE
40	30027	1	RING ASSY, SWING HOPPER SWIVEL SUPPORT, H10XX
39	FLW-RGLR_~500	2	1/2" STANDARD FLAT WASHER, ZINC
38	10185	4	SPACER, SWING HOPPER HOLD DOWN
37	HEX BOLT_~250-20 UNC_0~75_SIMP	2	BOLT, 1/4-20UNC X 3/4" HEXM GRD 5, ZINC
36	10151	2	CLAMP, 1/2" MEDIUM DUTY, GALV, VINYL, HYDRAULIC HOSE RETAIN
35	10528	2	LID,INSPECTION, (COVER PLATE)
34	30557	1	BEARING, 1-1/4" W/LOCK COLLAR & FLANGETTES, 3 BOLT, ZINC
33	10793	1	SUPPORT, PTO, A10XX
32	HEX NUT_~500-13 UNC TOPLOCK	2	1/2-13UNC TOP LOCK, HEX LOCK NUT
31	10326	1	#6 MALE JIC TO #4 MALE O-RING W/.0625 ORIFICE (6400R-06-04-.062)
30	10324	1	1/2 NPT MALE TIP, 1/2" BODYSIZE (8010-4) (PIONEER)
29	30552	1	1.25" 4 BOLT CAST FLANGE WITH BEARING WITH ECCENTRIC LOCK COLLAR (SKF BEARING ONLY # YET-207-104)
28	PB10001	1	WINCH AND MOUNT BRACKET ASSY.
27	HEX HD FLG_~375-16 UNC 1.SIMP	11	BOLT, 3/8-16UNC X 1", HEX, FLANGE, GRD 5, ZINC
26	10190	0	PLATE, CHAIN GUARD COVER, BOLT IN
25	NUT HEX FLG_~375-16 UNC_SIMP	18	NUT, 3/8-16UNC, HEX, FLANGE, GRD 5, ZINC
24	30716	1	HOUSING ASSEMBLY, INFEED, A10XX
23	10139	0	TAB, CHAIN GUARD LUBE HOLE COVER
22	10131B	1	BRACKET, HAND WINCH MOUNT, BOLT ON, FOR BRAKE WINCH
21	HEX NUT_~500-13 UNC_SIMP	1	NUT, 1/2-13UNC, HEX, GRD 5, ZINC
20	NUT HEX FLG_~500-13 UNC_SIMP	4	NUT, 1/2-13UNC HEX, FLANGE, GRD 5, ZINC
19	30035A	0	CHAIN GUARD AND PTO SHIELD ASSY. (FOR AUGERS WITH IDLER SPROCKETS)
18	10309	3	KEY, 1/4 x 1.5
17	1-2 x 1 1-2 CARRIAGE BOLT	4	1/2-13UNC x 1-1/2" CARRIAGE BOLT, GRD 5, ZINC
16	10170	2	PLATE, HOLD DOWN, SWING HOPPER 10"
15	HEX NUT_~250-20 UNC NYLOCK_SIMP	0	1/4-20UNC, HEX NYLOCK NUT, ZINC
14	HEX WSHR_~375-16 UNC_1~25_SIMP	4	3/8-16UNC x 1-1/4" HEX FLANGE BOLT, GRD 5, ZINC
13	HEX NUT_~3125-18 UNC_TOPLOCK	1	NUT, 5/16-18UNC, HEX, TOPLOCK, ZINC
12	LK WSHR-HLCL SPR-RGLR_~500	1	WASHER, LOCK, 1/2" SPLIT, SPRING
11	10370	2	BOLT, SHOULDER, 1/2-13UNC x .625" DIAMETER X 1" SHOULDER
10	HEX NUT_~750-10 UNC TOP LOCK_SIMP	1	3/4-10UNC, TOP LOCK NUT
9	10323	1	#6 MALE JIC TO #4 MALE O-RING STRAIGHT CONNECTOR (6400-06-04)
8	3-8 x 1 CARRIAGE BOLT	3	BOLT, 3/8-16UNC x 1" CARRIAGE, GRD 5, ZINC
7	10101A	1	COVER PLATE, CLEAN OUT, INFEED HOUSING
6	HEX BOLT_~750-10 UNC_4-1-2_SIMP	1	3/4-10UNC x 4-1/2" HEX BOLT, GRD 5, ZINC
5	30140	1	JACK, 5000LB, TOP WIND
4	HEX BOLT_~3125-18 UNC_3_SIMP	1	BOLT, 5/16-18UNC X 3", HEX, GRD.5, ZINC
3	NUT HEX FLG_~250-20 UNC_SIMP	2	NUT, 1/4-20UNC, HEX FLANGE, GRD 5 ZINC
2	10300	1	#60 x .5in BORE x 11 TOOTH IDLER SPROCKET
1	30741	1	HOSE ASSEMBLY, 1/4x153" #6 JIC FEMALE BOTH ENDS, IN KIT #30714, A1072
Item Number	Part Number	Quantity	Description

DRAWING NO.  
PBA1003

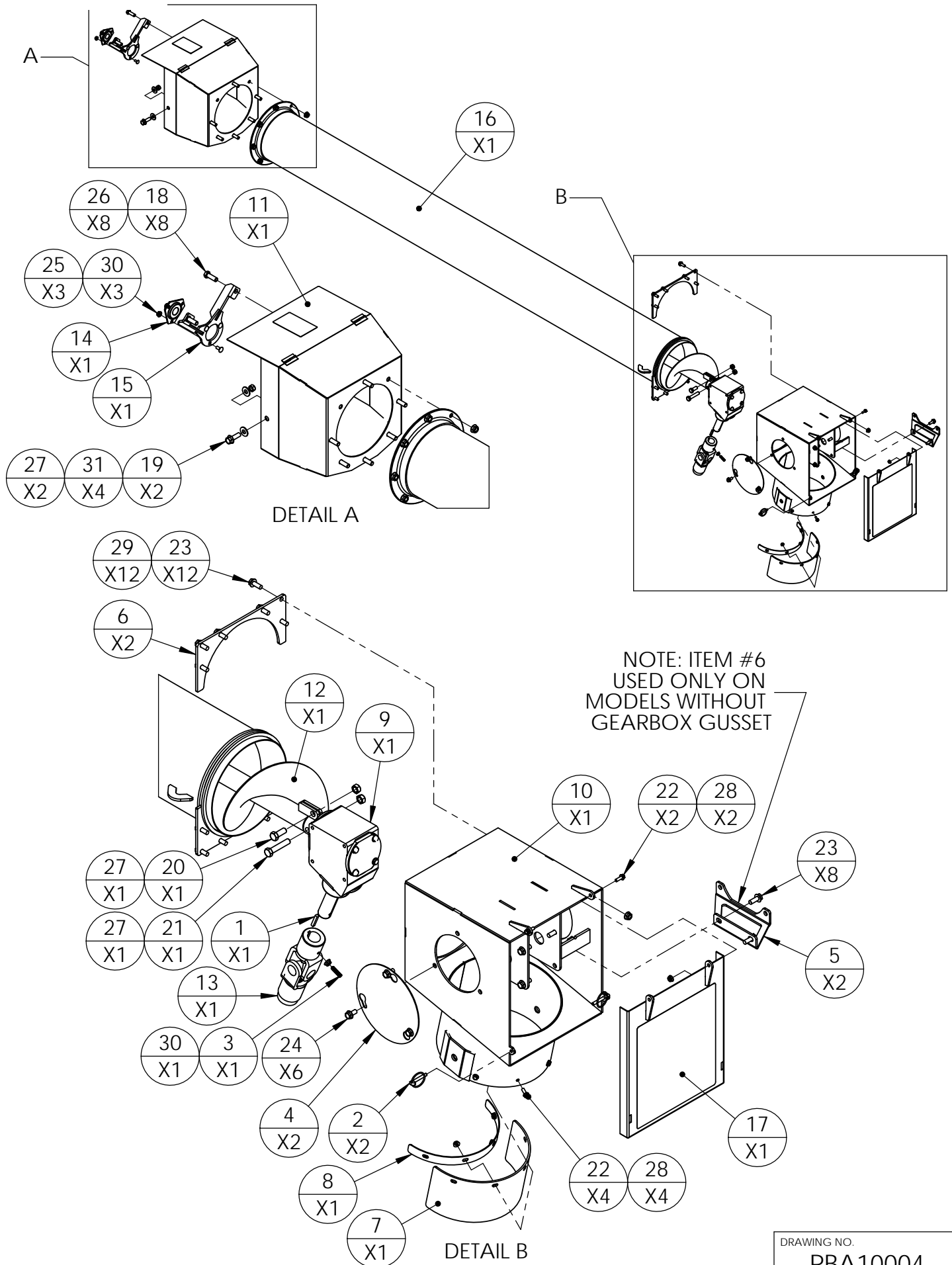

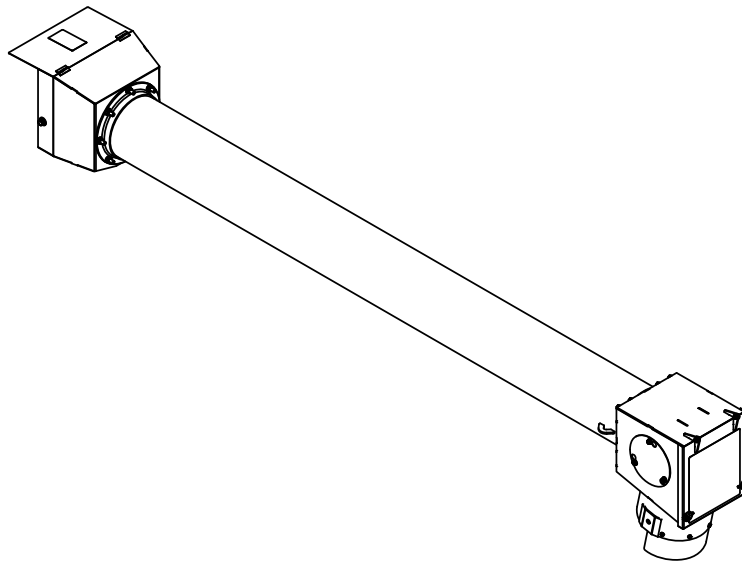

ITEM NO.	PART NO.	DESCRIPTION	QTY
1	10309	KEY, 1/4 X 1-1/2", SQUARE	1
2	10364	LYNCH PIN, 1/4" X 2-1/8"	2
3	10382	SCREW, SET, 5/16-UNC x 1.25" SELF LOCKING	1
4	10528	COVER PLATE, CLEAN OUT	2
5	11083	GUSSET, GEARBOX REINFORCE, H10XX & A1072	1
6	11761	PLATE, SWING TUBE RETAIN, 10" AUGERS	2
7	12092	DEFLECTOR, RUBBER, HOPPER DISCHARGE, H10	1
8	12093	STIFFENER, RUBBER, SWING TUBE, 10"	1
9	30007	GEARBOX, SWING HOPPER DRIVE, UPPER, H10XX	1
10	30008A	SWING HOPPER DRIVE HEAD, 10" BOLT ON	1
11	30011	SWING HOPPER, INTERMEDIATE, HINGE ASSEMBLY, 10"	1
12	30014	SWING HOPPER, INCLINE AUGER ASSEMBLY, 10"	1
13	30146	KNUCKLE ASM, GEARBOX DRIVE W/DEFLECTOR, H10XX	1
14	30550	1" 3 BOLT FLANGE WITH FAFNIR BEARING	1
15	30718	HANGER BEARING ASM, FORMED, 10"	1
16	30723A	SWING TUBE ASSEMBLY, 10"	1
17	31042	LID ASSY, SWING HOPPER DISCHARGE, H10XX	1
18	40004	BOLT, 1/2-13UNC X 1-1/2" HEX, GRD 5, ZINC	8
19	40005	BOLT, 1/2-13UNC X 1-1/2" HEX FLANGE, GRD 5, ZINC	2
20	40006	BOLT, 1/2-13UNC X 1-1/4" HEX, GRD 5, ZINC	1
21	40009	BOLT, 1/2-13UNC X 2-1/2" HEX, GRD 5, ZINC	1
22	40014	BOLT, 1/4-20UNC X 3/4" HEX FLANGE, GRD 5, ZINC	6
23	40025	BOLT, 3/8-16UNC X 1" HEX FLANGE, GRD 5, ZINC	20
24	40030	BOLT, 3/8-16UNC X 3/4" HEX FLANGE, GRD 5, ZINC	6
25	40037	BOLT, 5/16-18UNC X 3/4" CARRIAGE, GRD 5, ZINC	3
26	40047	NUT, 1/2-13UNC, HEX FLANGE, GRD 5, ZINC	8
27	40048	NUT, 1/2-13UNC, HEX, TOPLOCK, ZINC	4
28	40049	NUT, 1/4-20UNC, HEX FLANGE, GRD 5, ZINC	6
29	40056	NUT, 3/8-16UNC, HEX FLANGE, GRD 5, ZINC	12
30	40059	NUT, 5/16-18UNC, HEX FLANGE, GRD 5, ZINC	4
31	40066	WASHER, FLAT, 1/2", ZINC	4

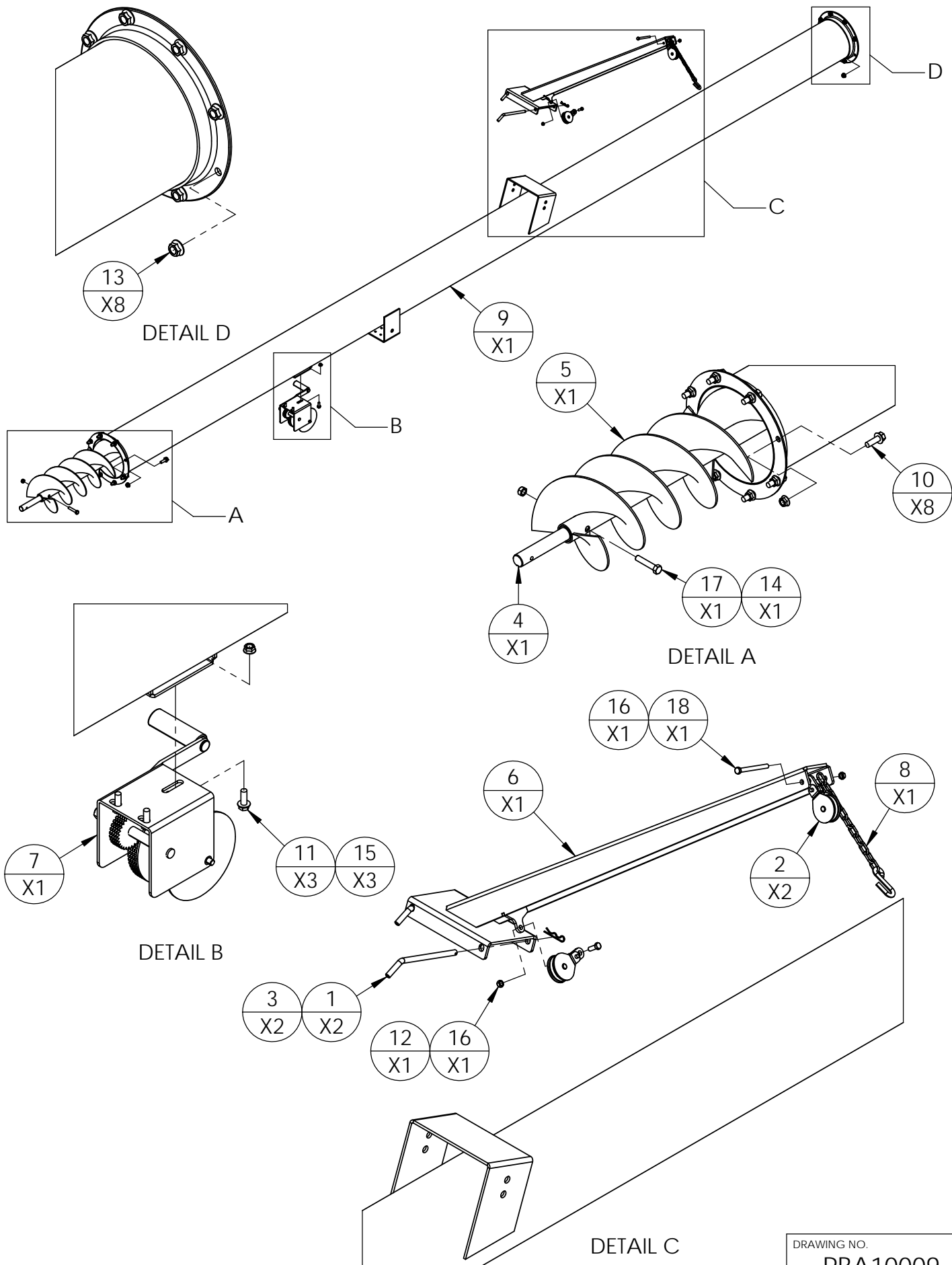

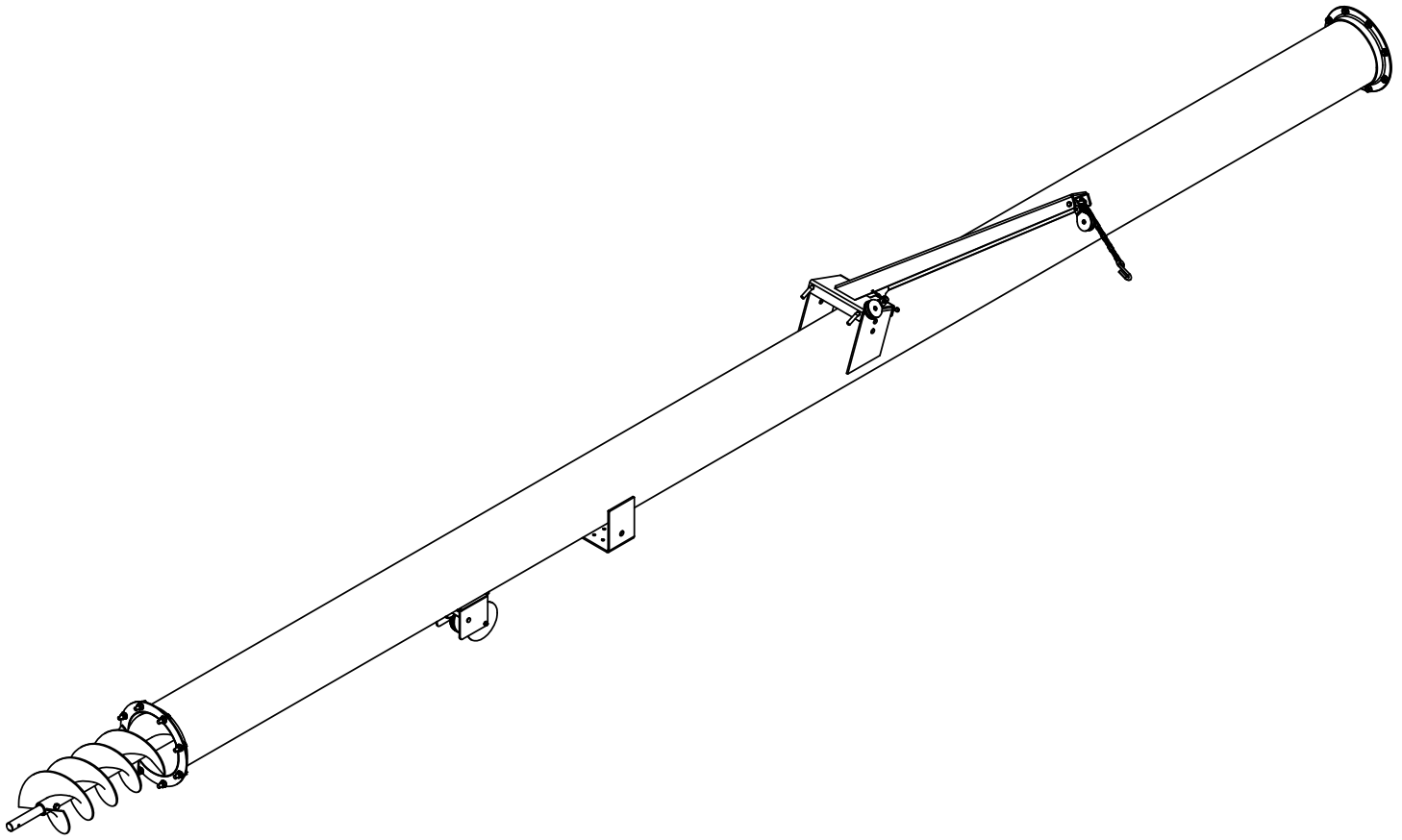

ITEM NO.	PART NO.	DESCRIPTION	QTY
1	10191	BENT PIN, 1/2"X7", SWING HOPPER LIFT RETAIN	2
2	10315	CABLE ROLLER,SWIVEL BLOCK,SWING HOPPER LIFT	2
3	10381	HAIRPIN, .093 X 1.625	2
4	30003A	FLIGHTING ASSEMBLY, 10" INFEED, STAGE 2	1
5	30003B	FLIGHTING ASM, 10" INFEED, STAGE 1	1
6	30034	LIFT ASSEMBLY, SWING HOPPER TRANSPORT, 10"	1
7	30108	WINCH ASSY, 1500 LB, BRAKE	1
8	30110	CHAIN, SUPPORT, SWING HOPPER, H10XX	1
9	31704	TUBE ASM, INFEED, A1042	1
10	40005	BOLT, 1/2-13UNC X 1-1/2" HEX FLANGE, GRD 5, ZINC	8
11	40025	BOLT, 3/8-16UNC X 1" HEX FLANGE, GRD 5, ZINC	3
12	40026	BOLT, 3/8-16UNC X 1" HEX, GRD 5, ZINC	1
13	40047	NUT, 1/2-13UNC, HEX FLANGE, GRD 5, ZINC	16
14	40048	NUT, 1/2-13UNC, HEX, TOPLOCK, ZINC	1
15	40056	NUT, 3/8-16UNC, HEX FLANGE, GRD 5, ZINC	3
16	40058	NUT, 3/8-16UNC, HEX, TOPLOCK, ZINC	2
17	40075	BOLT, 1/2-13UNC X 2-1/2" HEX, GRD 8, ZINC	1
18	40104	BOLT, 3/8-16UNC X 4" HEX, GRD5, ZINC	1



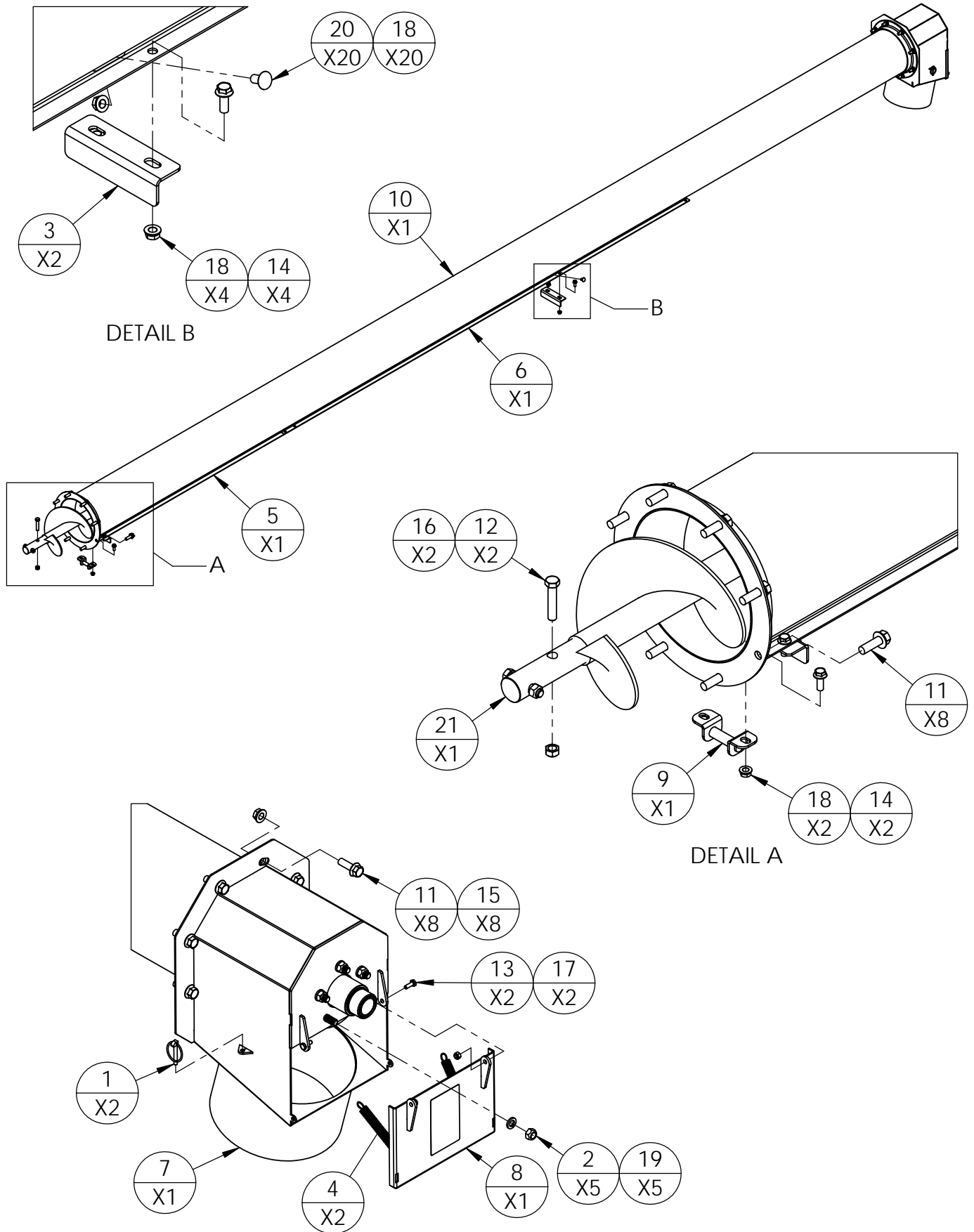

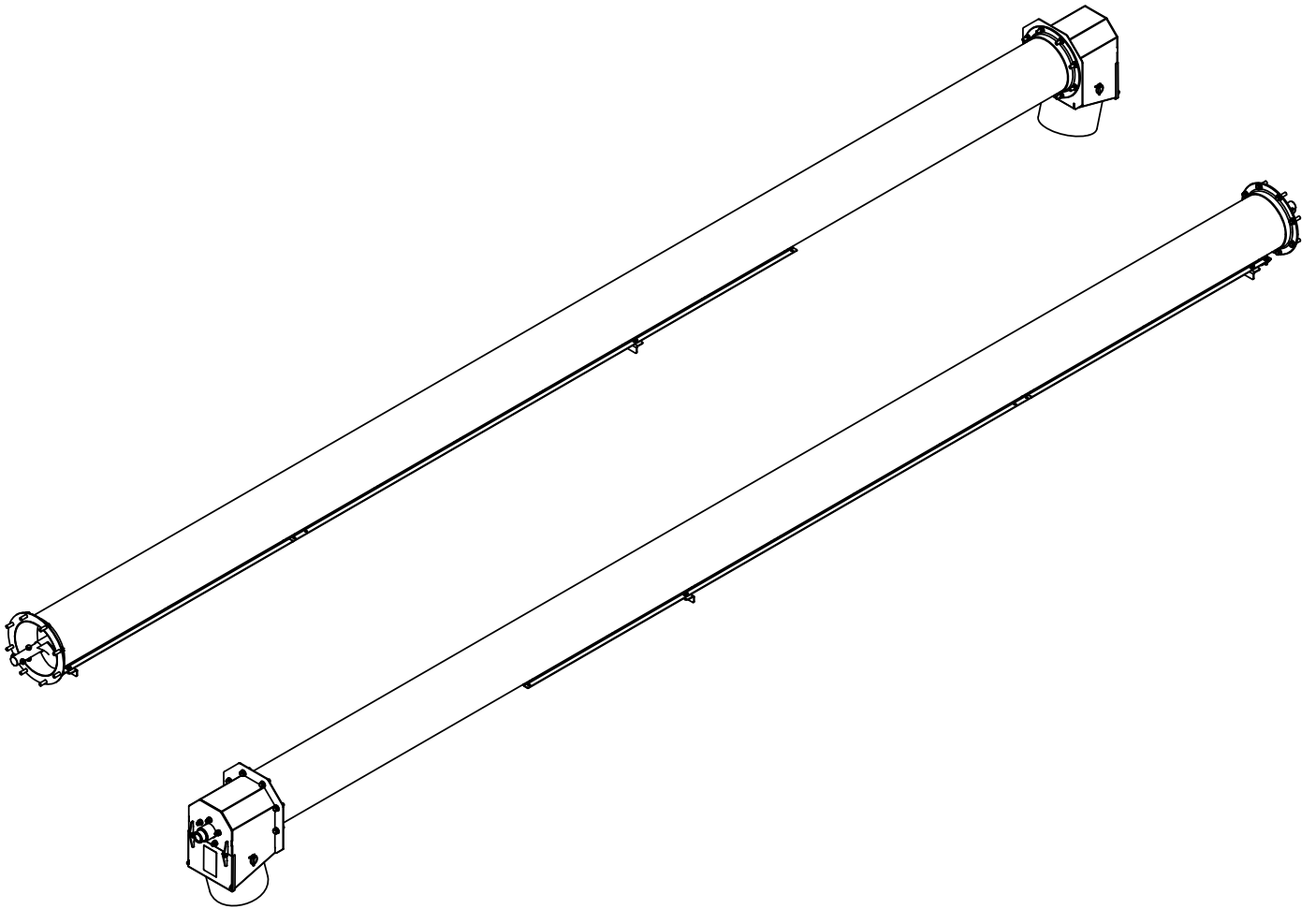

ITEM NO.	PART NO.	DESCRIPTION	QTY
1	10364	LYNCH PIN, 1/4" X 2-1/8"	2
2	10434	NUT, 1/2-20, 60 DEGREE LUG NUT, ZINC	5
3	10959	STOP, LIFT ROLLER, T AUGERS	2
4	11357	EXTENSION SPRING	2
5	11436	RAIL, SHORT, T8XX, T1032, T1042	1
6	11442	RAIL, LONG, T8XX, T1032, T1042	1
7	30028	DISCHARGE HOUSING ASSEMBLY, 10"	1
8	30721	LID, DISCHARGE SPOUT, H10XX	1
9	30993	CABLE STOP, BOLT ON, T AUGERS	1
10	31705	TUBE ASM, DISCHARGE, A1042	1
11	40005	BOLT, 1/2-13UNC X 1-1/2" HEX FLANGE, GRD 5, ZINC	16
12	40009	BOLT, 1/2-13UNC X 2-1/2" HEX, GRD 5, ZINC	2
13	40015	BOLT, 1/4-20UNC X 3/4" HEX, GRD 5, ZINC	2
14	40025	BOLT, 3/8-16UNC X 1" HEX FLANGE, GRD 5, ZINC	6
15	40047	NUT, 1/2-13UNC, HEX FLANGE, GRD 5, ZINC	8
16	40048	NUT, 1/2-13UNC, HEX, TOPLOCK, ZINC	2
17	40051	NUT, 1/4-20UNC, HEX, NYLOCK, ZINC	2
18	40056	NUT, 3/8-16UNC, HEX FLANGE, GRD 5, ZINC	26
19	40072	WASHER, LOCK, 1/2" SPLIT, ZINC	5
20	40123	BOLT, 3/8-16UNC X 3/4" SN CARRIAGE, ZINC	20
21	PBH10016	FLIGHTING ASM, DISCHARGE, H1062 & H1082	1

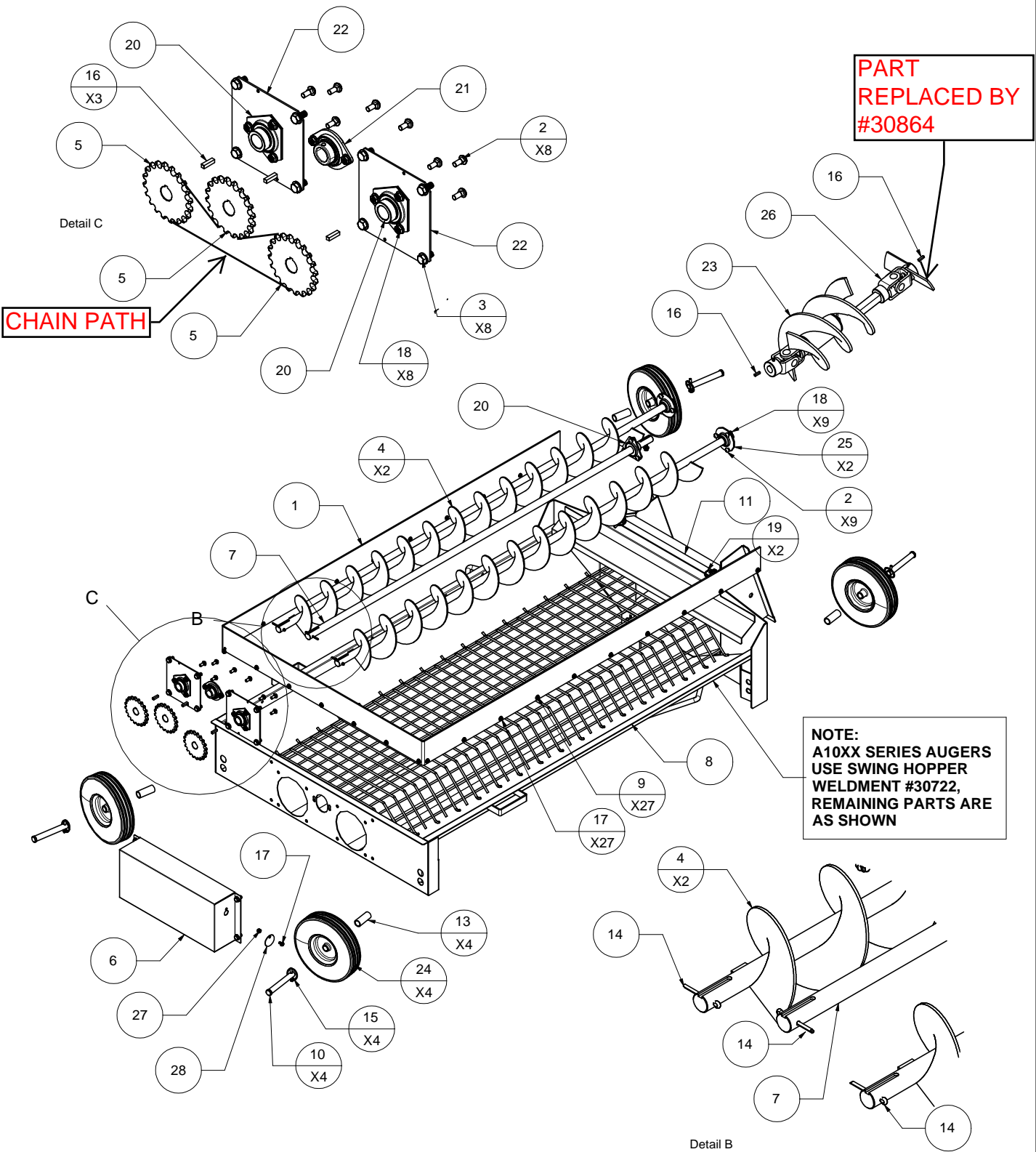

NOT SHOWN:  
10319-CHAIN, #50 X 58 ROLLERS + CONNECTOR LINK

DRAWING NO.  
PBH10012



REV	AUGER MODEL(S)	PART/ASSEMBLY NO.
	H1062, H1072, H1082, A1072	HOPPER ASSEMBLY

28	10139	1	TAB, CHAIN GUARD LUBE HOLE COVER
27	40051	1	1/4-20UNC, HEX NYLOCK NUT, ZINC
26	<del>30048</del> 30864	1	KNUCKLE, BAR SHAFT & PADDLE ASSEMBLY, MID AUGER, H10XX (impeller)
25	30558	2	INSERT, 1" BRASS WITH SELF ALIGN HOUSING, & 3 BOLT FLANGETTES
24	30104	4	TIRE & RIM ASSY, 10x4.10/3.50-4, SWING HOPPER
23	30042	1	FLIGHTING ASSEMBLY, SWING HOPPER MID AUGER
22	10041	2	PLATE, BEARING MOUNT, SWING HOPPER
21	30551	1	BEARING, 1" & LOCK COLLAR WITH 2 BOLT FLANGETTES, FAFNIR
20	30550	3	1" 3 BOLT FLANGE WITH FAFNIR BEARING
19	10364 LYNCH PIN	2	LYNCH PIN, 1/4" x 2 1/8" OVERALL LENGTH
18	40059	17	5/16-18UNC, HEX FLANGE NUT
17	40013	28	1/4-20UNC x 1/2" HEX FLANGE BOLT, GRD 5, ZINC
16	10307	5	KEY, 1/4 x 1.00"
15	10364	4	LYNCH PIN, 1/4" x 2 1/8" OVERALL LENGTH
14	10308	3	PIN, COTTER, 3/16x1.5"
13	10186	4	SPACER TUBE, SWING HOPPER WHEEL
12	HEX WSHR_~375-16 UNC_0~75_SIMP	1	3/8-16UNC x 3/4" HEX FLANGE BOLT, GRD 5, ZINC
11	10357	1	PLATE, SWING HOPPER LID HOLD DOWN
10	10255	4	PIN, SWING HOPPER WHEEL SUPPORT
9	NUT HEX FLG_~250-20 UNC_SIMP	27	NUT, 1/4-20UNC, GRD.5, FLANGE, ZINC
8	30029	1	SWING HOPPER, WELDMENT, 10"
7	<del>10042</del> 30062	1	DRIVE SHAFT, SWING HOPPER 10"
6	10094A	1	GUARD, CHAIN, SWING HOPPER DRIVE
5	10249	3	SPROCKET, #50 x 20 TOOTH, 1.00in BORE
4	30013	2	DRAG AUGER ASSEMBLY, SWING HOPPER H10XX
3	HEX WSHR_~375-16 UNC_0~75_SIMP	11	3/8-16UNC x 3/4" HEX FLANGE BOLT, GRD 5, ZINC
2	3125 x 75 CARRIAGE BOLT	17	BOLT, 5/16-UNC X 3/4", CARRIAGE, ZINC
1	10116	1	RUBBER, OVERFLOW FOR SWING HOPPER
Item Number	Part Number	Quantity	Description

DRAWING NO.  
PBH10012

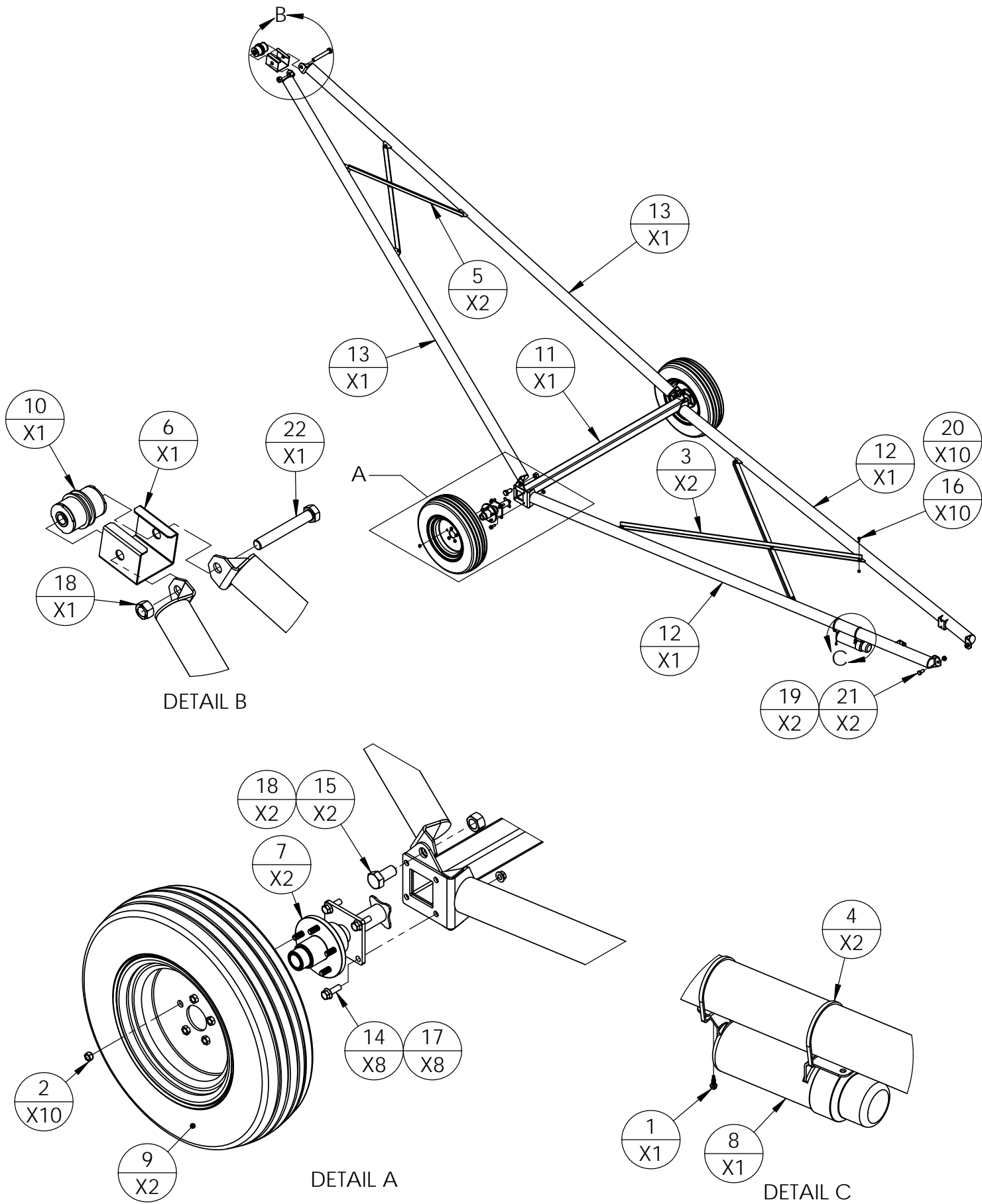

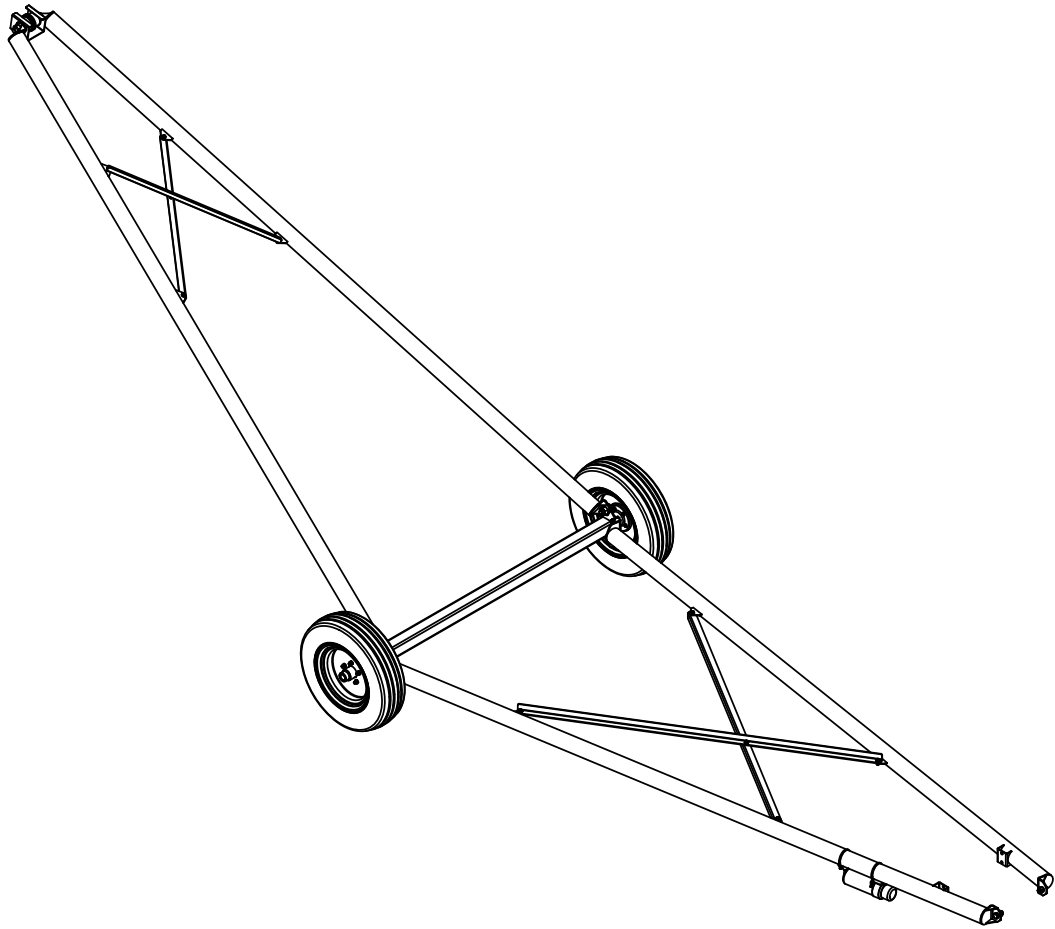

ITEM NO.	PART NO.	DESCRIPTION	QTY
1	10304	SCREW, SELF TAPPING, #12 x 3/4"	1
2	10434	NUT, 1/2-20, 60 DEGREE LUG NUT, ZINC	10
3	10693	X-BRACE, SUPPORT ARMS, A10XX	2
4	10960	ZIP TIE, MANUAL CANISTER MOUNT	2
5	10988	BRACE, X, T1042, T842, T836	2
6	11673	HOUSING, LIFT ROLLER, T AUGERS	1
7	30084	SPINDLE, ASSEMBLY, 10" AUGERS	2
8	30102	CANISTER, OWNERS MANUAL	1
9	30103	205/75 x 15" BIAS PLY TIRE & 5 BOLT RIM ASM	2
10	30971	ROLLER, LIFT, T1062 & T1072	1
11	31037	AXLE ASSEMBLY, T1342	1
12	31038	TUBE ASSEMBLY, CARRIAGE ARM, T1342	2
13	31039	TUBE ASSEMBLY, LIFT ARM, T1342	2
14	40005	BOLT, 1/2-13UNC X 1-1/2" HEX FLANGE, GRD 5, ZINC	8
15	40016	BOLT, 1-8UNC X 2 HEX, GRD 5, ZINC	2
16	40025	BOLT, 3/8-16UNC X 1" HEX FLANGE, GRD 5, ZINC	10
17	40047	NUT, 1/2-13UNC, HEX FLANGE, GRD 5, ZINC	8
18	40052	NUT, 1-8UNC, HEX, TOPLOCK, ZINC	3
19	40055	NUT, 3/4-10UNC, HEX, TOPLOCK, ZINC	2
20	40056	NUT, 3/8-16UNC, HEX FLANGE, GRD 5, ZINC	10
21	40090	BOLT, 3/4-10UNC x 1-1/2", HEX, GRD 5, ZINC	2
22	40122	BOLT, 1-8UNC X 7 HEX, GRD 5, ZINC	1