

Kodak

EasyShare 5300

All-in-One Printer



User's Guide

Kodak

Eastman Kodak Company

Rochester, New York 14650

© Eastman Kodak Company, 2008

P/N 1K3234

Kodak and EasyShare are trademarks of Eastman Kodak Company.

The Bluetooth word mark and logos are owned by the Bluetooth SIG, Inc. and any use of such marks is under license.

©1989-2007 I.R.I.S. (Image Recognition Integrated Systems), All Rights Reserved

Table of Contents

Product Overview	1
Main Components.....	1
Control Panel Layout.....	2
Status Lights.....	3
LCD Display Screen.....	8
Memory Card Slots and USB Port	9
AiO Home Center (Windows).....	10
AiO Home Center (Macintosh).....	11
Getting Started	13
Connect Power.....	13
Install the Printhead	13
Install Ink Cartridges.....	15
Install the Duplexer	16
Startup	17
Menus	18
Demo Sheet.....	21
Transfer Photos.....	22
Configuring Settings.....	22
Handling and Loading Paper	27
The Scanner Glass	27
Load Main Tray	28
Load Photo Tray	30
Load Envelopes.....	31
Load Labels.....	32
Print	33
Print Photos from a Camera.....	34
Print Photos from the Control Panel	34
Index Print.....	35
Print Photos from a Proofsheets	36
Tagged Photos (DPOF).....	36
Bluetooth Printing.....	37
Panoramic photos.....	38
Layouts	38
Setting Print Options.....	50
Previewing Photos	52
Copy	57
Copy with Control Panel	57

Scan	65
Scan with Control Panel.....	65
Maintenance	69
General Care.....	69
Clean the Scanner Glass.....	70
Clean the Scanner Lid.....	70
Format Memory Card.....	70
Print Diagnostic Sheet.....	70
Firmware Upgrade	71
Ink Cartridges	71
Printhead	73
Support	77
Contact Kodak.....	77
Limited Warranty	77
Telephone Customer Support.....	79
Troubleshooting.....	80
Appendix	91
All-in-One Specifications	91
Computer Requirements	91
Paper Types	92
Safety.....	94
Regulatory Compliance.....	95
Glossary	99
Index	101

1 Product Overview

The Kodak EasyShare 5300 All-in-One (AiO) Printer allows you to print, copy, and scan photos or documents. Many functions can be operated directly from the Control Panel. You can buy optional accessories to enhance your Kodak EasyShare AiO experience.

Main Components

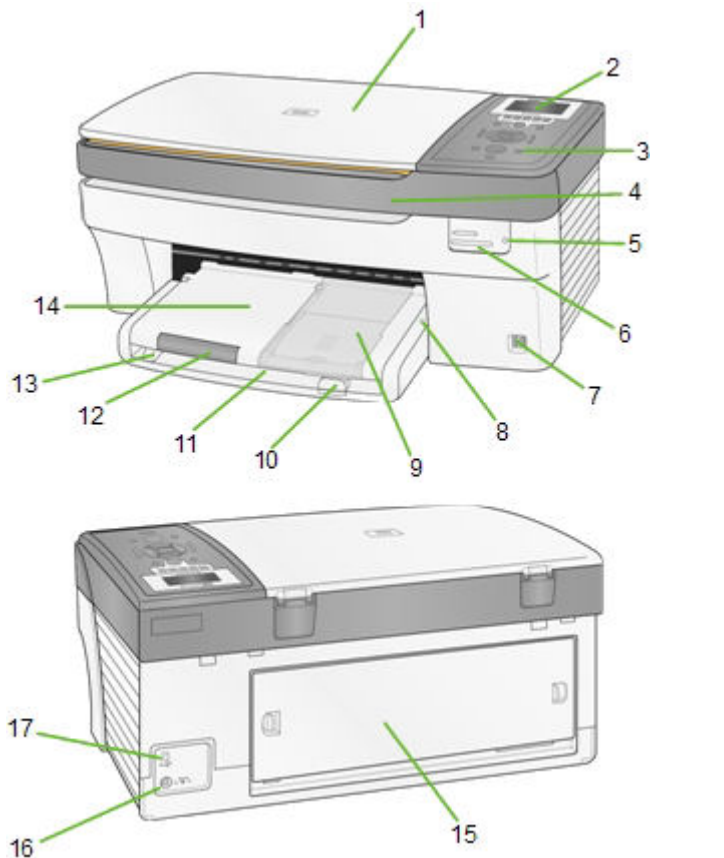

- | | |
|--------------------------------|--------------------------------|
| 1 Scanner lid | 10 Paper-length guide |
| 2 LCD display | 11 Main tray |
| 3 Control panel | 12 Output tray extender |
| 4 Printer access door | 13 Paper-width guide |
| 5 Memory card indicator | 14 Output tray |
| 6 Memory card slots | 15 Rear access door |
| 7 USB port | 16 Power connector |
| 8 Photo tray Light | 17 USB port |
| 9 Photo tray | |

Control Panel Layout

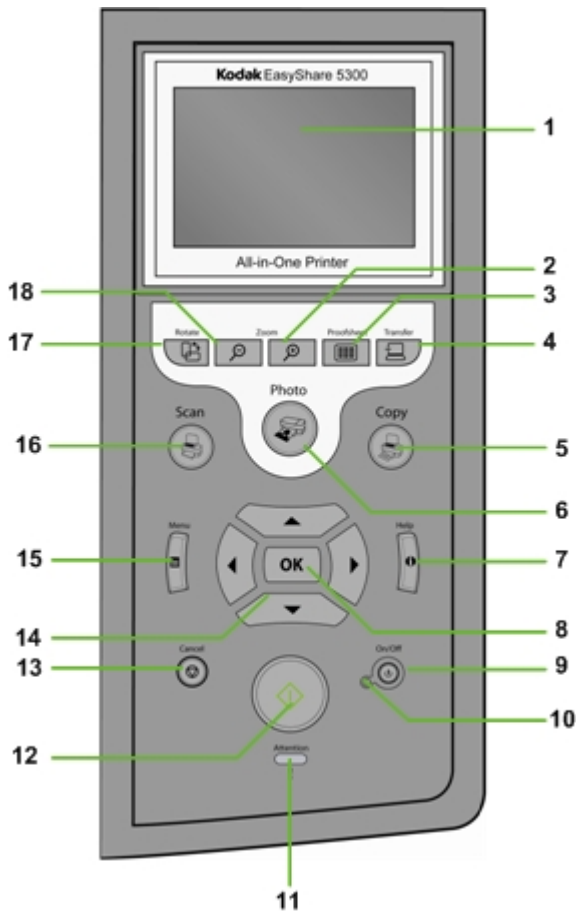

Number	Name	Description
1	LCD display	Displays photos, messages, status, and menus.
2	Zoom + button	When in Photo Preview mode, magnifies the photo to 1.5X. Subsequent presses zoom in 0.5X increments to a maximum of 5X. When in Multiview, displays the current photo in preview mode.
3	Proofsheet button	When there are pictures on an inserted memory card or connected USB host device, pressing Proofsheets displays the Proofsheets menu.
4	Transfer button	Transfers images from device connected to a USB host port, PictBridge, or Picture Transfer Protocol (PTP).
5	Copy button	Press to enter Copy mode. Lit when in Copy mode.
6	Photo button	Press to enter Print mode. Lit when in Print mode.
7	Help button	Displays the Help menu.
8	OK button	Used for selection in conjunction with the 4-way Navigation button.
9	On/Off button	Turns your EasyShare AiO on or off.
10	On/Off Light	Green when Starting Up, Ready, or in Standby mode. Flashes red when in an error state. Is not lit when in Sleep mode.

Number	Name	Description
11	Attention Light	On or flashing for an error or warning condition.
12	Start button	Starts a copy, print, or scan operation.
13	Cancel button	Cancels the current operation.
14	4-way Navigation button	Used to navigate Up ▲, Down ▼, Left ◀, and Right ▶.
15	Menu button	Displays the main menu screen.
16	Scan button	Press to enter Scan mode. Lit when in Scan mode.
17	Rotate button	Rotates picture on the display, clockwise, 90 degrees.
18	Zoom – button	When the EasyShare AiO is in Photo Preview mode, pressing enters Multiview. When a photo has been magnified with the Zoom + button, pressing decreases the magnification in 0.5X increments.

Status Lights

The following tables contain information on the EasyShare AiO lights.

All Lights on Control Panel		
Light Status	Cause	Action/Solution
All lights are off.	The printer is turned off.	Press the On/Off button to turn the printer on.
	The Printer does not have power applied.	Check the light on the power cord.
The On/Off Light is flashing and the Display has the following message: Kodak EasyShare System Starting Up (Please Wait) The five boxes at the bottom are flash walking left to right.	The Printer is Initializing.	None: Allow the Printer to complete the initialization process.

Power Light on Power Cord		
Light Status	Cause	Action/Solution
Power cord light is off.	The printer to power supply cord is not properly connected to the Power Supply.	Reseat the printer to power supply cord.
	The power supply to your wall outlet cord is not properly connected to your wall outlet.	Reseat the Power Supply to your Wall Outlet Cord.
	You do not have the appropriate power available at your wall outlet.	Test your wall outlet by plugging a known working device into you wall outlet. Have your wall outlet checked by a qualified electrician.
	There may be an issue with the power supply.	Visit Kodak.com for additional troubleshooting steps or contact your local Kodak Call Center.
Power cord light is on.	The power cord and power supply are properly connected and ready to supply power to the printer.	Ensure that the power cord is properly plugged into the back of the printer.

On/Off Light		
Light Status	Cause	Action/Solution
Light is off.	The printer is turned off.	Press the On/Off button to turn the printer on.
	The Printer does not have power applied.	Check the light on the power cord.
	The printer needs attention.	Check to see if the Photo Tray light is on. If the Photo Tray light is on for more that 20 seconds and the On/Off light does not come on, disconnect the power for 5 seconds and reconnect the power. If the Photo Tray light does not go out after 20 seconds and the On/Off light comes on, contact Kodak for assistance.
Light is a steady green.	The printer is properly powered up, on, and ready.	None
Light is a flashing green.	The printer is busy.	None: Normal operation when performing a print, copy, scan, or other job requests.
	The printer is initializing.	None: Please wait and allow the printer to complete the initialization process (about 30 seconds). If the flashing green persists, you may have an issue with the printer. Visit Kodak.com for additional troubleshooting steps or contact your local Kodak Call Center.
Light is a flashing yellow.	The printer has detected an error condition.	Disconnect power for 5 seconds and reconnect power. If the condition persists, please check the LCD display for additional information. Contact Kodak service for assistance. Also check the status monitor on your computer for a message.
Light is a flashing red.	The printer has detected an error condition that needs your attention.	Check the LCD display or status monitor on your computer for a message.
Flashing a rotating pattern of red, yellow, and green.	The printer has not detected that a Printhead is installed.	Please install a Printhead and ink cartridges.

Photo Tray Status Light		
Light Status	Cause	Action/Solution
Photo tray light is Off.	The photo tray is not engaged.	Push the photo tray in to engage if you want to print 4 x 6 inch pictures.
	The printer is not turned on.	Press the On/Off button to turn the printer on.
Photo tray light is On.	The photo tray is engaged.	Pull the photo tray out to disengage if you do not want to print 4 x 6 inch pictures.
	The printer is powering up.	None: Please wait and allow the printer to complete the initialization process. If the flashing green persists, you may have an issue with the printer. Visit Kodak.com for additional troubleshooting steps or contact your local Kodak Call Center.

Attention Light		
Light Status	Cause	Action/Solution
Light is off.	No Error.	None
Light is blinking steady.	Recoverable Error.	<p>Paper jam while printing. Main tray empty. Photo tray empty. Carrier stall during pick. Media size mismatch. Media type mismatch. Paper jam during pick. Carrier stall while printing. Change color ink cartridge. Change black ink cartridge. Color ink cartridge not readable. Black ink cartridge not readable. Change both ink cartridges. Printhead not calibrated. Calibration sheet needs scanning. Calibration sheet not detected. Calibration sheet read error. Back cover removed when idle. Back cover removed while printing. Unit opened when idle. Unit opened during printing. Too many picture sources. Proofsheet not detected. Proofsheet read error.</p>
Light is blinking rapidly.	Warning	<p>Color ink cartridge inserted incorrectly. Black ink cartridge inserted incorrectly. Color ink cartridge not installed. Black ink cartridge not installed. Ink cartridges not installed. Printhead not installed.</p>
Light is on.	Non-Recoverable Error	<p>Media sensor failure. Printhead failure. Scanner failure.</p>

Card Slot Light		
Light Status	Cause	Action/Solution
Light is off.	An SD/MMC card is not inserted or is improperly inserted in the card slot.	Remove and reinsert the SD/MMC card.
Light is on.	An SD/MMC card is properly inserted in the card slot.	None
Light blinks green.	Slow blink: The internal card reader is initializing or communicating with the printer.	None
	Fast blink: There is a card or communication error.	Remove the card and make sure the card is not "write" protected or damaged. Reinsert the card or replace with a new card if necessary.

LCD Display Screen

The LCD screen displays photos, messages, instructions, and menu parameters. Menu navigation is accomplished with the 4-way Navigation buttons. The screen is hinged at the back edge and can be positioned from flat on the control panel surface to vertical.

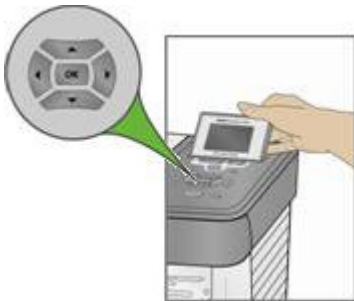

Instructions displayed on photos appear up to four seconds and then disappear, or disappear immediately after you start interacting with the screen. The instructions will return after fifteen seconds of inactivity.

When a second page of display text is present, it is indicated by the down arrow ▼ symbol, positioned in the lower right corner of the menu area. When the second or subsequent page of text is in view, the presence of a previous page is indicated by the up arrow ▲ symbol in the top of right corner of the menu area.

Each time you press Navigate Down (▼), you advance the highlight down 1 row. When the last row is highlighted, pressing ▼ causes page 1 to be replaced with page 2. When page 2 appears, the highlight is on the top row. The up arrow ▲ symbol appears at the right edge. If a third page of menu parameters is available, the down arrow ▼ symbol appears in the lower right corner. Until the highlight is advanced, pressing Navigate Up (▲) returns you to the previous page. Holding down any of the 4-way Navigation buttons causes them to repeat (scroll).

Default Display Settings

Default settings are provided for each option. If you make changes to the settings, the changes remain as long as you do not change modes. You can save the settings in each mode by navigating to **Save Settings** and pressing **OK**. You may reset options to the master defaults by going to the main menu and selecting **Reset All Settings**.

Photos

The LCD screen displays JPG images when you insert a memory card, camera, or USB device. However, the following images will not be displayed.

- File size greater than 8 MB
- Image size greater than 12 megapixels
- Image colorspace is not sRGB or adobeRGB
- Progressive JPEG images

Memory Card Slots and USB Port

Your Kodak EasyShare All-in-One can access the memory cards used in most digital cameras. You can insert the memory card into the EasyShare AiO, or connect your camera directly through one of the two USB ports on the front panel, using a USB cable. Your Kodak EasyShare AiO can read the contents of the memory card while it is still in the camera.



If your EasyShare AiO beeps three times when you plug a device into the USB Port, it means the device is not supported.

Supported Memory Cards



Your Kodak EasyShare AiO can read the following memory cards.

- xD-Picture Card
- Memory Stick
- Memory Stick Pro
- Secure Digital Card/MultiMediaCard
- Compact Flash type I and type II, including microdrives

Your EasyShare AiO also supports the following memory cards with Memory Stick and SD/MMC card slot adapters you can purchase.

- Memory Stick Duo
- miniSD
- MicroSD (TransFlash)

The Memory Card light is a green LED located near the memory card slots. It lights whenever you insert a memory card, and flashes while the card is being read. The flashing serves as an indication to not remove the card while it is being read, or written to, which could potentially damage the data on the card.



AiO Home Center (Windows)

The AiO Home Center software is an application that runs on the computer. It enables you to print, copy, scan, and configure your AiO printer from the computer.

The six large icons on the AiO Home Center main window let you:

- Scan Pictures and Documents
- Copy Pictures
- Print Pictures
- Configure Settings for Printing and Scanning.
- Access My Resource Center at Kodak
- Order Supplies

There are three small icons in the upper right corner of the window:

-  Returns you to the main Home Center screen
-  Displays the Status Monitor
-  Displays a Help panel for the Home Center software

AiO Home Center (Macintosh)

The AiO Home Center software is an application that runs on the computer. It enables you to configure your AiO printer from the computer. After installation, you can run Home Center from the Printer Setup Utility by selecting your Kodak AiO Printer in the Printer List and clicking the **Utility** icon.

The Setup and Maintenance tabs let you:

- Configure Settings
- Calibration and Printhead Cleaning

Select: Provides a list of connected printers where you can select another printer.

Order Supplies: Connects you to a Kodak web site where you can order supplies online.

View/Hide Status: Opens a drawer that displays the configuration status of your Kodak AiO printer.

2 Getting Started

It is important to find a good location for your AiO Printer. Place the printer on a clean flat surface, in a dry location, and out of direct sunlight. Make sure the printer has proper ventilation.

Avoid areas where ventilation ducts, open doors, or high traffic might expose the EasyShare AiO and paper to high levels of dust and debris. Airborne particles can affect picture quality.

Allow enough space on all sides of the EasyShare AiO to let you connect and disconnect cables, change the ink cartridges, and remove and load paper.

Connect Power



RISK OF ELECTRICAL SHOCK

Use only the AC power adapter included with your AiO printer. Other adapters or cords could damage your printer or computer.

- 1 Connect the printer power cord to the AC power adapter, then to the back of the AiO printer.
- 2 Plug the AC adapter power cord into a power outlet.

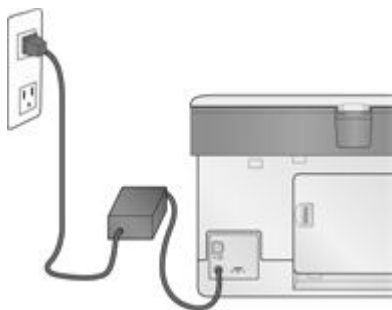

Install the Printhead

The printhead dispenses the ink from the cartridges onto the paper.

- 1 Make sure the EasyShare AiO is on.
- 2 Open the printer access door. The carriage moves to a center position.



- 3** Remove the printhead from its bag.



- 4** Remove and discard the clear plastic casing and the orange protective cap.

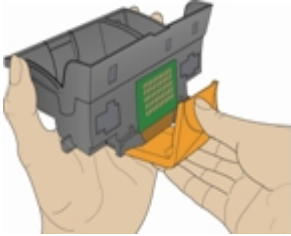

- 5** Place the printhead into the carriage.

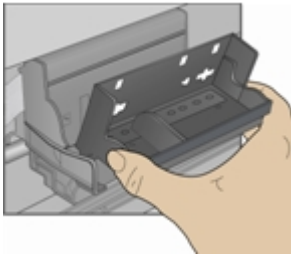

- 6** Push against the back wall of the printhead until it clicks into place.

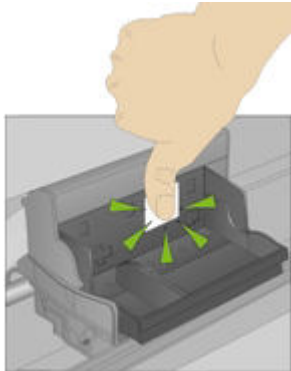

- 7** Install the ink cartridges.

Install Ink Cartridges

After installing the printhead, you need to install the black and color ink cartridges.

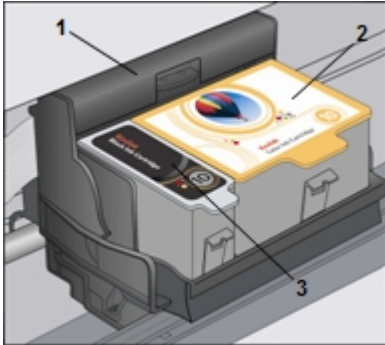

- 1 Printhead
- 2 Color ink cartridge
- 3 Black ink cartridge

- 1 Tear open the black ink cartridge bag at the notch and remove the ink cartridge.
IMPORTANT: Insert the ink cartridge immediately to prevent any drying of the ink.



- 2 Remove and discard the orange cap.
IMPORTANT: Handle ink cartridge carefully to avoid ink transfer.



- 3 Insert the black ink cartridge into the printhead.



- 4 Press down on the ink cartridge until you hear it snap into position.



- 5 Tear open the color ink cartridge bag at the notch and remove the ink cartridge.



- 6 Remove and discard the orange cap.
7 Insert the color ink cartridge into the printhead.

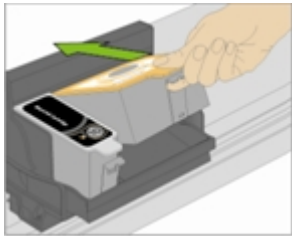

- 8 Press down firmly on the cartridge until you hear it snap into position.

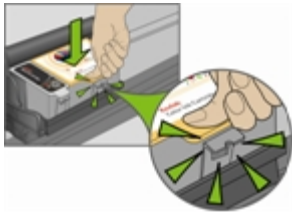

- 9 Close the printer access door.

NOTE: For the best quality prints, store ink cartridges in a location where the temperature does not exceed 85° F (30° C).

Install the Duplexer

The Kodak EasyShare AiO supports an optional duplexer (Kodak EasyShare 5000 Series Two-Sided Printing Accessory) that enables printing on both sides of the paper. When installed, the duplexer is automatically detected by the printer and computer system software.

The duplexer is limited to plain paper. The paper dimensions that can be used are from 6.9 to 8.5 inches (17.5 to 21.6 cm) wide and from 9.8 to 11.7 inches (24.9 to 29.7 cm) long.

You can purchase a duplexer and other accessories for your printer at www.kodak.com/go/accessories.

- 1 Remove the door on the back of the printer by pressing in on the two latches and pulling out.

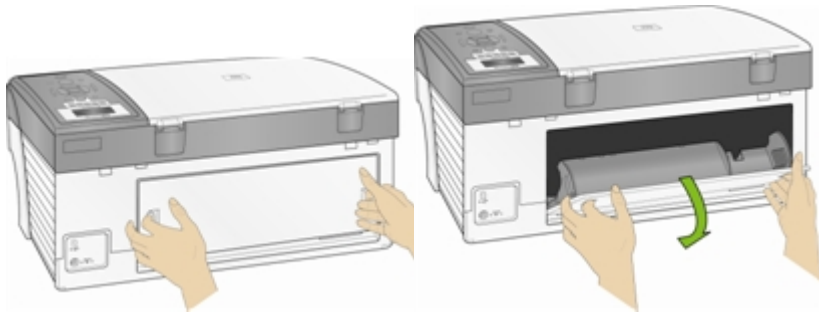

- 2 Insert the bottom of the duplexer into the printer and press the top in until it clicks.

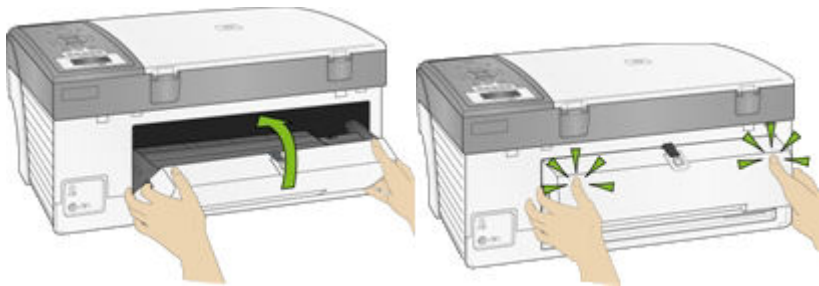

You can control how long the printer waits before a sheet is flipped by the duplexer with the AiO Home Center (See *General Settings*).

Startup

When you power on your Kodak EasyShare All-in-One, status information is displayed on the LCD. After the startup is complete, the EasyShare AiO enters the Copy mode, unless a photo device is attached. If a photo device is attached or memory card inserted, the EasyShare AiO enters Photo mode.

Menus

The Kodak EasyShare AiO menus are accessed by the Menu, Photo, Copy, Scan, and Help buttons.

Menu Button

Help	OK	Inserting Ink Cartridges Making a Copy Printing a Photo Making a Scan Calibrating Printer
Photo Print Settings	OK	Use Print Order if Found ◀ or ▶ Yes No Scene Balance ◀ or ▶ On Off Add Date to Prints ◀ or ▶ No Yes
Control Panel Settings	OK	Button Sounds ◀ or ▶ On Off Minutes to Standby ◀ or ▶ 10-30
Ink Levels	OK	
Proofsheet	OK	Print Proofsheet Scan Proofsheet
Clean Printhead	OK	Basic Clean Deep Clean
Calibrate Printer	OK	Print Calibration Page Scan Calibration Page
Format Memory Card	OK	Formats inserted memory card.
Print Demo Sheet	OK	Prints a demonstration page.
Print Diagnostic Sheet	OK	Prints a diagnostic page.

Date and Time	OK	Year	◀ or ▶	2006-2099
		Month	◀ or ▶	January-December
		Day	◀ or ▶	1-31
		Hour	◀ or ▶	0-24
		Minute	◀ or ▶	0-60
Language	◀ or ▶	<List of languages>		
Reset all Settings	OK			

Photo Button

Layout	◀ or ▶	Borderless
		Bordered
		2 per Page
		3 per Page
		4 per Page
		9 per Page
		Index
		2x2 Poster
		3x3 Poster
		4x4 Poster
Quantity	◀ or ▶	1 - 99
Color	◀ or ▶	Color
		Black & White
Quality	◀ or ▶	Normal
		Best
		Draft
Save Settings	◀ or ▶	No
		Yes

Copy Button

Quantity	◀ or ▶	1 - 99
Color	◀ or ▶	Black & White Color
Quality	◀ or ▶	Normal Draft Best
Output	◀ or ▶	Same Size Fit to Page Scale Percent Photo Layouts
Size	◀ or ▶	Output = Scale Percent 10 - 500 Output = Photo Layouts Borderless Bordered 2 per Page 3 per Page 4 per Page 9 per Page Index 2x2 Poster 3x3 Poster 4x4 Poster
Brightness	◀ or ▶	-3 to +3
Preview	◀ or ▶	No Yes (Photo Layouts only)
Save Settings	◀ or ▶	No Yes

Scan Button

Scan What	◀ or ▶	Document
		Photo
Scan To	◀ or ▶	File
		Application
		Memory Card
Application	◀ or ▶	<i>List of applications</i>
Save Settings	◀ or ▶	No
		Yes

Help Button

Installing Ink Cartridges	OK
Making a Copy	OK
Making a Photo	OK
Making a Scan	OK
Calibrating Printer	OK

Demo Sheet

You can print a sample page on US Letter or A4 size paper to evaluate print quality. The Demo Sheet is a single sheet of paper that displays information about the features and capabilities of your EasyShare AiO printer.

You can print a Demo Sheet by pressing the **Copy** and **Photo** buttons at the same time.

or

- 1 Press **Menu** to display the main menu.
- 2 Press ▼ until **Print Demo Sheet** is selected.
- 3 Press **OK**.
- 4 Press **Start** to begin printing.

Transfer Photos

After you take photos with your digital camera, you can print them immediately or save them directly to your computer. You can transfer from memory cards, PTP cameras, and USB mass storage devices.

- 1 Insert a Memory Card into the appropriate slot or connect a camera to the USB Port.



WARNING:

Never attempt to remove a memory card while it is being accessed. Doing so can damage files on the card. You can safely remove a card only when the status light next to the slots is not blinking.

- 2 Press **Transfer**.
- 3 Press **Start** to transfer.
- 4 Complete the transfer with the Transfer dialog on your computer.

Configuring Settings

You can configure settings for your Kodak EasyShare AiO using the Control Panel and the AiO Home Center software.

Use Print Order if Found

The Digital Print Order Format (DPOF) is an industry-standard file that can be created by some digital cameras. Camera-selected photos are photos you tag for printing with your digital camera. When you select photos with your camera, the camera creates a DPOF file that identifies which photos have been tagged for printing. Your Kodak EasyShare AiO can read the DPOF file from the memory card in a camera so you do not have to re-select the photos to print.

NOTE: Not all digital cameras allow you to tag your photos for printing. See your digital camera documentation to see if it supports tagging (DPOF).

When you print tagged photos, the selected default layout is applied, unless your camera allows selection of sizes.

The DPOF file is stored by the digital camera on a memory card and specifies the following information:

- Which photos to print
- The quantity of each photo to print
- Index printing (thumbnails of selected photos)

The default setting for using a detected DPOF file is Yes.

- 1 Press **Menu** to display the main menu.
- 2 Press ▼ to select **Photo Print Settings**.
- 3 Press **OK**.
- 4 Press ▼ to select **Use Print Order if Found**.
- 5 Press ◀ or ▶ to change the setting.
- 6 Press **OK**.

Scene Balance

Your EasyShare AiO is configurable to apply automatic scene balance improvements (brightness) for photos printed on the AiO from camera cards and USB connected devices. The default is to apply the scene balance improvements.

- 1 Press **Menu** to display the main menu.
- 2 Press ▼ to select **Photo Print Settings**.
- 3 Press **OK**.
- 4 Press ▼ until **Scene Balance** is selected.
- 5 Press ◀ or ▶ to enable or disable Scene Balance.
- 6 Press **OK**.

Add Date to Prints

You can set your EasyShare AiO to print the date a picture was taken on the photo print. The default is to not print the date.

- 1 Press **Menu** to display the main menu.
- 2 Press ▼ to select **Photo Print Settings**.
- 3 Press **OK**.
- 4 Press ▼ until **Add Date to Prints** is selected.
- 5 Press ◀ or ▶ to enable or disable date printing.
- 6 Press **OK**.

Button Sounds

You can configure your EasyShare AiO to emit an audio feedback beep when you press a button on the Control Panel. The default setting is to beep.

- 1 Press **Menu** to display the main menu.
- 2 Press ▼ until **Control Panel Settings** is selected.
- 3 Press **OK**.
- 4 Press ◀ or ▶ to enable or disable button sounds.
- 5 Press **OK**.

Minutes to Standby

When the Kodak EasyShare All-in-One is idle for the standby power setting timeout period, it enters the Standby state. The **On/Off** indicator remains lit, but power consumption is reduced. When in the Standby state, any activity such as a single button press, or inserting camera card, brings the EasyShare AiO out of the Standby state and returns it to the Ready state.

You can set the standby timeout from 10 – 30 minutes. The default setting is 15 minutes.

- 1 Press **Menu** to display the main menu.
- 2 Press **▼** until **Control Panel Settings** is selected.
- 3 Press **OK**. The Power Settings menu is displayed with **Minutes to Standby** selected.
- 4 Press **◀** or **▶** to change the standby timeout period.
- 5 Press **OK**.

Date and Time

Your Kodak EasyShare All-in-One contains a clock for stamping the date and time on scans to a memory card.

- 1 Press **Menu** to display the main menu.
- 2 Press **▼** until **Date and Time** is selected.
- 3 Press **OK** to go to the Date and Time menu.
- 4 Press **◀** or **▶** to set the **Year**.
- 5 Press **OK**.
- 6 Press **◀** or **▶** to set the **Month**.
- 7 Press **OK**.
- 8 Press **◀** or **▶** to set the **Day**.
- 9 Press **OK**.
- 10 Press **◀** or **▶** to set the **Hour**.
- 11 Press **OK**.
- 12 Press **◀** or **▶** to set the **Minute**.
- 13 Press **OK**.

Set Language

You can select the language the EasyShare AiO uses for the LCD display.

- 1 Press **Menu** to display the Main Menu.
- 2 Press ▼ until **Language** is displayed.
- 3 Press **OK** to go to the Select Language menu.
- 4 Press ▼ until the language you want is selected.
- 5 Press **OK**.

Reset All Settings

You can restore the original factory settings to your Kodak EasyShare All-in-One.

NOTE: Restoring the factory defaults will not change the date and time information you set.

- 1 Press **Menu** to display the Main Menu.
- 2 Press ▼ until **Reset All Settings** is selected.
- 3 Press **OK**.

3 Handling and Loading Paper

Use the following guidelines when handling paper.

- To avoid fingerprints, handle the paper by the edges as much as possible.
- Avoid touching the glossy side of photo paper.
- Keep the input and 4x6 paper trays closed to keep out dust and debris.
- Store paper flat.
- Keep paper away from direct sunlight, and out of high-temperature environments (such as a vehicle parked in the sun).

You can load many different types and sizes of paper in your Kodak EasyShare AiO, including letter paper, photo paper, transparencies, and envelopes (see *Paper Types* in the Appendix). The EasyShare AiO automatically detects the size and type of paper you load in the input tray, and then adjusts to generate the highest quality output for that paper.

The Scanner Glass

The scanner glass is where you place originals for copying or scanning.

- 1 Lift the lid and place your original face down on the right front corner of the scanner glass.

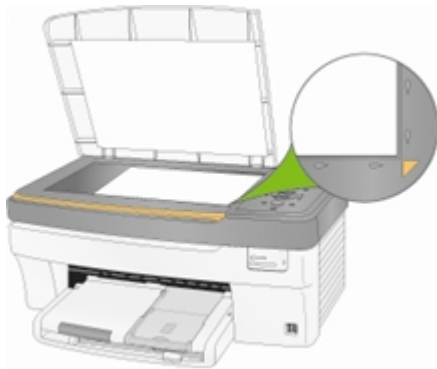

- 2 Close the lid.

You can copy or scan oversized originals by completely removing the lid from your EasyShare AiO. To remove the lid, lift the lid to the open position, grasp the sides of the lid, and then pull the lid upward.



Your EasyShare AiO functions normally with the lid removed. Replace the lid by inserting the tabs on the hinge back into the appropriate slots.

Load Main Tray

You can load the main paper tray with various types of paper from 3 to 8.5 inches wide and 5 to 14 inches long, with a capacity of 100 sheets of 20 lb plain paper (clean stack of new paper).

IMPORTANT: To print from the main paper tray, make sure the photo tray is not engaged, pulled all the way out, and the lid closed.

- 1 Lift the output tray, and slide the paper-width and paper-length guides to their outermost positions.

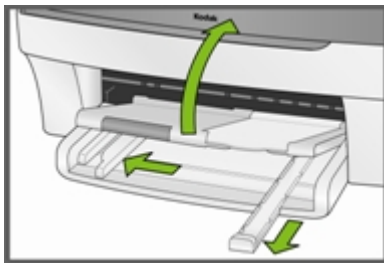

- 2 Align the edges of a stack of paper.
- 3 Insert the stack of paper into the input tray with the short edge forward and the print side down. Slide the stack of paper forward until it stops.

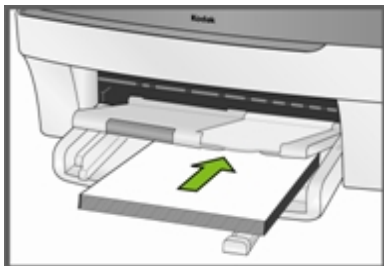

- Slide the paper-width and paper-length guides inward until they stop at the edges of the paper.

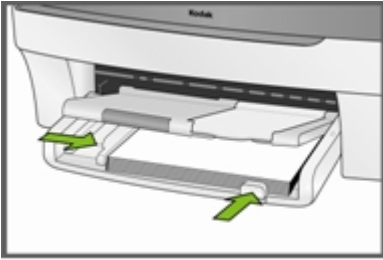

- Lower the output tray.

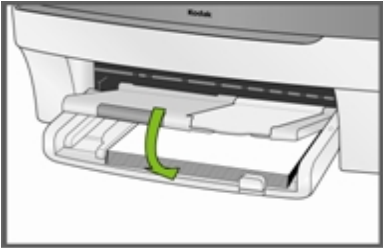

- Pull the extender tray out.

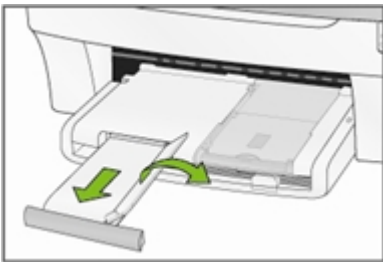

Load Photo Tray

You can load up to 20 sheets of 10 mil thick 4x6 inch (101x150 mm) photo paper into the photo tray.

TIP: To avoid fingerprints, handle the paper by the edges or by the perforated tabs. Avoid touching the glossy side of the paper.



- 1 Lift the photo tray lid.



- 2 Slide the photo tray towards you until it stops.
NOTE: When the photo tray is disengaged, the main paper tray is active.
- 3 Insert the stack of photo paper into the photo tray glossy side down.



- 4 Slide the photo tray with the stack of photo paper in until it stops. Engaging the photo tray turns the photo tray light on.



- 5 Close the photo tray lid.



Load Envelopes

You can load plain envelopes into the main input tray of your Kodak EasyShare AiO. Do not use envelopes with cutouts or cellophane windows.

- 1 Lift the output tray.

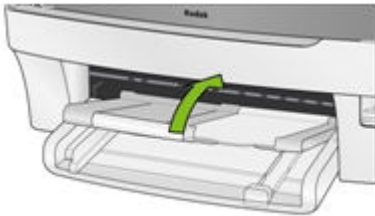

- 2 Remove any paper in the input tray.
- 3 Insert one or more envelopes face down with the envelope flaps to the left.
- 4 Slide the stack of envelopes forward until it stops.

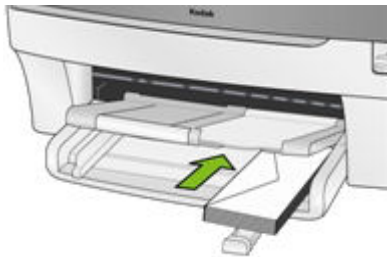

- 5 Slide the paper guides inward against the stack of envelopes until they stop.

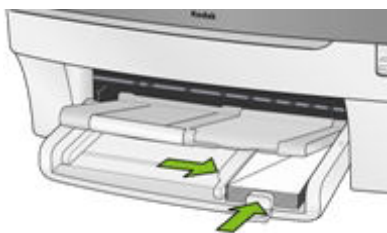

- 6 Close the output tray.

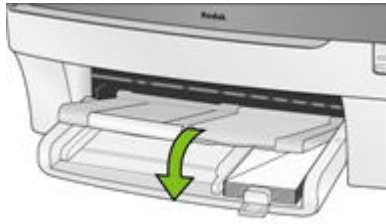

Load Labels

Use letter or A4 (designed for use with ink jet printers) label sheets.

- 1 Ensure that none of the pages are sticking together.
- 2 Place a stack of label sheets on top of standard paper in the input tray, label side down.

4 Print

The memory card slots accept most of the popular memory cards (see *Supported Memory Cards*). When you insert a memory card into the card slot, connect PTP camera, or USB flash drive, the last photo is displayed on the LCD display. When you press the **Photo** button the Photo Print menu is displayed. The **Photo** button toggles between displaying photos and the Photo Print menu.



CAUTION

You can only use one device (USB or Memory card) from which to print. If both devices are engaged, the EasyShare AiO generates an error message.

When you print from an application, the EasyShare AiO printer driver provides the following features.

Non-photo Paper Print Quality

Draft Produces the fastest print speed, but the lowest quality.

Normal Delivers high-quality output and is the default setting. Normal prints faster than Best.

Best Produces the highest quality for all paper and eliminates the banding (striping) effect that sometimes occurs in solid areas. Best is the slowest print speed.

Page Size

You can select a standard page size or create a custom size.

Borderless

Prints without any margin on the printed media.

Orientation

You can print a document with the short edge of the paper at the top of the page (portrait), or with the long edge of the paper at the top of the page (landscape).

Print last page first

Causes printing to begin with the last page and end with the first page.

NOTE: There can be a delay when printing a large document while it is being spooled. Printing will begin when the last page is spooled.

Collate

You can collate pages when printing multiple copies.

Scale Layout

You can scale pages or pictures by percentage or page size.

Multi-page Layout

The driver can reduce multiple pages so that they can all be printed on one sheet of paper.

Poster Layout

This function enlarges a picture, divides it into several pages, and prints each page on a separate sheet of paper. You can paste these sheets of paper together to create a poster.

Booklet Layout

The pages are distributed and printed on both sides of the paper and arranged in sequence. When they are folded in the middle and stapled they create a booklet.

Print Mirror Image

Flips the image for iron-on printing.

Two-sided Printing

You can print on both sides of the paper.

Watermark

You can select or create a background watermark.

Print Photos from a Camera

- 1 Connect your camera to the EasyShare AiO. The PictBridge logo is displayed on the LCD.



- 2 Load the photo tray with photo paper (See *Load Photo Tray* in Chapter 3).
- 3 Use your camera to select and print photos.

Print Photos from the Control Panel

The Photo Print mode is initiated by pressing the **Photo** button, inserting a memory card, or connecting a USB device to the Kodak EasyShare All-in-One.

- 1 Insert a memory card into the appropriate slot, a mass storage device into the USB port, or connect a digital camera to the USB port. The last photo is displayed.



WARNING

Never attempt to remove a memory card while it is being accessed. Doing so can damage files on the card. You can safely remove a card only when the status light next to the slots is not blinking.

- 2 Load the main tray (see *Load Main Tray* in Chapter 3) or photo tray (See *Load Photo Tray* in Chapter 3) with photo paper.

NOTE: The Photo Tray only supports 4x6 inch and 100x150 mm photo paper.

- 3 Press **▲** to select the number of prints for this photo.
- 4 Press **▶** to preview the next photo.

TIP: To select all the photos on a memory card or mass storage device, hold down the **OK** button for 2 seconds. Holding down the **OK** button again for 2 seconds will de-select all the photos.

- 5 Repeat Steps 3 and 4 until you are finished selecting photos.
- 6 Press **Start** to print the selected photos or **Photo** to set print options.
- 7 Set print options.

See *Set Print Layout*

See *Set Number of Prints*

See *Set Color*

See *Set Print Quality*

After a photo is printed, it is de-selected.

Index Print

The purpose of an index print is to catalog contents of a memory card or USB flash drive. An Index print contains the following:

- Sequence numbers for the relative position of each photo within the defined set of photos, incrementing from 001 and continuing progressively across all pages of a multi-page index print.
 - 8x10 Index prints are 7/8 inches wide with 1/8 inch white space between photos. The filename is displayed below each thumbnail image.
 - 4x6 index prints are 3/4 inch wide with 1/8 inch white space between images. The filename is displayed below each thumbnail image.
- 1 Insert a memory card into the appropriate slot, a mass storage device into the USB port, or connect a digital camera to the USB port. The first photo is displayed.



WARNING

Never attempt to remove a memory card while it is being accessed. Doing so can damage files on the card. You can safely remove a card only when the status light next to the slots is not blinking.

- 2 Load the main tray (see *Load Main Tray* in Chapter 3) or photo tray (See *Load Photo Tray* in Chapter 3) with photo paper.

NOTE: The Photo Tray only supports 4x6 inch and 100x150 mm photo paper.

- 3 Press **Photo**. The Print menu is displayed with Layout selected.
- 4 Press the ◀ or ▶ to select **Index**.
- 5 Press **Start**.

Print Photos from a Proofsheets

A proofsheets is a simple and convenient way to select photos and make prints directly from a camera or memory card without the need for a computer.

Proofsheets printing is a two step process. In the first step, you connect a PTP camera or insert a memory card and print a proofsheets. In the second step, you select pictures to print from the proofsheets and then scan the proofsheets into the EasyShare AiO.

IMPORTANT: If the AiO printer goes into standby mode, power is lost, or you unplug the memory card, camera, or USB device before you scan the proofsheets, the proofsheets session number becomes invalid and you will need to re-print it.

- 1 Insert a memory card into the appropriate slot, a mass storage device into the USB port, or connect a digital camera to the USB port. The first photo is displayed.



WARNING

Never attempt to remove a memory card while it is being accessed. Doing so can damage files on the card. You can safely remove a card only when the status light next to the slots is not blinking.

- 2 Load the main tray (see *Load Main Tray* in Chapter 3) with letter size plain paper.
- 3 Press **Menu**.
- 4 Press **▼** until **Proofsheets** is selected.
- 5 Press **OK**.
- 6 Press **Start** to print the proofsheets.
- 7 Complete the four steps on the proofsheets with the memory card, storage device, or camera connected.

Tagged Photos (DPOF)

The Digital Print Order Format (DPOF) is an industry-standard file that can be created by some digital cameras. Camera-selected photos are photos you tag for printing with your digital camera. When you select photos with your camera, the camera creates a DPOF file that identifies which photos have been tagged for printing. Your Kodak EasyShare AiO can read the DPOF file from the memory card in a camera so you do not have to re-select the photos to print.

NOTE: Not all digital cameras allow you to tag your photos for printing. See your digital camera documentation to see if it supports tagging (DPOF).

When you print tagged photos, the selected default layout is applied, unless your camera allows selection of sizes.

The DPOF file is stored by the digital camera on a memory card and specifies the following information:

- Which photos to print
- The quantity of each photo to print
- Rotation applied to a photo
- Cropping applied to a photo
- Index printing (thumbnails of selected photos)

If a DPOF file is detected when you insert a memory card, the EasyShare AiO displays a message asking if you want to print tagged images.

Bluetooth Printing

Bluetooth is a short-range radio technology that enables wireless connectivity between electronic devices. This feature supports an optional Kodak USB Bluetooth Adapter that accepts JPEG/EXIF image file types from the following types of Bluetooth enabled devices.



- Mobile camera phones
- PDAs
- Digital still cameras

You can purchase a Bluetooth Adapter directly from Kodak at www.kodak.com/go/accessories.

To enable Bluetooth wireless connectivity, plug your Kodak Bluetooth Adapter into the front USB port.



NOTE: Your EasyShare AiO supports connection to only one Bluetooth device at a time and has an 8MB file size limitation.

Range

The recommended maximum distance between Bluetooth devices for the highest transfer speed is 10 meters or 32.81 feet. However, Bluetooth will work beyond this distance.

User-friendly Name

Your EasyShare AiO has a serial number that is used to construct name for Bluetooth printing. The default name is **Kodak5300+XXXX**, where **XXXX** represents the last four digits if the AiO printer's serial number. You can change this to a more user-friendly name with the AiO Home Center (See *General Settings* in Chapter 2).

Printing

When a Bluetooth connection is made, no other functions are available, and the LCD display indicates printing from Bluetooth. You control printing from your Bluetooth device.

Panoramic photos

Panoramic images are detected based on the aspect ratio of the image. A panoramic image is displayed in a "fit to page" manner with blank space above and below the image. The crop box is adjusted for a 300 x 100 mm (12 x 4") aspect ratio and initially encompasses the entire image.

If panoramic images are selected for printing, the AiO printer prints all of the panoramic images after all other images have printed. Before printing the panoramic images, the EasyShare AiO displays a message to allow you to insert panoramic paper then press **Start** again to print the panoramic images.

Layouts

The photo layouts on your Kodak EasyShare AiO "snap" to the nearest standard print size whenever possible based on the combination of layout and paper size loaded. Otherwise the layouts are based on a standard 2x3 aspect ratio. The table below shows the print sizes that result from the various layouts when applied to US Letter size paper (8.5 X 11 in).

Layout	A Paper Print Size
Borderless	8.5x11"
Bordered	8x10"
2 per Page	5x7"
3 per Page	4x6"
4 per Page	3.5x5"
9 per Page	2.5x3.25 (wallet)

In addition to US Letter size paper, your EasyShare AiO provides photo layout support the following of US and ISO 216 paper sizes. US sizes are measured in inches and ISO 216 sizes are based on the metric system.

US photo paper sizes

- 3.5 X 5 inches
- 4 X 6 inches
- 5 X 7 inches
- 8 X 10 inches

ISO 216 paper sizes

- A4 (21 X 30 centimeters)
- A5 (15 X 21 centimeters)
- A6 (10 X 15 centimeters)
- B5 (17.6 X 25 centimeters)

The international paper size standard, ISO 216, consists of an A series and a less common B series. This standard has been adopted by all countries in the world except the United States and Canada. The most widely used size in the ISO format is A4.

The charts on the following pages compare the most common paper sizes.

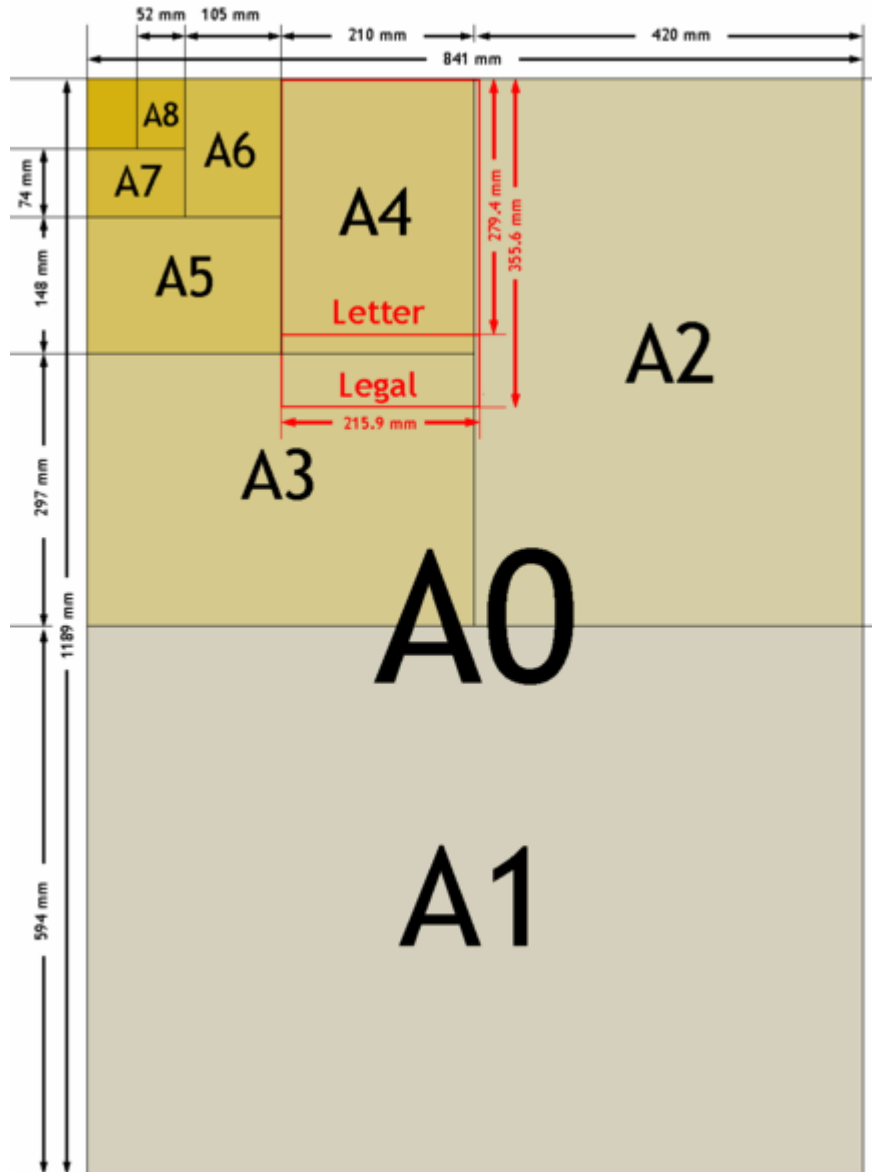

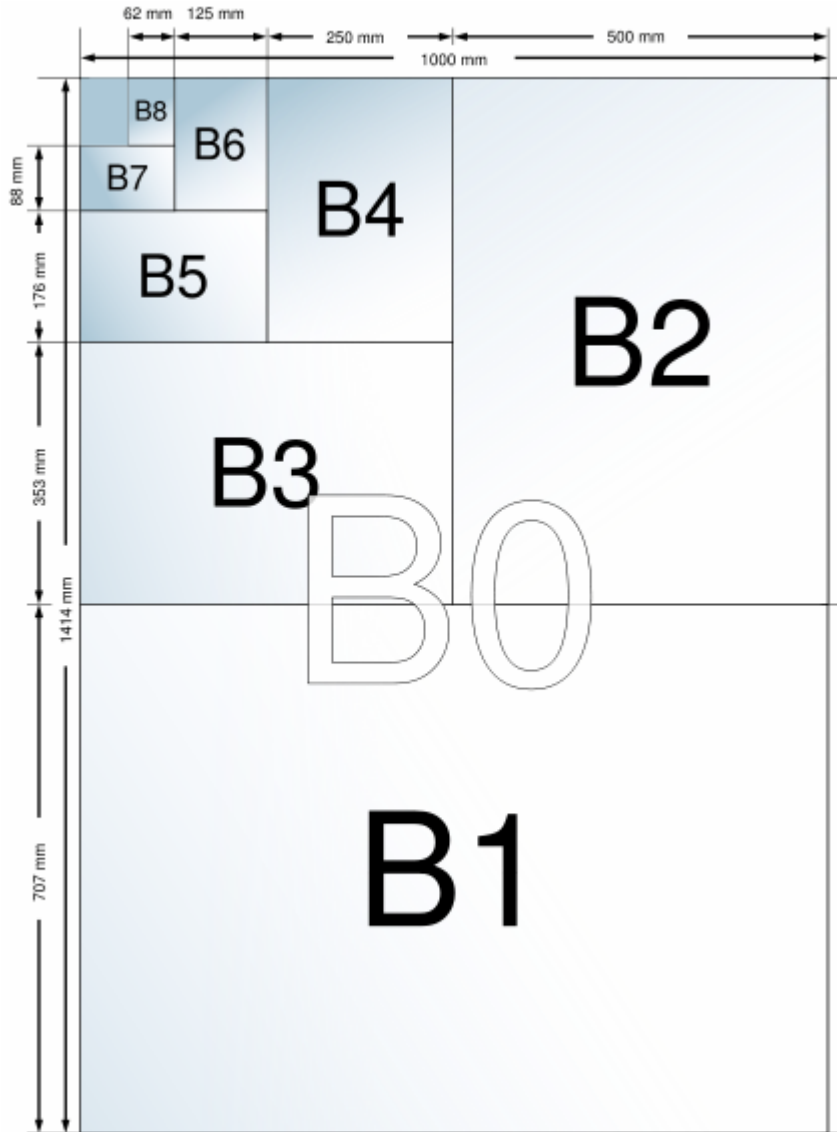

Set Print Layout

- 1 Press **Photo**. The Print menu is displayed with **Layout** selected.
- 2 Press ◀ or ▶ to change the print layout.
- 3 Press **OK** to set the selected layout and continue to set options, press **Photo** to preview, or **Start** to print.

3.5x5 Inch Paper



1 per page borderless

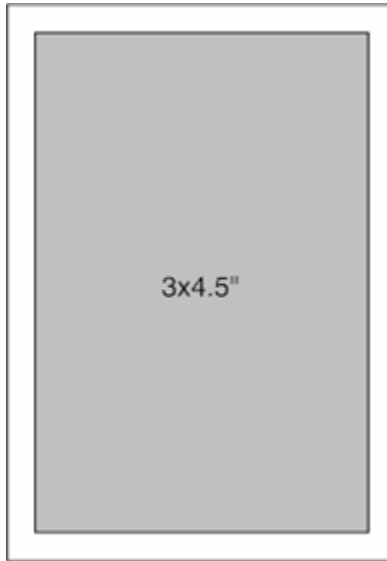

1 per page bordered

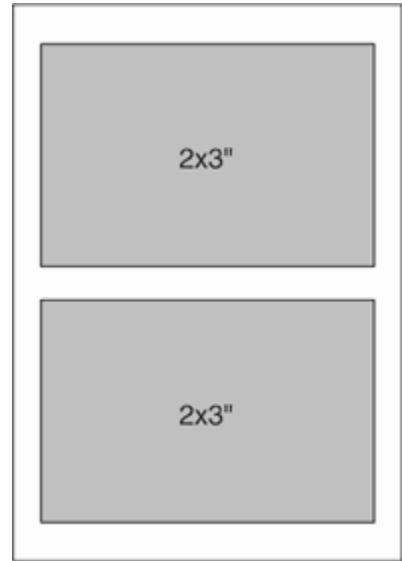

2 per page

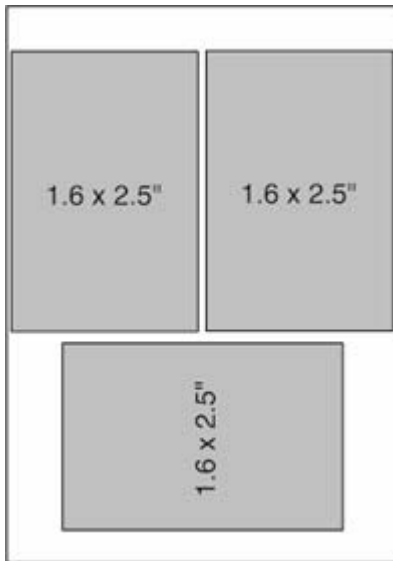

3 per page

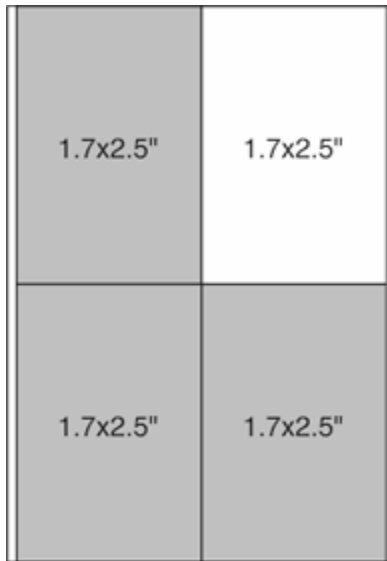

4 per page

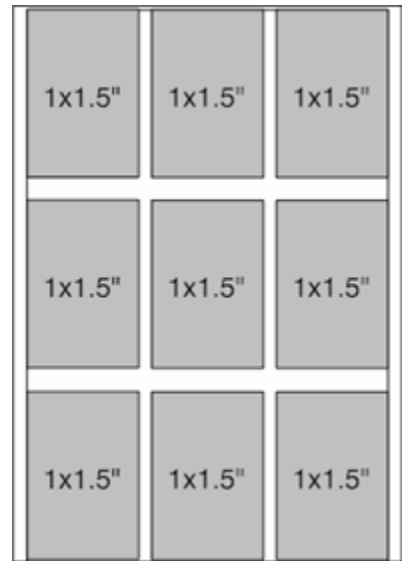

9 per page

4x6 Inch Paper

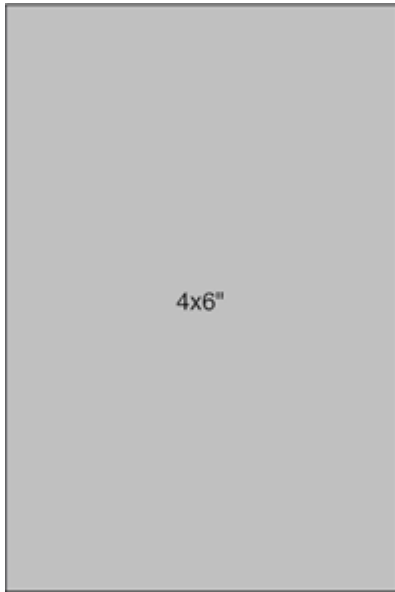

1 per page borderless

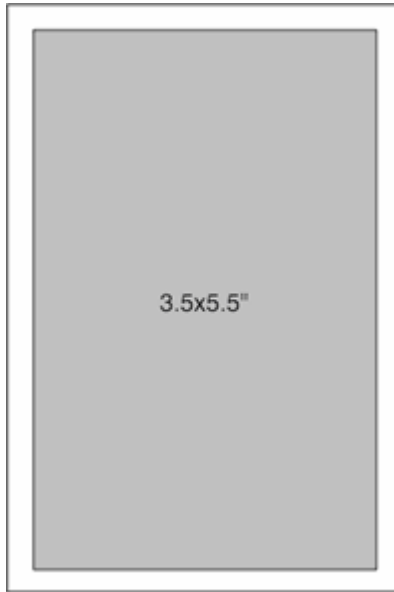

1 per page bordered

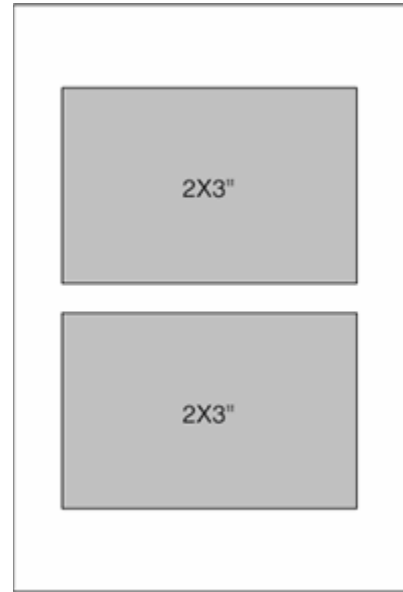

2 per page

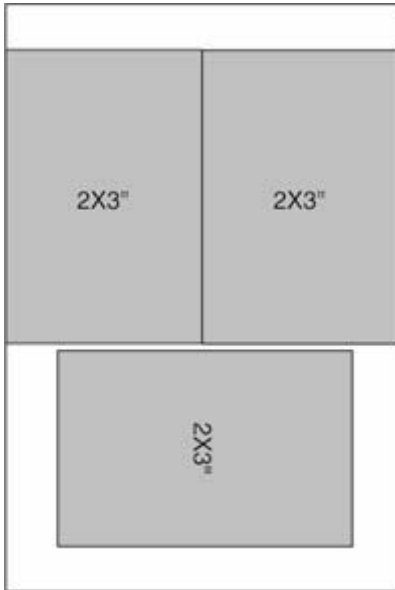

3 per page

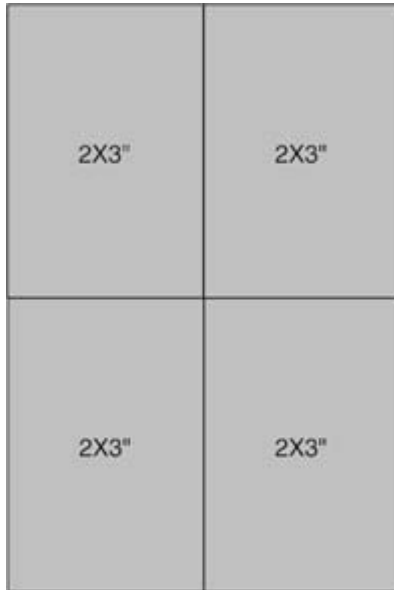

4 per page

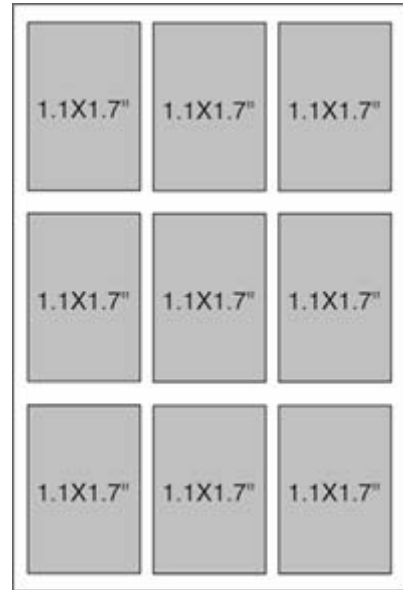

9 per page

5x7 Inch Paper



1 per page borderless

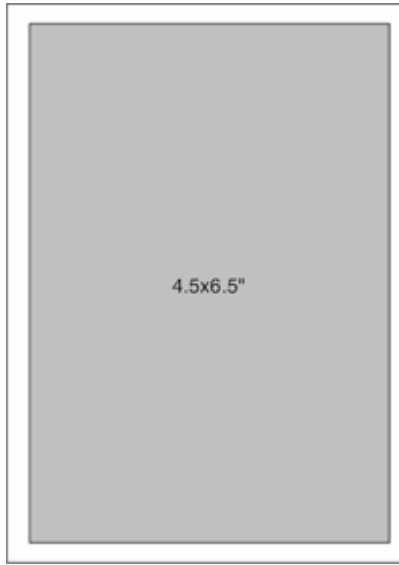

1 per page bordered



2 per page

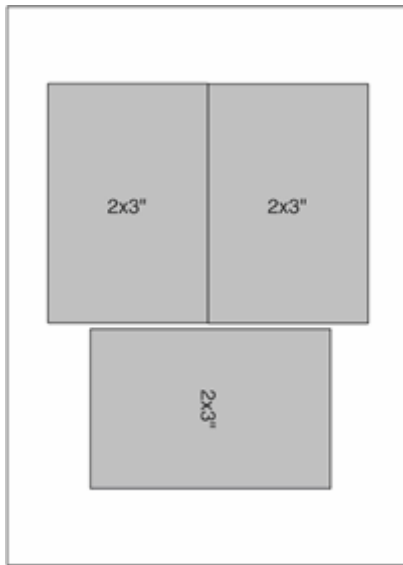

3 per page

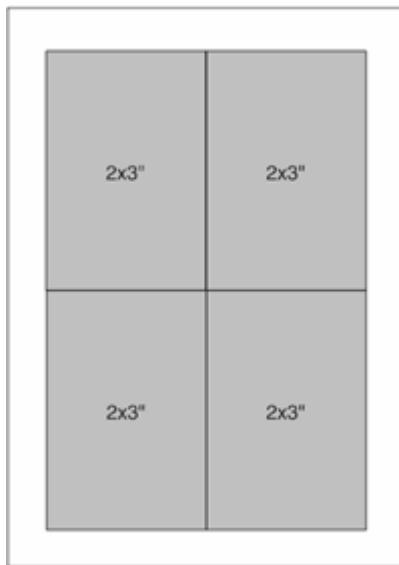

4 per page



9 per page

8x10 Inch Paper

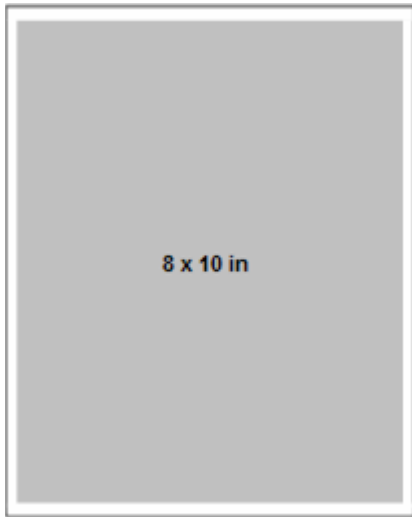

1 per page borderless

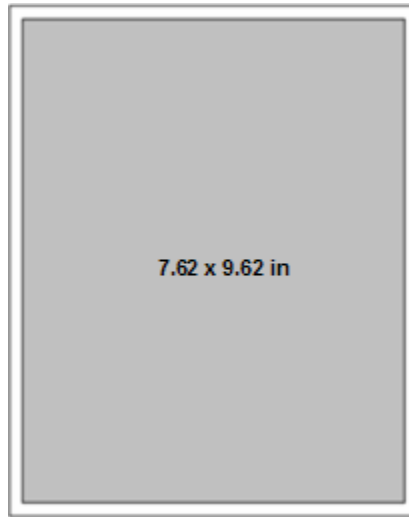

1 per page bordered

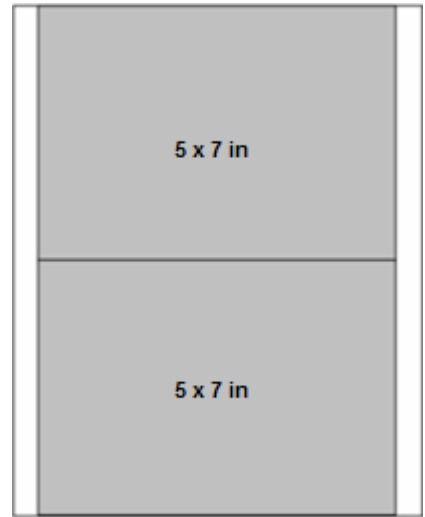

2 per page

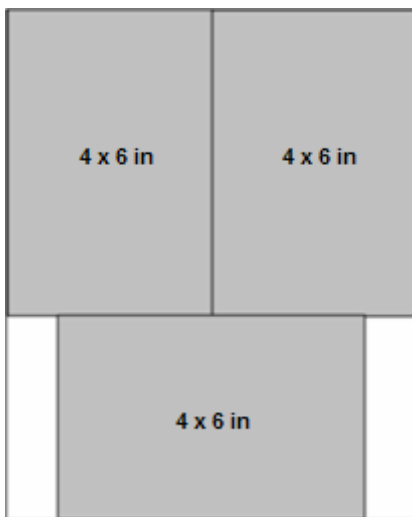

3 per page

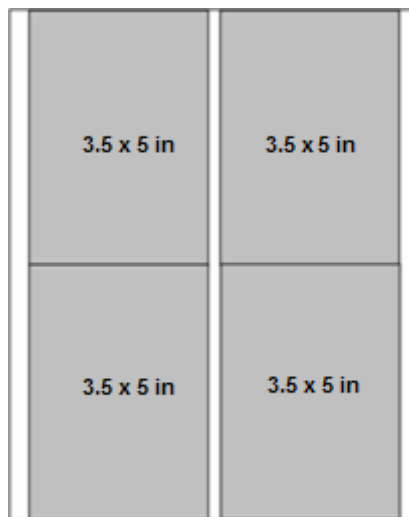

4 per page

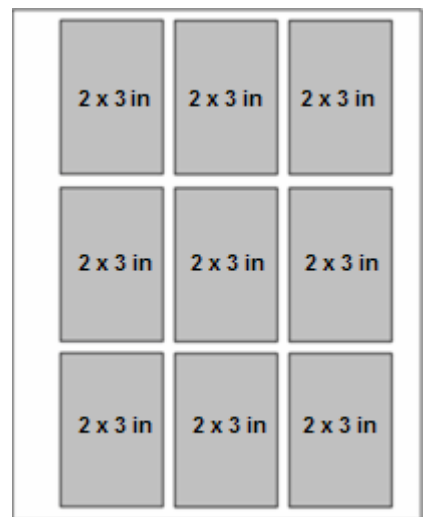

9 per page

US Letter

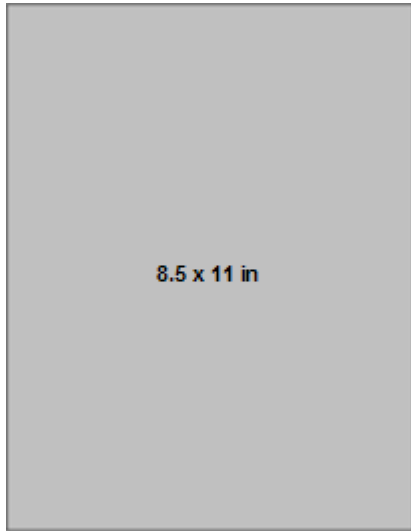

1 per page borderless

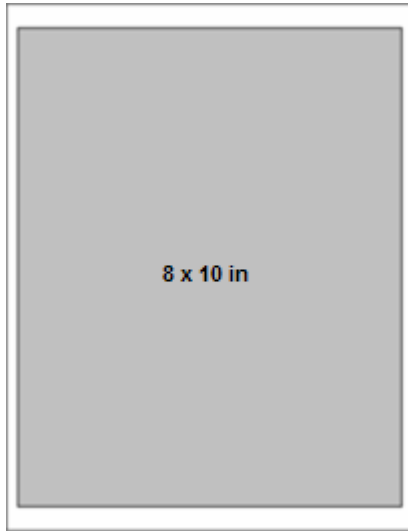

1 per page bordered

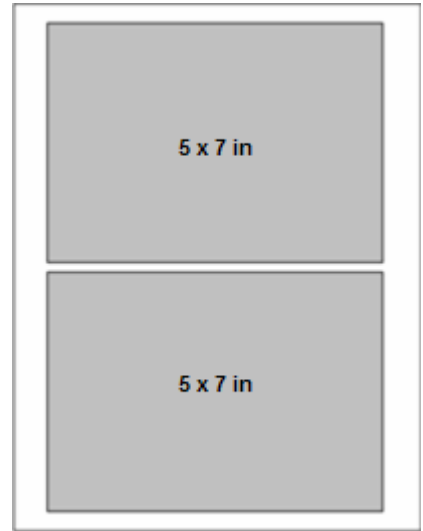

2 per page

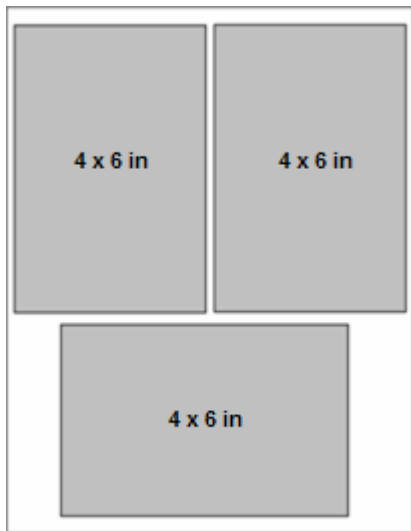

3 per page

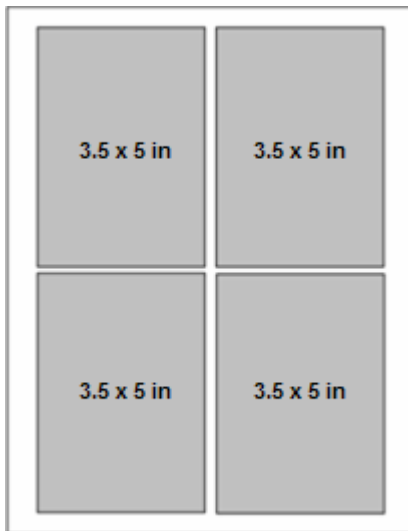

4 per page



9 per page

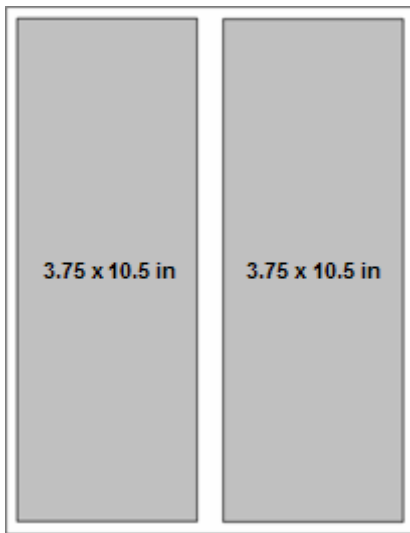

Panoramic

A4 Paper



1 per page borderless



1 per page bordered

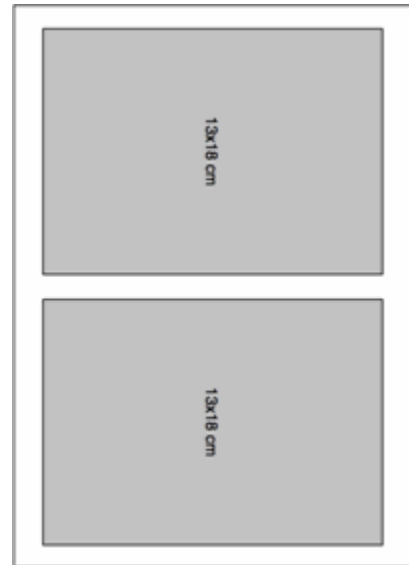

2 per page

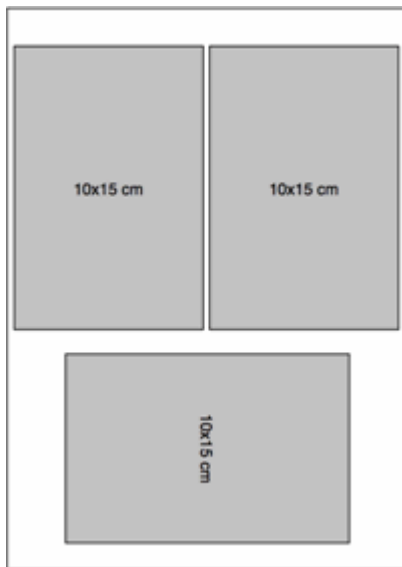

3 per page

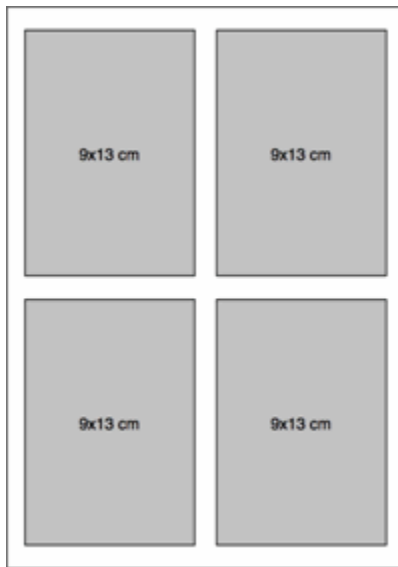

4 per page



9 per page

A5 Paper

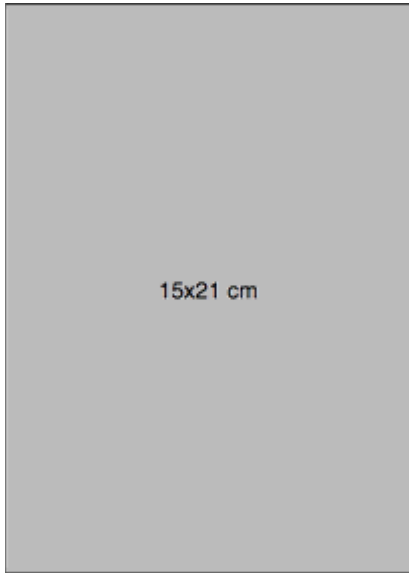

1 per page borderless

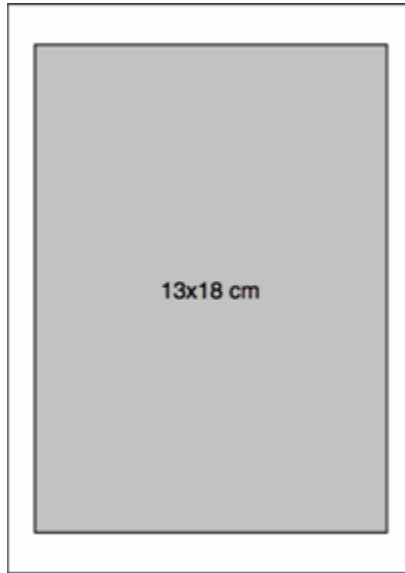

1 per page bordered

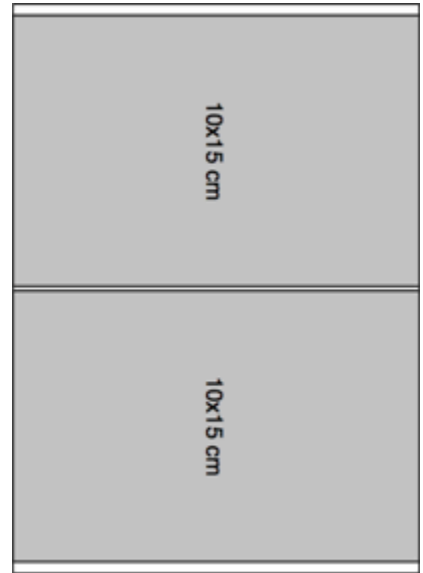

2 per page

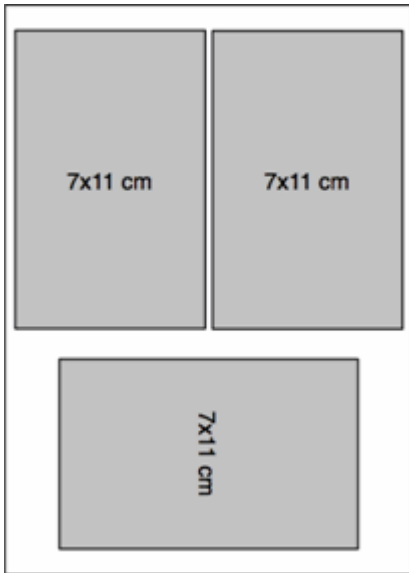

3 per page

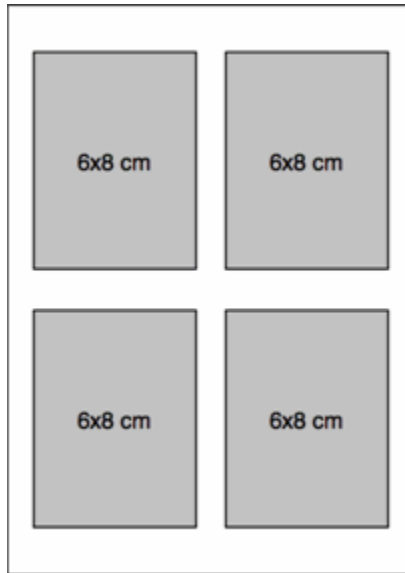

4 per page

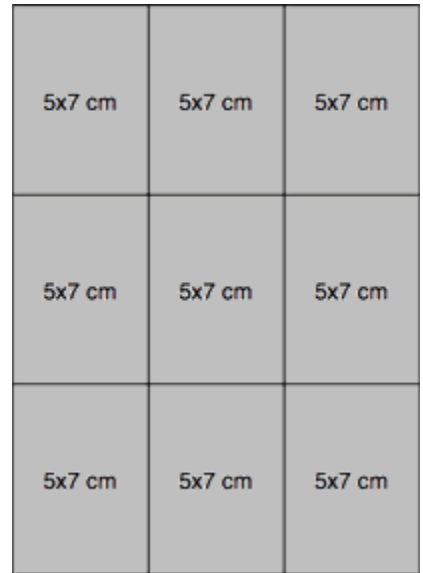

9 per page

A6 Paper

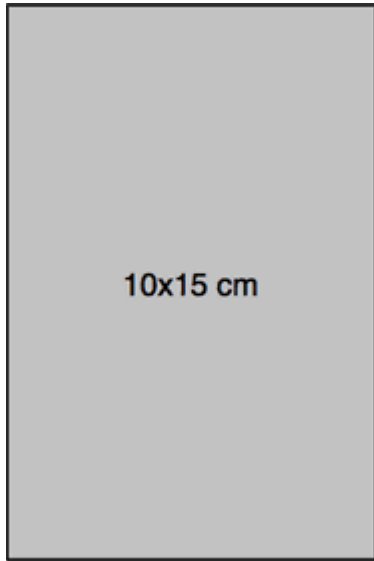

1 per page borderless

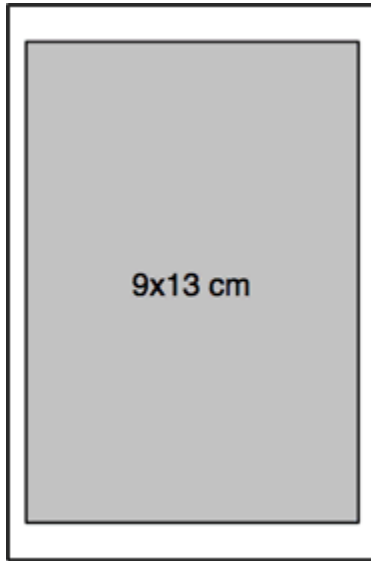

1 per page bordered

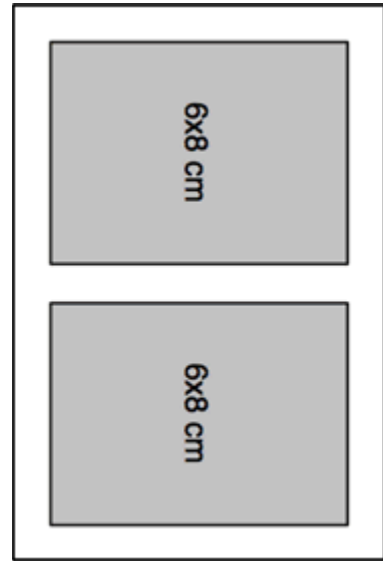

2 per page

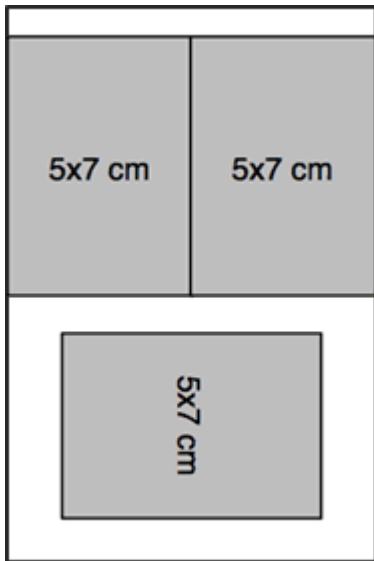

3 per page

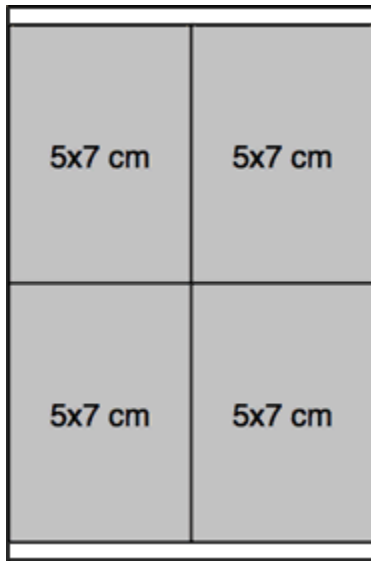

4 per page

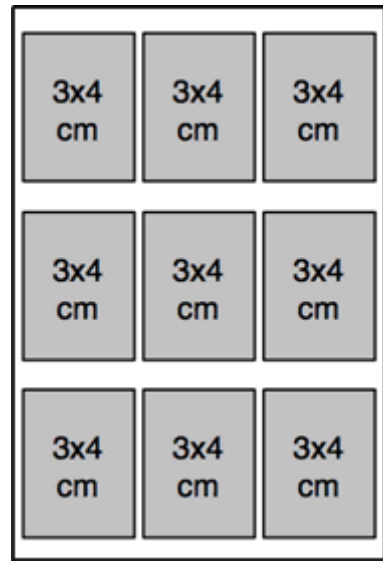

9 per page

B5 Paper

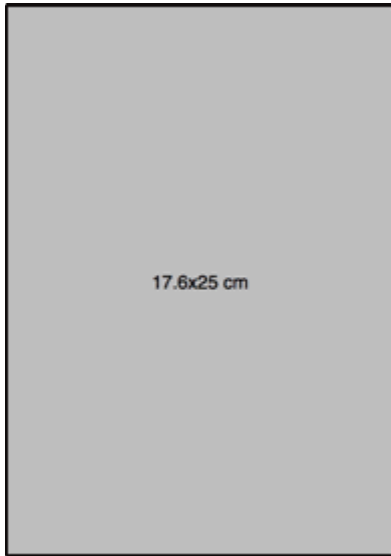

1 per page borderless

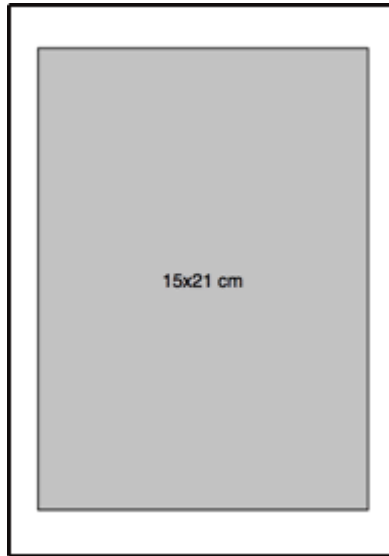

1 per page bordered

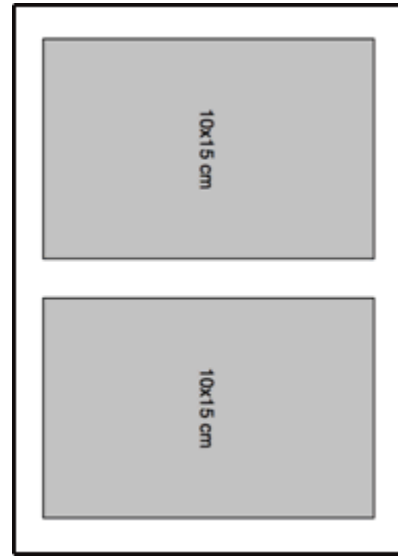

2 per page

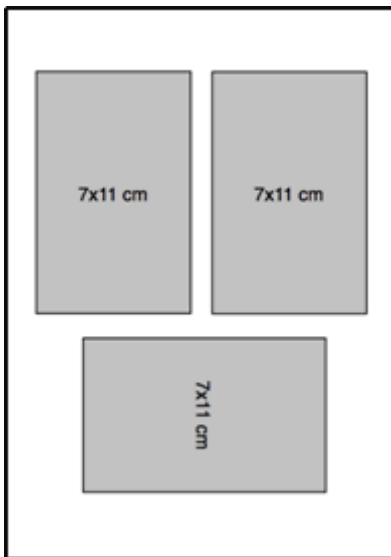

3 per page

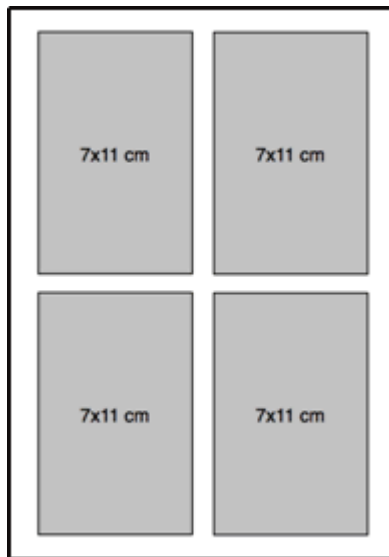

4 per page

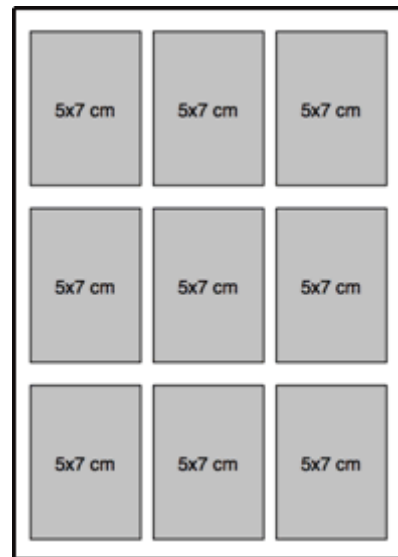

9 per page

Setting Print Options

Before you print photos you may want to change the following default settings.

- Layout: Borderless
- Quantity: 1 print
- Color: Color print
- Quality: Normal
- Save Settings: No

The Photo Print menu contains parameters that allow you to specify other options.

Set Number of Prints

You can increase the number of prints of each photo from the Photo Print menu. The default is 1 print.

- 1 On the Print menu, select **Quantity**.
- 2 Press ◀ or ▶ to change the print quantity.
- 3 Press **OK** to set the selected layout and continue to set options, press **Photo** to preview, or **Start** to print.

Set Color

You can print in color or black-and-white. Printing in color is the default.

- 1 On the Print menu, select **Color**.
- 2 Press ◀ or ▶ to change the print color.
- 3 Press **OK** to set the selected layout and continue to set options, press **Photo** to preview, or **Start** to print.

Set Print Quality

The Kodak EasyShare All-in-One provides three options that affect print speed and quality for plain paper. Print quality is automatically set to Kodak Picture Quality when photo paper is detected.

Draft Produces the fastest print speed, but the lowest quality.

Normal Delivers high-quality output and is the default setting. Normal prints faster than Best.

Best Produces the highest quality for all paper and eliminates the banding (striping) effect that sometimes occurs in solid areas. Best is the slowest print speed.

- 1 On the Print menu, select **Quality**.
- 2 Press ◀ or ▶ to change the print quality.
- 3 Press **OK** to set the selected layout and continue to set options, press **Photo** to preview, or **Start** to print.

Save Settings

When you change print settings from the control panel, the settings apply only to the current print job. To apply print settings to all future print jobs, you can save the changes you make.

- 1 On the Print menu, select **Save Settings**.
- 2 Press ◀ or ▶ to set to **Yes**.
- 3 Press **Photo** to preview, or **Start** to print.

Previewing Photos

The Print Preview screen contains a crop box, displays the current photo number on the card or USB host device, and the total number of photos on the card or device. It displays a checkbox indicating whether or not the currently displayed photo has been selected for printing. A checkmark is placed in the checkbox when the photo is selected along with the number of copies to be printed. All photos selected are given the number of copies specified in the Quantity parameter on the Print menu by default. For example, if the Quantity parameter is set to 2, all selected photos are initially be given a number-to-print value of 2.

Additionally, the Print Preview screen displays an icon of a printer and the total number of photos to be printed. For example if you select two photos, each set to print 2 copies, the number next to the printer icon will be 4.

For every card/USB host session, a message is displayed the first time a photo is displayed instructing you to press ◀ and ▶ to view the photos and to press **OK** to select the photo for printing.

For every card/USB host session, a message is displayed the first time you select a photo for printing, instructing you to use ▲ and ▼ to change the number of photos to print.

Preview Mode

Preview mode allows you to select and edit photos for printing. If you press the **Start** button while in Preview mode, all the selected photos are printed. If there are no photos selected, then the photo displayed is printed. Print preview mode is entered when you insert a memory card, connect a camera or mass storage device, or from Print mode by pressing **Photo**.

The Preview screen displays the current photo inside a crop box. The crop box aspect ratio is 1.4:1.

At the bottom of the screen, the current photo number on the card or USB host device, and the total number of photos is displayed. A checkbox indicates whether or not the currently displayed photo has been selected for printing. A checkmark is displayed in the checkbox if the photo has been selected along with the number of copies to be printed to the left of the checkbox. All photos selected are given the number of copies specified in the Quantity parameter on the Print menu by default. For example, if the Quantity parameter is set to 2, all selected photos are initially given a number-to-print value of 2.

Additionally, the Print Preview screen displays an icon of a printer and the total number of photos to be printed. For example if you select 2 photos, each set to print 2 copies, the number next to the printer icon will be 4.

IMPORTANT: Crop, zoom, and quantity are per image, but layout is global, applying to all images.



Zoom Photos

- 1 Insert a memory card into the appropriate slot, a mass storage device into the USB port, or connect a digital camera to the USB port. The first photo is displayed.



- 2 Press **Zoom +** to enlarge the photo in .25X increments up to 5X magnification. Pressing **Zoom -** decreases magnification in .25X increments down to 1X.



- 3 Use the **4-way Navigation** button to display the part of the picture you want to print.



- 4 Press **OK** when finished. The photo is displayed with a crop box around the magnification and position you selected.



- 5 Press **▲** to select the number of prints, and press **Start** to print the area displayed in the crop box.

Multiview

The Multiview screen shows thumbnails of nine photos. The current photo number and the total photo number are also displayed.

- 1 Insert a memory card into the appropriate slot, a mass storage device into the USB port, or connect a digital camera to the USB port. The last photo is displayed.



- 2 Press **Zoom -** to enter Multiview. The current photo is indicated by a red selection box.



- 3 Use the **4-way Navigation** button to move the red selection box to another photo. Pressing **▶** when in the rightmost column displays the next Multiview screen. Pressing **◀** when in the leftmost column displays the previous Multiview screen.

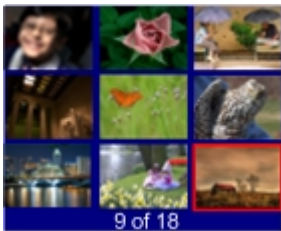

- 4 Press **OK** to preview the selected photo



- 5 Press **Start** to print.

5 Copy

The Kodak EasyShare AiO allows you to produce high-quality color and black-and-white copies on a variety of paper types, including transparencies. Once copying has started, you may at any time abort a copy operation by pressing the **Cancel** button.

Copy with Control Panel

Pressing **Copy** displays the copy menu where you can set copy options, preview copies after scanning, and make copies.

When copying from the Control Panel, you can choose from the following outputs.

Same Size: The copy is the same size as the original. Cropping will occur if the original is larger than the paper size. The copy will contain white space if the original is smaller than the paper size. Same Size is the default copy setting.

Fit to Page: The image is copied and fit to the paper size loaded. There may be cropping on the sides or top/bottom depending on the difference in the aspect ratios of the image and the page size.

Scale Percent: The default copy scale is 100%, however you can scale copies from 10% to 500%. Scaling is anchored to the upper left corner of the original.

Photo Layouts: You can set the layout for making copies of photos on your Kodak EasyShare All-in-One. The following layouts are supported.

- Borderless (default)
- Bordered
- 2 per Page
- 3 per Page
- 4 per Page
- 9 per Page
- 2x2 Poster
- 3x3 Poster
- 4x4 Poster

Same Size Copy

The copy is the same size as the original and is the default copy setting. Cropping will occur if the original is larger than the paper size. The copy will contain white space if the original is smaller than the paper size.

- 1 Load your original face down on the right front corner of the scanner glass.

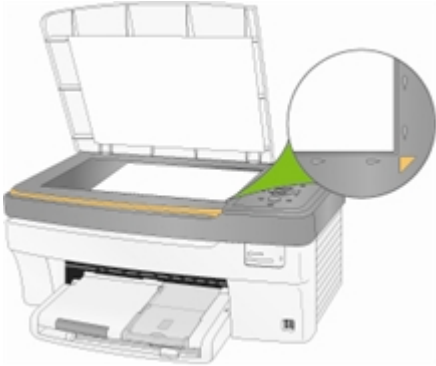

- 2 Press **Copy** to display the Copy menu.
- 3 Press **▼** to select **Output**.
- 4 Press **◀** or **▶** to select **Same Size**.
- 5 If desired, make changes to the following copy options with the Copy menu.
 - See *Set Number of Copies*
 - See *Set Color*
 - See *Set Quality*
 - See *Change Brightness*
 - See *Set Preview*
- 6 Press **Start**. If you turned preview on, the EasyShare AiO enters Preview mode, otherwise it starts making copies.

Fit to Page Copy

The image is copied and fit to the paper size loaded. There may be cropping on the sides or top/bottom depending on the difference in the aspect ratios of the image and the page size.

- 1 Place your original face down on the right front corner of the scanner glass.

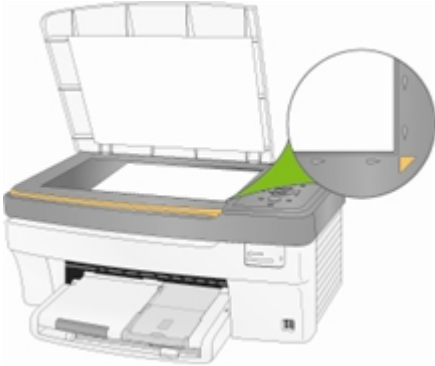

- 2 Press **Copy** to display the Copy menu.
- 3 Press ▼ to select **Output**.
- 4 Press ◀ or ▶ to select **Fit to Page**.
- 5 If desired, make changes to the following copy options with the Copy menu.
 - See *Set Number of Copies*
 - See *Set Color*
 - See *Set Quality*
 - See *Change Brightness*
 - See *Set Preview*
- 6 Press **Start**. If you turned preview on, the EasyShare AiO enters Preview mode, otherwise it starts making copies.

Scale Percent Copy

The default copy scale is 100%, however you can scale copies from 10% to 500%. Scaling is anchored to the upper left corner of the original.

- 1 Place your original face down on the right front corner of the scanner glass.

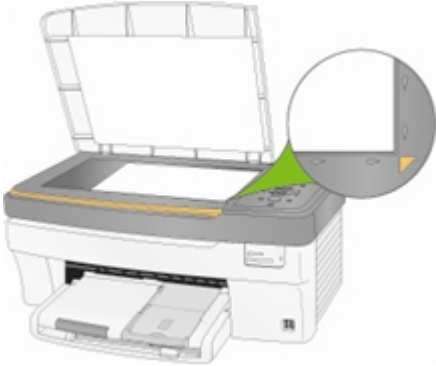

- 2 Press **Copy** to display the Copy menu.
- 3 Press ▼ to select **Output**.
- 4 Press ◀ or ▶ to select **Scale Percent**.
- 5 Press ▼ to select **Size**.
- 6 Press ◀ or ▶ to change the scaling.
- 7 If desired, make changes to the following copy options with the Copy menu.
 - See *Set Number of Copies*
 - See *Set Color*
 - See *Set Quality*
 - See *Change Brightness*
 - See *Set Preview*
- 8 Press **Start**. If you turned preview on, the EasyShare AiO enters Preview mode, otherwise it starts making copies.

Photo Layout Copy

You can set the layout for making copies of photos on your Kodak EasyShare All-in-One. The following layouts are supported.

Borderless (default)

Bordered

2 per Page

3 per Page

4 per Page

9 per Page

2x2 Poster

3x3 Poster

4x4 Poster

- 1 Place your original face down on the right front corner of the scanner glass.

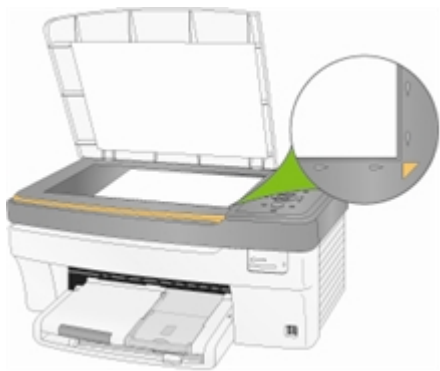

- 2 Press **Copy** to display the Copy menu.
- 3 Press **▼** to select **Output**.
- 4 Press **◀** or **▶** to select **Photo Layouts**.
- 5 Press **▼** to select **Size**.
- 6 Press **◀** or **▶** to change the layout.
- 7 If desired, make changes to the following copy options with the Copy menu.
 - See *Set Number of Copies*
 - See *Set Quality*
 - See *Change Brightness*
 - See *Set Preview*
- 8 Press **Start**. If you turned preview on, the EasyShare AiO enters Preview mode, otherwise it starts making copies.

Setting Copy Options

You can set the following copy options with the Control Panel Copy menu.

- Quantity
- Color
- Quality
- Output/Size (See *Same Size Copy*, *Fit to Page Copy*, *Scale Percent Copy*, or *Photo Layout Copy*)
- Brightness
- Preview
- Save Settings

Set Number of Copies

You can set the number of copies to make from the copy menu. The default is 1 copy.

- 1 On the Copy menu, select **Quantity**.
- 2 Press or hold ◀ or ▶ to change the number of copies you want to make.
- 3 Press **OK** to set and continue setting options, or **Start** to copy.

Set Color

You can make copies of documents in color or black-and-white. The default is color.

- 1 On the Copy menu, press ▼ to select **Color**.
- 2 Press ◀ or ▶ to change the copy color.
- 3 Press **OK** to set and continue setting options, or **Start** to copy.

Set Quality

Kodak picture quality is automatically selected when photo paper is detected in the main or photo input trays.

The Kodak EasyShare All-in-One provides three options that affect speed and quality for copying documents to plain paper.

Best Produces the highest quality for all paper and eliminates the banding (striping) effect that sometimes occurs in solid areas.

Normal Delivers high-quality output and is the default setting. Normal copies faster than Best.

Draft Produces the fastest copy speed, but the lowest quality.

- 1 On the Copy menu, press ▼ until **Quality** is selected.
- 2 Press ◀ or ▶ to change the copy quality.
- 3 Press **OK** to set and continue setting options, or **Start** to copy.

Change Brightness

You can change the brightness of copies with -3 being the darkest and +3 the lightest.

- 1 If the Copy menu is not displayed, press **Copy**.
- 2 Press ▼ until **Brightness** is selected.
- 3 Press ◀ to darken or ▶ to lighten.
- 4 Press **OK** to set and continue setting options, or **Start** to copy.

Set Preview

Copy Preview allows you to preview your originals before making copies. The Copy Preview screen shows the scanned image that you can zoom or crop (see *Zoom and Crop*).

- 1 On the Copy menu, press ▼ until **Preview** is selected.
- 2 Press ◀ or ▶ to enable or disable **Preview**.
- 3 Press **OK** to set and continue setting options, or **Start** to copy.

Save Copy Settings

When you change copy settings from the control panel, the settings apply only to the current copy job. To apply copy settings to all future copy jobs, you can save the setting changes.

- 1 If the Copy menu is not displayed, press **Copy**.
- 2 Press ▼ until **Save Settings** is selected.
- 3 Press ◀ or ▶ to set save copy settings to **Yes**.

Previewing Copies

Previewing Copies

Copy Preview mode is entered when the following conditions exist.

- The EasyShare AiO is in Copy mode.
- Preview is set to **Yes**.
- The **Start** button is pressed.

The Copy Preview feature can be used for photos or documents.

Zoom and Crop

To zoom and crop a photo before making a copy you must be in Preview mode (see Turning Copy Preview On).

- 1 With **Preview** set to **Yes** on the Copy menu, press **Start** to enter Preview mode. The photo on the glass is scanned and displayed with a crop box.

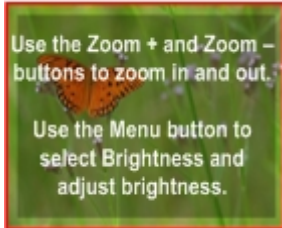

- 2 Press **Zoom +** to enlarge the photo in .25X increments up to 5X magnification. Pressing **Zoom -** decreases magnification in .25X increments down to 1X.



- 3 Use the **4-way Navigation** button to display the part of the picture you want to copy.



- 4 Press **OK** or **Start** to copy.

6 Scan

You can start a scan from the Kodak AiO Control Panel or your computer.

Scan with Control Panel

Pressing **Scan** places the Kodak EasyShare AiO in Scan mode and displays the Scan menu on the screen.

Save Scan Settings

When you change scan settings from the control panel, the settings apply only to the current scan job. To apply scan settings to all future scan jobs, you can save your changes.

- 1 Press **Scan** to display the Scan menu.
- 2 Change the desired Scan settings.
- 3 Press **▼** until **Save Settings** is selected.
- 4 Press **◀** or **▶** to set save scan settings to **Yes**.

Scanning Photos

With the Control Panel Scan menu, you can scan photos to a file, application, or memory card.

Scan to File

- 1 Place a photo or photos face down on the scanner glass.
- 2 Press **Scan** to display the Scan menu.
- 3 Press **◀** or **▶** to select **Photo**.
- 4 Press **▼** until **Scan To** is selected.
- 5 Press **◀** or **▶** to select **File**.
- 6 Press **Start**.

The photo is scanned and saved based on the Kodak AiO Home Center scan picture settings (see *Scan Picture Settings*).

Scan to Application

The Home Center software enables you to maintain a list of scan destination applications.

- 1 Place a photo or photos face down on the scanner glass.
- 2 Press **Scan** to display the Scan menu.
- 3 Press ◀ or ▶ to select **Photo**.
- 4 Press ▼ to select **Scan To**.
- 5 Press ▶ to select **Application**.
- 6 Press ▼ to until **Application** is selected.
- 7 Press ◀ or ▶ to select another application.
- 8 Press **Start**.

Scan to Memory Card

- 1 Insert a Memory Card into the appropriate card slot.



WARNING:

Never attempt to remove a memory card while it is being accessed. Doing so can damage files on the card. You can safely remove a card only when the status light next to the slots is not blinking.

- 2 Place a photo or photos face down on the scanner glass.
- 3 Press **Scan** to display the Scan menu.
- 4 Press ◀ or ▶ to select **Photo**.
- 5 Press ▼ to select **Scan To**.
- 6 Press ◀ or ▶ to select **Memory Card**.
- 7 Press **Start**.

Scanning Documents

With the Control Panel Scan menu, you can scan documents to a file, application, or memory card.

Scan to File

- 1 Load your original face down on the right front corner of the scanner glass.

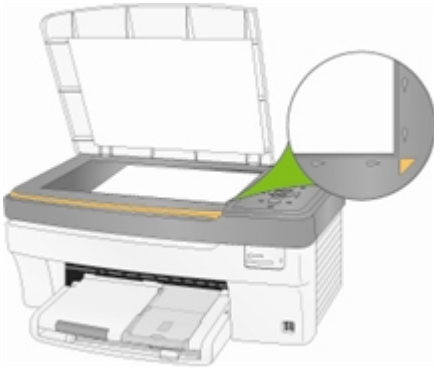

- 2 Press **Scan** to display the Scan menu.
- 3 Press ◀ or ▶ to select **Document**.
- 4 Press **Start**.

The document is scanned and saved based on the Kodak AiO Home Center scan document settings (see *Scan Document Settings*).

Scan to Application

- 1 Load your original face down on the right front corner of the scanner glass.

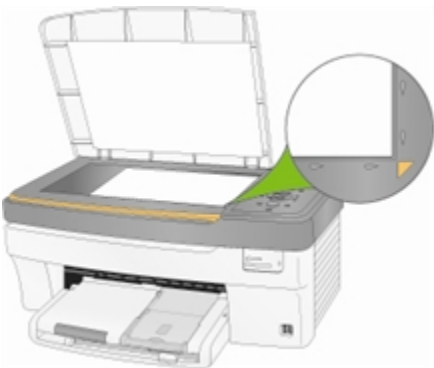

- 2 Press **Scan** to display the Scan menu.
- 3 Press ◀ or ▶ to select **Document**.
- 4 Press ▼ to select **Scan To**.
- 5 Press ◀ or ▶ to select **Application**.
- 6 Press ▼ to until **Application** is selected.
- 7 Press ◀ or ▶ to select another application.
- 8 Press **Start**.

Scan to Memory Card

- 1 Insert a Memory Card into the appropriate card slot.



WARNING:

Never attempt to remove a memory card while it is being accessed. Doing so can damage files on the card. You can safely remove a card only when the status light next to the slots is not blinking.

- 2 Load your original face down on the right front corner of the scanner glass.

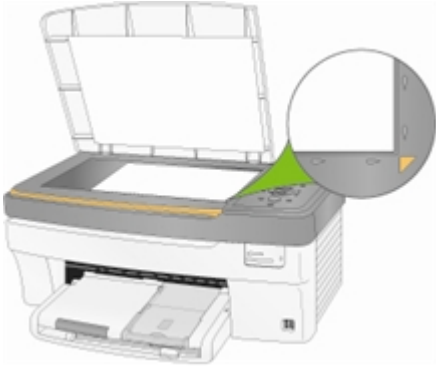

- 3 Press **Scan** to display the Scan menu.
- 4 Press ◀ or ▶ to select **Document**.
- 5 Press ▼ to select **Scan To**.
- 6 Press ◀ or ▶ to select **Memory Card**.
- 7 Press **Start**.

7 Maintenance

The Kodak EasyShare All-in-One requires little maintenance. However, you should clean the glass and lid backing to remove dust and fingerprints.

Fingerprints and other debris on the glass or lid backing could slow down performance and affect the accuracy of scanning.

This section covers the Settings menu, printhead installation, printhead calibration, checking ink levels, and changing ink cartridges.

General Care

IMPORTANT: *Always disconnect the power before cleaning. Do not use harsh or abrasive cleaners or organic solvents on the EasyShare AiO or any of its parts.*



WARNING:

Do not leave items on the scanner glass. The heat of the scanning lamp may cause them to stick.

- To clean, wipe the outside of the EasyShare AiO and LCD with a clean, dry cloth.
- Keep the surrounding area vacuumed and litter-free.
- Protect the EasyShare AiO from tobacco smoke, dust, sand, and liquid spills.
- Avoid placing objects on the EasyShare AiO.
- Keep the EasyShare AiO, accessories, and supplies away from direct sunlight and out of high-temperature environments.
- Do not allow chemicals, such as suntan lotion, to come into contact with the painted surface of the EasyShare AiO.
- If the EasyShare AiO has been subjected to inclement weather or you suspect water has gotten inside the EasyShare AiO, turn it off and let it dry out. If this does not resolve the problem, contact customer support (see *Telephone Customer Support*).
- Service agreements are available in some countries. Contact a dealer of Kodak products for more information.
- For more disposal or recycling information, contact your local authorities. In the US, visit the Electronics Industry Alliance Web site at www.eiae.org.

Clean the Scanner Glass

To ensure that your copies and scans remain clear, keep the scanner glass and lid backing clean and dust the exterior.

- 1 Turn off the EasyShare AiO and raise the lid.
- 2 Clean the glass with a soft cloth or sponge slightly moistened with a nonabrasive glass cleaner.



WARNING:

Do not use abrasives, acetone, benzene, or carbon tetrachloride on the glass, since they can damage it. Do not place or spray liquid directly on the glass. The liquid might seep under the glass and damage the device.

- 3 Dry the glass with a lint free cloth.

Clean the Scanner Lid

Minor debris can accumulate on the document backing located underneath the scanner lid of the Kodak EasyShare AiO.

- 1 Turn off the EasyShare AiO and raise the lid.
- 2 Clean the lid underside with a soft cloth or sponge slightly moistened with a mild soap and warm water.
- 3 Wipe the underside gently to loosen debris. Do not scrub.
- 4 Dry the underside with a chamois or soft cloth.



WARNING

Do not use paper-based wipes, as these might scratch the underside.

- 5 If further cleaning is needed, repeat the previous steps using isopropyl (rubbing) alcohol, and wipe the underside thoroughly with a damp cloth to remove any residual alcohol.

Format Memory Card

Formatting will erase all the data on a memory card.

- 1 Insert a memory card into the appropriate slot.
- 2 Press **Menu**.
- 3 Press **▼** until **Format Memory Card** is selected.
- 4 Press **OK**.
- 5 Press **Start** to begin formatting.

Print Diagnostic Sheet

The Diagnostic Page contains information about your printer that can be useful when contacting Kodak support.

- 1 Press **Menu**.
- 2 Press **▼** until **Print Diagnostic Sheet** is selected.
- 3 Press **OK**.

- 4 Press **Start** to begin printing.

Firmware Upgrade

You can update the firmware in your EasyShare AiO with the most recent available from the Home Center software. This requires an internet connection.

- 1 Click the Help button  to open the Help panel.
- 2 Under **General Links**, click **Maintenance**.
- 3 Click **Firmware Upgrade**.

Ink Cartridges

Your Kodak EasyShare AiO uses separate black and color ink cartridges. The ink levels are displayed on the Control Panel and the printer software. Generic or non-Kodak ink cartridges may not function in the KODAK EASYSHARE All-in-One Printer. Kodak recommends using Kodak ink cartridges.

Check Ink Levels

You can easily check the ink levels to determine how soon you might need to replace an ink cartridge. The ink level supply screen shows the amount of ink remaining in the ink tanks.

- 1 Press **Menu** to display the main menu.
- 2 Press **▼** until **Ink Levels** is selected.
- 3 Press **OK** to display the Ink Levels screen.



The Ink Levels screen shows ink levels in a vertical gauge format with one gauge for the Black Ink cartridge and one gauge for the Color Ink cartridge.

Replace Ink Cartridges

A Low Ink warning message is displayed when one of the ink levels drops below 20 percent.

NOTE: For the best quality prints, store ink cartridges in a location where the temperature does not exceed 85° F (30° C).



WARNING:

Generic or non-Kodak ink cartridges may not function in the KODAK EASYSHARE All-in-One Printer. Kodak recommends using Kodak ink cartridges. Third party ink cartridges may not contain the necessary Smart Chip information to notify you before the ink cartridge is empty.

- 1 Open the printer access door by lifting from the front center of the unit. The ink tanks are located in the print head.

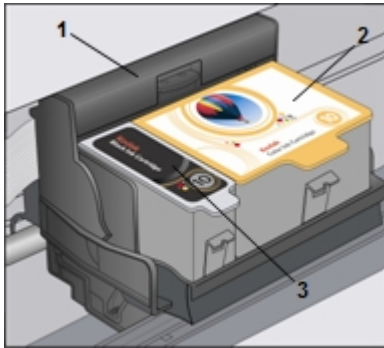

- 1 Print head
- 2 Color ink cartridge
- 3 Black ink cartridge

- 2 Wait until the printhead is idle and silent, then pinch the pinch latch on the old ink cartridge with your thumb and forefinger and lift it out of the print head.

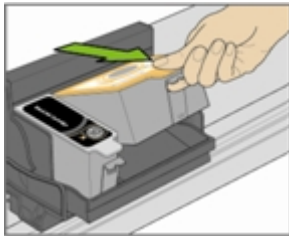

- 3 Open the box of the new ink cartridge.
- 4 Remove the bagged ink cartridge from the box and tear open the bag at the notch and remove the ink cartridge.

IMPORTANT: Insert the ink cartridge immediately to prevent any drying of the ink.



- 5 Remove the orange cap from the cartridge by grasping the top edge and pulling/rotating it off the ink cartridge.



- Slide the ink cartridge into the printhead.

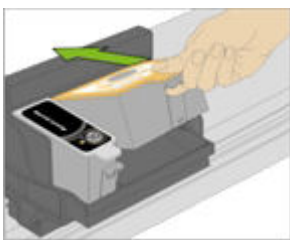

- Press down on the tab until you hear a click and feel the latch snap into position.

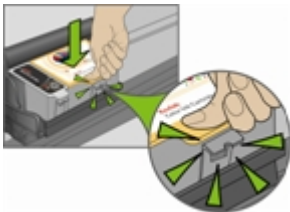

- Close the printer access door.

Printhead

The printhead dispenses the ink from the ink cartridges onto the paper. Printer maintenance involves:

- Calibration
- Clean the printhead

Calibration

The Kodak EasyShare AiO performs a calibration every time you install or replace a printhead. However, you can run a calibration if you are seeing changes in the image quality. Calibration aligns the printheads and performs a nozzle health check to enable high-quality prints.

To calibrate from computer

- Load the main tray or photo tray with photo paper.
 IMPORTANT: If you don't have any photo paper, you can use plain paper, but photo paper is highly recommended for calibrations.
- Start the AiO Home Center.
- Click  to open the Help panel.
- Under **General Links**, click **Maintenance**.
- Click **Calibration** to make a calibration print.
- Follow the instructions on the calibration print to calibrate the printer.

To calibrate from control panel

- 1 Load the main tray or photo tray with photo paper.
IMPORTANT: If you don't have any photo paper, you can use plain paper, but photo paper is highly recommended for calibrations.
- 2 Press **Menu**.
- 3 Press ▼ until **Calibrate Printer** is selected.
- 4 Press **OK**. A new screen appears with **Print Calibration Page** selected.
- 5 Press **Start** and follow the instructions on the LCD screen to complete the calibration.

Clean Printhead

If you notice a degradation in the quality of prints, the printhead may need cleaning.

To clean printhead from computer

- 1 Start the AiO Home Center.
- 2 Click  to open the Help panel.
- 3 Under **General Links**, click **Maintenance**.
- 4 Click **Printhead Cleaning**.

To clean printhead from control panel

- 1 Press **Menu** to display the Main Menu.
- 2 Press ▼ until **Clean Printhead** is selected.
- 3 Press **OK** to go to the Clean Printhead menu.
- 4 Press **OK** to perform a **Basic Clean**.
or
Press ▼ to select **Deep Clean** and press **OK** to perform a Deep Clean.

Replace Printhead

- 1 Make sure the EasyShare AiO is on.
- 2 Open the printer access door. The carriage moves to a center position.



- 3** Wait until the printhead is idle and silent, then pinch the pinch latch on the ink cartridge with your thumb and forefinger and lift it out of the print head. Remove both ink cartridges.

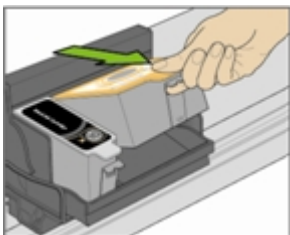

- 4** Unlatch the printhead by pressing the button in the upper-left corner of the carriage.

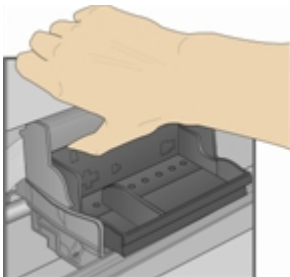

- 5** Remove the old printhead.

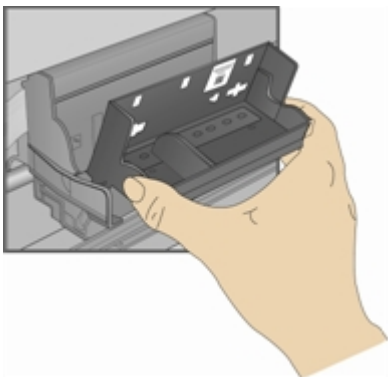

- 6** Remove the printhead from its bag.



- 7** Remove and discard the clear plastic casing and the orange protective cap.



- 8** Place the printhead into the carriage.

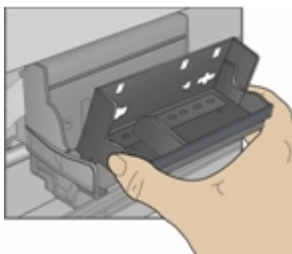

- 9** Push against the back wall of the printhead until it clicks into place.

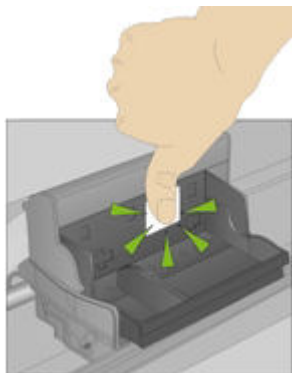

- 10** Reinstall the ink cartridges.

8

Support

If you have a problem with your AiO printer, refer to the Troubleshooting topics in this book. Additional technical information is available in the ReadMe file located on the Kodak EasyShare software CD. For online support, visit www.kodak.com/go/support.

Contact Kodak

Kodak	Resource Center	www.kodak.com/go/resourcecenter
Printer	Get support for your product (FAQs, troubleshooting information, etc.).	www.kodak.com/go/sfupport
	Purchase full range of digital camera and printer accessories.	www.kodak.com/go/accessories
	Download latest printer software, firmware and drivers.	www.kodak.com/go/downloads
	Online tutorials.	www.kodak.com/go/howto
Software	Get information on EasyShare software.	www.kodak.com/go/easysharesw (or click the Help button in the EasyShare software)
	Get help with the Windows operating system and working with digital pictures.	www.kodak.com/go/pcbasics
Other	Get support for Kodak printers, cameras, software, accessories, more. Print a Diagnostics Page before contacting Kodak support (see <i>Print Diagnostic Sheet</i> in the Maintenance chapter).	www.kodak.com/go/support
	Register your printer.	www.kodak.com/go/register

Limited Warranty

Kodak warrants Kodak consumer electronic products and accessories ("Products"), excluding batteries, to be free from malfunctions and defects in both materials and workmanship for one year from the date of purchase.

Retain the original dated sales receipt. Proof of the date of purchase will be required with any request for warranty repair.

Limited Warranty Coverage

Warranty service is only available from within the country where the Products were originally purchased. You may be required to ship Products, at your expense, to the authorized service facility for the country where the Products were purchased.

Kodak will repair or replace Products if they fail to function properly during the warranty period, subject to any conditions and/or limitations stated herein. Warranty service will include all labor as well as any necessary adjustments and/or replacement parts. If Kodak is unable to repair or replace a Product, Kodak will, at its option, refund the purchase price paid for the Product provided the Product has been returned to

Kodak along with proof of the purchase price paid. Repair, replacement, or refund of the purchase price are the sole remedies under this warranty.

If replacement parts are used in making repairs, those parts may be remanufactured, or may contain remanufactured materials. If it is necessary to replace the entire Product, it may be replaced with a remanufactured Product. Remanufactured Products, parts and materials are warranted for the remaining warranty term of the original Product, or 90 days after the date of repair or replacement, whichever is longer.

Limitations

This warranty does not cover circumstances beyond Kodak's control. This warranty does not apply when failure is due to shipping damage, accident, alteration, modification, unauthorized service, misuse, abuse, use with incompatible accessories or attachments (such as third party ink or ink tanks), failure to follow Kodak's operation, maintenance or repacking Instructions, failure to use items supplied by Kodak (such as adapters and cables), or claims made after the duration of this warranty.

KODAK MAKES NO OTHER EXPRESS OR IMPLIED WARRANTY FOR THIS PRODUCT, AND DISCLAIMS THE IMPLIED WARRANTIES OF MERCHANTABILITY AND FITNESS FOR A PARTICULAR PURPOSE. In the event that the exclusion of any implied warranty is ineffective under the law, the duration of the implied warranty will be one year from the purchase date or such longer period as required by law.

The option of repair, replacement, or refund is Kodak's only obligation. Kodak will not be responsible for any special, consequential or incidental damages resulting from the sale, purchase, or use of this product regardless of the cause. Liability for any special, consequential or incidental damages (including but not limited to loss of revenue or profit, downtime costs, loss of the use of the equipment, cost of substitute equipment, facilities or services, or claims of your customers for such damages resulting from the purchase use or failure of the Product), regardless of cause or for breach of any written or implied warranty is expressly disclaimed.

Your Rights

Some states or jurisdictions do not allow exclusion or limitation of incidental or consequential damages, so the above limitation or exclusion may not apply to you. Some states or jurisdictions do not allow limitations on how long an implied warranty lasts, so the above limitation may not apply to you.

This warranty gives you specific rights, and you may have other rights which vary from state to state or by jurisdiction.

Outside the United States and Canada

In countries other than the United States and Canada, the terms and conditions of this warranty may be different. Unless a specific Kodak warranty is communicated to the purchaser in writing by a Kodak company, no warranty or liability exists beyond any minimum requirements imposed by law, even though defect, damage, or loss may be by negligence or other act.

EASTMAN KODAK COMPANY

Rochester, NY 14650

U.S.A.

© Eastman Kodak Company, 2006. MC/MR/TM: Kodak Printed in China.

Telephone Customer Support

If you have questions concerning the operation of your EasyShare software, Home Center software, or EasyShare AiO, you may speak with a customer support representative. When you call, please have the following information available.

- Computer model, operating system
- Processor type and speed (MHz)
- Amount of memory (MB) and free hard disk space
- Printer serial number
- Version of Kodak EasyShare software
- Version of Kodak Home Center software
- Print a Diagnostics Page
- Exact error message you received
- Your unit's Kodak Service Number (under the printer access door).

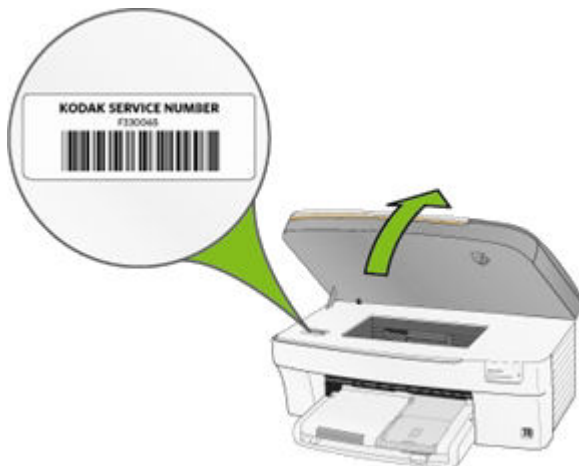

Customer Support Phone Numbers

Australia	1800 147 701
Austria	0179 567 357
Belgium	02 713 14 45
Canada	1 800 465 6325
Denmark	3 848 71 30
Finland	0800 1 17056
France	01 55 1740 77
Germany	069 5007 0035
International Toll Fax	+44 131 458 6962
International Toll Line	+44 131 458 6714
Ireland	01 407 3054
Italy	02 696 33452
Japan	03 5540 9002
Mexico	01 800 288 56325
Netherlands	020 346 9372
New Zealand	0800 440 786
Norway	23 16 21 33
Portugal	021 415 4125
Spain	91 749 76 53
Sweden	08 587 704 21
Switzerland	01 838 53 51
UK	0870 243 0270
US (toll-free) / (toll)	1 800 421 6699

Visit www.kodak.com/go/dfiswwcontacts.

Troubleshooting

AiO Fails to Power On

The power supply is not properly connected.

- 1 Make sure the power cord is connected to the power supply and plugged into a grounded power outlet or power strip.
- 2 If you are using a power strip, make sure it is turned on.
- 3 If you are using a switched power outlet, make sure the switch is on.
- 4 Make sure the power outlet is supplying power.
- 5 If none of the above corrects the problem, contact Kodak support.

Bluetooth Device not Recognized

Probable Cause 1

The internal Bluetooth radio in the device may be turned off.

Corrective Action

Make sure the device is on and within range of the Bluetooth radio signal (30 ft., or 10 meters).

NOTE: The Bluetooth technology enabled device must use an BIP, OPP, or FTP profile.

Probable Cause 2

Sending device requires a PIN.

Corrective Action

Enter a PIN of 1111 into the sending device.

Device not Recognized

Any of the following can cause the prevent your Kodak EasyShare AiO from reading a connected digital camera or memory card.

- The camera is turned OFF.
- The USB connector from the camera is not fully inserted in the port.
- The memory card is not completely inserted.
- The memory card is in backwards.
- The memory card file system is corrupt.

Correct any connection problems and try again.

If the memory card file system is corrupt, reformat it in your camera.

Ink Cartridge

Color/Black Cartridge Not Recognized

The ink cartridge installed was not recognized. Generic or non-Kodak ink cartridges may not function in the KODAK EASYSHARE All-in-One Printer. Kodak recommends using Kodak ink cartridges.

To correct the problem, install a genuine Kodak ink cartridge.

Ink Cartridge out of Ink

One of the ink cartridges has reached the end of its life and needs to be replaced.

To correct the problem, replace the expired ink cartridge.

Multiple Paper Feed

Multiple sheets of paper are pulled through printer.

- 1 Disengage the Photo tray.
- 2 Remove the paper from the paper tray(s). Carefully "fan" the paper to keep the sheets from sticking together.
- 3 Reload the paper tray(s). Do not overfill.
- 4 Re-engaged the Photo tray, then press **Start** to resume printing.

No Communication with Computer

Your EasyShare AiO is not connected to your computer.

- 1 Make sure you are using the proper USB Cable.



- 2 Check the connection from your computer to your AiO printer. Ensure that the square end of the USB cable is plugged in to the USB port on the back of your AiO printer, and the flat end into a USB port on your computer.



- 3 You may need to disconnect other printers or scanners from your computer.
- 4 After checking connections, restart your computer.
- 5 Make sure your computer meets the minimum system requirements. Upgrade your system if necessary.

For more information on connecting your Kodak AiO printer to your computer, see the Setup Poster that came with your unit.

No Paper Feed

Paper does not feed. You may have a message on the display on the printer and/or in the Status Monitor on your computer.

IMPORTANT: For best result, use only Kodak Ink cartridges and paper for your printer.

The paper tray(s) may be empty. Load paper into the paper tray(s), then press **Start**.

Check the paper

- 1 Disengage the Photo tray.
- 2 Inspect the paper and make sure paper no sheets are damaged in any way. Reload with new paper if necessary.
- 3 Carefully "fan" the paper to keep the sheets from sticking together.
- 4 Reload the paper tray(s). Do not overfill.
- 5 Engage the Photo tray, if printing 4 x 6 Photo's, then press **Start** to resume printing.

Paper Jam

The paper did not advance or was not picked properly from the paper tray.

- 1 Open the paper trays and remove the paper supply.
- 2 Press in the latches on the rear access door and remove it.



- 3 Pull the paper out from the rollers without tearing it.
IMPORTANT: If the paper tears while removing it, check inside the AiO for torn pieces of paper and remove them. More jams are likely to occur if all the torn pieces are not removed.
- 4 Replace the rear access door by pressing it in until it latches into place.



- 5 Reload the paper tray(s). Do not overfill.
- 6 Re-engage the Photo tray if desired.

Printer not Responding

If you receive a Printer not Responding message

- 1 Turn the printer off and turn it back on.
- 2 If the problem still persists, unplug the power cord from power supply and plug it back in.
- 3 If the problem continues to persist, restart your computer.

Transfer Pictures Failure

Nothing happens when you try to transfer pictures to the computer.

- 1 Press the Transfer button, on the printer.
- 2 Check the power and USB connections from the printer to the computer.
- 3 If you are trying to transfer pictures from a memory card and a PictBridge camera is connected, remove it.
- 4 Close unnecessary software applications, and minimize remaining application windows. Follow any messages on the screen that may have been hidden by other windows.
- 5 Disconnect then reconnect the USB cable from the printer to the computer.
- 6 Make sure you are using the USB cable included with your printer.
- 7 Make sure Kodak EasyShare software is installed. Install if necessary. If you choose Custom installation, make sure to install the printer driver.
- 8 Un-install, and then reinstall Kodak EasyShare software.
- 9 Make sure your computer meets the minimum system requirements. Upgrade your system if necessary.

NOTE: The Kodak AiO printer is compatible with the Kodak 8-in-1-card reader (sold separately). Other Kodak USB card readers may work with the printer; however, other manufacturers' card readers are not supported.

Wrong Paper Size

The paper you selected does not match the active paper tray. The paper selected may be too large or too small than the paper found in the paper tray.

- 1 Replace the paper in the paper tray with the correct type.
- 2 Press **OK** to continue or **Cancel** to exit.

Print Troubleshooting

Envelope Printing Incorrect

The envelopes are not loaded correctly.

- 1 Remove the envelopes from the main paper tray.
- 2 Straighten the stack of envelopes against a flat surface, and reload it into the main paper tray.
- 3 Slide the paper-width and paper-length guides inward until they stop at the edges of the envelopes.

Multiple-page Document in Reverse Order

The printing settings are set to print the first page of your document first.

Print the document in reverse order so the pages will be in the correct order when printing finishes.

- 1 Click the **Properties** button on the Print dialog.
- 2 Select **Print last page first** on the **General** tab.

Photo Print Smudged

Fingerprints may be on glossy side of paper.

Handle paper by the edges.

PictBridge Camera not Detected

- 1 Check the USB connections from the PictBridge compatible camera or device to the printer.
- 2 If disconnected, reconnect the USB cable from the PictBridge compatible camera or device to the printer.
- 3 Make sure there is at least one picture in the PictBridge compatible camera or device's internal memory or memory card.
- 4 Make sure the connected camera or device is PictBridge compatible. See your camera or device user's guide for details.

Picture Will Not Print

A selected picture does not print.

- The image file may be corrupt. Review the picture on the camera or computer and delete if necessary.
- The image file may not be JPEG format. The printer can only print JPEG files in standalone mode. Connect to a computer and use EasyShare software to print BMP and TIFF formats.

Pictures Cropped

- Change the picture quality setting (or resolution) on your digital camera to 3:2. See your camera user's guide for details.
- Adjust cropped pictures using Kodak EasyShare software on your computer.
- If you are printing from an application on your computer, select the proper paper size in print options.

NOTE: Cropping may vary depending on the selected picture size.

Poor Print Quality

- 1 Clean the printhead.
- 2 Run a calibration.

If the problem persists, repeat as often as necessary.

Print Skewed or Slanted

Probable Cause 1

The paper is not properly loaded in the tray.

- 1 Remove the stack of paper from the main paper tray, and slide the paper guides to the outermost position.
- 2 Remove the paper and check for wrinkles and tears.
- 3 Straighten the stack of paper against a flat surface, and reload it into the main paper tray.
- 4 Slide the paper-width and paper-length guides inward until they stop at the edges of the paper.

See Also: *Load Main Tray*

Probable Cause 2

More than one type of paper is loaded.

Load only one type of paper.

Print Spotted

Paper may be dirty.

Use a dry, lint-free cloth to wipe clean. For excessive dirt or debris, thoroughly clean the paper tray, and load new paper.

NOTE: Keep paper tray covers closed to keep dust and debris from collecting on the paper or inside the printer.

Print Too Dark

- Try re-taking the picture with the flash on, or move within the flash range of the camera. See your camera user's guide for details.
- Adjust the exposure compensation on your camera, and try re-taking the picture. See your camera user's guide for details.
- Edit the picture using Kodak EasyShare software on your computer. See the EasyShare software Help for details.
- Make sure the printer is not placed in direct sunlight or is not operating in a high-temperature environment.

Print Too Light

IMPORTANT: For best result, use only Kodak Ink cartridges and paper for your printer.

- Make sure the paper is loaded with the Kodak logo facing up. Reload if necessary.
- Try re-taking the picture with the flash off. See your camera user's guide for details.
- Adjust the exposure compensation on your camera, and try re-taking the picture. See your camera user's guide for details.
- Edit the picture using Kodak EasyShare software on your computer. See the EasyShare software Help for details.

Printing Stops

Printing stops during mid-print. Paper stops feeding, and Status light may blink.

IMPORTANT: For best result, use only Kodak Ink cartridges and paper for your printer.

Check the paper

- 1 Disengage the photo tray if engaged.
- 2 Check the paper access on the back of the printer.
- 3 Remove any loose paper from the printer.
- 4 Inspect the paper supplies and reload with new paper if necessary.
- 5 Carefully "fan" the paper to keep the sheets from sticking together.
- 6 Reload the paper trays. Do not overload.
- 7 Re-engage the photo tray, if desired, and then press Start to resume printing.

Slow Printing

NOTE: When printing a large number of prints, printing may slow down to prevent the print head from overheating.

- Make sure the printer is not placed in direct sunlight or is not operating in a high-temperature environment (higher than 95° F, or 35° C).
- Close unnecessary software applications.
- Make sure your computer meets the minimum system requirements. Upgrade your system if necessary.

White Edges on Borderless Prints

Probable Cause

White edges can appear when there are slight misalignments between the printer and paper. Some software applications are able to "hide" these small misalignments so that the prints look borderless like they are supposed to.

Corrective Action

Use the application's **Fit to Page/Fill Page** option, or resize the picture so it is slightly larger than the paper size.

Copy Troubleshooting

Copies Faded or Dull Colors

Probable Cause 1

The copy quality is set to **Draft**.

Set the copy quality to **Normal** or **Best**.

See *Set Copy Quality* or *Copy Settings*.

Probable Cause 2

The brightness setting for copies is set too light.

Adjust the brightness setting to darker.

See *Change Brightness* or *Copy Settings*.

Copies too Light or Dark

The brightness setting for copies is set too light or dark.

Adjust the brightness setting for copies

See *Change Brightness or Copy Settings*.

Copy Cut Off

The original is larger than the paper loaded.

When the original is larger than the paper loaded, use the Fit to Page option to reduce your original to the size of the paper loaded.

Scan Troubleshooting

Scan Fails

Probable Cause 1

Your computer is not turned ON.

Turn on your computer.

Probable Cause 2

Your EasyShare AiO is not connected to your computer.

Connect your EasyShare AiO to your computer with a standard USB cable.

Probable Cause 3

The EasyShare AiO Home Center software is not installed.

Insert the Kodak EasyShare 5000 All-in-One Printer installation CD and install the software.

Probable Cause 4

Your computer system resources may be low.

- 1 Turn off your computer and EasyShare AiO and then turn them back on.
- 2 If the problem still persists, try scanning at a lower resolution.

Scanned Image Blank

Your original is not placed correctly on the scanner glass.

Place your original face down on the right front corner of the scanner glass.



Proofsheet Scan Unsuccessful

Probable Cause 1

The scanner glass is dirty.

Make sure the scanner glass is completely clean or the proofsheets might not scan properly (see *Clean the Scanner Glass*).

Probable Cause 2

Memory Card or Camera Changed

Make sure the same memory card inserted or camera connected you used to print the proofsheets.

Probable Cause 3

Proofsheet not placed correctly on scanner glass.

Place the proofsheets on the front right of the scanner glass.

9 Appendix

All-in-One Specifications

B&W plain paper print speed (Draft/Normal/Best)	32 / 10.5 / 5 ppm
Color plain paper print speed (Draft/Normal/Best)	22 / 6 / 3 ppm
Photo print speed - 4X6 Kodak Studio Gloss	2.14 ppm [28 sec/print]
Photo print speed - 8X10 Kodak Studio Gloss	0.86 ppm [70sec/print]
B&W plain paper copy speed (Draft/Normal/Best)	30 / 10 / 5 ppm
Color plain paper copy speed (Draft/Normal/Best)	20 / 6 / 3 ppm
Scan Resolution	1200 dpi
Size	18.8"W x 14.7"D x 8.8"H (47.8 x 37.3 x 22.4 cm)
Weight	21.3 lbs (9.7 kg)
Image Formats	JPG (EXIF V 2.21)
Main Tray capacity	100 sheets of 20 lb plain paper
Photo Tray capacity	20 sheets of 10 mil thick 4x6 inch (101x150 mm) photo paper
Output Tray capacity	50 sheets of 20 lb plain paper or 20 sheets of photo paper
Product Operation Environmental Range	5 to 35 degrees C, 15 to 85 % RH (non-condensing), and atmospheric pressure of no less than 15 PSI (approximately 10,000 ft ASL)

Computer Requirements

Requirement	Minimum	Recommended
Operating System	XP SP1	XP SP2, XP 64, Vista
CPU	Celeron	Pentium 4
Clock Speed	1.2 GHz	3 GHz
Memory	128 MB	512 MB
Available Disk Space	200 MB	200 MB
Monitor Resolution	800 x 600 pixels	1024 x 768 pixels
Color Depth	16 bit	24 bit
Interface	USB 1.1	USB 2.0
Removable Drive	CD-ROM	CD-ROM

Paper Types

The following tables show the paper types and sizes the Kodak EasyShare AiO supports for copying and printing.

Supported Paper Types	
Plain paper	20 to 24 lb (64 to 90 gsm)
Photo paper	10 mils
Card Stock	110 lb index max (200 gsm)
Envelopes	20 to 24 lb (75 to 90 gsm)
Transparency	All commercially available inkjet varieties (with or without a widedstripe.)
Labels	All commercially available inkjet varieties on 8.5 x 11 and A4 size sheets
Iron-on Transfer	All commercially available inkjet varieties on 8.5 x 11 and A4 size sheets

Supported Paper Sizes		
Usage	Size	Tray
Document page sizes Labels	A4 (210x297 mm) A5 (148x210 mm) A6 (105x148 mm) US Executive (7.25x10.5 in.) (184x266 mm) US Legal (8.5x14 in.) (216x356 mm) US Letter (8.5x11 in.) (216x280 mm) Custom sizes	Main
Index Card Stock	3x5 in. index cards (76.2x127 mm) 4x6 in. index cards (101x152 mm) 5x7 in. index cards (127x178 mm)	Main
Transparency Iron-on Transfers	A4 (210x297 mm) US Letter (8.5x11 in.) (216x280 mm)	Main
Envelopes	B5 (6.92x9.84 in.) (176x250 mm) C5 (6.38x9 in.) (162x299 mm) C6 (4.49x6.38 in.) (114x162 mm) A2 (4.37x5.75 in.) (111x146 mm) DL (designated long) (4.33x8.66 in.) (110x220 mm) US #7 (7x9 in.) (178x127 mm) US #9 (9x12 in.) (127x305 mm) US #10 (4.12x9.5 in.) (105x241 mm)	Main
Photo	3.5x5 in. (89x127 mm) 100x150 mm 4x6 in. (101x152 mm) 4x8 in. (101x203 mm) 4x12 in. (101x305 mm) 5x7 in. (127x178 mm) 6x9 in. (152x229 mm) 8x10 in. (203x254 mm) 8.5x11 in. (216x280 mm) A4 210x297 mm	Main Photo Photo Main Main Main Main Main Main Main
Greeting Card	3.5x5.25 in. (89x133 mm) 3.5x7.25 in. (89x184 mm) 4x5.5 in. (101x140 mm) 4x8 in. (101x203 mm) Hagaki (100x148 mm)	Main

Safety

- Read and follow these cautions and warnings before using KODAK products.
- Always follow basic safety procedures.
- Follow all warnings and instructions marked on the equipment.

Parts



CAUTION

Do not disassemble this product; there are no user-serviceable Part(s) inside. Refer servicing to Kodak qualified service personnel.



WARNING

Keep out of reach of children.
Ink is harmful if swallowed.

Power



CAUTION

Unplug your EasyShare AiO from the power outlet and refer servicing to qualified service personnel if the power cord or plug is frayed or damaged, the equipment gets wet, or the equipment does not operate normally when the operating instructions are followed.



CAUTION

The AC adapter power supply is equipped with 3-wire grounding type plugs. If you cannot insert the plug into the power outlet, contact an electrician to check or replace the power outlet.



CAUTION

Do not plug the AC adapter into a household extension cord.



CAUTION

For added protection from damage during a lightning storm, or any time when your EasyShare AiO and its associated AC adapter will be left unused for long periods of time, unplug the AC adapter from the power outlet and the phone line from the modem.



WARNING

The use of an accessory attachment that is not recommended by Kodak, such as an AC adapter, could cause fire, electric shock, or injury.



WARNING

Pushing objects through the equipment openings can result in an electric shock or risk of fire.

Location



CAUTION

To prevent your EasyShare AiO from overheating do not block or cover the slots and openings in the equipment, place it near a heat register, or install it in a cabinet without proper ventilation.

**CAUTION**

Do not use your EasyShare AiO near water, or spill liquid on it.

**WARNING**

Do not place your EasyShare AiO on an unstable cart, stand, bracket, or table. Injury to persons and damage to the equipment may occur.

Environment

**CAUTION**

Excessive dust levels may damage internal parts.

**CAUTION**

Unplug the equipment from the wall outlet before cleaning.

**CAUTION**

Dropping your EasyShare AiO may damage the housing and result in extensive damage that will require repair by a qualified technician to restore normal operation.

**WARNING**

Do not expose this product to liquid, moisture, or extreme temperatures. KODAK AC adapters are intended for indoor use only. The use of controls, adjustments, or procedures other than those specified herein may result in exposure to shock and/or electrical or mechanical hazards.

For more information, go to www.Kodak.com/go/MSDS.

Regulatory Compliance

FCC Compliance and Advisory



This equipment has been tested and found to comply with the limits for a Class B digital device, pursuant to Part 15 of the FCC Rules. These limits are designed to provide reasonable protection against harmful interference in a residential installation.

This equipment generates, uses, and can radiate radio frequency energy and, if not installed or used in accordance with the instructions, may cause harmful interference to radio communications. However, there is no guarantee that interference will not occur in a particular installation.

If this equipment does cause harmful interference to radio or television reception, which can be determined by turning the equipment off and on, you are encouraged to try to correct the interference by one or more of the following measures: 1) reorient or relocate the receiving antenna; 2) increase the separation between the equipment and the receiver; 3) connect the equipment to an outlet on a circuit different from that to which the receiver is connected; 4) consult the dealer or an experienced radio/TV technician for additional suggestions.

Any changes or modifications not expressly approved by the party responsible for compliance could void the user's authority to operate the equipment. Where shielded interface cables have been provided with the product or specified additional components or accessories elsewhere defined to be used with the installation of the product, they must be used in order to ensure compliance with FCC regulation.



CAUTION

When using the wireless interface with an EasyShare AiO, this equipment should be installed and operated with a minimum distance of 7.9 in. (20 cm) for 2.4 GHz operations between the radiator and your body. This transmitter must not be collocated or operate in conjunction with any other antenna or transmitter.

FCC and Industry Canada

This device complies with Industry Canada RSS-210 and FCC Rules. Operation is subject to the following two conditions: (1) this device may not cause harmful interference, and (2) this device must accept any interference received, including interference that may cause undesired operation.

Canadian DOC statement

DOC Class B Compliance - This Class B digital apparatus complies with Canadian ICES-003.

Observation des normes-Class B - Cet appareil numérique de la classe B est conforme à la norme NMB-003 du Canada.

Waste Electrical and Electronic Equipment labeling



In the European Union, this symbol indicates that when the last user wishes to discard this product, it must be sent to appropriate facilities for recovery and recycling. Contact your local Kodak representative or refer to www.kodak.com/go/recycle for additional information on the collection and recovery programs available for this product

Notice to Users in the European Economic Area

The Kodak EasyShare All-in-One is designed to function with analogue telephone networks in the following countries.

Austria	Germany	Portugal
Belgium	Ireland	Spain
Denmark	Italy	Sweden
Finland	Netherlands	Switzerland
France	Norway	United Kingdom

Network compatibility depends on customer selected settings, which must be reset to use the equipment on a telephone network in a country other than where the product was purchased. Contact the vendor or Eastman Kodak Company if additional product support is necessary.

This equipment has been certified by the manufacturer in accordance with Directive 1999/5/EC (Annex II) for Pan-European single-terminal connection to the public switched telephone network (PSTN). However, due to differences between the individual PSTNs provided in different countries, the approval does not, of itself, give an unconditional assurance of successful operation on every PSTN network termination point.

In the event of problems, you should contact your equipment supplier in the first instance.

This equipment is designed for DTMF tone dialing and loop disconnect dialing. In the unlikely event of problems with loop disconnect dialing, it is recommended to use this equipment only with the DTMF tone dial setting.

Glossary

A

ADF: Automatic Document Feeder

AES: Advanced Encryption Standard

C

CHAP: Challenge Handshake Authentication Protocol

D

dBa: Decibel measured with a "weighting filter"

dBm: A measured power level in decibels relative to 1mW.

Dongle: A small electronic device that plugs into a USB port.

DPOF: Digital Print Order File - An ASCII order file that you can generate in a camera that supports DPOF. DPOF files enable you to request simple reprints of the photos in the file.

E

EAP: Extensible Authentication Protocol

EXIF: EXIF stands for Exchangeable Image File Format, and is a standard for storing interchange information in image files, especially those using JPEG compression. Most digital cameras now use the EXIF format.

J

JPEG: The term stands for "Joint Photographic Experts Group," because that is the name of the committee that developed the format. JPEG is a compressed image file format. JPEG is a "lossy" format, which means some quality is lost when the image is compressed.

K

KPT: Kodak Perfect Touch

P

PictBridge: A Camera and Imaging Products Association standard that enables direct printing between any PictBridge compliant digital cameras and any PictBridge compliant printer.

Picture Transfer Protocol (PTP): A standard for transferring pictures from a digital camera.

PPP: Point-to-Point Protocol

PTP: Picture Transfer Protocol - A standard for transferring pictures from a digital camera.

T

TKIP: Temporal Key Integrity Protocol

W

WEP: Wired Equivalent Privacy

Wi-Fi: Wireless Fidelity

WLAN: Wi-Fi Local Area Network

WPA: Wi-Fi Protected Access

Index

2

2-Sided Printing Accessory 16

A

A6 Paper 49

Audio Feedback 23

B

B5 Paper 50

Bluetooth 37, 81

Borderless 87

Brightness 63

C

Calibration 73

Clean 74

Cleaning 70

Color 51

Communication 82

Computer 82, 91

Control Panel 2, 34

Copy 62, 63

Copy Problems 87, 88

Cropped Pictures 85

Customer Support 79

D

Dark Print 86

Date 23, 24

Diagnostic Sheet 70

DPOF 22, 36

Duplexer 16

E

Envelopes 31

F

Firmware Upgrade 71

Fit to Page 59

Format 70

I

Index Print 35

Ink Cartridge 15, 71, 81

Ink Levels 71

J

Jam 83

L

Labels 32

Language 25

Layout 40

LCD display 8

Letter Paper 45

Light Print 86

M

Main Tray 28

Maintenance 69

Memory Card 70

Memory card slots 9

Menus 18

O

Originals 27

P

Panoramic 38

Paper 84, 92

Paper Feed 81, 82

Paper Jam 83

Photo Layout 41, 42, 43, 44

Photo Layouts 61

Photo Print 85

Photo Tray 30

Photos 53

PictBridge 9, 34, 85

Power 13, 80

Preview 52, 63

Print 34, 36, 40, 51

Print Order 22

Print Picture 85

Print Problems 84, 85

Print Quality 85

Print Spotted 86

Printhead 74

Printhead 13, 74

Printing Problems 84

Printing Stops 86

Proofsheet 36, 89

Q

Quality 51, 62

Quantity 51, 62

R

Requirements..... 91

Reset25

S

Safety 94

Same Size.....58

Sample Page..... 21

Scale Percent 60

Scan..... 89

Scan Document (Control Panel) 67, 68

Scan Photo..... 65, 66

Scan Problems 88, 89

Scan Settings65

Scanner Glass 70

Scanner Lid..... 70

Scene Balance.....23

Settings.....25, 51, 63

Sleep..... 24

Slow Printing 87

Specifications..... 91

Standby..... 24

Startup 17

Support 77

T

Tagged Images 22

Tagged Photos..... 36

Time..... 24

Transfer 22, 84

U

USB Port 9

W

White Edges 87

Z

Zoom..... 53

Zoom and Crop 64



1K3234