

FS-1030D

Clearing Paper Jams

The printer will stop when a paper jam occurs in the printer or if paper is misfed. The printer will go offline and the attention indicator (🔔 ⚠️) will fast flash.

Follow the instructions provided here to clear the jam. If paper jams occur frequently, try using a different type of paper, replace the paper using a new ream, or turn the paper over. Also, look for tiny pieces of paper which may have been left in the printer.

Indicators

There are four indicators located on the top right of the printer. The indicators are used to identify the status of the printer at any time. To identify the printer status, check the indicators on the printer and then refer to the table below.

Indicator	Status	Meaning
Ready ○ ● (Green)	Lit	Indicates online status (printing is possible).
	Flashing	An error has occurred, but printing resumes when the key is pressed. Offline status. You cannot print, but the printer can receive data. The printer is in sleep mode.
Data ● ● (Green)	Lit	Printing has stopped because an error has occurred.
	Flashing	The printer is processing data.
Attention 🔔 ⚠️ ● (Red)	Lit	The printer is receiving data.
	Flashing	The printer cover is open. A paper jam has occurred. The cassette is not inserted properly or the paper has run out.
Toner ● ● (Red)	Lit	The printer status is normal.
	Flashing	The printer has stopped because the toner is exhausted. The toner is running low.

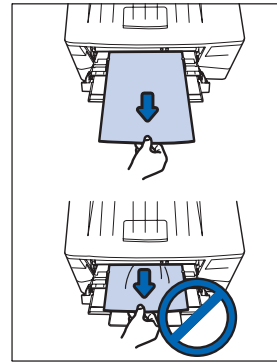

A MP Tray

- 1 Remove the paper from the MP tray.
Note Do not try to remove paper that has already been partially fed, proceed to step 2.

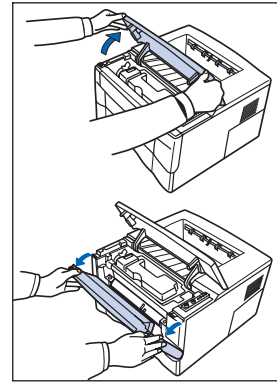

- 2 Open the top cover and front cover.

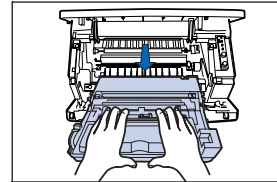

- 3 Lift the process unit together with the toner container out of the printer.
Note The drum in process unit is sensitive to light. Never expose the process unit to light for more than five minutes.

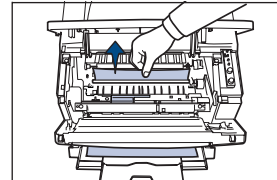

- 4 If the jammed paper appears to be pinched by rollers, pull it along the normal running direction of the paper.

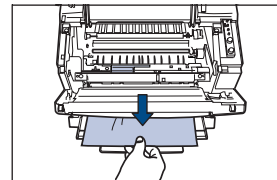

If it has not be fed as far as the metal registration roller, remove the paper from the MP tray side.

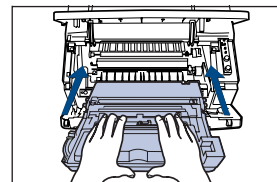

- 5 Insert the process unit together with the toner container, back into the machine. Close the front cover and top cover.

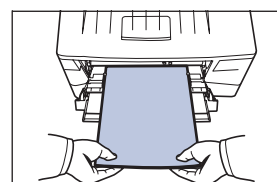

- 6 Reload the MP tray. The printer warms up and resumes printing.

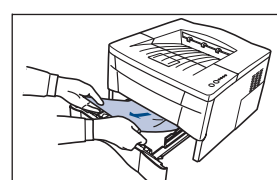

B Paper Cassette

- 1 Pull out the cassette. Remove any partially fed paper. Check to see if paper is loaded correctly. If not, reload the paper.

- 2 Push the cassette back in securely. Open and close the top cover to clear the error. The printer warms up and resumes printing.

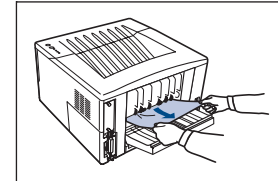

C Duplexer

- 1 Open the rear cover and remove the jammed paper as shown in the figure.

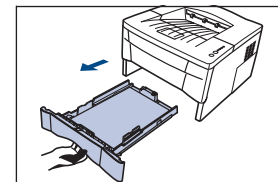

- 2 Pull the cassette all the way out of the printer.

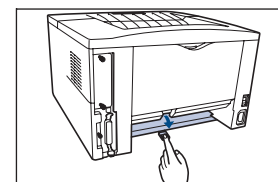

- 3 Open the duplexer's rear cover and remove any jammed paper.

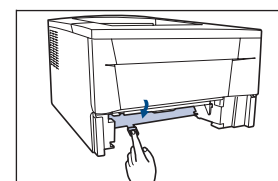

- 4 Open the duplexer's front cover and remove any jammed paper.
- 5 Insert the cassette into the slot in the printer.
- 6 Open and close the printer's top cover to clear the error. The printer then automatically warms up and resumes printing.

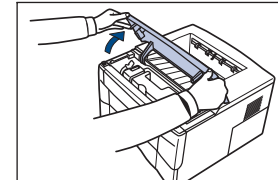

D Printer

- 1 Open the top cover and front cover.

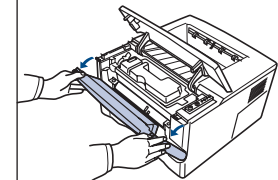

- 2 Lift the process unit together with the toner container out of the printer.
Note The drum in process unit is sensitive to light. Never expose the process unit to light for more than five minutes.

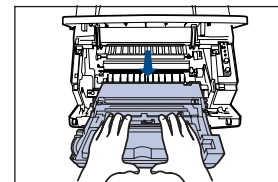

- 3 If the jammed paper appears to be pinched by rollers, pull it along the normal running direction of the paper.

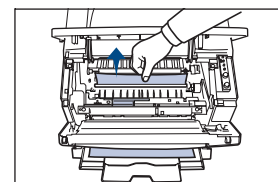

If it has not be fed as far as the metal registration roller, remove the paper from the MP tray side.

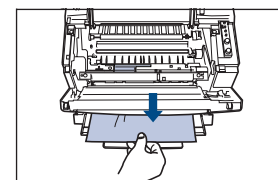

- 4 Insert the process unit together with the toner container, back machine. Close the front cover and top cover. The printer warms up and resumes printing.

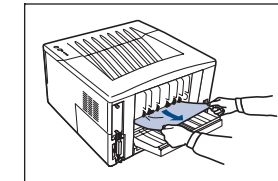

E Output Tray and Rear Cover

- 1 If paper is not completely ejected into the output tray, open the rear cover and remove the jammed paper by pulling it out.
- 2 Open and close the top cover to clear the error. The printer warms up and resumes printing.

General considerations for clearing jams

CAUTION When pulling the paper, pull it gently so as not to tear it. Torn pieces of paper are difficult to remove and may be easily overlooked, deterring the jam recovery.

- If paper jams occur frequently, try using a different type of paper, replace the paper with paper from another ream, flip the paper stack over, or rotate the paper stack 180 degrees. The printer may have problems if paper jams recur after the paper was replaced.

- Whether or not the jammed pages are reproduced normally after printing is resumed depends on the location of the paper jam.

- **CAUTION** Never use sharp tools like knives, screwdrivers or cutters to clear paperjams. Be aware of rings or watches as well.

- **CAUTION** Do no store paperclips or staples on any device.