THE BEST TIME TO CHANGE IS ... NOW!

THE RIGHT LED SOLUTIONS –
BASED ON LAMPS OR LUMINAIRES

JUNE 2023



LEDVANCE.COM



LEDVANCE



YOU HAVE THE PROBLEM. WE HAVE THE SOLUTION. PLAY IT SAFE WITH EU-COMPLIANT LED LAMPS



THE SITUATION MORE EFFICIENCY FOR OUR CLIMATE

As a measure against climate change, the EU aims to reduce CO₂ emissions in buildings by 30 % by 2030. What's more, the EU RoHS Directive is further restricting exceptions for mercury in light sources. As a result, mercury-containing and inefficient lamps may gradually no longer be placed on the market during 2023.



THE CHALLENGE SWITCHING TO LED

LED technology is efficient, versatile and future-proof. However, the switch from outdated T8/T5 fluorescent tubes and CFLni compact fluorescent lamps to innovative LED alternatives in existing lighting systems does not always work as a straightforward retrofit – local conditions differ too much.

GOODBYE FLUORESCENT LAMP. HELLO LED.

Fluorescent lamps have come to the end of the road. LEDVANCE offers future-proof alternatives: EU-compliant, energy-efficient and cost-effective.

CIRCULAR FLUORESCENT LAMPS T5/T9*

COMPACT FLUORESCENT LAMPS with plug-in bases (CFLni-2pin/4pin)

LINEAR FLUORESCENT LAMPS T8 and T5

HALOGEN PINS G4, GY6.35, G9

Products affected



2023



LEDVANCE LED replacement products



*T9 phase-out by LEDVANCE



THE SOLUTION LAMP REPLACEMENT OR NEW LUMINAIRE

In LEDVANCE, you have a lighting partner at your side who offers you a convincing alternative for your situation and supports you in finding solutions – from direct replacement and rewiring to upgrades and new installations.

This gives you peace of mind for always having the right answer to lamp bans, climate change and energy shortages – and at the same time allows you to successfully participate in the market.



A detailed overview of the lamp ban 2023 can be found at:
ledvance.com/lampban2023



For a detailed overview go to:
ledvance.com/rohs



4 OPTIONS FOR ALL SITUATIONS – HOW TO SWITCH

SOLUTIONS WITH LED TUBES

RETROFIT



Simple 1:1 replacement:

- Wide range of LED tubes for easy, quick and safe lamp replacement
- No rewiring necessary
- As a replacement for fluorescent tubes operated on CCG or compatible ECG
- Find the right LED tube in just a few steps with the Lamp Finder

CONVERSION



If there is no retrofit alternative or if the customer values maximum energy savings and low maintenance, rewiring is the solution.

1. LED tube on mains voltage:

Particularly quick and application-oriented with the conversion kit and the matching range of T8 and T5 LED tubes

2. LED TUBE EXTERNAL SYSTEM: T8/T5 LED tube and LED DRIVER EXTERNAL:

The perfect solution for switching from old fluorescent lamps and dimmable DALI control gear to efficient and dimmable LED tube technology

SOLUTIONS WITH LED LUMINAIRES

UPGRADE



Upgrade using the luminaire-in-luminaire principle:

- LINEAR MAGNETIC BATTEN T5 upgrade kit for existing T5 and T8 metal louver luminaires
- Positioning and mounting using adjustable magnets
- Quick, tool-free rewiring thanks to connector box
- Designed for use with T5 AC LED tubes
- Available in three different lengths

NEW INSTALLATION



Complete replacement with modern LED luminaires:

- Large range of innovative luminaires for new construction or renovation projects
- Attractive design and high quality
- High functionality for intelligent lighting control
- Long life and maximum potential for energy savings



Go directly to the Lamp Finder:
ledvance.com/lampfinder

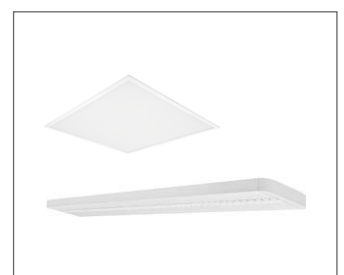



LAMP FINDER **FOR AN EASY SWITCH**

LED technology is efficient, versatile and future-proof. However, the switch from outdated T5/T8 fluorescent tubes, compact fluorescent and halogen lamps to innovative LED alternatives in existing lighting systems does not always work as a straightforward retrofit – local conditions differ too much.

PHASE-OUT AND LEDVANCE REPLACEMENT PRODUCTS

PRODUCTS AFFECTED		BANNED ¹	LED REPLACEMENT PRODUCTS
COMPACT FLUORESCENT LAMPS CFLi – E27, E14 etc. with integrated control gear		SEPT 1, 2021	
HIGH-VOLTAGE HALOGEN LAMPS² R7s > 2700 lm corresponds to approx. 140W		SEPT 1, 2021	
LOW-VOLTAGE HALOGEN LAMPS GU4, GU5.3, G53 with reflector >10° beam angle		SEPT 1, 2021	
LINEAR FLUORESCENT LAMPS T12 and T2		SEPT 1, 2021	
CIRCULAR FLUORESCENT LAMPS T5 and T9 ³		FEB 25, 2023	
COMPACT FLUORESCENT LAMPS with plug-in bases (CFLni – 2pin/4pin)		FEB 25, 2023	
LINEAR FLUORESCENT LAMPS T5 and T8		AUG 25, 2023	
HALOGEN PINS G4, GY6.35, G9		SEPT 1, 2023	

¹ Products that are already on the market may still be sold after this date, but may not be placed on the market again. | ² Suitable for the light point, differing lighting performance. Limitations: maximum luminous flux, general thermal requirements, dimensions of the replacement lamp. | ³ T9 phase-out by LEDVANCE

THE LAMP FINDER – HERE'S HOW IT WORKS:

The Lamp Finder gives you the answers you need. Just enter some information about your traditional lamp and we will give you alternative LED solutions for your installation. If there is no suitable LED lamp you can find alternative LED luminaires in our online product catalog.

▶ Provide some details of your traditional lamp such as wattage, light color and control gear and you will get possible LED alternatives.



Check it out:
ledvance.com/lampfinder



GET THE RIGHT LED REPLACEMENT IN NO MORE THAN 7 STEPS

1

Light source
Choose your traditional lamp

LINEAR FLUORESCENT LAMPS T5 and T8

CIRCULAR FLUORESCENT LAMPS T5/T8/U/T9

COMPACT FLUORESCENT LAMPS with plug-in bases (CFLuv-2pin/4pin)

HALOGEN LAMPS

Choose your traditional lamp.

3

Emergency lighting
Choose whether you need an LED lighting solution for emergency lighting or not

Non-Emergency lighting

Emergency lighting

Choose an LED solution for either emergency or non-emergency lighting. For linear fluorescent lamps we offer the LED Tube External System as an LED alternative which is fit for emergency lighting.

5

Light color
Choose the light color of your traditional lamp
Definition of light color: Color rendering index/color temperature (CRI/CCT) e.g. 830 = CRI = 80/CCT: 3 000 Kelvin

827

830

840

865

940

965

Choose your traditional lamp's light color. Definition of light color: Color rendering index/color temperature (CRI/CCT) e.g. 830 = CRI ≥ 80/CCT: 3 000 Kelvin.

7

Result Page
Your existing product

CIRCULAR FLUORESCENT LAMP, 21 W, 830, ECG

RETROFIT with LED alternative
Simple 1:1 replacement on CCG or compatible ECG

Product name	EAN	W	lm	K	lm/W	Yes	ECG	LED	
SubstiTUBE T5 HF HE14 7 W/3000 K 549 mm	4058075543300	549	7	900	3000	60000	Yes	ECG	LED

*) 1,79/800 at 20°C (lm/W)
*) Energy efficiency class (EEC) on a scale of A (highest efficiency) to G (lowest efficiency)
*) Check ECG compatibility before installation at Side Finder, technical specification and/or compatibility data. ECG-compatibility

The results page will display possible LED alternatives for retrofit and conversion. If there is no suitable lamp you can either check out our extensive LED luminaire range or get in touch with us and we will give you a tailored quote.

2

Dimmability
Choose whether you need a dimmable LED solution or not

Non-Dimmable Solution

Dimmable solution

Choose between a dimmable and non-dimmable LED solution.

4

Power (W)
Choose the power of your traditional lamp

4 W

6 W

8 W

13 W

14 W

15 W

16 W

18 W

21 W

23 W

24 W

28 W

30 W

35 W

36 W

38 W

39 W

49 W

54 W

58 W

70 W

80 W

Choose your traditional lamp's power.

6

Operation
Choose the ballast of your traditional lamp
ECG: Electronic Control Gear, CCG: Conventional Control Gear, a magnetic ballast with additional starter

ECG

CCG

Choose your traditional lamp's control gear/ballast. ECG: Electronic Control Gear, CCG: Conventional Control Gear, a magnetic ballast with additional starter.

Not sure if the solution's right for you?
Contact us: contact@ledvance.com

LED TUBES 4 SOLUTIONS FOR ALL SITUATIONS

SOLUTIONS WITH LED TUBES



RETROFIT



Switching from fluorescent tubes to LED tubes in existing luminaires is quick, easy and economical – either as retrofits or conversions.

Simple 1:1 replacement

- The most cost effective LED alternative for installations with CCG or compatible ECG
- Wide range of LED tubes for easy, quick and safe lamp replacement

Rewiring or modification

- If there is no retrofit alternative or if the customer values maximum energy savings and low maintenance
- Wide range of LED tubes for operation directly on AC mains
- Optional matching conversion kits for easy rewiring
- LED TUBE EXTERNAL SYSTEM when a dimmable LED tube or emergency lighting solution is needed

CONVERSION



SOLUTIONS WITH LED LUMINAIRES



UPGRADE



If the focus is on optimal light output and quality, maximum efficiency and perhaps added benefits, it's worth upgrading the luminaires or installing new ones.

Upgrade luminaire

- If an existing luminaire needs to be kept but electric or mechanical interfaces are too old for a retrofit or conversion

NEW INSTALLATION



New luminaire

- If the existing housing or other components have reached the end of their life
- If lighting performance requirements have changed (e.g. light distribution or quality)
- If a light management system needs to be integrated, or there's an upgrade to human centric lighting
- If aesthetical or functional design requirements have changed

RETROFIT

CONVERSION

LED T8 EM
LED T8 UNIVERSAL

LED T8 HF
LED T5 HF

LED T5 AC MAINS

LED TUBE EXTERNAL SYSTEM:
LED TUBE T8/T5 EXTERNAL
LED DRIVER EXTERNAL



NOT SURE WHAT TO CHOOSE?

LEDVANCE takes care of tailor-made calculations and offers you a customized solution for your lighting requirements – all from a single source. Please get in touch.

Email: contact@ledvance.com
Phone: +49 89 780673-660

LEDVANCE TRAINING CENTER: DEEPER KNOWLEDGE MADE EASY

Learn all you need to know about Lamp Ban 2023, products and applications. And discover the world of light in an interactive and interesting way.

Simply register at training.ledvance.com

LED TUBE APPLICATION MATRIX

LEDVANCE LED TUBE PORTFOLIO	T8							T5	T9C	T8/T5		
	ULTRA OUTPUT S	S	ULTRA OUTPUT P	P	ULTRA OUTPUT V	V	CONNECTED P	FOOD P	MOTION SENSOR P	HF/AC MAINS	T9 C	LED TUBE EXTERNAL SYSTEM
 <p>INDUSTRY Typical operating time: 24 h/day 6 days/week Recommended illuminance: 200–500+ lux</p>	✓	✓	✓	✓						✓		✓
 <p>WAREHOUSE Typical operating time: 24 h/day 6 days/week Recommended illuminance: 200–300 lux</p>	✓	✓	✓	✓	✓	✓	✓		✓ ¹	✓		✓
 <p>PARKING Typical operating time: 24 h/day 7 days/week Recommended illuminance: 75–300 lux</p>			✓	✓	✓	✓	✓		✓ ¹	✓		✓
 <p>RETAIL Typical operating time: 15 h/day 7 days/week Recommended illuminance: 500+ lux</p>	✓	✓	✓	✓						✓		✓
 <p>FOOD PRESENTATION Typical operating time: 15 h/day 7 days/week Recommended illuminance: Special spectrum with high CRI-R9 level, shatter protection</p>								✓		✓		
 <p>OFFICE Typical operating time: 14 h/day 5 days/week Recommended lighting intensity: 500+ lux</p>	✓		✓							✓	✓	✓
 <p>RESIDENTIAL AREAS Typical operating time: 2.7 h/day 7 days/week Recommended illuminance: 100+ lux</p>					✓	✓			✓	✓	✓	
 <p>OUTDOOR AREAS/PUBLIC TRANSPORTATION Typical operating time: 10 h/day 7 days/week Recommended illuminance: 5–500+ lux</p>	✓	✓	✓	✓						✓	✓	✓
 <p>PUBLIC BUILDINGS/ SPORTS AND LEISURE Typical operating time: 15 h/day 7 days/week Recommended illuminance: 100–500+ lux</p>	✓	✓	✓	✓			✓			✓	✓	✓

¹ < 10 light outlets

THREE SEGMENTS FOR EVERY NEED

PERFORMANCE & TECHNOLOGY



LED TUBE T8 EM ULTRA OUTPUT S
Operation on CCG and AC mains

LED TUBE T8 EM S
Operation on CCG and AC mains

- Luminous flux up to 4 100 lm
- Efficiency up to 185 lm/W
- Lifetime of 75 000 h¹
- 1 200 mm, 1 500 mm



LEDVANCE 5 year guarantee

CRI 80

GLASS

LED TUBE T8 EM ULTRA OUTPUT P
Operation on CCG and AC mains

LED TUBE T8 EM P
Operation on CCG and AC mains

- Luminous flux up to 3 700 lm
- Efficiency up to 160 lm/W
- Lifetime of 60 000 h¹
- 1 200 mm, 1 500 mm



LEDVANCE 5 year guarantee

CRI 80

GLASS

LED TUBE T8 EM ULTRA OUTPUT V
Operation on CCG and AC mains

LED TUBE T8 EM V
Operation on CCG and AC mains

- Luminous flux up to 3 500 lm
- Efficiency up to 120 lm/W
- Lifetime of 30 000 h¹
- 1 200 mm, 1 500 mm



LEDVANCE 3 year guarantee

CRI 80

GLASS

MAKE THE RIGHT CHOICE

CONTROL GEAR AND TECHNOLOGY OVERVIEW

COMPATIBILITY	CCG	ECG	AC MAINS
LED TUBE EM: "Electro magnetic" Replacement for T8 fluorescent lamps	✓	✗	✓
LED TUBE AC: "AC Mains" Replacement for T5 fluorescent lamps	✗	✗	✓

✗ = not compatible ✓ = compatible

¹L70/B50



The LEDVANCE LED TUBE LED tubes come in Superior Class, Performance Class and Value Class. This allows you to easily meet the requirements of each of your lighting projects. And when it comes to technology, the LEDVANCE LED TUBE range will also have the answer – no matter whether operated on ECG², CCG or AC mains.

LED TUBE T8 UNIVERSAL/HF ULTRA OUTPUT P
 HF on ECG² | UNIVERSAL on ECG², CCG and AC mains

LED TUBE T8 UNIVERSAL/HF P
 HF on ECG² | UNIVERSAL on ECG², CCG and AC mains

- Lumen output up to 3 700 lm
- Efficiency up to 161 lm/W
- Lifetime of UNIVERSAL: 60 000 h¹ /of HF: 75 000 h¹
- 1 200 mm, 1 500 mm



LEDVANCE
5 year guarantee

GLASS

CRI 80

- Lumen output up to 3 100 lm
- Efficiency up to 155 lm/W
- Lifetime of UNIVERSAL: 60 000 h¹ /of HF: 75 000 h¹
- 600 mm, 1 200 mm, 1 500 mm

LED TUBE T8 UNIVERSAL/HF V
 HF on ECG² | UNIVERSAL on ECG², CCG and AC mains

- Lumen output up to 2 800 lm
- Efficiency up to 116 lm/W
- Lifetime of 30 000 h¹
- UNIVERSAL: 600 mm, 1 200 mm, 1 500 mm
- HF: only 600 mm



LEDVANCE
3 year guarantee

GLASS

CRI 80



MAKE THE RIGHT CHOICE CONTROL GEAR AND TECHNOLOGY OVERVIEW

COMPATIBILITY	CCG	ECG ²	AC MAINS
LED TUBE HF: "High frequency" Replacement for T8/T5 fluorescent lamps	✗	✓	✗
LED TUBE UN: "Universal" One for everything. Replacement for T8 fluorescent lamps	✓	✓	✓

✗ = not compatible ✓ = compatible

¹L70/B50
²Check ECG compatibility at ledvance.com/compatibility or ledvance.com/tubefinder

LEDVANCE TUBES

SPECIAL TYPES, SPECIAL TASKS, SPECIAL SOLUTIONS

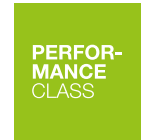

The LEDVANCE LED TUBE range also includes specialists. You can use them to offer your customers real added value for special applications.

LED TUBE T8 EM CONNECTED P
Operation on CCG and AC mains

Light on demand: intelligent control via a sensor reduces energy consumption.

- Communication via Zigbee 3.0
- Glass tube with splinter protection
- Only in connection with the LEDVANCE Connected Sensor:
Installation height
Low bay: up to 4 m
High bay: 4–14 m



LED TUBE T8 EM MOTION SENSOR P
Operation on CCG and AC mains

With movement there's light. Lighting control via the microwave sensor integrated in the tube.

- Integrated 5.8 GHz microwave sensor
- Available in three lengths: 600 mm, 1 200 mm, 1 500 mm
- Detection range up to 5 m
- 2-step dimming: 100 % (5 min), then 20 % (2 min), then off
- Also works in closed luminaires



LED TUBE T8 EM FOOD P
Operation on CCG and AC mains

A burst of freshness for food presentation thanks to a high R9 value.

- Similar spectrum to traditional NATURA (76) lamps with a high R9 value
- Available in four lengths: 600 mm, 900 mm, 1 200 mm, 1 500 mm
- Luminous flux up to 1 700 lm
- Ideal for meat processing plants, butchers, supermarkets



LED TUBE T9 EM V
Operation on CCG and AC mains

A great all-rounder: the efficient LED alternative for traditional T9 fluorescent lamps.

- Retrofit solution without rewiring
- Suitable for many luminaires thanks to rotatable base
- Uniform illumination
- Lifetime of 30 000h¹



¹L70/B50

LEDVANCE LED TUBE T5

LOWER MAINTENANCE COSTS, HIGHER LIGHT QUALITY

LED TUBE T5 are the right energy-efficient and SLR-compliant replacement for conventional T5 HO or T5 HE fluorescent tubes. Available as LED TUBE T5 HF for operation on ECG² or as LED TUBE T5 AC Mains for operation directly on mains voltage (AC). What's particularly convenient is that you can keep using existing luminaires.



THE BENEFITS OF BOTH PRODUCT SEGMENTS AT A GLANCE:

- Maximum luminous flux of up to 5600 lm
- Low-flicker according to EU 2019/2020 (SVM \leq 0.4; P_{st}LM \leq 1)
- Shatter-proof glass tubes
- Lifetime of up to 50 000 h¹



LED TUBE T5 HF P

Operation on ECG²

- High energy savings and longer lifetime result in fast payback times
- Quick and easy installation
- Operation on compatible ECG^{2,3}
- Shatter-proof glass tubes

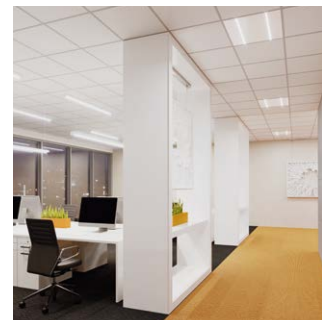

LED TUBE T5 AC MAINS P

Operation on AC mains

- Rewired directly on AC mains
- Removes any compatibility issues and energy losses from the control gear
- Eliminating maintenance costs associated with ballast replacements
- Shatter-proof glass tube



¹ L70/B50 | ² Check ECG compatibility at ledvance.com/compatibility or ledvance.com/tubefinder
³ Non-compatible with a direct mains voltage connection, 220–240 V AC

WE’LL HELP YOU CHOOSE THE RIGHT LED TUBE

T5 LUMINAIRE WITH G5 BASE



Existing ECG compatible with LED TUBE T5 HF



RETROFIT with LED TUBE T5 HF



Existing ECG **not** compatible with LED TUBE T5 HF



CONVERSION with TUBE T5 AC MAINS

T8 LUMINAIRE WITH G13 BASE



with starter



RETROFIT: ON CCG with LED TUBE T8 EM or UNIVERSAL



CONVERSION with LED TUBE T8 EM or UNIVERSAL

Existing ECG **not** compatible with LED TUBE T8 HF/ UNIVERSAL



Existing ECG compatible with LED TUBE T8 HF/ UNIVERSAL



CONVERSION with LED TUBE T8 EM or UNIVERSAL



RETROFIT: ON ECG with LED TUBE T8 HF or UNIVERSAL

FIND THE RIGHT TECHNOLOGY: EM OR HF

Are you wondering which technology you need for your luminaire with T8 fluorescent lamp – an EM lamp or an HF lamp? Our insider tip reveals two easy ways to find out.

STARTER TEST

Check whether the luminaire you want to fit the new lamp in has a starter. If it does, you need an **LED TUBE T8 EM** for operation on a CCG. If not, use an ECG-compatible version, either **LED TUBE HF** or **UNIVERSAL**.

CAMERA TEST

If the luminaire still has a working T8 lamp, take a look at it through a digital camera (such as the one on your smartphone or tablet). If the light flickers, you need an **LED TUBE T8 EM** for operation on a CCG. Otherwise use an ECG-compatible version, either **LED TUBE HF** or **UNIVERSAL**. For the test, we recommend a maximum distance from the digital camera to the light of 30 cm.

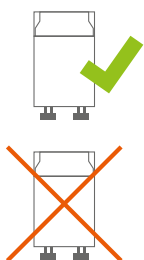

LED TUBE EM

LED TUBE HF

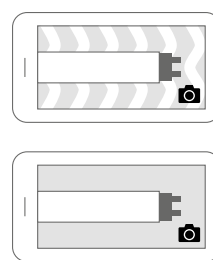

LED TUBE EM

LED TUBE HF



ALL MATERIALS IN ONE PACKAGE – THE LEDVANCE CONVERSION KIT

The LEDVANCE conversion kit includes all the materials you need for converting T8 or T5 lamps – including step-by-step instructions. Rewiring is quick and easy with this kit.

It comes in two versions for single- or double-lamp luminaires and includes:

- WAGO connectors
- Cable ties and adhesive sockets
- New blank type plate
- Microfuse (250V T2A) with wiring
- Step-by-step instructions (available at [ledvance.com/professional/services/downloads](https://www.ledvance.com/professional/services/downloads))



For single-lamp luminaires



For double-lamp luminaires

NOTE: The conversion kit is available in combination with selected LED tubes. For ordering information, [see page 22](#).

RETROFIT OR CONVERSION: WHICH PROCESS IS THE RIGHT ONE?

RETROFIT

ADVANTAGES

- Easiest installation
- Lowest installation costs

DISADVANTAGES

- Compatibility check required for ECG¹

CONVERSION

ADVANTAGES

- No compatibility issues
- Maximum efficiency and no ballast maintenance

DISADVANTAGES

- Higher installation costs
- More complex installation and additional material required
- New CE declaration needed for luminaire

¹Check ECG compatibility at [ledvance.com/compatibility](https://www.ledvance.com/compatibility) or [ledvance.com/tubefinder](https://www.ledvance.com/tubefinder)

INSTALLATION INSTRUCTIONS

REPLACEMENT MADE EASY

RETROFIT IN T8 LUMINAIRE WITH CCG

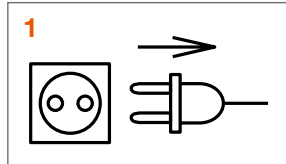

1 Disconnect luminaire from mains

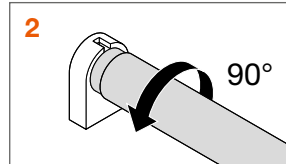

2 Unscrew and remove conventional T8 lamp

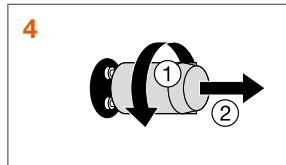
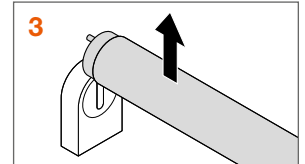

4 Remove conventional starter

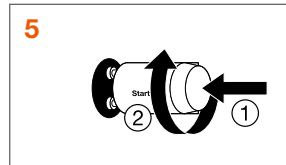

5 Replace with LED TUBE starter supplied in the EM/UNIVERSAL package.

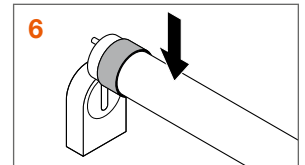

6 Insert LED TUBE T8 EM/UNIVERSAL

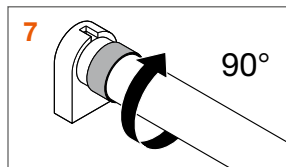

7 Screw in LED TUBE T8 EM/UNIVERSAL

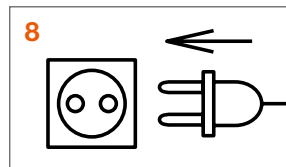

8 Turn on power

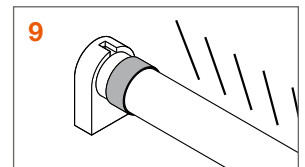

That's it!

RETROFIT IN T8 OR T5 LUMINAIRE WITH ECG

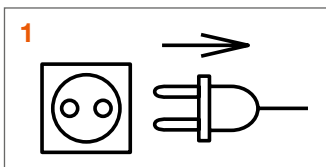

1 Disconnect luminaire from the mains

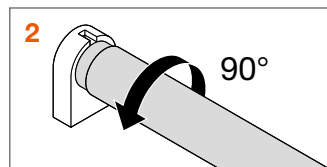

2 Unscrew and remove conventional T8 or T5 lamp

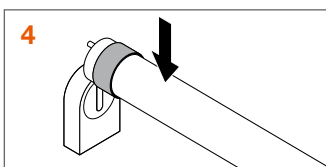
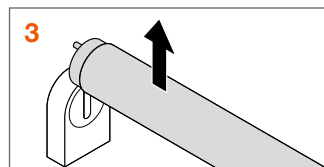

4 Insert and screw in LED TUBE T8 HF/UNIVERSAL or T5 HF

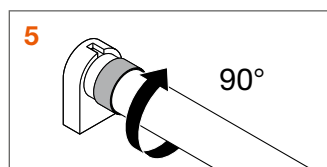

5 Turn on power

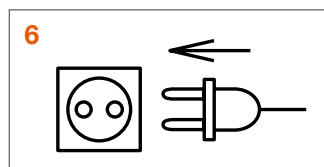

That's it!

Check ECG compatibility at ledvance.com/compatibility or www.ledvance.com/tubefinder



CONVERSION OF T8 OR T5 LUMINAIRES

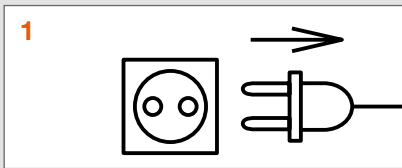

1 Disconnect luminaire from mains

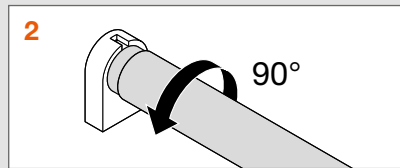

2 Unscrew and remove conventional T8 or T5 lamp

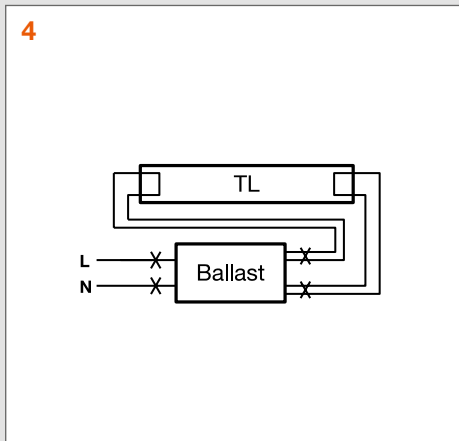
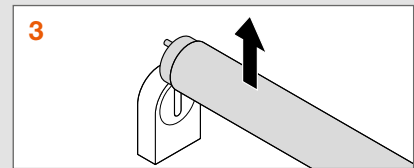

4 Remove ECG/CCG from the luminaire
For CCG: also remove capacitors for reactive power compensation

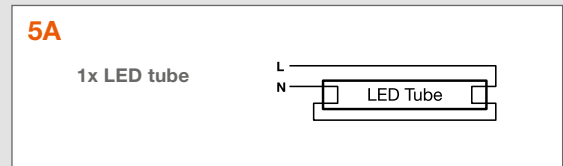

5A Rewiring following wiring diagram for single-lamp luminaires

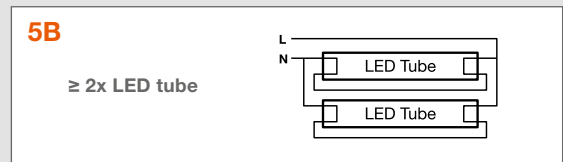

5B Rewiring following wiring diagram for multi-lamp luminaires

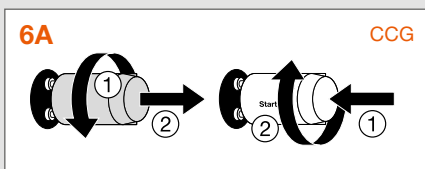

6A Replace conventional starter with LED TUBE starter supplied in the T8 EM/UNIVERSAL package

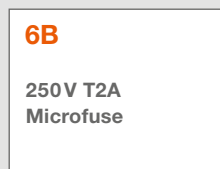

6B Insert microfuse (250V, T2A)

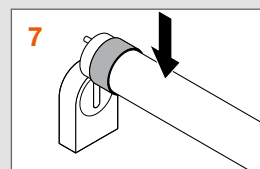

7 Insert and screw in LED TUBE T8 or T5

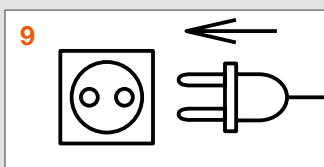
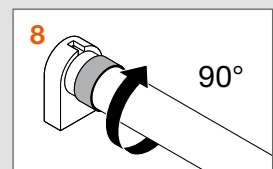

9 Turn on power

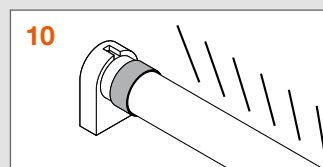

10 That's it!

IMPORTANT!

- A new CE declaration label has to be placed on the luminaire after the modification. For this purpose, testing following legal and safety requirements and technical standards such as DIN VDE 0701-0702 and DIN EN60598-1 is recommended.
- Affix a new type plate to the luminaire and obscure the old type plate.

NOTES

- The rewiring may only be carried out by qualified electricians.
- After rewiring, fluorescent lamps may no longer be used in the luminaire, only LED tubes. This should be mentioned on the luminaire's new type plate, for example. The LEDVANCE LED tubes are already provided with an appropriate sticker.

LED TUBES



wΔW Power in W for conventional technology

Product name	GTIN (EAN)	Segmentation	wΔW	mm	I [mA]	W	lm	lm/W	K	CRI	°	tIn ¹	IP ²	No.
--------------	------------	--------------	-----	----	--------	---	----	------	---	-----	---	------------------	-----------------	-----



LED TUBE T8 EM ULTRA OUTPUT S – High performance LED tubes for electromagnetic control gears (CCG), shatterproof

LED TUBE T8 EM ULTRA OUTPUT S 1200 mm 14W 830	4099854037092	■	36	G13	1212	14.0	2340	167	3000	80	> 190	75000	▶	1
LED TUBE T8 EM ULTRA OUTPUT S 1200 mm 14W 840	4099854037115	■	36	G13	1212	14.0	2600	185	4000	80	> 190	75000	▶	1
LED TUBE T8 EM ULTRA OUTPUT S 1200 mm 14W 850	4099854037177	■	36	G13	1212	14.0	2600	185	5000	80	> 190	75000	▶	1
LED TUBE T8 EM ULTRA OUTPUT S 1200 mm 14W 865	4099854037191	■	36	G13	1212	14.0	2600	185	6500	80	> 190	75000	▶	1
LED TUBE T8 EM ULTRA OUTPUT S 1500 mm 22.2W 830	4099854037214	■	58	G13	1513	22.2	3690	166	3000	80	> 190	75000	▶	1
LED TUBE T8 EM ULTRA OUTPUT S 1500 mm 22.1W 840	4099854037238	■	58	G13	1513	22.1	4100	185	4000	80	> 190	75000	▶	1
LED TUBE T8 EM ULTRA OUTPUT S 1500 mm 22.1W 850	4099854037252	■	58	G13	1513	22.1	4100	185	5000	80	> 190	75000	▶	1
LED TUBE T8 EM ULTRA OUTPUT S 1500 mm 22.1W 865	4099854037276	■	58	G13	1513	22.1	4100	185	6500	80	> 190	75000	▶	1
LED TUBE T8 EM ULTRA OUTPUT S 1200 mm 14W 940	4099854037290	■	36	G13	1212	14.0	2600	185	4000	90	> 190	75000	▶	1
LED TUBE T8 EM ULTRA OUTPUT S 1500 mm 22.1W 940	4099854037313	■	58	G13	1513	22.1	4100	185	4000	90	> 190	75000	▶	1



LED TUBE T8 EM S – High performance LED tubes for electromagnetic control gears (CCG), shatterproof

LED TUBE T8 EM S 438 mm 5.1W 830	4099854037337	■	15	G13	450	5.1	810	158	3000	80	> 190	75000	▶	1
LED TUBE T8 EM S 438 mm 5.1W 840	4099854037351	■	15	G13	450	5.1	900	176	4000	80	> 190	75000	▶	1
LED TUBE T8 EM S 438 mm 5.1W 865	4099854037375	■	15	G13	450	5.1	900	176	6500	80	> 190	75000	▶	1
LED TUBE T8 EM S 600 mm 6.3W 830	4099854037399	■	18	G13	603	6.3	990	157	3000	80	> 190	75000	▶	1
LED TUBE T8 EM S 600 mm 6.3W 840	4099854037412	■	18	G13	603	6.3	1100	174	4000	80	> 190	75000	▶	1
LED TUBE T8 EM S 600 mm 6.3W 865	4099854037436	■	18	G13	603	6.3	1100	174	6500	80	> 190	75000	▶	1
LED TUBE T8 EM S 900 mm 9.7W 830	4099854037450	■	30	G13	908	9.7	1530	157	3000	80	> 190	75000	▶	1
LED TUBE T8 EM S 900 mm 9.7W 840	4099854037474	■	30	G13	908	9.7	1700	175	4000	80	> 190	75000	▶	1
LED TUBE T8 EM S 900 mm 9.7W 865	4099854037498	■	30	G13	908	9.7	1700	175	6500	80	> 190	75000	▶	1
LED TUBE T8 EM S 1050 mm 11.4W 830	4099854037511	■	38	G13	1060	11.4	1800	157	3000	80	> 190	75000	▶	1
LED TUBE T8 EM S 1050 mm 11.4W 840	4099854037535	■	38	G13	1060	11.4	2000	175	4000	80	> 190	75000	▶	1
LED TUBE T8 EM S 1050 mm 11.4W 865	4099854037559	■	38	G13	1060	11.4	2000	175	6500	80	> 190	75000	▶	1
LED TUBE T8 EM S 1200 mm 12W 830	4099854037573	■	36	G13	1212	12.0	1890	157	3000	80	> 190	75000	▶	1
LED TUBE T8 EM S 1200 mm 12W 840	4099854037597	■	36	G13	1212	12.0	2100	175	4000	80	> 190	75000	▶	1
LED TUBE T8 EM S 1200 mm 12W 865	4099854037610	■	36	G13	1212	12.0	2100	175	6500	80	> 190	75000	▶	1
LED TUBE T8 EM S 1500 mm 17.7W 830	4099854037634	■	58	G13	1513	17.7	2790	157	3000	80	> 190	75000	▶	1
LED TUBE T8 EM S 1500 mm 17.7W 840	4099854037658	■	58	G13	1513	17.7	3100	175	4000	80	> 190	75000	▶	1
LED TUBE T8 EM S 1500 mm 17.7W 865	4099854037672	■	58	G13	1513	17.7	3100	175	6500	80	> 190	75000	▶	1



LED TUBE T8 EM ULTRA OUTPUT P – LED tubes for electromagnetic control gear (CCG), shatterproof

LED TUBE T8 EM ULTRA OUTPUT P 1200 mm 15.6W 830	4099854036774	■	36	G13	1200	15.6	2250	144	3000	80	> 190	60000	▶	1
LED TUBE T8 EM ULTRA OUTPUT P 1200 mm 15.6W 840	4099854036835	■	36	G13	1200	15.6	2500	160	4000	80	> 190	60000	▶	1
LED TUBE T8 EM ULTRA OUTPUT P 1200 mm 15.6W 865	4099854036873	■	36	G13	1200	15.6	2500	160	6500	80	> 190	60000	▶	1
LED TUBE T8 EM ULTRA OUTPUT P 1500 mm 23.1W 830	4099854037016	■	58	G13	1500	23.1	3330	144	3000	80	> 190	60000	▶	1
LED TUBE T8 EM ULTRA OUTPUT P 1500 mm 23.1W 840	4099854037030	■	58	G13	1500	23.1	3700	160	4000	80	> 190	60000	▶	1
LED TUBE T8 EM ULTRA OUTPUT P 1500 mm 23.1W 865	4099854037054	■	58	G13	1500	23.1	3700	160	6500	80	> 190	60000	▶	1



LED TUBE T8 EM P – LED tubes for electromagnetic control gear (CCG), shatterproof

LED TUBE T8 EM P 600 mm 7W 830	4099854036958	■	18	G13	603	7.0	990	141	3000	80	> 190	60000	▶	1
LED TUBE T8 EM P 600 mm 7W 840	4099854036972	■	18	G13	603	7.0	1100	157	4000	80	> 190	60000	▶	1
LED TUBE T8 EM P 600 mm 7W 865	4099854036996	■	18	G13	603	7.0	1100	157	6500	80	> 190	60000	▶	1
LED TUBE T8 EM P 1200 mm 13.5W 830	4099854036897	■	36	G13	1212	13.5	1890	140	3000	80	> 190	60000	▶	1
LED TUBE T8 EM P 1200 mm 13.5W 840	4099854036910	■	36	G13	1212	13.5	2100	155	4000	80	> 190	60000	▶	1
LED TUBE T8 EM P 1200 mm 13.5W 865	4099854036934	■	36	G13	1212	13.5	2100	155	6500	80	> 190	60000	▶	1
LED TUBE T8 EM P 1500 mm 20W 830	4099854037078	■	58	G13	1513	20.0	2790	139	3000	80	> 190	60000	▶	1
LED TUBE T8 EM P 1500 mm 20W 840	4099854037139	■	58	G13	1513	20.0	3100	155	4000	80	> 190	60000	▶	1
LED TUBE T8 EM P 1500 mm 20W 865	4099854037153	■	58	G13	1513	20.0	3100	155	6500	90	> 190	60000	▶	1

■ SUPERIOR CLASS ■ PERFORMANCE CLASS ■ VALUE CLASS



Further information about the LED Tubes products can be found at ledvance.com/tubes

¹ L70/B50 | ² Energy efficiency class (EEC) on a scale of A (highest efficiency) to G (lowest efficiency)
³ Refer to www.ledvance.com/guarantee for precise conditions

Product name	GTIN (EAN)	Segmentation										
--------------	------------	--------------	--	--	--	--	--	--	--	--	--	--

LED TUBE T8 EM ULTRA OUTPUT V – Economic LED tubes for electromagnetic control gears (CCG)

LED TUBE T8 EM ULTRA OUTPUT V 1200 mm 20W 830	4099854 038327	■	36	G13	1213	20.0	2160	108	3000	80	> 190	30000		1
LED TUBE T8 EM ULTRA OUTPUT V 1200 mm 20W 840	4099854 038402	■	36	G13	1213	20.0	2400	120	4000	80	> 190	30000		1
LED TUBE T8 EM ULTRA OUTPUT V 1200 mm 20W 865	4099854 038525	■	36	G13	1213	20.0	2400	120	6500	≥ 80	> 190	30000		1
LED TUBE T8 EM ULTRA OUTPUT V 1500 mm 29W 830	4099854 038624	■	58	G13	1514	29.0	3150	108	3000	80	> 190	30000		1
LED TUBE T8 EM ULTRA OUTPUT V 1500 mm 29W 840	4099854 038662	■	58	G13	1514	29.0	3500	120	4000	80	> 190	30000		1
LED TUBE T8 EM ULTRA OUTPUT V 1500 mm 29W 865	4099854 038747	■	58	G13	1514	29.0	3500	120	6500	80	> 190	30000		1

LED TUBE T8 EM V – Economic LED tubes for electromagnetic control gears (CCG)

LED TUBE T8 EM V 438 mm 5.4W 830	4099854 038907	■	15	G13	451	5.4	585	108	3000	80	> 190	30000		1
LED TUBE T8 EM V 438 mm 5.4W 840	4099854 038921	■	15	G13	451	5.4	650	120	4000	80	> 190	30000		1
LED TUBE T8 EM V 438 mm 5.4W 865	4099854 038945	■	15	G13	451	5.4	650	120	6500	80	> 190	30000		1
LED TUBE T8 EM V 600 mm 6.6W 830	4099854 038969	■	18	G13	604	6.6	720	109	3000	80	> 190	30000		1
LED TUBE T8 EM V 600 mm 6.6W 840	4099854 038983	■	18	G13	604	6.6	800	121	4000	80	> 190	30000		1
LED TUBE T8 EM V 600 mm 6.6W 865	4099854 039003	■	18	G13	604	6.6	800	121	6500	80	> 190	30000		1
LED TUBE T8 EM V 720 mm 7W 830	4099854 039027	■	16	G13	734	7.0	765	109	3000	80	> 190	30000		1
LED TUBE T8 EM V 720 mm 7W 840	4099854 039041	■	16	G13	734	7.0	850	121	4000	80	> 190	30000		1
LED TUBE T8 EM V 720 mm 7W 865	4099854 039065	■	16	G13	734	7.0	850	121	6500	80	> 190	30000		1
LED TUBE T8 EM V 900 mm 10W 830	4099854 039102	■	30	G13	908	10.0	1080	108	3000	80	> 190	30000		1
LED TUBE T8 EM V 900 mm 10W 840	4099854 039126	■	30	G13	908	10.0	1200	120	4000	80	> 190	30000		1
LED TUBE T8 EM V 900 mm 10W 865	4099854 039164	■	30	G13	908	10.0	1200	120	6500	80	> 190	30000		1
LED TUBE T8 EM V 1050 mm 11.6W 830	4099854 039201	■	38	G13	1061	11.6	1260	108	3000	80	> 190	30000		1
LED TUBE T8 EM V 1050 mm 11.6W 840	4099854 039249	■	38	G13	1061	11.6	1400	120	4000	≥80	> 190	30000		1
LED TUBE T8 EM V 1050 mm 11.6W 865	4099854 038488	■	38	G13	1061	11.6	1400	120	6500	80	> 190	30000		1
LED TUBE T8 EM V 1200 mm 15W 830	4099854 038143	■	36	G13	1213	15.0	1620	108	3000	80	> 190	30000		1
LED TUBE T8 EM V 1200 mm 15W 840	4099854 038167	■	36	G13	1213	15.0	1800	120	4000	80	> 190	30000		1
LED TUBE T8 EM V 1200 mm 15W 865	4099854 038181	■	36	G13	1213	15.0	1800	120	6500	80	> 190	30000		1
LED TUBE T8 EM V 1500 mm 18.3W 830	4099854 038204	■	58	G13	1514	18.3	2000	109	3000	80	> 190	30000		1
LED TUBE T8 EM V 1500 mm 18.3W 840	4099854 038228	■	58	G13	1514	18.3	2200	120	4000	80	> 190	30000		1
LED TUBE T8 EM V 1500 mm 18.3W 865	4099854 038242	■	58	G13	1514	18.3	2200	120	6500	80	> 190	30000		1

LED TUBE T8 EM MOTION SENSOR P – LED tubes with integrated microwave sensor for electromagnetic control gears (CCG), shatterproof

LED TUBE T8 EM MOTION SENSOR P 600 mm 6.8W 840	4099854 044472	■	18	G13	603	6.8	1100	161	4000	80	> 190	60000		1
LED TUBE T8 EM MOTION SENSOR P 1200 mm 13.1W 840	4099854 044960	■	36	G13	1212	13.1	2100	160	4000	80	> 190	60000		1
LED TUBE T8 EM MOTION SENSOR P 1500 mm 19.3W 840	4099854 045066	■	58	G13	1513	19.3	3100	160	4000	80	> 190	60000		1

LED TUBE T8 EM FOOD P – LED tubes for electromagnetic control gears (CCG), shatterproof, for food presentation

LED TUBE T8 EM FOOD P 600 mm 5.2W 833	4099854 044793	■	18	G13	603	5.2	500	96	3300	80	> 190	60000	–	1
LED TUBE T8 EM FOOD P 900 mm 7.9W 833	4099854 045226	■	30	G13	908	7.9	750	94	3300	80	> 190	60000	–	1
LED TUBE T8 EM FOOD P 1200 mm 11.6W 833	4099854 045004	■	36	G13	1212	11.6	1100	94	3300	80	> 190	60000	–	1
LED TUBE T8 EM FOOD P 1500 mm 17.9W 833	4099854 045127	■	58	G13	1513	17.9	1700	94	3300	80	> 190	60000	–	1

LED TUBE T8 EM CONNECTED P – LED tube for electromagnetic control gears works with Connected Sensors

LED TUBE T8 EM CON P 600 mm 7.5W 840	4058075 823938	■	18	G13	603	7.5	1100	146	4000	80	160	50000		2
LED TUBE T8 EM CON P 600 mm 7.5W 865	4058075 823952	■	18	G13	603	7.5	1100	146	6500	80	160	50000		2
LED TUBE T8 EM CON P 1200 mm 16W 840	4058075 823976	■	36	G13	1213	16.0	2400	150	4000	80	160	50000		2
LED TUBE T8 EM CON P 1200 mm 16W 865	4058075 823990	■	36	G13	1213	16.0	2400	150	6500	80	160	50000		2
LED TUBE T8 EM CON P 1500 mm 24W 840	4058075 824010	■	58	G13	1513	24.0	3600	150	4000	80	160	50000		2
LED TUBE T8 EM CON P 1500 mm 24W 865	4058075 824034	■	58	G13	1513	24.0	3600	150	6500	80	160	50000		2

Product name	GTIN (EAN)		
--------------	------------	--	--

LED TUBE T8 EM STARTER – Starter for LED TUBE T8 EM (CCG)

LED TUBE T8 EM STARTER	4099854 067150	40	20	3
------------------------	-----------------------	----	----	---



Further information about the LED Tubes products can be found at ledvance.com/tubes

■ SUPERIOR CLASS ■ PERFORMANCE CLASS ■ VALUE CLASS

¹ L70/B50 | ² Energy efficiency class (EEC) on a scale of A (highest efficiency) to G (lowest efficiency)
³ Refer to www.ledvance.com/guarantee for precise conditions

LED TUBES



wΔW Power in W for conventional technology

Product name	GTIN (EAN)	INFRARED	L × W × H [mm]	°	V _{DC}	t _{in} ¹	kHz ECG	IP	No.
--------------	------------	----------	----------------	---	-----------------	------------------------------	---------	----	-----

LEDVANCE CONNECTED SENSOR – Sensor for LED TUBE Connected TUBE									
CONNECTED SENSOR LB	4058075232969	Passive infrared (PIR)	95 × 95 × 65	360	220...240	50000	50	27	1
CONNECTED SENSOR HB	4058075232983	Passive infrared (PIR)	95 × 95 × 65	180	220...240	50000	50	27	1

LEDVANCE CONNECTED SENSOR REMOTE – Connected Sensor Remote for LEDVANCE Connected Sensor HB and LB									
CONNECTED SENSOR REMOTE CONTROL	4058075374034	—	58 × 94 × 8	15	—	—	—	10	2

Product name	GTIN (EAN)	Segmentation	wΔW	Im	l [mm]	W	lm	lm/W	K	CRI	°	t _{in} ¹	IP	No.
--------------	------------	--------------	-----	----	--------	---	----	------	---	-----	---	------------------------------	----	-----

LED TUBE T8 UNIVERSAL ULTRA OUTPUT P – LED tubes for electronic control gears (ECG), electromagnetic control gears (CCG) and mains, shatterproof														
LED TUBE T8 UNIVERSAL ULTRA OUTPUT P 1200 mm 15W 840	4099854026294	■	36	G13	1211	15.0	2400	160	4000	80	190	60000	IP20	3
LED TUBE T8 UNIVERSAL ULTRA OUTPUT P 1200 mm 15W 865	4099854026331	■	36	G13	1211	15.0	2400	160	6500	80	190	60000	IP20	3
LED TUBE T8 UNIVERSAL ULTRA OUTPUT P 1500 mm 23W 840	4099854026577	■	58	G13	1513	23.0	3700	160	4000	80	190	60000	IP20	4
LED TUBE T8 UNIVERSAL ULTRA OUTPUT P 1500 mm 23W 865	4099854026591	■	58	G13	1513	23.0	3700	160	6500	80	190	60000	IP20	4

LED TUBE T8 UNIVERSAL P – LED tubes for electronic control gears (ECG), electromagnetic control gears (CCG) and mains, shatterproof														
LED TUBE T8 UNIVERSAL P 600 mm 7.5W 830	4099854026119	■	18	G13	603	7.5	1100	146	3000	80	190	60000	IP20	5
LED TUBE T8 UNIVERSAL P 600 mm 7.5W 840	4099854026157	■	18	G13	603	7.5	1100	146	4000	80	190	60000	IP20	5
LED TUBE T8 UNIVERSAL P 600 mm 7.5W 865	4099854026218	■	18	G13	603	7.5	1000	133	6500	80	190	60000	IP20	5
LED TUBE T8 UNIVERSAL P 1200 mm 14W 830	4099854026492	■	36	G13	1211	14.0	1900	135	3000	80	190	60000	IP20	3
LED TUBE T8 UNIVERSAL P 1200 mm 14W 840	4099854026393	■	36	G13	1211	14.0	2100	150	4000	80	190	60000	IP20	3
LED TUBE T8 UNIVERSAL P 1200 mm 14W 865	4099854026430	■	36	G13	1211	14.0	2100	150	6500	80	190	60000	IP20	3
LED TUBE T8 UNIVERSAL P 1500 mm 20W 830	4099854026652	■	58	G13	1513	20.0	2800	140	3000	80	190	60000	IP20	4
LED TUBE T8 UNIVERSAL P 1500 mm 20W 840	4099854026614	■	58	G13	1513	20.0	3100	155	4000	80	190	60000	IP20	4
LED TUBE T8 UNIVERSAL P 1500 mm 20W 865	4099854026638	■	58	G13	1513	20.0	3100	155	6500	80	190	60000	IP20	4

LED TUBE T8 UNIVERSAL V – LED tubes for electronic control gears (ECG), electromagnetic control gears (CCG) and mains														
LED TUBE T8 UNIVERSAL V 600 mm 8W 830	4099854026515	■	18	G13	603	8.0	800	100	3000	80	190	30000	IP20	5
LED TUBE T8 UNIVERSAL V 600 mm 8W 840	4099854026539	■	18	G13	603	8.0	900	112	4000	80	190	30000	IP20	5
LED TUBE T8 UNIVERSAL V 600 mm 8W 865	4099854026553	■	18	G13	603	8.0	900	112	6500	80	190	30000	IP20	5
LED TUBE T8 UNIVERSAL V 1200 mm 18W 830	4099854026317	■	36	G13	1211	18.0	1850	102	3000	80	190	30000	IP20	3
LED TUBE T8 UNIVERSAL V 1200 mm 18W 840	4099854026355	■	36	G13	1211	18.0	2000	111	4000	80	190	30000	IP20	3
LED TUBE T8 UNIVERSAL V 1200 mm 18W 865	4099854026379	■	36	G13	1211	18.0	2000	111	6500	80	190	30000	IP20	3
LED TUBE T8 UNIVERSAL V 1500 mm 24W 830	4099854026416	■	58	G13	1513	24.0	2550	106	3000	80	190	30000	IP20	4
LED TUBE T8 UNIVERSAL V 1500 mm 24W 840	4099854026454	■	58	G13	1513	24.0	2800	116	4000	80	190	30000	IP20	4
LED TUBE T8 UNIVERSAL V 1500 mm 24W 865	4099854026478	■	58	G13	1513	24.0	2800	116	6500	80	190	30000	IP20	4

LED TUBE T8 HF ULTRA OUTPUT P – LED tubes for electronic high frequency control gears (ECG), shatterproof														
LED TUBE T8 HF ULTRA OUTPUT P 1200 mm 15W 840	4099854026133	■	36	G13	1211	15.0	2400	160	4000	80	190	75000	IP20	3
LED TUBE T8 HF ULTRA OUTPUT P 1200 mm 15W 865	4099854026171	■	36	G13	1211	15.0	2400	160	6500	80	190	75000	IP20	3
LED TUBE T8 HF ULTRA OUTPUT P 1500 mm 23W 840	4099854026195	■	58	G13	1513	23.0	3700	160	4000	80	190	75000	IP20	4
LED TUBE T8 HF ULTRA OUTPUT P 1500 mm 23W 865	4099854026232	■	58	G13	1513	23.0	3700	160	6500	80	190	75000	IP20	4

LED TUBE T8 HF P – LED tubes for electronic high frequency control gears (ECG), shatterproof														
LED TUBE T8 HF P 600 mm 7.5W 830	4099854026058	■	18	G13	603	7.5	1000	133	3000	80	190	75000	IP20	5
LED TUBE T8 HF P 600 mm 7.5W 840	4099854026072	■	18	G13	603	7.5	1100	146	4000	80	190	75000	IP20	5
LED TUBE T8 HF P 600 mm 7.5W 865	4099854026096	■	18	G13	603	7.5	1100	146	6500	80	190	75000	IP20	5
LED TUBE T8 HF P 1200 mm 14W 830	4099854025914	■	36	G13	1211	14.0	1900	135	3000	80	190	75000	IP20	3

■ SUPERIOR CLASS ■ PERFORMANCE CLASS ■ VALUE CLASS



Check ECG compatibility at ledvance.com/compatibility or ledvance.com/tubefinder

¹ L70/B50 | ² Refer to www.ledvance.com/guarantee for precise conditions | ³ Energy efficiency class (EEC) on a scale of A (highest efficiency) to G (lowest efficiency) | ⁴ Check ECG compatibility at ledvance.com/compatibility or ledvance.com/tubefinder

Product name	GTIN (EAN)	Segmentation													
LED TUBE T8 HF P – LED tubes for electronic high frequency control gears (ECG), shatterproof															
LED TUBE T8 HF P 1200 mm 14W 840	4099854025938	■	36	G13	1211	14.0	2100	150	4000	80	190	75000			
LED TUBE T8 HF P 1200 mm 14W 865	4099854025952	■	36	G13	1211	14.0	2100	150	6500	80	190	75000			
LED TUBE T8 HF P 1500 mm 20W 830	4099854025976	■	58	G13	1513	20.0	2800	140	3000	80	190	75000			
LED TUBE T8 HF P 1500 mm 20W 840	4099854025990	■	58	G13	1513	20.0	3100	155	4000	80	190	75000			
LED TUBE T8 HF P 1500 mm 20W 865	4099854026010	■	58	G13	1513	20.0	3100	155	6500	80	190	75000			
LED TUBE T8 HF V – Economic LED tubes for electronic high frequency control gears (ECG)															
LED TUBE T8 HF V 600 mm 8W 840	4099854026256	■	18	G13	603	8.0	900	112	4000	80	190	30000			
LED TUBE T8 HF V 600 mm 8W 865	4099854026270	■	18	G13	603	8.0	900	112	6500	80	190	30000			
LED TUBE T5 HF P – LED tubes for electronic high frequency control gears															
LED TUBE T5 HF HE14 P 549 mm 7W 830	4099854029448	■	14	G5	549	7.0	900	128	3000	80	190	50000			
LED TUBE T5 HF HE14 P 549 mm 7W 840	4099854029462	■	14	G5	549	7.0	1000	142	4000	80	190	50000			
LED TUBE T5 HF HE14 P 549 mm 7W 865	4099854029486	■	14	G5	549	7.0	1000	142	6500	80	190	50000			
LED TUBE T5 HF HE21 P 849 mm 10W 830	4099854029387	■	21	G5	849	10.0	1350	135	3000	80	190	50000			
LED TUBE T5 HF HE21 P 849 mm 10W 840	4099854029400	■	21	G5	849	10.0	1500	150	4000	80	190	50000			
LED TUBE T5 HF HE21 P 849 mm 10W 865	4099854029424	■	21	G5	849	10.0	1500	150	6500	80	190	50000			
LED TUBE T5 HF HE28 P 1149 mm 16W 830	4099854029325	■	28	G5	1149	16.0	2160	135	3000	80	190	50000			
LED TUBE T5 HF HE28 P 1149 mm 16W 840	4099854029349	■	28	G5	1149	16.0	2400	150	4000	80	190	50000			
LED TUBE T5 HF HE28 P 1149 mm 16W 865	4099854029363	■	28	G5	1149	16.0	2400	150	6500	80	190	50000			
LED TUBE T5 HF HE35 P 1449 mm 18W 830	4099854029172	■	35	G5	1449	18.0	2550	141	3000	80	190	50000			
LED TUBE T5 HF HE35 P 1449 mm 18W 840	4099854029196	■	35	G5	1449	18.0	2800	155	4000	80	190	50000			
LED TUBE T5 HF HE35 P 1449 mm 18W 865	4099854029219	■	35	G5	1449	18.0	2800	155	6500	80	190	50000			
LED TUBE T5 HF HO49 P 1449 mm 26W 830	4099854029110	■	49	G5	1449	26.0	3600	138	3000	80	190	50000			
LED TUBE T5 HF HO49 P 1449 mm 26W 840	4099854029134	■	49	G5	1449	26.0	4000	153	4000	80	190	50000			
LED TUBE T5 HF HO49 P 1449 mm 26W 865	4099854029158	■	49	G5	1449	26.0	4000	153	6500	80	190	50000			
LED TUBE T5 HF HO54 P 1149 mm 26W 830	4099854029257	■	54	G5	1149	26.0	3600	138	3000	80	190	50000			
LED TUBE T5 HF HO54 P 1149 mm 26W 840	4099854029271	■	54	G5	1149	26.0	4000	153	4000	80	190	50000			
LED TUBE T5 HF HO54 P 1149 mm 26W 865	4099854029301	■	54	G5	1149	26.0	4000	153	6500	80	190	50000			
LED TUBE T5 HF HO80 P 1449 mm 36W 830	4099854029059	■	80	G5	1449	36.0	5050	140	3000	80	190	50000			
LED TUBE T5 HF HO80 P 1449 mm 36W 840	4099854029073	■	80	G5	1449	36.0	5600	155	4000	80	190	50000			
LED TUBE T5 HF HO80 P 1449 mm 36W 865	4099854029097	■	80	G5	1449	36.0	5600	155	6500	80	190	50000			
LED TUBE T5 AC MAINS P – LED tubes for operation on AC mains connection															
LED TUBE T5 AC HE14 P 549 mm 7W 830	4058075824416	■	14	G5	549	7.0	900	128	3000	80	190	50000			
LED TUBE T5 AC HE14 P 549 mm 7W 840	4058075824430	■	14	G5	549	7.0	1000	142	4000	80	190	50000			
LED TUBE T5 AC HE14 P 549 mm 7W 865	4058075824454	■	14	G5	549	7.0	1000	142	6500	80	190	50000			
LED TUBE T5 AC HE21 P 849 mm 10W 830	4058075824355	■	21	G5	849	10.0	1350	135	3000	80	190	50000			
LED TUBE T5 AC HE21 P 849 mm 10W 840	4058075824379	■	21	G5	849	10.0	1500	150	4000	80	190	50000			
LED TUBE T5 AC HE21 P 849 mm 10W 865	4058075824393	■	21	G5	849	10.0	1500	150	6500	80	190	50000			
LED TUBE T5 AC HO24 P 549 mm 10W 830	4099854081200	■	24	G5	549	10.0	1350	135	3000	80	190	50000			
LED TUBE T5 AC HO24 P 549 mm 10W 840	4099854081224	■	24	G5	549	10.0	1500	150	4000	80	190	50000			
LED TUBE T5 AC HO24 P 549 mm 10W 865	4099854081248	■	24	G5	549	10.0	1500	150	6500	80	190	50000			
LED TUBE T5 AC HO39 P 849 mm 16W 830	4099854081149	■	39	G5	849	16.0	2160	135	3000	80	190	50000			
LED TUBE T5 AC HO39 P 849 mm 16W 840	4099854081163	■	39	G5	849	16.0	2400	150	4000	80	190	50000			
LED TUBE T5 AC HO39 P 849 mm 16W 865	4099854081187	■	39	G5	849	16.0	2400	150	6500	80	190	50000			
LED TUBE T5 AC HE28 P 1149 mm 16W 830	4058075824294	■	28	G5	1149	16.0	2150	134	3000	80	190	50000			
LED TUBE T5 AC HE28 P 1149 mm 16W 840	4058075824317	■	28	G5	1149	16.0	2400	150	4000	80	190	50000			
LED TUBE T5 AC HE28 P 1149 mm 16W 865	4058075824331	■	28	G5	1149	16.0	2400	150	6500	80	190	50000			
LED TUBE T5 AC HE35 P 1449 mm 18W 830	4058075824232	■	35	G5	1449	18.0	2550	141	3000	80	190	50000			
LED TUBE T5 AC HE35 P 1449 mm 18W 840	4058075824256	■	35	G5	1449	18.0	2800	155	4000	80	190	50000			
LED TUBE T5 AC HE35 P 1449 mm 18W 865	4058075824270	■	35	G5	1449	18.0	2800	155	6500	80	190	50000			
LED TUBE T5 AC HO49 P 1449 mm 26W 830	4058075824171	■	49	G5	1449	26.0	3600	138	3000	80	190	50000			
LED TUBE T5 AC HO49 P 1449 mm 26W 840	4058075824195	■	49	G5	1449	26.0	4000	153	4000	80	190	50000			
LED TUBE T5 AC HO49 P 1449 mm 26W 865	4058075824218	■	49	G5	1449	26.0	4000	153	6500	80	190	50000			
LED TUBE T5 AC HO54 P 1149 mm 26W 830	4058075824119	■	54	G5	1149	26.0	3600	138	3000	80	190	50000			
LED TUBE T5 AC HO54 P 1149 mm 26W 840	4058075824133	■	54	G5	1149	26.0	4000	153	4000	80	190	50000			
LED TUBE T5 AC HO54 P 1149 mm 26W 865	4058075824157	■	54	G5	1149	26.0	4000	153	6500	80	190	50000			



Check ECG compatibility at ledvance.com/compatibility or ledvance.com/tubefinder

■ SUPERIOR CLASS ■ PERFORMANCE CLASS ■ VALUE CLASS

¹ L70/B50 | ² Energy efficiency class (EEC) on a scale of A (highest efficiency) to G (lowest efficiency) | ³ Check ECG compatibility at ledvance.com/compatibility or ledvance.com/tubefinder | ⁴ Refer to www.ledvance.com/guarantee for precise conditions

LED TUBES



wΔW Power in W for conventional technology

Product name	GTIN (EAN)	Segmentation	wΔW	W	Im	lm	lm/W	K	CRI	Δ	t(in)	1	2	No.
--------------	------------	--------------	-----	---	----	----	------	---	-----	---	-------	---	---	-----

LED TUBE T5 AC MAINS P – LED tubes for operation on AC mains connection														
LED TUBE T5 AC H080 P 1449 mm 36W 830	4058075824058	■	80	G5	1449	36.0	5050	140	3000	80	190	50000	▶	1
LED TUBE T5 AC H080 P 1449 mm 36W 840	4058075824072	■	80	G5	1449	36.0	5600	155	4000	80	190	50000	▶	1
LED TUBE T5 AC H080 P 1449 mm 36W 865	4058075824096	■	80	G5	1449	36.0	5600	155	6500	80	190	50000	▶	1

LED TUBE T5 HF SHORT V – LED tubes for electronic high frequency control gears														
LED TUBE T5 HF L8 SHORT V 288 mm 4W 830	4058075823617	■	8	G5	288	4.0	380	95	3000	80	190	30000	▶	2
LED TUBE T5 HF L8 SHORT V 288 mm 4W 840	4058075823631	■	8	G5	288	4.0	400	100	4000	80	190	30000	▶	2
LED TUBE T5 HF L13 SHORT V 517 mm 7W 830	4058075823655	■	13	G5	517	7.0	770	110	3000	80	190	30000	▶	2
LED TUBE T5 HF L13 SHORT V 517 mm 7W 840	4058075823679	■	13	G5	517	7.0	850	121	4000	80	190	30000	▶	2

LED TUBE T8 EXTERNAL P – LED TUBE T8 EXTERNAL for LED DRIVER EXTERNAL ⁵														
LED TUBE T8 EXT P 1200 mm 15W 840	4058075730595	■	36	G13	1200	15.0	2400	160	4000	80	190	50000	▶	3
LED TUBE T8 EXT P 1200 mm 15W 865	4058075730618	■	36	G13	1200	15.0	2400	160	6500	80	190	50000	▶	3
LED TUBE T8 EXT P 1500 mm 23W 840	4058075730557	■	58	G13	1500	23.0	3700	160	4000	80	190	50000	▶	3
LED TUBE T8 EXT P 1500 mm 23W 865	4058075730571	■	58	G13	1500	23.0	3700	160	6500	80	190	50000	▶	3

LED TUBE T5 EXTERNAL P – LED TUBE T5 EXTERNAL for LED DRIVER EXTERNAL ⁵														
LED TUBE T5 EXT HE35 P 1449 mm 18W 840	4058075730519	■	35	G5	1449	18.0	2800	155	4000	80	180	50000	▶	4
LED TUBE T5 EXT HE35 P 1449 mm 18W 865	4058075730533	■	35	G5	1449	18.0	2800	155	6500	80	180	50000	▶	4
LED TUBE T5 EXT H054 P 1149 mm 26W 840	4058075730472	■	54	G5	1149	26.0	4000	153	4000	80	180	50000	▶	4
LED TUBE T5 EXT H054 P 1149 mm 26W 865	4058075730496	■	54	G5	1149	26.0	4000	153	6500	80	180	50000	▶	4
LED TUBE T5 EXT H049 P 1449 mm 26W 840	4058075730434	■	49	G5	1449	26.0	4000	153	4000	80	180	50000	▶	4
LED TUBE T5 EXT H049 P 1449 mm 26W 865	4058075730458	■	49	G5	1449	26.0	4000	153	6500	80	180	50000	▶	4
LED TUBE T5 EXT H080 P 1449 mm 37W 840	4058075730410	■	80	G5	1449	37.0	5600	151	4000	80	180	50000	▶	4
LED TUBE T5 EXT H080 P 1449 mm 37W 865	4058075730397	■	80	G5	1449	37.0	5600	151	6500	80	180	50000	▶	4

Product name	GTIN (EAN)	Segmentation	W	L x W x H [mm]	t(in)	Hz	No.
--------------	------------	--------------	---	----------------	-------	----	-----

LED DRIVER LED TUBE EXTERNAL DALI P – Constant current LED DRIVER EXTERNAL for LED TUBE EXTERNAL T5/T8 – indoor							
DR EXT DALI-P -1X15-37W 220-240	4058075730632	■	38.7	286 x 31 x 21	100000	0/50/60	25
DR EXT DALI-P -2X15-26W 220-240	4058075730656	■	54.0	360 x 31 x 21	100000	0/50/60	25

Product name	GTIN (EAN)	Segmentation	wΔW	W	Im	lm	lm/W	K	CRI	Δ	t(in)	1	2	No.
--------------	------------	--------------	-----	---	----	----	------	---	-----	---	-------	---	---	-----

LED TUBE T9 EM V – Circular LED tube for electromagnetic control gear (CCG) and AC mains														
LED TUBE T9 C 22 EM V 11W 830 G10Q	4099854042447	■	22	G10q	212	11.0	1200	109	3000	≥80	110	30000	▶	7
LED TUBE T9 C 22 EM V 11W 840 G10Q	4099854042461	■	22	G10q	212	11.0	1320	120	4000	≥80	110	30000	▶	7
LED TUBE T9 C 22 EM V 11W 865 G10Q	4099854042485	■	22	G10q	212	11.0	1320	120	6500	≥80	110	30000	▶	7
LED TUBE T9 C 32 EM V 18.3W 830 G10Q	4099854042508	■	32	G10q	300	18.3	2000	109	3000	≥80	110	30000	▶	8
LED TUBE T9 C 32 EM V 18.3W 840 G10Q	4099854042522	■	32	G10q	300	18.3	2200	120	4000	≥80	110	30000	▶	8
LED TUBE T9 C 32 EM V 18.3W 865 G10Q	4099854042546	■	32	G10q	300	18.3	2200	120	6500	≥80	110	30000	▶	8
LED TUBE T9 C 40 EM V 24W 840 G10Q	4099854042560	■	40	G10q	400	24.0	2900	120	4000	≥80	110	30000	▶	9
LED TUBE T9 C 40 EM V 24W 865 G10Q	4099854042584	■	40	G10q	400	24.0	2900	120	6500	≥80	110	30000	▶	9



Check ECG compatibility at ledvance.com/compatibility or ledvance.com/tubefinder

■ SUPERIOR CLASS ■ PERFORMANCE CLASS ■ VALUE CLASS

¹ LED tubes: L70/B50, LED DRIVER EXTERNAL: at Tc = 65 °C / 10 % failure rate | ² Energy efficiency class (EEC) on a scale of A (highest efficiency) to G (lowest efficiency) | ³ Check ECG compatibility at ledvance.com/compatibility or ledvance.com/tubefinder | ⁴ Refer to www.ledvance.com/guarantee for precise conditions | ⁵ Single sided LED TUBE (one-sided DC input) complying with safety requirement acc. IEC 62776:2014. Safety protection against electrical shock in misuse (ECG/CCG/Mains operation)

ALTERNATIVE LIGHTING FOR INDUSTRY

YOUR CHALLENGE

As the RoHS Directive prohibits the use of mercury in lighting products, fluorescent lamps may no longer be placed on the market across the EU after August 25, 2023. This is not only a challenge but also a unique opportunity to upgrade warehouses and other industrial areas to energy- and CO₂-saving LED technology. LEDVANCE is the ideal partner for this.

YOUR SOLUTION

High ceilings, narrow aisles, little daylight and often harsh environments. These are ideal conditions for LEDVANCE's range of industrial products. LEDVANCE LED solutions are particularly efficient and have an extremely long life and a guarantee of up to 5 years – whether it's LED TUBE T8 EM ULTRA OUTPUT P LED tubes with a particularly high light output or the easy-to-install TRUSYS FLEX LED luminaire.

SWITCH TO LED – THE POTENTIAL SAVINGS ARE ENORMOUS



RETROFIT¹

LED TUBE T8 EM
ULTRA OUTPUT P 1500 mm
23.1 W 840
4099854037030 EAN (GTIN)



CONVERSION¹

LED TUBE T8 EM
ULTRA OUTPUT P 1500 mm
23.1 W 840
4099854037030 EAN (GTIN)



NEW INSTALLATION

TRUSYS FLEX P 50 W 840 VN
CL WT
4058075771604 EAN (GTIN)



	OLD: Traditional T8 58 W	NEW: LED TUBE T8 EM ULTRA OUTPUT P 23.1 W	Savings	NEW: LED TUBE T8 EM ULTRA OUTPUT P 23.1 W	Savings	NEW: TRUSYS FLEX P 50 W	Savings
Guarantee		5 years ²		5 years ²		5 years ²	
Efficiency	90 lm/W	160 lm/W		160 lm/W		175 lm/W	
System wattage	68 W (incl. losses at CCG) ³	24.1 W (incl. losses at CCG) ³		23.1 W (on AC)		50 W	
Average lifetime	15 000 h	60 000 h ⁴		60 000 h ⁴		80 000 h ³	
Energy consumption of project	6.8 kW	2.41 kW		2.31 kW		2.5 kW	
Energy consumption over period of operation	254 592 kWh	90 230 kWh	164 362 kWh	86 486 kWh	168 106 kWh	93 600 kWh	160 992 kWh
CO ₂ emissions (231 g/kWh) ⁴	58 811 kg	20 843 kg	37 968 kg	19 978 kg	38 832 kg	21 622 kg	37 189 kg
Total cost savings up to		63%		64%		50%	
Payback time from		2 months		2 months		5 months	

MORE INFORMATION:

[ledvance.com/professional/products/product-stories/lamp-ban-2023/applications](https://www.ledvance.com/professional/products/product-stories/lamp-ban-2023/applications)

TOTAL
COST SAVINGS
UP TO
64%

TOTAL
CO₂ SAVINGS
UP TO
66%

PAYBACK TIME
FROM
< 2 MONTHS

ENERGY
SAVINGS
UP TO
**168 106
KWH**

COST SAVINGS
FOR
ELECTRICITY
UP TO
66%

GLOBAL PARAMETERS⁵: Period of operation: 60 months, 5 years, 37 440 operating hours | Operating times: 6 days a week, 52 weeks a year, 24 hours a day | Number of light points: 100 lamps, 50 luminaires

¹Product can be operated on traditional CCG (Retrofit) or AC Mains (Conversion). | ²Refer to www.ledvance.com/guarantee for precise conditions | ³t [h]: L70/B50 at 25 °C (T_a) | ⁴2020 European level of GHG emission intensity of electricity generation (www.eea.europa.eu) | ⁵Calculation parameters: Replacement costs: Traditional T8 58 W €4.50*/piece, LED TUBE T8 EM ULTRA OUTPUT P 23.1 W €21.00*/piece, TRUSYS FLEX P 50 W incl. mounting accessories €268.50*/1.5 m piece, costs for exchanging: retrofit €10.00*/housing, conversion €15.00*/housing, new installation luminaire €15.00*/piece, electricity costs: €0.40*/kWh. *Illustrative prices. Prices may vary in your country.

LED TUBE AS A MULTIPACK

LEDVANCE CONVERSION KITS

The LEDVANCE conversion kit includes all the materials you need for converting T8 or T5 lamps – including step-by-step instructions. Rewiring is quick and easy with this kit. In addition to the kit, a step-by-step guide is available as a download.

It comes in two versions for single- or double-lamp luminaires and includes:

- WAGO connectors
- Cable ties and adhesive sockets
- New blank name plate
- Pre-wired microfuse (250 V T2 A)



The conversion kit is available in combination with selected LED tubes.

For further information see ledvance.com/ledtube

Product name EAN 40 LED tube information on page

SINGLE-LAMP CONVERSION KIT

LED TUBE T8 EM Ultra Output S + conversion kit			
LEDTUBE T8 EM UO S 1200 14W 840 KIT1	4099854101250	10	16
LEDTUBE T8 EM UO S 1500 22.2W 840 KIT1	4099854107818	10	16
LEDTUBE T8 EM UO S 1500 22.2W 865 KIT1	4099854107832	10	16
LED TUBE T8 EM S + conversion kit			
LEDTUBE T8 EM S 1050 11.4W 830 KIT1	4099854116353	10	16
LEDTUBE T8 EM S 1050 11.4W 840 KIT1	4099854113659	10	16
LEDTUBE T8 EM S 1200 12W 840 KIT1	4099854107757	10	16
LEDTUBE T8 EM S 1500 17.7W 840 KIT1	4099854107795	10	16
LED TUBE T8 EM Ultra Output P + conversion kit			
LEDTUBE T8 EM UO P 1200 15.6W 840 KIT1	4099854108273	10	16
LEDTUBE T8 EM UO P 1500 23.1W 840 KIT1	4099854108297	10	16
LEDTUBE T8 EM UO P 1500 23.1W 865 KIT1	4099854111945	10	16
LED TUBE T8 EM P + conversion kit			
LEDTUBE T8 EM P 1200 13.5W 840 KIT1	4099854107863	10	16
LEDTUBE T8 EM P 1500 20W 840 KIT1	4099854108129	10	16

Product name EAN 40 LED tube information on page

SINGLE-LAMP CONVERSION KIT

LED TUBE T5 AC HE P + conversion kit			
LEDTUBE T5 AC HE21 P 849 10W 830 KIT1	4099854108488	10	19
LEDTUBE T5 AC HE28 P 1149 16W 840 KIT1	4099854101762	10	19
LEDTUBE T5 AC HE35 P 1449 18W 840 KIT1	4099854108501	10	19
LED TUBE T5 AC HO P + conversion kit			
LEDTUBE T5 AC HO24 P 549 10W 840 KIT1	4099854101755	10	19
LEDTUBE T5 AC HO39 P 849 16W 830 KIT1	4099854116360	10	19
LEDTUBE T5 AC HO39 P 849 16W 840 KIT1	4099854104237	10	19
LEDTUBE T5 AC HO49 P 1449 26W 840 KIT1	4099854108358	10	19
LEDTUBE T5 AC HO54 P 1149 26W 830 KIT1	4099854108396	10	19
LEDTUBE T5 AC HO54 P 1149 26W 840 KIT1	4099854108402	10	19
LEDTUBE T5 AC HO80 P 1449 37W 840 KIT1	4099854108440	10	20

Product name EAN 40 LED tube information on page

DOUBLE-LAMP CONVERSION KIT

LED TUBE T8 EM Ultra Output S + conversion kit			
LEDTUBE T8 EM UO S 1200 14W 840 KIT2	4099854101267	5	16
LEDTUBE T8 EM UO S 1500 22.2W 840 KIT2	4099854107825	5	16
LEDTUBE T8 EM UO S 1500 22.2W 865 KIT2	4099854107849	5	16
LED TUBE T8 EM S + conversion kit			
LEDTUBE T8 EM S 600 6.3W 840 KIT2	4099854112003	5	16
LEDTUBE T8 EM S 1200 12W 840 KIT2	4099854107740	5	16
LEDTUBE T8 EM S 1500 17.7W 840 KIT2	4099854107801	5	16
LED TUBE T8 EM Ultra Output P + conversion kit			
LEDTUBE T8 EM UO P 1200 15.6W 840 KIT2	4099854108280	5	16
LEDTUBE T8 EM UO P 1500 23.1W 840 KIT2	4099854108303	5	16
LEDTUBE T8 EM UO P 1500 23.1W 865 KIT2	4099854111952	5	16
LED TUBE T8 EM P + conversion kit			
LEDTUBE T8 EM P 1200 13.5W 840 KIT2	4099854108037	5	16
LEDTUBE T8 EM P 1500 20W 840 KIT2	4099854108150	5	16
LEDTUBE T8 EM P 1500 20W 865 KIT2	4099854108204	5	16

Product name EAN 40 LED tube information on page

DOUBLE-LAMP CONVERSION KIT

LED TUBE T5 AC HE P + conversion kit			
LEDTUBE T5 AC HE28 P 1149 16W 840 KIT2	4099854108495	5	19
LEDTUBE T5 AC HE35 P 1449 18W 840 KIT2	4099854108518	5	19
LEDTUBE T5 AC HE35 P 1449 18W 865 KIT2	4099854108525	5	19
LED TUBE T5 AC HO P + conversion kit			
LEDTUBE T5 AC HO49 P 1449 26W 840 KIT2	4099854108365	5	19
LEDTUBE T5 AC HO54 P 1149 26W 830 KIT2	4099854116377	5	19
LEDTUBE T5 AC HO54 P 1149 26W 840 KIT2	4099854108372	5	19
LEDTUBE T5 AC HO80 P 1449 37W 840 KIT2	4099854108457	5	20

DAMP PROOF HOUSING

ROBUST AND FUNCTIONAL

The ideal addition to the LEDVANCE LED TUBE T8 EM and LEDVANCE LED TUBE T8 EM CONNECTED, especially for use in harsh environments. The robust housing of the DAMP PROOF luminaire not only protects against moisture and dust but also easily withstands a hefty shock or two. Installation is particularly easy thanks to prewiring and integrated accessories. Wow your customers with our dream team of LED TUBE T8 EM or LED TUBE T8 EM CONNECTED and DAMP PROOF housing.

PRODUCT FEATURES

- Housing made of robust polycarbonate (PC), gray
- Suitable for **LED TUBE T8 EM** and **LED TUBE T8 EM CONNECTED**
- Luminaire housing, available for 1 or 2 **T8 LED lamps**
- Type of protection: IP65
- Impact resistance: IK08

PRODUCT BENEFITS

- Sustainable solution thanks to exchangeable lamps
- Prewired for easy installation of tubular AC LED lamps
- Robust housing
- Easy and quick installation
- 5-year guarantee¹

EQUIPMENT/ACCESSORIES

- All required accessories included



Product name	Segmentation	GTIN (EAN)				L x W x H [mm] Ø x H [mm]
DP HOUSING 600 1x Lamp IP65	■	4058075312395	105	IK08	600	651 x 64 x 75
DP HOUSING 600 2x Lamp IP65	■	4058075312418	105	IK08	850	651 x 103 x 75
DP HOUSING 1200 1x Lamp IP65	■	4058075312432	105	IK08	1000	1261 x 64 x 75
DP HOUSING 1200 2x Lamp IP65	■	4058075312456	105	IK08	1300	1261 x 103 x 75
DP HOUSING 1500 1x Lamp IP65	■	4058075312470	105	IK08	1300	1561 x 64 x 75
DP HOUSING 1500 2x Lamp IP65	■	4058075312494	105	IK08	1850	1561 x 103 x 75

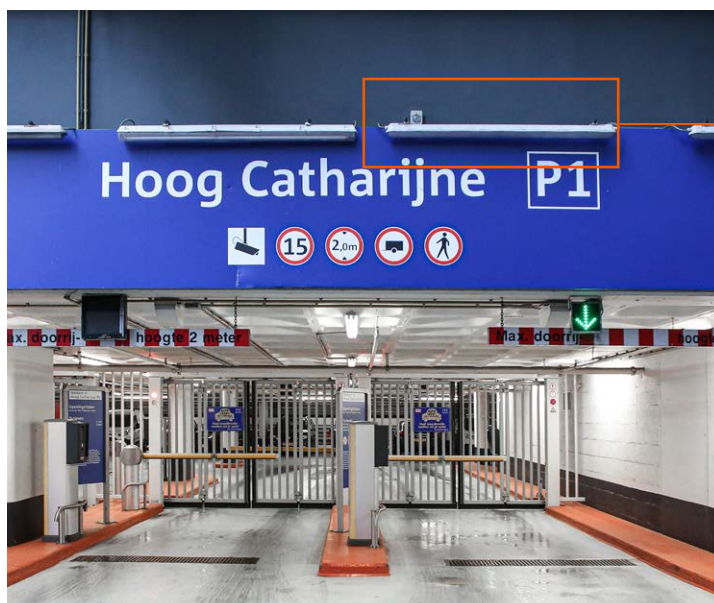

A STRONG COMBINATION FOR LARGE INDOOR CAR PARKS:

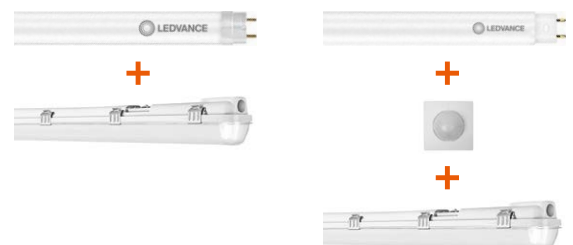

Both **LED TUBE T8 EM** and **LED TUBE CONNECTED** can be used in the robust **DAMP PROOF housing** (IP 65).

The **LED TUBE CONNECTED SYSTEM** allows wirelessly connected light management without extensive wiring and programming.

¹Refer to www.ledvance.com/guarantee for precise conditions



REPLACE LAMP, KEEP HOUSING WITH LED TUBE EXTERNAL SYSTEM

DIMMABLE – REPLACEABLE – FIT FOR EMERGENCY LIGHTING

LEDVANCE makes your work switching to LED tubes even easier because now you can continue to use existing components, giving you a compelling answer to the challenges of your existing installation: our LED Tube External System consisting of an LED tube and external driver.

BENEFIT 1: HIGH EFFICIENCY

For converting old fluorescent lamp systems with dimmable DALI control to LED technology with optimal system efficiency, guaranteeing excellent performance with high energy savings and a long lifetime.

BENEFIT 2:

CIRCULAR ECONOMY

No compatibility problems thanks to an LED tube and driver system that fit, keeping the replaceable lighting components for greater economy and sustainability.

BENEFIT 3:

FIT FOR EMERGENCY LIGHTING

For upgrading emergency lighting systems with LED tubes.

SIMPLE INSTALLATION IN A FEW STEPS

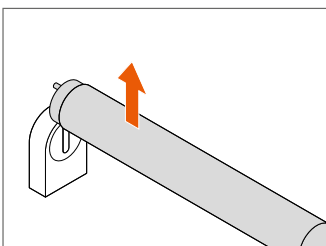

Remove the fluorescent tube from the base as usual.

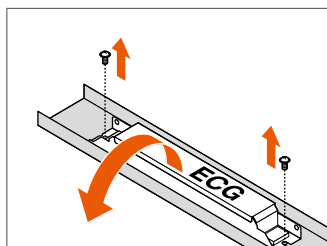

Release fastenings and remove ballast.

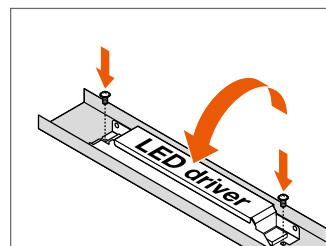

Insert, screw on and wire the same-size LED DRIVER EXTERNAL.

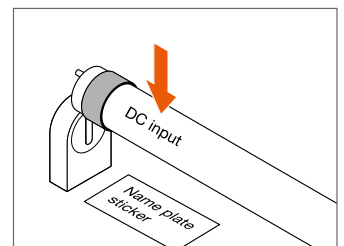

Insert the LED TUBE EXTERNAL on the active DC input side and issue a new CE declaration.

FEATURES LEDVANCE LED TUBE EXTERNAL SYSTEM



LED DRIVER EXTERNAL

- Multi-watt constant current SELV driver (1-channel and 2-channel version)
- High flexibility due to adjustable output currents via dip switch, fit for all T5 and T8 LED TUBE EXTERNAL
- DALI-2.0 interface for dimming and sensor operations
- Push DIM application for easy control
- Installation in emergency lighting systems according to IEC 61347-2-13, Appendix J
- ENEC mark
- Lifetime up to 100 000 h
- 5-year guarantee

LED DRIVER LED TUBE EXTERNAL DALI P

LED TUBE T8 EXTERNAL P



LED TUBE EXTERNAL

- Dimmable constant current LED tube
- Shatter protection thanks to special PET coating
- No bending thanks to glass tube
- Very high resistance to switching loads
- 4 000 K/6 500 K; 1.2 m/1.5 m
- Lifetime up to 50 000 h
- 5-year guarantee
- Mercury-free and RoHS-compliant
- Linear lighting for industry, offices, warehouses and retail outlets

LED TUBE T5 EXTERNAL P

PERFORMANCE CLASS

HUGE SAVINGS AND QUICK PAYBACK

LED TUBE EXTERNAL SYSTEM

LED TUBE T8 EXT P 1500 mm 23W 840
EAN: 4058075730557
Driver: DR EXT DALI-P -1X15-37W 220-240
EAN: 4058075730632



	OLD: Traditional T8 58W	NEW: LED TUBE T8 EXTERNAL SYSTEM	SAVINGS
Guarantee		5 years ¹	
Efficiency	90 lm/W	161 lm/W	
System wattage	58 W	23 W	
Average lifetime	15 000 h	50 000 h ²	
Energy consumption of project	6.8 kW	2.3 kW	
Energy consumption over period of operation	254 592 kWh	86 122 kWh	131 040 kWh
CO ₂ emissions (231 g/kWh) ³	58 811 kg	19 892 kg	30 270 kg
Total cost savings up to ⁴		50 %	
Payback time from		11 months	

TOTAL COST SAVINGS UP TO **50%**

COST SAVINGS FOR ELECTRICITY UP TO **60%**

PAYBACK TIME FROM **11** MONTHS

ENERGY SAVINGS UP TO **131 040** KWH

TOTAL CO₂ SAVINGS UP TO **60%**

! FURTHER ENERGY SAVINGS THROUGH THE USE OF SENSORS

GLOBAL PARAMETERS (example Warehouse): Period of operation: 60 months, 5 years, 37 440 operating hours | Operating times: 6 days per week, 52 weeks per year, 24 hours per day, dimming not included in calculation | Number of light points: 100 lamps, 50 luminaires

¹ Refer to www.ledvance.com/guarantee for precise conditions | ² Lifetime: LED TUBE T8 EXTERNAL P 50 000 h, t[h]: L70/B50 at 25 °C (T_a), LED DRIVER LED TUBE EXTERNAL DALI P 100 000 h, T_c: 65 °C; 10 % failure rate

³ 2020 European level of GHG emission intensity of electricity generation (www.eea.europa.eu) | ⁴ Calculation Parameters: Replacement costs: Traditional T8 58W 4.10 €/piece, LED TUBE T8 EXT P 1500 mm 23W 840 26.30 €/piece, DR EXT DALI-P-1X15-37W 220-240 71.97 €/piece, costs for exchanging: retrofit lamp 10.00 €/housing, conversion LED Tube External System 15.00 €/housing, electricity costs: 0.40 €/kWh. *Illustrative pricing. Prices may vary in your country.

INSTALLATION VIDEO:

For more information go to:
<https://youtu.be/9lhWFJeydEU>



FIND OUT MORE:

For more information go to:
ledvance.com/ext-system



LINEAR LED LUMINAIRES: UPGRADE OR NEW INSTALLATION?

SOLUTIONS WITH LED LUMINAIRES

UPGRADE



- if an existing luminaire needs to be kept but electric or mechanical interfaces are too old for a retrofit or conversion.

NEW INSTALLATION



- if the existing housing or other components have reached the end of their life
- if aesthetical or functional design requirements have changed
- if lighting performance requirements have changed, e.g. with regard to light distribution or quality
- if a light management system needs to be integrated, or there's an upgrade to human centric lighting

INCREASED PRODUCTIVITY



A new installation allows for the quality, distribution and function of the lighting to be perfectly adapted to current expectations, helping improve productivity.

It's preferable to an upgrade if keeping existing luminaires isn't important.



Not sure what to choose? Our experts are happy to advise you. Get in touch with us: contact@ledvance.com

RECOMMENDED PRODUCTS

	INDUSTRY Recommended illuminance: 200 – 500+ lux	WAREHOUSE Recommended illuminance: 200 – 300 lux	PARKING Recommended illuminance: 75 – 300 lux	OFFICE/PUBLIC BUILDINGS Recommended illuminance: 500+ lux
PANEL				
Panel Protect	✓	✓		✓
Panel Comfort				✓
Panel Compact				✓
Panel IndiviLED				✓
DAMP PROOF				
Damp Proof Compact Gen 2	✓	✓	✓	✓
Damp Proof Gen 2	✓	✓	✓	✓
Damp Proof Special Gen 2	✓	✓	✓	
LINEAR				
Linear Surface IP44 Gen 2				✓
Linear Ultra Output	✓	✓		✓
Linear Compact High Output				✓
Low Bay Flex Ball Proof	✓	✓		
Linear Magnetic Batten T5	✓	✓		✓

PRODUCT HIGHLIGHTS

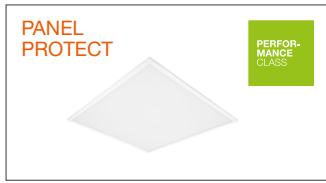

The tough panel luminaire: IP54 protection and resistant PMMA surface, ON/OFF or DALI versions (dimmmable).



Highly efficient square or rectangular recessed panels offering power select (PS), low-glare, CRI90 with CCT select, ON/OFF or DALI IoT/Zigbee (dimmmable) & EM conversion box compatibility.

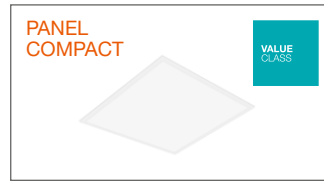

Standard square or rectangular recessed panel luminaires with different features: low-glare, DALI-2 or CRI 90, compatible with EM conversion box.

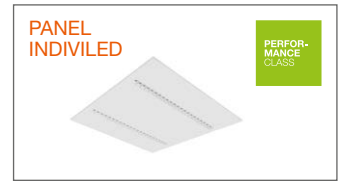

The panel luminaire for perfectionists: perfect lighting with IndiviLED optics and SCALE design, ON/OFF, IoT-ready DALI/Zigbee (dimmmable) or Emergency versions.



Modern damp-proof luminaires with lumen-switchable versions, highly versatile due to available power select versions that allow 2 different lumen packages.



Damp-proof luminaires for a wide range of applications: ON/OFF switchable, DALI, through-wired and Emergency versions available.



Tubular damp-proof luminaire with extra high IP67 rating, pre-installed through-wiring, ammonium-resistant and for outdoor, industry and agricultural applications.



Robust IP44 luminaires with direct light emission, integrated driver for surface mounting, up to 137 lm/W. DALI and self-contained emergency versions also available.



Surface luminaire with high lumen output and high luminous efficacy. Robust structure with IK08, through-wiring possible and easy time-saving installation.



Compact single or light line luminaire with high luminous flux. Fast and seamless connection of up to 10 luminaires possible and low-flicker light thanks to special control gear.



Robust IK08 ball-proof low-bay luminaires with attractive linear design, up to 155 lm/W, DALI Version available, pre-fitted with through-wiring cable and easy time-saving installation.



Luminaire-insert for upgrading existing metallic ceiling luminaires (T8 and T5 fluorescent) to energy-saving LED T5 technology. Available in 4 lengths.

You can find details and versions of the listed products or other luminaires at ledvance.com/luminaires



RETAIL Recommended illuminance: 500+ lux	FOOD PRESENTATION Recommended illuminance: Special spectrum with high CRI-R9 level, shatter protection	RESIDENTIAL AREAS Recommended illuminance: 100+ lux	OUTDOOR AREAS / PUBLIC TRANSPORTATION Recommended illuminance: 5 – 500+ lux	PUBLIC BUILDINGS / SPORTS AND LEISURE Recommended illuminance: 100 – 500+ lux
✓		✓ ✓ ✓		
		✓ ✓	✓	
✓		✓ ✓ ✓		✓

DULUX LED LAMPS SOLUTIONS FOR ALL SITUATIONS

LED SOLUTIONS LEDVANCE DULUX LED LAMPS

RETROFIT



Simple 1:1 replacement
For existing installations

LEDVANCE DULUX LED lamp
Compatible with EM (CCG ballast or compatible ECG)

CONVERSION



Technical modification or rewiring
For existing luminaires

LEDVANCE DULUX LED lamp (case: no compatible ECG). If there is no retrofit alternative or if the customer values maximum energy savings and low maintenance, rewiring is the solution.
▶ All DULUX LED lamps can be converted to 230 V.

LED SOLUTIONS LEDVANCE DOWNLIGHTS

NEW INSTALLATION



Complete replacement with modern LED luminaires
New LED luminaires

- Wide range of innovative luminaires for new construction or refurbishment projects
- With high functionality for intelligent light control
- With long service life and maximum energy-saving potential

DULUX LED S EM & AC MAINS V G23



DULUX LED T/E HF & AC MAINS V GX24Q



DULUX LED D EM & AC MAINS V G24D



DULUX LED L HF & AC MAINS V 2G11



DULUX LED D/E HF & AC MAINS V G24Q



DULUX LED F EM & AC MAINS V 2G10



DULUX LED T EM & AC MAINS V GX24D



DULUX LED SQ EM & AC MAINS V GR8



DOWNLIGHT COMFORT



DOWNLIGHT UGR 19



DOWNLIGHT ALU



DOWNLIGHT SURFACE IP65



How to convert your DULUX LED Lamp to 230 V:
please find more information in the installation guide
ledvance.com/services



Check ECG compatibility at
ledvance.com/compatibility

DULUX LED LAMPS



wΔW Power in W for conventional technology

Product name GTIN (EAN) Segmentation **W** **lm** **K** **CRI** **t_{in}**¹ ² No.

DULUX LED D EM & AC MAINS V – LED replacement for CFLni with 2-pin G24d base for CCG and AC mains operation.

Product name	GTIN (EAN)	Segmentation	wΔW	E	I [mm]	Ø d [mm]	W	lm	K	CRI	A	t _{in}	IP	3	No.
DULUX LED D10 EM & AC MAINS V 5W 830 G24D-1	4058075823051	■	10	G24d-1	110.0	35.0	5.0	540	3000	80	120	30000	▶	3	1
DULUX LED D10 EM & AC MAINS V 5W 840 G24D-1	4058075823075	■	10	G24d-1	110.0	35.0	5.0	600	4000	80	120	30000	▶	3	1
DULUX LED D13 EM & AC MAINS V 6W 830 G24D-1	4058075823099	■	13	G24d-1	148.0	35.0	6.0	600	3000	80	120	30000	▶	3	1
DULUX LED D13 EM & AC MAINS V 6W 840 G24D-1	4058075823112	■	13	G24d-1	148.0	35.0	6.0	660	4000	80	120	30000	▶	3	1
DULUX LED D18 EM & AC MAINS V 7W 830 G24D-2	4058075823136	■	18	G24d-2	148.0	35.0	7.0	700	3000	80	120	30000	▶	3	1
DULUX LED D18 EM & AC MAINS V 7W 840 G24D-2	4058075823150	■	18	G24d-2	148.0	35.0	7.0	770	4000	80	120	30000	▶	3	1
DULUX LED D26 EM & AC MAINS V 9W 830 G24D-3	4058075823174	■	26	G24d-3	171.0	35.0	9.0	990	3000	80	120	30000	▶	3	1
DULUX LED D26 EM & AC MAINS V 9W 840 G24D-3	4058075823198	■	26	G24d-3	171.0	35.0	9.0	1100	4000	80	120	30000	▶	3	1

DULUX LED D VT EM & AC MAINS V – LED replacement for CFLni with 2-pin G24d base for CCG and AC mains operation.

Product name	GTIN (EAN)	Segmentation	wΔW	E	I [mm]	Ø d [mm]	W	lm	K	CRI	A	t _{in}	IP	3	No.
DULUX LED D13 VT EM & AC MAINS V 5.5W 830 G24D	4058075821811	■	13	G24d	103.0	37.7	5.5	640	3000	80	300	30000	▶	3	2
DULUX LED D13 VT EM & AC MAINS V 5.5W 840 G24D	4058075821835	■	13	G24d	103.0	37.7	5.5	700	4000	80	300	30000	▶	3	2
DULUX LED D18 VT EM & AC MAINS V 7.5W 830 G24D	4058075821859	■	18	G24d	117.0	37.7	7.5	870	3000	80	300	30000	▶	3	2
DULUX LED D18 VT EM & AC MAINS V 7.5W 840 G24D	4058075821873	■	18	G24d	117.0	37.7	7.5	950	4000	80	300	30000	▶	3	2
DULUX LED D26 VT EM & AC MAINS V 9.5W 830 G24D	4058075821897	■	26	G24d	125.5	37.7	9.5	1080	3000	80	300	30000	▶	3	2
DULUX LED D26 VT EM & AC MAINS V 9.5W 840 G24D	4058075821910	■	26	G24d	125.5	37.7	9.5	1200	4000	80	300	30000	▶	3	2

DULUX LED D/E HF & AC MAINS V – LED replacement for CFLni, with 4-pin G24q base for CCG and AC mains operation

Product name	GTIN (EAN)	Segmentation	wΔW	E	I [mm]	Ø d [mm]	W	lm	K	CRI	A	t _{in}	IP	3	No.
DULUX LED D/E13 HF & AC MAINS V 6W 830 G24Q-1	4058075821934	■	13	G24q-1	142.8	33.0	6.0	600	3000	80	120	30000	▶	3	3
DULUX LED D/E13 HF & AC MAINS V 6W 840 G24Q-1	4058075821958	■	13	G24q-1	142.8	33.0	6.0	660	4000	80	120	30000	▶	3	3
DULUX LED D/E18 HF & AC MAINS V 7W 830 G24Q-2	4058075821972	■	18	G24q-2	142.8	33.0	7.0	700	3000	80	120	30000	▶	3	3
DULUX LED D/E18 HF & AC MAINS V 7W 840 G24Q-2	4058075821996	■	18	G24q-2	142.8	33.0	7.0	770	4000	80	120	30000	▶	3	3
DULUX LED D/E26 HF & AC MAINS V 10W 830 G24Q-3	4058075822016	■	26	G24q-3	169.8	33.0	10.0	990	3000	80	120	30000	▶	3	4
DULUX LED D/E26 HF & AC MAINS V 10W 840 G24Q-3	4058075822030	■	26	G24q-3	169.8	33.0	10.0	1100	4000	80	120	30000	▶	3	4

DULUX LED S EM & AC MAINS V – LED replacement for short CFLni, with 2-pin G23 base for CCG and AC mains operation.

Product name	GTIN (EAN)	Segmentation	wΔW	E	I [mm]	Ø d [mm]	W	lm	K	CRI	A	t _{in}	IP	3	No.
DULUX LED S7 EM & AC MAINS V 3.5W 830 G23	4058075822931	■	7	G23	135.0	32.3	3.5	360	3000	80	120	30000	▶	3	5
DULUX LED S7 EM & AC MAINS V 3.5W 840 G23	4058075822955	■	7	G23	135.0	32.3	3.5	400	4000	80	120	30000	▶	3	5
DULUX LED S9 EM & AC MAINS V 4W 830 G23	4058075822979	■	9	G23	165.0	32.3	4.0	500	3000	80	120	30000	▶	3	6
DULUX LED S9 EM & AC MAINS V 4W 840 G23	4058075822993	■	9	G23	165.0	32.3	4.0	550	4000	80	120	30000	▶	3	6
DULUX LED S11 EM & AC MAINS V 6W 830 G23	4058075823013	■	11	G23	220.0	32.3	6.0	630	3000	80	120	30000	▶	3	7
DULUX LED S11 EM & AC MAINS V 6W 840 G23	4058075823037	■	11	G23	220.0	32.3	6.0	700	4000	80	120	30000	▶	3	7

DULUX LED L HF & AC MAINS V – LED replacement for CFLni, with 4-pin 2G11 base for CCG and AC mains operation

Product name	GTIN (EAN)	Segmentation	wΔW	E	I [mm]	Ø d [mm]	W	lm	K	CRI	A	t _{in}	IP	3	No.
DULUX LED L18 HF & AC MAINS V 8W 830 2G11	4058075822054	■	18	2G11	229.5	44.0	8.0	900	3000	80	140	30000	▶	3	8
DULUX LED L18 HF & AC MAINS V 8W 840 2G11	4058075822078	■	18	2G11	229.5	44.0	8.0	1000	4000	80	140	30000	▶	3	8
DULUX LED L24 HF & AC MAINS V 12W 830 2G11	4058075822092	■	24	2G11	324.5	44.0	12.0	1350	3000	80	140	30000	▶	3	9
DULUX LED L24 HF & AC MAINS V 12W 840 2G11	4058075822115	■	24	2G11	324.5	44.0	12.0	1500	4000	80	140	30000	▶	3	9
DULUX LED L36 HF & AC MAINS V 18W 830 2G11	4058075822139	■	36	2G11	416.5	44.0	18.0	2070	3000	80	140	30000	▶	3	10
DULUX LED L36 HF & AC MAINS V 18W 840 2G11	4058075822153	■	36	2G11	416.5	44.0	18.0	2300	4000	80	140	30000	▶	3	10
DULUX LED L55 HF & AC MAINS V 25W 830 2G11	4058075822177	■	55	2G11	537.0	44.0	25.0	2950	3000	80	140	30000	▶	3	11
DULUX LED L55 HF & AC MAINS V 25W 840 2G11	4058075822191	■	55	2G11	537.0	44.0	25.0	3250	4000	80	140	30000	▶	3	11

SAFETY ADVICE: The operating temperature range of DULUX LED is restricted. In case of doubt regarding suitability of the application please measure T_c max temperature on the product prior to installation.



Check ECG compatibility at ledvance.com/compatibility

■ SUPERIOR CLASS ■ PERFORMANCE CLASS ■ VALUE CLASS

¹ L70/B50 | ² Energy efficiency class (EEC) on a scale of A (highest efficiency) to G (lowest efficiency) | ³ Refer to www.ledvance.com/guarantee for precise conditions | ⁴ Compatibility list also online: ledvance.com/compatibility

DULUX LED LAMPS



wΔW Power in W for conventional technology

Product name	GTIN (EAN)	Segmentation	wΔW	lm	l [mm]	∅ d [mm]	W	lm	K	CRI	△	t _{in} ¹	IP ²	No.
DULUX LED F EM & AC MAINS V – LED replacement for flat CFLni with 4-pin 2G10 base for CCG and AC mains operation.														
DULUX LED F18 EM & AC MAINS V 8W 830 2G10	4058075822412	■	18	2G10	128.0	89.5	8.0	900	3000	80	130	30000	▶▶▶	1
DULUX LED F18 EM & AC MAINS V 8W 840 2G10	4058075822436	■	18	2G10	128.0	89.5	8.0	1000	4000	80	130	30000	▶▶▶	1
DULUX LED F24 EM & AC MAINS V 12W 830 2G10	4058075822450	■	24	2G10	169.5	89.5	12.0	1350	3000	80	130	30000	▶▶▶	1
DULUX LED F24 EM & AC MAINS V 12W 840 2G10	4058075822474	■	24	2G10	169.5	89.5	12.0	1500	4000	80	130	30000	▶▶▶	1
DULUX LED F36 EM & AC MAINS V 20W 830 2G10	4058075822498	■	36	2G10	221.5	89.5	20.0	2250	3000	80	130	30000	▶▶▶	1
DULUX LED F36 EM & AC MAINS V 20W 840 2G10	4058075822511	■	36	2G10	221.5	89.5	20.0	2500	4000	80	130	30000	▶▶▶	1
DULUX LED T EM & AC MAINS V – LED replacement for CFLni with 2-pin GX24d base for CCG and AC mains operation.														
DULUX LED T13 EM & AC MAINS V 6W 830 GX24d-1	4058075823211	■	13	GX24d-1	132.0	38.0	6.0	630	3000	80	120	30000	▶▶▶	2
DULUX LED T13 EM & AC MAINS V 6W 840 GX24d-1	4058075823235	■	13	GX24d-1	132.0	38.0	6.0	700	4000	80	120	30000	▶▶▶	2
DULUX LED T18 EM & AC MAINS V 7W 830 GX24d-2	4058075823259	■	18	GX24d-2	132.0	38.0	7.0	720	3000	80	120	30000	▶▶▶	2
DULUX LED T18 EM & AC MAINS V 7W 840 GX24d-2	4058075823273	■	18	GX24d-2	132.0	38.0	7.0	800	4000	80	120	30000	▶▶▶	2
DULUX LED T26 EM & AC MAINS V 9W 830 GX24d-3	4058075823297	■	26	GX24d-3	147.0	38.0	9.0	1000	3000	80	120	30000	▶▶▶	2
DULUX LED T26 EM & AC MAINS V 9W 840 GX24d-3	4058075823310	■	26	GX24d-3	147.0	38.0	9.0	1100	4000	80	120	30000	▶▶▶	2
DULUX LED T/E HF & AC MAINS V – LED replacement for CFLni with 4-pin GX24q base for CCG and AC mains operation														
DULUX LED T/E13 HF & AC MAINS V 6W 830 GX24q-1	4058075822214	■	13	GX24q-1	102.8	45.0	6.0	630	3000	80	120	30000	▶▶▶	3
DULUX LED T/E13 HF & AC MAINS V 6W 840 GX24q-1	4058075822238	■	13	GX24q-1	102.8	45.0	6.0	700	4000	80	120	30000	▶▶▶	3
DULUX LED T/E18 HF & AC MAINS V 7W 830 GX24q-2	4058075822252	■	18	GX24q-2	119.8	45.0	7.0	720	3000	80	120	30000	▶▶▶	4
DULUX LED T/E18 HF & AC MAINS V 7W 840 GX24q-2	4058075822276	■	18	GX24q-2	119.8	45.0	7.0	800	4000	80	120	30000	▶▶▶	4
DULUX LED T/E26 HF & AC MAINS V 10W 830 GX24q-3	4058075822290	■	26	GX24q-3	139.8	45.0	10.0	990	3000	80	120	30000	▶▶▶	5
DULUX LED T/E26 HF & AC MAINS V 10W 840 GX24q-3	4058075822313	■	26	GX24q-3	139.8	45.0	10.0	1100	4000	80	120	30000	▶▶▶	5
DULUX LED T/E32 HF & AC MAINS V 16W 830 GX24q-3	4058075822337	■	32	GX24q-3	154.8	45.0	16.0	1620	3000	80	120	30000	▶▶▶	6
DULUX LED T/E32 HF & AC MAINS V 16W 840 GX24q-3	4058075822351	■	32	GX24q-3	154.8	45.0	16.0	1800	4000	80	120	30000	▶▶▶	6
DULUX LED T/E42 HF & AC MAINS V 20W 830 GX24q-4	4058075822375	■	42	GX24q-4	164.8	45.0	20.0	2025	3000	80	120	30000	▶▶▶	7
DULUX LED T/E42 HF & AC MAINS V 20W 840 GX24q-4	4058075822399	■	42	GX24q-4	164.8	45.0	20.0	2250	4000	80	120	30000	▶▶▶	7
DULUX LED SQ EM & AC MAINS V – LED replacement for CFLni with 2-pin GR8 base for CCG and AC mains operation.														
DULUX LED SQ16 EM & AC MAINS V 7W 830 GR8	4058075822535	■	16	GR8	137.1	134.0	7.0	720	3000	80	130	30000	▶▶▶	8
DULUX LED SQ16 EM & AC MAINS V 7W 835 GR8	4058075822559	■	16	GR8	137.1	134.0	7.0	720	3500	80	130	30000	▶▶▶	8
DULUX LED SQ28 EM & AC MAINS V 13W 830 GR8	4058075822573	■	28	GR8	204.0	202.0	13.0	1350	3000	80	130	30000	▶▶▶	8
DULUX LED SQ28 EM & AC MAINS V 13W 835 GR8	4058075822597	■	28	GR8	204.0	202.0	13.0	1350	3500	80	130	30000	▶▶▶	8

SAFETY ADVICE: The operating temperature range of DULUX LED is restricted. In case of doubt regarding suitability of the application please measure T_c max temperature on the product prior to installation.



Check ECG compatibility at ledvance.com/compatibility

■ SUPERIOR CLASS ■ PERFORMANCE CLASS ■ VALUE CLASS

¹ L70/B50 | ² Energy efficiency class (EEC) on a scale of A (highest efficiency) to G (lowest efficiency)

³ Refer to www.ledvance.com/guarantee for precise conditions | ⁴ Compatibility list also online: ledvance.com/compatibility

NEW LED LUMINAIRE INSTALLATION: SOLUTIONS WITH ADDED BENEFITS

NEW INSTALLATION WITH LED LUMINAIRES



By installing new LED luminaires, the lighting can be perfectly adapted to contemporary standards in terms of aesthetics, function and quality of light. Integrating them into a light management system or installing human centric lighting is also easy and convenient.

INCREASED PRODUCTIVITY



As a result, users benefit not only from outstanding energy efficiency but also from improved productivity thanks to ideal lighting conditions.

PRODUCT HIGHLIGHTS

DOWNLIGHT UGR19 PERFORMANCE CLASS



Downlights with good UGR < 19 glare reduction and up to 30° cut-off angle for comfortable lighting. IP54, low flicker, ON/OFF or IoT-ready DALI/Zigbee versions.

DOWNLIGHT COMFORT PERFORMANCE CLASS



Downlights with three light colors selectable CCT slide switch. Aluminum housing, polycarbonate diffuser, good glare reduction, IP54 and easy wiring push terminals.

DOWNLIGHT SURFACE IP65 PERFORMANCE CLASS



IP65 surface-mounted downlights for dusty and damp conditions. High impact resistance: IK06. With push terminals for tool-free and easy wiring.

DOWNLIGHT ALU



Downlight luminaires with aluminum housing. For dusty and humid environments thanks to IP44, DALI versions also available.

DOWNLIGHT SLIM ALU VALUE CLASS



Flat downlights with external driver and aluminum housing. Extremely small mounting depth due to very low-profile housing.

SURFACE COMPACT IK10 PERFORMANCE CLASS



Wall and ceiling luminaire with high impact IK10 resistance. Vandalism resistant with transparent protective cover, high luminous efficacy and through-wiring possible.

SURFACE BULKHEAD PERFORMANCE CLASS



Robust IK10 wall and ceiling luminaire for indoor/outdoor public area use, IP65. Switchable, high-frequency sensor and emergency versions available.

SURFACE CIRCULAR



Wall and ceiling luminaire with IP44. Versions with sensor: easy adjustment sensor range, daylight detection and illumination time.

RECOMMENDED PRODUCTS

	OFFICE/PUBLIC BUILDINGS Recommended illuminance: 500+ lux	RETAIL Recommended illuminance: 500+ lux	RESIDENTIAL AREAS Recommended illuminance: 100+ lux
DOWNLIGHTS			
Downlight UGR19	✓	✓	
Downlight Comfort	✓	✓	
Downlight Surface IP65	✓	✓	
Downlight Alu	✓	✓	
Downlight Slim Alu	✓	✓	✓
SURFACE			
Surface Compact IK10	✓		✓
Surface Bulkhead	✓		✓
Surface Circular	✓		✓



You can find details and versions of the listed products or other luminaires at ledvance.com/luminaires

Not sure what to choose? Our experts are happy to advise you. Get in touch with us: contact@ledvance.com



BAN OF HALOGEN LAMPS

Halogen lamps are also affected by the EU legislations. As part of the SLR/ELR regulations, selected HIGH-VOLTAGE HALOGEN LAMPS and LOW-VOLTAGE HALOGEN LAMPS may no longer be placed on the market as of September 1, 2021, and some HALOGEN PINS as of September 1, 2023 (see phase out chart on p. 4).

The following range of reflector and special lamps offers a suitable LED alternative for your existing applications in many cases. Please note that the dimensions of the LED alternatives may differ from those of your existing halogen lamps.

LED REFLECTOR LAMPS



wΔW Power in W for conventional technology

Product name	GTIN (EAN)	Segmentation	wΔW	⏏	l (mm)	∅ d (mm)	W	lm	cd	K	CRI	△	t _{in} ¹	⏏ ²	⚙️ No.
--------------	------------	--------------	-----	---	--------	----------	---	----	----	---	-----	---	------------------------------	----------------	--------

LED REFLECTOR MR16 – Dimmable LED reflector lamps MR16 with pin base, natural daylight

MR16 20 36° DIM S 3.6W 927 GU5.3	4099854070501	■	20	GU5.3	44	50	3.6	230	500	2700	97	36	40000	▶▶	2
MR16 20 36° DIM S 3.6W 930 GU5.3	4099854070525	■	20	GU5.3	44	50	3.6	230	500	3000	97	36	40000	▶▶	2
MR16 20 36° DIM S 3.6W 940 GU5.3	4099854070549	■	20	GU5.3	44	50	3.6	230	500	4000	97	36	40000	▶▶	2
MR16 35 36° DIM S 6.3W 927 GU5.3	4099854058776	■	35	GU5.3	46	51	5.3	345	620	2700	97	36	40000	▶▶	2
MR16 35 36° DIM S 6.3W 930 GU5.3	4099854058837	■	35	GU5.3	46	51	5.3	345	620	3000	97	36	40000	▶▶	2
MR16 35 36° DIM S 6.3W 940 GU5.3	4099854058929	■	35	GU5.3	46	51	5.3	345	620	4000	97	36	40000	▶▶	2
MR16 43 36° DIM S 7.8W 927 GU5.3	4099854048111	■	43	GU5.3	44	50	6.6	500	850	2700	97	36	40000	▶▶	2
MR16 43 36° DIM S 7.8W 930 GU5.3	4099854048159	■	43	GU5.3	44	50	6.6	500	850	3000	97	36	40000	▶▶	2
MR16 43 36° DIM S 7.8W 940 GU5.3	4099854048234	■	43	GU5.3	44	50	6.6	500	850	4000	97	36	40000	▶▶	2

LED MR16 DIM S – Dimmable low-voltage LED reflector lamps MR16 with retrofit pin base

MR16 20 36° DIM S 3.6W 927 GU5.3	4099854070501	■	20	GU5.3	44	50	3.6	230	500	2700	97	36	40000	▶▶	2
MR16 20 36° DIM S 3.6W 930 GU5.3	4099854070525	■	20	GU5.3	44	50	3.6	230	500	3000	97	36	40000	▶▶	2
MR16 20 36° DIM S 3.6W 940 GU5.3	4099854070549	■	20	GU5.3	44	50	3.6	230	500	4000	97	36	40000	▶▶	2
MR16 35 36° DIM S 6.3W 927 GU5.3	4099854058776	■	35	GU5.3	46	51	5.3	345	620	2700	97	36	40000	▶▶	2
MR16 35 36° DIM S 6.3W 930 GU5.3	4099854058837	■	35	GU5.3	46	51	5.3	345	620	3000	97	36	40000	▶▶	2
MR16 35 36° DIM S 6.3W 940 GU5.3	4099854058929	■	35	GU5.3	46	51	5.3	345	620	4000	97	36	40000	▶▶	2
MR16 43 36° DIM S 7.8W 927 GU5.3	4099854048111	■	43	GU5.3	44	50	6.6	500	850	2700	97	36	40000	▶▶	2
MR16 43 36° DIM S 7.8W 930 GU5.3	4099854048159	■	43	GU5.3	44	50	6.6	500	850	3000	97	36	40000	▶▶	2
MR16 43 36° DIM S 7.8W 940 GU5.3	4099854048234	■	43	GU5.3	44	50	6.6	500	850	4000	97	36	40000	▶▶	2

■ SUPERIOR CLASS ■ PERFORMANCE CLASS ■ VALUE CLASS



Check ballast or dimmer compatibility at ledvance.com/compatibility

All technical parameters apply to the entire lamp. Due to the complex production process for light-emitting diodes, the typical values shown for the technical LED parameters are purely statistical values that do not necessarily match the actual technical parameters of each individual product, which can vary from the typical value.

¹ L70/B50 | ² Energy efficiency class (EEC) on a scale of A (highest efficiency) to G (lowest efficiency)

³ Refer to www.ledvance.com/guarantee for precise conditions | ⁴ Compatibility list also online: ledvance.com/compatibility

Product name GTIN (EAN) Segmentation

LED MR16 DIM P – Dimmable low-voltage LED reflector lamps MR16 with retrofit pin base

MR16 20 36° DIM P 3.4W 927 GU5.3	4099854070563	■	20	GU5.3	44	50	3.4	230	500	2700	90	36	25000		2
MR16 20 36° DIM P 3.4W 930 GU5.3	4099854070594	■	20	GU5.3	44	50	3.4	230	500	3000	90	36	25000		2
MR16 20 36° DIM P 3.4W 940 GU5.3	4099854070617	■	20	GU5.3	44	50	3.4	230	500	4000	90	36	25000		2
MR16 35 36° DIM P 5W 927 GU5.3	4099854059698	■	35	GU5.3	44	50	5.0	345	700	2700	90	36	25000		2
MR16 35 36° DIM P 5W 930 GU5.3	4099854059711	■	35	GU5.3	44	50	5.0	345	700	3000	90	36	25000		2
MR16 35 36° DIM P 5W 940 GU5.3	4099854059735	■	35	GU5.3	44	50	5.0	345	700	4000	90	36	25000		2
MR16 50 36° DIM P 8W 927 GU5.3	4099854050473	■	50	GU5.3	44	50	8.0	621	1150	2700	90	36	25000		2
MR16 50 36° DIM P 8W 930 GU5.3	4099854050497	■	50	GU5.3	44	50	8.0	621	1150	3000	90	36	25000		2
MR16 50 36° DIM P 8W 940 GU5.3	4099854050510	■	50	GU5.3	44	50	8.0	621	1150	4000	90	36	25000		2

LED MR16 P – Low-voltage LED reflector lamps MR16 with retrofit pin base

MR16 20 36° P 2.6W 827 GU5.3	4099854059759	■	20	GU5.3	44	50	2.6	210	500	2700	80	36	15000		2
MR16 20 36° P 2.6W 830 GU5.3	4099854059773	■	20	GU5.3	44	50	2.6	210	500	3000	80	36	15000		2
MR16 20 36° P 2.6W 840 GU5.3	4099854059797	■	20	GU5.3	44	50	2.6	210	500	4000	80	36	15000		2

LED MR16 P – Low-voltage LED reflector lamps MR16 with retrofit pin base

MR16 35 36° P 3.8W 827 GU5.3	4099854068058	■	35	GU5.3	44	50	3.8	345	700	2700	80	36	15000		2
MR16 35 36° P 3.8W 830 GU5.3	4099854068072	■	35	GU5.3	44	50	3.8	345	700	3000	80	36	15000		2
MR16 35 36° P 3.8W 840 GU5.3	4099854068096	■	35	GU5.3	44	50	3.8	345	700	4000	80	36	15000		2
MR16 50 36° P 6.3W 827 GU5.3	4099854047817	■	50	GU5.3	44	50	6.5	621	1150	2700	80	36	15000		2
MR16 50 36° P 6.3W 830 GU5.3	4099854047992	■	50	GU5.3	44	50	6.5	621	1150	3000	80	36	15000		2
MR16 50 36° P 6.3W 840 GU5.3	4099854048036	■	50	GU5.3	44	50	6.5	621	1150	4000	80	36	15000		2

LED MR16 P – Low-voltage LED reflector lamps MR16 with retrofit pin base

MR16 20 120° P 2.6W/827 GU5.3	4099854103544	■	20	GU5.3	44	50	2.6	200	210	2700	80	120	15000		2
MR16 35 120° P 4.3W/827 GU5.3	4099854103568	■	35	GU5.3	44	50	4.3	396	125	2700	80	120	20000		2
MR16 50 120° P 6.5W/827 GU5.3	4099854103582	■	50	GU5.3	44	50	6.5	630	210	2700	80	120	20000		2

LED MR11 DIM P – Dimmable low-voltage LED reflector lamps MR11 with retrofit pin base

MR11 20 36° DIM P 2.8W 927 GU4	4099854050206	■	20	GU4	38	35	2.8	184	350	2700	90	36	25000		3
MR11 35 36° DIM P 4.5W 927 GU4	4099854050268	■	35	GU4	38	35	4.5	345	500	2700	90	36	25000		3

LED MR11 P – Low-voltage LED reflector lamps MR11 with retrofit pin base

MR11 20 36° P 2.5W 827 GU4	4099854070365	■	20	GU4	38	35	2.5	184	400	2700	≥80	36	15000		3
MR11 20 36° P 2.5W 840 GU4	4099854070396	■	20	GU4	38	35	2.5	184	400	4000	≥80	36	15000		3

LED MR11 P – Low-voltage LED reflector lamps MR11 with retrofit pin base

MR11 35 36° P 4.2W 827 GU4	4099854050329	■	35	GU4	38	35	4.2	345	700	2700	80	36	15000		3
MR11 35 36° P 4.2W 840 GU4	4099854050350	■	35	GU4	38	35	4.2	345	700	4000	80	36	15000		3

LED AR111 DIM S – Low-voltage LED reflector lamps AR111 with retrofit pin base

AR111 50 24° S 7.4W 927 G53	4099854048524	■	50	G53	55	110.7	7.4	450	1800	2700	97	24	40000		4
AR111 50 24° S 7.4W 930 G53	4099854048548	■	50	G53	55	110.7	7.4	450	1800	3000	97	24	40000		4
AR111 50 40° S 7.4W 930 G53	4099854048845	■	50	G53	55	110.7	7.4	450	1000	3000	97	40	40000		4
AR111 50 40° S 7.4W 927 G53	4099854048708	■	50	G53	55	110.7	7.4	450	1000	2700	97	40	40000		4
AR111 75 24° S 11.7W 927	4099854048982	■	75	G53	55	110.7	11.7	800	2800	2700	97	24	40000		4
AR111 75 24° S 11.7W 930	4099854049040	■	75	G53	55	110.7	11.7	800	2800	3000	97	24	40000		4
AR111 75 24° S 11.7W 940 G53	4099854049064	■	75	G53	55	110.7	11.7	800	2800	4000	97	24	40000		4
AR111 75 40° S 11.7W 927 G53	4099854049125	■	75	G53	55	110.7	11.7	800	1600	2700	97	40	40000		4
AR111 75 40° S 11.7W 930 G53	4099854049163	■	75	G53	55	110.7	11.7	800	1600	3000	97	40	40000		4
AR111 100 24° DIM S 13.5W 927 G53	4099854070655	■	100	G53	55	111.0	13.5	950	2500	2700	97	24	40000		4

■ SUPERIOR CLASS ■ PERFORMANCE CLASS ■ VALUE CLASS



Check ballast or dimmer compatibility at ledvance.com/compatibility

All technical parameters apply to the entire lamp. Due to the complex production process for light-emitting diodes, the typical values shown for the technical LED parameters are purely statistical values that do not necessarily match the actual technical parameters of each individual product, which can vary from the typical value.

¹ L70/B50 | ² Energy efficiency class (EEC) on a scale of A (highest efficiency) to G (lowest efficiency)

³ Refer to www.ledvance.com/guarantee for precise conditions | ⁴ Compatibility list also online: ledvance.com/compatibility

LED SPECIAL LAMPS



wΔW Power in W for conventional technology

Product name	GTIN (EAN)	Segmentation	wΔW	Energy Class	L [mm]	d [mm]	W	lm	K	CRI	Beam Angle	t _{in} ¹	IP ²	No.
LED SPECIAL T26 P – Special LED lamps for refrigerators														
SPC.T26 20 P 2.3W 827 FR E14	4099854066993	■	20	E14	58	25	2.3	200	2700	80	200	15000	▶	1
SPC.T26 20 P 2.3W 865 FR E14	4099854067020	■	20	E14	58	25	2.3	200	6500	80	200	15000	▶	1
LED SPECIAL T26 – Small special LED lamps with E14 screw base														
SPC.T26 5 1.6 W/2400 K E14	4058075432819	—	5	E14	63	26	1.6	50	2400	≥80	320	15000	▶	2
SPC.T26 55 6.5 W/2700 K E14	4058075432963	—	55	E14	80	25	6.5	730	2700	≥80	320	15000	▶	3
LED SPECIAL T26 P – Special LED lamps for refrigerators														
SPC.T26 10 P 1.3W 827 FIL E14	4099854066108	■	10	E14	65	26	1.3	110	2700	80	300	15000	▶	2
SPC.T26 25 P 2.8W 827 FIL E14	4099854066320	■	25	E14	65	26	2.8	250	2700	80	300	15000	▶	4
SPC.T26 25 P 2.8W 865 FIL E14	4099854066498	■	25	E14	65	26	2.8	250	6500	80	300	15000	▶	4
SPC.T26 40 P 4.2W 827 FIL E14	4099854066665	■	40	E14	83	25	4.2	470	2700	80	300	15000	▶	3
LED SPECIAL T SLIM DIM – Dimmable slim LED lamps														
T SLIM DIM 60 320 ° 7 W/2700 K E14	4058075607316	—	60	E14	92	20	7.0	806	2700	≥80	320	15000	▶	5
LED PIN 12 V DIM P – Dimmable low-voltage 12 V LED lamps with retrofit pin base														
PIN20 DIM P 2 W 827 CL G4	4099854064661	■	20	G4	40	15	2.0	200	2700	≥80	320	25000	▶	6
LED PIN 12 V DIM – Dimmable low-voltage 12 V LED lamps with retrofit pin base														
P DIM PIN 40 320 ° 4.5 W/2700 K GY6.35	4058075607255	—	40	GY6.35	50	18	4.5	470	2700	≥80	320	20000	▶	7
LED PIN MICRO 12 V – Small sized low-voltage 12 V LED lamps with retrofit pin base														
PIN MICRO 10 300 ° 1 W/2700 K G4	4058075523098	—	10	G4	30	10	1.0	100	2700	≥80	300	15000	▶	8
LED PIN 12V P – Low-voltage 12 V LED lamps with retrofit pin base														
PIN10 P 0.9 W 827 CL G4	4099854064722	■	10	G4	33	12	0.9	100	2700	≥80	320	15000	▶	9
PIN20 P 1.8 W 827 CL G4	4099854064753	■	20	G4	36	13	1.8	200	2700	≥80	320	15000	▶	9
PIN40 P 4 W 827 CL GY6.35	4099854064692	■	40	GY6.35	50	18	4.0	470	2700	≥80	320	15000	▶	10
LED PIN 12V P – Low-voltage 12 V LED lamps with retrofit pin base														
PIN28 P 2.6W 827 CL G4	4099854048616	■	28	G4	40	14	2.6	300	2700	80	320	15000	▶	11
PIN28 P 2.6W 827 CL GY6.35	4099854048470	■	28	GY6.35	40	14	2.6	300	2700	80	320	15000	▶	12
LED PIN G9 DIM P – Dimmable LED lamps with retrofit pin base G9														
PIN30 DIM P 3W 827 CL G9	4099854048586	■	30	G9	52	16	3.0	320	2700	80	300	25000	▶	13
LED PIN G9 DIM P – Dimmable LED lamps with retrofit pin base G9														
PIN40 DIM P 4 W 827 CL G9	4099854064814	■	40	G9	59	18	4.0	470	2700	≥80	320	25000	▶	14

■ SUPERIOR CLASS ■ PERFORMANCE CLASS ■ VALUE CLASS



Check ballast or dimmer compatibility at ledvance.com/compatibility

All technical parameters apply to the entire lamp. Due to the complex production process for light-emitting diodes, the typical values shown for the technical LED parameters are purely statistical values that do not necessarily match the actual technical parameters of each individual product, which can vary from the typical value.

¹ L70/B50 | ² Energy efficiency class (EEC) on a scale of A (highest efficiency) to G (lowest efficiency)

³ Refer to www.ledvance.com/guarantee for precise conditions | ⁴ Compatibility list also online: ledvance.com/compatibility

LED SPECIAL LAMPS

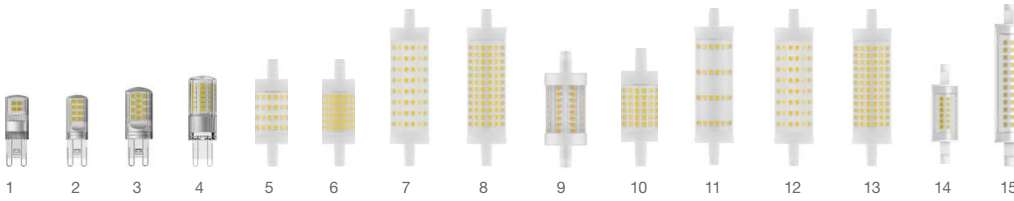

wΔW Power in W for conventional technology

Product name GTIN (EAN) Segmentation

LED PIN G9 P – LED lamps with retrofit pin base G9

Product Name	GTIN (EAN)	Segmentation	W _{ΔW}	Beam Angle	Diameter	W	lm	K	CRI	Temp	Efficacy	No.	
PIN20 P 1.9 W 827 CL G9	4099854064579	■	20	G9	46	15	1.9	200	2700	≥80	300	15000	1
PIN30 P 2.6 W 827 CL G9	4099854064548	■	30	G9	47	15	2.6	320	2700	≥80	300	15000	2
PIN30 P 2.6 W 840 CL G9	4099854064517	■	30	G9	47	15	2.6	320	4000	≥80	300	15000	2
PIN40 P 4.2 W 827 CL G9	4099854064609	■	40	G9	52	19	4.2	470	2700	≥80	300	15000	3
PIN40 P 4.2 W 840 CL G9	4099854064630	■	40	G9	52	19	4.2	470	4000	≥80	300	15000	3
PIN50 P 4.8 W 827 CL G9	4099854064784	■	48	G9	59	18	4.8	600	2700	≥80	320	15000	4
PIN50 P 4.8 W 840 CL G9	4099854064845	■	48	G9	59	18	4.8	600	4000	≥80	320	15000	4

LINE R7s DIM P – Dimmable double-ended special LED lamp

Product Name	GTIN (EAN)	Segmentation	W _{ΔW}	Beam Angle	Diameter	W	lm	K	CRI	Temp	Efficacy	No.	
LINE R7S 75 DIM P 9.5 W 827 R7s	4099854064906	■	75	R7s	78	28	9.5	1055	2700	≥80	300	25000	5
LINE R7S 100 DIM P 12 W 827 R7s	4099854064876	■	100	R7s	78	28	12.0	1521	2700	≥80	300	25000	6
LINE R7S 125 DIM P 15W 827 R7s	4099854048753	■	125	R7s	118	28	15.0	2000	2700	80	300	25000	7
LINE R7S 150 DIM P 18.5W 827 R7s	4099854048678	■	150	R7s	118	28	18.2	2452	2700	80	300	25000	8

LED LINE R7s P – Double-ended special LED lamps

Product Name	GTIN (EAN)	Segmentation	W _{ΔW}	Beam Angle	Diameter	W	lm	K	CRI	Temp	Efficacy	No.	
LINE R7S 60 P 7.3W 827 R7s	4099854049682	■	60	R7s	78	28	7.3	806	2700	80	330	15000	9
LINE R7S 75 P 9W 827 R7s	4099854049736	■	75	R7s	78	28	8.0	1055	2700	80	330	15000	10
LINE R7S 100 P 11.5W 827 R7s	4099854049767	■	100	R7s	78	28	11.5	1521	2700	80	300	15000	11
LINE R7S 125 P 15W 827 R7s	4099854048647	■	125	R7s	118	28	15.0	2000	2700	80	300	15000	12
LINE R7S 150 P 18.5W 827 R7s	4099854048722	■	150	R7s	118	28	18.2	2452	2700	80	300	15000	13
LINE R7S 100 P 13 W 827 R7s	4099854064937	■	100	R7s	118	28	13.0	1521	2700	≥80	300	15000	11

LED SLIM LINE R7s – Slim LED lamps with retrofit base R7s

Product Name	GTIN (EAN)	Segmentation	W _{ΔW}	Beam Angle	Diameter	W	lm	K	CRI	Temp	Efficacy	No.	
SLIM LINE R7s 78.00 mm 60 7 W/2700 K R7s	4058075432710	—	60	R7s	78	20	7.0	806	2700	≥80	300	15000	14
SLIM LINE R7s 118.00 mm 100 12 W/2700 K R7s	4058075432734	—	100	R7s	118	20	12.0	1521	2700	≥80	300	15000	15

SAFETY ADVICE: To ensure full light efficiency and product lifetime, it is recommended to detach any glass or cover of the luminaire.



Check ballast or dimmer compatibility at ledvance.com/compatibility

■ SUPERIOR CLASS ■ PERFORMANCE CLASS ■ VALUE CLASS

All technical parameters apply to the entire lamp. Due to the complex production process for light-emitting diodes, the typical values shown for the technical LED parameters are purely statistical values that do not necessarily match the actual technical parameters of each individual product, which can vary from the typical value.

¹ L70/B50 | ² Energy efficiency class (EEC) on a scale of A (highest efficiency) to G (lowest efficiency)

³ Refer to www.ledvance.com/guarantee for precise conditions | ⁴ Compatibility list also online: ledvance.com/compatibility

POSSIBLE LED ALTERNATIVES TO FLUORESCENT TUBES, COMPACT FLUORESCENT LAMPS AND HALOGEN PINS

In the tables below you can see what LED alternatives are available to replace the conventional light sources that are being withdrawn from the market. There are some important criteria to consider. LED light sources do not have the same output as their conventional counterparts – their beam angles are not identical. Therefore, we recommend that you carry out application-specific lighting design before any installation to ensure that the lighting level is the same after the replacement.

Light sources affected by the lamp ban	Possible LED alternatives
--	---------------------------

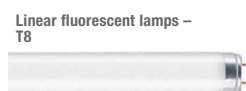

Conventional lamp	EAN (GTIN)	LED alternative	Ballast	Note to the proposed alternative
L 18 W/827	4099854026119	LED TUBE T8 UNIVERSAL P 600 mm 7.5W 830	ECG ¹ / CCG / AC Mains	Color temperature 3 000 K
L 18 W/830	4099854026119	LED TUBE T8 UNIVERSAL P 600 mm 7.5W 830	ECG ¹ / CCG / AC Mains	
L 18 W/840	4099854026157	LED TUBE T8 UNIVERSAL P 600 mm 7.5W 840	ECG ¹ / CCG / AC Mains	
L 18 W/865	4099854026218	LED TUBE T8 UNIVERSAL P 600 mm 7.5W 865	ECG ¹ / CCG / AC Mains	
L 18 W/880	4099854026218	LED TUBE T8 UNIVERSAL P 600 mm 7.5W 865	ECG ¹ / CCG / AC Mains	Color temperature 6 500 K
L 36 W/827	—	—	—	—
L 36 W/830	4099854026294	LED TUBE T8 UNIVERSAL ULTRA OUTPUT P 1200 mm 15W 840	ECG ¹ / CCG / AC Mains	Color temperature 4 000 K
L 36 W/840	4099854026294	LED TUBE T8 UNIVERSAL ULTRA OUTPUT P 1200 mm 15W 840	ECG ¹ / CCG / AC Mains	
L 36 W/865	4099854026331	LED TUBE T8 UNIVERSAL ULTRA OUTPUT P 1200 mm 15W 865	ECG ¹ / CCG / AC Mains	
L 36 W/880	4099854026331	LED TUBE T8 UNIVERSAL ULTRA OUTPUT P 1200 mm 15W 865	ECG ¹ / CCG / AC Mains	Color temperature 6 500 K
L 58 W/827	—	—	—	—
L 58 W/830	4099854026577	LED TUBE T8 UNIVERSAL ULTRA OUTPUT P 1500 mm 23W 840	ECG ¹ / CCG / AC Mains	Color temperature 4 000 K
L 58 W/840	4099854026577	LED TUBE T8 UNIVERSAL ULTRA OUTPUT P 1500 mm 23W 840	ECG ¹ / CCG / AC Mains	
L 58 W/865	4099854026591	LED TUBE T8 UNIVERSAL ULTRA OUTPUT P 1500 mm 23W 865	ECG ¹ / CCG / AC Mains	
L 58 W/880	4099854026591	LED TUBE T8 UNIVERSAL ULTRA OUTPUT P 1500 mm 23W 865	ECG ¹ / CCG / AC Mains	Color temperature 6 500 K

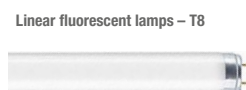

Conventional lamp	EAN (GTIN)	LED alternative	Ballast	Note to the proposed alternative
L 18 W/827	4099854038969	LED TUBE T8 EM V 600 mm 6.6W 830	CCG	Color temperature 3 000 K
L 18 W/830	4099854038969	LED TUBE T8 EM V 600 mm 6.6W 830	CCG	
L 18 W/840	4099854037412	LED TUBE T8 EM S 600 mm 6.3W 840	CCG	
L 18 W/865	4099854037436	LED TUBE T8 EM S 600 mm 6.3W 865	CCG	
L 18 W/880	4099854037436	LED TUBE T8 EM S 600 mm 6.3W 865	CCG	Color temperature 6 500 K
L 36 W/827	4099854037092	LED TUBE T8 EM ULTRA OUTPUT S 1200 mm 14W 830	CCG	Color temperature 3 000 K
L 36 W/830	4099854037092	LED TUBE T8 EM ULTRA OUTPUT S 1200 mm 14W 830	CCG	
L 36 W/840	4099854037115	LED TUBE T8 EM ULTRA OUTPUT S 1200 mm 14W 840	CCG	
L 36 W/865	4099854037191	LED TUBE T8 EM ULTRA OUTPUT S 1200 mm 14W 865	CCG	
L 36 W/880	4099854037191	LED TUBE T8 EM ULTRA OUTPUT S 1200 mm 14W 865	CCG	Color temperature 6 500 K
L 58 W/827	4099854037214	LED TUBE T8 EM ULTRA OUTPUT S 1500 mm 22.2W 830	CCG	Color temperature 3 000 K
L 58 W/830	4099854037214	LED TUBE T8 EM ULTRA OUTPUT S 1500 mm 22.2W 830	CCG	
L 58 W/840	4099854037238	LED TUBE T8 EM ULTRA OUTPUT S 1500 mm 22.1W 840	CCG	
L 58 W/865	4099854037276	LED TUBE T8 EM ULTRA OUTPUT S 1500 mm 22.1W 865	CCG	
L 58 W/880	4099854037276	LED TUBE T8 EM ULTRA OUTPUT S 1500 mm 22.1W 865	CCG	Color temperature 6 500 K

This is just a small selection of LED alternatives from our extensive range of lamps. For more LED alternatives please visit ledvance.com/lampfinder



¹Check ECG compatibility at ledvance.com/compatibility or ledvance.com/tubefinder

Light sources affected by the lamp ban Possible LED alternatives

Linear fluorescent lamps – T5 HE

LED TUBE T5 HF HE



Conventional lamp	EAN (GTIN)	LED alternative	Ballast	Note to the proposed alternative
HE 14 W/827	4099854029448	LED TUBE T5 HF HE14 P 549 mm 7W 830	ECG ¹	Color temperature 3 000 K
HE 14 W/830	4099854029448	LED TUBE T5 HF HE14 P 549 mm 7W 830	ECG ¹	
HE 14 W/840	4099854029462	LED TUBE T5 HF HE14 P 549 mm 7W 840	ECG ¹	
HE 14 W/865	4099854029486	LED TUBE T5 HF HE14 P 549 mm 7W 865	ECG ¹	
HE 21 W/827	4099854029387	LED TUBE T5 HF HE21 P 849 mm 10W 830	ECG ¹	Color temperature 3 000 K
HE 21 W/830	4099854029387	LED TUBE T5 HF HE21 P 849 mm 10W 830	ECG ¹	
HE 21 W/840	4099854029400	LED TUBE T5 HF HE21 P 849 mm 10W 840	ECG ¹	
HE 21 W/865	4099854029424	LED TUBE T5 HF HE21 P 849 mm 10W 865	ECG ¹	
HE 28 W/827	4099854029325	LED TUBE T5 HF HE28 P 1149 mm 16W 830	ECG ¹	Color temperature 3 000 K
HE 28 W/830	4099854029325	LED TUBE T5 HF HE28 P 1149 mm 16W 830	ECG ¹	
HE 28 W/840	4099854029349	LED TUBE T5 HF HE28 P 1149 mm 16W 840	ECG ¹	
HE 28 W/865	4099854029363	LED TUBE T5 HF HE28 P 1149 mm 16W 865	ECG ¹	
HE 35 W/827	4099854029172	LED TUBE T5 HF HE35 P 1449 mm 18W 830	ECG ¹	Color temperature 3 000 K
HE 35 W/830	4099854029172	LED TUBE T5 HF HE35 P 1449 mm 18W 830	ECG ¹	
HE 35 W/840	4099854029196	LED TUBE T5 HF HE35 P 1449 mm 18W 840	ECG ¹	
HE 35 W/865	4099854029219	LED TUBE T5 HF HE35 P 1449 mm 18W 865	ECG ¹	

Linear fluorescent lamps – T5 HO

LED TUBE T5 AC/HF HO



Conventional lamp	EAN (GTIN)	LED alternative	Ballast	Note to the proposed alternative
HO 24 W/827	4099854081200	LED TUBE T5 AC HO24 P 549 mm 10W 830	AC Mains	Color temperature 3 000 K
HO 24 W/830	4099854081200	LED TUBE T5 AC HO24 P 549 mm 10W 830	AC Mains	
HO 24 W/840	4099854081224	LED TUBE T5 AC HO24 P 549 mm 10W 840	AC Mains	
HO 24 W/865	4099854081248	LED TUBE T5 AC HO24 P 549 mm 10W 865	AC Mains	
HO 39 W/830	4099854081149	LED TUBE T5 AC HO39 P 849 mm 16W 830	AC Mains	
HO 39 W/840	4099854081163	LED TUBE T5 AC HO39 P 849 mm 16W 840	AC Mains	
HO 39 W/865	4099854081187	LED TUBE T5 AC HO39 P 849 mm 16W 865	AC Mains	
HO 49 W/827	4099854029110	LED TUBE T5 HF HO49 P 1449 mm 26W 830	ECG ¹	Color temperature 3 000 K
HO 49 W/830	4099854029110	LED TUBE T5 HF HO49 P 1449 mm 26W 830	ECG ¹	
HO 49 W/840	4099854029134	LED TUBE T5 HF HO49 P 1449 mm 26W 840	ECG ¹	
HO 49 W/865	4099854029158	LED TUBE T5 HF HO49 P 1449 mm 26W 865	ECG ¹	
HO 54 W/827	4099854029257	LED TUBE T5 HF HO54 P 1149 mm 26W 830	ECG ¹	Color temperature 3 000 K
HO 54 W/830	4099854029257	LED TUBE T5 HF HO54 P 1149 mm 26W 830	ECG ¹	
HO 54 W/840	4099854029271	LED TUBE T5 HF HO54 P 1149 mm 26W 840	ECG ¹	
HO 54 W/865	4099854029301	LED TUBE T5 HF HO54 P 1149 mm 26W 865	ECG ¹	
HO 80 W/830	4099854029059	LED TUBE T5 HF HO80 P 1449 mm 36W 830	ECG ¹	
HO 80 W/840	4099854029073	LED TUBE T5 HF HO80 P 1449 mm 36W 840	ECG ¹	
HO 80 W/865	4099854029097	LED TUBE T5 HF HO80 P 1449 mm 36W 865	ECG ¹	

Linear fluorescent lamps – T5 DE LUXE HO

LED TUBE T5 AC/HF HO



Conventional lamp	EAN (GTIN)	LED alternative	Ballast	Note to the proposed alternative
HO 24 W/940	4099854081224	LED TUBE T5 AC HO24 P 549 mm 10W 840	AC Mains	CRI > 80
HO 24 W/965	4099854081248	LED TUBE T5 AC HO24 P 549 mm 10W 865	AC Mains	CRI > 80
HO 49 W/940	4099854029134	LED TUBE T5 HF HO49 P 1449 mm 26W 840	ECG ¹	CRI > 80
HO 49 W/965	4099854029158	LED TUBE T5 HF HO49 P 1449 mm 26W 865	ECG ¹	CRI > 80
HO 54 W/940	4099854029271	LED TUBE T5 HF HO54 P 1149 mm 26W 840	ECG ¹	CRI > 80
HO 54 W/965	4099854029301	LED TUBE T5 HF HO54 P 1149 mm 26W 865	ECG ¹	CRI > 80

This is just a small selection of LED alternatives from our extensive range of lamps. For more LED alternatives please visit ledvance.com/lampfinder



¹Check ECG compatibility at ledvance.com/compatibility or ledvance.com/tubefinder

Light sources affected by the lamp ban | **Possible LED alternatives**

Compact fluorescent lamps - DULUX S, 2 Pins

DULUX LED S EM & AC MAINS V



Conventional lamp	EAN (GTIN)	LED alternative	Ballast	Note to the proposed alternative
DULUX S 5 W/827	—	LED luminaire solutions available. Large range of innovative LED luminaires for complete replacement at ledvance.com/luminaires	—	—
DULUX S 5 W/840	—	—	—	—
DULUX S 7 W/827	4058075822931	DULUX LED S7 EM & AC MAINS V 3.5W 830 G23	CCG / AC mains	Color temperature 3 000 K
DULUX S 7 W/830	4058075822931	DULUX LED S7 EM & AC MAINS V 3.5W 830 G23	CCG / AC mains	—
DULUX S 7 W/840	4058075822955	DULUX LED S7 EM & AC MAINS V 3.5W 840 G23	CCG / AC mains	—
DULUX S 9 W/827	4058075822979	DULUX LED S9 EM & AC MAINS V 4W 830 G23	CCG / AC mains	Color temperature 3 000 K
DULUX S 9 W/830	4058075822979	DULUX LED S9 EM & AC MAINS V 4W 830 G23	CCG / AC mains	—
DULUX S 9 W/840	4058075822993	DULUX LED S9 EM & AC MAINS V 4W 840 G23	CCG / AC mains	—
DULUX S 11 W/827	4058075823013	DULUX LED S11 EM & AC MAINS V 6W 830 G23	CCG / AC mains	Color temperature 3 000 K
DULUX S 11 W/830	4058075823013	DULUX LED S11 EM & AC MAINS V 6W 830 G23	CCG / AC mains	—
DULUX S 11 W/840	4058075823037	DULUX LED S11 EM & AC MAINS V 6W 840 G23	CCG / AC mains	—

Compact fluorescent lamps - DULUX S/E, 4 Pins



Conventional lamp	EAN (GTIN)	LED alternative	Ballast	Note to the proposed alternative
DULUX S/E 7 W/827	—	LED luminaire solutions available. Large range of innovative LED luminaires for complete replacement at ledvance.com/luminaires	—	—
DULUX S/E 7 W/830	—		—	—
DULUX S/E 7 W/840	—		—	—
DULUX S/E 9 W/827	—		—	—
DULUX S/E 9 W/830	—		—	—
DULUX S/E 9 W/840	—		—	—
DULUX S/E 11 W/827	—		—	—
DULUX S/E 11 W/830	—		—	—
DULUX S/E 11 W/840	—		—	—

Compact fluorescent lamps - DULUX D, 2 Pins

DULUX LED D EM & AC MAINS V



Conventional lamp	EAN (GTIN)	LED alternative	Ballast	Note to the proposed alternative
DULUX D 10 W/827	4058075823051	DULUX LED D10 EM & AC MAINS V 5W 830 G24D-1	CCG / AC mains	Color temperature 3 000 K
DULUX D 10 W/830	4058075823051	DULUX LED D10 EM & AC MAINS V 5W 830 G24D-1	CCG / AC mains	—
DULUX D 10 W/840	4058075823075	DULUX LED D10 EM & AC MAINS V 5W 840 G24D-1	CCG / AC mains	—
DULUX D 13 W/827	4058075823099	DULUX LED D13 EM & AC MAINS V 6W 830 G24D-1	CCG / AC mains	Color temperature 3 000 K
DULUX D 13 W/830	4058075823099	DULUX LED D13 EM & AC MAINS V 6W 830 G24D-1	CCG / AC mains	—
DULUX D 13 W/840	4058075823112	DULUX LED D13 EM & AC MAINS V 6W 840 G24D-1	CCG / AC mains	—
DULUX D 18 W/827	4058075823136	DULUX LED D18 EM & AC MAINS V 7W 830 G24D-2	CCG / AC mains	Color temperature 3 000 K
DULUX D 18 W/830	4058075823136	DULUX LED D18 EM & AC MAINS V 7W 830 G24D-2	CCG / AC mains	—
DULUX D 18 W/840	4058075823150	DULUX LED D18 EM & AC MAINS V 7W 840 G24D-2	CCG / AC mains	—
DULUX D 18 W/865	4058075823150	DULUX LED D18 EM & AC MAINS V 7W 840 G24D-2	CCG / AC mains	Color temperature 4 000 K
DULUX D 26 W/827	4058075823174	DULUX LED D26 EM & AC MAINS V 9W 830 G24D-3	CCG / AC mains	Color temperature 3 000 K
DULUX D 26 W/830	4058075823174	DULUX LED D26 EM & AC MAINS V 9W 830 G24D-3	CCG / AC mains	—
DULUX D 26 W/840	4058075823198	DULUX LED D26 EM & AC MAINS V 9W 840 G24D-3	CCG / AC mains	—
DULUX D 26 W/865	4058075823198	DULUX LED D26 EM & AC MAINS V 9W 840 G24D-3	CCG / AC mains	Color temperature 4 000 K

NOT SURE WHAT TO CHOOSE?

LEDVANCE takes care of tailor-made calculations and offers you a customized solution for your lighting requirements – all from a single source. Please get in touch. We look forward to hearing from you.

Email: contact@ledvance.com | **Phone:** +49 89 780673-660

YOUR BENEFITS AT A GLANCE

- Uniformly good light distribution
- Precise wattage per sqm
- Maximum efficient calculation of required number of luminaires and VIVARES components

This is just a small selection of LED alternatives from our extensive range of lamps. For more LED alternatives please visit ledvance.com/lampfinder



Light sources affected by the lamp ban Possible LED alternatives

Compact fluorescent lamps - Dulux D/E, 4 Pins

DULUX LED D/E HF & AC MAINS V



Conventional lamp	EAN (GTIN)	LED alternative	Ballast	Note to the proposed alternative
DULUX D/E 10 W/827	---	LED luminaire solutions available. Large range of innovative LED luminaires for complete replacement at ledvance.com/luminaires	ECG ¹ /AC Mains	Color temperature 3000K
DULUX D/E 10 W/830	---		ECG ¹ /AC Mains	
DULUX D/E 10 W/840	---		ECG ¹ /AC Mains	
DULUX D/E 13 W/827	4058075821934	DULUX LED D/E13 HF & AC MAINS V 6W 830 G24Q-1	ECG ¹ /AC Mains	Color temperature 3000K
DULUX D/E 13 W/830	4058075821934	DULUX LED D/E13 HF & AC MAINS V 6W 830 G24Q-1	ECG ¹ /AC Mains	
DULUX D/E 13 W/840	4058075821958	DULUX LED D/E13 HF & AC MAINS V 6W 840 G24Q-1	ECG ¹ /AC Mains	
DULUX D/E 18 W/827	4058075821972	DULUX LED D/E18 HF & AC MAINS V 7W 830 G24Q-2	ECG ¹ /AC Mains	Color temperature 3000K
DULUX D/E 18 W/830	4058075821972	DULUX LED D/E18 HF & AC MAINS V 7W 830 G24Q-2	ECG ¹ /AC Mains	
DULUX D/E 18 W/840	4058075821996	DULUX LED D/E18 HF & AC MAINS V 7W 840 G24Q-2	ECG ¹ /AC Mains	
DULUX D/E 18 W/865	4058075821996	DULUX LED D/E18 HF & AC MAINS V 7W 840 G24Q-2	ECG ¹ /AC Mains	Color temperature 4000K
DULUX D/E 26 W/827	4058075822016	DULUX LED D/E26 HF & AC MAINS V 10W 830 G24Q-3	ECG ¹ /AC Mains	Color temperature 3000K
DULUX D/E 26 W/830	4058075822016	DULUX LED D/E26 HF & AC MAINS V 10W 830 G24Q-3	ECG ¹ /AC Mains	
DULUX D/E 26 W/840	4058075822030	DULUX LED D/E26 HF & AC MAINS V 10W 840 G24Q-3	ECG ¹ /AC Mains	
DULUX D/E 26 W/865	4058075822030	DULUX LED D/E26 HF & AC MAINS V 10W 840 G24Q-3	ECG ¹ /AC Mains	Color temperature 4000K

Compact fluorescent lamps - DULUX T PLUS, 2 Pins

DULUX LED T EM & AC MAINS V



Conventional lamp	EAN (GTIN)	LED alternative	Ballast	Note to the proposed alternative
DULUX T PLUS 13 W/830	4058075823211	DULUX LED T13 EM & AC MAINS V 6W 830 GX24D-1	CCG/AC mains	
DULUX T PLUS 13 W/840	4058075823235	DULUX LED T13 EM & AC MAINS V 6W 840 GX24D-1	CCG/AC mains	
DULUX T PLUS 18 W/827	4058075823259	DULUX LED T18 EM & AC MAINS V 7W 830 GX24D-2	CCG/AC mains	Color temperature 3000K
DULUX T PLUS 18 W/830	4058075823259	DULUX LED T18 EM & AC MAINS V 7W 830 GX24D-2	CCG/AC mains	
DULUX T PLUS 18 W/840	4058075823273	DULUX LED T18 EM & AC MAINS V 7W 840 GX24D-2	CCG/AC mains	
DULUX T PLUS 26 W/827	4058075823297	DULUX LED T26 EM & AC MAINS V 9W 830 GX24D-3	CCG/AC mains	Color temperature 3000K
DULUX T PLUS 26 W/830	4058075823297	DULUX LED T26 EM & AC MAINS V 9W 830 GX24D-3	CCG/AC mains	
DULUX T PLUS 26 W/840	4058075823310	DULUX LED T26 EM & AC MAINS V 9W 840 GX24D-3	CCG/AC mains	

Compact fluorescent lamps - DULUX T/E PLUS, 4 Pins

DULUX LED T/E HF & AC MAINS V



Conventional lamp	EAN (GTIN)	LED alternative	Ballast	Note to the proposed alternative
DULUX T/E PLUS 13 W/830	4058075822214	DULUX LED T/E13 HF & AC MAINS V 6W 830 GX24Q-1	ECG ¹ /AC Mains	
DULUX T/E PLUS 13 W/840	4058075822238	DULUX LED T/E13 HF & AC MAINS V 6W 840 GX24Q-1	ECG ¹ /AC Mains	
DULUX T/E PLUS 18 W/827	4058075822252	DULUX LED T/E18 HF & AC MAINS V 7W 830 GX24Q-2	ECG ¹ /AC Mains	Color temperature 3000K
DULUX T/E PLUS 18 W/830	4058075822252	DULUX LED T/E18 HF & AC MAINS V 7W 830 GX24Q-2	ECG ¹ /AC Mains	
DULUX T/E PLUS 18 W/840	4058075822276	DULUX LED T/E18 HF & AC MAINS V 7W 840 GX24Q-2	ECG ¹ /AC Mains	
DULUX T/E PLUS 26 W/827	4058075822290	DULUX LED T/E26 HF & AC MAINS V 10W 830 GX24Q-3	ECG ¹ /AC Mains	Color temperature 3000K
DULUX T/E PLUS 26 W/830	4058075822290	DULUX LED T/E26 HF & AC MAINS V 10W 830 GX24Q-3	ECG ¹ /AC Mains	
DULUX T/E PLUS 26 W/840	4058075822313	DULUX LED T/E26 HF & AC MAINS V 10W 840 GX24Q-3	ECG ¹ /AC Mains	
DULUX T/E PLUS 32 W/827	4058075822337	DULUX LED T/E32 HF & AC MAINS V 16W 830 GX24Q-3	ECG ¹ /AC Mains	Color temperature 3000K
DULUX T/E PLUS 32 W/830	4058075822337	DULUX LED T/E32 HF & AC MAINS V 16W 830 GX24Q-3	ECG ¹ /AC Mains	
DULUX T/E PLUS 32 W/840	4058075822351	DULUX LED T/E32 HF & AC MAINS V 16W 840 GX24Q-3	ECG ¹ /AC Mains	
DULUX T/E PLUS 42 W/827	4058075822375	DULUX LED T/E42 HF & AC MAINS V 20W 830 GX24Q-4	ECG ¹ /AC Mains	Color temperature 3000K
DULUX T/E PLUS 42 W/830	4058075822375	DULUX LED T/E42 HF & AC MAINS V 20W 830 GX24Q-4	ECG ¹ /AC Mains	
DULUX T/E PLUS 42 W/840	4058075822399	DULUX LED T/E42 HF & AC MAINS V 20W 840 GX24Q-4	ECG ¹ /AC Mains	

This is just a small selection of LED alternatives from our extensive range of lamps. For more LED alternatives please visit ledvance.com/lampfinder



¹Check ECG compatibility at ledvance.com/compatibility

Light sources affected by the lamp ban	Possible LED alternatives
--	---------------------------

Compact fluorescent lamps – DULUX L



DULUX LED L HF & AC MAINS V



Conventional lamp	EAN (GTIN)	LED alternative	Ballast	Note to the proposed alternative
DULUX L 18 W/827	4058075822054	DULUX LED L18 HF & AC MAINS V 8W 830 2G11	ECG/AC Mains	Color temperature 3 000 K
DULUX L 18 W/830	4058075822054	DULUX LED L18 HF & AC MAINS V 8W 830 2G11	ECG/AC Mains	
DULUX L 18 W/840	4058075822078	DULUX LED L18 HF & AC MAINS V 8W 840 2G11	ECG/AC Mains	
DULUX L 24 W/827	4058075822092	DULUX LED L24 HF & AC MAINS V 12W 830 2G11	ECG/AC Mains	
DULUX L 24 W/830	4058075822092	DULUX LED L24 HF & AC MAINS V 12W 830 2G11	ECG/AC Mains	
DULUX L 24 W/840	4058075822115	DULUX LED L24 HF & AC MAINS V 12W 840 2G11	ECG/AC Mains	
DULUX L 36 W/827	4058075822139	DULUX LED L36 HF & AC MAINS V 18W 830 2G11	ECG/AC Mains	
DULUX L 36 W/830	4058075822139	DULUX LED L36 HF & AC MAINS V 18W 830 2G11	ECG/AC Mains	

Compact fluorescent lamps - DULUX F, 4 Pins



DULUX LED F EM & AC MAINS V



Conventional lamp	EAN (GTIN)	LED alternative	Ballast	Note to the proposed alternative
DULUX F 18 W/830	4058075822412	DULUX LED F18 EM & AC MAINS V 8W 830 2G10	CCG/AC mains	
DULUX F 18 W/840	4058075822436	DULUX LED F18 EM & AC MAINS V 8W 840 2G10	CCG/AC mains	
DULUX F 24 W/827	4058075822450	DULUX LED F24 EM & AC MAINS V 12W 830 2G10	CCG/AC mains	Color temperature 3 000 K
DULUX F 24 W/830	4058075822450	DULUX LED F24 EM & AC MAINS V 12W 830 2G10	CCG/AC mains	
DULUX F 24 W/840	4058075822474	DULUX LED F24 EM & AC MAINS V 12W 840 2G10	CCG/AC mains	
DULUX F 36 W/827	4058075822498	DULUX LED F36 EM & AC MAINS V 20W 830 2G10	CCG/AC mains	Color temperature 3 000 K
DULUX F 36 W/830	4058075822498	DULUX LED F36 EM & AC MAINS V 20W 830 2G10	CCG/AC mains	
DULUX F 36 W/840	4058075822511	DULUX LED F36 EM & AC MAINS V 20W 840 2G10	CCG/AC mains	

HALOPIN PRO



PIN P G9



Conventional pin	EAN (GTIN)	LED alternative	Note to the proposed alternative
HALOPIN PRO 66720 20W 230V G9	4099854064579	PIN20 P 1.9 W 827 CL G9	not dimmable
HALOPIN PRO 66733 33W 230V G9	4099854048586	PIN30 DIM P 3W 827 CL G9	dimmable ²
HALOPIN PRO 66748 48W 230V G9	4099854064814	PIN40 DIM P 4 W 827 CL G9	dimmable ²
HALOPIN PRO 66760 60W 230V G9	4099854064784	PIN50 P 4.8 W 827 CL G9	not dimmable

HALOSTAR PRO



PIN P G4, PIN P GY6.35 or P DIM PIN GY6.36



Conventional pin	EAN (GTIN)	LED alternative	Note to the proposed alternative
HALOSTAR PRO 64417 7W 12V G4	4099854064722	PIN10 P 0.9 W 827 CL G4	not dimmable
HALOSTAR PRO 64423 14W 12V G4	4099854064753	PIN20 P 1.8 W 827 CL G4	not dimmable
HALOSTAR PRO 64429 25W 12V GY6.35	4099854048470	PIN28 P 2.6W 827 CL GY6.35	not dimmable
HALOSTAR PRO 64432 35W 12V GY6.35	4099854048470	PIN28 P 2.6W 827 CL GY6.35	not dimmable
HALOSTAR PRO 64440 50W 12V GY6.35	4099854064692	PIN40 P 4 W 827 CL GY6.35	not dimmable
HALOSTAR PRO 64447 60W 12V GY6.35	4058075607255	P DIM PIN 40 320° 4.5 W/2700 K GY6.35	dimmable ²

HALOSTAR STARLITE



PIN P G4, PIN P GY6.35 or PIN MICRO G4



Conventional pin	EAN (GTIN)	LED alternative	Note to the proposed alternative
HALOSTAR STARLITE 64410S AX 10W 6V G4	4099854064722	PIN10 P 0.9 W 827 CL G4	not dimmable
HALOSTAR STARLITE 64405S 5W 12V G4	4058075523098	PIN MICRO 10 300 ° 1 W/2700 K G4	not dimmable
HALOSTAR STARLITE 64415S AX 10W 12VG4	4099854064722	PIN10 P 0.9 W 827 CL G4	not dimmable
HALOSTAR STARLITE 64425S AX 20W 12VG4	4099854064661	PIN20 DIM P 2 W 827 CL G4	dimmable ²
HALOSTAR STARLITE 64427S AX 20W 12V GY6.35	4099854048470	PIN28 P 2.6W 827 CL GY6.35	not dimmable
HALOSTAR STARLITE 64432S AX 35W 12V GY6.35	4099854048470	PIN28 P 2.6W 827 CL GY6.35	not dimmable
HALOSTAR STARLITE 64440S AX 50W 12V GY6.35	4099854064692	PIN40 P 4 W 827 CL GY6.35	not dimmable
HALOSTAR STARLITE 64450S AX 75W 12V GY6.35	—	—	—
HALOSTAR STARLITE 64458S AX 90W 12V GY6.35	—	—	—

This is just a small selection of LED alternatives from our extensive range of lamps. For more LED alternatives please visit ledvance.com/lampfinder



¹Check ECG compatibility at ledvance.com/compatibility
²Check compatibility at ledvance.com/compatibility

SHEDDING LIGHT AND SYMBOLS



Shatter protection



Operating frequency in Hz



Operation on conventional control gear



Type of protection



Base



Operation on electronic control gear



Dimmable



Length [mm]



Operation on conventional control gear and ignitor



Sensor versions



Diameter [mm]



Energy efficiency class



Wireless



Beam angle in °



Recommended retail price excl. VAT



Glow DIM 2000K...2700K



Color temperature in K



Unit of Packaging



Power in W for conventional technology



Color rendering index



Fig. no.



Power in W



Light intensity in cd



Dimming interface DALI-2



Output voltage in V



Average period of use/life in hours (B50/L70)



Push-DIM function



Luminous flux in lm



Glass Material



LED TUBE EXTERNAL SYSTEM



Luminous efficacy



AC Mains



SELV voltage



TAKE ADVANTAGE OF THE SERVICE OFFERED BY LEDVANCE FOR TAILOR-MADE LIGHTING DESIGN

PROFESSIONAL LIGHTING DESIGN

DIALUX AND RELUX

LEDVANCE is collaborating with the developers of DIALux and RELUX software. So you can now easily integrate LEDVANCE products in your lighting designs. Our luminaire data is also BIM-compatible.

EVEN MORE CONVENIENT

LEDVANCE takes care of tailor-made calculations and offers you a customized solution for your lighting requirements – all from a single source.

YOUR BENEFITS AT A GLANCE

- Uniformly good light distribution
- Precise wattage per sqm
- Maximum efficient calculation of required number of luminaires and VIVARES components

SPECIFY

NEW: OUR LIGHT FOR YOUR PROJECT

Do you have a special project that calls for a special solution? Whether you're looking for a customized installation method, type of connection, light output, light management functions or even a completely individual luminaire – we can tailor products to your needs. Just ask us!



Are you interested in our special services for your project requirements? Then please get in touch. We look forward to hearing from you. **Email:** contact@ledvance.com | **Phone:** +49 89 780673-660

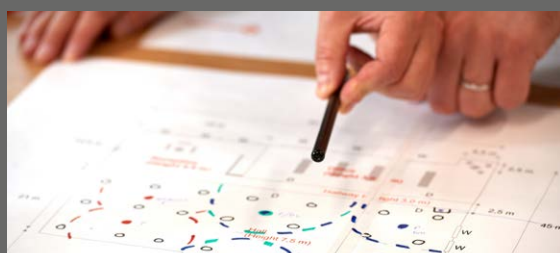

THE ONLINE TRAINING PLATFORM

A host of application-oriented eLearnings for professional users, practical tips concerning installation, integrated standards check, planning tips, and much more.

Register and find out more at training.ledvance.com

SAVING THE BEST FOR LAST: LED IS LEDVANCE

PROFESSIONAL LED LAMPS NOW BEAR OUR NAME



The change in the lighting market requires decisive action from all of us, which is why we are making the transition to innovative LED technology as easy as possible and offering our professional range of lamps under our own name throughout the EU. So in the future you only need to remember one thing: where LEDVANCE is written, inside quality, efficiency and future-proofing is assured.

100 YEARS OF EXPERIENCE, 7 YEARS OF LEDVANCE

Having emerged from the general lighting division of OSRAM, LEDVANCE has established itself as a leading brand in LED solutions.

NEW NAME, OLD FAVORITES

The name is new – and so is the EAN. Since we have linked the new LEDVANCE LED lamps with the well-known predecessor products in our online product catalog, your “old favorites” are still very easy to find during the transition phase. And when you look at the redesigned packaging you will quickly see that many of our professional LED lamps have become even more powerful with the change of brand. However lamps from the residential sector such as the VINTAGE EDITION 1906 or the LEDinestra range, which we continue to carry under the OSRAM brand, will of course continue to meet all your expectations in terms of quality, performance and efficiency.

THE SWITCH TO LED: AS EASY AS POSSIBLE

The EU-wide production ban on inefficient and pollutant-containing lamps signals the end of the fluorescent lamp. LEDVANCE wants to make the switch to EU-compliant LED technology as simple and straightforward as possible, which is why we offer practical replacements for almost every application – and why our professional range of lamps now bears the name LEDVANCE. The classification of the lamps into SUPERIOR, PERFORMANCE and VALUE product classes, which you already know from our luminaires, as well as a clear nomenclature with all important product information allow you to quickly and reliably choose the right lamp.



LED TUBE T8 EM UO S 1500 mm 22.1W 840

Example of the new lamp nomenclature

SUPERIOR CLASS
Indicates the product class in line with the luminaire portfolio (P = Performance Class, V = Value Class)

SUSTAINABLE PARTNERSHIP

LEDVANCE also supports you in terms of sustainability – with pioneering efficiency and, for example, with products which consist of recycled materials and promote the circular economy. The success of our commitment to sustainability is demonstrated by the silver medal awarded by EcoVadis. Find out more at [ledvance.com/sustainability](https://www.ledvance.com/sustainability)



ABOUT LEDVANCE



LEDVANCE

With offices in more than 50 countries and business activities in more than 140 countries, LEDVANCE is one of the world's leading general lighting providers for professional users and end consumers. Having emerged from OSRAM's general lighting division, LEDVANCE offers a wide-ranging portfolio of LED luminaires for a broad spectrum of applications, intelligent lighting products for Smart Home and Smart Building solutions, one of the most comprehensive ranges of advanced LED lamps in the lighting industry, traditional light sources, an LED Strip System and light management systems.

LEDVANCE GmbH
Parkring 29–33
85748 Garching
Germany
[LEDVANCE.COM](https://www.ledvance.com)

Partner:



[LEDVANCE.COM](https://www.ledvance.com)