

OREGON CHAPTER of the AMERICAN FISHERIES SOCIETY

45th Annual Meeting

Sharing Our Passion!

February 25-27, 2009



©RichGrost.com

The Riverhouse Hotel and Convention Center | Bend, Oregon



Let's turn the answers on.

The printing of this program was sponsored by PacifiCorp Energy, dedicated to providing safe, reliable, and renewable energy with environmental respect – and to generating answers for our future.



| | |
|--|-----------|
| Conference Maps | 4 |
| A Letter from Program Chair Rich Grost | 7 |
| 2009 ORAFS Planning Committee..... | 8 |
| Conference Overview | 9 |
| Plenary Session | 10 |
| Socials..... | 11 |
| Vendor Exhibits..... | 12 |
| Schedule at a Glance | 13 |
| Sessions at a Glance | 15 |
| Schedule of Oral Presentations Wednesday, February 25 | 16 |
| Schedule of Oral Presentations Thursday, February 26 | 17 |
| Schedule of Oral Presentations Friday, February 27 | 19 |
| Posters | 20 |

All presentations will be held in the Convention Center.
Detailed map on Page 5

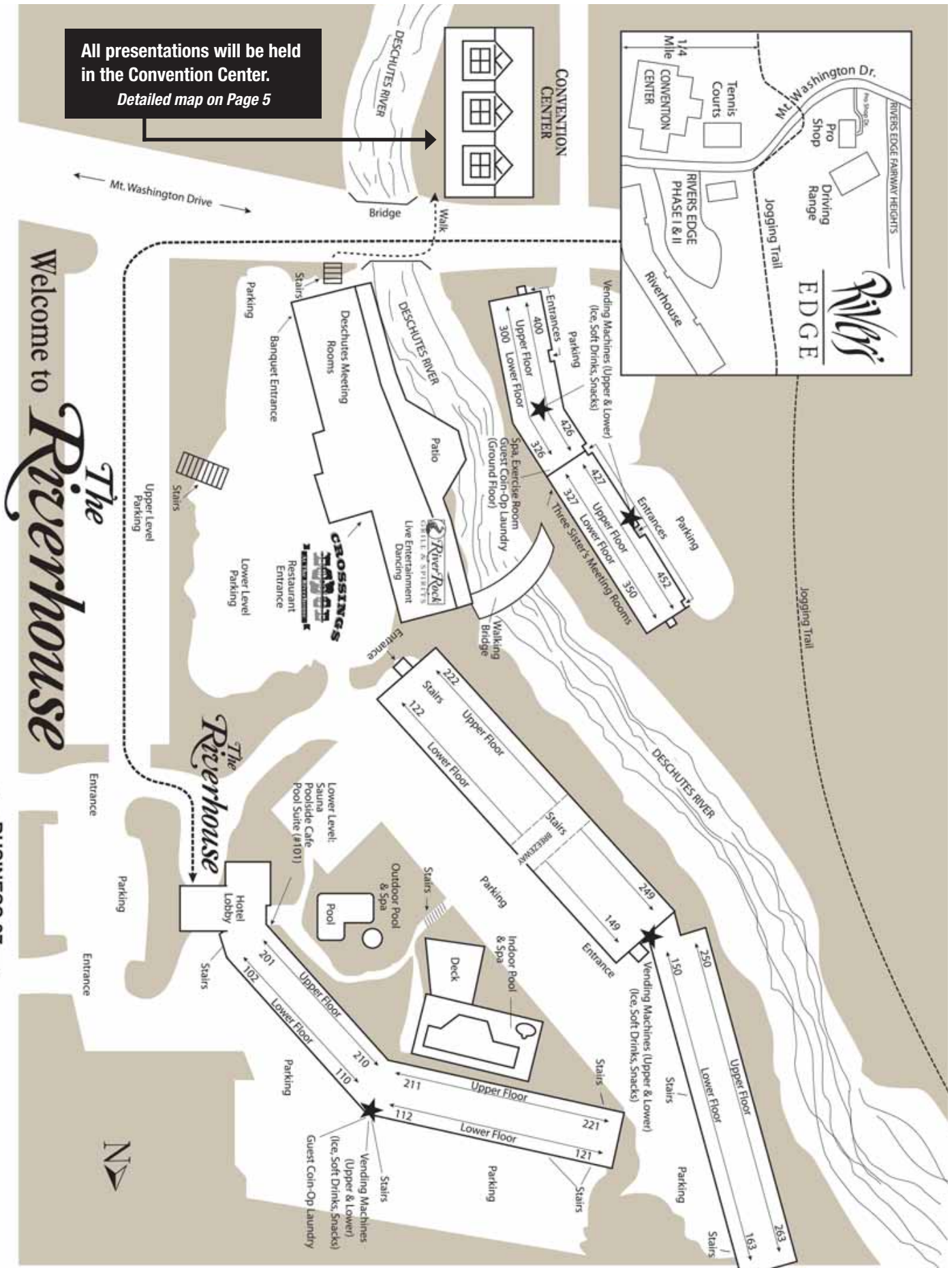

Convention Center

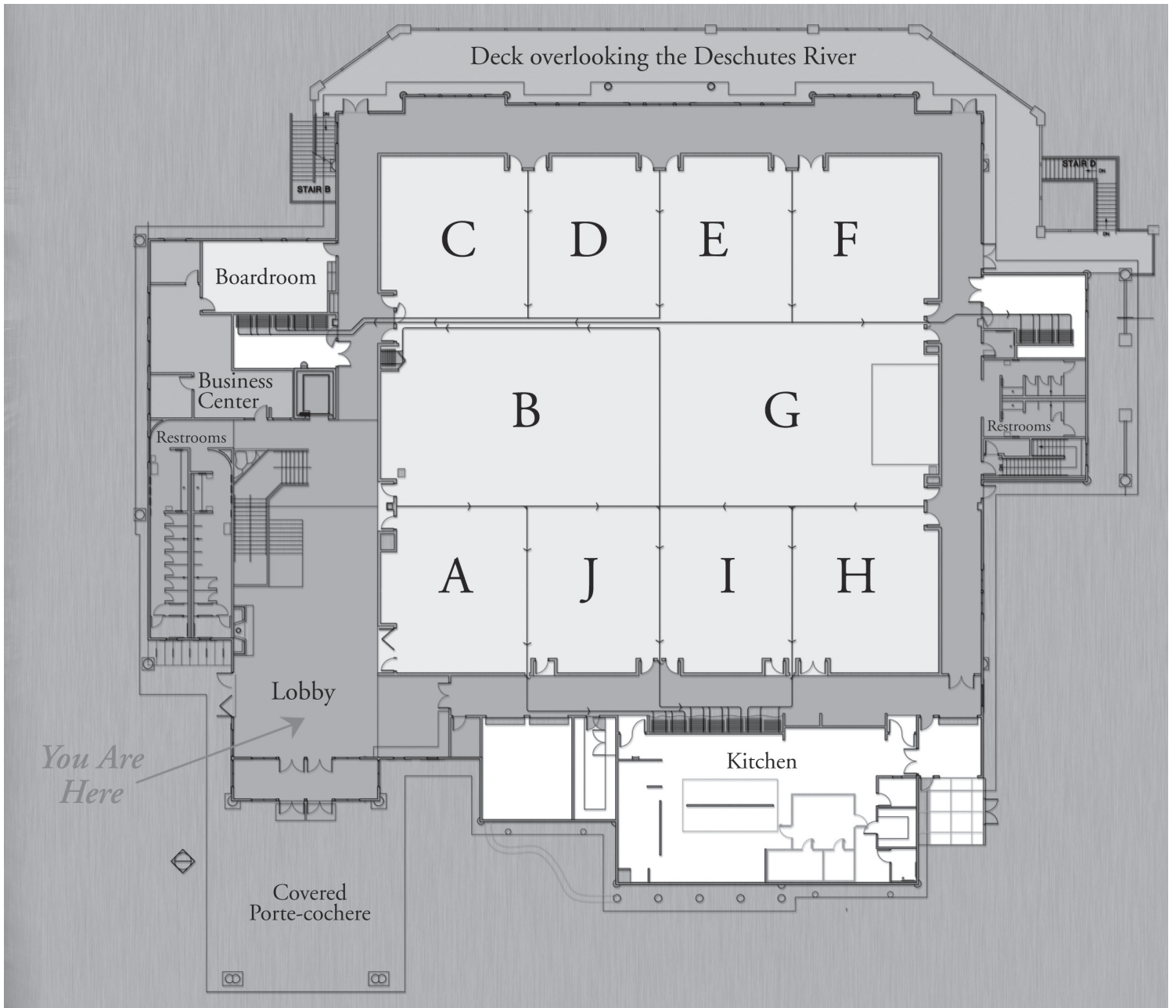

Exhibit Hall is located on the lower level

POSTER SESSION MAP

Poster Session

Set-up
 Wednesday, February 25
 Noon – 7:30 PM

Display Hours
 8:00 PM Wednesday, February 25* –
 10:20 AM Friday, February 27

Take Down
 Friday, February 27
 10:20 AM – Noon

Exhibit Hall

| | | | |
|----------|---|----|--------|
| Thompson | 1 | 13 | Arnold |
| Blundon | 2 | 14 | Bowers |
| Sogge | 3 | 15 | Hansen |
| Hurst | 4 | 16 | Church |

| | | | |
|----------|---|----|----------|
| Penaluna | 5 | 17 | Bickford |
| Ocana | 6 | 18 | Erdman |
| Reiffe | 7 | 19 | Volpe |
| Stoike | 8 | 20 | Firman |

| | | | |
|-----------|----|----|------------|
| Leblanc | 9 | 21 | Williams |
| Arismendi | 10 | 22 | Williams |
| Raggon | 11 | 23 | Strickland |
| Tomaro | 12 | 24 | Espinosa |

| | | | |
|-----------|----|----|----------|
| Leer | 25 | 33 | Griswold |
| McCormick | 26 | 34 | Bateman |
| Alfonso | 27 | 35 | LaVigne |
| Bratcher | 28 | 36 | Seese |

| | |
|---------|----|
| Spence | 29 |
| Steele | 30 |
| Deckard | 31 |
| Dunham | 32 |

*Poster authors will be on hand from 8:00 p.m. to 9:00 p.m. during the Poster Social on Wednesday evening.

Sharing Our Passion!

Welcome! The Annual Meeting is the ORAFS's premier venue for Sharing Our Passion for fish and fisheries, and your participation is greatly appreciated. As professionals, we're generally expected to be pragmatic and practical—but we also can, and sometimes should, be passionate—passionate about our work, our profession, and especially about the underlying interests and experiences that inspire us, and allow us to inspire others.



There's plenty of passion already evident in this outstanding and diverse program, and among the hundreds of members who have contributed to it. As you participate, I challenge you to not only "embrace your inner fish" (as keynote speaker Ray Troll says) but also exercise it—release it to infuse a little extra passion into your presentations, conversations, and camaraderie.

I'll start right here. One of my passions is fish photography, and for this meeting I'm sharing one of my favorite images, "Rainbow Release" (cover photo). This image evokes passion for me because it was among the most challenging fish I've ever caught (feeding in an eddy rip along the far bank beside a fast current, me balanced on a log tangling most backcasts in the tall pines, it rejecting my few decent casts until the 4th fly change), I photographed it alone in difficult conditions (one-handed among the canyon shadows in deep, numbing water), and yet the effort yielded a "dream-shot"—a sharp well-composed image that I'd been striving to achieve for many years: capturing that nanosecond between the freedom of an open hand and the escape burst of a vigorous wild fish. The tenuous connection between freedom and beauty, people and wild native fish, is evident. It even has geographic relevance—it was made on the Metolius River not far from Bend. It's been published many times, mostly to convey messages of conservation, and won several regional and national awards. In this context, I hope it inspires you to share your own brand of passion right here at this meeting, and throughout your career!

Rich Grost

PROGRAM CHAIR
2009 ORAFS ANNUAL MEETING

2009 ORAFS Planning Committee

Oregon Chapter of the American Fisheries Society
Annual Meeting | February 25-27, 2009

GENERAL CHAIR

Rich Grost (PacifiCorp)

PROGRAM

Technical Presentations

Rich Grost (PacifiCorp)

Poster

Michele Weaver (ODFW)

PROGRAM GUIDE

Neil Ward (CBFWA)

Heather Stanley (EditFish)

ARTWORK AND GRAPHICS

Rich Grost (PacifiCorp)

CONTINUING EDUCATION

Rich Grost (PacifiCorp)

FUNDRAISING

Doug Young (USFWS)

Neil Ward (CBFWA)

HOSPITALITY

Martyne Reesman (ODFW)

RAFFLE

Christy Fellas, Chair (NOAA)

Terry Smith (USFS)

REGISTRATION

Shaun Clements (ODFW)

Doug Young (USFWS)

On-site Coordination

Melissa Kennedy (USFWS)

SIGNS AND BANNERS

Martyne Reesman (ODFW)

STUDENT JUDGING

Mike Hudson (USFWS)

SOCIAL AND CATERING

Chair

Martyne Reesman (ODFW)

Poster Social

Martyne Reesman (ODFW)

Jam Session

Mike Faler (USFWS)

Texas Hold'em Fundraiser

Dave Ward (CBFWA)

Tom Iverson (CBFWA)

Student-Mentor Social

Christy Fellas (NOAA)

ODFW/OSU Mixer

Martyne Reesman (ODFW)

Charlie Corrarino (ODFW)

Bruce Macintosh (ODFW)

Dan Edge (OSU)

Beverages

Mike Gauvin (ODFW)

STUDENT AFFAIRS

Christy Fellas (NOAA)

Rebecca Goggan (OSU)

Shivonne Nesbit (OSU)

Scott Heppell (OSU)

Kristle Waren (OSU)

VENDOR SHOW

Neil Ward (CBFWA)

WEBSITE

Kara Anlauf (ODFW)

Registration

Located on the first floor of the Convention Center, registration hours are as follows:

Tuesday, February 24
10:00 AM – 5:00 PM

Wednesday, February 25
7:00 AM – 6:30 PM

Thursday, February 26
7:00 AM – 5:00 PM

Friday, February 27
7:00 AM – Noon

Raffle

Raffle tickets will be for sale Tuesday through Thursday in the registration area and during the Poster Social. On Thursday night, tickets will be available during the banquet social as well as during the banquet. Several of the raffle items will be on display at the registration table prior to the raffle.

Meeting Abstracts

Abstracts from the technical sessions and symposia, as well as other conference information can be found on the ORAFS website at www.orafs.org. A “community copy” of the abstracts will be available at the registration table.

Poster Session — Exhibit Hall

Poster Set-up Noon – 7:30 PM Wednesday
Display Hours 8:00 PM Wednesday – 10:20 AM Friday

Poster authors will be on hand from 8:00 p.m. to 9:00 p.m. during the Poster Social on Wednesday evening. Posters have been organized by topic, and updated maps will be available in the Exhibit Hall. Posters will be taken down

from 10:20 a.m. to noon on Friday. Unless alternative arrangements are made in advance, posters that are not removed from the display boards by noon on Friday will be discarded.

ORAFS Business Meeting — Exhibit Hall

Thursday, February 26 4:00 PM – 5:15 PM

Come hear what your chapter has been up to this year as well as which students will be the recipients of this year’s scholarships, including the inaugural Carl Bond Scholarship. This meeting is open to all, so show your support for the students and ORAFS activities by attending this meeting. Since there are no other activities planned during this period, we hope to see all of you in the Exhibit Hall.

Immediately following the Business Meeting, the ORAFS External Committees will be meeting in the Exhibit Hall from 5:15 p.m. to 6:00 p.m. If you are interested in learning more about each committee and contributing to their efforts, please plan on participating in this session.

Student Activities

Special student opportunities and events will be held during the meeting.

Free Workshops

| | |
|----------------------------|-----------------|
| “Fisheries Telemetry” | Cascade C |
| Tuesday, February 24 | 1:00 – 5:00 PM |
| Wednesday, February 25 | 8:00 – 11:30 AM |
| “Aquatic Invasive Species” | Cascade D |
| Tuesday, February 24 | 1:00 – 5:00 PM |
| Wednesday, February 25 | 8:00 – 11:30 AM |

Student-Mentor Social

Wednesday, February 25 6:00 – 8:00 PM
Cascade C and D

Due to the huge success during previous meetings, we will once again be facilitating a student-mentor social in Bend. Students and professionals will have the occasion to discuss experiences, opportunities, and challenges in fisheries careers in a one-on-one forum during the student-mentor social. Employers, professors, professionals, and graduate program representatives are encouraged to attend.



Fish Worship and the Art of Ray Troll *or: How I Became a Scientific Surrealist*

Alaskan artist Ray Troll will share the twists and turns of his unique fish-inspired career. Ray moved to the Northwest in the late 1970s and eventually on to Alaska in the early '80s with a couple of art degrees in his back pocket and a life long interest in natural history. He settled in the rain-swept, coastal town of Ketchikan and began producing offbeat fish-filled T-shirts that soon gained him an audience with cannery workers, anglers, commercial fishers and scientists. His art has toured in exhibitions at major museums across the United States. He has co-authored and illustrated seven books. The latest is "Cruisin' the Fossil Freeway," a fact and fun filled romp through the American west with paleontologist Kirk Johnson. Ray also wrote and illustrated a unique alphabetical children's book of living and prehistoric sharks called "Sharkabet." "Rapture of the Deep" is a career overview of Ray's work with an introduction by Brad Matsen. Ray acted as the art director for the Miami Museum of Science's major traveling exhibit "Amazon Voyage: Vicious Fishes and Other Riches" currently on tour across the country. He is also an avid garage band "a-fish-ianado" and has just released a CD of original "sub-aqua-punk-bush-rock" music called 'Where the Fins Meet the Frets'. You can find out more about Ray at: www.trollart.com. (Ray will also present in the Education and Outreach and the Wet-n-Wild Images technical sessions...and the Jam Session.)

PLENARY SESSION

Ray Troll

Wednesday, February 25

1:00 PM – 2:30 PM

Cascade A,B,C,D, and J



2009 ORAFS Annual Meeting Socials

To maximize networking opportunities and celebrate our chapter's accomplishments, the 2009 ORAFS Annual Meeting will host six exciting events in Bend. Admission to socials requires a conference name badge.

Student/Mentor Social

Wednesday, February 256:00 PM
Cascade C and D Rooms

Students and all members who support their professional development will enjoy this social on Wednesday. This is an excellent opportunity network and make personal connections that will last a lifetime while enjoying complimentary hors d'oeuvres and non-alcoholic beverages.

Poster Social

Wednesday, February 258:00 PM
Exhibit Hall

The Exhibit Hall is the site for Wednesday's Poster Social. See the latest fisheries research findings and interact with authors while enjoying complimentary food and drinks.

ODFW/OSU Mixer

Wednesday, February 259:00 PM
Cascade C and D Rooms

The OSU/ODFW social is an opportunity for OSU students, alumni, faculty and staff to meet with ODFW staff, get reacquainted, meet potential employees and employers, spend some quality time discussing fish and wildlife management issues, share research needs but mostly, enjoy one another's company. AFS has graciously provided the room, OSU Department of Fisheries and Wildlife will provide refreshments and ODFW will provide light snacks.

Banquet Social, Banquet, Auction, and Raffle

Thursday, February 26.....6:00 PM – 9:00 PM
Cascade A,B,C,D, and J Rooms

Social: 6:00 PM – 6:30 PM
Silent Auction: 6:00 PM – 8:30 PM

Banquet: 6:30 PM – 8:00 PM
Raffle and Oral Auction: 8:00 PM – 9:00 PM

All attendees are encouraged to join their friends during the festivities planned for Thursday night. Do not miss this opportunity to win some great artwork, possibly a trip, or maybe some outdoors equipment. Complimentary beverages will be available throughout the night. Although banquet tickets are not required to participate in the social and raffle/auction, a ticket is required to receive a banquet meal. To ensure an evening of continuous fun, be sure to purchase your banquet ticket in advance.

Texas Hold'em Fundraiser

Thursday, February 26.....9:00 PM – Midnight
Cascade A,B,C,D, and J Rooms

If you know when to hold'em, then this is the event for you. Join meeting attendees in this fundraising event to see who the best, or luckiest, Texas Hold'em player is among meeting attendees while enjoying free beverages and snacks. Who will walk away with the bragging rights? If you are interested in participating, but have not registered, please sign-up at the registration table in the Lobby (\$25 registration fee).

Jam Session

Thursday, February 26.....9:00 PM – Midnight
Cascade A,B,C,D, and J Rooms

Meeting attendees that enjoy music, especially that produced by your friends in the fisheries profession, will not want to miss the open jam session following the banquet. All those that are musically inclined are encouraged to participate. This is an excellent opportunity to marvel at the talents of your colleagues while enjoying free drinks and music.

Vendor Exhibit Information

Come and see what is happening in fishery science, arts, and technology at the 2009 ORAFS Vendor Exhibit. Stay abreast of new technologies and creative expressions with abundant opportunities to network with professionals and learn about their products and services. Morning and afternoon refreshments breaks will be served daily in the Vendor Exhibit area. We look forward to seeing you there.



Vendor Exhibit Hours of Operation

Wednesday, February 25

2:30 PM – 10:00 PM

Thursday, February 26

8:00 AM – 6:00 PM

Friday, February 27

8:00 AM – 10:20 AM

AMIRIX Systems Inc. VEMCO Division

77 Chain Lake Drive
Halifax, NS B3S 1E1
902-450-1700

AMIRIX Systems Inc., through its VEMCO division, is the world leader in the design and manufacturer of underwater acoustic telemetry transmitters and receivers for fisheries biologists and marine researchers studying the behavior patterns of marine and freshwater animals.

Hach Environmental

P.O. Box 389
Loveland, CO 80539
800-949-3766

Hach Environmental – the source for reliable and dependable environmental water monitoring data that is the gold standard in our industry. Only Hach Environmental can provide completely integrated, turn-key solutions for water quality, water level, and precipitation monitoring. In addition, the combination of Hach, Hydrolab, and OTT resources has created world-class product development capabilities that will ensure that Hach Environmental continues to be the gold standard for environmental water quality and water quantity monitoring data. Finally, the Hach Environmental sales and support network spans the globe so that we can provide local support – no matter where water monitoring needs reside.

Lotek Wireless Inc.

115 Pony Drive
Newmarket, ON L34 7B5
905-836-6680

Lotek shares your passion for an environment characterized by self-sustaining fisheries, wildlife, and birds. New Lotek products being introduced to realize this goal include: Low cost Radio and Acoustic data-logging receivers (SRX-DL, WHS 2000), smaller and lower cost Nanotag transmitters, Dual-Mode transmitters (MR-series), smaller Sensor-transmitters (MST-series) and data-logging tags (LAT-series), Wireless and Mobile Acoustic Positioning systems (ALPS, SYNAPS).

Roscoe Steel and Culvert

www.roscoesteel.com

Environmental Stewardship as it relates to Roscoe Culvert products includes applications such as fish flumes for hatcheries, large diameter culverts and bridge products to promote fish migration, patented Critter-Crossing™ Animal Access shelves to prevent vehicle-animal collision, erosion control and soil stabilization products to prevent stream and river contamination, geo-grids to minimize asphalt and mined rock requirements for road building. By focusing on and providing premier products that can be “valued” by current and future impacts to the construction site and final installation economics via Best Management Practices versus cheapest short-term solutions, Roscoe Culvert has re-defined the Value Model of water and soil management solutions!

SCHEDULE-AT-A-GLANCE

| Thursday, February 26 | | | |
|------------------------------|----------|---|------------------------|
| 7:00 AM | 5:00 PM | Registration / Information / Sales Desk | Lobby |
| 7:45 AM | 8:00 AM | Coffee and Refreshment Service | Lobby |
| 8:00 AM | 6:00 PM | Speaker Practice | Room 317 |
| 8:00 AM | 5:30 PM | Poster Session | Exhibit Hall |
| 8:00 AM | 6:00 PM | Vendor Show Exhibits | Lobby |
| 8:00 AM | Noon | Symposia and Contributed Papers | Cascade (various) |
| 10:00 AM | 10:20 AM | Break | Lobby |
| Noon | 1:20 PM | Awards Luncheon (complimentary) | Exhibit Hall |
| 1:20 PM | 3:40 PM | Symposia and Contributed Papers | Cascade (various) |
| 3:40 PM | 4:00 PM | Break | Lobby |
| 4:00 PM | 5:15 PM | ORAFS Business Meeting | Exhibit Hall |
| 5:15 PM | 6:00 PM | ORAFS External Committee Discussions | Exhibit Hall |
| 6:00 PM | 6:30 PM | Banquet Social | Cascade A,B,C,D, and J |
| 6:00 PM | 8:30 PM | Silent Auction | Cascade A,B,C,D, and J |
| 6:30 PM | 8:00 PM | Awards Banquet | Cascade A,B,C,D, and J |
| 8:00 PM | 9:00 PM | Oral Auction and Raffle | Cascade A,B,C,D, and J |
| 9:00 PM | Midnight | Jam Session | Cascade A,B,C,D, and J |
| 9:00 PM | Midnight | Texas Hold'em Fundraiser | Cascade A,B,C,D, and J |
| Friday, February 27 | | | |
| 7:00 AM | Noon | Registration / Information / Sales Desk | Lobby |
| 7:45 AM | 8:00 AM | Coffee and Refreshment Service | Lobby |
| 8:00 AM | Noon | Speaker Practice | Room 317 |
| 8:00 AM | 10:20 AM | Poster Session | Exhibit Hall |
| 8:00 AM | 10:20 PM | Vendor Show Exhibits | Lobby |
| 8:00 AM | Noon | Symposia and Contributed Papers | Cascade (various) |
| 10:00 AM | 10:20 AM | Break | Lobby |
| 10:20 AM | Noon | Poster Session Take-Down | Exhibit Hall |
| 10:20 AM | Noon | Vendor Show Take-Down | Lobby |
| 12:30 PM | | Round Butte Dam Field Tour and Lunch | Off-site |

ORAL PRESENTATIONS | THURSDAY, FEB. 26

| Thursday February 26 | Bull Trout - Curiosity and Conservation | Ecology and Habitat Interactions | Environmental Drivers of <i>Oncorhynchus mykiss</i> Life History | Marine Research | Student Research (Continued) |
|-----------------------------|--|--|--|---|--|
| Room | Cascade A,B, and J | Cascade C and D | Cascade E and F | Cascade H and I | Cascade G |
| Moderator | Jason Dunham, USGS | Robert Hughes, EPA | Ian Courter, Cramer Fish Sciences | Scott Heppell, OSU | Brooke Penaluna, Bill Brignon, OSU |
| 8:00 AM | <i>Salvelinus confluentus</i> Curiosity Society – The Beginning David Buchanan, ODFW – Retired | Evidence for Behavioral Thermoregulation by Subyearling Fall Chinook Salmon (<i>Oncorhynchus tshawytscha</i>) in Lower Granite Reservoir Tobias Kock, USGS | Landscape and Life History Influences on Genetic Diversity in <i>O. mykiss</i> Around the Pacific Rim Megan McPhee, Flathead Lake Biological Station | Long-lived Marine Species and Resiliency to Overfishing Selina Heppell, Dept. Fisheries and Wildlife, OSU | Summer International Research Opportunity for Graduate Students Alena Pribly, OSU |
| 8:20 AM | Contributions of the <i>Salvelinus confluentus</i> Curiosity Society to Bull Trout Conservation Jason Dunham, USGS | Looking for Pieces of the Puzzle: Life History of Spring Chinook Salmon in the Willamette Basin Kirk Schroeder, ODFW | Response of Rainbow Trout Populations to Reconnection with Adult Steelhead after Removal of Century-old Barriers Patrick Connolly, USGS-Columbia River Research Laboratory | Marine Climate Indicators and Salmon Stock Forecasts Tom Wainwright, NOAA Northwest Fisheries Science Center | Using EMG Telemetry to Assess Relative Activity and Habitat Use of Over-Summering Steelhead * Eva Schemmel, OSU |
| 8:40 AM | Evolutionary Patterns in Bull Trout as Revealed by Genetic Markers Patrick DeHaan, USFWS | Variations in Juvenile Migration Timing for Local Populations of Spring Chinook Salmon from the Grande Ronde River, Oregon Jeff Yanke, ODFW | <i>O. mykiss</i> Population Structure Response to Environmental Changes in the Cedar River, Washington Brad Thompson, USFWS, Western WA Fish and Wildlife Office | Patterns in the Marine Distribution and Behavior of Chinook Salmon Stocks Along the Oregon Coast * Robert Ireland, OSU | Modeling the Ceratomyxosis Cycle of Chinook Salmon in the Lower Klamath River * Adam Ray, OSU |
| 9:00 AM | Overview and Update of Bull Trout Status in Oregon Bianca Streif, USFWS | Finding the Answers to Burning Questions: Rainbow Trout Habitat and Population Response to Wildfire and Subsequent Habitat Enhancements in a Southwestern Oregon Stream Ian Reid, USFS, Rogue River-Siskiyou National Forest | Understanding the Behavior and Development of Freshwater Maturing Male <i>O. mykiss</i> * John McMillan, OSU/USGS | Maternal Effects in Pacific Ocean Perch (<i>Sebastes alutus</i>) from the Gulf of Alaska Scott Heppell, OSU | Take Your Vitamins! Describing the Relationship Between Egg Thiamine (vitamin B1) and Mortality in Lake Michigan Lake Trout * Allison Evans, OSU |
| 9:20 AM | Research and Monitoring of Oregon's Bull Trout: An Overview of Investigations by the ODFW Native Fish Project Steve Jacobs, ODFW | Longitudinal Variability in Pacific Northwest River Fish Assemblages Alan Herlihy, Department of Fisheries & Wildlife, OSU | Movement, Passage, and Life-history of Redband Trout in the Donner und Blitzen River, Oregon * Matthew Anderson, OSU | To be with Barotrauma or not to be with Barotrauma? A Physiological Survey of Six Rockfish Species * Alena Pribly, Oregon Cooperative Fish and Wildlife Research Unit (USGS-BRD), OSU | — |
| 9:40 AM | Comparison of Mark-recapture Methods to Estimate Juvenile Bull Trout Survival * Tracy Bowerman, Utah State University | The Aliens are Coming! (or at Least Expanding their Ranges in a River Near You) Robert Hughes, OSU | Processes Influencing Stream Temperature and Juvenile Habitat Suitability for Southern Steelhead (<i>O. mykiss</i>) in a Dynamic System Matthew Sloat, OSU | Identifying Canary Rockfish (<i>Sebastes pinniger</i>) Habitat off Washington and Oregon from Environmental Data and Trawl Logbooks * Cathleen Vestfals, COAS/OSU | — |
| 10:00 AM | Break | | | | |

| Thursday February 26 | Bull Trout - Curiosity and Conservation (Continued) | Ecology and Habitat Interactions (Continued) | Environmental Drivers of <i>Oncorhynchus mykiss</i> Life History (Continued) | Marine Research and Reserves (Continued) | Blue-green Algae and Fish: Emerging Knowledge |
|-----------------------------|--|---|---|--|--|
| Room | Cascade A,B, and J | Cascade C and D | Cascade E and F | Cascade H and I | Cascade G |
| Moderator | Jason Dunham, USGS | Robert Hughes, EPA | Ian Courter, Cramer Fish Sciences | Scott Heppell, OSU, and Selina Heppell, OSU | Joe Eilers, MaxDepth Aquatics |
| 10:20 AM | Upper Willamette Bull Trout Trilogy Part 1: The Tale of Two Rivers and the Recovery Process Kate Meyer, USFS, Willamette National Forest, McKenzie River Ranger District | Analysis of Stable Isotopes in Fish to Identify Habitat Use and Switching Marshall Church, US EPA | Predicting Consumption Rates of Juvenile <i>O. mykiss</i> Using Abundance of Drifting Invertebrates * Nicholas Weber, Utah State University | Are There Two Subgroups of North Pacific Albacore in the Coastal Fishery of North America? * Mac Barr, OSU, College of Oceanic and Atmospheric Sciences | Low-Tech Solutions to a High-Profile Problem: Tui Chub Management through Netting and its Implications for Sport Fishing and Blue-Green Algae Dynamics in Fish Lake, Jackson County, Oregon Ian Reid, USFS, Rogue River-Siskiyou National Forest |
| 10:40 AM | Upper Willamette Bull Trout Trilogy Part 2: The Story of Sweetwater Creek: A Bull Trout Reintroduction Success Andrew Talabere, Eugene Water & Electric Board | How Can Stable Isotope Analysis Contribute to Our Understanding of Stream Food Webs? Beth Sanderson, NOAA Fisheries | Anadromy and Residency in Brook Trout: Environment, Genetics, and Effect of Recreational Fishing on Evolution of Life-history Form Veronique Theriault, Hatfield Marine Science Center, OSU | Seasonal and Interannual Variability in the Structure of Small Demersal Fish Assemblages Along the Central Oregon Coast Christopher Toole, NMFS | Diamond Lake: Looking at the Links Laura Jackson, ODFW |
| 11:00 AM | Upper Willamette Bull Trout Trilogy Part 3: If We Build It, Will They Come? Gravel Augmentation for Bull Trout in the Middle Fork Willamette River, Oregon Jeff Ziller, ODFW | Responses of Fish to Low-head Dams and Water Withdrawals in an Aridland River David Wooster, OSU | Environmental Drivers of Ecotype Abundance in Interdependent Resident and Anadromous Rainbow Trout Populations Ian Courter, Cramer Fish Sciences | Marine Reserves in Oregon: Clarifying Conservation Needs and Potential Costs and Benefits – Part 1 Selina Heppell, Department of Fisheries and Wildlife, OSU | Lemolo Lake Algal Blooms: Are Tui Chub to Blame? Joseph Eilers, MaxDepth Aquatics, Inc. |
| 11:20 AM | Assessing the Feasibility of Native Fish Reintroductions: a Framework and Example Applied to Bull Trout in the Clackamas River, Oregon Dan Shively, USFS, Mt. Hood National Forest | Transferability of Models to Predict Selection of Cover by Coastal Cutthroat Trout in Small Streams in Western Oregon * Heidi Andersen, Bureau of Land Management | Effects of Intermixing Between Resident and Anadromous Rainbow Trout on Population Productivity Steve Cramer, Cramer Fish Sciences | Marine Reserves in Oregon: Clarifying Conservation Needs and Potential Costs and Benefits – Part 2 Selina Heppell, Department of Fisheries and Wildlife, OSU | The Roles of Lake Hydrodynamics and Fish Stocking on Water Quality in Odell Lake, Oregon Kellie Vache, Biological and Ecological Engineering, OSU |
| 11:40 AM | Assessing Potential Impacts of a Proposed Reintroduction of Bull Trout on ESA Listed Salmon and Steelhead in the Clackamas River, Oregon Chris Allen, USFWS, Oregon Fish & Wildlife Office | Crayfish, Competition, and Coexistence: Exploring Shelter Competition in an Invasive Crayfish Assemblage * Brett Hanshew, OSU | — | Prepare for afternoon panel discussion | Conversion of Macrophytes to Cyanobacteria in Devils Lake, an Unintended Consequence of an Experimental Introduction of Chinese Grass Carp Paul Robertson, Devils Lake Water Improvement District |

* student paper

ORAL PRESENTATIONS | FRIDAY, FEB. 27

| Friday February 27 | Aquaculture Advances | Deschutes Basin Fishery Restoration | Harvest Management: recent and impending challenges | Lamprey and Non-game Fish | Pesticide Impacts to Aquatic Resources |
|---------------------------|---|--|--|---|---|
| Room | Cascade A,B, and J | Cascade C and D | Cascade E and F | Cascade H and I | Cascade G |
| Moderator | Ryan Couture, ODFW and David Hand, USFWS | Michael Gauvin, ODFW | Rhine Messmer, ODFW | Steve Jacobs, ODFW | Kristle Warren, OSU, and OSU senior undergraduate class |
| 8:00 AM | Status of the Grande Ronde River Basin Spring Chinook Salmon Captive Broodstock Program: 1995 – 2009 Tim Hoffnagle, ODFW | Historical Perspective of the Round Butte Project and the Fish Passage Effort Don Ratliff, PGE | The ODFW 25-Year Angling Enhancement Plan Thomas Friesen, ODFW | It's Not All About Exploitation: Fish Societies in the Northwest Stewart Reid, Western Fishes | Pesticides and the Management of Aquatic and Riparian Invasive Species (AIS) in the Pacific Northwest Samuel Chan, Fisheries and Wildlife, Sea Grant Extension, OSU |
| 8:20 AM | Run Timing and Spawning Distribution of Hatchery-and Natural-Origin Spring Chinook Salmon in Three Different Northeastern Oregon Streams Joseph Feldhaus, ODFW | Design and Construction of the New Selective Water Withdrawal and Fish Capture Facility at Round Butte Dam Chad Croft, PGE | Public Perspectives on Wild Trout Harvest; When Did Harvest Turn into Killing? Rhine Messmer, ODFW | Monitoring the Status of the Endangered Borax Lake Chub <i>Gila boraxobius</i> in a Geothermal Lake in Southeastern Oregon Paul Scheerer, ODFW | Pesticides in the Clackamas River Basin, Oregon, and Potential Impacts to Aquatic Life – Part 1 Kurt Carpenter, USGS - Oregon Water Science Center |
| 8:40 AM | Radio Telemetry of Spring Chinook Salmon in the Warm Springs River Jens Lovtang, Confederated Tribes of Warm Springs, Branch of Natural Resources | Selective Water Withdrawal / Fish Passage Facilities James Bartlett, PGE | An Innovative, Non-lethal Electric Field to Deter Marine Mammal Predation on Fishery Resources: Results of Trials on Harbor Seals and California Sea Lions Carl Burger, Smith-Root, Inc. | Improved Status, Research Goals and Potential Downlisting of Oregon Chub in the Willamette River Drainage Brian Bangs, ODFW | Pesticides in the Clackamas River Basin, Oregon, and Potential Impacts to Aquatic Life – Part 2 Kurt Carpenter, USGS - Oregon Water Science Center |
| 9:00 AM | Hatchery Release Strategies: Maximizing Survival, Minimizing Risk, and Mimicking Wild Migration David Hand, USFWS | Fish Reintroduction above the Pelton Round Butte Project Michael Gauvin, ODFW | Weak Stock Ocean Fishery Management: How Do California Chinook Salmon Stocks Influence Oregon Fisheries? Randolph Ericksen, Cramer Fish Sciences | From Ideas to Implementation: Adult Lamprey Passage at Dams David Clugston, Portland District COE | The Ecotoxicology of Pesticides and Pacific Salmon – Part 1 Nat Scholz, NOAA Fisheries |
| 9:20 AM | Migration Dynamics of Released Hatchery Steelhead Smolts Determine Type and Magnitude of Potential Ecological and Genetic Risks Benjamin Kennedy, USFWS- Abernathy Fish Technology Center | Sockeye Development Strategies for the Deschutes Basin Brad Houslet, CTWSRO | Challenges to Providing Harvest Opportunities in Oregon Marine Recreational Fisheries Lynn Mattes, ODFW | Eau de Entosphenus: The Role of Pheromones and Current Velocity in Mediating Adult Lamprey Movements Mary Moser, Northwest Fisheries Science Center | The Ecotoxicology of Pesticides and Pacific Salmon – Part 2 Nat Scholz, NOAA Fisheries |
| 9:40 AM | Seasonal Foraging and Piscivory by Sympatric Wild and Hatchery-reared Steelhead from an Integrated Hatchery Program William Simpson, USFWS - Abernathy Fish Technology Center | Bull Trout Restoration in the Deschutes River Basin Peter Lickwar, USFWS | Reestablishing Wild Coho Salmon Fisheries in Siltcoos and Tahkenitch Lakes Robert Buckman, ODFW | Indexing Northern Pikeminnow Predation 1990-2008 Michele Weaver, ODFW | Urban Pesticides: Assessment Difficulties and Lessons From Pristine Environments (National Parks) Carl Schreck, USGS/OSU |
| 10:00 AM | Break | | | | |

| Friday February 27 | Aquaculture Advances (Continued) | Deschutes Basin Fishery Restoration (Continued) | Harvest Management: Recent and Impending Challenges (Continued) | Wet-n-Wild: Images from the Aquatic Realm | Pesticide Impacts to Aquatic Resources (Continued) |
|---------------------------|---|--|---|--|--|
| Room | Cascade A,B, and J | Cascade C and D | Cascade E and F | Cascade H and I | Cascade G |
| Moderator | Ryan Couture, ODFW and David Hand, USFWS | Michael Gauvin, ODFW | Rhine Messmer, ODFW | Jeremy Monroe, Freshwaters Illustrated (schedule approximate) | Kristle Warren, OSU, and OSU senior undergraduate class |
| 10:20 AM | Pressure Shock Induction of Rainbow Trout Anitra Firmenich, ODFW | Reintroduction of a Listed Species, the Best-Laid Plans of Mice and Fish Biologists Scott Carlton, NMFS | Growth, Survival and Contribution to Fisheries of Transplanted White Sturgeon in the Lower Columbia River Colin Chapman, ODFW | Telling the Underwater Story Jeremy Monroe, Freshwaters Illustrated | Oregon Pesticide Stewardship Partnerships: Improving Water Quality Through Collaboration Kevin Masterson, Oregon Department of Environmental Quality |
| 10:40 AM | Examination of Differences by Sex in Antibiotic Activity and BKD ELISA Value in Maturing Chinook Salmon Sally Gee, ODFW | Deschutes Basin Fish Health Monitoring During the Reintroduction Process Richard Stocking, ODFW | Restoration Planning, Actions and Outcomes in Tryon Creek, Portland Oregon Chip McCannaha, ICF Jones & Stokes | Nassau Grouper Spawning Aggregation in the Caribbean Scott Heppell Deterring Seals and Sea Lions from Marine Gillnets Carl Burger | Pesticides and Water Quality in Oregon Steve Riley, Oregon Department of Agriculture |
| 11:00 AM | Achieving Optimum Fish Health at Your Propagation Facility Tod Jones, Natural Solutions North West, LLC | Cooperative Habitat Restoration in the Upper Deschutes River Basin Scott McCaulou, Deschutes River Conservancy | Q&A, Discussion: Harvest Management: Recent and Impending Challenges | Beneath the Surface: Steelhead Sex, Salmon Lust, and Rearing the Kids (Bad Juvenile Behavior) John McMillan | Panel Discussion: Implications of Individual Pesticides and Accumulating Low-level Mixtures on Aquatic Resources in the Pacific Northwest |
| 11:20 AM | Oxygen Supplementation at a Coastal Hatchery Roger Warren, ODFW-Gnat Creek Hatchery | Lower Deschutes River Experimental Gravel Augmentation Project Bob Spateholts, PGE | — | Viscious Fishes and Other Riches of the Amazon Ray Troll, SOHO COHO Fin Art Gallery | Panel Discussion (continued) |
| 11:40 AM | Ultraviolet Disinfection at Leaburg Hatchery Erik Withalm, ODFW - Leaburg Hatchery | Gather for noon departure: Field Trip to Round-Butte Dam – Don Ratliff and Jim Bartlett, PGE | — | Viscious Fishes and Other Riches of the Amazon (continued) Ray Troll, SOHO COHO Fin Art Gallery | Panel Discussion (continued) |

POSTERS

Wednesday, February 25, 2009

8:00 PM – Midnight

Exhibit Hall

| Location | Title | Authors |
|-----------------------------|--|--|
| Best Student Posters | | |
| 1 | Loop Analysis as a Potential Tool to Study Ecosystem Changes in the Gulf of Alaska | Kevin Thompson, Oregon State University |
| 2 | Synchronous Growth Patterns within and Among Populations of the Unionid Mussel <i>Margaritifera falcata</i> and the Potential for Reconstructing River Temperature and Discharge | Brett Blundon, Oregon State University/United States Geological Survey |
| 3 | Distribution of the Freshwater Mussel <i>Margaritifera falcata</i> in Oregon Coastal Streams | Brian Sogge, Oregon State University |
| 4 | <i>Ceratomyxa shasta</i> Distribution and Host Specificity in the Williamson River | Charlene Hurst, Oregon State University |
| 5 | Individual- and Population-level Dynamics of Coastal Cutthroat Trout: Examining Roles of Physical and Biotic Processes using Individual-based Models and Manipulated Experiments | Brooke Penaluna, Oregon State University |
| 6 | What Olive Ridley Sea Turtles and Salmonids have in Common: A Discussion of Density-dependent Impacts on Egg Survival | Melissa Ann Ocana, Oregon State University |
| 7 | Temperate Marine Reserve Response and Implications for Oregon's Marine Reserve Science | Heather Reiff, Oregon State University |
| 8 | Catch and Release in the Live Rockfish Fishery: Can Release of Pregnant Females be a Conservation Tool? | Suzanna Stoike, Oregon State University |
| 9 | Impact of a New Artificial Shelter on Arctic Charr <i>Salvelinus alpinus</i> , L. Behavior and Culture Performances during the Endogenous Feeding Period | Camille Leblanc, OSU Dept of Fisheries and Wildlife |
| 10 | Stable Isotopes and Stomach Analysis Reveal Trophic Position and Carbon Source for Non-native Rainbow Trout (<i>Oncorhynchus mykiss</i>) and Brown Trout (<i>Salmo trutta</i>) in Southern Chilean Streams | Ivan Arismendi, Universidad Austral de Chile |
| 11 | The Ecological Relevance of Seasonal and Spatial Variability in Diet and Consumption by Cottid and Salmonid Fishes in Headwater Streams in Western Oregon | Mark Raggon, Department of Fisheries and Wildlife, Oregon State University |
| 12 | Can the Otolith Microchemical Fingerprint Distinguish Naturally-spawned and Hatchery-reared Mid-upper Columbia River Chinook Salmon? Validation of a De-facto 'Hatchery Mark' | Londi M. Tomaro, Oregon State University |
| 13 | Age Structure Metrics for Precautionary Management: Can Simpler Assessment Tools Save Fish, Time and Money? | Linsey Arnold, OSU Department of Fisheries and Wildlife |
| Fish Passage | | |
| 14 | Oregon Fish Passage Barrier Data Standard and Inventory Project | Jon Bowers, Oregon Department of Fish and Wildlife |
| 15 | Monitoring the Effectiveness of Culverts Replaced or Retrofitted for Fish Passage in the Upper West Fork of Smith River, Oregon | Bruce Hansen, USDA, Forest Service, PNW Research Station, Corvallis Forestry Sciences Laboratory |
| Fish Ecology | | |
| 16 | Fish Mucus as a Rapidly Responding Tissue in Diet Switching Studies | Marshall Church, US EPA |
| Habitat | | |
| 17 | The Upper South Fork McKenzie River Enhancement Project – An Effort to Restore Processes and Recover Habitat | Dave Bickford, USDA Forest Service |
| 18 | Explosive Conservation: Larval Sucker Response to Wetlands Restoration at the Tulana Portion of the Williamson River Delta Preserve, Oregon | Charles Erdman, The Nature Conservancy |
| 19 | Effects of Prescribed Fire in Riparian Areas of Southwest Oregon Mixed-Conifer Forests on Riparian Function and Biological Integrity | Chris Volpe, Bureau of Land Management |

| Modeling | | |
|-----------------------|--|---|
| 20 | The Devil's in the Details: Using Life-cycle Models to Evaluate the Probability of Extinction | Julie Firman, Oregon Department of Fish and Wildlife |
| Fisheries Management | | |
| 21 | Historical Population Structure of Coho Salmon in the Southern Oregon/Northern California Coasts Evolutionarily Significant Unit | Thomas Williams, NMFS Southwest Fisheries Science Center |
| 22 | Framework for Assessing Viability of Threatened Coho Salmon in the Southern Oregon/Northern California Coast Evolutionarily Significant Unit | Thomas Williams, NMFS Southwest Fisheries Science Center |
| 23 | Estimates of Winter Rearing Capacity for Coho Salmon in Oregon Coast Watersheds | Matt Strickland, Oregon Department of Fish and Wildlife |
| Population Monitoring | | |
| 24 | The Use of a Resistivity Fish Counter to Passively Enumerate Adult A Run Héeyey Steelhead <i>Oncorhynchus mykiss</i> in Camp Creek, Imnaha River Tributary, Oregon | Neal Espinosa, Nez Perce Tribe Department of Fisheries Resources Management |
| 25 | Low Cost Weir Design for Monitoring Fish Movement in Small Headwater Streams: Examples from the Trask River Watershed Study | David Leer, Oregon State University, Dept. of Forest Engineering, Resources and Management |
| 26 | Redd Counts as a Measure of Summer Steelhead Escapement Using the Environmental Monitoring and Assessment Program (EMAP) in the John Day Basin | Joshua McCormick, Oregon Department of Fish & Wildlife |
| 27 | Seasonal Movements of Cyprinids and Catostomids in the Upper Grande Ronde River, Oregon | Brian Alfonse, Oregon Department of Fish and Wildlife |
| 28 | Parr-to-Smolt Survival for Spring Chinook Salmon in the Grande Ronde and Imnaha Rivers, Oregon 1993-2007 | Kyle Bratcher, Oregon Department of Fish and Wildlife |
| 29 | Coho Salmon in Santa Cruz and San Mateo Counties: Detecting Rare Fish Species Using Snorkel Surveys | Brian Spence, National Marine Fisheries Service |
| 30 | Overwinter Survival of Juvenile Spring Chinook Salmon in the Grande Ronde River Subbasin | Jesse Steele, Oregon Department of Fish and Wildlife |
| 31 | Examining Juvenile Chinook Densities in North and Mid Oregon Coastal Estuaries | Casey Deckard, Oregon Department of Fish and Wildlife |
| 32 | Spatial Patterns in the Occurrence of Steelhead in the John Day River | Jason Dunham, U.S. Geological Survey, Forest and Rangeland Ecosystem Science Center |
| 33 | Creating a Science-based Conservation Framework for Coastal Cutthroat Trout | Kitty Griswold, Pacific States Marine Fisheries Commission (contractor) |
| 34 | Relative Growth Rates of Coastal Cutthroat Trout in Headwater Streams of Western Oregon | Douglas Bateman, Forest Engineering, Resources and Management, College of Forestry, Oregon State University |
| Invasive Species | | |
| 35 | Invasive Species Disinfection Protocol of the Aquatic and Riparian Effectiveness Monitoring Program | Henry LaVigne, AREMP - BLM |
| 36 | Equipment Decontamination with Sparquat 256: Preventing the Spread of Aquatic Nuisance Species | Calah Seese, PACFISH/INFISH Biological Opinion Effectiveness Monitoring USFS |

**FEBRUARY 24-26
2010 ORALS ANNUAL MEETING**



**HILTON EUGENE &
CONFERENCE CENTER**

©RichGrost.com



2009 Oregon Chapter American Fisheries Society Annual Meeting

made possible in part by the generous contributions of these organizations



Let's turn the answers on.



Portland General Electric



OSU Department of Fisheries & Wildlife



**COLUMBIA BASIN
FISH AND WILDLIFE
AUTHORITY**

