

### Overview

The HP Smart Array P212 is HP's entry level PCI Express (PCIe) Serial Attached SCSI (SAS) RAID controller. The low profile, half height card has 8 ports and utilizes DDR2-800 memory. The P212 is ideal for RAID 0, 1, 1+0, and can be upgraded with 256 MB Cache module for RAID 5, 5+0 and additionally with Battery Kit and Smart Array Advanced Pack (SAAP) license key for RAID 6 (ADG), & 6+0.

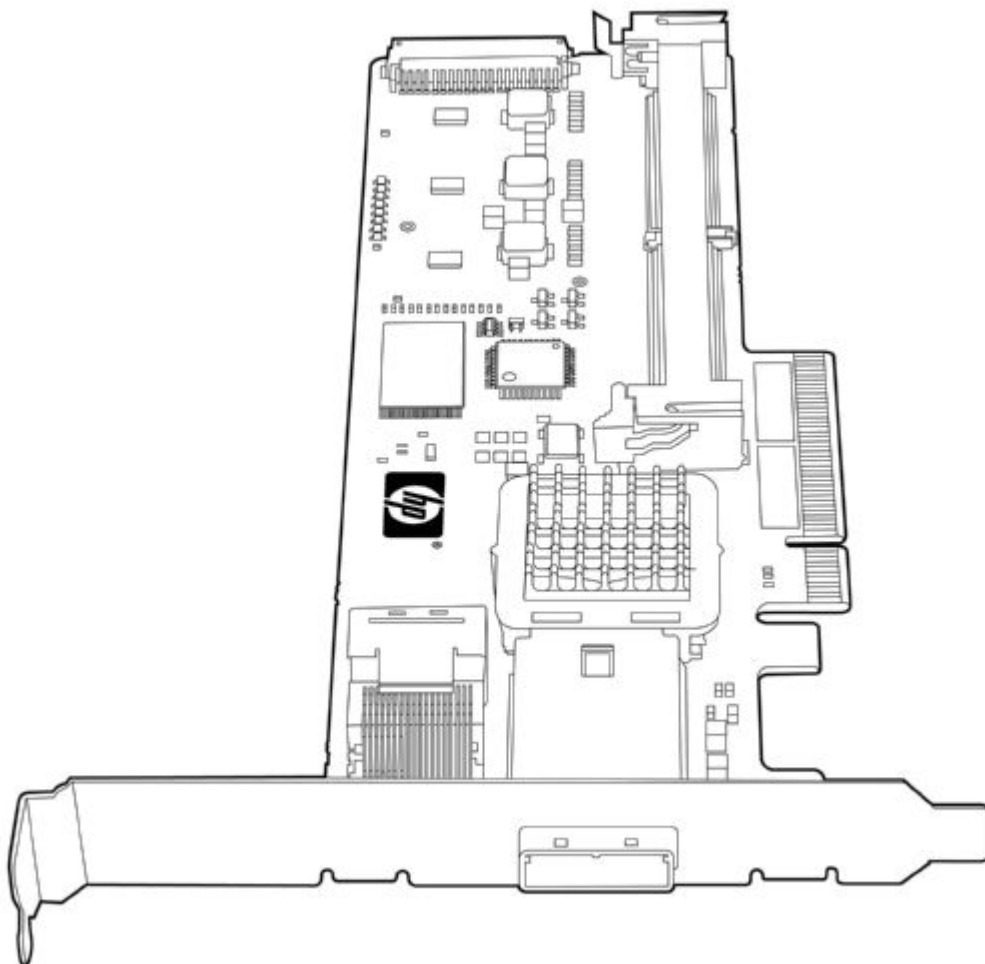

### What's New

- 6G SAS and 3G SATA support
- HP StorageWorks D2600 Disk Enclosure Support
- HP StorageWorks D2700 Disk Enclosure Support
- HP StorageWorks 600 Modular Disk System

### Models

HP Smart Array P212 Controller	HP Smart Array P212/Zero Memory Controller	462828-B21
	HP Smart Array P212/256MB Controller	462834-B21

### Overview

### Upgrade Options

HP Optional Upgrades 256 MB Cache Module	462968-B21
Battery Kit upgrade	462969-B21
<b>NOTE:</b> To enable BBWC on the 256MB cache.	
HP Smart Array Advanced Pack No Media 1-Server license including 1yr 24x7 Technical Support	516471-B21
<b>NOTE:</b> This part number can be used to purchase a single license or to order multiple licenses with a single activation key. Customers will receive a license entitlement certificate via e-mail. The license entitlement certificate must be redeemed online or via fax in order to obtain the license activation key(s). Include one year of 24x7 HP Software Technical Support Services.	
<b>NOTE:</b> A license key, a minimum of 256MB cache, and battery kit is required to enable features. For more information go to: <a href="http://www.hp.com/go/saap">http://www.hp.com/go/saap</a>	

### Standard Features

#### The Smart Array Advantage

HP's innovative design and integration work of the Smart Array family of products creates customer value that is unmatched in the industry. Use of Smart Array products across multiple applications results in a much lower Total Cost of Ownership (TCO) than any other server storage RAID product. The HP Smart Array family brings an unparalleled return on investment through:

**Data Compatibility** among all models of Smart Array controllers allows simple and easy upgrades any time needs for higher performance, capacity, and availability increase. Even successive generations of Smart Array controllers understand the data format of other Smart Array Controllers.

**Consistent Configuration and Management Tools.** All Smart Array products utilize a standard set of management and utility software. These tools minimize Total Cost of Ownership (TCO) by reducing training requirements and technical expertise necessary to install and maintain the HP server storage.

**Universal Hard Drive form factor** is for use across multiple HP servers, disk enclosures and storage systems. With compatibility across many enterprise platforms, you are free to deploy and re-deploy these drives to quickly deliver increased storage capacity, migrate data between systems, and easily manage spare drives.

**Pre-Failure Warranty** means HP Insight Manager not only reports when a drive is going to fail but allows replacement of failing drives prior to actual failure. For complete details, consult the HP Support Center or refer to your HP Server documentation.

#### Key Features

- Seamless upgrades from past generations and upgrades to next generation HP high performance and high capacity Serial Attached SCSI Smart Array controllers.
- The SA-P212 Controller supports the HP StorageWorks D2600 Disk Enclosure, HP StorageWorks D2700 Disk Enclosure, and the HP StorageWorks 600 Modular Disk System.
- 6Gb/s SAS technology delivers high performance and data bandwidth and contains full compatibility with 3Gb/s SATA technology.
- x8 5G PCI Express 2.0 host interface technology delivers high performance and data bandwidth up to 5 GB/s maximum bandwidth.
- Addition of the battery backed cache upgrade enables Capacity Expansion, RAID migration, and Stripe Size Migration. Additionally, Smart Array Advanced Pack license key enables RAID 6 (ADG), 6+0, Advanced Capacity Expansion, Mirror Splitting and Recombining in Offline Mode, Drive Erase, Performance Optimization-Degraded Reads and Read Coalescing (VOD)
- Mix-and-match SAS and SATA hard drives, lets you deploy drive technology as needed to fit your computing environment.
- Support for > 2 TB in a single logical drive.
- Support for HP StorageWorks SAS tape and tape automation products.
- Software consistency among all Smart Array family products: Array Configuration Utility (ACU), Option ROM Configuration for Arrays (ORCA), Systems Insight Manager, Array Diagnostic Utility (ADU) and SmartStart. Some of these features are not available with ProLiant 100 series platforms.
- The SA-P212 controller supports up to 54 drives.
- Low-profile PCI Express form factor - ships with a full size bracket for deployment in either a low-profile or full sized slot

#### Online Management Features

- Online Capacity Expansion (with BBWC upgrade)
- Advanced Capacity Expansion (with BBWC and SAAP license key)
- Online RAID Level Migration (with BBWC upgrade)
- Online Stripe Size Migration (with BBWC upgrade)
- Mirror splitting and recombining (with SAAP license key)
- Unlimited Global Online Spares Assignment
- User Selectable Expand and Rebuild Priority
- User Selectable RAID Level and Stripe Size
- User Selectable Read and Write Cache Sizes

#### Ports

- Eight (8) SAS physical links distributed across 1 internal x4/1 external x4 wide port connectors.

### Standard Features

#### Performance

HP's High Performance Architecture sets new boundaries of industry performance expectations!

- 6Gb/s SAS
- x8 6Gb/s SAS physical links (compatible with 3G SATA)
- 256 MB DDR2-800 battery-backed cache provides up to 4.2 GB/s maximum bandwidth.
- x8 5G PCI Express host interface provides 4 GB/s maximum bandwidth.
- MIPS 32-bit Processor
- Read ahead caching
- Write-back caching (with battery-backed write cache upgrade)

#### Native Command Queuing

Native Command Queuing (NCQ) is a technology designed to increase performance of SATA hard disk drives by allowing the individual hard disk to internally optimize the order in which received read and write commands are executed. This can reduce the amount of unnecessary going back-and-forth on the drive's heads, resulting in increased performance for workloads where multiple simultaneous read/write requests are outstanding, most often occurring in server or storage-type applications. Without NCQ the drive has to process and complete one command at a time. For NCQ to be enabled, it must be supported and turned on in the controller and in the hard drive itself.

**NOTE:** Please see the [SATA Hard Drive QuickSpecs](http://h18000.www1.hp.com/products/quickspecs/11940_div/11940_div.html) for specific SATA hard drive capacities that support NCQ: [http://h18000.www1.hp.com/products/quickspecs/11940\\_div/11940\\_div.html](http://h18000.www1.hp.com/products/quickspecs/11940_div/11940_div.html)

#### Capacity

Given the increasing need for high performance and rapid capacity expansion, the SA-P212 offers:

- Up to 24.3TB of external storage per PCI slot with 6x internal 450GB 3.5" SAS hard drives and 4x HP StorageWorks 60 Modular Smart Array enclosures or HP StorageWorks D2600 Disk Enclosures and 48 x 450GB 3.5" SAS hard drives.
- Up to 54TB of total storage per PCI slot with 6x internal 1TB 3.5" SATA MDL hard drives and 4x HP StorageWorks 60 Modular Smart Array enclosures or HP StorageWorks D2600 Disk Enclosures and 48 x 1TB 3.5" SATA MDL hard drives.
- Up to 17.4TB of total storage per PCI slot with 8x internal 300GB SFF SAS hard drives and 4x HP StorageWorks 70 Modular Smart Array enclosures or HP StorageWorks D2600 Disk Enclosures and 50 x 300GB SFF SAS hard drives.
- Up to 14.5 TB of total storage per PCI slot with 8x internal 250GB SFF SATA hard drives and 4x HP StorageWorks 70 Modular Smart Array enclosures or HP StorageWorks D2600 Disk Enclosures and 100 x 250GB SFF SATA hard drives

**NOTE:** Support for greater than 2TB in a single logical drive. Additional capacity up to 180 with an expander.

#### Availability

Provides increased server uptime by providing advanced storage functionality:

- Online Capacity Expansion (with BBWC upgrade)
- Online Advanced Capacity Expansion (with Smart Array Advanced Pack upgrade)
- Online RAID Level Migration (with BBWC upgrade)
- Online Stripe Size Migration (with BBWC upgrade)
- Global Online Spare
- Pre-Failure Warranty

### Standard Features

Fault Prevention	<p>The following features offer detection of possible failures before they occur, allowing preventive action to be taken:</p> <ul style="list-style-type: none"><li>● S.M.A.R.T.: Self Monitoring Analysis and Reporting Technology first developed at HP detects possible hard disk failure before it occurs, allowing replacement of the component before failure occurs.</li><li>● Drive Parameter Tracking monitors drive operational parameters, predicting failure and notifying the administrator.</li><li>● Dynamic Sector Repairing continually performs background surface scans on the hard disk drives during inactive periods and automatically remaps bad sectors, ensuring data integrity.</li><li>● Smart Array Cache Tracking monitors integrity of controller cache, allowing pre-failure preventative maintenance.</li></ul>
Fault Tolerance	<ul style="list-style-type: none"><li>● Keeps data available and server running while a failed drive is being replaced; several fault tolerance configurations are supported including:</li><li>● RAID 6 with ADG (Advanced Data Guarding): This is the highest level of fault tolerance. It allocates two sets of parity data across drives and allows simultaneous write operations. This level of fault tolerance can withstand two simultaneous drive failures without downtime or data loss.</li><li>● RAID 6+0: Supported with min of 8 drives, but would have 4 available. Target benefit is to split RAID across the external boxes. <b>NOTE: RAID 6, 6+0 can be enabled with either</b><ul style="list-style-type: none"><li>○ 256 MB cache, Battery kit and Smart Array Advanced Pack License key option upgrades</li><li>○ 512 MB BBWC and Smart Array Advanced Pack License key option upgrades</li></ul></li><li>● RAID 5 (Distributed Data Guarding): This allocates one set of parity data across drives and allows simultaneous write operations. This level of fault tolerance can withstand a single drive failure without downtime or data loss. <b>NOTE: RAID 5 can be enabled with a minimum 256 MB cache</b></li><li>● RAID 5+0: This is a RAID 0 array striped across 5 elements. Combines the straight block-level striping of RAID 0 with the distributed parity of RAID 5.</li><li>● RAID 1, 1+0 (Drive Mirroring): This allocates half of the drive array to data and the other half to mirrored data, providing two copies of every file. It is a high-performance RAID.</li></ul>
Fault Recovery	<p>Minimizes downtime, reconstructs data, and facilitates a quick recovery from drive failure</p> <ul style="list-style-type: none"><li>● On-Line Spares: There is no limit to the number of spare drives that can be installed prior to drive failure. If a failure occurs, recovery begins with an On-Line Spare and data is reconstructed automatically.</li><li>● DRAM ECC corrects against single bit data and address corruption.</li><li>● Battery-backed write cache upgrade provides for up to three days of battery power for data cache retention. The data backup duration could be extended anytime the server's auxiliary power is available during system power down.</li></ul>
Ease of Use	<p>Consistency and Upgradeability make the Smart Array family unique in the industry:</p> <ul style="list-style-type: none"><li>● GUI based configuration, management and diagnostic software tools</li><li>● Common data format between generations of products</li><li>● Data migration between servers and external StorageWorks Modular Smart Array enclosures and HP StorageWorks Disk Enclosures</li></ul>

### Standard Features

#### Warranty

The warranty for this device is 3 years parts, labor and onsite.

**Pre-Failure Warranty:** Drives attached to the Smart Array Controller and monitored under Insight Manager are supported by a Pre-Failure (replacement) Warranty. For complete details, consult the HP Support Center or refer to your HP Server Documentation.

#### Warranty Upgrade Options

- Response - Upgrade on-site response from next business day to same day 4 hours
- Coverage - Extend hours of coverage from 9 hours x 5 days to 24 hours x 7 days
- Duration - Select duration of coverage for a period of 1, 3, or 5 years
- Warranty upgrade options can come in the form of Care Packs, which are sold at the HP System level this product attaches too

### Compatibility

**Server Compatibility** For up to date compatibility, please see the following URL for complete Smart Array P212 Controller compatibility and support information:  
<http://h18006.www1.hp.com/products/servers/proliantstorage/arraycontrollers/index.html>

---

**Operating Systems**

- Microsoft Windows 2003 x64 Edition
- Microsoft Windows 2003 x84 Edition
- Microsoft Windows 2008 Server x64
- Microsoft Windows 2008 Server x84
- Red Hat Enterprise Linux 4, 5 (x64 & x84)
- SUSE Linux Enterprise Server 9 (x64 & x84)
- SUSE Linux Enterprise Server 10 (x64 & x84)
- SUSE Linux Enterprise Server 11 (x64 & x84)
- Novell Netware 6.5 (Open Enterprise Server)
- VMware

**NOTE:** For more Linux OS support & certification information, please visit our the ProLiant & BladeSystem Server Linux matrix: <http://h18004.www1.hp.com/products/servers/linux/hplinuxcert.html>

---

**Software Suite** All Smart Array products share a common set of configuration, management and diagnostic tools, including Array Configuration Utility (ACU), Array Diagnostic Utility (ADU), and Systems Insight Manager. This software consistency of tools reduces the cost of training for each successive generation of product and takes much of the guesswork out of troubleshooting field problems. These tools lower the total cost of ownership by reducing training and technical expertise necessary to install and maintain HP server storage.

#### Systems Insight Manager

- Powerful server and server options/storage manager tool
- Monitors over 1200 system wide parameters
- Configuration/Diagnostic Utilities
- SIM is only for the HP ProLiant 300, 500 and Blade series servers.

#### HP Array Configuration Utility (ACU)

- Powerful Web based configuration utility for all Smart Array controllers
- Provides a graphical view of HP drive array configurations.
- Allows for management of multiple arrays over a secure internet connection from anywhere in the world.
- Easy to use Wizards for configuration
- Runs offline for all supported Operating Systems on the ProLiant 300, 500 and Blade series and runs online for Windows and Linux. For online configuration of NetWare, use CPQONLIN.

#### HP Option ROM Configuration for Arrays (ORCA)

- A simple method for managing logical volumes during system power up by pressing F8 during POST
- Allows the ability to create arrays, logical volumes, and assign an online spare drive.
- Allows the ability to view and delete logical volumes
- Allows the ability to select the boot controller
- For advanced array configurations use ACU

#### HP Array Diagnostic Utility (ADU)

- In depth diagnostic and reporting utility for all Smart Array controllers
- Runs offline for all supported Operating Systems, and runs online for Windows and Linux in HP ProLiant 300, 500 and Blade series servers

### Service and Support

**Service and Support**    **HP Care Pack Services: Packaged server and storage services for increased uptime, productivity and ROI**

When you buy HP server and storage products and solutions, it's also a good time to think about what levels of support you may need. Our portfolio of service options reduce deployment and management worries while helping you get the most out of your server and storage investments. We take a holistic approach to your environment, bridging servers, blades, storage, software and network infrastructures with our packaged HP Care Pack Services for servers and storage.

#### Protect your business beyond warranty

When it comes to robustness and reliability, standard computing equipment warranties have matured along with technology. Good news that can also create problems stemming from depending on standard warranties designed to only protect against product defects and some downtime causes. Using a standard approach to warranty uplifts, such as HP Care Pack Services, helps reduce downtime risks and provides operational consistency for mission-critical and standard business computing.

**HP Care Pack Services: Upgrading or extending standard server and storage warranties cost-effectively**

HP Care Pack Services offer a standard reactive hardware and software support services suite sold separately, or combined with our Support Plus and Support Plus 24 services. The portfolio also provides a combination of integrated proactive and reactive services, such as Proactive 24 Service and Critical Service. In addition with HP Proactive Select, you can acquire the specific proactive constancy and technical services. HP Proactive Select menu offers a broad set of service options that you can mix and match depending on your specific requirements. Proactive service options include offers for server, storage, network, SAN device, software, environment and education services.

HP server and storage lifecycle support services offers a full spectrum of customer care-from technology support to complex migrations to complete managed services. HP Factory Express provides customization, integration and deployment services for turnkey solutions. HP Education Services offer flexible, comprehensive training on to help your IT staff get the most out of your server and storage investments. HP Financial solutions extend innovative financing and cost-effective asset management programs-from purchase to equipment retirement.

Learn more: [www.hp.com/services/servers](http://www.hp.com/services/servers) and [www.hp.com/services/storage](http://www.hp.com/services/storage)

**NOTE:** Care Pack Services availability may vary by product and country.

HP Care Pack Services are sold by HP and HP Authorized Service Partners:

- Services for customers purchasing from HP or an enterprise reseller are quoted using HP order configuration tools.
- Customers purchasing from a commercial reseller can find HP Care Pack Services at <http://www.hp.com/go/lookuptool>



### Service and Support

#### Recommended HP Care Pack Services for optimal satisfaction with your HP product

##### Recommended Services Hardware Options Support

HP Care Packs provide support for all HP-branded hardware options qualified for inclusion in your server or storage solution. Any additional HP-qualified options installed within the server are covered at the same service level and for the same period as the server and no additional cost.

- Help improve or maintain system uptime
- Convenient onsite support
- Committed response time

<http://h20195.www2.hp.com/V2/GetPDF.aspx/5982-6547EEE>

##### 3-Year HP Hardware Support Onsite Service, 4-hour response, 24x7

Provides you with rapid remote support and if required an HP authorized representative who will arrive on site any time and day of the year to begin hardware maintenance service within 4 hours of the service request being logged.

This service provides a trained HP service specialist to perform an installation that meets HP quality standards, for:

- Help improve or maintain system uptime
- Convenient onsite support
- Committed response time

<http://h20195.www2.hp.com/V2/GetPDF.aspx/5982-6547EEE>

##### HP Installation and Startup of HP ProLiant Servers

Provides for the installation of your new HP ProLiant server and operating system to assist you in bringing your new HP ProLiant server and operating system into operation in a timely and professional manner.

This service provides a trained HP service specialist to perform an installation that meets HP quality standards, for:

- Delivery of the service at a mutually scheduled time convenient to your organization
- Availability of an HP service specialist to answer basic questions during the onsite delivery of this service
- Custom installation as detailed in "Delivery specifications" or in a Statement of Work (SOW)
- Verification prior to installation that all service prerequisites are met

<http://h20195.www2.hp.com/V2/GetPDF.aspx/5982?7572ENN>

### Service and Support

#### Optional HP Care Pack Services that will enhance your HP product experience

##### Optional Services

**3-Year HP Hardware Support Onsite Call-to-Repair (CTR) Service, 6- or 24-hour**  
As an alternative to our recommended support level, for customers who need committed call-to-repair for server hardware.

Provides your IT manager with a team of support specialists who will quickly begin troubleshooting the system to help return the hardware to operating condition within 6 or 24 hours of the initial service request to the HP Global Solution Center.

<http://h20195.www2.hp.com/V2/GetPDF.aspx/5981-6636ENN>

##### 3-Year HP Support Plus 24

As an alternative to our recommended support level, for customers who need access to responsive 24x7 hardware and software support plus software updates on HP and selected third party products:

For a higher return on your server and storage technology, our 3-year combined reactive support service delivers integrated onsite hardware/software support services available 24x7x365, including access to HP technical resources, 4-hour response onsite hardware support and software updates.

<http://h20195.www2.hp.com/V2/GetPDF.aspx/5981-6638EEE>

##### HP Proactive Select Service

Customer needs on demand access to consulting, technical proactive services and education courses

Provides a flexible way to purchase HP best-in-class consultancy and technical services. You can buy Proactive Select Service Credits when you purchase your hardware and then use the credits over the next 12 months.

<http://h20195.www2.hp.com/V2/GetPDF.aspx/4AA2-3842ENN>

---

#### eSupport

HP eSupport is a portfolio of technology-based services that assist you with managing your business environment - from the desktop to the data center.

##### Support Portal

The HP support portal provides one-stop access to the information, tools and services you need to manage the daily operations of your IT environment.

##### Features include:

- Access to self-solve tools (including search technical knowledge base)
- Efficient logging and tracking of support cases
- Collaboration with other business and IT professionals
- Download of patches and drivers
- Access to diagnostic tools
- Proactive notification of relevant information

Access to certain features of the support portal requires an HP service agreement. To access the support portal, visit: <http://www.hp.com/support>

HP Insight Remote Support software delivers secure remote support for your HP Servers and Storage, 24 X 7, so you can spend less time solving problems and more time focused on your business. You can have your systems remotely monitored for hardware failure using secure technology that's been proven at thousands of companies around the world. In many cases, you can avoid problems before they occur.

### Service and Support

#### Customer Technical Training

In today's cost-conscious business environment, IT professionals, developers, consultants and users face an interesting challenge: how to keep up with the latest technologies and expand important skills while delivering profitable results on current projects. To help address this challenge, HP offers innovative training solutions that help keep you up-to-date on virtualization, server, storage, Insight Control, Citrix, Microsoft® and open source/Linux-related topics-while spending less time away from business-critical activities.

---

#### HP Services Awards

HP Technology Services continues to be recognized for service and support excellence by customers, partners, industry organizations and publications around the world. Recent honors and award reflect our services team's dedications, technical expertise, professionalism and uncompromising commitment to customer satisfaction.

---

#### Additional Services Information

To learn more on HP ProLiant servers, HP BladeSystem servers and HP StorageWorks storage products, please contact your HP sales representative or HP Authorized Channel Partner. Or visit: [www.hp.com/services/proliant](http://www.hp.com/services/proliant) or [www.hp.com/services/bladesystem](http://www.hp.com/services/bladesystem) or <http://www.hp.com/hps/storage>

### Related Options

NOTE: This is a list of related options. Some may be discontinued.

#### HP Hard Drives

NOTE: The components of a storage subsystem (e.g. the drive, the HBA/controller, firmware, and the server backplane) should operate at the same data transfer rate or the system bandwidth will be negotiated down to an acceptable level for all components.

NOTE: Hard drives have either a one year or three year warranty; refer to the specific hard drive QuickSpecs for details.

#### SAS Hot Plug SFF (2.5-inch) Enterprise (ENT) Drives

HP 600GB 6G SAS 10K rpm SFF (2.5-inch) Dual Port Enterprise 3yr Warranty Hard Drive 581286-B21

HP 450GB 6G SAS 10K rpm SFF (2.5-inch) Dual Port Enterprise 3yr Warranty Hard Drive 581284-B21

HP 300GB 6G SAS 10K rpm SFF (2.5-inch) Dual Port Enterprise 3yr Warranty Hard Drive 507127-B21

HP 300GB 3G SAS 10K rpm SFF (2.5-inch) Dual Port Enterprise 3yr Warranty Hard Drive 492620-B21

HP 146GB 6G SAS 15K rpm SFF (2.5-inch) Dual Port Enterprise 3yr Warranty Hard Drive 512547-B21

HP 146GB 3G SAS 15K rpm SFF (2.5-inch) Dual Port Enterprise 3yr Warranty Hard Drive 504062-B21

HP 146GB 6G SAS 10K rpm SFF (2.5-inch) Dual Port Enterprise 3yr Warranty Hard Drive 507125-B21

HP 146GB 3G SAS 10K rpm SFF (2.5-inch) Dual Port Enterprise 3yr Warranty Hard Drive 418367-B21

HP 72GB 6G SAS 15K rpm SFF (2.5-inch) Dual Port Enterprise 3yr Warranty Hard Drive 512545-B21

HP 72GB 3G SAS 15K rpm SFF (2.5-inch) Dual Port Enterprise 3yr Warranty Hard Drive 418371-B21

HP 72GB 10K rpm Hot Plug SAS 2.5 Dual Port Hard Drive 384842-B21

HP 36GB 15K rpm Hot Plug SAS 2.5 Dual Port Hard Drive 418369-B21

#### SAS Non-Hot Plug SFF (2.5-inch) Enterprise (ENT) Drives

HP 300GB 6G SAS 10K rpm SFF (2.5-inch) Non-hot Plug Dual Port Enterprise 3yr Warranty Hard Drive 537809-B21

HP 146GB 6G SAS 10K rpm SFF (2.5-inch) Non-hot Plug Dual Port Enterprise 3yr Warranty Hard Drive 537807-B21

HP 72GB 6G SAS 15K rpm SFF (2.5-inch) Non-hot Plug Dual Port Enterprise 3yr Warranty Hard Drive 537805-B21

#### SAS Hot Plug LFF (3.5-inch) Enterprise (ENT) Drives

HP 600GB 6G SAS 15K rpm LFF (3.5-inch) Dual Port Enterprise 3yr Warranty Hard Drive 516828-B21

HP 450GB 6G SAS 15K rpm LFF (3.5-inch) Dual Port Enterprise 3yr Warranty Hard Drive 516816-B21

HP 450GB 3G SAS 15K rpm LFF (3.5-inch) Dual Port Enterprise 3yr Warranty Hard Drive 454232-B21

HP 400GB 10K rpm Hot Plug SAS 3.5 Dual Port Enterprise Hard Drive 459508-B21

HP 300GB 6G SAS 15K rpm LFF (3.5-inch) Dual Port Enterprise 3yr Warranty Hard Drive 516814-B21

HP 300GB 3G SAS 15K rpm LFF (3.5-inch) Dual Port Enterprise 3yr Warranty Hard Drive 416127-B21

HP 146GB 3G SAS 15K rpm LFF (3.5-inch) Dual Port Enterprise 3yr Warranty Hard Drive 384854-B21



### Related Options

HP 72GB 15K rpm Hot Plug SAS 3.5 Dual Port Hard Drive	384852-B21
SAS Non-Hot Plug LFF (3.5-inch) Enterprise (ENT) Drives	
HP 600GB 6G SAS 15K rpm LFF (3.5-inch) Non-hot Plug Dual Port Enterprise 3yr Warranty Hard Drive	516830-B21
HP 450GB 6G SAS 15K rpm LFF (3.5-inch) Non-hot Plug Dual Port Enterprise 3yr Warranty Hard Drive	516826-B21
HP 450GB 3G SAS 15K rpm LFF (3.5-inch) Non-hot Plug Dual Port Enterprise 3yr Warranty Hard Drive	454234-B21
HP 400GB 10K rpm Non Hot Plug SAS 3.5 Dual Port Enterprise Hard Drive	508232-B21
HP 300GB 6G SAS 15K rpm LFF (3.5-inch) Non-hot Plug Dual Port Enterprise 3yr Warranty Hard Drive	516824-B21
HP 300GB 3G SAS 15K rpm LFF (3.5-inch) Non-hot Plug Dual Port Enterprise 3yr Warranty Hard Drive	417950-B21
HP 146GB 3G SAS 15K rpm LFF (3.5-inch) Non-hot Plug Dual Port Enterprise 3yr Warranty Hard Drive	417855-B21
SAS Hot Plug SFF (2.5-inch) Midline (MDL) Drives	
HP 500GB 6G SAS 7.2K rpm SFF (2.5-inch) Dual Port Midline 1yr Warranty Hard Drive	507610-B21
SAS Hot Plug LFF (3.5-inch) Midline (MDL) Drives	
HP 2TB 6G SAS 7.2K rpm LFF (3.5-inch) Dual Port Midline 1yr Warranty Hard Drive	507616-B21
HP 1TB 6G SAS 7.2K rpm LFF (3.5-inch) Dual Port Midline 1yr Warranty Hard Drive	507614-B21
HP 1TB 3G SAS 7.2K rpm LFF (3.5-inch) Dual Port Midline 1yr Warranty Hard Drive	461137-B21
HP 750GB 3G SAS 7.2K rpm LFF (3.5-inch) Dual Port Midline 1yr Warranty Hard Drive	461135-B21
SATA Hot Plug SFF (2.5-inch) Midline (MDL) Drives	
HP 500GB 3G SATA 7.2K rpm SFF (2.5-inch) Midline 1yr Warranty Hard Drive	507750-B21
HP 160GB 3G SATA 7.2K rpm SFF (2.5-inch) Midline 1yr Warranty Hard Drive	530888-B21
SATA Non-Hot Plug SFF (2.5-inch) Midline (MDL) Drives	
HP 500GB 3G SATA 7.2K rpm SFF (2.5-inch) Non-hot Plug Midline 1yr Warranty Hard Drive	507753-B21
HP 160GB 3G SATA 7.2K rpm SFF (2.5-inch) Non-hot Plug Midline 1yr Warranty Hard Drive	530891-B21
SATA Hot Plug LFF (3.5-inch) Midline (MDL) Drives	
HP 2TB 3G SATA 7.2K rpm LFF (3.5-inch) Midline 1yr Warranty Hard Drive	507632-B21
HP 1TB 3G SATA 7.2K rpm LFF (3.5-inch) Midline 1yr Warranty Hard Drive	454146-B21
HP 750GB 3G SATA 7.2K rpm LFF (3.5-inch) Midline 1yr Warranty Hard Drive	458930-B21
HP 500GB 3G SATA 7.2K rpm LFF (3.5-inch) Midline 1yr Warranty Hard Drive	458928-B21
HP 250GB 3G SATA 7.2K rpm LFF (3.5-inch) Midline 1yr Warranty Hard Drive	458926-B21
SATA Non-Hot Plug LFF (3.5-inch) Midline (MDL) Drives	
HP 2TB 3G SATA 7.2K rpm LFF (3.5-inch) Non-hot Plug Midline 1yr Warranty Hard Drive	507774-B21
HP 1TB 3G SATA 7.2K rpm LFF (3.5-inch) Non-hot Plug Midline 1yr Warranty Hard Drive	507772-B21
HP 750GB 3G SATA 7.2K rpm LFF (3.5-inch) Non-hot Plug Midline 1yr Warranty Hard Drive	462595-B21
HP 500GB 3G SATA 7.2K rpm LFF (3.5-inch) Non-hot Plug Midline 1yr Warranty Hard Drive	458941-B21
HP 250GB 3G SATA 7.2K rpm LFF (3.5-inch) Non-hot Plug Midline 1yr Warranty Hard Drive	458939-B21
SATA SFF Hot Plug Entry (ETY) Drives	

### Related Options

HP 250GB 3G SATA 5.4K rpm SFF (2.5-inch) Entry 1yr Warranty Hard Drive	460355-B21
HP 120GB 1.5G SATA 5.4K rpm SFF (2.5-inch) Entry 1yr Warranty Hard Drive	458924-B21
SATA Non-Hot Plug SFF (2.5-inch) Entry (ETY) Drives	
HP 250GB 3G SATA 5.4K rpm SFF (2.5-inch) Non-hot Plug Entry 1yr Warranty Hard Drive	460357-B21
HP 120GB 1.5G SATA 5.4K rpm SFF (2.5-inch) Non-hot Plug Entry 1yr Warranty Hard Drive	459357-B21
SATA Hot Plug LFF (3.5-inch) Entry (ETY) Drives	
HP 250GB 3G SATA 7.2K rpm LFF (3.5-inch) Entry 1yr Warranty Hard Drive	571230-B21
HP 160GB 3G SATA 7.2K rpm LFF (3.5-inch) Entry 1yr Warranty Hard Drive	458945-B21
SATA Non-Hot Plug LFF (3.5-inch) Entry (ETY) Drives	
HP 250GB 3G SATA 7.2K rpm LFF (3.5-inch) Non-hot Plug Entry 1yr Warranty Hard Drive	571232-B21
HP 160GB 3G SATA 7.2K rpm LFF (3.5-inch) Non-hot Plug Entry 1yr Warranty Hard Drive	458947-B21
<p><b>NOTE:</b> Go to the <a href="http://www.hp.com/products/harddiskdrives">HP Hard Drive Compatibility table</a> for complete drive compatibility information (<a href="http://www.hp.com/products/harddiskdrives">http://www.hp.com/products/harddiskdrives</a>). Using hard drives in unsupported configurations will result in voiding the warranty and could result in damage to the drive and/or loss of data.</p>	

### HP Disk Storage Systems MSA SAN Storage Arrays

HP StorageWorks 60 Modular Smart Array	418408-B21
<p><b>NOTE:</b> Supports 12 SFF drives, and SAS 3 Gb/s and SATA 1.5 Gb/s.  <b>NOTE:</b> Please see the QuickSpecs for additional options and configuration information at:  <a href="http://h18000.www1.hp.com/products/quickspecs/12627_div/12627_div.html">http://h18000.www1.hp.com/products/quickspecs/12627_div/12627_div.html</a></p>	
HP StorageWorks 70 Modular Smart Array	418800-B21
<p><b>NOTE:</b> Supports 25 SFF drives, and SAS 3 Gb/s and SATA 1.5 Gb/s.  <b>NOTE:</b> Please see the QuickSpecs for additional options and configuration information at:  <a href="http://h18000.www1.hp.com/products/quickspecs/12652_div/12652_div.html">http://h18000.www1.hp.com/products/quickspecs/12652_div/12652_div.html</a></p>	

### HP StorageWorks Modular Disk System

HP MDS600 with two Dual Port I/O Module System	AJ866A
<p><b>NOTE:</b> Please see the QuickSpecs for additional information including configuration steps and additional options needed for a complete solution at:  <a href="http://h18000.www1.hp.com/products/quickspecs/13257_div/13257_div.html">http://h18000.www1.hp.com/products/quickspecs/13257_div/13257_div.html</a></p>	

### HP Tape Drives

DAT Tape Drives	
HP StorageWorks DAT 160 SAS Internal Tape Drive	Q1587A
HP StorageWorks DAT 160 SAS External Tape Drive	Q1588A
LTO Ultrium Tape Drives	
HP StorageWorks LTO-2 Ultrium 448 SAS Internal Tape Drive	DW085A
HP StorageWorks LTO-2 Ultrium 448 SAS External Tape Drive	DW086A
HP StorageWorks LTO-3 Ultrium 920 SAS Internal Tape Drive	EH847A
HP StorageWorks LTO-3 Ultrium 920 SAS External Tape Drive	EH848A
HP StorageWorks LTO-4 Ultrium 1760 SAS Internal Tape Drive	EH919A
HP StorageWorks LTO-4 Ultrium 1760 SAS External Tape Drive	EH920A
HP StorageWorks 1U SAS Rack-Mount Kit with one LTO-4 Ultrium 1760	EH946A
HP StorageWorks LTO-4 Ultrium 1840 SAS Internal Tape Drive	EH860A

### Related Options

HP StorageWorks LTO-4 Ultrium 1840 SAS External Tape Drive	EH861A
Rack-mount Tape Drive Enclosures	
HP StorageWorks 1U SAS Rack-Mount Kit	AE459A
NOTE: The 1U SAS Rack-Mount Kit can support up to (2) half-height tape drives and is compatible with the DAT 160 SAS, LTO-2 Ultrium 448 SAS, LTO-3 Ultrium 920 SAS and LTO-4 Ultrium 1760 SAS tape drives.	
HP StorageWorks 3U SAS Rack-mount Kit	AG576A
NOTE: The 3U Rack-mount Kit can support up to (2) full-height or (4) half-height tape drives and compatible with multiple SAS tape drives including DAT 160 SAS, LTO-2 Ultrium 448 SAS, LTO-3 Ultrium 920 SAS, LTO-4 Ultrium 1760 SAS and LTO-4 Ultrium 1840 SAS tape drives.	
Tape Autoloaders	
HP StorageWorks 1/8 G2 LTO-4 Ultrium 1760 SAS Tape Autoloader	AK377A
HP StorageWorks 1/8 G2 LTO-3 Ultrium 920 SAS Autoloader	AH558A
Tape Libraries	
HP StorageWorks MSL2024 1 LTO-4 Ultrium 1760 SAS Drive Library	AK378A
HP StorageWorks MSL2024 1 LTO-3 Ultrium 920 SAS Drive Library	AH559A
HP StorageWorks MSL4048 2 LTO-4 Ultrium 1760 SAS Drive Library	AK380A
HP StorageWorks MSL4048 1 LTO-3 Ultrium 920 SAS Drive Library	AH560A
HP StorageWorks MSL8096 2 LTO-4 Ultrium 1760 SAS Drive Library	AH382A
HP StorageWorks MSL8096 2 LTO-3 Ultrium 920 SAS Drive Library	AH561A
SAS Cables for Tape Drives and Automation	
1 meter internal SAS SFF8087, split to 1 x internal SFF8087 + 1 x SFF8482 cable	AP746A
NOTE: Use this cable to connect HP StorageWorks Ultrium 448, 920, 960, 1760 and 1840 SAS internal tape drives to Mini-SAS (SFF8087) ports. This replaces the existing cable connecting the HBA/controller to the disk backplane. This replacement cable has three channels for disks and 1 channel for the tape drive (SFF8482 port).	
2 meter external Mini-SAS (SFF8088) to Mini-SAS (SFF8088) 1x SAS cable	AE470A
NOTE: Use this cable to connect HP StorageWorks SAS external tape devices to HP SAS controllers with external Mini-SAS (SFF8088) connectors.	
4 meter external Mini-SAS (SFF8088) to Mini-SAS (SFF8088) 1x SAS cable	AE465A
NOTE: Use this cable to connect HP StorageWorks SAS external tape devices to HP SAS controllers with external Mini-SAS (SFF8088) connectors.	
4 meter internal Mini-SAS (SFF8087), split to 3 x internal Mini-SAS (SFF8087) + 1x SFF8088	AG452A
NOTE: This split cable connects internally to SAS Hard Drive Cage (3 channels) and externally to the tape drive (1 channel) with other connector attaching to the controller. The external cable, for the drive, requires a PCI slot to exit the server.	
2 meter external mini-SAS (SFF8088), split to 4x mini-SAS (SFF8088) cable	AN975A
NOTE: One cable is required for every four drives. Use this cable to connect HP StorageWorks MSL SAS Tape Libraries to Mini-SAS (SFF8088) ports.	
4 meter external mini-SAS (SFF8088), split to 4x mini-SAS (SFF8088) cable	AN976A
NOTE: One cable is required for every four drives. Use this cable to connect HP StorageWorks MSL SAS Tape Libraries to Mini-SAS (SFF8088) ports.	

### Related Options

HP Cable Options	Mini SAS Cables	
	HP Mini SAS to Mini SAS 28in Cable Assembly	496013-B21
	HP Mini SAS to Mini SAS 33in Cable Assembly	496014-B21
	HP Mini SAS to 8484 18in/24in Cable Assembly	496015-B21
	HP Mini SAS to 8484 32in/35in Cable Assembly	496016-B21
	Additional Cables	
	HP 15 Position 24in SFP Battery Cable Assembly	496029-B21



### Technical Specifications

Dimensions (not including bracket)	Low Profile PCIe Form Factor 19.05 cm x 24.13 cm x 5.72cm (7.5 in x 9.5 in x 2.25 in)
Disk Drive and Enclosure Interface - transfer rate	6Gb/s SAS (Serial Attached SCSI) 3Gb/s SATA (Serial ATA)
SAS Connectors	1 internal/1 external (Mini-SAS) x8 wide port connectors
Cache Memory Speed	DDR-2/800 MHz with 40 or 72-bit wide bus provides up to 4.2 GB/s maximum bandwidth.
Server Interface	x8 5G PCIe 2.0 provides 4GB/s maximum bandwidth.
SAS Speed	x8 6G SAS provides 4.8GB/s maximum bandwidth.
Cache Memory	40-bit 256MB ECC protected cache; transportable with battery-backed upgrade. <b>NOTE: The 256MB cache is not battery-backed or transportable.</b>
Logical Volumes Supported	Zero Memory, Up to 2 logical volumes 256mb cache, Up to 64 logical volumes
Maximum Volume Capacity	6TB (6 x 1TB SATA 3.5" MDL HDD) <b>NOTE: Support for greater than 2TB in a single logical drive.</b>
Host Memory Addressing	64-bit, supporting greater than 4GB server memory space
RAID Support	RAID 6, 6+0 (Advanced Data Guarding) <b>NOTE: RAID 6, 6+0 can be enabled with either</b> <ul style="list-style-type: none"><li>• 256 MB cache, Battery kit and Smart Array Advanced Pack License key option upgrades</li><li>• 512 MB BBWC and Smart Array Advanced Pack License key option upgrades</li></ul> RAID 5, 5+0 (Distributed Data Guarding) <b>NOTE: RAID 5, 5+0 can be enabled with a minimum 256 MB cache</b> RAID 1, 1+0 (Striping & Mirroring) RAID 0 (Striping)
Upgradeable Firmware	Upgradeable Firmware with Recovery ROM feature

**Environment-friendly End-of-life Management Products and Approach and Recycling** Hewlett-Packard offers end-of-life HP product return, trade-in, and recycling programs in many geographic areas. For trade-in information, please go to: <http://www.hp.com/go/green>. To recycle your product, please go to: <http://www.hp.com/go/green> or contact your nearest HP sales office. Products returned to HP will be recycled, recovered or disposed of in a responsible manner.

The EU WEEE directive (2002/95/EC) requires manufacturers to provide treatment information for each product type for use by treatment facilities. This information (product disassembly instructions) is posted on the Hewlett Packard web site at: <http://www.hp.com/go/green>. These instructions may be used by recyclers and other WEEE treatment facilities as well as HP OEM customers who integrate and re-sell HP equipment.

© Copyright 2010 Hewlett-Packard Development Company, L.P.

The information contained herein is subject to change without notice. Microsoft and Windows are registered trademarks or trademarks of Microsoft Corporation in the U.S. and/or other countries. The only warranties for HP products and services are set forth in the express warranty statements accompanying such products and services. Nothing herein should be construed as constituting an additional warranty. HP shall not be liable for technical or editorial errors or omissions contained herein.

For hard drives, 1GB = 1 billion bytes. Actual formatted capacity is less.

