



Intelligent functions to make your security system operations easier and more secure

WV-SAE200 is possible to use the following functions: the face detection function and the i-VMD function (alarm functions: intrusion detection/ loitering/ direction detection/ scene change/ object detection/ cross line detection, the analysis data control function: people count/heat map, and the privacy function: MOR (Moving Object Remover)).

Key Features

Intelligent Video Motion Detection

Intruder

Type1 / Type2 / Type3 / Type4

It is possible to issue an alarm when a moving object enters the area. Up to 8 objects, or 32 objects (Type3 only) can be detected simultaneously per channel.



Loitering

Type1 / Type2 / Type3 / Type4

It is possible to issue an alarm when a moving object enters the area and stays for the specified period. Up to 8 objects, or 32 objects (Type3 only) can be detected simultaneously per channel.



Direction

Type1 / Type2 / Type4

It is possible to issue an alarm when a moving object enters the area and moves to the specified direction. Up to 8 objects, or 32 objects (Type3 only) can be detected simultaneously per channel.



Cross line

Type2 / Type3 / Type4

It is possible to issue an alarm when an object moving to the specified direction crossed the line. Up to 8 objects, or 32 objects (Type3 only) can be detected simultaneously per channel.



Object

Type2 / Type3 / Type4

It is possible to issue an alarm if an object (suspicious object, etc.) is left behind in the area or taken away from the area. Up to 8 objects, or 24 objects (Type3 only) can be detected simultaneously per channel.



Scene change

Type1 / Type2 / Type3 / Type4

It is possible to issue an alarm when a camera is covered with something or the camera direction is changed to shoot a different subject.

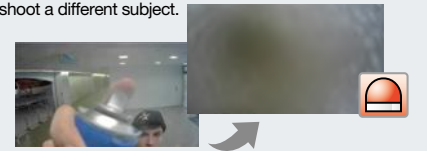

People Counting

Type3

It provides function of counting the number of people who crossed the line in a certain direction which is set with "Line".



Heat-map

Type3

Heat-map provides statistical information of traffic lines. Counts up both passing and loitering in the shooting area.

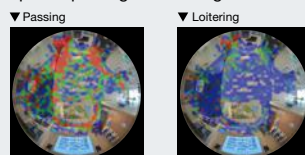

MOR(Moving Object Remover)

Type3

MOR is a privacy-conscious function which removes people from the image and only send the background image.

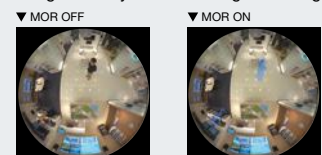

Actions When an Alarm is Detected

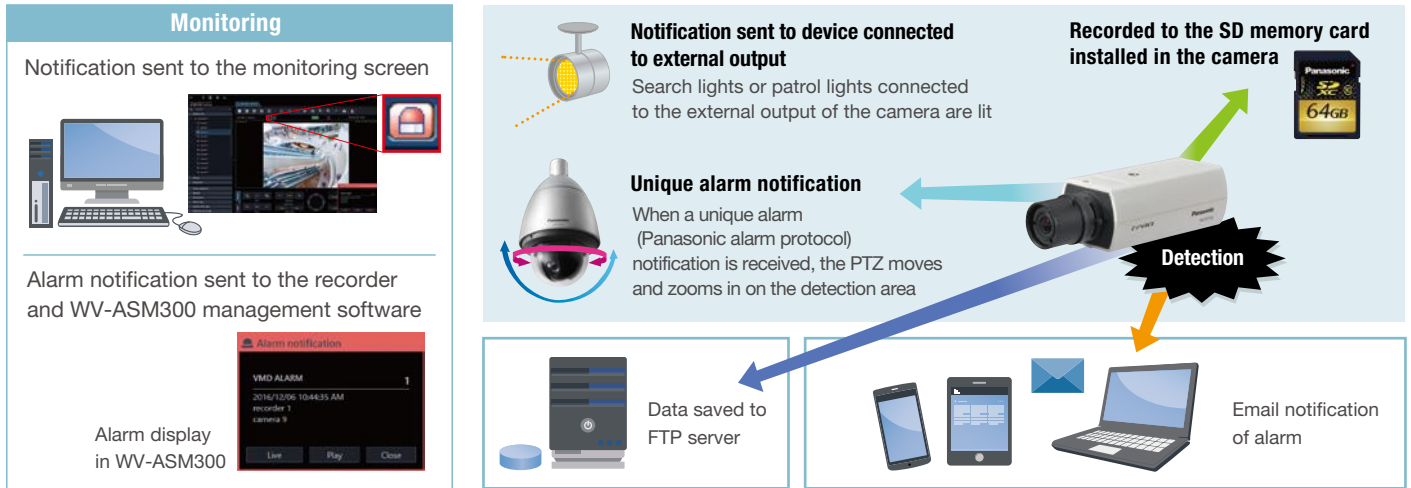

Specifications

Intelligent Video Motion Detection

Detection program	Available number of programs	Up to 2
	Title	1 - 20 characters
Detection area	Available number of Detection Areas	Up to 8 detection areas (for each detection program)
	Paint type	Cross line, Quadrangle, Polygon (up to 16 apexes)
Mask area	Available number of Mask Areas	Up to 8 mask areas (for each detection program)
	Paint type	Quadrangle, Polygon (up to 16 apexes)
Detection mode	Intruder / Loitering / Direction / Object / Cross line	
Direction setup	One of eight directions can be chosen. (Upper, Upper right, Right, Lower right, Lower, Lower left, Left, Upper left)	
Scene change	ON / OFF	
Cross line setup	A --> B, B --> A, A <--> B	

Advanced settings

Detection sensitivity	1(Low), 2, 3, 4(Middle), 5, 6, 7(High)	
Detection sensitivity (Object)	Low / Middle / High	
Detection sensitivity (Scene change)	1(Low), 2, 3, 4(Middle), 5(High)	
Scene change detection level	1(Low), 2(Middle), 3, 4, 5(High)	
Detection time	Intruder detection time	0.2 s / 0.4 s / 1 s / 2 s / 3 s / 4 s / 5 s / 10 s
	Loitering detection time	10 s / 20 s / 30 s / 1 min / 2 min / 3 min / 5 min
	Direction detection time	1 s / 2 s / 3 s / 4 s / 5 s / 10 s
	Object detection time	10 s / 20 s / 30 s / 1 min / 2 min / 3 min / 5 min
	Scene change detection time	1 s / 2 s / 3 s / 4 s / 5 s / 10 s
Detection size ¹	Min. size	10 / 20 / 30 / 40 / 50 / 60 / 70 / 80 / 90%
	Max. size	100 / 150 / 200 / 250 / 300%

¹ Except Type 3 network cameras

Compatible models

	Registration Key Type	Product Number
Network Camera	Type1	WV-SW559 / WV-SW558 / WV-SW158 / WV-SP509 / WV-SP508 / WV-SF549 / WV-SF548 / WV-SF539 / WV-SF538 / WV-SF138
	Type2	WV-SVR611L / WV-SPW631LT / WV-SPW631L / WV-SPW611L / WV-SPW611 / WV-SPW532L / WV-SPW531AL / WV-SPW312L / WV-SPW311AL / WV-SPN631 / WV-SPN611 / WV-SPN531 / WV-SPN311 / WV-SPN310 / WV-SFV631LT / WV-SFV631L / WV-SFV611L / WV-SFV531 / WV-SFV311 / WV-SFV310 / WV-SFV130M / WV-SFV130 / WV-SFV110M / WV-SFV110 / WV-SFR631L / WV-SFR531 / WV-SFR311 / WV-SFR310 / WV-SFN631L / WV-SFN611L / WV-SFN531 / WV-SFN311L / WV-SFN311 / WV-SFN310 / WV-SFN130 / WV-SFN110
	Type3	WV-SFV481 / WV-SFN480
	Type4	WV-X6531N / WV-X6511N / WV-S2531LTN / WV-S2531LN / WV-S2511LN / WV-S2231L / WV-S2211L / WV-S2131L / WV-S2131 / WV-S2130 / WV-S2111L / WV-S2110 / WV-S1531LTN / WV-S1531LN / WV-S1511LN / WV-S1132 / WV-S1131 / WV-S1112 / WV-S1111

Trademarks and registered trademarks

– "i-PRO EXTREME" logo is trademarks or registered trademarks of Panasonic Corporation.

Important

– Safety Precaution : Carefully read the Important Information, Installation Guide and operating instructions before using this product.
– Panasonic cannot be responsible for the performance of the network and/or other manufacturers' products used on the network.

• All TV pictures are simulated.
• Specifications are subject to change without notice.

DISTRIBUTED BY :

Panasonic

<http://security.panasonic.com>

<http://www.facebook.com/PanasonicNetworkCamera>

(2A-110BA)