

# HOW TO USE A GENERIC ADRENACLICK® AUTO-INJECTOR

## Call 911 immediately after using the Epinephrine Auto-Injector

The effects of the epinephrine auto-injector begin to wear off after 10–15 minutes. It is very important to call 911 or the emergency number in your area immediately after using the epinephrine auto-injector. Your child could have another reaction and needs to be observed in the emergency department for at least 4 hours. Bring the epinephrine auto-injector with you to the hospital or give to emergency personnel when they arrive to safely dispose of it.

### Steps to Using the Generic Adrenaclick® Auto-Injector



#### Step A

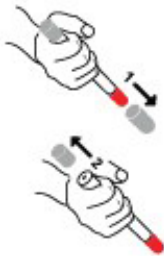

- Pull off **GRAY** end cap with the [1]; you will now see a **RED** tip. Never put thumb, finger, or hand over the **RED** tip.
- Pull off **GRAY** end cap with [2].

#### Step B



- Put the **RED** tip against the middle of the outer side of your thigh (upper leg) as shown. It can go through clothes.
- Press down hard until the needle enters your thigh (upper leg) through your skin. Hold it in place while slowly counting to 10.
- Remove the epinephrine auto-injector from your thigh.
- Check the **RED** tip. If the needle is exposed, you received the dose. If the needle is not visible, repeat Step B.

#### Step C



**Get emergency  
medial help right  
away: Call 911.**

- **Be prepared** to give a second dose of the epinephrine auto-injector if symptoms do not improve in 5 to 15 minutes.

This handout is for general information only. The information and above list are guidelines and do not include all symptoms. This document is not a substitute for being seen by a doctor. Always call your doctor if you have questions or seek emergency medical attention if necessary.

**Children's**  
HOSPITAL • ST. LOUIS  
BJC HealthCare

## When to Use Generic Adrenaclick®

The Generic Adrenaclick® auto-injector is an epinephrine shot used to treat severe allergic reactions (anaphylaxis). A severe allergic reaction can become fatal within minutes if untreated. Using epinephrine gives the life saving time needed to get further medical treatment.

### **SYMPTOMS OF ANAPHYLAXIS INCLUDE**

**Mouth:** Itchy, swelling of tongue and/or lips

**Throat:** Itchy, tightness/closure, hoarseness, trouble breathing/swallowing

**Skin:** Itchy, hives, redness, swelling, red watery eyes

**Gut:** Nausea, vomiting, cramps, diarrhea

**Lung:** Short of breath, wheeze, repetitive cough

**Heart:** Pale or blue skin color, dizzy/faint, weak pulse

**Neurological:** Sense of "impending doom," irritability, change in alertness, mood change, confusion

**Other:** Itchy, red, watery eyes

## Tips about Generic Adrenaclick®

- Comes in two strengths and are prescribed based on the individual weight.
- A Generic Adrenaclick® trainer is included in the box with the real Generic Adrenaclick®.
- The trainer does not have medicine or a needle.
- Use the trainer to practice steps of giving the injection.
- Store at room temperature.
  - Do not refrigerate.
  - Do not keep in a vehicle during hot or cold weather.
  - Do not expose to direct sunlight.
- Be sure the medicine is clear/colorless in the viewing window.
- Check the expiration date. If expired get a refill.

**Additional Information:**  
**[epinephrineautoinject.com](http://epinephrineautoinject.com)**

This handout is for general information only. The information and above list are guidelines and do not include all symptoms. This document is not a substitute for your child being seen by a doctor. Always call your doctor if you have questions or seek emergency medical attention if necessary.