

COMPLETE THIS SECTION FOR ALL SPILLS:

Date of Spill: 97/12/01 Date Found: 97/12/02 Date Reported: 97/12/03
 Area: Estevan 10 Pool: Quensdale EAST FROBISHER ALIDA BEDS
 Surface Land Location: LS 14 SC 12 TP 6 RG 1 W 2 Horizontal: Yes No
 Company: Talisman Energy Phone No: (306) 453-2545
 Reported By: Travis Doty Company Rep Landowner Other
 Substance Spilled: Oil Salt Water Emulsion Condensate Fresh Water
 Spill Source: Line Well Facility Misc
 Status of Line/Facility/Well: Active Suspended Abandoned
 Estimate of Fluid Spilled: 30.0 m³ Oil 2.0 m³ Water 28.0 m³ Condensate m³
 Estimate of Fluid Recovered: 6.0 m³ Oil 1.5 m³ Water 4.5 m³ Condensate m³
 Surface Feature Affected: (Choose up to 3)
 Cultivated Uncultivated Bush Surface Water Groundwater Access Other
 Size of Area Affected: (Fill in one) Square Meters 300 OR Hectares
 Total Area Affected: On Lease % Off Lease 100 %
 Landowner: Lionel Boutin Phone No: (306) 443-2381 Crown Land: Yes No
 Occupant: Same Phone No: ()
 Contacted by Company: Yes No Contacted by SEM: Yes No
 Comments: This incident resulted from a flowline failure
 Signature: [Signature] SEM - Regina SEM - Field ENV - Canada

COMPLETE THIS SECTION FOR LINE SPILLS:

Line Location: From Point: LX LS 14 SC 12 TP 6 RG 1 W 2
 To Point: LX LS 10 SC 12 TP 6 RG 1 W 2
 Break Location:
400 Meters, North South East West of, LS 14 SC 12 TP 6 RG 1 W 2
 Date Installed: OR Date Replaced: OR Date Upgraded:
 Type of Line: Flowline Transfer Inj/Disp Condensate
 Pipeline Fresh Water Produced Water
 Material: Steel Fiberglass Aluminum Lined (Date Lined:)
 Corrosion Protection: External Internal Cathodic
 Size: 76 mm Wall Thickness: 4.0 mm
 Cause: Corrosion Mechanical Failure Human Error Vandalism Test Failure
 NUMBER OF PREVIOUS LINE FAILURES 1

COMPLETE THIS SECTION FOR WELL SPILLS:

LX
 Well Type: Oil Gas Water Source Water Inj/Disp Steam Injector Other Injector
 Cause: Stuffing Box Valve Equipment Failure Storage Tank Human Error
 Vandalism Cattle Lightning Blowout

COMPLETE THIS SECTION FOR FACILITY SPILLS:

Facility Type: Battery Water Plant Satellite Compressor/Dehydrator
 Reclaimer Steam Boiler Pit
 Equipment Type: Treater Tank Separator Pumps
 Cause: Equipment Failure Corrosion Human Error Lightning Vandalism Fire

COMPLETE THIS SECTION FOR MISCELLANEOUS SPILLS:

Type: Truck Other - _____

Cause: Human Error Mechanical Error Road Conditions

COMPLETE THIS SECTION FOR CLEAN-UP:

Date Clean-up Started: 97/12/02 Initial Inspection Date: 97/12/03

Number of Subsequent Inspections: _____ Final Inspection Date: 98/07/07

Clean-up Condition: Satisfactory Unsatisfactory

Clean-up Procedures: Amendments Added Removal of Soil
Spread-on Lease Burning Nothing Required

Details of Clean-up: see below

Details of Repairs Conducted: line shut-in

Contaminated Material Moved to: NEWALTA 4m³ of oil

Contaminated Material Used for: _____

Type and Amount of Soil Amendment Added: 30 bags of Peat Moss
72kg of Calcium nitrate

DIAGRAM OF SPILL AREA:

NORTH

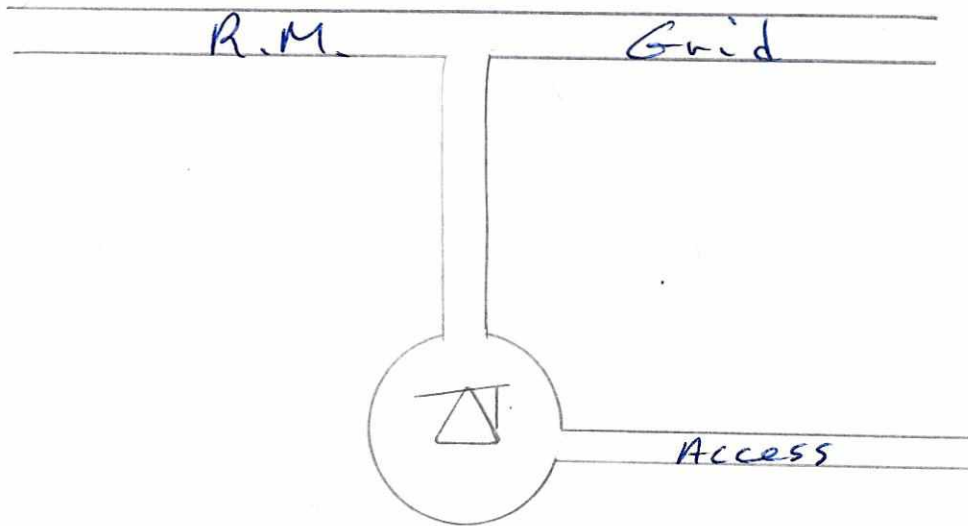

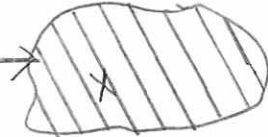
Affected area on seeded grassland 

Additional Comments: 97/12/03 All free standing fluid has been picked up! 4m³ bails of straw around perimeter
The line is shut in - has not yet been repaired.

There is oil staining on the surface and P.W.R. are responsible for soil reclamation

98/07/07/ ^{peat moss} ~~straw~~ has been applied - looks good
still shut-in.

400 669

COMPLETE THIS SECTION FOR ALL SPILLS:

Date of Spill: 97/12/01 Date Found: 97/12/02 Date Reported: 97/12/03

Area: Pool:

Surface Land Location: LS 14 SC 12 TP 6 RG 1 W 1 Horizontal: Yes No

Company: Talisman Energy Phone No: (306)453-2545

Reported By: Trevor Doty Company Rep X Landowner Other

Substance Spilled: Oil Salt Water Emulsion X Condensate Fresh Water

Spill Source: Line X Well Facility Misc

Status of Line/Facility/Well: Active X Suspended Abandoned

Estimate of Fluid Spilled: 30 m3 Oil 2 m3 Water 28 m3 Condensate m

Estimate of Fluid Recovered: 6 m3 Oil 15 m3 Water 4.5 m3 Condensate m

Surface Feature Affected: (Choose up to 3)

Cultivated X Uncultivated Bush Surface Water Groundwater Access Other

Size of Area Affected: (Fill in one) Square Meters 300 OR Hectares

Total Area Affected: On Lease % Off Lease 100%

Landowner: Lionel Boutin Phone No: (306)443-2381 Crown Land: Yes No X

Occupant: N/A Phone No: ()

Contacted by Company: Yes V No Contacted by SEM: Yes No X

Comments: Failed to SEM 97/12/03 8:30 A.M.

Signature: SEM - Regina SEM - Field ENV - Cana

of Previous Leaks 1

COMPLETE THIS SECTION FOR LINE SPILLS:

Line Location: From Point: LX # LS 14 SC 12 TP 6 RG 1 W 1

To Point: LX LS 10 SC 12 TP 6 RG 1 W 1

Break Location:

400 Meters, North South 200m East 200m West of, LS 14 SC 12 TP 6 RG 1 W 1

Date Installed: OR Date Replaced: OR Date Upgraded:

Type of Line: Flowline X Transfer Inj/Disp Condensate Pipeline Fresh Water Produced Water

Material: Steel X Fiberglass Aluminum Lined (Date Lined:)

Corrosion Protection: External Internal X Cathodic X

Size: 77 mm Wall Thickness: mm

Cause: Corrosion X Mechanical Failure Human Error Vandalism Test Failure

COMPLETE THIS SECTION FOR WELL SPILLS: LX

Well Type: Oil Gas Water Source Water Inj/Disp Steam Injector Other Injector

Cause: Stuffing Box Valve Equipment Failure Storage Tank Human Error Vandalism Cattle Lightning Blowout

COMPLETE THIS SECTION FOR FACILITY SPILLS:

Facility Type: Battery Water Plant Satellite Compressor/Dehydrator Reclaimer Steam Boiler Pit

Equipment Type: Treater Tank Separator Pumps

Cause: Equipment Failure Corrosion Human Error Lightning Vandalism Fire

COMPLETE THIS SECTION FOR MISCELLANEOUS SPILLS:

Type: Truck ___ Other ___ - _____
Cause: Human Error ___ Mechanical Error ___ Road Conditions ___

COMPLETE THIS SECTION FOR CLEAN-UP:

Date Clean-up Started: 97/12/02 Initial Inspection Date: 97/12/02

Number of Subsequent Inspections: _____ Final Inspection Date: _____

Clean-up Condition: Satisfactory ___ Unsatisfactory ___

Clean-up Procedures: Amendments Added ___ Removal of Soil ___
Spread-on Lease ___ Burning ___ Nothing Required ___

Details of Clean-up: Dec 2/97 had vacuum truck suck up any
free standing fluid and haul to Newalta.

Details of Repairs Conducted: _____

Contaminated Material Moved to: Newalta, Sk.

Contaminated Material Used for: Reclamation.

Type and Amount of Soil Amendment Added: _____

DIAGRAM OF SPILL AREA:

NORTH

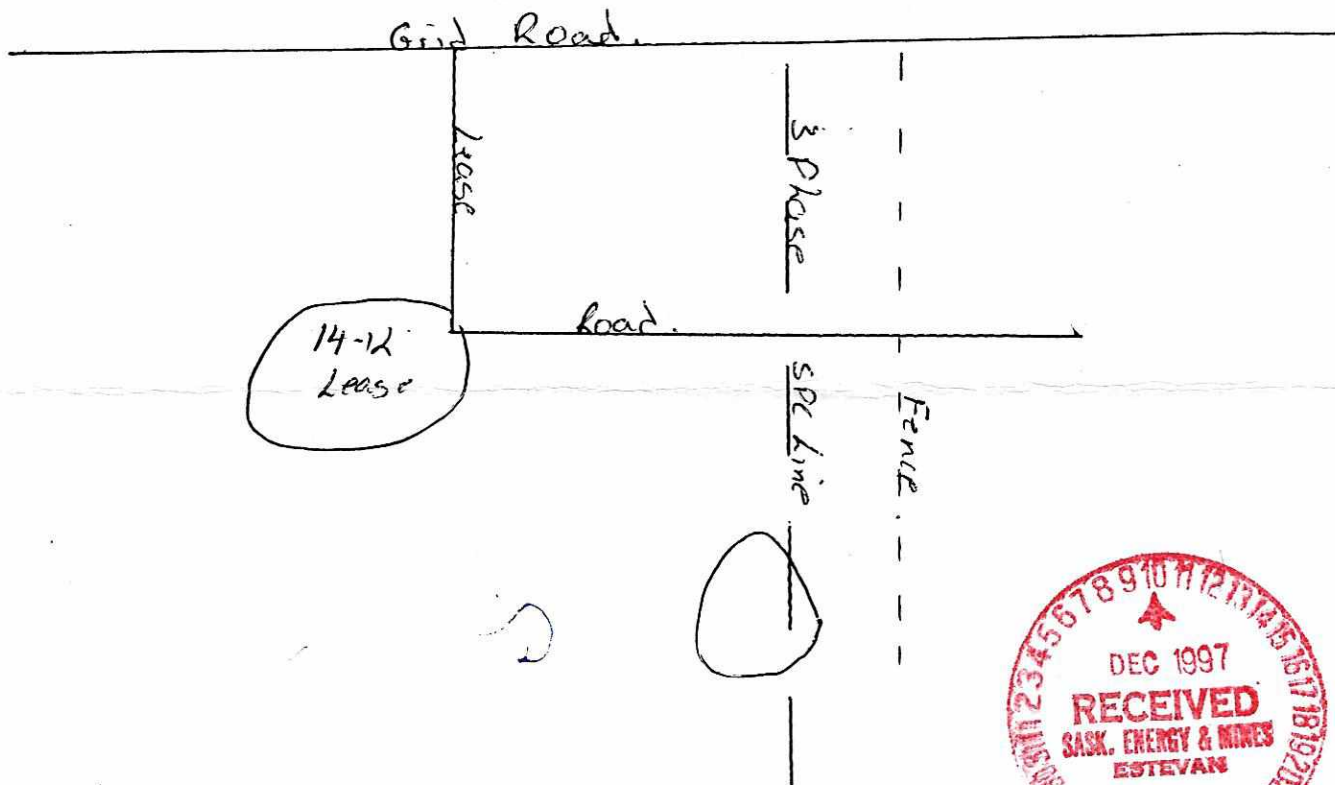

Additional Comments: _____

