

Educational Specifications

Prototype High School

January 2007

School Board Members

Mr. Frank H. Kovach, Chair
Dr. Kathy Kleinlein, Vice Chair
Dr. Carol Todd
Mrs. Caroline Zucker
Mrs. Shirley Brown

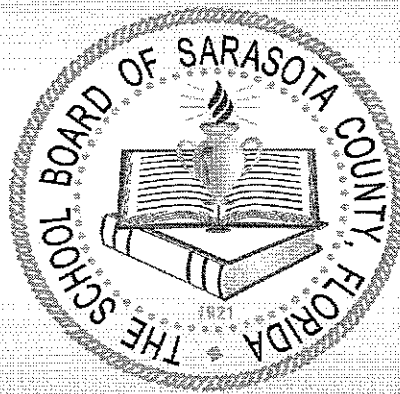

Dr. Gary Norris, Superintendent

District staff assisted by:



EDUCATIONAL SPECIFICATIONS

**School Board of Sarasota County
Prototype High School**

TABLE OF CONTENTS

INTRODUCTION.....	1
DESIGN CRITERIA.....	2
FACILITY LIST (SURVEY COMPLIANT).....	13
STANDARD CLASSROOMS.....	19
SCIENCE CLASSROOMS.....	23
J.R.O.T.C.	27
SKILLS DEVELOPMENT LABORATORY	31
RESOURCE ROOM.....	34
EXCEPTIONAL STUDENT EDUCATION.....	37
ART	41
BAND	45
VOCAL.....	49
ORCHESTRA.....	52
PIANO/KEYBOARD LABORATORY	55
PHYSICAL EDUCATION	58
CAREER AND TECHNICAL EDUCATION.....	62
MEDIA CENTER	67
ADMINISTRATION	71
FOOD SERVICE	76
AUDITORIUM/STAGE	79
CUSTODIAL	81

EDUCATIONAL SPECIFICATIONS

School Board of Sarasota County Prototype High School

INTRODUCTION

The Educational Specifications are intended to be used as a planning tool by architects and other professionals responsible for the development of the facility. The Educational Specifications provide general details for proposed spaces while leaving ample flexibility in design by the architect. Specific details are contained in standards that are updated, as needed, by Construction, Technology, Safety & Security, and other departments. Furniture, fixtures, and equipment lists are no longer in this document; FF&E items will appear in these Ed Specs only when the design needs to ensure that adequate space is provided.

The graphic representations of the space chart are intended to establish adjacencies and not to set design. Spaces shall be arranged for the various program areas in a configuration compatible with the overall traffic control and site needs of the school plant.

The Educational Specifications have been developed after several meetings with District Staff as well as school-based personnel. The specifications will result in facilities that are functional, energy efficient, safe, secure, technologically advanced and flexible in design. This high school specification ensures an academy model with limited access by the public.

This document provides an excellent prototype for Sarasota County School's future high schools and a means by which to determine the extent to which existing high schools are adequate. ~~This facility prototype may be enhanced~~ The district may depart from this prototype, at the recommendation of the Superintendent and approval by the School Board, to provide amenities which (a) meet the particular culture or programs reflective of specific school communities, (b) are clearly defined in the school's instructional delivery system, and (c) receive ~~the community's~~ community and/or outside financial support.

EDUCATIONAL SPECIFICATIONS

School Board of Sarasota County Prototype High School

DESIGN CRITERIA

The following general guidelines should be considered in plant design. Wherever individual sections refer to "standard," these overall considerations shall be the reference.

A. GENERAL

1. Codes - Applicable codes shall include, but not be limited to:
 - Florida Building Code with latest revisions,
 - State Requirements for Educational Facilities (S.R.E.F.),
 - The School District of Sarasota County standards and guidelines,
 - Florida Accessibility Code for Building Construction (F.A.C.B.C.) as referenced in Chapter 11 Florida Building Code.
 - American Disabilities Act

Any educational specifications contained herein that are in conflict with applicable codes shall be modified by mutual consent between the architect and the School District to the extent necessary to eliminate the conflict and comply with code requirements.

2. Security – The design shall use "safe school design" principles through the use of Crime Prevention Through Environmental Design (CPTED). CPTED design principals include natural surveillance of school grounds, access control and territoriality. CPTED design features include, but are not limited to, controlled access entrances, fencing, sufficient entrances and exits, signage and front desks having views of the entrance. The design shall be committed to maximum security from unauthorized or illegal entry during school hours and when the school is not in session. Internal security preventatives such as limited access, locked storage, proper lighting, etc., shall be considered. The exterior of the building shall not have "natural ladders", blind corners or areas where security would be difficult. Security systems as directed per contract documents.
3. Flexibility – Design consideration shall be given to flexibility to allow for future program changes, future additions and/or expansions of the school plant.
4. Safety - Provide safety devices in accordance with State and Federal requirements. Exits, exit lights, panic hardware, etc., shall be provided according to State and Federal requirements. Fire extinguishers and automatic extinguishing systems shall be placed as required.
5. Crowd Control – The design shall reflect manageable crowd control. Consideration should be given to the efficient movement of students between activities during school hours and after school.

EDUCATIONAL SPECIFICATIONS

School Board of Sarasota County Prototype High School

6. **Construction Techniques** – Design considerations shall be given to ensure rapid and economical construction but be consistent with the long-range maintenance and flexibility requirements of a permanent school plant. Standardized building components may be utilized.
7. **Economy** – All major alternatives shall be evaluated by standard life-cycle costing procedures. **First costs** (building construction, fees for architects/engineers and construction manager services, legal fees, interim financing and cost of the owner's staff), **operating costs** (operating personnel, energy, maintenance, repair, taxes and permanent financing) and **use costs** (salaries of workers, devices or equipment used and space adjustments) are to be considered.
8. **Instructional Technology** – Provisions shall be made for the immediate and future use of state of the art instructional technology, as well as networked informational and communication technology in all appropriate spaces.

B. **BUILDING COMPONENTS**

1. **Windows** – Windows shall be operable where appropriate and all window areas shall allow a high degree of efficiency in heating and cooling but shall not be so few as to require evacuation of the school plant in the event of a power failure or other failures of cooling equipment. All instructional areas shall have natural lighting. Control of natural light shall be provided for exterior windows, sufficient for room darkening required for audio-visual presentations. Additional measures such, as impact-resistant glass, vandal-resistant window treatments, etc. may be requested dependant on the project specific plan review process.
2. **Floors** – Floors shall have carpeting and VCT, unless otherwise specified. Any specified carpeting shall meet district-wide standards. Janitor closets, mechanical and electrical rooms shall be sealed concrete. All toilet rooms & showers shall be ceramic tile.
3. **Walls** – Group toilet rooms shall be ceramic tile from floor to ceiling. Service closets and individual toilet rooms shall have smooth impervious finish from floor to ceiling.
4. **Roof** - Roof pitch shall be adequate to ensure rapid runoff and shall conform to code. Storm water shall be collected and conveyed to storm water management system. No skylights will be utilized. Twenty year no dollar limit warranty roof shall be provided. Use of rooftop equipment shall be limited.

EDUCATIONAL SPECIFICATIONS

School Board of Sarasota County Prototype High School

5. **Ceilings** – Ceilings shall be 2' X 2' suspended standard fissured acoustical tile unless otherwise specified. Mechanical rooms shall have ceilings as required by code. Heights in all instructional spaces shall conform to district standards.
6. **Doors** – All interior doors, unless otherwise written, must provide a view panel in the door. All doors shall comply with School District standards.
7. **Canopies** – Provide extruded aluminum covered walkways to all instructional, support and ancillary spaces within the school plant.
8. **Corridors and Student Commons** - Corridor width shall comply with code. Doorstops and holders shall be overhead or wall-mounted with backing at the walls to reduce wall damage. Doors shall be recessed in walls.
9. **Restrooms** – Staff, Public and Student toilets shall be sufficient in number to provide required number of fixtures. Soap dispensers shall be liquid type provided and installed by the contractor. Paper towel dispenser shall be provided by owner and installed by contractor. Toilet paper dispensers shall be provided by owner and installed by the contractor. A full-length door mirror shall be provided in each restroom.
10. **Bulletin Boards** - In addition to any bulletin boards specified in departmental specifications, there shall be located in the corridors and/or student common area the following: (a) for general administrative, provide eight lineal feet; (b) for student activities, eight lineal feet; (c) for general faculty, eight lineal feet; (d) for interdepartmental use, eight lineal feet. Bulletin Boards shall be located in the hallways of the instructional areas between classrooms. Bulletin (tack) boards shall not be less than 36" vertical measurement.
11. **Custodial Service Closets** – Custodial service closets shall be provided in each wing, floor or major area of the school plant. It should contain a mop sink, shelving and a rack for storage of brooms and mops.
12. **Colors** - Harmonizing colors shall be used to enhance the design and construction of the plant as well as the learning environment. The architect shall submit colors for review and approval by the School District. Exterior materials and coatings shall be graffiti resistant and easily cleaned to the maximum extent practical. The architect shall submit finishing schedules and millwork for review and approval by the School District.
13. **Signs** – Room signs of appropriate size and construction shall be located near the door entrance. Signs shall be a minimum of 48" above finished

EDUCATIONAL SPECIFICATIONS

School Board of Sarasota County Prototype High School

floor and meet Florida Building Code Chapter 11 requirements, as well as the requirements for signage for the Florida Inventory of School Houses (FISH). A school sign of appropriate size and construction shall be located in a prominent location at or near the front of the school site.

14. **Flag Pole** – Locate a flagpole that is 30' high with two (2) complete rope systems near the front entrance of the school.
15. **Hurricane Hardening** – Comply with School District and County Emergency Management office requirements for provisions for emergency shelters.
16. **Display** – A built-in trophy case shall be located in the entrance foyer of the administration area and the lobby of the gymnasium.

C. BUILDING SYSTEMS

1. **Energy Conservation** – The building as well as all of its components shall conform in all respects to the current edition of the codes. Consideration should also be given to the use of potentially less expensive energy sources (e.g. solar) and available energy techniques and devices (e.g. heat recovery) where practical.
2. **Environmental Indoor Air Quality** - Air conditioning and heating shall be provided. Designer shall give consideration to pre-conditioning the outside make-up supply as a means for controlling humidity levels. Master controls shall be placed in suitable locations. The system selected shall provide a back up for circulation of fresh outside air in event of a breakdown to the cooling system and for use as the main system on mild days. The mechanical systems must be as simple as possible, for ease of maintenance and zoned to permit closing down of various areas of the building when they are not in use. Designer shall coordinate with District Maintenance Department to ensure system will interface with the District's climate control scheme and system.
3. **Lighting** – Lighting shall comply with District Standards.
4. **Electrical** – Lightning protection, power conditioning and surge protection, wire management, voice/video/data outlets, communication closets, grounding, low voltage systems and photo-voltaic to comply with code. Electrical outlets, disconnect switches and wiring shall be provided for all equipment furnished by contractor or the School District, including but not limited to, computers, printers, appliances, TV, all-in-one interactive board with projector, vending machines and electrical equipment throughout the school. Lockable, weatherproof, GFCI outlets shall be located every 150' lineal of exterior wall. Copper wiring shall be

EDUCATIONAL SPECIFICATIONS

School Board of Sarasota County

Prototype High School

used throughout. No aluminum wire shall be used at any point beyond the District side of the meter/main disconnect.

5. **Telephones**– The telephone system will be designed in accordance with School District standards. The system shall provide for incoming calls to be routed to a central office console with the ability for internal calls to be routed directly station to station. Telephone devices shall be provided to all instructional and administrative areas.
6. **CCTV Distribution** - Classrooms, instructional areas and other designated areas shall be equipped with closed circuit conduit, TV receivers or other multimedia devices, according to District Technology Standards.
7. **Intercommunications System** - There shall be a complete public address/bell signaling system that provides two-way communications between the administration offices and all occupied spaces, including exterior parking and playground/athletic areas. This system is to provide for distribution of announcements and signal tones to remote speakers using zone and emergency override paging. The system shall have the capacity to be operated by remote telephony device or manually at the main control unit. The intercommunication system shall include a port enabling access from the telephone system which shall be centrally located in the administrative area.
8. **Water Outlets** – Hose bibbs shall be located in each group to toilet rooms. Hose bibbs shall be provided on exterior wall or per current district requirements. Locate hose bibbs near air conditioning unit filters. Group toilet rooms shall have floor drains. Exterior hose bibbs to be in keyed, recessed boxes.
9. **Water Supply** – Water supply may be either from municipal or county system. Provide backflow preventor at main water supply.
10. **Sewage Disposal** – Sewage disposal shall be from a local utility company.
11. **Hot water** – Hot water shall be provided as indicated and per code.
12. **Computers, Voice/Data and Video** - All offices, classrooms and instructional spaces shall be wired per School District standards, forming a campus-wide network. All conduits, wiring and termination systems shall be provided to form a complete premise distribution system. The specifications for cabling, terminations and installations are provided separately by School District. Space requirements for communications wiring closets are detailed in the School District specifications.

EDUCATIONAL SPECIFICATIONS

School Board of Sarasota County

Prototype High School

Classrooms and instructional spaces shall have electrical receptacle located adjacent to each voice/data outlet.

Provide computer quantities and configuration per School District standards. Each classroom shall have data ports and electrical power for docking and charging of wireless laptop carts. Sufficient electrical outlets shall be provided for the charging of laptops when needed at convenient location to student desks. Electrical and cabling should be installed for future audio sound enhancement field.

- 13. Intrusion Detection system** – Provide intrusion detection system as directed by School District.
- 14. General Maintenance Considerations** – Design considerations shall be given to space requirements for maintaining all items of fixed equipment such as boilers, air conditioners, etc. including sufficient storage for standardized equipment. Design shall provide for ease of access and minimal maintenance.
- 15. Exterior Building Materials** - Major exterior building materials shall be fully documented in the design phase of project development for review and approval by the School District. Exterior materials and coatings shall be graffiti resistant and easily cleaned to the maximum extent possible.
- 16. Site Fire Protection** - Provide fire hydrants as recommended by the appropriate local fire protection agency and NFPA. Fire alarm system shall be provided in accordance with the codes.
- 17. Water Coolers** – Electrically-cooled water fountains shall be provided at convenient places, recessed in walls, except those for the handicapped.
- 18. Clocks** -- a master clock system shall be located in the administrative area with synchronized clocks in all instructional, administrative, and common areas.
- 19. Two-Way Radios** –Two (2) UHF repeaters designated in accordance with district standards shall be located in the main administrative office area for use with the campus two-way portable radios. The repeaters shall be cabled to antennas mounted on the exterior of the building at the maximum height feasible. One 800-MHz console radio designated in accordance with district standards shall be located in the main administrative office area for public safety and radio interoperability, and shall be cables to an antenna mounted on the exterior of the building at the maximum height feasible.

EDUCATIONAL SPECIFICATIONS

School Board of Sarasota County Prototype High School

20. **CCTV Studio** - a TV distribution studio shall be provided meeting approved district standards.
21. **ITV** -- ITFS equipment shall be provided enabling the reception of instructional television programming. The equipment shall be cabled to the building exterior at a height providing an unobstructed line of sight to the applicable broadcast tower.
22. **Fire Alarm System** -- Provide a fire alarm system according to district standards.
23. **Public Address System** -- Provide public address system as directed by school district.
24. **Media Distribution** -- Provide CCTV distribution system as directed by the district.
25. **Cafeteria Sound System** -- Provide cafeteria sound system as directed by the district.
26. **Food Service Receiving Entry** -- Provide a two-way communication device as directed by the district.
27. **Stage Systems** -- provide lighting, sound, projection, CCTV, rigging, and intercommunications systems according to district standards.

D. SITE DEVELOPMENT

1. **Site Circulation** - A comprehensive site circulation plan shall be developed that provides maximum separation of pedestrian/bicycle circulation from bus/automobile circulation. Coordination with local jurisdictions shall be required in developing and planning access to and on the site for pedestrians, bicycles and vehicular traffic.
2. **Crowd Control** -- The design shall reflect manageable crowd control. Considerations should be given to large groups that enter and exit the site at time of public and school events.
3. **Parking** - Parking per State Requirements for Educational Facilities (S.R.E.F.) shall be provided for staff and visitors. Accessible handicap parking stalls shall be provided at a ratio of two percent [2%] of total parking, per SREF. Visitor parking shall be provided near the entrance to the administrative suite. Student parking shall be provided for fifty percent [50%] of the total juniors and seniors. Signage shall be provided to facilitate efficient pedestrian and vehicular circulation throughout the

EDUCATIONAL SPECIFICATIONS

School Board of Sarasota County Prototype High School

site. Adequate directional signage shall be provided to direct visitors to non-school functions. Parking shall be illuminated for night use.

Adequate loading and unloading areas should be provided for school buses. Adequate standards for bus turning and parking should be utilized in the design. Bus loading area shall be separated from parking areas, parent pick-up and all delivery areas, food services loading areas, parking areas and pedestrian/bicycle accesses. Covered area in close proximity to building should be provided for inclement weather.

Service and delivery areas shall be separated from bus loading areas and shall be screened from public areas. Adequate standards for turning and parking shall be utilized. Loading docks at service areas and service drives shall be designed to accommodate semi-tractor trailer trucks including adequate turn-around provisions.

4. **Site Utilization** – Buildings, driveways, parking and storm water management areas shall be designed so as to allow maximum use of the site.
5. **Building Orientation** – Buildings shall be oriented to take advantage of natural light and minimize solar heat gain.
6. **Storm Water Drainage** - Systems shall be designed in accordance with code.
7. **Pavement, Site Improvements** - Provide all pavement typical sections, access routings, sidewalks, traffic and pedestrian controls, signing and pavement markings layout, sports facilities, as identified elsewhere in this section, and other site improvements.
8. **Landscape Plan** – A landscape plan shall contribute to the development of the educational complex. Landscaping shall be based on surveys of existing plants on the site and a palette of species of plants native to the vicinity. Xeriscape design principles shall be incorporated in the landscape plan. Plantings shall be site specific with special consideration given to minimizing supplemental irrigation systems, energy efficiency and maintainability of the designed vegetation systems, from installation to maturity. Supplemental irrigation systems to be used shall provide for total coverage of landscape areas. Where practical, minimum plant sizes and maximum spacing shall be used. Landscaping shall be in compliance with State Requirements for Educational Facilities (S.R.E.F.).
9. **Irrigation Water** - Provide irrigation water system from a wet retention area or well as directed by School District. Provide a rust inhibitor

EDUCATIONAL SPECIFICATIONS

School Board of Sarasota County Prototype High School

system to prevent staining of buildings and sidewalls. If available, the campus should utilize reclaimed water for irrigation.

- 10. Security** – Meet with SBSC Building Department and the Department of Safety and Security at the first stage, site and building layout development, to discuss project specific security issues. The design shall use “safe school design” principles through the use of Crime Prevention Through Environmental Design (CPTED). Provide multiple exits from assembly areas to allow for expedient dispersal of crowds. Exit routes shall be convenient so that all exits will be used. Exits should be designed to avoid where evacuated students would be trapped in dead-end areas.

The areas of loading/unloading of students shall be designed to provide easy supervisions and to ensure no mixing of pedestrians and vehicles.

Visitor parking shall be provided near the entrance to the administrative suite. Parking lots should have more than one access. Parking lots shall have good natural surveillance following CPTED principles. The facility lot shall be fences locked and secured during the day if local conditions necessitate.

The access to the site shall consist of a primary road and a secondary access in the event the primary access is blocked. Ability for emergency vehicles to gain access to all of the facility shall be established through the use of stabilized surfaces at least 20' wide.

School sites shall have perimeter security fencing which shall be vinyl coated and six (6) foot minimum height, preventing access to walkways and courtyards when the facility is not occupied but allow for public access to exterior athletic facilities. Fencing around tennis, basketball courts can be galvanized fencing. Landscaping to include plantings meeting CPTED Principles and may include a berm with plantings and the fence setback and shall be aesthetically pleasing to the public. The exterior doors shall be designed to prevent unauthorized entry by minimizing key locks and associated hardware which would not be used for the purpose of essential entry but are installed for emergency egress (Panic Door Hardware).

Doors which are determined to be essential for entry shall be provided with key access as well as card access and have the capabilities to incorporate Biometric reader control and hardware.

The delivery/receiving service entry gate(s) shall have electric latching/locking hardware to allow control from either a card access or biometric reader. The gates shall be swing style.

EDUCATIONAL SPECIFICATIONS

School Board of Sarasota County

Prototype High School

An interior perimeter shall be created that will block the public access to open areas for students and staff as well as access to the thoroughfares, courtyard areas, between buildings, portables, classrooms, PE fields and any other common area without first going through a controlled main public entry, the focal point of the entrance. The main public entry shall consist of structurally mounted set of metal doors that are also an integral part of the interior perimeter. The courtyard egress shall be done using ornamental gating with doors located in thoroughfare between the visitor parking areas and the reception area in the administrative complex. At the public entry area provide for card access, video surveillance, remote intercom, electric controlled lock hardware as per current policy of SDSC, guidelines, and project specific plan review process. The same structurally mounted metal entry doors shall be placed at the egress areas through the interior perimeter barrier. No decorative or chain link fence gates should be used.

Restrooms when appropriate such as in the gymnasium and cafeteria shall use a maze-type entry system. The exterior area entry points shall not have any maze type of entry.

The bicycle storage area shall be enclosed with a 6' high fence with good natural surveillance and visibility from either a classroom or the main office. Racks to allow the bicycles to be secured to shall be provided. The storage area should be visible on surveillance cameras.

Courtyards shall be designed to allow for groups of students to congregate but not allow for large groups to gather impeding natural surveillance and traffic flow. Planters and benches shall be constructed to allow natural surveillance. The courtyard design shall create a smooth flow of traffic. The landscaping shall follow the CPTED principles. The tree canopies shall not be lower than 7' and not be able to grow to block the use of surveillance cameras, lighting and impede the ability of natural surveillance. Bushes shall not grow higher than 3', so as not to provide areas for hiding. The planters and tree heights shall also be limited when planted in the thoroughfares, common areas, bike and parking lots, courtyards and portables. The entry and exit areas throughout the interior and perimeter area shall be free of any landscaping and the perimeter control shall be done with ornamental gating and doors.

Teacher planning areas should be spread out throughout the campus where additional supervision of problem areas can be provided. The ideal locations for the teacher planning areas are at the ends of hallways and/or the center of the hallways.

EDUCATIONAL SPECIFICATIONS

School Board of Sarasota County Prototype High School

Lighting shall be established in zones to allow for security during nighttime activities. In isolated areas the use of motion detectors can be utilized. Lighting needs to be provided for the 24 hour video surveillance cameras.

Roof shall be designed so there are no obstructions and no availability for access from stairways. Any roof access shall be able to be properly secured and locked.

Video Surveillance cameras and equipment shall be the appropriate amount for the site and placed to provide the best coverage of the campus.

Provide two (2) KNOX BOXES for emergency key access. One (1) recessed box keyed to the local fire jurisdiction shall be installed at the main entrance, and the second Knox Box cabinet keyed to the local fire jurisdiction and school district security department installed at a location directed by the district. Each Knox Box unit shall be wired to the security intrusion system.

11. Backflow preventors and other elements of similar character shall be sited away from school entrance and sufficiently screened such that they are not readily visible from public areas, either off or on site, yet the screening does not hinder access for maintenance or impair any requirement for visibility.
12. Adequate buffers shall be provided between the school and neighboring areas.
13. Provide stubbed out services at the edge of area planned for future portable classrooms.
14. Driveways (entrance/exit) should have lockable gates.

E. Miscellaneous

1. All classrooms to have holder for American Flag (provided by contractor).

EDUCATIONAL SPECIFICATIONS

School Board of Sarasota County Prototype High School

FACILITY LIST (Survey Compliant)

District:		Sarasota		Total Stations	2,914	Gross Sq Ft:	427,023
Level:		High 9-12		Student Capacity	2,622	Utilization:	95%
100	Acres Required			NET SQUARE FEET	DESIGN	TOTAL	
NO.	FISH					CAPACITY	STATIONS
SPACES	CODE		DESCRIPTION	UNIT	TOTAL	PER UNIT	UTILIZED
			GRAND TOTALS		300,636		2,949
			STANDARD CLASSROOMS				
40	003	9-12	Senior High Classroom	800	32,000	25	1,000
	808		Storage, Material	100	4,000		
			Subtotal	900	36,000		
1	704	K-12	Detention Classroom	600	600	20	20
	808		Storage, Material	100	100		
	815		Toilet, Student-Male	60	60		
	816		Toilet, Student-Female	60	60		
			Subtotal	820	820		
			SKILLS DEVELOPMENT LAB				
22	012	9-12	Senior High Skills Labs	800	17,600	25	550
	808		Storage, Student	100	2,200		
			Subtotal	900	19,900		
			SCIENCE				
22	023	9-12	Senior High Sci Lab	1,275	28,050	25	500
	808		Storage, Material	100	2,200		
	812		Storage, Project	150	3,300		
			Subtotal	1,525	33,550		
			R.O.T.C.				
1	708	9-12	J.R.O.T.C. Classroom	1,050	1,050	25	25
	800		Arms Room	150	150		
	802		Conference	225	225		
	808		Storage, Material	155	155		
			Subtotal	1,580	1,580		
			RESOURCE - REGULAR				
7	040	PK-12	Resource Room	290	2,030	10	
	808		Storage, Material	100	700		
			Subtotal	390	2,730		
			EXCEPTIONAL EDUCATION				
6	061	PK-12	ESE Part-time	975	5,850	15	90
	808		Storage, Material	100	600		
	813		Storage, Student	40	200		
	815		Toilet, Student-Male	0	0		
	816		Toilet, Student-Female	0	0		
			Subtotal	1,115	6,650		

EDUCATIONAL SPECIFICATIONS

School Board of Sarasota County Prototype High School

District:		Sarasota		Total Stations	2,914	Gross Sq Ft:	427,023
Level:		High 9-12		Student Capacity	2,622	Utilization:	95%
100 Acres Required				NET SQUARE FEET	DESIGN	TOTAL	
NO.	FISH					CAPACITY	STATIONS
SPACES	CODE		DESCRIPTION	UNIT	TOTAL	PER UNIT	UTILIZED
3	062	PK-12	ESE Full-time	950	2,850	10	30
	808		Storage, Material	100	300		
	813		Storage, Student	40	120		
	817		RR and Bath, Student	110	330		
			Subtotal	1,200	3,600		
1	063	N-12	ESE Vocational	1,140	1,140	12	12
	808		Storage, Student	100	100		
	815		Toilet, Student-Male	60	60		
	816		Toilet, Student-Female	60	60		
			Subtotal	1,360	1,360		
1	064	N-PK	ESE PT/OT	475	475	5	0
	808		Storage, Material	100	100		
	813		Storage, Student	40	40		
	817		RR and Bath, Student	110	110		
			Subtotal	725	725		
6	065	PK-12	ESE Resource Room	380	2,280	4	0
	808		Storage, Material	100	600		
	813		Storage, Student	40	240		
			Subtotal	520	3,120		
0	066	PK-12	Supplementary Instruction	100	0	2	0
	808		Storage, Material	100	0		
			Subtotal	200	0		
			ART				
2	052	6-8	Senior High	1,484	2,968	28	84
1	803		Darkroom	100	100		
	805		Kiln	60	120		
2	808		Storage, Material	100	200		
2	812		Storage, Project	150	300		
			Subtotal	1,894	3,788		
			MUSIC				
1	076	6-12	Band Classroom	2,000	2,000	50	50
	806		Reference	100	100		
	808		Storage, Material	100	100		
	830		Ensemble	300	300		
	831		Practice Room(s)	70	140		
	832		Storage, Instrument	600	600		
	834		Uniform	300	300		
	835		Studio	180	180		
			Subtotal	3,650	3,720		
1	075	6-12	Vocal Classroom	1,425	1,425	25	25
	806		Reference	100	100		
	808		Storage, Material	100	100		

EDUCATIONAL SPECIFICATIONS

School Board of Sarasota County Prototype High School

District:		Sarasota		Total Stations	2,914	Gross Sq Ft:	427,023
Level:	High 9-12		Student Capacity	2,622	Utilization:	95%	
100	Acres Required		NET SQUARE FEET	DESIGN	TOTAL		
NO.	FISH					CAPACITY	STATIONS
SPACES	CODE		DESCRIPTION	UNIT	TOTAL	PER UNIT	UTILIZED
	830		Ensemble	300	300		
	831		Practice Room(s)	70	70		
	833		Robe	150	150		
			Subtotal	2,145	2,145		
1	077	6-12	Orchestra Classroom	1,596	1,596	28	28
	806		Reference	100	100		
	808		Storage, Material	100	100		
	830		Ensemble	300	300		
	831		Practice Room(s)	70	70		
	832		Storage, Instrument	600	600		
			Subtotal	2,766	2,766		
1	080	6-12	Piano Laboratory	925	925	25	25
	808		Storage, Material	100	100		
			Subtotal	1,025	1,025		
			PHYSICAL EDUCATION				
1	112	9-12	Gymnasium Floor	6,500	6,500	160	160
	090/091	6-12	Dressing Room	1,681	3,362		
	092/093		Lockers	280	560		
	094/095		Showers	280	560		
	815/816		Restroom	280	560		
	096/097		Drying Area	280	560		
	099/100		Teacher Toilet/Shower	66	132		
	098		PE Storage	1,261	1,261		
	113		Gym Seating	8,966	8,966		
	114		Laundry/towel	280	280		
	115		First Aid	280	280		
1	116		Training Room & whirlpool	250	250		
1	117		Weight Room	1,000	1,000		
1	118		Wrestling Room	1,680	1,680		
1	119		Gymnastics & Dance	1,050	1,050		
	120		Gym. Storage	420	420		
	370		Lobby	1,401	1,401		
	371		Concessions	200	200		
	372		Ticket Booth	30	30		
	822/823		Public Toilets	280	560		
			Subtotal	26,465	29,612		
			CAREER TECHNICAL EDUCATION				
			BUSINESS EDUCATION				
3	212	9-PS	Education Lab	1,460	4,380	20	60
	808		Storage, Material	100	300		
	812		Storage, Project	150	450		
			Subtotal	1,710	5,130		

EDUCATIONAL SPECIFICATIONS

School Board of Sarasota County Prototype High School

District:		Sarasota		Total Stations	2,914	Gross Sq Ft:	427,023
Level:		High 9-12		Student Capacity	2,622	Utilization:	95%
100	Acres Required			NET SQUARE FEET	DESIGN	TOTAL	
NO.	FISH					CAPACITY	STATIONS
SPACES	CODE		DESCRIPTION	UNIT	TOTAL	PER UNIT	UTILIZED
FAMILY & CONSUMER SCIENCE							
1	233	9-PS	Medium Education Lab	1,380	1,380	20	20
	808		Storage, Material	100	100		
	842		Kitchen	125	125		
	843		Laundry	50	50		
	852		Technology Resource	800	800		
			Subtotal	2,455	2,455		
2	234	9-PS	Large Education Lab	2,125	4,250	20	40
	812		Storage, Project	150	300		
	813		Student Storage	40	80		
	842		Kitchen	125	250		
	843		Laundry	50	100		
	852		Technology Resource	800	1,600		
			Subtotal	2,865	6,580		
TECHNOLOGY EDUCATION							
3	241	9-12	Small Education Lab	1,625	4,875	25	75
3	808		Storage, Material	100	300		
3	852		Technology Resource	800	2,400		
			Subtotal	2,525	7,575		
2	242	9-12	Medium Education Lab	2,375	4,750	25	50
2	810		Storage, Material	395	790		
2	852		Technology Resource	800	1,600		
			Subtotal	3,570	7,140		
2	243	9-12	Large Education Lab	3,375	6,750	25	50
2	808		Storage, Material	100	200		
2	810		Storage, Material	395	790		
2	849		Storage, Project	310	620		
2	851		Storage, Tool	310	620		
2	852		Technology Resource	800	1,600		
			Subtotal	5,290	10,580		
HEALTH OCCUPATIONS EDUCATION							
2	252	9-PS	Small Education Lab	1,200	2,400	20	20
	804		Dispensary	135	270		
	808		Storage, Material	100	200		
	812		Storage, Project	150	300		
	840		Classroom Related	675	1,350		
			Subtotal	2,260	4,520		

EDUCATIONAL SPECIFICATIONS

School Board of Sarasota County Prototype High School

District:		Sarasota		Total Stations		2,914	Gross Sq Ft:		427,023
Level:		High 9-12		Student Capacity		2,622	Utilization:		95%
100		Acres Required		NET SQUARE FEET		DESIGN		TOTAL	
NO.	FISH							CAPACITY	STATIONS
SPACES	CODE	DESCRIPTION		UNIT		TOTAL		PER UNIT	UTILIZED
MEDIA CENTER									
1	380	P-PS	Reading Room/Stacks	10,367	10,367				
	381	P-PS	Technical Processing	1,121	1,121				
	382	P-PS	Prod. Professional Lib.	1,121	1,121				
	383	P-PS	A-V Storage	1,681	1,681				
	384	P-PS	Periodical Storage	560	560				
	385	P-PS	C.C. Television	1,961	1,961				
	386	P-PS	C.C.T.V. Storage	1,401	1,401				
	387	P-PS	Media Production Lab	1,401	1,401				
	388	P-PS	Copying Room	560	560				
	389	P-PS	Small Group Listening	280	280				
	390	P-PS	Group Projects	1,401	1,401				
	391	P-PS	Maintenance Repair	280	280				
			Subtotal	22,134	22,134				
ADMINISTRATION									
1	300	N-PS	Principal's/Dir Office	250	250				
16	301	N-PS	Asst Prin/Other Office	175	2,800				
3	302	N-PS	Bookkeeping Office	125	375				
4	303	N-PS	Secretarial Space	158	632				
	304	N-PS	Admin. Reception	2,382	2,382				
	305	N-PS	Production/Workroom	1,121	1,121				
	306	N-PS	Conference Rooms	1,961	1,961				
	307	N-PS	Clinic	841	841				
	308	N-PS	Admin. Storage	1,401	1,401				
	309	N-PS	Records/Vault	841	841				
	310	N-PS	School Store	280	280				
	311	N-PS	Student Activities Area	1,401	1,401				
	312	N-PS	Computer Area	420	420				
	313	N-PS	Careers Room	841	841				
8	314	N-PS	Itinerant Office	125	1,000				
	315	N-PS	Teacher Planning Area	5,604	5,604				
	316	N-PS	Teacher Lounge/Dining	1,121	1,121				
	819-821	P-PS	Toilets, Staff (M & F)	560	1,120				
			Subtotal	19,607	24,391				
FOOD SERVICE									
1	340	N-PS	Dining	11,208	11,208				
	341	N-PS	Kitchen	12,329	12,329				
	349	N-PS	Chair Storage	560	560				
	351	N-PS	Covered Patio	10,087	10,087				
			Subtotal	34,184	34,184				
AUDITORIUM									
1	360	6-PS	Auditorium Seating	8,406	8,406				
	370	6-PS	Lobby	1,401	1,401				
	371	6-PS	Concessions	200	200				
	372	6-PS	Ticket Booth	30	30				
			Subtotal	10,037	10,037				

EDUCATIONAL SPECIFICATIONS

School Board of Sarasota County

Prototype High School

District:		Sarasota		Total Stations	2,914	Gross Sq Ft:	427,023
Level:		High 9-12		Student Capacity	2,622	Utilization:	95%
100		Acres Required		NET SQUARE FEET	DESIGN	TOTAL	
NO.	FISH					CAPACITY	STATIONS
SPACES	CODE		DESCRIPTION	UNIT	TOTAL	PER UNIT	UTILIZED
			STAGE				
1	363	N-PS	Stage	990	990		
	364	N-PS	Storage	1,401	1,401		
	365/366	N-PS	Dressing (M & F)	1,401	1,401		
	367	N-PS	Control Booth	100	100		
			Subtotal	3,892	3,892		
			OTHER SPACES				
1	368	N-PS	Textbook Storage	981	981		
	815/816		Student Toilet	2,102	4,204		
	822/823		Public Toilets	280	560		
			Subtotal	3,363	5,745		
			CUSTODIAL				
1	330	N-PS	Custodial Receiving	4,203	4,203		
1	333	N-PS	Flammable Storage	155	155		
	334	N-PS	Equipment Storage	500	500		
			Subtotal	4,858	4,858		

EDUCATIONAL SPECIFICATIONS

School Board of Sarasota County
Prototype High School

STANDARD CLASSROOMS

I. OBJECTIVES/GOALS

The high school experience will provide diverse opportunities in a structured learning environment. The program goals would include socialization, decision-making process, citizenship and knowledge acquisition.

II. ACTIVITIES/ENROLLMENT

Through the arrangement of furniture, materials and supplies, a learning laboratory will be created for students to be in large group instruction, small group instruction, and individual instruction. This arrangement will provide an environment that will be physically, mentally and socially conducive to learning.

Teacher-Student Ratio: 1:25

Grade level for which program is intended: 9-12

III. PROGRAM SPACES

NO.	FISH			NET SQUARE FEET		DESIGN	TOTAL
	SPACES	CODE	DESCRIPTION	UNIT	TOTAL	CAPACITY	STATIONS
40	003	9-12	Senior High Classroom	800	32,000	25	1000
	808		Storage, Material	100	4,000		
			Subtotal	900	36,000		

EDUCATIONAL SPECIFICATIONS

School Board of Sarasota County Prototype High School

IV. SPECIAL CONSIDERATIONS

- A. Heating/Cooling/Ventilation – Standard. Each space, as per district policy, will be centrally controlled by an energy management system.
- B. Acoustical – Standard acoustical treatment will be provided throughout.
- C. Floor – Provide resilient flooring in each classroom. Flooring to include raised floor for future networking purposes.
- D. Walls – Shall meet District Standards.
- E. Ceiling – The ceiling height will be a minimum of 9' with acoustical tile panels.
- F. Lighting – Provide energy efficient fluorescent lighting with the capability of separate switching of rows of light parallel to the teaching wall.
- G. Windows – Standard. The windows will be operable to allow natural ventilation and/or when required by code. Window treatments will be provided for all exterior windows in order to darken rooms for instructional purposes.
- H. Doors – Standard. Exterior doors will be hollow metal with window(s). Doors opening to the outside of the building will also be protected by a security system. Interior doors, except for restrooms, will have window(s).
- I. Water/Plumbing Fixtures - Shall meet District Standards. One classroom to be used for drama instruction shall be in close proximity to water fountain (bubbler.)
- J. Communications – Shall meet District Standards.
- K. Electrical – Shall meet District Standards. Provide outlets for computers, printers and other equipment.
- L. Gas and Air - N/A.
- M. Safety – Shall meet District Standards.
- N. Fencing – N/A.
- O. Service Drives – N/A.
- P. Parking – N/A.

EDUCATIONAL SPECIFICATIONS

School Board of Sarasota County Prototype High School

Q. Built-ins

1. Counters and Cabinet/Shelving
 - a. Bookcase with adjustable shelving, 48"x12"x72"
 - b. Storage Cabinet, 48"x30"x72"
 - c. Provide 90" x 24" base cabinetry and upper cabinets
2. Instructional Aids
 - a. Interactive board with projector
 - b. Marker board with map rails, 48"x48" (4)
 - c. Tack board, 48" x 48" (3)

- R. Other Considerations - Design of classroom shall allow for a space to "park" rolling back packs, bookcases, and/or wireless laptop carts where appropriate.

Classrooms shall be arranged as "career academies" with core subjects and ESE interspersed. Shared teacher planning and storage shall be placed in each academy.

One classroom shall be located in close proximity to art, music, and the auditorium and in order to efficiently delivery drama instruction.

- S. Next Generation Technologies – Design to include equipping each classroom with the following Next Generation Technologies
- Interactive board with short throw projector mounted at front instructional area per district specifications
 - CCTV channel changer device per district specifications
 - Enhancement sound system with four to six speaker installation per district specifications. All media audio (voice, computer, CCTV) will be channeled through audio system.
 - Docucam system integrated into video projection screen.
 - Student access to computers will be per district standards.

EDUCATIONAL SPECIFICATIONS

School Board of Sarasota County

Prototype High School

V. SPATIAL RELATIONSHIPS

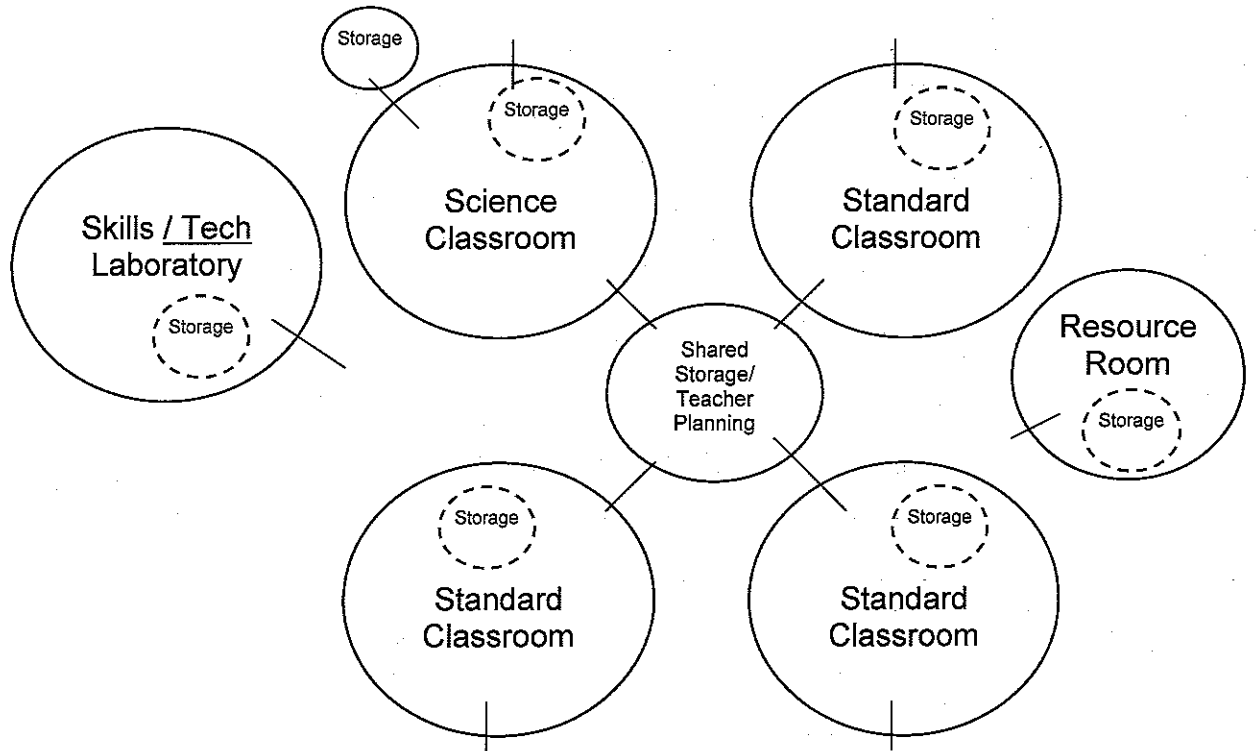

Not all classrooms are shown

EDUCATIONAL SPECIFICATIONS

School Board of Sarasota County
 Prototype High School

SCIENCE CLASSROOMS

I. OBJECTIVES/GOALS

The objectives of the science program is to provide experience which help students gather information, analyze information, think critically, be creative in their approach to problem solving, develop a knowledge of generalizations in science and develop skills used in a scientific approach. These objectives are achieved by a carefully integrated use of laboratory activities, challenging mental activities, use of resources and authentic assessments.

II. ACTIVITIES/ENROLLMENT

During science, students will be engaged in lectures, demonstrations, laboratory activities, computer analysis of data, multimedia and independent research. Students will use the scientific laboratory apparatus in all science courses with short and long-range activities. Students will be able to do laboratory work independently as wells in groups of two or more.

Teacher-Student Ratio: 1:25

Grade level for which program is intended: 9-12

III. PROGRAM SPACES

NO.	FISH	CODE	DESCRIPTION	NET SQUARE FEET		DESIGN	TOTAL
				UNIT	TOTAL	CAPACITY	STATIONS
SPACES						PER UNIT	UTILIZED
22	023	9-12	Senior High Sci Lab	1,275	28,050	25	500
	808		Storage, Material	100	2,200		
	812		Storage, Project	150	3,300		
			Subtotal	1,525	33,550		

EDUCATIONAL SPECIFICATIONS

School Board of Sarasota County Prototype High School

IV. SPECIAL CONSIDERATIONS

- A. **Heating/Cooling/Ventilation** – Standard. Each space, as per district policy, will be centrally controlled by an energy management system. Provided necessary ventilation for the permanent fume hoods.
- B. **Acoustical** – Standard acoustical treatment will be provided throughout.
- C. **Floor** – Provide resilient flooring in each classroom. Flooring to include raised floor for future networking purposes.
- D. **Walls** – Shall meet District Standards.
- E. **Ceiling** – The ceiling height will be a minimum of 9' with acoustical tile panels.
- F. **Lighting** – Provide energy efficient fluorescent lighting with the capability of separate switching of rows of light parallel to the teaching wall.
- G. **Windows** – Standard. The windows will be operable to allow natural ventilation and/or when required by code. Window treatments will be provided for all exterior windows in order to darken rooms for instructional purposes.
- H. **Doors** – Standard. Exterior doors will be hollow metal with window(s). Doors opening to the outside of the building will also be protected by a security system. Interior doors, except for restrooms, will have window(s).
- I. **Water/Plumbing Fixtures** - Provide water to sinks in the lab tables, teacher demonstration tables and storage rooms. Provide safety shower in laboratories with floor sloped to drain. Provide master shut off and located in a secure area.
- J. **Communications** – Shall meet District Standards.
- K. **Electrical** – Shall meet District Standards. Provide outlets for computers, laptop cart, printers and other equipment.
- L. **Gas and Air** - Provide gas and air at the lab tables and teacher demonstration tables. Provide master shut off and located in a secure area.
- M. **Safety** – Shall meet District Standards.
- N. **Fencing** – N/A.

EDUCATIONAL SPECIFICATIONS

School Board of Sarasota County

Prototype High School

O. Service Drives – N/A.

P. Parking – N/A.

Q. Built-ins

1. Counters and Cabinet/Shelving

- a. Bookcase with adjustable shelving, 48"x12"x72"
- b. Storage Cabinet, 48"x30"x72"
- c. Provide specialized science upper and lower cabinetry with deep sinks and chemical resistant countertop for classrooms, material storage and chemical storage.
- d. Provide fixed student lab tables with water, gas, air, electric and data for 28 students.
- e. Provide teacher demonstration table with water, gas, air, electric and data.

2. Instructional Aids

- a. Interactive board with projector
- b. Marker board with map rails, 48"x48" (4)
- c. Tack board, 48" x 48" (3)

R. Other Considerations – Design of classroom shall allow for a space to "park" rolling book packs, bookcases, and/or wireless laptop carts where appropriate.

Classrooms shall be arranged as "career academies" with core subjects and ESE interspersed. Shared teacher planning and storage shall be placed in each academy.

Science classrooms shall have a "split" classroom design with one part of the room having fixed lab tables and another part of the room having student desks/tables. Where practicable, science classrooms shall be paired and project storage will be combined into one 300 nsf prep area.

S. Next Generation Technologies – Design to include equipping each classroom with the following Next Generation Technologies

- Interactive board with short throw projector mounted at front instructional area per district specifications
- CCTV channel changer device per district specifications
- Enhancement sound system with four to six speaker installation per district specifications. All media audio (voice, computer, CCTV) will be channeled through audio system.
- Docucam system integrated into video projection screen that allows for manipulation of camera viewing angle.
- Student access to computers will be per district standards.
- Probeware and associated sensor interface designed to allow user to digital acquire, process and analyze experimental data on either computer or visual display device to be able to support 10 lab stations .

Science Classroom

EDUCATIONAL SPECIFICATIONS

School Board of Sarasota County

Prototype High School

V. SPATIAL RELATIONSHIPS

Refer to Standard Classroom for Spatial Relationship

EDUCATIONAL SPECIFICATIONS

School Board of Sarasota County Prototype High School

J.R.O.T.C.

I. OBJECTIVES/GOALS

The high school experience will provide diverse opportunities in a structured learning environment. The goal of the J.R.O.T.C. program is to acquaint students with the armed forces through socialization, decision-making process, citizenship and knowledge acquisition.

II. ACTIVITIES/ENROLLMENT

Through the arrangement of furniture, materials and supplies, a learning laboratory will be created for students to be in large group instruction, small group instruction, and individual instruction. This arrangement will provide an environment that will be physically, mentally and socially conducive to learning.

Teacher-Student Ratio: **1:25**

Grade level for which program is intended: **9-12**

III. PROGRAM SPACES

NO. SPACES	FISH CODE		DESCRIPTION	NET SQUARE FEET		DESIGN	TOTAL
				UNIT	TOTAL	CAPACITY PER UNIT	STATIONS UTILIZED
1	708	9-12	J.R.O.T.C. Classroom	1,050	1,050	25	25
	800		Arms Room	150	150		
	802		Conference	225	225		
	808		Storage, Material	155	155		
			Subtotal	1,580	1,580		

EDUCATIONAL SPECIFICATIONS

School Board of Sarasota County Prototype High School

IV. SPECIAL CONSIDERATIONS

- A. **Heating/Cooling/Ventilation** – Standard. Each space, as per district policy, will be centrally controlled by an energy management system.
- B. **Acoustical** – Standard acoustical treatment will be provided throughout.
- C. **Floor** – Provide resilient flooring in each classroom.
- D. **Walls** – Shall meet District Standards.
- E. **Ceiling** – The ceiling height will be a minimum of 9' with acoustical tile panels.
- F. **Lighting** – Provide energy efficient fluorescent lighting with the capability of separate switching of rows of light parallel to the teaching wall.
- G. **Windows** – Standard. The windows will be operable to allow natural ventilation and/or when required by code. Window treatments will be provided for all exterior windows in order to darken rooms for instructional purposes.
- H. **Doors** – Standard. Exterior doors will be hollow metal with window(s). Doors opening to the outside of the building will also be protected by a security system. Interior doors, except for restrooms, will have window(s).
- I. **Water/Plumbing Fixtures** - Shall meet District Standards.
- J. **Communications** – Shall meet District Standards.
- K. **Electrical** – Shall meet District Standards. Provide outlets for computers, printers and other equipment.
- L. **Gas and Air** - N/A
- M. **Safety** – Shall meet District Standards.
- N. **Fencing** – N/A.
- O. **Service Drives** – N/A.
- P. **Parking** – N/A.
- Q. **Built-ins**
 - 1. Counters and Cabinet/Shelving

EDUCATIONAL SPECIFICATIONS

School Board of Sarasota County Prototype High School

- a. Bookcase with adjustable shelving, 48"x12"x72"
- b. Storage Cabinet, 48"x30"x72"
- c. Provide 90" x 24" base cabinetry and upper cabinets
- d. Provide 1 and 2 tiered rod system with shelves above for uniform storage.
3. Provide gun rack to hold 24 simulated rifles.
2. Instructional Aids
 - a. Interactive board with projector
 - b. Marker board with map rails, 48"x48" (4)
 - c. Tack board, 48" x 48" (3)
- R. **Other Considerations** - Design of classroom shall allow for a space to "park" rolling back packs, bookcases, and/or wireless laptop carts where appropriate.

Classrooms shall be arranged as "career academies" with core subjects and ESE interspersed. Shared teacher planning and storage shall be placed in each academy.

- S. **Next Generation Technologies** – Design to include equipping each classroom with the following Next Generation Technologies
 - Interactive board with short throw projector mounted at front instructional area per district specifications
 - CCTV channel changer device per district specifications
 - Enhancement sound system with four to six speaker installation per district specifications. All media audio (voice, computer, CCTV) will be channeled through audio system.
 - Docucam system integrated into video projection screen.

EDUCATIONAL SPECIFICATIONS

School Board of Sarasota County

Prototype High School

V. SPATIAL RELATIONSHIPS

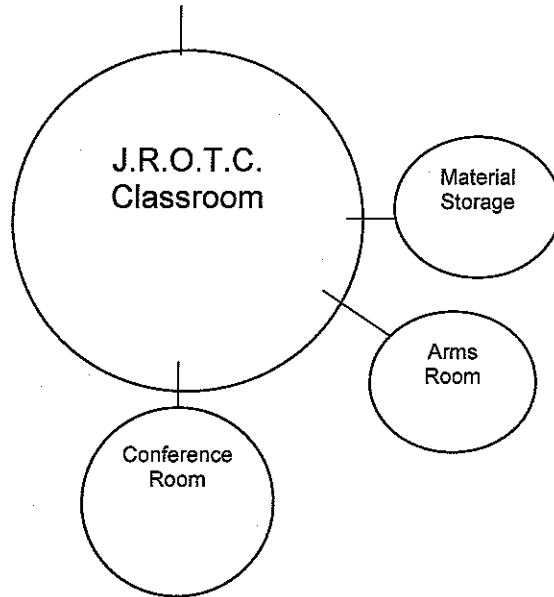

EDUCATIONAL SPECIFICATIONS

School Board of Sarasota County Prototype High School

SKILLS DEVELOPMENT LABORATORY

I. OBJECTIVES/GOALS

Teaching goals shall extend opportunities to the students for improvement of self-concepts through successful learning experiences.

II. ACTIVITIES AND ENROLLMENT

The activities for the programs are lecture/listening, discussion, audio-visual presentations, research, independent or group projects and presentations, reading, speaking, and writing. Provide experiences and opportunities for students to develop skills in critical thinking, deductive and inductive reasoning, and in problem solving.

Teacher-Student Ratio: **1:25**

Grade level for which program is intended: **9-12**

III. PROGRAM SPACES

NO. SPACES	FISH CODE		DESCRIPTION	NET SQUARE FEET		DESIGN	TOTAL
				UNIT	TOTAL	CAPACITY PER UNIT	STATIONS UTILIZED
			SKILLS DEVELOPMENT LAB				
22	012	9-12	Senior High Skills Labs	800	17,600	25	550
	808		Storage, Student	100	2,200		
			Subtotal	900	19,900		

IV. SPECIAL CONSIDERATIONS

- A. **Heating/Cooling/Ventilation** – Standard. Each space, as per district policy, will be centrally controlled by an energy management system. The HVAC system must be able to handle the extra heat generated by the computers and other equipment.
- B. **Acoustical** – Standard acoustical treatment will be provided throughout.
- C. **Floor** – Provide resilient flooring. Flooring to include raised floor for future networking purposes.
- D. **Walls** – Shall meet District Standards.
- E. **Ceiling** – The ceiling height will be a minimum of 9' with acoustical tile panels.

EDUCATIONAL SPECIFICATIONS

School Board of Sarasota County Prototype High School

- F. **Lighting** – Provide energy efficient fluorescent lighting with the capability of separate switching of rows of light parallel to the audio-visual screen.
- G. **Windows** – Standard. The windows will be operable to allow natural ventilation and/or when required by code. Window treatments will be provided for all exterior windows in order to darken rooms for instructional purposes.
- H. **Doors** – Standard. Exterior doors will be hollow metal with window(s). Doors opening to the outside of the building will also be protected by a security system. Interior doors, except for restrooms, will have window(s).
- I. **Water/Plumbing Fixtures** – Shall meet District Standards.
- J. **Communications** – Shall meet District Standards.
- K. **Electrical** – Shall meet District Standards. Provide outlets for computers, printers and other equipment.
- L. **Gas and Air** - N/A.
- M. **Safety** – Shall meet District Standards.
- N. **Fencing** – N/A.
- O. **Service Drives** – N/A.
- P. **Parking** – N/A.
- Q. **Built-ins** –
 - 1. Counters and Cabinet/Shelving
 - a. Bookcase with adjustable shelving, 48"x12"x72"
 - b. Storage Cabinet, 48"x30"x72"
 - c. Provide 90" x 24" base cabinetry and upper cabinets
 - 2. Instructional Aids
 - a. Interactive board with projector
 - b. Marker board with map rails, 48"x48" (4)
 - c. Tack board, 48" x 48" (3)
- R. **Other Considerations** – Design of classroom shall allow for a space to "park" rolling back packs, bookcases, and/or wireless laptop carts where appropriate.

Classrooms shall be arranged as "career academies" with core subjects and ESE interspersed. Shared teacher planning and storage shall be placed in each academy.

EDUCATIONAL SPECIFICATIONS

School Board of Sarasota County

Prototype High School

- S. Next Generation Technologies** – Design to include equipping each classroom with the following Next Generation Technologies
- Interactive board with short throw projector mounted at front instructional area per district specifications
 - CCTV channel changer device per district specifications
 - Enhancement sound system with four to six speaker installation per district specifications. All media audio (voice, computer, CCTV) will be channeled through audio system.
 - Docucam system integrated into video projection screen.

V. SPATIAL RELATIONSHIPS

Refer to Standard Classroom for Spatial Relationship

EDUCATIONAL SPECIFICATIONS

School Board of Sarasota County Prototype High School

RESOURCE ROOM

I. OBJECTIVES/GOALS

Resource Rooms are used to support the instructional program by providing space for supplemental activities.

II. ACTIVITIES/ENROLLMENT

Program activities include small group instruction and student testing.

Teacher-Student Ratio: 1:10

Grade level for which program is intended: 9-12

III. PROGRAM SPACES

				NET SQUARE FEET		DESIGN	TOTAL
NO.	FISH					CAPACITY	STATIONS
SPACES	CODE		DESCRIPTION	UNIT	TOTAL	PER UNIT	UTILIZED
			RESOURCE - REGULAR				
7	040	PK-12	Resource Room	290	2,030	10	
	808		Storage, Material	100	700		
			Subtotal	390	2,730		

IV. SPECIAL CONSIDERATIONS

- A. Heating/Cooling/Ventilation – Standard. Each space, as per district policy, will be centrally controlled by an energy management system.
- B. Acoustical – Standard acoustical treatment will be provided throughout.
- C. Floor – Provide resilient flooring in each classroom. Flooring to include raised floor for future networking purposes.
- D. Walls – Shall meet District Standards.
- E. Ceiling – The ceiling height will be a minimum of 9' with acoustical tile panels.
- F. Lighting – Provide energy efficient fluorescent lighting with the capability of separate switching of rows of light parallel to the audio-visual screen.
- G. Windows – Standard. The windows will be operable to allow natural ventilation and/or when required by code. Window treatments will be provided for all exterior windows in order to darken rooms for instructional purposes.

EDUCATIONAL SPECIFICATIONS

School Board of Sarasota County Prototype High School

- H. **Doors** – Standard. Exterior doors will be hollow metal with window(s). Doors opening to the outside of the building will also be protected by a security system. Interior doors, except for restrooms, will have window(s).
- I. **Water/Plumbing Fixtures** – N/A.
- J. **Communications** – Shall meet District Standards.
- K. **Electrical** – Shall meet District Standards. Provide outlets for computers, printers and other equipment.
- L. **Gas and Air** - N/A.
- M. **Safety** – Shall meet District Standards.
- N. **Fencing** – N/A.
- O. **Service Drives** – N/A.
- P. **Parking** – N/A.
- Q. **Built-ins**
1. Counters and Cabinet/Shelving
 - a. Bookcase with adjustable shelving, 48"x12"x72"
 - b. Storage Cabinet, 48"x30"x72"
 - c. Provide 90" x 24" cabinetry with lower and upper cabinets
 2. Instructional Aids
 - a. Interactive board with projector
 - b. Marker board with map rails, 48"x48" (3)
 - c. Tack board, 48" x 48" (2)
- R. **Other Considerations** - Classrooms shall be arranged as "career academies" with core subjects and ESE interspersed. Shared teacher planning and storage shall be placed in each academy.
- S. **Next Generation Technologies** – Design to include equipping each classroom with the following Next Generation Technologies
- Interactive board with short throw projector mounted at front instructional area per district specifications
 - CCTV channel changer device per district specifications
 - Enhancement sound system with four to six speaker installation per district specifications. All media audio (voice, computer, CCTV) will be channeled through audio system.
 - Docucam system integrated into video projection screen.
 - Student access to computers will be per district standards.

EDUCATIONAL SPECIFICATIONS

School Board of Sarasota County

Prototype High School

V. SPATIAL RELATIONSHIPS

Refer to Standard Classroom for Spatial Relationship

EDUCATIONAL SPECIFICATIONS

School Board of Sarasota County Prototype High School

EXCEPTIONAL STUDENT EDUCATION

I. OBJECTIVES/GOALS

Students with special learning difference will be provided educational programs designed to meet their individual needs. Diagnostic evaluation, planning and implementation of individual student programs will be provided.

II. ACTIVITIES AND ENROLLMENT

Students with special learning styles will be provided educational programs designed to meet their individual needs. Individualized and small group instruction will be provided.

Teacher-Student Ratio: Varies

Grade level for which program is intended: 9-12

III. PROGRAM SPACES

NO.	FISH CODE		DESCRIPTION	NET SQUARE FEET		DESIGN	TOTAL
				UNIT	TOTAL	CAPACITY PER UNIT	STATIONS UTILIZED
			EXCEPTIONAL EDUCATION				
6	061	PK-12	ESE Part-time	975	5,850	15	90
	808		Storage, Material	100	600		
	813		Storage, Student	40	200		
	815		Toilet, Student-Male	0	0		
	816		Toilet, Student-Female	0	0		
			Subtotal	1,115	6,650		
1	704	K-12	Detention Classroom	600	600	20	20
	808		Storage, Material	100	100		
	815		Toilet, Student-Male	60	60		
	816		Toilet, Student-Female	60	60		
			Subtotal	820	820		
3	062	PK-12	ESE Full-time	950	2,850	10	30
	808		Storage, Material	100	300		
	813		Storage, Student	40	120		
	817		RR and Bath, Student	110	330		
			Subtotal	1,200	3,600		
1	063	N-12	ESE Vocational	1,140	1,140	12	12
	808		Storage, Student	100	100		
	815		Toilet, Student-Male	60	60		
	816		Toilet, Student-Female	60	60		
			Subtotal	1,360	1,360		
1	064	N-PK	ESE PT/OT	475	475	5	0
	808		Storage, Material	100	100		

EDUCATIONAL SPECIFICATIONS

School Board of Sarasota County Prototype High School

				NET SQUARE FEET		DESIGN	TOTAL
NO.	FISH					CAPACITY	STATIONS
SPACES	CODE		DESCRIPTION	UNIT	TOTAL	PER UNIT	UTILIZED
	813		Storage, Student	40	40		
	817		RR and Bath, Student	110	110		
			Subtotal	725	725		
6	065	PK-12	ESE Resource Room	380	2,280	4	0
	808		Storage, Material	100	600		
	813		Storage, Student	40	240		
			Subtotal	520	3,120		
0	066	PK-12	Supplementary Instruction	100	0	2	0
	808		Storage, Material	100	0		
			Subtotal	200	0		

IV. SPECIAL CONSIDERATIONS

- A. **Heating/Cooling/Ventilation** – Standard. Each space, as per district policy, will be centrally controlled by an energy management system.
- B. **Acoustical** – Standard acoustical treatment will be provided throughout.
- C. **Floor** – Provide carpeting in ESE Vocational Classroom (Apartment) except for kitchen area. The kitchen area shall have resilient flooring. Provide resilient flooring in each classroom. Flooring to include raised floor for future networking purposes.
- D. **Walls** – Shall meet District Standards.
- E. **Ceiling** – The ceiling height will be a minimum of 9' with acoustical tile panels.
- F. **Lighting** – Provide energy efficient fluorescent lighting with the capability of separate switching of rows of light parallel to the audio-visual screen.
- G. **Windows** – Standard. The windows will be operable to allow natural ventilation and/or when required by code. Window treatments will be provided for all exterior windows in order to darken rooms for instructional purposes. Provide observation windows in areas where District/School Staff as deemed necessary.
- H. **Doors** – Standard. Exterior doors will be hollow metal with window(s). Doors opening to the outside of the building will also be protected by a security system. Interior doors, except for restrooms, will have window(s).
- I. **Water/Plumbing Fixtures** – Shall meet District Standards.

EDUCATIONAL SPECIFICATIONS

School Board of Sarasota County Prototype High School

- J. **Communications** – Shall meet District Standards.
- K. **Electrical** – Shall meet District Standards. Provide outlets for computers, printers and other equipment.
- L. **Gas and Air** - N/A.
- M. **Safety** – Shall meet District Standards.
- N. **Fencing** – N/A.
- O. **Service Drives** – N/A.
- P. **Parking** – N/A.
- Q. **Built-ins**
1. Counters and Cabinet/Shelving
 - a. Bookcase with adjustable shelving, 48"x12"x72"
 - b. Storage Cabinet, 48"x30"x72"
 - c. Provide 90" x 24" lower cabinetry and upper cabinets
 2. Instructional Aids
 - a. Interactive board with projector
 - b. Marker board with map rails, 48"x48" (4)
 - c. Tack board, 48" x 48" (3)
- R. **Other Considerations** – Design of classroom shall allow for a space to "park" rolling back packs, bookcases, and/or wireless laptop carts where appropriate.
- Classrooms shall be arranged as "career academies" with core subjects and ESE interspersed. Shared teacher planning and storage shall be placed in each academy.
- S. **Next Generation Technologies** – Design to include equipping each classroom with the following Next Generation Technologies
- Interactive board with short throw projector mounted at front instructional area per district specifications
 - CCTV channel changer device per district specifications
 - Enhancement sound system with four to six speaker installation per district specifications. All media audio (voice, computer, CCTV) will be channeled through audio system.
 - Docucam system integrated into video projection screen.
 - Student access to computers will be per district standards.

EDUCATIONAL SPECIFICATIONS

School Board of Sarasota County

Prototype High School

V. SPATIAL RELATIONSHIPS

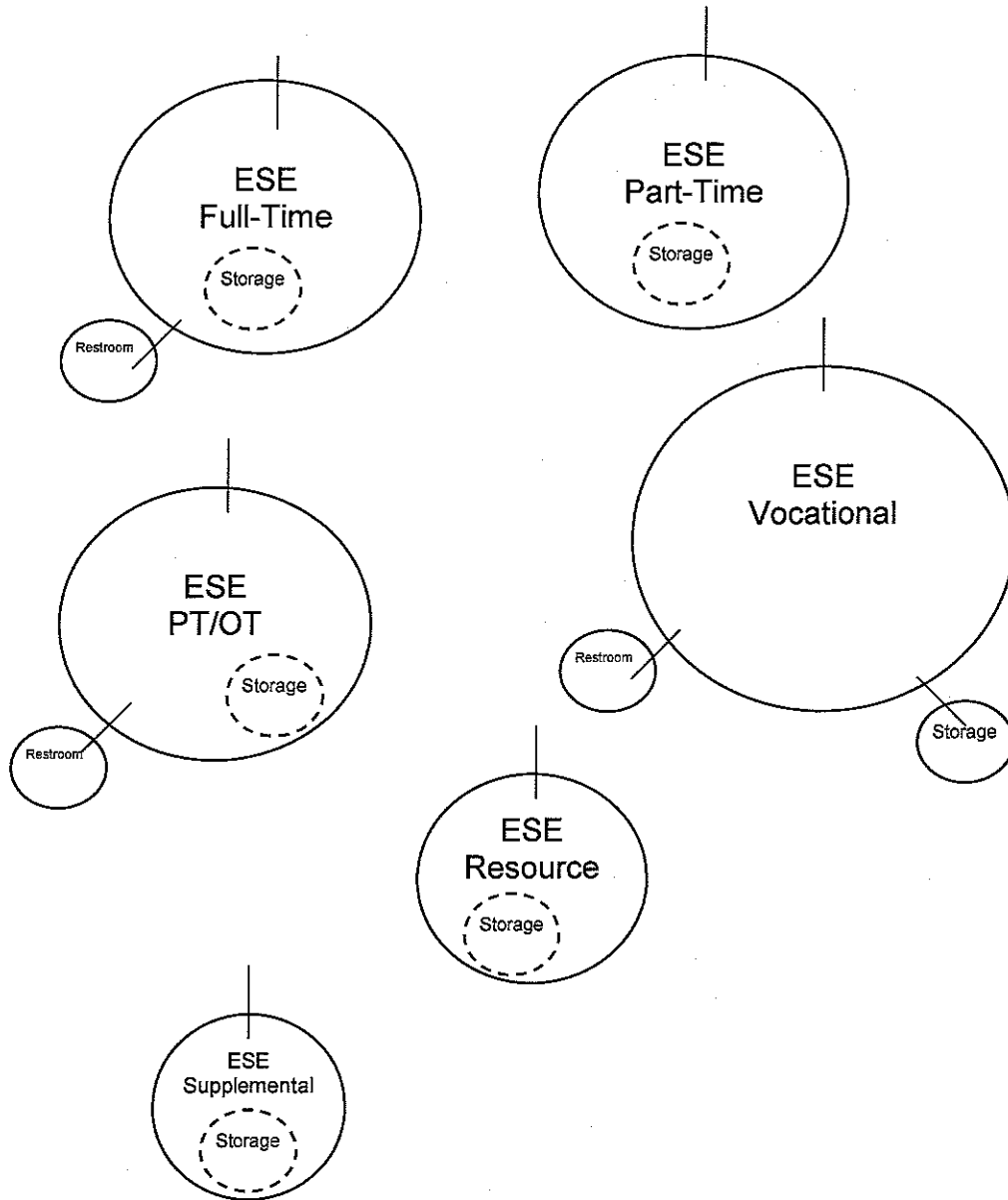

EDUCATIONAL SPECIFICATIONS

School Board of Sarasota County Prototype High School

ART

I. OBJECTIVES/GOALS

The art program shall provide opportunities to learn and appreciate past and present artistic expressions of others. A variety of course offerings provide many opportunities for students to develop their artistic talents.

II. ACTIVITIES AND ENROLLMENT

The art curriculum will provide many different types of activities such as drawing, painting, mixed media, photography, ceramics, printmaking, and art appreciation. In addition to 2-D and 3-D Art classrooms, one Small Technology Lab shall be used for Graphic Arts, allowing for instruction in computer generated art.

Teacher-Student Ratio: **1:28**

Grade level for which program is intended: **9-12**

III. PROGRAM SPACES

NO.	FISH CODE	DESCRIPTION	NET SQUARE FEET		DESIGN	TOTAL
			UNIT	TOTAL	CAPACITY PER UNIT	STATIONS UTILIZED
		ART				
2	052	6-8 Senior High	1,484	2,968	28	84
1	803	Darkroom	100	100		
	805	Kiln	60	120		
2	808	Storage, Material	100	200		
2	812	Storage, Project	150	300		
		Subtotal	1,894	3,788		

IV. SPECIAL CONSIDERATIONS

- A. **Heating/Cooling/Ventilation** – Standard. Each space, as per district policy, will be centrally controlled by an energy management system. Provide special ventilation for kiln room.
- B. **Acoustical** - Standard acoustical treatment will be provided throughout to control reverberation, echo and/or excessive deadness.
- C. **Floor** – Provide resilient flooring. Provide smooth transition from art classroom to art patio to kiln room for the rolling of carts. Flooring to include raised floor for future networking purposes.
- D. **Walls** - Shall meet District Standards. Provide wall space for murals where possible. Provide the maximum amount of wall space for tackable material to display art work.

EDUCATIONAL SPECIFICATIONS

School Board of Sarasota County Prototype High School

- E. **Ceiling** – The ceiling height will be a minimum of 9” with acoustical tile panels.
- F. **Lighting** – Provide energy efficient fluorescent lighting with the capability of separate switching of rows of light parallel to the audio-visual screen. Provide track lighting to illuminate art displays.
- G. **Windows** – Standard. The windows will be operable to allow natural ventilation and/or when required by code. Window treatments will be provided for all exterior windows in order to darken rooms for instructional purposes. Allow for natural light from a northern source.
- H. **Doors** – Standard. Exterior doors will be hollow metal with window(s). Doors opening to the outside of the building will also be protected by a security system. Interior doors, except for restrooms, will have window(s). The kiln room door shall be fire rated.
- I. **Water/Plumbing Fixtures** - Provide two deep art sink(s) with gooseneck faucet in the cabinetry in the classroom. Locate a hose bibb at the art patio.
- J. **Communications** – Shall meet District Standards. Graphic arts shall have data and power for 30 student computers.
- K. **Electrical** – Shall meet District Standards. Provide outlets for kiln(s), computers, printers and other equipment. Graphic arts shall have data and power for 30 student computers.
- L. **Gas and Air** - N/A.
- M. **Safety** – Shall meet District Standards.
- N. **Fencing** – N/A.
- O. **Service Drives** – N/A.
- P. **Parking** – N/A.
- Q. **Built-ins**
 - 1. Counters and Cabinet/Shelving
 - a. Provide base cabinets with double compartment sink in the Art classrooms.
 - b. Provide base cabinet with art sink in Art classrooms.
 - c. Provide cabinets with fully vented doors and 15 adjustable shelves in the Art classrooms.

EDUCATIONAL SPECIFICATIONS

School Board of Sarasota County

Prototype High School

- d. Provide upper and lower cabinets with a counter in the middle and 4" vertical dividers in part of the lower cabinets in the classroom.
- e. Provide storage cabinets with adjustable shelves and no doors in Project/Material Storage. Storage cabinets shall include storage of large paper.
- f. Provide metal shelving in Kiln room.
- g. Provide upper and lower cabinets with sink in darkroom.
- h. Provide 90"x 24" lower cabinetry and upper cabinets in Graphic Arts

2. Instructional Aids

- a. Interactive board with projector
- b. Marker board with map rails, 48"x48" (4)
- c. Tack board, 48" x 48" (3)
- d. Provide floor to ceiling tack board in classroom.

R. Other Considerations –

1. Provide pre-cast concrete benches at the outside art patio.
2. Provide Kiln with exhaust hood, electric.
3. Design of classroom shall allow for a space to "park" rolling back packs, bookcases, and/or wireless laptop carts where appropriate.
4. Provide area outside of Art classroom(s) for displaying of projects.
5. Art shall be located in close proximity to music and auditorium and a classroom that can be used for drama.

S. Next Generation Technologies – Design to include equipping each classroom with the following Next Generation Technologies

- Interactive board with short throw projector mounted at front instructional area per district specifications
- CCTV channel changer device per district specifications
- Enhancement sound system with four to six speaker installation per district specifications. All media audio (voice, computer, CCTV) will be channeled through audio system.
- Docucam system integrated into video projection screen.
- Student access to computers will be per district standards.

EDUCATIONAL SPECIFICATIONS

School Board of Sarasota County

Prototype High School

V. SPATIAL RELATIONSHIPS

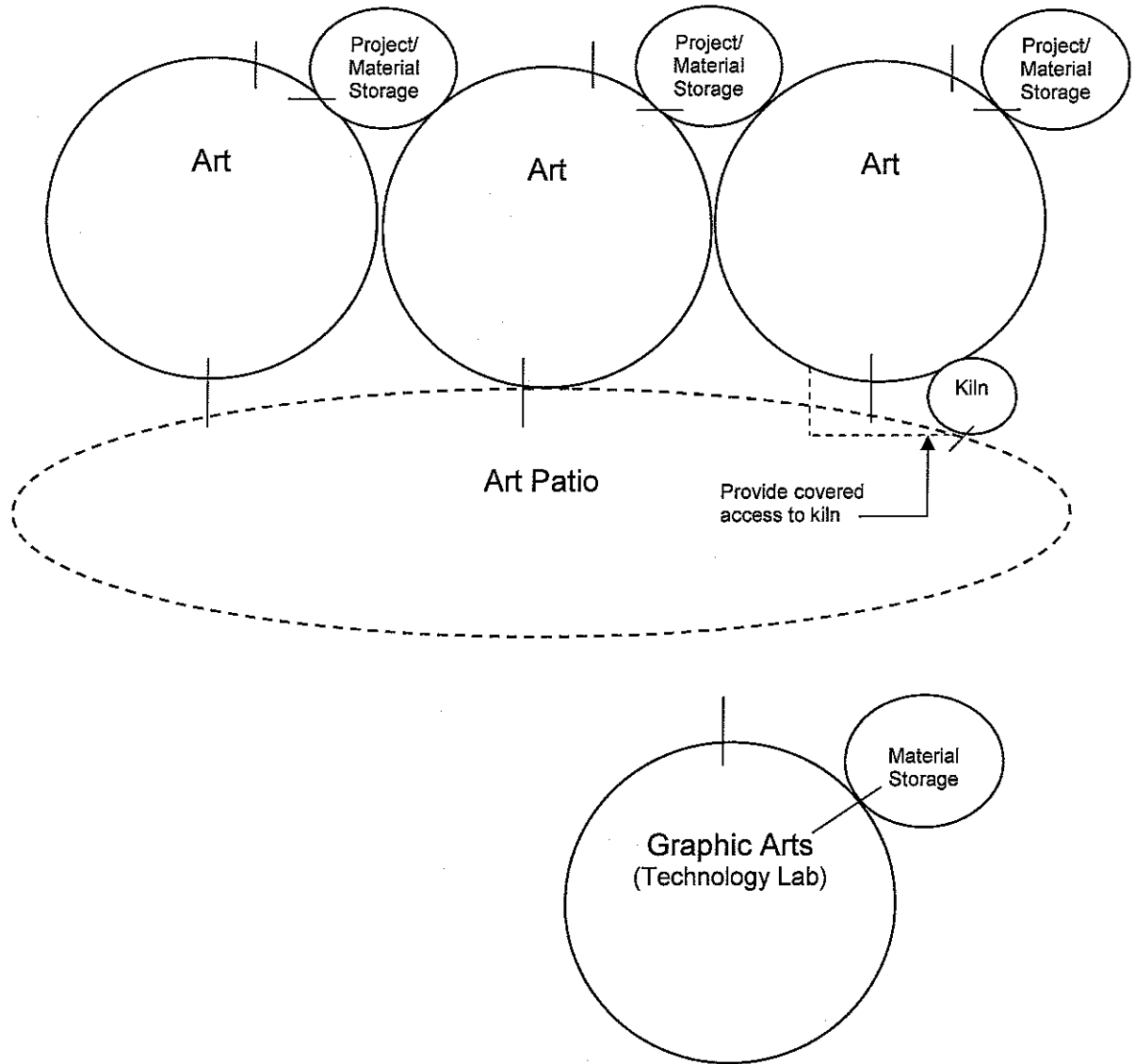

EDUCATIONAL SPECIFICATIONS

School Board of Sarasota County Prototype High School

BAND

I. OBJECTIVES/GOALS

The music program will enable students to compose; sing and play instruments; read and write music. Students will develop critical thinking and problem solving skills through music composition, performance and listening. Students will listen to, analyze, describe and evaluate their own performance and those of others.

II. ACTIVITIES AND ENROLLMENT

The music curriculum will consist of formal courses of study, performing groups, individualized instruction and music activities. Group rehearsals, ensemble groups, individualized instruction and general teaching will utilize the music facilities.

Teacher-Student Ratio: varies

Grade level for which program is intended: 9-12

III. PROGRAM SPACES

NO. SPACES	FISH CODE		DESCRIPTION	NET SQUARE FEET		DESIGN	TOTAL
				UNIT	TOTAL	CAPACITY PER UNIT	STATIONS UTILIZED
			MUSIC				
1	076	6-12	Band Classroom	2,000	2,000	50	50
	806		Reference	100	100		
	808		Storage, Material	100	100		
	830		Ensemble	300	300		
	831		Practice Room(s)	70	140		
	832		Storage, Instrument	600	600		
	834		Uniform	300	300		
	835		Studio	180	180		
			Subtotal	3650	3720		

IV. SPECIAL CONSIDERATIONS

- A. Heating/Cooling/Ventilation – Standard. Each space, as per district policy, will be centrally controlled by an energy management system. Provide controls for temperature and humidity during times school is not in session to protect the musical instruments from damage.
- B. Acoustical - Standard acoustical treatment will be provided throughout to control reverberation, echo and/or excessive deadness. Extra acoustical treatment on the walls and ceiling may be necessary to prevent sound from entering or leaving from the classroom.

EDUCATIONAL SPECIFICATIONS

School Board of Sarasota County Prototype High School

- C. **Floor** – Provide carpeting in Classroom except for “wet area” around sink. The “wet area” shall have resilient flooring. Flooring to include raised floor for future networking purposes.
- D. **Walls** - Shall meet District Standards.
- E. **Ceiling** – The ceiling height will be a minimum of 22’ with acoustical tile panels.
- F. **Lighting** – Provide energy efficient fluorescent lighting with the capability of separate switching of rows of light parallel to the audio-visual screen.
- G. **Windows** – Standard. The windows will be operable to allow natural ventilation and/or when required by code. Window treatments will be provided for all exterior windows in order to darken rooms for instructional purposes. Provide observation windows between classroom and practice room(s) and classroom and ensemble.
- H. **Doors** – Provide heavy doors to hallways that will serve to contain sound within the band room. Exterior doors will be hollow metal with window(s). Provide double doors or wide doors to the entrance of the band room and to the outside for movement of instruments. Doors opening to the outside of the building will also be protected by a security system. Interior doors, except for restrooms, will have window(s). Provide full-length window in practice rooms.
- I. **Water/Plumbing Fixtures** - Shall meet District Standards. Provide sink with gooseneck faucet and bubbler in the cabinetry in the classroom with hot and cold water.
- J. **Communications** – Shall meet District Standards.
- K. **Electrical** – Shall meet District Standards. Provide outlets for computers, printers and other equipment.
- L. **Gas and Air** - N/A.
- M. **Safety** – Shall meet District Standards.
- N. **Fencing** – N/A.
- O. **Service Drives** – The band classroom should be located near the service drive.
- P. **Parking** – N/A.
- Q. **Built-ins**

EDUCATIONAL SPECIFICATIONS

School Board of Sarasota County Prototype High School

1. Counters and Cabinet/Shelving
 - a. Bookcase with adjustable shelving, 48"x12"x72"
 - b. Storage Cabinet, 48"x30"x72"
 - c. Provide 90" x 24" cabinetry with sink and bubbler; and upper cabinets
 - d. Provide double-tiered rods with shelves above rods on all walls of Uniform Storage.
 2. Instructional Aids
 - a. Interactive board with projector
 - b. Marker board with map rails, 48"x48" (4)
 - c. Tack board, 48" x 48" (3)
 - d. Marker Board, 8'x5' Music Staff with 4' tack board above
- R. Other Considerations** – Design of classroom shall allow for a space to "park" rolling back packs, bookcases, and/or wireless laptop carts where appropriate.
- S. Next Generation Technologies** – Design to include equipping each classroom with the following Next Generation Technologies
- Interactive board with short throw projector mounted at front instructional area per district specifications
 - CCTV channel changer device per district specifications
 - Enhancement sound system with four to six speaker installation per district specifications. All media audio (voice, computer, CCTV) will be channeled through audio system.
 - Docucam system integrated into video projection screen

EDUCATIONAL SPECIFICATIONS

School Board of Sarasota County

Prototype High School

V. SPATIAL RELATIONSHIPS

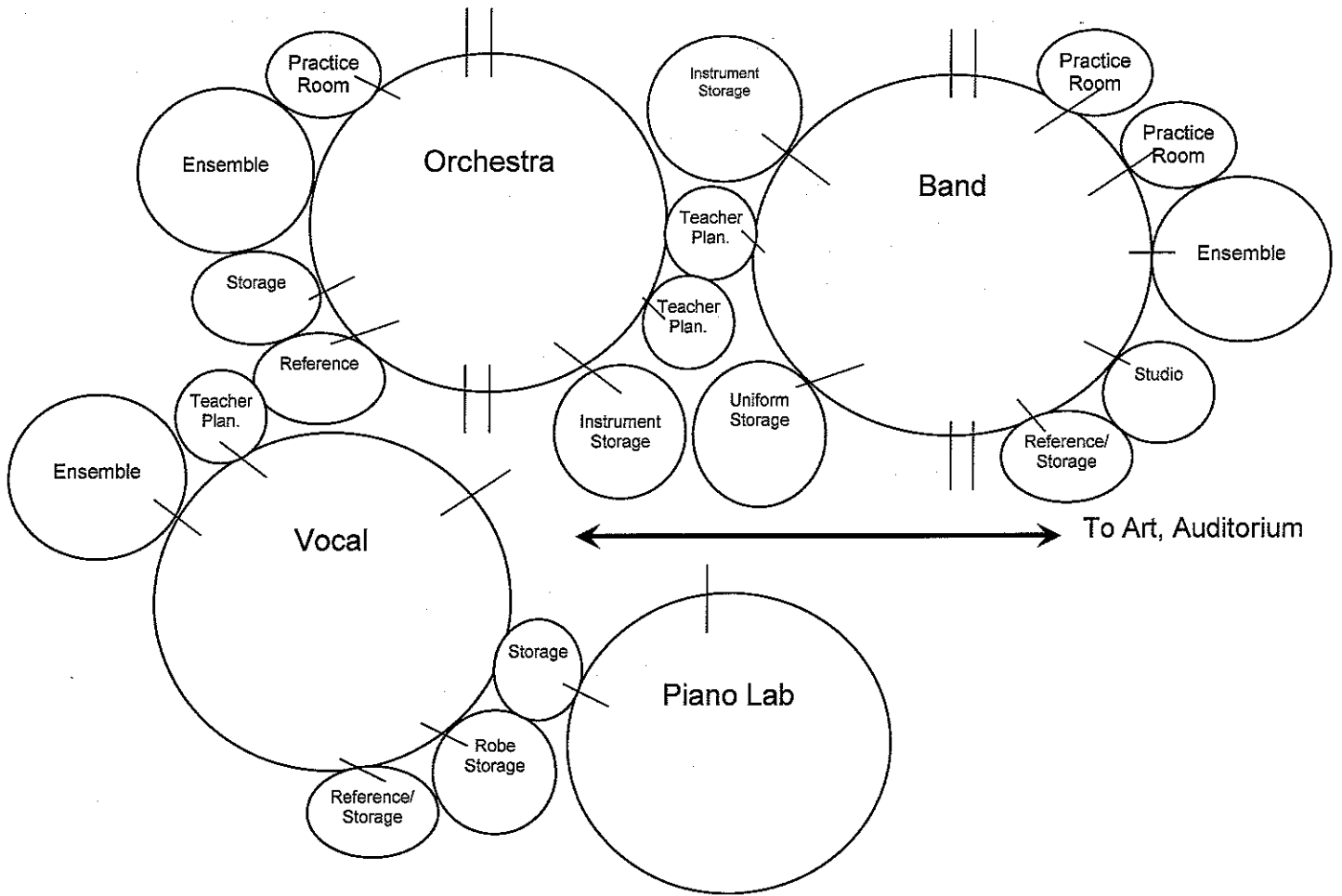

EDUCATIONAL SPECIFICATIONS

School Board of Sarasota County Prototype High School

VOCAL

I. OBJECTIVES/GOALS

The music program will enable students to compose; sing and play instruments; read and write music. Students will develop critical thinking and problem solving skills through music composition, performance and listening. Students will listen to, analyze, describe and evaluate their own performance and those of others.

II. ACTIVITIES AND ENROLLMENT

The music curriculum will consist of formal courses of study, performing groups, individualized instruction and music activities. Group rehearsals, ensemble groups, individualized instruction and general teaching will utilize the music facilities.

Teacher-Student Ratio: varies

Grade level for which program is intended: 9-12

III. PROGRAM SPACES

				NET SQUARE FEET		DESIGN	TOTAL
NO.	FISH					CAPACITY	STATIONS
SPACES	CODE		DESCRIPTION	UNIT	TOTAL	PER UNIT	UTILIZED
			MUSIC				
1	075	6-12	Vocal Classroom	1425	1425	25	25
	806		Reference	100	100		
	808		Storage, Material	100	100		
	830		Ensemble	300	300		
	831		Practice Room(s)	70	70		
	833		Robe	150	150		
			Subtotal	2145	2145		

IV. SPECIAL CONSIDERATIONS

- A. **Heating/Cooling/Ventilation** – Standard. Each space, as per district policy, will be centrally controlled by an energy management system. Provide controls for temperature and humidity during times school is not in session to protect the musical instruments from damage.
- B. **Acoustical** - Standard acoustical treatment will be provided throughout to control reverberation, echo and/or excessive deadness. Extra acoustical treatment on the walls and ceiling may be necessary to prevent sound from entering or leaving from the classroom.
- C. **Floor** – Shall be of a resilient material that is conducive to the acoustics necessary for vocal usage. Flooring to include raised floor for future networking purposes.

EDUCATIONAL SPECIFICATIONS

School Board of Sarasota County

Prototype High School

- D. **Walls** - Shall meet District Standards.
- E. **Ceiling** – The ceiling height will be a minimum of 20' with acoustical tile panels.
- F. **Lighting** – Provide energy efficient fluorescent lighting with the capability of separate switching of rows of light parallel to the audio-visual screen.
- G. **Windows** – Standard. The windows will be operable to allow natural ventilation and/or when required by code. Window treatments will be provided for all exterior windows in order to darken rooms for instructional purposes.
- H. **Doors** – Provide heavy doors to hallways that will serve to contain sound within the vocal room. Exterior doors will be hollow metal with window(s). Doors opening to the outside of the building will also be protected by a security system. Interior doors, except for restrooms, will have window(s). Provide full-length window in practice room.
- I. **Water/Plumbing Fixtures** - Shall meet District Standards.
- J. **Communications** – Shall meet District Standards.
- K. **Electrical** – Shall meet District Standards. Provide outlets for computers, printers and other equipment.
- L. **Gas and Air** - N/A.
- M. **Safety** – Shall meet District Standards.
- N. **Fencing** – N/A.
- O. **Service Drives** – N/A.
- P. **Parking** – N/A.
- Q. **Built-ins**
 - 1. Counters and Cabinet/Shelving
 - a. Bookcase with adjustable shelving, 48"x12"x72"
 - b. Storage Cabinet, 48"x30"x72"
 - c. Provide 90" x 24" cabinetry with sink and bubbler; and upper cabinets
 - d. Provide single-tiered rod with shelves above rods on all walls of Robe Storage.
 - 2. Instructional Aids
 - a. Interactive board with projector

EDUCATIONAL SPECIFICATIONS

School Board of Sarasota County

Prototype High School

- b. Marker board with map rails, 48"x48" (4)
- c. Tack board, 48" x 48" (3)
- d. Marker Board, 8'x5' Music Staff with 4' tack board above

R. Other Considerations – Design of classroom shall allow for a space to “park” rolling back packs, bookcases, and/or wireless laptop carts where appropriate.

S. Next Generation Technologies – Design to include equipping each classroom with the following Next Generation Technologies

- Interactive board with short throw projector mounted at front instructional area per district specifications
- CCTV channel changer device per district specifications
- Enhancement sound system with four to six speaker installation per district specifications. All media audio (voice, computer, CCTV) will be channeled through audio system.
- Docucam system integrated into video projection screen.

V. SPATIAL RELATIONSHIPS

For spatial relationships, see Band.

EDUCATIONAL SPECIFICATIONS

School Board of Sarasota County Prototype High School

ORCHESTRA

I. OBJECTIVES/GOALS

The music program will enable students to compose; sing and play instruments; read and write music. Students will develop critical thinking and problem solving skills through music composition, performance and listening. Students will listen to, analyze, describe and evaluate their own performance and those of others.

II. ACTIVITIES AND ENROLLMENT

The music curriculum will consist of formal courses of study, performing groups, individualized instruction and music activities. Group rehearsals, ensemble groups, individualized instruction and general teaching will utilize the music facilities.

Teacher-Student Ratio: **varies**

Grade level for which program is intended: **9-12**

III. PROGRAM SPACES

				NET SQUARE FEET		DESIGN	TOTAL
NO.	FISH					CAPACITY	STATIONS
SPACES	CODE		DESCRIPTION	UNIT	TOTAL	PER UNIT	UTILIZED
1	077	6-12	Orchestra Classroom	1,596	1,596	28	28
	806		Reference	100	100		
	808		Storage, Material	100	100		
	830		Ensemble	300	300		
	831		Practice Room(s)	70	70		
	832		Storage, Instrument	600	600		
			Subtotal	2,766	2,766		

IV. SPECIAL CONSIDERATIONS

- A. **Heating/Cooling/Ventilation** – Standard. Each space, as per district policy, will be centrally controlled by an energy management system. Provide controls for temperature and humidity during times school is not in session to protect the musical instruments from damage.
- B. **Acoustical** - Standard acoustical treatment will be provided throughout to control reverberation, echo and/or excessive deadness. Extra acoustical treatment on the walls and ceiling may be necessary to prevent sound from entering or leaving from the classroom.
- C. **Floor** – Provide carpeting in Classroom except for “wet area” around sink. The “wet area” shall have resilient flooring. Flooring to include raised floor for future networking purposes.

EDUCATIONAL SPECIFICATIONS

School Board of Sarasota County Prototype High School

- D. **Walls** - Shall meet District Standards.
- E. **Ceiling** – The ceiling height will be a minimum of 22' with acoustical tile panels.
- F. **Lighting** – Provide energy efficient fluorescent lighting with the capability of separate switching of rows of light parallel to the audio-visual screen.
- G. **Windows** – Standard. The windows will be operable to allow natural ventilation and/or when required by code. Window treatments will be provided for all exterior windows in order to darken rooms for instructional purposes. Provide observation windows between classroom and practice room(s) and classroom and ensemble.
- H. **Doors** – Provide heavy doors to hallways that will serve to contain sound within the orchestra room. Exterior doors will be hollow metal with window(s). Provide double doors or wide doors to the entrance of the orchestra room and to the outside for movement of instruments. Doors opening to the outside of the building will also be protected by a security system. Interior doors, except for restrooms, will have window(s). Provide full-length window in practice rooms.
- I. **Water/Plumbing Fixtures** – Shall meet District Standards. Provide sink with gooseneck faucet and bubbler in the cabinetry in the classroom with hot and cold water.
- J. **Communications** – Shall meet District Standards.
- K. **Electrical** – Shall meet District Standards. Provide outlets for computers, printers and other equipment.
- L. **Gas and Air** – N/A.
- M. **Safety** – Shall meet District Standards.
- N. **Fencing** – N/A.
- O. **Service Drives** – The orchestra classroom should be located near the service drive.
- P. **Parking** – N/A.
- Q. **Built-ins**
 - 1. Counters and Cabinet/Shelving
 - a. Bookcase with adjustable shelving, 48"x12"x72"
 - b. Storage Cabinet, 48"x30"x72"

EDUCATIONAL SPECIFICATIONS

School Board of Sarasota County

Prototype High School

- c. Provide 90" x 24" cabinetry with sink and bubbler; and upper cabinets
- 2. Instructional Aids
 - a. Interactive board with projector
 - b. Marker board with map rails, 48"x48" (4)
 - c. Tack board, 48" x 48" (3)
 - d. Marker Board, 8'x5' Music Staff with 4' tack board above
- R. **Other Considerations** – Design of classroom shall allow for a space to "park" rolling back packs, bookcases, and/or wireless laptop carts where appropriate.
- S. **Next Generation Technologies** – Design to include equipping each classroom with the following Next Generation Technologies
 - Interactive board with short throw projector mounted at front instructional area per district specifications
 - CCTV channel changer device per district specifications
 - Enhancement sound system with four to six speaker installation per district specifications. All media audio (voice, computer, CCTV) will be channeled through audio system.
 - Docucam system integrated into video projection screen.

V. SPATIAL RELATIONSHIPS

For spatial relationships, see Band.

EDUCATIONAL SPECIFICATIONS

School Board of Sarasota County Prototype High School

PIANO/KEYBOARD LABORATORY

I. OBJECTIVES/GOALS

The music program will enable students to compose; sing and play instruments; read and write music. Students will develop critical thinking and problem solving skills through music composition, performance and listening. Students will listen to, analyze, describe and evaluate their own performance and those of others.

II. ACTIVITIES AND ENROLLMENT

The music curriculum will consist of formal courses of study, performing groups, individualized instruction and music activities. Group rehearsals, ensemble groups, individualized instruction and general teaching will utilize the music facilities.

Teacher-Student Ratio: varies

Grade level for which program is intended: 9-12

III. PROGRAM SPACES

NO.	FISH CODE	DESCRIPTION	NET SQUARE FEET		DESIGN	TOTAL
			UNIT	TOTAL	CAPACITY PER UNIT	STATIONS UTILIZED
1	080	6-12 Piano Laboratory	925	925	25	25
	808	Storage, Material	<u>100</u>	<u>100</u>		
		Subtotal	1,025	1,025		

IV. SPECIAL CONSIDERATIONS

- A. Heating/Cooling/Ventilation – Standard. Each space, as per district policy, will be centrally controlled by an energy management system. Provide controls for temperature and humidity during times school is not in session to protect the musical instruments from damage.
- B. Acoustical - Standard acoustical treatment will be provided throughout to control reverberation, echo and/or excessive deadness. Extra acoustical treatment on the walls and ceiling may be necessary to prevent sound from entering or leaving from the classroom.
- C. Floor – Provide carpeting in Classroom except for “wet area” around sink. The “wet area” shall have resilient flooring. Flooring to include raised floor for future networking purposes.
- D. Walls - Shall meet District Standards.

EDUCATIONAL SPECIFICATIONS

School Board of Sarasota County Prototype High School

- E. **Ceiling** – The ceiling height will be a minimum of 9' with acoustical tile panels.
- F. **Lighting** – Provide energy efficient fluorescent lighting with the capability of separate switching of rows of light parallel to the audio-visual screen.
- G. **Windows** – Standard. The windows will be operable to allow natural ventilation and/or when required by code. Window treatments will be provided for all exterior windows in order to darken rooms for instructional purposes. Provide observation windows between classroom and practice room(s) and classroom and ensemble.
- H. **Doors** – Standard. Exterior doors will be hollow metal with window(s). Provide double doors or wide doors to the entrance of the piano/keyboard laboratory and to the outside for movement of instruments. Doors opening to the outside of the building will also be protected by a security system. Interior doors, except for restrooms, will have window(s).
- I. **Water/Plumbing Fixtures** – Shall meet District Standards. Provide sink with gooseneck faucet and bubbler in the cabinetry in the classroom and in instrument storage.
- J. **Communications** – Shall meet District Standards.
- K. **Electrical** – Shall meet District Standards. Provide outlets for computers, printers and other equipment, necessary to serve up to 25 keyboards.
- L. **Gas and Air** – N/A.
- M. **Safety** – Shall meet District Standards.
- N. **Fencing** – N/A.
- O. **Service Drives** – N/A.
- P. **Parking** – N/A.
- Q. **Built-ins**
 - 1. Counters and Cabinet/Shelving
 - a. Bookcase with adjustable shelving, 48"x12"x72"
 - b. Storage Cabinet, 48"x30"x72"
 - c. Provide 90" x 24" cabinetry with sink and bubbler; and upper cabinets
 - 2. Instructional Aids
 - a. Interactive board with projector
 - b. Marker board with map rails, 48"x48" (4)
 - c. Tack board, 48" x 48" (3)

EDUCATIONAL SPECIFICATIONS

School Board of Sarasota County Prototype High School

d. Marker Board, 8'x5' Music Staff with 4' tack board above

R. Other Considerations – Design of classroom shall allow for a space to “park” rolling back packs, bookcases, and/or wireless laptop carts where appropriate.

S. Next Generation Technologies – Design to include equipping each classroom with the following Next Generation Technologies

- Interactive board with short throw projector mounted at front instructional area per district specifications
- CCTV channel changer device per district specifications
- Enhancement sound system with four to six speaker installation per district specifications. All media audio (voice, computer, CCTV) will be channeled through audio system.
- Docucam system integrated into video projection screen.

V. SPATIAL RELATIONSHIPS

For spatial relationships, see Band.

EDUCATIONAL SPECIFICATIONS

School Board of Sarasota County Prototype High School

PHYSICAL EDUCATION

I. OBJECTIVES/GOALS

Physical education at all levels should focus on motor skills, knowledge and critical thinking skills necessary for lifelong physical activity that contributes to a healthy lifestyle. Students can benefit from varied experiences that will assist them in evaluating and measuring their own performance. Students can also be involved in activities in which they cooperatively give appropriate feedback to their peers.

II. ACTIVITIES AND ENROLLMENT

The curriculum will consist of various physical activities for group and individualized instruction.

Teacher-Student Ratio: varies

Grade level for which program is intended: 9-12

III. PROGRAM SPACES

NO. SPACES	FISH CODE		DESCRIPTION	NET SQUARE FEET		DESIGN	TOTAL
				UNIT	TOTAL	CAPACITY PER UNIT	STATIONS UTILIZED
			PHYSICAL EDUCATION				
1	112	9-12	Gymnasium Floor	6,500	6,500	160	160
	090/091	6-12	Dressing Room	1,681	3,362		
	092/093		Lockers	280	560		
	094/095		Showers	280	560		
	815/816		Restroom	280	560		
	096/097		Drying Area	280	560		
	099/100		Teacher Toilet/Shower	66	132		
	098		PE Storage	1,261	1,261		
	113		Gym Seating	8,966	8,966		
	114		Laundry/towel	280	280		
	115		First Aid	280	280		
1	116		Training Room & whirlpool	250	250		
1	117		Weight Room	1,000	1,000		
1	118		Wrestling Room	1,680	1,680		
1	119		Gymnastics & Dance	1,050	1,050		
	120		Gym. Storage	420	420		
	370		Lobby	1,401	1,401		
	371		Concessions	200	200		
	372		Ticket Booth	30	30		
	822/823		Public Toilets	280	560		
			Subtotal	26,465	29,612		

EDUCATIONAL SPECIFICATIONS

School Board of Sarasota County Prototype High School

IV. SPECIAL CONSIDERATIONS

- A. Heating/Cooling/Ventilation – Standard. Each space, as per district policy, will be centrally controlled by an energy management system.
- B. Acoustical – Standard acoustical treatment will be provided throughout.
- C. Floor – Shall meet District Standards. Gymnasium floor shall have markings for basketball and volleyball. The Gymnasium floor, dance and wrestling shall be wood. The floor in the weight room shall be rubberized.
- D. Walls – Shall meet District Standards. Wall(s) shall have mirrors in the gymnastic/dance room and weight room. Walls in wrestling room shall be padded.
- E. Ceiling – Shall meet District Standards.
- F. Lighting – Shall meet District Standards.
- G. Windows – Shall meet District Standards. Provide observation windows between locker room and teacher planning.
- H. Doors – Shall meet District Standards.
- I. Water/Plumbing Fixtures – Shall meet District Standards. Provide water fountains at the outdoor playfields. Provide laundry tub in the laundry room.
- J. Communications - Shall meet District Standards.
- K. Electrical - Shall meet District Standards.
- L. Gas and Air - N/A
- M. Safety – Shall meet District Standards.
- N. Fencing – Shall meet District Standards.
- O. Service Drives – Shall meet District Standards.
- P. Parking – Locate outdoor fields near parking for after school activities.
- Q. Built-ins –
 - 1. Locker Room- What size lockers & how many?

EDUCATIONAL SPECIFICATIONS

School Board of Sarasota County Prototype High School

2. Laundry Room – Provide upper cabinets above washer and dryer.
3. Training/1st Aid Room –
 - a. Storage Cabinet, 48"x30"x72"
 - b. Provide 90" x 24" base cabinetry and sink and upper cabinets.
4. Provide metal shelving with adjustable shelving on one wall in all storage rooms. Metal shelving shall start 3' AFF.
5. Concession –
 - a. Provide work counter with two open rows under the counter.
 - b. Provide adjustable shelves with 2" lip opposite of counter.
6. Ticket Booth –
 - a. Provide work counter with money drawer.
7. Instructional Aids
 - a. Interactive board with projector in Multipurpose and Gym.
 - b. Marker board with map rails, 48"x48" in Multipurpose, Weight Room, and Dance.
 - c. Tack board, 48" x 48" in Multipurpose, Locker Rooms, Weight Room, Wrestling and Dance.

R. Other Considerations –

1. Provide outdoor basketball equipment, including post, backboard, rim and net.
2. Provide outdoor volleyball equipment, including volleyball sleeves and standards.
3. Fields shall be provided by School District.
4. Consideration shall be given to locating Gymnastics/Dance near Music, Art, Drama, & Auditorium.

EDUCATIONAL SPECIFICATIONS

School Board of Sarasota County

Prototype High School

V. SPATIAL RELATIONSHIPS

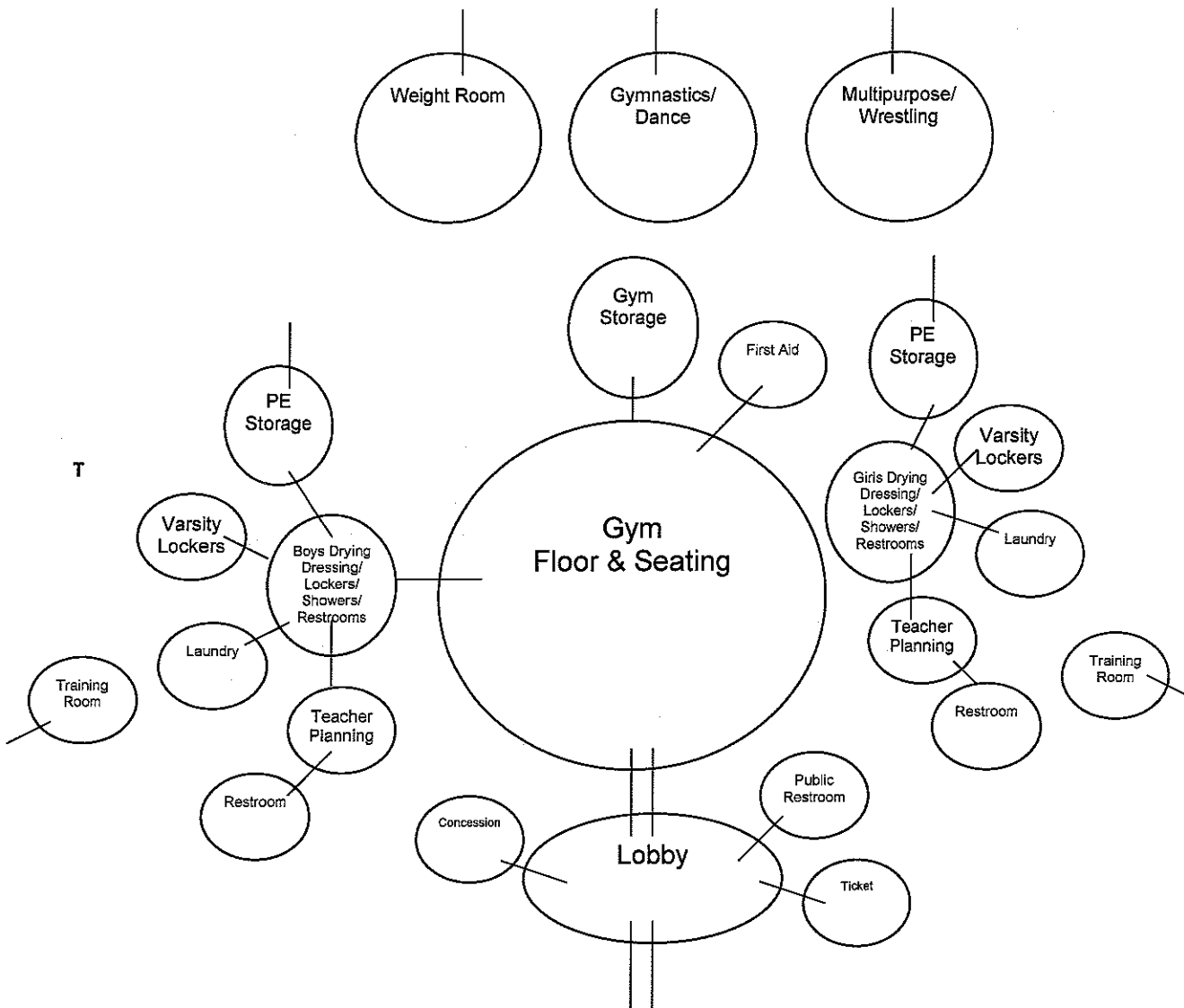

EDUCATIONAL SPECIFICATIONS

School Board of Sarasota County Prototype High School

CAREER AND TECHNICAL EDUCATION

I. OBJECTIVES/GOALS

Career and Technical Education is a group of planned, specialized instructional programs structured to prepare students to explore, enter, advance, and refine prescribed competencies requisite for employment in a cluster of occupations or in a specific occupation chosen as a career objective.

II. ACTIVITIES/ENROLLMENT

Through the arrangement of furniture, materials and supplies, and equipment, a learning laboratory will be created for students to be in large group instruction, small group instruction, and individual instruction. This arrangement will provide an environment that will be physically, mentally, socially, and technically conducive to learning. Students will be provided hands-on learning experiences that will assist students with exploring and preparing for a variety of career opportunities. Activities in the labs will vary depending on which career and technical programs utilize the space. Technology Resource rooms may be used as computer resource rooms or classrooms for related instruction, depending on the instructional program and career focus.

Teacher-Student Ratio: **1:20-1:25**

Grade level for which program is intended: **9-12**

III. PROGRAM SPACES

				NET SQUARE FEET		DESIGN	TOTAL
NO.	FISH					CAPACITY	STATIONS
SPACES	CODE		DESCRIPTION	UNIT	TOTAL	PER UNIT	UTILIZED
	1		BUSINESS EDUCATION				
3	212	9-PS	Education Lab	1,460	4,380	20	60
	808		Storage, Material	100	300		
	812		Storage, Project	150	450		
			Subtotal	1,710	5,130		
			FAMILY & CONSUMER SCIENCE				
1	233	9-PS	Medium Education Lab	1,380	1,380	20	20
	808		Storage, Material	100	100		
	842		Kitchen	125	125		
	843		Laundry	50	50		
	852		Technology Resource	800	800		
			Subtotal	2,455	2,455		
2	234	9-PS	Large Education Lab	2,125	4,250	20	40
	812		Storage, Project	150	300		
	813		Student Storage	40	80		
	842		Kitchen	125	250		

EDUCATIONAL SPECIFICATIONS

School Board of Sarasota County Prototype High School

				NET SQUARE FEET		DESIGN	TOTAL
NO.	FISH					CAPACITY	STATIONS
SPACES	CODE		DESCRIPTION	UNIT	TOTAL	PER UNIT	UTILIZED
	843		Laundry	50	100		
	852		Technology Resource	800	1,600		
			Subtotal	2,865	6,580		
1			TECHNOLOGY EDUCATION				
3	241	9-12	Small Education Lab	1,625	4,875	25	75
3	808		Storage, Material	100	300		
3	852		Technology Resource	800	2,400		
			Subtotal	2,525	7,575		
2	242	9-12	Medium Education Lab	2,375	4,750	25	50
2	810		Storage, Material	395	790		
2	852		Technology Resource	800	1,600		
			Subtotal	3,570	7,140		
2	243	9-12	Large Education Lab	3,375	6,750	25	50
2	808		Storage, Material	100	200		
2	810		Storage, Material	395	790		
2	849		Storage, Project	310	620		
2	851		Storage, Tool	310	620		
2	852		Technology Resource	800	1,600		
			Subtotal	5,290	10,580		
			HEALTH OCCUPATIONS EDUCATION				
2	252	9-PS	Small Education Lab	1,200	2,400	20	20
	804		Dispensary	135	270		
	808		Storage, Material	100	200		
	812		Storage, Project	150	300		
	840		Classroom Related	675	1,350		
			Subtotal	2,260	4,520		

EDUCATIONAL SPECIFICATIONS

School Board of Sarasota County Prototype High School

IV. SPECIAL CONSIDERATIONS

- A. **Heating/Cooling/Ventilation** – Standard. Each space, as per district policy, will be centrally controlled by an energy management system.
- B. **Acoustical** – Standard acoustical treatment will be provided throughout.
- C. **Floor** – Provide resilient flooring in each classroom. Flooring to include raised floor for future networking purposes.
- D. **Walls** – Shall meet District Standards.
- E. **Ceiling** – The ceiling height will be a minimum of 9' with acoustical tile panels.
- F. **Lighting** – Provide energy efficient fluorescent lighting with the capability of separate switching of rows of light parallel to the teaching wall.
- G. **Windows** – Standard. The windows will be operable to allow natural ventilation and/or when required by code. Window treatments will be provided for all exterior windows in order to darken rooms for instructional purposes.
- H. **Doors** – Standard. Exterior doors will be hollow metal with window(s). Doors opening to the outside of the building will also be protected by a security system. Interior doors, except for restrooms, will have window(s).
- I. **Water/Plumbing Fixtures** – Shall meet District Standards.
- J. **Communications** – Shall meet District Standards.
- K. **Electrical** – Shall meet District Standards. Provide outlets for computers, printers and other equipment.
- L. **Gas and Air** – N/A.
- M. **Safety** – Shall meet District Standards.
- N. **Fencing** – N/A.
- O. **Service Drives** – N/A.
- P. **Parking** – N/A.
- Q. **Built-ins**

EDUCATIONAL SPECIFICATIONS

School Board of Sarasota County

Prototype High School

1. Counters and Cabinet/Shelving
 - a. Bookcase with adjustable shelving, 48"x12"x72"
 - b. Storage Cabinet, 48"x30"x72"
 - c. Provide 90" x 24" base and upper cabinets
 2. Instructional Aids
 - a. AV Screen
 - b. Marker board with map rails, 48"x48" (4)
 - c. Tack board, 48" x 48" (3)
- R. Other Considerations** - Design of classroom shall allow for a space to "park" rolling back packs, bookcases, and/or wireless laptop carts where appropriate.
- S. Next Generation Technologies** – Design to include equipping each classroom with the following Next Generation Technologies
- Interactive board with short throw projector mounted at front instructional area per district specifications
 - CCTV channel changer device per district specifications
 - Enhancement sound system with four to six speaker installation per district specifications. All media audio (voice, computer, CCTV) will be channeled through audio system.
 - Docucam system integrated into video projection screen.
 - Appropriate computer technology to provide a one-to-one desktop ratio.

EDUCATIONAL SPECIFICATIONS

School Board of Sarasota County
Prototype High School

- SPATIAL RELATIONSHIPS

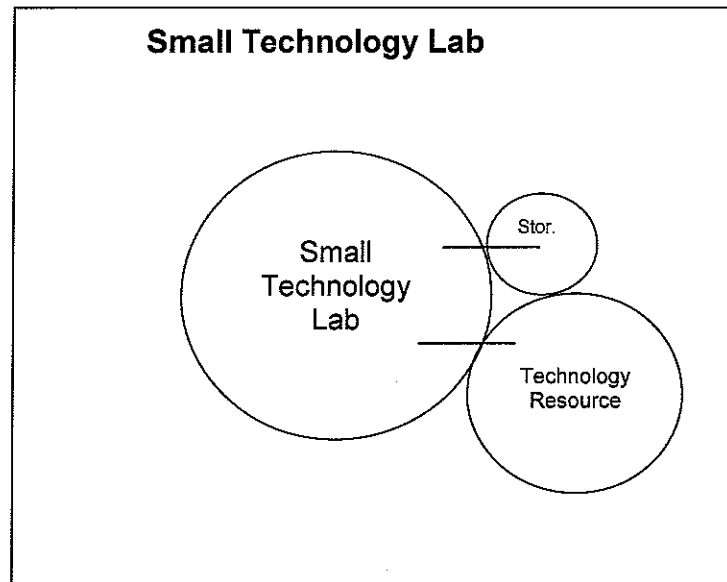
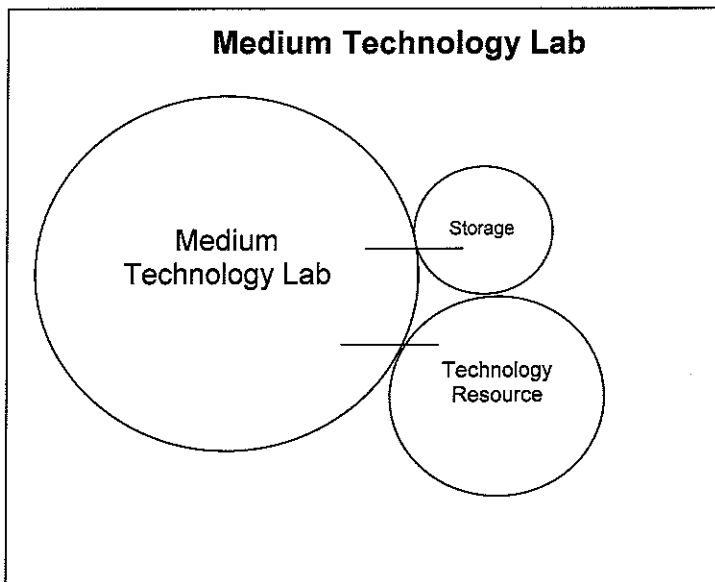
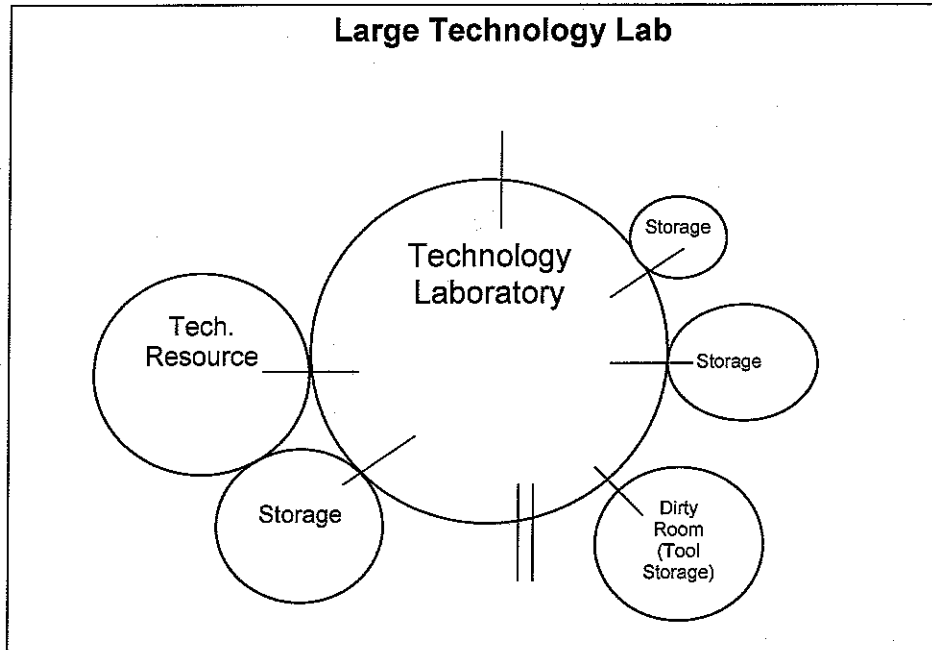

Not all classrooms are shown

EDUCATIONAL SPECIFICATIONS

School Board of Sarasota County

Prototype High School

MEDIA CENTER

I. OBJECTIVES/GOALS

The library media program represents a combination of resources that includes people, services, materials, equipment and facilities. Its prime responsibility is to facilitate the teaching-learning process by providing resources and services that satisfy both individual and instructional needs of students in an atmosphere that promotes inquiry, creativity, self-direction, communication of ideas, and the ability to use rational processes.

II. ACTIVITIES AND ENROLLMENT

Both planned and spontaneous interaction in the library media center can occur concurrently. The library media center program is action centered: it facilitates attainment of knowledge by both individuals and groups using different learning modes and different technologies for transmitting information. As a learning laboratory, the library media center must provide flexibility to permit participation in both active and quiet ways.

Teacher-Student Ratio: varies

Grade level for which program is intended: 9-12

III. PROGRAM SPACES

NO.	FISH		DESCRIPTION	NET SQUARE FEET		DESIGN	TOTAL
				UNIT	TOTAL	CAPACITY	STATIONS
SPACES	CODE					PER UNIT	UTILIZED
			MEDIA CENTER				
1	380	P-PS	Reading Room/Stacks	10,367	10,367		
	381	P-PS	Technical Processing	1,121	1,121		
	382	P-PS	Prod. Professional Lib.	1,121	1,121		
	383	P-PS	A-V Storage	1,681	1,681		
	384	P-PS	Periodical Storage	560	560		
	385	P-PS	C.C. Television	1,961	1,961		
	386	P-PS	C.C.T.V. Storage	1,401	1,401		
	387	P-PS	Media Production Lab	1,401	1,401		
	388	P-PS	Copying Room	560	560		
	389	P-PS	Small Group Listening	280	280		
	390	P-PS	Group Projects	1,401	1,401		
	391	P-PS	Maintenance Repair	280	280		
			Subtotal	22,134	22,134		

EDUCATIONAL SPECIFICATIONS

School Board of Sarasota County Prototype High School

IV. SPECIAL CONSIDERATIONS

- A. **Heating/Cooling/Ventilation** – Standard. Each space, as per district policy, will be centrally controlled by an energy management system. The HVAC system must be able to handle the extra heat generated by the computers and other equipment along with humidity control for the preservation of books.
- B. **Acoustical** – Standard acoustical treatment will be provided throughout. Special sound treatment is necessary for the CCTV area.
- C. **Floor** – Provide carpeting in Media Center, EHPA Office, Conference, Group Projects and resilient flooring in Technical Processing, AV Storage and CCTV.
- D. **Walls** – Shall meet District Standards.
- E. **Ceiling** – The ceiling height will be a minimum of 9' with acoustical tile panels.
- F. **Lighting** – Provide energy efficient fluorescent lighting with the capability of separate switching of rows of light parallel to AV screen.
- G. **Windows** – Standard. Provide observation windows in Technical Processing, Group Projects, and CCTV Control Room.
- H. **Doors** – Standard. Provide large doors for equipment.
- I. **Water/Plumbing Fixtures** – Standard.
- J. **Communications** - Standard
- K. **Electrical** - Provide outlets for computers, printers and other equipment.
- L. **Gas and Air** - N/A.
- M. **Safety** – N/A.
- N. **Fencing** – N/A.
- O. **Service Drives** – N/A.
- P. **Parking** – N/A.
- Q. **Built-ins**

EDUCATIONAL SPECIFICATIONS

School Board of Sarasota County

Prototype High School

1. Counters and Cabinet/Shelving
 - a. Provide storage cabinets with 5 adjustable shelves along two walls (6'h x 4'w x 13"d) in Media Production
 - b. Provide upper and lower cabinets with sink in Media Production.
 - c. Provide upper Cabinets, lower cabinets and drawers with sink in Media Production.
 - d. Provide island base cabinet with drawers for paper and electric in Media Production.
 - e. Provide compartment storage on base with adjustable shelves (12"x6"x17" each compartment) along one wall in AV Storage.
 - f. Provide work counter with drawers in AV Storage.
 - g. Provide open adjustable shelving on one wall of AV Storage
 - h. Provide maximum metal shelving with adjustable shelves on all walls. Provide free-standing shelving for center area, allowing for adequate passage & access.
 - i. Provide 28" base cabinet with doors and drawers in Group Projects. Base cabinets to provide bank of 3"h x 40"w drawers.
 - j. Provide Peg Board, 4'x5' in AV Storage
2. Instructional Aids
 - a. Interactive board with projector
 - b. Marker board with map rails, 48"x48"
 - c. Tack board, 48" x 48"
 - d. Provide storage cubbies
 - e. Provide coat/backpack hooks

R. Other Considerations – N/A.

EDUCATIONAL SPECIFICATIONS

School Board of Sarasota County

Prototype High School

V. SPATIAL RELATIONSHIPS

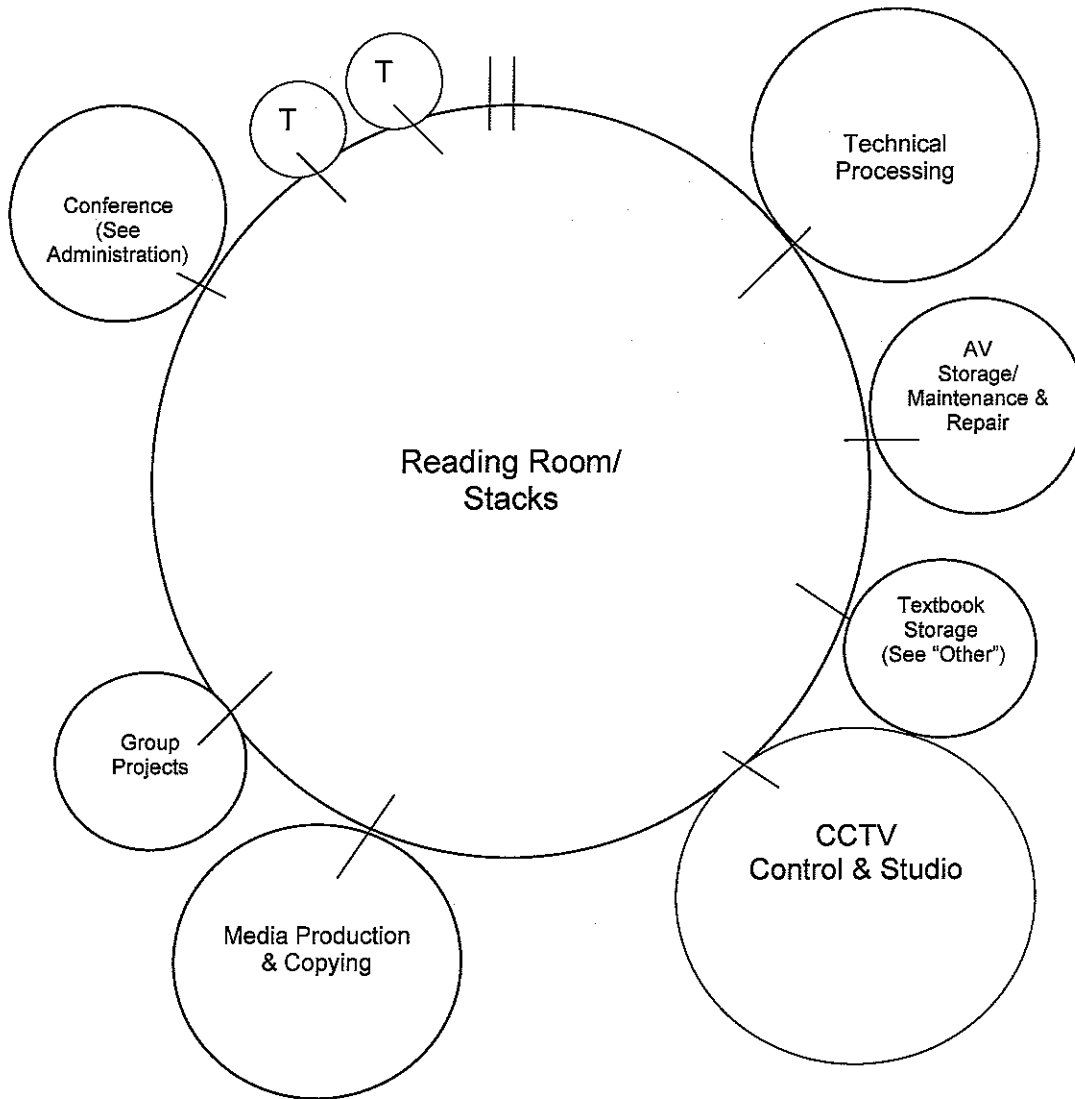

EDUCATIONAL SPECIFICATIONS

School Board of Sarasota County Prototype High School

ADMINISTRATION

I. OBJECTIVES/GOALS

Provide leadership for all activities so that maximum benefits in terms of student growth and development will result. Promote a school culture that will enhance good relations with students, parents, teachers and community. Administrative offices will be throughout the facility to enhance access, communications and supervision.

II. ACTIVITIES AND ENROLLMENT

The activities for the administration/student service area are: reception for students, public and staff; secretarial and bookkeeping duties; conferences; clinic; and storage.

III. PROGRAM SPACES

NO. SPACES	FISH CODE		DESCRIPTION	NET SQUARE FEET		DESIGN	TOTAL
				UNIT	TOTAL	CAPACITY PER UNIT	STATIONS UTILIZED
			ADMINISTRATION				
1	300	N-PS	Principal's/Dir Office	250	250		
16	301	N-PS	Asst Prin/Other Office	175	2,800		
3	302	N-PS	Bookkeeping Office	125	375		
4	303	N-PS	Secretarial Space	158	632		
	304	N-PS	Admin. Reception	2,382	2,382		
	305	N-PS	Production/Workroom	1,121	1,121		
	306	N-PS	Conference Rooms	1,961	1,961		
	307	N-PS	Clinic	841	841		
	308	N-PS	Admin. Storage	1,401	1,401		
	309	N-PS	Records/Vault	841	841		
	310	N-PS	School Store	280	280		
	311	N-PS	Student Activities Area	1,401	1,401		
	312	N-PS	Computer Area	420	420		
	313	N-PS	Careers Room	841	841		
8	314	N-PS	Itinerant Office	125	1,000		
	315	N-PS	Teacher Planning Area	5,604	5,604		
	316	N-PS	Teacher Lounge/Dining	1,121	1,121		
	819- 821	P-PS	Toilets, Staff (M & F)	560	1,120		
			Subtotal	19,607	24,391		

EDUCATIONAL SPECIFICATIONS

School Board of Sarasota County Prototype High School

IV. SPECIAL CONSIDERATIONS

- A. **Heating/Cooling/Ventilation** – Standard. Each space, as per district policy, will be centrally controlled by an energy management system.
- B. **Acoustical** – Standard acoustical treatment will be provided throughout.
- C. **Floor** – Provide carpeting in all administration spaces and resilient flooring in the Clinic.
- D. **Walls** – Shall meet District Standards.
- E. **Ceiling** – The ceiling height will be a minimum of 9' with acoustical tile panels.
- F. **Lighting** – Provide energy efficient fluorescent lighting with the capability of separate switching of rows of light.
- G. **Windows** – Standard. The windows will be operable to allow natural ventilation and/or when required by code.
- H. **Doors** – Standard. Exterior doors will be hollow metal with window(s). Doors opening to the outside of the building will also be protected by a security system. Interior doors, except for restrooms, will have window(s).
- I. **Water/Plumbing Fixtures** – Standard. Provide hot water in clinic for sinks, washer & dryer. Provide water to refrigerator ice makers.
- J. **Communications** – Standard.
- K. **Electrical** - Provide outlets for computers, printers and other equipment.
- L. **Gas and Air** - N/A.
- M. **Safety** – N/A.
- N. **Fencing** – N/A.
- O. **Service Drives** – N/A.
- P. **Parking** – N/A.
- Q. **Built-ins**
 - 1. Counters and Cabinet/Shelving

EDUCATIONAL SPECIFICATIONS

School Board of Sarasota County

Prototype High School

- a. Storage shelving shall be provided by School District.
 - b. Provide Upper and Lower Cabinets with sink in Work Room.
 - c. Provide Upper and Lower Cabinets with sink/eye wash in Clinic.
 - d. Provide Upper and Lower Cabinets with sink in Teacher's Lounge.
2. Instructional Aids
- a. Interactive board with projector in conference room
 - b. Marker board with map rails, 48"x48" in conference room, principal secretary.
 - c. Tack board, 48" x 48" located in reception, Principal's office and Conference Room and outside Assistant Principal's Office.

R. Other Considerations –

1. Locate Video Camera Monitoring Station in hallway of Administration – to be provided by School District per security system standards.

EDUCATIONAL SPECIFICATIONS

School Board of Sarasota County

Prototype High School

V. SPATIAL RELATIONSHIPS

Administration

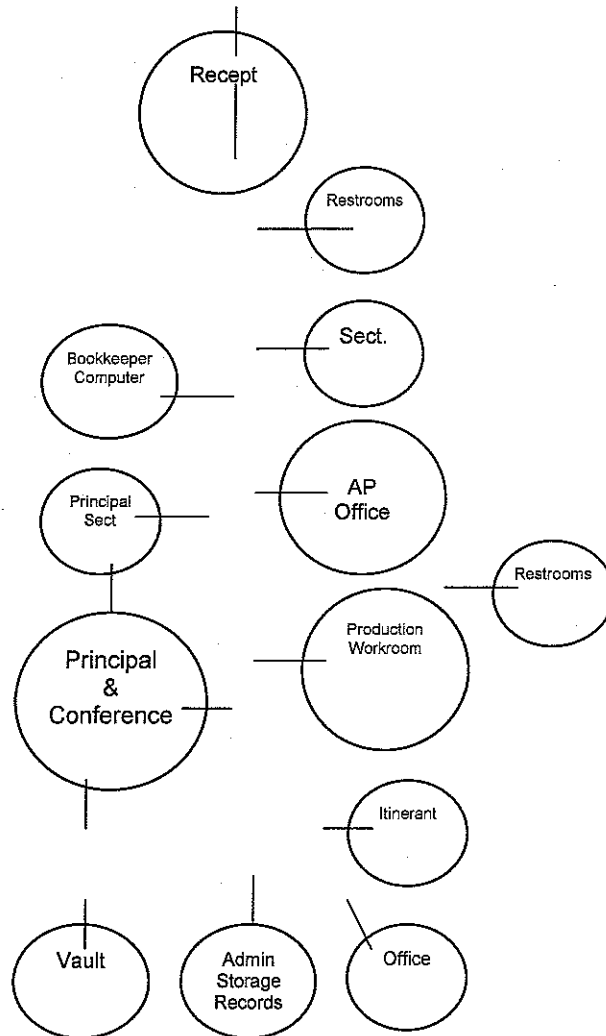

EDUCATIONAL SPECIFICATIONS

School Board of Sarasota County Prototype High School

Student Services

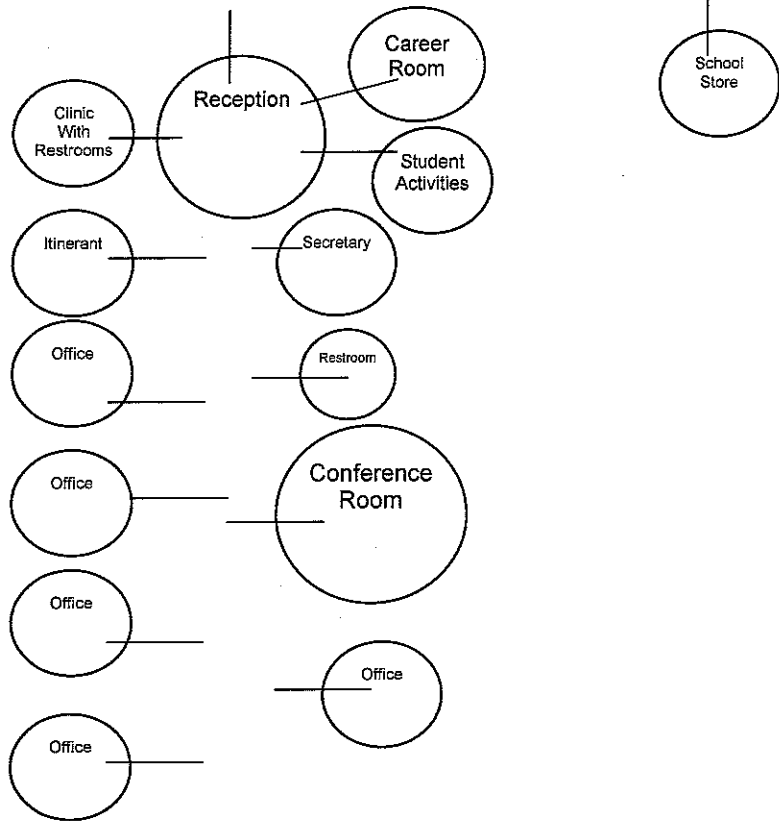

EDUCATIONAL SPECIFICATIONS

School Board of Sarasota County Prototype High School

FOOD SERVICE

I. OBJECTIVES/GOALS

The food service facilities shall be designed to meet the particular needs of the middle school student. It should extend to the student the opportunity to exercise some individuality in selecting from a variety of menu choices. Design considerations should allow for menu selections to be prepared and served in the most efficient manner possible. Dining facilities shall be so designed to offer maximum flexibility and utilization during the entire school day. The design of this facility shall also offer an atmosphere that the student will find both relaxing and functional.

II. ACTIVITIES AND ENROLLMENT

The activities for the food service area are: preparation of food, serving of food and dining.

III. PROGRAM SPACES

NO.	FISH CODE		DESCRIPTION	NET SQUARE FEET		DESIGN	TOTAL
				UNIT	TOTAL	CAPACITY PER UNIT	STATIONS UTILIZED
			FOOD SERVICE				
1	340	N-PS	Dining	11,208	11,208		
	341	N-PS	Kitchen	12,329	12,329		
	349	N-PS	Chair Storage	560	560		
	351	N-PS	Covered Patio	10,087	10,087		
			Subtotal	34,184	34,184		

IV. SPECIAL CONSIDERATIONS

- A. Heating/Cooling/Ventilation – Standard. Each space, as per district policy, will be centrally controlled by an energy management system.
- B. Acoustical – Enhanced acoustical treatment will be provided throughout.
- C. Floor – Provide quarry tile in kitchen areas and resilient flooring in the dining/multi-purpose.
- D. Walls – Shall meet District Standards.
- E. Ceiling – The ceiling height will be a minimum of 9' with acoustical tile panels.
- F. Lighting – Provide energy efficient fluorescent lighting with the capability of separate switching of rows of light.

EDUCATIONAL SPECIFICATIONS

School Board of Sarasota County Prototype High School

- G. Windows** – Standard. The windows will be operable to allow natural ventilation when required by code.
- H. Doors** – Standard. Exterior doors will be hollow metal with peephole. Doors opening to the outside of the building will also be protected by a security system. Interior doors, except for restrooms, will have window(s). Provide large doors for equipment.
- I. Water/Plumbing Fixtures** – Standard.
- J. Communications** – Standard.
- K. Electrical** - Provide outlets for computers, printers and other equipment.
- L. Gas and Air** - N/A.
- M. Safety** – Provide safety systems and equipment as required.
- N. Fencing** – N/A.
- O. Service Drives** – Provide access to service drives for deliveries.
- P. Parking** – N/A.
- Q. Built-ins** - Office- built-in work counter/desk located so that cafeteria manager has view of deliveries as well as kitchen food preparation area. Coordinate lay-out with District.
- R. Other Considerations** – Custodial storage from overall custodial allocations.

EDUCATIONAL SPECIFICATIONS

School Board of Sarasota County

Prototype High School

V. SPATIAL RELATIONSHIPS

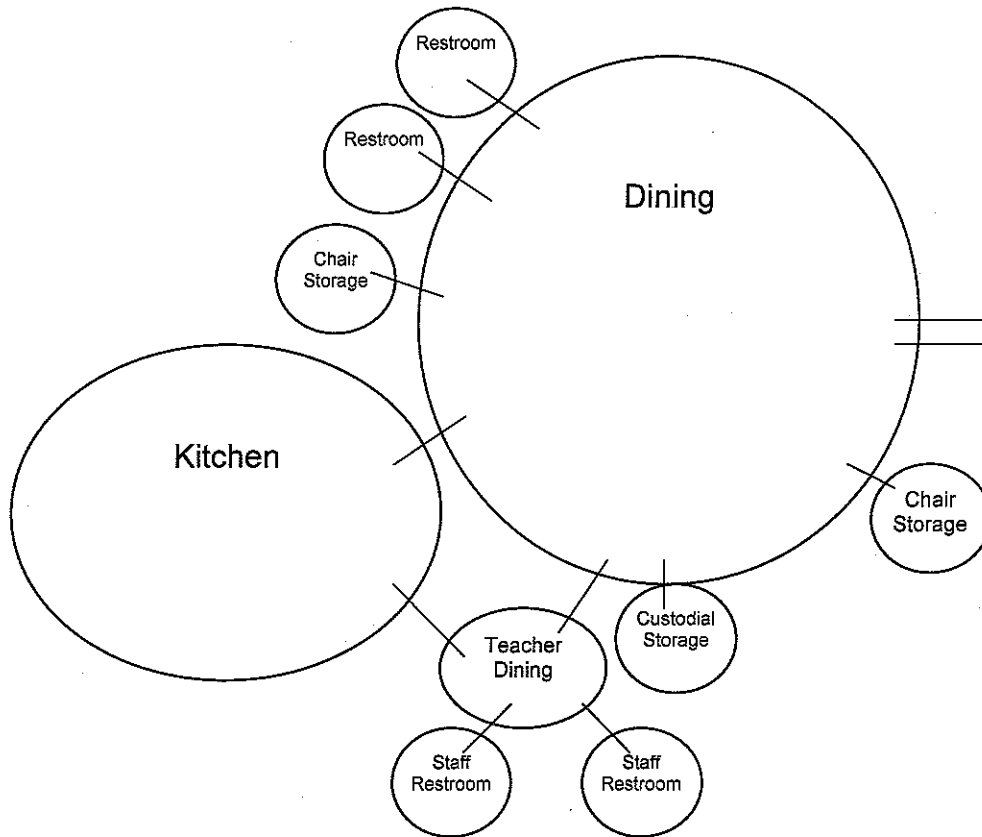

EDUCATIONAL SPECIFICATIONS

School Board of Sarasota County Prototype High School

AUDITORIUM/STAGE

I. OBJECTIVES/GOALS

The Auditorium/Stage area provides support of instructional programs, and to encourage out-of-class use of students and staff. New trends in teaching methods and new awareness of the school as a community center make stage essential auxiliary teaching and community activities spaces for the middle school.

II. ACTIVITIES AND ENROLLMENT

The activities for the programs are presentations and large group assemblies for a variety of purposes - instruction, meetings, displays, etc. A facility for teaching, participation in, and appreciation of, the performing arts.

III. PROGRAM SPACES

NO.	FISH CODE		DESCRIPTION	NET SQUARE FEET		DESIGN	TOTAL
				UNIT	TOTAL	CAPACITY PER UNIT	STATIONS UTILIZED
			AUDITORIUM				
1	360	6-PS	Auditorium Seating	8,406	8,406		
	370	6-PS	Lobby	1,401	1,401		
	371	6-PS	Concessions	200	200		
	372	6-PS	Ticket Booth	30	30		
			Subtotal	10,037	10,037		
			STAGE				
1	363	N-PS	Stage	990	990		
	364	N-PS	Storage	1,401	1,401		
	365/366	N-PS	Dressing (M & F)	1,401	1,401		
	367	N-PS	Control Booth	100	100		
			Subtotal	3,892	3,892		

IV. SPECIAL CONSIDERATIONS

- A. Heating/Cooling/Ventilation – Standard. Each space, as per district policy, will be centrally controlled by an energy management system.
- B. Acoustical – Standard acoustical treatment will be provided throughout.
- C. Floor – Standard. Stage shall be resilient flooring.
- D. Walls – Shall meet District Standards.
- E. Ceiling – Standard.

EDUCATIONAL SPECIFICATIONS

School Board of Sarasota County Prototype High School

- F. **Lighting** – Provide energy efficient fluorescent lighting with the capability of separate switching of rows of light.
- G. **Windows** – Standard. The windows will be operable to allow natural ventilation and/or when required by code.
- H. **Doors** – Standard. Exterior doors will be hollow metal with window(s). Provide double doors or wide doors to the entrance of the stage and to the outside for movement of instruments and scenery. Doors opening to the outside of the building will also be protected by a security system. Interior doors, except for restrooms, will have window(s).
- I. **Water/Plumbing Fixtures** – Standard.
- J. **Communications** – Standard.
- K. **Electrical** - Provide outlets for computers, printers and other equipment. Provide a data plug mid-stage.
- L. **Gas and Air** - N/A.
- M. **Safety** – Provide safety systems and equipment as required.
- N. **Fencing** – N/A.
- O. **Service Drives** – N/A.
- P. **Parking** – N/A.
- Q. **Built-ins** – N/A.
- R. **Other Considerations** - Attention must be paid to acoustics for the music performances and theatre performances (plays) in addition to other assemblies.

V. SPATIAL RELATIONSHIPS

Refer to Music Section for spatial relationships.

EDUCATIONAL SPECIFICATIONS

School Board of Sarasota County Prototype High School

CUSTODIAL

I. OBJECTIVES/GOALS

To provide a safe, sanitary and aesthetically acceptable learning and work environment through proper utilization of human resources, materials, equipment and methods.

II. ACTIVITIES AND ENROLLMENT

The activities for the custodial staff are: prepare and maintain work schedules; maintain restrooms, water fountains, showers and sinks; maintain custodial equipment; and assure school grounds are kept free of litter and safety hazards.

III. PROGRAM SPACES

NO.	FISH	FISH	DESCRIPTION	NET SQUARE FEET		DESIGN	TOTAL
				UNIT	TOTAL	CAPACITY	STATIONS
SPACES	CODE					PER UNIT	UTILIZED
			CUSTODIAL				
1	330	N-PS	Custodial Receiving	4,203	4,203		
1	333	N-PS	Flammable Storage	155	155		
	334	N-PS	Equipment Storage	500	500		
			Subtotal	4,858	4,858		

IV. SPECIAL CONSIDERATIONS

- A. Heating/Cooling/Ventilation – Standard. Each space, as per district policy, will be centrally controlled by an energy management system.
- B. Acoustical – Standard acoustical treatment will be provided throughout.
- C. Floor – Standard.
- D. Walls – Shall meet District Standards.
- E. Ceiling – The ceiling height will be a minimum of 9' with acoustical tile panels.
- F. Lighting – Provide energy efficient fluorescent lighting with the capability of separate switching of rows of light.
- G. Windows – Standard. The windows will be operable to allow natural ventilation and/or when required by code.
- H. Doors – Standard. Exterior doors will be hollow metal with window(s). Doors opening to the outside of the building will also be protected by a

EDUCATIONAL SPECIFICATIONS

School Board of Sarasota County Prototype High School

security system. Interior doors, except for restrooms, will have window(s). Provide large (4') door for equipment storage adjacent to dining.

- I. **Water/Plumbing Fixtures** – Standard. Provide an emergency eye wash station in Custodial Central Receiving.
- J. **Communications** – Standard.
- K. **Electrical** - Provide outlets for computers, printers and other equipment. Provide outlets on campus for recharge of golf carts.
- L. **Gas and Air** - N/A.
- M. **Safety** – Provide safety systems and equipment as required.
- N. **Fencing** – N/A.
- O. **Service Drives** – N/A.
- P. **Parking** – N/A.
- Q. **Built-ins**
 - 1. Provide Metal Work Bench (24"dx8'l) in Custodial Central Receiving.
 - 2. Provide (2) Metal shelf Units (24"dx36"wx72"h) each with 4 adjustable shelves and lockable doors in Custodial Central Receiving.
 - 3. Provide (4) Metal Shelf Units (24"dx36"wx72") each with first shelf at 24" AFF and remainder at 16" OC.
- R. **Other Considerations** – N/A.

EDUCATIONAL SPECIFICATIONS

School Board of Sarasota County

Prototype High School

V. SPATIAL RELATIONSHIPS

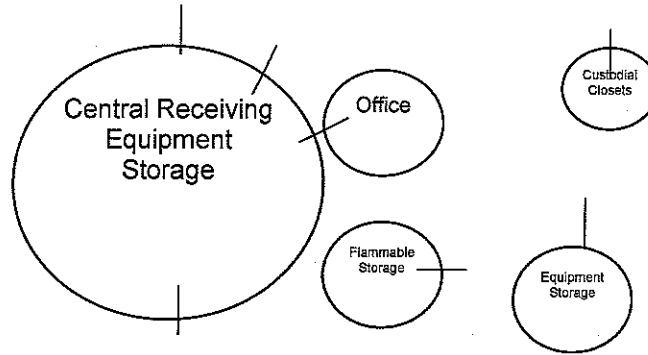

The number and location of custodial closets per code.