

Ancient Sites & Buildings.

Bagenalstown Area

Dunleckney Manor House

Dunleckney. *Dun Leicne. The fort of the flags.* The townland is situated to the north of the modern town of Muine Bheag, founded by Walter Bagenal in 1790 and known locally as Bagenalstown. History records that his ancestor George Bagenal built a manor house here in 1612.

In 1845 the Georgian style building was demolished completely and replaced with the present manor, designed in the Tudor Revival style by Robertson. Construction work by William Morrison of Station Road, Bagenalstown. Granite stone used in its construction was quarried at Boherduff nearby. The intricate carved stonework at the front of the building came from a deposit of very fine granite found at Kilcarrig Rocks. Bangor blue slate for the roof was installed by a team of slaters from Wales.



Fig 1; Illustration of Dunleckney Manor circa 1830. Courtesy of John Bagenal, Herts, England

Part of this 17th c building still exists at the back of the present manor (ie east side). In the 18th c the house was extended to the west. This building is depicted in the illustration given at Fig 1. The artist shows a large two storey house in the Georgian style adjoining the original 17th c building. The ground plan extended further west and east of the present 19th c house.

∪

The manor house site was surveyed by the authors in 2003. Diving techniques were used to determine the presence of earlier buildings on site. Four building dated to the 15th c were eventually found. These are shown in the drawing at Fig 2 below. They include a large baronial house, a smaller dwelling, coach-house and one of unknown purpose.

Two other buildings (not shown) dated to 17th c were located to the north beyond the pond crossing the rose garden. One of these measured 80' x 48' (24.4 x 14.6m) and was fitted with stalls for horses. The second building was similar but lofted (presumably for winter fodder) *Note that in the era of the big ascendancy houses their owners were required to maintain a regiment of yeomanry or militia. Stabling was also required for the horses of family & guests.*

References; *Carlow, Visitors Guide. Carlow Junior Chamber, 1981*

Architectural Heritage of Carlow. 2002

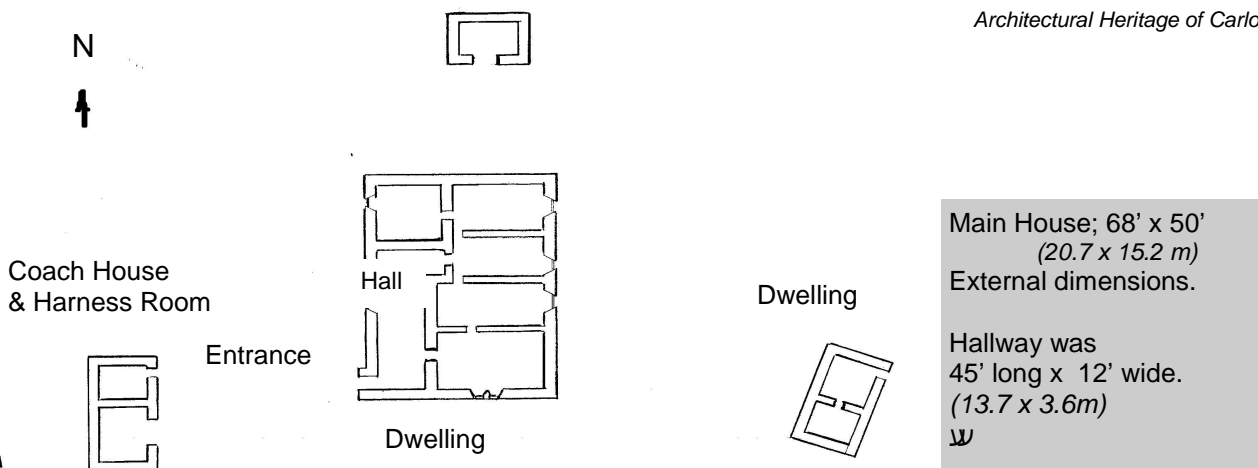

Fig 2 15th Century buildings located beneath and around the present Dunleckney Manor



Late 19th c photographs. Laurence Collection. Courtesy of the National Library.

View from South



View from North-west