



Engine Shed Cottage, Waterstead Lane, Whitby, North Yorkshire, YO21 1AE

Guide Price £149,950

Ref: 8604/TJR

This stunning conversion of part of Whitby's railway history is simply a must view for those looking for a town centre holiday cottage and something a little bit different.

Part of the Grade II listed Engine Shed, the cottage has put a modern contemporary twist within the stone walls of one of Whitby's historic buildings. The cottage comprises open plan lounge kitchen with utility and cloakroom off, and a generous double bedroom with en-suite, with high quality fixtures and fittings throughout, including the full range of integral appliances, underfloor heating throughout and double glazing to the windows.

Outside there is a parking space for one car and a small patio to sit out on and enjoy the steam trains of the NYM railway come by, whilst also being within easy walking distance of Whitby's busy town centre and all the amenities it enjoys.

Engine Shed Cottage, Windsor Terrace, Whitby, North Yorkshire, YO21 1ET

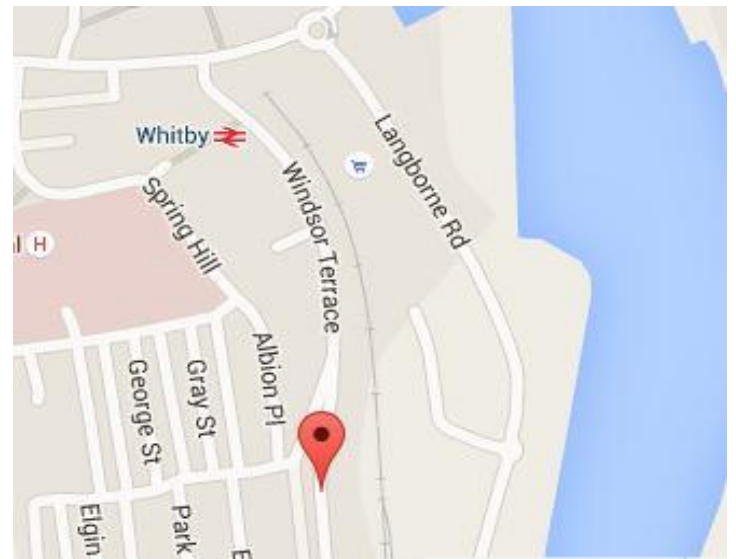
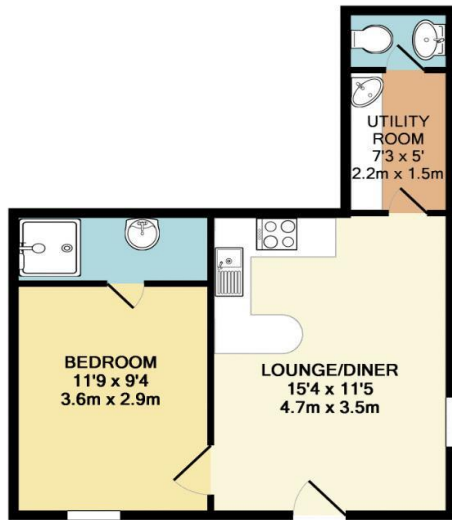

Whilst every attempt has been made to ensure the accuracy of the floor plan contained here, measurements of doors, windows, rooms and any other items are approximate and no responsibility is taken for any error, omission, or mis-statement. This plan is for illustrative purposes only and should be used as such by any prospective purchaser. The services, systems and appliances shown have not been tested and no guarantee as to their operability or efficiency can be given
Made with Metropix ©2015

TENURE:

We have not had sight of the Title Deeds but believe the property to be held on a Freehold basis.

COUNCIL TAX:

The property is to be assessed by Scarborough Borough Council in due course

SERVICES:

All mains services are connected to the property, with the exception of mains gas.

Astin's is the trading name of Edward G Astin & Associates Ltd (the Company). The Company for itself and for the vendor(s) or lessor(s) of this property for whom it acts as Agents gives notice that:

- (i) The particulars are a general outline only for the guidance of intending purchasers or lessees and do not constitute an offer or contract
- (ii) All descriptions are given in good faith and are believed to be correct, but any prospective purchasers or lessees should not rely on them as statements of fact and must satisfy themselves by inspection or otherwise as to their correctness
- (iii) All measurements of rooms contained within these particulars should be taken as approximate and it is the responsibility of the prospective purchaser or lessee or his professional advisor to determine the exact measurements and details as required prior to Contract
- (iv) None of the property's services or service installations have been tested and are not warranted to be in working order
- (v) No employee of the Company has any authority to make or give any representation or warranty whatsoever in relation to the property