



COYOTE® Silicone Grommet Kits

Be sure to read and completely understand this procedure before applying product. Be sure to select the proper size PREFORMED™ product before application.

NOMENCLATURE

1. End Plate Grommet
2. Plugs (one provided for each grommet entry)
3. Measure Tape
4. Silicone Lubricant (1)
5. Glove (1)

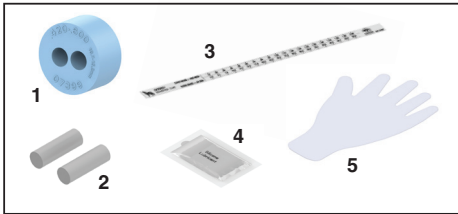

Step #1 Measure the cable to determine the diameter and hole location to use in the grommet.

Step #2 If using cut cable, insert the cable through the grommet. If your application requires express cables, see Step 4 for grommet slitting procedure.

COYOTE Silicone Grommet Kits				
PLP Catalog Number	Cable Range Inches (mm)	Description	Image	Slitting Location
8003691	.40" - .60" (10.2 - 15.2 mm)	1-entry grommet		
8003692	.60" - .85" (15.2 - 21.6 mm)	1-entry grommet		
8003693	.85" - 1.0" (21.6 - 25.4 mm)	1-entry grommet		
8003694	1.0" - 1.25" (25.4 - 31.7 mm)	1-entry grommet		
8003663	.42" - .60" (10.7 - 15.2 mm)	2-entry grommet		
8004122	RPX Only	2-entry grommet		
8004065	.250" - .312" (6.4 - 7.9 mm)	4-entry grommet		
8003664	.30" - .43" (7.6 - 10.9 mm)	4-entry grommet		
8003990	.50" - .60" (12.7 - 15.2 mm) .125" - .25" (3.2 - 6.4 mm) and flat drop	4-entry grommet		
8003665	.125" - .25" (3 - 6mm) and flat drop	6-entry grommet		
8003676	.42" - .60" (10.7 - 15.2 mm) .125" - .25" (3.2 - 6.4 mm) and flat drop	7-entry grommet		
8004094	.093" - .125" (2.4 - 3.2 mm)	8-entry grommet		
8003677	.125" - .25" (3.2 - 6.4 mm) and flat drop	8-entry grommet		

NOTE: Grommet Kit contains (1) Grommet, (1) Cable Measure Tape, (1) Silicone Lubricant Pack, (1) Set of Plugs, (1) Glove

Step #3 Installing Figure 8 Style Cables and Cables with Tracer Wires

Remove the tracer wire or ground wire from the portion of the cable that will be positioned in the grommet and insert the cable into the grommet. Remove any burrs left on the cable caused by separating the tracer wire from the sheath.

Cable with Tracer Wire



Not Correct Installation



Correct Installation

Figure 8 Style Cable



Not Correct Installation



Correct Installation

Step #5 Lubricate the outer surface of each grommet. Spread the lubricant evenly around the outer surface.

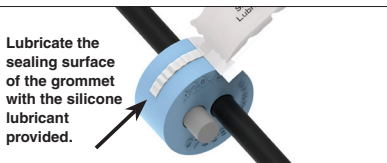

Step #5 Future Entry

Loosen bolts on End Plate Cap.
Remove the plug from the grommet entry hole selected for the future cable entry.
Carefully pierce the thin layer of material on the outside surface of the grommet and push the cable through the grommet.
Retighten bolts on End Plate Cap.

Step #4 Grommet Slitting – If slitting is required, lay the grommet on a stable flat surface. Position the utility knife with the cutting edge against the top surface and cut through the grommet. Consult the grommet chart on page 1 for slitting locations of all grommets.

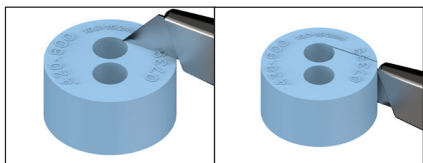

PLP Tip: Use a pen to sketch slitting lines on top surface of grommet prior to cutting.

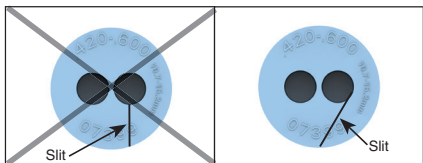

Not Correct Slitting Angle

Correct Slitting Angle

SAFETY CONSIDERATIONS

This application procedure is not intended to supersede any company construction or safety standards. This procedure is offered only to illustrate safe application for the individual. **FAILURE TO FOLLOW THESE PROCEDURES MAY RESULT IN PERSONAL INJURY OR DEATH.**

Do not modify this product under any circumstances.

This product is intended for use by trained technicians only. **This product should not be used by anyone who is not familiar with, and not trained to use it.**

When working in the area of energized lines, extra care should be taken to prevent accidental electrical contact.

For proper performance and personal safety, be sure to select the proper size PREFORMED™ product before application.

PREFORMED products are precision devices. To ensure proper performance, they should be stored in cartons under cover and handled carefully.