

**PART A: Information relating to the applicant and land to which the application relates
(all applicants must complete this Part)**

1. Name of appropriate authority to which the application is addressed:
Cheshire West and Chester Council

2. Name and full address (including postcode) of applicant:
**Philip Wilbraham, Michael Ewart-Smith & Paul Abbott as Trustees of the Wilbraham (HD) 1996 Grandchildren Trust
c/o Strutt & Parker
15 Dyer Street
Cirencester
Gloucestershire
GL7 2PP**

3. Status of applicant (tick relevant box or boxes):

I am

- (a) the owner of the land(s) described in paragraph 4.
(b) making this application and the statements/declarations it contains on behalf of **Trustees of the Wilbraham (HD) 1996 Grandchildren Trust** who are the owners of the land(s) described in paragraph 4 and in my capacity as **Managing Agent**.

4. Insert description of the land(s) to which the application relates (including full address and postcode):

1 Poplar Cottage, Cuddington Lane, Northwich, Cheshire, CW8 2SZ
Various parcels of Land and Buildings near Sweet Briar, Camomile Farm and Gallowsclough Farm

5. Ordnance Survey six-figure grid reference(s) of a point within the area of land(s) to which the application relates (if known):

SJ 57833 71386

6. This deposit comprises the following statement(s) and/or declarations (*delete Parts B, C, or D where not applicable*):

Part A, Part C Part F

~~PART B: Statement under section 31(6) of the Highways Act 1980~~

PART C: Declaration under section 31(6) of the Highways Act 1980

- The Trustees of the Wilbraham (HD) 1996 Grandchildren Trust** are the owners of the land described in paragraph 4 of Part A of this form and shown edged in red on the map accompanying this declaration
- On the 28th day of May 2014 we the **Trustees of the Wilbraham (HD) 1996 Grandchildren Trust** deposited with Cheshire West & Chester Council, being the appropriate council, a statement accompanied by a map showing the **Trustees of the Wilbraham (HD) 1996 Grandchildren Trust** property edged in red which stated that no ways had been dedicated as highways over **Trustees of the Wilbraham (HD) 1996 Grandchildren Trust** property.
- No additional ways have been dedicated over the land edged in red on that map accompanying that statement since the statement dated **21st May 2014** referred to in paragraph 2 above and at the

present time Trustees of the Wilbraham (HD) 1996 Grandchildren Trust has no intention of dedicating any more public rights of way over the property.

~~PART C: Declaration under section 31(6) of the Highways Act 1980~~

~~PART D: Statement under section 15A(1) of the Commons Act 2006~~

**~~PART E: Additional information relevant to the application
(insert any additional information relevant to the application)~~**

**PART F: Statement of Truth
(all applicants must complete this Part)**

WARNING: If you dishonestly enter information or make a statement that you know is, or might be, untrue or misleading, and intend by doing so to make a gain for yourself or another person, or to cause loss or the risk of loss to another person, you may commit the offence of fraud under section 1 of the Fraud Act 2006, the maximum penalty for which is 10 years' imprisonment or an unlimited fine, or both.

I BELIEVE THAT THE FACTS AND MATTERS CONTAINED IN THIS FORM ARE TRUE

Signature (of the person making the statement of truth):



Print full name: **Kerry Holbrook-Bull as Authorised Managing Agent for Trustees of the Wilbraham (HD) 1996 Grandchildren Trust**

Date: **5th June 2014**

Data Protection Act 1998 - Fair Processing Notice

The purpose of this Fair Processing Notice is to inform you of the use that will be made of your personal data, as required by the Data Protection Act 1998.

The appropriate authority (see explanation of definition in above guidance notes) in England is the data controller in respect of any personal data that you provide when you complete this form.

The information that you provide will be used by the appropriate authority in its duties to process applications to deposit statements, maps and declarations under section 31(6) the Highways Act 1980 and statements under section 15A(1) of the Commons Act 2006. The information you provide will also be used by the appropriate authority in its duty to update the registers in which details of such deposits are recorded under the Dedicated Highways (Registers under Section 31A of the Highways Act 1980) (England) Regulations 2007 and the Commons (Registration of Town or Village Greens) and Dedicated Highways (Landowner Statements and Declarations) (England) Regulations 2013.

The appropriate authority is required by the legislation above to maintain a register which holds information provided in this form, which can be inspected online or in person by members of the public on request. It may also be required to release information, including personal data and commercial information, on request under the Environmental Information Regulations 2004 or the Freedom of Information Act 2000. However, the appropriate authority will not permit any unwarranted breach of confidentiality nor will they act in contravention of their obligations under the Data Protection Act 1998.

Strutt & Parker

15 Dyer Street, Cirencester, Gloucestershire, GL7 2PP
01285 659661

S.31(6) Highways Act 1980 Statutory Declaration

SCALE : 1 : 10000 @ A4 DATE : 05/06/2014

MAP FILENAME :
[Filename]

Pear Technology Services Ltd. Email info@peartechnology.co.uk
Maps based on Ordnance Survey MasterMap or 1:25000 Mid-scale data
with the permission of the Controller of HMSO. © Crown Copyright

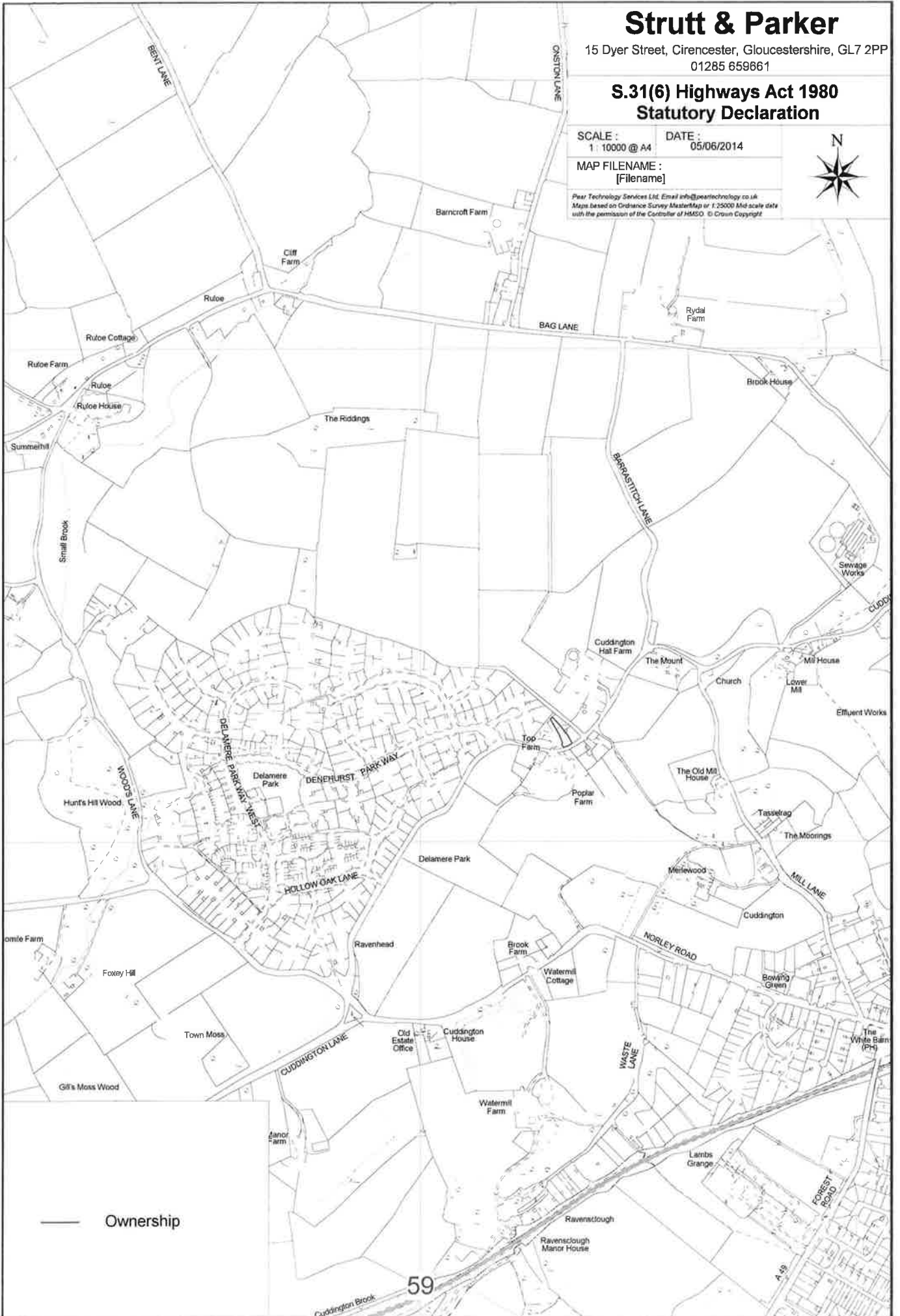

— Ownership

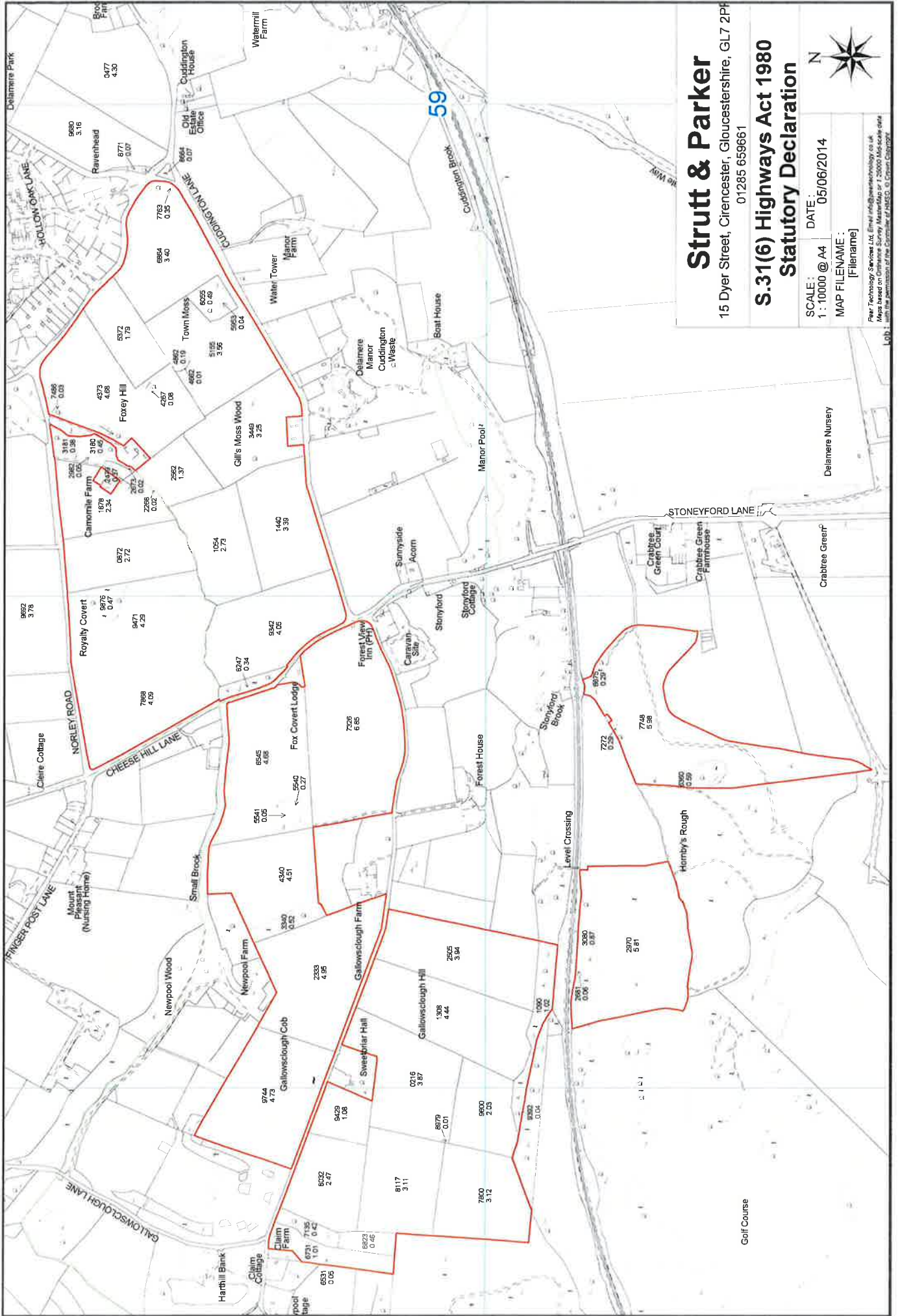

Strutt & Parker

15 Dyer Street, Cirencester, Gloucestershire, GL7 2PF
01285 659661

S.31(6) Highways Act 1980 Statutory Declaration

SCALE: 1 : 10000 @ A4
DATE: 05/06/2014
MAP FILENAME: [Filename]



Plan Technology Services Ltd, Email: info@plan-technology.co.uk
Map based on Ordnance Survey Masterfile or 1:25000 Map scale data
LOB 1 with the permission of the Controller of HMSO, © Crown Copyright